

Bench Mark Top of S.D. Inlet @ curb Elev. 433.96

Bench Mark Top of S.D. Inlet @ Face Elev. 443.38

Bench Mark Square cut in top of curb. Elev. 462.02

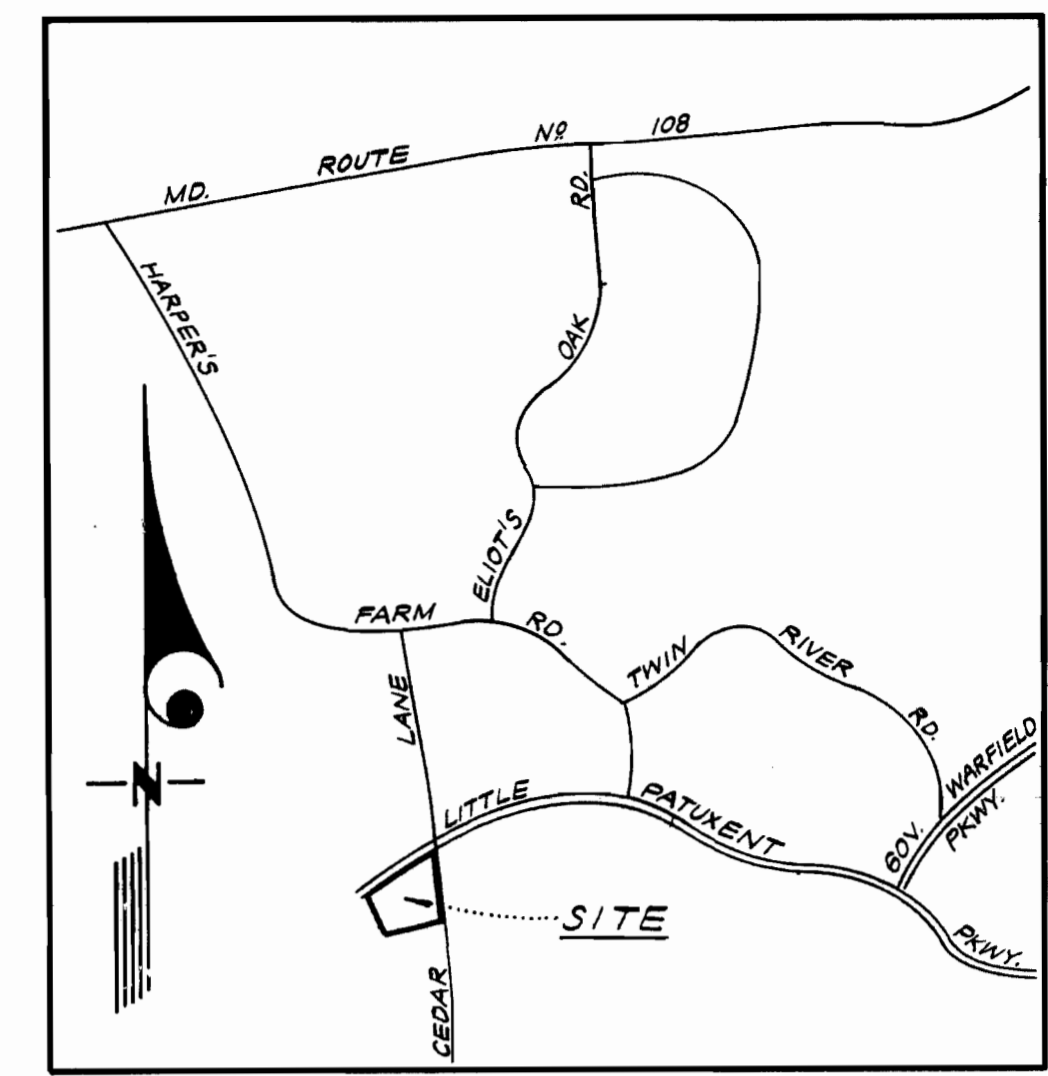

VICINITY MAP SCALE: 1"=2000'

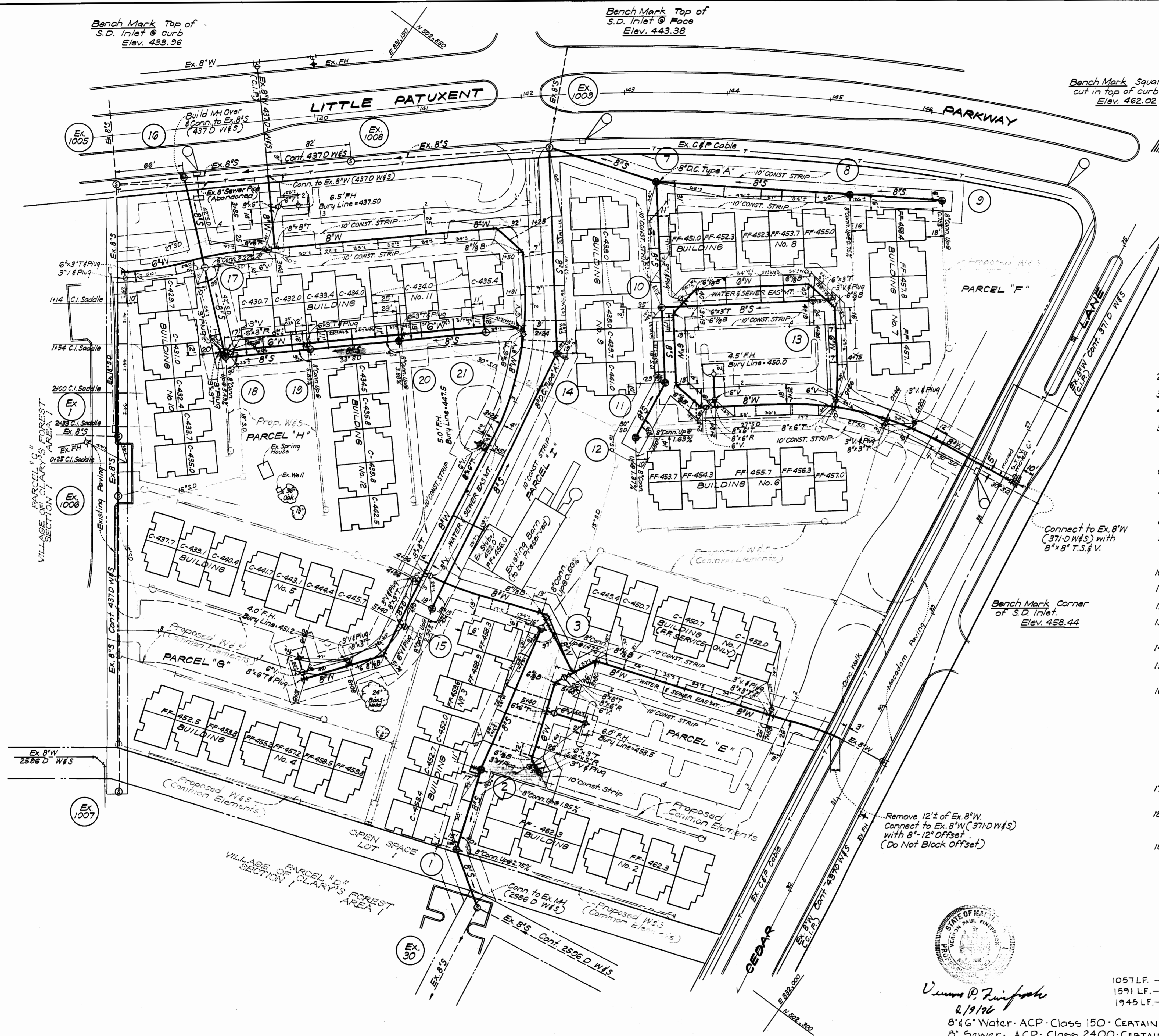

**GENERAL NOTES**

- All water mains to be C.I.P., D.I.P. or A.C.P. unless otherwise shown.
- Top of all water mains to have a minimum of 3.5 ft. cover unless otherwise noted.
- All valves shall be strapped to tees in accordance with standard details.
- Block all fittings with concrete, see standards bound in specifications.
- Bury line elevations on fire hydrants shall be set to the elevations shown on the drawings. All fire hydrants shall be strapped and buttressed with concrete in accordance with standard details. Soil around the fire hydrants to be compacted in accordance with Section 5-15 of the Standard Specifications.
- All sewer mains shall be C.S.P.X., V.C.P.X., or A.C.P. Class 2400 unless otherwise noted.
- The contractor shall provide a joint in all sewer mains within 2'-0" of exterior manhole wall.
- All manholes shall be 4'-0" inside diameter, unless otherwise noted.
- Approximate locations of existing mains are shown. The contractor shall take all necessary precautions to protect existing mains and services and maintain uninterrupted supply. Any damage incurred shall be repaired immediately.
- All horizontal controls are based on Maryland State Coordinates.
- All vertical controls are based on U.S.G.S. Datum.
- All pipe elevations shown are invert elevations.
- Clear all utilities by a minimum of 6"; Clear all poles by 2'-0" minimum or tunnel as required.
- For all standard details see standards bound in specifications.
- Contractor shall locate existing utilities in advance of construction operations in the vicinity of proposed utilities.
- Contractor shall notify the following utilities or agencies at least five (5) days before starting work shown on these plans:
  - State Highway Administration - 531-5533
  - Baltimore Gas and Electric Company - Underground Electric Distribution Engineering - "Damage Control" - 234-5881
  - Baltimore Gas and Electric Company - Underground Gas Distribution Engineering - 550-0100
  - Chesapeake and Potomac Telephone Co. - 725-0976
  - American Telephone and Telegraph - Cable Location Division - 301-393-3553
  - Colonial Pipeline Company - 781-4641
- Trees are to be protected from damage to maximum extent. Trees located within the construction strip are not to be removed or damaged by the contractor.
- Contractor shall remove trees, stumps and roots along line of excavation as directed by the Engineer. Payment for such removal, shall be included in the unit price bid for excavation and backfill for water and sewer mains.
- Place regulation "Men Working" and warning signs as required to comply with Maryland State Highway Administration Manual of Traffic Control for Highway Construction and Maintenance Operations.

**LEGEND**

PUBLIC W&S  
PRIVATE W&S SYSTEM  
(NOT INCLUDED IN THIS CONTRACT)

ITEM	QUANTITY
1057 LF. 6" Water	+655 LF
1591 LF. 8" Water	+596 LF
1945 LF. 8" Sewer	+926 LF

COLUMBIA  
VILLAGE OF CLARY'S FOREST  
SECTION I AREA I  
PARCELS "E, F, G, H & I"  
CONTRACT 2635 D W&S



Vernon P. Fineprock  
2/19/76  
8" Water - ACP - Class 150 - CERTAIN TEED  
8" Sewer - ACP - Class 2400 - CERTAIN TEED

**CLARK • FINEPROCK & SACKETT**  
ENGINEERS • PLANNERS • SURVEYORS  
11315 LOCKWOOD DRIVE • SILVER SPRING, MARYLAND 20904

DEPARTMENT OF PUBLIC WORKS  
HOWARD COUNTY, MARYLAND  
3-24-76  
DATE

CONTRACT NO. 2635 D W&S

PLAN OF  
WATER & SEWER MAINS

COLUMBIA  
VILLAGE OF CLARY'S FOREST  
ELECTION DISTRICT - CLARKSVILLE No. 5

DRAWING  
NO. 1  
OF 2  
SCALE  
1" = 50'

As Built 10-22-76

BUILDINGS NO 10, 11 & 12

EXISTING BARN

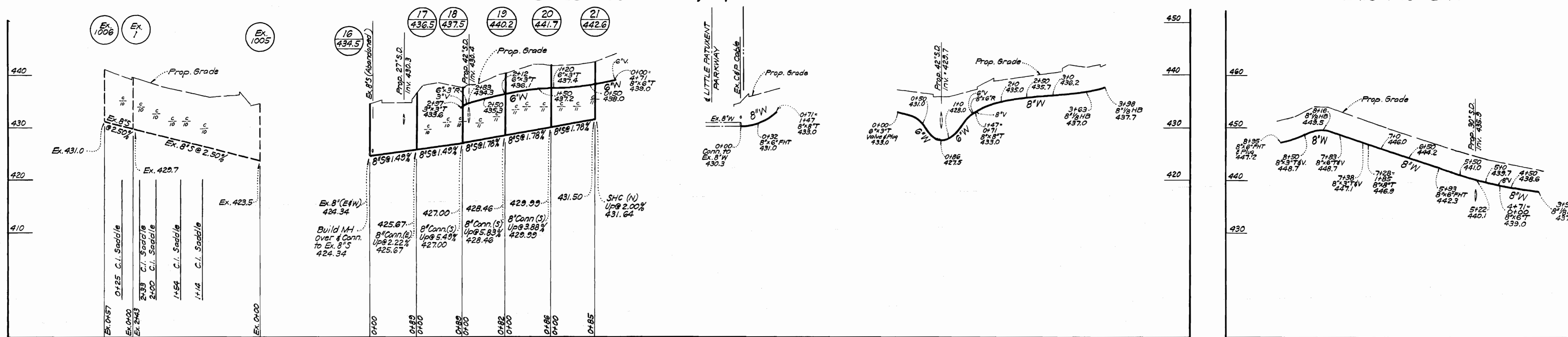

BUILDING NO 9 & EXIST. BARN

BETWEEN EXIST. BARN & BLDG. NO 3

BUILDINGS NO 6, 7, 8 & 9

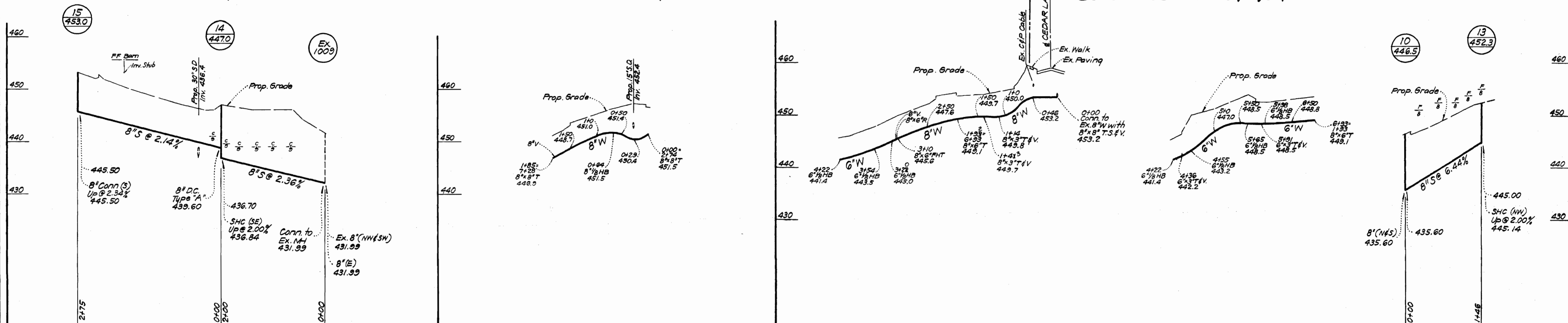

BUILDINGS NO 1, 2 & 3

BUILDINGS NO 6, 8 & 9

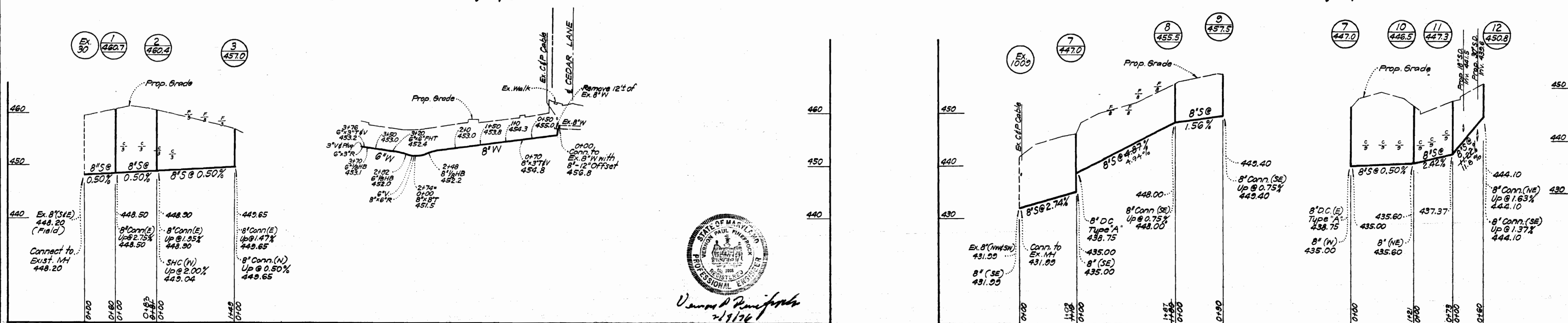

James P. Penfold  
2/19/76

**CLARK • FINEFROCK & SACKETT**  
ENGINEERS • PLANNERS • SURVEYORS

13315 LOCKWOOD DRIVE SILVER SPRING, MARYLAND 20904

**DEPARTMENT OF PUBLIC WORKS**  
HOWARD COUNTY, MARYLAND

70 Road 3-24-76  
DIRECTOR OF PUBLIC WORKS DATE CHIEF BUREAU OF ENGINEERING DATE

CONTRACT NO. 2635 D W & S

**PROFILES OF WATER & SEWER MAINS**

**COLUMBIA VILLAGE OF CLARY'S FOREST ELECTION DISTRICT - CLARKSVILLE No. 5**

**DRAWING NO. 2 OF 2 SCALE Hor. 1"=100' Ver. 1"=10'**

As Built 10-22-1976