

**BENCH MARKS**

- P & J B.M. "T-1" Elev. 366.71  
Southwest corner of Baltimore Gas and Electric Pad #40036
- P & J B.M. "T-2" Elev. 384.96  
Roofing nail and red flagging found top of curb, 60'± southeast of P.I. "BB-4" on Lynngate Court.
- P & J B.M. "T-3" Elev. 372.25  
Southwest corner of inlet rim, 63'± northeast of P.I. "BB-2" on Lynngate Road.
- P & J B.M. "T-4" Elev. 376.69  
Southwest corner of inlet rim at East edge of blacktop drive, north side of Darlington Road.
- P & J B.M. "T-5" Elev. 383.73  
Roadside Bonnet bolt of fire hydrant on East side of intersection of Durham Road and Darlington Road.

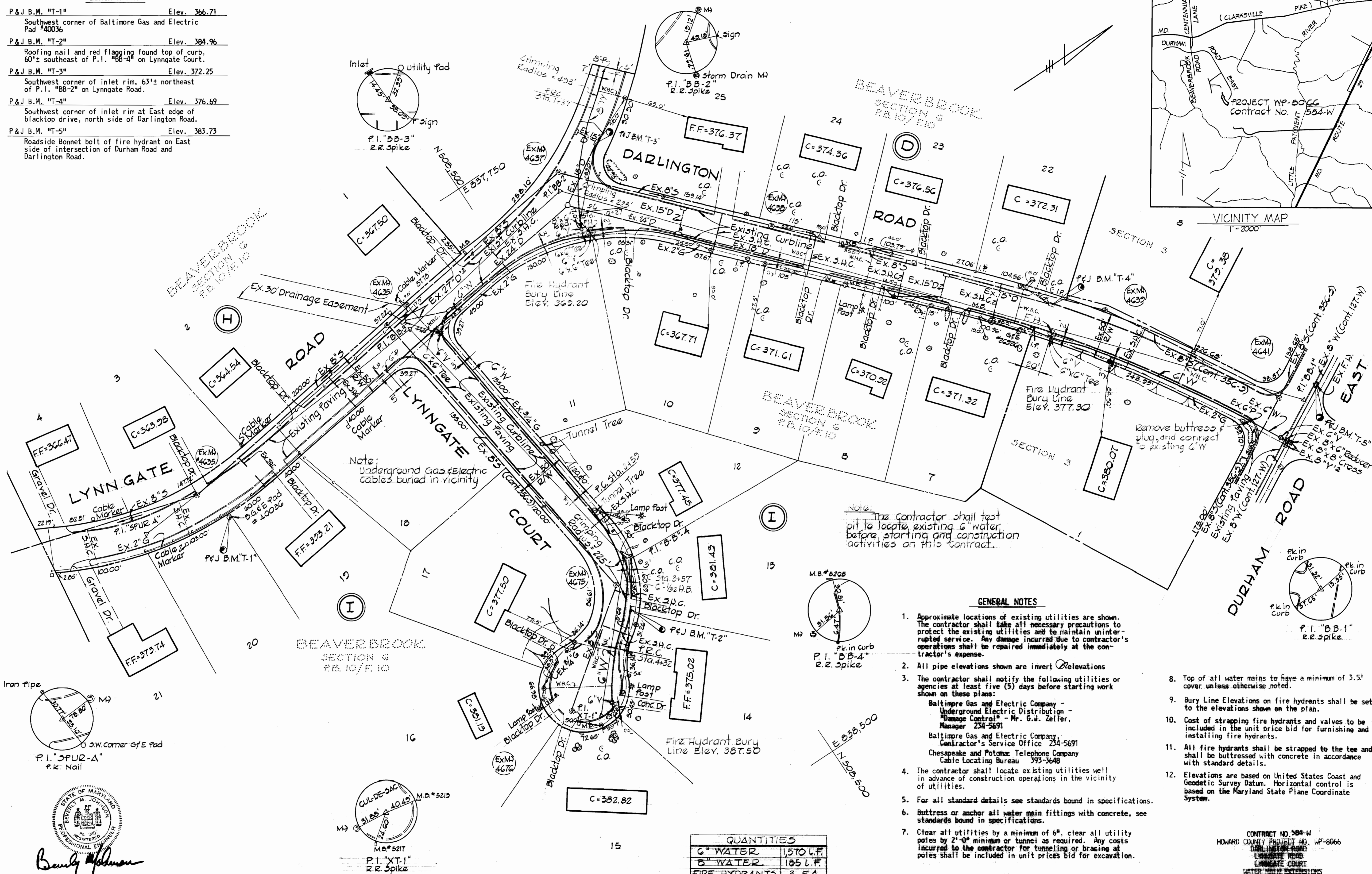
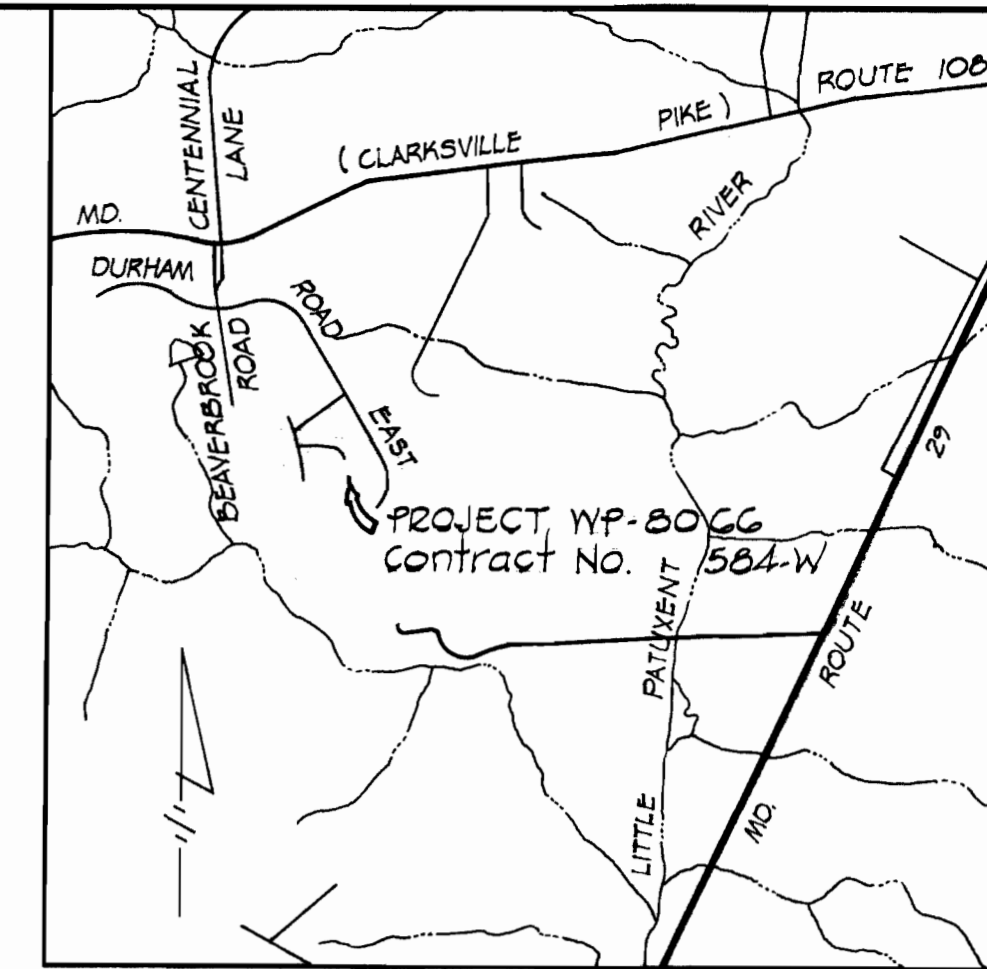

- GENERAL NOTES**
- Approximate locations of existing utilities are shown. The contractor shall take all necessary precautions to protect the existing utilities and to maintain uninterrupted service. Any damage incurred due to contractor's operations shall be repaired immediately at the contractor's expense.
  - All pipe elevations shown are invert elevations.
  - The contractor shall notify the following utilities or agencies at least five (5) days before starting work shown on these plans:  
 Baltimore Gas and Electric Company - Underground Electric Distribution - "Damage Control" - Mr. G.V. Zeller, Manager 234-5691  
 Baltimore Gas and Electric Company, Contractor's Service Office 234-5691  
 Chesapeake and Potomac Telephone Company Cable Locating Bureau 393-3648
  - The contractor shall locate existing utilities well in advance of construction operations in the vicinity of utilities.
  - For all standard details see standards bound in specifications.
  - Buttress or anchor all water main fittings with concrete, see standards bound in specifications.
  - Clear all utilities by a minimum of 6", clear all utility poles by 2'-0" minimum or tunnel as required. Any costs incurred to the contractor for tunneling or bracing at poles shall be included in unit prices bid for excavation.
  - Top of all water mains to have a minimum of 3.5' cover, unless otherwise noted.
  - Bury Line Elevations on fire hydrants shall be set to the elevations shown on the plan.
  - Cost of strapping fire hydrants and valves to be included in the unit price bid for furnishing and installing fire hydrants.
  - All fire hydrants shall be strapped to the tee and shall be buttressed with concrete in accordance with standard details.
  - Elevations are based on United States Coast and Geodetic Survey Datum. Horizontal control is based on the Maryland State Plane Coordinate System.

QUANTITIES	
6" WATER	1,370 L.F.
8" WATER	105 L.F.
FIRE HYDRANTS	3 EA.

**PURDUM & JESCHKE ENGINEERS**  
 1023 N. CALVERT ST.  
 BALTIMORE, MARYLAND

**DEPARTMENT OF PUBLIC WORKS**  
 HOWARD COUNTY, MARYLAND  
 DATE 12-14-73  
 W.O. Fallick  
 CHIEF BUREAU OF ENGINEERING

CONTRACT NO. 584-W

PLAN  
 BEAVERBROOK WATER MAINS

ELECTION DISTRICT  
 CLARKSVILLE NO 5

DRAWING NO. 1 OF 2  
 SCALE 1" = 50'  
 DESIGNED: R.E.L.  
 DRAFTED: R.E.L.  
 CHECKED: T.A.F.

suspender

### LYNNGATE ROAD

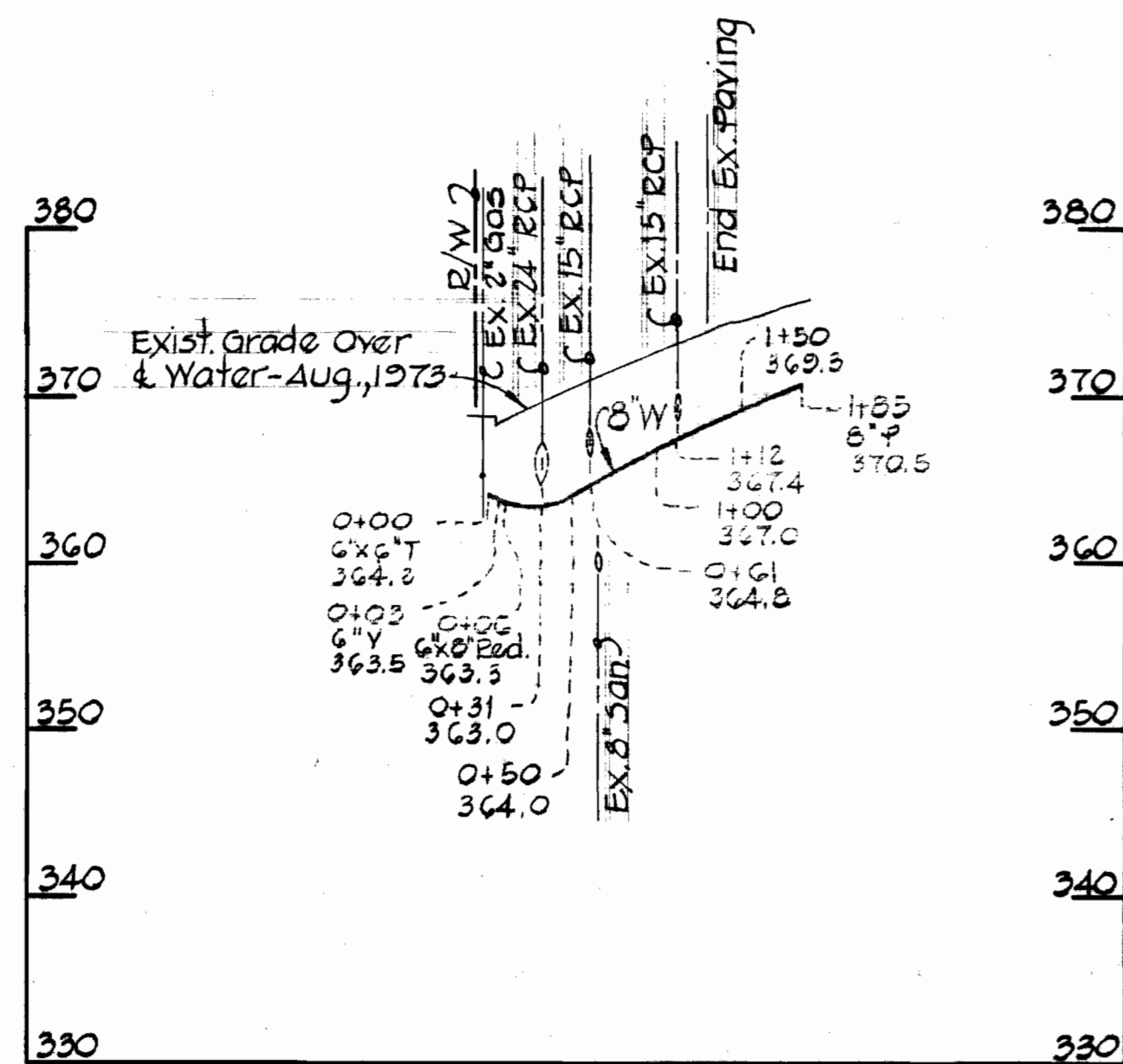

suspender

### LYNNGATE COURT

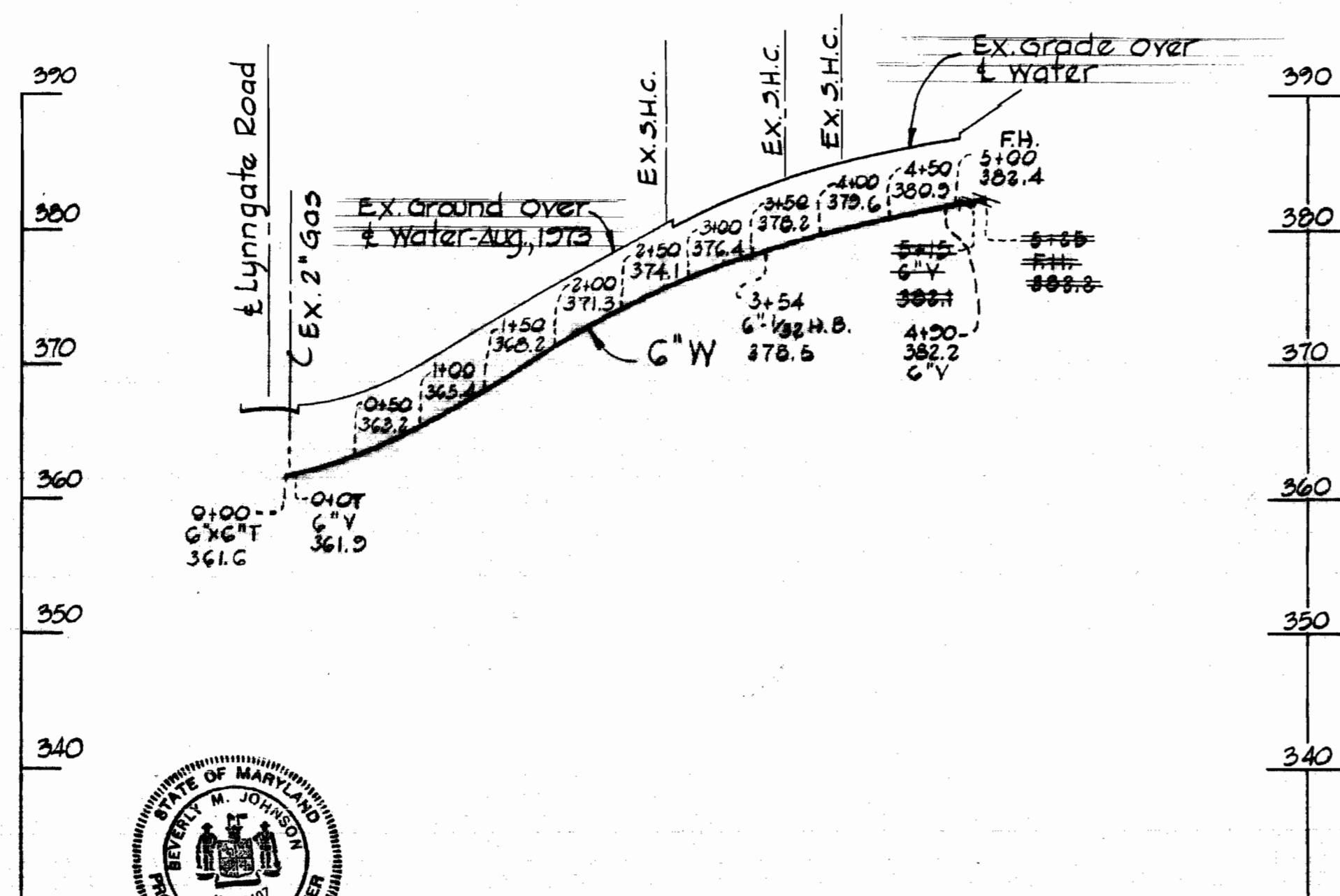

### LYNNGATE ROAD

### DARLINGTON ROAD

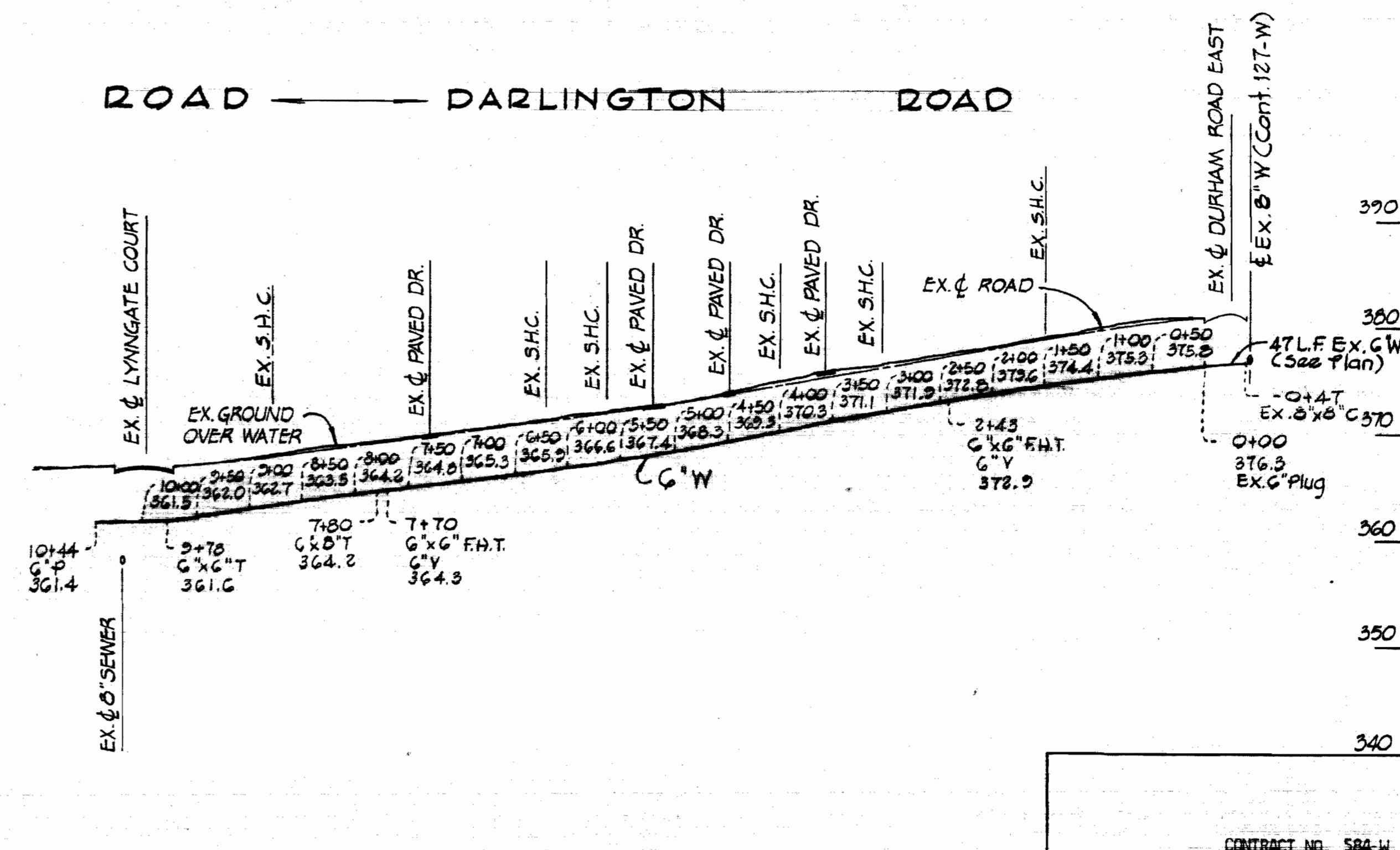

*Beverly M. Johnson*  
 BEVERLY M. JOHNSON  
 PROFESSIONAL ENGINEER

**PURDUM & JESCHKE**  
 ENGINEERS  
 1023 N. CALVERT ST.  
 BALTIMORE, MARYLAND

**DEPARTMENT OF PUBLIC WORKS**  
 HOWARD COUNTY, MARYLAND  
 12-19-73  
 DATE

CONTRACT NO. 584-W

**PROFILES**  
 SEWERAGE WATER MAINS

**ELECTION DISTRICT**  
 CLARKSVILLE NO. 8

**DRAWING**  
 NO. 2  
 OF 2

**SCALE**  
 HORIZ. 1"=100'  
 VERT. 1"=10'

CONTRACT NO. 584-W  
 HOWARD COUNTY PROJECT NO. HP-0066  
 BALTIMORE ROAD  
 CLARKSVILLE DISTRICT  
 WATER MAIN EXTENSIONS

WS 584-W/2