

PLAN  
Scale 1"=50'

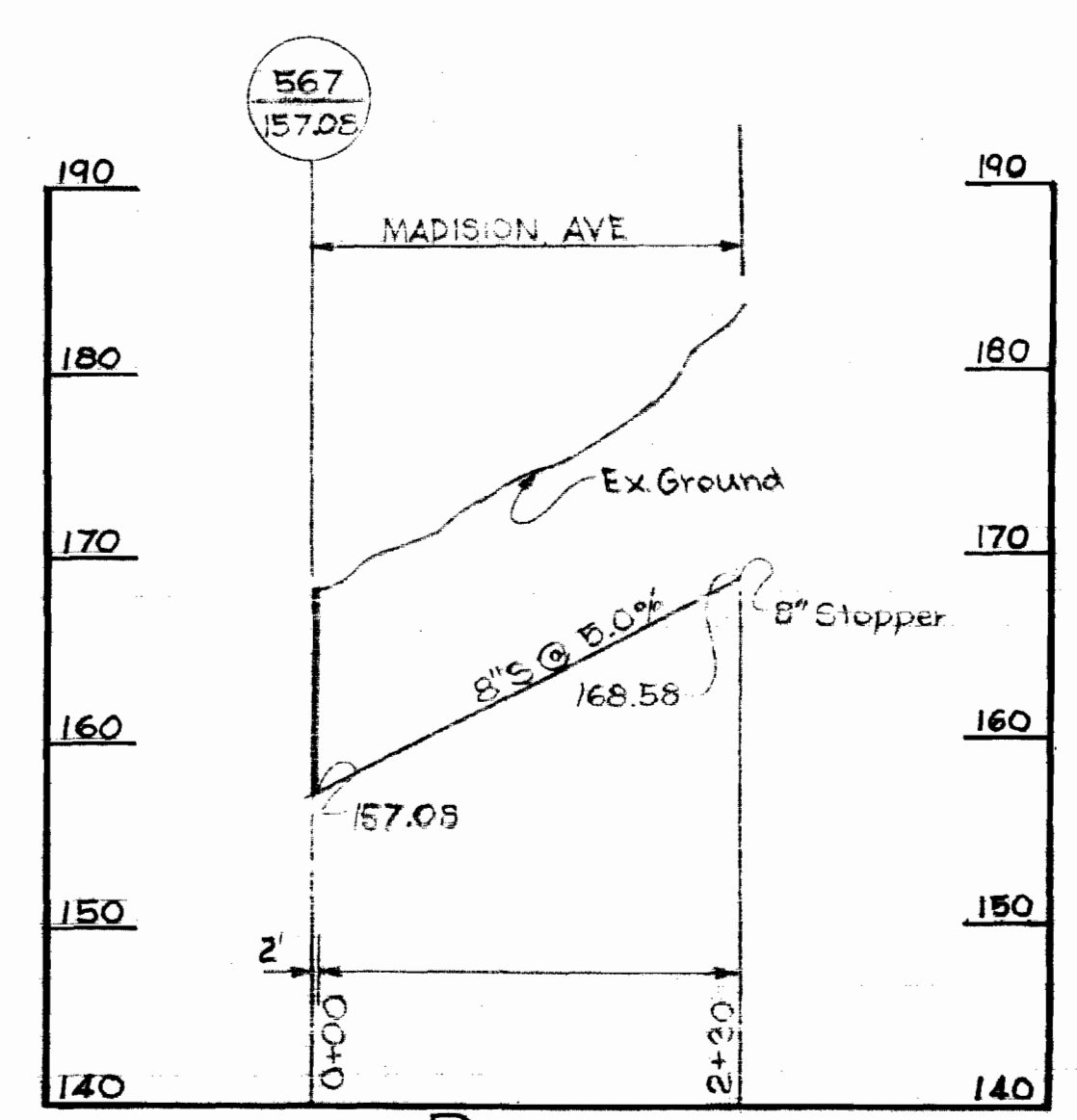

PROFILE  
Scale: Vert. 1"=10'  
Horz. 1"=100'

GENERAL NOTES

1. Approximate locations of existing mains are shown. The contractor shall take all necessary precautions to protect existing mains and services and maintain uninterrupted supply. Any damage incurred by contractor operations shall be repaired immediately at contractor's expense.
2. All horizontal controls are based on Maryland State Coordinates.
3. All vertical controls are based on Maryland State Datum.
4. All pipe elevations shown are invert elevations.
5. Clear all utilities by a minimum of 6". Clear all poles 2'-0" minimum or tunnel as required.
6. For all standard details see standards bound in specifications.
7. Contractor shall locate existing utilities a minimum of 2 weeks in advance of construction operations in the vicinity of proposed utilities.
8. Contractor shall notify the following utilities or agencies at least five (5) days before starting work show on these plans:  
 State Highway Administration - 531-5533  
 Baltimore Gas and Electric Company - Underground Electric Distribution  
 Engineering - "Damage Control" - 234-5691  
 Baltimore Gas and Electric Company - Underground Gas Distribution  
 Engineering - 559-0100  
 Chesapeake and Potomac Telephone Co. - 725-9976  
 American Telephone and Telegraph - Cable location Division - 301-393-3553  
 Colonial Pipeline Company - 781-4641  
 Miss Utility - 393-3648
9. Top of all water mains to have a minimum of 3 1/2' cover unless otherwise noted.
10. All valves shall be strapped to trees in accordance with standard details.
11. All water meter vaults to be for either twin 5/8" meters or single 5/8" meter unless otherwise noted. Meters furnished and installed by the county.
12. All sewer mains shall be C.S.P.X., V.C.P.X., or A.C.P. Class 2400 unless otherwise noted.
13. The contractor shall provide a joint in all sewer mains within 2'-0" of exterior manhole wall.
14. All manholes shall be 4'-0" inside diameter, unless otherwise noted.

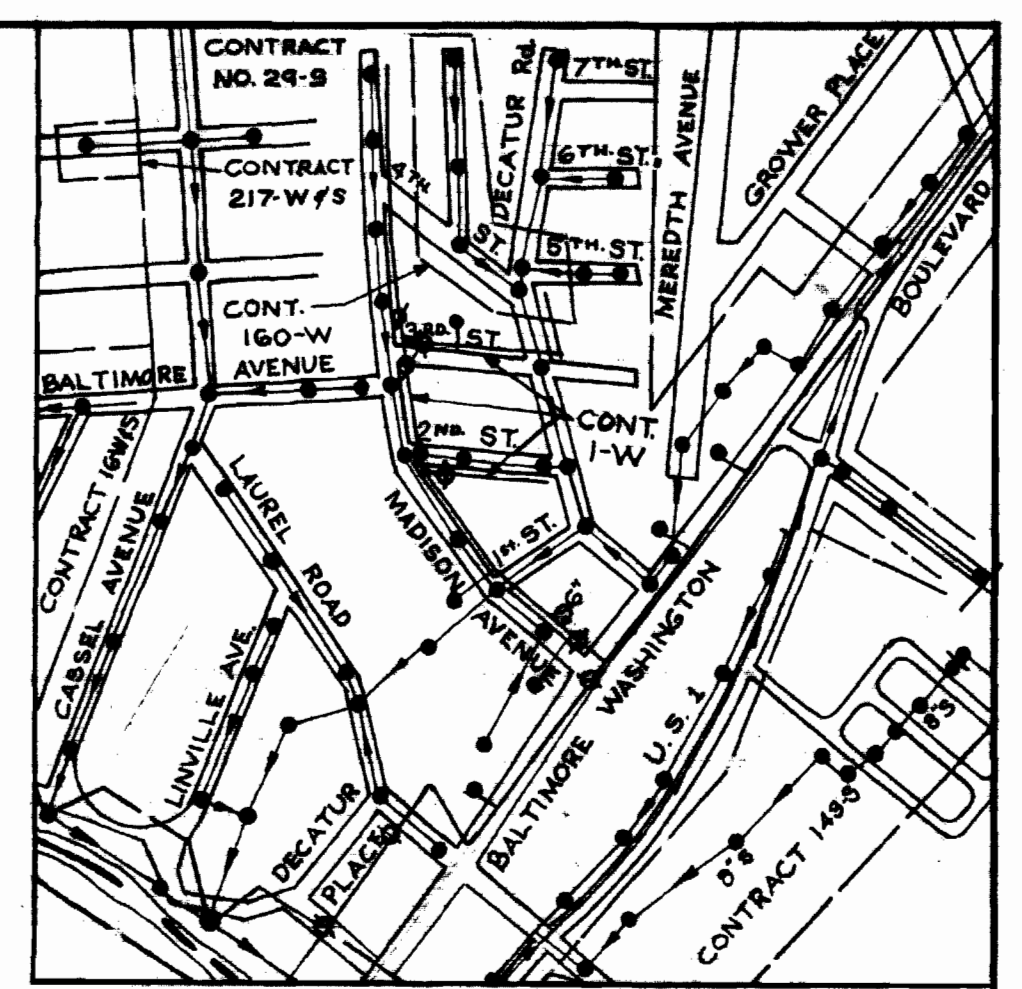

VICINITY MAP  
Scale = 1"=100'