

SUSPENSE

SUSPENSE

SUSPENSE

BENCH MARKS

P&J B.M. "PLUM" ELEV. 394.38
 2 cut nails in GFE pole #331728
 (C&P#4) at end of Plumtree Dr.

P&J B.M. "RAIL" ELEV. 368.22
 PK. nail in top of first guard-rail post, East of bridge on old Frederick Road.

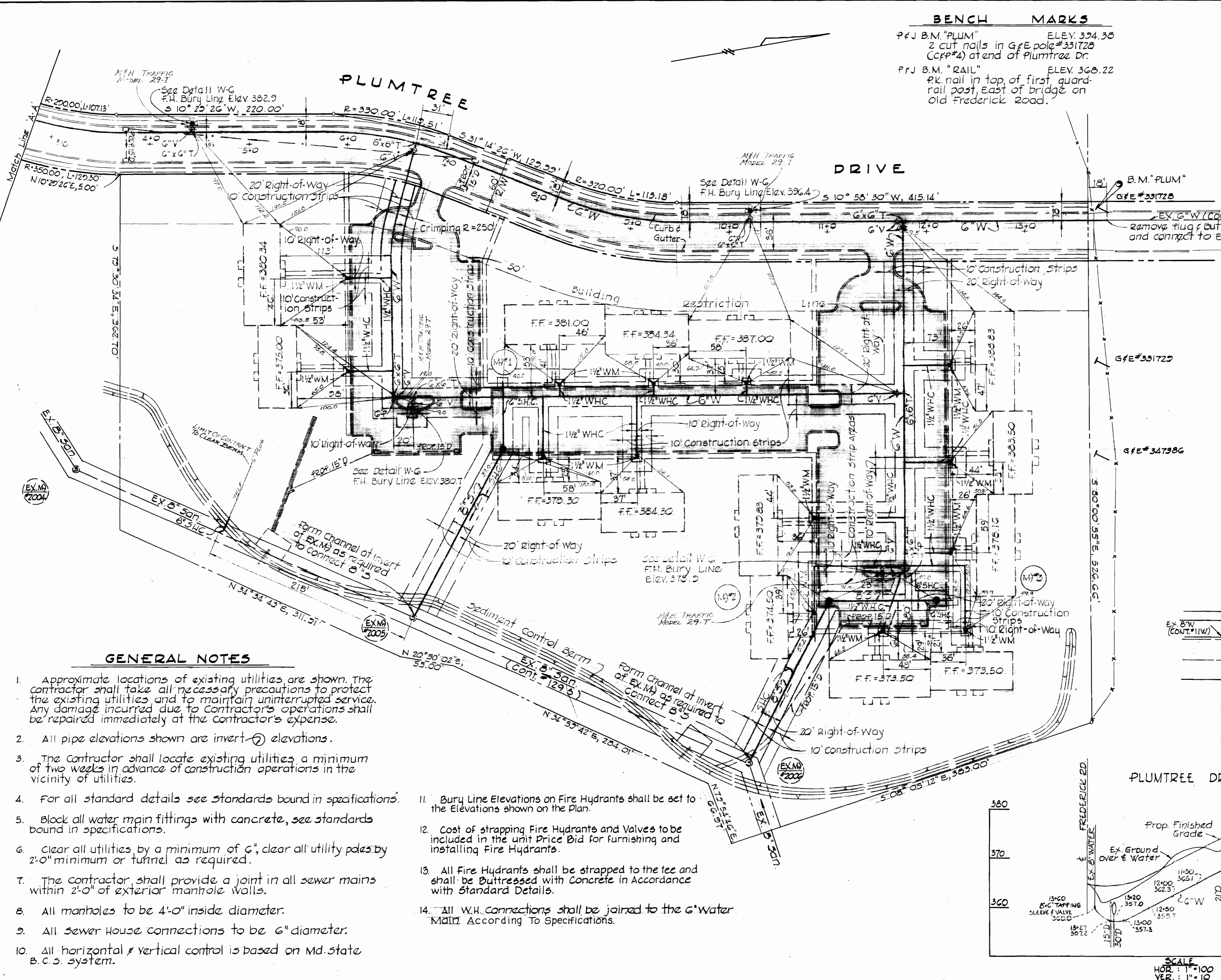
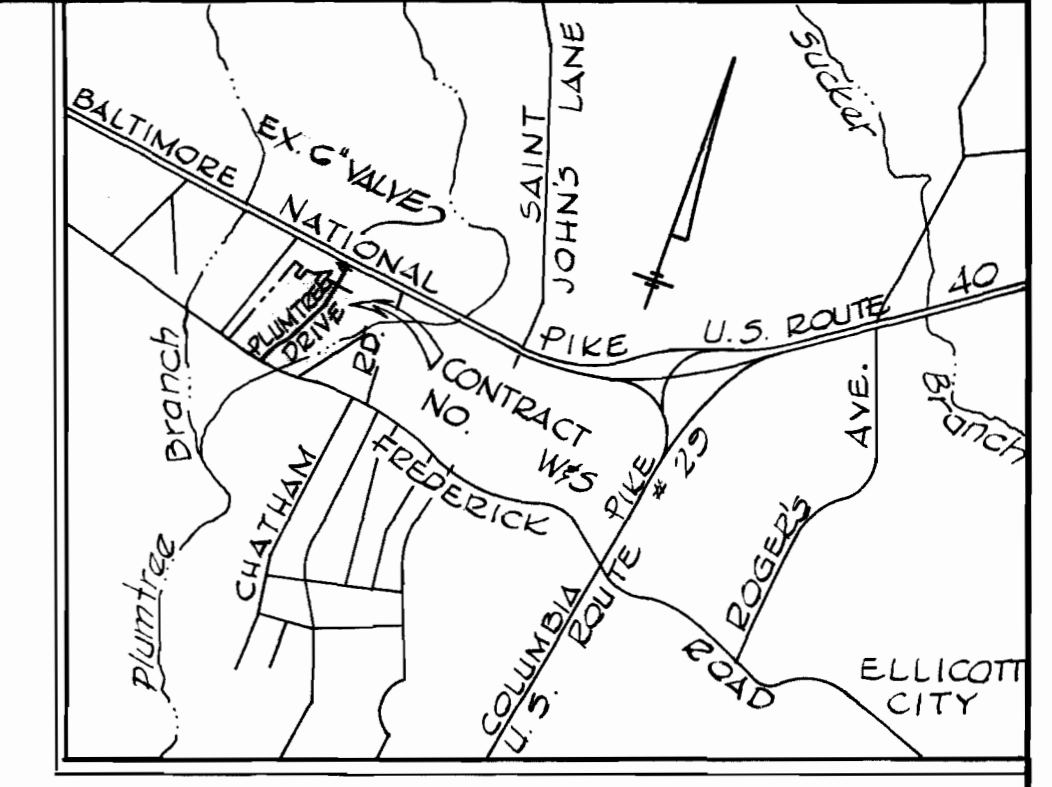

EX. G*W (Cont. #35 W&S)
 remove plug & buttress
 and connect to Ex. G*Water

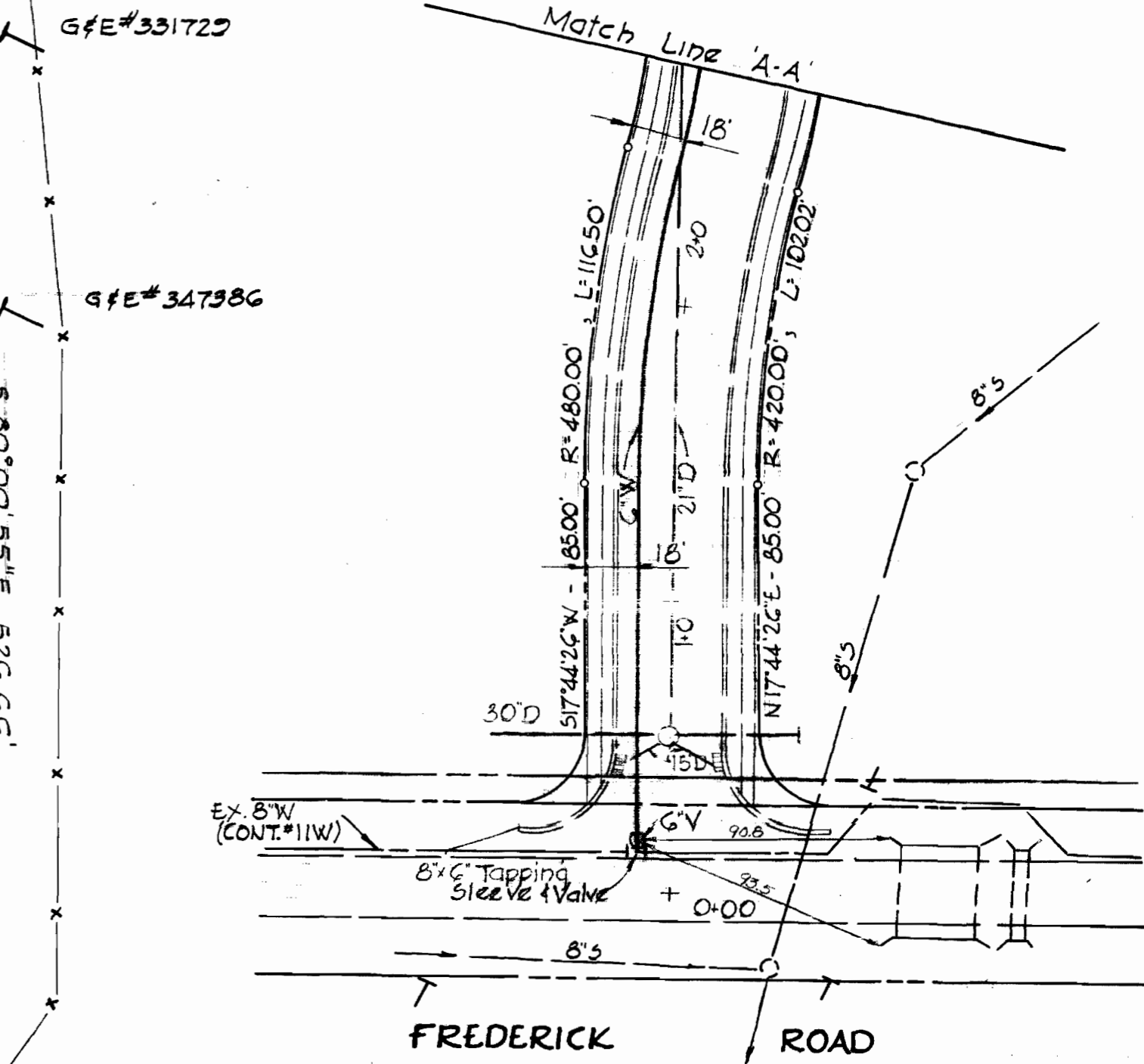

GENERAL NOTES

- Approximate locations of existing utilities are shown. The contractor shall take all necessary precautions to protect the existing utilities and to maintain uninterrupted service. Any damage incurred due to Contractor's operations shall be repaired immediately at the contractor's expense.
- All pipe elevations shown are invert elevations.
- The contractor shall locate existing utilities a minimum of two weeks in advance of construction operations in the vicinity of utilities.
- For all standard details see standards bound in specifications.
- Block all water main fittings with concrete, see standards bound in specifications.
- Clear all utilities by a minimum of 6", clear all utility poles by 2'-0" minimum or tunnel as required.
- The contractor shall provide a joint in all sewer mains within 2'-0" of exterior manhole walls.
- All manholes to be 4'-0" inside diameter.
- All sewer house connections to be 6" diameter.
- All horizontal & vertical control is based on Md. state B. C. S. system.
- Bury Line Elevations on Fire Hydrants shall be set to the Elevations shown on the Plan.
- Cost of strapping Fire Hydrants and Valves to be included in the unit Price Bid for furnishing and installing Fire Hydrants.
- All Fire Hydrants shall be strapped to the tee and shall be buttressed with concrete in accordance with standard details.
- All W.H. connections shall be joined to the G*water MAIN According to Specifications.

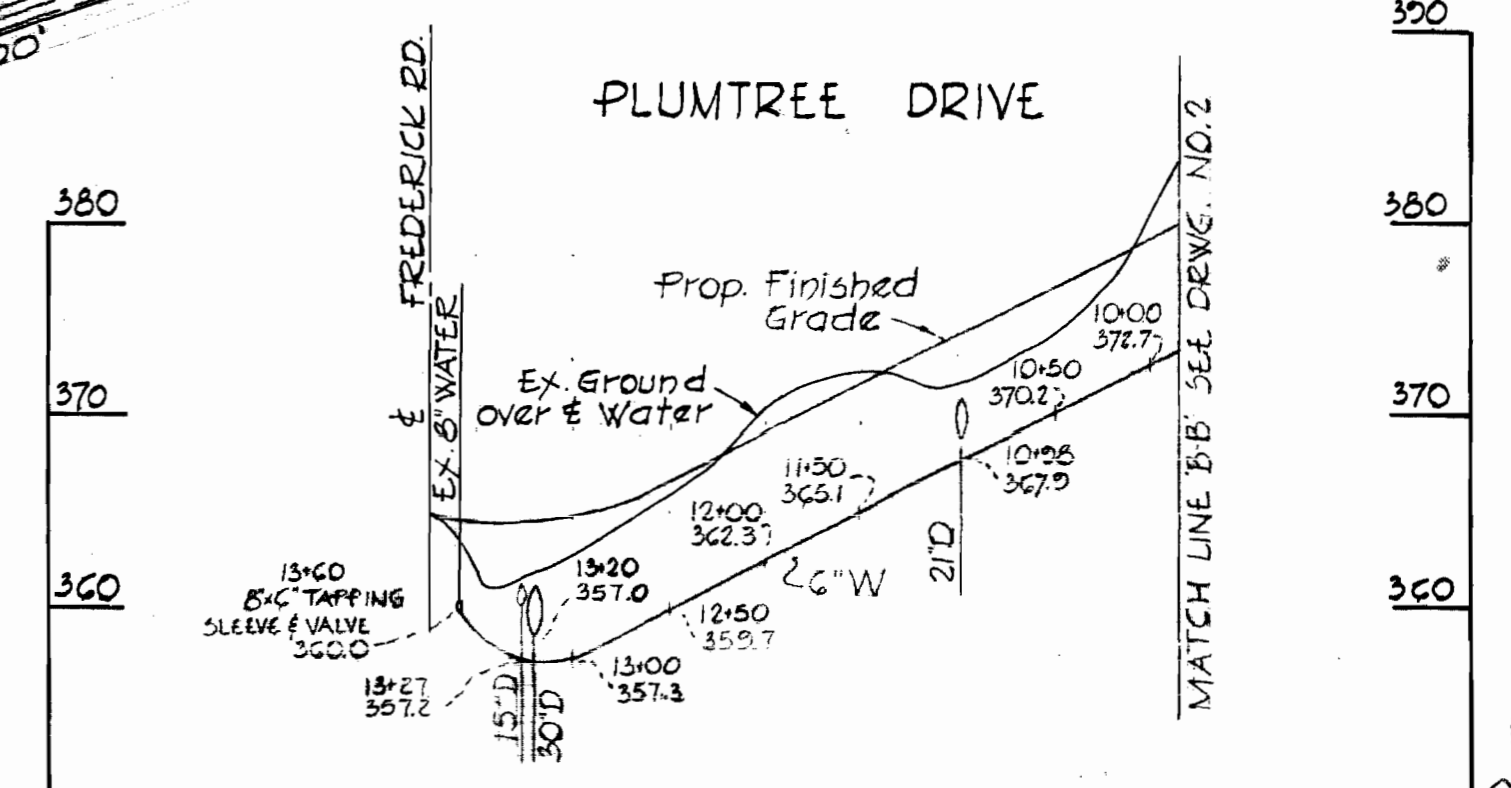

SCALE
 HOR. : 1"=100'
 VER. : 1"=10'



PURDUM & JESCHKE
 ENGINEERS
 1023 N. CALVERT ST.
 BALTIMORE, MARYLAND

DEPARTMENT OF PUBLIC WORKS
 HOWARD COUNTY, MARYLAND
 DATE: 11-22-71
 CHIEF - BUREAU OF WATER AND SEWER

CONTRACT NO. 460-D W/S

PLAN OF WATER AND SEWER MAINS

PLUMTREE APARTMENTS
ELECTION DISTRICT ELLICOTT CITY NO. 2

DRAWING NO. 1 OF 2
 SCALE 1"=50'

WS 460 W&S/1

PLUMTREE DRIVE

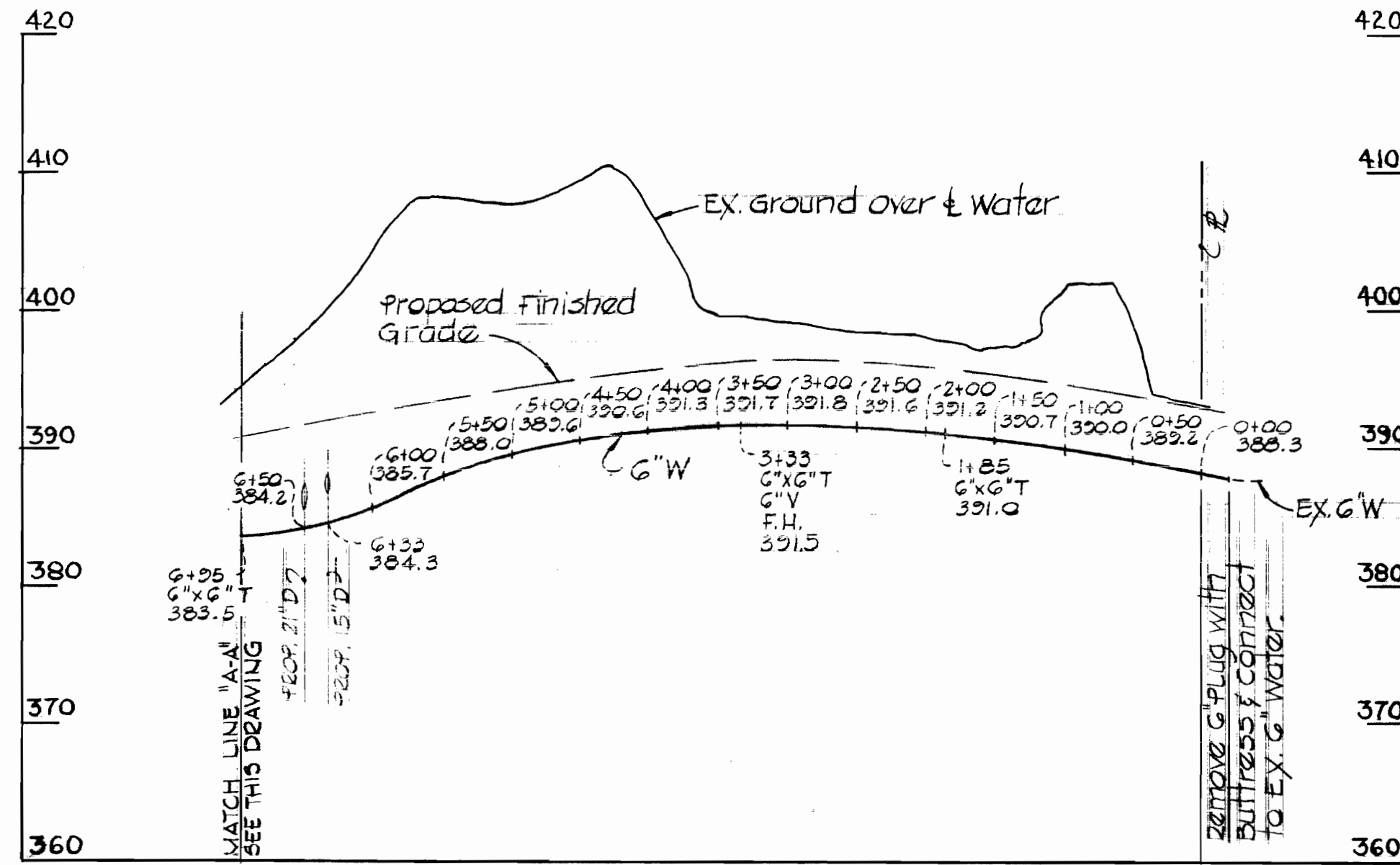

NORTH LOOP

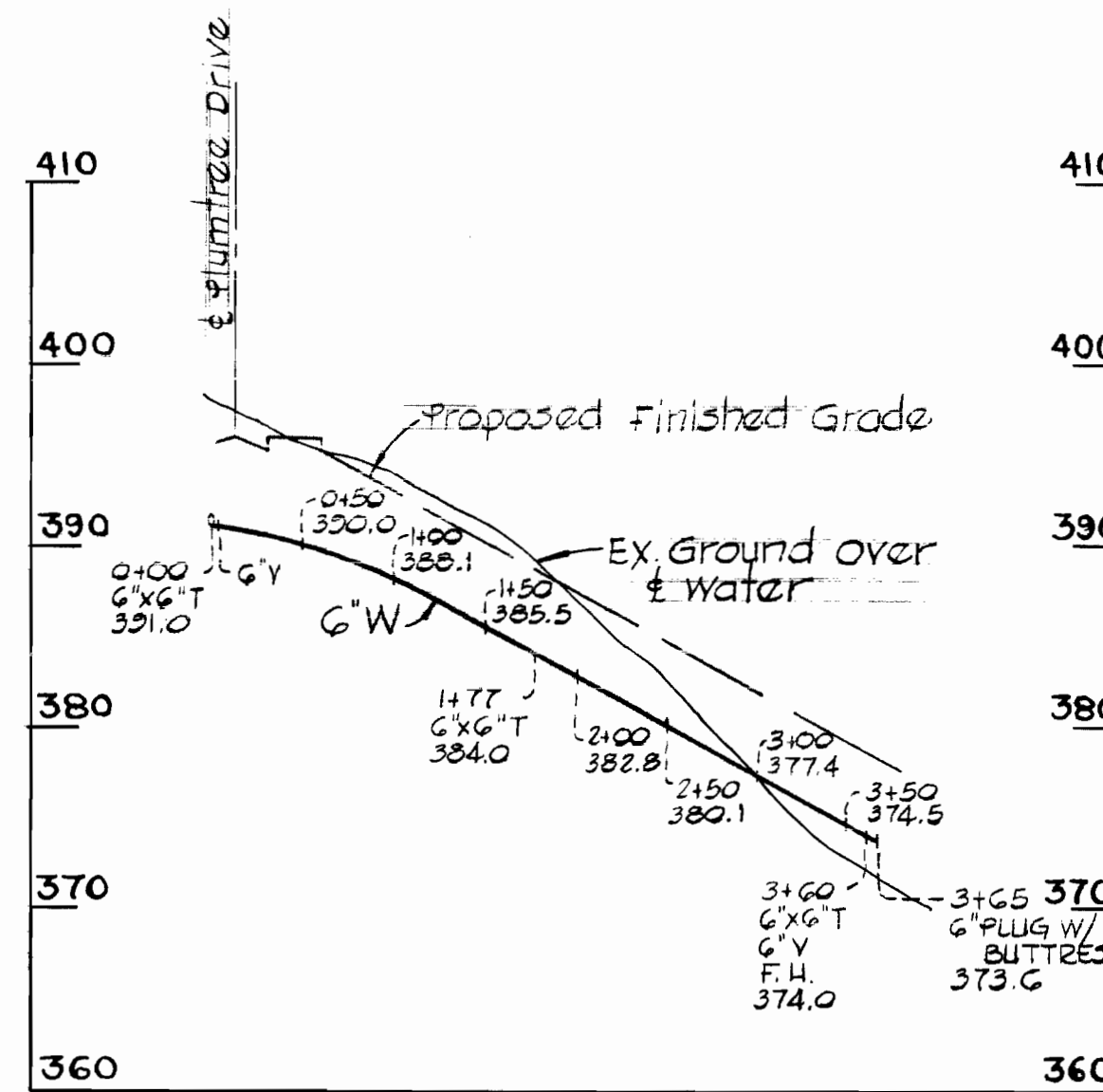

EAST LOOP

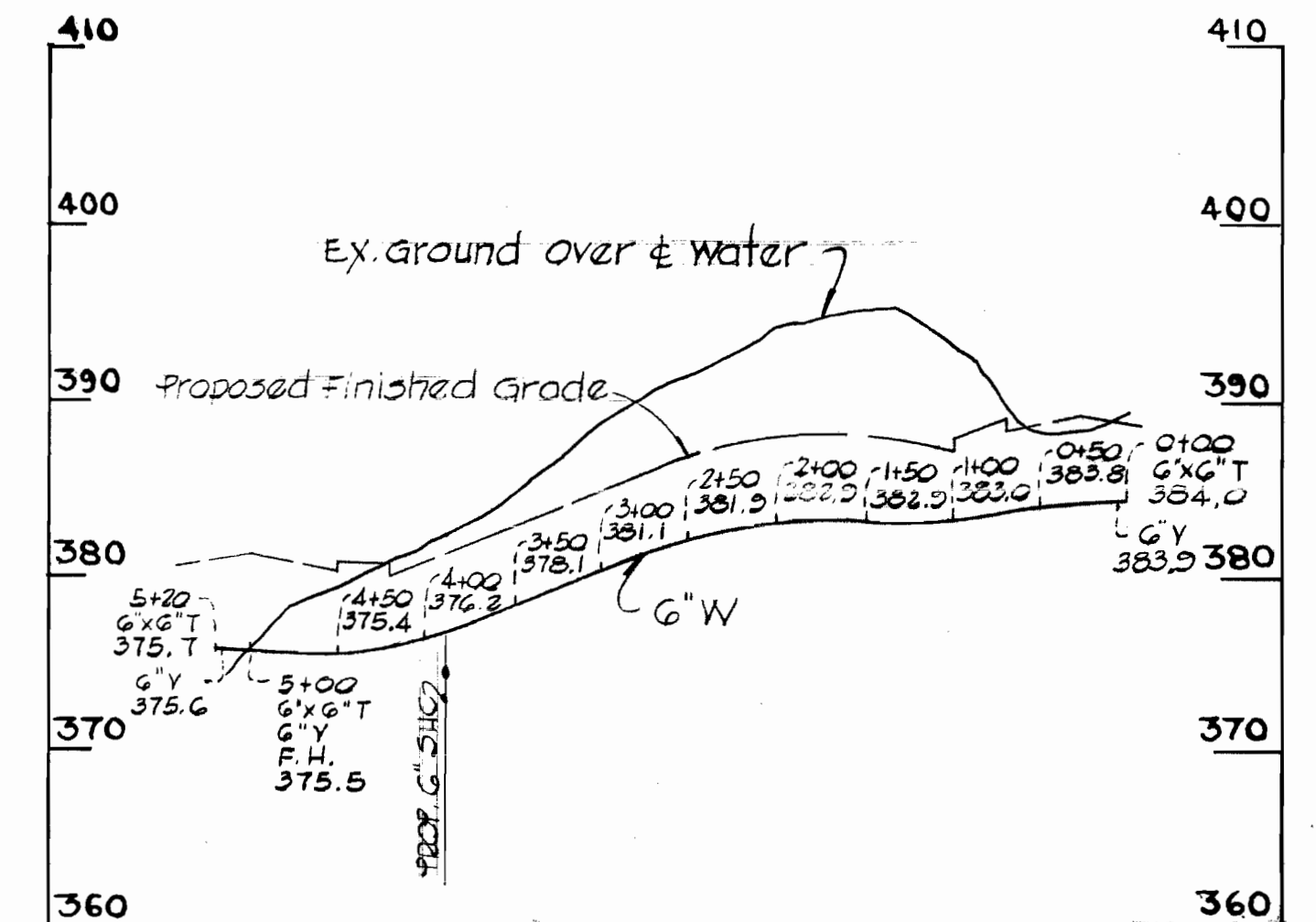

NORTH LOOP

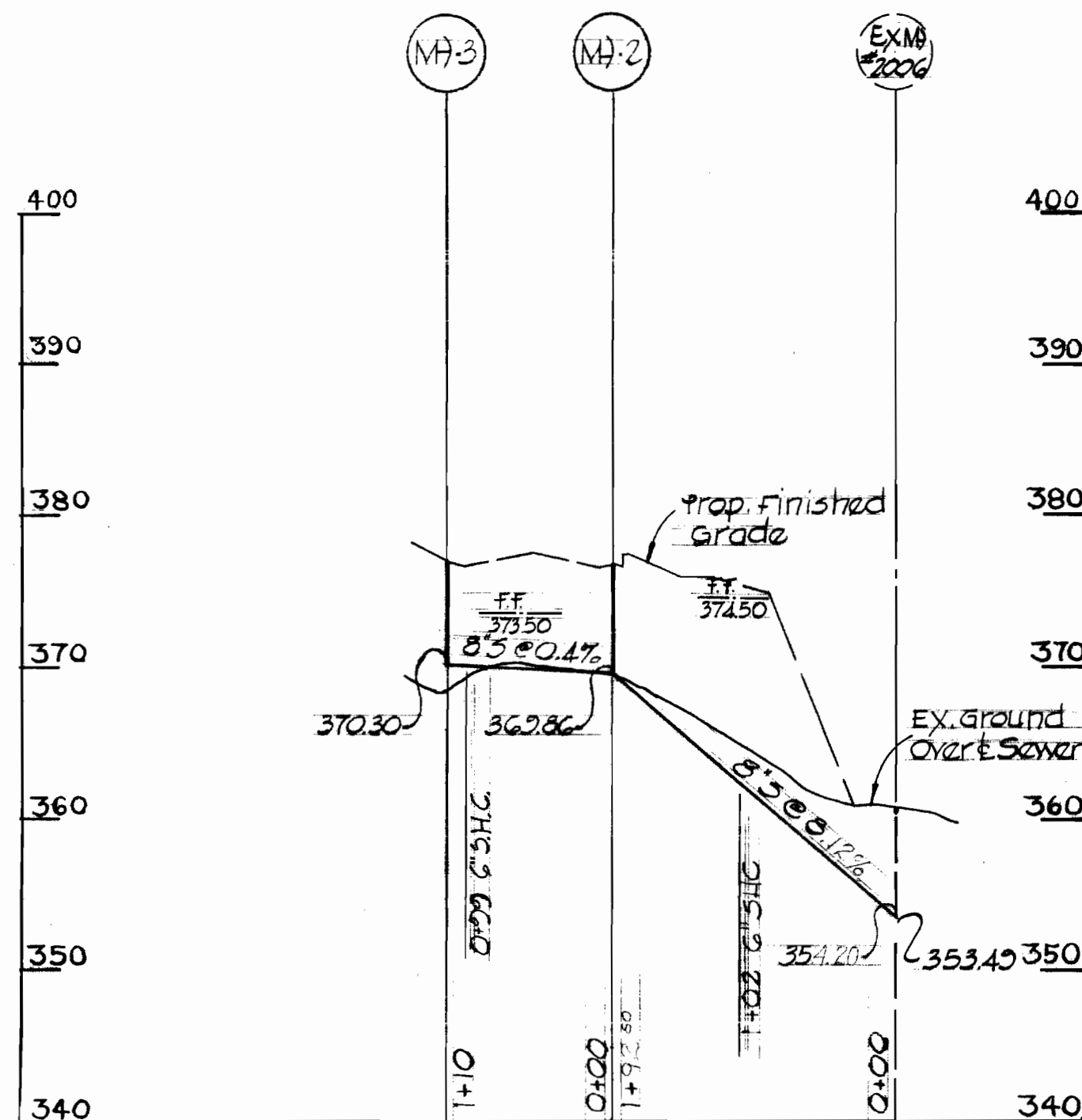

EAST LOOP

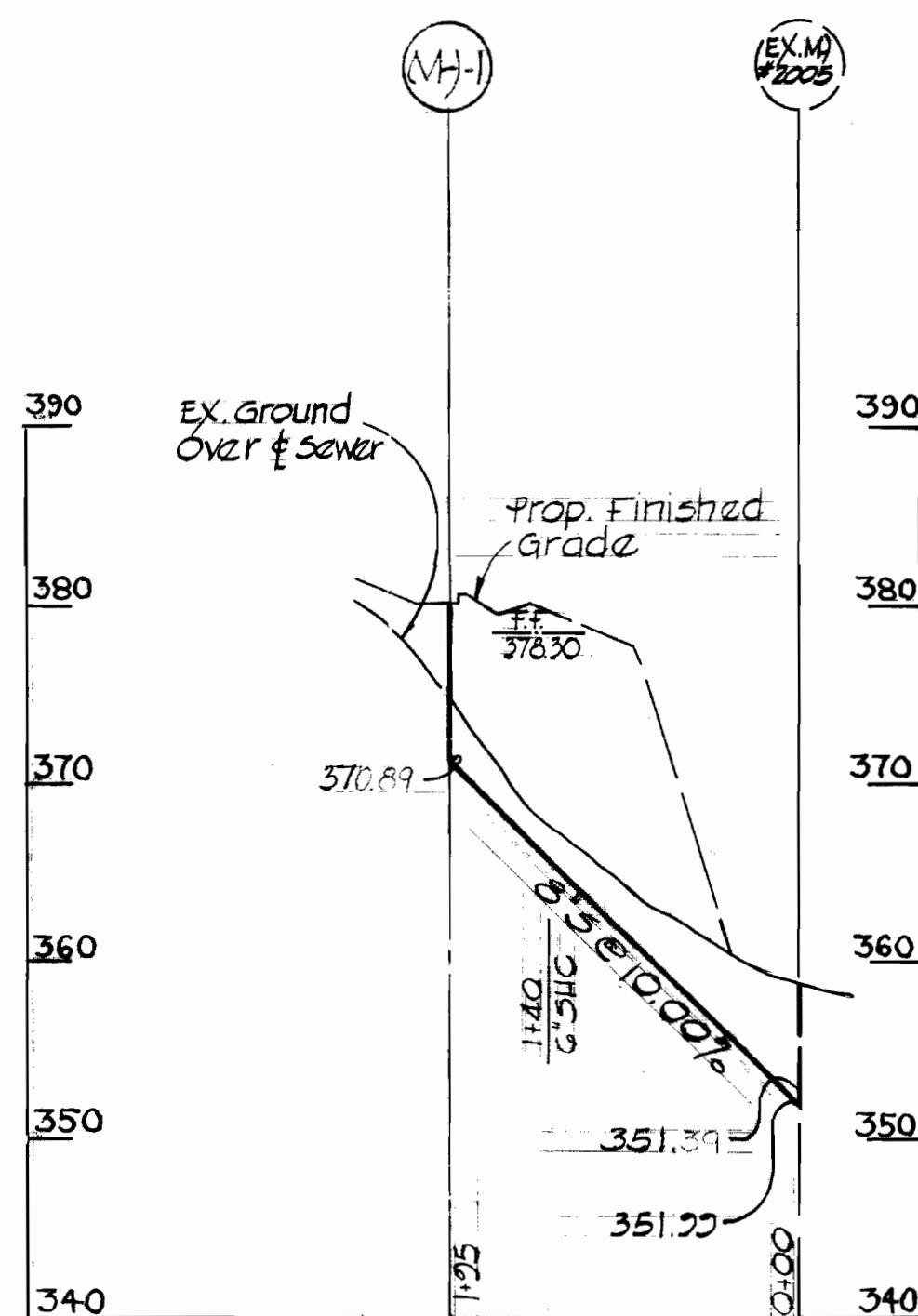

SOUTH LOOP

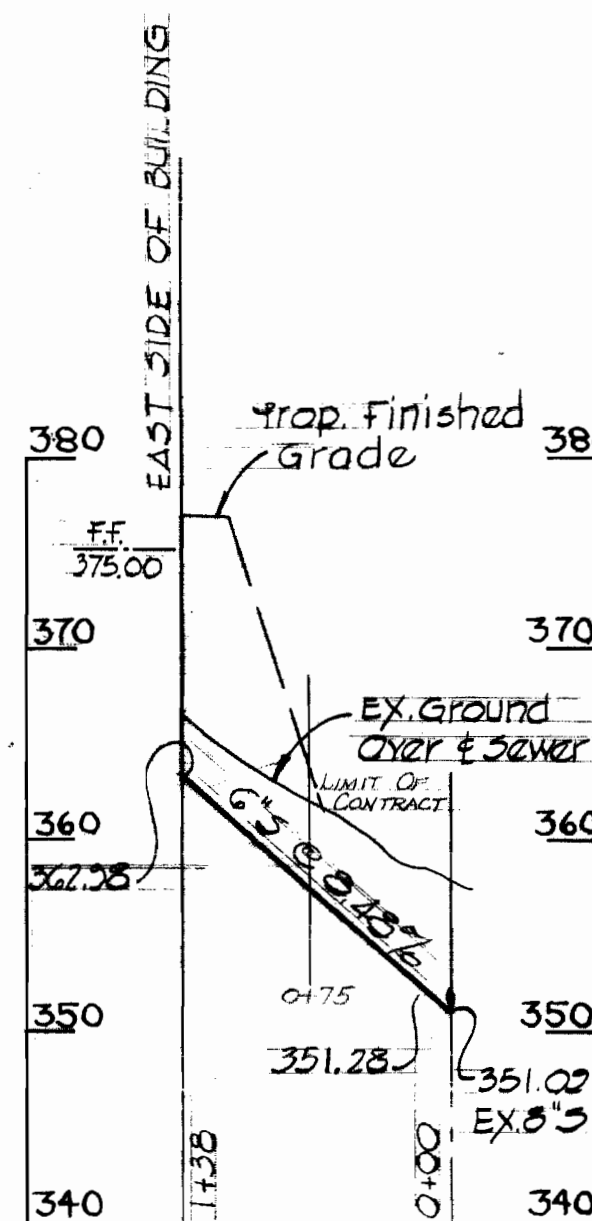

PLUMTREE DRIVE

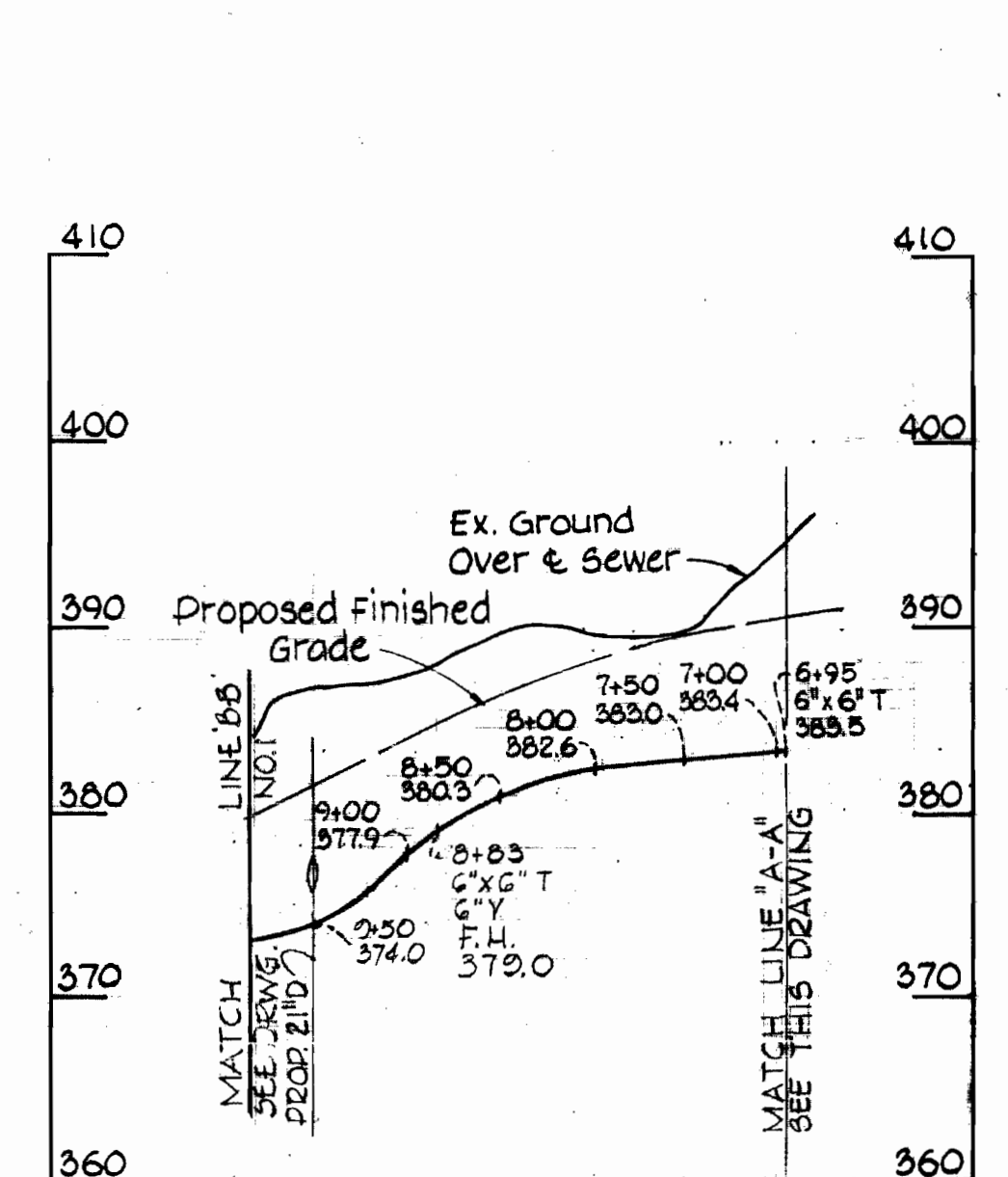
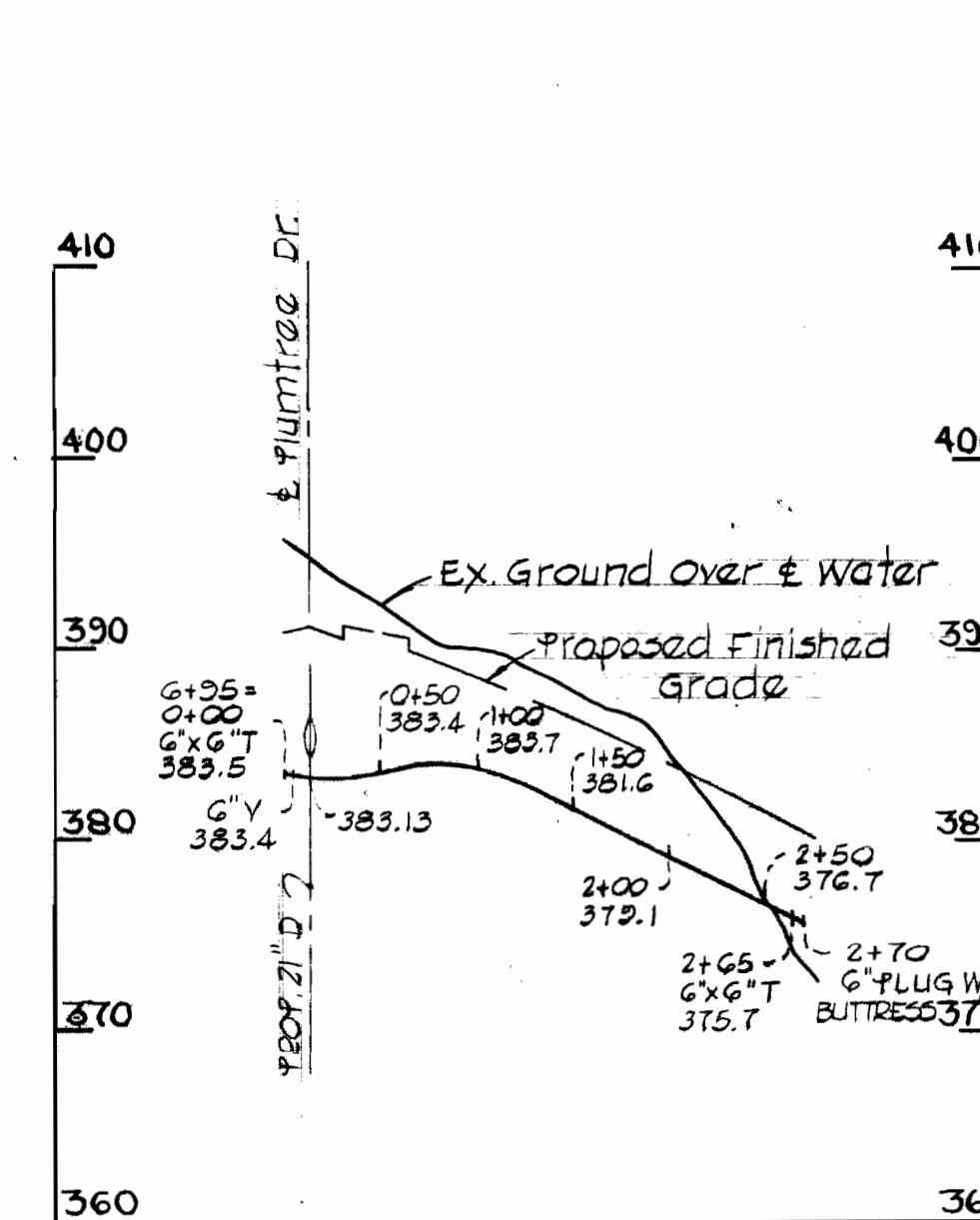

Note:
 For details of Buttress and Plug see, "Howard County Standard Specifications and Details" page no. W-8.

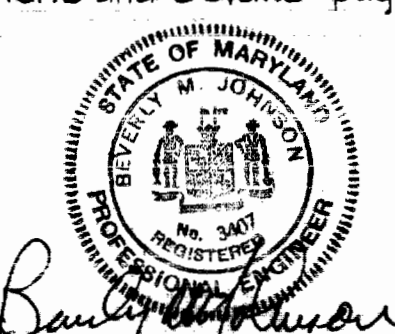

Bailey Johnson

PURDUM & JESCHKE
 ENGINEERS
 1023 N. CALVERT ST.
 BALTIMORE, MARYLAND

DEPARTMENT OF PUBLIC WORKS
 HOWARD COUNTY, MARYLAND
 DATE 11-22-71
 W. O. Filbert
 CHIEF - BUREAU OF WATER AND SEWER

CONTRACT NO. 460-DW/S

PROFILES OF WATER AND SEWER MAINS

PLUMTREE APARTMENTS
 ELECTION DISTRICT ELLICOTT CITY NO. 2

DRAWING NO. 2 OF 2
 SCALE H-1"=100' V-1"=10'

WS 460 W4S/2

suspense

suspense