

Note:
The Contractor shall notify The Baltimore Gas and Electric Company prior to any construction activities in the vicinity of the Gas Mains by calling Area Code 301-234-5681 in Baltimore.

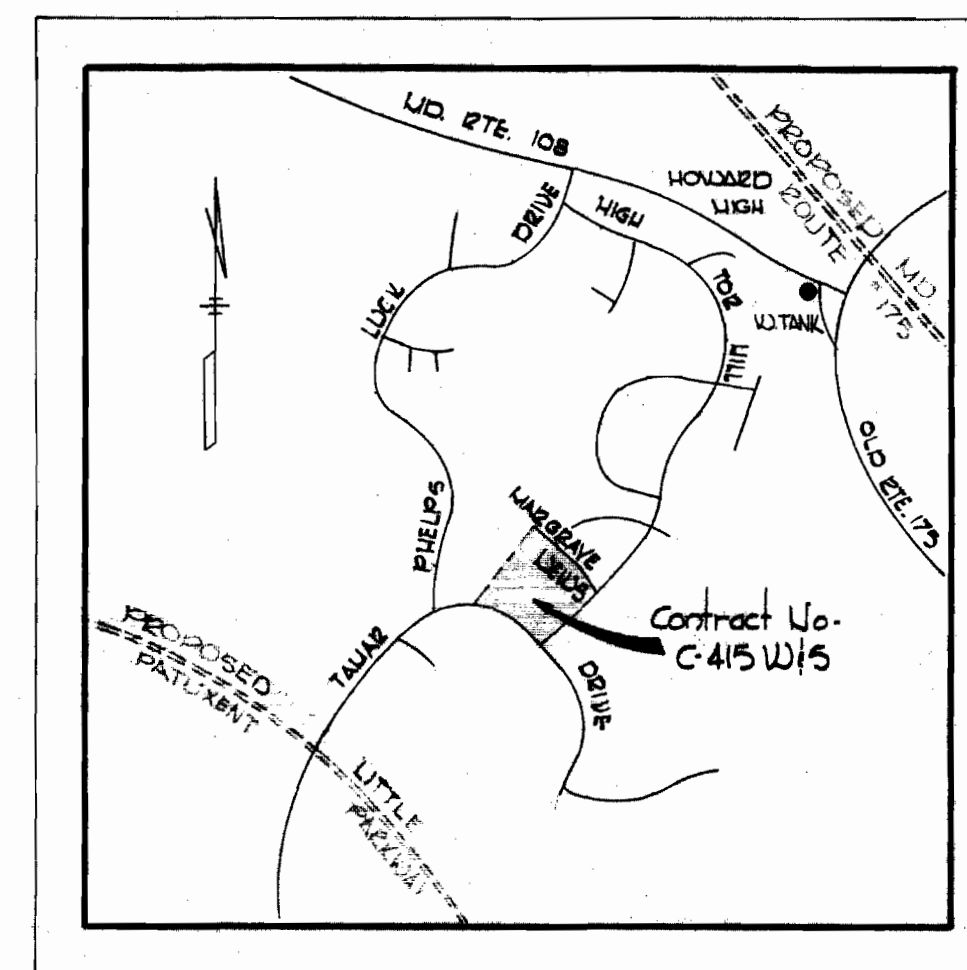
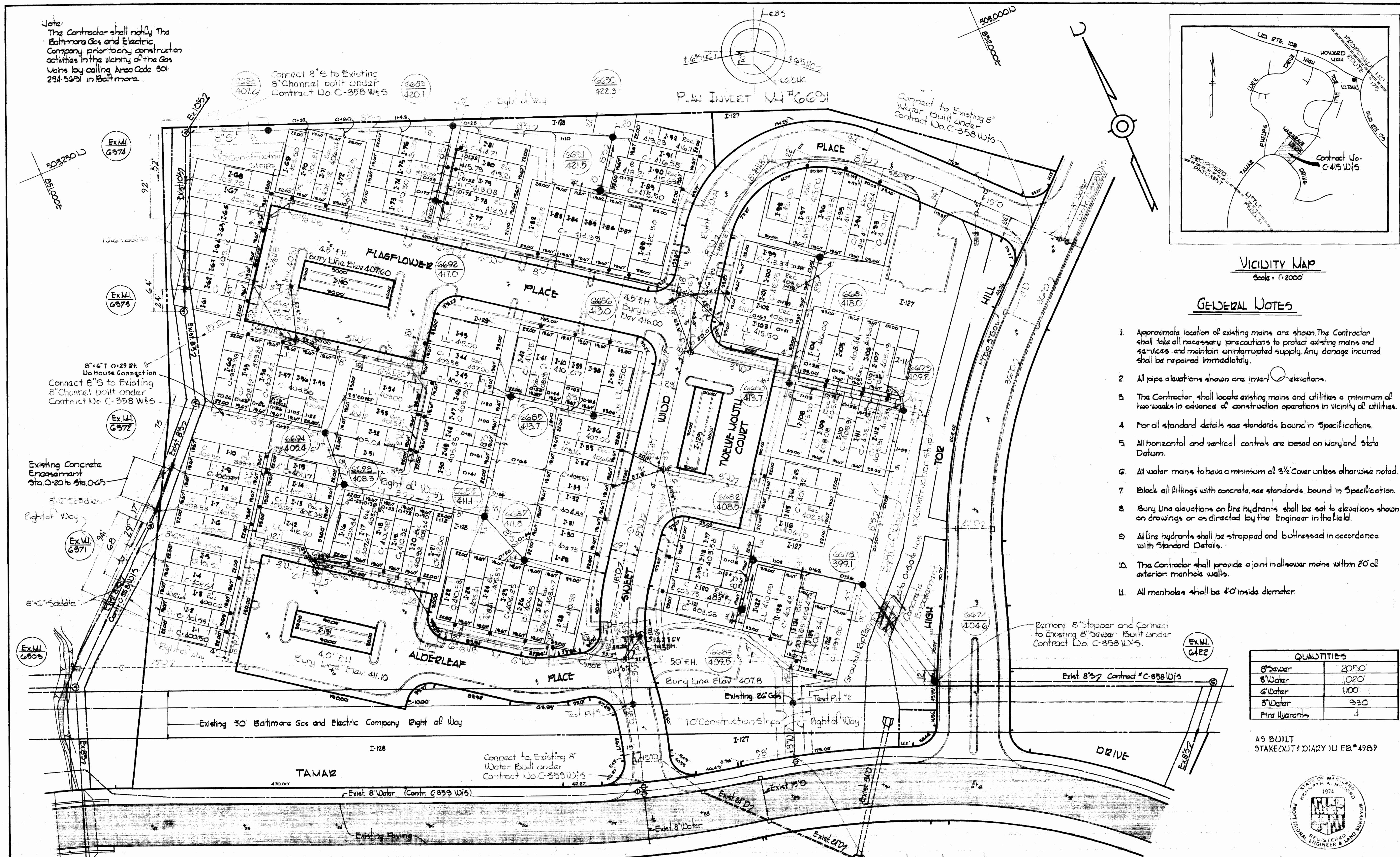

VICINITY MAP
Scale: 1" = 2000'

GENERAL NOTES

1. Approximate location of existing mains are shown. The Contractor shall take all necessary precautions to protect existing mains and services and maintain uninterrupted supply. Any damage incurred shall be repaired immediately.
2. All pipe elevations shown are invert elevations.
3. The Contractor shall locate existing mains and utilities a minimum of two weeks in advance of construction operations in vicinity of utilities.
4. For all standard details see standards bound in Specifications.
5. All horizontal and vertical controls are based on Maryland State Datum.
6. All water mains to have a minimum of 3/2' cover unless otherwise noted.
7. Block all fittings with concrete, see standards bound in Specification.
8. Bury Line elevations on fire hydrants shall be set to elevations shown on drawings or as directed by the Engineer in the field.
9. All fire hydrants shall be strapped and boltressed in accordance with Standard Details.
10. The Contractor shall provide a joint in all sewer mains within 20' of exterior manhole walls.
11. All manholes shall be 40" inside diameter.

QUANTITIES	
8" Sewer	2050
8" Water	1020
6" Water	100'
3" Water	330
Fire Hydrants	4

AS BUILT
STAKEOUT # DIARY 10 FEB. 4989



Kenneth A. Madala
Village of Longreach
Parcel I, Section 1, Area 1
Contract No. C-415 W/S

Note:
Test Pit Existing 26' Gas Prior to Construction of Water Main.

Connect to Existing 8" Water Built under Contract C-358 W/S

Remove 8" Stopper and Connect to Existing 8" Sewer Built under Contract No. C-358 W/S

WHITMAN, REQUARDT & ASSOCIATES
ENGINEERS
1304 ST. PAUL ST.
BALTIMORE, MARYLAND

DEPARTMENT OF PUBLIC WORKS
HOWARD COUNTY, MARYLAND
DATE: 4.11.71
W. O. Palout
CHIEF - BUREAU OF WATER AND SEWER

CONTRACT NO. C-415 W/S

PLAN OF WATER & SEWER MAINS

COLUMBIA VILLAGE OF LONGREACH ELECTION DISTRICT GUILFORD NO. 6

DRAWING NO. 1 OF 2 AS SHOWN

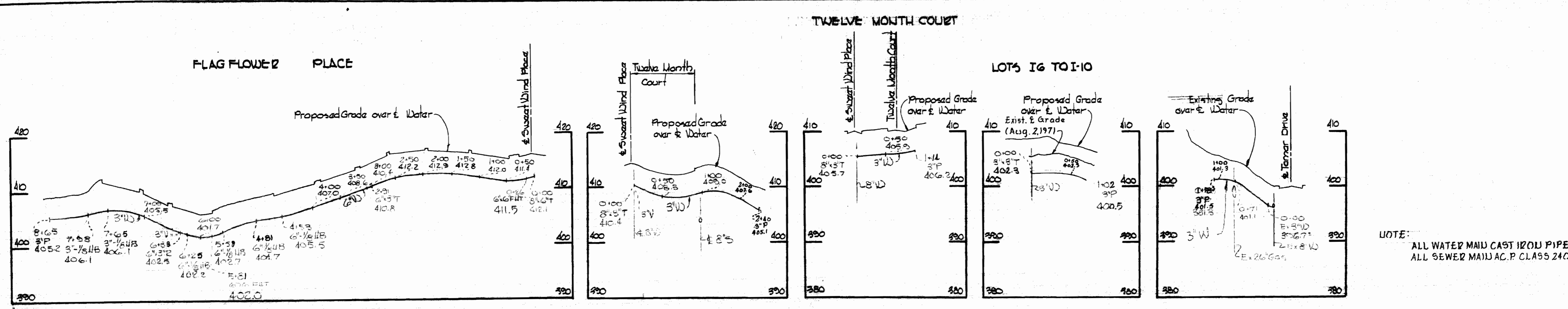

NOTE:
ALL WATER MAIN CAST IRON PIPE.
ALL SEWER MAIN A.C.P. CLASS 2400.

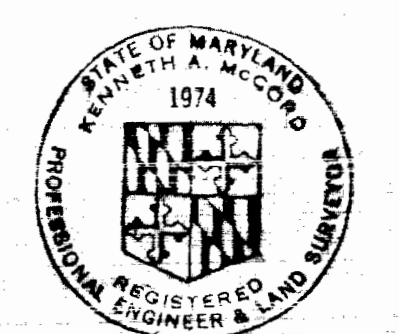
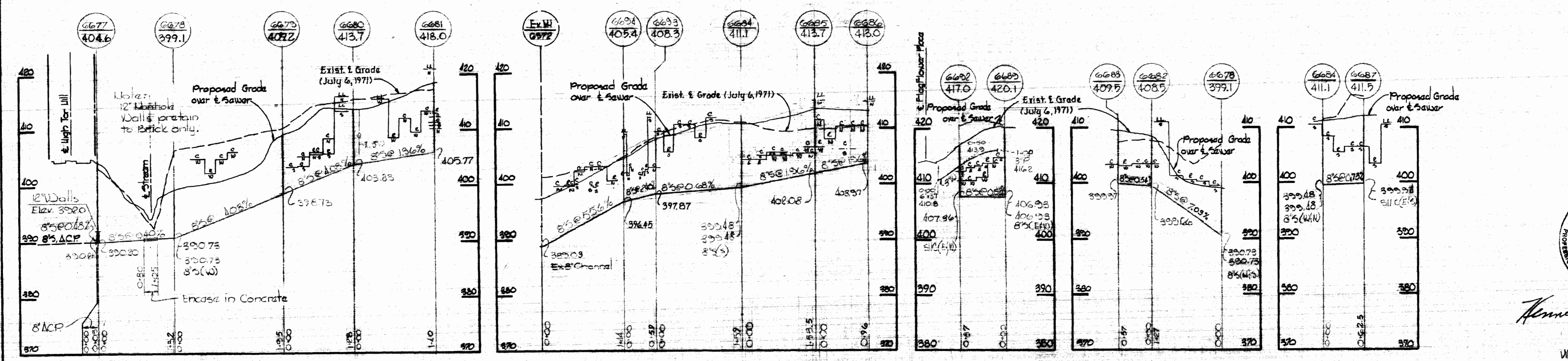
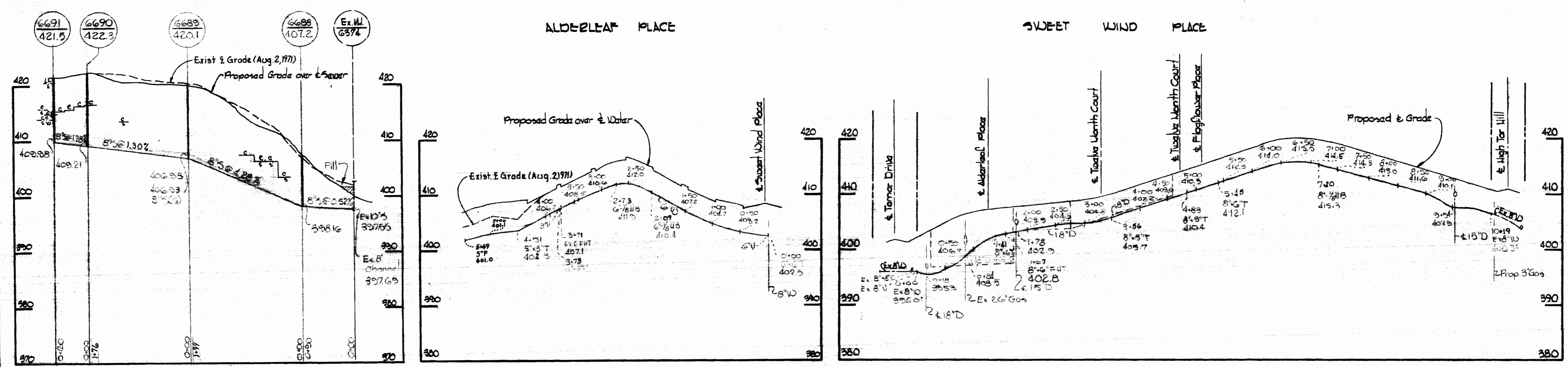

Kenneth A. McLeod

Village of Longreach
Parcel T, Section 1, Area 1
Contract No. C-415W&S

WS 415-W&S/2

WHITMAN, REQUARDT & ASSOCIATES ENGINEERS 1304 ST. PAUL ST. BALTIMORE, MARYLAND	DEPARTMENT OF PUBLIC WORKS HOWARD COUNTY, MARYLAND 4-19-71 <i>W. O. Pillard</i> CHIEF - BUREAU OF WATER AND SEWER	CONTRACT NO. C-415W&S	PROFILES OF WATER & SEWER MAINS	COLUMBIA VILLAGE OF LONGREACH ELECTION DISTRICT GUILFORD NO. 6	DRAWING NO. 2	SCALE H:1"=100' V:1"=10'
					OF 2	

W. O. 00852

AS BUILT OCTOBER 1971