

W.R.#A. BM# W-01 Elev. 279.41
 X cut on roadside flange bolt of fire hydrant NW side U.S. Route near Patuxent Range Road

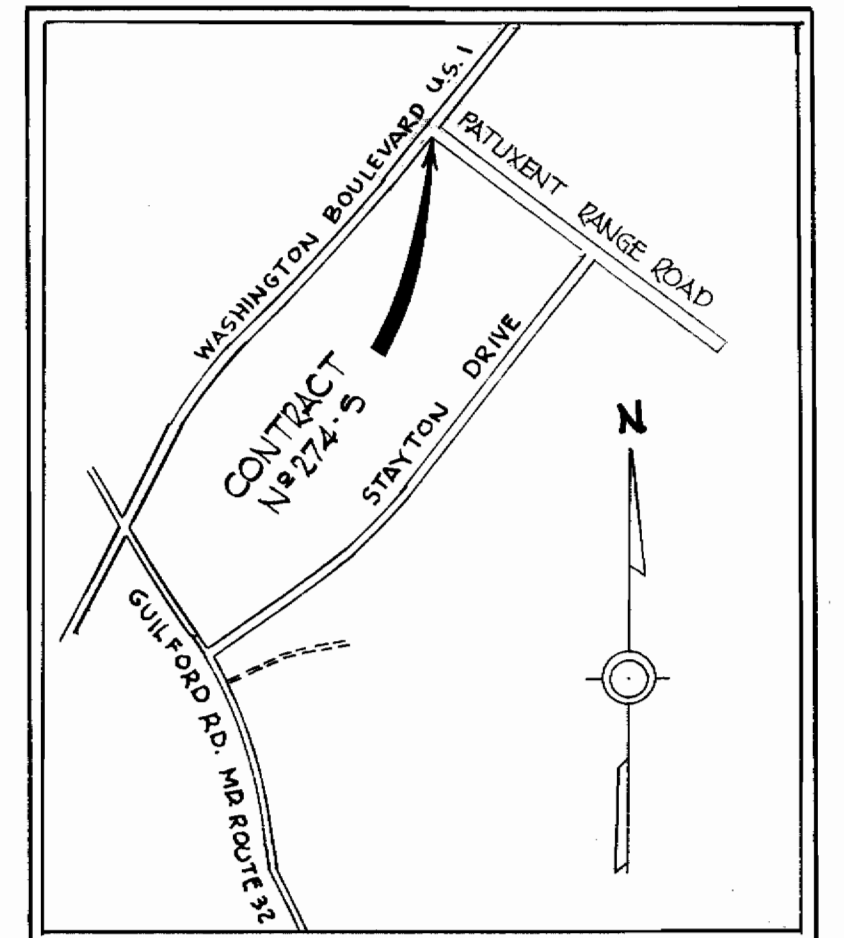

VICINITY MAP
 Scale: 1"=1200'

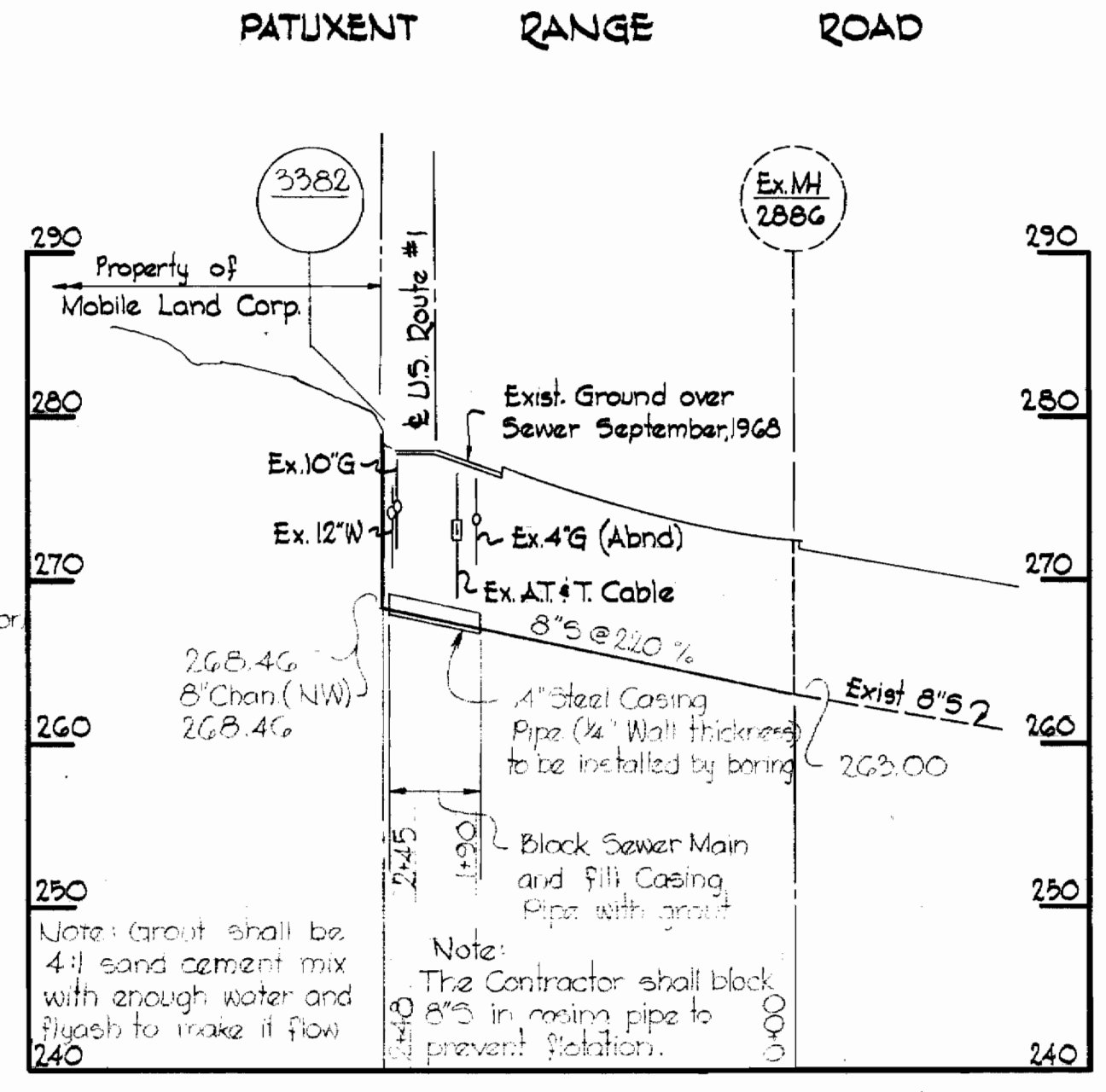

NOTE:
 Notify the A.T.&T. Company - Mr. Goldman, 922-7700 before beginning the construction of the crossing of U.S. Route #1

Exist 12"W and Exist 8" E built by others under Contract N° 234-W#5

Note:
 The Contractor shall block 8" S in main pipe to prevent Station.

GENERAL NOTES

1. Approximate location of existing mains are shown. The Contractor shall take all necessary precautions to protect existing mains and services and maintain uninterrupted supply. Any damage incurred shall be repaired immediately.
2. All pipe elevations shown are invert elevations.
3. The Contractor shall locate existing utilities a minimum of two weeks in advance of construction operations in vicinity of utilities.
4. For all standard details see standards bound in Specifications.
5. The Contractor shall provide a joint in all sewer mains within 2'-0" of exterior manhole walls.
6. All Manholes shall be 4'-0" inside diameter.

NOT BUILT

QUANTITIES	
ITEM	QUANTITY
8" Sewer Main	248 LF.



Kenneth A. McLeod
 Mobile Land Corporation
 Contract N° 274-S

S 274-5/1

WHITMAN, REQUARDT & ASSOCIATES ENGINEERS 1304 ST. PAUL ST. BALTIMORE, MARYLAND	HOWARD COUNTY METROPOLITAN COMMISSION 9-20-68 <i>lvo Palbert</i> <small>DATE</small> <small>CHIEF ENGINEER</small>	CONTRACT NO. 274-S	PLAN 8: PROFILE OF SEWER MAINS	ELECTION DISTRICT GUILFORD NO. 6	DRAWING NO. 1 OF 1	SCALE AS SHOWN <small>54 SW 26</small> <small>479-490</small> <small>479-489</small>
					FB#42G2	