

VICINITY MAP
Scale: 1"=600'
GENERAL NOTES

1. Approximate location of existing mains are shown. The Contractor shall take all necessary precautions to protect existing mains and services and maintain uninterrupted supply. Any damage incurred shall be repaired immediately.
2. All pipe elevations shown are invert elevations.
3. The Contractor shall locate existing utilities a minimum of two weeks in advance of construction operations in vicinity of utilities.
4. For all standard details see standards bound in Specifications.
5. Clear all utilities by a minimum of 6', clear all poles by 2'-0" minimum or tunnel as required.
6. The Contractor shall provide a joint in all sewer mains within 2'-0" of exterior manhole walls.
7. All manholes shall be 4'-0" inside diameter.
8. The cost of grouted Rip Rap and concrete encasement to be included in the unit price bid for furnishing and laying sewer mains.

MATERIALS TO BE FURNISHED BY THE OWNER

6" V	2
6x5' FM-CT	1

QUANTITIES

12" Water	150 LF
6" Sewer	300 LF
Meter Vault	1
6" Water	35 LF

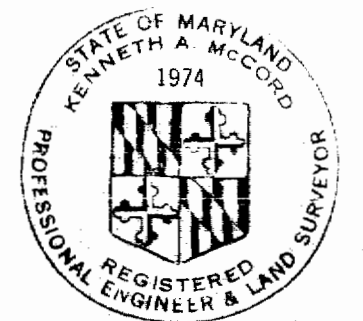

Kenneth A. McCord

Oakland Ridge Industrial Park
Section 5
Contract No. C-253-W&S

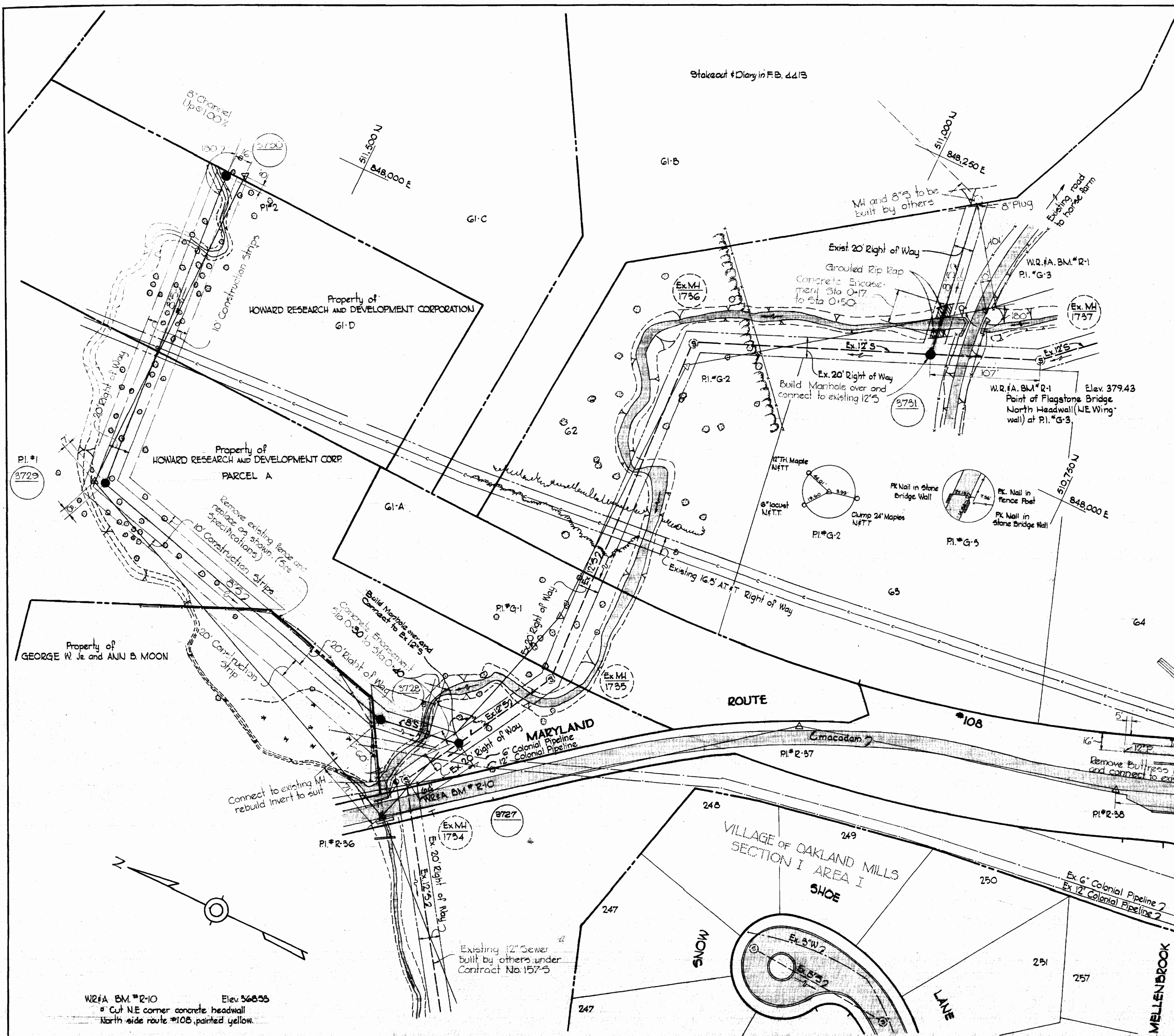

WHITMAN, REQUARDT & ASSOCIATES
ENGINEERS
1304 ST. PAUL ST.
BALTIMORE, MARYLAND

HOWARD COUNTY METROPOLITAN COMMISSION
DATE: 2-27-69
W. O. Faint
CHIEF ENGINEER

CONTRACT NO. C-253-W&S

PLAN OF WATER AND SEWER MAINS

COLUMBIA
OAKLAND RIDGE INDUSTRIAL PARK
ELECTION DISTRICT - ELLICOTT CITY No 2

DRAWING NO. 1 OF 3
SCALE AS SHOWN

253-WS/1

S

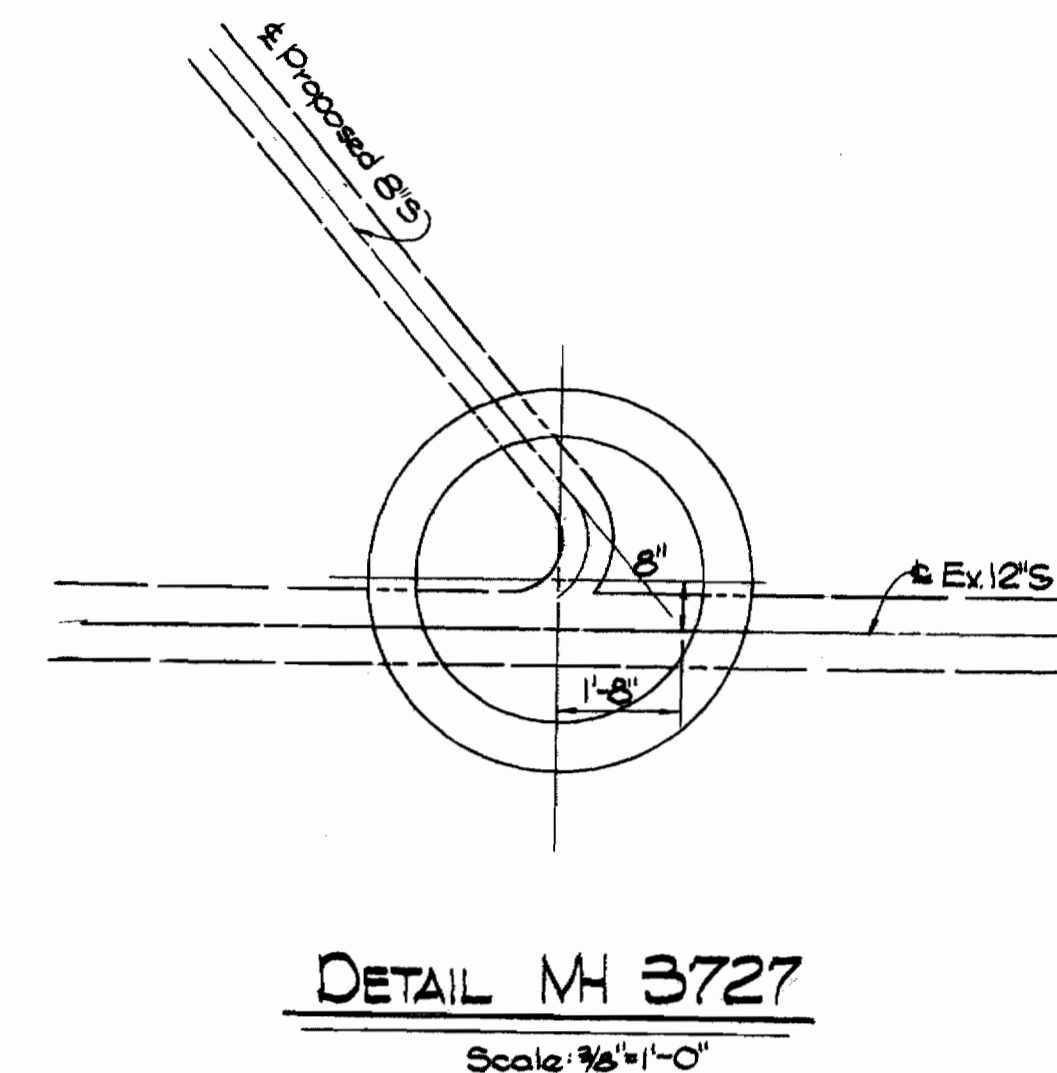
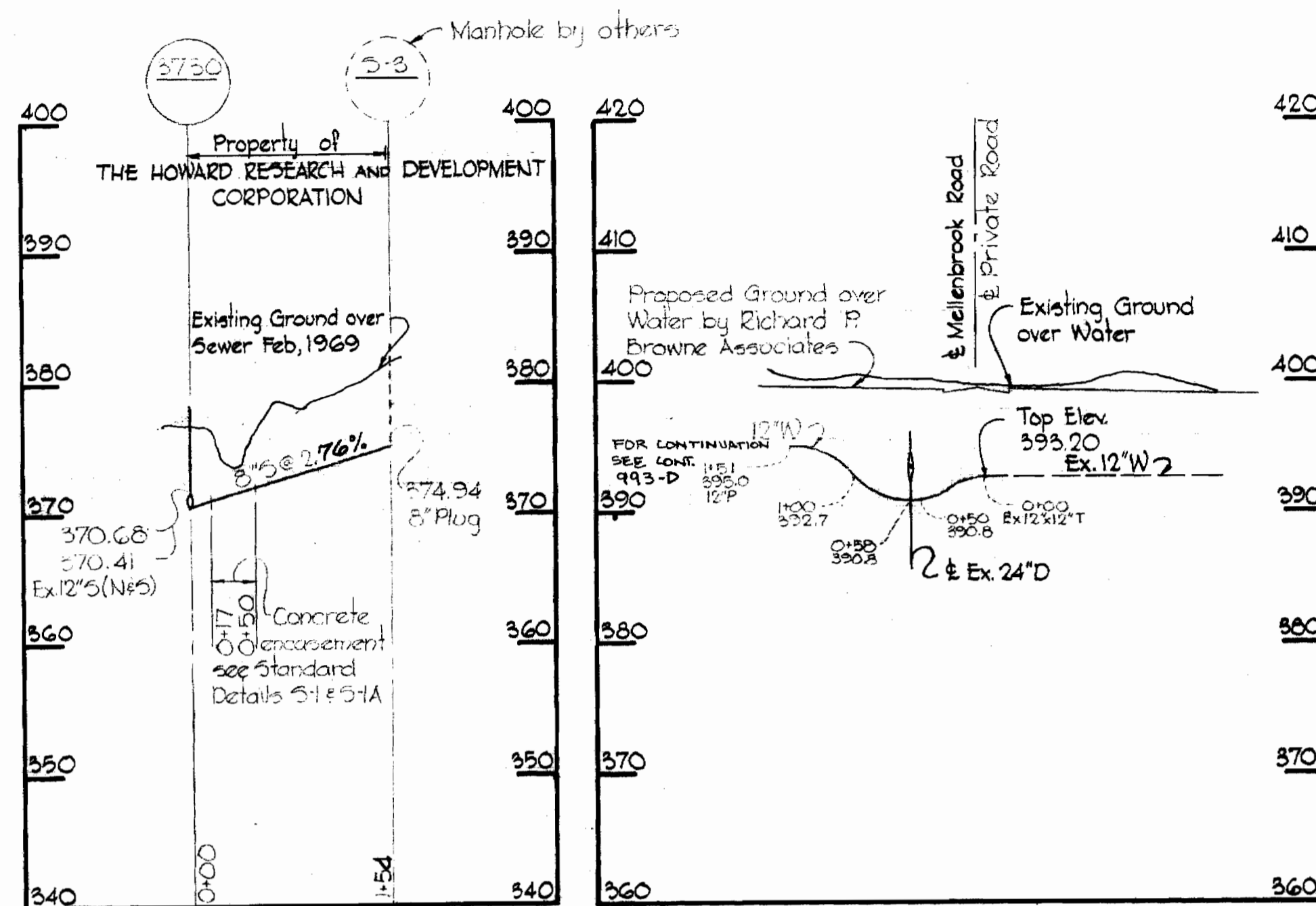

ALL SEWER PIPE USED - A.C.P. CLASS 2400

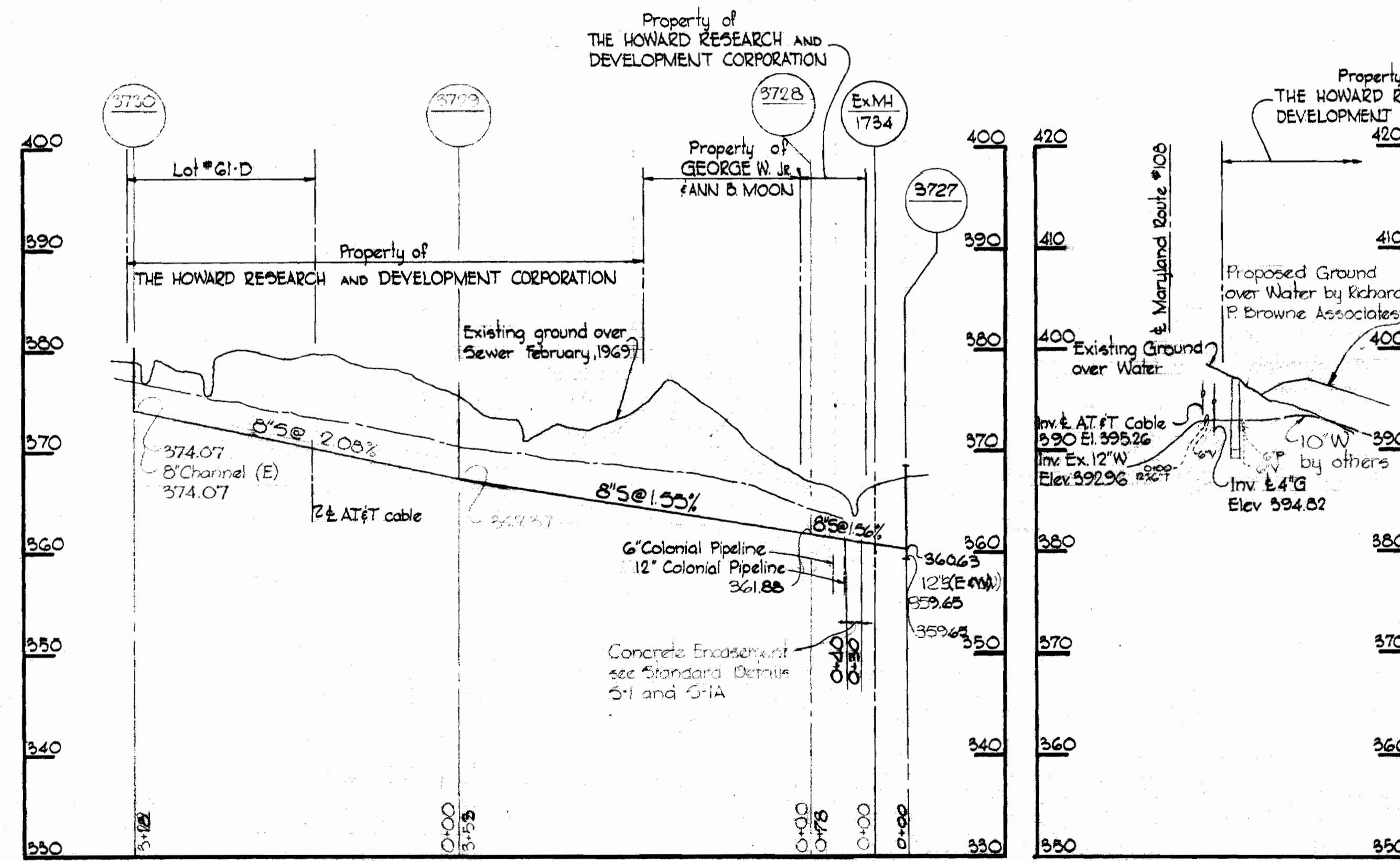

NOTE:
The Contractor shall notify the Telephone Company prior to any construction activities in the vicinity of the telephone cables by calling collect at 685-0400 in Baltimore, Maryland.

NOTE:
The Contractor shall notify the Colonial Pipeline Company 72 hours in advance of excavation in the vicinity of the Colonial Pipeline Company Right of Way by calling Colonial Division Office Richmond, Va. Area Code 703, 282-9771 or Mr. S.H. Crumlich, Area Supervisor, Baltimore, Maryland 787-2295



Kenneth A. McCord

Oakland Ridge Ind. Park
Section 3
Contract No. C-253-W&S

WHITMAN, REQUARDT & ASSOCIATES ENGINEERS 1304 ST. PAUL ST. BALTIMORE, MARYLAND	HOWARD COUNTY METROPOLITAN COMMISSION DATE: 10/23/69 W. O. Falout CHIEF ENGINEER	CONTRACT NO. C-253-W&S	PROFILES OF WATER AND SEWER MAINS	COLUMBIA OAKLAND RIDGE INDUSTRIAL PARK ELECTION DISTRICT - ELLICOTT CITY No. 2	DRAWING NO. 2 OF 3 SCALE H-1"=100' V-1"=10' AS BUILT Oct. 23, 1969
---	---	------------------------	--------------------------------------	--	--

15 253-W&S/2

SCHEDULE

Meter Size	Dimensions					Volume (cu yd)	Weight (lb)	Reinforcing
	A	B	C	D	E			
4"x2" FM CT	5'-8"	2'-8"	2'-8"	6'-10"	6'-10"	8 yd ³	1100#	10 Top 5/8" #5 @ 6" E.W. Bars
6"x4" FM CT	6'-8"	3'-0"	2'-8"	8'-0"	7'-4"	9 yd ³	1400#	12 Top 5/8" #6 @ 6" E.W. Bars
8"x4" FM CT	7'-8"	3'-0"	2'-5"	8'-10"	8'-1"	10 yd ³	1600#	12 Top 5/8" #6 @ 6" E.W. Bars
10"x6" FM CT	8'-10"	3'-0"	2'-5"	10'-2"	9'-1"	13 yd ³	1900#	12 Top 5/8" #6 @ 6" E.W. Bars

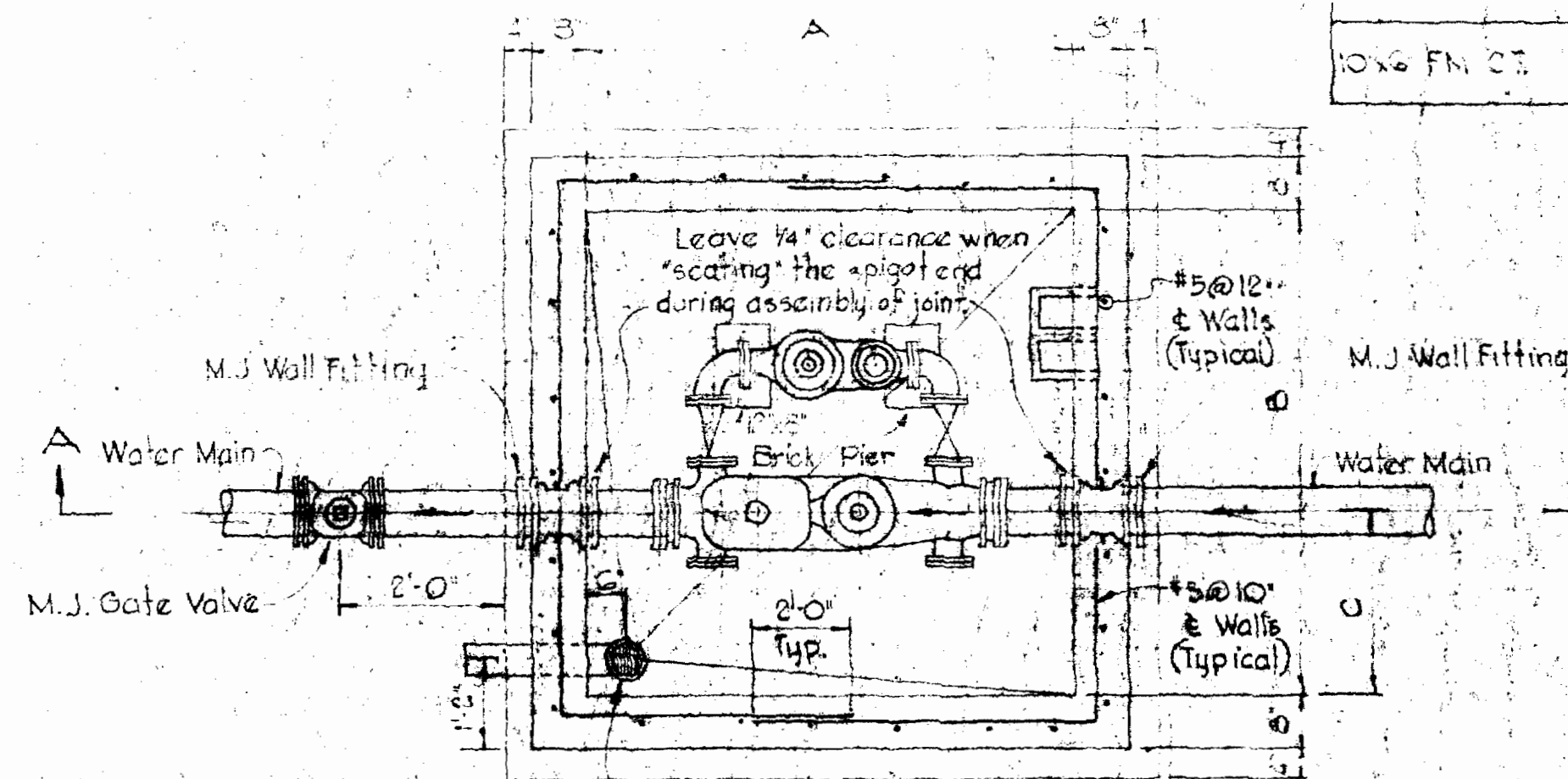

NOTE:
Meter to be furnished with plain ends and installed with Smith-Blair 912 Flanged coupling adapters. Prior to placing meter, strap valve to see standard detail W-G.A.

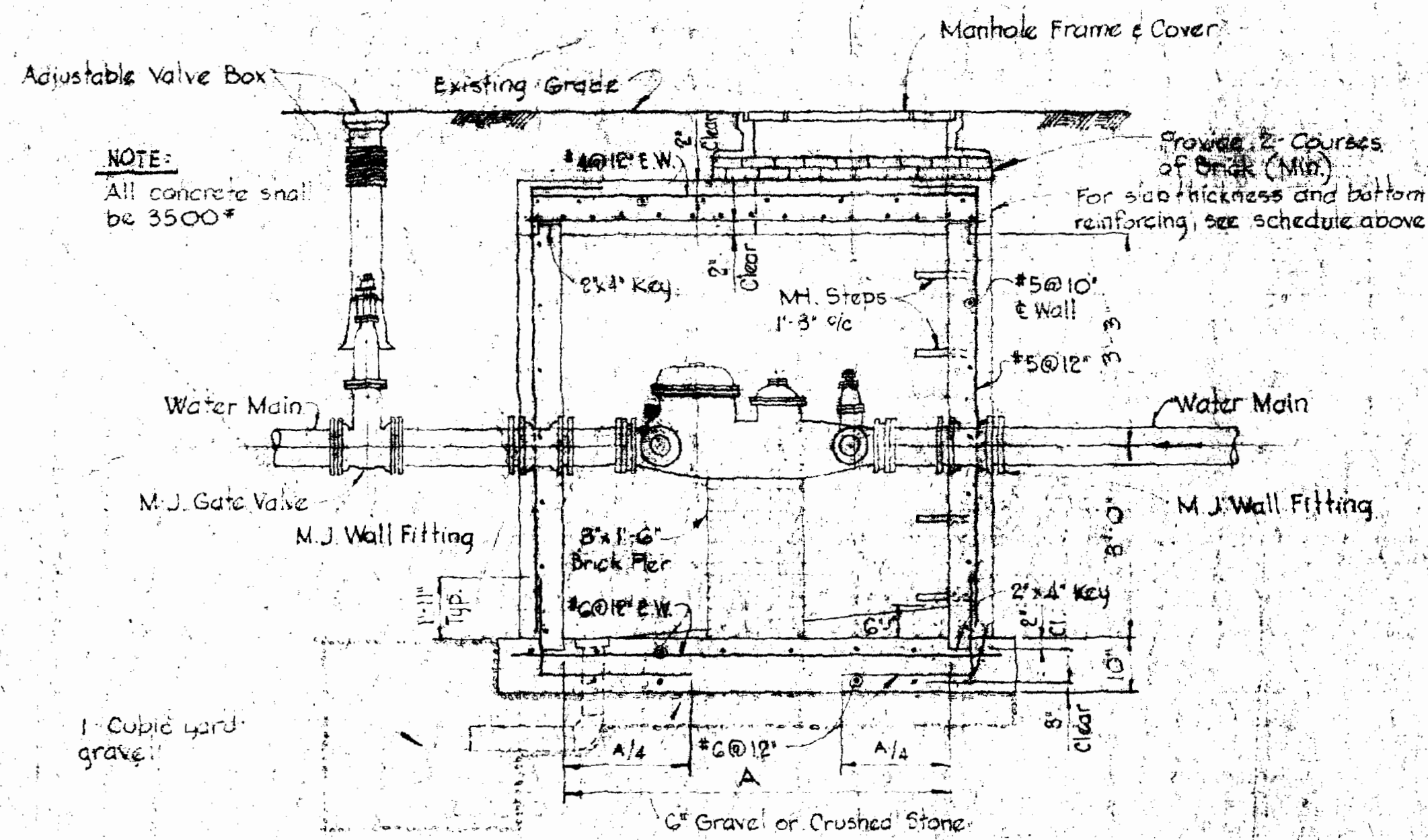
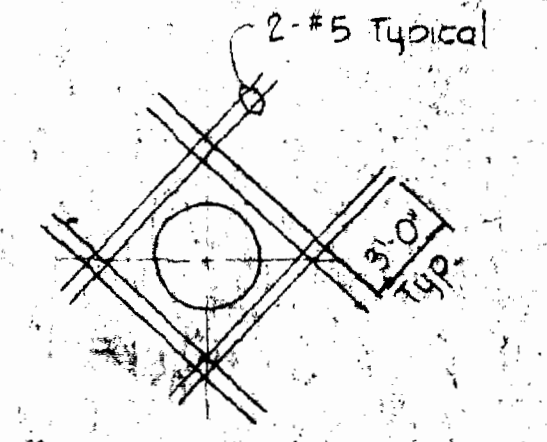
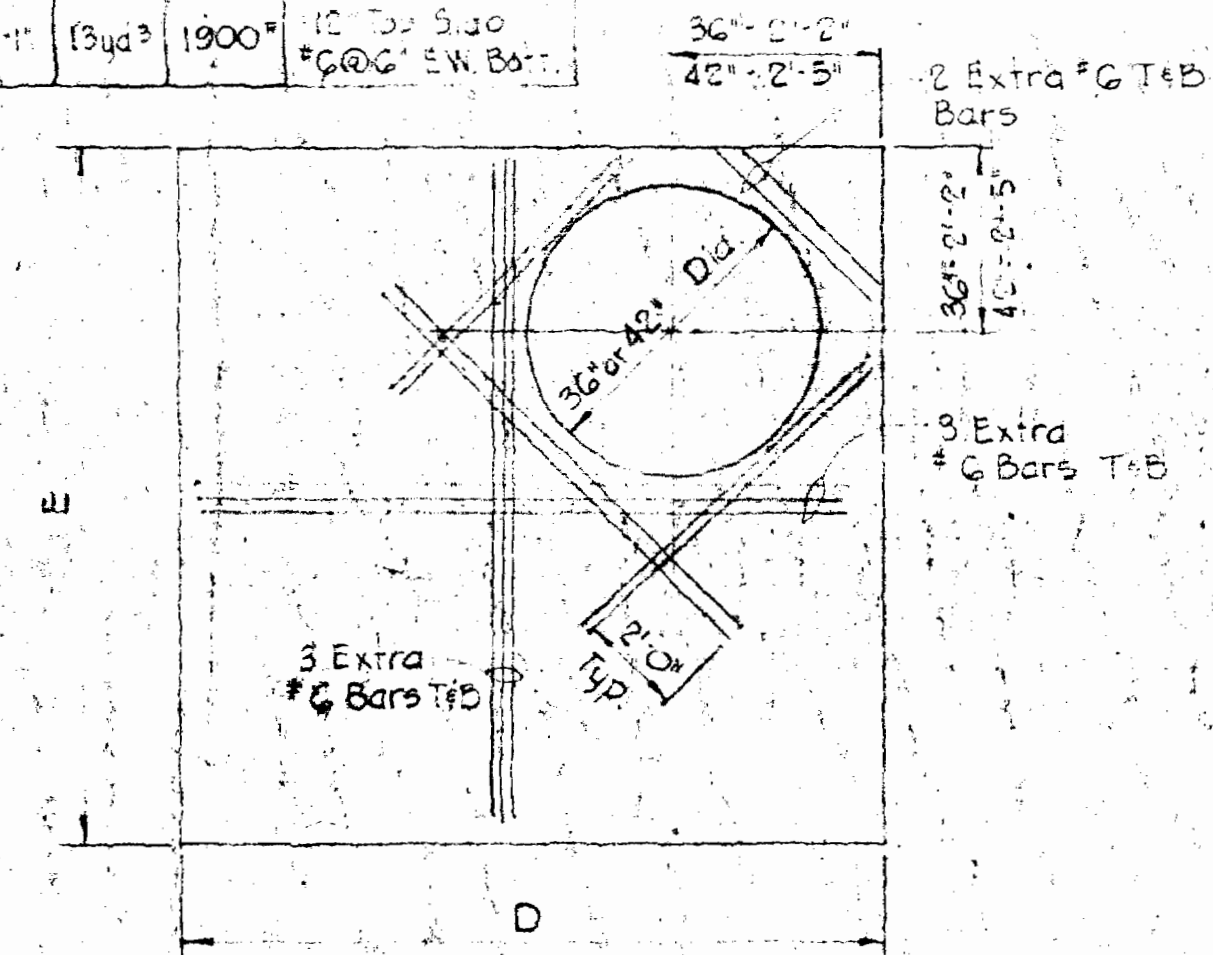

- GENERAL CONCRETE NOTES
- All reinforced concrete shall be Class A, 3500 psi at 28 days.
 - Reinforcing steel shall be intermediate grade (ASTM A-15) with deformations conforming to ASTM Specification A 305.
 - All dowel projections beyond construction joints shall be 30 diameters.
 - All bars laps shall be 30 diameters unless otherwise noted.

WHITMAN, REQUARDT & ASSOCIATES
ENGINEERS
BALTIMORE, MARYLAND

METER VAULT
Scale 1/2" = 1'-0"

Oakland Ridge Industrial Park
Section 5
Contract No. C-253-W-5

HOWARD COUNTY, MARYLAND
DEPARTMENT OF PUBLIC WORKS

AS BUILT
DATE: Oct 23 1969

3 of 3

WS 253-WS/3

suspensi

suspensi