

**PLAN**  
Scale 1" = 50'

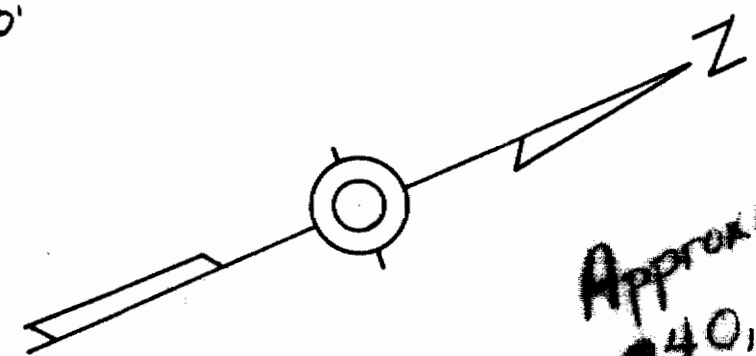

Approximately  
840,000  
468,125

BUILT ACCORDING TO PLAN

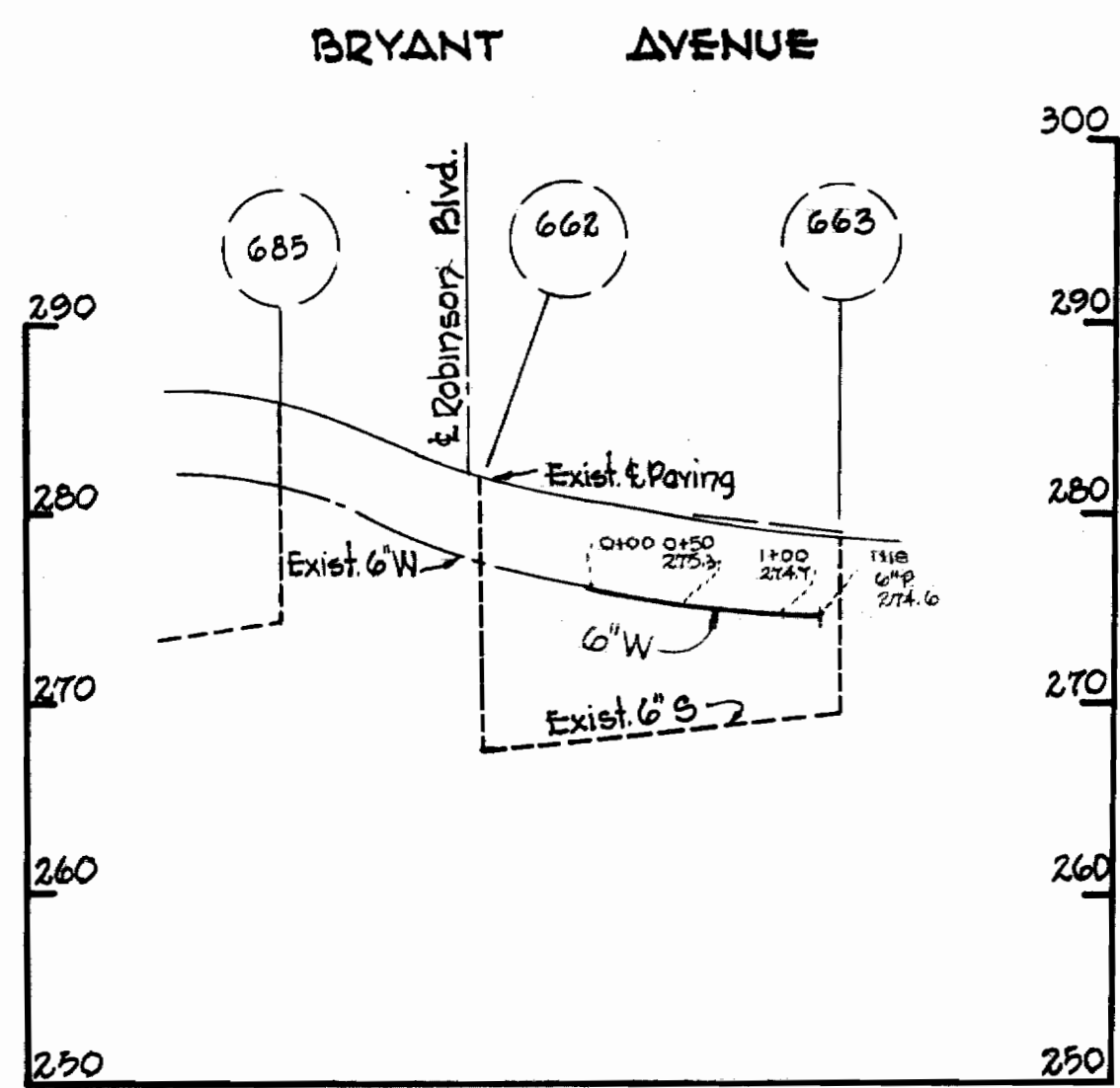

**PROFILE**  
Scale Hor. 1" = 100'  
Vert. 1" = 10'

QUANTITIES	
ITEM	QUANTITY
6" W	118'

**GENERAL NOTES**

1. Approximate location of all existing mains are shown. The contractor shall take all necessary precautions to protect existing mains and services and maintain uninterrupted supply. Any damage incurred shall be repaired immediately.
2. All pipe elevations shown are invert elevation.
3. The Contractor shall locate existing utilities a minimum of two weeks in advance of construction operations in vicinity of utilities.
4. For all standard details see standards bound in Specifications.
5. All water mains to be CIP or DIP and have a minimum of 3 1/2' cover.
6. Block all fitting with concrete, see standard details bound in Specifications.
7. Clear all utilities by a minimum of 6'; clear a poles by 2'-0" minimum or tunnel as required.

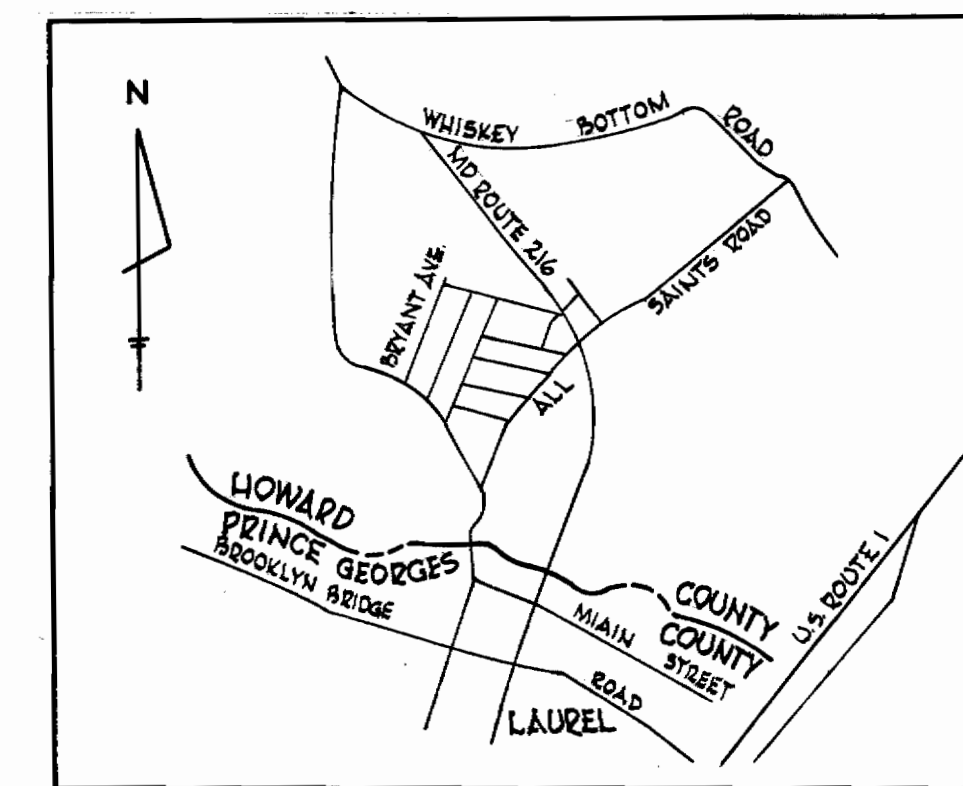

**VICINITY MAP**  
Scale: 1" = 1/2 mile



*James H. ...*

WHITMAN, REQUARDT & ASSOCIATES  
ENGINEERS  
1304 ST. PAUL ST.  
BALTIMORE, MARYLAND

HOWARD COUNTY METROPOLITAN COMMISSION  
DATE 1-9-68 *W. O. ...* CHIEF ENGINEER

CONTRACT NO. 218-W

PLAN AND PROFILE OF  
WATER MAIN EXTENTION

ELECTION DISTRICT  
GUILFORD NO. 6

DRAWING  
NO. 1  
OF 1

SCALE  
AS  
SHOWN

15 218-W/1 1/M-812