

NOTE:
 The existing sanitary system shown must be kept in operation at all times. Any damage incurred must be repaired immediately as required or directed. The cost shall be included in the unit price bid for excavation and backfill of sewer mains.

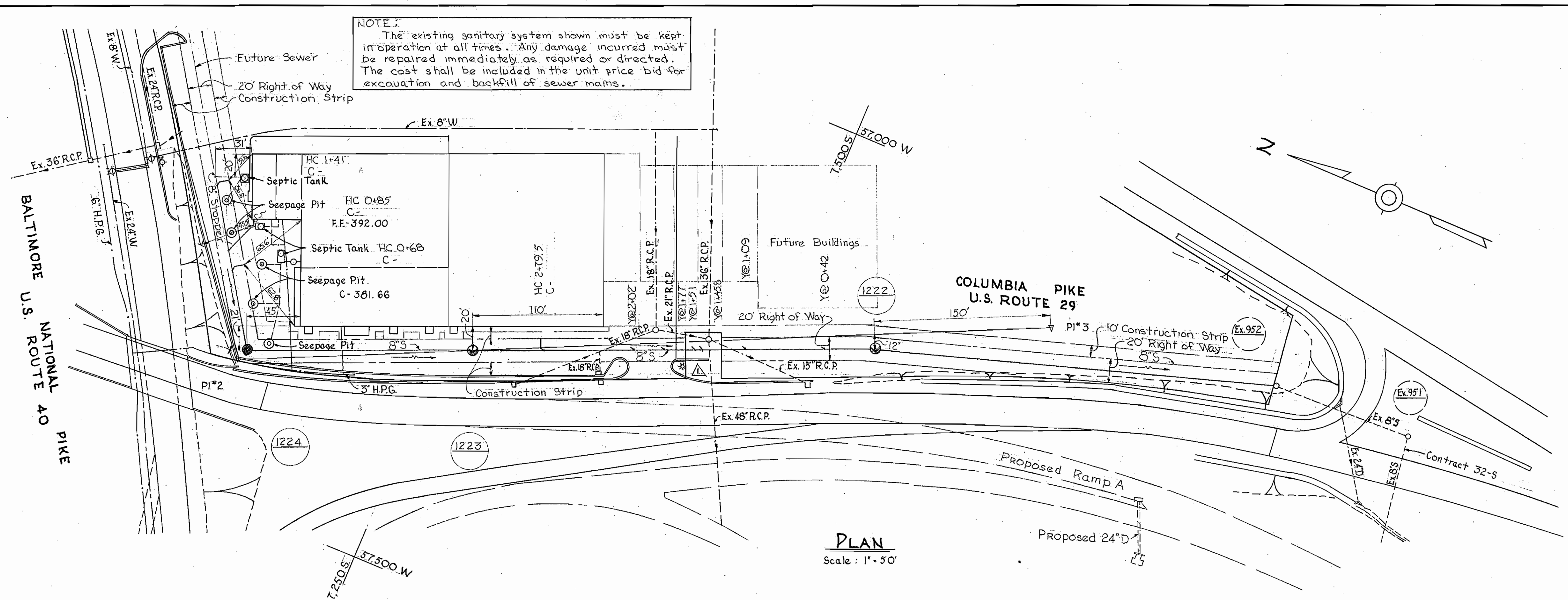

PLAN
 Scale: 1" = 50'

WR & A. B.M. #31 Elev. 419.24'
 = cut in top N. end concrete curb surrounding grass plot in concrete crossover, 105' N of & int. East Bound Lane and crossover, opposite Econo Go gas station.

GENERAL NOTES

1. Approximate location of existing mains are shown. The Contractor shall take all necessary precautions to protect existing mains and services and maintain uninterrupted supply. Any damage incurred shall be replaced immediately.
2. All pipe elevation shown are invert \odot elevations.
3. The Contractor shall locate existing utilities a minimum of two weeks in advance of construction operations in vicinity of utilities.
4. For all standard details see Standard bound in the Specifications.
5. All sewers shall be V.C.P.X., C.S.P.X. or Asbestos Cement Class 2400 unless otherwise noted.
6. Clear all poles by 2'-0" minimum or tunnel as required. Clear all utilities by 6' minimum.

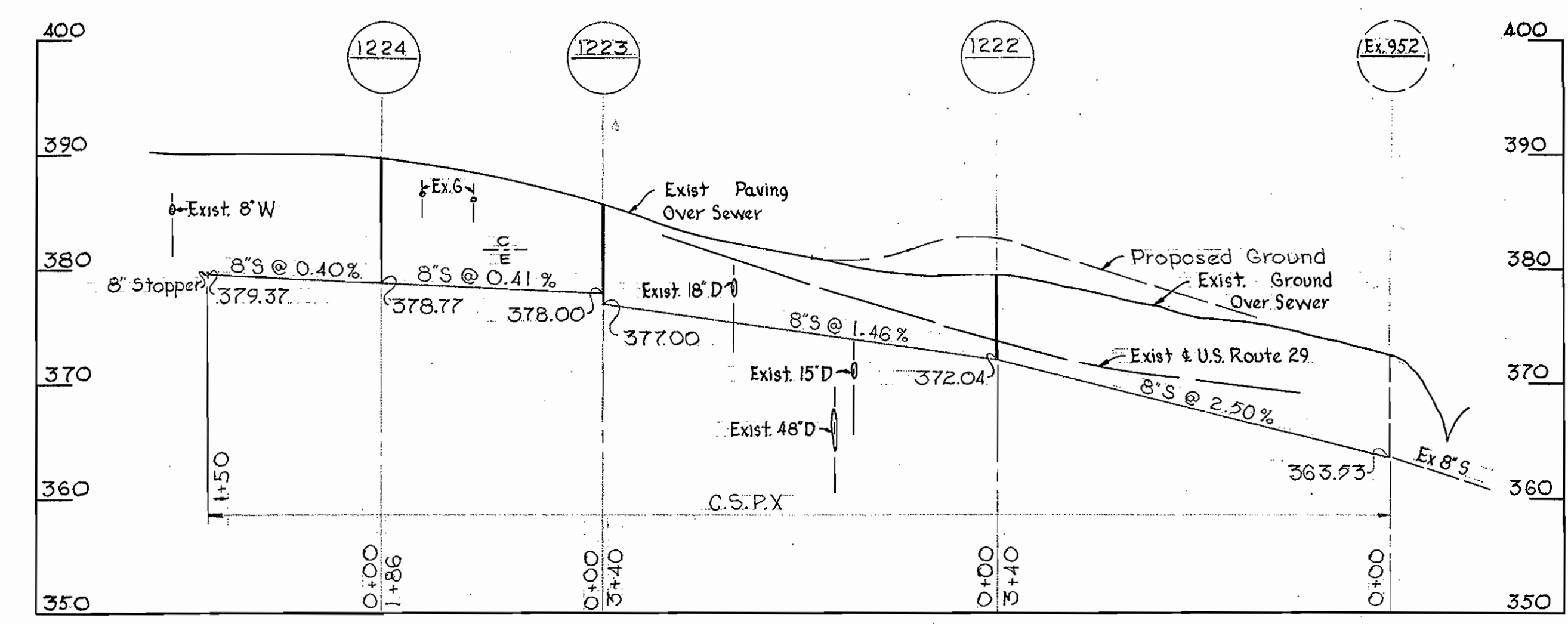

PROFILE
 Scale: Hor. 1" = 100'
 Vert. 1" = 10'

1	1-3-66	Revised Right of Way
11	Date	Revision



Contract No. 115-S
 Golden Triangle

WHITMAN, REQUARDT & ASSOCIATES
 ENGINEERS
 1304 ST. PAUL ST.
 BALTIMORE, MARYLAND

HOWARD COUNTY METROPOLITAN COMMISSION
 12-13-65
 DATE
W. O. Meland
 CHIEF ENGINEER

CONTRACT NO. 115-S

PLAN AND PROFILE OF SEWER MAIN EXTENSIONS

ELLICOTT CITY SUB-DISTRICT

DRAWING NO.	SCALE
OF 1	AS SHOWN

W. O. - 5129-2

AS BUILT . 7. FEB. 65

FB. 2878

WS 1155/1