

VICINITY MAP
SCALE: 1" = 600'

General Notes
 For Locations of 'Y's' On Sewers, Pluses Are Taken From Down Grade Manhole.
 Data Pertaining to Existing Sewers Taken From Plans Prepared By J.E. Serrine, Mill Architect And Engineer Of Greenville, S.C. (Dated April 15, 1917), And Sewer And Water Plans Prepared By J.H. Gregory, 170 Broadway, New York (Dated March 30, 1918)

BENCH MARK CHISELED Φ ON STONE PIER OF SW. CORNER OF SOUTH ABUTMENT. ELEVATION 164.22 U.S. GEOLOGICAL SURVEY DATUM (SANDY HOOD)

PLAN
SCALE: 1" = 100'

THIS PLAN IS REDRAWN FROM A PLAT DATED AUGUST 29, 1919

BUREAU OF ENGINEERING INSPECTION AND SURVEY DIVISION

DEPARTMENT OF PUBLIC WORKS
 HOWARD COUNTY, MARYLAND
 DATE 6-14-77
 W.O. Libert
 CHIEF-BUREAU OF WATER AND SEWER

CONTRACT NO. 4-5

PLAN OF SEWER MAINS

ELECTION DISTRICT NO. 6

DRAWING NO. 1 OF 30
 SCALE AS SHOWN
 DRWN: P.K.H.

Believe to be most recent
 "As Built" Information: 6-15-1977

WS 45/1

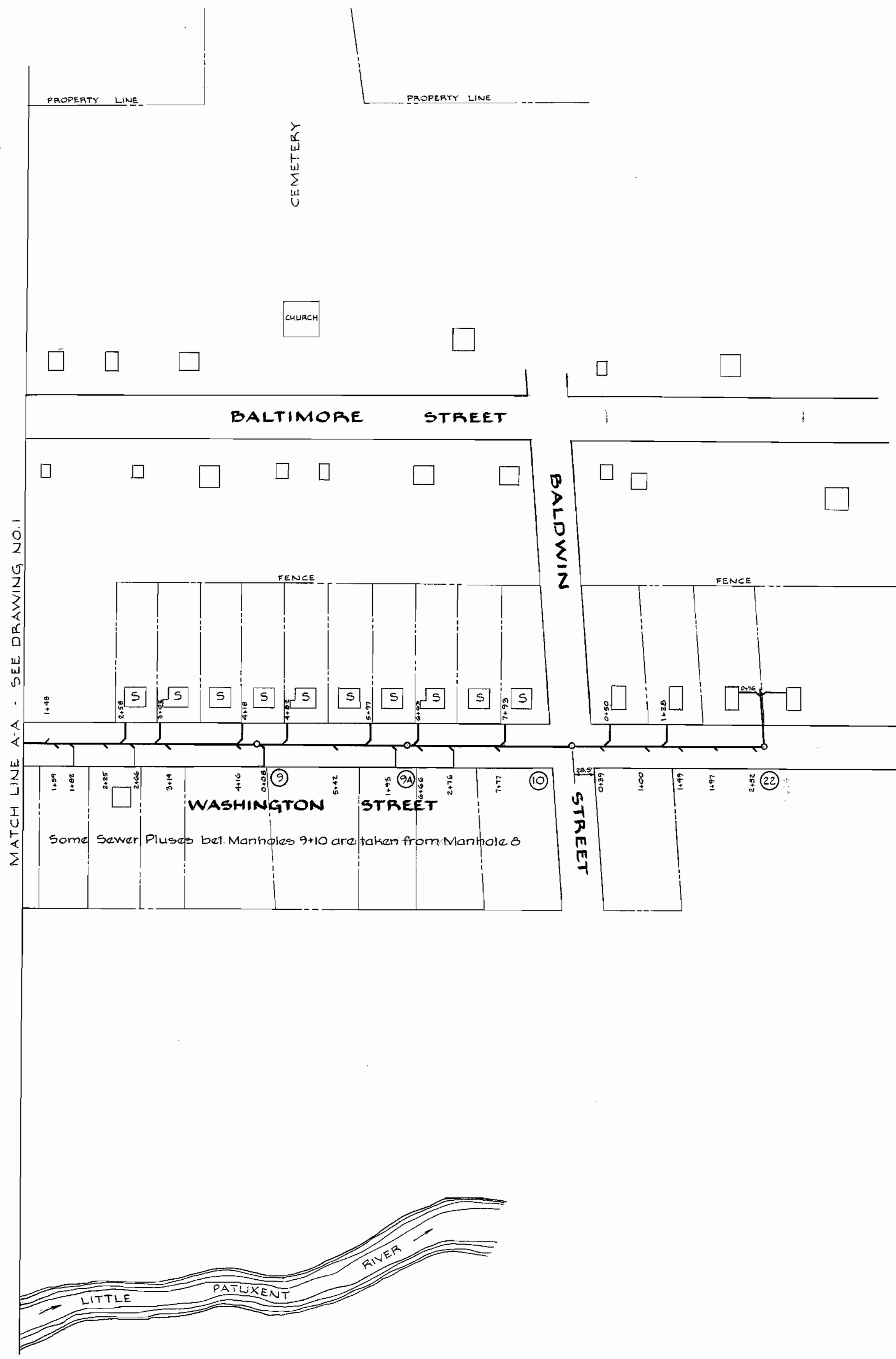
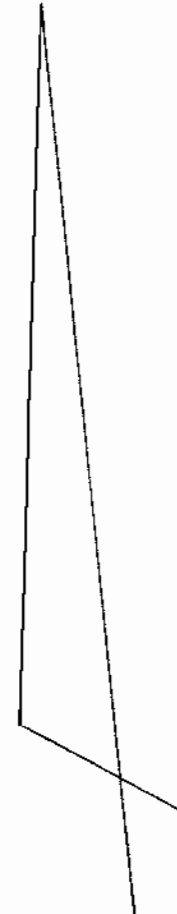

THIS PLAN IS REDRAWN FROM A PLAT DATED AUGUST 29, 1919

WS 45/2

BUREAU OF ENGINEERING INSPECTION AND SURVEY DIVISION

DEPARTMENT OF PUBLIC WORKS HOWARD COUNTY, MARYLAND
DATE 6-13-77
W. O. Libert CHIEF-BUREAU OF WATER AND SEWER

CONTRACT NO. 4-5

PLAN OF SEWER MAINS

ELECTION DISTRICT NO. 6

DRAWING NO. 2 OF 3 SCALE 1"=100' DRWN: R.A.H.

Believe to be most recent 'As Built' Information. 6-15-1977

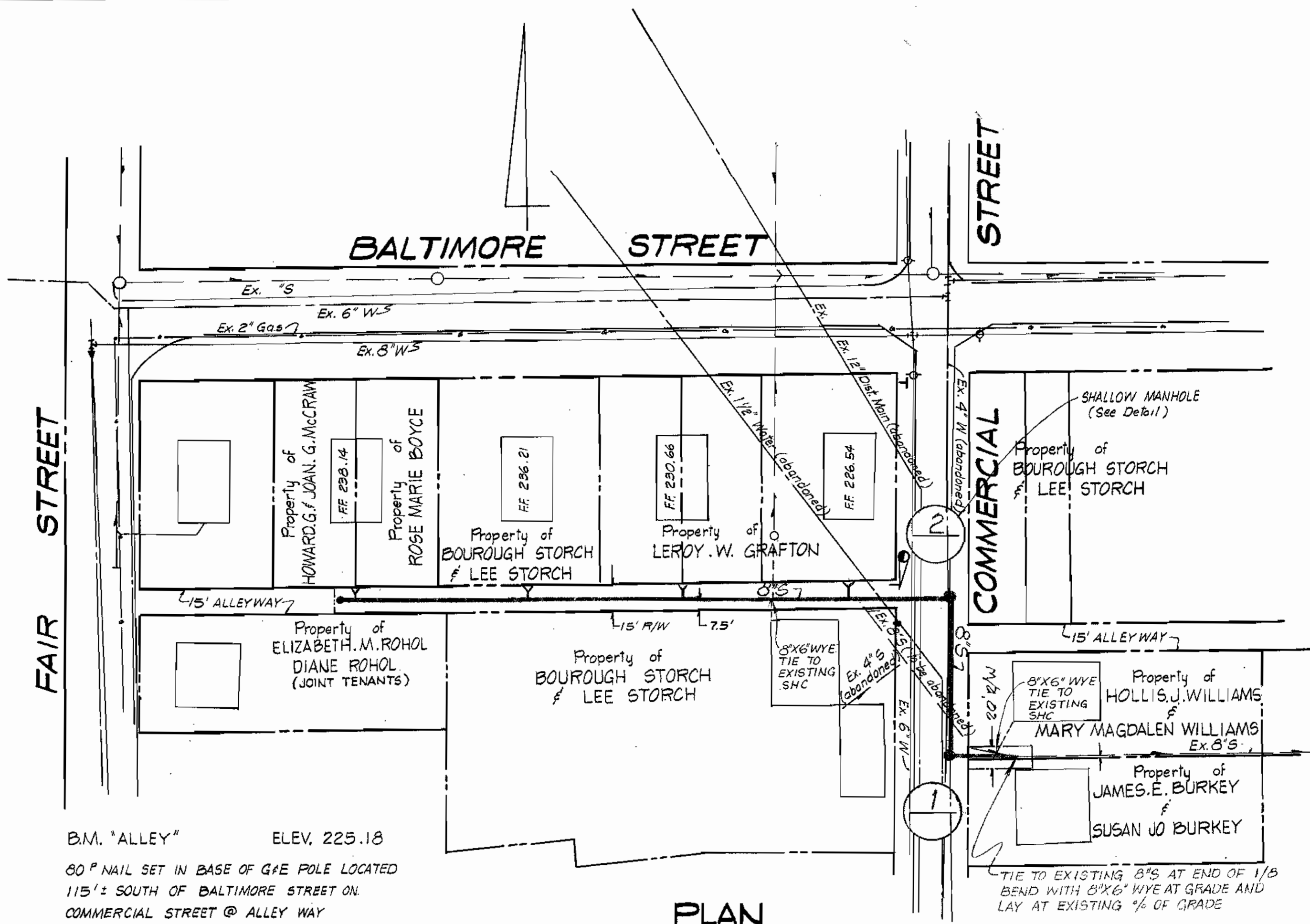

B.M. "ALLEY" ELEV. 225.18
 60" NAIL SET IN BASE OF GFE POLE LOCATED
 115' S SOUTH OF BALTIMORE STREET ON
 COMMERCIAL STREET @ ALLEY WAY

PLAN
 SCALE: 1" = 50'

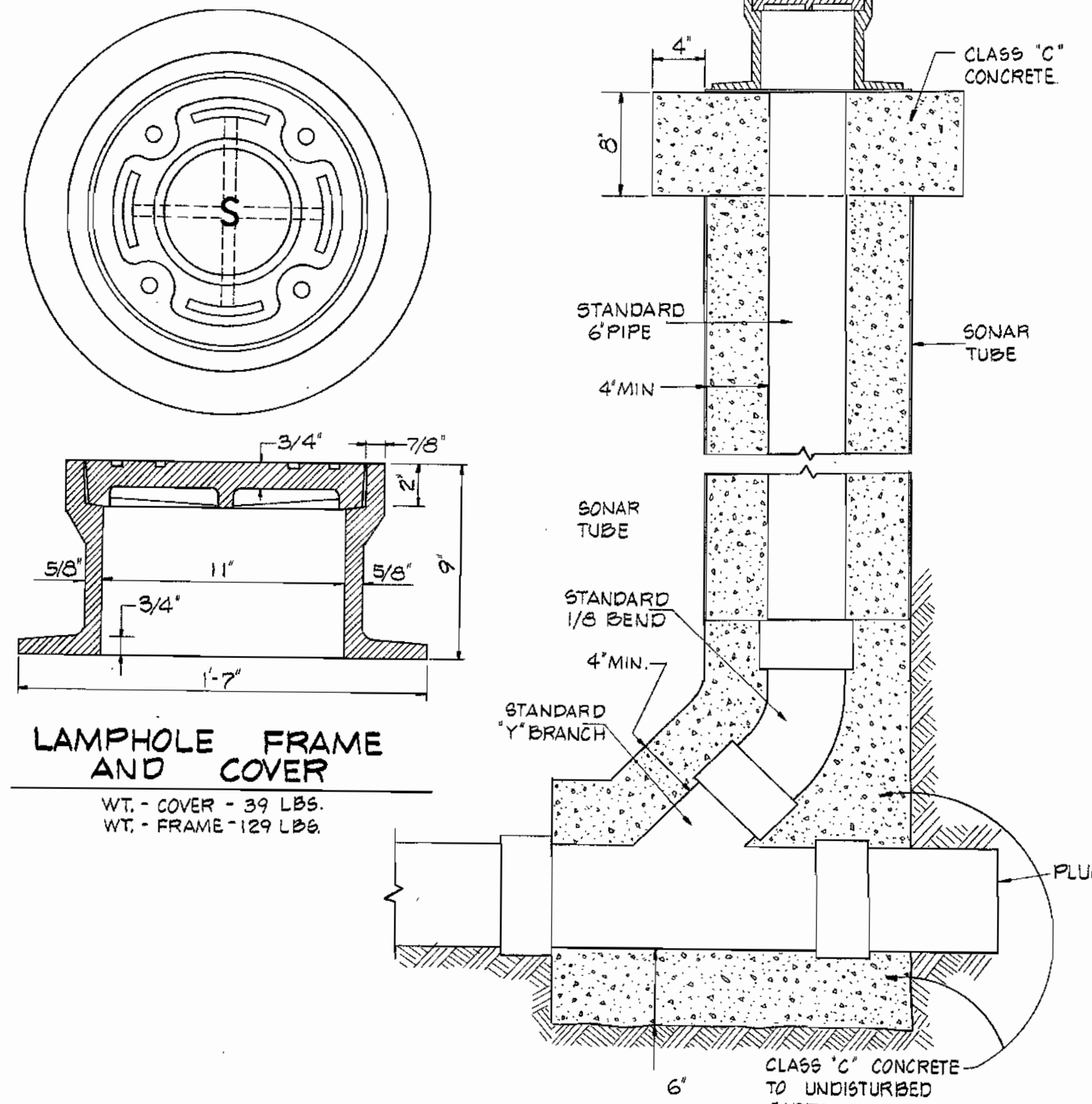

MAIN LINE CLEANOUT - LAMPHOLE DETAIL
 NO SCALE

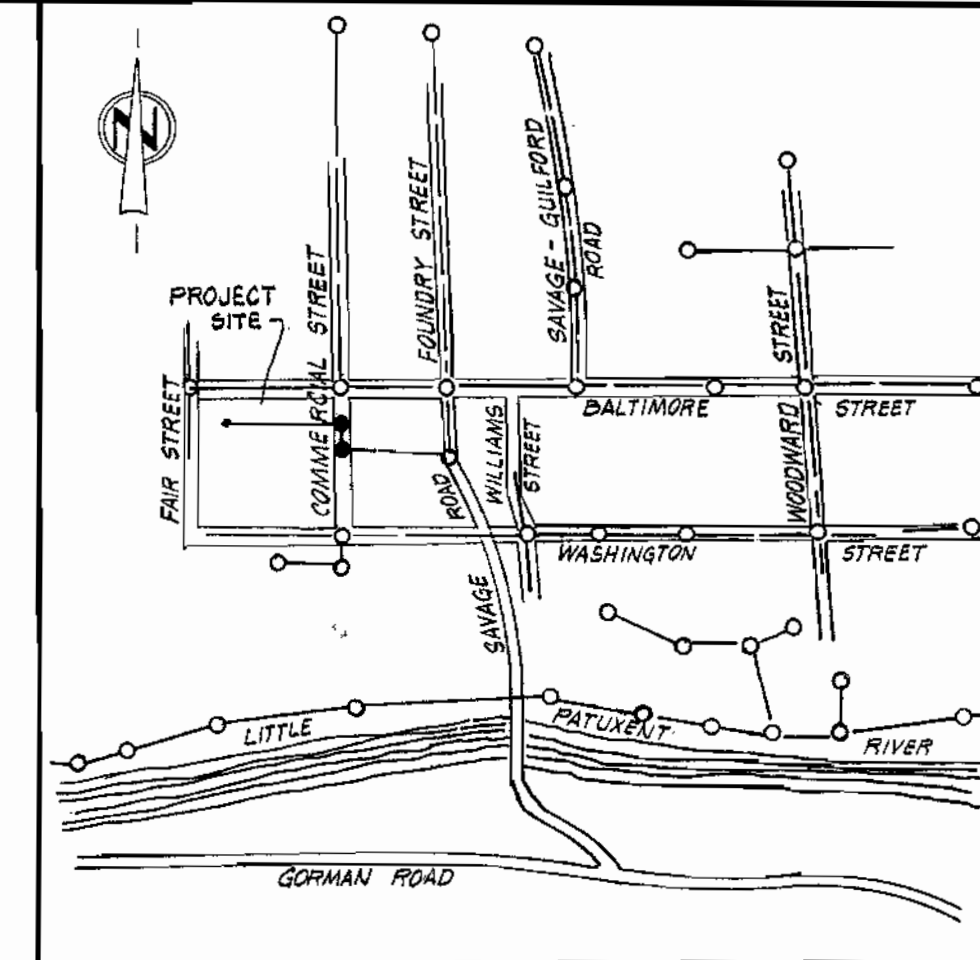

VICINITY MAP
 SCALE: 1" = 600'

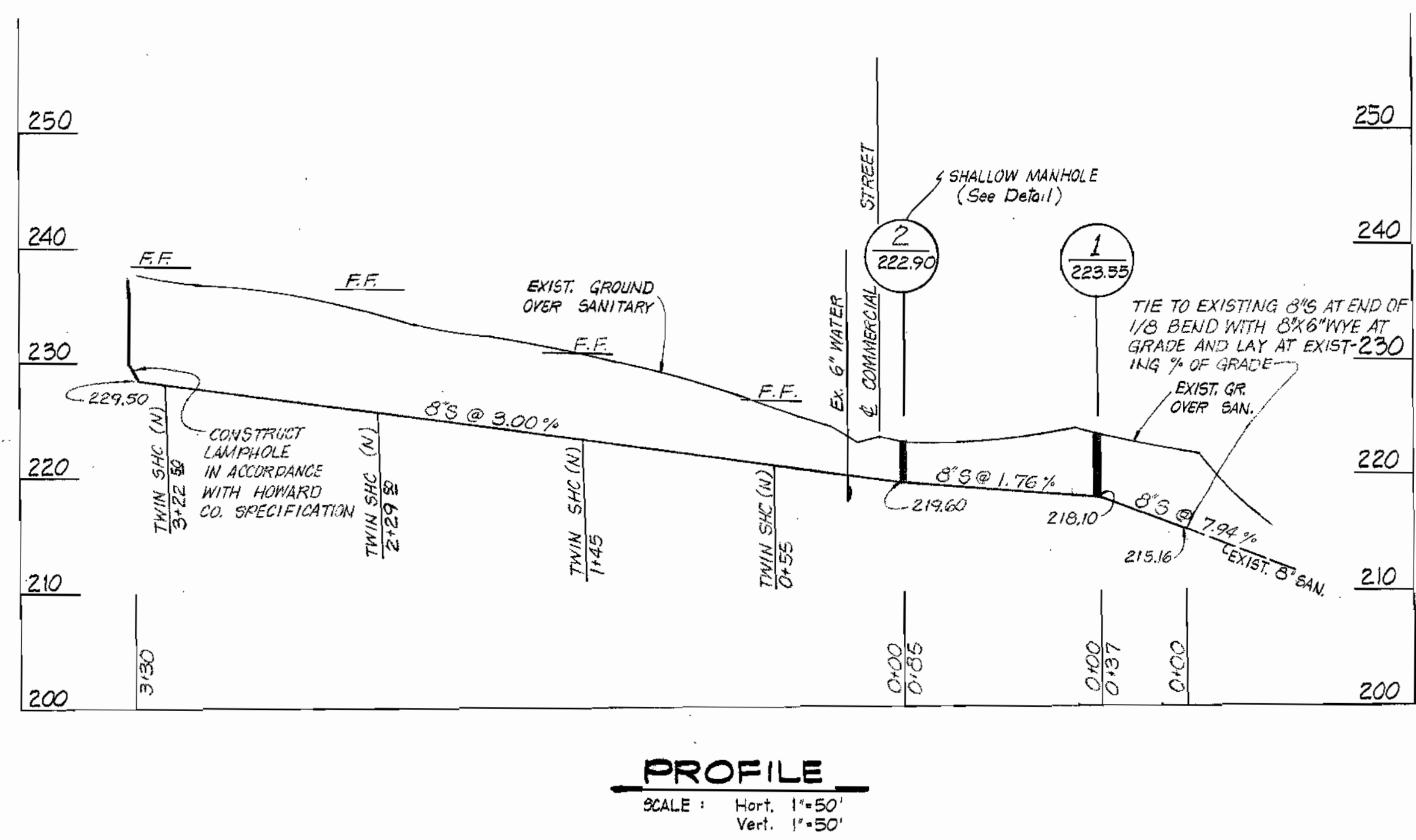

PROFILE
 SCALE: Horz. 1" = 50'
 Vert. 1" = 50'

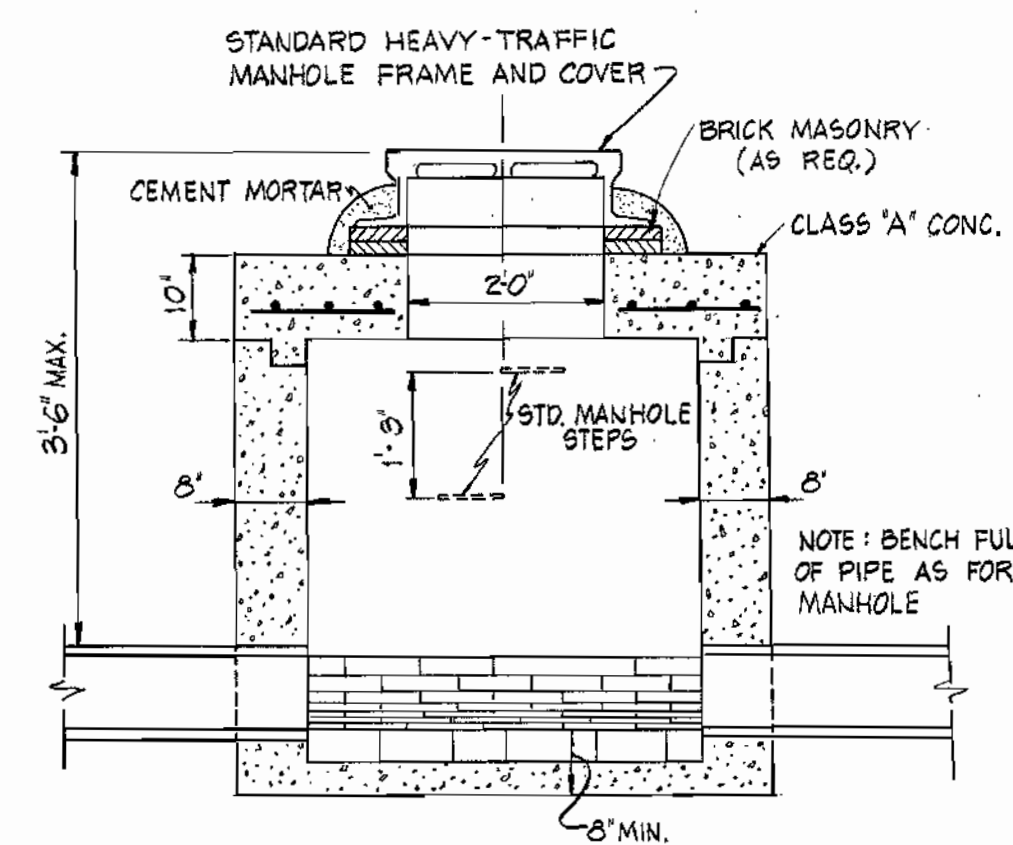

SHALLOW MANHOLE SECTION
 NO SCALE

GENERAL NOTES

- APPROXIMATE LOCATION OF EXISTING MAINS ARE SHOWN. THE CONTRACTOR SHALL TAKE ALL NECESSARY PRECAUTIONS TO PROTECT ALL EXISTING MAINS AND SERVICES AND MAINTAIN UNINTERRUPTED SUPPLY. ANY DAMAGE INCURRED SHALL BE REPAIRED IMMEDIATELY.
- ALL PIPE ELEVATIONS ARE INVERT. (ELEVATIONS).
- THE CONTRACTOR SHALL LOCATE EXISTING UTILITIES A MINIMUM OF TWO WEEKS IN ADVANCE OF CONSTRUCTION OPERATIONS IN VICINITY OF UTILITIES.
- FOR ALL STANDARD DETAILS SEE STANDARDS BOUND IN SPECIFICATIONS.
- CLEAR ALL UTILITIES BY A MINIMUM OF 6' CLEAR ALL POLES BY A 2'-0" MINIMUM OR TUNNEL AS REQUIRED.
- ALL HORIZONTAL CONTROLS ARE BASED ON MARYLAND STATE COORDINATES.
- ALL VERTICAL CONTROLS ARE BASED ON U.S.G.S. DATUM.
- CONTRACTOR SHALL NOTIFY THE FOLLOWING UTILITIES OR AGENCIES AT LEAST FIVE (5) DAYS BEFORE STARTING WORK ON THESE PLANS.
 - STATE HIGHWAY ADMINISTRATION 531-5533
 - BALTIMORE GAS AND ELECTRIC COMPANY - UNDERGROUND GAS DISTRIBUTION ENGINEERING - 559-0100
 - BALTIMORE GAS AND ELECTRIC COMPANY UNDERGROUND ELECTRIC DISTRIBUTION - DAMAGE CONTROL 234-5691
 - CHESAPEAKE AND POTOMAC TELEPHONE CO. 725-9976
 - AMERICAN TELEPHONE AND TELEGRAPH - CABLE LOCATION DIVISION 301-393-3553
 - COLONIAL PIPELINE COMPANY 781-4641
- THE CONTRACTOR SHALL PROVIDE A JOINT IN ALL SEWER MAINS WITHIN 2'-0" OF EXTERIOR MANHOLE WALLS.
- ALL MANHOLES SHALL BE 4'-0" INSIDE DIAMETER.
- ALL SEWER MAINS SHALL BE C.S.P.X., V.C.P.X., OR ACP CLASS 2400 UNLESS OTHERWISE NOTED.

HOWARD COUNTY DEPARTMENT OF PUBLIC WORKS
 BUREAU OF ENGINEERING, CONST. INSPECTION & SURVEY DIV.
 3430 COURT HOUSE DRIVE
 ELLICOTT CITY, MD. 21043

DEPARTMENT OF PUBLIC WORKS
 HOWARD COUNTY, MARYLAND
 Director of Public Works - DATE
 Chief - Bureau of Engineering - DATE

REVISIONS TO
 CONTRACT NO. 4-5

PLAN AND PROFILE
 SEWER MAIN EXTENSION

PATUXENT SUB-DISTRICT No.2

DRAWING NO. 1 OF 3
 SCALE AS SHOWN

WS 45/3