

COORDINATES

NO.	NORTH	EAST
265	552951.34	1348813.11
266	552953.30	1348844.24
267	553125.86	1349006.83
268	553096.93	1349014.75

COORDINATES SHOWN HEREON ARE BASED ON THE MARYLAND STATE GRID SYSTEM NAD'83 AS PROJECTED BY HOWARD COUNTY MONUMENTS 41C2 AND 42BB.

E 1348700
N 553250

LEGEND

- CCG= COMBINATION CONC. CURB & GUTTER
- ⊙ = STORM DRAIN MANHOLE
- SS= SANITARY SEWER MANHOLE
- ⊕ = CONC. STORM DRAIN INLET
- ⊗ = DECIDUOUS TREE OR SHRUB
- ⊛ = EVERGREEN TREE OR SHRUB

LINE	DIRECTION	DISTANCE
L1	N26°31'42"E	5.84'
L2	S41°50'44"W	14.44'

AREA TABULATION
7,586 SQ.FT. OR 0.174 ACRES±

NOTES

- THIS EASEMENT IS BASED ON A FIELD RUN AND MONUMENTED BOUNDARY SURVEY BY THE HOWARD COUNTY SURVEY DIVISION ON OR ABOUT SEPT. 1, 1995.
- EASEMENT IS BASED ON THE EXISTING STORM DRAIN AS LOCATED FROM WITHIN THE PIPE.
- AREA OF EASEMENT HATCHED AS SHOWN.



JEFFERSON D. HOBBS
PROPERTY LINE SURVEYOR
NO. 362 DATE:

PLAT NO. D-1114-1
CAP. PROJ. NO. D-1114
SCALE: 1"= 30'
DATE: SEPT. 25, 1995
COMPUTED BY: AMB
DRAWN BY: CAD
CHECKED BY: JDH
FILE: C:\ACADR13\WIN\ATHOLT2.DWG



E 1348700
N 553000

E 1349000
N 553000

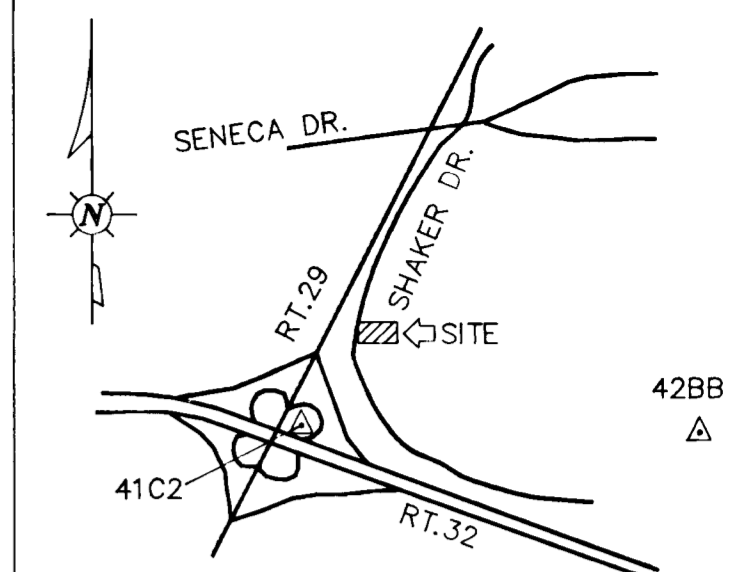
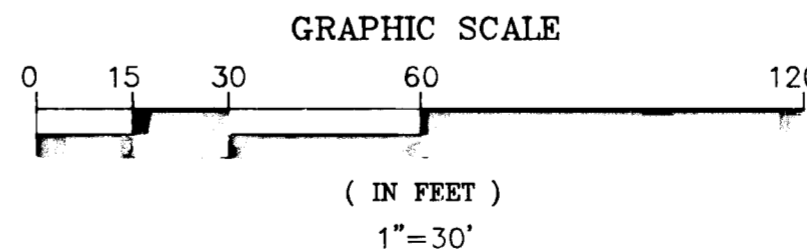
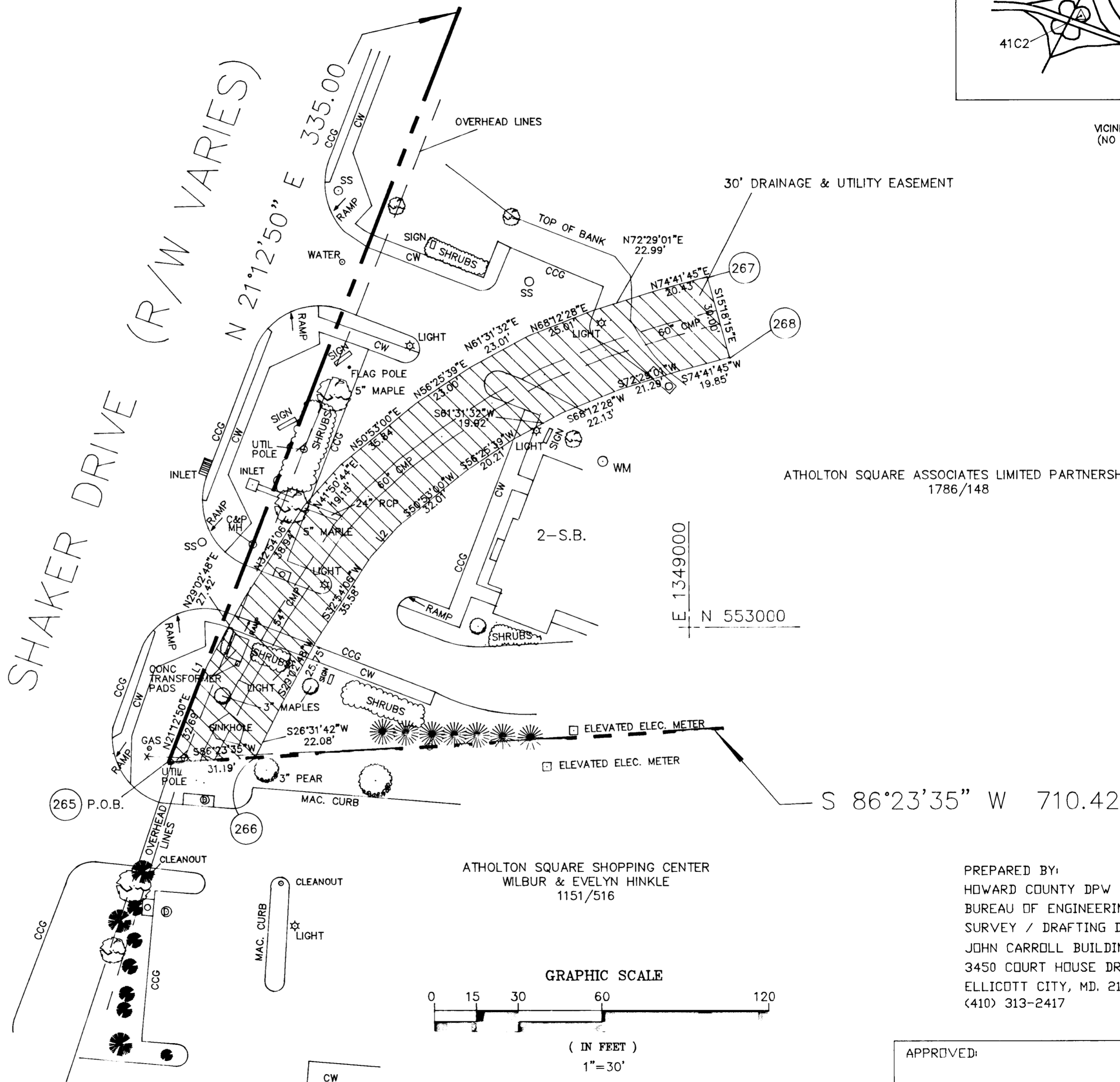

VICINITY MAP
(NO SCALE)

PLAT OF A DRAINAGE AND UTILITY EASEMENT
ATHOLTON SQUARE ASSOCIATES LIMITED PARTNERSHIP
TO
HOWARD COUNTY, MARYLAND

TAX MAP 36 PARCELS 63,189, & 287 LIBER 1786 FOLIO 148 SIXTH ELECTION DISTRICT

APPROVED:	
BUREAU OF ENGINEERING	DATE
REAL ESTATE SERVICES DIVISION	DATE

PREPARED BY:
HOWARD COUNTY DPW
BUREAU OF ENGINEERING
SURVEY / DRAFTING DIVISION
JOHN CARROLL BUILDING
3450 COURT HOUSE DRIVE
ELLCOTT CITY, MD. 21043
(410) 313-2417