

MATCHLINE SEE SHEET 3 OF 4

TENTATIVELY APPROVED
 DEPT. OF PLANNING AND ZONING OF
 HOWARD COUNTY
John R. Rupp
 PLANNING DIRECTOR JA 11/9/11
 DATE

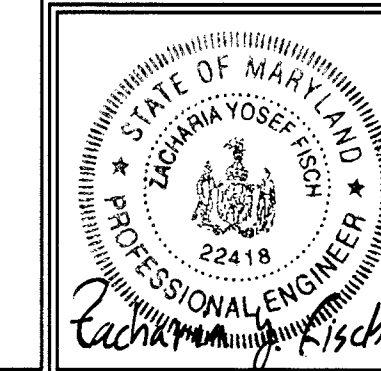

FSH Associates
 Engineers Planners Surveyors
 8318 Forrest Street, Ellicott City, MD 21043
 Tel: 410-750-2251 Fax: 410-750-7350
 E-mail: FSHAssociates@cs.com

SKETCH PLAN
WATERFORD FARMS
 TAX MAP 13, 14, 20 & 21 BLOCK 24, 19, 12 & 7 PARCEL 312, 67 & 20
 4TH ELECTION DISTRICT HOWARD COUNTY, MARYLAND

OWNER/DEVELOPER
 WATERFORD FARM, LLC
 4003 JENNINGS CHAPEL ROAD
 BROOKVILLE, MARYLAND 20833

DESIGN BY: ZYF
 DRAWN BY: PS
 CHECKED BY: ZYF
 SCALE: 1"=100'
 DATE: September 5, 2011
 W.O. No.: 3006
 SHEET No. 2 OF 4



DAISY ROAD
(MAJOR COLLECTOR)
(PUBLIC COUNTY ROAD)

WILLIAM BIANCO
L. 3656, F. 138

MARION R. COMPTON
L. 1317, F. 227

RESIDUE OF PARCEL 61
THE BYONG YOO SUBDIVISION
L. 1222, F. 49
0.50 AC ±

PARCEL 6B
L. 811, F. 193

EDWARD K. DUNN
L. 403, F. 787

ROBERT S. BATH
L. 454, F. 780

2 OF 4

SHEET

SEE

MATCHLINE

TENTATIVELY APPROVED
DEPT. OF PLANNING AND
ZONING OF
HOWARD COUNTY
James R. ...
PLANNING DIRECTOR DATE 11/9/01

OWNER/DEVELOPER
WATERFORD FARM, LLC
4003 JENNINGS CHAPEL ROAD
BROOKVILLE, MARYLAND 20833

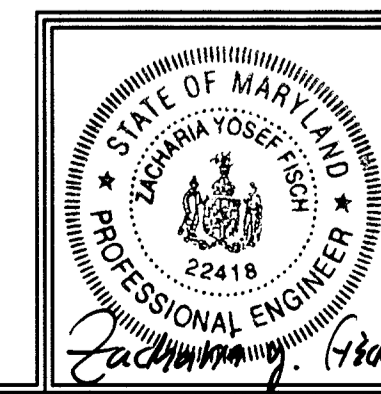

FSH Associates
Engineers Planners Surveyors
8316 Forrest Street, Ellicott City, MD 21043
Tel: 410-750-2251 Fax: 410-750-7350
E-mail: FSHAssociates@cs.com

SKETCH PLAN
WATERFORD FARMS

TAX MAP 13, 14, 20 & 21 BLOCK 24, 19, 12 & 7 PARCEL 312, 67 & 20
4TH ELECTION DISTRICT HOWARD COUNTY, MARYLAND

DESIGN BY: ZYF
DRAWN BY: PS
CHECKED BY: ZYF
SCALE: 1"=100'
DATE: September 5, 2001
W.O. No.: 3006
SHEET No. 3 OF 4

Maryland State Grid Meridian

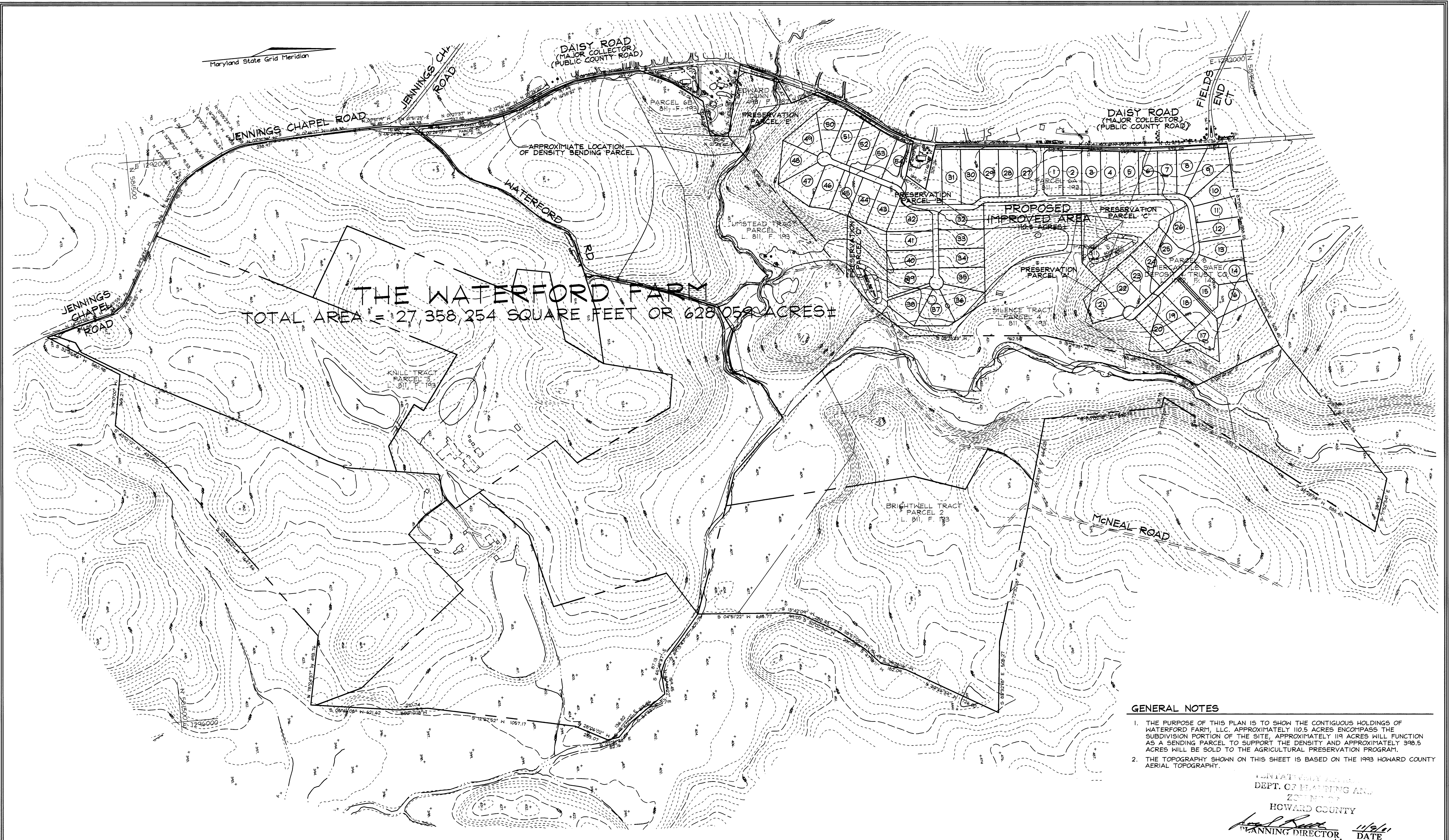

THE WATERFORD FARM
TOTAL AREA = 27,358,254 SQUARE FEET OR 628.053 ACRES ±

GENERAL NOTES

1. THE PURPOSE OF THIS PLAN IS TO SHOW THE CONTIGUOUS HOLDINGS OF WATERFORD FARM, LLC. APPROXIMATELY 110.5 ACRES ENCOMPASS THE SUBDIVISION PORTION OF THE SITE, APPROXIMATELY 119 ACRES WILL FUNCTION AS A SENDING PARCEL TO SUPPORT THE DENSITY AND APPROXIMATELY 390.5 ACRES WILL BE SOLD TO THE AGRICULTURAL PRESERVATION PROGRAM.
2. THE TOPOGRAPHY SHOWN ON THIS SHEET IS BASED ON THE 1993 HOWARD COUNTY AERIAL TOPOGRAPHY.

INITIALLY APPROVED
DEPT. OF PLANNING AND
ZONING OF
HOWARD COUNTY

James A. ...
PLANNING DIRECTOR *JA* DATE *11/9/10*

OWNER/DEVELOPER
WATERFORD FARM, LLC.
4003 JENNINGS CHAPEL ROAD
BROOKVILLE, MARYLAND 20833

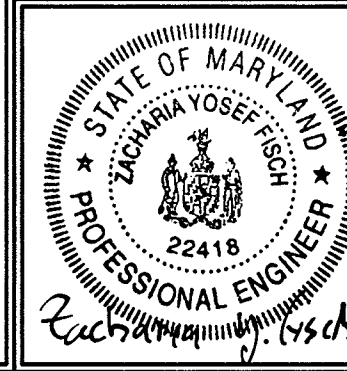

FSH Associates
Engineers Planners Surveyors
8318 Forest Street, Ellicott City, MD 21043
Tel: 410-750-2251 Fax: 410-750-7350
E-mail: FSHAssociates@cs.com

TOTAL CONTIGUOUS HOLDINGS
WATERFORD FARMS
TAX MAP 13, 14, 20 & 21 BLOCK 24, 19, 12 & 7 PARCEL 312, 67 & 20
4TH ELECTION DISTRICT HOWARD COUNTY, MARYLAND

DESIGN BY: ZYF
DRAWN BY: PS
CHECKED BY: ZYF
SCALE: 1"=300'
DATE: Sept. 08, 2001
W.O. No.: 3006
SHEET No. 4 OF 4