

GENERAL NOTES

- The Contractor is Not Responsible For Providing The Following:
A Island Enlargement B Lane Marking
- The Timing of The Signal System Shall Be Furnished By The Traffic Engineer
- The location of all underground utilities shown are approximate and the Contractor must verify the locations by calling Miss Utility at 559-0100.
- The underground conduit will be of sufficient size to accommodate future left turn phase detector and signal wiring. Pole foundations Nos 3 & 4 shall have additional conduit stubs to provide for future left turn detectors and signal wiring.

EQUIPMENT LIST

A CONTROLLER

- Fully Actuated Two (2) Phase Solid State Controller Expandable to three (3) Phase fully Actuated
- Memory & Recall For Each Phase
- Standard Police Panel with Manual - Override Option
- All Red Clearance Interval For Each Phase
- Conflict Monitor With Solid State Signal Loading Switches
- Six (6) Loop Detector Amplifiers (Loop 1&2, 3&4 wired in parallel)
- Minimum Acceptable Adjustment Range:
 - a) Major & Minor Street Initial Period and Unit Extension: 2-30 sec
 - b) Major & Minor Street Extension: 10-60 "
 - c) Vehicle Clearance Interval & All Red Clearance Interval: up to 10 "
- Base Mounted Control Cabinet Large Enough to Accommodate the Ultimate Four Phases. The cabinet shall be finished bronze.

B DETECTORS - Location in Accordance With Plan

Phase	Detector No (SEE PLAN)	Dimensions
A	1&4	6' x 6'
A	2&3	6' x 20'
B	5&6	6' x 20'
A	7&8	6' x 20'

C SIGNAL HEADS

No (SEE PLAN)	Size of Indications
1,2,3,4	12" Red, 12" Amber, 12" Green
5,6,7,8	12" Red, 8" Amber, 8" Green

Standard Visors (CAP) on All Indications

D. LANE USE SIGNS - SEE MUTCD*

- Quantity - 2
- Location in Accordance With Plan
- The Signs Shall Be Tethered

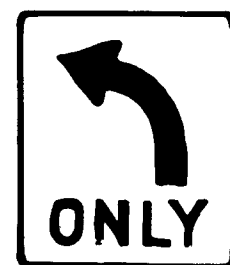

E GUARDRAIL - BEAM

- End #1 & 2 Are to Be Anchored in Accordance With State of Maryland - State Roads Commission Specifications Standard No 66031 Entitled Guardrail With Beam End Flare
- End #3 & 4 Are to Be Anchored in Accordance With Standard No 66002 of Same Specifications

* Manual on Uniform Traffic Control Devices

F POLES - MAST ARM

- Quantity - 4
- Location in accordance with Plan
- Finish Bronze with manufacturer's primer.
- Dimensions:
 - No 1 - 27 ft span
 - No 2 - 32 ft span
 - No 3 - 30 ft span
 - No 4 - 37 ft span
- All mast arms are to be oriented perpendicular to the travel lanes
- Design style and appearance equivalent to Union Metal Design 50300

S YMBOLS

- → Signal Head
- --- Vehicle - Loop Detector
- --- Hand Box (Junction Box)
- --- Meter Box
- --- Control Cabinet
- ⊙ --- Proposed Steel Pole

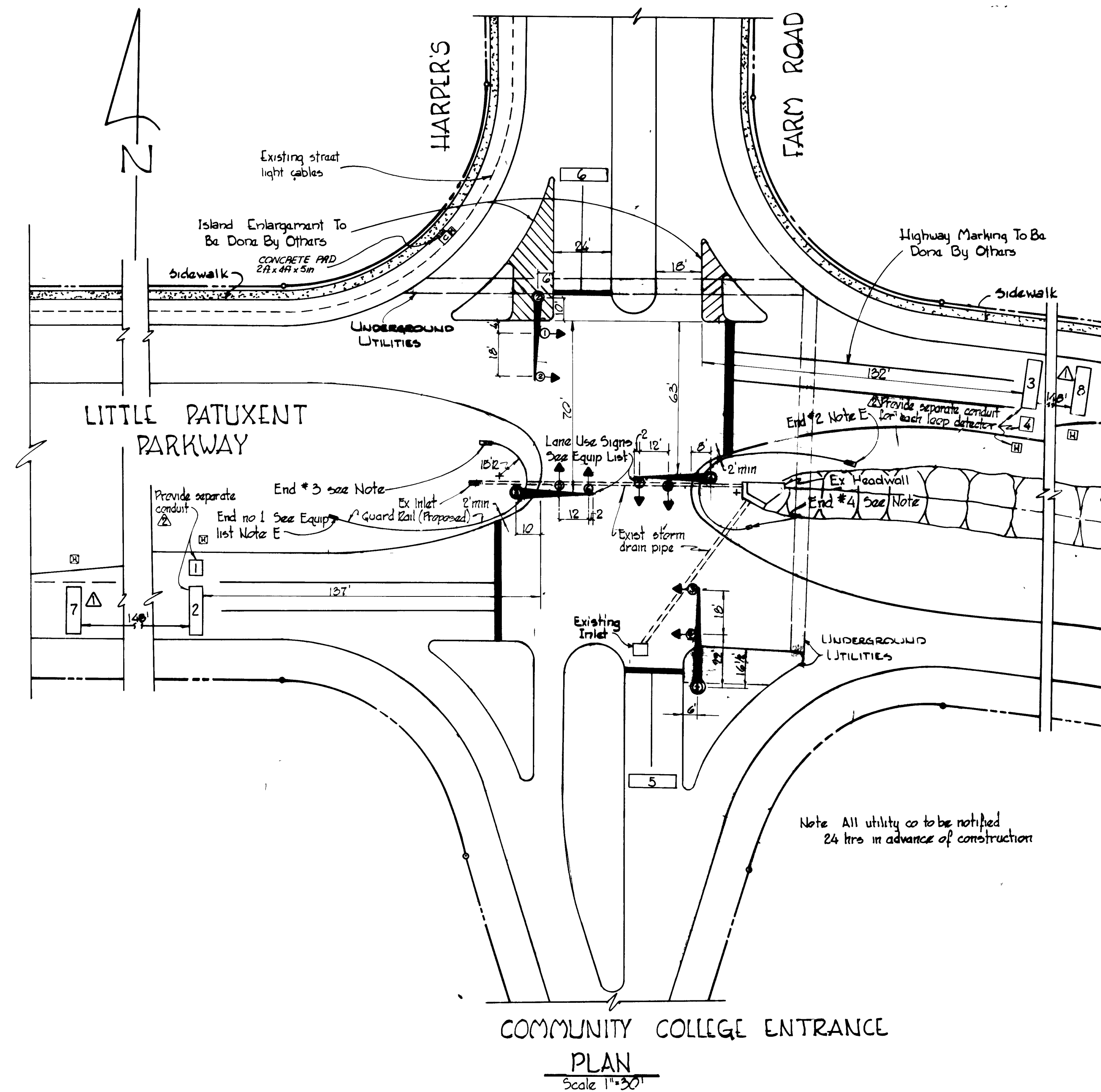

COMMUNITY COLLEGE ENTRANCE
PLAN
Scale 1"=30'

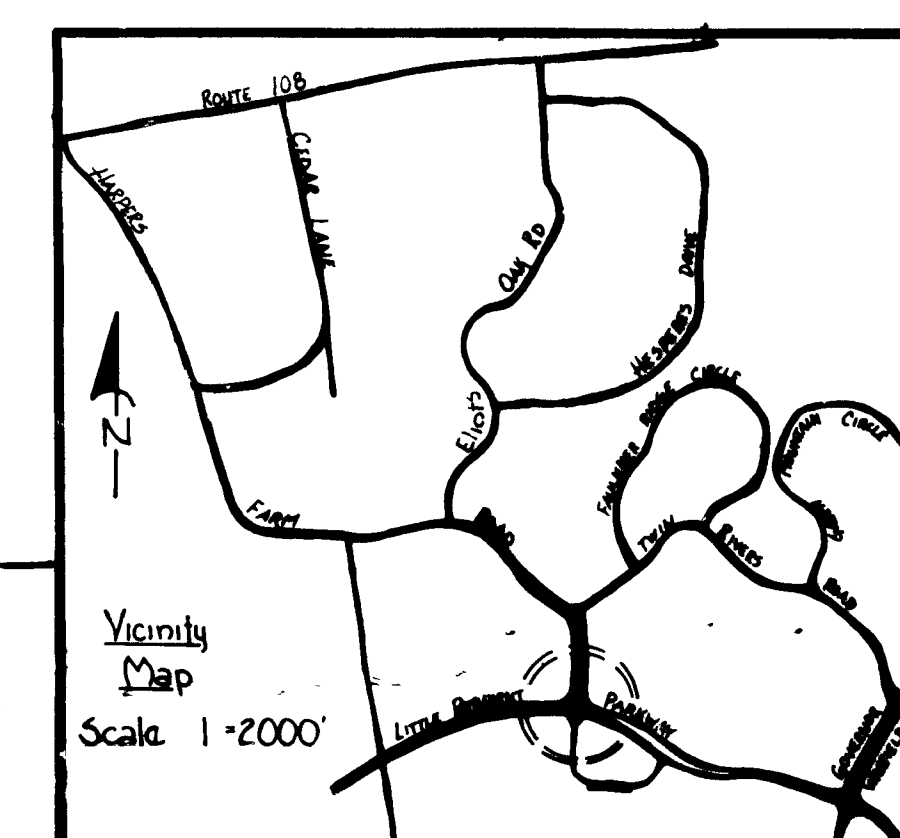

APPROVED: *Carl E. Smith* 10-20-77
DISTRICT ENGINEER - STATE HIGHWAY ADMIN
DATE

APPROVED: *Hynd-Dunn* 10/25/77
CHIEF ENGINEER - STATE HIGHWAY ADMIN
DATE

APPROVED: *Willie A. Atkins* 10/9/75
DIRECTOR OF PUBLIC WORKS

APPROVED: *J. H. McCreary* 9/19/75
CHIEF BUREAU OF HIGHWAYS

APPROVED: *W. O. Gilbert* 9-30-75
CHIEF BUREAU OF ENGINEERING

APPROVED: *James E. Kiebler* 9-9-75
CHIEF DIV. OF TRAFFIC ENG.

REV NO.	DESCRIPTION	DATE
1	Added S.H.A. signature blocks	Aug 17, 1977
2	Added Conduit Notes	June 6, 1977
3	Added Detectors 7 & 8	Nov 1, 1976

HOWARD COUNTY DEPARTMENT OF PUBLIC WORKS
BUREAU OF ENGINEERING
TRAFFIC SIGNAL CONSTRUCTION
PLAN AND EQUIPMENT LIST
CAPITAL IMPROVEMENT PROJECT No. TG-7002-1
LITTLE PATUXENT PARKWAY AT
HARPER'S FARM ROAD

Scale: As Shown
Date: Sept 1, 1975
Sheet 1 of 1
Dwg. No. T-75-12

Des: K. Porezo
Draw: H. Harper
Chkd: M. Wilhelm
Apprv: J. Riddle

STATE HIGHWAY ADMINISTRATION
CONTRACT NO. HO 523 451 717
FEDERAL AID
PROJECT NO. M 3142(1)