

PERMANENT SEEDING NOTES

APPLY TO GRADED OR CLEARED AREAS NOT SUBJECT TO IMMEDIATE FURTHER DISTURBANCE WHERE A PERMANENT LONG-LIVED VEGETATIVE COVER IS NEEDED.

SEEDBED PREPARATION: Loosen upper three inches of soil by raking, discing or other acceptable means before seeding, if not previously loosened.

SOIL AMENDMENTS: In lieu of soil test recommendations, use one of the following schedules:
 1) Preferred—Apply 2 tons per acre dolomitic limestone (92 lbs./1000 sq ft.) and 600 lbs per acre 10-10-10 fertilizer (14 lbs./1000 sq ft.) before seeding. Harrow or disc into upper three inches of soil. At the time of seeding, apply 400 lbs per acre 30-0-0 ureaform fertilizer (9 lbs./1000 sq ft.)
 2) Acceptable—Apply 2 tons per acre dolomitic limestone (92 lbs./1000 sq ft.) and 1000 lbs per acre 10-10-10 fertilizer (23 lbs./1000 sq ft.) before seeding. Harrow or disc into upper three inches of soil.

SEEDING: For the periods March 1 thru April 30, and August 1 thru October 15, seed with 60 lbs per acre (1.4 lbs./1000 sq ft.) of Kentucky 31 Tall Fescue. For the period May 1 thru July 31, seed with 80 lbs per acre Kentucky 31 Tall Fescue per acre and 2 lbs per acre (.05 lbs./1000 sq ft.) of weeping lovegrass. During the period of October 16 thru February 28, protect site by: Option (1) 2 tons per acre well anchored straw mulch and seed as soon as possible in the spring. Option (2) Use sod. Option (3) Seed with 60 lbs/acre Kentucky 31 Tall Fescue and mulch with 2 tons/acre well anchored straw.

MULCHING: Apply 1 1/2 to 2 tons per acre (70 to 90 lbs./1000 sq ft.) of unrotted small grain straw immediately after seeding. Anchor mulch immediately after application using mulch anchoring tool or 2 lbs per acre (5 gal./1000 sq ft.) of emulsified asphalt on flat areas. On slopes 8 feet or higher, use 348 gallons per acre (8 gal./1000 sq ft.) for anchoring.

MAINTENANCE: Inspect all seeded areas and make needed repairs, replacements and reseedings.

TEMPORARY SEEDING NOTES

SEEDBED PREPARATION: Loosen upper three inches of soil by raking, discing or other acceptable means before seeding, if not previously loosened.

SOIL AMENDMENTS: Apply 600 lbs per acre 10-10-10 fertilizer (14 lbs./1000 sq ft.)

SEEDING: For periods March 1 thru April 30 and from August 15 thru November 15, seed with 2 1/2 bushels per acre of annual ryegrass (3.2 lbs./1000 sq ft.). For the period May 1 thru August 14, seed with 3 lbs per acre of weeping lovegrass (.07 lbs./1000 sq ft.). For the period November 16 thru February 28, protect site by seeding 2 tons per acre of well anchored straw mulch and seed as soon as possible in the spring, or use sod.

MULCHING: Apply 1 1/2 to 2 tons per acre (70 to 90 lbs./1000 sq ft.) of unrotted small grain straw immediately after seeding. Anchor mulch immediately after application using mulch anchoring tool or 2 lbs per acre (5 gal./1000 sq ft.) of emulsified asphalt on flat areas. On slopes 8 feet or higher, use 348 gallons per acre (8 gal./1000 sq ft.) for anchoring.

REFER TO THE 1983 MARYLAND STANDARDS AND SPECIFICATIONS FOR SOIL EROSION AND SEDIMENT CONTROL FOR RATE AND METHODS NOT COVERED.

SEDIMENT AND EROSION CONTROL NOTES

- A minimum of 24 hours notice must be given to the Howard County Office of Inspection and Permits prior to the start of any construction. (992-2437).
- All vegetative and structural practices are to be installed according to the provisions of this plan and are to be in conformance with the 1983 MARYLAND STANDARDS AND SPECS. FOR SOIL EROSION AND SEDIMENT CONTROL.
- Following initial soil disturbance or redistribution, permanent or temporary stabilization shall be completed within 72 calendar days for all perimeter sediment control structures, dikes, perimeter slopes and all slopes greater than 3:1, b) 14 days as to all other disturbed or graded areas on the project site.
- All sediment traps/basins shown must be fenced and warning signs posted around their perimeters in accordance with Vol. 1, Chapter 12, of the HOWARD COUNTY DESIGN MANUAL, Storm Drainage.
- All disturbed areas must be stabilized within the time period specified above in accordance with the 1983 MARYLAND STANDARDS AND SPECIFICATIONS FOR SOIL EROSION AND SEDIMENT CONTROL for permanent seedings (Sec. 51) sod (Sec. 54), temporary seedings (Sec. 50) and mulching (Sec. 52). Temporary stabilization with mulch alone can only be done when recommended seeding dates do not allow for proper germination and establishment of grasses.
- All sediment control structures are to remain in place and are to be maintained in operative condition until permission for their removal has been obtained from the Howard County Sediment Control Inspector.
- SITE ANALYSIS**
 Total Area of Site: 0.387 Ac.
 Area Disturbed: 0.271 Ac.
 Area to be roofed or paved: 0.037 Ac.
 Area to be vegetatively stabilized: 0.234 Ac.
 Total Cut: 2.050 CU
 Total Fill: 0
 Offsite Waste/Borrow Area Location: _____
- Any sediment control practice which is disturbed by grading activity for placement of utilities must be repaired on the same day of disturbance.
- Additional sediment control must be provided, if deemed necessary by the Howard County DPM Sediment Control Inspector.
- On all sites with disturbed areas in excess of 2 acres, approval of the inspection agency shall be requested upon completion of installation of perimeter erosion and sediment controls, but before proceeding with any other earth disturbance or grading. Other building or grading inspection approvals may not be authorized until this initial approval by the inspection agency is made.
- If houses are to be constructed on an "as sold" basis, at random, Single Family Sediment Control, as shown below shall be implemented.
- All pipes to be blocked at the end of each day (see detail this sheet).
- The total amount of silt fence = 120 LF

It is the responsibility of the contractor to identify the spoil/borrow site and notify and gain approval from the sediment control inspector of the site and its grading permit number at the time of construction.

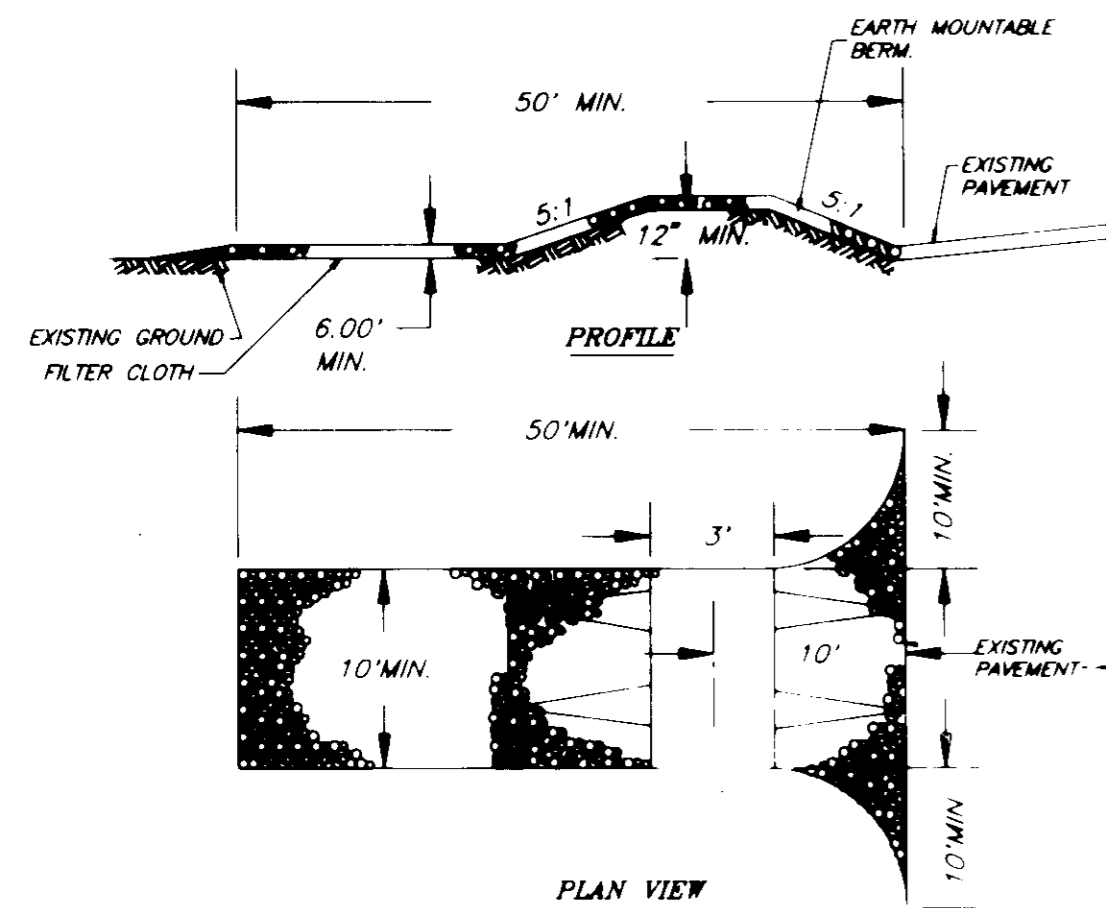

CONSTRUCTION SPECIFICATIONS

- STONE SIZE: USE 2" STONE OR RECYCLED CONCRETE EQUIVALENT
- LENGTH: AS REQUIRED, BUT NOT LESS THAN 30 FEET (EXCEPT ON A RESIDENCE LOT WHERE A 30 FOOT MINIMUM LENGTH WOULD APPLY.)
- THICKNESS: NOT LESS THAN SIX (6) INCHES
- WIDTH: TEN (10) FOOT MINIMUM, BUT NOT LESS THAN THE FULL WIDTH AT POINTS WHERE INGRESS OR EGRESS OCCURS.
- FILTER CLOTH WILL BE PLACED OVER THE ENTIRE AREA PRIOR TO PLACING OF STONE. FILTER CLOTH WILL NOT BE REQUIRED ON A SINGLE FAMILY RESIDENCE.
- SURFACE WATER: ALL SURFACE WATER FLOWING OR DIVERTED TOWARD CONSTRUCTION ENTRANCES SHALL BE PIPED ACROSS THE ENTRANCE IF PIPING IS IMPRACTICAL, A MOUNTABLE BERM WITH 5:1 SLOPES WILL BE PERMITTED.
- MAINTENANCE: THE ENTRANCE SHALL BE MAINTAINED IN A CONDITION WHICH WILL PREVENT TRACKING OR FLOWING OF SEDIMENT ONTO PUBLIC RIGHTS-OF-WAY. THIS MAY REQUIRE PERIODIC TOP DRESSING WITH ADDITIONAL STONE AS CONDITIONS DEMAND AND REPAIR AND/OR CLEANUP OF ANY MEASURES USED TO TRAP SEDIMENT. ALL SEDIMENT SPILLED, DROPPED, WASHED, OR TRACKED ONTO PUBLIC RIGHTS-OF-WAY MUST BE REMOVED IMMEDIATELY.
- WASHING: WHEELS SHALL BE CLEANED TO REMOVE SEDIMENT PRIOR TO ENTRANCE ONTO PUBLIC RIGHTS-OF-WAY. WHEN WASHING IS REQUIRED, IT SHALL BE DONE ON AN AREA STABILIZED WITH STONE AND WHICH DRAINS INTO AN APPROVED SEDIMENT TRAPPING DEVICE.
- PERIODIC INSPECTION AND NEEDED MAINTENANCE SHALL BE PROVIDED AFTER EACH RAINFALL.

STABILIZED CONSTRUCTION ENTRANCE (SCE)

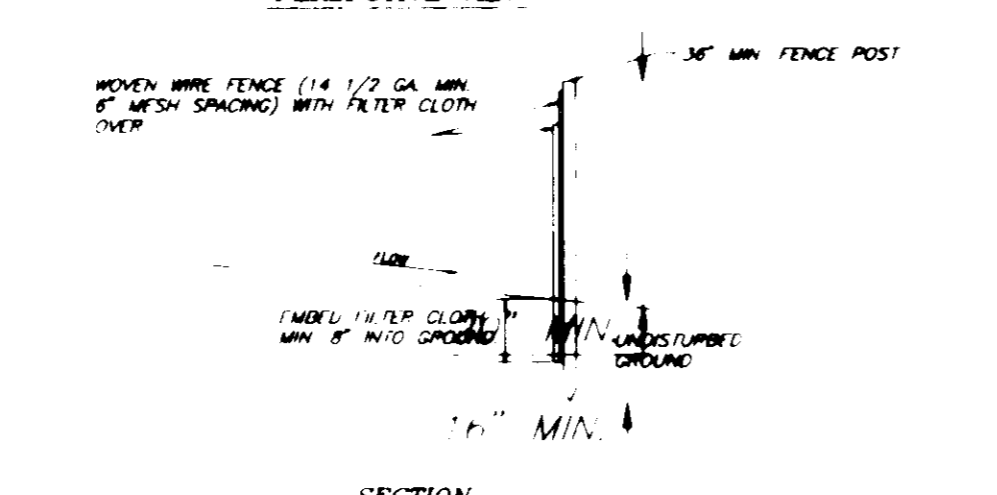
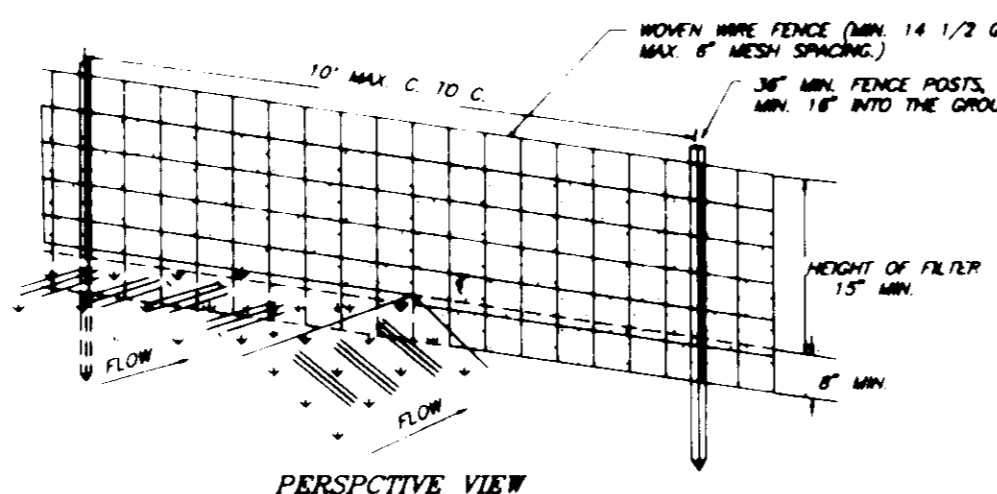

STANDARD SYMBOL FOR FABRICATED SILT FENCE

CONSTRUCTION NOTES FOR FABRICATED SILT FENCE

- WIRE MESH FENCE TO BE FASTENED SECURELY TO FENCE POSTS WITH WIRE TIES OR STAPLES.
- FILTER CLOTH TO BE FASTENED SECURELY TO WOVEN WIRE FENCE WITH TIES SPACED EVERY 24" AT TOP AND MID SECTION.
- WHEN TWO SECTIONS OF FILTER CLOTH ADJOIN EACH OTHER THEY SHALL BE OVER LAPPED BY SIX INCHES AND FOLDED.
- MAINTENANCE SHALL BE PERFORMED AS NEEDED AND MATERIAL REMOVED WHEN "BULGES" DEVELOP IN THE SILT FENCE.

POSTS: STEEL EITHER 1" OR 1 1/2" TYPE OR 2" HARDWOOD FENCE: WOVEN WIRE, 14 GA. 6" MAX MESH OPENING. FILTER CLOTH: FILTER # 1000, STABILIZED TRACK, OR APPROVED EQUAL PREFABRICATED UNIT. GEOTEX, ENVIROFENCE, OR APPROVED EQUAL.

SILT FENCE (S)

NO SCALE

CONSTRUCTION SEQUENCE

- Obtain grading permit and install sediment and erosion control devices and Blaz Orange Plastic Mesh Fence to be placed at edge line of existing trees to remain on lot.
- Excavate for foundations, rough grade and temporarily stabilize.
- Construct structures, sidewalks and driveways.
- Final grade and stabilize in accordance with Sids and Specs.
- Upon approval of the sediment control inspector, remove sediment and erosion control devices and stabilize.

BLAZE ORANGE PLASTIC MESH TYPICAL TREE PROTECTION FENCE DETAIL

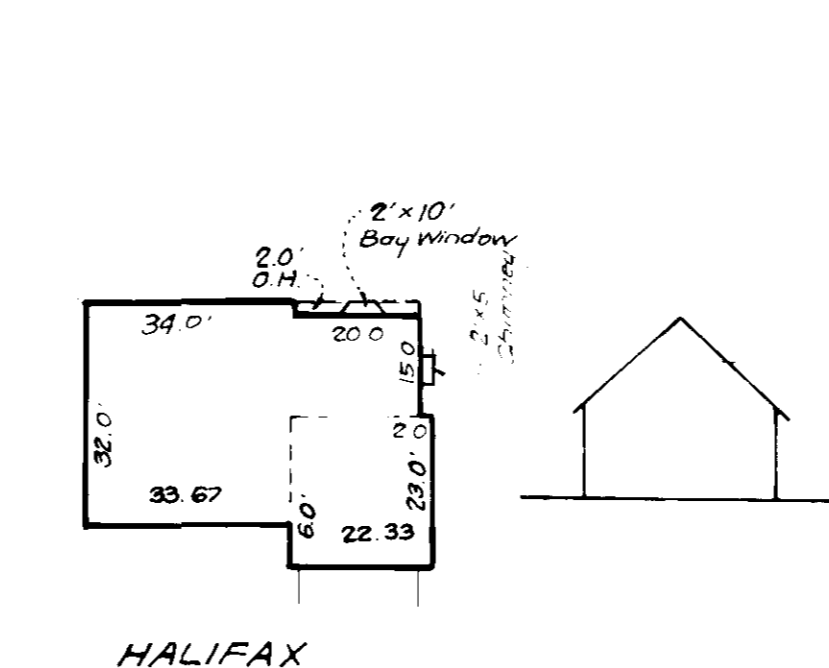

LEGEND

- CONTOUR INTERVAL
- EXISTING CONTOUR
- PROPOSED CONTOUR
- DIRECTION OF DRAINAGE
- WALK OUT BASEMENT
- EXISTING SEWER MAIN
- EXISTING WATER MAIN
- EXISTING STORM DRAIN
- EXISTING TREES TO REMAIN
- Silt Fence
- Stabilized Construction Entrance w/ Mountable Berm

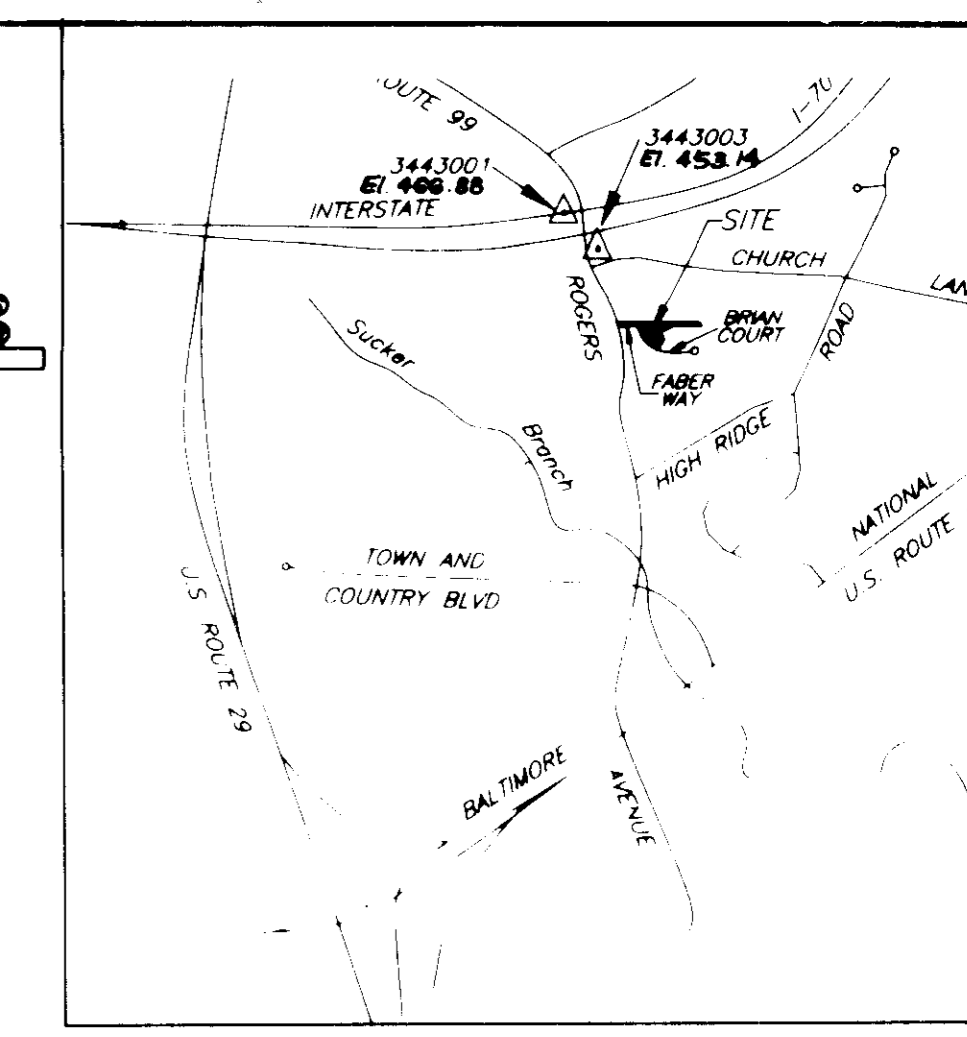

VICINITY MAP
SCALE: 1" = 200'

GENERAL NOTES:

- The contractor shall notify the Department of Public Works/Division of Construction Inspection at 410 (313-1800) at least five (5) working days prior to the start of work.
- The contractor shall notify "Miss Utility" at 1-800-257-7777 at least 48 hours prior to any excavation work.
- The existing topography shown was field run by Clark, Fintrack and Sackett, Inc. on 9/29/88. The contour interval is 2 feet.
- Coordinates based on MD 27' Maryland Coordinate System as projected by Howard County, Maryland Geodetic Control Stations No. 3443001 and No. 3443003.
- Storm water management is provided per: F-90-109.
- Any damage to county owned rights-of-way shall be corrected at the developer's expense.
- Utilities shown as existing are taken from approved water and sewer plan Contract # 127312, approved road construction plans F-90-109, and actual field survey.
- Reference Plot No. 11167.
- All roadways are public and existing.
- Subject property is zoned: R 20 per 10/18/93 Comprehensive Zoning Plan.
- The total area included in this submission is: 16,000 SF.
- The total number of lots included in this submission are: 1.
- Improvement to property: Single family detached.
- No clearing, grading, or construction is permitted within the wetland or stream buffers, except as approved by the Dept. of Planning and Zoning.
- See County files: P-90-05, S-89-36, F-90-109, S.D.P. No. 44, F.D.C. 90, F.D.A. 91.
- For driveway entrance details refer to Ho Co Design Manual Volume III, 6th Edition, 11-6-93.
- Sewer House Connection elevation taken to Property Line.

SPECIAL NOTES:

This plan is for house siting and lot grading only. Improvements shown within the rights-of-way on this S.D.P. are not to be used for construction. For construction, see approved Road Construction Plans F-90-109 and/or approved Water and Sewer Plans Contract #C-127312.

SHEET INDEX:

SHEETS 1 SITE DEVELOPMENT AND SEDIMENT AND EROSION CONTROL PLAN

ADDRESS CHART	
LOT NUMBER	STREET ADDRESS
20	2803 BRIAN CT

PLANNED NAME	SECTION/AREA	LOVE/PARCELS
ROCKLAND SQUARE		
PLAT NO. 11167	BLOCK NO. 18 & 13	ZONE R-12
	REV. MAP NO. 17 & 18	ELEVATION SURV. 2ND
		GEN. DIST. 002G
UNVER CODE 402		SEWER CODE 1454200

APPROVED: HOWARD COUNTY DEPT OF PLANNING & ZONING
 DIRECTOR: [Signature] DATE: 6/27/94
 CHIEF DIVISION OF COMMUNITY PLANNING AND LAND DEVELOPMENT: [Signature] DATE: 6/21/94
 APPROVED: FOR PUBLIC WATER AND PUBLIC SEWERAGE, STORM DRAINAGE SYSTEMS AND PUBLIC ROADS
 HOWARD COUNTY DEPARTMENT OF PUBLIC WORKS
 DIRECTOR: [Signature] DATE: 6/23/94
 [Signature] DATE: 6/23/94

Reviewed for HOWARD S.C.D. Name: [Signature] Date: [Signature]
 US Soil Conservation Service
 THIS DEVELOPMENT PLAN IS APPROVED FOR SOIL EROSION AND SEDIMENT CONTROL BY THE HOWARD SOIL CONSERVATION DISTRICT
 [Signature] Date: 6/18/94

DEVELOPER'S/BUILDER'S CERTIFICATE
 I/We certify that all development and construction will be done according to this plan of development and plan for sediment and erosion control and that all responsible personnel involved in the construction project will have a Certificate of Attendance of a Department of the Environment Approved Training Program for the Control of Sediment and Erosion before beginning the project, site buffers, periods, or-site inspection by the Howard Soil Conservation District or their authorized agents, as are deemed necessary.
 [Signature] Date: [Signature]

ENGINEER'S CERTIFICATE
 I hereby certify that this plan for Sediment and Erosion Control represents a practical and suitable plan based on my personal knowledge of the site conditions and that it was prepared in accordance with the requirements of the Howard Soil Conservation District.
 [Signature] Date: 4-28-94

CLARK • FINEFROCK & SACKETT, INC.
 ENGINEERS • PLANNERS • SURVEYORS
 1500 Minutal Hwy., Columbia, Md 21045 • (410) 381-7500 BALT. • (301) 621-8100 Wash.

DESIGNED: JME	SCALE: AS SHOWN
DRAWN: BAL	DRAWING: 1021
CHECKED: JME	JOB NO: 94-080
DATE: JUNE 13, 1994	FILI NO: 94-080X

FOR: DAVIES COMPANIES
 9051 Baltimore National Pike Suite 1C
 Ellicott City, Md 21043