

GENERAL NOTES

- Subject property is zoned: R-MH & R-SC per 10-18-93 Comprehensive Zoning Plan.
- The total area included in this submission is: 4.474 Ac.
Area in R-SC zone = 2.792 Ac.
Area in R-MH zone = 1.682 Ac.
- The total number of lots included in this submission are 27. Total buildable lots are 25.
- Improvement to property: Single family detached.
- Utilities shown as existing are taken from approved water and sewer plan Contract #14-3303-D and approved road construction plans F-93-37.
- Any damage to county/state owned right-of-way shall be corrected at the developer's expense.
- Storm water management for this SDP is provided in Willowood Section 3, Area 2 (F-93-37) by extended detention.
- The existing topography was taken from road construction plan (F-93-37) prepared by TSA Group, Inc.
- The coordinates shown hereon are based upon the Howard County Geodetic Control which is based upon Maryland Grid System NAD 27. Howard County Monument Nos.: 2444005 and 2444013.
- The contractor shall notify the Department of Public Works (Bureau of Engineering/Construction Division at (410)313-1880 24 hours prior to the start of work.
- The contractor shall notify "Miss Utility" at 1-800-257-7777 at least 48 hours prior to any excavation work.
- The contractor shall verify location of utilities and easements prior to construction.
- Waiver petition WP-91-76 was approved on January 18, 1991 pertaining to Sections 16.113(c) (10) of the Subdivision Regulations to allow cul-de-sac length to exceed 1200 feet.
- For driveway apron details see Howard County Details R-6.03 and R-6.05.
- All roadways are public and existing.
- No wetlands exist within the lots of this submission.
- For flag or pipe stem lots, refuse collection, snow removal and road maintenance are provided to the junction of the flag or pipe stem and road right of way line and not to the flag or pipe stem lots driveway.
- Maintenance Agreement for the Use-In-Common driveways for Lots 462-465, and Lots 469-471 were recorded on 1/31/94 in Liber 3145 at Folios 533, 535, respectively. For Lots 510-511, 514-517, and 520-521 were recorded on April 20, 1994 in Liber 3227 at Folios 045, 047 & 049 respectively.
- DRIVEWAYS SHALL BE PROVIDED PRIOR TO THE RESIDENTIAL OCCUPANCY TO INSURE SAFE ACCESS FOR FIRE AND EMERGENCY VEHICLES PER THE FOLLOWING MINIMUM REQUIREMENTS:
A.) WIDTH: 12' (16' SERVING MORE THAN ONE RESIDENCE.)
B.) SURFACE: 6" OF COMPACT CRUSHER RUN BASE W/TAR AND CHIP COATING.
C.) GEOMETRY: MAX. 15% DRIVEWAY GRADE, MAX. 10% GRADE CHANGE.
D.) WHERE COMMON DRIVEWAYS ARE PROPOSED, A HOUSE NUMBER SIGN SHALL BE PLACED AT EACH LOT ENTRANCE INDICATING THE RANGE OF STREET ADDRESS & HOUSE NUMBERS WHERE THE COMMON DRIVEWAY INTERSECTS WITH THE MAIN ROAD.

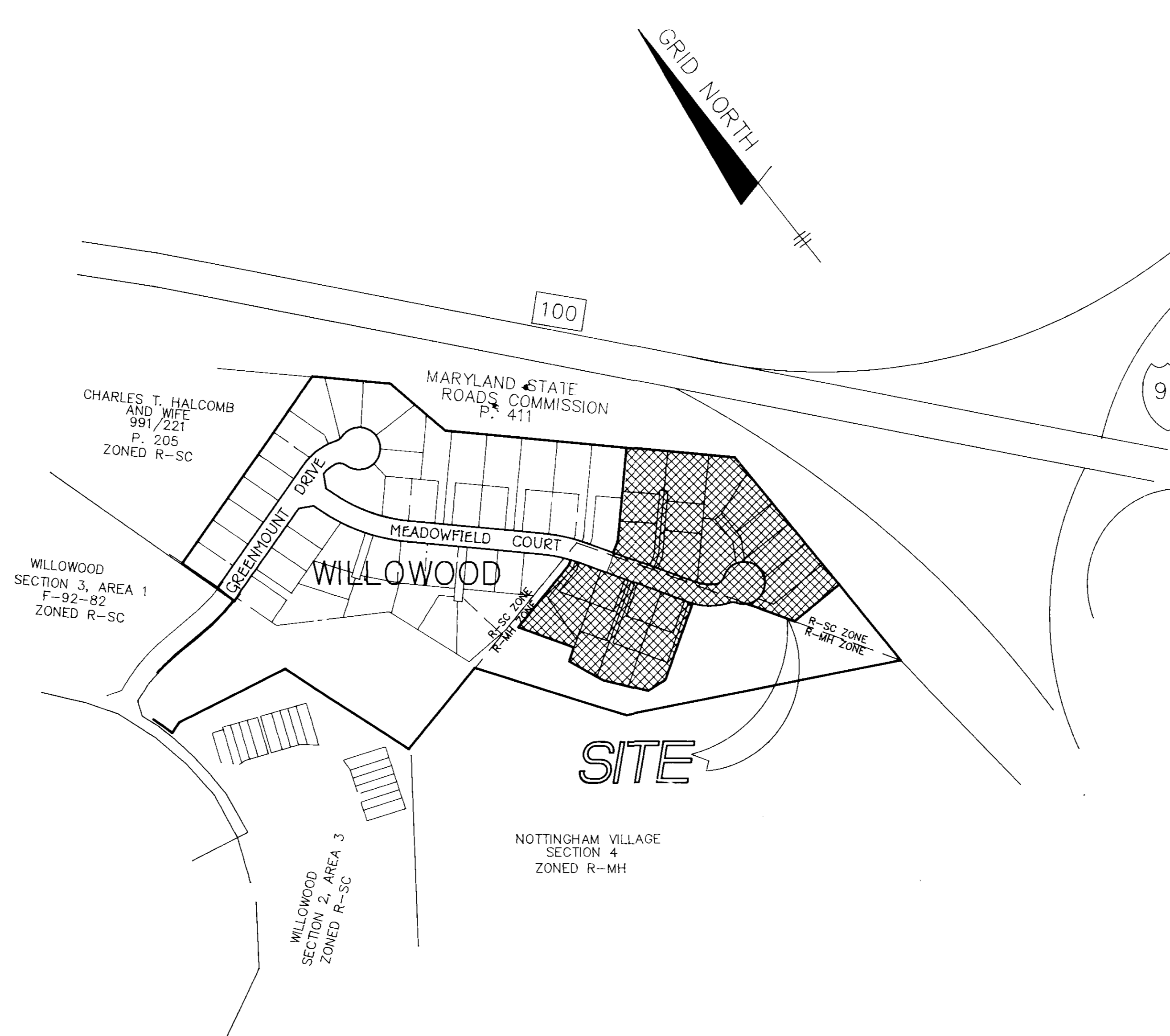

LOCATION MAP

SCALE: 1"=200'

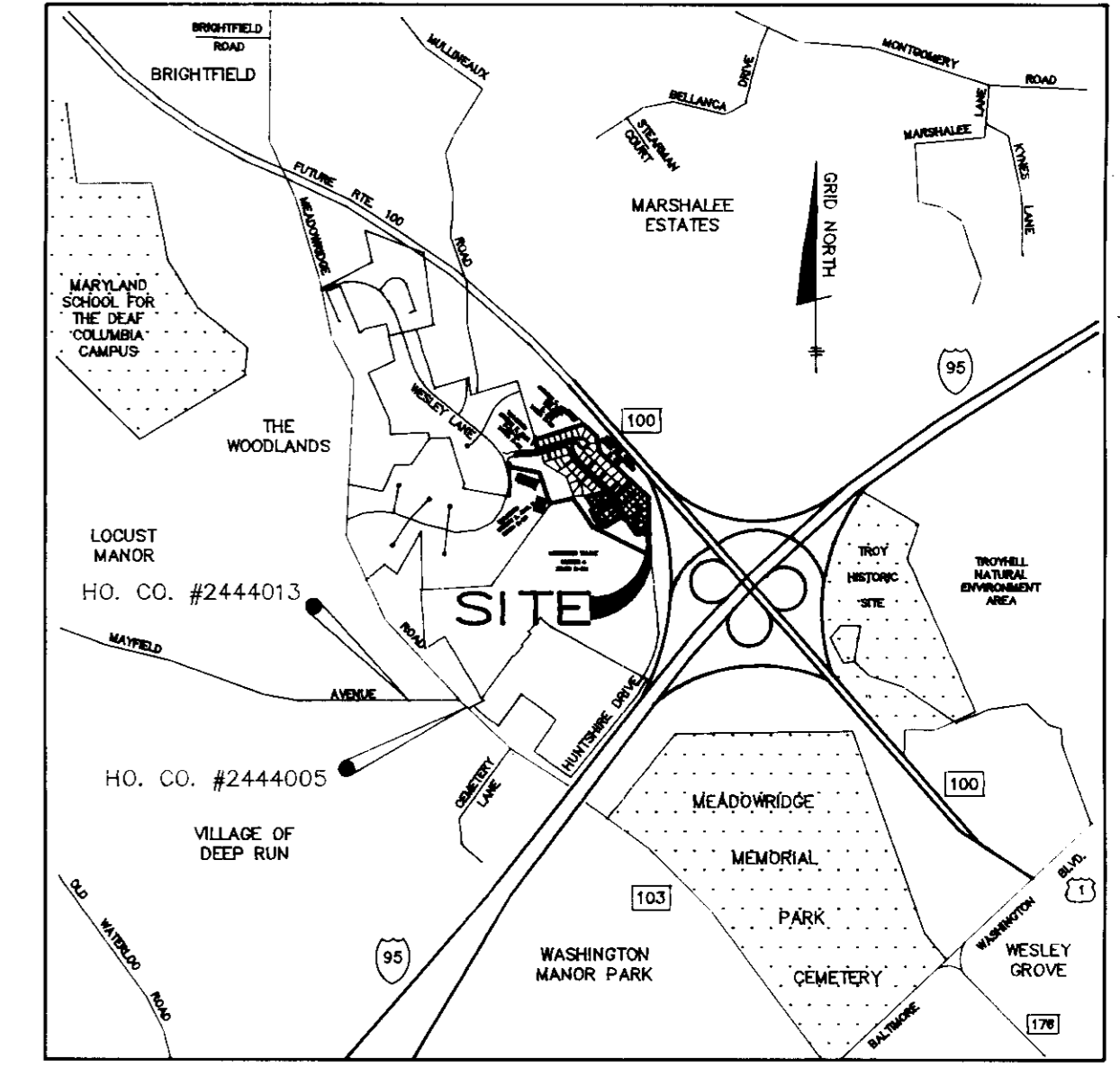

BENCH MARK DATA

HOWARD COUNTY MON. #2444005 ELEV.= 271.249
CONC. MONUMENT 0.5' BELOW SURFACE ON THE WEST SIDE OF MEADOWFIELD ROAD, SOUTH OF MAYFIELD ROAD.
N 48558.271 E 863126.170

HOWARD COUNTY MON. #2444013 ELEV.= 268.109
CONC. MONUMENT AT SURFACE, 17.1' NORTH OF CENTERLINE OF MAYFIELD AVE.
N 495646.964 E 862542.349

LOT NO	GROSS AREA	P/STEM AREA	REMAINING AREA	100 YR. FLOODPLAIN	25% SLOPE	MINIMUM LOT SIZE
474	10,599 S.F.	942 S.F.	9,657 S.F.	0	0	9,657 S.F.
510	7,294 S.F.	1,502 S.F.	5,792 S.F.	0	0	5,792 S.F.
511	5,700 S.F.	800 S.F.	4,900 S.F.	0	0	4,900 S.F.
514	5,400 S.F.	640 S.F.	4,760 S.F.	0	0	4,760 S.F.
515	7,820 S.F.	1,200 S.F.	6,620 S.F.	0	0	6,620 S.F.
516	7,264 S.F.	1,200 S.F.	6,064 S.F.	0	0	6,064 S.F.
517	5,260 S.F.	840 S.F.	4,420 S.F.	0	0	4,420 S.F.
520	6,438 S.F.	819 S.F.	5,619 S.F.	0	0	5,619 S.F.
521	8,613 S.F.	1,071 S.F.	7,542 S.F.	0	0	7,542 S.F.

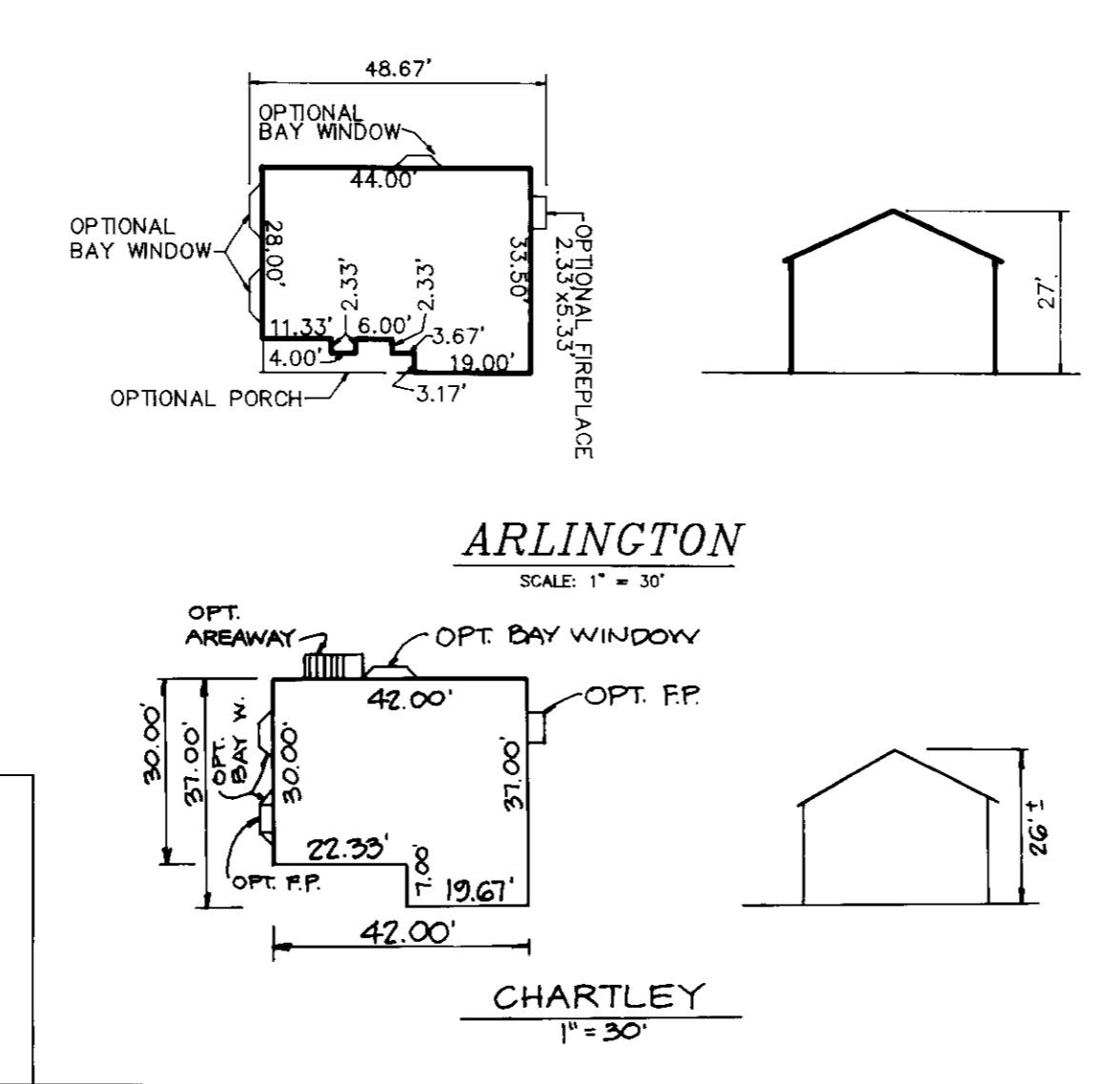
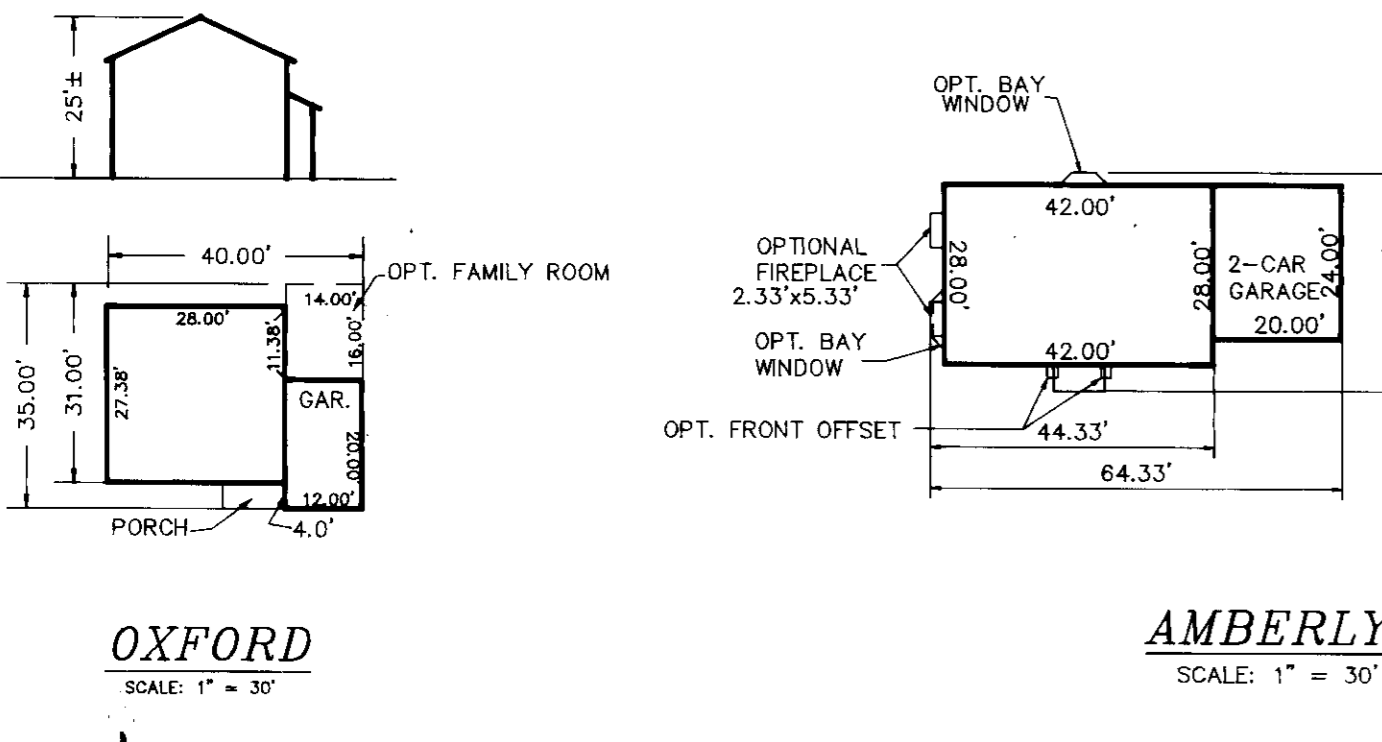
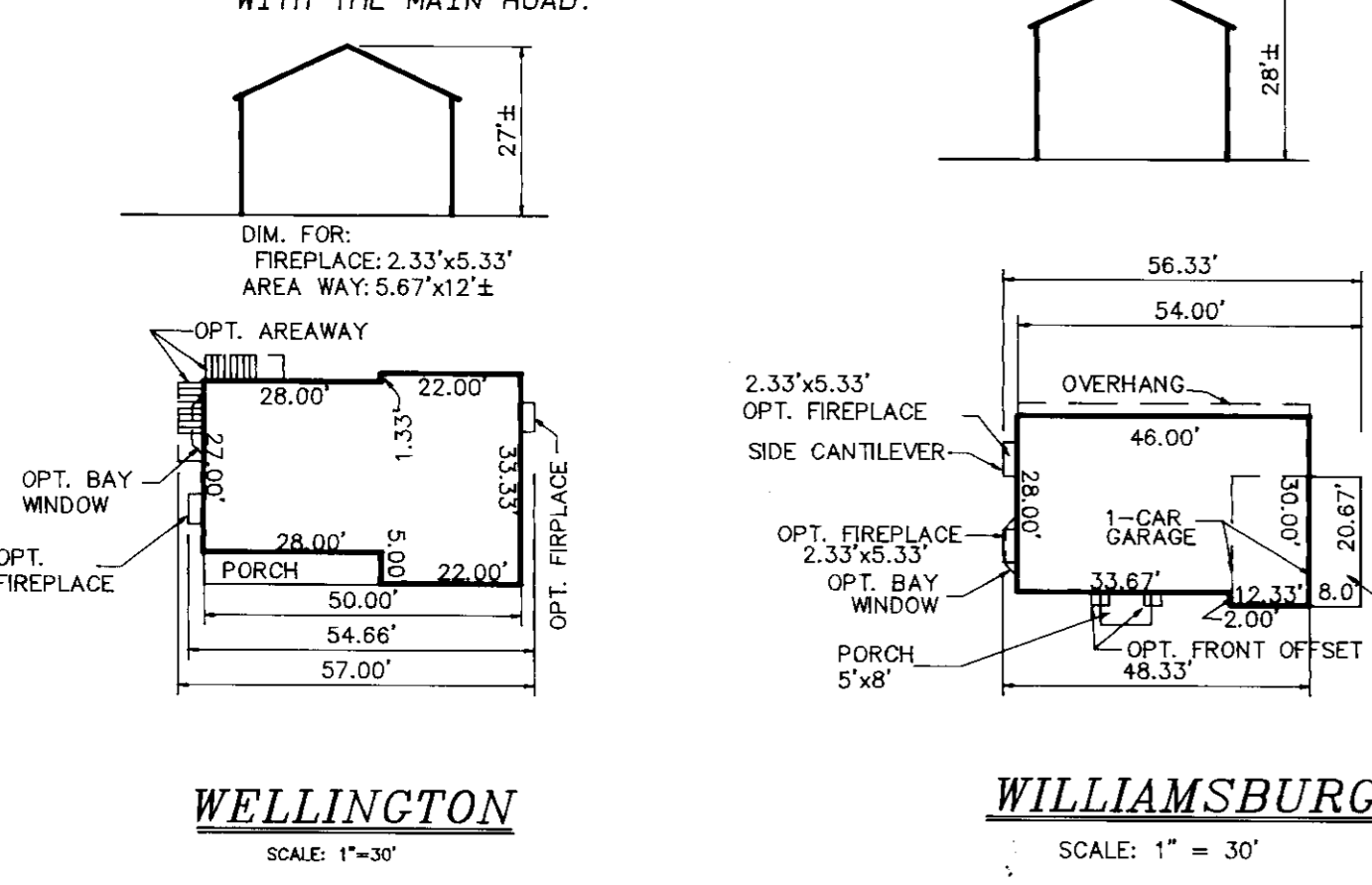

LOT NO.	SHC INVERT	MIN. CELLAR ELEVATION
460	256.1	258.7
462	256.1	259.4
463	256.5	260.2
464	256.3	259.8
465	255.8	259.1
466	251.1	254.8
467	245.9	250.4
469	248.2	252.7
470	247.3	251.3
471	247.0	251.2
472	247.3	251.4
473	247.3	251.3
474	246.7*	250.5
510	248.4	250.1
511	246.2	249.9
512	250.5	253.8
513	255.2	258.5
514	249.2	252.9
515	249.4	253.1
516	252.9	256.6
517	252.7	256.4
518	256.9	260.2
519	257.9	261.3
520	254.4	258.7
521	254.6	259.0

NOTES: * DENOTES 1.0% SLOPE FOR SHC
** DATA FROM W & S CONT. #14-3303-D

LOT NUMBER	STREET ADDRESS	LOT NUMBER	STREET ADDRESS
460	6557 MEADOWFIELD COURT	474	6605 MEADOWFIELD COURT
461	OPEN SPACE	510	6600 MEADOWFIELD COURT
462	6561 MEADOWFIELD COURT	511	6596 MEADOWFIELD COURT
463	6565 MEADOWFIELD COURT	512	6592 MEADOWFIELD COURT
464	6569 MEADOWFIELD COURT	513	6588 MEADOWFIELD COURT
465	6573 MEADOWFIELD COURT	514	6584 MEADOWFIELD COURT
466	6577 MEADOWFIELD COURT	515	6580 MEADOWFIELD COURT
467	6581 MEADOWFIELD COURT	516	6576 MEADOWFIELD COURT
468	OPEN SPACE	517	6572 MEADOWFIELD COURT
469	6585 MEADOWFIELD COURT	518	6568 MEADOWFIELD COURT
470	6589 MEADOWFIELD COURT	519	6564 MEADOWFIELD COURT
471	6593 MEADOWFIELD COURT	520	6560 MEADOWFIELD COURT
472	6597 MEADOWFIELD COURT	521	6556 MEADOWFIELD COURT
473	6601 MEADOWFIELD COURT		

NO	DATE	REV. PER COUNTY COMMENTS	REVISION
1	6/94	ADDED HOUSE TYPE	
0	4/94	SUBMISSION TO COUNTY FOR REVIEW AND APPROVAL	

TSA GROUP, INC.
planning • architecture • engineering
5400 Baltimore National Pike • Ellicott City, Maryland 21040 • (410) 480-0100

APPROVED: HOWARD COUNTY DEPARTMENT OF PLANNING & ZONING
DATE: 6/27/94

APPROVED: HOWARD COUNTY DEPARTMENT OF PUBLIC WORKS
FOR PUBLIC WATER & SEWERAGE, STORM DRAINAGE SYSTEMS AND ROADS
DATE: 6/16/94

SUBDIVISION NAME	SECT./AREA	PARCEL #	LIBER & FOLIO	PREVIOUS FILE:
WILLOWOOD	3/2	615, PART OF 136,411, AND 134	L.1427 F. 284	S-89-29P-91-08 F-92-82F-93-37 WP-91-76
PLAT No.	BLOCK No.	ZONE	TAX MAP	ELEC. DIST.
11156	16	R-SC & R-MH	37	6011.01
WATER CODE	SEWER CODE			
2153000	DO6			
SCALE: AS SHOWN	DATE: APRIL 1994			

OWNER/DEVELOPER:	PROJECT:
CORNERSTONE HOMES, INC. 6571 HUNTSIRE DRIVE ELKRIDGE, MARYLAND 21227 (410) 379-0157	WILLOWOOD SECTION 3, AREA 2 LOTS 460-474, & LOTS 510-521
	LOCATION: TAX MAP 37C-PARCEL 615, & PART OF PARCELS 136,411, & 134 1ST ELECTION DISTRICT HOWARD COUNTY, MARYLAND
	TITLE: SITE DEVELOPMENT PLAN
	DATE: APRIL 1994 PROJECT NO. 0686
DES: YSL DRN: YSL	SCALE: AS SHOWN DRAWING 1 OF 4

LEGEND

- CONTOUR INTERVAL 2 FEET
- EXISTING CONTOUR
- PROPOSED CONTOUR
- PROPOSED SPOT ELEVATION $\times 5/25$
- DIRECTION OF DRAINAGE
- EXISTING SEWER
- EXISTING WATER MAIN
- EXISTING STORM DRAIN
- PROPOSED TREE LINE
- EXISTING TREE LINE
- FLOODPLAIN ELEVATION
- WALKOUT BASEMENT
- PROPOSED DRIVEWAY
- INGRESS/EGRESS EASEMENT
- UTILITY EASEMENT

LOT AREA CHART			
LOT NUMBER	AREA	LOT NUMBER	AREA
460	8061 S.F.	513	4800 S.F.
461	3690 S.F.	514	5400 S.F.
462	6160 S.F.	515	7820 S.F.
463	9994 S.F.	516	7261 S.F.
464	11226 S.F.	517	5260 S.F.
465	6160 S.F.	518	4800 S.F.
466	9429 S.F.	519	5090 S.F.
467	10376 S.F.	520	6438 S.F.
468	2517 S.F.	521	8613 S.F.
469	10145 S.F.		
470	8127 S.F.		
471	7553 S.F.		
472	8046 S.F.		
473	9514 S.F.		
474	10599 S.F.		
510	7294 S.F.		
511	5700 S.F.		
512	4800 S.F.		

PERIMETER LANDSCAPE EDGE FOR LOTS 463 & 464

CATEGORY	ADJACENT TO ROADWAY
LANDSCAPE TYPE	B
LINEAR FEET OF ROADWAY FRONTAGE/PERIMETER	196'
CREDIT FOR EXISTING VEGETATION	58'
CREDIT FOR WALL, FENCE OR BERM	0
NUMBER OF PLANTS REQUIRED	
SHADE TREES	3(1:50)
EVERGREEN TREES	4(1:40)
SHRUBS	
NUMBER OF PLANTS PROVIDED	
SHADE TREES	3
EVERGREEN TREES	5
SHRUBS	0

PLANT LIST FOR LOTS 463 & 464

SYMBOL	QUANTITY	NAME	REMARKS
	3	PINUS STROBUS WHITE PINE	4'-6" HEIGHT B & B
	5	QUERCUS RUBRA RED OAK	2-1/2" MINIMUM CALIPER B & B

STREET PLANT LIST

SYMBOL	QUANTITY	NAME	REMARKS
	22	QUERCUS RUBRA RED OAK	2-1/2" MINIMUM CALIPER B & B
	22	PINUS STROBUS WHITE PINE	4'-6" HEIGHT B & B

* TO BE PLANTED BY BUILDER IN ACCORDANCE WITH F-93-37 AND THIS SDF. TREES ARE TO BE A MINIMUM OF 4' OFF SIDEWALK

4	8-6-94	LOT 517 WALK-THRU REV TO ADD AREAWAY
3	3-18-96	HOUSE TYPE REVISIONS - LOTS 465 & 475
2	12-8-95	HOUSE TYPE REVISION (LOT 460)
1	10/95	REV. GRADING & HSE ELEVS. LOTS 470 & 520
1	6/94	REV. PER COUNTY COMMENTS
0	4/94	SUBMISSION TO COUNTY FOR REVIEW AND APPROVAL
NO	DATE	REVISION

TSA GROUP, INC.
planning • architecture • engineering
8400 Baltimore National Pike • Ellicott City, Maryland 21048 • (410) 480-8108

John Smith

OWNER/DEVELOPER: CORNERSTONE HOMES, INC. 6571 HUNTSIDE DRIVE ELKBRIDGE, MARYLAND 21227 (410) 379-0157	PROJECT: WILLOWOOD SECTION 3, AREA 2 LOTS 460-474, & LOTS 510-521
LOCATION: TAX MAP 37C-PARCEL 615, & PART OF PARCELS 136,411, & 134 1st ELECTION DISTRICT HOWARD COUNTY, MARYLAND	TITLE: SITE DEVELOPMENT PLAN
DATE: APRIL 1994	PROJECT NO. 0686
SCALE: 1" = 30'	DRAWING 2 OF 4

PERMIT INFORMATION CHART					
SUBDIVISION NAME: WILLOWOOD					
SECTION 3, AREA 2					
LOTS 460-474, & LOTS 510-521					
SECT./AREA	PARCEL #	LIBER & FOLIO	PREVIOUS FILE:		
3/2	615, PART OF 136,411, AND 134	L1427 F. 284 L1827 F. 78	S-89-29,P-91-08 F-92-82,F-93-37 W-91-76,F-94-87		
PLAT No.	BLOCK No.	ZONE	TAX MAP	ELEC. DIST.	CENSUS
11156	16	R-SC & R-MH	37	1st	6011.01
WATER CODE: 2153000			SEWER CODE: D06		
SCALE: 1" = 30'			DATE: APRIL 1994		

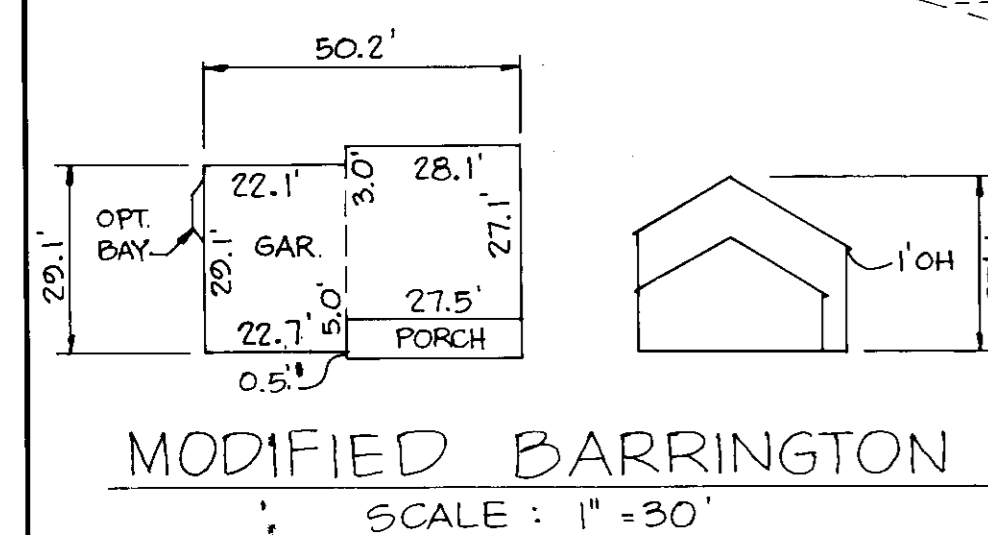

APPROVED: HOWARD COUNTY DEPARTMENT OF PLANNING & ZONING
James B. Smith 6/27/94
DIRECTOR DATE
Ann Williamson 6/24/94
CHIEF, DIVISION OF LAND DEVELOPMENT AND RESEARCH DATE

APPROVED: HOWARD COUNTY DEPARTMENT OF PUBLIC WORKS FOR PUBLIC WATER & SEWERAGE, STORM DRAINAGE SYSTEMS AND ROADS
John E. Smith 6/16/94
DIRECTOR DATE
Paul J. Spon 6/16/94
CHIEF, BUREAU OF ENGINEERS DATE

SCALE: 1" = 30'



LEGEND

- CONTOUR INTERVAL 2 FEET
- EXISTING CONTOUR 200
- PROPOSED CONTOUR 200
- EXISTING SEWER EX. 8" S
- EXISTING WATER MAIN EX. 8" W
- EXISTING STORM DRAIN EX. 18" SDP
- STABILIZED CONSTRUCTION ENTRANCE
- PROPOSED EARTH DIKE E.D. A-3
- EXISTING EARTH DIKE TO BE REMOVED
- EXISTING EARTH DIKE TO REMAIN
- SILT FENCE
- EXISTING SILT FENCE
- SUPER SILT FENCE
- LIMIT OF DISTURBED AREA
- EXISTING TREE LINE
- PROPOSED TREE LINE
- TREE PROTECTION FENCE

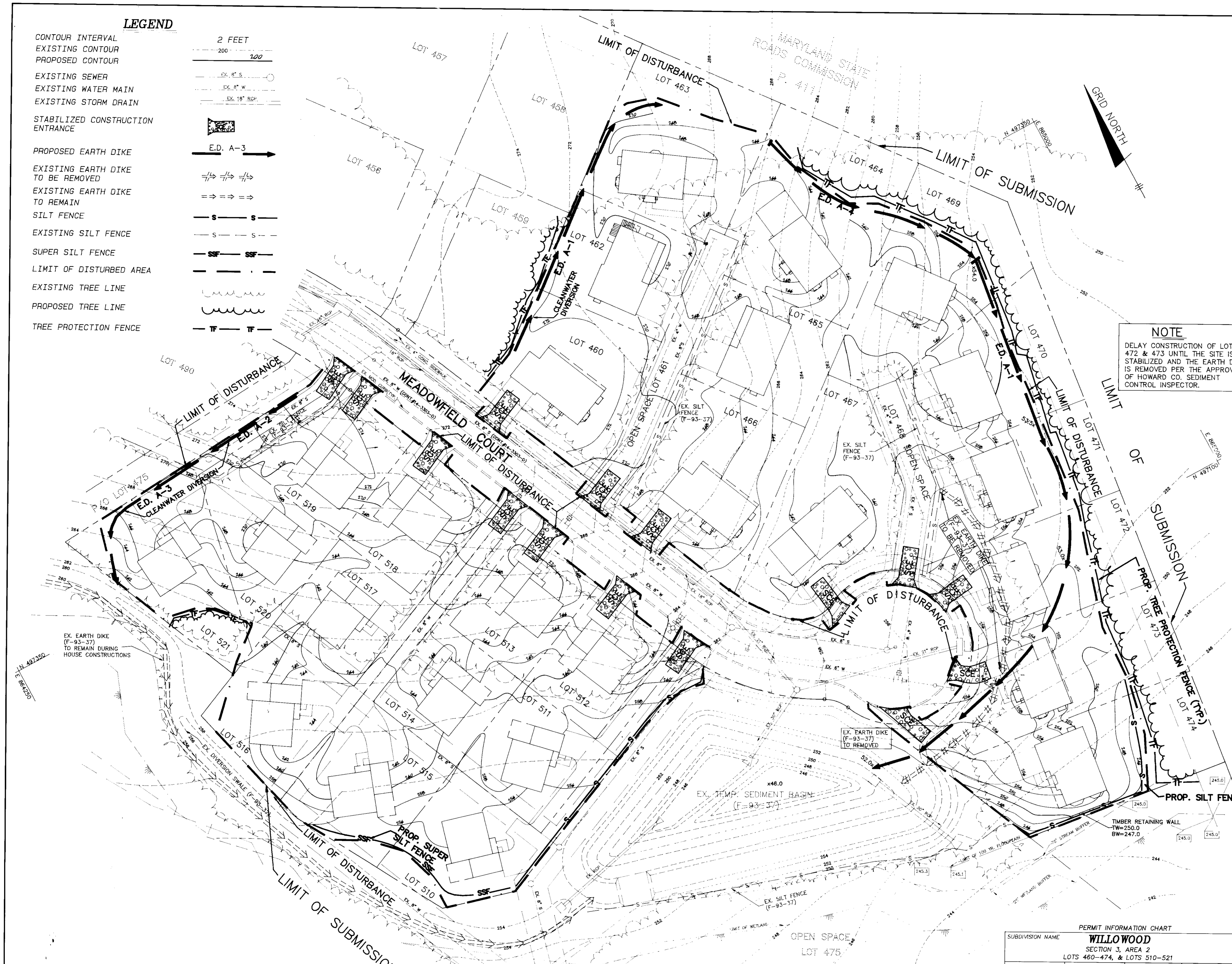

NOTE: THE CONTRACTOR IS RESPONSIBLE FOR CLEANING THE EXISTING TEMP. SEDIMENT BASIN OF ALL SEDIMENTS ATTRIBUTED TO THIS PLAN AND REFURBISHING IT TO ITS ORIGINALLY APPROVED DIMENSIONS PER F-93-37.

NOTE
 DELAY CONSTRUCTION OF LOTS 472 & 473 UNTIL THE SITE IS STABILIZED AND THE EARTH DIKE IS REMOVED PER THE APPROVAL OF HOWARD CO. SEDIMENT CONTROL INSPECTOR.

DEVELOPER'S CERTIFICATE
 I/We certify that all development and construction will be done in accordance with this plan of development and plan for erosion and sediment control and that all responsible personnel involved in the construction of this project will have a certificate of attendance at a Department of the Environment approved training program for the control of sediment and erosion before beginning the project. I also authorize periodic onsite inspection by the Howard County Soil Conservation District or their authorized agents, as are deemed necessary.
 Signature of Developer: *B. D. Boy* Date: 6/9/94

ENGINEER'S CERTIFICATE
 I hereby certify that this plan for erosion and sediment control represents a practical and workable plan based on my personal knowledge of the site conditions and that it was prepared in accordance with the requirements of the Howard County Soil Conservation District.
 Signature: *J. G. Gungor* #12841 Date: 6/9/94

APPROVED: THIS DEVELOPMENT IS APPROVED FOR EROSION AND SEDIMENT CONTROL BY THE HOWARD COUNTY SOIL CONSERVATION DISTRICT.
 Signature: *J. G. Gungor* Date: 4/4/94
 HOWARD SOIL CONSERVATION DISTRICT

APPROVED: REVIEWED FOR HOWARD COUNTY SOIL CONSERVATION DISTRICT AND MEETS TECHNICAL REQUIREMENTS.
 Signature: *S. W. W. W.* Date: 6/14/94
 HOWARD COUNTY SOIL CONSERVATION SERVICE

1	6/94	REV. PER COUNTY COMMENTS
0	4/94	SUBMISSION TO COUNTY FOR REVIEW AND APPROVAL
NO	DATE	REVISION

TSA GROUP, INC.
 planning • architecture • engineering
 6480 Baltimore National Pike • Millersville, Maryland 21104 • (410) 466-8106
 Signature: *J. G. Gungor*

APPROVED: HOWARD COUNTY DEPARTMENT OF PLANNING & ZONING
 Signature: *James S. Smith* Date: 6/27/94
 DIRECTOR
 Signature: *Anna J. Jaramany* Date: 6/24/94
 CHIEF, DIVISION OF LAND DEVELOPMENT AND RESEARCH

APPROVED: HOWARD COUNTY DEPARTMENT OF PUBLIC WORKS FOR PUBLIC WATER & SEWERAGE, STORM DRAINAGE SYSTEMS AND ROADS
 Signature: *James C. J.* Date: 6/16/94
 DIRECTOR
 Signature: *Paul J. J.* Date: 6/16/94
 CHIEF, BUREAU OF ENGINEERING

EX. SEDIMENT BASIN/ SWM POND
 D.A. = 14.29 AC.
 VOLUME = 0.59 AC.-FT.
 BOTTOM ELEV. = 248.0
 CLEANOUT ELEV. = 248.4
 TEMP. WEIR ELEV. = 250.80

PERMIT INFORMATION CHART

SUBDIVISION NAME: WILLOWOOD					
SECTION 3, AREA 2					
LOTS 460-474, & LOTS 510-521					
SECT./AREA	PARCEL #	LIBER & FOLIO	PREVIOUS FILE:		
3/2	615, PART OF 136,411, AND 134	L.1427 F. 284 L.1827 F.78	S-89-29-P-91-08 F-92-82-F-93-37 W-91-76-F-94-87		
PLAT No.	BLOCK No.	ZONE	TAX MAP	ELEC. DIST.	CENSUS
11156	16	R-SC & R-MH	37	1st	6011.01
WATER CODE: 2153000			SEWER CODE: 006		
SCALE: 1"=30'			DATE: APRIL 1994		

OWNER/DEVELOPER:	PROJECT:
CORNERSTONE HOMES, INC. 6571 HUNTSIRE DRIVE ELKRIDGE, MARYLAND 21227 (410) 379-0157	WILLOWOOD SECTION 3, AREA 2 LOTS 460-474, & LOTS 510-521
LOCATION:	TITLE:
TAX MAP 37C-PARCEL 615, & PART OF PARCELS 136,411, 134 1st ELECTION DISTRICT HOWARD COUNTY, MARYLAND	EROSION & SEDIMENT CONTROL PLAN
DATE: APRIL 1994	PROJECT NO. 0686
DES: CAM DRN: YSL	SCALE: 1"=30' DRAWING 3 OF 4

PERMANENT SEEDING NOTES

Apply to graded or cleared areas not subject to immediate further disturbance where a permanent long-lived vegetative cover is needed.

Seeding Preparation: Loosen upper three inches of soil by raking, dething or other acceptable means before seeding. (If not previously measured)

Soil Amendments: In lieu of soil test recommendations, use on the following substances:

- 1) Phosphate - Apply 2 tons per acre dolomitic limestone (92 lbs/1000 #) and 200 lbs per acre 10-10-10 fertilizer (14 lbs/1000 #) before seeding. Same or add into upper three inches of soil. At time of seeding, apply 400 lbs per acre 33-0-0 uniform fertilizer (9 lbs/1000 #).
- 2) Ammonia - Apply 2 tons per acre dolomitic limestone (92 lbs/1000 #) and 1000 lbs per acre 10-10-10 fertilizer (23 lbs/1000 #) before seeding. Same or add into upper three inches of soil.

Seeding: For the periods March 1 through April 30 and August 1 through October 31, seed with 80 lbs per acre (1.4 lbs/1000 #) of Kentucky 31 Tall Fescue. For the period May 1 through July 31, seed with 80 lbs Kentucky 31 Tall Fescue per acre and 2 lbs per acre (0.05 lbs/1000 #) of Weeping Lovegrass. During the period of October 16 through February 26, protect site by Option 1) 2 tons per acre of well-rotted straw mulch and seed as soon as possible in the spring. Option 2) use and, Option 3) seed with 80 lbs/acre Kentucky 31 Tall Fescue and mulch with 2 tons/acre well-rotted straw.

Mulching: Apply 1-1/2 to 2 tons per acre (70 to 90 lbs/1000 #) of unrotted small grain straw immediately after seeding. Anchor mulch immediately after application using mulch anchoring tool or 218 gallons per acre (5 gal/1000 #) of emulsified asphalt on flat areas. On slopes 8 feet or higher, use 348 gallons per acre (6 gal/1000 #) for anchoring.

Maintenance: Inspect all seeded areas and make needed repairs, replacements and reseedings.

TEMPORARY SEEDING NOTES

Apply to graded or cleared areas likely to be re disturbed where a short-term vegetative cover is needed.

Seeding Preparation: Loosen upper three inches of soil by raking, dething or other acceptable means before seeding. (If not previously measured)

Soil Amendments: Apply 400 lbs per acre 10-10-10 fertilizer (14 lbs/1000 #).

Seeding: For periods March 1 through April 30 and from August 15 through November 15, seed with 2-1/2 bushel per acre of annual ryegrass (3.2 lbs/1000 #). For the period May 1 through August 14, seed with 3 lbs per acre of Weeping Lovegrass (0.07 lbs/1000 #). For the period November 16 through February 26, protect site by applying 2 tons per acre of well-rotted straw mulch and seed as soon as possible in the spring, or use and.

Mulching: Apply 1-1/2 to 2 tons per acre (70 to 90 lbs/1000 #) of unrotted small grain straw immediately after seeding. Anchor mulch immediately after application using mulch anchoring tool or 218 gallons per acre (5 gal/1000 #) of emulsified asphalt on flat areas. On slopes 8 feet or higher, use 348 gallons per acre (6 gal/1000 #) for anchoring.

Refer to the 1983 Maryland Standards and Specifications for Soil Erosion and Sediment Control for rates and methods not covered.

SEDIMENT CONTROL NOTES

1. A minimum of 48 hours notice must be given to the Howard County Department of Inspection, Licensing and Permits, Sediment Control Division prior to the start of any construction (311-1855).

2. All vegetation and structural practices are to be installed according to the provisions of this plan and are to be in conformance with the most current Maryland Standards and Specifications for Soil Erosion and Sediment Control, and revisions thereto.

3. Knowingly inflicting disturbances or re disturbance, permanent or temporary stabilization shall be completed within 14 calendar days for all permanent sediment control structures, dikes, perimeter slopes and all slopes greater than 3:1, 14 calendar days or to all other disturbed or graded areas on the project site.

4. All sediment traps, basins and structures must be fenced and warning signs posted around their perimeter as accordance with Vol. 1, Chapter 12, of the Howard County Design Manual, Storm Drainage.

5. All disturbed areas must be stabilized within the time period specified above in accordance with the 1981 Maryland Standards and Specifications for Soil Erosion and Sediment Control for Permanent Seeding (Sec. 5), Soil (Sec. 54), Temporary Seeding (Sec. 56) and Mulching (Sec. 52). Temporary stabilization with mulch alone is not to be used when recommended seeding duties do not allow for proper germination and establishment of grasses.

6. All sediment control structures are to remain in place and are to be maintained in operative condition until permission for their removal has been obtained from the Howard County Sediment Control Inspector.

7. Site Analysis:

Total Area of Site: 4.47 acres
Area to be disturbed: 4.05 acres
Area to be protected or paved: 1.33 acres
Area to be vegetatively stabilized: 2.72 acres
Total Soil: 4800 cu yd
Total Fill: 8848 cu yd

8. Any sediment control practice which is disturbed by grading activity for placement of utilities must be repaired on the same day of disturbance.

9. Additional sediment controls must be provided, if deemed necessary by the Howard County Sediment Control Inspector.

10. On all sites with disturbed areas in excess of 2 acres, approval of the inspection agency shall be requested upon completion of installation of perimeter erosion and sediment controls, but before proceeding with any other earth disturbance or grading. Other grading or grading inspection approvals may not be authorized until this notice is approved by the inspection agency in writing.

11. Schedules for the construction of utilities is limited to three pipe lengths or that which can be back filled and stabilized within one working day, whichever is shorter.

12. Quantities and estimates shown are for sediment control purposes only. Contractor shall prepare his/her own quantity estimates to his/her satisfaction.

13. It is the responsibility of the contractor to identify the spot/borrow site and notify and gain approval from the sediment control inspector of the site and its grading permit number at the time of construction.

SEQUENCE OF CONSTRUCTION

Notify Sediment Control Division 48 hours prior to start of construction.

1. Obtain grading permit.
2. Install area protection fences as indicated on this plan.
3. Clear and grub the site as indicated in this plan.
4. Inspect existing sediment and erosion control devices and repair or re-install them if required. Continued using the existing Sediment Losses as designed under F-27-17.
5. Install new sediment and erosion control devices and stabilize.
6. Excavate for foundations, small grubs and temporary stabilizers. Protect lots 472 & 473 daily construction of these lots until the site is stabilized and the north side is removed with the approval of Howard County Sediment Control Inspector.
7. Construct structures and ditches.
8. Final grubs and stabilize in accordance with standards and specifications.
9. Upon approval of the Howard County sediment control inspector, remove sediment and erosion control devices and stabilize.

Date	Description
Day 1	Obtain grading permit.
Day 2-3	Install area protection fences as indicated on this plan.
Day 4-5	Clear and grub the site as indicated in this plan.
Day 6-7	Inspect existing sediment and erosion control devices and repair or re-install them if required. Continued using the existing Sediment Losses as designed under F-27-17.
Day 8-10	Install new sediment and erosion control devices and stabilize.
Day 10-17	Excavate for foundations, small grubs and temporary stabilizers. Protect lots 472 & 473 daily construction of these lots until the site is stabilized and the north side is removed with the approval of Howard County Sediment Control Inspector.
Day 17-21	Construct structures and ditches.
Day 22-25	Final grubs and stabilize in accordance with standards and specifications.
Day 26-30	Upon approval of the Howard County sediment control inspector, remove sediment and erosion control devices and stabilize.

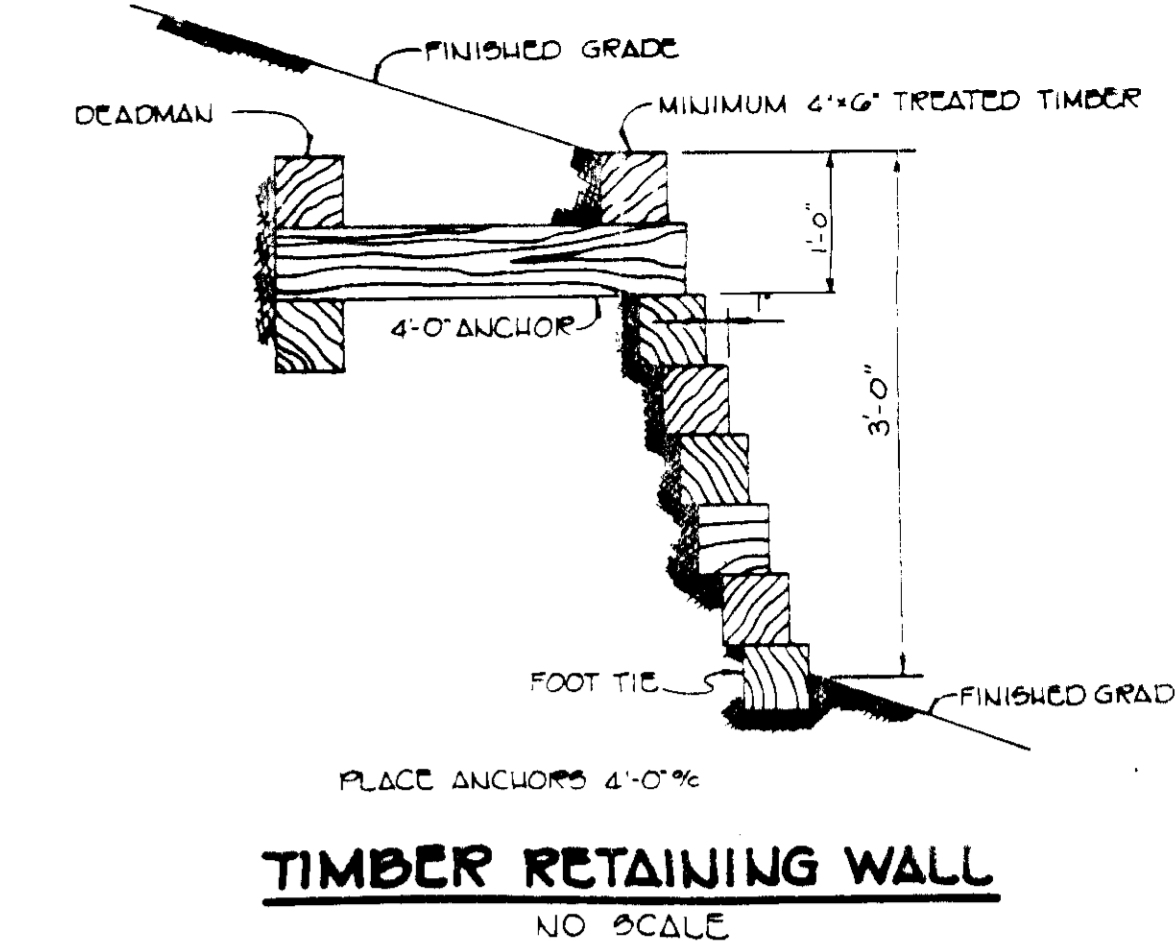
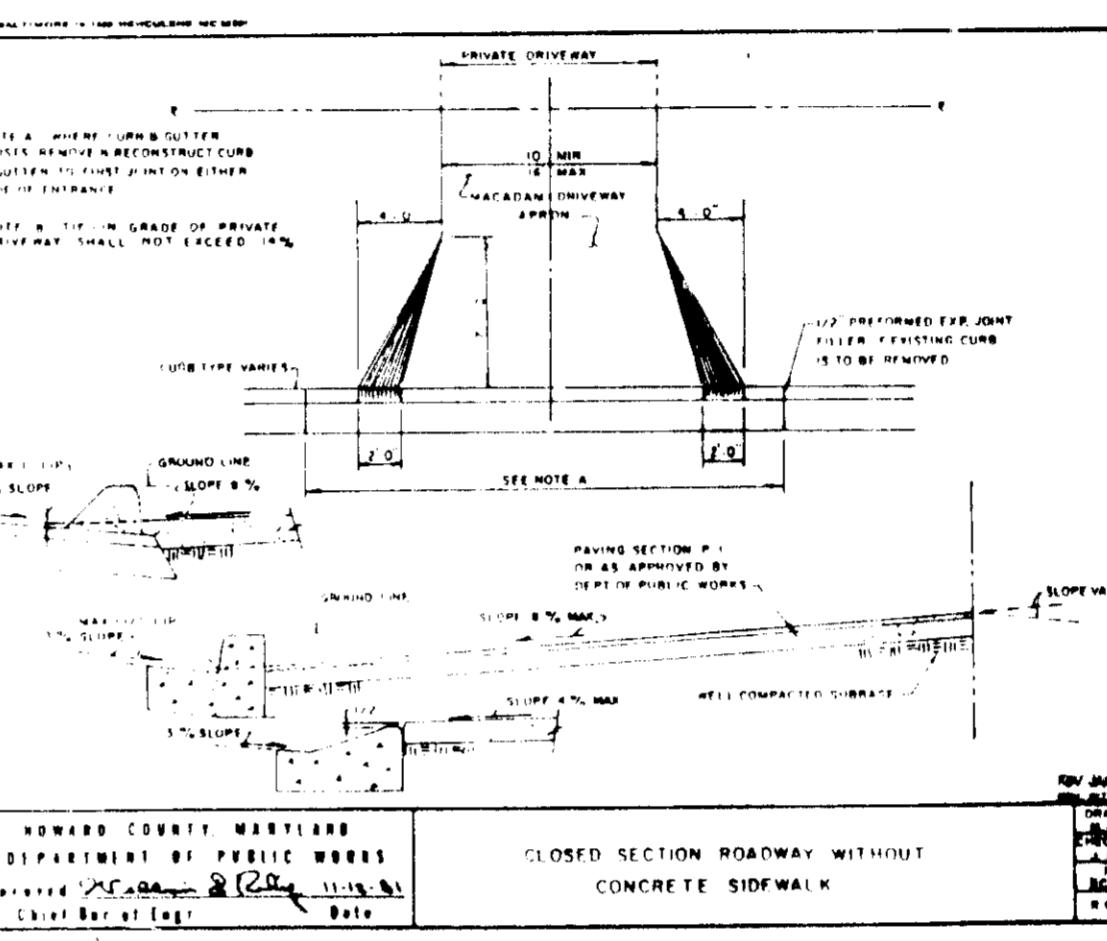
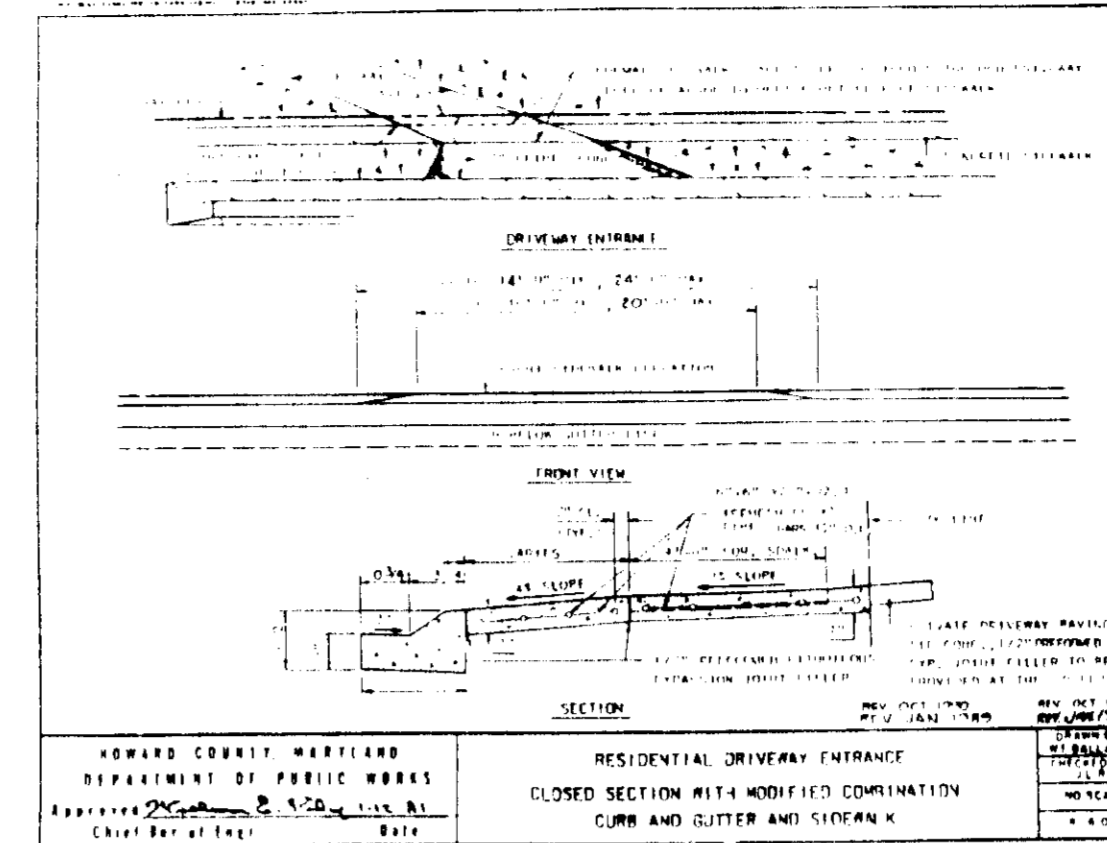
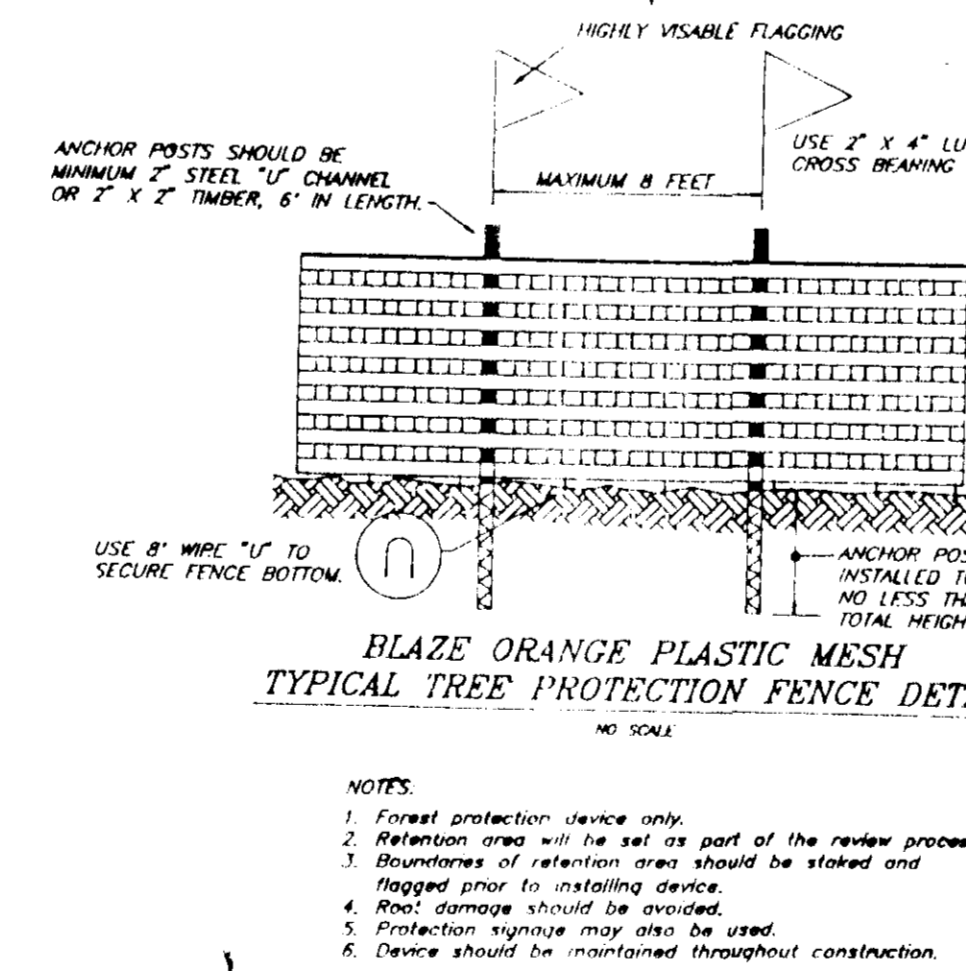
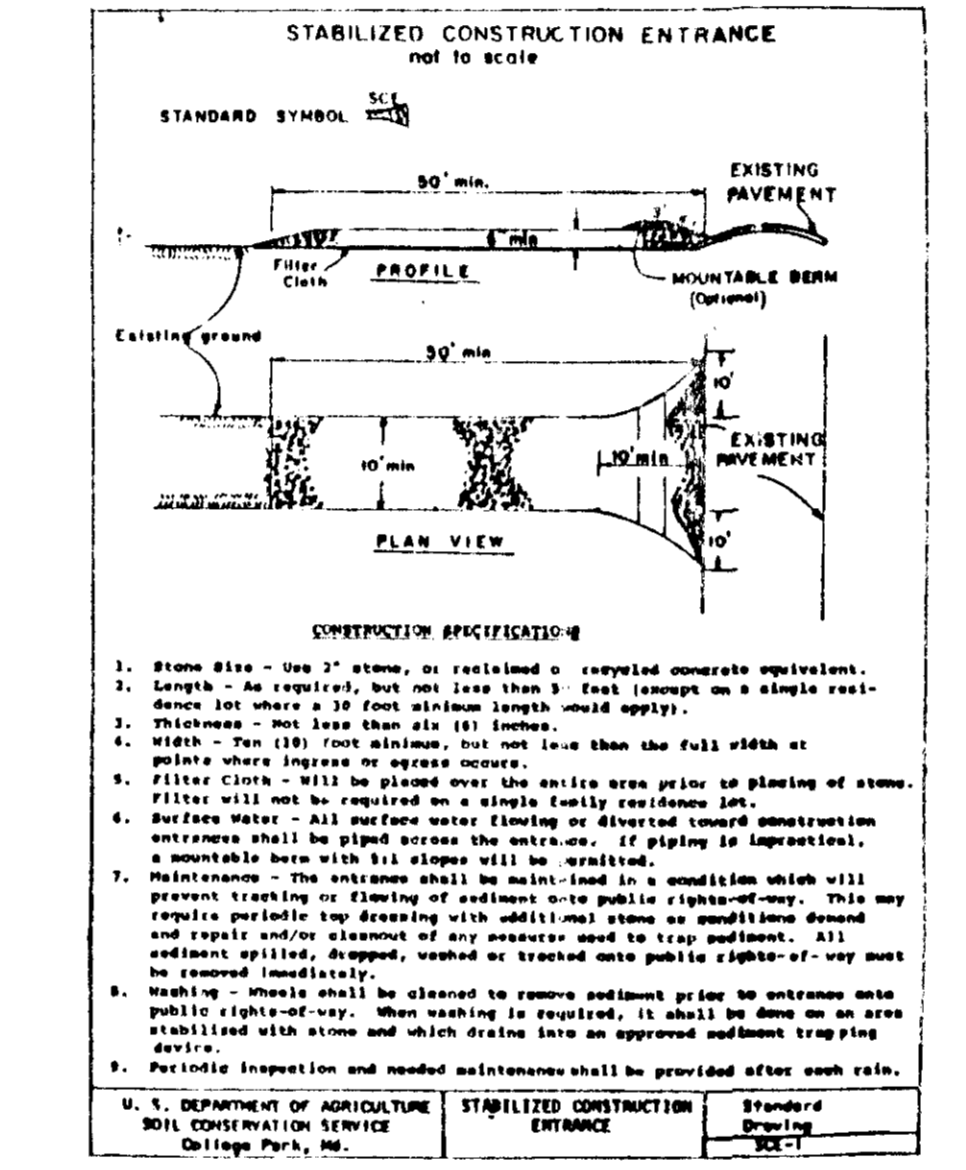
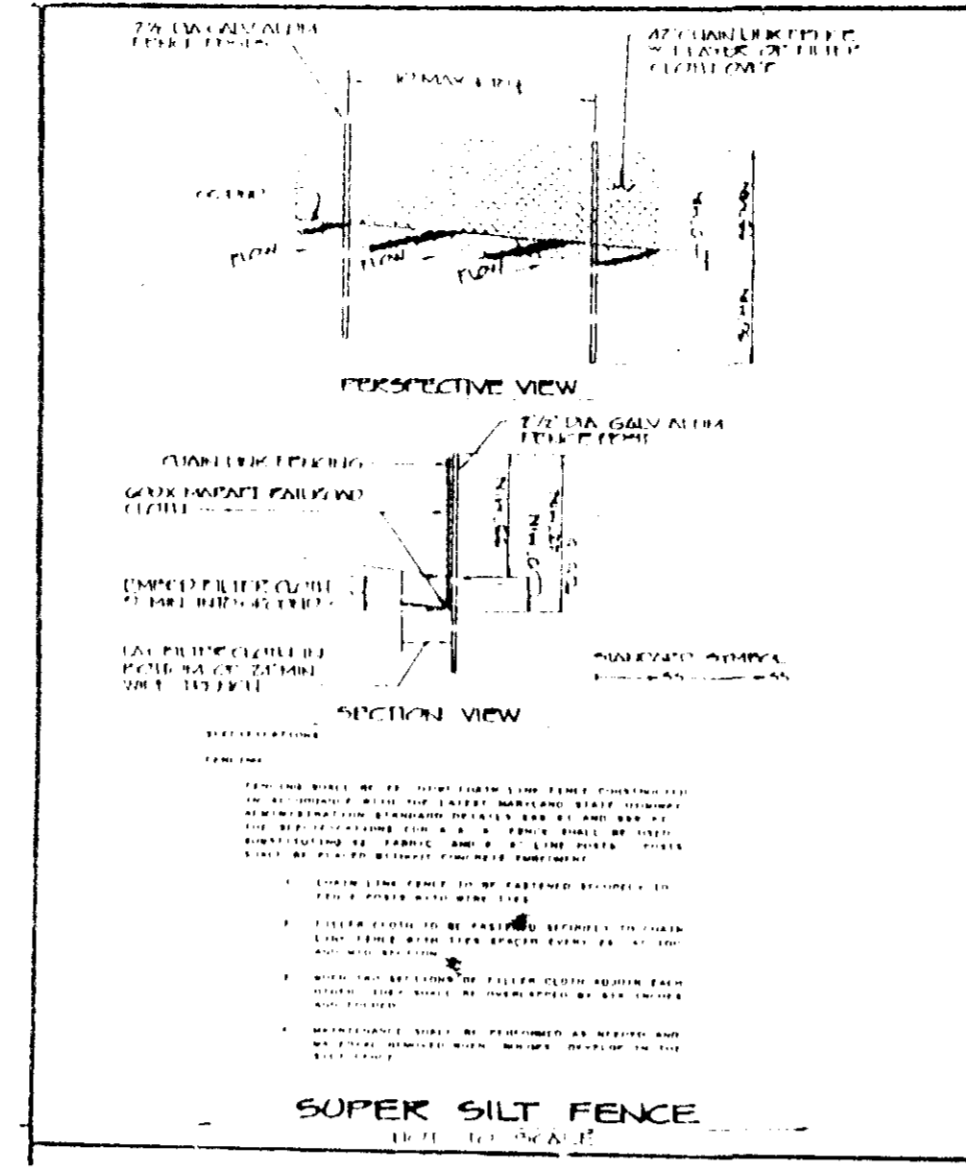
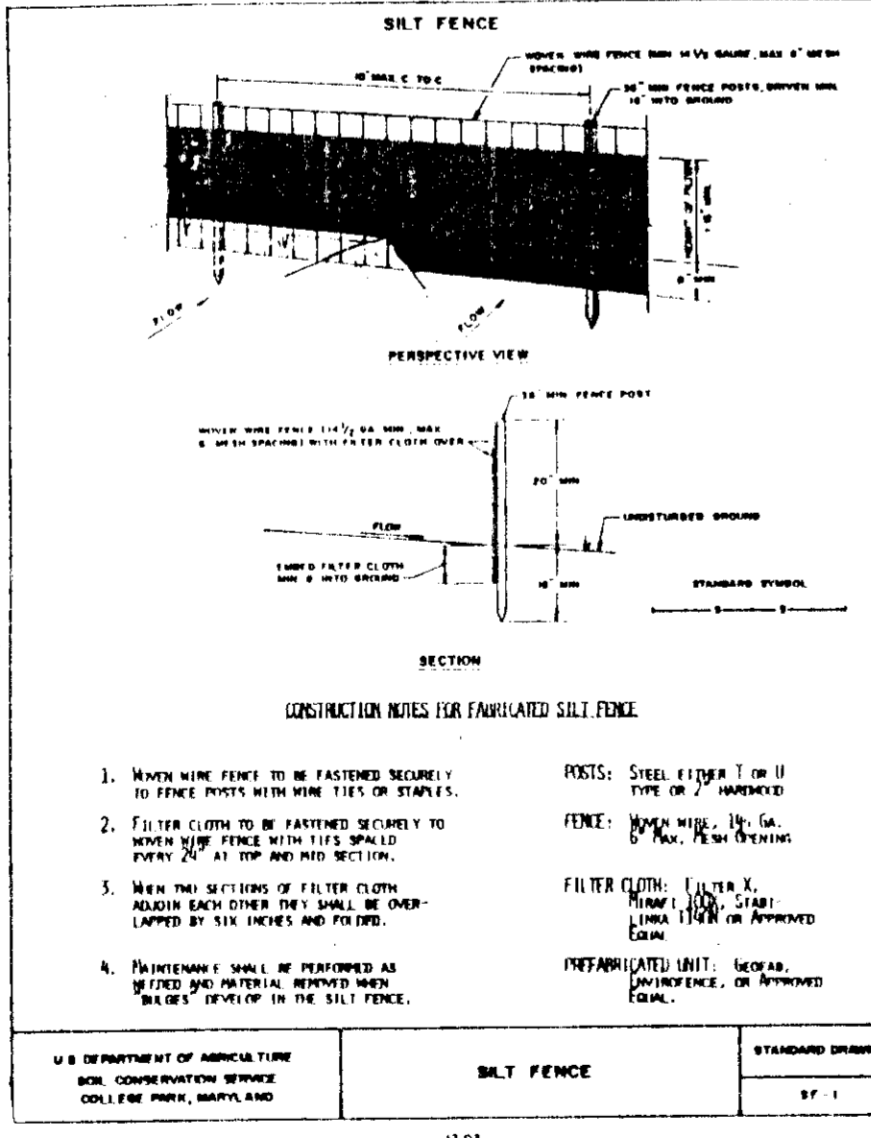
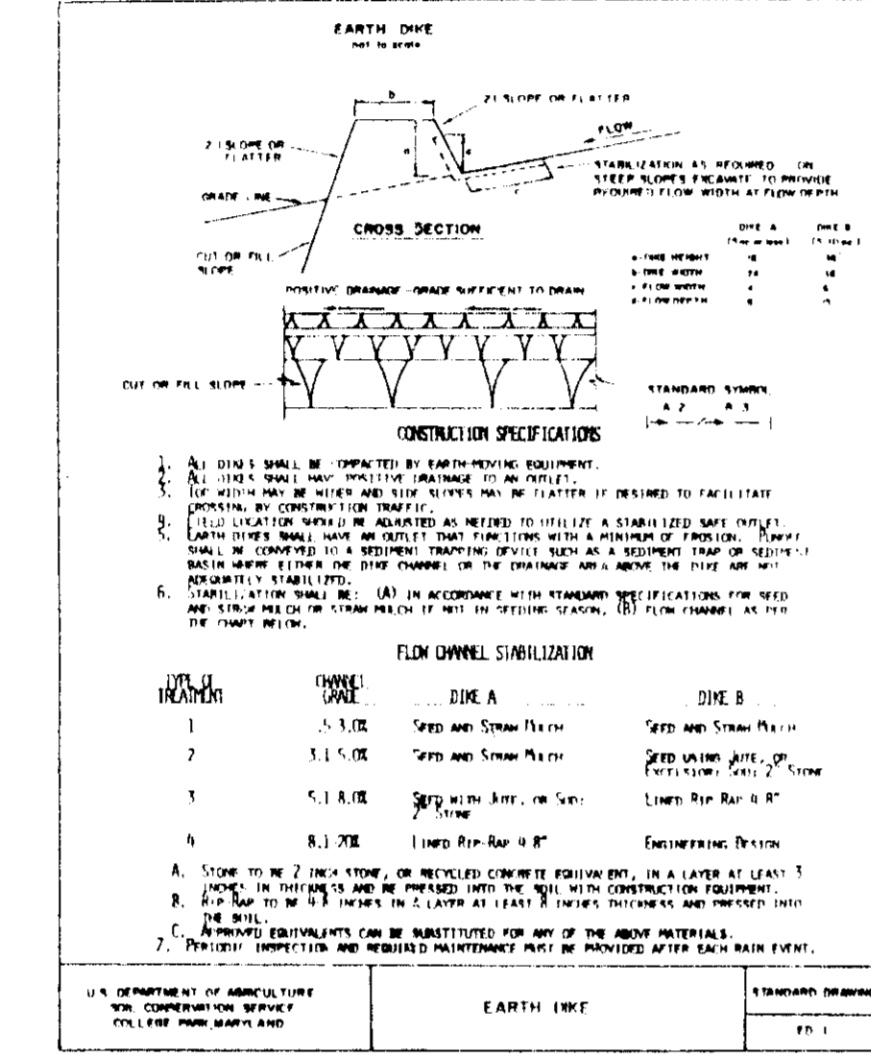

APPROVED: HOWARD COUNTY DEPARTMENT OF PLANNING & ZONING
 [Signature] 6/27/94
 [Signature] 6/29/94

APPROVED: HOWARD COUNTY DEPARTMENT OF PUBLIC WORKS FOR PUBLIC WATER & SEWERAGE, STORM DRAINAGE SYSTEMS AND ROADS
 [Signature] 6/16/94
 [Signature] 6/16/94

PERMIT INFORMATION CHART

SUBDIVISION NAME		SECTION 3, AREA 2		PREVIOUS FILE	
WILLOWOOD		SECTION 3, AREA 2		S-80-29-P-91-08	
LOTS 460-474, & LOTS 510-521		PARCEL #		F-92-82-F-93-37	
SECT./AREA		LIBER & FOLIO		WP-91-76-F-94-87	
3/2		L1427 F. 284			
L136,411, AND 134		L1827 F. 78			
PLAT No.	BLOCK No.	ZONE	TAX MAP	ELEC. DIST.	CENSUS
11156	16	R-SC & R-MH	37	1st	6011.01
WATER LUMP		WATER CODE		DATE	
2153000		D06		APRIL 1994	
SCALE		DATE		SCALE	
AS SHOWN		APRIL 1994		AS SHOWN	

TSA GROUP, INC.
 planning - architecture - engineering
 600 Baltimore National Pike • Ellicott City, Maryland 21040 • (410) 480-8100

OWNER/DEVELOPER:	PROJECT:
CORNERSTONE HOMES, INC. 6571 HUNTSVILLE DRIVE ELK RIDGE, MARYLAND 21227 (410) 379-0157	WILLOWOOD SECTION 3, AREA 2 LOTS 460-474, & LOTS 510-521
LOCATION:	TITLE:
TAX MAP 37C-PARCEL 615, & PART OF PARCELS 136,411,413,414 1st ELECTION DISTRICT HOWARD COUNTY, MARYLAND	EROSION & SEDIMENT CONTROL NOTES AND DETAILS
DATE:	PROJECT NO.:
APRIL 1994	0814
DES:	DRN:
YSL	YSL
SCALE:	DRAWING:
AS SHOWN	4 OF 4