

GENERAL NOTES (Cont.)

12. WP-90-07 WAIVED SECTION 121107 OF THE 1972 EDITION OF THE HOWARD COUNTY SUBDIVISION AND LAND DEVELOPMENT REGULATIONS TO GRANT A SIX MONTH EXTENSION TO THE PRELIMINARY PLAN APPROVAL. IT WAS APPROVED BY THE DIRECTOR OF PLANNING & ZONING ON DECEMBER 2, 1990.
13. ALL CONSTRUCTION SHALL BE IN ACCORDANCE WITH THE LATEST STANDARDS AND SPECIFICATIONS OF HOWARD COUNTY.
14. THE CONTRACTOR SHALL NOTIFY THE DEPARTMENT OF PUBLIC WORKS/BUREAU OF CONSTRUCTION INSPECTION AT (410) 219-2002 AT LEAST FIVE (5) WORKING DAYS PRIOR TO THE START OF WORK.
15. BASEMENT PILES NOT SEWER BY GRAVITY FOR LOTS 20, 31 & 32.

GENERAL NOTES

1. SUBJECT PROPERTY IS ZONED R-12 PER 8/2/85 COMPREHENSIVE ZONING PLAN.
2. THE COORDINATES SHOWN HEREON ARE BASED ON THE MARYLAND STATE GRID SYSTEM AS PROJECTED BY HOWARD COUNTY GEODETIC CONTROL STATIONS NO. 2447002 AND 2447006.
3. ALL ROADWAYS ARE PUBLIC AND EXISTING.
4. TOTAL AREA INCLUDED IN THIS PLAN: 7,3723 AC.
5. ANY DAMAGE TO COUNTY OWNED RIGHTS-OF-WAY SHALL BE CORRECTED AT THE DEVELOPER'S EXPENSE.
6. TOTAL NUMBER OF LOTS IN THIS PLAN: 24.
7. STORM WATER MANAGEMENT FOR THIS PROJECT IS PROVIDED BY F-91-18.
8. THE MAXIMUM PERMITTED LOT COVERAGE IS 30%.
9. SEE DEPT. OF PLANNING & ZONING FILE NO. P-88-55, WP-90-09, WP-90-79, WP-91-05, 5-2004, F-91-04.
10. STORM WATER MANAGEMENT PROVIDED IN CENTRAL FACILITY, F 89-18.
11. TOPOGRAPHY TAKEN FROM PLANS PREPARED BY MILDENBERG, MOCHI & ASSOCIATES, INC.

SPECIAL NOTES

1. APPROVED ROAD CONSTRUCTION PLANS SHALL BE USED FOR ALL PUBLIC UTILITIES.
2. PUBLIC WATER SEWER SHOWN FOR REFERENCE ONLY. FOR MORE DETAILED INFORMATION, SEE WATER & SEWER PLANS CONTRACT NO. 14-7222-D.
3. THE WATER SEWER HOUSE CONNECTIONS NOT INCLUDED IN A DEVELOPER'S AGREEMENT SHALL CONFORM HOWARD COUNTY PLUMBING CODE. THE ON-SITE WWC SHALL BE 3/4" COPPER AND THE SMO SHALL BE 4" IRON.
4. STREET TREES TO BE PROVIDED AS REQUIRED BY SECTION 16.136 OF THE HOWARD COUNTY SUBDIVISION AND LAND DEVELOPMENT REGULATIONS.
5. WP-90-13 WAIVED SEC. 18.113 F-3 OF THE SUBDIVISION REGULATIONS ON 12/19/90 REQUIRING TRUNCATION AT HANOVER ROAD & HANOVER CROSSING WAY, GRANTED 12/15/90.
6. THIS PROPERTY IS LOCATED IN THE AIRPORT NOISE ZONE AND WAS APPROVED FOR SUBDIVISION PURSUANT TO COMAR ARTICLE - TRANSPORTATION, SEC. 5.822 AS EVIDENCED BY AIRPORT ZONING PERMIT APPLICATION NO. DOCKET 229. FUTURE RESIDENTIAL CONSTRUCTION WILL REQUIRE APPROVAL FROM THE BOARD OF AIRPORT ZONING APPEALS PRIOR TO ISSUE.
7. BASEMENT SEWER SERVICE ARE NOT PROVIDED FOR LOTS 29, 31 & 32.
8. ALL ROAD CONSTRUCTION, STORM DRAINAGE FACILITIES AND PUBLIC WATER AND SEWER ARE SHOWN FOR REFERENCE ONLY. USE APPROVED PLAN (F-91-04) FOR ALL PHASES OF CONSTRUCTION.
9. THE WETLAND STREAM BUFFER INDICATED ON THIS PLAN DOES NOT AFFECT THE INITIAL CONSTRUCTION OF A RESIDENTIAL UNIT ON ANY LOT. IT DOES PROHIBIT SUBSEQUENT CLEARING, GRADING, OR CONSTRUCTION IN THE BUFFER AREA. MAINTENANCE OF RESIDENCES, LANDSCAPING AND UTILITIES IS PERMITTED.

BENCHMARKS

HOWARD COUNTY MONUMENT # 2447002 - ELEV. 49.819
CONCRETE MONUMENT NORTHWEST CORNER
RAILROAD TRACKS AND HANOVER ROAD. 3'
BELOW SURFACE.

HOWARD COUNTY MONUMENT # 2447006 - ELEV. 49.478
REBAR ON WEST SIDE RACE ROAD OPPOSITE RT. OF
PT. OF CURVE. IN ROAD, 9' OFF EDGE OF
MACADAM. 2' BELOW SURFACE.

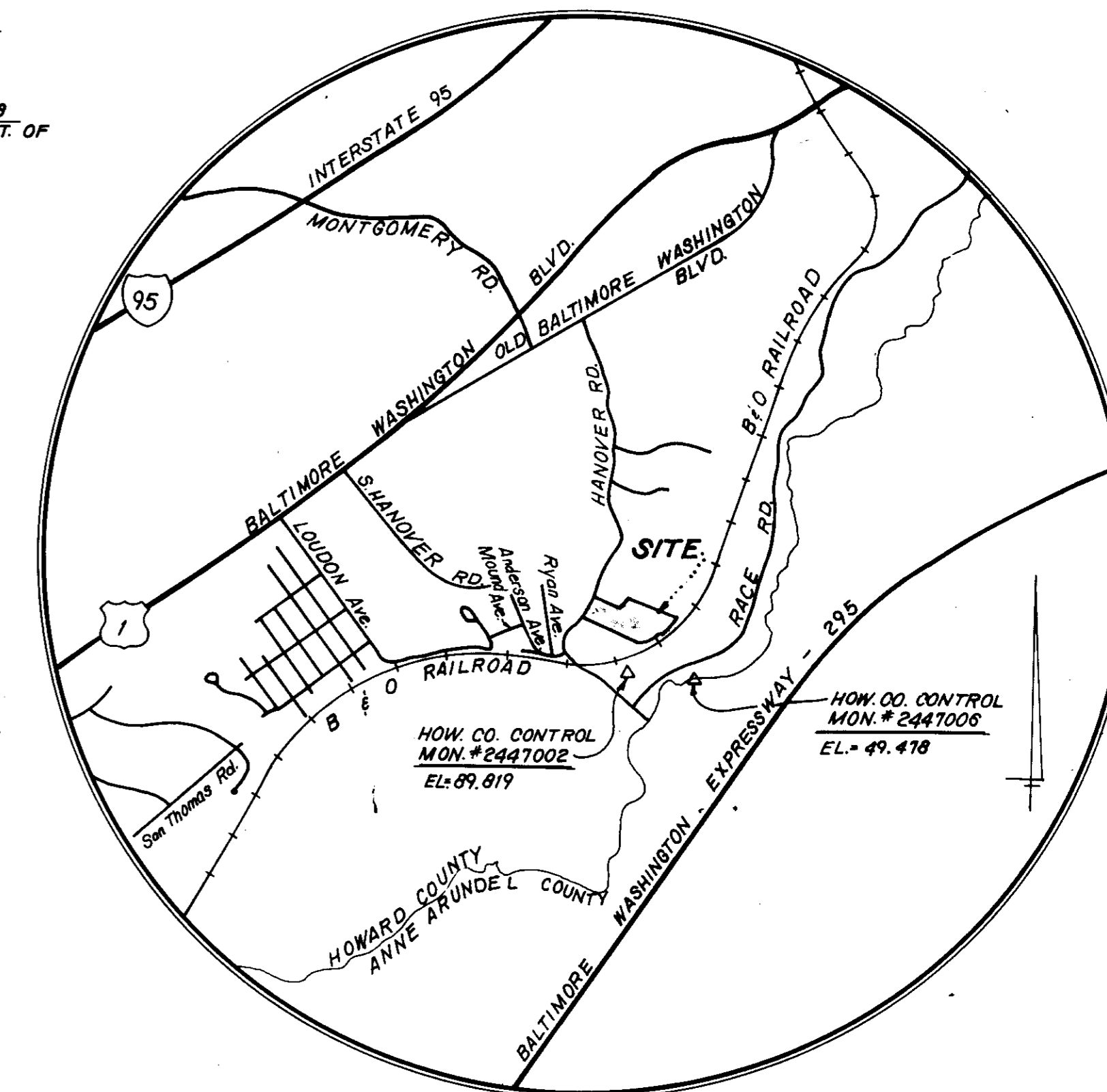

LOCATION MAP

SCALE: 1"=2000'
(HOWARD COUNTY STREET MAP, PG. 17-10 H)

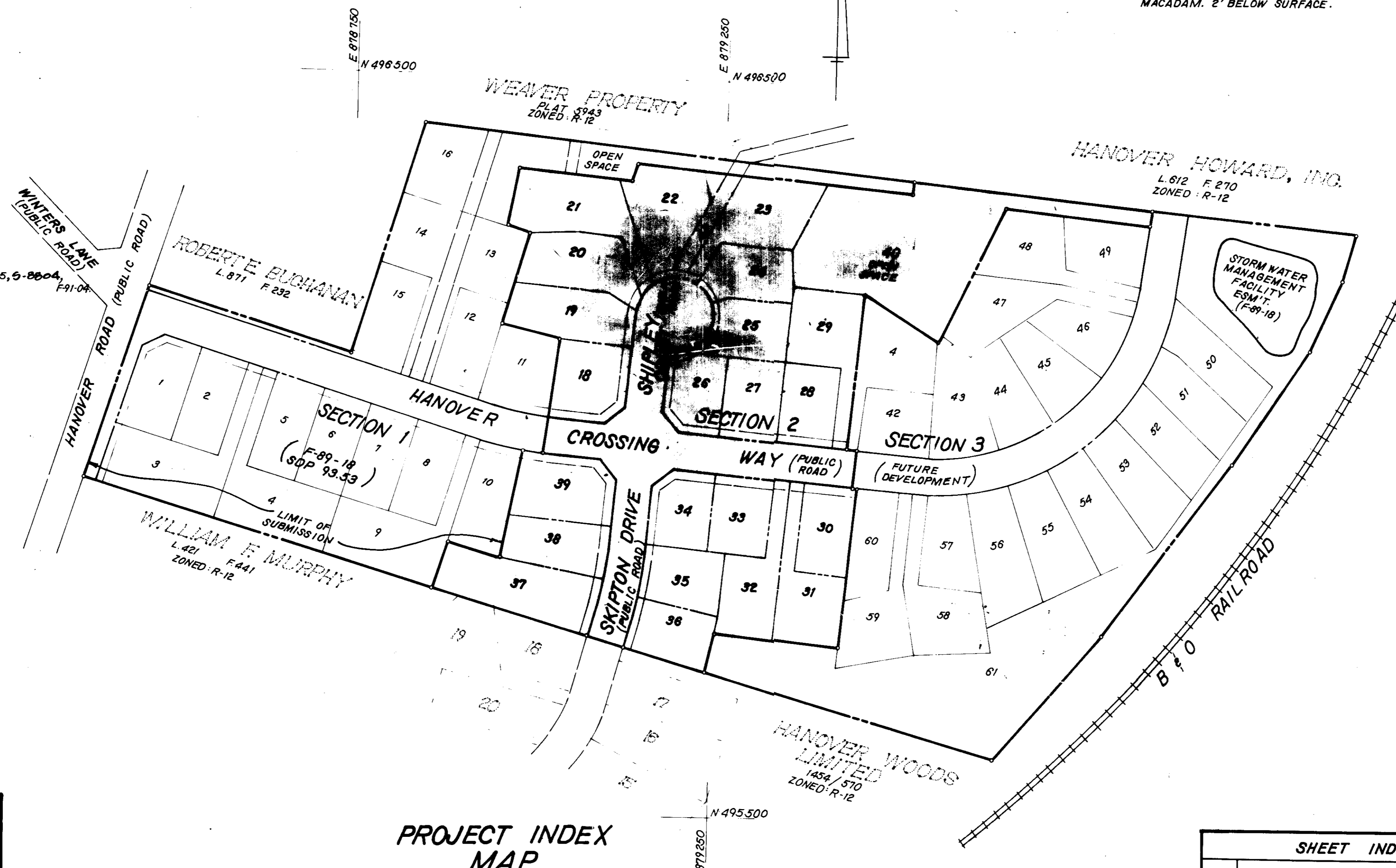

PROJECT INDEX MAP

SCALE: 1"=100'

PERMIT BLOCK

SUBDIVISION NAME		SECTION	LOTS	CENSUS TR.
HANOVER CROSSING		2	18-41	6012
PLAT NO.	BLOCK #	ZONE	TAX MAP/PARCEL	ELECT. DIST.
	15	R-12	38	200
WATER CODE		SEWER CODE		
A01		2130000		

SHEET INDEX

NO.	DESCRIPTION
1	COVER SHEET
2	SITE DEVELOPMENT PLAN
3	SEDIMENT CONTROL PLAN
4	DETAIL SHEET

ADDRESS CHART

LOT #	STREET ADDRESS
18	0002 Hanover Crossing Way
19	0000 Skipton Court
20	0000 Skipton Court
21	0010 Skipton Court
22	0017 Skipton Court
23	0018 Skipton Court
24	0000 Skipton Court
25	0001 Skipton Court
26	0000 Hanover Crossing Way
27	0000 Hanover Crossing Way
28	0000 Hanover Crossing Way
29	0000 Hanover Crossing Way
30	0000 Hanover Crossing Way
31	0000 Hanover Crossing Way
32	0000 Hanover Crossing Way
33	0000 Hanover Crossing Way
34	0001 Hanover Crossing Way
35	0000 Skipton Drive
36	0000 Skipton Drive
37	0000 Skipton Drive
38	0000 Skipton Drive
39	0001 Hanover Crossing Way
40	Open Space
41	Open Space

LOT	GROSS AREA	PIPESTEM AREA	FLOODPLAIN/STEEP SLOPES	NET AREA
18	10,298 #	0		10,298 #
19	10,897 #	0		10,897 #
20	11,702 #	0		11,702 #
21	13,898 #	1532 #		12,366 #
22	12,488 #	0		12,488 #
23	12,095 #	1358 #		10,737 #
24	8,588 #	0		8,588 #
25	8,862 #	0		8,862 #
26	8,537 #	0		8,537 #
27	8,470 #	0		8,470 #
28	8,470 #	0		8,470 #
29	12,008 #	2,200 #		9,808 #
30	8,400 #	0		8,400 #
31	11,085 #	2,400 #		8,685 #
32	10,500 #	2,100 #		8,400 #
33	8,400 #	0		8,400 #
34	8,566 #	0		8,566 #
35	8,642 #	0		8,642 #
36	8,451 #	0		8,451 #
37	15,059 #	0		15,059 #
38	9,198 #	0		9,198 #
39	11,302 #	0		11,302 #

HANOVER CROSSING - SECTION TWO
1ST ELECTION DISTRICT
HOWARD COUNTY, MARYLAND

APPROVED FOR PUBLIC WATER AND PUBLIC SEWERAGE SYSTEMS HOWARD COUNTY HEALTH DEPT.
COUNTY HEALTH OFFICER *[Signature]* DATE 10/14/93

APPROVED FOR PLANNING & ZONING HOWARD COUNTY DEPT. OF PLANNING & ZONING
PLANNING DIRECTOR *[Signature]* DATE 10/21/93

APPROVED FOR LAND DEVELOPMENT AND RESEARCH HOWARD COUNTY DEPT. OF LAND DEVELOPMENT AND RESEARCH
CHIEF, DIVISION OF LAND DEVELOPMENT AND RESEARCH *[Signature]* DATE 10/20/93

APPROVED FOR PUBLIC WATER AND PUBLIC SEWERAGE STORM DRAINAGE SYSTEMS AND PUBLIC ROADS HOWARD COUNTY DEPT. OF PUBLIC WORKS
DIRECTOR *[Signature]* DATE 10/3/93

CHIEF BUREAU OF ENGINEERING WK. *[Signature]* DATE 10/8/93

OWNER:
JNDC LIMITED PARTNERSHIP, % NEWBURN DEVELOPMENT CORP. GENERAL PARTNER 5570 STERRET PLACE 201 COLUMBIA, MD. 21044

CONTRACT PURCHASER:
LOVELL REGENCY HOMES LIMITED PARTNERSHIP 49 OLD SOLOMONS ISLAND RD. SUITE # 301 ANNAPOLIS, MD. 21401

REVISIONS
REV. 7-29-93

SHAFFER BATT & ASSOC., INC.
ENGINEERS-LAND PLANNERS-SURVEYORS
604 WIND RIVER LANE GAITHERSBURG, MARYLAND 20878 (301) 477-0344



SHEET 1 OF 4

COVER SHEET
LOTS 18-41
HANOVER CROSSING (SECTION TWO)
1ST ELECTION DISTRICT
HOWARD COUNTY, MARYLAND

SCALE: AS SHOWN
FEBRUARY, 1993

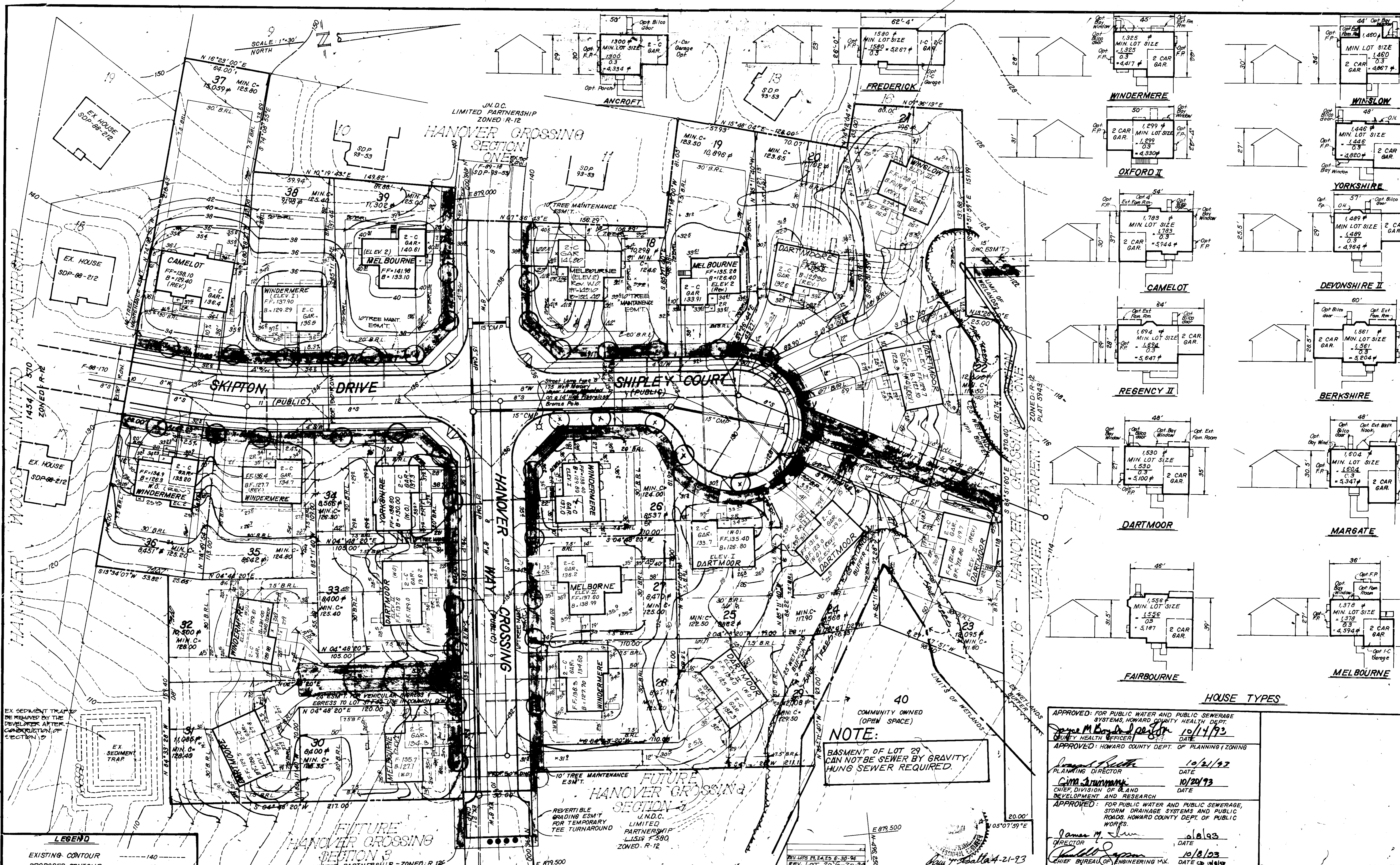

LEGEND

- EXISTING CONTOUR
- PROPOSED CONTOUR
- PROPOSED SPOT ELEVATION
- DIRECTION OF DRAINAGE
- TREE LINE
- STREET TREE

BUILDING RESTRICTION LINES

- FRONT: 20' UNLESS OTHERWISE SHOWN
- SIDES: 15'
- REAR: 30' UNLESS OTHERWISE SHOWN

OWNER:
 J.N.D.C. LIMITED PARTNERSHIP
 5570 STENNET PLACE, #201
 COLUMBIA, MD. 21044

CONTRACT PURCHASER:
 LOVELL REGENCY HOMES
 LIMITED PARTNERSHIP
 49 OLD SOLOMONS ISLAND
 ROAD, SUITE #301
 ANNAPOLIS, MD. 21401

REVISIONS

REV. LOTS 18-25 6-30-93	DATE
REV. LOT 26 6-20-94	DATE
REV. LOT 30 6-20-94	DATE

SHAFER BATT & ASSOC., INC.
 ENGINEERS-LAND PLANNERS-SURVEYORS
 804 WOOD RIVER LANE
 GAITHERSBURG, MARYLAND 20878
 (301) 477-0344



SITE DEVELOPMENT PLAN
 LOTS 18-41
HANOVER CROSSING (SECTION TWO)
 1ST ELECTION DISTRICT
 HOWARD COUNTY, MARYLAND

APPROVED: FOR PUBLIC WATER AND PUBLIC SEWERAGE SYSTEMS, HOWARD COUNTY HEALTH DEPT.
James M. Boyd 10/14/93
 COUNTY HEALTH OFFICER DATE

APPROVED: HOWARD COUNTY DEPT. OF PLANNING & ZONING
James M. Boyd 10/21/93
 PLANNING DIRECTOR DATE

APPROVED: FOR PUBLIC WATER AND PUBLIC SEWERAGE, STORM DRAINAGE SYSTEMS AND PUBLIC ROADS, HOWARD COUNTY DEPT. OF PUBLIC WORKS.
James M. Boyd 10/18/93
 DIRECTOR DATE

APPROVED: FOR PUBLIC WATER AND PUBLIC SEWERAGE SYSTEMS, HOWARD COUNTY HEALTH DEPT.
James M. Boyd 10/18/93
 CHIEF BUREAU OF ENGINEERING M.A. DATE

SHEET 2 OF 4

SCALE: 1"=30'

DECEMBER, 1992

SDP 93-104

Reviewed for HOWARD S.C.D. Home and most Technical Requirements Date 7/29/93 U.S. Soil Conservation Service Approved 7/29/93 Howard S.C.D.

(THIS DEVELOPMENT PLAN IS APPROVED FOR SOIL EROSION AND SEDIMENT CONTROL BY THE HOWARD COUNTY CONSERVATION DISTRICT.)

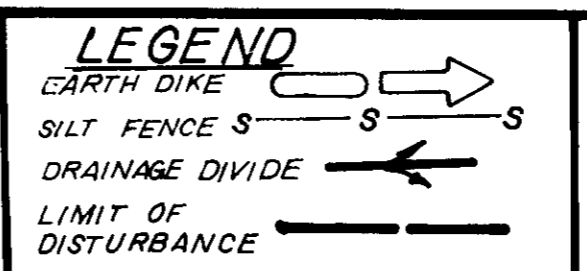

SEDIMENT TRAP #1 TYPE - ST V DRAINAGE AREA - 1.74 Ac. STORAGE REQUIRED = 3050 C.F. STORAGE PROVIDED = 3240 C.F. WEIR CREST ELEV. = 116.8' TOP EMBANKMENT ELEV. = 118.9' CLEAN OUT ELEV. = 112.5' BOTTOM DIMENSION WEIR LENGTH = 10' SIDE SLOPE - CUT = 2:1 FILL = 2:1

- SEDIMENT CONTROL NOTES 1) A minimum of 24 hours notice must be given to the Howard County Office... 2) All vegetative and structural practices are to be installed according to provisions of 2014... 3) Following initial soil disturbance or redistribution permanent or temporary stabilization operations shall be completed within 14 calendar days... 4) All sediment traps/basins shown must be fenced and warning signs posted... 5) All disturbed areas must be stabilized within the time period specified above... 6) All sediment control structures are to remain in place and are to be maintained in operative condition until permission for their removal has been obtained... 7) Site Analysis Total Area of Site 7.97 Acres Area Disturbed or Paved 4.22 Acres Area to be Vegetatively Stabilized 2.75 Acres Total Cut 1.22 Cu. Yds Total Fill 1.22 Cu. Yds # The waste site must be approved by the sediment control inspector... 8) Any sediment control practice which is disturbed by grading activity or placement of utilities must be repaired on the same day of disturbance... 9) Additional sediment control must be provided if deemed necessary by the Howard County DPW sediment control inspector... 10) On all sites with disturbed areas in excess of 2 acres approval of installation of permanent erosion and sediment controls, but before proceeding with any other earth disturbing activity or placement of utilities must be obtained... 11) The standard sediment control plan for single lots may not be used for any lot on this plan. 12) All pipes to be blocked at the end of each day. 13) The total amount of straw bale dike/silt fence equals 1,220 L.F. 14) Only one stabilized construction entrance is required for a group of adjoining houses being constructed concurrently. 15) Developer to be responsible for cleaning sediments attributed to their development. 16) Contractor to obtain approval from inspector on borrow site prior to the commencement of grading operations.

PERMANENT SEEDING NOTES Apply to graded or cleared areas not subject to immediate further disturbance where a permanent long-lived vegetative cover is needed. Seedbed Preparation: Loosen upper three inches of soil by raking, disking or other acceptable means before seeding, if not previously loosened. Soil Amendments: In lieu of soil test recommendations, use one of the following schedules: 1) Apply 2 tons per acre dolomitic limestone (92 lbs/1000 sq. ft.) and 600 lbs per acre 10-10-10 fertilizer and 4 lbs/1000 sq. ft. of urea-formaldehyde fertilizer (46-0-0) or 18 gallons per acre (5 gal/100 sq. ft.) of urea-formaldehyde fertilizer (46-0-0) on a slope 8 feet or higher, use 348 gallons per acre (8 gal/1000 sq. ft.) for anchoring. 2) Acceptable - Apply 2 tons per acre dolomitic limestone (92 lbs/1000 sq. ft.) and 600 lbs per acre 10-10-10 fertilizer (23 lbs/1000 sq. ft.) before seeding. Harrow or disc into upper three inches of soil. Seeding: For the period March 1 thru April 30, and August 1 thru October 15, use 3 lbs per acre annual ryegrass (14 lbs/1000 sq. ft.) and 3 lbs per acre tall fescue (14 lbs/1000 sq. ft.) For the period May 1 thru July 31, use 3 lbs per acre annual ryegrass (14 lbs/1000 sq. ft.) and 3 lbs per acre tall fescue (14 lbs/1000 sq. ft.) For the period August 1 thru October 15, use 3 lbs per acre annual ryegrass (14 lbs/1000 sq. ft.) and 3 lbs per acre tall fescue (14 lbs/1000 sq. ft.) Mulching: Apply 1 1/2 to 2 tons per acre (70 to 90 lbs/1000 sq. ft.) of unrotted straw immediately after seeding. Anchor mulch immediately after application using mulch anchoring tool or 218 gallons per acre (5 gal/1000 sq. ft.) of urea-formaldehyde fertilizer (46-0-0) on a slope 8 feet or higher, use 348 gallons per acre (8 gal/1000 sq. ft.) for anchoring. Maintenance: Inspect all seeded areas and make needed repairs, replacements and reseedings.

TEMPORARY SEEDING NOTES Apply to graded or cleared areas likely to be redistributed where a short-term vegetative cover is needed. Seedbed Preparation: Loosen upper three inches of soil by raking, disking or other acceptable means before seeding, if not previously loosened. Soil Amendments: Apply 600 lbs per acre 10-10-10 fertilizer (14 lbs/1000 sq. ft.) before seeding. Seeding: For periods March 1 thru April 30 and from August 15 thru November 15, use 3 lbs per acre annual ryegrass (14 lbs/1000 sq. ft.) and 3 lbs per acre tall fescue (14 lbs/1000 sq. ft.) For the period May 1 thru July 31, use 3 lbs per acre annual ryegrass (14 lbs/1000 sq. ft.) and 3 lbs per acre tall fescue (14 lbs/1000 sq. ft.) For the period August 1 thru October 15, use 3 lbs per acre annual ryegrass (14 lbs/1000 sq. ft.) and 3 lbs per acre tall fescue (14 lbs/1000 sq. ft.) Mulching: Apply 1 1/2 to 2 tons per acre (70 to 90 lbs/1000 sq. ft.) of unrotted straw immediately after seeding. Anchor mulch immediately after application using mulch anchoring tool or 218 gallons per acre (5 gal/1000 sq. ft.) of urea-formaldehyde fertilizer (46-0-0) on a slope 8 feet or higher, use 348 gallons per acre (8 gal/1000 sq. ft.) for anchoring. Refer to the 1983 MARYLAND STANDARDS AND SPECIFICATIONS FOR SOIL EROSION AND SEDIMENT CONTROL for rate and methods not covered.

APPROVED: FOR PUBLIC WATER AND PUBLIC SEWERAGE SYSTEMS, HOWARD COUNTY HEALTH DEPT. Joyce M. Bond 10/14/93 COUNTY HEALTH OFFICER, E.L. DATE APPROVED: HOWARD COUNTY DEPT. OF PLANNING & ZONING James A. Smith 10/31/93 PLANNING DIRECTOR DATE Gina Trumpanic 10/20/93 CHIEF DIVISION OF LAND DEVELOPMENT AND RESEARCH DATE APPROVED: FOR PUBLIC WATER AND PUBLIC SEWERAGE, STORM DRAINAGE SYSTEMS AND PUBLIC ROADS, HOWARD COUNTY DEPT. OF PUBLIC WORKS. James J. Elson 10/18/93 DIRECTOR DATE Chad W. Dixon 10/8/93 CHIEF BUREAU OF ENGINEERING M.A. DATE

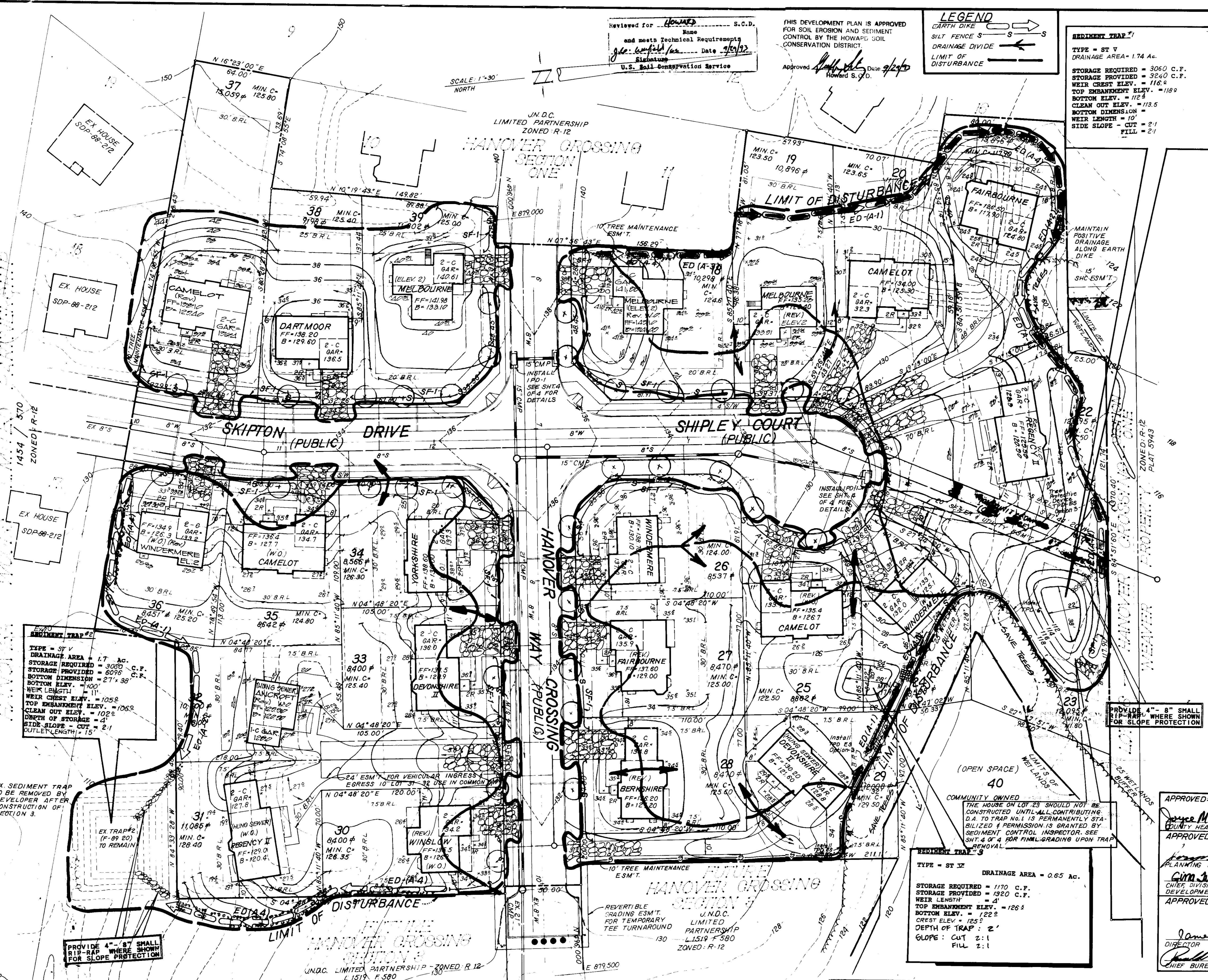

SEDIMENT TRAP #2 TYPE - ST V DRAINAGE AREA - 1.7 Ac. STORAGE REQUIRED = 3050 C.F. STORAGE PROVIDED = 3240 C.F. WEIR CREST ELEV. = 105.2' TOP EMBANKMENT ELEV. = 106.8' CLEAN OUT ELEV. = 102.2' BOTTOM DIMENSION WEIR LENGTH = 11' SIDE SLOPE - CUT = 2:1 FILL = 2:1

SEDIMENT TRAP #3 TYPE - ST V DRAINAGE AREA - 0.65 Ac. STORAGE REQUIRED = 1170 C.F. STORAGE PROVIDED = 1320 C.F. WEIR CREST ELEV. = 126.4' TOP EMBANKMENT ELEV. = 128.4' CLEAN OUT ELEV. = 122.2' BOTTOM DIMENSION WEIR LENGTH = 10' SIDE SLOPE - CUT = 2:1 FILL = 2:1

BUILDING RESTRICTION LINES FRONT 20' UNLESS OTHERWISE SHOWN SIDES 7.5' REAR 30' UNLESS OTHERWISE SHOWN

OWNER: UNDC LIMITED PARTNERSHIP % NEWBURN DEVELOPMENT CORPORATION GENERAL PARTNER 5570 STERRET PLACE, #201 COLUMBIA, MD. 21044 CONTRACT PURCHASER: LOVELL REGENCY HOMES LIMITED PARTNERSHIP 49 OLD SOLOMONS ISLAND ROAD, SUITE 1301 ANNAPOLIS, MD. 21401

REVISIONS REV. 7-29-93

SHAFFER BATT & ASSOC., INC. ENGINEERS-LAND PLANNERS-SURVEYORS 904 WIND RIVER LANE GAITHERSBURG, MARYLAND 20878 (301) 417-0344



SEDIMENT CONTROL PLAN LOT 18-4 HANOVER CROSSING (SECTION TWO) 1ST ELECTION DISTRICT HOWARD COUNTY, MARYLAND

SCALE 1"=30' DECEMBER, 1993

SDP 93-104

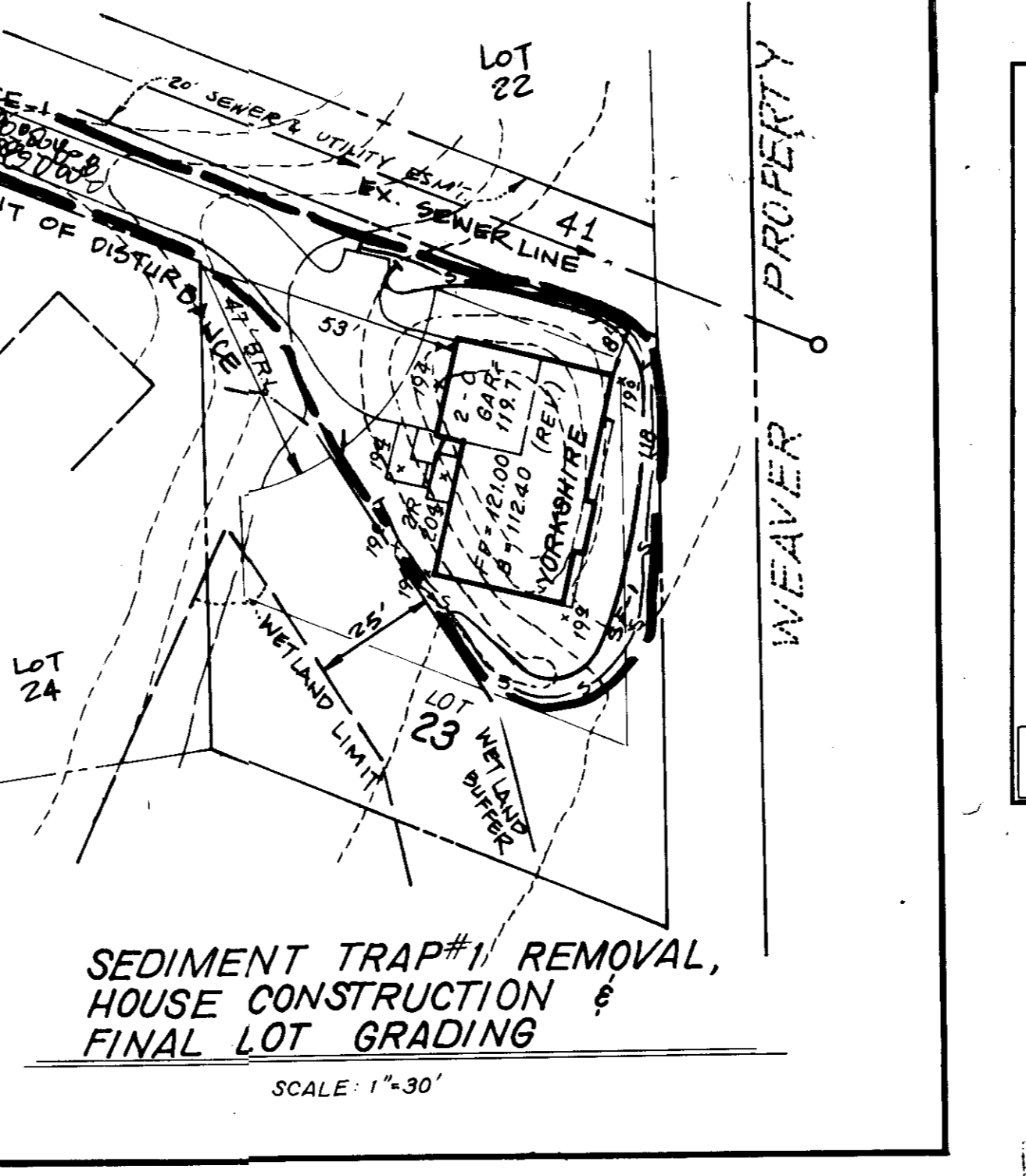
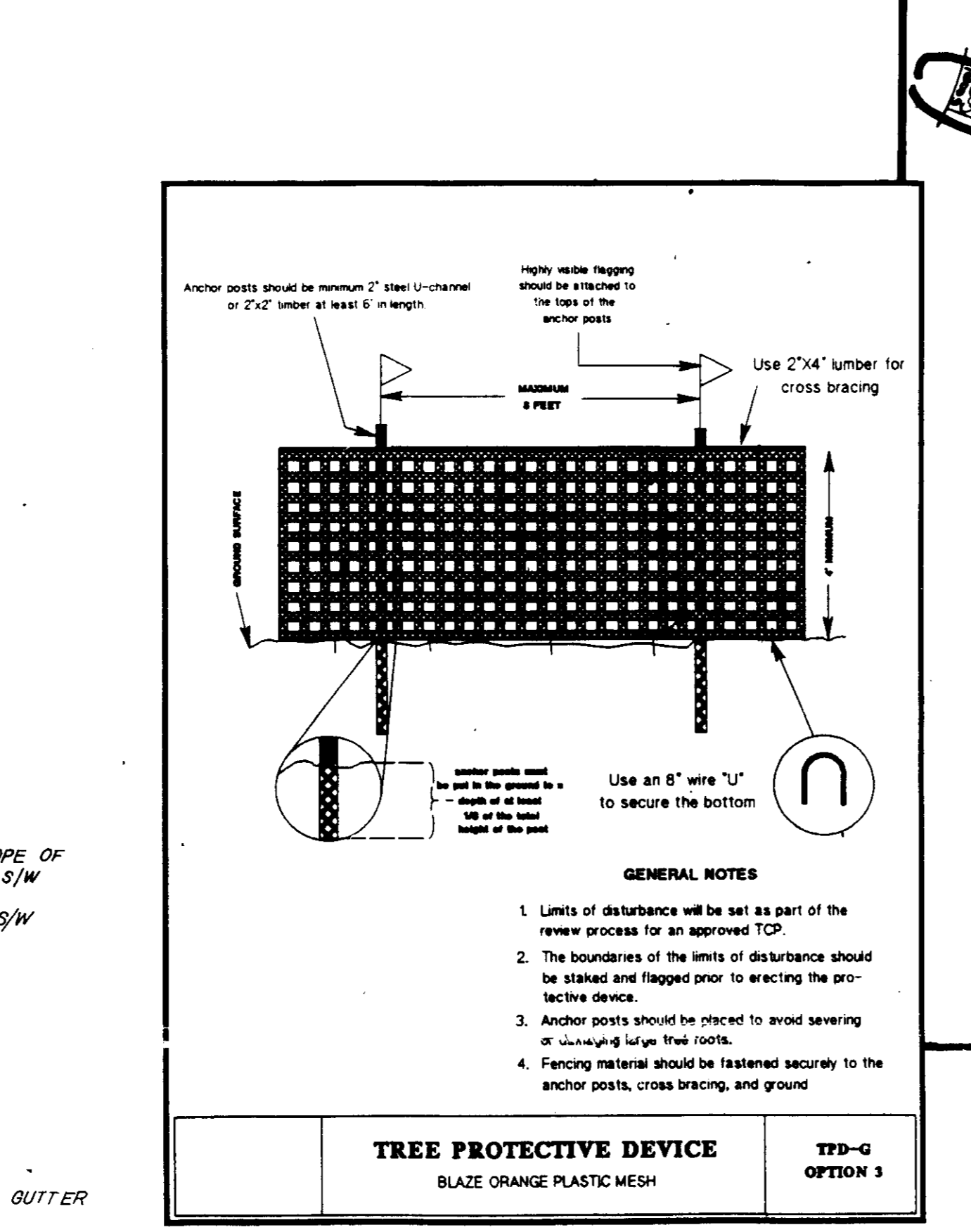
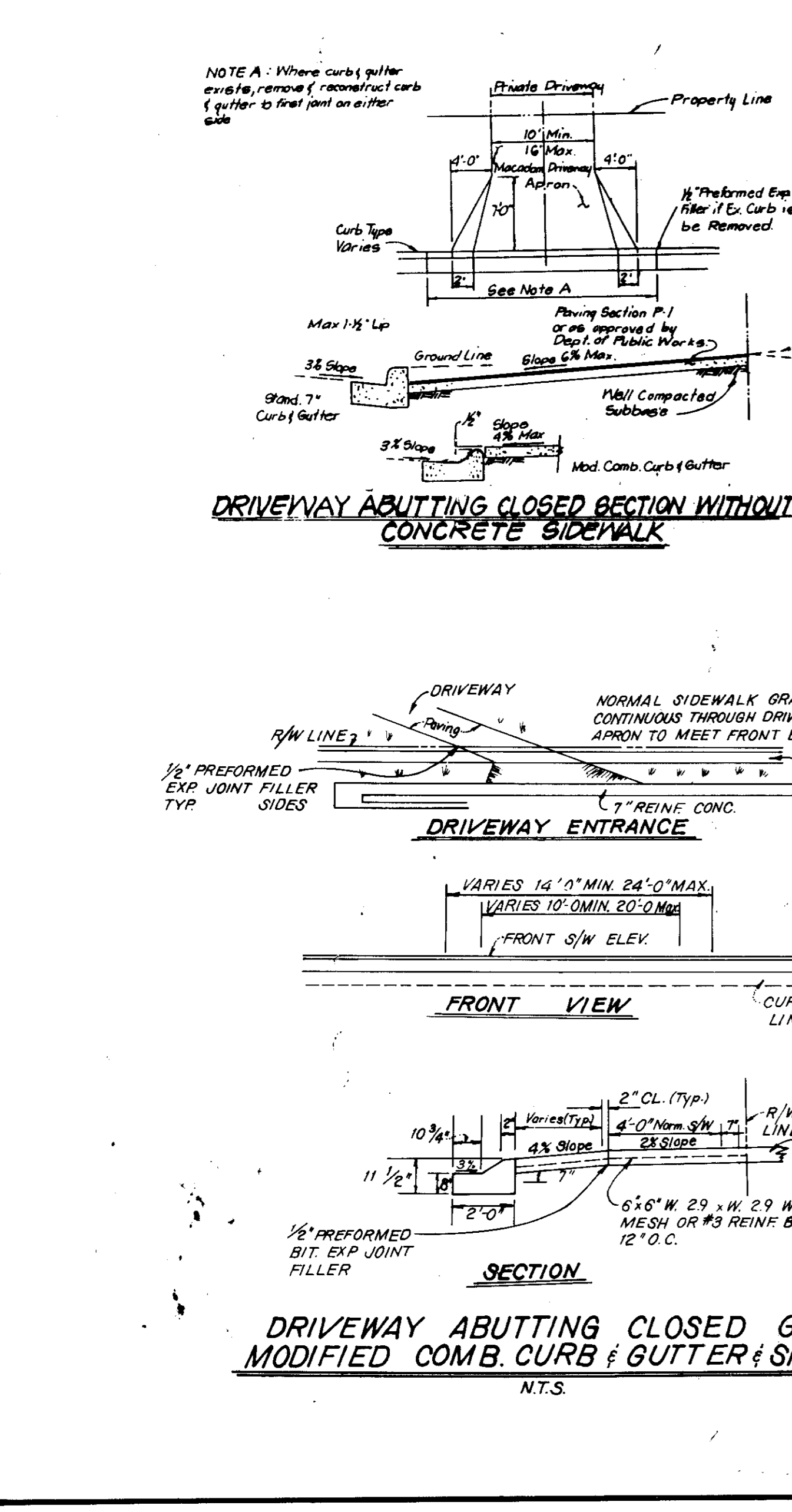
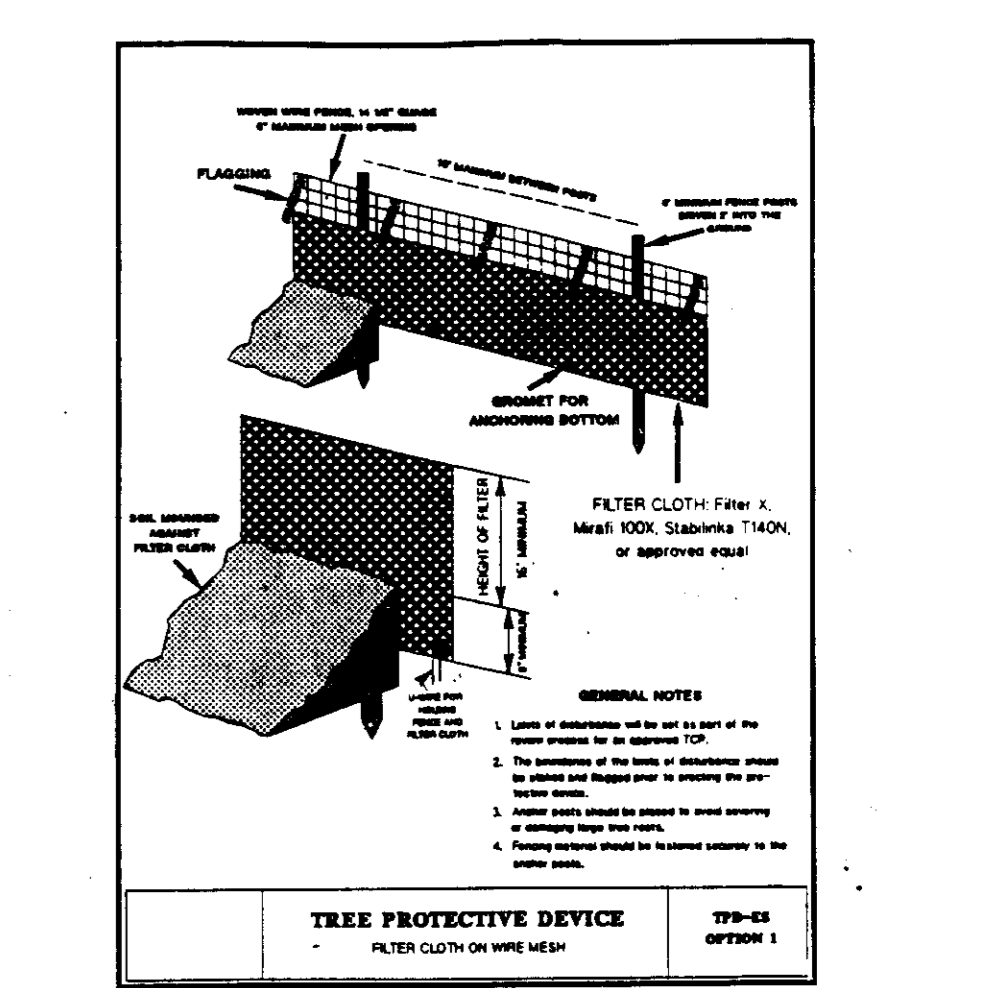
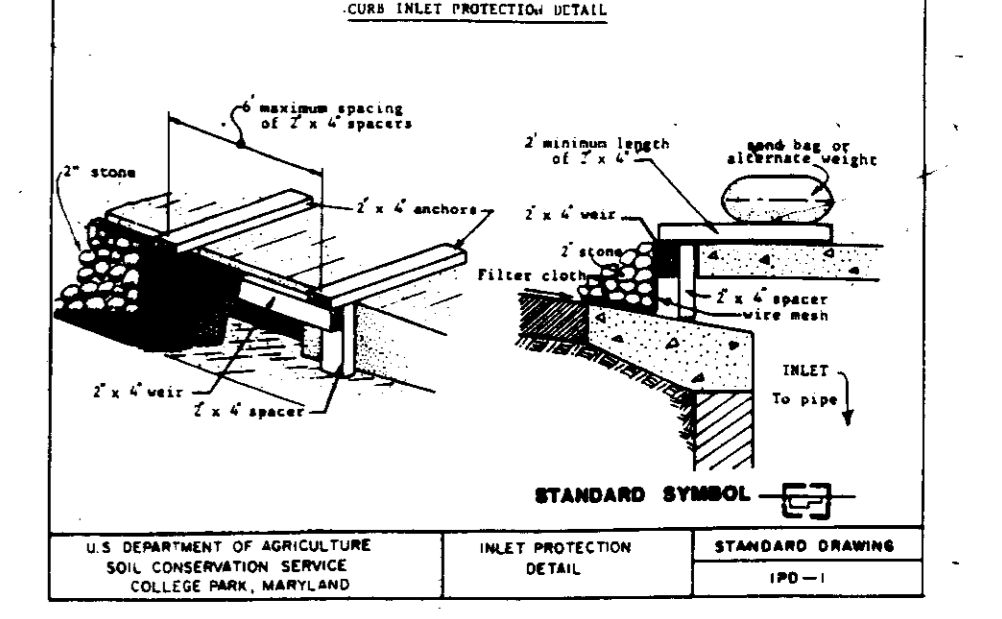
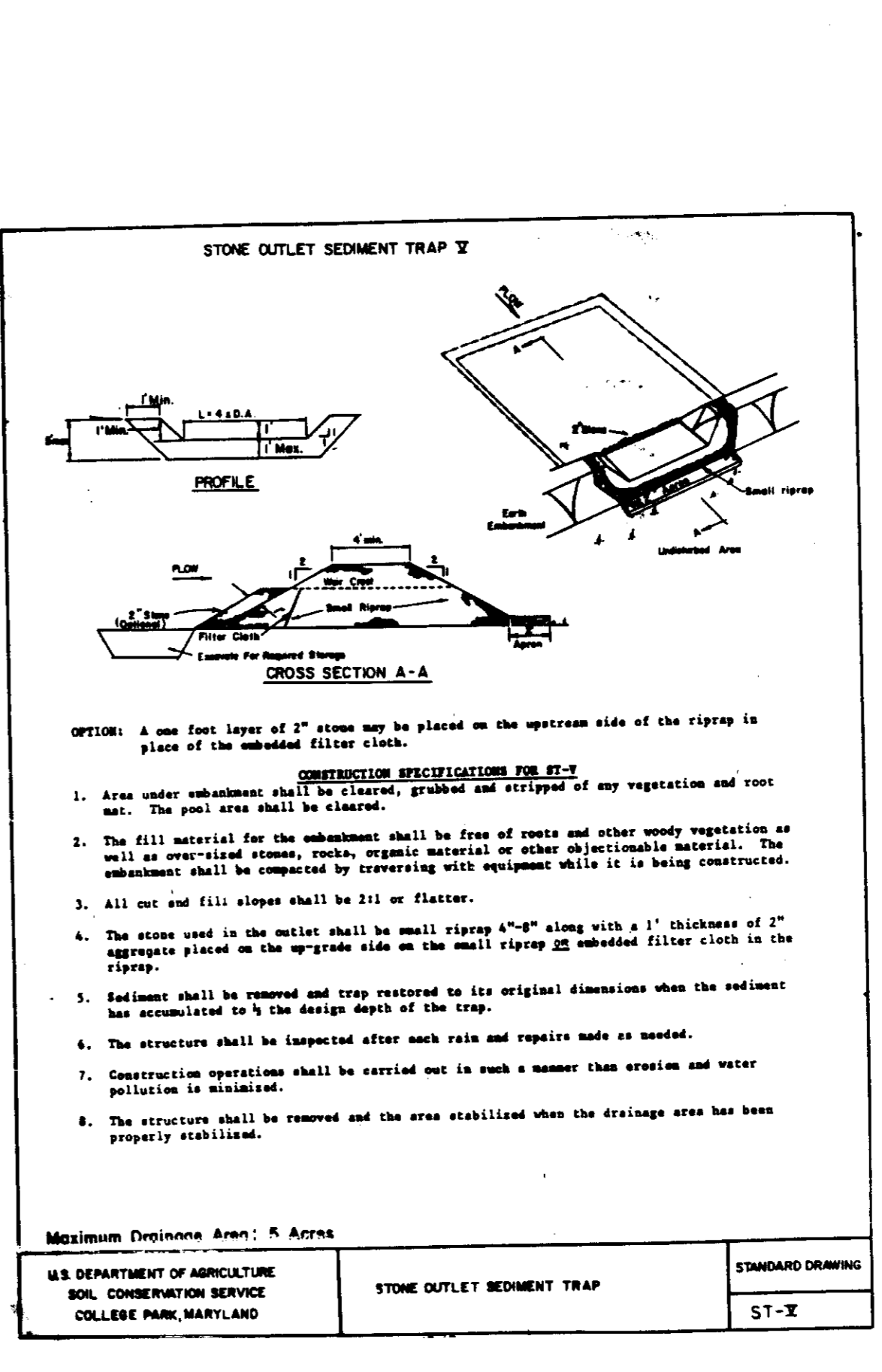
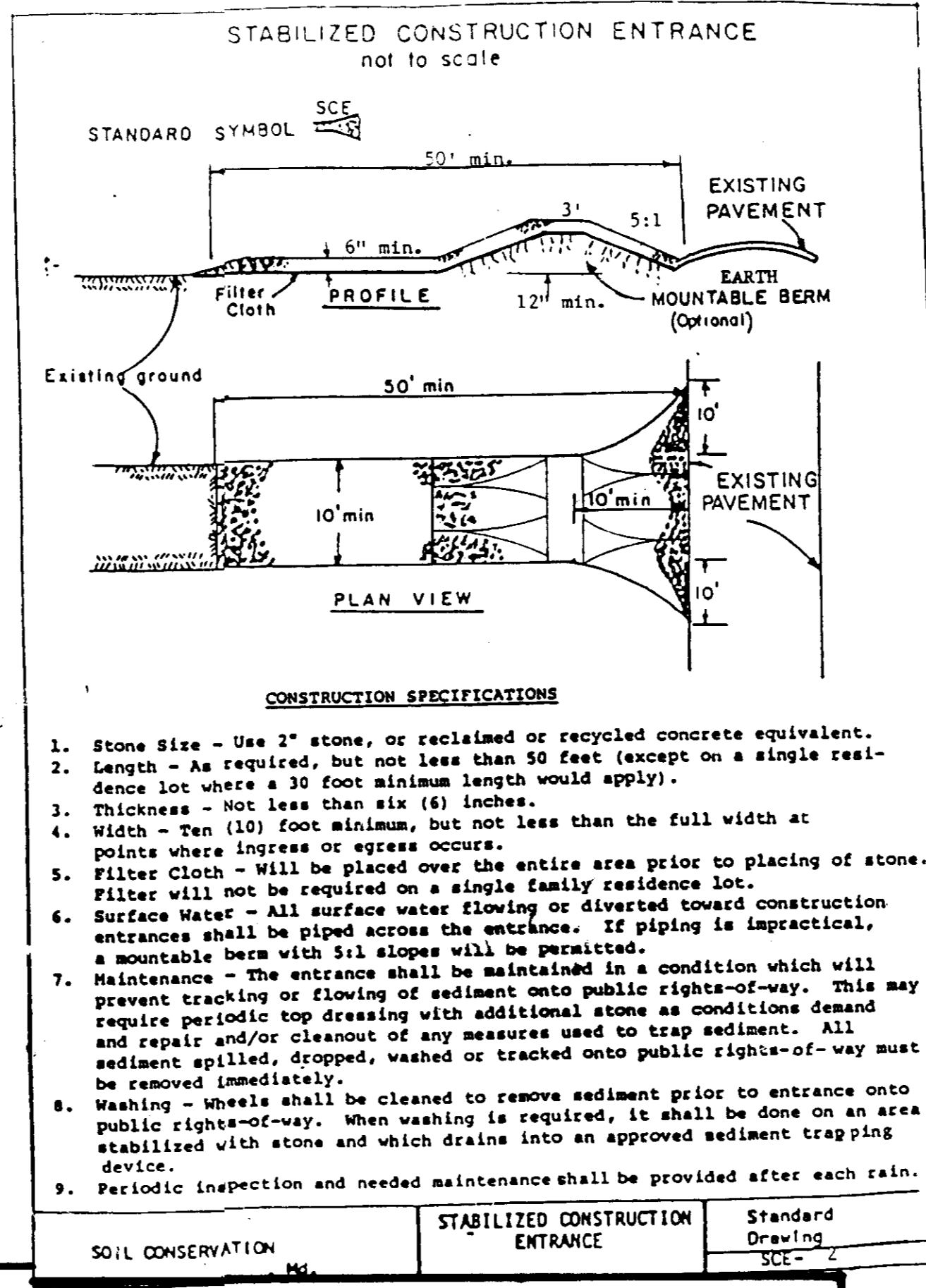
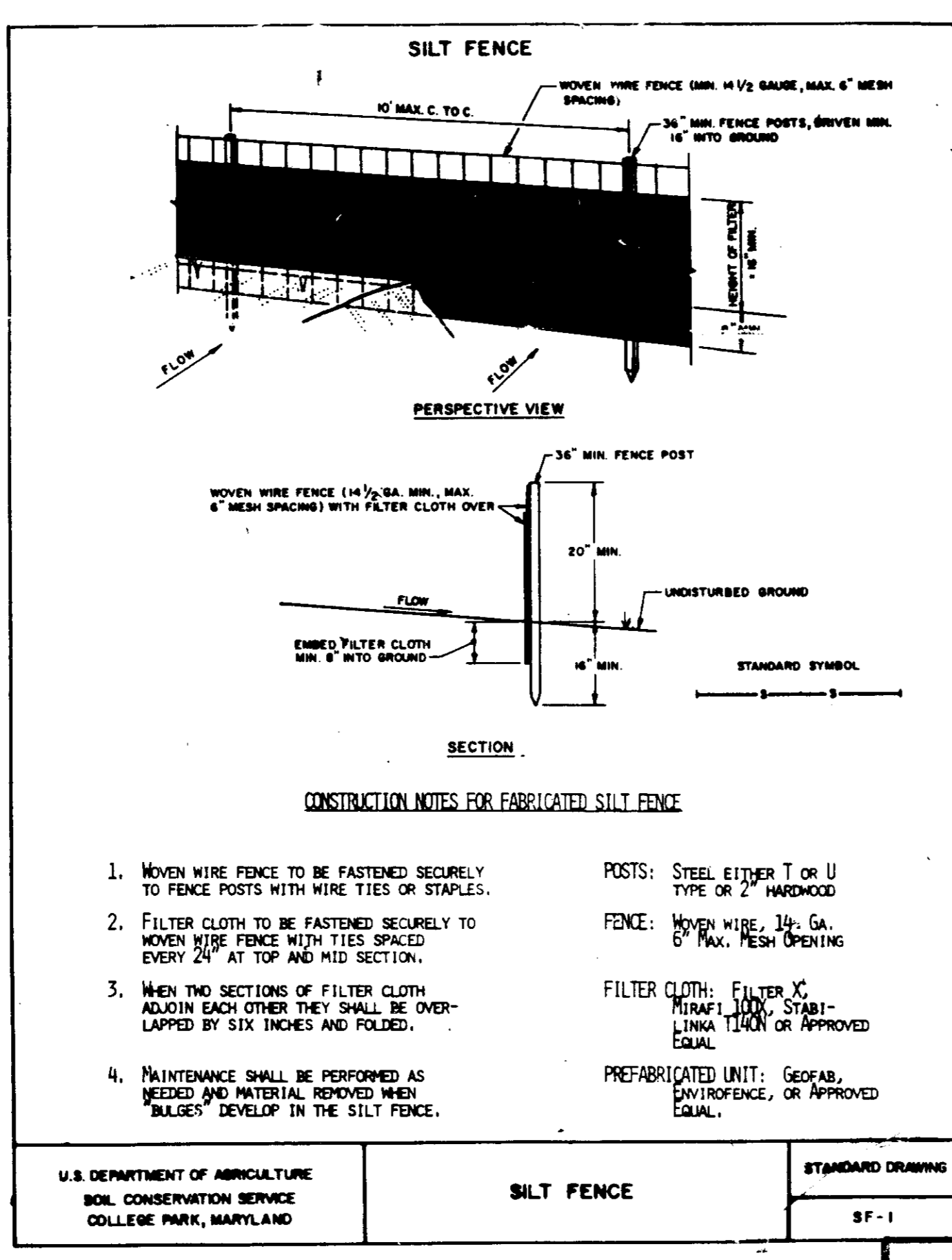
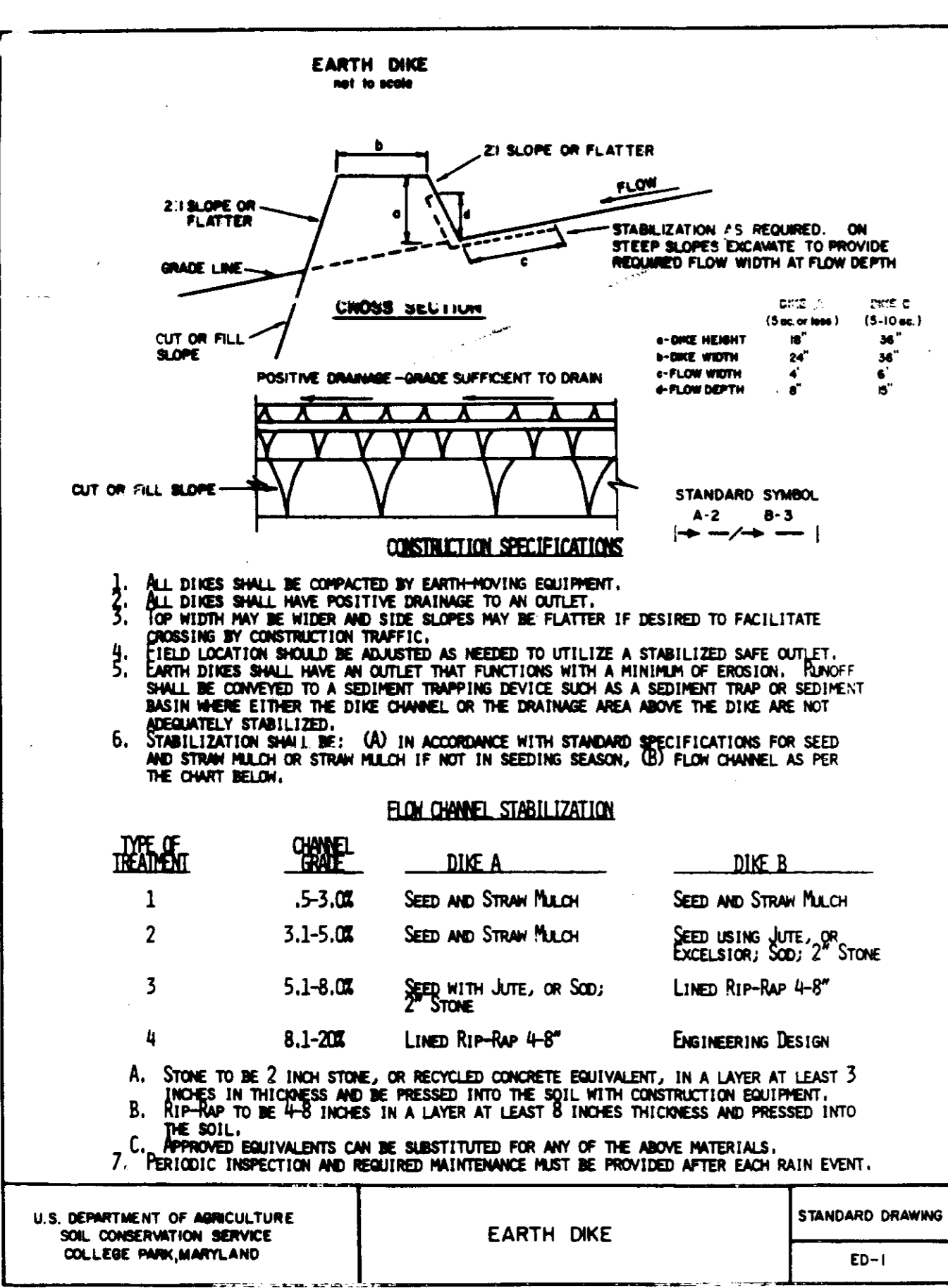

SEQUENCE OF CONSTRUCTION

Work Description	Time
1. OBTAIN GRADING PERMIT.	N/A
2. INSTALL BLAZE ORANGE PLASTIC MESH TREE PROTECTION DEVICE AS SHOWN ON SHEET 3 OF 3.	1 Day
3. REPAIR AS NECESSARY EXISTING SEDIMENT AND EROSION CONTROL DEVICES AND INSTALL ADDITION CONTROLS AS SHOWN ON SHEET 3 OF 3.	4 Days
4. EXCAVATE FOR FOUNDATIONS.	60 Days
5. CONSTRUCT HOUSES, SIDEWALKS AND DRIVEWAYS.	200 Days
6. FINAL GRADE AND STABILIZE THE DISTURBED AREA WITH PERMANENT VEGETATIVE COVER IN ACCORDANCE WITH STANDARDS AND SPECIFICATIONS.	5 Days
7. UPON APPROVAL OF THE SEDIMENT CONTROL INSPECTOR, REMOVE SEDIMENT AND EROSION CONTROLS.	5 Days
TOTAL	278 Days

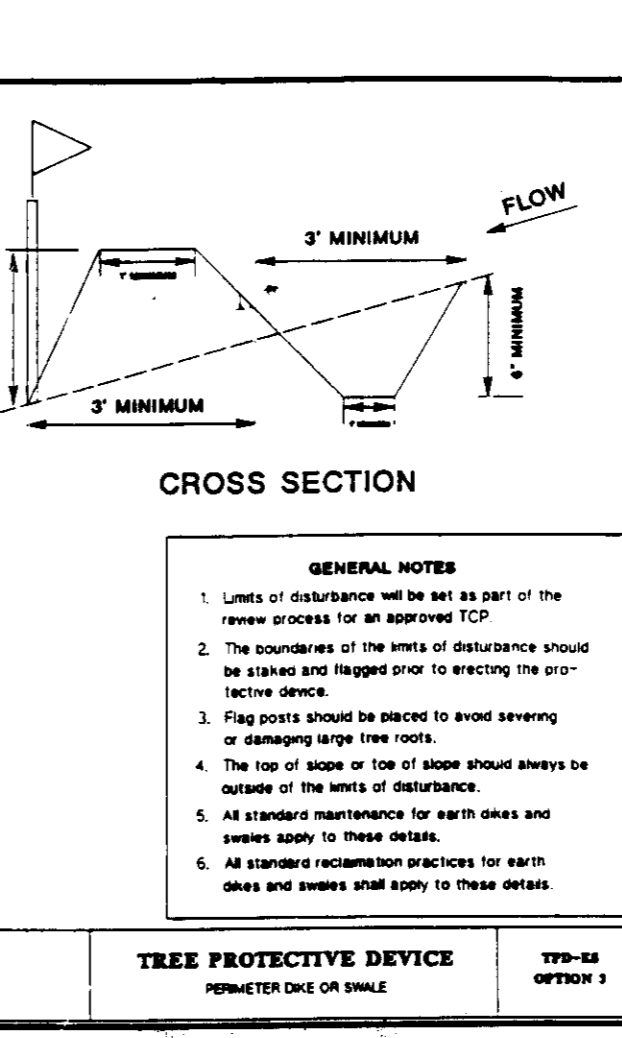

THIS DEVELOPMENT PLAN IS APPROVED FOR SOIL EROSION AND SEDIMENT CONTROL BY THE HOWARD SOIL CONSERVATION DISTRICT.

Approved: *[Signature]* Date: 7/2/93
Howard S. G.D.

Reviewed for HOWARD Name: S.C.U. and meets Technical Requirements
[Signature] Date: 7/2/93
U.S. Soil Conservation Service

DEVELOPER'S / BUILDER'S CERTIFICATE

I/WE CERTIFY THAT ALL DEVELOPMENT AND CONSTRUCTION WILL BE DONE ACCORDING TO THIS PLAN OF DEVELOPMENT AND PLAN FOR EROSION AND SEDIMENT CONTROL AND THAT ALL RESPONSIBLE PERSONNEL INVOLVED IN THE CONSTRUCTION PROJECT WILL HAVE A CERTIFICATE OF ATTENDANCE AT THE MARYLAND DEPARTMENT OF ENVIRONMENT APPROVED TRAINING PROGRAM FOR THE CONTROL OF SEDIMENT AND EROSION BEFORE BEGINNING THE PROJECT. I ALSO AUTHORIZE PERIODIC ONSITE INSPECTION BY THE HOWARD SOIL CONSERVATION DISTRICT OR THEIR AUTHORIZED AGENTS, AS ARE DEEMED NECESSARY.

[Signature] UP
DAVID R. PRIDDY, VICE PRESIDENT
LOVELL - REGENCY HOMES

2/26/93
DATE

ENGINEER'S CERTIFICATE

I HEREBY CERTIFY THAT THIS PLAN FOR EROSION AND SEDIMENT CONTROL REPRESENTS A PRACTICAL AND WORKABLE PLAN BASED ON MY PERSONAL KNOWLEDGE OF THE SITE CONDITIONS AND THAT IT WAS PREPARED IN ACCORDANCE WITH THE REQUIREMENTS OF THE HOWARD SOIL CONSERVATION DISTRICT.

[Signature]
RAM T. BATTI
REGISTERED PROFESSIONAL ENGINEER
MARYLAND NO. 11643

1-21-93
DATE

APPROVED: FOR PUBLIC WATER AND PUBLIC SEWERAGE SYSTEMS, HOWARD COUNTY HEALTH DEPT.
[Signature] DATE: 10/14/93
COUNTY HEALTH OFFICER

APPROVED: HOWARD COUNTY DEPT. OF PLANNING & ZONING.
[Signature] DATE: 10/21/93
PLANNING DIRECTOR

APPROVED: FOR PUBLIC WATER AND PUBLIC SEWERAGE, STORM DRAINAGE SYSTEMS AND PUBLIC ROADS. HOWARD COUNTY DEPT. OF PUBLIC WORKS.
[Signature] DATE: 10/21/93
DIRECTOR

[Signature] DATE: 10/18/93
CHIEF BUREAU OF ENGINEERING

OWNER:
JNDC LIMITED PARTNERSHIP
% NEWBURN DEVELOP CORP
GENERAL PARTNER
5570 STERRET PLACE #201
COLUMBIA, MD. 21044

CONTRACT PURCHASER:
LOVELL REGENCY HOMES
LIMITED PARTNERSHIP
49 OLD SOLOMONS ISLAND ROAD
SUITE 301
ANNAPOLIS, MD. 21401

REVISIONS
REV. 7-29-92

SHAFER BATTI & ASSOC., INC.
ENGINEERS-LAND PLANNERS-SURVEYORS
904 WIND RIVER LANE
GAITHERSBURG, MARYLAND 20878
(301) 417-0344

REVISIONS
REV. 7-29-92

SHAFER BATTI & ASSOC., INC.
ENGINEERS-LAND PLANNERS-SURVEYORS
904 WIND RIVER LANE
GAITHERSBURG, MARYLAND 20878
(301) 417-0344

REVISIONS
REV. 7-29-92

SHAFER BATTI & ASSOC., INC.
ENGINEERS-LAND PLANNERS-SURVEYORS
904 WIND RIVER LANE
GAITHERSBURG, MARYLAND 20878
(301) 417-0344

DETAIL SHEET
LOTS 18-41
HANOVER CROSSING (SECTION TWO)
1ST ELECTION DISTRICT
HOWARD COUNTY, MARYLAND

SCALE: AS NOTED

DECEMBER, 1992

500 93-104