

**LEGEND**

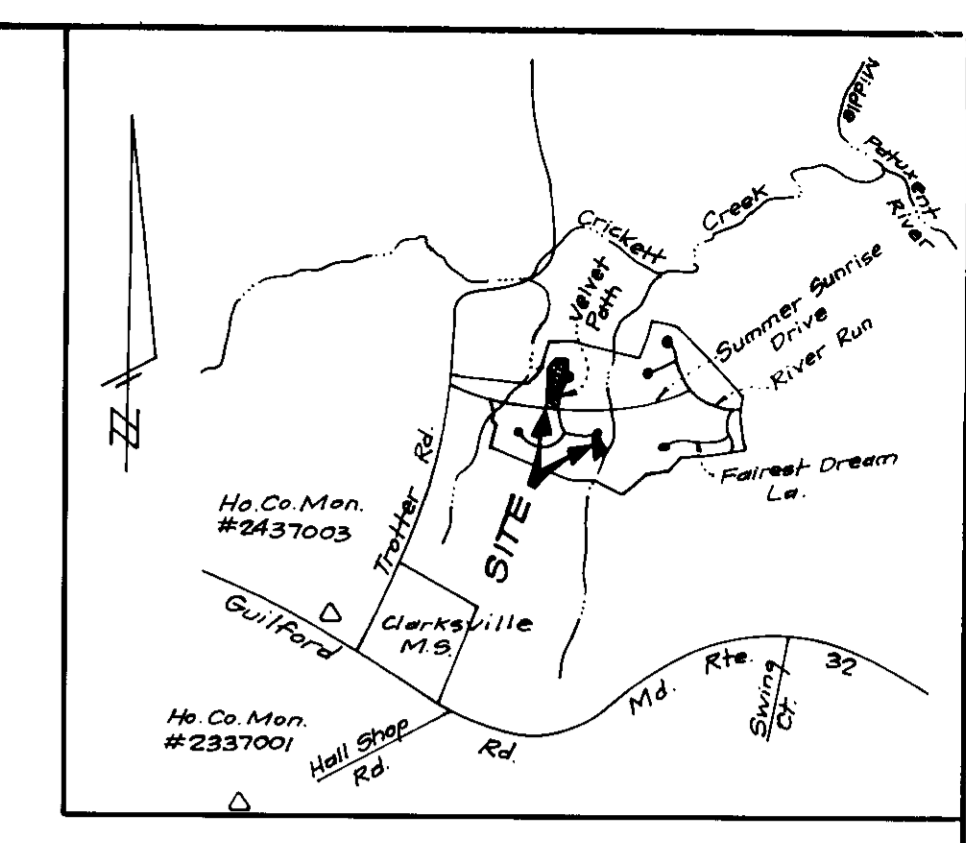
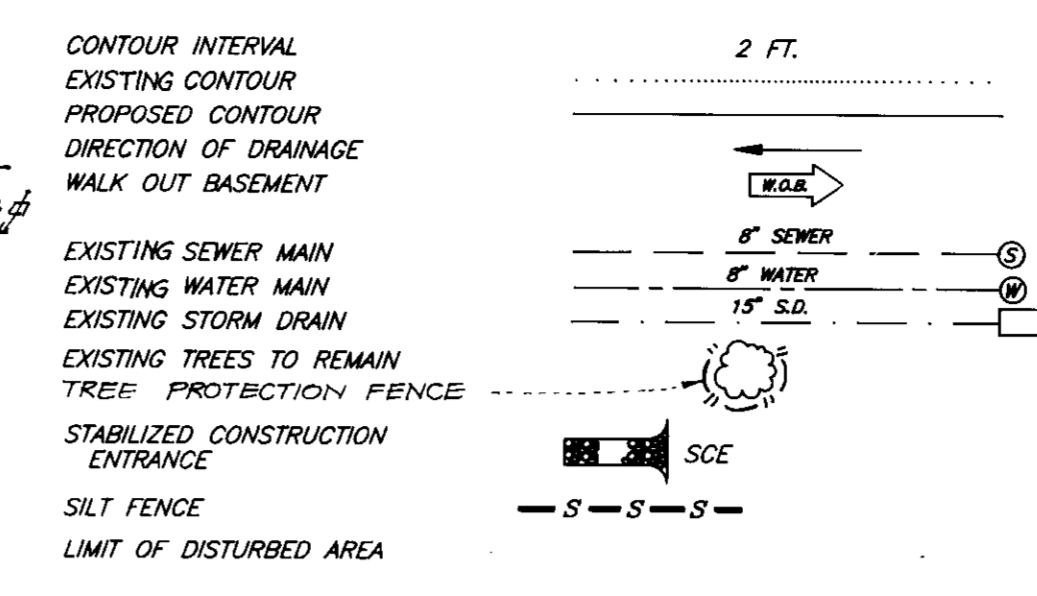

**VICINITY MAP**  
SCALE: 1"=2000'

**GENERAL NOTES:**

- Subject property is zoned: NTSFLD per 8-2-85 Comprehensive Zoning Plan and FDP Phase 203, Phase I.
- The total area included in this submission is: 75,959 sq. ft. = 1.74 Ac.
- The total number of lots included in this submission are: 7.
- Improvement to property: Single family detached.
- The maximum lot coverage permitted is: 30%.
- Department of Planning and Zoning reference file numbers are: S-91-03, P-92-13, WP-92-13, F-93-18, W/P-92-13 to 1000 sq. ft. deck to be added to each lot and 1000 sq. ft. deck to be added to each lot.
- Utilities shown as existing are taken from approved water and sewer plan Contract # 34-3204-D, approved road construction plans F-93-18, and actual field survey.
- Any damage to county owned rights-of-way shall be corrected at the developer's expense.
- Storm water management is provided per: F-93-18 Detention for Quantity Control, Extended Detention for Quantity Control. All roadways are public and existing.
- The existing topography was taken from plans prepared by Riemer Muegge and Assoc., Inc. dated Dec., 1992.
- The coordinates shown hereon are based upon the Howard County Geodetic Control which is based upon the Maryland State Plane Coordinate System - Howard County Monument Nos.: 2337001, 2337002 and 2437003.
- The contractor shall notify the Department of Public Works/Bureau of Construction Inspection a (410) 313-1810 at least five (5) working days prior to the start of work.
- The contractor shall notify "Miss Utility" at 1-800-257-7777 at least 48 hours prior to any excavation work.
- Porches, decks, open or enclosed may project not more than three (3) feet into the front or rear setback.
- The wetland/stream buffer indicated on the plan prohibits subsequent clearing, grading or construction in the buffer area. Maintenance of residences, landscaping and utilities is permitted.
- For driveway entrance details refer to Howard County Design Manual Volume II Std. Details R-6.01, R-6.03 and R-6.05.

**SPECIAL NOTES:**

- This plan is for house siting and lot grading only. Improvements shown within the rights-of-way on this S.D.P. are not to be used for construction. For construction, see approved Road Construction Plans F-93-18 and/or approved Water and Sewer Plans Contract # 34-3204-D. SMC elevations shown are located at the property line.
- WP 92-13 was a waiver request to permit creation of cul-de-sac streets with lengths in excess of 1200 Feet.

ADDRESS CHART	
LOT NUMBER	STREET ADDRESS
1	6301 VELVET PATH
2	6305 VELVET PATH
3	6309 VELVET PATH
4	6313 VELVET PATH
5	6317 VELVET PATH
6	6321 VELVET PATH
98	6328 ANGEL ROSE COURT

**SHEET INDEX**

Sheet 1 - Site Development Plan, Sediment & Erosion Control Plan  
Sheet 2 - Detail Sheet

SUBMISSION NAME	SECTION/AREA	LOTS/PARCELS
COLUMBIA VILLAGE OF RIVER HILL	2/1	1 - 6 & 98
PLAT NO. 10843-10848	BLOCK NO. 14	ZONE NTSFLD
TAX MAP NO. 35	ELECTION DIST. 5TH	CONDUIT TRACT 6055
WATER CODE I-12	SEWER CODE 6652500	

**CLARK • FINEFROCK & SACKETT, INC.**  
ENGINEERS • PLANNERS • SURVEYORS  
7135 MINTREL WAY • COLUMBIA, MD 21045 • (410) 381-7500 • BALTO. • (301) 621-8100 • WASH.

DESIGNED	VLP	SCALE
DRAWN	BAL	1" = 30'
CHECKED	JME	DRAWING
DATE	March 1993	1 OF 2
		JOB NO.
		93-048
		FILE NO.
		93-048-X

No.	REVISIONS	Date
7	Rev. hse. & grad. lot 6, Add hse. type	1/18/93
6	Reverse house and Revise grad. lot 2	1/18/93
5	Raise house lot 4	10/27/92
4	Rev. hse. & grad. lot 2, Add hse. typical	6/6/92
3	Rev. hse. & grad. lot 4, Add hse. typical	5/6/92
2	Rev. hse. & grad. lot 1, Add hse. typical	3/8/92
1	Rev. hse. & grad. lots 3 & 5, Add hse. typical	9/6/92

**DEVELOPER/BUILDER'S CERTIFICATE**  
I/We certify that all development and construction will be done according to this plan of development and plan for erosion and sediment control and that all responsible personnel involved in the construction project will have a Certificate of Attendance at a Dept. of the Environment Approved Training Session for the Control of Erosion and Sediment before beginning the project. I/We also authorize periodic on-site inspection by the Howard Soil Conservation District or their authorized agents, as are deemed necessary.  
*John P. Nelson*  
Signature of Developer/Builder  
3-26-93  
Date

**ENGINEER'S CERTIFICATE**  
I hereby certify that this plan for Erosion and Sediment Control represents a practical and workable plan based on my personal knowledge of the site conditions and that it was prepared in accordance with the requirements of the Howard Soil Conservation District.  
*G. Nelson Clark*  
Signature  
3-25-93  
Date



Reviewed for HOWARD COUNTY S.C.D. Name: *Howard County S.C.D.*  
and meets Technical Requirements  
*John M. Kelly*  
Signature  
7/6/93  
Date  
U.S. Soil Conservation Service  
THIS DEVELOPMENT PLAN IS APPROVED FOR SOIL EROSION AND SEDIMENT CONTROL BY THE HOWARD SOIL CONSERVATION DISTRICT.  
*John M. Kelly*  
Signature  
7/6/93  
Date

APPROVED: FOR PUBLIC WATER AND PUBLIC SEWERAGE SYSTEMS, HOWARD COUNTY HEALTH DEPARTMENT  
*John M. Kelly*  
COUNTY HEALTH OFFICER  
7-14-93  
DATE  
APPROVED: HOWARD COUNTY DEPT. OF PLANNING & ZONING  
*John M. Kelly*  
DIRECTOR  
7/21/93  
DATE  
*John M. Kelly*  
CHIEF DIVISION OF DEVELOPMENT AND RESEARCH  
7/30/93  
DATE  
APPROVED: FOR PUBLIC WATER AND PUBLIC SEWERAGE, STORM DRAINAGE SYSTEMS AND PUBLIC ROADS, HOWARD COUNTY DEPARTMENT OF PUBLIC WORKS  
*John M. Kelly*  
DIRECTOR  
7/13/93  
DATE  
*John M. Kelly*  
CHIEF BUREAU OF ENGINEERING  
7/12/93  
DATE

**SEDIMENT AND EROSION CONTROL NOTES**

- A minimum of 24 hours notice must be given to the Howard County Office of Inspection and Permits prior to the start of any construction. (303-1895).
- All vegetative and structural practices are to be installed according to the provisions of this plan and are to be in conformance with the 1983 MARYLAND STANDARDS AND SPECS. FOR SOIL EROSION AND SEDIMENT CONTROL.
- Following initial soil disturbance or re disturbance, permanent or temporary stabilization shall be completed within: a) 7 calendar days for all perimeter sediment control structures, dikes, perimeter slopes and all slopes greater than 3:1, b) 14 days as to all other disturbed or graded areas on the project site.
- All sediment traps/basins must be fenced and warning signs posted around their perimeters in accordance with Vol. 1, Chapter 12, of the HOWARD COUNTY DESIGN MANUAL, Storm Drainage.
- All disturbed areas must be stabilized within the time period specified above in accordance with the 1983 MARYLAND STANDARDS AND SPECIFICATIONS FOR SOIL EROSION AND SEDIMENT CONTROL for permanent seedings (Sec.51) and (Sec.54), temporary seeding (Sec.50) and mulching (Sec.52). Temporary stabilization with mulch alone can only be done when recommended seeding dates do not allow for proper germination and establishment of grasses.
- All sediment control structures are to remain in place and are to be maintained in operative condition until permission for their removal has been obtained from the Howard County Sediment Control Inspector.
- SITE ANALYSIS:
 

Total Area of Site:	1.74 AC.
Area Disturbed:	1.61 AC.
Area to be roofed or paved:	0.66 AC.
Area to be vegetatively stabilized:	0.95 AC.
Total Cut:	8085 CU.
Total Fill:	8085 CU.

 Offsite Waste/Borrow Area Location:  
 Any sediment control practice which is disturbed by grading activity for placement of utilities must be repaired on the same day of disturbance.  
 Additional sediment control must be provided, if deemed necessary by the Howard County DPW Sediment Control Inspector. On all sites with disturbed areas in excess of 2 acres, approval of the inspection agency shall be requested upon completion of installation of perimeter erosion and sediment controls, but before proceeding with any other earth disturbance or grading. Other building or grading inspection approvals may not be authorized until this initial approval by the inspection agency is made.  
 If houses are to be constructed on an "as sold" basis, at random, Single Family Sediment Control, as shown below shall be implemented.  
 All pipes to be blocked at the end of each day (see detail this sheet).  
 The total amount of silt fence = 1,200 LF

\* It is the responsibility of the contractor to identify the spoil/borrow site and notify and gain approval from the sediment control inspector of the site and it's grading permit number at the time of construction.

**CONSTRUCTION SEQUENCE:**

	NO. OF DAYS
A. Obtain grading permit	7
B. Install tree protection fence.	7
C. Install sediment and erosion control devices and stabilize.	14
D. Excavate for foundations, rough grade and temporarily stabilize.	30
E. Construct structures, sidewalks and driveways.	60
F. Final grade and stabilize in accordance with Stds. and Specs.	14
G. Upon approval of the sediment control inspector, remove sediment and erosion control devices and stabilize.	7

**PERMANENT SEEDING NOTES**

APPLY TO GRADED OR CLEARED AREAS NOT SUBJECT TO IMMEDIATE FURTHER DISTURBANCE WHERE A PERMANENT LONG-LIVED VEGETATIVE COVER IS NEEDED.

**SEEDBED PREPARATION:** Loosen upper three inches of soil by raking, disking or other acceptable means before seeding, if not previously loosened.

**SOIL AMENDMENTS:** In lieu of soil test recommendations, use one of the following schedules:  
 1) Preferred - Apply 2 tons per acre dolomitic limestone (92 lbs./1000 sq ft.) and 600 lbs. per acre 10-10-10 fertilizer (14 lbs./1000 sq ft.) before seeding. Harrow or disc into upper three inches of soil. At the time of seeding, apply 400 lbs. per acre 30-0-0 ureaform fertilizer (9 lbs./1000 sq ft.).  
 2) Acceptable - Apply 2 tons per acre dolomitic limestone (92 lbs./1000 sq ft.) and 1000 lbs. per acre 10-10-10 fertilizer (23 lbs./1000 sq ft.) before seeding. Harrow or disc into upper three inches of soil.

**SEEDING:** For the periods March 1 thru April 30, and August 1 thru October 15, seed with 60 lbs per acre (1.4 lbs./1000 sq ft) of Kentucky 31 Tall Fescue. For the period May 1 thru July 31, seed with 60 lbs. Kentucky 31 Tall Fescue per acre and 2 lbs per acre (.05 lbs./1000 sq ft) of weeping lovegrass. During the period of October 16 thru February 28, protect site by: Option (1) 2 tons per acre well anchored straw mulch and seed as soon as possible in the spring. Option (2) Use sod. Option (3) Seed with 60 lbs/acre Kentucky 31 Tall Fescue and mulch with 2 tons/acre well anchored straw.

**MULCHING:** Apply 1 1/2 to 2 tons per acre (70 to 90 lbs./1000 sq ft) of unrattled small grain straw immediately after seeding. Anchor mulch immediately after application using mulch anchoring tool or 218 gallons per acre (5 gal/1000 sq ft) of emulsified asphalt on flat areas. On slopes 8 feet or higher, use 348 gallons per acre (8 gal/1000 sq ft) for anchoring.

**MAINTENANCE:** Inspect all seeded areas and make needed repairs, replacements and reseeds.

**TEMPORARY SEEDING NOTES**

**SEEDBED PREPARATION:** Loosen upper three inches of soil by raking, disking, or other acceptable means before seeding, if not previously loosened.

**SOIL AMENDMENTS:** Apply 600 lbs per acre 10-10-10 fertilizer (14 lbs./1000 sq ft).  
**SEEDING:** For periods March 1 thru April 30 and from August 15 thru November 15, seed with 2 1/2 bushels per acre of annual ryegrass (3.2 lbs./1000 sq ft). For the period May 1 thru August 14, seed with 3 lbs per acre of weeping lovegrass (.07 lbs./1000 sq ft). For the period November 16 thru February 28, protect site by applying 2 tons per acre of well anchored straw mulch and seed as soon as possible in the spring, or use sod.  
**MULCHING:** Apply 1 1/2 to 2 tons per acre (70 to 90 lbs./1000 sq ft) of unrattled small grain straw immediately after seeding. Anchor mulch immediately after application using mulch anchoring tool or 218 gallons per acre (5 gal/1000 sq ft) of emulsified asphalt on flat areas. On slopes 8 feet or higher, use 348 gallons per acre (8 gal/1000 sq ft) for anchoring.

REFER TO THE 1983 MARYLAND STANDARDS AND SPECIFICATIONS FOR SOIL EROSION AND SEDIMENT CONTROL FOR RATE AND METHODS NOT COVERED.

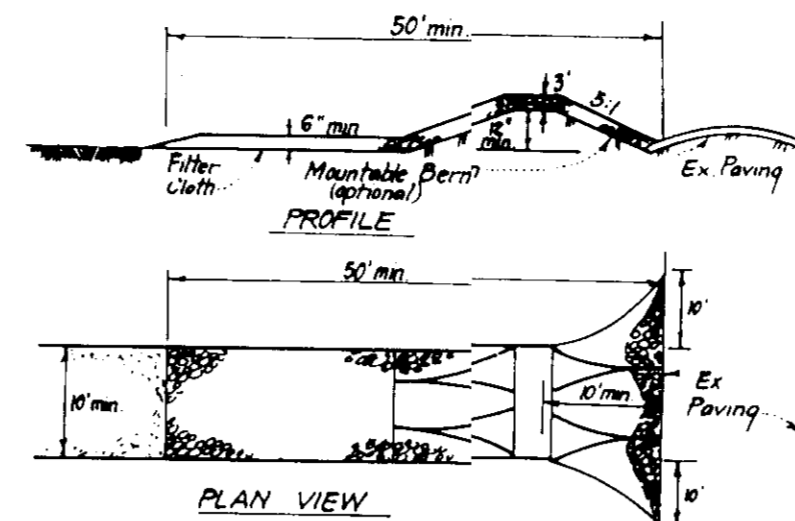

- CONSTRUCTION SPECIFICATIONS:**
- Stone size - Use 2" stone or reclaimed or recycled concrete equivalent.
  - Length - As required, but not less than 50 feet (except on a simple residence lot where a 30 foot minimum length would apply).
  - Thickness - Not less than six (6) inches.
  - Width - Ten (10) feet minimum, but not less than the full width at points where ditches or gorges occur.
  - Filter Cloth - Will be placed over the entire area prior to placing of stone. Filter will not be required on a simple family residence lot.
  - Surface Water - All surface water flowing or diverted toward construction entrance shall be piped across the entrance. If piping is impractical, a maintainable berm with 5:1 slopes will be permitted.
  - Maintenance - The entrance shall be maintained in a condition which will prevent tracking or flowing of sediment onto public right-of-way. This may require periodic top dressing with additional stone as conditions demand and repair and/or cleanup of any material carried to trap equipment. All sediment which is tracked, washed or tracked onto public right-of-way must be removed immediately.
  - Warning - Signs shall be placed to warn sediment prior to entrance onto public right-of-way. When warning is required, it shall be done on an area stabilized with stone and which drains into an approved sediment trapping device.
  - Periodic inspection and needed maintenance shall be provided after each rain.

**STABILIZED CONSTRUCTION ENTRANCE (SCE)**

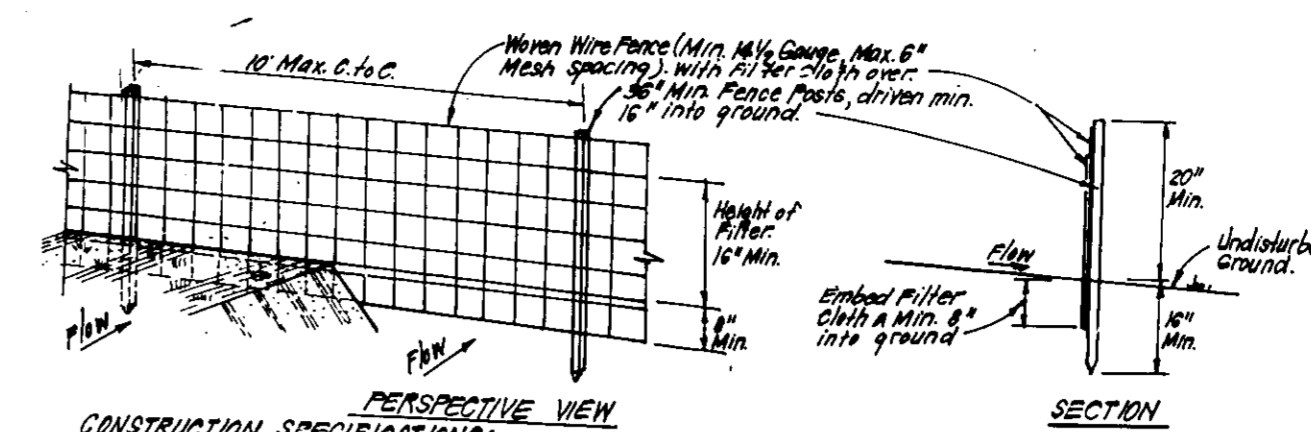
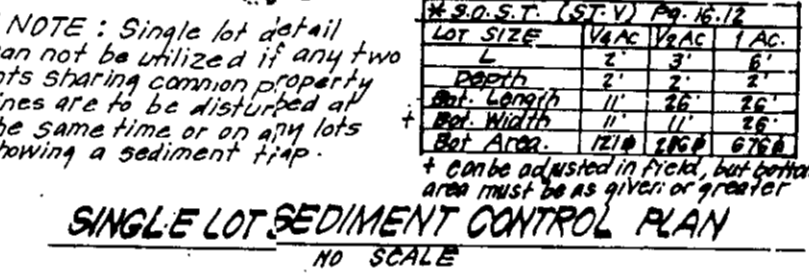
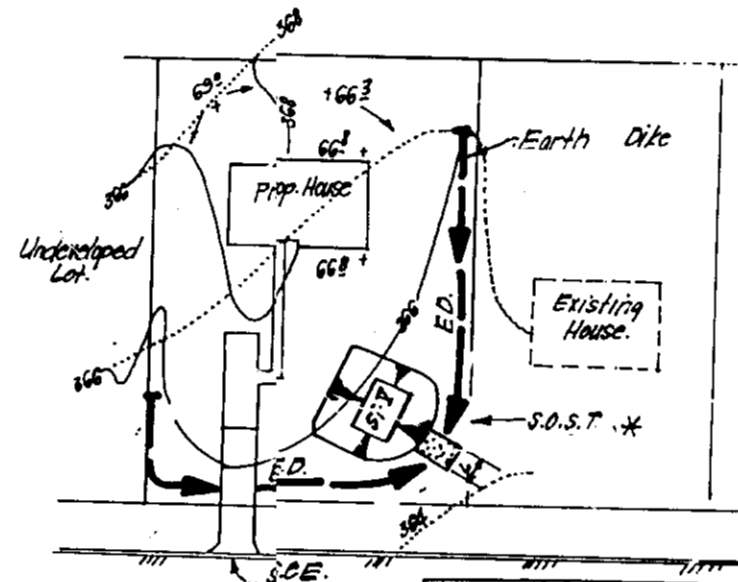

- CONSTRUCTION SPECIFICATIONS:**
- Woven wire fence to be installed accurately to fence posts with wire first of staples.
  - Filter cloth to be fastened securely to woven wire fence with 1/2\"/>
- POSTS:** Steel, either T or U Type or 2\"/>

**FENCE:** Woven Wire, 1/4\"/>

**FILTER CLOTH:** Filter Cloth, 1/4\"/>

**PREFABRICATED UNIT:** Geotextile, Envirofence, or approved equal.

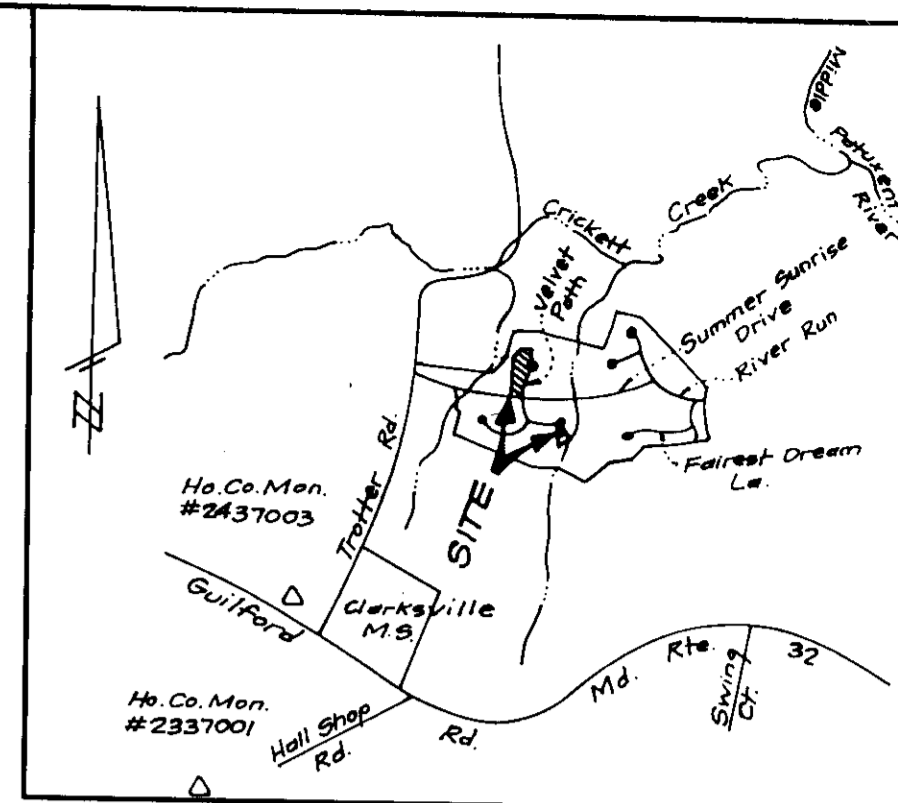
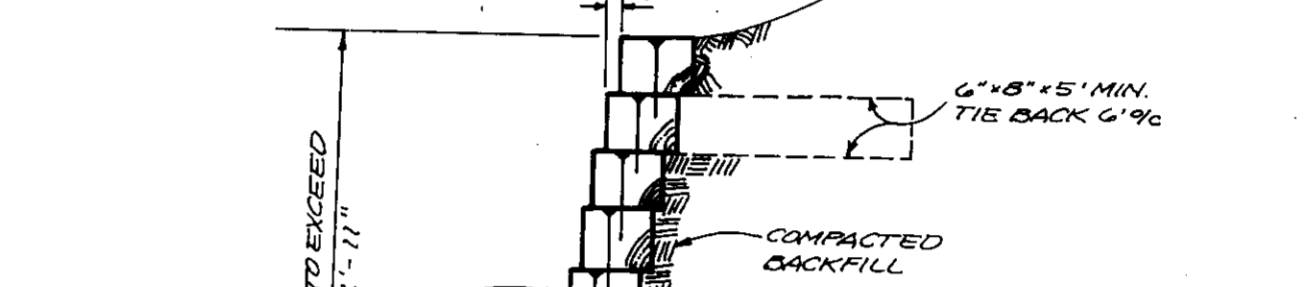

**VICINITY MAP**  
SCALE: 1"=2000'

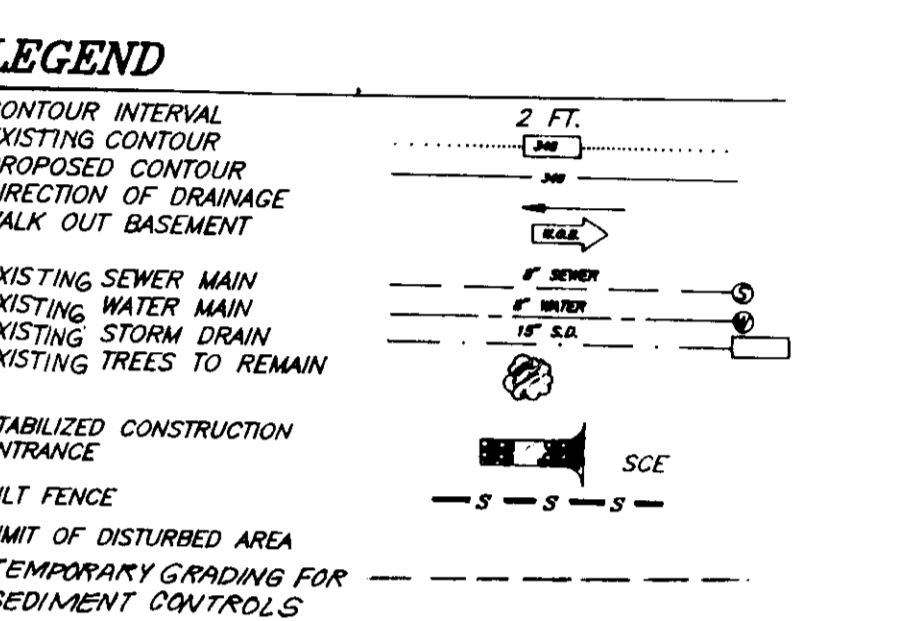

OWNER:  
HOWARD RESEARCH AND DEVELOPMENT CORPORATION  
10275 Little Patuxent Parkway  
Columbia, Maryland 21044

APPROVED: FOR PUBLIC WATER AND PUBLIC SEWERAGE SYSTEMS, HOWARD COUNTY HEALTH DEPARTMENT  
 COUNTY HEALTH OFFICER: James L. Boyd 7/14/93  
 APPROVED: HOWARD COUNTY DEPT. OF PLANNING & ZONING  
 DIRECTOR: Thomas J. Smith 7/21/93  
 CHIEF DIVISION OF DEVELOPMENT AND RESEARCH: Thomas J. Smith 7/20/93  
 APPROVED: FOR PUBLIC WATER AND PUBLIC SEWERAGE, STORM DRAINAGE SYSTEMS AND PUBLIC ROADS, HOWARD COUNTY DEPARTMENT OF PUBLIC WORKS  
 DIRECTOR: James L. Boyd 7/13/93  
 CHIEF BUREAU OF ENGINEERING: James L. Boyd 7/12/93

Reviewed for HOWARD S.C.D. Name: \_\_\_\_\_  
 and meets Technical Requirements of \_\_\_\_\_  
 Signature: James L. Boyd 7/13/93  
 US Soil Conservation Service

**DEVELOPER'S/BUILDER'S CERTIFICATE**  
 "I/we certify that all development and construction will be done according to this plan of development and plan for sediment and erosion control and that all responsible personnel involved in the construction project will have a Certificate of Attendance at a Department of the Environment Approved Training Program for the Control of Sediment and Erosion before beginning the project. I also authorize periodic on-site inspection by the Howard Soil Conservation District or their authorized agents, as are deemed necessary."

**ENGINEER'S CERTIFICATE**  
 I hereby certify that this plan for Sediment and Erosion Control represents a practical and workable plan based on my personal knowledge of the site conditions and that it was prepared in accordance with the requirements of the Howard Soil Conservation District.  
 Signature: G. Nelson Clark 3-25-93  
 Date: 3-25-93

THIS DEVELOPMENT PLAN IS APPROVED FOR SOIL EROSION AND SEDIMENT CONTROL BY THE HOWARD SOIL CONSERVATION DISTRICT.  
 Signature: James L. Boyd  
 Date: 3-26-93

**CLARK • FINEFROCK & SACKETT, INC.**  
 ENGINEERS • PLANNERS • SURVEYORS  
 7135 MINSTREL WAY • COLUMBIA MD 21045 • (301) 381-7500 - BALTO • (301) 621-8100 - WASH.

DESIGNED KIWM	<b>SEDIMENT AND EROSION CONTROL PLAN</b> LOTS 1 THRU 6 AND 98 <b>COLUMBIA</b> VILLAGE OF RIVER HILL SECTION 2 AREA 1 5TH ELECTION DISTRICT HOWARD COUNTY, MARYLAND	SCALE As shown
DRAWN BAL		DRAWING 2 OF 2
CHECKED KIWM		JOB NO. 93-048
DATE March 1993		FILE NO. 93-048SE
		FOR: JOHN McDONOUGH BUILDERS, INC. 6310 Stevens Forest Rd. #104 Columbia, Maryland 21046

SDP 93-88