

LOT NO.	SQ. FT.	LOT NO.	SQ. FT.	LOT NO.	SQ. FT.	LOT NO.	SQ. FT.	LOT NO.	SQ. FT.
F-1	2172	F-14	1892	F-27	1713	F-40	2238	F-53	1872
F-2	2880	F-15	2280	F-28	1888	F-41	2284	F-54	1859
F-3	2880	F-16	2280	F-29	1888	F-42	2284	F-55	2301
F-4	2880	F-17	2280	F-30	1888	F-43	2284	F-56	1872
F-5	2880	F-18	2280	F-31	1888	F-44	2284	F-57	2040
F-6	2880	F-19	2280	F-32	1888	F-45	2284	F-58	2040
F-7	2880	F-20	2280	F-33	1888	F-46	2284	F-59	1872
F-8	2880	F-21	2280	F-34	1888	F-47	2284	F-60	1872
F-9	2880	F-22	2280	F-35	1888	F-48	2284	F-61	1872
F-10	2880	F-23	2280	F-36	1888	F-49	2284	F-62	1872
F-11	2880	F-24	2280	F-37	1888	F-50	2284	F-63	1872
F-12	2880	F-25	2280	F-38	1888	F-51	2284	F-64	1872
F-13	2880	F-26	2280	F-39	1888	F-52	2284	F-65	1872

LOT NO.	ELEV.	LOT NO.	ELEV.	LOT NO.	ELEV.	LOT NO.	ELEV.	LOT NO.	ELEV.
F-1	326.7	F-14	348.7	F-27	367.4	F-40	384.3	F-53	398.5
F-2	326.7	F-15	348.7	F-28	367.4	F-41	384.3	F-54	398.5
F-3	326.7	F-16	348.7	F-29	367.4	F-42	384.3	F-55	398.5
F-4	326.7	F-17	348.7	F-30	367.4	F-43	384.3	F-56	398.5
F-5	326.7	F-18	348.7	F-31	367.4	F-44	384.3	F-57	398.5
F-6	326.7	F-19	348.7	F-32	367.4	F-45	384.3	F-58	398.5
F-7	326.7	F-20	348.7	F-33	367.4	F-46	384.3	F-59	398.5
F-8	326.7	F-21	348.7	F-34	367.4	F-47	384.3	F-60	398.5
F-9	326.7	F-22	348.7	F-35	367.4	F-48	384.3	F-61	398.5
F-10	326.7	F-23	348.7	F-36	367.4	F-49	384.3	F-62	398.5
F-11	326.7	F-24	348.7	F-37	367.4	F-50	384.3	F-63	398.5
F-12	326.7	F-25	348.7	F-38	367.4	F-51	384.3	F-64	398.5
F-13	326.7	F-26	348.7	F-39	367.4	F-52	384.3	F-65	398.5

**LEGEND**

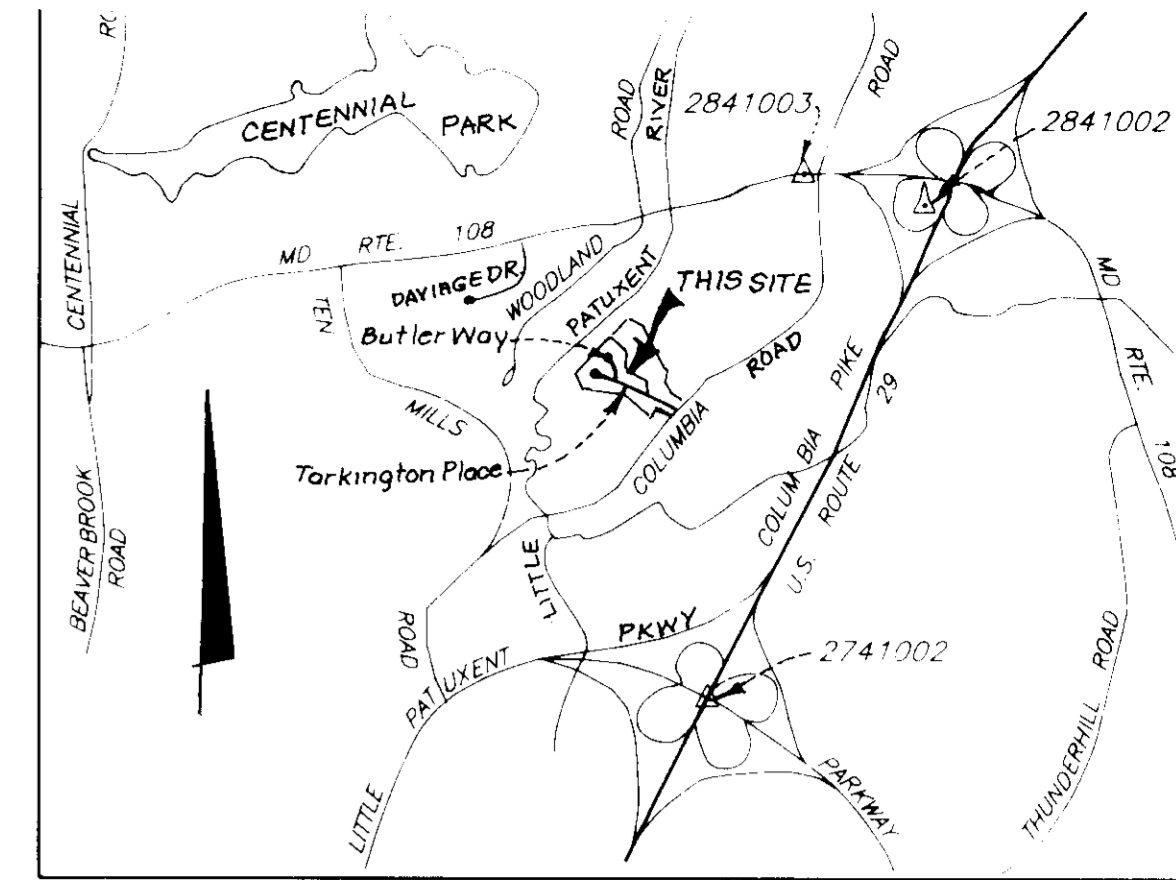
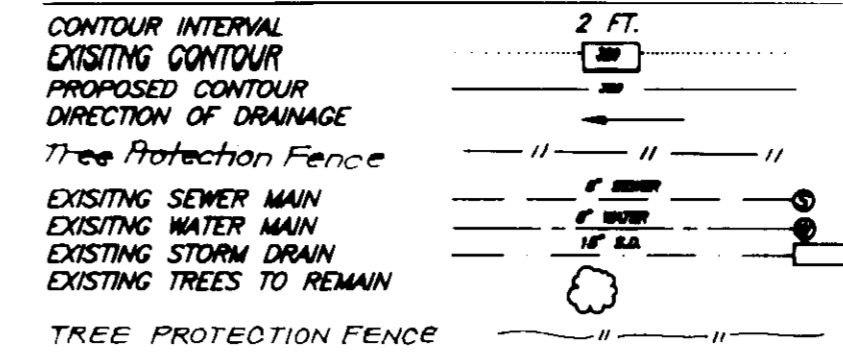

**SHEET INDEX:**

- SHEETS 1 & 2 SITE DEVELOPMENT PLAN
- SHEETS 3 & 4 SEDIMENT & EROSION CONTROL PLANS
- SHEETS 6 & 7 LANDSCAPE PLANS

**GENERAL NOTES:**

- The contractor shall notify the Department of Public Works/Bureau of Construction Inspection a (301) 792-7272 at least five (5) working days prior to the start of work.
- The contractor shall notify "Miss Utility" at 1-800-257-7777 at least 48 hours prior to any excavation work.
- The existing topography shown was taken from F-91-35. The contour interval is 2 feet.
- The coordinates shown hereon are based upon the Maryland State Plane Coordinate System; the origin coordinates values are taken from Howard County Geodetic Control Points Nos. 2841002, 2841003 and 2741002.
- Storm water management is provided per: F-91-35
- Any damage to county owned rights-of-way shall be corrected at the developer's expense.
- Utilities shown as existing are taken from approved water and sewer plan Contract #24-3032 - approved road construction plans F-91-35, and actual field survey.
- Department of Planning and Zoning reference file numbers are: F-86-26, FDP-191-A-1, WP-89-179, S-89-89, P-90-30 and F-91-35, SDP 91-35
- All roadways are public and existing.
- Subject property is zoned: New Town per B-2-85 Comprehensive Zoning Plan.
- The total area included in this submission is: 3.29 Acres. The total number of lots included in this submission are 69.
- The maximum lot coverage is: Nine As per: FDP 191-A-1
- Improvement to property: Single family attached (Fee Simple)
- Based on a wetland assessment conducted by Kiddle Consultants, dated September 24, 1987, No wetlands exist on this parcel.
- Minimum building setback restrictions from the property lines and the rights-of-way lines of any public road is to be in accordance with Final Development Plan-Phase 191-A-1.
- The 100 year flood plain in VODS Section 3 Area 1 has been obtained by reference to the Little Patuxent Hydrology Model, Volume I - Synopsis Attachment Sheets numbered: D-4-1007-227-41, D-4-1007-228-41 and D-4-1007-229-41 as prepared by Century Engineering Inc. from aerial photography dated 1971.
- Environmental Analysis submitted with previously approved sketch plan S-89-89.
- The water and sewer house connections not included in a Developer's Agreement shall conform to Howard County Plumbing Code. The on-site WHC shall be 1" copper and the SHC shall be 4" iron.
- The reduction of the 30 foot BRL from the edge of the public rights-of-way, as stipulated by FDP-191-A-1, to a 20 foot BRL is as approved November 22, 1989 by the Planning Board for units with integral garages
- Improvements shown within the right-of-way on this SDP are not to be used for construction. For construction see F-91-35 and/or contr# 24-3032-D.

**SITE ANALYSIS**

- ZONED: New Town
- Area of Lots: 3.29 Acres
- Number of Units Proposed: 69
- Parking Spaces Required (2 per unit): 138
- Parking Spaces Provided:
 

Private Parking	138
Common Parking	27
<b>Total</b>	<b>165</b>
- Building Coverage: None as per FDP Phase 191-A-1
- Garages shall be used for parking purposes only in accordance with FDP 191-A-1 and Section 127-B-26 (18) of the Hb Co Zoning Regulations
- Type of Unit Proposed: Single Family Attached

**SPECIAL NOTES:**

- This plan is for house siting and lot grading only. Improvements shown within the rights-of-way on this SDP are not to be used for construction. For construction, see approved Road Construction Plans F-91-35 and/or approved Water and Sewer Plans Contract #24-3032-D.
- For Driveway Abutting detail, see Howard County Design Manual for Road Construction No R-6.01 & R-6.03

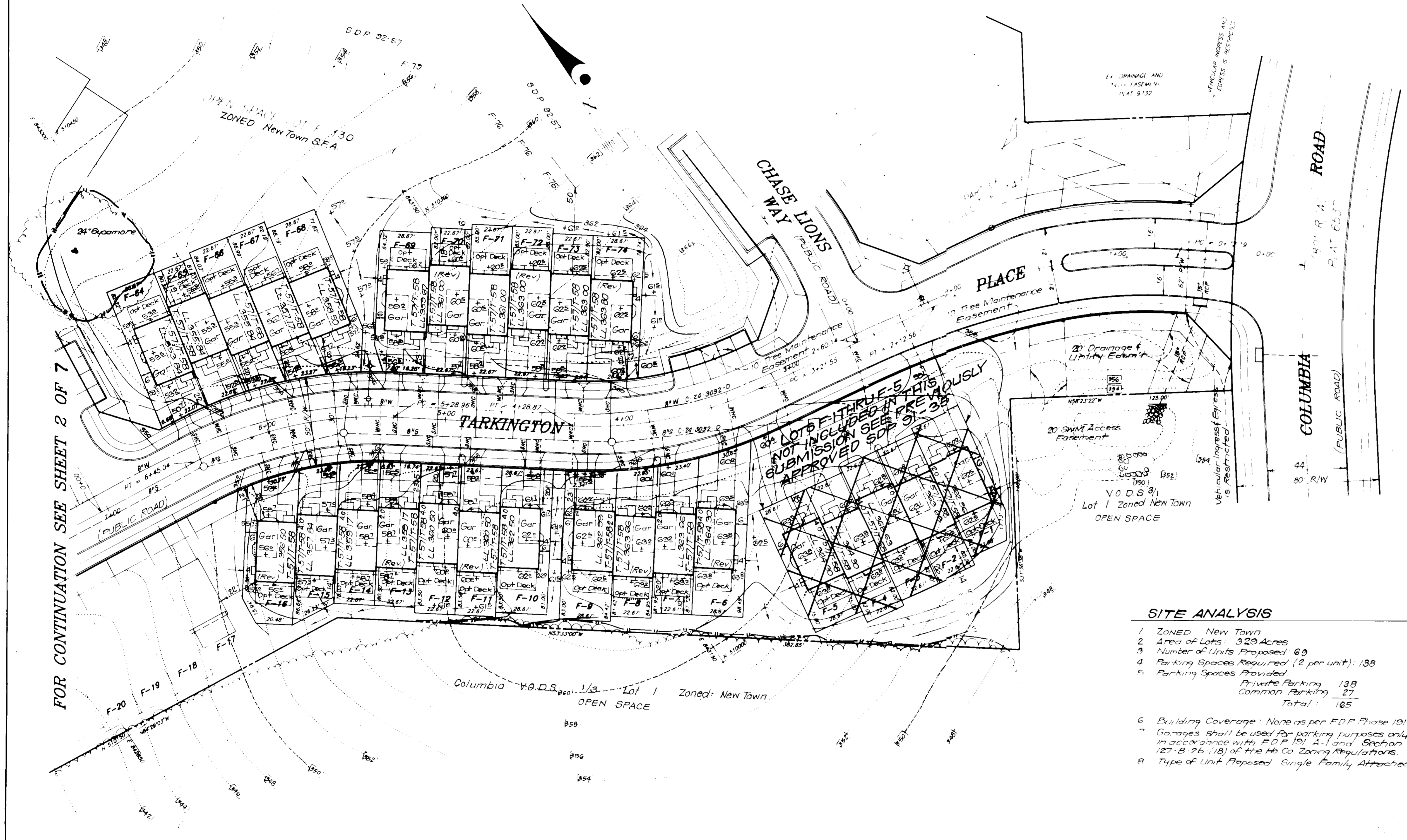

APPROVED FOR PUBLIC WATER AND PUBLIC SEWERAGE SYSTEMS  
 HOWARD COUNTY HEALTH DEPARTMENT  
 COUNTY HEALTH OFFICER: *John Boyd* DATE: 10-8-92

APPROVED: HOWARD COUNTY DEPT OF PLANNING & ZONING  
 DIRECTOR: *Joseph DePinto* DATE: 10/16/92  
 CHIEF DIVISION OF COMMUNITY PLANNING AND LAND DEVELOPMENT

APPROVED: FOR PUBLIC WATER AND PUBLIC SEWERAGE  
 STORM DRAINAGE SYSTEMS AND PUBLIC ROADS  
 HOWARD COUNTY DEPARTMENT OF PUBLIC WORKS  
 DIRECTOR: *Carroll Segan* DATE: 10/2/92  
 CHIEF BUREAU OF ENGINEERING: *Mark S.* DATE: 10-2-92

9-1-92

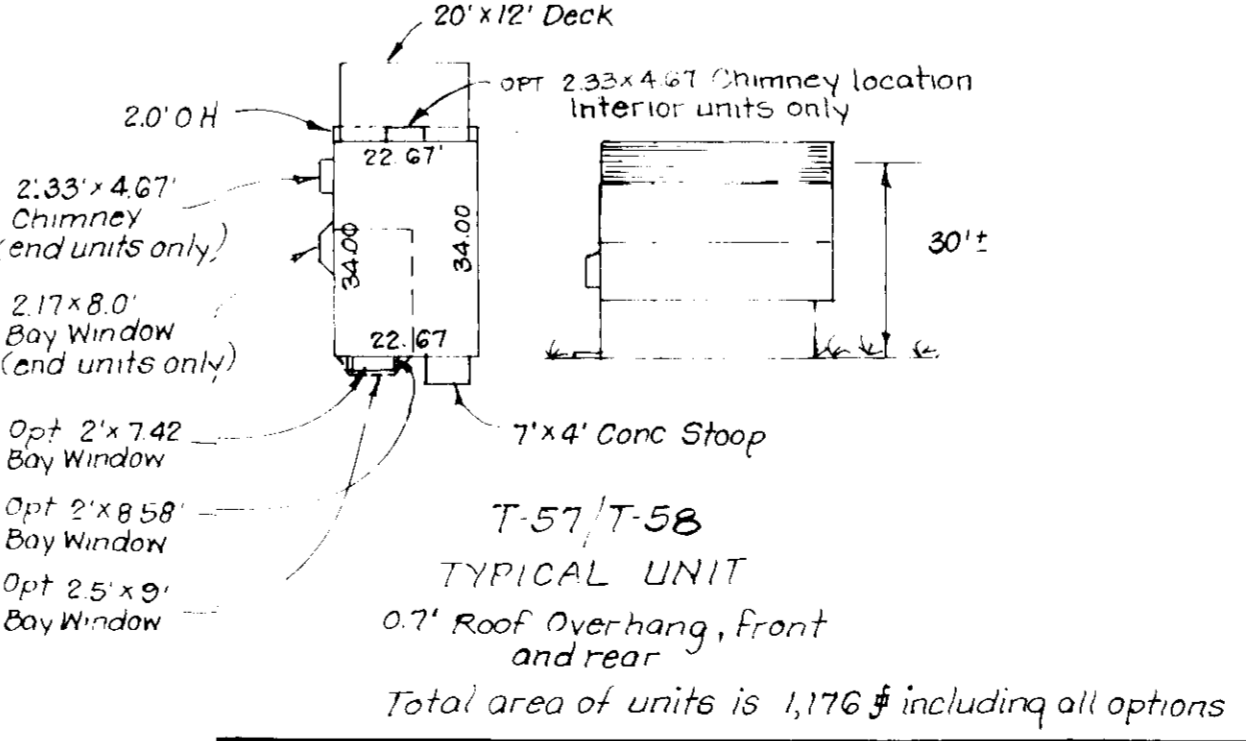

OWNER:  
 HOWARD RESEARCH AND DEVELOPMENT CORPORATION  
 10275 Little Patuxent Parkway  
 Columbia, MD. 21044

PLATS	DATE	CHECKED BY
UNRECORDED		
RECORDED	12 21 92	N/A

SUBDIVISION NAME COLUMBIA VILLAGE OF DORSEY'S SEARCH	SECTION/AREA 3/1	LOTS/PARCELS F-6 Thru F-74
PLAT NO. 9729, 9730 & 9731	BLOCK NO. 37	TAX MAP NO. 30
WATER CODE E01	ELECTION DIST. 5TH	GENESIS TRACER 6054
SEWER CODE 568.0000		

**CLARK • FINEFROG & SACKETT, INC.**  
 ENGINEERS • PLANNERS • SURVEYORS

DESIGNED: VLP  
 DRAWN: BAL, KIMM  
 CHECKED: JME  
 DATE: JULY, 1992

**SITE DEVELOPMENT PLAN  
 LOTS F-6 THRU F-74  
 COLUMBIA  
 VILLAGE OF DORSEY'S SEARCH  
 SECTION 3 AREA 1  
 5TH ELECTION DISTRICT  
 HOWARD COUNTY, MARYLAND**

SCALE: 1" = 30'  
 DRAWING: 1 OF 7  
 JOB NO: 92-075  
 FILE NO: 92-075-X

BUILDER: TRAFALGAR HOUSE RESIDENTIAL MARYLAND  
 8965 GUILFORD ROAD, SUITE 29  
 COLUMBIA, MARYLAND 21746

SDP 93-09

- Notes:
1. Retention shall be within 4' (minimum) limited retention area.
  2. 1/2" (minimum) limited retention area shall be within 4' (minimum) of retention area.
  3. Retention shall be for full depth of retention area.
  4. Retention shall be for full depth of retention area.
  5. Retention shall be for full depth of retention area.
  6. Retention shall be for full depth of retention area.
  7. Retention shall be for full depth of retention area.
  8. Retention shall be for full depth of retention area.
  9. Retention shall be for full depth of retention area.
  10. Retention shall be for full depth of retention area.

When ground water bearing will be possible, place 1/2" of gravel or crushed stone per 1' foot of wall (typ).

RETAINING WALL DETAIL

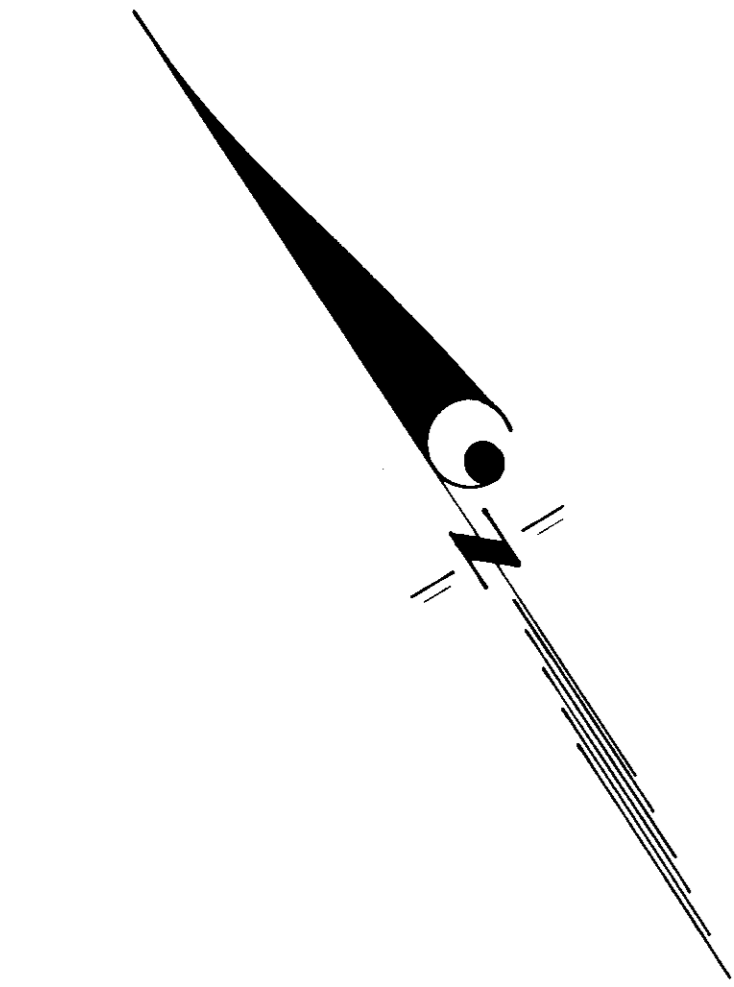
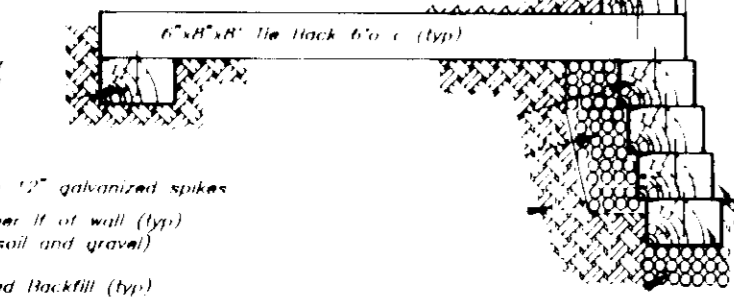

BLAZE ORANGE PLASTIC MESH TYPICAL FENCE DETAIL

- Notes:
1. Fence protection device only.
  2. Retention area will be set on part of the review process.
  3. Boundaries of retention area should be staked and flagged prior to installing device.
  4. Flood damage should be avoided.
  5. Protection signage may also be used.
  6. Device should be maintained throughout construction.

APPROVED FOR PUBLIC WATER AND PUBLIC SEWERAGE SYSTEMS  
HOWARD COUNTY HEALTH DEPARTMENT

*Dean Ford* 10-8-92  
COUNTY HEALTH OFFICER DATE

APPROVED HOWARD COUNTY DEPT OF PLANNING & ZONING

*Emma Howard* 10/16/92  
DATE

*Emma Howard* 10/15/92  
DATE

APPROVED FOR PUBLIC WATER AND PUBLIC SEWERAGE  
STORM DRAINAGE SYSTEMS AND PUBLIC ROADS  
HOWARD COUNTY DEPARTMENT OF PUBLIC WORKS

*Robert S. [Signature]* 10/2/92  
DIRECTOR DATE

*[Signature]* 10-2-92  
CHIEF BUREAU OF ENGINEERING M.K. DATE

9-1-92

VOIDS 1/3 Lot 1, Zones: New Town  
SUNNY FACILITY F-2, F-35  
OPEN SPACE



ADDRESS CHART		
LOT NUMBER	STREET ADDRESS	
F-1	5301 TARKINGTON PLACE	
F-2	5303 TARKINGTON PLACE	
F-3	5305 TARKINGTON PLACE	
F-4	5307 TARKINGTON PLACE	
F-5	5309 TARKINGTON PLACE	
F-6	5313 TARKINGTON PLACE	
F-7	5315 TARKINGTON PLACE	
F-8	5317 TARKINGTON PLACE	
F-9	5319 TARKINGTON PLACE	
F-10	5321 TARKINGTON PLACE	
F-11	5323 TARKINGTON PLACE	
F-12	5325 TARKINGTON PLACE	
F-13	5327 TARKINGTON PLACE	
F-14	5329 TARKINGTON PLACE	
F-15	5331 TARKINGTON PLACE	
F-16	5333 TARKINGTON PLACE	
F-17	5337 TARKINGTON PLACE	
F-18	5339 TARKINGTON PLACE	
F-19	5341 TARKINGTON PLACE	
F-20	5343 TARKINGTON PLACE	
F-21	5345 TARKINGTON PLACE	
F-22	5347 TARKINGTON PLACE	
F-23	5349 TARKINGTON PLACE	
F-24	5341 TARKINGTON PLACE	
F-25	5353 TARKINGTON PLACE	
F-26	5355 TARKINGTON PLACE	
F-27	5357 TARKINGTON PLACE	
F-28	5359 TARKINGTON PLACE	
F-29	5361 TARKINGTON PLACE	
F-30	5363 TARKINGTON PLACE	
F-31	5365 TARKINGTON PLACE	
F-32	5367 TARKINGTON PLACE	
F-33	5369 TARKINGTON PLACE	
F-34	5371 TARKINGTON PLACE	
F-35	5373 TARKINGTON PLACE	
F-36	5366 TARKINGTON PLACE	
F-37	5364 TARKINGTON PLACE	
F-38	5362 TARKINGTON PLACE	
F-39	5360 TARKINGTON PLACE	
F-40	5358 TARKINGTON PLACE	
F-41	5356 TARKINGTON PLACE	
F-42	5342 TARKINGTON PLACE	
F-43	5340 TARKINGTON PLACE	
F-44	5338 TARKINGTON PLACE	
F-45	5336 TARKINGTON PLACE	
F-46	5334 TARKINGTON PLACE	
F-47	5330 TARKINGTON PLACE	
F-48	5328 TARKINGTON PLACE	
F-49	5326 TARKINGTON PLACE	
F-50	5324 TARKINGTON PLACE	
F-51	5322 TARKINGTON PLACE	
F-52	5320 TARKINGTON PLACE	
F-53	5318 TARKINGTON PLACE	
F-54	5316 TARKINGTON PLACE	
F-55	5314 TARKINGTON PLACE	
F-56	5312 TARKINGTON PLACE	
F-57	5310 TARKINGTON PLACE	
F-58	5308 TARKINGTON PLACE	
F-59	5306 TARKINGTON PLACE	
F-60	5304 TARKINGTON PLACE	
F-61	5302 TARKINGTON PLACE	
F-62	5300 BUTLER COURT	
F-63	5300 BUTLER COURT	
F-64	5300 BUTLER COURT	
F-65	5300 BUTLER COURT	
F-66	5300 BUTLER COURT	
F-67	5300 BUTLER COURT	
F-68	5300 BUTLER COURT	
F-69	5300 BUTLER COURT	
F-70	5300 BUTLER COURT	
F-71	5300 BUTLER COURT	
F-72	5300 BUTLER COURT	
F-73	5300 BUTLER COURT	
F-74	5300 BUTLER COURT	

FOR CONTINUATION SEE SHEET 1 OF 7

SUBDIVISION NAME	COLUMBIA	SECTION/AREA	3/1	LOTS/PARCELS	F-1 thru F-74
PLAT NO.	3729, 2730#	BLOCK NO.	9	ELECTION DIST.	5TH
WATER CODE	E01	SEWER CODE	5680000	CENSUS TRACT	G05A

OWNER:  
HOWARD RESEARCH AND  
DEVELOPMENT CORPORATION  
10275 Little Patuxent Parkway  
Columbia, MD. 21044

PLATS	DATE	CHECKED BY
UNRECORDED		
RECORDED	12 21 90	N/A

**CLARK • FINEROCK & SACKETT, INC.**  
ENGINEERS • PLANNERS • SURVEYORS

7115 MINISTERS WAY • COLUMBIA, MD. 21045 • (410) 481-7500 • BALTIMORE, MD. 21201 • WASHINGTON, D.C. 20004

DESIGNED: VLP  
DRAWN: BAL  
CHECKED: KTW  
DATE: July 1992

**SITE DEVELOPMENT PLAN**  
LOTS F-6 THRU F-74  
**COLUMBIA**  
VILLAGE OF DORSEY'S SEARCH  
SECTION 3 AREA 1  
5TH ELECTION DISTRICT  
HOWARD COUNTY, MARYLAND

TRAFALGAR HOUSE RESIDENTIAL MARYLAND  
8865 GUILFORD ROAD, SUITE 29  
COLUMBIA, MARYLAND 21746

SCALE: 1/4"=30'  
DRAWING: 2 OF 7  
JOB NO: 92-075  
FILE NO: 92-075-X

3729-2730



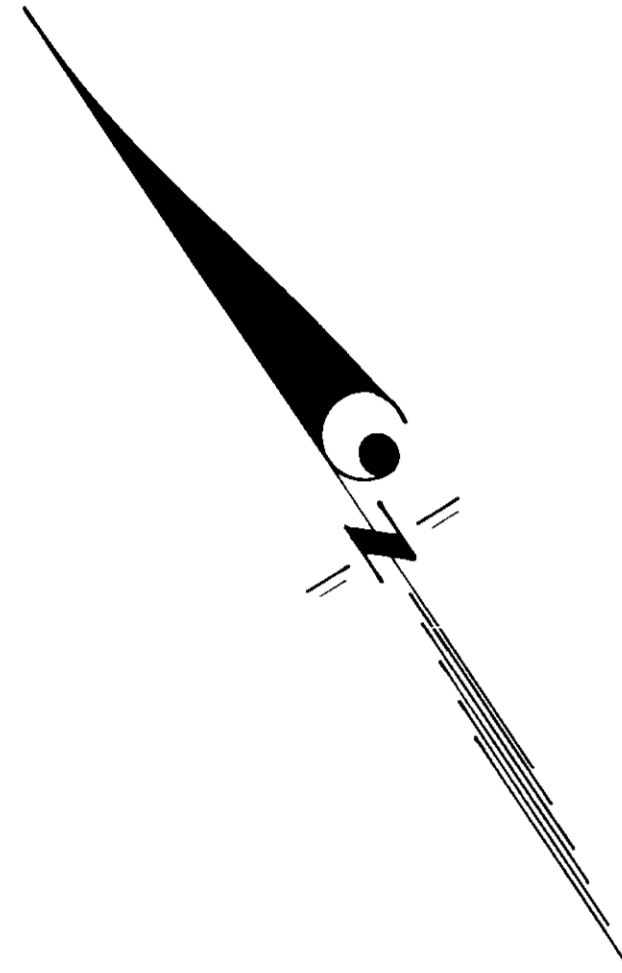

554  
556  
558  
560  
562  
564

INFILTRATION POND PER F-91-035

**TRAP NO 1 SOST ST IV**  
 Drainage Area 1.5 Ac.  
 Storage Required 2700 cf  
 Storage Provided 2700 cf  
 Depth 3'  
 Top of Stone Crest 324.0  
 Bottom Elevation 320.0  
 Clean out Elevation 321.5  
 Bottom Dimensions 44'x12'  
 2:1 Side Slopes  
 L=6'

9-1-92

APPROVED FOR PUBLIC WATER AND PUBLIC SEWERAGE SYSTEMS  
 HOWARD COUNTY HEALTH DEPARTMENT  
 COUNTY HEALTH OFFICER *[Signature]* 10-8-92  
 DATE  
 APPROVED HOWARD COUNTY DEPT. OF PLANNING & ZONING  
*[Signature]* 10/16/92  
 DATE  
*[Signature]* 10/15/92  
 DATE  
 CHIEF DIVISION OF COMMUNITY PLANNING & LAND DEVELOPMENT  
 APPROVED FOR PUBLIC WATER AND PUBLIC SEWERAGE  
 STORM DRAINAGE SYSTEMS AND PUBLIC ROADS  
 HOWARD COUNTY DEPARTMENT OF PUBLIC WORKS  
 DIRECTOR *[Signature]* 10/2/92  
 DATE  
 CHIEF BUREAU OF ENGINEERING *[Signature]* 10-2-92  
 DATE

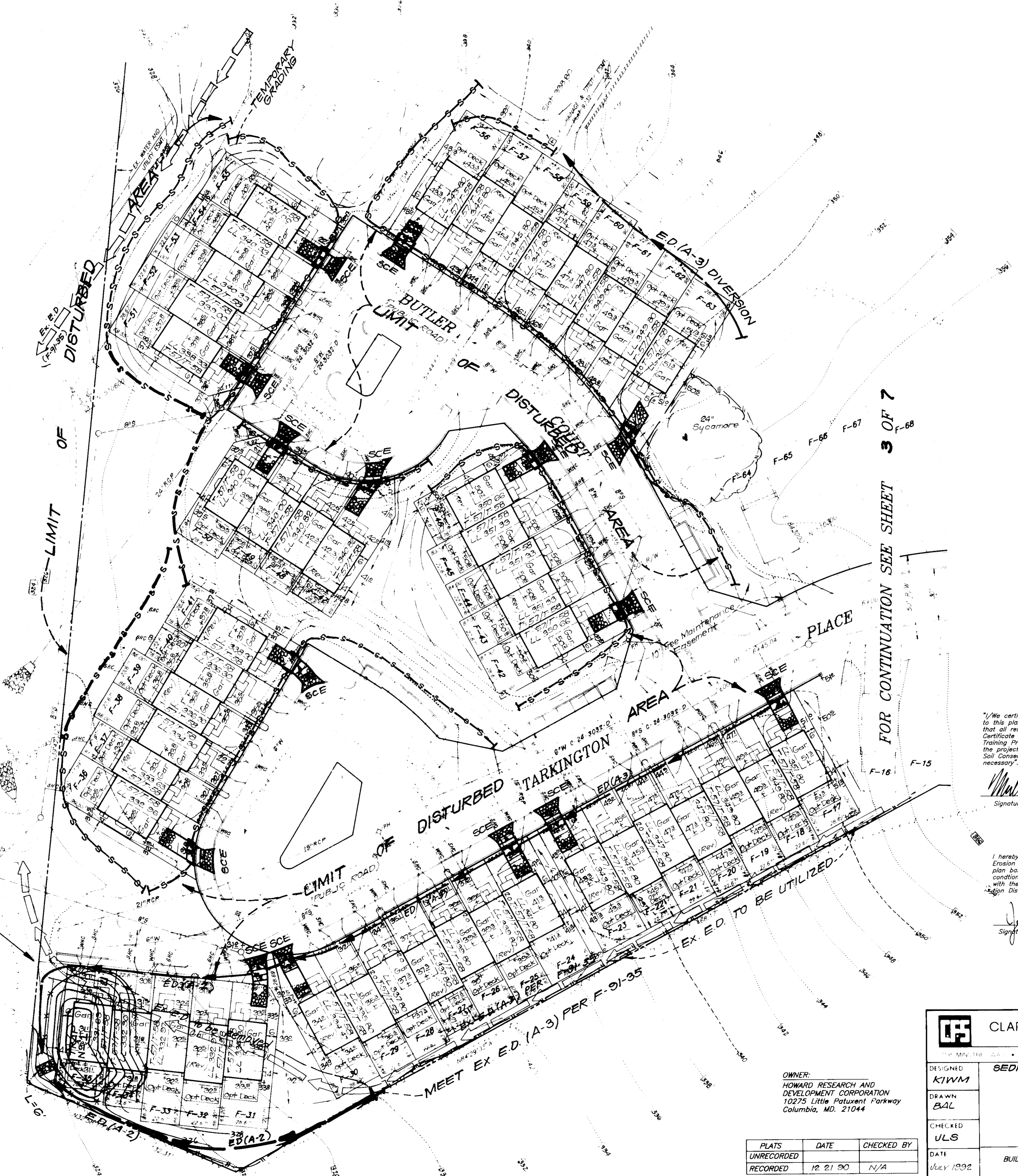

FOR CONTINUATION SEE SHEET 3 OF 7

Required for HOWARD S.C.D.  
 Name  
 Signature *[Signature]* 9/15/92  
 US Soil Conservation Service

THIS DEVELOPMENT PLAN IS APPROVED  
 FOR SOIL EROSION AND SEDIMENT  
 CONTROL BY THE HOWARD SOIL  
 CONSERVATION DISTRICT  
*[Signature]* 9/12/92  
 Approved

DEVELOPER'S/BUILDER'S CERTIFICATE

"I/We certify that all development and construction will be done according to this plan of development and plan for sediment and erosion control and that all responsible personnel involved in the construction project will have a Certificate of Attendance at a Department of the Environment Approved Training Program for the Control of Sediment and Erosion before beginning the project. I also authorize periodic on-site inspection by the Howard Soil Conservation District or their authorized agents, as are deemed necessary."

*[Signature]* 7/21/92  
 Signature Date

ENGINEER'S CERTIFICATE

I hereby certify that this plan for Sediment and Erosion Control represents a practical and workable plan based on my personal knowledge of the site conditions and that it was prepared in accordance with the requirements of the Howard Soil Conservation District.

*[Signature]* 7/20/92  
 Signature Date

OWNER:  
 HOWARD RESEARCH AND  
 DEVELOPMENT CORPORATION  
 10275 Little Patuxent Parkway  
 Columbia, MD. 21044

PLATS	DATE	CHECKED BY
UNRECORDED		
RECORDED	10-21-90	N/A

<b>CLARK • FINEFROCK &amp; SACKETT INC</b> ENGINEERS • PLANNERS • SURVEYORS		SCALE 1"=30' DRAWING 4 OF 7 JOB NO. DATE FILE NO.
DESIGNED <b>KIWM</b> DRAWN <b>BAL</b> CHECKED <b>ULS</b> DATE JULY 1992	<b>SEDIMENT &amp; EROSION CONTROL PLAN</b> LOTS F-G THRU F-74 <b>COLUMBIA</b> VILLAGE OF DORSEY'S SEARCH SECTION 3 AREA 1 5TH ELECTION DISTRICT HOWARD COUNTY, MARYLAND TRAFALGAR HOUSE RESIDENTIAL MARYLAND 8965 GUILFORD ROAD, SUITE 29 COLUMBIA, MARYLAND 21746	

Apply to graded or cleared areas not subject to immediate further disturbance where a permanent long-lived vegetative cover is needed.

Seedbed Preparation: Loosen upper three inches of soil by raking, discing or other acceptable means before seeding, if not previously loosened.

Soil Amendments: In lieu of soil test recommendations, use one of the following schedules

- 1) Preferred - Apply 2 tons per acre dolomitic limestone (92 lbs/1000 square ft) and 600 lbs per acre 10-10-10 fertilizer (14 lbs/1000 sq ft) before seeding.
2) Acceptable - Apply 2 tons per acre dolomitic limestone (92 lbs/1000 sq ft) and 1000 lbs per acre 10-10-10 fertilizer (23 lbs/1000 sq ft) before seeding.

Seeding - For the periods March 1 thru April 30, and August 1 thru October 15, seed with 60 lbs per acre (1.4 lbs/1000 sq ft) of Kentucky 31 Tall Fescue. For the period May 1 thru July 31, seed with 60 lbs Kentucky 31 Tall Fescue per acre and 2 lbs per acre (.05 lbs/1000 sq ft) of weeping lovegrass.

Mulching - Apply 1 1/2 to 2 tons per acre (70 to 90 lbs/1000 sq ft) of unrotted small grain straw immediately after seeding. Anchor mulch immediately after application using mulch anchoring tool or 2 1/2 gallons per acre (5 gal/1000 sq ft) of emulsified asphalt on flat areas.

Inspection - Inspect all seeded areas and make needed repairs, replacements and reseedings.

TEMPORARY SEEDING NOTES

Apply to graded or cleared areas likely to be redisturbed where a short-term vegetative cover is needed.

Seedbed Preparation: Loosen upper three inches of soil by raking, discing or other acceptable means before seeding, if not previously loosened.

Soil Amendment: Apply 600 lbs per acre 10-10-10 fertilizer (14 lbs/1000 sq ft)

Seeding: For periods March 1 thru April 30 and from August 15 thru November 15, seed with 25 bushel per acre of annual rye (3.2 lbs/1000 sq ft). For the period May 1 thru August 14, seed with 3 lbs per acre of weeping lovegrass (.07 lbs/1000 sq ft).

Mulching: Apply 1 1/2 to 2 tons per acre (70 to 90 lbs/1000 sq ft) of unrotted small grain straw immediately after seeding. Anchor mulch immediately after application using mulch anchoring tool or 2 1/2 gal per acre (5 gal/1000 sq ft) of emulsified asphalt on flat areas.

Refer to the 1983 MARYLAND STANDARDS AND SPECIFICATIONS FOR SOIL EROSION AND SEDIMENT CONTROL for methods and materials not covered.

- 1. A minimum of 24 hours notice must be given to the Howard County Office of Inspection and Permits prior to the start of any construction.
2. All vegetative and structural practices are to be installed according to the provisions of this plan and are to be in conformance with the 1983 MARYLAND STANDARDS AND SPECS. FOR SOIL EROSION AND SEDIMENT CONTROL.
3. Following initial soil disturbance or redisturbance, permanent or temporary stabilization shall be completed within 7 calendar days for all perimeter sediment control structures, dikes, perimeter slopes and all slopes greater than 3:1, b) 14 days for all other disturbed or graded areas on the project site.
4. All sediment traps/basins shown must be fenced and warning signs posted around their perimeters in accordance with Vol. 1, Chapter 12 of the HOWARD COUNTY DESIGN MANUAL, Storm Drainage.
5. All disturbed areas must be stabilized within the time period specified above in accordance with the 1983 MARYLAND STANDARDS AND SPECIFICATIONS FOR SOIL EROSION AND SEDIMENT CONTROL for permanent seedings (Sec. 51) sod (Sec. 54), temporary seeding (Sec. 52) and mulching (Sec. 52). Temporary stabilization with mulch alone can only be done when recommended seeding dates do not allow for proper germination and establishment of grasses.
6. All sediment control structures are to remain in place and are to be maintained in operative condition until permission for their removal has been obtained from the Howard County Sediment Control Inspector.
7. SITE ANALYSIS: Total Area of Site: 3.263 Ac. Area Disturbed: 4.91 Ac. Area to be roofed or paved: 2.04 Ac. Area to be vegetatively stabilized: 2.87 Ac. Total: 7.82 Ac. Total Fill: 14,800 cu yd. Offsite Waste/Borrow Area Location:
8. Any sediment control practice which is disturbed by grading activity for placement of utilities must be repaired on the same day of disturbance.
9. Additional sediment control must be provided, if deemed necessary by the Howard County DPW Sediment Control Inspector. On all sites with disturbed areas in excess of 2 acres, approval of the inspection agency shall be requested upon completion of installation of perimeter erosion and sediment controls, but before proceeding with any other earth disturbance or grading. Other building or grading inspection approvals may not be authorized until this initial approval by the inspection agency is made.
10. If houses are to be constructed on an "as-sold" basis, at random, single-family sediment control, as shown below, shall be implemented.
11. All pipes to be blocked at the end of each day (see detail - this sheet).
12. The total amount of silt fences: 2565
13. It is the responsibility of the contractor to identify the spoil/borrow site and notify and gain approval from the sediment control inspector of the site and it's grading permit number at the time of construction.

CONSTRUCTION SEQUENCE table with columns: CONSTRUCTION SEQUENCE, NO. OF DAYS. Rows include: Obtain grading permit and install sediment and erosion control devices and stabilize (7 days), Excavate for foundations, rough grade and temporarily stabilize (30 days), Construct structures, sidewalks and driveways (30 days), Final grade and stabilize in accordance with Stds. and Specs. (14 days), Upon approval of the sediment control inspector, remove sediment and erosion control devices and stabilize (7 days).

\*Delay construction of houses on lots F-31-F-35 until trap #1 is removed.

NOTE: The builder shall be responsible for the removal of sediment and repair of damages to the SWM facilities as a result of the construction of this SDP.

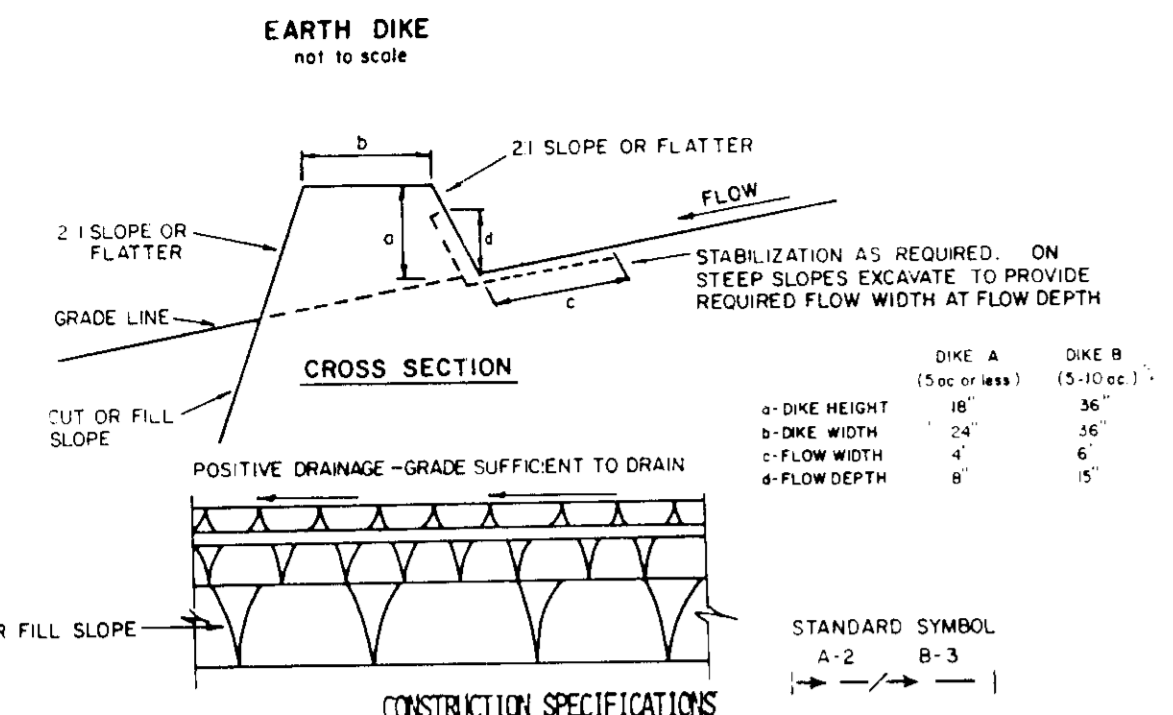

- 1. ALL DIKES SHALL BE COMPACTED BY EARTH-MOVING EQUIPMENT.
2. ALL DIKES SHALL HAVE POSITIVE DRAINAGE TO AN OUTLET.
3. TOP WIDTH MAY BE WIDER AND SIDE SLOPES MAY BE FLATTER IF DESIRED TO FACILITATE CROSSING BY CONSTRUCTION TRAFFIC.
4. FIELD LOCATION SHOULD BE ADJUSTED AS NEEDED TO UTILIZE A STABILIZED SAFE OUTLET.
5. EARTH DIKES SHALL HAVE AN OUTLET THAT FUNCTIONS WITH A MINIMUM OF EROSION. RUNOFF SHALL BE CONVEYED TO A SEDIMENT TRAPPING DEVICE SUCH AS A SEDIMENT TRAP OR SEDIMENT BASIN WHERE EITHER THE DIKE CHANNEL, OR THE DRAINAGE AREA ABOVE THE DIKE ARE NOT ADEQUATELY STABILIZED.
6. STABILIZATION SHALL BE: (A) IN ACCORDANCE WITH STANDARD SPECIFICATIONS FOR SEED AND STRAW MULCH OR STRAW MULCH IF NOT IN SEEDING SEASON, (B) FLOW CHANNEL AS PER THE CHART BELOW.

FLOW CHANNEL STABILIZATION table with columns: TYPE OF TREATMENT, CHANNEL SLOPE, DIKE A, DIKE B. Rows include: 1. 5-3.0% SEED AND STRAW MULCH SEED AND STRAW MULCH; 2. 3.1-5.0% SEED USING JUTE, OR EXCELSTOR, SOD; 2" STONE SEED USING JUTE, OR EXCELSTOR, SOD; 2" STONE; 3. 5.1-8.0% SEED WITH JUTE, OR SOD; 2" STONE LINED RIP-RAP 4-8"; 4. 8.1-20% LINED RIP-RAP 4-8" ENGINEERING DESIGN.

- A. STONE TO BE 2 INCH STONE, OR RECYCLED CONCRETE EQUIVALENT, IN A LAYER AT LEAST 3 INCHES IN THICKNESS AND BE PRESSED INTO THE SOIL WITH CONSTRUCTION EQUIPMENT.
B. RIP-RAP TO BE 4-8 INCHES IN A LAYER AT LEAST 8 INCHES THICKNESS AND PRESSED INTO THE SOIL.
C. APPROVED EQUIVALENTS CAN BE SUBSTITUTED FOR ANY OF THE ABOVE MATERIALS.
7. PERIODIC INSPECTION AND REQUIRED MAINTENANCE MUST BE PROVIDED AFTER EACH RAIN EVENT.

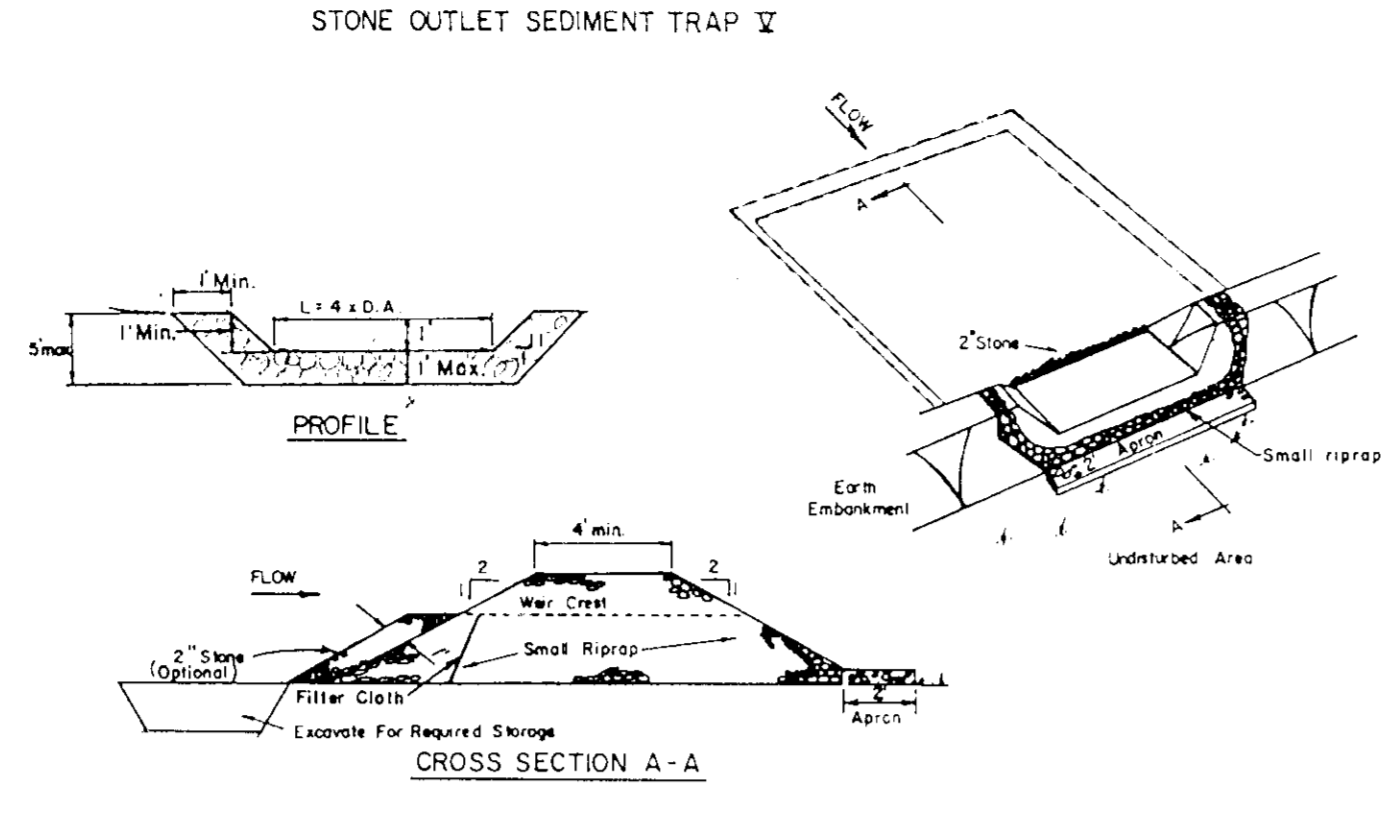

OPTION: A one foot layer of 2" stone may be placed on the upstream side of the riprap in place of the embedded filter cloth.

- 1. Area under embankment shall be cleared, grubbed and stripped of any vegetation and root mat. The pool area shall be cleared.
2. The fill material for the embankment shall be free of roots and other woody vegetation as well as over-sized stones, rocks, organic material or other objectionable material. The embankment shall be compacted by traversing with equipment while it is being constructed.
3. All cut and fill slopes shall be 2:1 or flatter.
4. The stone used in the outlet shall be small riprap 4"-8" along with a 1" thickness of 2" aggregate placed on the upgrade side on the small riprap embedded filter cloth in the riprap.
5. Sediment shall be removed and trap restored to its original dimensions when the sediment has accumulated to 1/2 the design depth of the trap.
6. The structure shall be inspected after each rain and repairs made as needed.
7. Construction operations shall be carried out in such a manner that erosion and water pollution is minimized.
8. The structure shall be removed and the area stabilized when the drainage area has been properly stabilized.

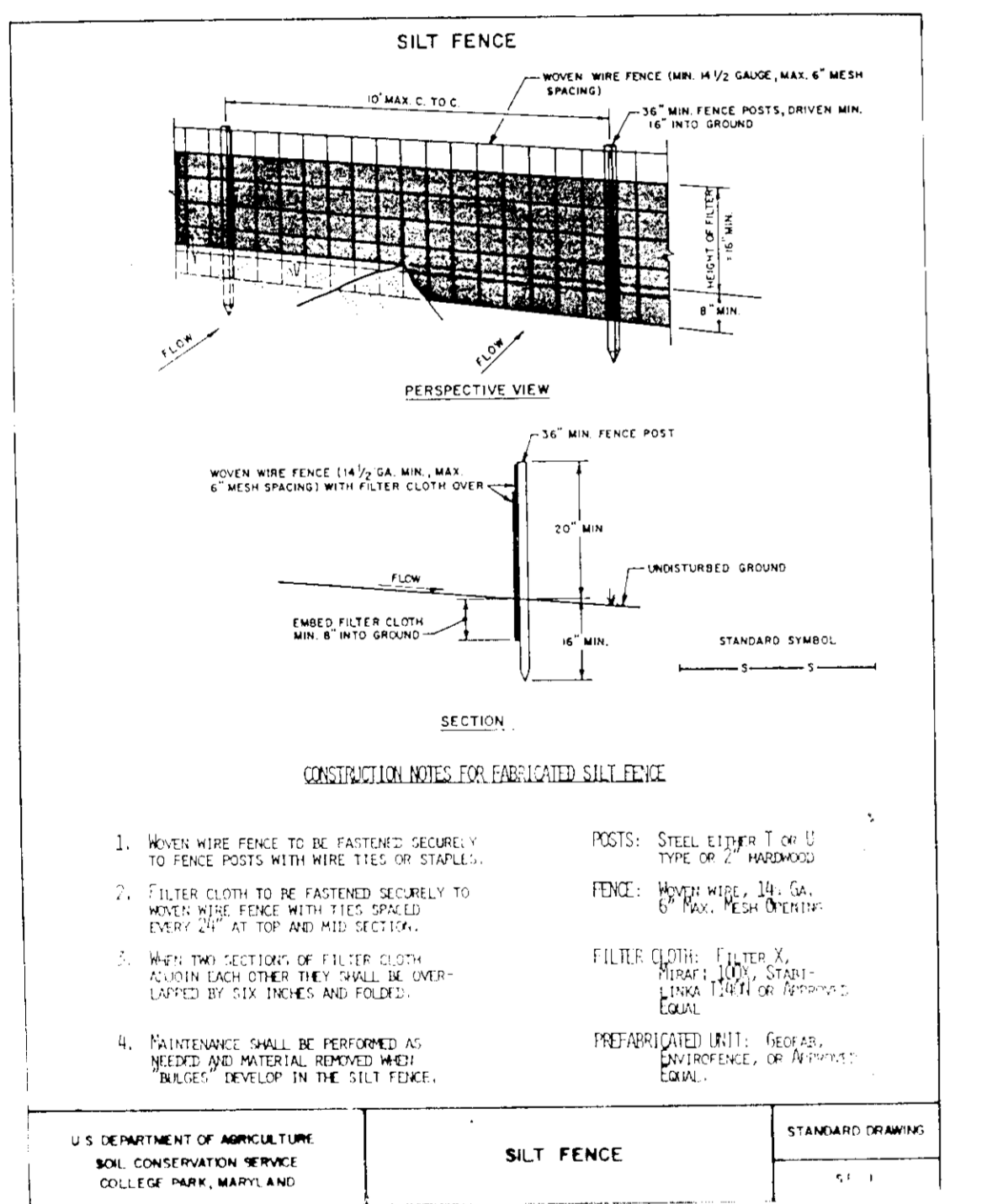

CONSTRUCTION NOTES FOR FABRICATED SILT FENCE table with columns: U.S. DEPARTMENT OF AGRICULTURE SOIL CONSERVATION SERVICE COLLEGE PARK, MARYLAND; SILT FENCE; STANDARD DRAWING.

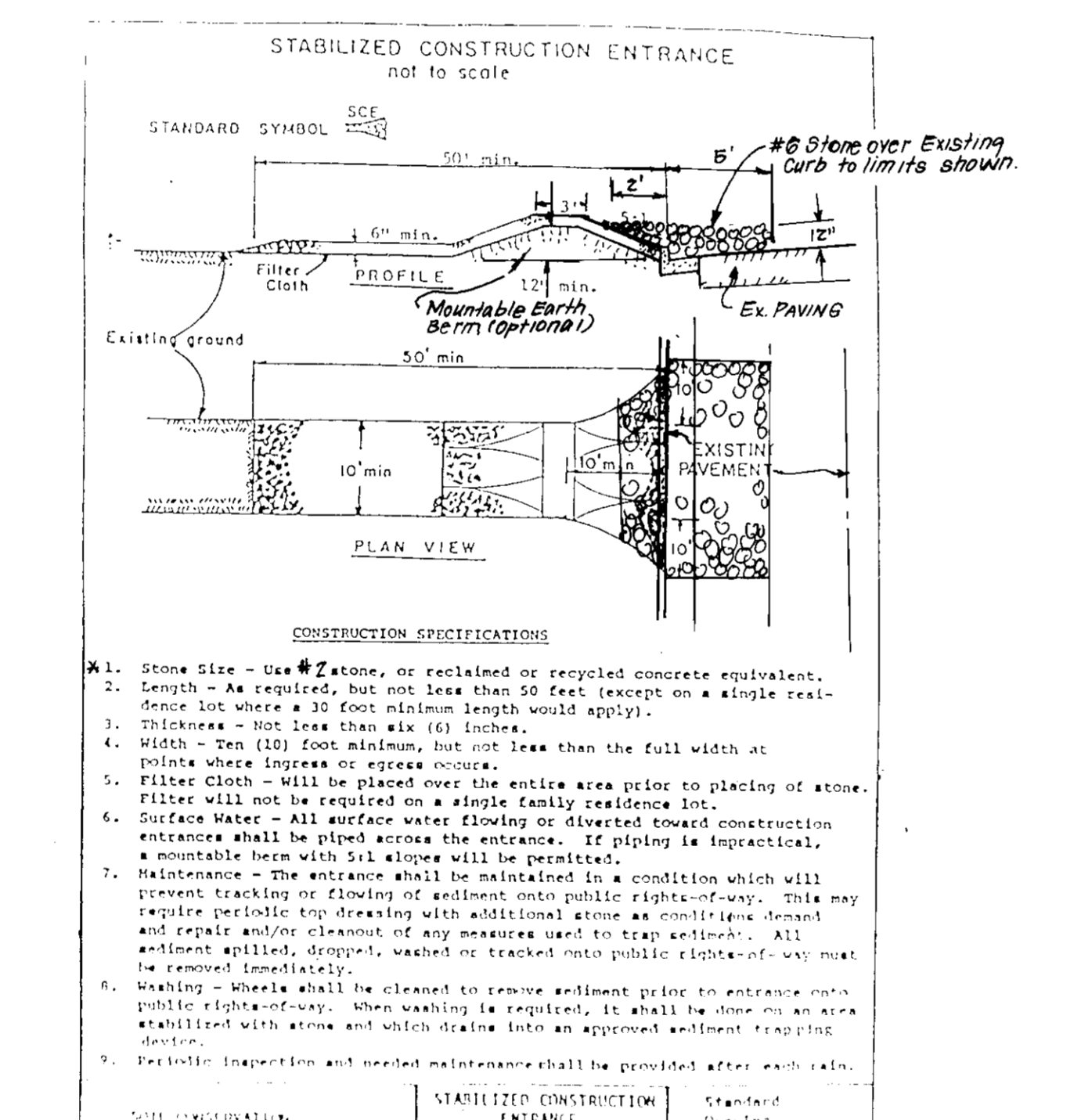

\* Use #8 Stone over Existing Curb to limits shown

APPROVED FOR PUBLIC WATER AND PUBLIC SEWERAGE SYSTEMS, HOWARD COUNTY HEALTH DEPARTMENT. County Health Officer: [Signature] 10-8-92. APPROVED: HOWARD COUNTY DEPT. OF PLANNING & ZONING. Director: [Signature] 10/12/92. APPROVED: FOR PUBLIC WATER AND PUBLIC SEWERAGE, STORM DRAINAGE SYSTEMS AND PUBLIC ROADS, HOWARD COUNTY DEPARTMENT OF PUBLIC WORKS. Director: [Signature] 10-2-92.

9-1-92

Reviewed for HOWARD S.C.D. Name: [Signature] Date: 9/23/92. US Soil Conservation Service.

DEVELOPER'S/BUILDER'S CERTIFICATE. I/we certify that all development and construction will be done according to this plan of development and plan for sediment and erosion control and that all responsible personnel involved in the construction project will have a Certificate of Attendance at a Department of the Environment Approved Training Program for the Control of Sediment and Erosion before beginning the project. I also authorize periodic on-site inspection by the Howard Soil Conservation District or their authorized agents, as are deemed necessary. Signature: [Signature] Date: 7/21/92.

ENGINEER'S CERTIFICATE. I hereby certify that this plan for Sediment and Erosion Control represents a practical and workable plan based on my personal knowledge of the site conditions and that it was prepared in accordance with the requirements of the Howard Soil Conservation District. Signature: [Signature] Date: 7/20/92.

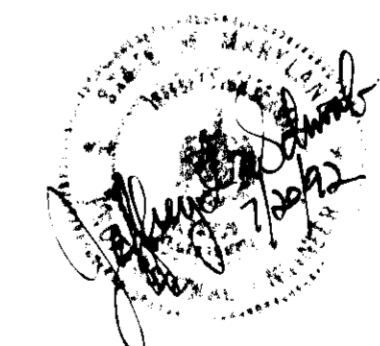

CLARK • FINEFROCK & SACKETT, INC. ENGINEERS • PLANNERS • SURVEYORS. SEDIMENT & EROSION CONTROL PLAN. LOT'S F-G THRU F-74. COLUMBIA. VILLAGE OF DORSEY'S SEARCH SECTION 3 AREA 1 5TH ELECTION DISTRICT HOWARD COUNTY, MARYLAND. TRAFALGAR HOUSE RESIDENTIAL MARYLAND 8865 GUILFORD ROAD, SUITE 29 COLUMBIA, MARYLAND 21746. Scaled: 1" = 30'. Drawing: 5 of 7. Job No: [Blank]. File No: [Blank].

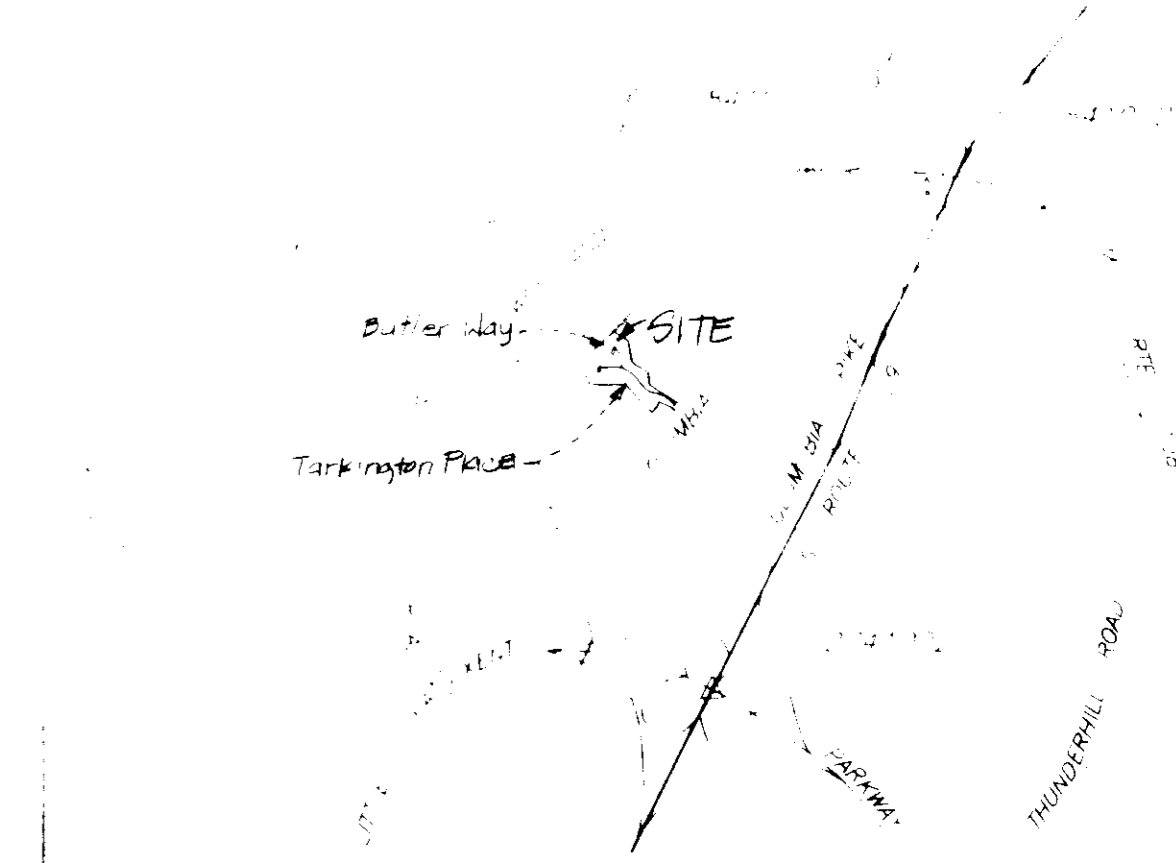

VICINITY MAP

SCALE: 1" = 2,000'

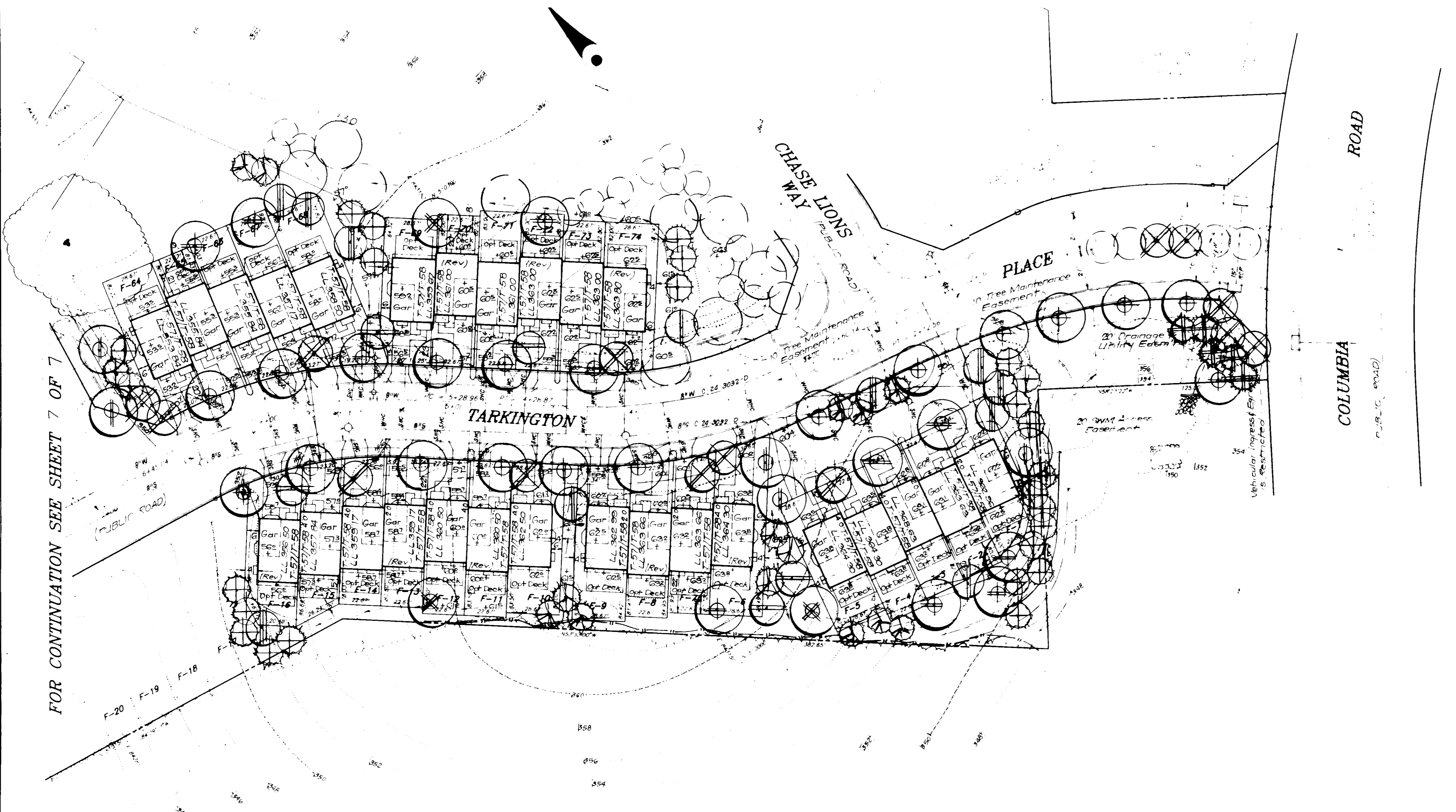

PLANT SCHEDULE				
KEY	PLANT NAME	SIZE	QTY	REMARKS
SHADE TREES				
⊕	ACER RUBRA 'OCTOBER GLORY'	2 1/2' CAL	24	D + B
⊕	OCTOBER GLORY RED MAPLE	12' 14' HT.		HEAVY HEADS
⊕	QUERCUS TEL. NERNIA 'SHADEMASTER'		7	
⊕	SHADEMASTER HONEYLOCUST		7	
⊕	PLATANUS AUERFELDI 'BURROOD'			
⊕	LONDON PLANETREE			
⊕	RUBRUS FLEURS		24	
⊕	WILLOW OAK			
⊕	ZELKOVIA SER. 'GREEN VASE'		44	
⊕	GREEN VASE ZELKOVA			
FLOWERING/EVERGREEN TREES				
⊕	BETULA A. (CLUMPS)	2" 2 1/2' CAL	14	
⊕	EUROPEAN WHITE BIRCH	12' 14' HT.		
⊕	MAHOG. x SNOWDRIFT		18	
⊕	SNOWDRIFT CRABAPPLE			
⊕	PRUNUS SER. KWANZAN		40	
⊕	KWANZAN CHERRY			
⊕	PRUNUS TERRENSIS		23	
⊕	YOSHINO CHERRY			
⊕	PINUS THUNBERGII	6-8' HT.	58	
⊕	JAPANESE BLACK PINE			
⊕	TAXUS CANADENSIS		66	
⊕	CANDIDIA HEMLOCK			
⊕	PICCA WHITEBLS		5	
⊕	COLORADO SPRUCE			

NOTES:

- 1) ALL PLANTING SHALL BE DONE IN ACCORDANCE WITH COLUMBIA H.F.D. LANDSCAPE SPECIFICATIONS.
- 2) CONTRACTOR SHALL VERIFY LOCATION OF ALL UNDERGROUND UTILITIES PRIOR TO DIGGING.
- 3) FINAL LOCATION OF ALL TREES ARE SUBJECT TO ADJUSTMENTS TO MEET FINAL FIELD CONDITIONS.

⊕ - INDICATES PLANTS FROM SDP 22-57

SUBMISSION NAME		COLUMBIA		SECTION/AREA		LOTS/PARCELS	
VILLAGE OF DORSEY'S SEARCH		3/1		F-1 F-74			
PLAT NO.	BLOCK NO.	ZONE	BY MAP NO.	ELECTION DIST.	CENSUS TRACT		
9729, 9730 E	9731	SPA	30	5TH			
WATER CODE		SEWER CODE					
E01		568.0000					

APPROVED FOR PUBLIC WATER AND PUBLIC SEWERAGE SYSTEMS  
 HOWARD COUNTY HEALTH DEPARTMENT  
 COUNTY HEALTH OFFICER: *John P. ...* DATE: 10-8-92

APPROVED HOWARD COUNTY DEPT. OF PLANNING & ZONING  
 DIRECTOR: *James B. ...* DATE: 10/16/92  
 CHIEF DIVISION OF COMMUNITY PLANNING AND LAND DEVELOPMENT

APPROVED FOR PUBLIC WATER AND PUBLIC SEWERAGE  
 STORM DRAINAGE SYSTEMS AND PUBLIC ROADS  
 HOWARD COUNTY DEPARTMENT OF PUBLIC WORKS  
 DIRECTOR: *Charles J. ...* DATE: 10/2/92  
 CHIEF BUREAU OF ENGINEERING: *M. K.* DATE: 10-2-92

9-1-92

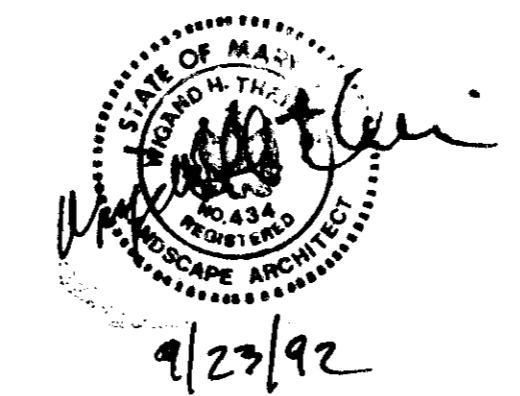

OWNER  
 HOWARD RESEARCH AND DEVELOPMENT CORPORATION  
 10275 Little Patuxent Parkway  
 Columbia, MD. 21044

PLATS	DATE	CHECKED BY
UNRECORDED		
RECORDED	10-21-92	N.2

**CLARK • FINEFROCK & SACKETT, INC.**  
 ENGINEERS • PLANNERS • SURVEYORS

DESIGNED: MJP  
 DRAWN: MJP  
 CHECKED: WHH  
 DATE: 7-22-92

LANDSCAPE PLANTING PLAN  
 LOTS F-1 THRU F-74  
**COLUMBIA**  
 VILLAGE OF DORSEY'S SEARCH  
 SECTION 3 AREA 1  
 5TH ELECTION DISTRICT  
 HOWARD COUNTY, MARYLAND

SCALE: 1" = 30'  
 DRAWING: 60 F 7  
 JOB NO: 92-075  
 FILE NO: 92-075 LS

BUILDER: TRAFALGAR HOUSE RESIDENTIAL MARYLAND  
 8965 GUILFORD ROAD, SUITE 29  
 COLUMBIA, MARYLAND 21746

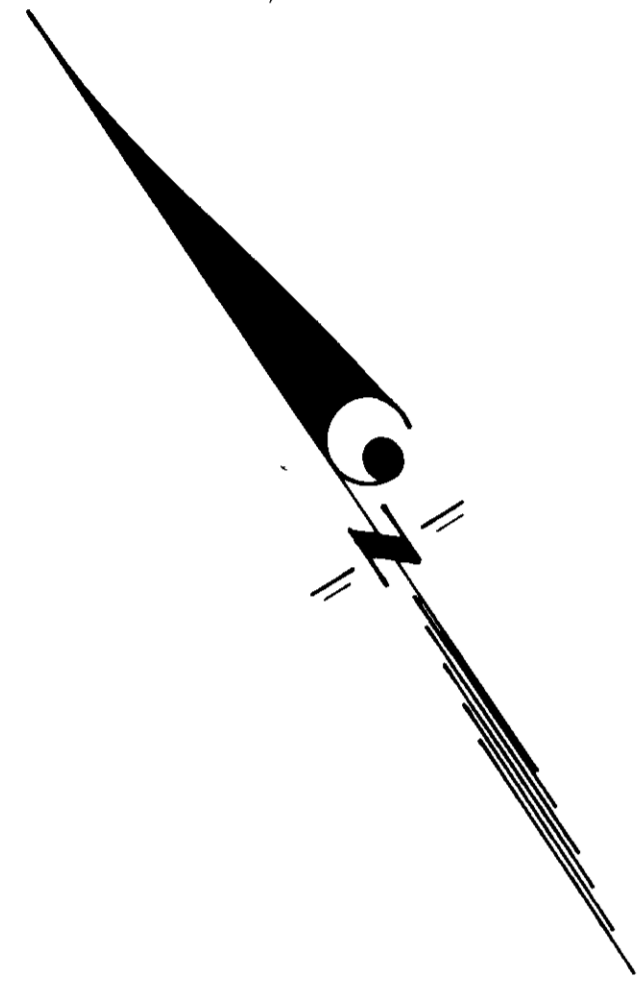

0.54  
 0.52  
 0.50  
 0.48  
 0.46  
 0.44  
 0.42  
 0.40  
 0.38  
 0.36  
 0.34  
 0.32  
 0.30  
 0.28  
 0.26  
 0.24  
 0.22  
 0.20  
 0.18  
 0.16  
 0.14  
 0.12  
 0.10  
 0.08  
 0.06  
 0.04  
 0.02  
 0.00

V.O.D.S.'s Lot 1, Zoned: NEW TOWN  
SWM FACILITY F-9-035



FOR CONTINUATION SEE SHEET 6 OF 7

APPROVED FOR PUBLIC WATER AND PUBLIC SEWERAGE SYSTEMS  
 HOWARD COUNTY HEALTH DEPARTMENT  
 COUNTY HEALTH OFFICER: *John Boyle* DATE: 10-8-92  
 APPROVED HOWARD COUNTY DEPT. OF PLANNING & ZONING  
 DIRECTOR: *Edward Smith* DATE: 10/16/92  
*William Holman* DATE: 10/15/92  
 CHIEF DIVISION OF COMMUNITY PLANNING & LAND DEVELOPMENT  
 APPROVED FOR PUBLIC WATER AND PUBLIC SEWERAGE STORM DRAINAGE SYSTEMS AND PUBLIC ROADS  
 HOWARD COUNTY DEPARTMENT OF PUBLIC WORKS  
 DIRECTOR: *Robert Johnson* DATE: 10/2/92  
 CHIEF BUREAU OF ENGINEERING: *M. King* DATE: 10-2-92

9-1-92

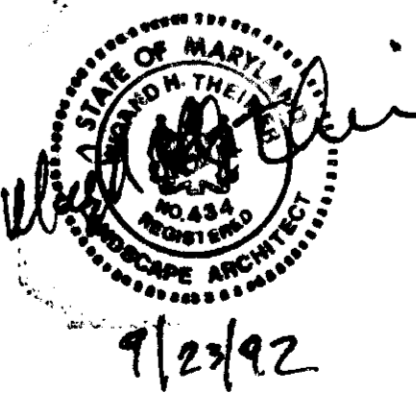

OWNER:  
 HOWARD RESEARCH AND DEVELOPMENT CORPORATION  
 10275 Little Patuxent Parkway  
 Columbia, MD. 21044

PLATS	DATE	CHECKED BY
UNRECORDED		
RECORDED	12 21 90	N/A

SUBDIVISION NAME	COLUMBIA	SECTION/AREA	3/1	LOTS/PARCELS	F-1 F-74
VILLAGE OF DORSEY'S SEARCH					
PLAT NO.	9729-9730#	BLOCK NO.	N/T	TAX MAP NO.	30
	2221		SEA	ELECTION DIST.	5TH
WATER CODE	E01	SEWER CODE	5680000		

**CLARK • FINEPROCK & SACKETT, INC.**  
 ENGINEERS • PLANNERS • SURVEYORS  
 7145 MINNISTRE L. WA. • COLUMBIA, MD. 21046 • FORT BELLEVILLE, ILL. 62209 • WASHINGTON, D.C. 20004

DESIGNED MJP	<b>COLUMBIA</b> VILLAGE OF DORSEY'S SEARCH SECTION 3 AREA 1 5TH ELECTION DISTRICT HOWARD COUNTY, MARYLAND TRAFALGAR HOUSE RESIDENTIAL MARYLAND 8965 GUILFORD ROAD, SUITE 29 COLUMBIA, MARYLAND 21746	SCALE 1"=30'
DRAWN MJP		DRAWING 7 OF 7
CHECKED WHT		JOB NO 92-075
DATE 7-22-92		FILE NO 92-075-13

SDP-9309

for No. 11