

SEDIMENT CONTROL NOTES

- A minimum of 24 hours notice must be given to the Howard County Office of Inspection and Enforcement prior to the start of any construction.
- All vegetative and structural practices are to be installed according to the provisions of this plan and shall be in accordance with the 1983 MARYLAND STANDARDS AND SPECIFICATIONS FOR SOIL EROSION AND SEDIMENT CONTROL.
- Following initial soil disturbance or disturbance, permanent or temporary stabilization shall be completed within a 7 calendar days for all permanent erosion control structures, ditches, permanent slopes and all other disturbed or graded areas on the project site.
- All sediment traps/basins shall be located and warning signs posted around their perimeter in accordance with Vol. 1, Chapter 15, of the HOWARD COUNTY DESIGN MANUAL, Storm Drainage.
- All disturbed areas must be stabilized within the time period specified above in accordance with the 1983 MARYLAND STANDARDS AND SPECIFICATIONS FOR SOIL EROSION AND SEDIMENT CONTROL. For permanent seedings (See 5B) and (See 5C) and (See 5D), temporary seedings (See 5E) and mulching (See 5F). Temporary stabilization which will allow only be done when recommended seeding rates do not allow for proper germination and establishment of grasses.
- All sediment control structures are to remain in place and are to be maintained in operative condition until permission for their removal has been obtained from the Howard County Sediment Control Inspector.
- Site Analysis of Site:
 - Total Area of Site: 0.17 Acres
 - Area Disturbed: 0.17 Acres
 - Area to be seeded or covered: 0.17 Acres
 - Area to be vegetatively stabilized: 0.17 Acres
 - Total Cost: \$1,125.00
 - Office use/allowance area: NONE
- Any sediment control practices which is described by grading activity may placement of utilities must be completed on the same day of disturbance.
- Additional sediment controls must be provided, if deemed necessary by the Howard County SDC sediment control inspector.
- On all sites with disturbed areas in excess of 1-acre, approval of the Inspection Agency shall be requested upon completion of installation of sediment control and sediment controls, but before proceeding with any other earth disturbance or grading. Other building or grading inspection approvals may not be authorized until this initial approval by the Inspection Agency is made.

SECTION NUMBER	ROAD AND STREET CLASSIFICATION	PAVEMENT MATERIALS	PAVEMENT ALTERNATIVES
P-1	PARKING BAYS APARTMENTS AND COMMERCIAL INDUSTRIAL ZONES WITH NO HEAVY TRAFFIC	1" BIT. CONC. SURFACE 4" BIT. CONC. BASE	1" BIT. CONC. SURFACE 2" BIT. CONC. BASE PRIME
	TRAVELWAYS FOR APARTMENTS AND COMMERCIAL INDUSTRIAL ZONES WITH NO HEAVY TRAFFIC	2" BIT. CONC. SURFACE 4" BIT. CONC. BASE	2" BIT. CONC. SURFACE 4" BIT. CONC. BASE PRIME

NOTE: WAIVER GRANTED FROM STD DETAIL R-607 BY LETTER DATED OCT. 1, 1991 FROM THE DEPT. OF PUBLIC WORKS

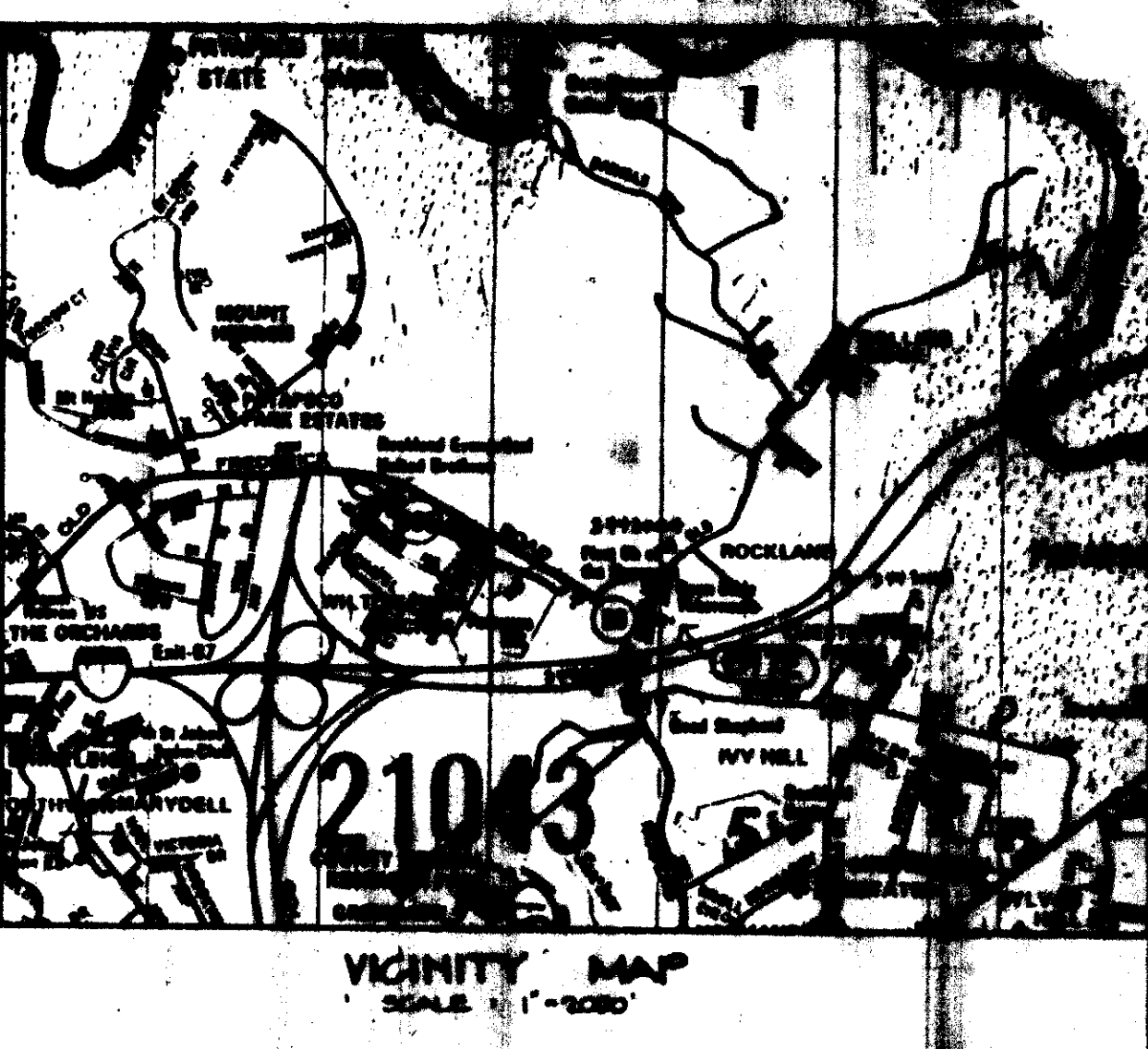

- SITE ANALYSIS**
- AREA OF PARCEL: 0.17704 ACRES (38,774 sq ft)
 - TAX MAP: 21043 (C-1 MAP)
 - PRESENT ZONING: R-1 (SINGLE-FAMILY RESIDENTIAL)
 - PROPOSED USE: 100 SINGLE-FAMILY RESIDENTIAL UNITS (SFR) WITH 100 GARAGES AND 100 CARPORTS.
 - FLOOR SPACE: 1,297,707 sq ft (BASEMENT)
 - PROPOSED TRAFFIC: 1775 VEH/HR (AT PEAK)
 - SEATING CAPACITY: 100 (AT PEAK)
 - PARKING SPACES REQUIRED: 100 (AT PEAK)
 - PARKING PROVIDED: 100 (AT PEAK)
 - SITE COVERAGE: 100% (AT PEAK)
 - BENCH MARK No. 044 (ELEV. 550.00)
 - COORDINATES BASED ON HOWARD COUNTY GEODETIC STATIONS: 2600
 - SEPTIC AREA: APPROVED BY HOWARD COUNTY HEALTH OFFICER 9/27/91
 - STORMWATER MANAGEMENT: WAIVER APPROVED BY HOWARD COUNTY DYS DIRECTOR 1/30/93
 - SOILS: GIB2 - GLENDALE LOAM 2% TO 8%
 - STREAM OR WETLANDS: NO WETLANDS OR STREAMS ON SITE
- GENERAL NOTES**
- ALL CONSTRUCTION SHALL BE IN ACCORDANCE WITH HOWARD COUNTY SPECIFICATIONS & DETAILS FOR CONSTRUCTION.
 - PUBLIC WATER RESERVE: EXISTING TO SITE WATER NETER
 - CONTRACTOR SHALL CALL 800-UTILITY 34 HOURS PRIOR TO STARTING CONSTRUCTION.
 - ALL DAMAGE TO PUBLIC R/W AREA SHALL BE REPAIRED AT THE CONTRACTOR'S EXPENSE.

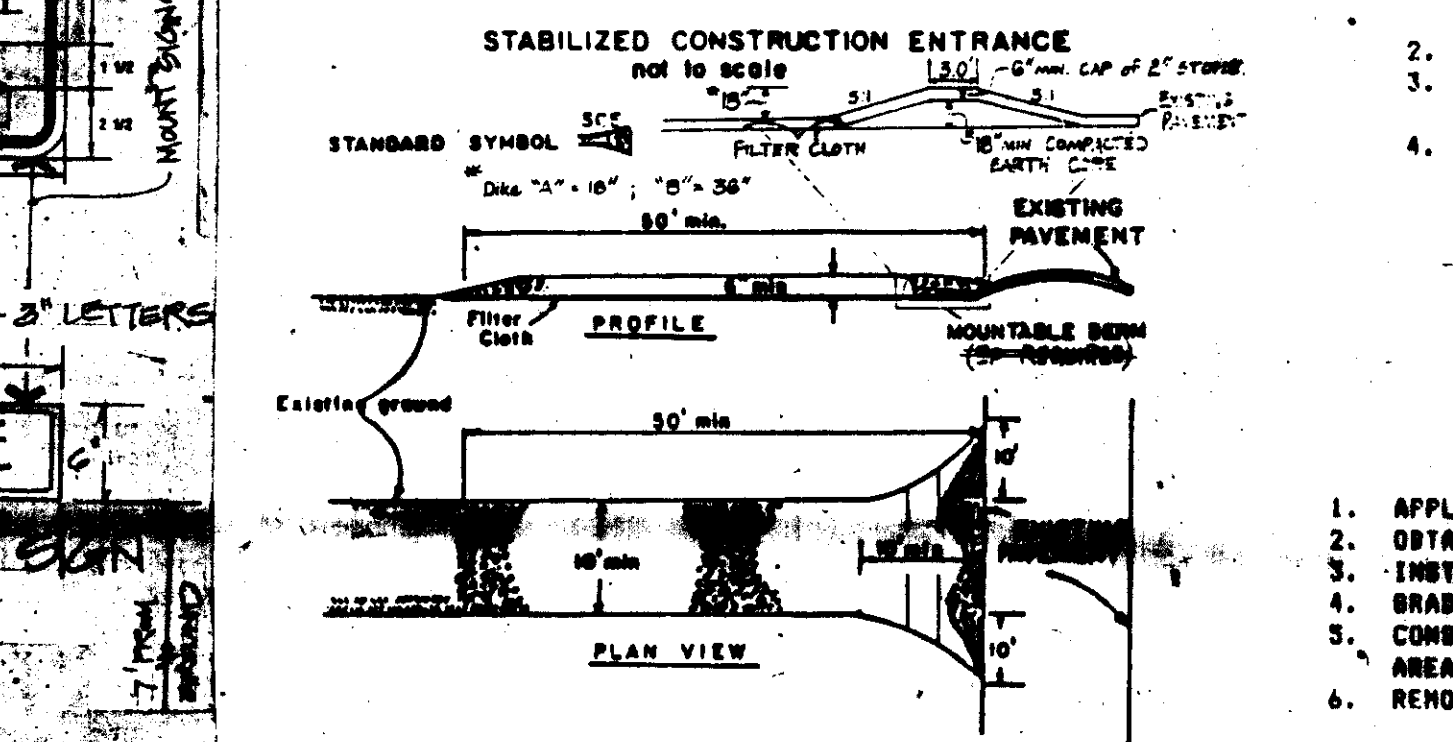
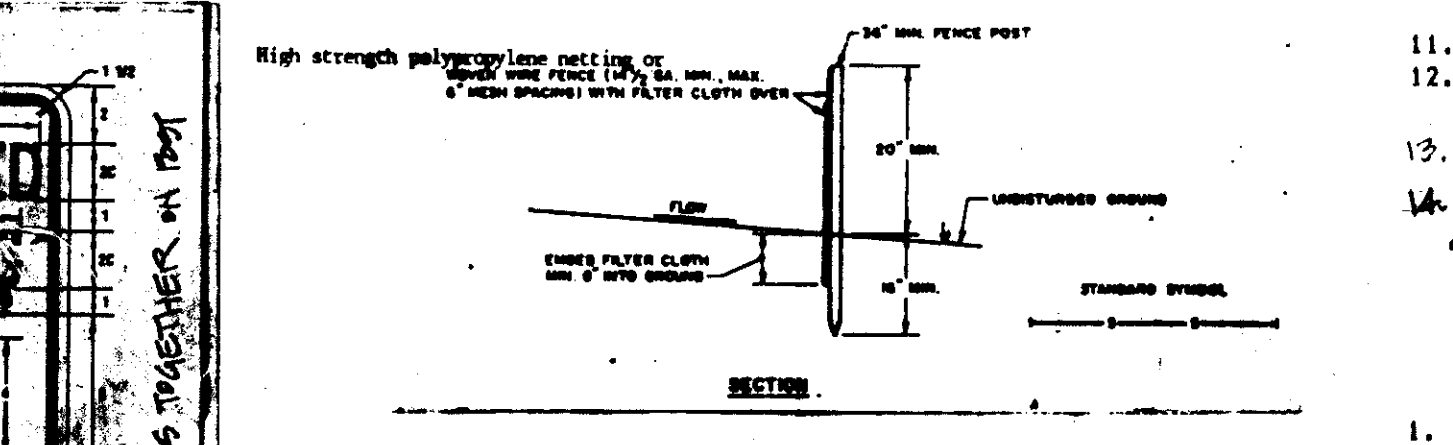
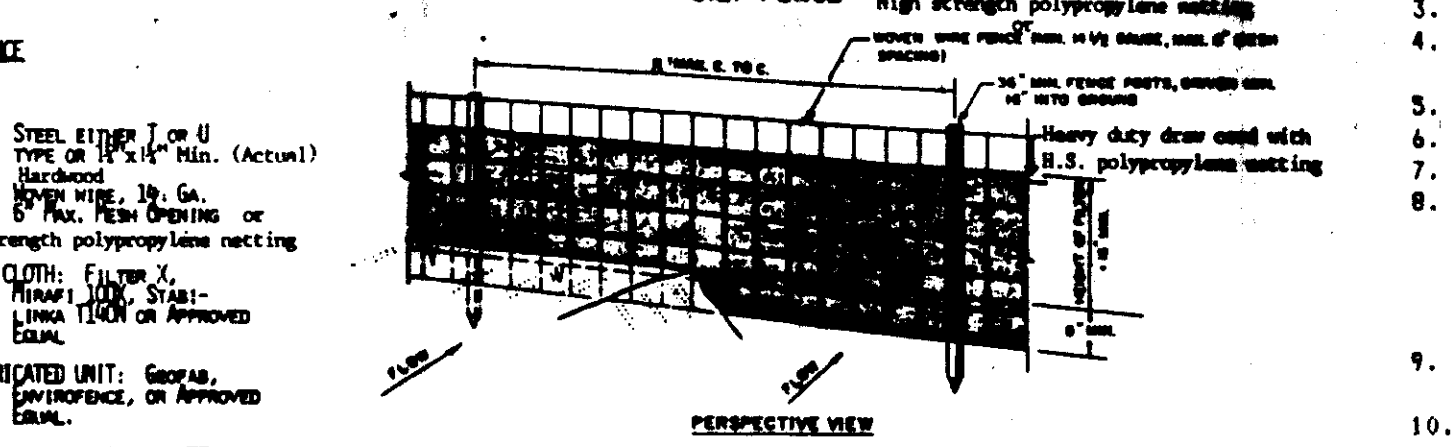

- SEQUENCE OF CONSTRUCTION**
- APPLY FOR PERMIT FROM HOWARD COUNTY.
 - INSTALL SILT FENCE AND STABILIZED CONSTRUCTION ENTRANCE.
 - GRADE SITE AND STABILIZE DISTURBED AREAS IN ACCORDANCE WITH SEEDING PLAN.
 - CONSTRUCT CHURCH ADDITION, SIDEWALKS AND PARKING, STABILIZED DISTURBED AREAS IN ACCORDANCE WITH PERMANENT SEEDING OR SDC.
 - REMOVE SEDIMENT CONTROL DEVICES AFTER APPROVAL BY HOWARD COUNTY.

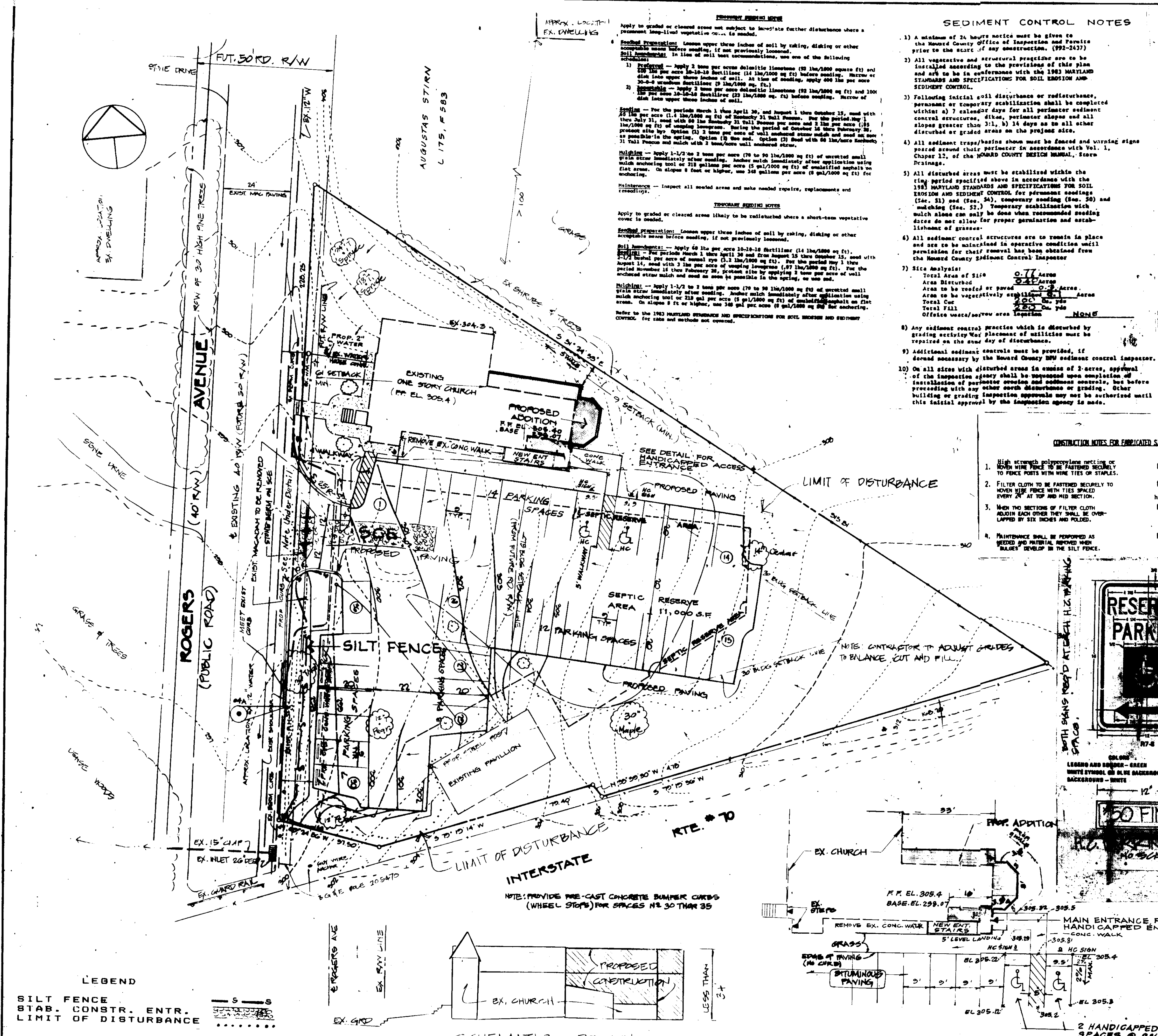

APPROVED FOR PUBLIC WATER AND PRIVATE SEWERAGE SYSTEMS
HOWARD COUNTY HEALTH DEPARTMENT
County Health Officer: *[Signature]* 12-9-91
Date

APPROVED HOWARD COUNTY DEPT. OF PLANNING & ZONING
Planning and Land Development
Chief, Division of Community Planning and Land Development: *[Signature]* 12/20/91
Date

APPROVED FOR PUBLIC WATER, STORM DRAINAGE SYSTEMS AND PUBLIC ROADS
HOWARD COUNTY DEPARTMENT OF PUBLIC WORKS
James M. Helm (ES) 11/15/91
Date

REVIEWED FOR HOWARD SOIL CONSERVATION AND MEETS TECHNICAL REQUIREMENTS
DATE: 10/16/91
OFFICIAL: *[Signature]*

THIS DEVELOPMENT PLAN IS APPROVED FOR SOIL EROSION AND SEDIMENT CONTROL BY THE HOWARD SOIL CONSERVATION DISTRICT
DATE: 10/17/91
OFFICIAL: *[Signature]*

DEVELOPER'S CERTIFICATION
I CERTIFY THAT ALL DEVELOPMENT AND CONSTRUCTION WILL BE DONE ACCORDING TO THE PLAN FOR EROSION AND SEDIMENT CONTROL AND THAT ALL RESPONSIBLE PERSONNEL INVOLVED IN THE CONSTRUCTION PROJECT WILL HAVE A CERTIFICATE OF ATTENDANCE AT THE DEPARTMENT OF THE ENVIRONMENT APPROVED TRAINING PROGRAM FOR THE CONTROL OF SEDIMENT AND EROSION BEFORE PERFORMING THE PROJECT. I ALSO AUTHORIZE PERIODIC ON-SITE INSPECTIONS BY THE HOWARD SOIL CONSERVATION DISTRICT.
DATE: 6-13-91
OFFICIAL: *[Signature]*

ENGINEER'S CERTIFICATION
I CERTIFY THAT THIS PLAN FOR EROSION AND SEDIMENT CONTROL REPRESENTS A FEASIBLE AND WORKABLE PLAN BASED ON PROVISIONAL DETERMINATIONS OF THE SITE SURVEY AND THAT THE PLAN IS IN ACCORDANCE WITH THE REQUIREMENTS OF THE HOWARD SOIL CONSERVATION DISTRICT.
DATE: OCT. 20, 1991
OFFICIAL: *[Signature]*

OWNER: OPEN BIBLE TABERNACLE CHURCH
C/O PASTOR JACK COMPTON
2631 ROGERS AVE
ELLICOTT CITY, MARYLAND 21043

ADDRESS CHART

LOT NUMBER	STREET ADDRESS	POST OFFICE ZIP CODE	WATER CODE
	2631 ROGERS AVE.	21043	W-2

BUILDING ADDITION & PARKING LOT SITE DEVELOPMENT PLAN
OPEN BIBLE TABERNACLE CHURCH
2631 ROGERS AVE.
HOWARD COUNTY, MD. SECTION 2007
TAX MAP: 17 PARCELS SCALE 1" = 20'

PREPARED BY: *[Signature]*