

TYPICAL CROSS SECTION  
G' ASPHALT PATHWAY  
NO SCALE

- LEGEND**
- T — CSP UNDERGROUND CABLE
  - E — BG&E UNDERGROUND CABLE
  - X — EXISTING FENCE LINE
  - - - - EXISTING CURB LINE
  - 6" — FIRE HYDRANT
  - 350 — EXISTING CONTOUR
  - 346 — PROPOSED CONTOUR
  - [Hatched Box] — ASPHALT PAVING
  - [Dotted Box] — CONCRETE
  - [Grid Box] — CONCRETE PAVERS



APPROVED FOR PUBLIC WATER PUBLIC SEWERAGE SYS., MS, STORM DRAINAGE SYSTEMS AND PUBLIC ROADS  
HOWARD COUNTY DEPARTMENT OF PUBLIC WORKS  
DATE: 2.20.91

APPROVED HOWARD COUNTY DEPARTMENT OF PLANNING AND ZONING  
DATE: 1/13/91

APPROVED FOR PUBLIC WATER AND PUBLIC SEWERAGE SYSTEMS,  
HOWARD COUNTY HEALTH DEPARTMENT  
DATE: 12/27/91

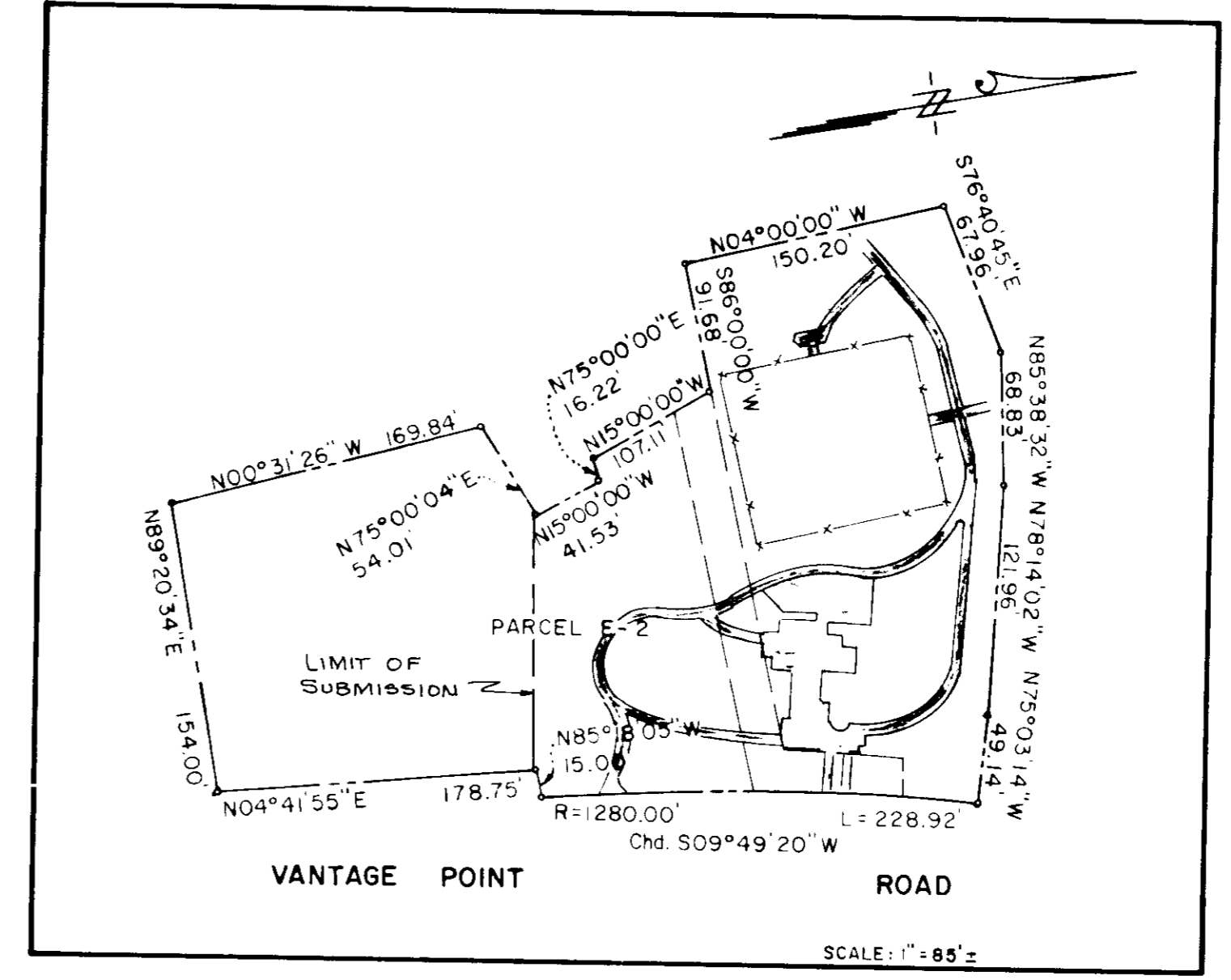

Standard Penetration Test

DEPTH	NO. BLOWES	REMARKS	DESCRIPTION
0.0-1.5	4	1.2/1.5	Dark brown moist loess, clay, some root material and sand (M)
1.5-3.0	3	1.4/1.5	Brown moist medium dense sandy silt with trace to little rock fragments (M)
3.0-4.5	4	1.6/2.5	USDA clay loam
4.5-6.0	5	1.3/1.5	Brown to green-yellow moist medium dense to dense micaceous sandy silt with trace gravel and little clay (M)
6.0-7.5	8	1.3/1.5	USDA loam
7.5-9.0	4	1.3/1.5	Brown to green-yellow moist medium dense to dense micaceous sandy silt with trace gravel and little clay (M)
9.0-10.5	5	1.3/1.5	USDA loam
10.5-12.0	8	1.3/1.5	B.R. 14.5 Topsoil 3
12.0-13.5	8	1.3/1.5	
13.5-15.0	8	1.3/1.5	

Standard Penetration Test

DEPTH	NO. BLOWES	REMARKS	DESCRIPTION
0.0-1.5	4	1.2/1.5	Dark brown moist loess, clay, some root material and sand (M)
1.5-3.0	3	1.4/1.5	Brown moist medium dense sandy silt with trace to little rock fragments (M)
3.0-4.5	4	1.6/2.5	USDA clay loam
4.5-6.0	5	1.3/1.5	Brown to green-yellow moist medium dense to dense micaceous sandy silt with trace gravel and little clay (M)
6.0-7.5	8	1.3/1.5	USDA loam
7.5-9.0	4	1.3/1.5	Brown to green-yellow moist medium dense to dense micaceous sandy silt with trace gravel and little clay (M)
9.0-10.5	5	1.3/1.5	USDA loam
10.5-12.0	8	1.3/1.5	B.R. 14.5 Topsoil 3
12.0-13.5	8	1.3/1.5	
13.5-15.0	8	1.3/1.5	

NOTE: A FEE-IN-LIEU OF STORMWATER MANAGEMENT REQUEST WAS APPROVED BY THE HOWARD COUNTY DEPARTMENT OF PUBLIC WORKS ON AUGUST 20, 1991.

CONTRACTOR TO MAKE CONNECTION TO EXISTING WATER LINE. WATER METER TO BE INSTALLED IN ACCORDANCE WITH HOWARD COUNTY DEPARTMENT OF PUBLIC WORKS SPECIFICATIONS.

**SITE ANALYSIS**

- TOTAL AREA = 1.991 ACRES +-
- DISTURBED AREA = 0.713 ACRES +-
- IMPERVIOUS AREA = 0.450 ACRES +-
- PERVIOUS AREA = 1.541 ACRES +-
- ZONED: R-20 "OPEN SPACE"
- BUILDING AREA = NA SF +-
- PARKING:
  - NO. OF SPACES REQUIRED = NA
  - NO. OF SPACES PROVIDED = NA
  - AREA TO BE DISTURBED = 31,000 SF +-
  - AREA TO BE VEGRETATIVELY STABILIZED = 21,000 SF +-
  - TOTAL CUT = 317 CY +-
  - TOTAL FILL = 113 CY +-
  - TOTAL SPOILBORROW = 208 CY +-

**OWNER/DEVELOPER**  
COLUMBIA PARK & RECREATION ASSOCIATION  
5829 BANNEKER ROAD  
COLUMBIA, MARYLAND 21044  
(301) 381-0020

**ADDRESS CHART**

LOT NO.	STREET ADDRESS
Parcel E-2	5440 VANTAGE POINT ROAD

**SLATER ASSOCIATES**  
SUITE 208 WILDE LAKE VILLAGE GREEN  
COLUMBIA, MARYLAND 21044  
LAND PLANNING  
SITE PLANNING  
LANDSCAPE ARCHITECTURE  
982-0091

**RESPONSIBLE PERSONNEL CERTIFICATION**  
"I HEREBY CERTIFY THAT ANY RESPONSIBLE PERSONNEL INVOLVED IN THE CONSTRUCTION PROJECT WILL HAVE A CERTIFICATE OF ATTENDANCE FROM A DEPARTMENT OF THE ENVIRONMENT APPROVED TRAINING PROGRAM FOR THE CONTROL OF SEDIMENT AND EROSION BEFORE BEGINNING THE PROJECT."  
Signature: Denis Ellis (Civil Engr.) DATE: 5-21-91

**CERTIFICATION BY THE ENGINEER**  
"I CERTIFY THAT THIS PLAN FOR EROSION AND SEDIMENT CONTROL REPRESENTS A PRACTICAL AND WORKABLE PLAN BASED ON MY PERSONAL KNOWLEDGE OF THE SITE CONDITIONS AND THAT IT WAS PREPARED IN ACCORDANCE WITH THE REQUIREMENTS OF THE HOWARD SOIL CONSERVATION DISTRICT."  
Signature: John M. Christman, PE DATE: 5-21-91

**CERTIFICATION BY THE DEVELOPER**  
"I CERTIFY THAT ALL DEVELOPMENT AND OR CONSTRUCTION WILL BE DONE ACCORDING TO THIS PLAN OF DEVELOPMENT AND PLAN FOR EROSION AND SEDIMENT CONTROL AND I ALSO AUTHORIZE PERIODIC ON-SITE INSPECTION BY THE HOWARD SOIL CONSERVATION DISTRICT OR THEIR AUTHORIZED AGENTS, AS DEEMED NECESSARY."  
Signature: Denis Ellis (Civil Engr.) DATE: 5-21-91

THIS DEVELOPMENT PLAN IS APPROVED FOR SOIL EROSION AND SEDIMENT CONTROL BY THE HOWARD SOIL CONSERVATION DISTRICT.  
APPROVED: [Signature] DATE: 5/21/91  
REVIEWED FOR HOWARD S.C.D. AND MEETS TECHNICAL REQUIREMENTS.  
APPROVED: [Signature] DATE: 5/21/91

revisions: none  
description: Revision to Viewing Area  
date: 4/10/91

prepared by: **RBA** ENGINEERS + ARCHITECTS + PLANNERS  
5560 STERRETT PLACE, SUITE 300  
COLUMBIA, MARYLAND 21044  
301 / 730-7950 821-6050

**SITE PLAN**  
SCALE: 1" = 20'  
DRAWN: JMM CHECKED: LTM  
PROJ. NO: M0329 DATE: [blank]  
SHEET: 1 OF 5





- LEGEND**
- CBP UNDERGROUND CABLE
  - B6BE UNDERGROUND CABLE
  - EXISTING FENCE LINE
  - EXISTING CURB LINE
  - 6" FIRE HYDRANT
  - 350 EXISTING CONTOUR
  - 346 PROPOSED CONTOUR

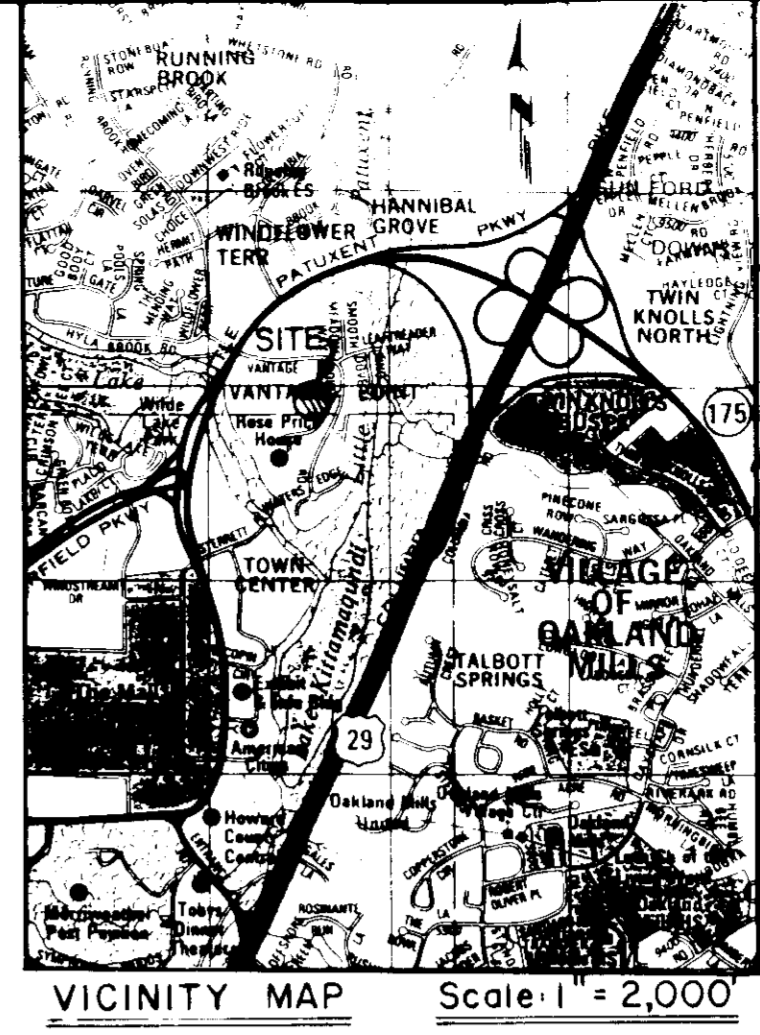

APPROVED FOR PUBLIC WATER, PUBLIC SEWERAGE SYSTEMS, STORM DRAINAGE SYSTEMS AND PUBLIC ROADS  
HOWARD COUNTY DEPARTMENT OF PUBLIC WORKS

*James M. Helms* 2/20/91  
DIRECTOR DATE

*James M. Helms* 12/24/91  
CHIEF, BUREAU OF ENGINEERING DATE

APPROVED HOWARD COUNTY DEPARTMENT OF PLANNING AND ZONING

*James M. Helms* 1/12/92  
DIRECTOR DATE

*James M. Helms* 1/10/92  
CHIEF, DIVISION OF COMMUNITY PLANNING AND LAND DEVELOPMENT DATE

APPROVED FOR PUBLIC WATER AND PUBLIC SEWERAGE SYSTEMS, HOWARD COUNTY HEALTH DEPARTMENT

*James M. Helms* 12/27/91  
COUNTY HEALTH OFFICER DATE

**SPECIFIC TERMS AGREEMENT**  
between  
COLUMBIA ASSOCIATION (CA)  
and  
THE HOWARD SOIL CONSERVATION DISTRICT (HSCD)

**Intent:** The intent of this agreement is: (1) to establish a procedure for approval of certain minor earth disturbing activities associated with the installation of recreation pathways and (2) to allow CA to exercise on-site discretion regarding erosion and sediment control measures for such activities in lieu of obtaining prior approval of a detailed erosion and sediment control plan.

This agreement applies only to those activities specified herein. Any other earth disturbing activities, not within the scope of this agreement, shall be covered by a detailed erosion and sediment control plan, approved by HSCD prior to beginning such activities.

This agreement shall not be construed as a waiver of the requirement to provide effective erosion and sediment control on any type of earth disturbing activity. Its only purpose is to simplify the procedure for complying with the erosion and sediment control requirements on work of a minor (as defined herein) nature.

**General Terms**

- A. This agreement shall remain in effect, on an annually renewable basis, from the date herein, or until terminated by either party upon written notice to the other.
- B. Nothing in this agreement, either expressed or implied shall be interpreted as relieving CA of the responsibility to meet any and all terms or conditions as set forth in the following regulations:
  - (1) The Maryland Code, Natural Resources, Article 8, Subtitle 11--Sediment Control
  - (2) The Howard County Code, Subtitle 4, Sections 3.400 through 3.404
- C. This agreement does not constitute a Permit. Any required permits must be obtained from appropriate authorities.
- D. CA shall designate an official with appropriate authority, to assume responsibility for implementation of this agreement, and who will serve as liaison agent with the Howard Soil Conservation District and the Howard County Sediment Control Division.
- E. The liaison agent shall be responsible for informing the appropriate agencies in a timely manner, of any problems, changes or conditions that might reduce the effectiveness of any proposed or existing erosion or sediment control measures.

**Specific Terms**

- A. All work performed under this agreement shall comply fully with the requirements of the 1983 Maryland Standards and Specifications for Soil Erosion and Sediment Control and/or specific requirements which may be issued by HSCD.
- B. No work covered by this agreement shall be started until written approval (as defined herein) has been received from HSCD.
- C. CA shall be responsible for arranging for immediate repair or replacement of existing erosion or sediment control measures which are removed, damaged, or rendered ineffective by work covered under this agreement.
- D. This agreement applies to earth disturbing activities necessary for the construction of recreational pathways which may be surfaced with bituminous paving, concrete, stone or mulch.
- E. The following grading limitations are imposed:
  - 1) Earth work is limited to grubbing, cutting and filling (except as noted herein) necessary to construct pathways.
  - 2) Fill must be properly compacted, fill height not to exceed three (3) feet, and be no steeper than 3:1 percent. (3:1)
  - 3) Cut slopes may not exceed 2:1, 50 percent.
  - 4) Grading may not impair surface drainage, create an erosion hazard or discharge sediment into any adjacent waterway.
  - 5) Grading or filling within the 100-year flood plain is not permitted without the required permits. In cases where these conditions cannot be met, CA must contact the HSCD for specific recommendations. (This may involve preparation of a custom plan by CA).
- F. Sediment and erosion control measures will be performed as follows:
  - 1) Sediment control measures shall be placed as clearing and grubbing progresses on a day to day basis.
  - 2) Equipment entrances must be stabilized with stone to prevent the tracking of sediment onto public streets. If tracking occurs, immediate cleanup is required.
  - 3) Silt fence or straw bale dikes shall be used around graded areas to contain sediment.

- 4) Following initial soil disturbance or redisturbance, permanent or temporary stabilization shall be completed within: a) seven calendar days for the surface of all perimeter controls and all perimeter slopes; b) fourteen calendar days for all other disturbed or graded areas. Areas where active construction is in progress are exempt.
- 5) Upon completion of final grading all disturbed areas shall be stabilized with concrete, blacktop, stone, or vegetative cover. Areas to be vegetatively stabilized (seeded) shall be stabilized during the first seeding period (March 1 thru April 30, or August 1 thru October 15) following grading. Extension Service Bulletin No. 111 may be used as a guide for seeding.
- 6) All off-site fill or borrow areas must have an approved sediment control plan and permit prior to grading.
- 7) The applicant shall notify the Howard County Sediment Control Division at least 48 hours prior to commencing clearing or grading. Call 992-2431.
- 8) Compliance with the provisions of the agreement shall not relieve CA of taking additional measures when necessary to prevent erosion and sedimentation. Additional requirements may be imposed by the Howard County Sediment Control Inspector assigned to the job, when deemed necessary to prevent erosion and sedimentation.

**OWNER/DEVELOPER**  
COLUMBIA PARK & RECREATION ASSOCIATION  
5829 BANNEKER ROAD  
COLUMBIA, MARYLAND 21044  
(301) 381-0020

**ADDRESS CHART**

BUILDING	STREET ADDRESS
Parcel E-2	5440 VANTAGE POINT ROAD

**SLATER ASSOCIATES**  
SUITE 206 WILDE LAKE VILLAGE GREEN  
COLUMBIA, MARYLAND 21044  
LAND PLANNING  
SITE PLANNING  
LANDSCAPE ARCHITECTURE 882-0001

SUBDIVISION NAME	SECTION/AREA	LOT/ PARCEL
COLUMBIA TOWN CENTER	7/7	E-2
PLAT	BLOCK/ZONE/TAX ZONE	MAR/LEC DIST/CENSUS TR
9025	20 (R-20)	30 5th
WATER CODE	SEWER CODE	

**STONE OUTLET SEDIMENT TRAP**  
D.A. = 9 ACRES  
REQUIRED STORAGE = 3,420 CU FT  
STORAGE PROVIDED = 3,508 CU FT  
CREST ELEVATION = 335.0  
CREST WIDTH = 8.0 FT  
BOTTOM ELEVATION = 331.0  
BOTTOM DIMENSIONS = 60' X 15'  
TOP OF EMBANKMENT ELEV. = 337.5  
SIDE SLOPES = 2:1 FILL, 1:1 CUT  
FLOW DEPTH = 1.0 FT  
DEPTH OF CHANNEL = 1.5 FT  
STORAGE DEPTH = 3.0 FT

**VANTAGE POINT**  
MOUNTABLE BERM

**RESPONSIBLE PERSONNEL CERTIFICATION**  
I HEREBY CERTIFY THAT ANY PERSONNEL PERSONNEL INVOLVED IN THE CONSTRUCTION OF THIS PROJECT WILL HAVE A CERTIFICATE OF ATTENDANCE FROM A DEPARTMENT OF THE ENVIRONMENT APPROVED TRAINING PROGRAM FOR THE CONTROL OF EROSION AND SEDIMENTATION BEGGINNING THE PROJECT.

*Denis Elias* 5-21-91  
SIGNATURE OF DEVELOPER DATE  
DENIS ELIAS (CONS. MGR.)

**CERTIFICATION BY THE ENGINEER**  
I CERTIFY THAT THIS PLAN FOR EROSION AND SEDIMENT CONTROL REPRESENTS A PRACTICAL AND WORKABLE PLAN BASED ON MY PERSONAL KNOWLEDGE OF THE SITE CONDITIONS AND THAT IT WAS PREPARED IN ACCORDANCE WITH THE REQUIREMENTS OF THE HOWARD SOIL CONSERVATION DISTRICT.

*John M. Christman* 5-21-91  
SIGNATURE OF ENGINEER DATE  
JOHN M. CHRISTMAN, PE

**CERTIFICATION BY THE DEVELOPER**  
I CERTIFY THAT ALL DEVELOPMENT AND OR CONSTRUCTION WILL BE DONE ACCORDING TO THIS PLAN OF DEVELOPMENT AND PLAN FOR EROSION AND SEDIMENT CONTROL AND ALSO AUTHORIZE PERIODIC ON-SITE INSPECTION BY THE HOWARD SOIL CONSERVATION DISTRICT OR THEIR AUTHORIZED AGENTS AS DEEMED NECESSARY.

*Denis Elias* 5-21-91  
SIGNATURE OF DEVELOPER DATE  
DENIS ELIAS (CONS. MGR.)

THIS DEVELOPMENT PLAN IS APPROVED FOR SOIL EROSION AND SEDIMENT CONTROL BY THE HOWARD SOIL CONSERVATION DISTRICT

APPROVED *John R. Robinson* 12/2/91  
HOWARD S.C.D. DATE

REVIEWED FOR HOWARD S.C.D. AND MEETS TECHNICAL REQUIREMENTS

APPROVED *James M. Helms* 12/27/91  
HOWARD SOIL CONSERVATION SERVICE DATE



revisions	
no.	description

prepared by  
**RBA**  
ENGINEERS • ARCHITECTS • PLANNERS  
5560 STERRETT PLACE SUITE 300  
COLUMBIA MARYLAND 21044  
301-730-7950 621-6050

**SEDIMENT & EROSION CONTROL PLAN**

**TOWN CENTER PARK**  
COLUMBIA TOWN CENTER

5th ELECTION DISTRICT  
HOWARD COUNTY MARYLAND

SCALE	1" = 20'
DRAWN	CHECKED
JMM	LTM
PROJ NO	DATE
M0329	
2	5
SHEET	OF



**GENERAL NOTES**

- ALL WORK SHALL BE PERFORMED IN ACCORDANCE WITH THE HOWARD COUNTY DESIGN MANUAL STANDARD SPECIFICATIONS AND DETAILS FOR CONSTRUCTION.
- DEVIATIONS FROM THESE PLANS AND SPECIFICATIONS WITHOUT PRIOR WRITTEN CONSENT OF THE CIVIL ENGINEER MAY CAUSE THE WORK TO BE UNACCEPTABLE.
- ADJUSTMENTS TO THE SEQUENCE OF CONSTRUCTION ON SHEET SHALL BE APPROVED BY THE HOWARD COUNTY DEPARTMENT OF INSPECTIONS AND PERMITS PRIOR TO SUCH ADJUSTMENTS.
- CONTRACTOR IS TO REFER TO ARCHITECTS PLANS FOR SPECIFIC BUILDING AND SUPPORT FACILITY FEATURES PRIOR TO AND DURING CONSTRUCTION.
- APPROXIMATE LOCATIONS OF EXISTING UTILITIES ARE SHOWN. THE CONTRACTOR SHALL TAKE ALL NECESSARY PRECAUTIONS TO PROTECT THE EXISTING UTILITIES AND MAINTAIN UNINTERRUPTED SERVICE. ANY DAMAGE INCURRED DUE TO CONTRACTOR'S OPERATIONS SHALL BE REPAIRED IMMEDIATELY AT THE CONTRACTOR'S EXPENSE.
- CONTRACTOR TO ALSO COMPLY WITH SEDIMENT CONTROL NOTES AS DOCUMENTED ON SHEET.
- THERE MAY BE ADDITIONAL UTILITIES NOT SHOWN ON THESE PLANS. THE ENGINEER ASSUMES NO RESPONSIBILITY FOR LOCATIONS SHOWN AND IT SHALL BE THE RESPONSIBILITY OF THE CONTRACTOR TO VERIFY THE LOCATIONS OF ALL UTILITIES WITHIN THE LIMITS OF CONSTRUCTION AND NOTIFY THE ENGINEER.
- CONTRACTOR TO NOTIFY THE FOLLOWING UTILITIES OR AGENCIES AT LEAST FIVE DAYS BEFORE STARTING WORK ON THESE DRAWINGS:  
"MISS UTILITY" 1-(800) 257-7777  
BALTIMORE GAS & ELECTRIC COMPANY (301) 234-5891  
C & P TELEPHONE COMPANY (301) 395-3448
- IT SHALL BE DISTINCTLY UNDERSTOOD THAT FAILURE TO MENTION SPECIFICALLY ANY WORK WHICH WOULD NORMALLY BE REQUIRED TO COMPLETE THE PROJECT SHALL NOT RELIEVE THE CONTRACTOR OF HIS RESPONSIBILITY TO PERFORM SUCH WORK.
- THE CONTRACTOR SHALL OBTAIN THE NECESSARY BUILDING PERMITS FOR CONSTRUCTION.
- ALL UTILITIES ARE TO BE RETAINED UNLESS MARKED OTHERWISE AND ADJUSTMENTS ARE TO BE ADJUSTED TO FINISHED GRADE.
- THE CONTRACTOR SHALL REPAIR AND MAINTAIN EXISTING SEDIMENT CONTROL DEVICES UNTIL ALL AREAS WITHIN THE LIMIT OF CONSTRUCTION ARE STABILIZED. AT THAT POINT, ALL SEDIMENT CONTROL DEVICES SHALL BE REMOVED AND AREAS RESTORED AND STABILIZED.
- THE MEASURES REQUIRED IN THE APPROVED SEDIMENT CONTROL PLAN SHALL APPLY AS IF SHOWN ON THIS PLAN.
- THE CONTRACTOR SHALL CONTACT THE CONSTRUCTION INSPECTION SURVEY DIVISION 24 HOURS IN ADVANCE OF COMMENCEMENT OF WORK AT 792-2417 OR 992-2418.
- TOP TAKEN FROM A SURVEY BY THE RBA GROUP, DATED JANUARY, 1991.
- ALL HORIZONTAL CONTROLS ARE BASED ON MARYLAND STATE COORDINATES.
- THE DEVELOPER IS RESPONSIBLE FOR THE ACQUISITION OF ALL EASEMENTS, RIGHTS AND/OR RIGHTS-OF-WAY THAT MAY BE REQUIRED FOR THE SEDIMENT AND EROSION CONTROL PRACTICES, STORMWATER MANAGEMENT PRACTICES AND THE DISCHARGE OF STORMWATER ONTO OR ACROSS ADJACENT OR DOWNSTREAM PROPERTIES INCLUDED IN THIS PLAN. HE IS ALSO RESPONSIBLE FOR THE ACQUISITION OF ALL EASEMENTS, RIGHTS AND/OR RIGHTS-OF-WAY THAT MAY BE REQUIRED FOR GRADING AND/OR WORK ON ADJACENT PROPERTIES INCLUDED IN THIS PLAN.
- PRIOR TO START OF ANY CONSTRUCTION, CONTRACTOR SHALL STAKEOUT ALL CONSTRUCTION AND VERIFY ALL OFFSETS, SETBACKS, EXISTING UTILITY LOCATIONS (HORIZONTAL AND VERTICAL) AND DIMENSIONS.
- ALL PLAN DIMENSIONS ARE TO FACE UNLESS OTHERWISE NOTED.
- CONTRACTOR SHALL USE DIMENSIONS SHOWN. SCALING OF THESE PLANS IS DISCOURAGED UNLESS DIRECTED BY CIVIL ENGINEER.
- THE CONTRACTOR SHALL TEST PIT EXISTING UTILITIES, WHERE DIRECTED BY THE ENGINEER, A MINIMUM OF TWO WEEKS IN ADVANCE OF CONSTRUCTION OPERATIONS.
- ALL PIPE ELEVATIONS SHOWN ARE INVERT ELEVATIONS.
- THE DEVELOPER MUST REQUEST THAT THE DEPARTMENT OF INSPECTIONS AND PERMITS APPROVE WORK COMPLETED IN ACCORDANCE WITH THE APPROVED EROSION AND SEDIMENT CONTROL PLAN, THE GRADING OR BUILDING PERMIT, AND THE ORDINANCE.
- ON ALL SITES WITH DISTURBED AREAS IN EXCESS OF 2 ACRES, APPROVAL OF THE DEPARTMENT OF INSPECTIONS AND PERMITS SHALL BE REQUIRED ON COMPLETION OF INSTALLATION OF PERIMETER EROSION AND SEDIMENT CONTROLS, BUT BEFORE PROCEEDING WITH ANY OTHER EARTH DISTURBANCE OR GRADING. OTHER BUILDING OR GRADING INSPECTION APPROVALS MAY NOT BE AUTHORIZED UNTIL THE INITIAL APPROVAL BY THE DEPARTMENT OF INSPECTIONS AND PERMITS IS OBTAINED.
- APPROVAL SHALL BE REQUESTED ON FINAL STABILIZATION OF ALL SITES WITH DISTURBED AREAS IN EXCESS OF 2 ACRES BEFORE REMOVAL OF CONTROLS.
- ANY DAMAGE TO COUNTY RIGHTS-OF-WAY AND PAVING OF PUBLIC ROADS SHALL BE REPAIRED IMMEDIATELY AT THE CONTRACTOR'S EXPENSE IN ACCORDANCE WITH THE HOWARD COUNTY SPECIFICATIONS AND STANDARDS.
- CONTRACTOR IS RESPONSIBLE FOR MAKING CONNECTIONS TO ALL BUILDING SERVICES SO AS TO ASSURE COMPLETE UTILITY SERVICES TO AND FROM THE BUILDINGS.
- ALL FILL SHALL BE ROLLED TO A MINIMUM DEGREE OF COMPACTION OF 95% OF THE DRY UNIT WEIGHT AS DETERMINED BY ASTM D-698.
- ALL CONCRETE FOR SITE WORK SHALL BE CLASS 2 CONCRETE AND SHALL BE IN ACCORDANCE WITH THE MARYLAND STATE HIGHWAY ADMINISTRATION SPECIFICATIONS AS AMENDED TO DATE.
- STRUCTURES NOTED FOR REMOVAL SHALL BE REMOVED ENTIRELY AND COMPLETELY. REMOVAL OF UTILITIES OR MATERIALS THAT ARE BELOW GRADE SHALL HAVE THE SURFACE ABOVE RESTORED TO MATCH ADJACENT GRADES.
- ALL DISTURBED AREAS SHALL BE STABILIZED WITH PERMANENT SEED AND MULCH IN ACCORDANCE WITH PLANS APPROVED BY THE HOWARD COUNTY CONSERVATION DISTRICT.
- FOR DETAILS OF UPRIGHT SIGNS AND AREAS FOR HANDICAPPED, SEE THE CODE OF MARYLAND REGULATIONS 05-01-07 MARYLAND BUILDING CODE FOR THE HANDICAPPED.
- PAVED AREAS AS PER DETAILS SHOWN ON THESE APPROVED DRAWINGS.

**SEDIMENT & EROSION CONTROL NOTES**

- A MINIMUM OF 24 HOURS NOTICE MUST BE GIVEN TO THE HOWARD COUNTY OFFICE OF INSPECTION AND PERMITS PRIOR TO THE START OF ANY CONSTRUCTION. (592-2437)
- ALL VEGETATIVE AND STRUCTURAL PRACTICES ARE TO BE INSTALLED ACCORDING TO THE PROVISIONS OF THIS PLAN AND ARE TO BE IN CONFORMANCE WITH THE 1981 MARYLAND STANDARDS AND SPECIFICATIONS FOR SOIL EROSION AND SEDIMENT CONTROL.
- FOLLOWING THE INITIAL SOIL DISTURBANCE OR REDISTURBANCE, PERMANENT OR TEMPORARY STABILIZATION SHALL BE COMPLETE WITHIN: A) SEVEN (7) CALENDAR DAYS AS TO THE SURFACE OF ALL PERIMETER SLOPES AND ALL SLOPES GREATER THAN 3 HORIZONTAL TO 1 VERTICAL (3:1) AND B) FORTYEEN (14) DAYS AS TO ALL OTHER DISTURBED OR GRADED AREAS ON THE PROJECT SITE.
- ALL SEDIMENT TRAPS/BASIN SHOW MUST BE FENCED AND WARNING SIGNS POSTED AROUND THEIR PERIMETER IN ACCORDANCE WITH VOLUME 1, CHAPTER 12 OF HOWARD COUNTY DESIGN MANUAL, STORM DRAINAGE.
- ALL DISTURBED AREAS MUST BE STABILIZED WITHIN THE TIME PERIOD SPECIFIED ABOVE IN ACCORDANCE WITH THE 1981 MARYLAND STANDARDS AND SPECIFICATIONS FOR SOIL EROSION AND SEDIMENT CONTROL FOR PERMANENT SEEDING (SEC. 51), SOE (SEC. 54), TEMPORARY SEEDING (SEC. 50), AND MULCHING (SEC. 52). TEMPORARY STABILIZATION WITH MULCH ALONE CAN ONLY BE DONE WHEN RECOMMENDED SEEDING DATES DO NOT ALLOW FOR PROPER GERMINATION AND ESTABLISHMENT OF GRASSES.
- ALL SEDIMENT CONTROL STRUCTURES ARE TO REMAIN IN PLACE AND ARE TO BE MAINTAINED IN OPERATIVE CONDITION UNTIL PERMITS FOR THEIR REMOVAL HAS BEEN OBTAINED FROM THE HOWARD COUNTY SEDIMENT CONTROL INSPECTOR.
- ANY SEDIMENT CONTROL PRACTICE WHICH IS DISTURBED BY GRADING ACTIVITY FOR PLACEMENT OF UTILITIES MUST BE REPAIRED ON THE SAME DAY OF DISTURBANCE.
- ADDITIONAL SEDIMENT CONTROLS MUST BE PROVIDED IF DEEMED NECESSARY BY THE HOWARD COUNTY DEPT. OF PUBLIC WORKS SEDIMENT CONTROL INSPECTOR.
- ON ALL SITES, DISTURBED AREAS IN EXCESS OF 2 ACRES APPROVAL OF THE INSPECTION AGENCY SHALL BE REQUESTED UPON COMPLETION OF INSTALLATION OF PERIMETER EROSION AND SEDIMENT CONTROLS, BUT BEFORE PROCEEDING WITH ANY OTHER EARTH DISTURBANCE OR GRADING. OTHER BUILDING OR GRADING INSPECTION APPROVALS MAY NOT BE AUTHORIZED UNTIL THIS INITIAL APPROVAL BY THE INSPECTION AGENCY IS MADE.
- REFER TO 1981 MARYLAND STANDARDS AND SPECIFICATIONS FOR THE SOIL EROSION AND SEDIMENT CONTROL FOR THE STANDARD DETAILS AND DETAILED SPECIFICATIONS OF EACH PRACTICE SPECIFIED HEREIN.
- WITH THE APPROVAL OF THE SEDIMENT CONTROL INSPECTOR, MINOR FIELD ADJUSTMENTS CAN AND WILL BE MADE TO INSURE THE CONTROL OF ANY SEDIMENT. CHANGES IN SEDIMENT CONTROL PRACTICES REQUIRE PRIOR APPROVAL OF THE SEDIMENT CONTROL INSPECTOR AND THE HOWARD COUNTY SOIL CONSERVATION DISTRICT.
- ANY CHANGE TO THE GRADING PROPOSED ON THIS PLAN REQUIRES RE-SUBMISSION TO HOWARD COUNTY SOIL CONSERVATION DISTRICT FOR APPROVAL.
- DUST CONTROL WILL BE PROVIDED FOR ALL DISTURBED AREAS. REFER TO 1981 MARYLAND STANDARDS AND SPECIFICATIONS FOR SOIL EROSION AND SEDIMENT CONTROL, PP 62.01 OR 62.02 FOR ACCEPTABLE METHODS AND SPECIFICATIONS FOR JUST CONTROL.
- ANY VARIATION FROM THE SEQUENCE OF OPERATIONS STATED ON THIS PLAN REQUIRES THE APPROVAL OF THE SEDIMENT CONTROL INSPECTOR AND THE HOWARD COUNTY SOIL CONSERVATION DISTRICT PRIOR TO THE INITIATION OF THE CHANGE.
- ANY DISTURBED EARTH LEFT IDLE FOR PERIODS EXCEEDING 30 DAYS SHALL BE STABILIZED ACCORDING TO TEMPORARY STABILIZATION SPECIFICATIONS.
- AT THE END OF EACH WORKING DAY ALL SEDIMENT CONTROL PRACTICE WILL BE INSPECTED AND LEFT IN OPERATIONAL CONDITION.
- AT THIS TIME, WE BELIEVE THAT SECTIONS 404 OR 401 OF THE CLEAN WATER ACT DO NOT EFFECT OUR SITE.
- THE DEVELOPER IS RESPONSIBLE FOR THE ACQUISITION OF ALL EASEMENTS, RIGHTS, AND/OR RIGHTS-OF-WAY THAT MAY BE REQUIRED FOR THE SEDIMENT AND EROSION CONTROL PRACTICES, STORMWATER MANAGEMENT PRACTICES AND THE DISCHARGE OF STORMWATER ONTO OR ACROSS ADJACENT OR DOWNSTREAM PROPERTIES INCLUDED IN THIS PLAN. HE IS ALSO RESPONSIBLE FOR THE ACQUISITION OF ALL EASEMENTS, RIGHTS AND/OR RIGHTS-OF-WAY THAT MAY BE REQUIRED FOR GRADING AND/OR WORK ON ADJACENT PROPERTIES INCLUDED IN THIS PLAN.
- THE SEDIMENT CONTROL APPROVALS ON THIS PLAN EXTEND ONLY TO AREAS AND PRACTICES IDENTIFIED AS PROPOSED WORK.
- THE APPROVAL OF THE PLAN FOR SEDIMENT AND EROSION CONTROL DOES NOT RELIEVE THE DEVELOPER, CONSULTANT FROM COMPLYING WITH ANY FEDERAL, STATE/COUNTY REQUIREMENTS APPLICABLE TO ENVIRONMENTAL ISSUES.

**PERMANENT SEEDING & SODDING SPECIFICATION**

- All disturbed areas shall be seeded and mulched.
- Seeded Preparation - Apply 2 tons per acre of lime and 100 lb. per acre of 10-10-10 fertilizer of equivalent. Thoroughly mix into soil to a minimum of 3".
- Seeding - Use 40% Kentucky tall fescue, 25% Kentucky bluegrass, 10% annual rye and 25% Red fescue at the rate of 250 lb. per acre.
- Mulching - Use clean, unweathered, unchopped small grain straw at the rate of 1-1/2 to 2 tons per acre anchored down with cutback asphalt at the rate of 5-8 gallons per 1000 sq. ft.
- Disking and harrowing shall be done on contour.
- Sod shall be state "approved sod" inspected and approved by MD Dept. of Agriculture. All sod shall be laid on site no more than 16 hours after it has been cut. It shall be a mixture of 40% (min.) Kentucky 31 tall fescue and 40% (min.) Kentucky bluegrass.
- Sod Peds or Stakes be untreated wood pegs driven through and flush with sod. All slopes with a grade 3 to 1 or steeper shall be pegged at a minimum of 4 pegs per square yard of sod.
- Soil Preparation weeds and undesirable grasses growing on existing grade that is to be seeded and/or sodded must be cut and removed before soil preparation begins. Before seeding or sodding all soil shall be loosened by means of tilling and/or disking. All trash, debris, rocks, broken wire, rocks, stones and other foreign debris over one inch in diameter shall be removed prior to seeding and/or sodding, to a depth of four (4") inches.

- Sodding, Seeding and Mulching - May be done immediately after final grading, provided that sod has remained in good, friable condition and has not become soddy or hard. If it has become hard, it shall be tilled to friable condition again.
- Seed shall be worked into the top 1/4" of soil by means of raking, wire drag or other approved equipment. During periods of high temperature and/or drought, the soil shall be watered immediately prior to laying the sod. All sod shall be laid at right angles to slopes. No sod shall be applied to frozen ground and no frozen sod is to be laid. Seeding shall commence immediately during or after the laying operation, and will be sufficient to thoroughly wet the sod roots and the soil below.

**Permanent Seeding:** Shall be done February 1 through 10, and May 1 through October 31. Irrigation for permanent seeding shall be done between May 1 and August 14.

**Temporary Seeding:** Shall be done between February 1 through April 14 and August 15 through November 30. All other disturbed areas requiring stabilization not within the seeding dates shall be mulched.

Sediment control devices (ditches - dikes - traps, etc.) are to remain in place until contributing watershed has been stabilized. Maintenance to sediment control devices during the undergoing grading, construction and development should be done as necessary. Removal of these devices shall be with the approval of the Montgomery County sediment control inspector.

**Temporary Seeding Specifications**

- All temporary seeded areas shall be mulched immediately after seeding. Mulch materials should be unweathered, unchopped, small grain straw spread at a rate of 1-1/2 to 2 tons per acre. The mulch shall be anchored immediately after placement with asphalt, peg and twine, plastic nettings or by a mulch anchoring tool.
- Lime and fertilizer shall be required for temporary seeding in accordance with the following procedure:
  - Pulverized dolomitic limestone is to be applied at the rate of 46 lbs. per 1,000 sq. ft.
  - Fertilizer shall be 10-10-10 or equivalent and applied at the rate of 12 to 18 lbs. per 1,000 sq. ft.

**Seeded Preparation**

The top layer of soil shall be loosened by disking or raking (shall be done on contour) at a depth of at least 3", before seeding occurs.

**Seeding**

- Lime: 50 lbs. of dolomitic limestone per 1,000 sq. ft.
  - Fertilizer: 15 lbs. of 10-10-10 per 1,000 sq. ft.
  - Seed: Italian rye or perennial rye at 0.92 lbs. per 1,000 sq. ft. (Notes: February 1st - April 30th, or August 15-November 1st) Millet - same rate as above (Date: May 1st - August 15 only)
  - Mulch: Same rate as above (Date: November 2 - January 31, only)
- Planting Depth: 1" to 2" for all of the above.

**SEQUENCE OF CONSTRUCTION**

- OBTAIN GRADING PERMIT.
- NOTIFY HOWARD COUNTY SOIL CONSERVATION DISTRICT AND THE HOWARD COUNTY BUREAU OF LICENSES, INSPECTIONS, AND PERMITS AT LEAST 48 HOURS BEFORE ANY WORK BEGINS.
- CLEAN AND GRUB FOR THE INSTALLATION OF SEDIMENT AND EROSION CONTROL MEASURES ONLY.
- INSTALL SEDIMENT CONTROL MEASURES.
- NOTIFY HOWARD COUNTY, BUREAU OF LICENSES, INSPECTIONS AND PERMITS AND THE SEDIMENT CONTROL INSPECTOR UPON COMPLETION OF SEDIMENT CONTROL INSTALLATION.
- BEGIN SITE GRADING, MAINTAIN POSITIVE DRAINAGE TO SEDIMENT CONTROL STRUCTURES.
- DURING BUILDING CONSTRUCTION, MAINTAIN ALL SEDIMENT CONTROL STRUCTURES.
- PERMANENTLY STABILIZE ALL REMAINING DISTURBED AREAS.
- AFTER OBTAINING PERMISSION FROM THE SEDIMENT CONTROL INSPECTOR, REMOVE ALL EROSION CONTROL DEVICES, FINAL GRADE AND STABILIZE IF NECESSARY.

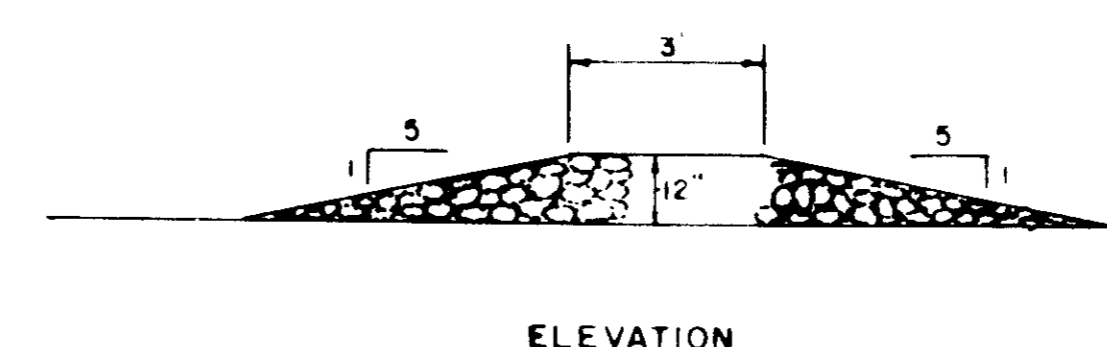

STONE - CRUSHED AGGREGATE #2 (1-1/2" TO 3") OR RECLAIMED OR RECYCLED CONCRETE SHALL BE USED.

**5 MOUNTABLE BERM NO SCALE**

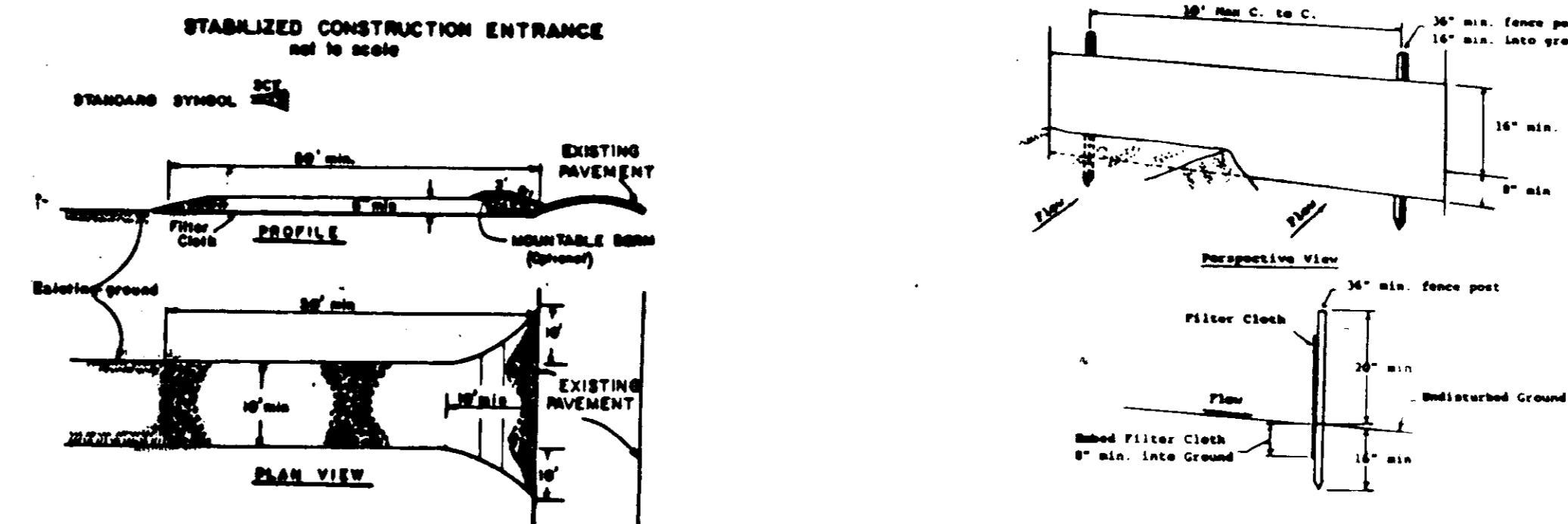

- STANDARD SYMBOL**
- 36" wide curb
  - 36" wide filter cloth
  - 36" wide concrete apron
- CONSTRUCTION SPECIFICATIONS**
- 36" wide curb - Use 2" stone, or reinforced or unrecycled concrete aprons. Apron - 30 required, but not less than 30 feet (except on a single road) apron for those a 30 feet minimum length would apply).
  - 36" wide filter cloth - Use 30 mesh minimum length would apply).
  - 36" wide apron - Use 12" wide minimum, not less than the full width at 12" wide apron or more apron.
  - Surface water - All surface water on the entire area prior to placing of stone filter will not be required on a single family residential lot.
  - Surface water - All surface water on the entire area prior to placing of stone filter will not be required on a single family residential lot.
  - Maintenance - The entrance shall be maintained in a condition which will prevent blocking or flowing of sediment onto public right-of-way. This may require periodic long sweeping with additional stone as conditions demand and 1/2 cubic yard of stone or more used to trap sediment. All maintenance shall be done on a regular basis. Maintenance shall be done on a regular basis.
  - Sealing - Vehicle shall be cleaned to remove sediment prior to entrance onto public right-of-way. When washing is required, it shall be done on an area stabilized with stone and which drains into an approved sediment trap/pit.
  - Periodic inspection and needed maintenance shall be provided after each rain.

**1 STABILIZED CONSTRUCTION ENTRANCE NOT TO SCALE**

**3 SILT FENCE NOT TO SCALE**

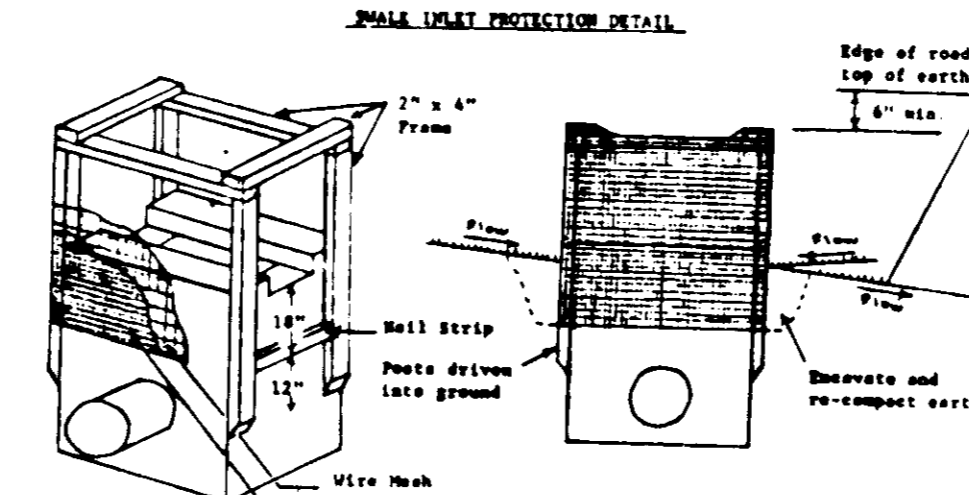

**2 CURB INLET PROTECTION DETAIL**

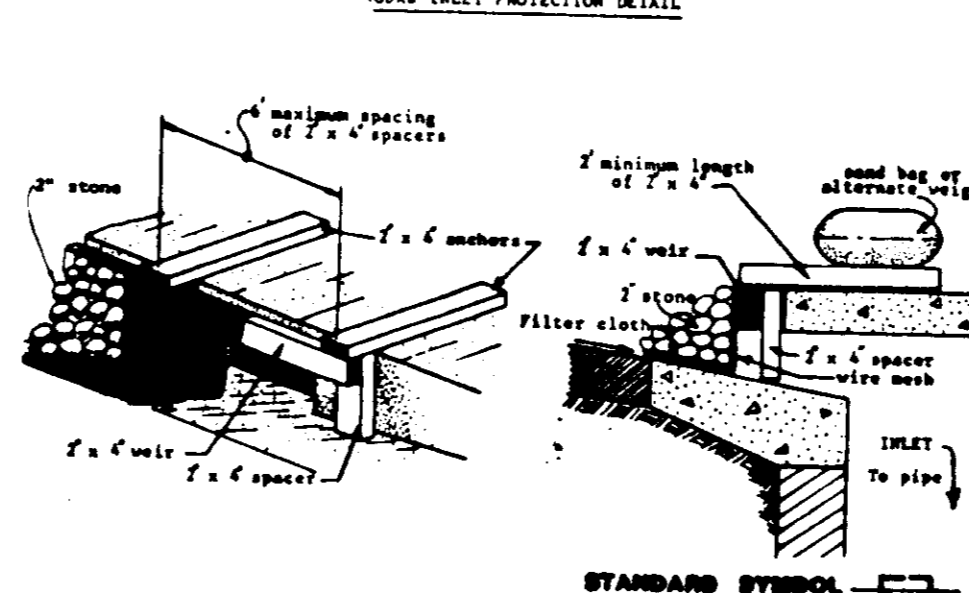

**2 INLET PROTECTION NOT TO SCALE**

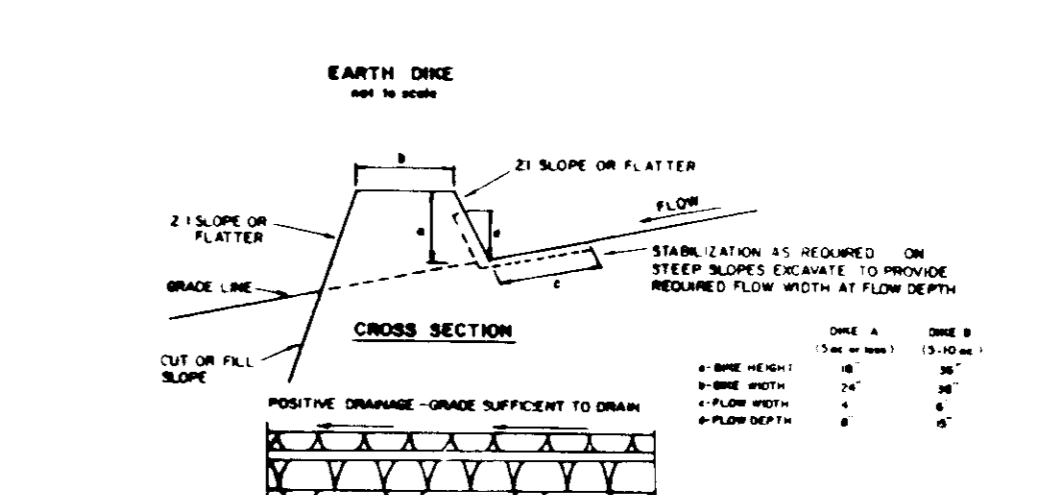

**4 EARTH DIKE DETAIL NOT TO SCALE**

APPROVED FOR PUBLIC WATER, PUBLIC SEWERAGE SYSTEMS, STORM DRAINAGE SYSTEMS AND PUBLIC ROADS  
HOWARD COUNTY DEPARTMENT OF PUBLIC WORKS

*[Signature]* 12/20/91  
DIRECTOR DATE

APPROVED HOWARD COUNTY DEPARTMENT OF PLANNING AND ZONING

*[Signature]* 11/13/92  
DIRECTOR DATE

CHIEF DIVISION OF COMMUNITY PLANNING AND LAND DEVELOPMENT

APPROVED FOR PUBLIC WATER AND PUBLIC SEWERAGE SYSTEMS, HOWARD COUNTY HEALTH DEPARTMENT

*[Signature]* 12/27/91  
COUNTY HEALTH OFFICER DATE

**SLATER ASSOCIATES**  
SUITE 205 WILDE LAKE VILLAGE GREEN  
COLUMBIA, MARYLAND 21044

LAND PLANNING  
SITE PLANNING  
LANDSCAPE ARCHITECTURE 800-0001

**OWNER/DEVELOPER**  
COLUMBIA PARK & RECREATION ASSOCIATION  
5829 BANNER ROAD  
COLUMBIA, MARYLAND 21044  
(301) 381-0020

ADDRESS CHART	
BUILDING	STREET ADDRESS
Parcel E-2	5440 VANTAGE POINT ROAD
SUBDIVISION NAME: COLUMBIA TOWN CENTER	
SECTION/AREA: 7/7	LOT/PARCEL: E-2
PLAT: 9025	BLOCK/ZONE: 20 R 20
TAX/ZONE: 30	MAP/ELEC DIST: 5th
WATER CODE	SEWER CODE

**RESPONSIBLE PERSONNEL CERTIFICATION**

I HEREBY CERTIFY THAT ANY RESPONSIBLE PERSONNEL INVOLVED IN THE CONSTRUCTION PROJECT WILL HAVE A CERTIFICATE OF ATTENDANCE FROM A DEPARTMENT OF THE ENVIRONMENT APPROVED TRAINING PROGRAM FOR THE CONTROL OF SEDIMENT AND EROSION BEFORE BEGINNING THE PROJECT.

*[Signature]* 5-21-91  
SIGNATURE OF DEVELOPER DATE

*[Signature]* DENIS ELLIS (CONS. MGR.)

**CERTIFICATION BY THE ENGINEER**

I CERTIFY THAT THIS PLAN FOR EROSION AND SEDIMENT CONTROL PRESENTS A PRACTICAL AND WORKABLE PLAN BASED ON MY PERSONAL KNOWLEDGE OF THE SITE CONDITIONS AND THAT IT WAS PREPARED IN ACCORDANCE WITH THE REQUIREMENTS OF THE HOWARD COUNTY CONSERVATION DISTRICT.

*[Signature]* 5-21-91  
SIGNATURE OF ENGINEER DATE

*[Signature]* JOHN M. CHRISTMAN, PE

**CERTIFICATION BY THE DEVELOPER**

I CERTIFY THAT ALL DEVELOPMENT AND OR CONSTRUCTION WILL BE DONE ACCORDING TO THIS PLAN OF DEVELOPMENT AND PLAN FOR EROSION AND SEDIMENT CONTROL, AND I ALSO AUTHORIZE PERIODIC ON-SITE INSPECTION BY THE HOWARD COUNTY CONSERVATION DISTRICT OR THEIR AUTHORIZED AGENTS, AS DEEMED NECESSARY.

*[Signature]* 5-21-91  
SIGNATURE OF DEVELOPER DATE

*[Signature]* DENIS ELLIS (CONS. MGR.)

THIS DEVELOPMENT PLAN IS APPROVED FOR SOIL EROSION AND SEDIMENT CONTROL BY THE HOWARD COUNTY CONSERVATION DISTRICT

APPROVED *[Signature]* 12/12/91  
HOWARD S.C.D. DATE

REVIEWED FOR HOWARD S.C.D. AND MEETS TECHNICAL REQUIREMENTS

APPROVED *[Signature]* 12/12/91  
U.S. SOIL CONSERVATION SERVICE DATE

no.	description	date

prepared by **RBA** ENGINEERS - ARCHITECTS - PLANNERS

3550 STERRETT PLACE, SUITE 300  
COLUMBIA MARYLAND 21044  
301 / 730-7950 621-6050

**SEDIMENT & EROSION CONTROL DETAILS**

TOWN CENTER PARK  
COLUMBIA TOWN CENTER

5th ELECTION DISTRICT  
HOWARD COUNTY MARYLAND

SCALE AS SHOWN	DRAWN	CHECKED
3	TR	DATE
5	PROJ. NO. M0329	DATE
SHEET	3	OF



APPROVED FOR PUBLIC WATER, PUBLIC SEWERAGE SYSTEMS, STORM DRAINAGE SYSTEMS AND PUBLIC ROADS  
 HOWARD COUNTY DEPARTMENT OF PUBLIC WORKS  
 DIRECTOR: *James M. Helton* DATE: 12/20/91  
 CHIEF, BUREAU OF ENGINEERING

APPROVED HOWARD COUNTY DEPARTMENT OF PLANNING AND ZONING  
 DIRECTOR: *James M. Helton* DATE: 11/3/92  
 CHIEF, DIVISION OF COMMUNITY PLANNING AND LAND DEVELOPMENT

APPROVED FOR PUBLIC WATER AND PUBLIC SEWERAGE SYSTEMS, HOWARD COUNTY HEALTH DEPARTMENT  
 COUNTY HEALTH OFFICER: *James M. Helton* DATE: 12/27/91

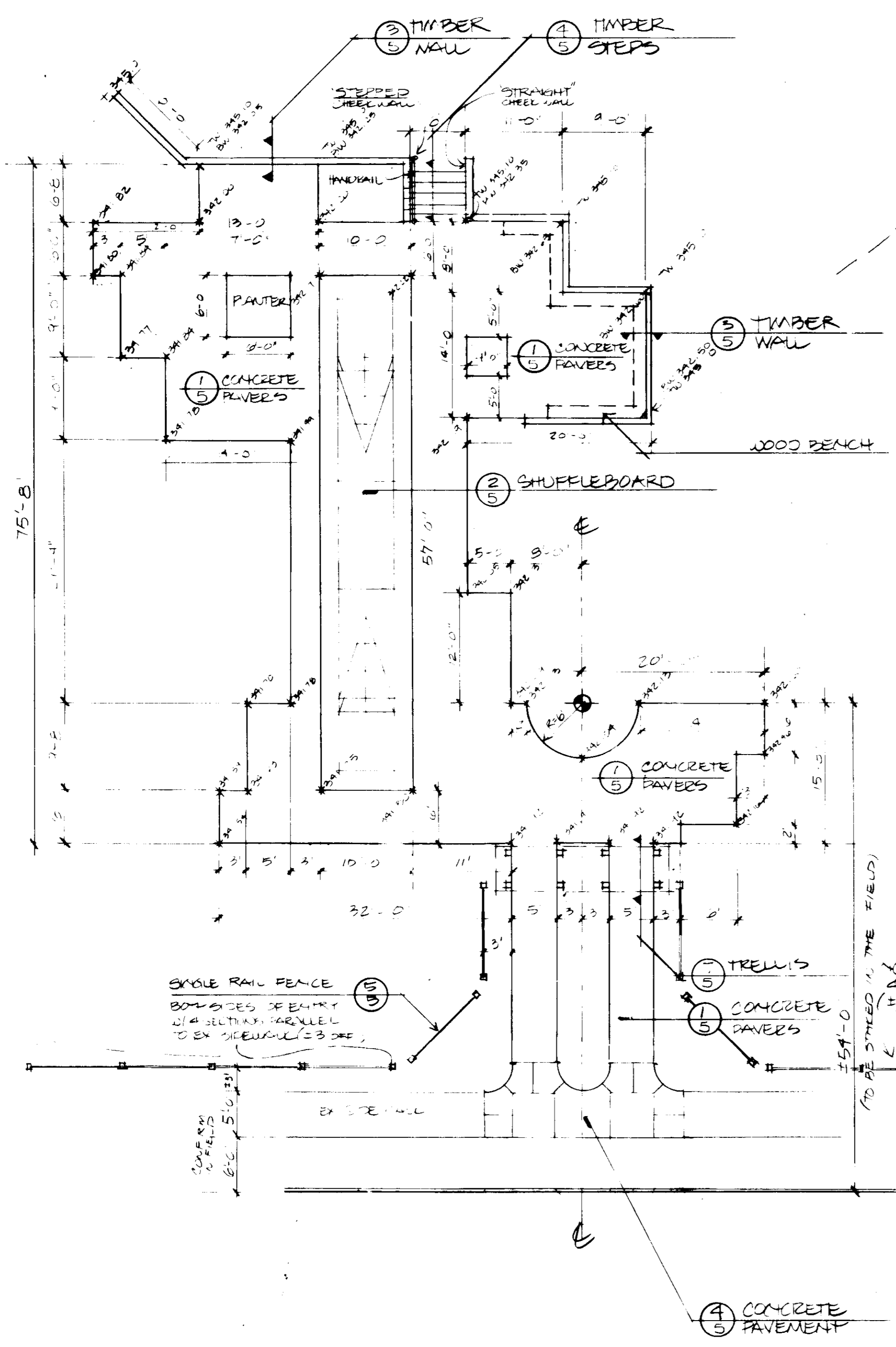

**1 Plaza Layout and Grading**  
 1"=10'-0"

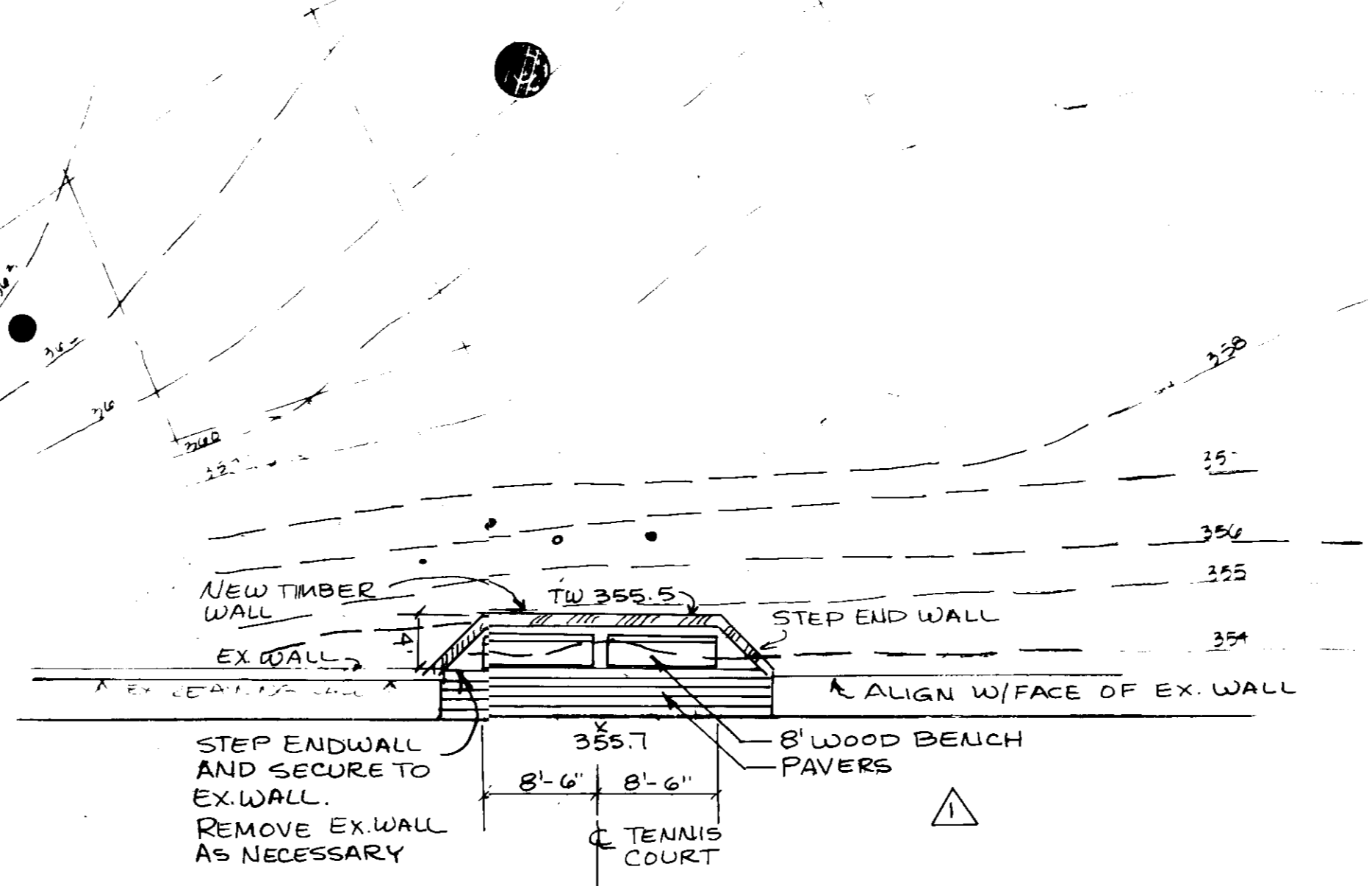

**2 Viewing Area Layout and Grading**  
 1"=10'-0"

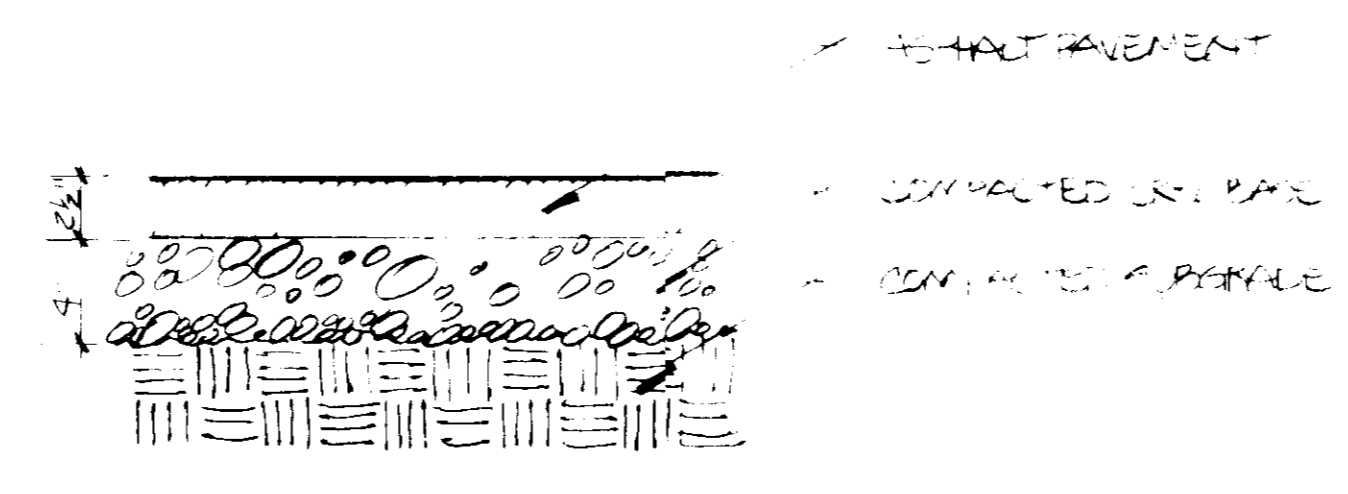

**3 Asphalt Pavement Section**  
 1/2"=1'-0"

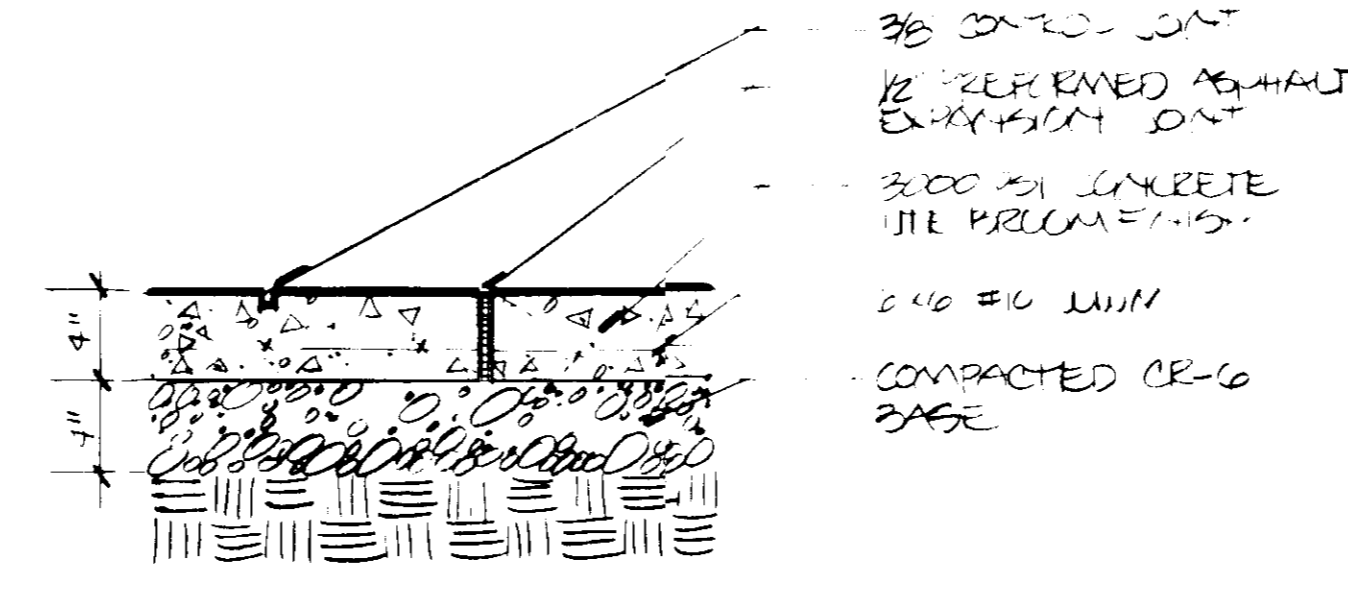

**4 Concrete Pavement Section**  
 1/2"=1'-0"

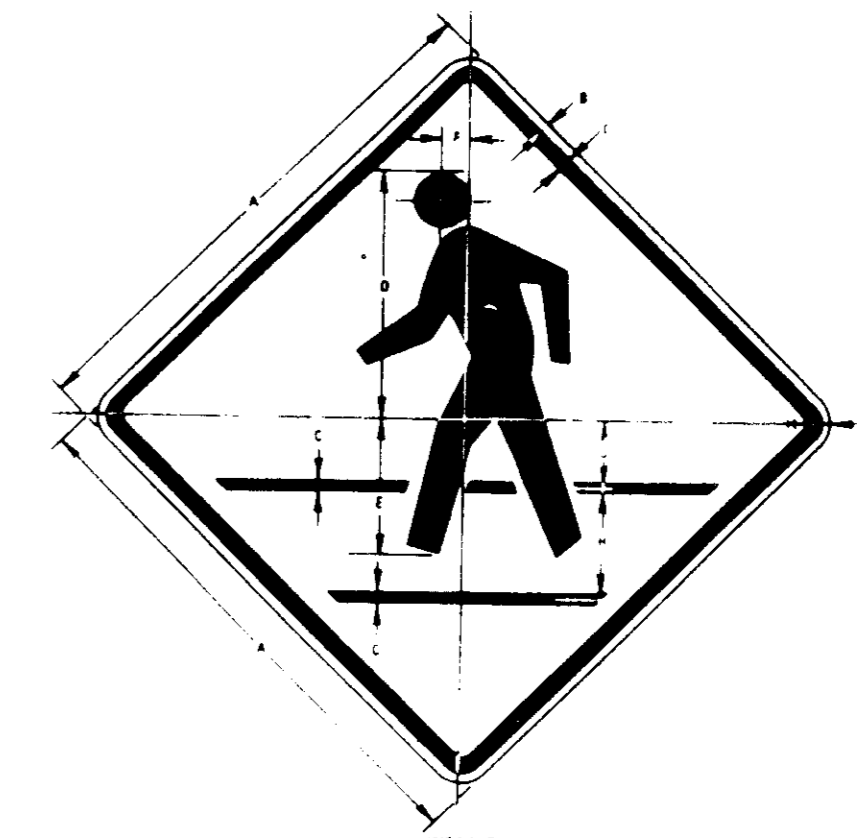

**6 PEDESTRIAN CROSSING SIGN DETAIL**  
 NO SCALE

SIGN	DIMENSIONS (INCHES)							
	A	B	C	D	E	F	G	H
WALK	18	36	54	8.25	4.25	2.56	3.54	1.12
WALK	24	36	54	11	4.25	2.56	3.18	1.12
WALK	30	36	54	14	4.25	2.56	2.56	1.12
WALK	36	36	54	17	4.25	2.56	2.56	1.12
SPECIAL	42	36	54	20	4.25	2.56	2.56	1.12

NOTE: STANDARD DIMENSIONS TO BE USED FOR ALL SIGNS

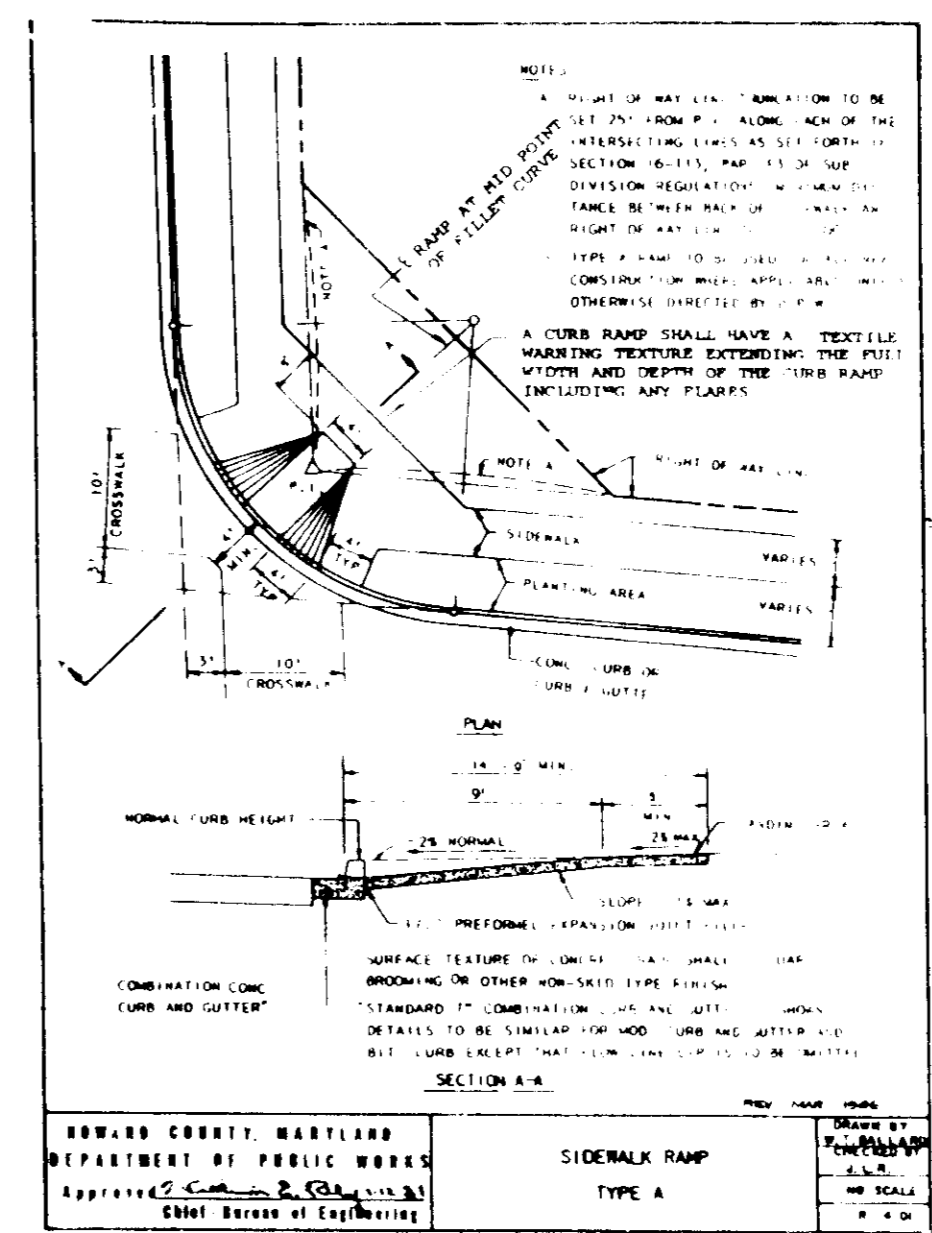

**5 HANDICAP SIDEWALK RAMP DETAIL**  
 NO SCALE

**SLATER ASSOCIATES**  
 205 W. 14th St. #200  
 Columbia, Maryland 21044  
 LAND PLANNING  
 SITE PLANNING  
 LANDSCAPE ARCHITECTURE 892 0001

**OWNER/DEVELOPER**  
 COLUMBIA PARK & RECREATION ASSOCIATION  
 5829 BANNER ROAD  
 COLUMBIA, MARYLAND 21044  
 (301) 381-0070

**ADDRESS CHART**

BUILDING	STREET	ADD. 55
Parcel # 2	5440 VANTAGE POINT ROAD	

**SUBDIVISION NAME**  
 COLUMBIA TOWN CENTER

**SECTION/AREA**  
 3025 20 R 2 30

**LOT/PARCEL**  
 E

**PLAT**  
 3025 20 R 2 30

**WATER CODE**  
 SEWER CODE

**RESPONSIBLE PERSONNEL CERTIFICATION**  
 I HEREBY CERTIFY THAT ANY RESPONSIBLE PERSONNEL INVOLVED IN THE CONSTRUCTION PROJECT WILL HAVE A CERTIFICATE OF ATTENDANCE FROM A DEPARTMENT OF NATURAL RESOURCES APPROVED TRAINING PROGRAM FOR THE CONTROL OF SEDIMENT AND EROSION BEFORE BEGINNING THE PROJECT.  
 SIGNATURE OF DEVELOPER: *Devin Ellis* DATE: 5/21/91

**CERTIFICATION BY THE ENGINEER**  
 I CERTIFY THAT THIS PLAN FOR EROSION AND SEDIMENT CONTROL REPRESENTS A PRACTICAL AND WORKABLE PLAN BASED ON MY PERSONAL KNOWLEDGE OF THE SITE CONDITIONS AND THAT IT WAS PREPARED IN ACCORDANCE WITH THE REQUIREMENTS OF THE HOWARD SOIL CONSERVATION DISTRICT.  
 SIGNATURE OF ENGINEER: *John M. Christman* DATE: 5/21/91

**CERTIFICATION BY THE DEVELOPER**  
 I CERTIFY THAT ALL DEVELOPMENT AND OR CONSTRUCTION WILL BE DONE ACCORDING TO THIS PLAN OF DEVELOPMENT AND PLAN FOR EROSION AND SEDIMENT CONTROL AND I ALSO AUTHORIZE PERIODIC ON-SITE INSPECTION BY THE HOWARD SOIL CONSERVATION DISTRICT OR THEIR AUTHORIZED AGENTS, AS DEEMED NECESSARY.  
 SIGNATURE OF DEVELOPER: *Devin Ellis* DATE: 5/21/91

**THIS DEVELOPMENT PLAN IS APPROVED FOR SOIL EROSION AND SEDIMENT CONTROL BY THE HOWARD SOIL CONSERVATION DISTRICT**  
 APPROVED: *John R. Robertson* DATE: 12/12/91  
 HOWARD SOIL CONSERVATION DISTRICT  
 REVIEWED FOR HOWARD SOIL DISTRICT AND MEETS TECHNICAL REQUIREMENTS  
 APPROVED: *James M. Helton* DATE: 12/12/91  
 SOIL CONSERVATION SERVICE

**REVISIONS**

no.	description	date
1	REVISION TO VIEWING AREA	4/10/92

**prepared by**  
**RBA** ENGINEERS ARCHITECTS PLANNERS  
 1580 STERRETT PLACE SUITE 300  
 COLUMBIA, MARYLAND 21044  
 301 730 7850 FAX 671 6711

**MISCELLANEOUS SITE DETAILS**  
 TOWN CENTER PARK  
 COLUMBIA TOWN CENTER

**DATE**  
 5/21/91

**DRAWN**  
 DEVIN ELLIS

**CHECKED**  
 JOHN M. CHRISTMAN

**DATE**  
 5/21/91

**SHEET**  
 116

