

CALL "MISS UTILITY" AT LEAST 48 HOURS IN ADVANCE OF CONSTRUCTION AT 1-800-257-7777

- Site Analysis
- Boundary and topography by GPI
 - Zoning: M-1
Site address: 6526 Baltimore Washington Boulevard
 - Tax Map No. 38, Block 7
Liber 2239, Folio 065
Census Tract 8012
 - Site Areas:
Gross Site Area: 239,313 SF = 5.953 Ac.
Additional Offsite Area to be Acquired: 40,060 SF = .92 Ac.
Total Site Area = 279,373 SF = 6.873 Ac.
Non-Tidal Wetlands = 52,416 SF = 1.20 Ac.
Open Space Required: (20%) 55,825 SF
Open Space Provided: (23%) 68,146 SF
Maximum Allowable Building Area: (40%)
Proposed Building Area: (6.9%) 17,001 SF
Proposed Impervious Area: 60,269 SF
Proposed Area of Parking Lot: 47,399 SF
Proposed Area of Landscape Islands: 3,798 SF
Landscape Islands Required: (5%)
Landscape Islands Provided: (7.9%)
 - Water and Sewer: Public
Water Code 00
Sewer Code 2150533
 - Parking
Total Spaces Required: 69
Total Handicap Spaces Required: 3
Total Spaces Provided: 108
Total Handicap Spaces Provided: 5
 - Survey Information
For stakeout information see Stormwater/Water and Sewer Plan
Survey book number: #257, #181
Survey book dates: 5-30-90 to present
For detailed storm drain, stormwater management, water and sewer information, see Storm Drain/Water and Sewer Plan.
 - For sediment control information, see Sediment Control Plan
 - For site landscaping, see Landscape Plan.
 - Site work shall be in accordance with the Howard County Standard details as shown:
-Handicapped Ramps - R 4.03
-Contract must ensure that maximum grades specified for the ramps in the solid standards are not exceeded.
-Curb and Gutter - R 3.01 (Standard 7)
-Dumpster Pad - R 11.01
 - Wetlands are delineated as shown on this plan. There will be disturbance of the wetlands or wetland buffer during site development therefore U.S. Army Corps of Engineers Wetland Permits (Section 404 and Section 401) are needed. Unless a revised wetlands delineation determines them based on present accepted criteria.
 - Grading and clearing is not permitted inside the wetlands or the wetlands buffer. Without the appropriate permits.
Benchmarks: A: HO. CO. monument #244504. ELEV=192.5'
B: HO. CO. monument #244505. ELEV=172.6'

A VARIANCE FROM THE 150' B.R.L. WAS GRANTED BY HOWARD COUNTY BOARD OF ZONING RESOLUTION # 209 OF 1991 ADOPTED OCTOBER 7, 1991.

NOTE: CONSTRUCTION OF WORK SHOWN ON THIS PLAN CAN NOT BE STARTED UNTIL SWM POND/SEDIMENT BASIN IS CONSTRUCTED AND FUNCTIONING.

OWNER: HOWARD COUNTY GOVERNMENT
DEVELOPER/APPLICANT
ELKRIDGE LIBRARY
c/o DEPT. OF PUBLIC WORKS
GENERAL PROJECTS DIVISION
3430 COURT HOUSE DRIVE
ELlicott CITY, MD 21043
ATTN. MR. KENNETH EDWARDS
(301) 313-2040

SUBDIVISION NAME		SECT./AREA	PARCEL #
Ho. Co. ELKRIDGE LIBRARY		38	97
PLAT # OR L/F	BLOCK #	TAX/ZONE MAP	ELEC. DIST.
2239/065	7	M-1	1ST
WATER CODE	SEWER CODE		
AOI	2150533		

APPROVED: FOR PUBLIC WATER AND PUBLIC SEWERAGE SYSTEMS. HOWARD COUNTY HEALTH DEPARTMENT		DATE
<i>Joseph Boyden</i>		2-21-92
APPROVED: HOWARD COUNTY DEPT. OF PLANNING & ZONING		DATE
<i>James H. ...</i>		2/25/92
APPROVED: FOR PUBLIC WATER AND PUBLIC SEWERAGE STORM DRAINAGE SYSTEMS AND PUBLIC ROADS HOWARD COUNTY DEPARTMENT OF PUBLIC WORKS		DATE
<i>James ...</i>		1/6/92
ADDRESS CHART		DATE
LOT No.	STREET ADDRESS	
PARCEL 97	6526 BALTIMORE WASHINGTON BLVD. (US. RT. 1)	
OR ROWENBERRY DRIVE		

DATE	REVISION
2/76/92	REV C&P ESMNTS. & HC
8-91-92	REV. POND AND UTILITY AS SHOWN.
PROJ. MGR.	R.E.B.
DESIGN	M.A.H./T.F.R.
DRAWN	M.A.H./T.F.R.
CHECKED	R.L.C.

SITE PLAN

ELKRIDGE LIBRARY
HOWARD COUNTY, MARYLAND
1ST. ELECTION DISTRICT
CAPITAL PROJECT L-0007
TAX MAP 38, PARCEL 97

DRAWING NO.	SCALE	DATE	SHEET NO.
90126	1"=30'	Dec. 7, 1991	C1 OF 8

GREENMAN-PEDERSEN INC.
ENGINEERS/ARCHITECTS/PLANNERS
14504 GREENVIEW DRIVE, SUITE 100, LAUREL, MD. 20708
WASH. (301) 470-2772 BALT. (301) 880-3055

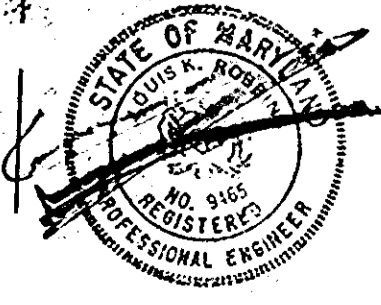

AutoCAD FILE NAME: ELKSITE.DWG

SDP 91-F3

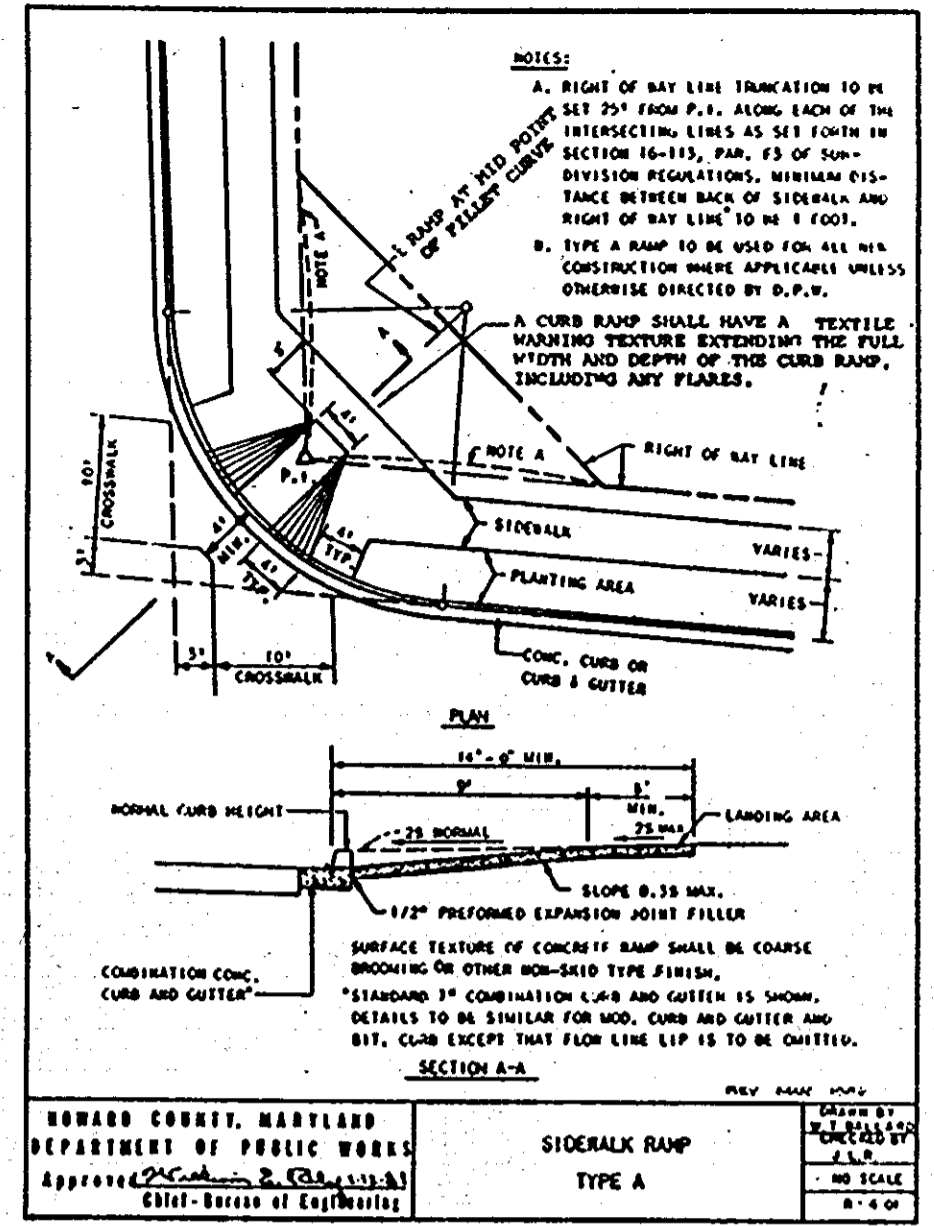
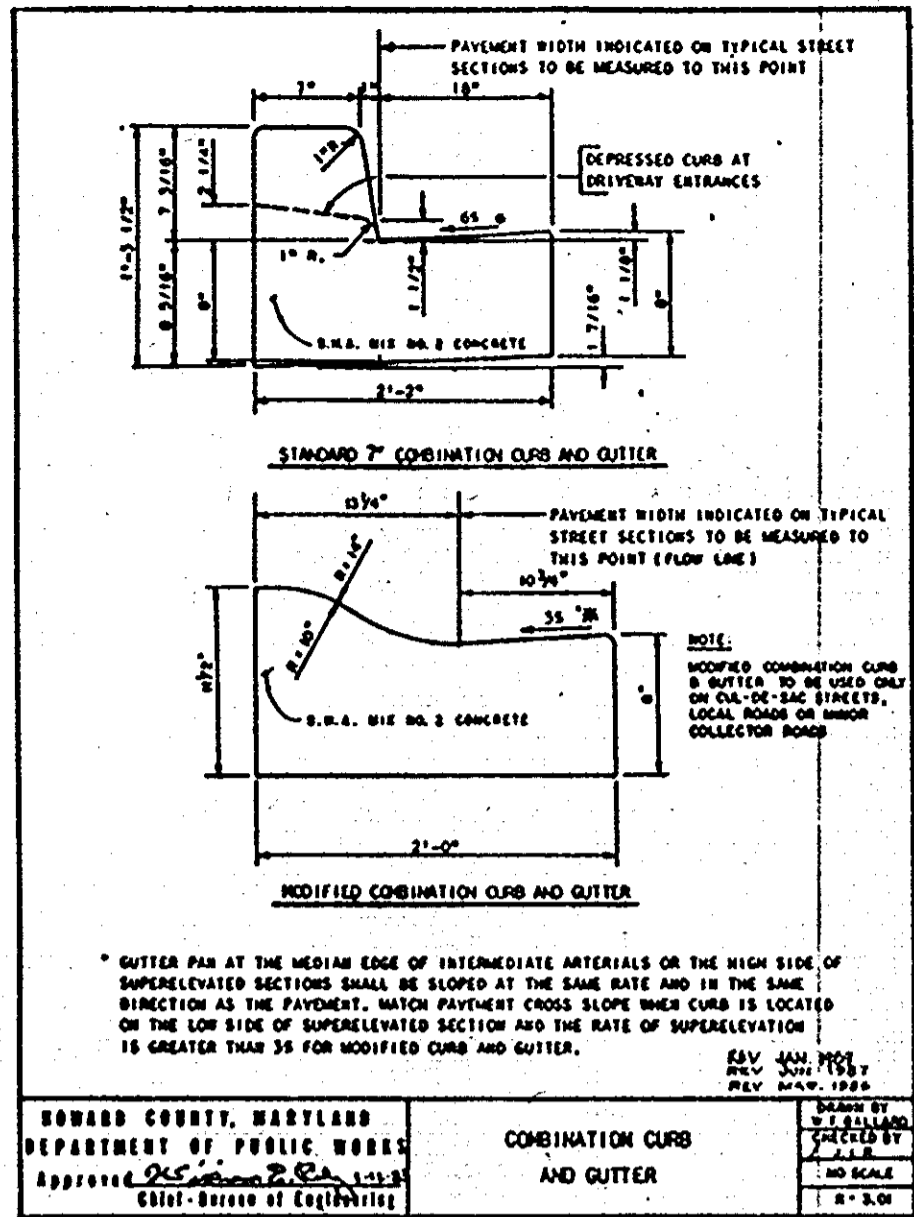

SECTION NUMBER	ROAD AND STREET CLASSIFICATION	PAVEMENT MATERIALS	
		FULL DEPTH BIT. CONC. ALTERNATE	GRAVEL BASE ALTERNATE
P-1	PARKING BAYS APARTMENTS AND COMMERCIAL-INDUSTRIAL ZONES WITH HEAVY TRUCKS	1" BIT. CONC. SURFACE 4" BIT. CONC. BASE	1" BIT. CONC. SURFACE 2" BIT. CONC. BASE 4" GRADED AGGREGATE BASE COURSE
P-2	COMMERCIAL-INDUSTRIAL ZONES MINOR COLLECTOR	1 1/2" BIT. CONC. SURFACE 3 1/2" BIT. CONC. BASE 5" BIT. CONC. BASE	1 1/2" BIT. CONC. SURFACE 1 1/2" BIT. CONC. BASE 5" BIT. CONC. BASE 4" GRADED AGGREGATE BASE COURSE

TRUCKS ARE DEFINED AS THOSE WITH 6 WHEEL OR MORE INCLUDING GARBAGE TRUCKS.

REV. OCT. 1990
REV. JAN. 1991
REV. JUN. 1991
REV. JUL. 1992

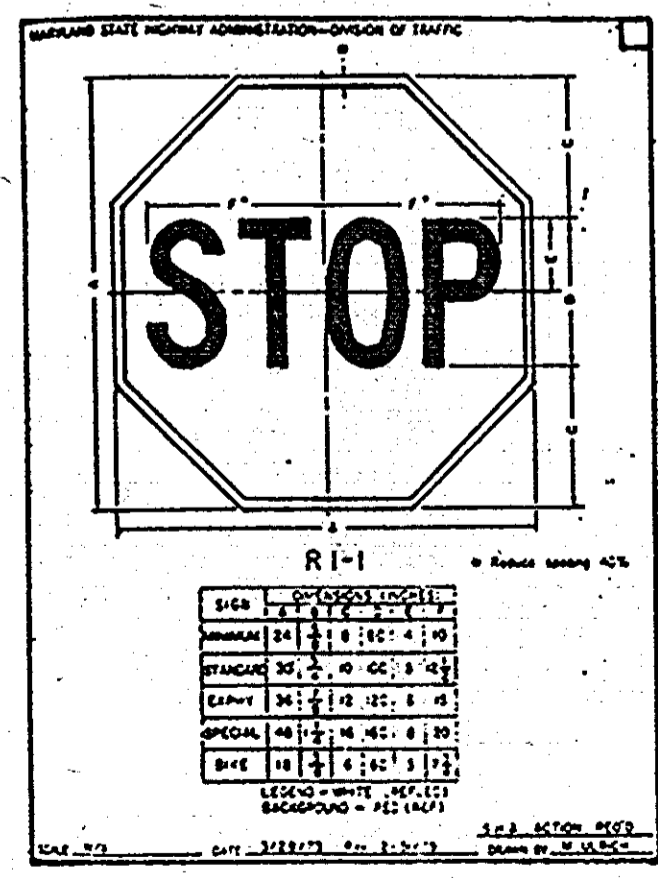
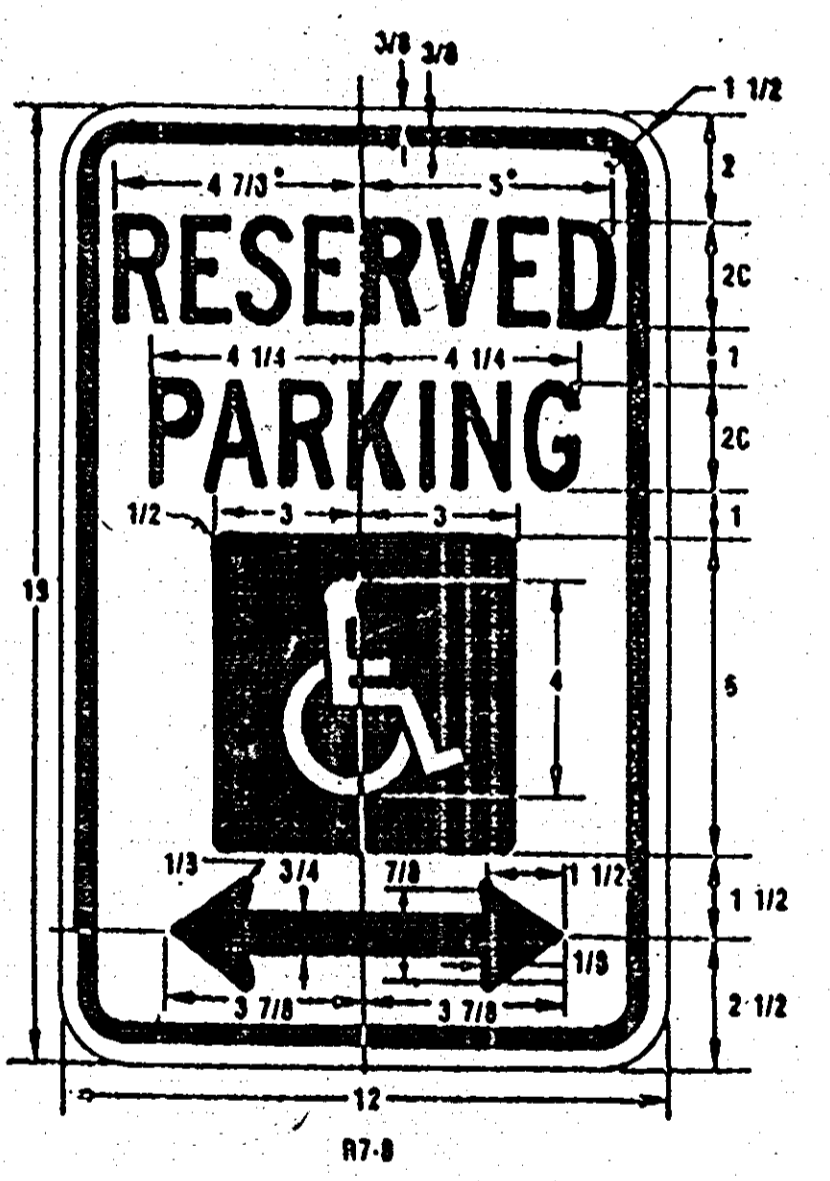
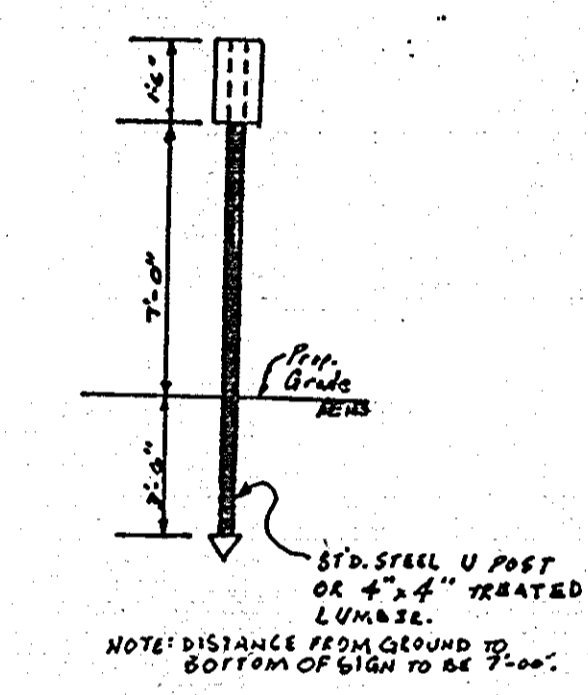
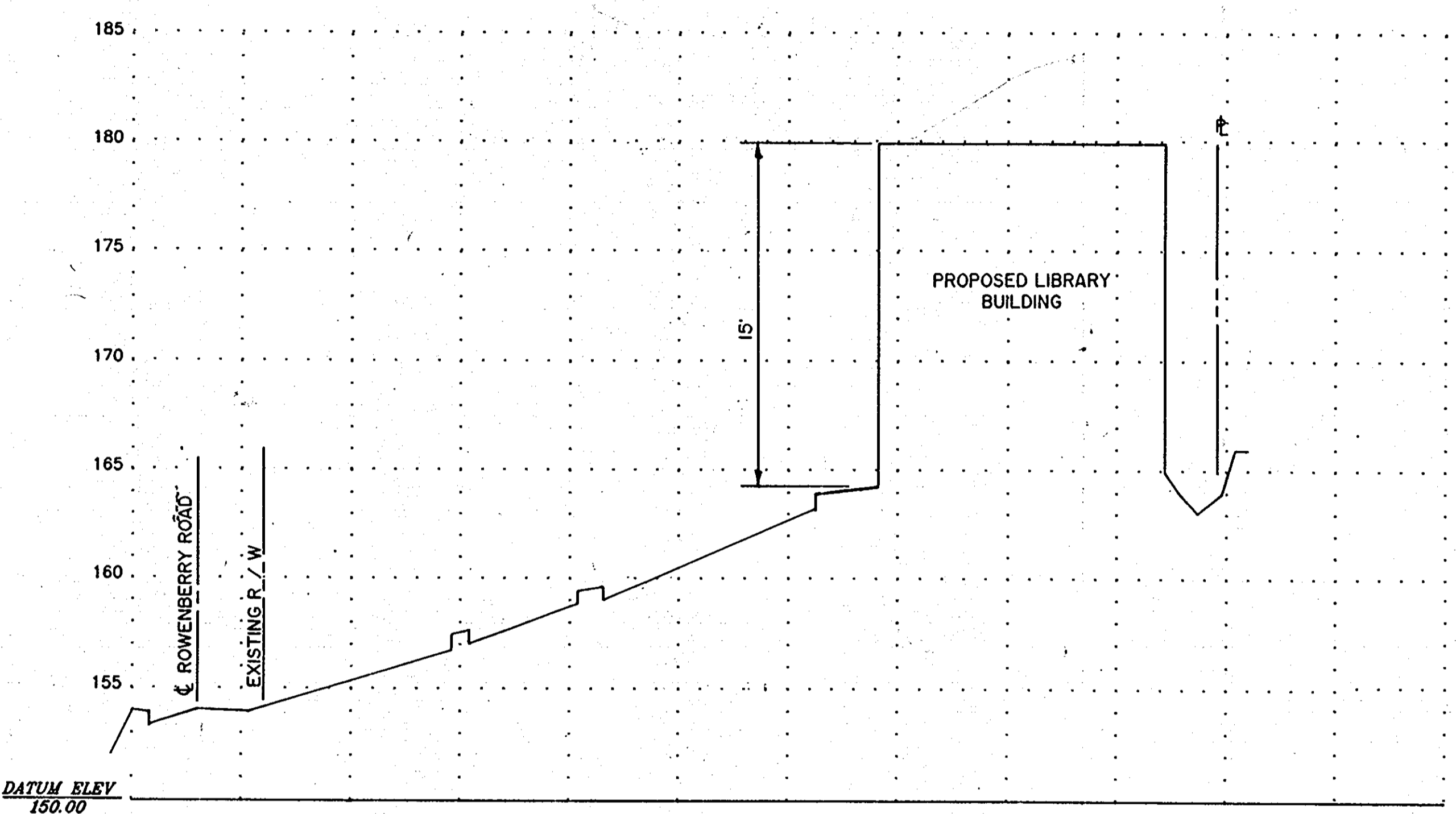

- GENERAL NOTES**
- Drawing and page numbers shown hereon are referenced to the Howard County Design Manual Volume IV and Standard Specifications and Details dated April 7, 1989.
 - The location of existing utilities shown hereon are based on the latest available information. The Contractor shall, however, determine the exact location before making connections.
 - All workmanship and materials shall be in accordance with the Howard County Design Manual Volume IV, Standard Specifications and Details, dated April 7, 1989 unless otherwise specified.
 - The Contractor shall notify the Howard County Construction Inspection Survey Section at 792-2632, 24 hours prior to beginning work.
 - Notify Baltimore Gas & Electric and C & P Telephone Company five (5) days prior to commencing the work.
 - Prior to the start of any operations, the Contractor shall stake out the baselines of construction and verify setbacks and offset dimensions.
 - The Contractor shall notify "Miss Utility" at 1-800-257-7777 at least 72 hours prior to starting excavation to verify all locations of the existing utilities.
 - Abutting properties shall be protected from damage. Repairs are an obligation of the Contractor. Access to areas outside the limit of the contract within the property line is prohibited. The Contractor shall be liable for any damage to existing vegetation and any violations of the protected areas.
 - All disturbed areas not stabilized with paving, seeding, sodding or mulch in planting areas shall be seeded and mulched in accordance with the specifications and sediment control plan, prior to the contract completion.
 - The Contractor shall provide positive drainage at all times.

APPROVED: FOR PUBLIC WATER AND PUBLIC SEWERAGE SYSTEMS,
STORM DRAINAGE SYSTEMS AND PUBLIC ROADS
HOWARD COUNTY DEPARTMENT OF PUBLIC WORKS

[Signature] 2-21-92
COUNTY HEALTH OFFICER DATE

APPROVED: HOWARD COUNTY DEPT. OF PLANNING & ZONING SPP 91-83

[Signature] 2/25/92
DIRECTOR DATE

[Signature] 2/24/92
CHIEF DIVISION OF COMMUNITY PLANNING AND LAND DEVELOPMENT DATE

APPROVED: FOR PUBLIC WATER AND PUBLIC SEWERAGE,
STORM DRAINAGE SYSTEMS AND PUBLIC ROADS
HOWARD COUNTY DEPARTMENT OF PUBLIC WORKS

[Signature] 1/21/92
DIRECTOR DATE

[Signature] 1-2-92
CHIEF BUREAU OF ENGINEERING DATE

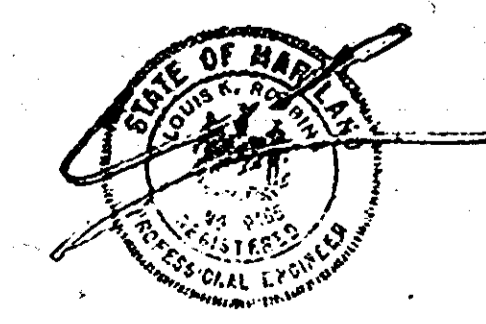

DATE	REVISION

SITE DETAILS

ELKRIDGE LIBRARY
HOWARD COUNTY, MARYLAND
1ST. ELECTION DISTRICT
CAPITAL PROJECT L-0007
TAX MAP 38, PARCEL 97

DRAWING NO. 90126	SCALE AS SHOWN	DATE Dec. 7, 1991	SHEET NO. 02 OF 8
-------------------	----------------	-------------------	-------------------

GREENMAN-PEDERSEN INC.
DIRECTOR/ARCHITECT/PLANNERS
14504 GREENVIEW DRIVE, SUITE 100, LAUREL, MD. 20708
WASH. (301) 470-2772 BALT. (301) 850-3055

spi

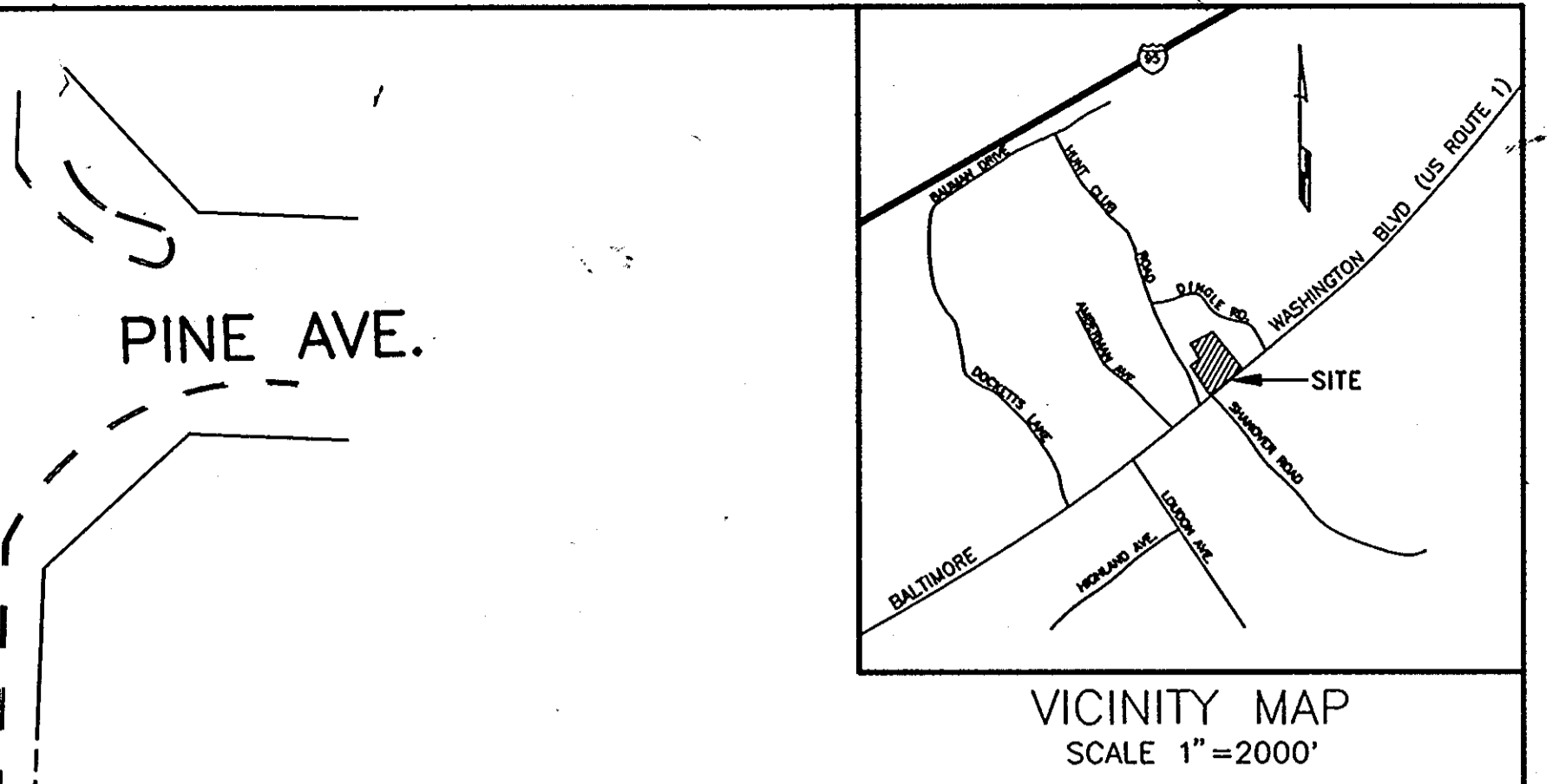
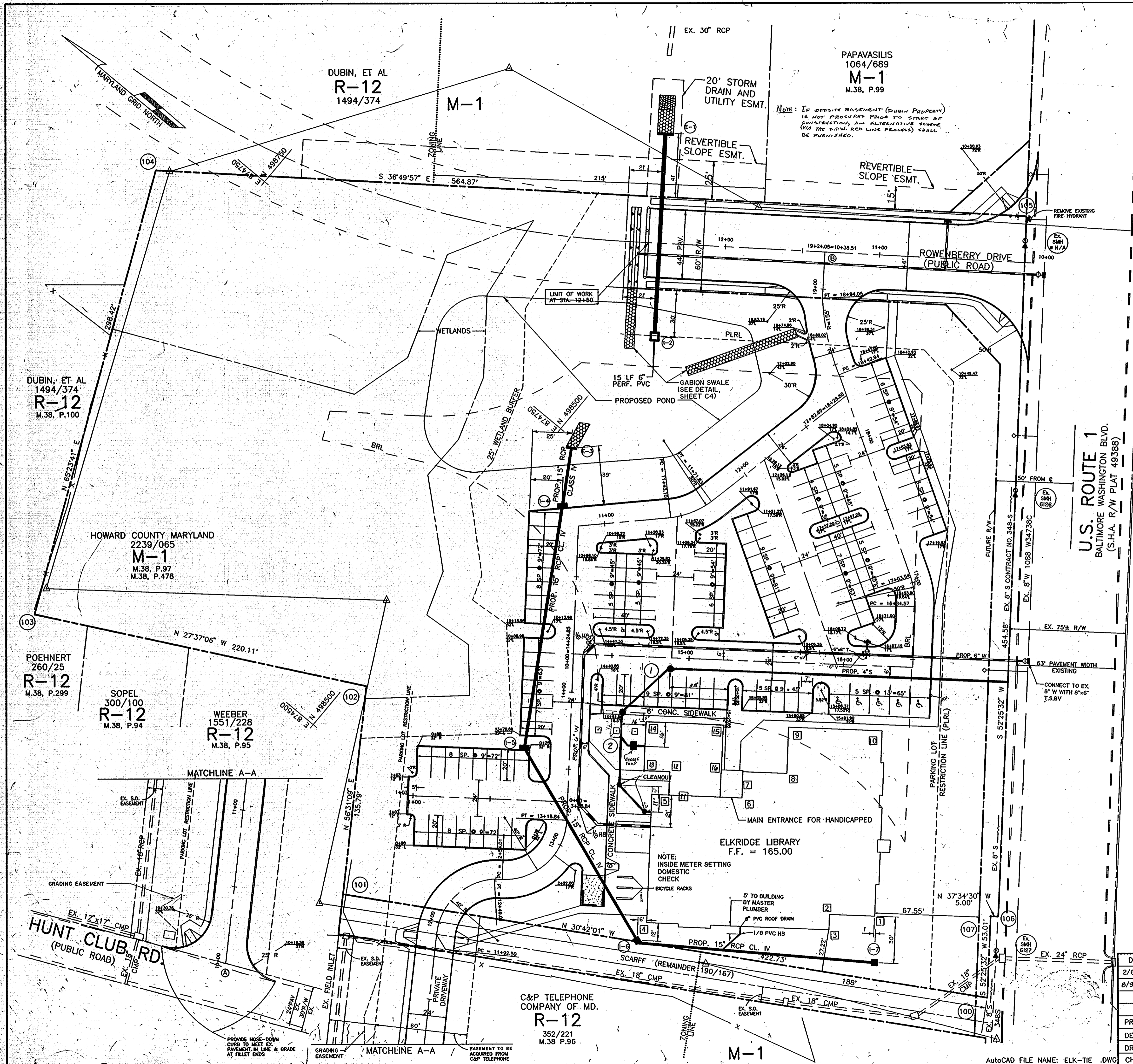

PROPERTY COORDINATES

POINT	NORTHING	EASTING
100	498051.0329	874643.8877
101	498414.5213	874428.0617
102	498489.4311	874541.3201
103	498158.1152	874611.9684
104	498808.7124	874710.6036
105	498356.5946	875049.2323
106	498083.3563	874688.4481
107	498083.3563	874685.8991

BUILDING COORDINATES

POINT	NORTHING	EASTING
1	498140.9646	874637.7813
2	498164.2131	874619.8940
3	498158.1152	874611.9684
4	498251.9015	874539.8095
5	498302.7175	874605.8562
6	498256.2207	874641.6307
7	498266.5872	874655.1043
8	498244.1313	874672.3817
9	498262.4251	874696.1585
10	498214.3430	874733.1527

BASELINE COORDINATES

POINT	NORTHING	EASTING
A	498245.2533	874286.3413
B	498442.0347	874947.7574
11	498262.2991	874619.7065
12	498277.2757	874622.4313
13	498277.2757	874622.4464
14	498202.9269	874604.8026
15	498202.9269	874654.7558
16	498278.9435	874659.6145

- GENERAL NOTES
1. ALL STORM DRAIN, STORMWATER MANAGEMENT, WATER AND SEWER TO BE CONSTRUCTED IN ACCORDANCE WITH THE LATEST GENERAL AND STANDARD SPECIFICATIONS OF THE HOWARD COUNTY DEPARTMENT OF PUBLIC WORKS.
 2. TYPES OF STRUCTURES AND FITTINGS REFER TO THE LATEST STANDARD DETAILS OF THE HOWARD COUNTY DEPARTMENT OF PUBLIC WORKS.
 3. INFORMATION CONCERNING EXISTING UNDERGROUND UTILITIES WAS OBTAINED IN THE FIELD AND FROM AVAILABLE RECORDS. THE CONTRACTOR MUST DETERMINE THE EXACT LOCATIONS AND ELEVATIONS OF THE UTILITIES BY DIGGING TEST PITS BY HAND AT ALL UTILITY CROSSINGS WELL IN ADVANCE OF TRENCHING. IF CLEARANCE ARE LESS THAN SPECIFIED, CONTACT THE HOWARD COUNTY DEPARTMENT OF PUBLIC WORKS AND THE DEVELOPMENT DIVISION OF GREENMAN-PEDERSEN, INC. PRIOR TO PROCEEDING WITH CONSTRUCTION.

OWNER: HOWARD COUNTY GOVERNMENT

DEVELOPER/APPLICANT
ELKRIDGE LIBRARY
c/o DEPT. OF PUBLIC WORKS
GENERAL PROJECTS DIVISION
3430 COURT HOUSE DRIVE
ELLCOTT CITY, MD 21043
ATTN: MR. KENNETH EDWARDS
(301) 313-2040

APPROVED: FOR PUBLIC WATER AND PUBLIC SEWERAGE SYSTEMS.
HOWARD COUNTY HEALTH DEPARTMENT
Jocelyn Bogden 2-21-92
COUNTY HEALTH OFFICER DATE

APPROVED: HOWARD COUNTY DEPT. OF PLANNING & ZONING
SDP-91-83
James P. Lewis 2/25/92
DIRECTOR DATE

APPROVED: DIVISION OF COMMUNITY PLANNING AND LAND DEVELOPMENT
Edward H. Halsemark 2/24/92
DATE

APPROVED: FOR PUBLIC WATER AND PUBLIC SEWERAGE, STORM DRAINAGE SYSTEMS AND PUBLIC ROADS
HOWARD COUNTY DEPARTMENT OF PUBLIC WORKS
James P. Lewis 2/25/92
DIRECTOR DATE

James P. Lewis 2/25/92
CHIEF BUREAU OF ENGINEERING DATE

CALL "MISS UTILITY" AT LEAST 48 HOURS IN ADVANCE OF CONSTRUCTION AT 1-800-257-7777



STORM DRAIN & WATER & SEWER

ELKRIDGE LIBRARY
HOWARD COUNTY, MARYLAND
1ST. ELECTION DISTRICT
CAPITAL PROJECT L-0007
TAX MAP 38, PARCEL 97

DRAWING NO. 90126 SCALE 1"=30' DATE Dec. 7, 1991 SHEET NO. C3 OF 8

GREENMAN-PEDERSEN INC.
ENGINEERS/ARCHITECTS/PLANNERS
1450 GREENVIEW DRIVE, SUITE 100, LAUREL, MD. 20708
WASH. (301) 470-2772 BALT. (301) 880-3055

DATE	REVISION
2/6/92	REV CAP ESMTS & HC AREA AT SIDEWALK
8/31/92	REV. POND & BLDG. UTILITIES & BLDG. COORDINATES

PROJ. MGR.	R.L.C.
DESIGN	M.A.H./T.F.R.
DRAWN	M.A.H./T.F.R.
CHECKED	R.L.C.

C&P TELEPHONE COMPANY OF MD.
R-12
352/221
M.38 P.96

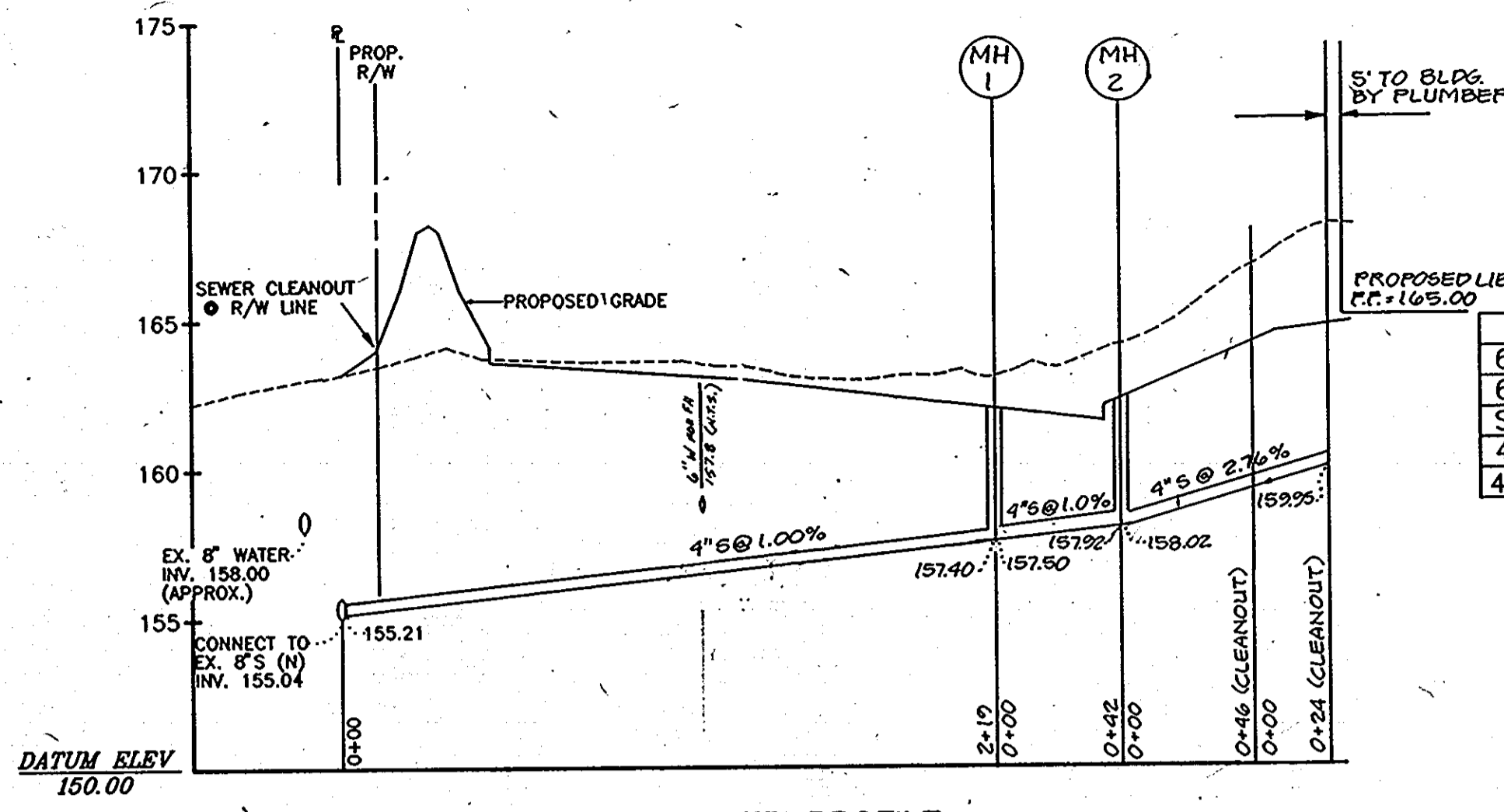
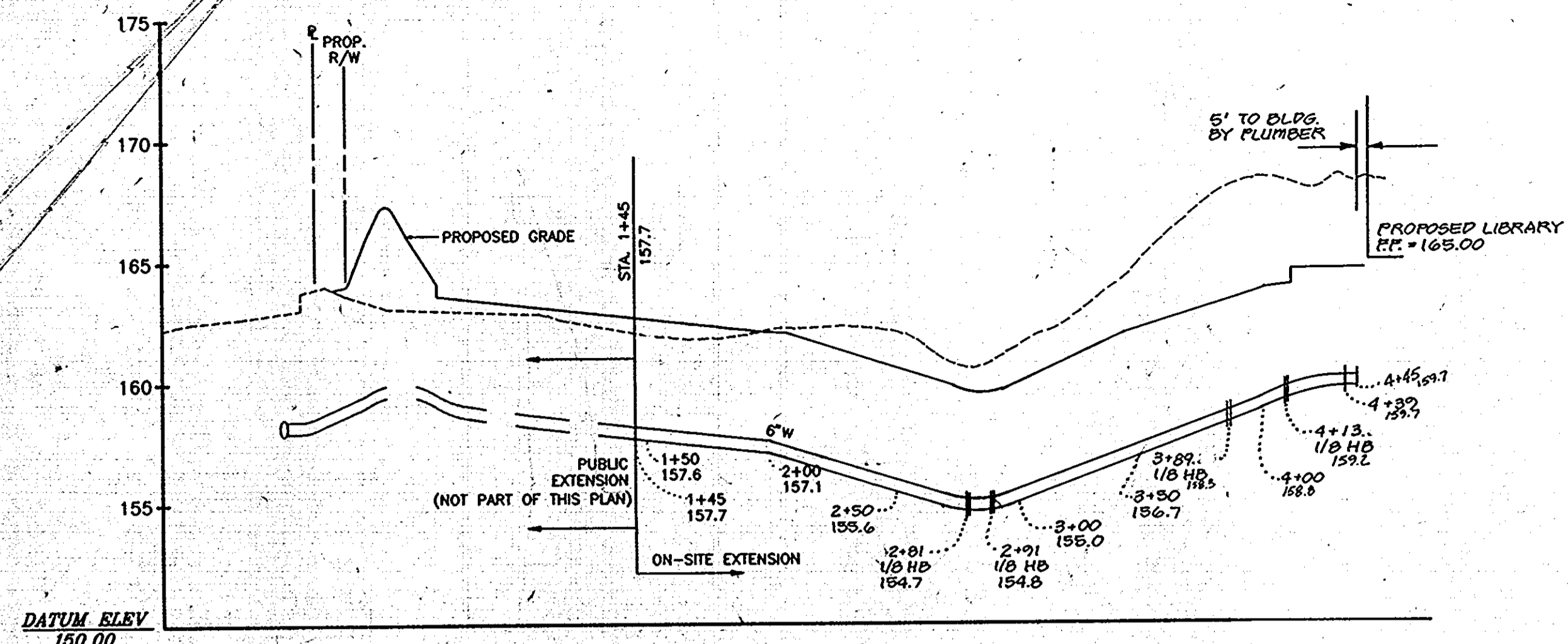

WATER & SEWER SCHEDULE

ITEM	TYPE	AMOUNT
6" - 1/8" H B	-	4 EA.
6" W	D.I.P. (AWWA C-151)	300 L.F.
SEWER MH	-	2 EA.
4" S	P.V.C.	323 L.F.
4" S CLEANOUT	-	2 EA.

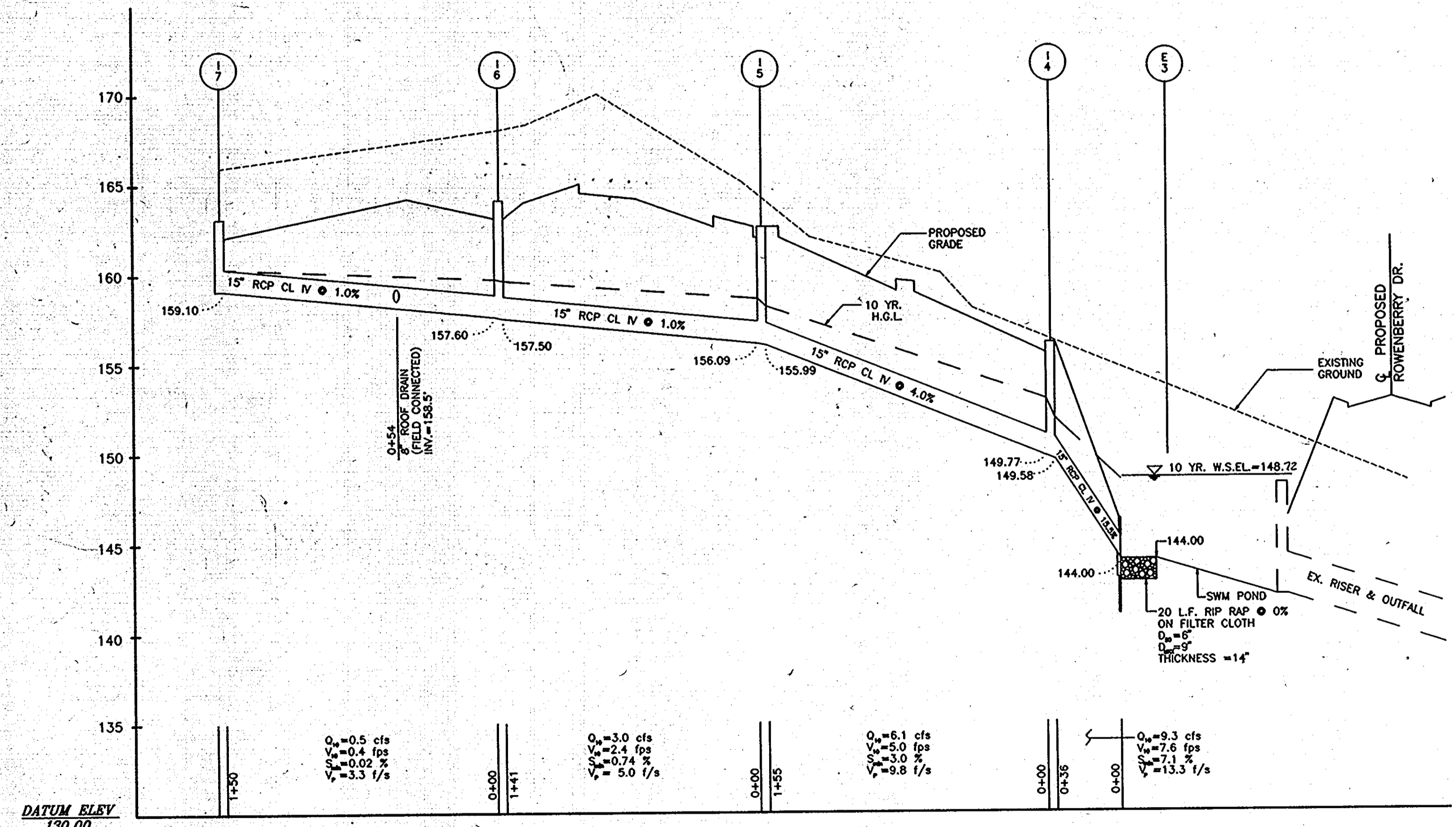
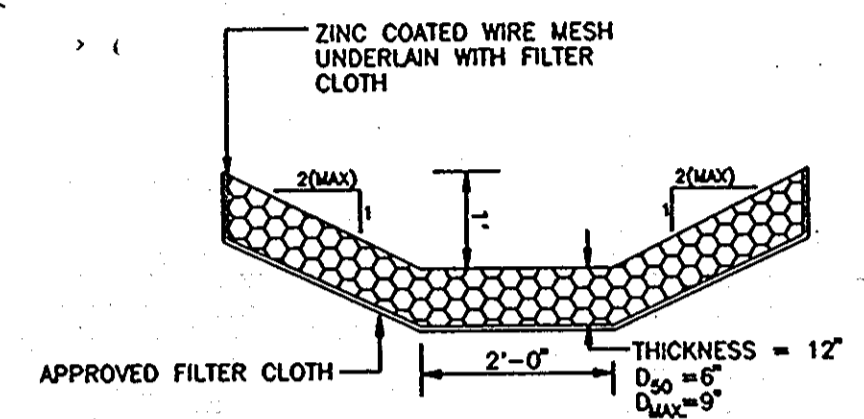

STRUCTURE SCHEDULE

NO.	TYPE	TOP ELEV.	INV. OUT	REMARKS
3	ENDWALL	146.25	144.00	H.C.D.P.W. No. SD 5.21, D=15"
4	A-5	156.08	149.58	H.C.D.P.W. No. SD 4.40 *
5	A-5	163.18	155.99	H.C.D.P.W. No. SD 4.40 *
6	K	163.60	157.50	H.C.D.P.W. No. SD 4.13
7	K	162.60	159.10	H.C.D.P.W. No. SD 4.13

PIPE SUMMARY

SIZE	TYPE	LENGTH
15"	CLASS IV RCP	482 LF
8"	PVC	20 LF

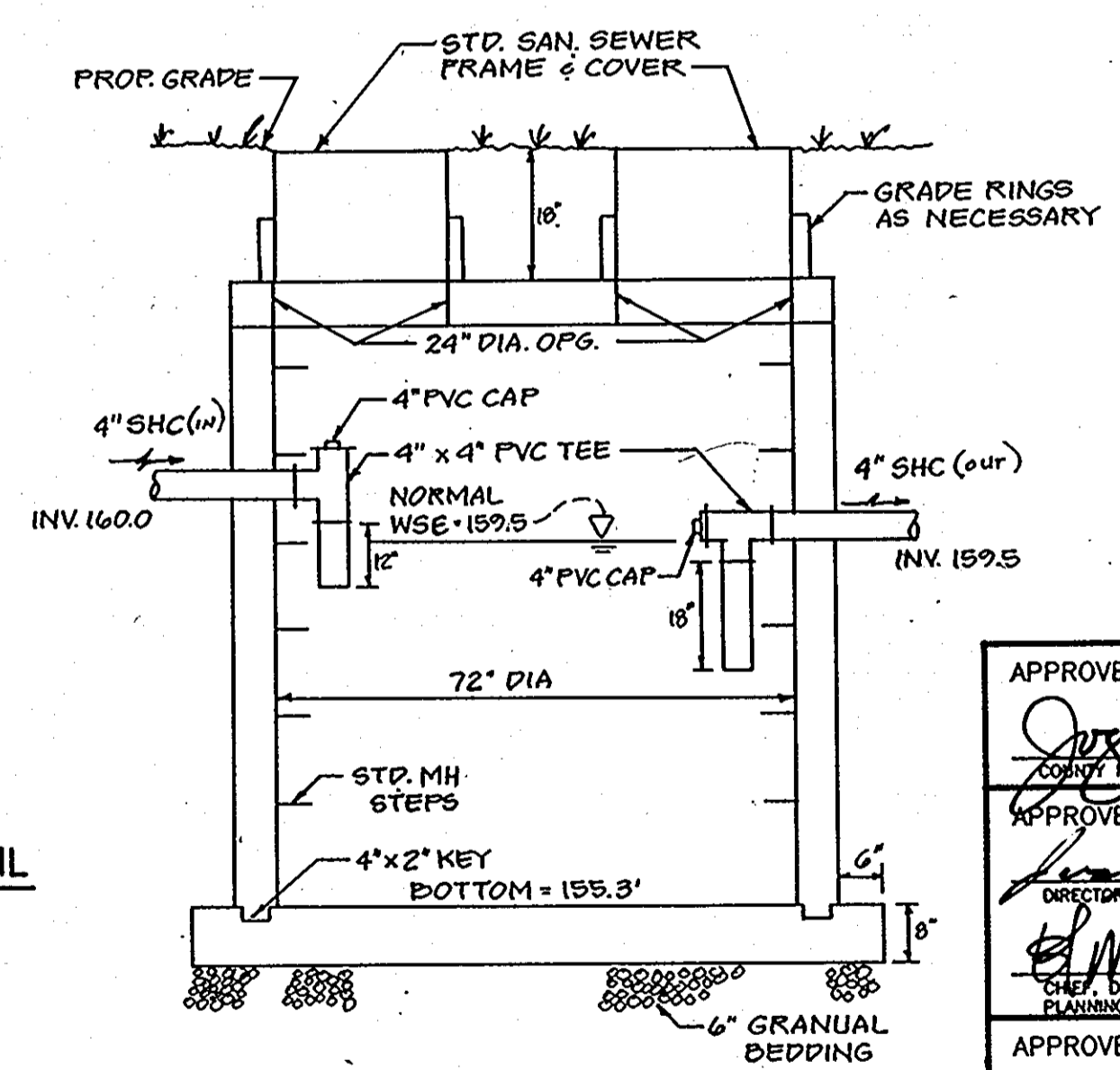
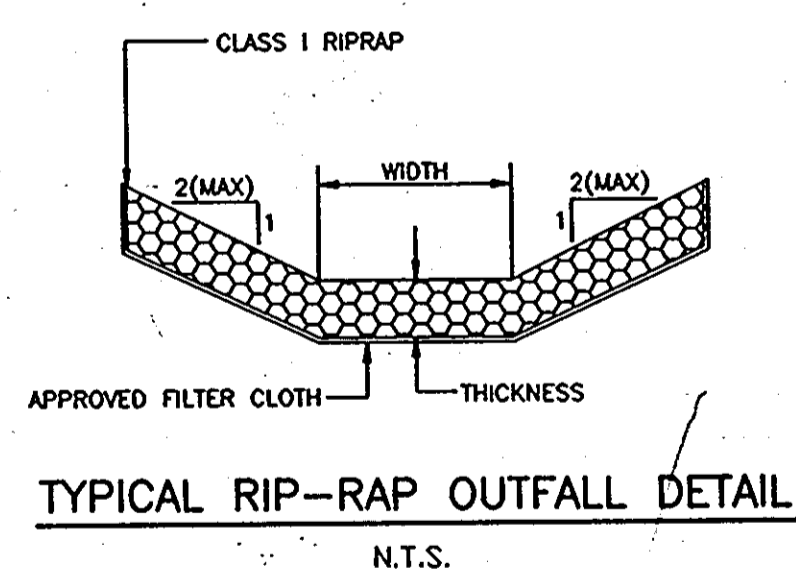

APPROVED: FOR PUBLIC WATER AND PUBLIC SEWERAGE SYSTEMS.
 HOWARD COUNTY HEALTH DEPARTMENT
 Director: *James Boyd* 2-21-92
 APPROVED: HOWARD COUNTY DEPT. OF PLANNING & ZONING
 Director: *James Boyd* 2/25/92
 APPROVED: FOR PUBLIC WATER AND PUBLIC SEWERAGE.
 STORM DRAINAGE SYSTEMS AND PUBLIC ROADS
 HOWARD COUNTY DEPARTMENT OF PUBLIC WORKS
 Director: *James Boyd* 1/6/92
 Director: *James Boyd* 1-6-92



REVISION

DATE	REVISION
8/31/92	REV. PROFILES & ADD GREASE TRAP

PROFILES & DETAILS

ELKRIDGE LIBRARY
 HOWARD COUNTY, MARYLAND
 1ST. ELECTION DISTRICT
 CAPITAL PROJECT L-0007
 TAX MAP 38, PARCEL 97

PROJ. MGR.	R.L.B.	DRAWING NO.	90126	SCALE	AS SHOWN	DATE	Dec. 7, 1991	SHEET NO.	84 OF 8
DESIGN	M.H./D.J.	GREENMAN-PEDERSEN INC. 14504 GREENVIEW DRIVE, SUITE 100, LAUREL, MD. 20708 WASH. (301)-470-2772 BALT. (301) 880-3055							
DRAWN	T.F.R.	SDP 91-83							
CHECKED	R.L.C.								

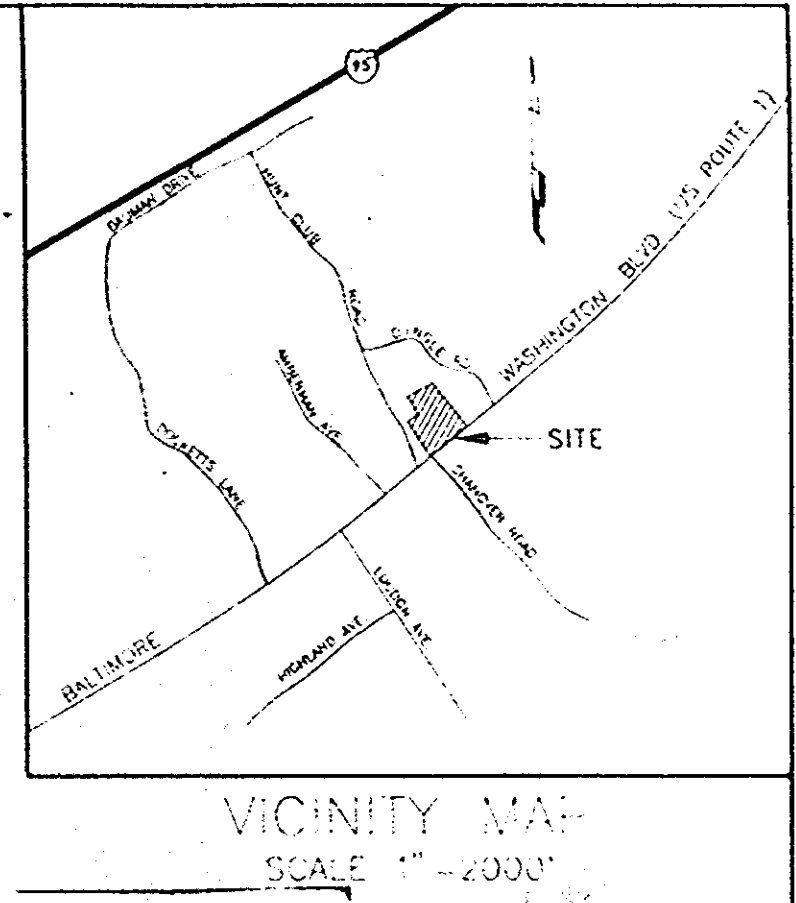
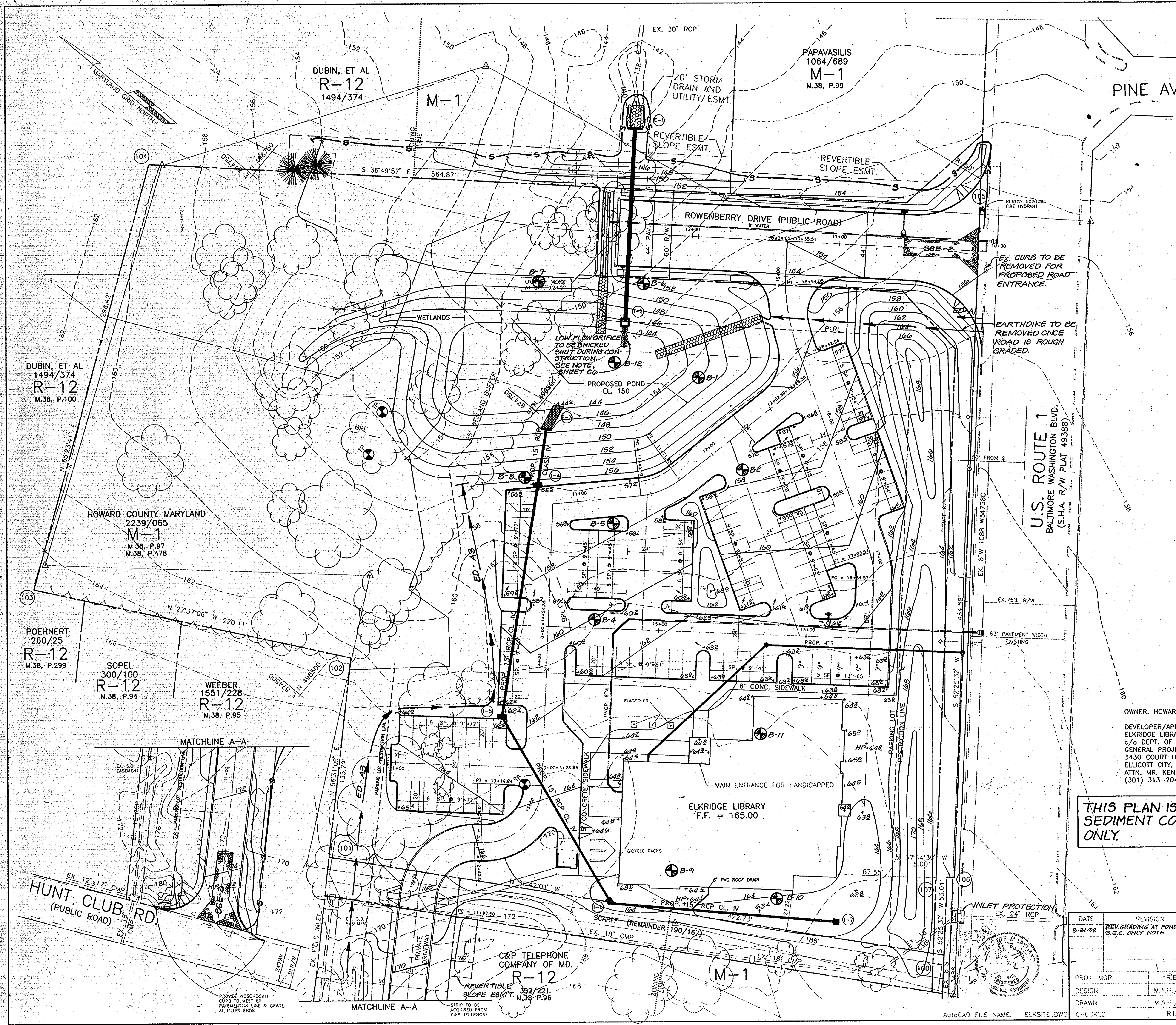

TRAP SUMMARY TABLE

NUMBER	PIPE OUTLET
TYPE	41 AC.
EX. DRAINAGE AREA	61 AC.
PROP. DRAINAGE AREA	9180 C.F.
STORAGE REQUIRED	57,000 C.F.
BOTTOM ELEVATION	142.0
SPILLWAY CREST ELEVATION	147.6
STORAGE DEPTH OF TRAP	5.7
CLEANOUT ELEVATION	144.85
SIDE SLOPES	4:1
RISER SIZE	6'x6'
BARREL SIZE	27"

SOIL BORING

THESE PLANS HAVE BEEN REVIEWED FOR THE HOWARD SOIL CONSERVATION DISTRICT AND MEET THE TECHNICAL REQUIREMENTS FOR SOIL EROSION AND SEDIMENT CONTROL.

James M. Miller (GS) 2/19/92
U.S. SOIL CONSERVATION SERVICE DATE

THESE PLANS FOR SOIL EROSION AND SEDIMENT CONTROL MEET THE REQUIREMENTS OF THE HOWARD SOIL CONSERVATION DISTRICT.

Robert Z. Ziehn (GS) 2/10/92
HOWARD SOIL CONSERVATION DISTRICT DATE

APPROVED: FROM PUBLIC WATER AND PUBLIC SEWERAGE SYSTEMS, HOWARD COUNTY HEALTH DEPARTMENT

Joseph Bogdan 2-21-92
HEALTH OFFICER DATE

PROJECT: HOWARD COUNTY DEPT. OF PLANNING & ZONING SDR-91-83

James H. Smith 2/25/92
DATE

Edward Holomath 2/24/92
DATE

APPROVED: FOR PUBLIC WATER AND PUBLIC SEWERAGE STORM DRAINAGE SYSTEMS AND PUBLIC ROADS HOWARD COUNTY DEPARTMENT OF PUBLIC WORKS

James G. Linn 1/16/92
DIRECTOR DATE

William E. Ray 1-1-92
DATE

ADDRESS CHART

LOT No.	STREET ADDRESS
PARCEL 97	6526 BALTIMORE WASHINGTON BLVD. (US. RT. 1)
OR	ROWENBERRY DRIVE

THIS PLAN IS FOR SEDIMENT CONTROL ONLY.

OWNER: HOWARD COUNTY GOVERNMENT
DEVELOPER/APPLICANT
ELKRIDGE LIBRARY
c/o DEPT. OF PUBLIC WORKS
GENERAL PROJECTS DIVISION
3430 COURT HOUSE DRIVE
ELLCOTT CITY, MD 21043
ATTN: MR. KENNETH EDWARDS
(301) 313-2040

DATE	REVISION
8-21-92	REV. GRADING AT POND, ADDED S.E.C. ONLY NOTE

PROJ. MGR.	DESIGN	DRAWN	CHECKED

SEDIMENT CONTROL PLAN

ELKRIDGE LIBRARY
HOWARD COUNTY, MARYLAND
1ST. ELECTION DISTRICT
CAPITAL PROJECT L-0007
TAX MAP 38, PARCEL 97

DRAWING NO. 901261 SCALE: 1"=30' DATE: Dec. 7, 1991 SHEET NO. C5 OF 8 SDR 5 of 10

GREENMAN-PETERSEN INC.
ENGINEERS/ARCHITECTS/PLANNERS
14509 GREENVIEW DRIVE, SUITE 100, LAUREL, MD 20708
WASH. (301) 470-2779 BAL. (301) 883-3055

gpi

AutoCAD FILE NAME: ELKSITE.DWG

SDP 91-83

STABILIZED CONSTRUCTION ENTRANCE - 2

NOT TO SCALE

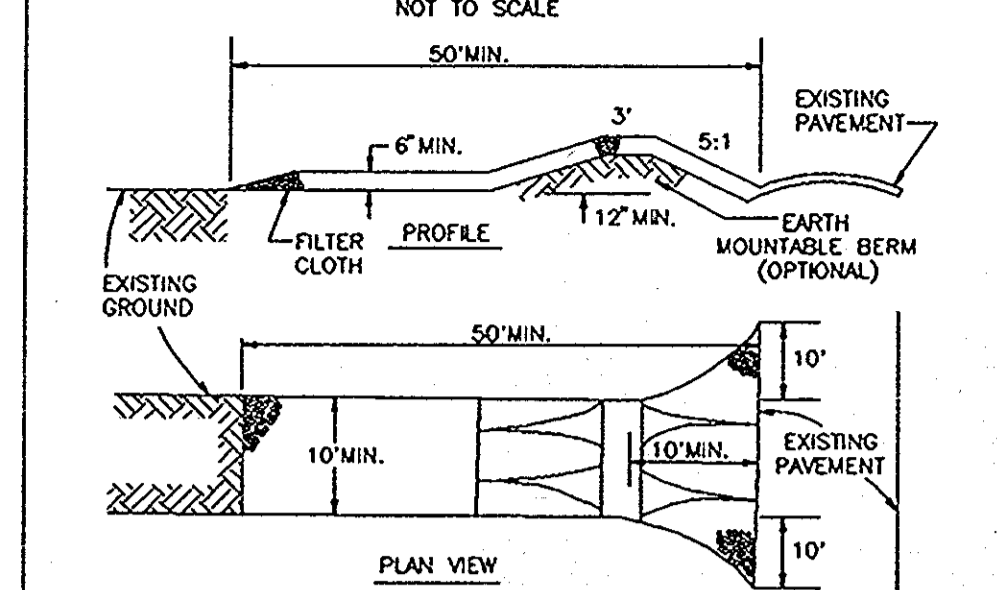

- CONSTRUCTION SPECIFICATIONS**
- STONE SIZE - USE 2" STONE, OR RECLAIMED OR RECYCLED CONCRETE EQUIVALENT.
 - LENGTH - AS REQUIRED, BUT NOT LESS THAN 50 FEET (EXCEPT ON A SINGLE RESIDENTIAL LOT WHERE A 30 FOOT MINIMUM LENGTH WOULD APPLY).
 - THICKNESS - NOT LESS THAN SIX (6) INCHES.
 - WIDTH - TEN (10) FOOT MINIMUM, BUT NOT LESS THAN THE FULL WIDTH OF ANY POINTS WHERE INGRESS OR EGRESS OCCURS.
 - FILTER CLOTH - WILL BE PLACED OVER THE ENTIRE AREA PRIOR TO PLACING OF STONE. FILTER WILL NOT BE REQUIRED ON A SINGLE FAMILY RESIDENCE LOT.
 - SURFACE WATER - ALL SURFACE WATER FLOWING OR DIVERTED TOWARD CONSTRUCTION ENTRANCES SHALL BE PIPED ACROSS THE ENTRANCE. IF PIPING IS IMPRACTICAL, A MOUNTABLE BERM WITH 5:1 SLOPES WILL BE PROVIDED.
 - MAINTENANCE - THE ENTRANCE SHALL BE MAINTAINED IN A CONDITION WHICH WILL PREVENT TRACKING OR FLOWING OF SEDIMENT ONTO PUBLIC RIGHTS-OF-WAY. THIS MAY REQUIRE PERIODIC TOP DRESSING WITH ADDITIONAL STONE AS CONDITIONS DEMAND AND REPAIR AND FOR CLEANOUT OF ANY MEASURES USED TO TRAP SEDIMENT. ALL SEDIMENT SPILLED, DROPPED, WASHED OR TRACKED ONTO PUBLIC RIGHTS-OF-WAY MUST BE REMOVED IMMEDIATELY.
 - WASHING - WHEELS SHALL BE CLEANED TO REMOVE SEDIMENT PRIOR TO ENTRANCE ONTO PUBLIC RIGHTS-OF-WAY. WHEN WASHING IS REQUIRED, IT SHALL BE DONE ON AN AREA STABILIZED WITH STONE AND WHICH DRAINS INTO AN APPROVED SEDIMENT TRAPPING DEVICE.
 - PERIODIC INSPECTION AND NEEDED MAINTENANCE SHALL BE PROVIDED AFTER EACH RAIN.

SOIL CONSERVATION SERVICE COLLEGE PARK, MD	STABILIZED CONSTRUCTION ENTRANCE	STANDARD DRAWING SCE-2
---	-------------------------------------	---------------------------

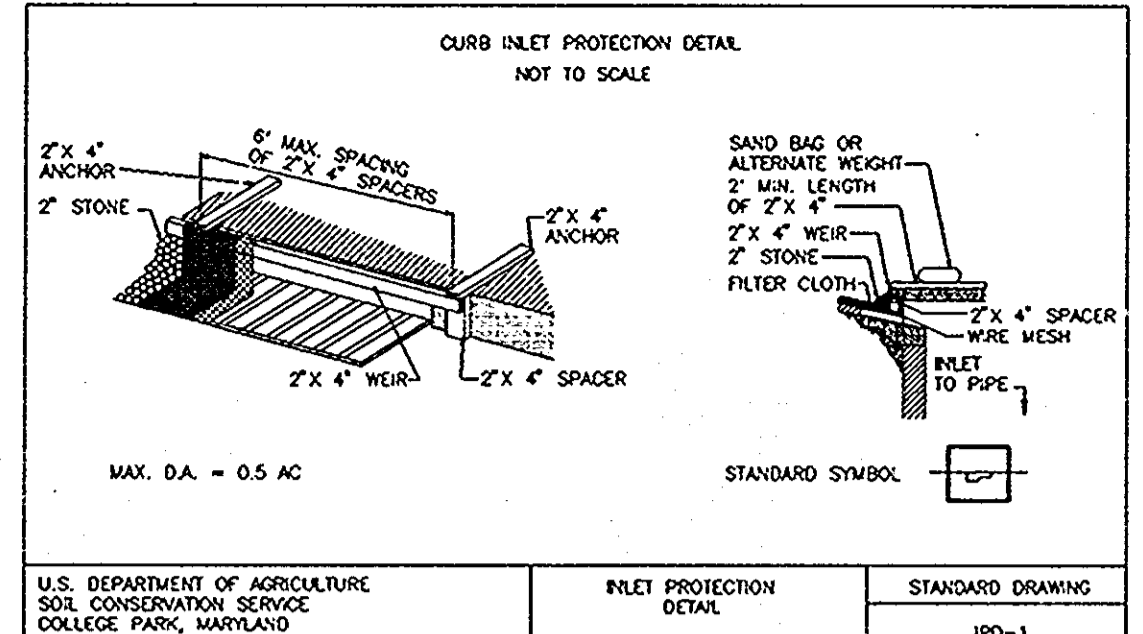

U.S. DEPARTMENT OF AGRICULTURE
SOIL CONSERVATION SERVICE
COLLEGE PARK, MARYLAND

CONSTRUCTION SPECIFICATIONS

- I. MATERIALS**
- WOODEN FORM IS TO BE CONSTRUCTED OF 2" X 4" CONSTRUCTION GRADE LUMBER.
 - WIRE MESH MUST BE OF SUFFICIENT STRENGTH TO SUPPORT FILTER FABRIC, AND STONE FOR CURB INLETS, WITH WATER FULLY IMPOUNDED AGAINST IT.
 - FILTER CLOTH MUST BE OF A TYPE APPROVED FOR THIS PURPOSE, RESISTANT TO SUNLIGHT WITH SIEVE SIZE, EGS, 40-85, TO ALLOW SUFFICIENT PASSAGE OF WATER REMOVAL OF SEDIMENT.
 - STONE IS TO BE 2" IN SIZE AND CLEAN, SINCE FINES WOULD CLOG THE CLOTH.
- B. CURB INLET PROTECTION:**
- ATTACH A CONTINUOUS PIECE OF WIRE MESH (30" MIN. WIDTH BY THROAT LENGTH PLUS 4") TO THE 2" X 4" WEIR (MEASURING THROAT LENGTH PLUS 2") AS SHOWN ON THE STANDARD DRAWING.
 - PLACE A PIECE OF APPROVED FILTER CLOTH (40-85 SIEVE) OF THE SAME DIMENSIONS AS THE WIRE MESH OVER THE WIRE MESH AND ACTUARY ATTACHED TO THE 2" X 4" WEIR.
 - SECURELY NAIL THE 2" X 4" WEIR TO 9" LONG VERTICAL SPACERS TO BE LOCATED BETWEEN THE WEIR AND INLET FACE (MAX. 6" APART).
 - PLACE THE ASSEMBLY AGAINST THE INLET THROAT AND NAIL (MINIMUM 2" LENGTHS OF 2" X 4" TO THE TOP OF THE WEIR AT SPACER LOCATIONS. THESE 2" X 4" ANCHORS SHALL EXTEND ACROSS THE INLET TOP AND BE HELD IN PLACE BY SANDBAGS OR ALTERNATE WEIGHT.

MARYLAND SCS/WRA APRIL 1983

PIPE OUTLET TRAP CONSTRUCTION SPECIFICATION FOR ST-1

- AREA UNDER EMBANKMENT SHALL BE CLEARED, GRUBBED AND STRIPPED OF ANY VEGETATION AND ROOT MAT. THE POOL AREA SHALL BE CLEARED.
- THE FILL MATERIAL FOR THE EMBANKMENT SHALL BE FREE OF ROOTS OR OTHER WOODY VEGETATION AS WELL AS OVERSIZED STONES, ROCKS, ORGANIC MATERIAL, OR OTHER OBJECTIONABLE MATERIAL. THE EMBANKMENT SHALL BE COMPACTED BY TRAVERSING WITH EQUIPMENT WHILE IT IS BEING CONSTRUCTED.
- VOLUME OF SEDIMENT STORAGE SHALL BE 1800 CUBIC FEET PER ACRE OF CONTRIBUTORY DRAINAGE.
- SEDIMENT SHALL BE REMOVED AND TRAP RESTORED TO ITS ORIGINAL DIMENSIONS WHEN THE SEDIMENT HAS ACCUMULATED TO 1/2 THE DESIGN DEPTH OF THE TRAP. REMOVED SEDIMENT SHALL BE DEPOSITED IN A SUITABLE AREA AND IN SUCH A MANNER THAT IT WILL NOT ERODE.
- THE STRUCTURE SHALL BE INSPECTED AFTER EACH RAIN AND REPAIRS MADE AS NEEDED.
- CONSTRUCTION OPERATIONS SHALL BE CARRIED OUT IN SUCH A MANNER THAT EROSION AND WATER POLLUTION ARE MINIMIZED.
- THE STRUCTURE SHALL BE REMOVED AND AREA STABILIZED WHEN THE DRAINAGE AREA HAS BEEN PROPERLY STABILIZED.
- ALL FILL SLOPES SHALL BE 2:1 OR FLATTER; CUT SLOPES 1:1 OR FLATTER.
- ALL PIPE CONNECTIONS SHALL BE WATER TIGHT.
- THE TOP 2/3 OF THE RISER SHALL BE PERFORATED WITH ONE (1) INCH DIAMETER HOLES OR SLOTS SPACED SIX (6) INCHES VERTICALLY AND HORIZONTALLY AND PLACED IN THE CONCAVE PORTION OF PIPE. NO HOLES WILL BE ALLOWED WITHIN SIX (6) INCHES OF THE HORIZONTAL BARREL.
- THE RISER SHALL BE WRAPPED WITH 1/4 TO 1/2 INCH HARDWARE CLOTH WIRE THAN WRAPPED WITH FILTER CLOTH (HAVING AN EQUIVALENT SIEVE SIZE OF 40 - 80). THE FILTER CLOTH SHALL EXTEND SIX (6) INCHES ABOVE THE HIGHEST HOLE AND SIX (6) INCHES BELOW THE LOWEST HOLE. WHERE ENDS OF FILTER CLOTH COME TOGETHER, THEY SHALL BE OVERLAPPED, FOLDED AND STAPLED TO PREVENT BYPASS.
- STRAPS OR CONNECTING BANDS SHALL BE USED TO HOLD THE FILTER CLOTH AND WIRE FABRIC IN PLACE. THEY SHALL BE PLACED AT THE TOP AND BOTTOM OF THE CLOTH.
- FILL MATERIAL AROUND THE PIPE SPILLWAY SHALL BE HAND COMPACTED IN FOUR (4) INCH LAYERS. A MINIMUM OF TWO (2) FEET OF HAND-COMPACTED BACKFILL SHALL BE PLACED OVER THE PIPE SPILLWAY BEFORE CROSSING IT WITH CONSTRUCTION EQUIPMENT.
- THE RISER SHALL BE ANCHORED WITH EITHER A CONCRETE BASE OR STEEL PLATE BASE TO PREVENT FLOTATION. FOR CONCRETE BASES THE DEPTH SHALL BE 12 INCHES WITH THE RISER EMBEDDED NINE (9) INCHES. A 1/4 INCH MINIMUM THICKNESS STEEL PLATES SHALL BE ATTACHED TO THE RISER BY A CONTINUOUS WELD AROUND THE BOTTOM TO FORM A WATER TIGHT CONNECTION AND THEN PLACE TWO (2) FEET OF STONE, GRAVEL OR TAMPED EARTH ON THE PLATE.

PERMANENT SEEDING NOTES

APPLY TO GRADED OR CLEARED AREAS NOT SUBJECT TO IMMEDIATE FURTHER DISTURBANCE WHERE A PERMANENT LONG-LIVED VEGETATIVE COVER IS NEEDED.

SEEDBED PREPARATION: LOOSEN UPPER THREE INCHES OF SOIL BY RAKING, DISCING OR OTHER ACCEPTABLE MEANS BEFORE SEEDING, IF NOT PREVIOUSLY LOOSENED.

SOIL AMENDMENTS: IN LIEU OF SOIL TEST RECOMMENDATIONS, USE ONE OF THE FOLLOWING SCHEDULES:

- PREFERRED - APPLY 2 TONS PER ACRE DOLOMITIC LIMESTONE (92 LBS/1000 SQ. FT.) AND 600 LBS PER ACRE 10-10-10 FERTILIZER (14 LBS/1000 SQ. FT.) BEFORE SEEDING. HARROW OR DISC INTO UPPER THREE INCHES OF SOIL. AT TIME OF SEEDING, APPLY 400 LBS PER ACRE 30-0-0 UREA FORM FERTILIZER (9 LBS/1000 SQ. FT.)
- ACCEPTABLE - APPLY 2 TONS PER ACRE DOLOMITIC LIMESTONE (92 LBS/1000 SQ. FT.) AND 1000 LBS PER ACRE 10-10-10 FERTILIZER (23 LBS/1000 SQ. FT.) BEFORE SEEDING. HARROW OR DISC INTO UPPER THREE INCHES OF SOIL.

SEEDING - FOR THE PERIODS MARCH 1 THRU APRIL 30, AND AUGUST 1 THRU OCTOBER 15, SEED WITH 60 LBS PER ACRE (1.4 LBS/1000 SQ. FT.) OF KENTUCKY 31 TALL FESCUE. FOR THE PERIOD MAY 1 THRU JULY 31, SEED WITH 60 LBS KENTUCKY 31 TALL FESCUE PER ACRE AND 2 LBS PER ACRE (.05 LBS/1000 SQ. FT.) OF WEEPING LOVERGRASS. DURING THE PERIOD OF OCTOBER 16 THRU FEBRUARY 28, PROTECT SITE BY: OPTION (1) 2 TONS PER ACRE OF WELL ANCHORED STRAW MULCH AND SEED AS SOON AS POSSIBLE IN THE SPRING. OPTION (2) USE SOD. OPTION (3) SEED WITH 60 LBS/ACRE KENTUCKY 31 TALL FESCUE AND MULCH WITH 2 TONS/ACRE WELL ANCHORED STRAW.

MULCHING - APPLY 1 1/2 TO 2 TONS PER ACRE (70 TO 90 LBS/1000 SQ. FT.) OF UNROTATED SMALL GRASS STRAW IMMEDIATELY AFTER SEEDING. ANCHOR MULCH IMMEDIATELY AFTER APPLICATION USING MULCH ANCHORING TOOL OR 218 GALLONS PER ACRE (5 GAL/1000 SQ. FT.) OF EMULSIFIED ASPHALT ON FLAT AREAS. ON SLOPES 8 FEET OR HIGHER, USE 348 GALLONS PER ACRE (8 GAL/1000 SQ. FT.) FOR ANCHORING.

MAINTENANCE - INSPECT ALL SEEDING AREAS AND MAKE NEEDED REPAIRS, REPLACEMENTS AND RESEEDINGS.

TEMPORARY SEEDING NOTES

APPLY TO GRADED OR CLEARED AREAS LIKELY TO BE REDISTURBED WHERE A SHORT-TERM VEGETATIVE COVER IS NEEDED.

SEEDBED PREPARATION: LOOSEN UPPER THREE INCHES OF SOIL BY RAKING, DISCING OR OTHER ACCEPTABLE MEANS BEFORE SEEDING, IF NOT PREVIOUSLY LOOSENED.

SOIL AMENDMENTS: APPLY 60 LBS PER ACRE 10-10-10 FERTILIZER (14 LBS/1000 SQ. FT.).

SEEDING: FOR PERIODS MARCH 1 THRU APRIL 30 AND FROM AUGUST 15 THRU NOVEMBER 15, SEED WITH 2 1/2 BUSHEL PER ACRE OF ANNUAL RYE (32 LBS/1000 SQ. FT.). FOR THE PERIOD MAY 1 THRU AUGUST 14, SEED WITH 3 LBS PER ACRE OF WEEPING LOVERGRASS (0.07 LBS/1000 SQ. FT.). FOR THE PERIOD NOVEMBER 16 THRU FEBRUARY 28, PROTECT SITE BY APPLYING 2 TONS PER ACRE OF WELL ANCHORED STRAW MULCH AND SEED AS SOON AS POSSIBLE IN THE SPRING, OR USE SOD.

MULCHING: APPLY 1 1/2 TO 2 TONS PER ACRE (70 TO 90 LBS/1000 SQ. FT.) OF UNROTATED SMALL GRAIN STRAW IMMEDIATELY AFTER SEEDING. ANCHOR MULCH IMMEDIATELY AFTER APPLICATION USING MULCH ANCHORING TOOL OR 218 GAL PER ACRE (5 GAL/1000 SQ. FT.) OF EMULSIFIED ASPHALT ON FLAT AREAS. ON SLOPES 8 FT. OR HIGHER, USE 348 GAL. PER ACRE (8 GAL/1000 SQ. FT.) FOR ANCHORING.

REFER TO THE 1983 MARYLAND STANDARDS AND SPECIFICATIONS FOR SOIL EROSION AND SEDIMENT CONTROL FOR RATE AND METHODS NOT COVERED.

SEDIMENT CONTROL NOTES

- MINIMUM OF 24 HOURS NOTICE MUST BE GIVEN TO THE HOWARD COUNTY OFFICE OF INSPECTION AND PERMITS PRIOR TO THE START OF ANY CONSTRUCTION (992-2437).
- ALL VEGETATIVE AND STRUCTURAL PRACTICES ARE TO BE INSTALLED ACCORDING TO THE PROVISIONS OF THIS PLAN AND ARE TO BE IN CONFORMANCE WITH THE 1983 MARYLAND STANDARDS AND SPECIFICATIONS FOR SOIL EROSION AND SEDIMENT CONTROL.
- FOLLOWING INITIAL SOIL DISTURBANCE OR REDISTURBANCE, PERMANENT OR TEMPORARY STABILIZATION SHALL BE COMPLETED WITHIN: A) 7 CALENDAR DAYS FOR ALL PERIMETER SEDIMENT CONTROL STRUCTURES, DIKES, PERMETER SLOPES AND ALL SLOPES GREATER THAN 3:1, B) 14 DAYS AS TO ALL OTHER DISTURBED OR GRADED AREAS ON THE PROJECT SITE.
- ALL SEDIMENT TRAPS/BASINS SHOWN MUST BE FENCED AND WARNING SIGNS POSTED AROUND THEIR PERIMETER IN ACCORDANCE WITH VOL. 1, CHAPTER 12, OF THE HOWARD COUNTY DESIGN MANUAL, STORM DRAINAGE.
- ALL DISTURBED AREAS MUST BE STABILIZED WITHIN THE TIME PERIOD SPECIFIED ABOVE IN ACCORDANCE WITH THE 1983 MARYLAND STANDARDS AND SPECIFICATIONS FOR SOIL EROSION AND SEDIMENT CONTROL FOR PERMANENT SEEDINGS (SEC. 51) SOD (SEC. 54), TEMPORARY SEEDING (SEC. 50) AND MULCHING (SEC. 52). TEMPORARY STABILIZATION WITH MULCH ALONE CAN ONLY BE DONE WHEN RECOMMENDED SEEDING DATES DO NOT ALLOW FOR PROPER GERMINATION AND ESTABLISHMENT OF GRASSES.
- ALL SEDIMENT CONTROL STRUCTURES ARE TO REMAIN IN PLACE AND ARE TO BE MAINTAINED IN OPERATIVE CONDITION UNTIL PERMISSION FOR THEIR REMOVAL HAS BEEN OBTAINED FROM THE HOWARD COUNTY SEDIMENT CONTROL INSPECTOR.
- SITE ANALYSIS:

TOTAL AREA OF SITE	6.87 AC.
AREA DISTURBED	4.4 AC.
AREAS TO BE ROOFED OR PAVED	3.0 AC.
AREAS TO BE VEGETATIVELY STABILIZED	1.4 AC.
TOTAL CUT	9831 CY
TOTAL FILL	4635 CY
OFFSITE WASTE/BORROW AREA LOCATION	
- ANY SEDIMENT CONTROL PRACTICE WHICH IS DISTURBED BY GRADING ACTIVITY FOR PLACEMENT OF UTILITIES MUST BE REPAIRED ON THE SAME DAY OF DISTURBANCE.
- ADDITIONAL SEDIMENT CONTROLS MUST BE PROVIDED, IF DEEMED NECESSARY BY THE HOWARD COUNTY DPW SEDIMENT CONTROL INSPECTOR.
- ON ALL SITES WITH DISTURBED AREAS IN EXCESS OF 2 ACRES, APPROVAL OF THE INSPECTION AGENCY SHALL BE REQUESTED UPON COMPLETION OF INSTALLATION OF PERIMETER EROSION AND SEDIMENT CONTROLS, BUT BEFORE PROCEEDING WITH ANY OTHER EARTH DISTURBANCE OR GRADING. OTHER BUILDING OR GRADING INSPECTION APPROVALS MAY NOT BE AUTHORIZED UNTIL THIS INITIAL APPROVAL BY THE INSPECTION AGENCY IS MADE.

CONSTRUCTION SEQUENCE

- OBTAIN A GRADING PERMIT
- THE SITE SUPERINTENDENT AND/OR THE PERSON DIRECTLY RESPONSIBLE FOR MAINTAINING THE SEDIMENT CONTROL DEVICES MUST CONTACT THE HOWARD COUNTY DEPARTMENT OF LICENSES AND PERMITS INSPECTOR OF THE START DATE AT LEAST FORTY EIGHT (48) HOURS IN ADVANCE AT 880-3450.
- INSTALL STABILIZED CONSTRUCTION ENTRANCES.
- INSTALL SILT FENCE AT LOWER END OF STORMWATER MANAGEMENT POND, CLEAR AND GRUB STORMWATER MANAGEMENT AREA.
- CONSTRUCT STORMWATER MANAGEMENT POND FOR USE AS SEDIMENT TRAP. INSTALL RISER/BARREL AND BLOCK LOW FLOW ORIFICE AS PER DETAIL THIS SHEET. INSTALL EARTH DIKE ON SOUTH SIDE OF ROWENBERRY DRIVE FOR DIVERSION TO TRAP 1. ROUGH GRADE AND STABILIZE ROWENBERRY DRIVE.
- INSTALL REMAINING SEDIMENT CONTROL DEVICES AND REMOVE EARTH DIKE INSTALLED IN ITEM 5 ONLY WHEN STABILIZED.
- CONSTRUCT STORM DRAIN SYSTEM IN ORDER TO CONVEY SEDIMENT Laden WATER TO STORMWATER MANAGEMENT POND, MAINTAIN POSITIVE DRAINAGE AT ALL TIMES.
- BEGIN ROUGH GRADING SITE. MAINTAIN POSITIVE DRAINAGE TO STORMWATER MANAGEMENT POND AT ALL TIMES.
- BEGIN CONSTRUCTION OF BUILDING.
- INSTALL ON-SITE SEWER AND WATER CONNECTIONS.
- INSTALL CURB AND GUTTER AND BASE PAVING FOR PARKING LOT, DRIVEWAY AND ROWENBERRY DRIVE.
- AS AREA BECOMES STABILIZED INSTALL SOD, TREES, AND SHRUBS AS PER LANDSCAPE PLAN.
- AS ALL AREAS ARE BROUGHT TO FINAL GRADE AND UPON APPROVAL FROM THE INSPECTOR, CLEAN OUT STORM DRAIN SYSTEM, DRAIN AND MUCK OUT STORMWATER MANAGEMENT POND AND FINAL GRADE.
- UNBLOCK LOW FLOW ORIFICE AND INSTALL THE 15 LF OF 6" PVC FOR THE POND DRAIN AND COVER WITH STONE.
- UPON PERMISSION FROM THE INSPECTOR REMOVE ALL SEDIMENT CONTROL DEVICES.
- COMPLETE BUILDING CONSTRUCTION AS PER ITEM 9.
- UPON COMPLETION OF BUILDING CONSTRUCTION, INSTALL FINAL PAVING.

ORIFICE BLOCKING NOTE

BLOCK LOW FLOW ORIFICE WITH BRICK AND MORTAR AGAINST RISER STRUCTURE FACE AT ORIFICE OPENING.

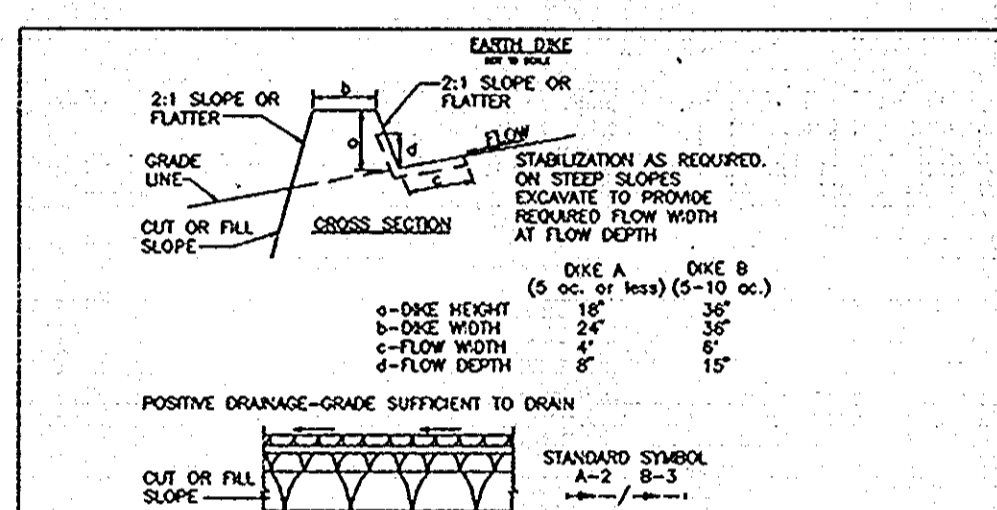

- CONSTRUCTION SPECIFICATIONS**
- ALL DIKES SHALL BE COMPACTED BY EARTH-MOVING EQUIPMENT.
 - ALL DIKES SHALL HAVE POSITIVE DRAINAGE TO AN OUTLET.
 - TOP WIDTH MAY BE INCREASED TO PROVIDE TRAFFIC IF DESIRED TO FACILITATE CROSSING BY CONSTRUCTION TRAFFIC.
 - FIELD LOCATIONS SHOULD BE ADJUSTED AS NEEDED TO PREVENT A STABILIZED SAFE OUTLET.
 - EARTH DIKES SHALL HAVE AN OUTLET THAT FUNCTIONS WITH A MINIMUM OF EROSION. RAINFALL SHALL BE CONVEYED TO A SEDIMENT BASIN WHERE EITHER THE DIKE CHANNEL OR THE DRAINAGE AREA ABOVE THE DIKE ARE NOT ADEQUATELY STABILIZED.
 - STABILIZATION SHALL BE DONE IN ACCORDANCE WITH STANDARD SPECIFICATIONS FOR SEED AND STRAW MULCH OR STRAW MULCH IF NOT IN SEEDING SEASON. (B) FLOW CHANNEL AS PER THE CHART BELOW.

FLOW CHANNEL STABILIZATION

TYPE OF TREATMENT	CHANNEL SIZE	DIKE A	DIKE B
1	5'-3.0'	SEED AND STRAW MULCH	SEED AND STRAW MULCH
2	3.1'-6.0'	SEED AND STRAW MULCH	SEED USING WIRE OR EXCELLENCE SOD 2" STONE
3	5.1'-8.0'	SEED WITH WIRE OR SOD; LINED RPP-RAP 4"-8" 2" STONE	
4	8.1'-20'	LINED RPP-RAP 4"-8" ENGINEERING DESIGN	

A. STONE TO BE 2 INCH STONE, OR RECYCLED CONCRETE EQUIVALENT, IN A LAYER AT LEAST 3 INCHES IN THICKNESS AND BE PRESSED INTO THE SOIL WITH CONSTRUCTION EQUIPMENT.
B. RPP-RAP TO BE 4-8 INCHES IN A LAYER AT LEAST 8 INCHES THICKNESS AND PRESSED INTO THE SOIL.
C. APPROVED EQUIVALENTS CAN BE SUBSTITUTED FOR ANY OF THE ABOVE MATERIALS.

7. PERIODIC INSPECTION AND REDUCED MAINTENANCE MUST BE PROVIDED AFTER EACH RAIN EVENT.

U.S. DEPARTMENT OF AGRICULTURE
SOIL CONSERVATION SERVICE
COLLEGE PARK, MARYLAND

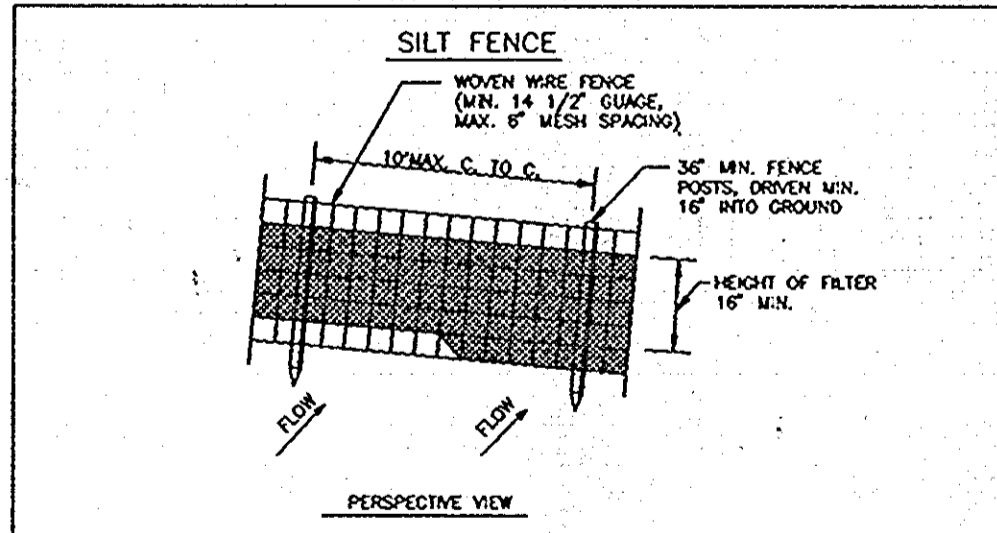

- CONSTRUCTION NOTES FOR FABRICATED SILT FENCE**
- WOVEN WIRE FENCE TO BE FASTENED SECURELY TO FENCE POSTS WITH WIRE TIES OR STAPLES.
 - FILTER CLOTH TO BE FASTENED SECURELY TO WOVEN WIRE FENCE WITH TIES SPACED EVERY 24" AT TOP AND MID SECTION.
 - WHEN TWO SECTIONS OF FILTER CLOTH ADJOIN EACH OTHER THEY SHALL BE OVERLAPPED BY SIX INCHES AND FOLDED.
 - MAINTENANCE SHALL BE PERFORMED AS NEEDED AND MATERIAL REMOVED WHEN "BULGES" DEVELOP IN THE SILT FENCE.

SOIL CONSERVATION SERVICE
COLLEGE PARK, MD

DEVELOPER'S CERTIFICATION

"I CERTIFY THAT ALL DEVELOPMENT AND/OR CONSTRUCTION WILL BE DONE ACCORDING TO THESE PLANS, AND THAT ANY RESPONSIBLE PERSONNEL INVOLVED IN THE CONSTRUCTION PROJECT WILL HAVE A CERTIFICATE OF ATTENDANCE AT A MARYLAND DEPARTMENT OF THE ENVIRONMENT APPROVED TRAINING PROGRAM FOR THE CONTROL OF SEDIMENT AND EROSION BEFORE BEGINNING THE PROJECT. I ALSO AUTHORIZE PERIODIC ON-SITE INSPECTIONS BY THE HOWARD COUNTY SOIL CONSERVATION DISTRICT."

William B. Ray 2-19-92 DATE

ENGINEER'S CERTIFICATION

"I CERTIFY THAT THIS PLAN FOR EROSION AND SEDIMENT CONTROL REPRESENTS A PRACTICAL AND WORKABLE PLAN BASED ON MY PERSONAL KNOWLEDGE OF THE SITE CONDITIONS. THIS PLAN WAS PREPARED IN ACCORDANCE WITH THE REQUIREMENTS OF THE HOWARD SOIL CONSERVATION DISTRICT."

William B. Ray Dec. 7, 1991 DATE



THESE PLANS HAVE BEEN REVIEWED FOR THE HOWARD SOIL CONSERVATION DISTRICT AND MEET THE TECHNICAL REQUIREMENTS FOR SOIL EROSION AND SEDIMENT CONTROL.

James M. Hahn (G.S.) 2/19/92 DATE
U.S. SOIL CONSERVATION SERVICE

THESE PLANS FOR SOIL EROSION AND SEDIMENT CONTROL MEET THE REQUIREMENTS OF THE HOWARD SOIL CONSERVATION DISTRICT.

Robert W. Zickm (G.S.) 2/19/92 DATE
HOWARD SOIL CONSERVATION DISTRICT

APPROVED: FOR PUBLIC WATER AND PUBLIC SEWERAGE SYSTEMS. HOWARD COUNTY HEALTH DEPARTMENT <i>Joseph Bogdanus</i> 2-21-92 DATE COUNTY HEALTH OFFICER	APPROVED: HOWARD COUNTY DEPT. OF PLANNING & ZONING <i>William B. Ray</i> 2/25/92 DATE PLANNING AND LAND DEVELOPMENT
APPROVED: FOR PUBLIC WATER AND PUBLIC SEWERAGE. STORM DRAINAGE SYSTEMS AND PUBLIC ROADS HOWARD COUNTY DEPARTMENT OF PUBLIC WORKS <i>William B. Ray</i> 2-25-92 DATE DIRECTOR	

SEDIMENT CONTROL NOTES/DETAILS

ELKCRIDGE LIBRARY
HOWARD COUNTY, MARYLAND
1ST. ELECTION DISTRICT
CAPITAL PROJECT L-0007
TAX MAP 38, PARCEL 97

DRAWING NO. 90126	SCALE NONE	DATE Dec. 7, 1991	SHEET NO. 8 OF 8
-------------------	------------	-------------------	------------------

gpi GREENMAN-PEDERSEN INC.
ENGINEERS/ARCHITECTS/PLANNERS
14504 GREENVIEW DRIVE, SUITE 100, LAUREL, MD. 20708
WASH. (301) 470-2772 BALT. (301) 880-3055

AutoCAD FILE NAME: ELKSED2.DWG

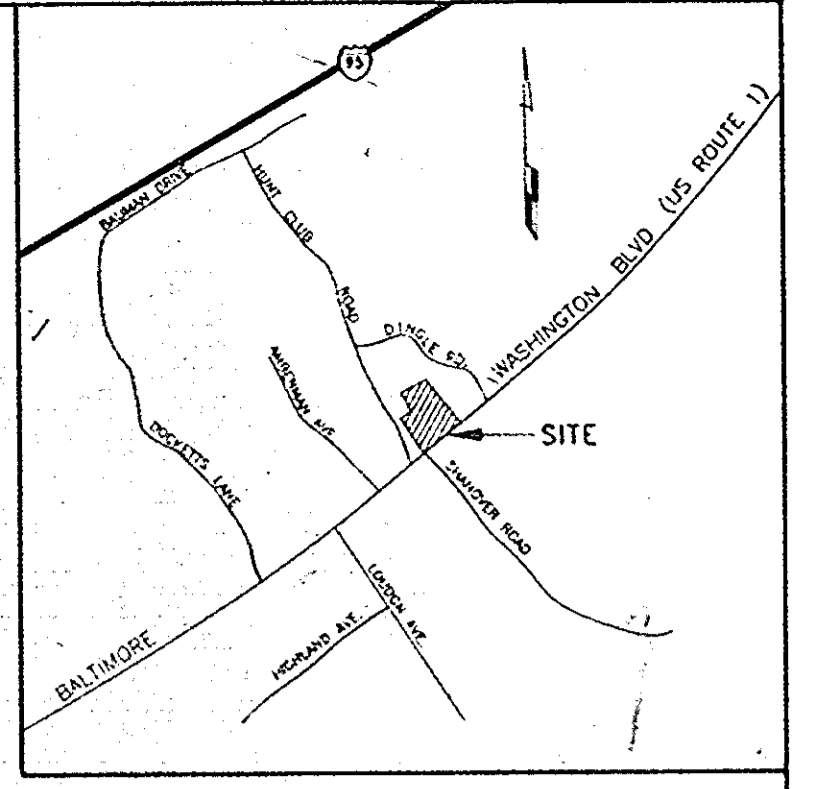

VICINITY MAP
SCALE 1"=2000'

SOIL NAME	SOIL TYPE	CHARACTERISTIC
ScB	TYPE C	SANDY AND CLAYEY LAND, GENTLY SLOPING.
luB	TYPE C	LUKA LOAM, LOCAL ALLUVIUM, 1 TO 5 % SLOPES.
BeB2	TYPE C	BELTSVILLE SILT LOAM, 1 TO 5% SLOPES, MODERATELY ERODED.

LEGEND

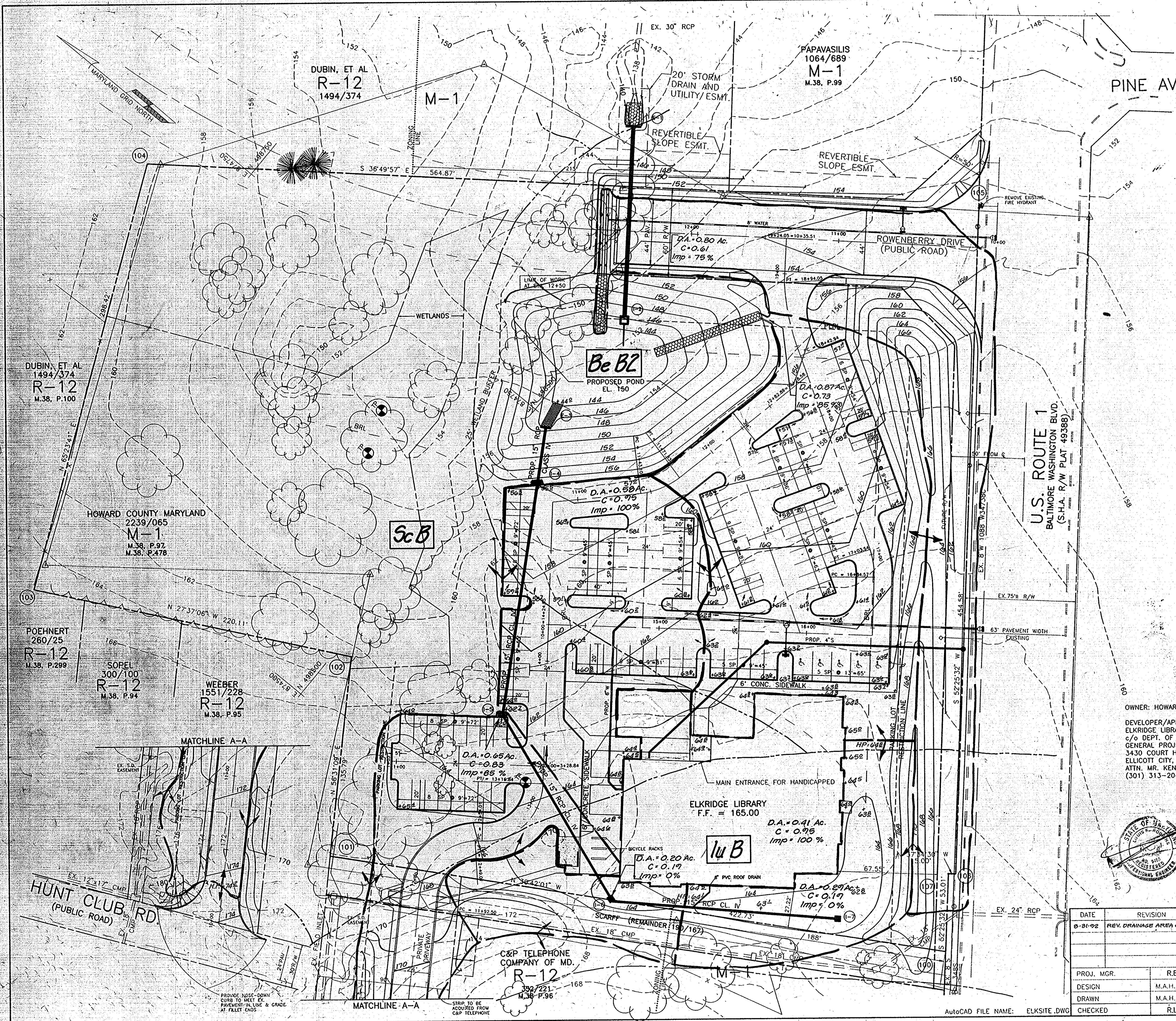
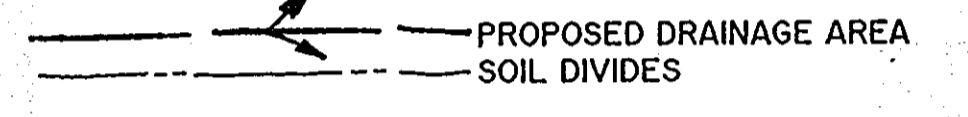

OWNER: HOWARD COUNTY GOVERNMENT
DEVELOPER/APPLICANT:
ELKRIDGE LIBRARY
c/o DEPT. OF PUBLIC WORKS
GENERAL PROJECTS DIVISION
3430 COURT HOUSE DRIVE
ELLCOTT CITY, MD 21043
ATTN: MR. KENNETH EDWARDS
(301) 313-2040

APPROVED: FOR PUBLIC WATER AND PUBLIC SEWERAGE SYSTEMS.
HOWARD COUNTY HEALTH DEPARTMENT
Joseph Boyle 2-21-92
DATE

APPROVED: HOWARD COUNTY DEPT. OF PLANNING & ZONING
James R. Smith 2/25/92
DATE

APPROVED: CLERK, DIVISION OF COUNTY PLANNING AND LAND DEVELOPMENT
Anna Hilomath 2/25/92
DATE

APPROVED: FOR PUBLIC WATER AND PUBLIC SEWERAGE SYSTEMS AND PUBLIC ROADS
HOWARD COUNTY DEPARTMENT OF PUBLIC WORKS
James M. Lewis 1/16/92
DATE

APPROVED: STATE OF MARYLAND PROFESSIONAL ENGINEER
William B. Remy 1/16/92
DATE

ADDRESS CHART

LOT No.	STREET ADDRESS
PARCEL 97	6526 BALTIMORE, WASHINGTON BLVD. (US. RT. 1)
	OR ROWENBERRY DRIVE

SOILS and DRAINAGE AREA MAP

ELKRIDGE LIBRARY
HOWARD COUNTY, MARYLAND
1ST. ELECTION DISTRICT
CAPITAL PROJECT L-0007
TAX MAP 38, PARCEL 97

DATE	REVISION
8-21-92	REV. DRAINAGE AREA ONLY

PROJ. MGR.	R.E.B. -
DESIGN	M.A.H./T.F.R.
DRAWN	M.A.H./T.F.R.
CHECKED	R.L.C.

DRAWING NO.	SCALE	DATE	SHEET NO.
90126	1"=30'	Dec. 7, 1991	67 OF 8

GREENMAN-PEDERSEN INC.
ENGINEERS/ARCHITECTS/PLANNERS
14504 GREENVIEW DRIVE, SUITE 100, LAUREL, MD. 20708
WASH. (301) 470-2772 BALT. (301) 880-3055

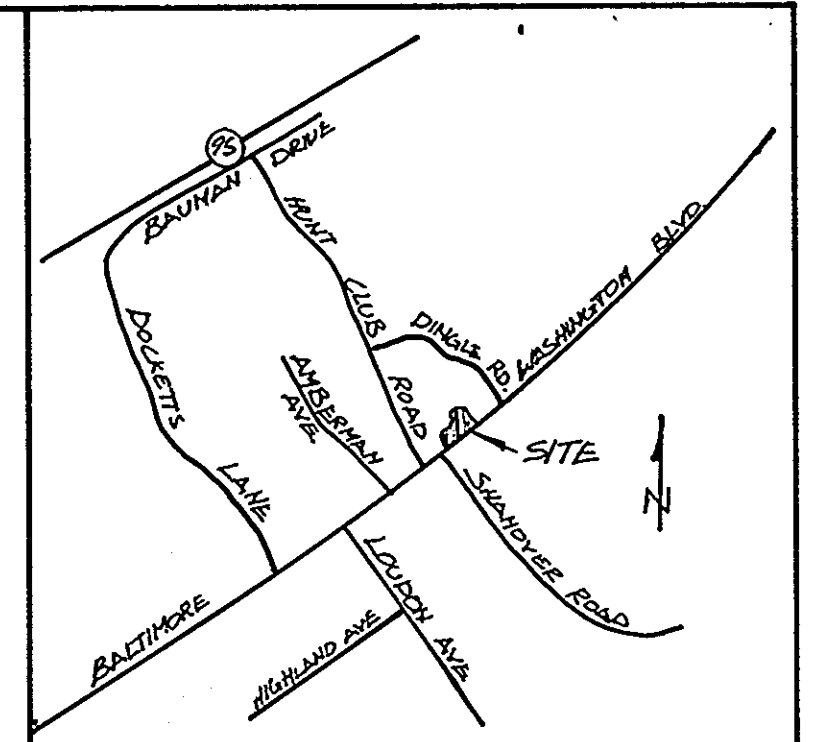
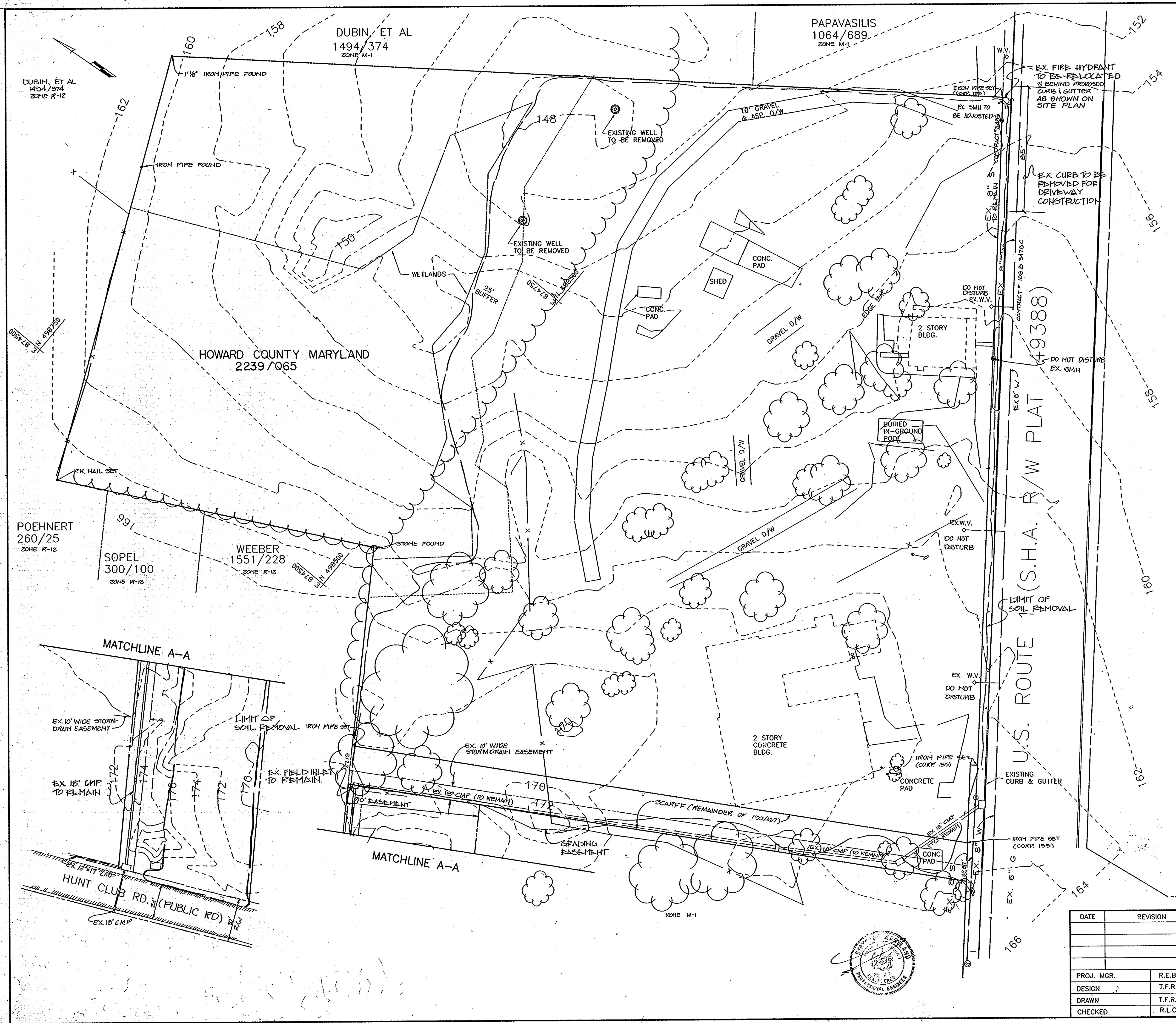

VICINITY MAP
SCALE 1"=2000'

APPROVED: FOR PUBLIC WATER AND PUBLIC SEWERAGE SYSTEMS.
HOWARD COUNTY HEALTH DEPARTMENT
Joseph W. Boyd 2-21-92
COUNTY HEALTH OFFICER DATE

APPROVED: HOWARD COUNTY DEPT. OF PLANNING & ZONING
SDP 91-83
Robert Smith 2/25/92
DIRECTOR DATE

APPROVED: DIVISION OF COMMUNITY PLANNING AND LAND DEVELOPMENT
Anna Hornath 2/24/92
CHIEF DATE

APPROVED: FOR PUBLIC WATER AND PUBLIC SEWERAGE.
STORM DRAINAGE SYSTEMS AND PUBLIC ROADS
HOWARD COUNTY DEPARTMENT OF PUBLIC WORKS
James P. Lee 1/6/92
DIRECTOR DATE

William E. Ryan 1-6-92
CHIEF BUREAU OF ENGINEERING DATE

OWNER: HOWARD COUNTY GOVERNMENT
DEVELOPER/APPLICANT:
HOWARD COUNTY LIBRARY & HEALTH DEPT.
3430 COURT HOUSE DRIVE
ELLCOTT CITY, MD. 21043
ATTN: MR. KENNETH EDWARDS
(301) 313-2040

- GENERAL NOTES
- MISS UTILITY AND UTILITY COMPANIES SHALL BE CONTACTED AT LEAST 5 DAYS PRIOR TO THE BEGINNING OF ANY DEMOLITION WORK.
 - OWNER SHALL REMOVE TRASH, DEBRIS, FENCE AND EXISTING STRUCTURES, INCLUDING BUILDING SLABS WITHIN THE PROPERTY.
 - CONTRACTOR SHALL REMOVE 12" OF EXISTING SOIL WITHIN THE LIMITS SHOWN, INCLUDING EXISTING DRIVEWAYS, PARKING AREAS AND OTHER EXISTING PAVING.
 - EXISTING UTILITIES SHOWN ARE FROM BEST AVAILABLE INFORMATION. CONTRACTOR TO VERIFY LOCATION IN FIELD BEFORE BEGINNING WORK AND SHALL TAKE ALL PRECAUTIONS TO AVOID DAMAGE TO ANY EXISTING UTILITIES.
 - IF ANY UTILITIES ARE DAMAGED DURING DEMOLITION OR CONSTRUCTION PROCESS, CONTRACTOR IS TO CONTACT THE UTILITY COMPANY INVOLVED & THE PLANNING & DEVELOPMENT DIVISION OF GREENMAN-PEDERSEN, INC. IMMEDIATELY.

EX. CONDITIONS/DEMOLITION

ELKRIDGE LIBRARY
HOWARD COUNTY, MARYLAND
1ST. ELECTION DISTRICT
CAPITAL PROJECT L-0007
TAX MAP 38, PARCEL 97

DATE	REVISION

PROJ. MGR.	R.E.B.	DRAWING NO.	SCALE	DATE	SHEET NO.
DESIGN	T.F.R.	90126.	1"=30'	DEC. 7, 1991	8 OF 8
DRAWN	T.F.R.	GREENMAN-PEDERSEN INC.			SDP 91-83
CHECKED	R.L.C.	ENGINEERS/ARCHITECTS/PLANNERS			
14504 GREENMEADOW DRIVE, SUITE 100, LAUREL, MD. 20708 WASH. (301) 470-2772 BALT. (301) 880-3055					

