

ADDRESS CHART

LOT NUMBER	STREET ADDRESS	LOT	STREET ADDRESS
205	6306 ARBOR WAY	345	6407 Frothingham Ct.
206	6308	346	6405 "
207	6310	347	6403 "
208	6312	348	6401 "
209	6314		
210	6316		
211	6318		
212	6320		
213	6322		
214	6324		
215	6326		
216	6328		
217	6330		
218	6332		
219	6334		
220	6336		
221	6338		
222	6340		
223	6342		
224	6344		
225	6346		
226	6348		
227	6350		
228	6352		
229	6354		
230	6356		
231	6358		
232	6360		
233	6362		
234	6364		
235	6366		
236	6368		
237	6370		
238	6372		
239	6374		
240	6376		
241	6378		
242	6380		
243	6382		
244	6384		
245	6386		
246	6388		
247	6390		
248	6392		
249	6394		
250	6396		
251	6398		
252	6400		
253	6402		
254	6404		
255	6406		
256	6408		
257	6410		
258	6412		
259	6414		
260	6416		
261	6418		
262	6420		
263	6422		
264	6424		
265	6426		
266	6428		
267	6430		
268	6432		
269	6434		
270	6436		
271	6438		
272	6440		
273	6442		
274	6444		
275	6446		
276	6448		
277	6450		
278	6452		
279	6454		
280	6456		
281	6458		
282	6460		
283	6462		
284	6464		
285	6466		
286	6468		
287	6470		
288	6472		
289	6474		
290	6476		
291	6478		
292	6480		
293	6482		
294	6484		
295	6486		
296	6488		
297	6490		
298	6492		
299	6494		
300	6496		
301	6498		
302	6500		
303	6502		
304	6504		
305	6506		
306	6508		
307	6510		
308	6512		
309	6514		
310	6516		
311	6518		
312	6520		
313	6522		
314	6524		
315	6526		
316	6528		
317	6530		
318	6532		
319	6534		
320	6536		
321	6538		
322	6540		
323	6542		
324	6544		
325	6546		
326	6548		
327	6550		
328	6552		
329	6554		
330	6556		
331	6558		
332	6560		
333	6562		
334	6564		
335	6566		
336	6568		
337	6570		
338	6572		
339	6574		
340	6576		
341	6578		
342	6580		
343	6582		
344	6584		

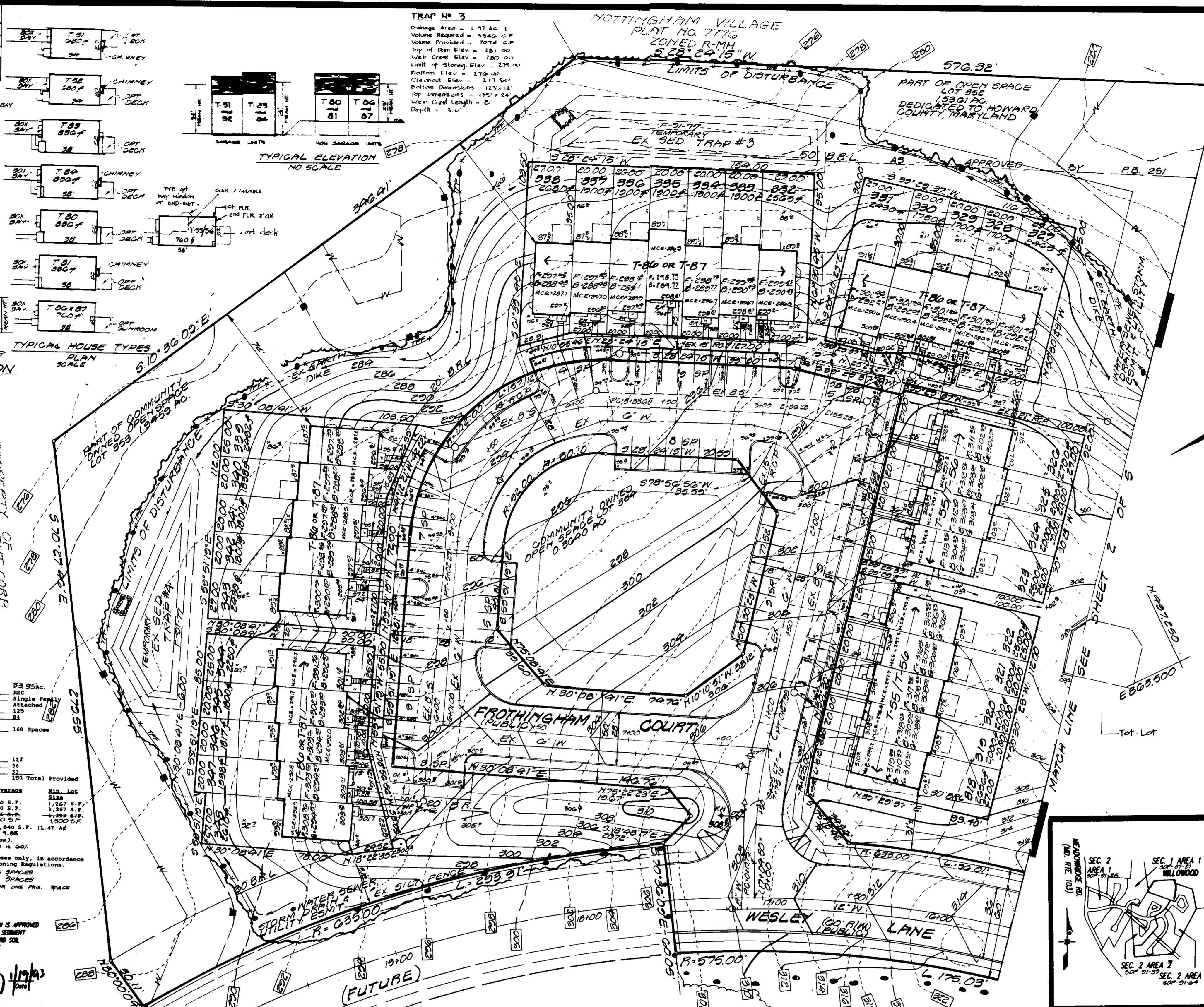

TRAP #4
 Drainage Area = 2.98 AC ±
 Volume Required = 428.4 CF
 Volume Provided = 664.4 CF
 Top of Dam Elev = 281.00
 Water Crest Elev = 282.00
 Limit of Storage Elev = 281.00
 Bottom Elev = 279.00
 Clearwater Elev = 279.50
 Bottom Dimensions = 12' x 12'
 Top Dimensions = 15' x 24'
 Water Crest Length = 10'
 Depth = 3.0'

TRAP #3
 Drainage Area = 1.71 AC ±
 Volume Required = 256.0 CF
 Volume Provided = 707.4 CF
 Top of Dam Elev = 281.00
 Water Crest Elev = 282.00
 Limit of Storage Elev = 279.00
 Bottom Elev = 276.00
 Clearwater Elev = 277.50
 Bottom Dimensions = 12' x 12'
 Top Dimensions = 15' x 24'
 Water Crest Length = 10'
 Depth = 3.0'

SITE ANALYSIS

Area of Subdivision	73.25 ac.
Existing zoning	RSC
Proposed Use	Single Family Attached
No. Units Allowed	125
No. Units Proposed (Building Lots)	125
Parking required (Sec 2 Area 3)	148 Spaces
Parking provided	151 Total Provided
Common surface parking spaces	122
Driveway parking spaces	36
Garage parking	3

UNIT TYPES

COVERAGE	Min. Lot Size	Max. Lot Size
T-55 and T-66	760 S.F.	1,267 S.F.
T-60, T-61, T-62, and T-63	760 S.F.	1,267 S.F.
T-64, T-65, T-66, T-67, T-68, T-69, T-70, T-71, T-72, T-73, T-74, T-75, T-76, T-77, T-78, T-79, T-80, T-81, T-82, T-83, T-84, T-85, T-86, T-87, T-88, T-89, T-90, T-91, T-92, T-93, T-94, T-95, T-96, T-97, T-98, T-99, T-100	760 S.F.	1,267 S.F.
Total Building Coverage	69,840 S.F. (1.57 ac.)	1,900 S.F.
Of Section 2 Area 3 Subarea	69,840 S.F. (1.57 ac.)	1,900 S.F.
Max. building coverage in 50% (incl. opt. deck/terrace)	34,920 S.F. (0.79 ac.)	950 S.F.
Max. building coverage permitted by 40% (incl. opt. deck/terrace)	27,936 S.F. (0.64 ac.)	760 S.F.

Garage shall be used for parking purposes only, in accordance with Section 32.2.2.3. (1) of the zoning regulations.
 DRIVEWAY DOOR PROVIDE 2 HANDING SPACES.
 DRIVEWAY DOOR PROVIDE 2 HANDING SPACES.
 A MIN. OF 6" OVERHANG IS REQUIRED FOR ONE PRG. SPACE.

- GENERAL NOTES**
- Topography was prepared by Photogrammetric Data Services, Inc. in April, 1990.
 - Site will be served by public water and sewer.
 - All utilities shown as existing were compiled from available records and field survey. Contractor shall verify location of utilities prior to construction and notify G.W. of any discrepancies.
 - All work shall be performed in accordance with the Howard County Design Manual Volume IV.
 - Reference: S-88-32, S-88-02, PB-226, F-87-41, SDP-87-81, VP-87-02, P-86-59, S-86-23, PB-186, F-87-41, F-89-96, PB-251, S-89-24, P-90-19, F-91-18, SDP-91-25 and F-91-47, SDP-91-19, F-91-77.
 - Sediment Control and Stormwater Management for Section 2 Area 3 are provided by F-91-77.
 - Where proposed curb is along a designated fire lane (shown as solid curb and gutter line, see legend), common "Red Traffic Paint" shall be used to paint the entire top and vertical surface of the curb. The painted surface shall extend for the full length of the designated fire lane. This type of paint is readily obtainable from the Baltimore Paint and Chemical Company or any similar source dispensing special-use paints. Paint may be applied by either brush or spray.
 At each end of the fire lane, within the red painted area, the phrase, "NO PARKING - FIRE LANE" shall be painted in white letters no less than three (3) inches high on top of the curb. This phrase shall be repeated approximately every twenty feet (20') along the entire painted curb top surface. This phrase shall also be placed approximately every twenty (20) feet on the vertical face of the curb, offset by ten (10) feet with respect to the above markings on the top surface. However, in no event, shall there be less than two (2) such markings on the top of the curb and one (1) on the vertical face.
 - Sidewalk shall be constructed per F-91-77.
 - Units with driveway will receive trash pick-up @ the end of their driveway. Units without driveway will receive the modified top of collection service.
 - SEDIMENT TRAPS Nos. 2, 3, AND 4 WILL BE REMOVED BY TRAFALGAR HOUSE RESIDENTIAL MARYLAND AS SOON AS DISTURBED AREA HAS BEEN STABILIZED.

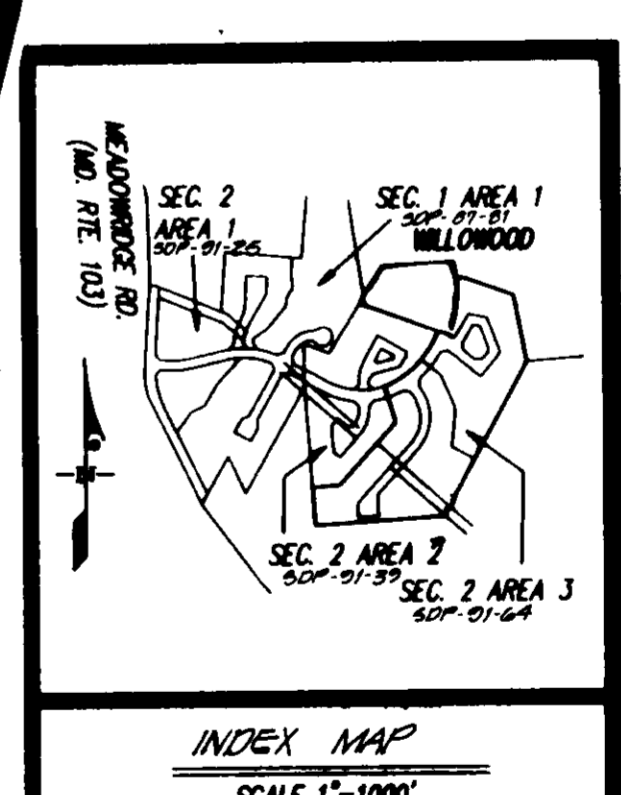

LEGEND

- EX CONTOUR
- PROP CONTOUR
- LIMIT OF DISTURBANCE
- EARTH DIKE
- SILT FENCE
- STONE CONST. ENTRANCE
- LIMIT OF WETLANDS
- 25' WETLANDS BUFFER
- FIRE LANE
- STREET LIGHT (PER F-91-77)
- EX TREELINE
- PROP TREELINE
- TREE PROTECTION FENCE

DENSITY TABULATION

WILLOWOOD	GROSS FLOORPLAN AREA	NET AREA	# OF UNITS ALLOWED	TOTAL OF UNITS ALLOWED	OPEN SPACE PROVIDED	OPEN SPACE REQUIRED	OPEN SPACE PROVIDED	OPEN SPACE REQUIRED	DENSITY PER ACRE	
SEC 1 AREA 1	1740A	3.02 AC	145A	45	33	54	2.89 AC	1.45 AC	4.80 AC	472
SEC 2 AREA 1	1740A	0.00 AC	140A	20	0	20	1.48 AC	0.74 AC	4.52 AC	635
SEC 2 AREA 2	0.37A	0.00 AC	0.37A	34	0	34	1.71 AC	0.86 AC	4.12 AC	600
SEC 2 AREA 3	0.37A	2.33 AC	30.54A	123	0	123	6.67 AC	3.34 AC	10.94 AC	650
TOTAL	0.37A	5.41 AC	68.90A	233	8	241	12.76 AC	6.38 AC	20.56 AC	403

*EXCLUDES AREAS WITHIN OPEN SPACES DESIGNATED FOR PRIVATE PARKING, SWIM FLOODPLAIN, STEEP SLOPES AND WETLANDS.
 **PREVIOUSLY PLATTED SECTIONS DO NOT INCLUDE AREAS RESUBDIVIDED IN SUBSEQUENT SUBDIVISIONS.
 †INCLUDES LOTS 356 AND 357.

Tot Lot Notes

- Play structure and benches shall be Victor Shering Model 0600 and Model 0 (D'Arbois Manufacturing) respectively.
- Timber edge shall be 5/8" diameter treated.
- 2" Lot area within timber edge shall be mulched.

SUBDIVISION NAME
 WILLOWOOD

SECTION
 2/3

LOT NUMBER
 265-354

BLK
 10571

BLK
 10581

WATER CODE
 D06

SEWER CODE
 2153000

APPROVED: FOR PUBLIC WATER & PUBLIC SEWERAGE SYSTEMS, HOWARD COUNTY HEALTH DEPARTMENT
 Date: 2-4-93

APPROVED: HOWARD COUNTY DEPARTMENT OF PLANNING & ZONING
 Date: 11-12-90

APPROVED: FOR PUBLIC WATER & PUBLIC SEWERAGE, STORM DRAINAGE SYSTEMS AND PUBLIC ROADS, HOWARD COUNTY DEPARTMENT OF PUBLIC WORKS
 Date: 2-1-93

APPROVED PLANNING BOARD OF HOWARD COUNTY
 DATE Nov. 12, 1991

OWNER'S CERTIFICATE
 I, the undersigned, certify that this plan for subdivision and subdivision control represents a practical and suitable plan based on my personal knowledge of the site conditions and that it was prepared in accordance with the requirements of the Howard Soil Conservation District.
 Date: 11-7-90

DEVELOPER'S/BUILDER'S CERTIFICATE
 I, the undersigned, certify that all information and/or construction will be done according to this plan, and that any responsible personnel involved in the construction project will have a Certificate of Attendance at a Department of the Environment Approved Training Program for the Control of Sediment and Erosion before beginning the project. I also authorize periodic on-site inspection by the HSDC.
 Date: 11-7-90

G.W. GUTSCHICK LITTLE & WEBER, P.A.
 ENGINEERS, PLANNERS, SURVEYORS
 3909 NATIONAL DRIVE - SUITE 250 - BURTONSVILLE OFFICE PARK - BURTONSVILLE, MD. 20886
 TELEPHONE: (301) 421-4024

PREPARED FOR:
 TRAFALGAR HOUSE
 RESIDENTIAL MARYLAND
 8888 GUILFORD ROAD, SUITE 250
 COLUMBIA, MARYLAND 21046
 (301) 621-8151

SITE DEVELOPMENT PLAN
WILLOWOOD
 SECTION 2 AREA 3
 LOTS 265 THRU 354
 FIRST ELECTION DISTRICT
 HOWARD COUNTY, MARYLAND

SCALE	1"=30'
ZONING	RSC
G.L.W. FILE NO.	89-080
DATE	NOVEMBER, 1990
TAX MAP No.	37
SHEET	1 OF 5

SDP-91-64

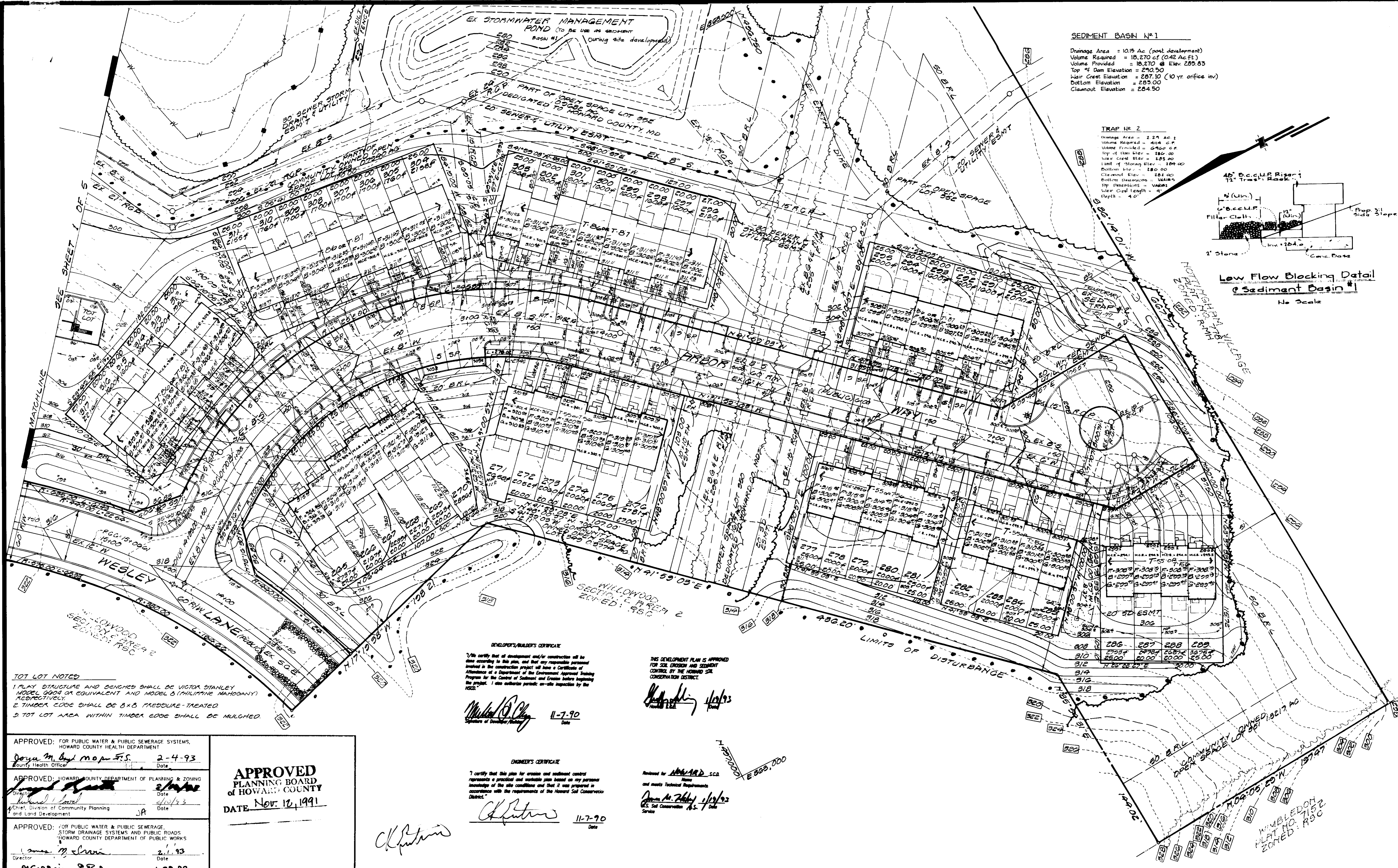

SEDIMENT BASIN #1
 Drainage Area = 10.15 Ac (post development)
 Volume Required = 18,270 cf (0.42 Ac ft)
 Volume Provided = 18,270 cf
 Top of Dam Elevation = 284.50
 Inlet Crest Elevation = 287.10 (10 yr. orifice inv)
 Bottom Elevation = 283.00
 Cleanout Elevation = 284.50

TRAP #2
 Drainage Area = 2.27 AC ±
 Volume Required = 4114 c.f.
 Volume Provided = 6260 c.f.
 Top of Trap Elev = 285.00
 Inlet Crest Elev = 285.00
 Limit of Storage Elev = 284.00
 Bottom Elev = 280.00
 Cleanout Elev = 284.00
 Bottom Dimensions - Values
 Top Dimensions - Values
 Weir Crest Length = 9'-0"
 Depth = 4'-0"

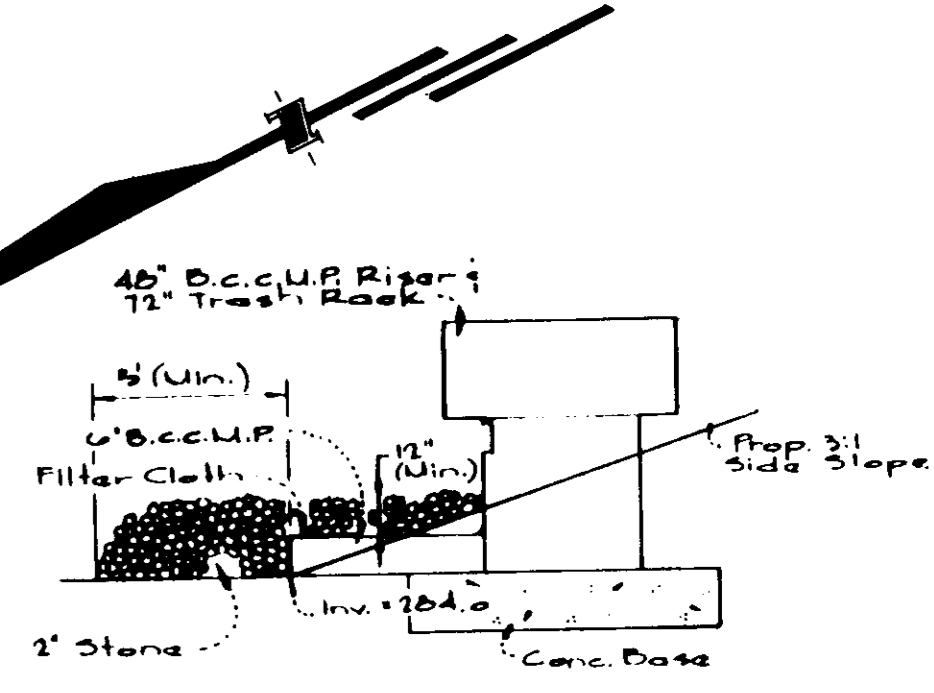

Low Flow Blocking Detail of Sediment Basin #1
 No Scale

- TOT LOT NOTES**
1. PLAY STRUCTURE AND BENCHES SHALL BE VICTOR STANLEY MODEL 9909 OR EQUIVALENT AND MODEL 6 (PHILIPINE NAHOGANY) RESPECTIVELY.
 2. TIMBER EDGE SHALL BE 8x8 TREDGURE-TREATED.
 3. TOT LOT AREA WITHIN TIMBER EDGE SHALL BE MULCHED.

DEVELOPER'S/BUILDER'S CERTIFICATE
 I/We certify that all development and/or construction will be done according to this plan, and that any responsible personnel involved in the construction project will have a Certificate of Attendance at a Department of the Environment Approval Training Program for the Control of Sediment and Erosion before beginning the project. I also authorize periodic on-site inspection by the DCSD.

Michael P. Clay 11-7-90
 Date

THIS DEVELOPMENT PLAN IS APPROVED FOR SOIL EROSION AND SEDIMENT CONTROL BY THE HOWARD SOIL CONSERVATION DISTRICT.

John M. Hill 11/2/93
 Date

ENGINEER'S CERTIFICATE
 I certify that this plan for erosion and sediment control represents a practical and suitable plan based on my personal knowledge of the site conditions and that it was prepared in accordance with the requirements of the Howard Soil Conservation District.

John M. Hill 11-7-90
 Date

Reviewed for HOWARD SOIL CONSERVATION DISTRICT and meets Technical Requirements

John M. Hill 11/2/93
 Date

APPROVED: FOR PUBLIC WATER & PUBLIC SEWERAGE SYSTEMS, HOWARD COUNTY HEALTH DEPARTMENT
Dona M. Boyd 11-7-93
 County Health Officer Date

APPROVED: HOWARD COUNTY DEPARTMENT OF PLANNING & ZONING
John M. Hill 11/2/93
 Director Date

APPROVED: FOR PUBLIC WATER & PUBLIC SEWERAGE, STORM DRAINAGE SYSTEMS AND PUBLIC ROADS, HOWARD COUNTY DEPARTMENT OF PUBLIC WORKS
James M. Shinn 11-23-93
 Director Date

APPROVED PLANNING BOARD OF HOWARD COUNTY
 DATE Nov. 12, 1991

GLW GUTSCHICK LITTLE & WEBER, P.A.
 ENGINEERS, PLANNERS, SURVEYORS
 3908 NATIONAL DRIVE · SUITE 250 · BURTONSVILLE OFFICE PARK · BURTONSVILLE, MD. 20866
 TELEPHONE: (301) 421-4024

DATE	REVISION	BY	APPR.
10/5/94	REV HSE TYPES lots 271-287 (T-33 or T-34) lots 290-295 (10000187)	MCF	
10/25/94	Revising bldgs per new HSE Types T-80, T-81, T-55, T-56	MCF	
11-3-93	REVISED GRADING ELEV & BLDGS PER NEW HSE TYPES T-80, T-50 & T-51	JK	

PREPARED FOR:
TRAFALGAR HOUSE RESIDENTIAL MARYLAND
 8888 GUILFORD ROAD, SUITE 200
 COLUMBIA, MARYLAND 21046
 (301) 621-6181

SITE DEVELOPMENT PLAN
WILLOWOOD SECTION 2 AREA 3
LOTS 265 THRU 354
 HOWARD COUNTY, MARYLAND

SCALE	ZONING	G.L.W. FILE NO.
1"=30'	RSC	89-080
DATE	TAX MAP NO.	SHEET
NOVEMBER, 1990	37	2 OF 5

SDR91-64

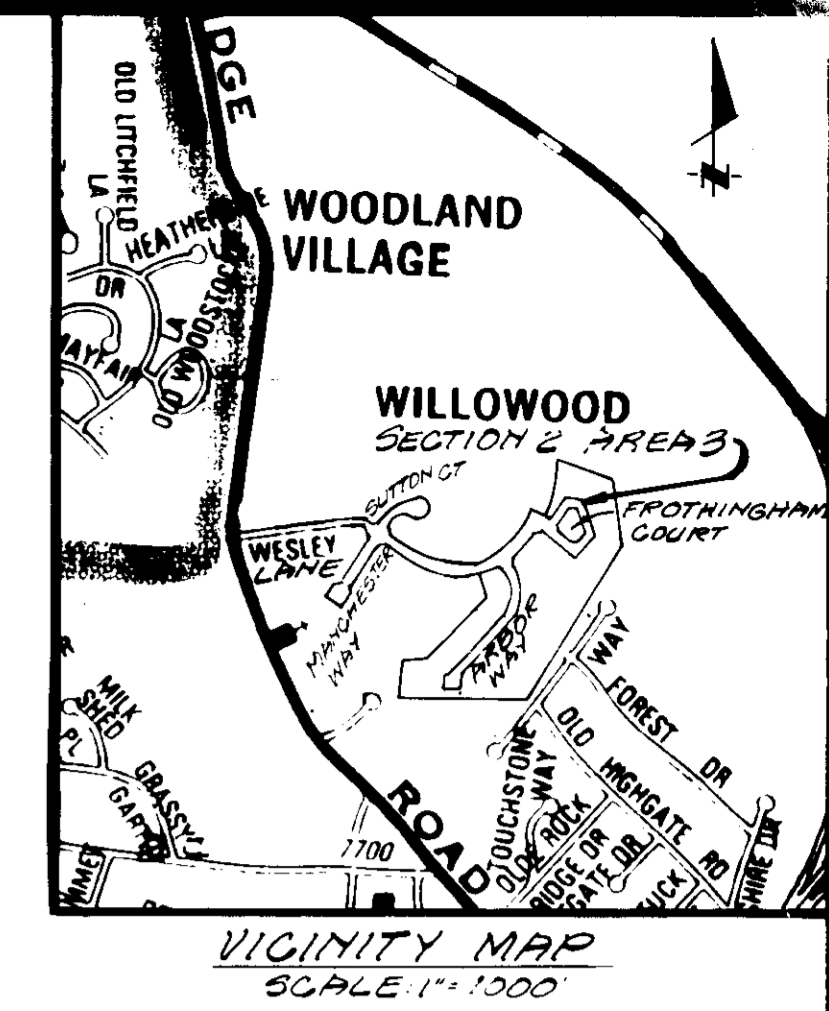
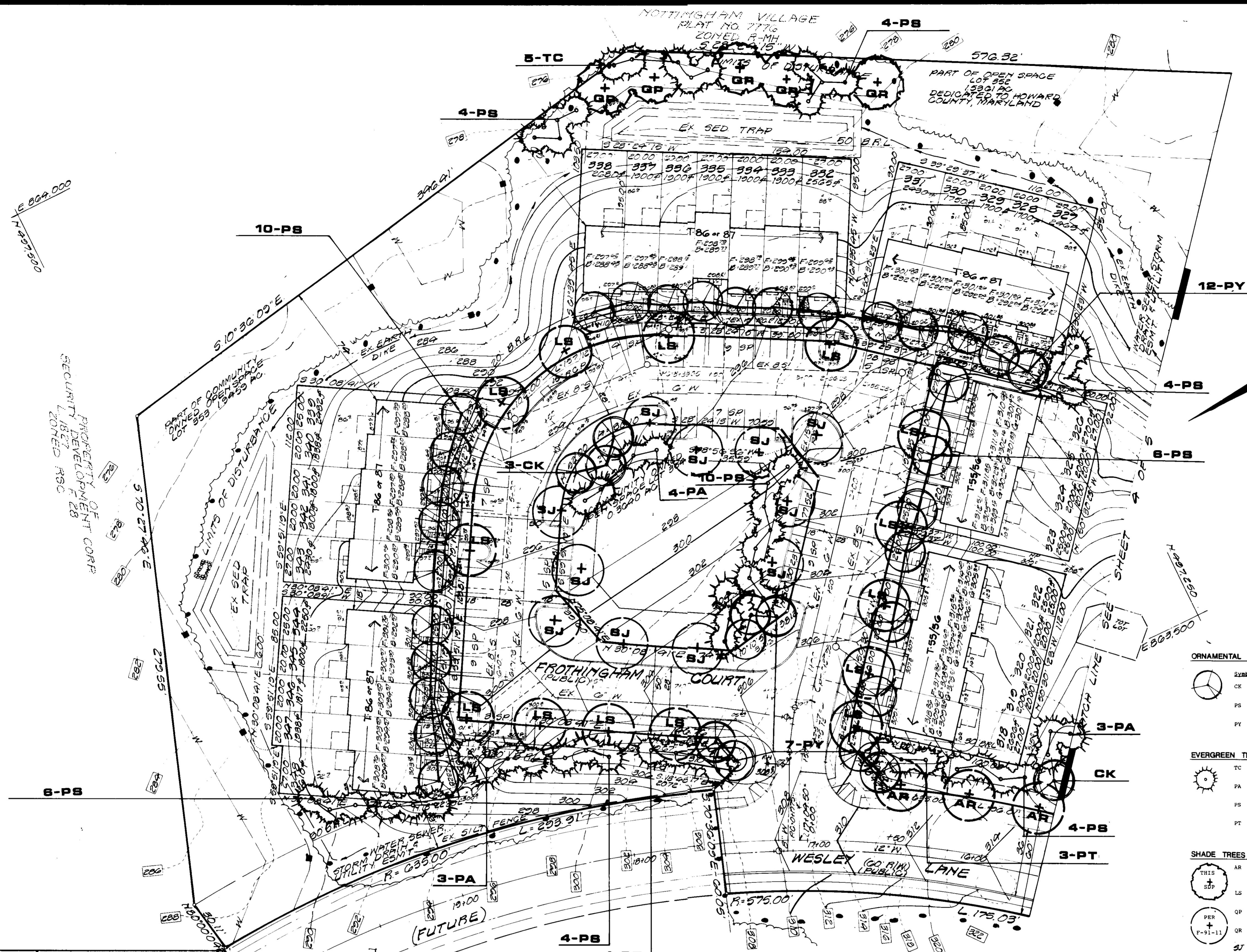

PLANT LIST

Symbol	Name (Botanical/Common)	Quant.	Size	Remarks
ORNAMENTAL TREES				
CK	Cornus kousa chinensis Chinese Dogwood	6	2 1/2-3" Cal. 8-10' Ht.	8&B Well Branched
PS	Prunus serrulata 'kwanzan' Kwanzan Cherry	36	2 1/2-3" Cal. 8-10' Ht.	8&B Well Branched
PY	Prunus yedoensis Yoshino Cherry	40	2 1/2-3" Cal. 8-10' Ht.	8&B Well Branched
EVERGREEN TREES				
TC	Tsuga canadensis Canadian Hemlock	10	2 1/2-3" Cal. 8-10' Ht.	8&B
PA	Picea abies Norway Spruce	10	2 1/2-3" Cal. 8-10' Ht.	8&B
PS	Pinus strobus Eastern White Pine	80	2 1/2-3" Cal. 8-10' Ht.	8&B
PT	Pinus thunbergii Japanese Black Pine	11	2 1/2-3" Cal. 8-10' Ht.	8&B Balanced Form
SHADE TREES				
AR	Acer rubrum 'Oct. Red Glory' / Oct. Red Glory Red Maple	(9)	2 1/2-3" Cal. 12-14' Ht.	8&B Full Head
LS	Liquidambar styraciflua Sweet Gum	(6)	2 1/2-3" Cal. 12-14' Ht.	8&B Full Head
QP	Quercus palustris Pig Oak	4	2 1/2-3" Cal. 12-14' Ht.	8&B Full Head
QR	Quercus rubrum Red Oak	4	2 1/2-3" Cal. 12-14' Ht.	8&B Full Head
SJ	BOPHORA JAPONICA JAPANESE PAJODA TREE	(11)	2 1/2-3" Cal. 12-14' Ht.	8&B FULL HEAD

* QUANTITY IN PARENTHESIS INCLUDES TREES SHOWN ON E21-77.

APPROVED: FOR PUBLIC WATER & PUBLIC SEWERAGE SYSTEMS,
HOWARD COUNTY HEALTH DEPARTMENT
Debra M. Boyd M.D. p.e.f. 2-4-93
County Health Officer Date

APPROVED: HOWARD COUNTY DEPARTMENT OF PLANNING & ZONING
Richard J. [Signature] 11/17/93
Director Date

APPROVED: FOR PUBLIC WATER & PUBLIC SEWERAGE,
STORM DRAINAGE SYSTEMS, AND PUBLIC ROADS,
HOWARD COUNTY DEPARTMENT OF PUBLIC WORKS
James H. [Signature] 2-1-93
Director Date

William S. [Signature] 1-28-93
Chief, Bureau of Engineering & Inspection Date

APPROVED
PLANNING BOARD
of HOWARD COUNTY
DATE: Nov. 12, 1991

CK [Signature]

FOR PLANTING PURPOSES ONLY!

GLW GUTSCHICK LITTLE & WEBER, P.A.
ENGINEERS, PLANNERS, SURVEYORS
3909 NATIONAL DRIVE - SUITE 250 - BURTONSVILLE OFFICE PARK - BURTONSVILLE, MD 20886
TELEPHONE: (301) 421-4024

DATE	REVISION	BY	APP'R.

PREPARED FOR:
TRAFALGAR HOUSE
RESIDENTIAL MARYLAND
8885 GUILFORD ROAD, SUITE 280
COLUMBIA, MARYLAND 21046
(301) 621-8151

PLANTING PLAN
WILLOWOOD
SECTION 2 AREA 3
LOTS 283 THRU 354
FIRST ELECTION DISTRICT HOWARD COUNTY, MARYLAND

SCALE	ZONING	G.L.W. FILE NO.
1"=30'	RSC	89-080
DATE	TAX MAP No.	SHEET
NOVEMBER, 1990	37	3 OF 5

SDP91-64

TREE PROTECTION FENCE DETAIL

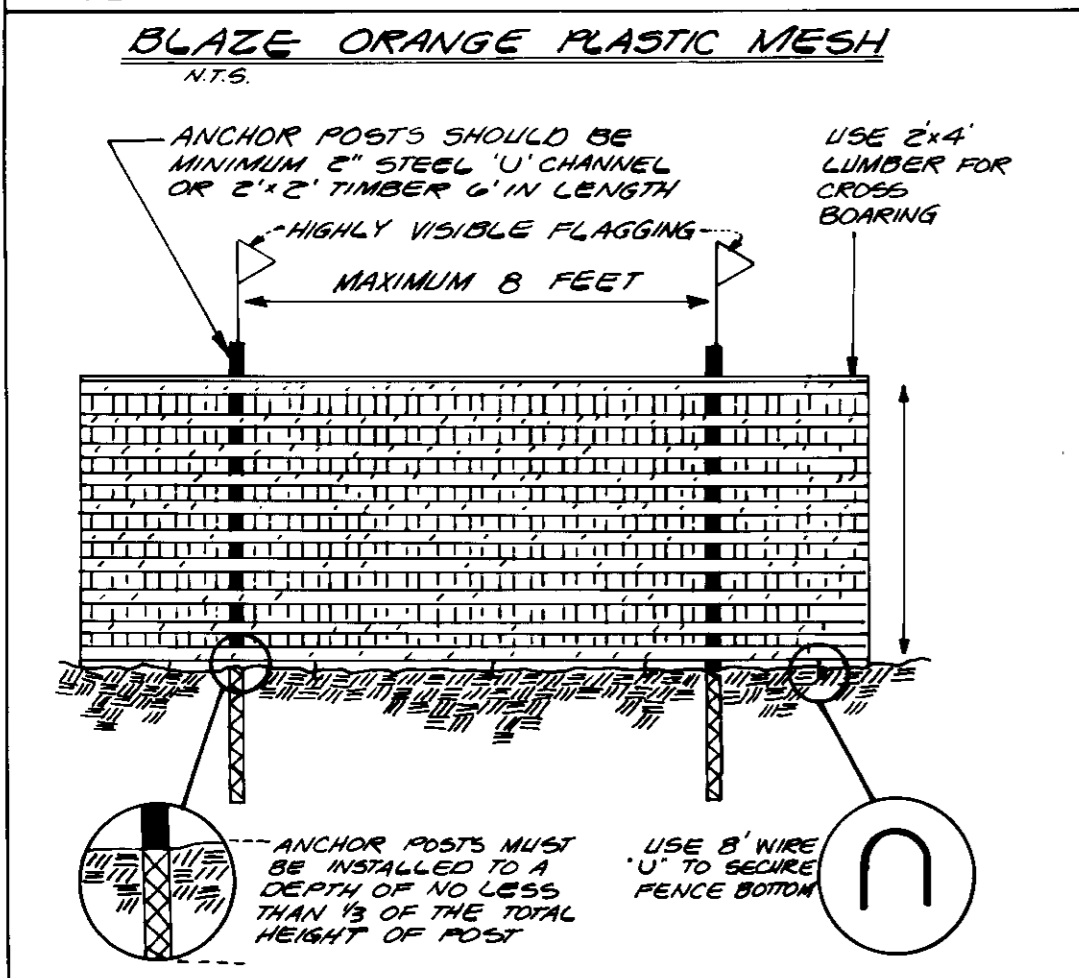

NOTES:
 1. FENCE PROTECTION DEVICE ONLY.
 2. RETENTION AREA WILL BE SET AS PART OF REVIEW PROCESS.
 3. BOUNDARIES OF RETENTION AREA SHOULD BE STAKED AND FLAGGED PRIOR TO INSTALLING DEVICE.
 4. ROOT DAMAGE SHOULD BE AVOIDED.
 5. PROTECTIVE SIGNAGE MAY ALSO BE USED.
 6. DEVICE SHOULD BE MAINTAINED THROUGHOUT CONSTRUCTION.

DEVELOPER'S/BUILDER'S CERTIFICATE

I/We certify that all development and/or construction will be done according to this plan, and that any responsible personnel involved in the construction project will have a Certificate of Attendance of a Department of the Environment Approved Training Program for the Control of Sediment and Erosion before beginning the project. I also authorize periodic on-site inspection by the HSCD.

Michael J. Clay
 Signature of Developer/Builder
 11-7-90
 Date

ENGINEER'S CERTIFICATE

I certify that this plan for erosion and sediment control represents a practical and workable plan based on my personal knowledge of the site conditions and that it was prepared in accordance with the requirements of the Howard Soil Conservation District.

C.K. Johnston
 Signature of Engineer
 11-7-90
 Date

THIS DEVELOPMENT PLAN IS APPROVED FOR SOIL CONSERVATION AND SEDIMENT CONTROL BY THE HOWARD SOIL CONSERVATION DISTRICT.

Reviewed for HOWARD S.C.D. Name and meets Technical Requirements
James A. [Signature]
 S. Soil Conservation Service
 Date 11/12/90

SEDIMENT CONTROL NOTES

- A minimum of 24 hours notice must be given to the Howard County Office of Inspection and Permits prior to the start of any construction. (883-2437) 313-1850
- All vegetative and structural practices are to be installed according to the provisions of this plan and are to be in conformance with the 1983 MARYLAND STANDARDS AND SPECIFICATIONS FOR SOIL EROSION AND SEDIMENT CONTROL.
- Following initial soil disturbance or redistribution, permanent or temporary stabilization shall be completed within: a) 7 calendar days for all perimeter sediment control structures, dikes and perimeter slopes and all slopes greater than 3:1, b) 14 days as to all other disturbed or graded areas on the project site.
- All sediment traps/basins shown must be fenced and warning signs posted around their perimeter in accordance with Vol. 1, Chapter 12, of the HOWARD COUNTY DESIGN MANUAL, Storm Drainage.
- All disturbed areas must be stabilized within the time period specified above in accordance with the 1983 MARYLAND STANDARDS AND SPECIFICATIONS FOR SOIL EROSIONS AND SEDIMENT CONTROL for permanent seedings (Sec. 51), sod (Sec. 54), temporary seedings (Sec. 50) and mulching (Sec. 52). Temporary stabilization, with mulch alone can only be done when recommended seeding dates do not allow for proper germination and establishment of grasses.
- All sediment control structures are to remain in place and are to be maintained in operative condition until permission for their removal has been obtained from the Howard County Sediment Control Inspector.
- Site Analysis:
 Total Area of Site: 33.35 Acres
 Area Disturbed: 10.30 Acres
 Area to be roofed or paved: 375 Acres
 Area to be vegetatively stabilized: 8.69 Acres
 Total Cut: 307,000 Cu. Yds.
 Total Fill: 1,653 Cu. Yds.
 Off-Site waste/barrow area location: SDP-91-39
- Any sediment control practice which is disturbed by grading activity for placement of utilities must be repaired on the same day of disturbance.
- Additional sediment control must be provided, if deemed necessary by the Howard County DPW Sediment Control Inspector.
- On all sites with disturbed areas in excess of 2 acres, approval of the inspection agency shall be requested upon completion of installation of perimeter erosion and sediment controls, but before proceeding with any other earth disturbance or grading. Other building or grading inspection approvals may not be authorized until this initial approval by the inspection agency is made.

TEMPORARY SEEDING NOTES

Apply to graded or cleared areas likely to be redisturbed where a short-term vegetative cover is needed.

Seedbed Preparation: Loosen upper three inches of soil by raking, discing or other acceptable means before seeding (unless previously loosened).

Soil Amendments: Apply 600 lbs per acre 10-10-10 fertilizer (14 lbs/1000 sq ft).

Seeding: For periods March 1 thru April 30 and from August 15 thru November 15, seed with 2-1/2 bushel per acre of annual rye (3.2 lbs./1000 sq ft). For the period May 1 thru August 14, seed with 3 lbs per acre of weeping lovegrass (.07 lbs/1000 sq ft). For the period November 16 thru February 28, protect site by applying 2 tons per acre of well anchored straw mulch and seed as soon as possible in the spring, or use sod.

Mulching: Apply 1-1/2 to 2 tons per acre (70 to 90 lbs/1000 sq ft) of unrattled small grain straw immediately after seeding. Anchor mulch immediately after application using mulch anchoring tool or 218 gal per acre (5 gal/1000 sq ft) of emulsified asphalt on flat areas. On slopes, 8 ft or higher, use 348 gal per acre (8 gal/1000 sq ft) for anchoring.

Refer to the 1983 MARYLAND STANDARDS AND SPECIFICATIONS FOR SOIL EROSION AND SEDIMENT CONTROL for rate and methods not covered.

PERMANENT SEEDING NOTES

Apply to graded or cleared area not subject to immediate further disturbance where a permanent long-lived vegetative cover is needed.

Seedbed Preparation: Loosen upper three inches of soil by raking, discing or other acceptable means before seeding (unless previously loosened).

Soil Amendments: In lieu of soil test recommendations, use one of the following schedules

- Preferred - Apply 2 tons per acre dolomitic limestone (92 lbs/1000 square feet) and 600 lbs per acre 10-10-10 fertilizer (14 lbs/1000 sq ft) before seeding. Harrow or disc into upper three inches of soil. At time of seeding, apply 400 lbs per acre 30-0-0 ureaform fertilizer (9 lbs/1000 sq ft).
- Acceptable - Apply 2 tons per acre dolomitic limestone (92 lbs/1000 sq ft) and 1000 lbs per acre 10-10-10 fertilizer (23 lbs/1000 sq ft) before seeding. Harrow or disc into upper three inches of soil.

Seeding: For the periods March 1 thru April 30, and August 1 thru October 15, seed with 60 lbs per acre (1.4 lbs/1000 sq ft) of Kentucky 31 Tall Fescue. For the period May 1 thru July 31, seed with 60 lbs Kentucky 31 Tall Fescue per acre and 2 lbs per acre (.05 lbs/1000 sq ft) of weeping lovegrass. During the period of October 16 thru February 28, protect site by Option (1) 2 tons per acre of well anchored straw mulch and seed as soon as possible in the spring. Option (2) Use sod. Option (3) Seed with 60 lbs/acre Kentucky 31 Tall Fescue and mulch with 2 tons/acre well anchored straw.

Mulching: Apply 1-1/2 to 2 tons per acre (70 to 90 lbs/1000 sq ft) of unrattled small grain straw immediately after seeding. Anchor mulch immediately after application using mulch anchoring tool or 218 gallons per acre (5 gal/1000 sq ft) of emulsified asphalt on flat areas. On slopes 8 feet or higher, use 348 gallons per acre (8 gal/1000 sq ft) for anchoring.

Maintenance: Inspect all seeded areas and make needed repairs, replacements and reseedings.

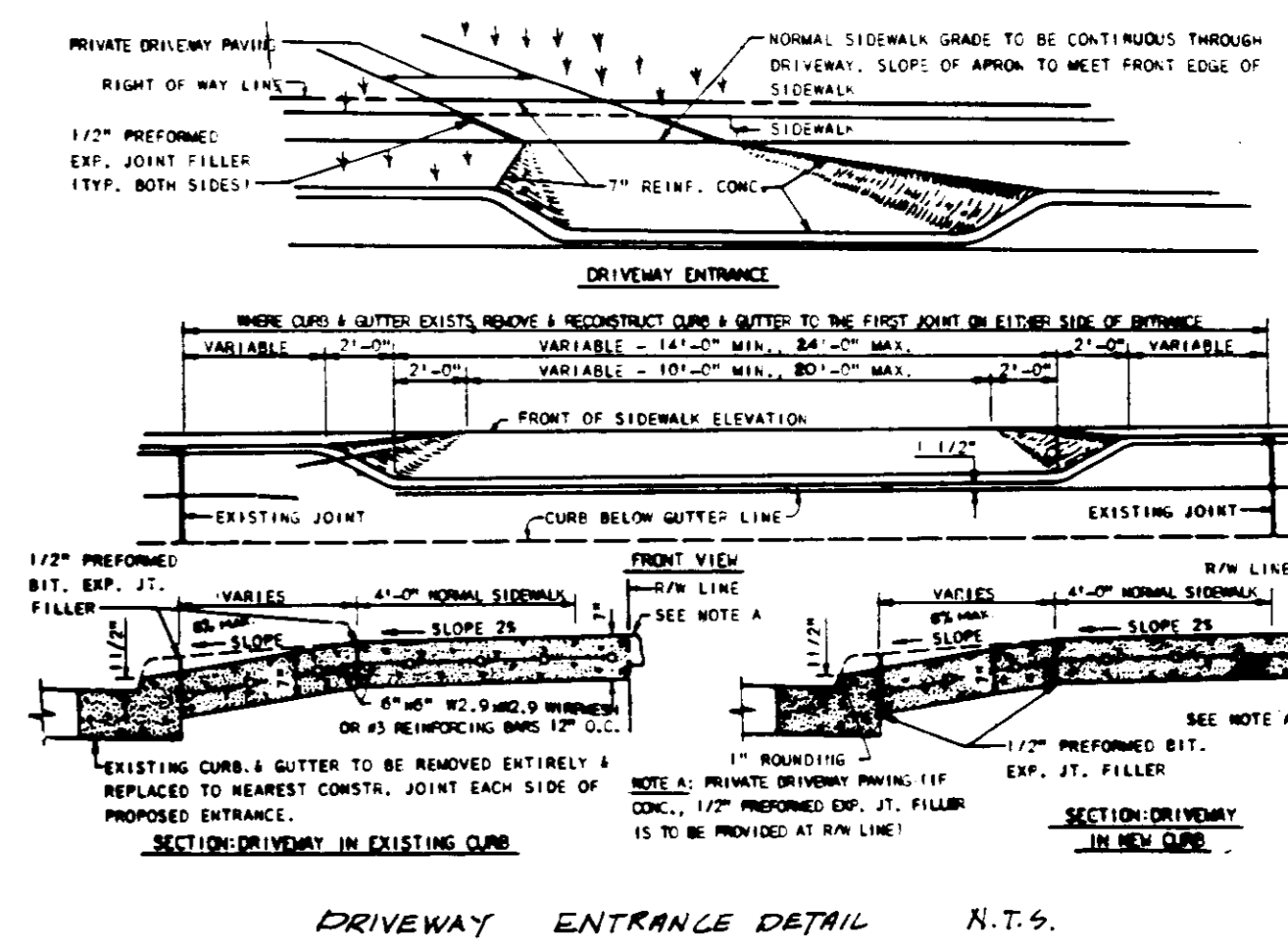

DRIVEWAY ENTRANCE DETAIL N.T.S.

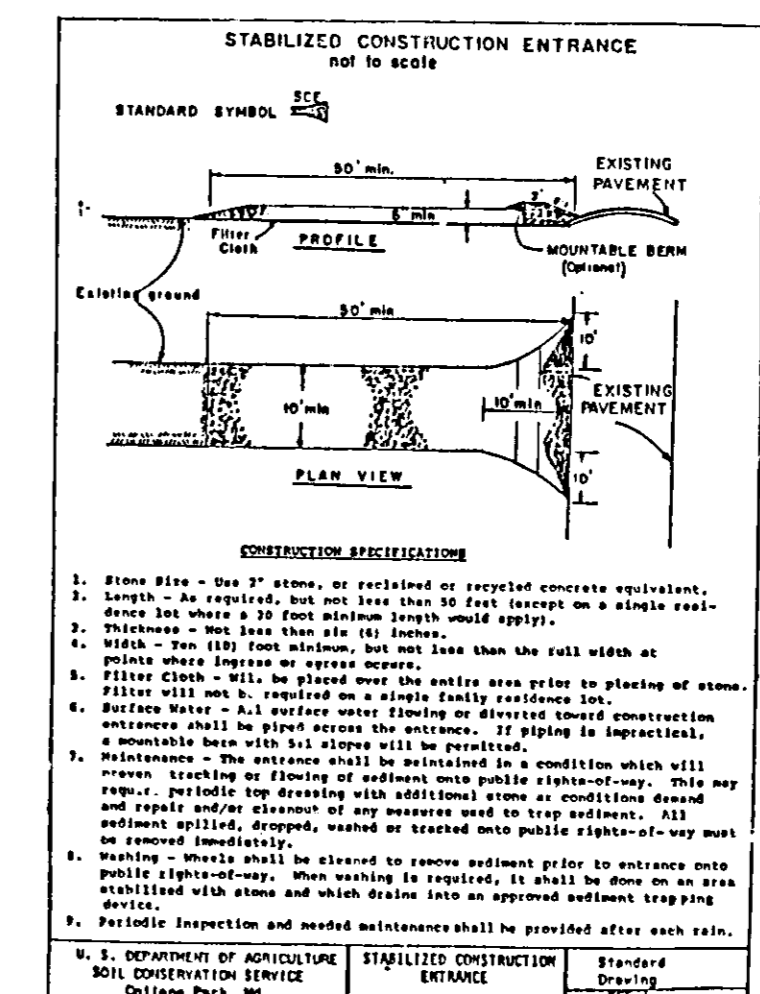

STABILIZED CONSTRUCTION ENTRANCE Not to scale

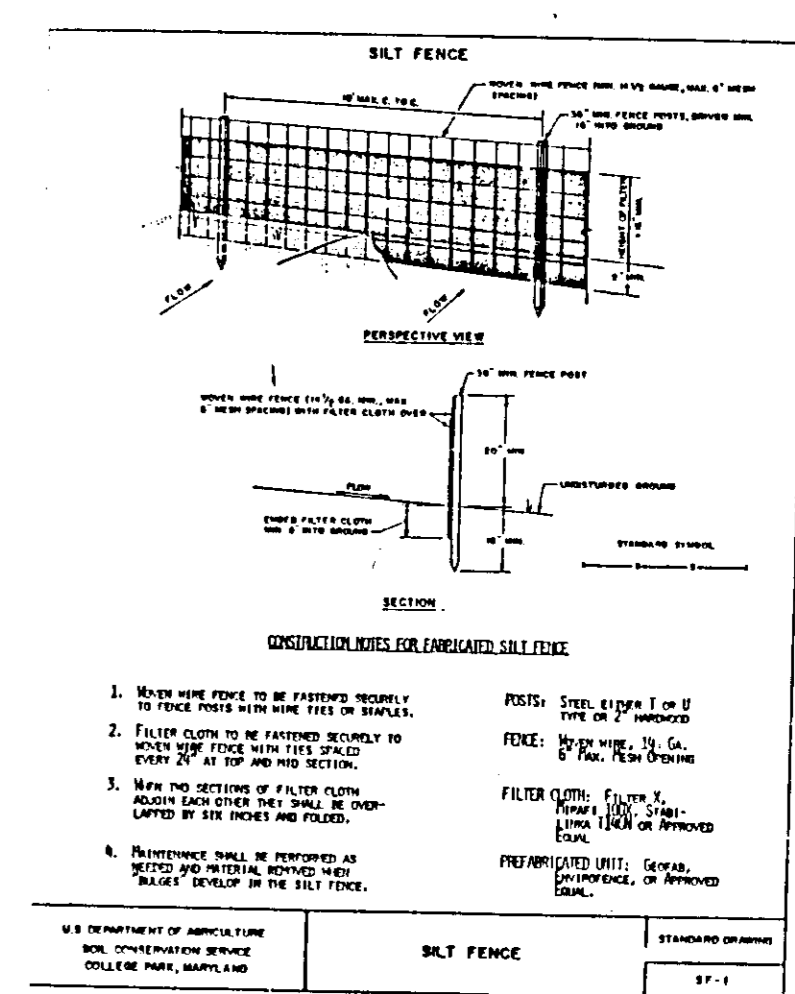

SILT FENCE

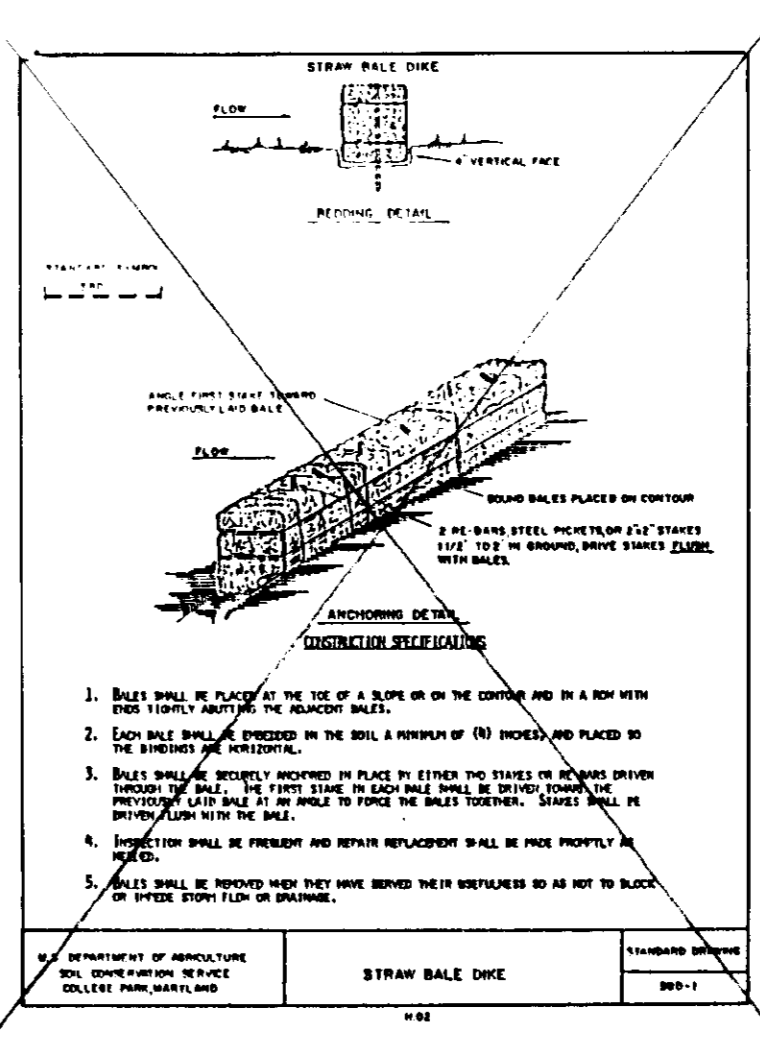

STRAW BALE DIKE

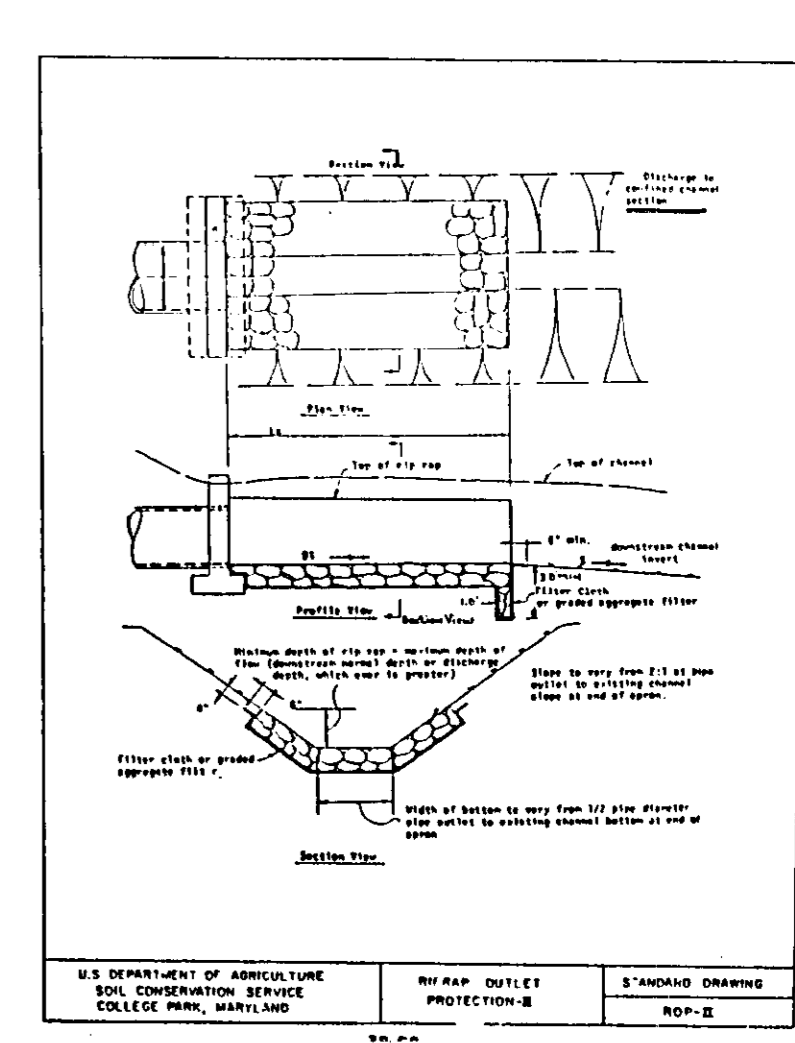

TYPICAL PARKING N.T.S.

APPROVED: FOR PUBLIC WATER & PUBLIC SEWERAGE SYSTEMS, HOWARD COUNTY HEALTH DEPARTMENT
James M. [Signature]
 County Health Officer
 Date 2-4-93

APPROVED: HOWARD COUNTY DEPT. OF PLANNING & ZONING
Richard [Signature]
 Director
 Date 2/14/93

APPROVED: FOR PUBLIC WATER & PUBLIC SEWERAGE, STORM DRAINAGE SYSTEMS AND PUBLIC ROADS, HOWARD COUNTY DEPARTMENT OF PUBLIC WORKS
James [Signature]
 Director
 Date 2-4-93

APPROVED: PLANNING BOARD OF HOWARD COUNTY
 DATE Nov. 12, 1991

GLW GUTSCHICK LITTLE & WEBER, P.A.
 ENGINEERS, PLANNERS, SURVEYORS
 3909 NATIONAL DRIVE - SUITE 250 - BURTONSVILLE OFFICE PARK - BURTONSVILLE, MD 20886
 TELEPHONE: (301) 421-4024

DATE	REVISION	BY	APP'R.

PREPARED FOR:
TRAFALGAR HOUSE RESIDENTIAL MARYLAND
 8888 GULFPORT ROAD, SUITE 250
 COLUMBIA, MARYLAND 21046
 (301) 821-8151

NOTES & DETAILS
WILLOWOOD
 SECTION 2 AREA 3
 LOTS 265 THRU 354
 HOWARD COUNTY, MARYLAND

ELECTION DISTRICT NO. 1

SCALE	ZONING	G.L.W. FILE No.
AS SHOWN	R50	89-080
DATE	TAX MAP No.	SHEET
NOVEMBER, 1990	37	5 OF 5

SDP-91-64