

LEGEND
 EX. CONTOURS 405
 PROP. CONTOURS 405
 LIMIT OF DISTURBANCE
 SILT FENCE 3-3-3
 SLOPES > 25%
 SLOPES 15% - 25% XXX
 EARTH OIKE
 STONE OUTLET STRUCTURE
 STABILIZED CONSTRUCTION ENTRANCE SCE

SEQUENCE OF CONSTRUCTION:

1. OBTAIN GRADING PERMIT
2. NOTIFY HOWARD COUNTY OFFICE OF INSPECTION AND PERMITS 24 HOURS PRIOR TO STARTING WORK
3. INSTALL ALL SEDIMENT CONTROL FEATURES
4. ROUGH GRADE SITE
5. FINE GRADE SITE
6. STABILIZE SITE PER PERMANENT SEEDING PROCEDURES
7. REMOVE SEDIMENT CONTROL DEVICES AND STABILIZE THOSE AREAS AFTER APPROVAL BY HO. CO. SEDIMENT CONTROL INSPECTOR.

- SITE ANALYSIS**
1. TOTAL AREA OF SITE IS 28,110 SQUARE FEET (0.64 ACRES)
 2. TOTAL AREA OF LIMIT OF SUBMISSION IS 1,280 SQUARE FEET (0.03 ACRES)
 3. PRESENT ZONING - R-20
 4. EXISTING AND PROPOSED USE - SINGLE FAMILY RESIDENCE

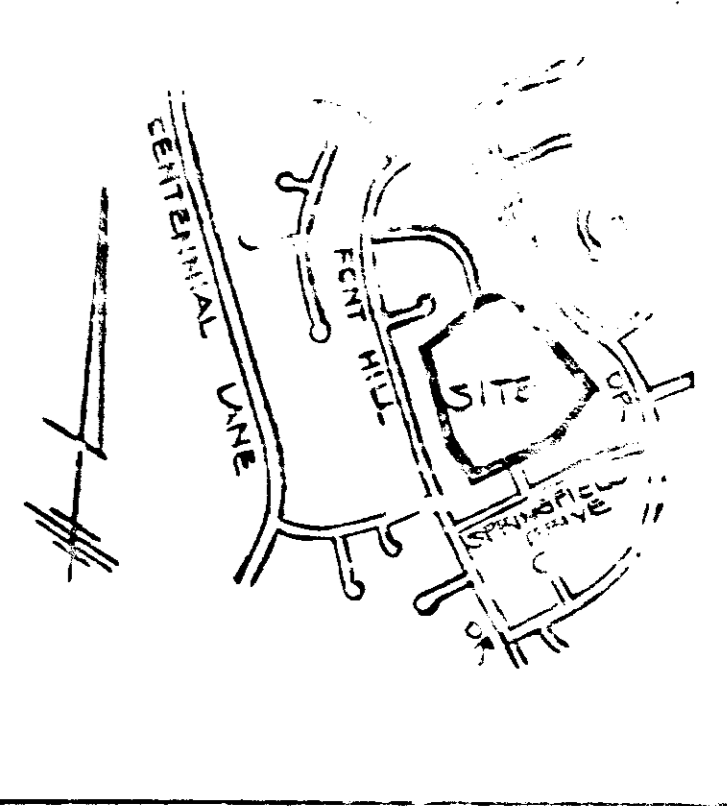

NOTE:
 THIS SITE IS TO BE UTILIZED FOR THE DISPOSAL OF EXCESS MATERIAL FROM SECTION 5, FONT HILL VILLAGE. SEE P-88-187 S.O.P. 20-212

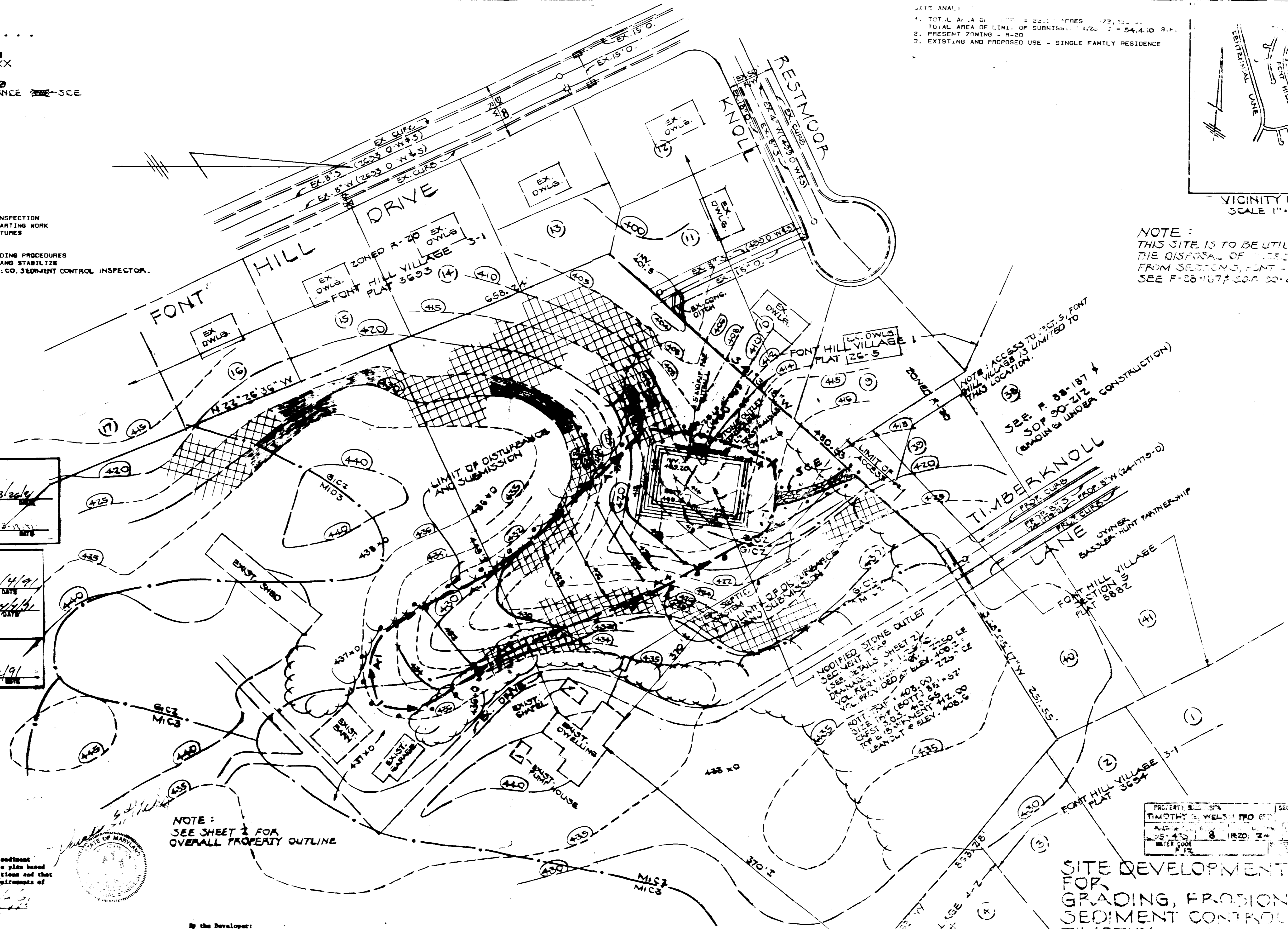

APPROVED: DEPARTMENT OF PUBLIC WORKS FOR PUBLIC STORM DRAINAGE SYSTEMS AND ROADS
 James M. [Signature] 2/26/91
 DIRECTOR, PUBLIC WORKS

APPROVED: DEPT. OF PLANNING AND ZONING
 [Signature] 4/4/91
 PLANNING DIRECTOR
 [Signature] 3/16/91
 CHIEF, DIVISION OF COMMUNITY PLANNING & LAND DEVELOPMENT

APPROVED: HOWARD COUNTY HEALTH DEPARTMENT FOR PRIVATE WATER AND SEWERAGE SYSTEMS
 [Signature] 4/2/91
 HEALTH OFFICER

Approved for HOWARD S.C.D. and State Technical Requirements
 [Signature] 3/16/91
 S.C.D. SOIL CONSERVATION SERVICE
 [Signature] 3/4/91
 STATE DEVELOPMENT PLAN IS APPROVED FOR SOIL EROSION AND SEDIMENT CONTROL AND THE HOWARD SOIL CONSERVATION DISTRICT.

By the Engineer:
 "I certify that this plan for erosion and sediment control represents a practical and workable plan based on my personal knowledge of the site conditions and that it was prepared in accordance with the requirements of the Howard Soil Conservation District."
 [Signature] 3-7-91
 Engineer

NOTE:
 SEE SHEET 2 FOR OVERALL PROPERTY OUTLINE

By the Developer:
 "I/We certify that all development and construction will be done according to this plan, and that any responsible personnel involved in the construction project will have a Certificate of Attendance at a Department of the Environment Approved Training Program for the Control of Sediment and Erosion before beginning the project. I also authorize periodic on-site inspection by the Howard Soil Conservation District."
 [Signature] 3-7-91
 Signature of Developer

OWNER / DEVELOPER
 TIMOTHY E. WELSH
 P.O. BOX 1226
 FONT HILL MANOR FARM
 ELLICOTT CITY, MD. 21043

ADDRESS CHART

LOT NO.	ADDRESS
P-725	3181 PARROTT DRIVE

PROPERTY SURVEY
 TIMOTHY E. WELSH PRO. 725
 28-43 8 1R20 34 2 6023
 WATER CODE

SITE DEVELOPMENT PLAN FOR GRADING, EROSION AND SEDIMENT CONTROL
 TIMOTHY E. WELSH PROPERTY
 TAX MAP 24 PARCELS 725
 2ND ELECTION DISTRICT
 HOWARD COUNTY, MARYLAND
 SCALE: 1"=50'
 JULY 21, 1990
 SHEET 1 OF 2

JOB NO. 0907
 SOP 91-74

CENTRAL DRAFTING AND DESIGN, INC.
 601 CHARWOOD COURT
 EDGEWOOD, MD. 21040
 679-8719

