

**PLAN NOTES**

- SEQUENCE OF CONSTRUCTION**
- OBTAIN THE GRADING PERMIT.
  - INSTALL SEDIMENT AND EROSION CONTROL DEVICES.
  - BEGIN CLEARING AND GRUBBING.
  - CONSTRUCT PAVING AND STORM WATER MANAGEMENT POND AND REMOVE SEDIMENT AND EROSION CONTROL DEVICES ONLY AFTER PERMISSION FROM THE HOWARD COUNTY SEDIMENT AND EROSION CONTROL INSPECTOR.

**SITE DEVELOPMENT AREA TABULATION**

1. TOTAL AREA OF SITE	9.00 ACRES
2. AREA DISTURBED	19,770 S.F.
3. AREA TO VEGETATIVELY STABILIZED	19,410 S.F.
4. AREA TO BE PAVED	10,360 S.F.
5. TOTAL "CUT" VOLUME	1550 CU YDS.
6. TOTAL "FILL" VOLUME	2550 CU YDS.

**PARKING TABULATION**

1. PARKING REQUIRED (METHOD "A" - FEW SEATS): 1 SPACE PER 3 SEATS (OR) 18 X 30	22 SPACES
2. PARKING REQUIRED (METHOD "B" - NET AREA): 1 SPACE PER 100 S.F. (OR) 3,700 X .01	37 SPACES
3. TOTAL PARKING REQUIRED	59 SPACES
4. TOTAL (EXISTING AND NEW) PARKING PROVIDED	59 SPACES
5. HANDICAPPED SPACES PROVIDED	2 SPACES

**OPEN SPACE TABULATION**

1. AREA OF PAVING	0.568 ACRES (OR)
2. PERCENT OF PAVING	7 (%) PERCENT (OR)
3. AREA OF BUILDINGS	1 (1%) PERCENT (OR)
4. PERCENT OF BUILDINGS	1 (%) PERCENT (OR)
5. AREA OF GREEN SPACE	8.320 ACRES
6. PERCENT OF GREEN SPACE	92 (%) PERCENT.

**STORM WATER MANAGEMENT CALCULATIONS**

1. DRAINAGE AREA	19,770 SF (OR)
2. "DESIGN" STORM	0.45 ACRES
3. INFLOW	3 CFS
4. ALLOWABLE DISCHARGE	1 CFS
5. VOLUME REQUIRED	2,472 CU FT.
6. VOLUME PROVIDED	2,800 CU FT.
7. 100 YEAR WATER SURFACE ELEVATION	353.2 FT.
8. TOP OF BEAM ELEVATION	354.2 FT.
9. "FREE BOARD" DISTANCE	1 FT.

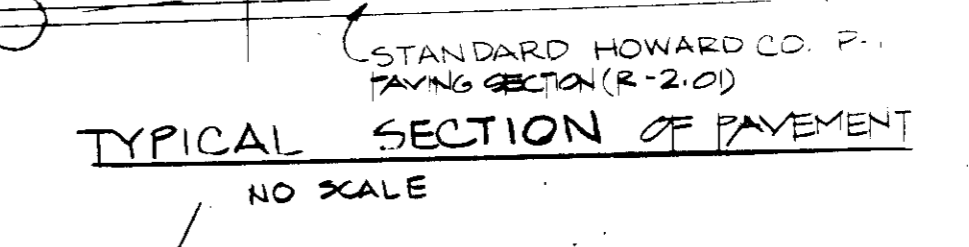
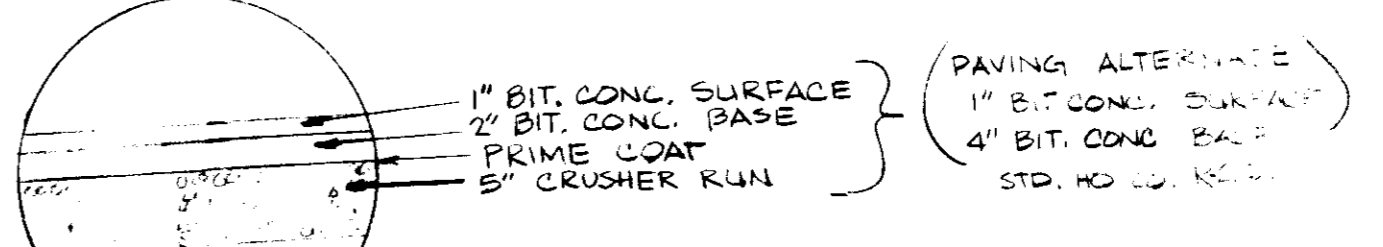
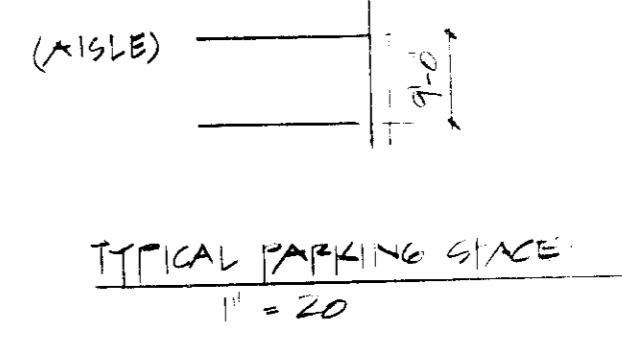

**NEIGHBORHOOD MAP**

**GENERAL NOTES**

- THE CONTRACTOR SHALL NOT REMOVE OR DISTURB ANY EXISTING TREES OVER TWELVE (12) INCHES IN DIAMETER, AND SHALL PROVIDE "SNOW FENCE" PROTECTION AROUND THE TREE'S "DRIP RING" DURING CONSTRUCTION.
- THE STORM WATER MANAGEMENT FACILITY IS INTENDED TO BE TEMPORARY. FOR REPLACEMENT AT SUCH TIME THAT THE FUTURE CHURCH MULTI-PURPOSE BUILDING IS CONSTRUCTED.
- THE SCOPE OF WORK AS PREVIOUSLY APPROVED PORTION OF WHICH IS HEREBY SUBMITTED, AS FOLLOWS:  
(BAF 89-034E) REQUESTED FOR AN EXPANSION OF THE EXISTING RELIGIOUS FACILITY TO INCLUDE TWO (2) TEMPORARY MODULAR CLASSROOMS AND AN EXPANDED PARKING LOT. THE REQUEST WAS GRANTED SUBJECT TO THE FOLLOWING FIVE (5) CONDITIONS: (1) COMPLIANCE WITH ALL LOCAL STATE AND FEDERAL LAWS; (2) THE PRESERVATION OF AS MANY MATURE EXISTING TREES AS IS POSSIBLE; (3) A PROVISION FOR AN EVERGREEN LANDSCAPE BUFFER ADJACENT TO THE RESIDENTIAL ADJUTING PROPERTY LINE; (4) CONNECTION OF ANY BATHROOMS TO THE PUBLIC WATER AND SEWER; AND (5) THE REMOVAL WITHIN TWO (2) YEARS OF THE MODULAR CLASSROOMS.  
(WPA 90-127) REQUESTED AND WAS GRANTED A WAIVER OF THE REQUIREMENT FOR A SITE DEVELOPMENT PLAN FOR THE MODULAR CLASSROOMS.
- CARE SHALL BE TAKEN TO PRESERVE ALL EXISTING MATURE TREES OVER TWELVE (12) INCHES IN DIAMETER, BY FENCING AROUND THE TREE'S "DRIP RING" PRIOR TO, AND DURING, CONSTRUCTION.
- ZONING: "R-12"
- USE: RELIGIOUS FACILITY

"I/We certify that all development and construction will be done according to this plan, and that any responsible personnel involved in the construction project will have a Certificate of Attendance at a Department of the Environment Approved Training Program for the Control of Sediment and Erosion before beginning the project. I also authorize periodic on-site inspection by the Howard Soil Conservation District."

*T.F. Mackin* 9/18/90  
Signature of Developer  
Date  
Print name: T.F. MACKIN

"I certify that this plan for erosion and sediment control represents a practical and workable plan based on my personal knowledge of the site conditions and that it was prepared in accordance with the requirements of the Howard Soil Conservation District."

*John R. Heinrichs* 9/12/90  
Signature of Engineer  
Date  
Print name: John R. Heinrichs

*James R. Shields* 9/18/90  
Checked for HOWARD S.C.D. and  
Special Requirements  
Signature of District Director  
Date  
Print name: James R. Shields

*John R. Shields* 9/17/90  
Signature of District Director  
Date  
Print name: John R. Shields

APPROVED: For public water and public sewerage systems.  
HOWARD COUNTY HEALTH DEPARTMENT.  
*Joan M. Bogdus* 12-24-90  
County Health Officer

APPROVED: HOWARD COUNTY DEPT. OF PLANNING & ZONING  
*Richard Blood* 12/27/90  
Chief, Division of Community Planning & Land Development

APPROVED: For public water public sewerage, storm drainage systems, and public roads.  
HOWARD COUNTY DEPT. OF PUBLIC WORKS  
*James R. Shields* 12/10/90  
Director

*William S. Schaefer* 9-28-90  
Chief, Bureau of Engineering

**PARKING LOT SITE DEVELOPMENT PLAN**  
FOR  
CHRIST EPISCOPAL CHURCH  
6TH ELECTION DISTRICT - HOWARD CO. MD

SCALE: 1"=50'

NO.	DATE	REVISION	1 OF 2
1	8-31-90	CHANGES AS PER COUNTY COMMENTS	
		SUP 91-00	

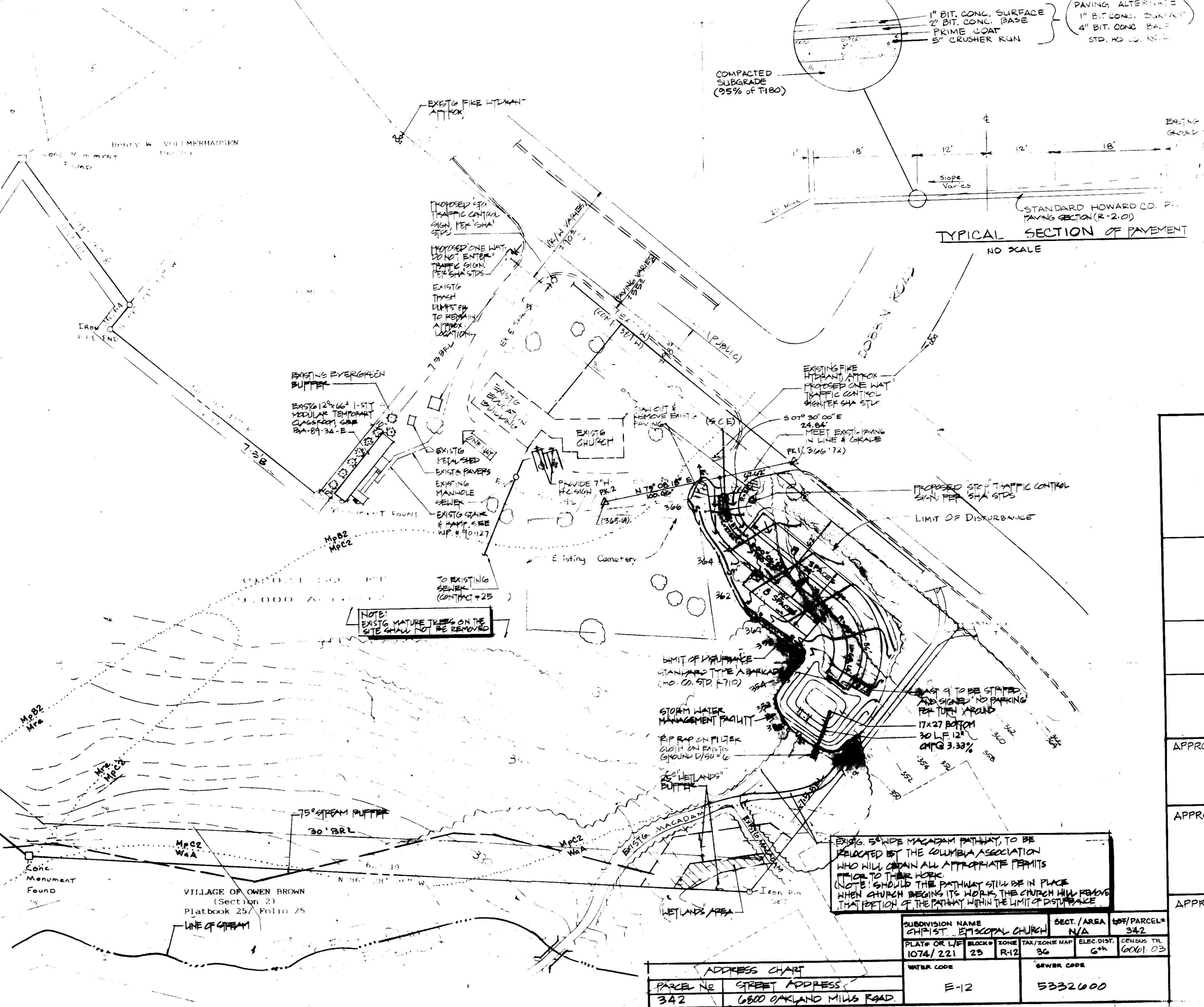
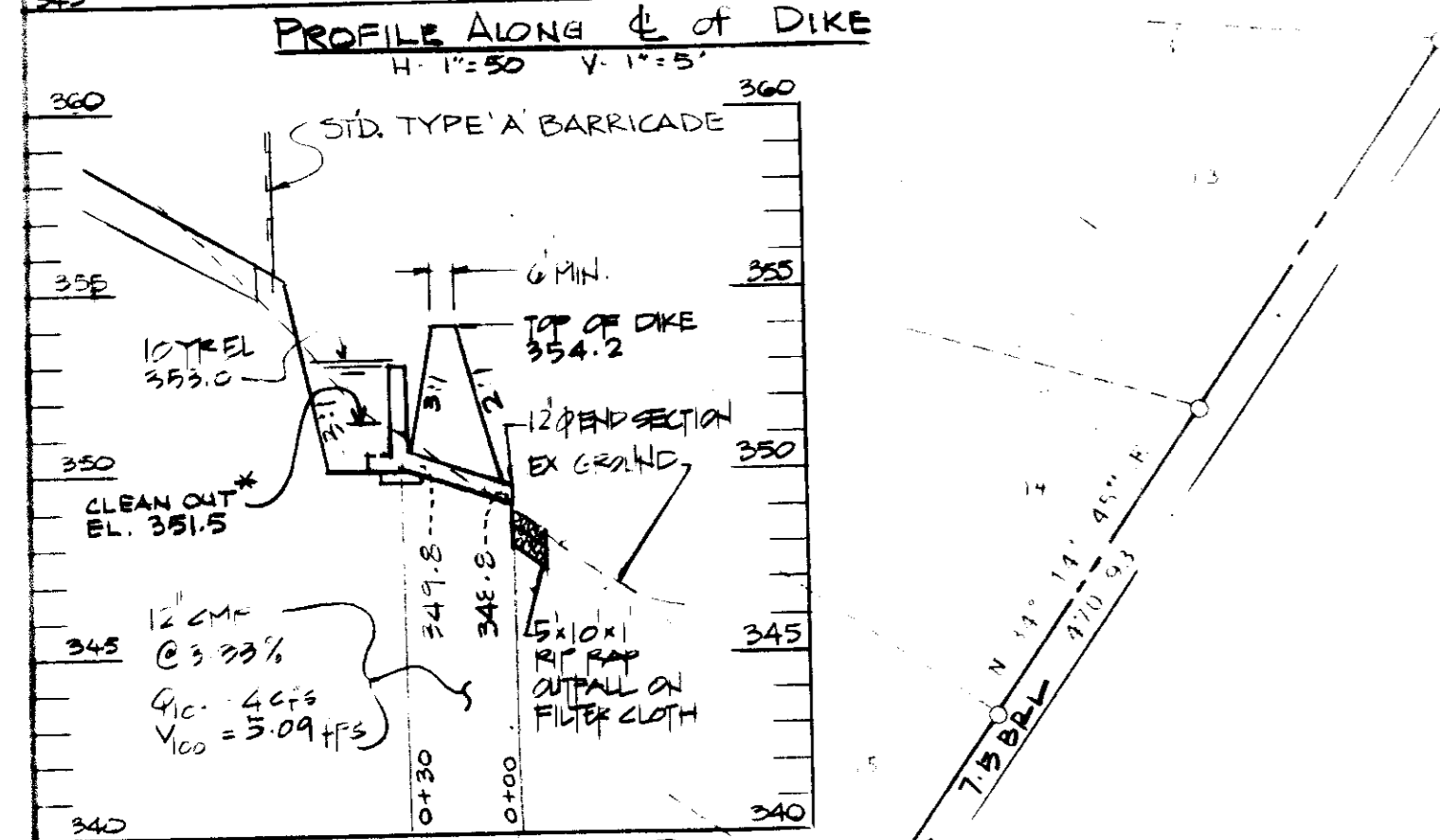
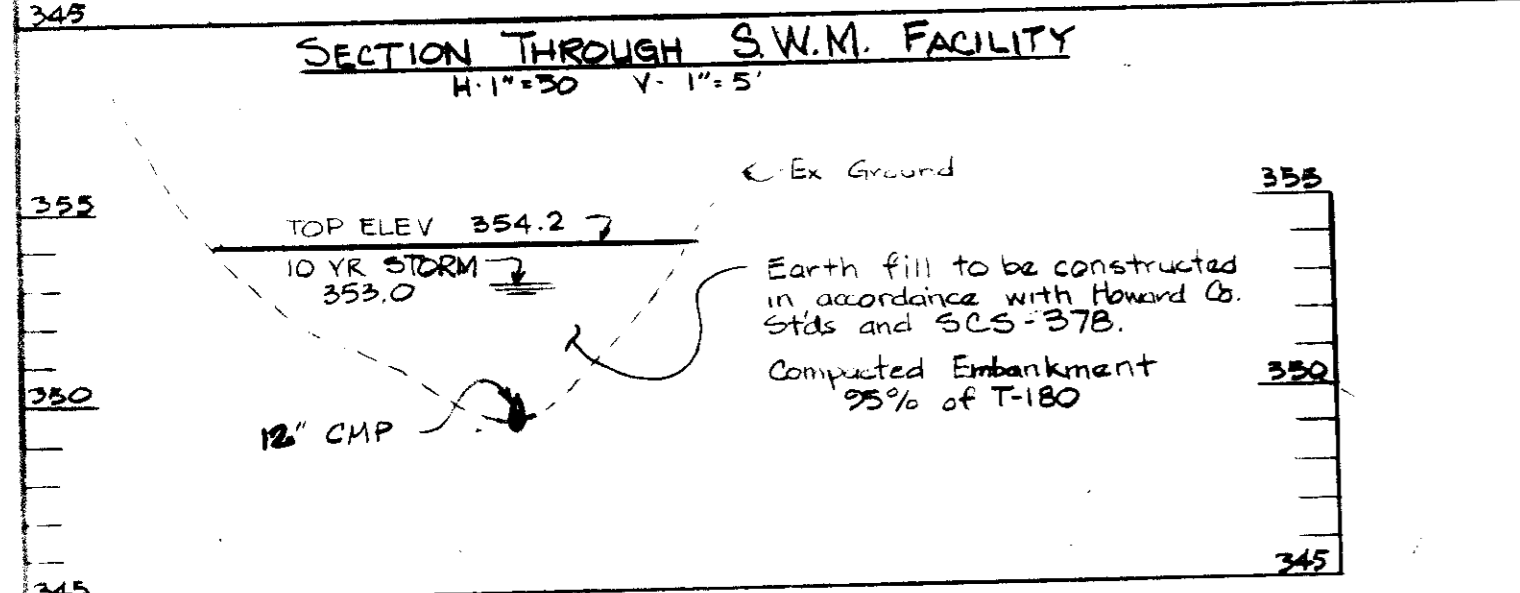
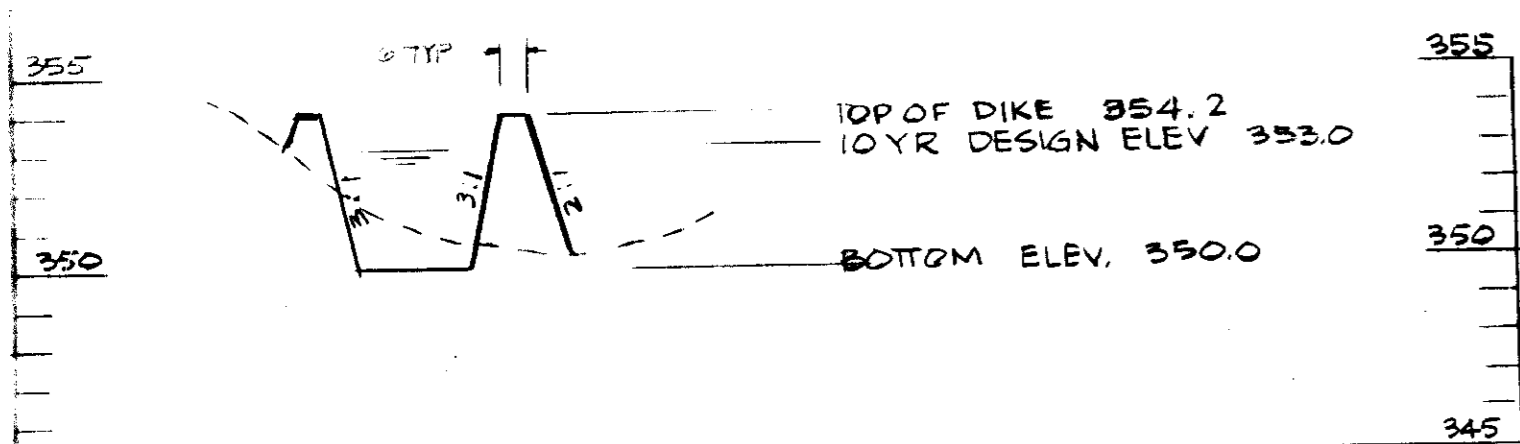

THE HOWARD RESEARCH & DEVELOPMENT CORP.  
467196

**C.B. MILLER ASSOCIATES, INC.**  
REGISTERED LAND SURVEYORS  
11054 TARRAGON ROAD  
REISTERSTOWN, MD 21116  
(301) 833-5905

**ADDRESS CHART**

PARCEL NO.	STREET ADDRESS
342	6800 OAKLAND MILLS ROAD

**OWNER:** EPISCOPAL DIOCESE OF MARYLAND  
105 W. MONUMENT STREET  
BALTIMORE, MARYLAND 21201 727-3738

**APPLICANT:** JAMES SHIELDS RECTOR; CHRIST EPISCOPAL CHURCH  
6800 OAKLAND MILLS ROAD  
COLUMBIA, MD 21045 381-9365

**COUNCIL:** CHRIS CHRISTENSEN  
6482 BARCHINK PLACE  
COLUMBIA, MD. 21045 381-0881

SUBDIVISION NAME	CHURCH	SECT./AREA	109/PARCEL#
PLAT OR LIE	1074/221	N/A	342
BLOCK	23	R-12	36
TAX/ZONE MAP	6th	6061	03

WATER CODE	E-12	SEWER CODE	5332000
------------	------	------------	---------

**SEDIMENT CONTROL NOTES**

- 1) A minimum of 24 hours notice must be given to the Howard County Office of Inspection and Permits prior to the start of any construction. (992-2437)
- 2) All vegetative and structural practices are to be installed according to the provisions of this plan and are to be in conformance with the 1983 MARYLAND STANDARDS AND SPECIFICATIONS FOR SOIL EROSION AND SEDIMENT CONTROL.
- 3) Following initial soil disturbance or redistribution, permanent or temporary stabilization shall be completed within: a) 7 calendar days for all perimeter sediment control structures, dikes, perimeter slopes and all slopes greater than 3:1, b) 14 days as to all other disturbed or graded areas on the project site.
- 4) All sediment traps/basins shown must be fenced and warning signs posted around their perimeter in accordance with Vol. 1, Chapter 12, of the HOWARD COUNTY DESIGN MANUAL, Storm Drainage.
- 5) All disturbed areas must be stabilized within the time period specified above in accordance with the 1983 MARYLAND STANDARDS AND SPECIFICATIONS FOR SOIL EROSION AND SEDIMENT CONTROL for permanent seedings (Sec. 51) sod (Sec. 54), temporary seeding (Sec. 50) and mulching (Sec. 52.) Temporary stabilization with mulch alone can only be done when recommended seeding dates do not allow for proper germination and establishment of grasses.
- 6) All sediment control structures are to remain in place and are to be maintained in operative condition until permission for their removal has been obtained from the Howard County Sediment Control Inspector.
- 7) Site Analysis:
 

Total Area of Site	2.0 Acres
Area Disturbed	0.45 Acres
Area to be roofed or paved	0.24 Acres
Area to be vegetatively stabilized	0.21 Acres
Total Cut	500 Cu. yds
Total Fill	500 Cu. yds
Offsite waste/borrow area location	N/A
- 8) Any sediment control practice which is disturbed by grading activity for placement of utilities must be repaired on the same day of disturbance.
- 9) Additional sediment controls must be provided, if deemed necessary by the Howard County DWM sediment control inspector.
- 10) On all sites with disturbed areas in excess of 2-acres, approval of the inspection agency shall be requested upon completion of installation of perimeter erosion and sediment controls, but before proceeding with any other earth disturbance or grading. Other building or grading inspection approvals may not be authorized until this initial approval by the inspection agency is made.

**PERMANENT SEEDING NOTES**

Apply to graded or cleared areas not subject to immediate further disturbance where a permanent long-lived vegetative cover is needed.

**Seeded Preparation:** Loosen upper three inches of soil by raking, disking or other acceptable means before seeding, if not previously loosened.  
**Soil Amendments:** In lieu of soil test recommendations, use one of the following schedules:

- 1) Preferred -- Apply 2 tons per acres dolomitic limestone (92 lbs/1000 square ft) and 600 lbs per acre 10-10-10 fertilizer (14 lbs/1000 sq ft) before seeding. Harrow or disk into upper three inches of soil. At time of seeding, apply 400 lbs per acre 30-0-0 ureaform fertilizer (9 lbs/1000 sq. ft.)
- 2) Acceptable -- Apply 2 tons per acre dolomitic limestone (92 lbs/1000 sq ft) and 1000 lbs per acre 10-10-10 fertilizer (23 lbs/1000 sq. ft) before seeding. Harrow or disk into upper three inches of soil.

**Seeding** -- For the periods March 1 thru April 30, and August 1 thru October 15, seed with 60 lbs per acre (1.4 lbs/1000 sq ft) of Kentucky 31 Tall Fescue. For the period May 1 thru July 31, seed with 60 lbs Kentucky 31 Tall Fescue per acre and 2 lbs per acre (.05 lbs/1000 sq ft) of weeping lovegrass. During the period of October 16 thru February 28, protect site by: Option (1) 2 tons per acre of well anchored straw mulch and seed as soon as possible in the spring. Option (2) Use sod. Option (3) Seed with 60 lbs/acre Kentucky 31 Tall Fescue and mulch with 2 tons/acre well anchored straw.

**Mulching** -- Apply 1-1/2 to 2 tons per acre (70 to 90 lbs/1000 sq ft) of unrotted small grain straw immediately after seeding. Anchor mulch immediately after application using mulch anchoring tool or 218 gallons per acre (5 gal/1000 sq ft) of emulsified asphalt on flat areas. On slopes 8 ft or higher, use 348 gallons per acre (8 gal/1000 sq ft) for anchoring.

**Maintenance** -- Inspect all seeded areas and make needed repairs, replacements and reseedings.

**TEMPORARY SEEDING NOTES**

Apply to graded or cleared areas likely to be redisturbed where a short-term vegetative cover is needed.

**Seeded preparation:** Loosen upper three inches of soil by raking, disking or other acceptable means before seeding, if not previously loosened.

**Soil Amendments:** -- Apply 60 lbs per acre 10-10-10 fertilizer (14 lbs/1000 sq ft).

**Seeding:** -- For periods March 1 thru April 30 and from August 15 thru October 15, seed with 2-1/2 bushel per acre of annual rye (3.2 lbs/1000 sq ft). For the period May 1 thru August 14, seed with 3 lbs per acre of weeping lovegrass (.07 lbs/1000 sq ft). For the period November 16 thru February 28, protect site by applying 2 tons per acre of well anchored straw mulch and seed as soon as possible in the spring, or use sod.

**Mulching:** -- Apply 1-1/2 to 2 tons per acre (70 to 90 lbs/1000 sq ft) of unrotted small grain straw immediately after seeding. Anchor mulch immediately after application using mulch anchoring tool or 218 gal per acre (5 gal/1000 sq ft) of emulsified asphalt on flat areas. On slopes 8 ft or higher, use 348 gal per acre (8 gal/1000 sq ft) for anchoring.

Refer to the 1983 MARYLAND STANDARDS AND SPECIFICATIONS FOR SOIL EROSION AND SEDIMENT CONTROL for rate and methods not covered.

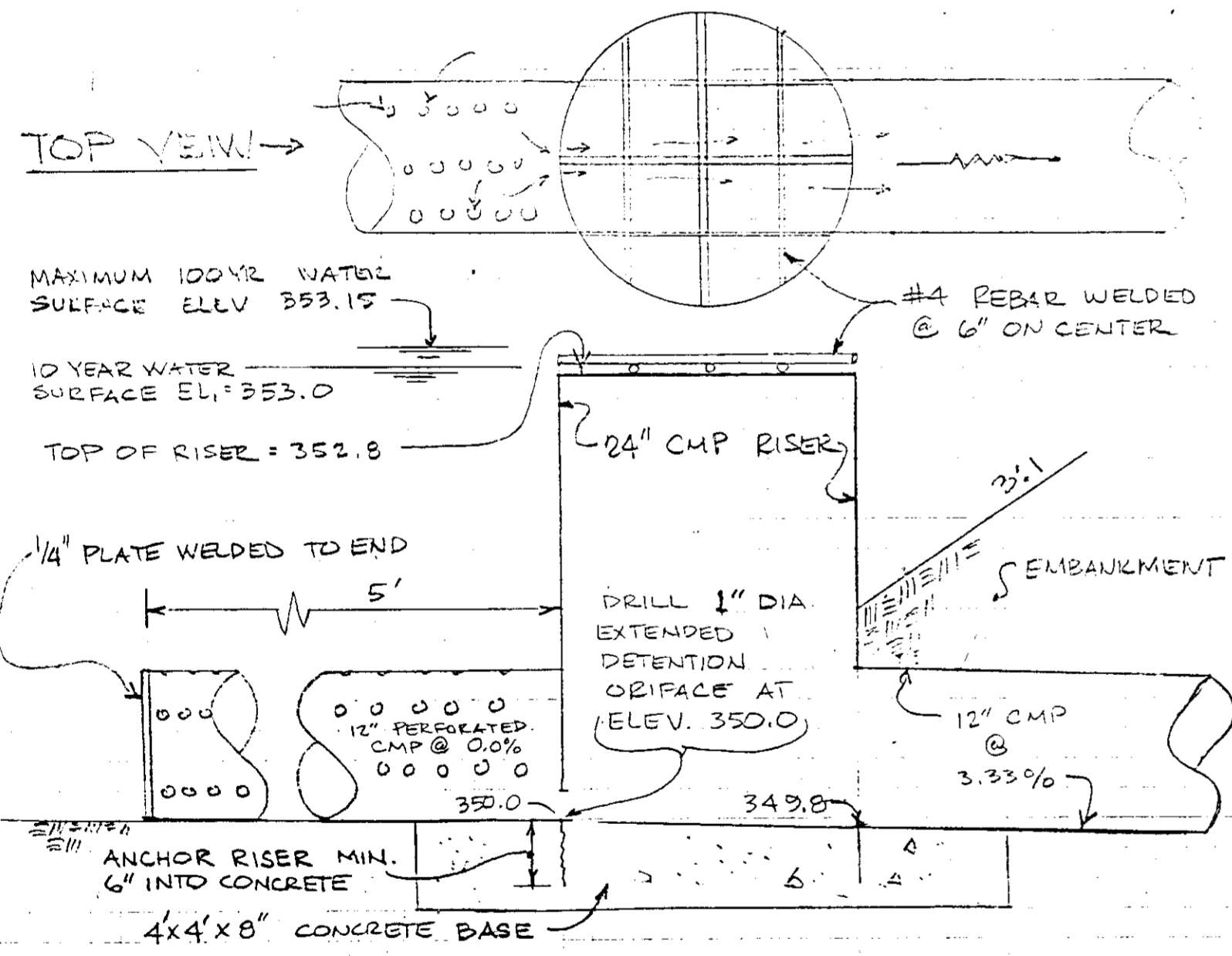
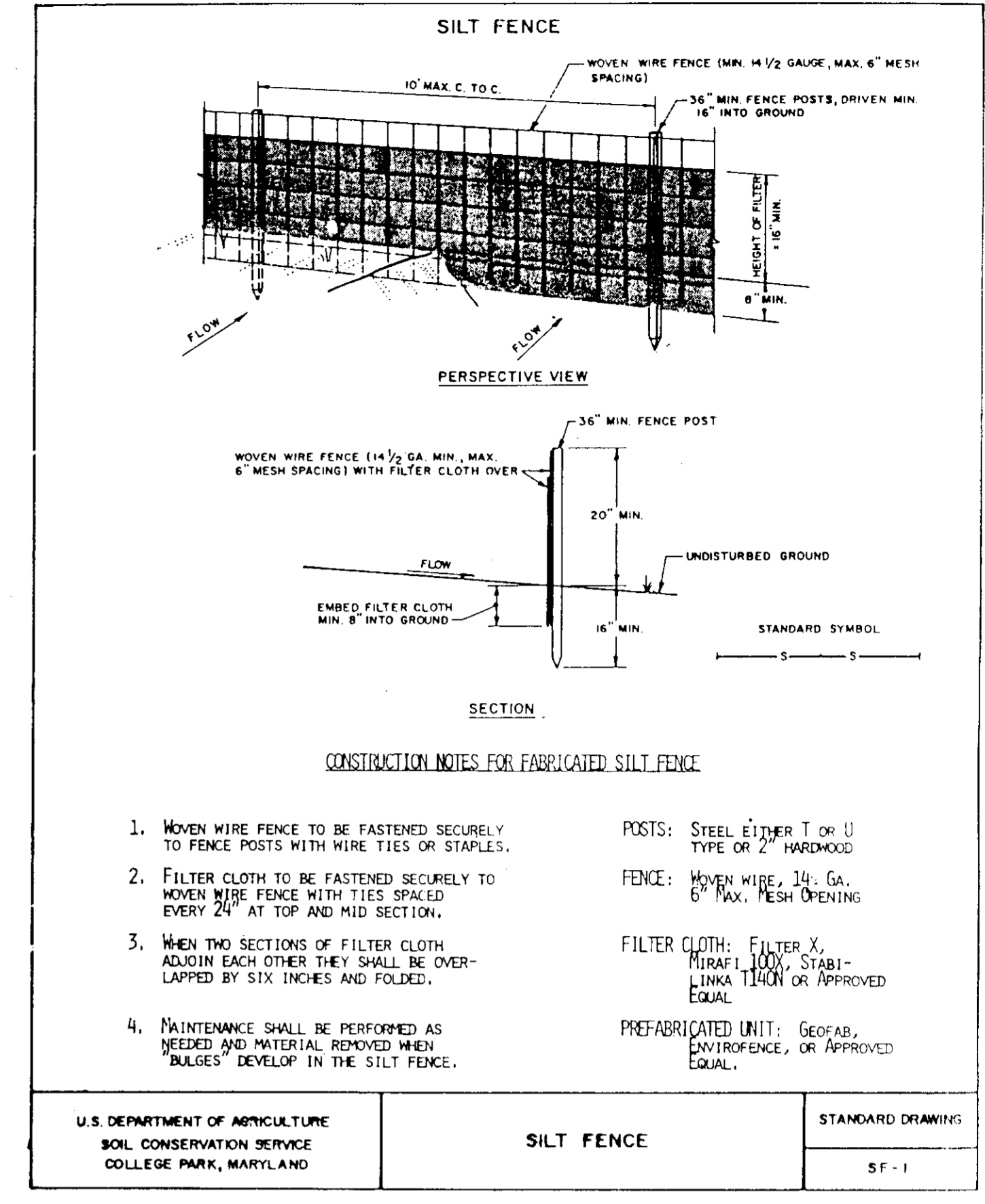
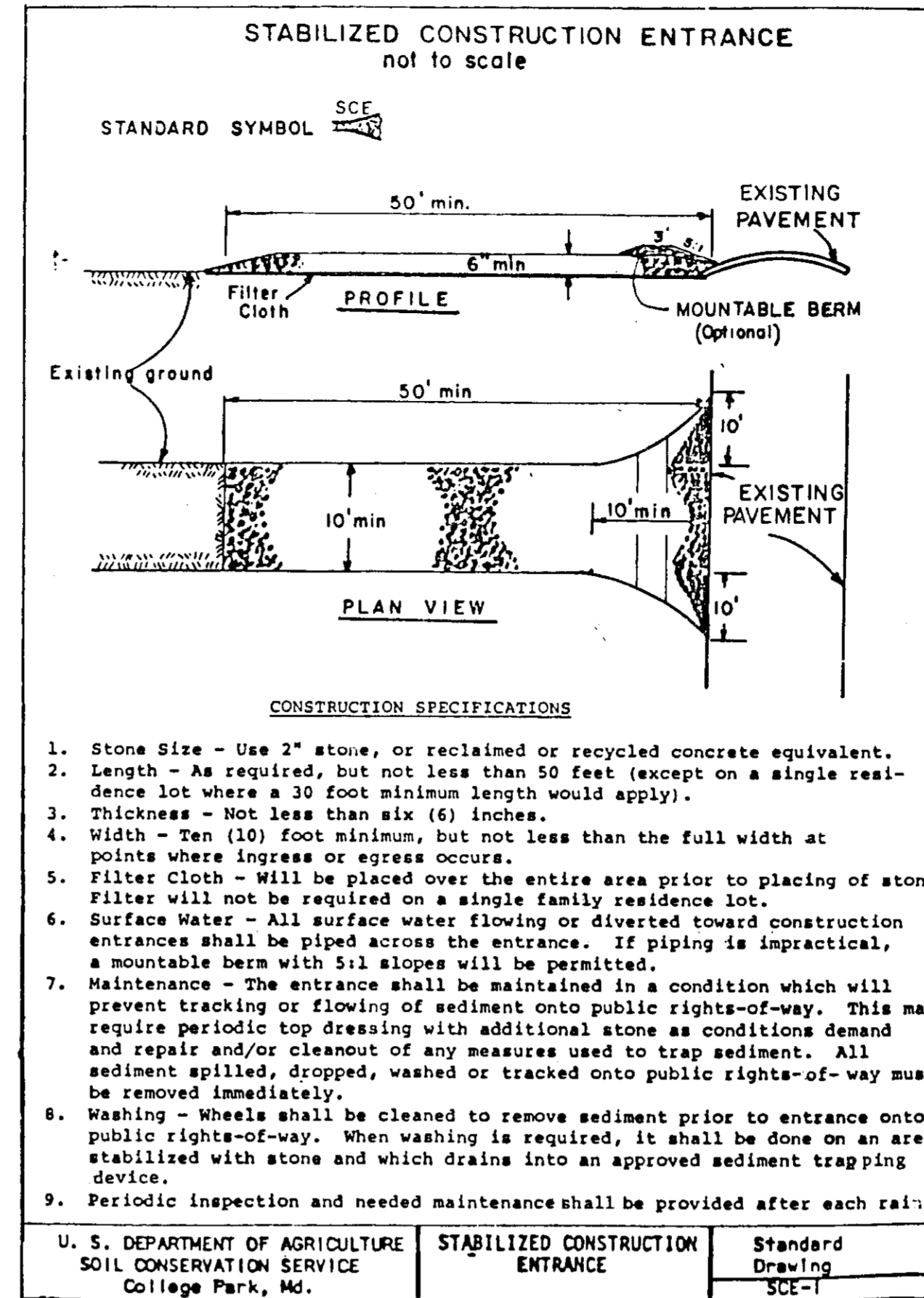

**DETAIL OF RISER STRUCTURE**  
NO SCALE

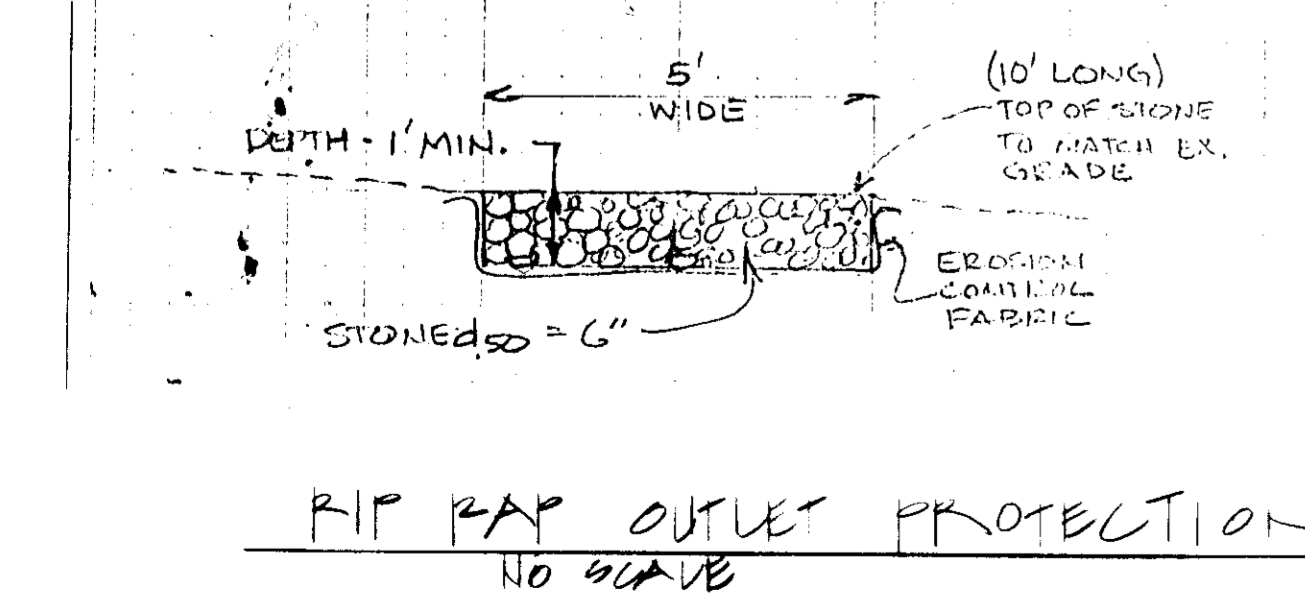

<p>C. B. MILLER ASSOCIATES, INC. REGISTERED LAND SURVEYORS 13054 TARRAGON ROAD REISTERSTOWN, MD 21136 (301) 833-5905</p>	<p>9-12-90</p> <p>John J. Smith</p>	<p>OWNER: EPISCOPAL DIOCESE OF MARYLAND 105 W. MONUMENT STREET BALTIMORE, MARYLAND 21201 727-3738</p>	<p>PARKING LOT <b>SITE DEVELOPMENT PLAN</b> FOR CHRIST EPISCOPAL CHURCH 6TH ELECTION DISTRICT, HOWARD CO MD DATE: JUNE 1990</p>						
		<p>APPLICANT: JAMES SHIELDS, RECTOR; CHRIST EPISCOPAL CHURCH 6800 OAKLAND MILLS ROAD COLUMBIA, MD 21045 981-9365</p> <p>COUNCIL: CHRIS CHRISTENSEN 6482 BARCHINK PLACE COLUMBIA, MD. 21045 981-0881</p>							
<p>APPROVED: For public water and public sewerage systems. HOWARD COUNTY HEALTH DEPARTMENT. James Boydles 12-24-90 County Health Officer</p>		<p>APPROVED: HOWARD COUNTY DEPT. OF PLANNING &amp; ZONING Director 12/31/90 Richard Blood 12/27/90 S&amp;A Chief, Division of Community Planning &amp; Land Development</p>							
<p>APPROVED: For public water public sewerage, storm drainage systems, and public roads. HOWARD COUNTY DEPT. OF PUBLIC WORKS Director 12/18/90 CD Chief, Bureau of Engineering 9-28-90</p>		<table border="1"> <thead> <tr> <th>NO</th> <th>DATE</th> <th>REVISIONS</th> </tr> </thead> <tbody> <tr> <td>1</td> <td>8-21-90</td> <td>CHANGES AS PER COUNTY REQUEST</td> </tr> </tbody> </table> <p>SDP 91-01</p>		NO	DATE	REVISIONS	1	8-21-90	CHANGES AS PER COUNTY REQUEST
NO	DATE	REVISIONS							
1	8-21-90	CHANGES AS PER COUNTY REQUEST							