

ELLCOTT CENTER, SEC. 2

- GENERAL NOTES
1. THE CONTRACTOR SHALL NOTIFY "MISS UTILITY" AT TELEPHONE NO. 301-599-0100 AT LEAST 72 HOURS PRIOR TO STARTING EXCAVATION TO VERIFY ALL LOCATIONS OF EXISTING UTILITIES.
 2. ALL CONSTRUCTION SHALL BE DONE IN ACCORDANCE WITH HOWARD COUNTY DESIGN MANUAL, VOLUME IV - STANDARD SPECIFICATIONS AND DETAILS.
 3. THE INFORMATION SHOWN ON THESE PLANS IS FOR THE CONVENIENCE OF THOSE CONCERNED ONLY. THE CORRECTNESS OR COMPLETENESS OF THE INFORMATION SHOWN IS NOT WARRANTED OR GUARANTEED. THE CONTRACTOR SHALL VERIFY ALL INFORMATION TO HIS OWN SATISFACTION.
 4. THE CONTRACTOR OR DEVELOPER SHALL CONTACT THE CONSTRUCTION INSPECTION DIVISION, 24 HOURS IN ADVANCE OF COMMENCEMENT OF WORK AT 301-792-7272.
 5. THE CONTRACTOR SHALL BE RESPONSIBLE FOR ANY DAMAGES TO THE COUNTY RIGHT-OF-WAY.
 6. ALL DISTURBED AREAS NOT STABILIZED WITH PAVING SHALL BE SEEDED AND MULCHED.
 7. THE PROPOSED IMPROVEMENT IS LESS THAN 5,000 SQUARE FEET NO STORMWATER MANAGEMENT OR SEDIMENT CONTROL IS REQUIRED.
 8. FOR TRUCK AND LOADING AREA RESTRICTION, SEE BA CASE 793-C. FOR TRASH COLLECTION DEVICE LOCATION, SEE BA CASE 819-C.
 9. ORIGINAL SITE PLAN SITE ANALYSIS APPROVED UNDER SOP-75-80

1. AREA OF SITE = 9.2087 ACRES = 401,131 S.F.
 2. EXISTING BUILDING HEIGHT = 24' - 8"
 3. CURRENT USE = WAREHOUSE AND MANUFACTURING
 4. AREA OF LIMIT OF SUBMISSION = 480 S.F.
 5. USE OF PROPOSED IMPROVEMENT = SILOS
 6. ZONING = M-1
 7. OWNER = C.R. DANIELS
 3451 ELLCOTT CENTER DRIVE
 ELLCOTT CITY, MD. 21043

	AREA (S.F.)	PERCENT COVERAGE
A. SITE	401,131	
B. BUILDING		
EXISTING	137,178	34.24
PROPOSED	137,178	34.24
C. PARKING LOT		
EXISTING	77,226	19.254
PROPOSED	76,746	19.134
D. BUILDING AND PARKING LOT		
EXISTING	214,404	53.444
PROPOSED	213,924	53.408
E. LANDSCAPED ISLANDS		
EXISTING	47,600	11.865
PROPOSED	47,600	11.865
F. OPEN SPACE INCL. LANDSCAPED ISLANDS		
EXISTING	186,627	46.554
PROPOSED	186,627	46.554

PARKING DATA
 EXISTING PARKING SPACES = 166 SPACES
 NO. REQUIRED FOR THIS IMPROVEMENT = 0
 TOTAL PARKING SPACES = 166 SPACES

P. 121
 INVESTORS
 LIMITED PARTNERSHIP
 F 675 / 242
 F 781 L 491
 POR

- LEGEND :
- ▲ - Existing light pole
 - ☁ - Existing tree line
 - ⊕ - Existing tree
 - - Existing paving
 - ==== - Existing curb
 - - Existing grade

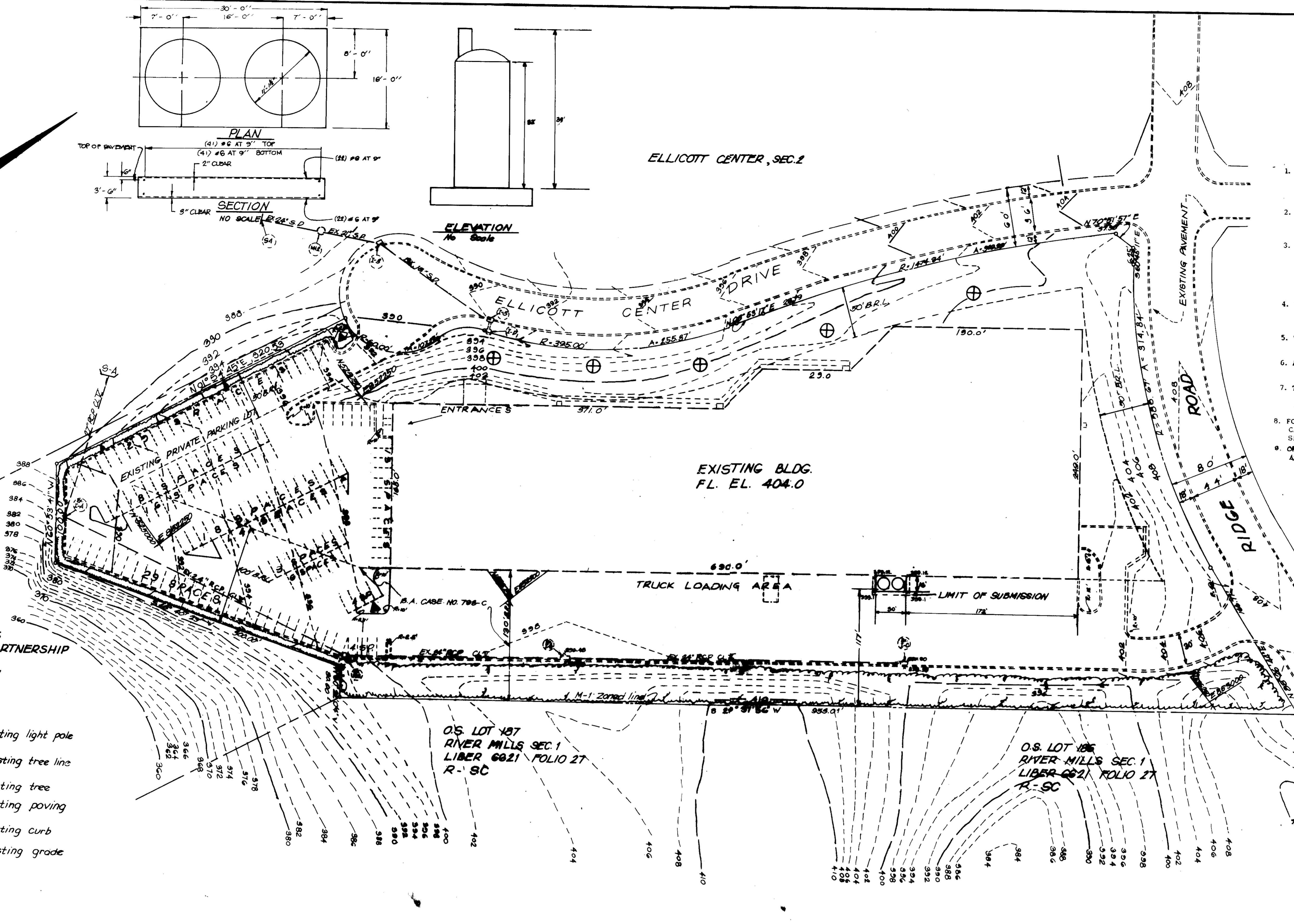

ADDRESS CHART	
PARCEL NO.	STREET ADDRESS
A	3451 ELLCOTT CENTER DRIVE ELLCOTT CITY, MD. 21043

SUBDIVISION NAME:		SECT./AREA	PARCEL
ELLCOTT CENTER		3	A
PLAT #	BLOCK #	ZONE	TAX / ZONE MAP
L 725 F 43	6	M-1	24
ELEC. DIST.		CENSUS TR.	
2			
WATER CODE:		SEWER CODE:	
F04		1403500	

APPROVED FOR PUBLIC WATER AND PUBLIC SEWERAGE SYSTEMS
 HOWARD COUNTY HEALTH DEPARTMENT
 [Signature] 7/2/90
 COUNTY HEALTH OFFICER
 APPROVED FOR HOWARD COUNTY DEPARTMENT OF PLANNING & ZONING
 [Signature] 7/2/90
 PLANNING DIRECTOR
 APPROVED FOR PUBLIC WATER AND PUBLIC SEWERAGE,
 STORM DRAINAGE SYSTEMS AND PUBLIC ROADS
 HOWARD COUNTY DEPARTMENT OF PUBLIC WORKS
 [Signature] 7/2/90
 DIRECTOR

Coria engineering inc.
 Consulting Engineers • Land Planners • Surveyors
 3228 Bethony Lane, Suite 4, Ellicott City, Maryland
 301-465-0400

These plans have been reviewed by the Soil Conservation District and approved for sediment control.
 U. S. Soil Conservation District
 These plans have been reviewed by the Soil Conservation District and approved for sediment control.
 U. S. Soil Conservation District

DESIGNED: M.L.
 DRAWN: B.R.P.
 CHECKED: M.L.
 DATE: 9/28/90

SITE DEVELOPMENT PLAN
C.R. DANIELS
ELLCOTT CENTER, SEC. 3
PARCEL A
PROPOSED SILOS

SCALE: 1" = 50'
 SHEET NO. 1 OF 1
 JOB NO.
 OWNER: C. R. DANIELS
 3451 ELLCOTT CENTER DRIVE
 ELLCOTT CITY, MD. 21043