

GENERAL NOTES

1. Subject property zoned N.T.S.F.L.D. per B 2 85 Comprehensive Zoning Plan.
2. The coordinates shown hereon are based on The Maryland State Grid System and derived from the following Howard County Control Stations 2439001 and 244001.
3. All roadways are public and existing.
4. Total area included in this submission: 1.67 Ac.
5. Total number of lots: 5.
6. Any damage to county owned right-of-ways shall be corrected at the Developer's expense.
7. Maximum lot coverage is 30%.
8. Reference plans S-88-115, P 89-76 and F 90-07, P.B. Case 243, W.P. 89-71.
9. The Contractor or Developer shall contact the Construction/Inspection Division, 24 hours in advance of commencement of work at 792-2630.
10. The existing topography shown was taken from plans (F-90-07) prepared by Whitman, Requardt and Associates.
11. Stormwater Management provided under F-90-97.
12. This subdivision is subject to Section 18.122B of the Howard County Code.
13. Minimum building setback restrictions from property lines and the right-of-way of any public road or street to be in accordance with FDP Phase 205, 3054.A, 1091-1096.
14. 10' Tree maintenance easement along all road frontages.
15. Reference FDP Phase 205, 3054.A, 1091-1096.
16. The fireplace chimneys located within the required 7.5-foot side yard BRL on lots 34 and 36 shall be in accordance with FDP, Phase 205, Part I.

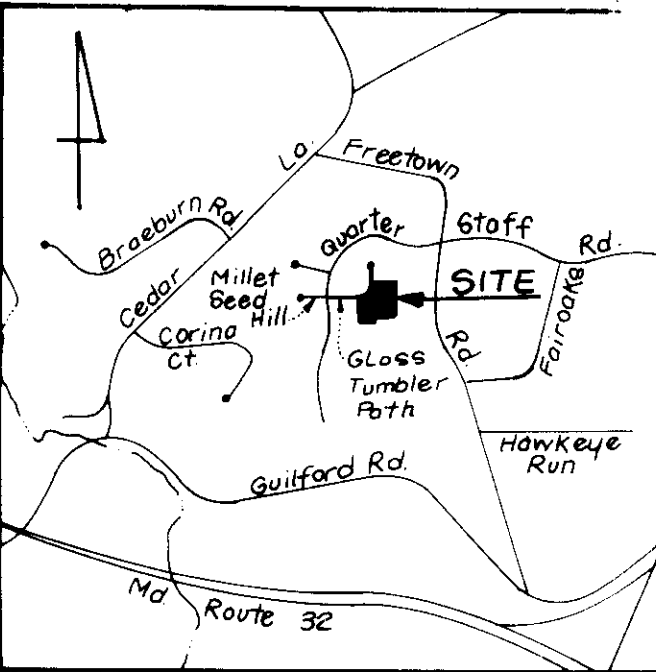

VICINITY MAP
Scale 1" = 2000'

LEGEND

- Contour Interval: 2 FT.
- Existing Contour: ---
- Proposed Contour: - - -
- Spot Elevation: +10.2
- Direction of Drainage: →
- Walk out Basement: [Symbol]

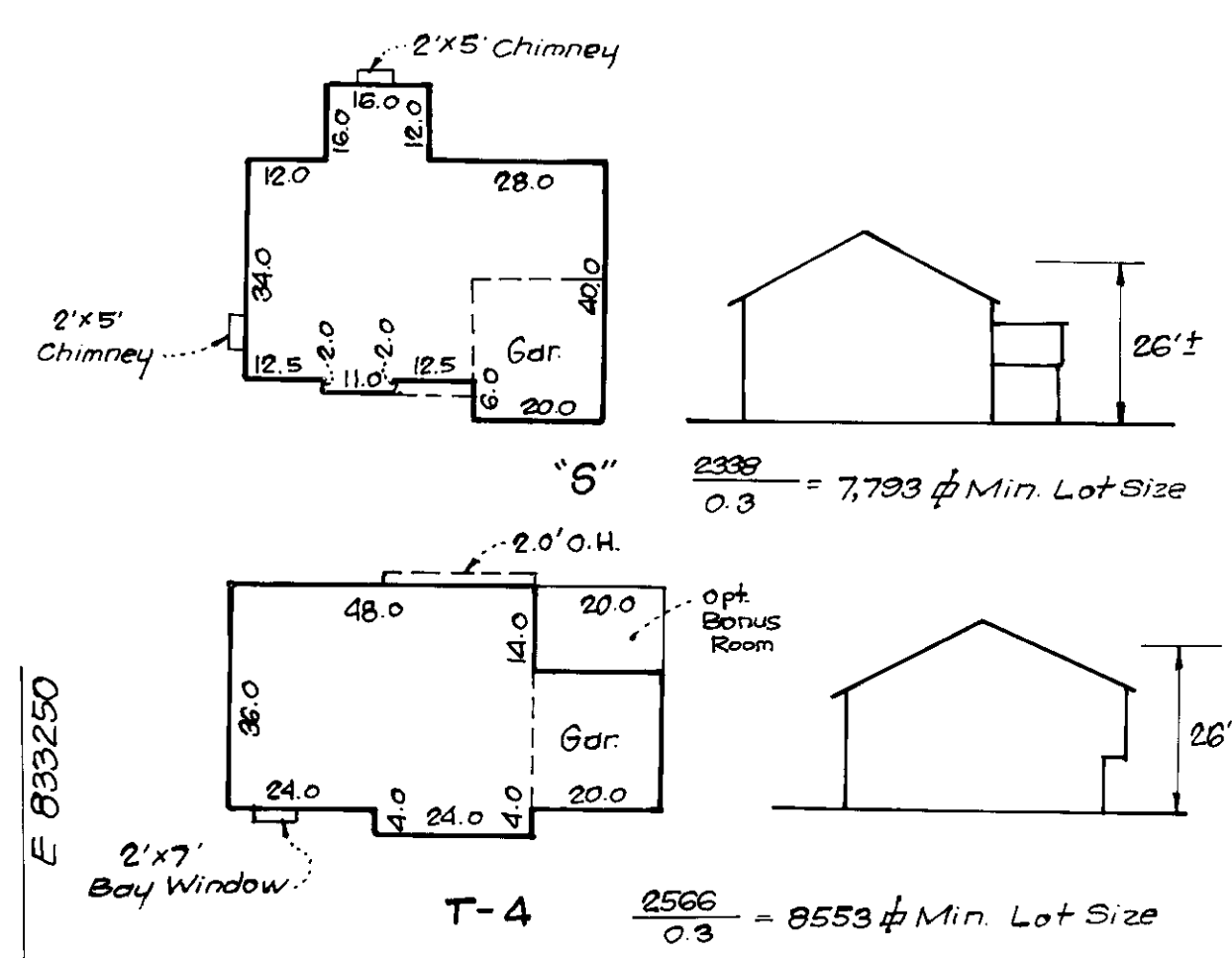

TYPICAL HOUSES

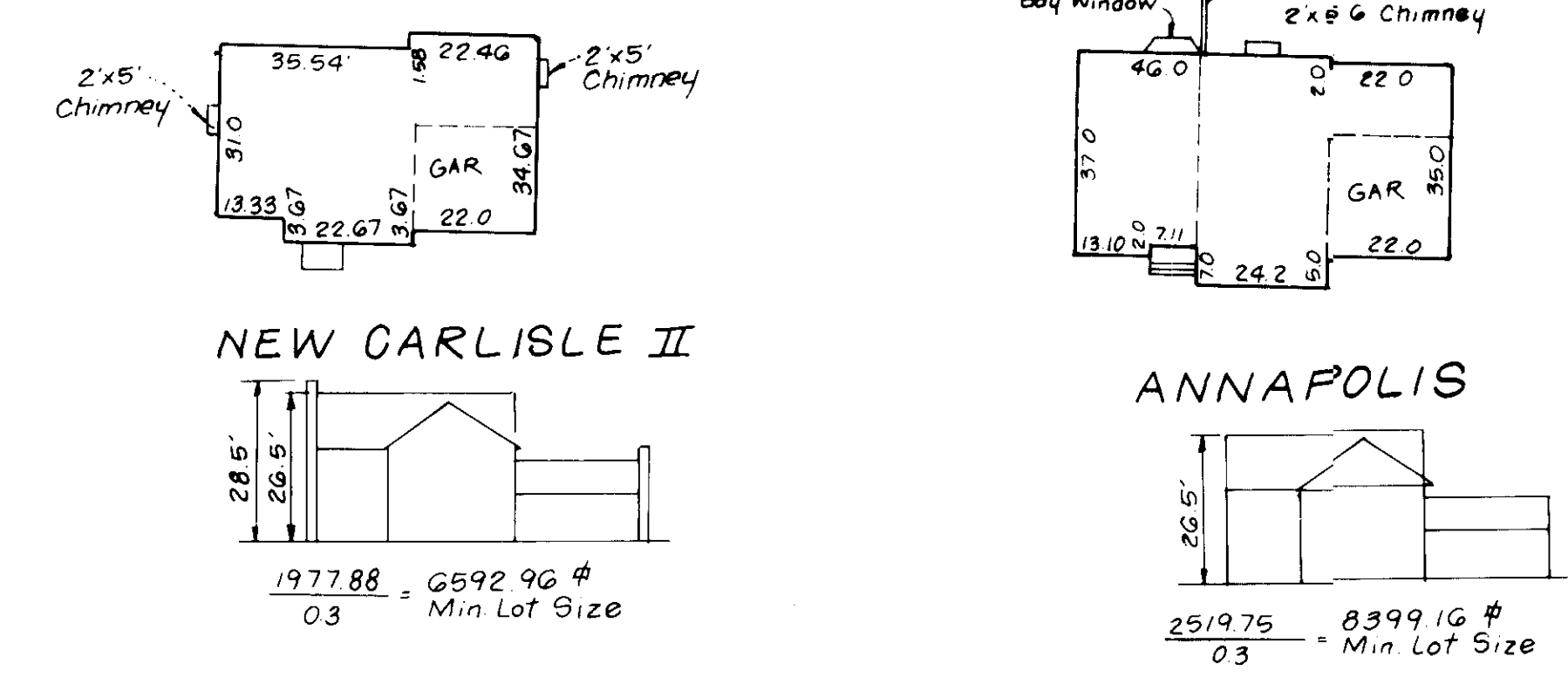

Scale: 1" = 30'
Note: All units have 1' roof eaves, front & rear.

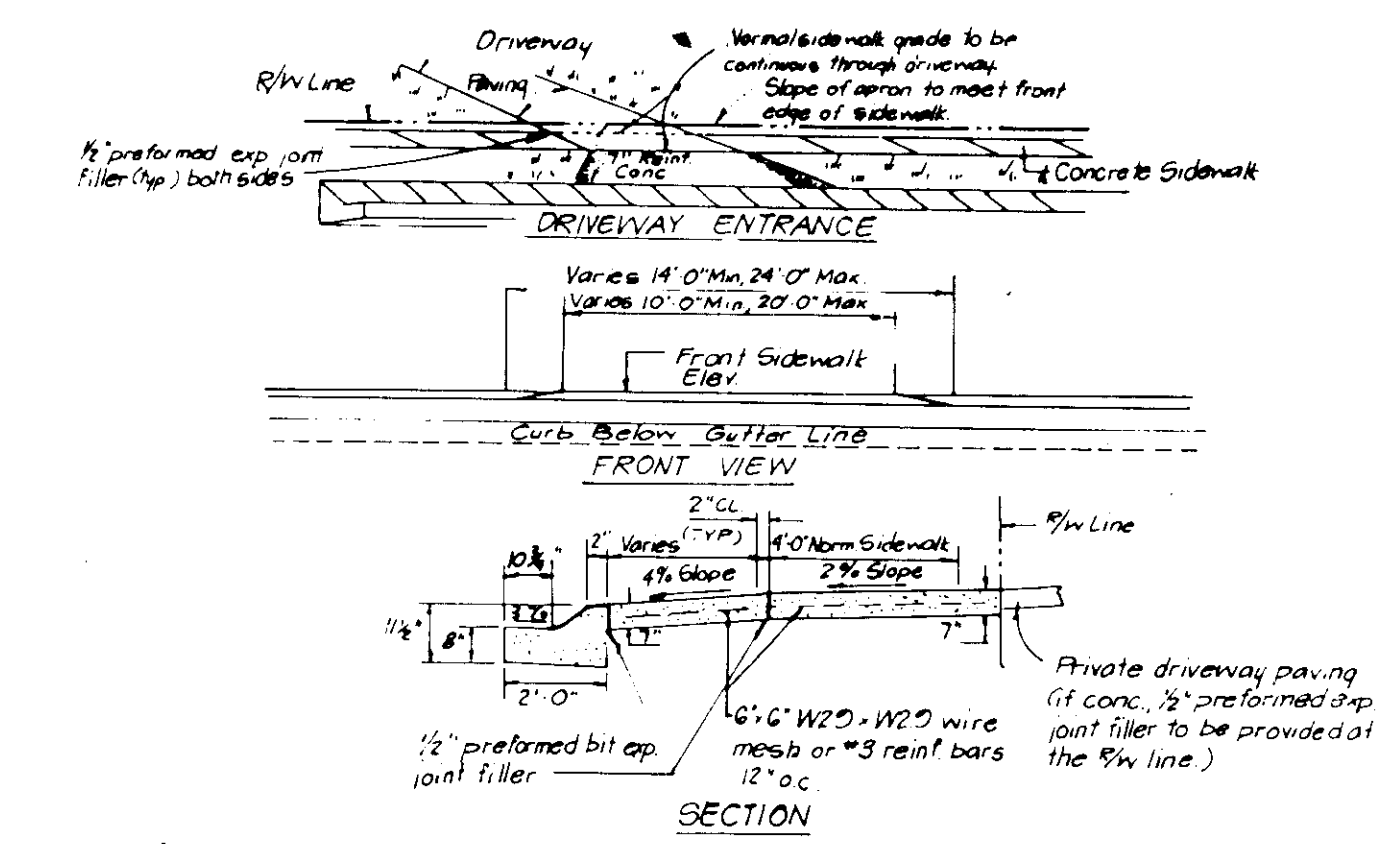

DRIVEWAY ABUTTING CLOSED SECTION WITH MODIFIED CURB & GUTTER & SIDEWALK

NO	REVISION	DATE
1	Rev. hse. of 9rd Lot 35 from Annapolis to Somerset	7-3-91
2	Rev. hse. of 9rd. Lots 36 & 37, Add hse. typical	3-23-92

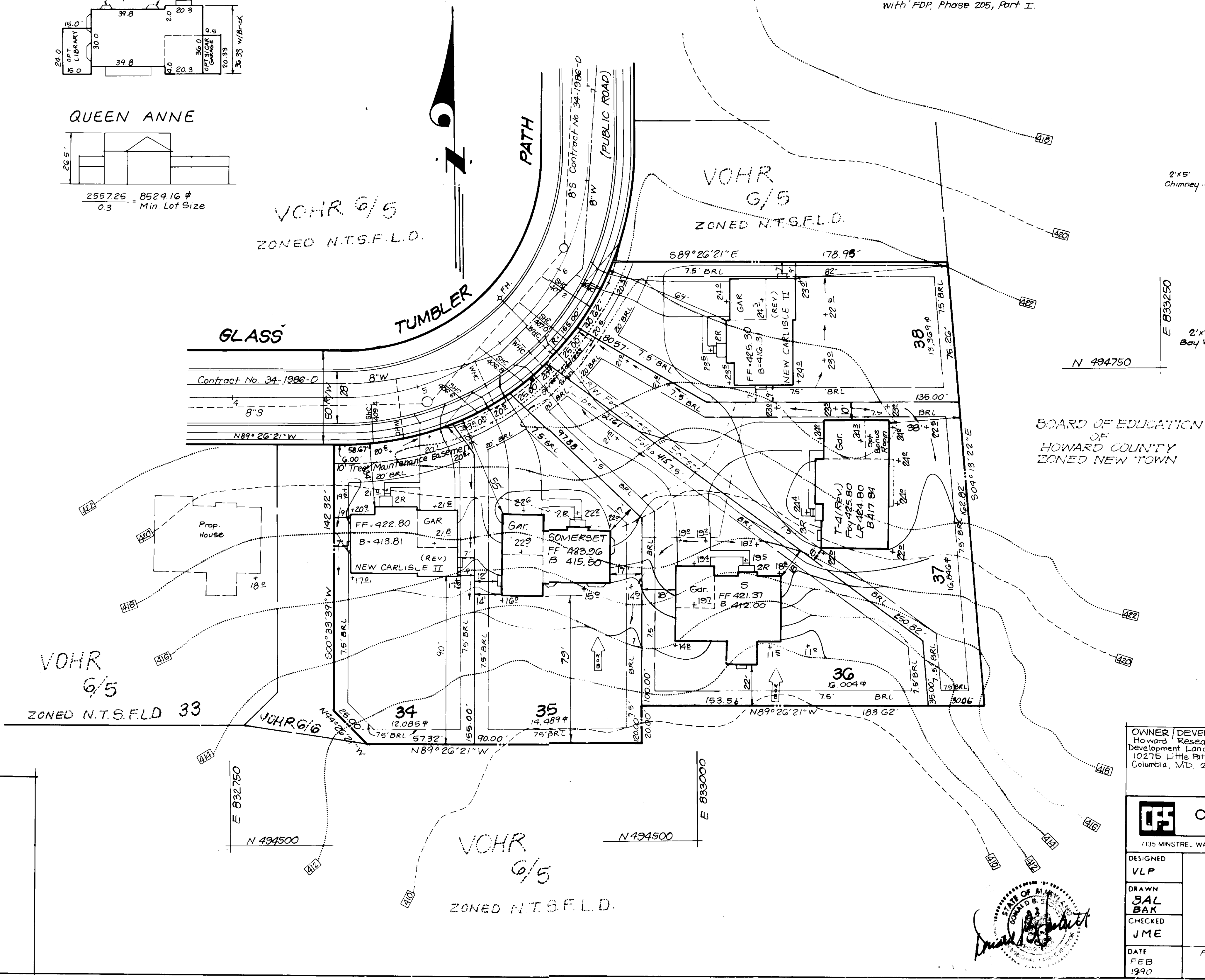

LOT #	STREET	ADDRESS
34	GLASS	TUMBLER PATH
35	"	"
36	"	"
37	"	"
38	"	"

OWNER/DEVELOPER: Howard Research & Development Land Co. 10275 Little Patuxent Pkwy Columbia, MD 21044	Subdivision Name: COLUMBIA VILLAGE OF HICKORY RIDGE Plot No: 9341-9344 Block No: 17, 18, 23 Zone: N.T.S.F.L.D. Water Code: E29	Sect./Area: G/5 Lots: 34 thru 38 Tax Map No: Elec Dist: Census Tr: 35 5 6053.02 Sewer Code: 6580000
--	--	--

APPROVED: FOR PUBLIC WATER AND PUBLIC SEWERAGE SYSTEMS.
HOWARD COUNTY HEALTH DEPARTMENT
DATE: 4-21-91

APPROVED: HOWARD COUNTY DEPT OF PLANNING & ZONING
DATE: 4-27-90

APPROVED: FOR PUBLIC WATER AND PUBLIC SEWERAGE, STORM DRAINAGE SYSTEMS AND PUBLIC ROADS
HOWARD COUNTY DEPARTMENT OF PUBLIC WORKS
DATE: 4-20-90

CLARK • FINEFROCK & SACKETT, INC.
ENGINEERS • PLANNERS • SURVEYORS
7135 MINSTREL WAY • COLUMBIA, MD 21045 • (301) 381-7500 • BALTO • (301) 621-1800 • WASH

DESIGNED: VLP
DRAWN: JAL BAK
CHECKED: JME
DATE: FEB 1990

SITE DEVELOPMENT PLAN
LOTS 34 thru 38
COLUMBIA VILLAGE OF HICKORY RIDGE
SECTION 6 AREA 5
5TH ELECTION DISTRICT
HOWARD COUNTY MARYLAND
FOR: CONSOLIDATED HOME BUILDERS, INC
6625 Belnick Road
Baltimore, Md. 21227

SCALE: 1" = 30'
DRAWING: 1 OF 2
JOB NO: 90-024
FILE NO: 90-024x

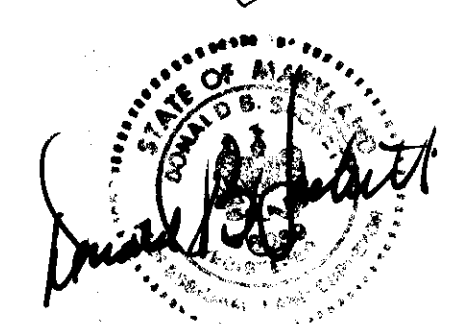

SEDIMENT CONTROL NOTES

- 1) A minimum of 24 hours notice must be given to the Howard County Office of Inspection and Permits prior to the start of any construction. (392-2437)
- 2) All vegetative and structural practices are to be installed according to the provisions of this plan and are to be in conformance with the 1983 MARYLAND STANDARDS AND SPECIFICATIONS FOR SOIL EROSION AND SEDIMENT CONTROL.
- 3) Following initial soil disturbance or redistribution, permanent or temporary stabilization shall be completed within: a) 7 calendar days for all perimeter sediment control structures, dikes, perimeter slopes and all slopes greater than 3:1, b) 14 days as to all other disturbed or graded areas on the project site.
- 4) All sediment traps/basins shown must be fenced and warning signs posted around their perimeter in accordance with Vol. 1, Chapter 14, of the HOWARD COUNTY DESIGN MANUAL, Storm Drainage.
- 5) All disturbed areas must be stabilized within the time period specified above in accordance with the 1983 MARYLAND STANDARDS AND SPECIFICATIONS FOR SOIL EROSION AND SEDIMENT CONTROL for permanent seedings (Sec. 51) and (Sec. 54), temporary seedings (Sec. 50) and mulching (Sec. 52). Temporary stabilization with mulch alone can only be done when recommended seeding rates do not allow for proper germination and establishment of grasses.
- 6) All sediment control structures are to remain in place and are to be maintained in operative condition until permission for their removal has been obtained from the Howard County Sediment Control Inspector.
- 7) Site Analysis:
Total Area of Site: 1.67 Acres
Area Disturbed: 1.58 Acres
Area to be seeded or paved: 0.50 Acres
Area to be vegetatively stabilized: 0.82 Acres
Total Cut: 2323 Cu. yds
Total Fill: 710 Cu. yds
Offsite waste/borrow area location: **Undetermined**
- 8) Any sediment control practice which is disturbed by grading activity for placement of utilities must be repaired on the same day of disturbance.
- 9) Additional sediment control must be provided, if deemed necessary by the Howard County Sediment Control Inspector.
- 10) On all sites with disturbed areas in excess of 2 acres, completion of installation of perimeter erosion and sediment controls, but before proceeding with any other earth disturbance or grading. Other building or grading inspection approvals may not be authorized until this initial approval by the inspection agency is made.
- 11) If houses are to be constructed on an "As-Built" basis, at random, Single Lot Sediment Control as shown below shall be implemented.
- 12) All pipes to be blocked at the end of each day (see detail below). N/A
- 13) The total amount of straw bale dikes/silt fence equals 205 L.F.

CONSTRUCTION SEQUENCE:

- Obtain Grading Permit and Install Sediment and Erosion Control Devices and Stabilize.
- Excavate for foundations and Rough Grade & temporarily stabilize.
- Construct Structures, Sidewalks and Driveways.
- Final Grade and stabilize in accordance with Stds. & Specs.
- Upon approval of the sediment control inspector, remove sediment and erosion controls and stabilize.

No. of Days	
7	
30	
120	
30	
7	

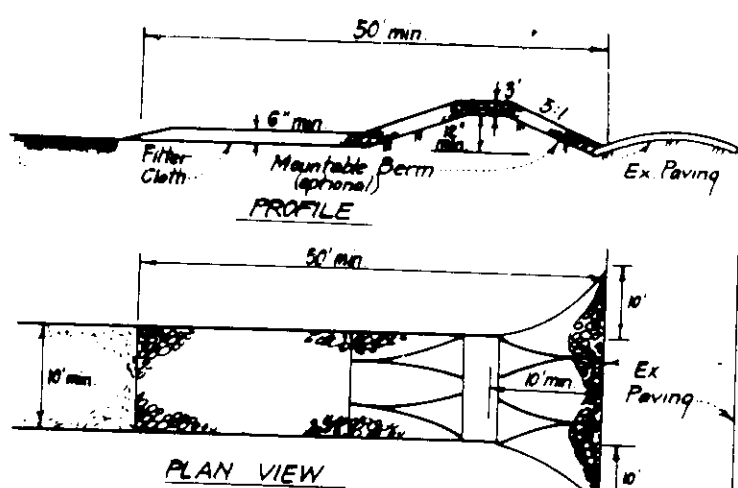

CONSTRUCTION SPECIFICATIONS:

1. Stone size - Use 2" stone or reclaimed or recycled concrete equivalent.
2. Length - No stagger, but not less than 50 feet (except on a single residence lot where a shorter minimum length would apply).
3. Thickness - Not less than six (6) inches.
4. Width - Ten (10) feet minimum, but not less than the full width of points where ingress or egress occurs.
5. Filter Cloth - Will be placed over the entire area prior to placing of stone. Filter will not be required on a single family residence lot.
6. Surface Water - All surface water flowing or gathered toward construction entrances shall be piped across the entrance. If piping is impractical, a manhole shall be installed with 3" drops will be permitted.
7. Maintenance - The entrance shall be maintained in a condition which will prevent tracking or flowing of sediment with traffic. This may require periodic cleaning with additional water when construction is completed and/or other measures may be required. All sediment shall be removed immediately.
8. Washing - Trucks shall be cleaned to remove sediment prior to entrance into public right-of-way. When washing is required, it shall be done on an area stabilized with stone and which drains into an approved sediment trapping device.
9. Periodic inspection and needed maintenance shall be provided after each rain.

STABILIZED CONSTRUCTION ENTRANCE (SCE)

PERMANENT SEEDING NOTES

Apply to graded or cleared areas not subject to immediate further disturbance where a permanent long-lived vegetative cover is needed.

Seedbed Preparation: Loosen upper three inches of soil by raking, disking or other acceptable means before seeding, if not previously loosened.

Soil Amendments: In lieu of soil test recommendations, use one of the following schedules:
1) Preferred - Apply 2 tons per acre dolomitic limestone (91 lbs/1000 sq ft) and 600 lbs per acre 10-10-10 fertilizer (14 lbs/1000 sq ft) before seeding. Harrow or disc into upper three inches of soil. At time of seeding, apply 400 lbs per acre 30-0-0 ureaformal fertilizer (9 lbs/1000 sq ft).
2) Acceptable - Apply 2 tons per acre dolomitic limestone (91 lbs/1000 sq ft) and 1000 lbs per acre 10-10-10 fertilizer (23 lbs/1000 sq ft) before seeding. Harrow or disc into upper three inches of soil.

Seeding - For periods March 1 thru April 30, and August 1 thru October 15, seed with 60 lbs per acre (1.4 lbs/1000 sq ft) of Kentucky 31 Tall Fescue. For the period May 1 thru July 31, seed with 90 lbs Kentucky 31 Tall Fescue per acre and 2 lbs per acre (.05 lbs/1000 sq ft) of weeping lovegrass. During the period of October 15 thru February 28, protect site by: Option (1) 2 tons per acre of well anchored straw mulch and seed as soon as possible in the spring. Option (2) Use seed. Option (3) Seed with 60 lbs/acre Kentucky 31 Tall Fescue and mulch with 2 tons/acre well anchored straw.

Mulching - Apply 1 1/2 to 2 tons per acre (70 to 90 lbs/1000 sq ft) of untreated small grain straw immediately after seeding. Anchor mulch immediately after application using mulch anchoring tool or 218 gallons per acre (5 gal/1000 sq ft) of emulsified asphalt on flat areas. On slopes 8 feet or higher, use 348 gallons per acre (8 gal/1000 sq ft) for anchoring.

Maintenance - Inspect all seeded areas and make needed repairs, replacements and seedings.

TEMPORARY SEEDING NOTES

Apply to graded or cleared areas likely to be redisturbed where a short-term vegetative cover is needed.

Seedbed Preparation: Loosen upper three inches of soil by raking, disking or other acceptable means before seeding, if not previously loosened.

Soil Amendments: Apply 600 lbs per acre 10-10-10 fertilizer (14 lbs/1000 sq ft)

Seeding - For periods March 1 thru April 30 and from August 15 thru November 15, seed with 25 bushel per acre of annual rye (3.2 lbs/1000 sq ft). For the period May 1 thru August 14, seed with 3 lbs per acre of weeping lovegrass (.07 lbs/1000 sq ft). For well anchored straw mulch and seed as soon as possible in the spring, or use seed.

Mulching - Apply 1 1/2 to 2 tons per acre (70 to 90 lbs/1000 sq ft) of untreated small grain straw immediately after seeding. Anchor mulch immediately after application using mulch anchoring tool or 218 gal per acre (5 gal/1000 sq ft) of emulsified asphalt on flat areas. On slopes 8 ft or higher, use 348 gal per acre (8 gal/1000 sq ft) for anchoring. Refer to the 1983 MARYLAND STANDARDS AND SPECIFICATIONS FOR SOIL EROSION AND SEDIMENT CONTROL for rate and methods not covered.

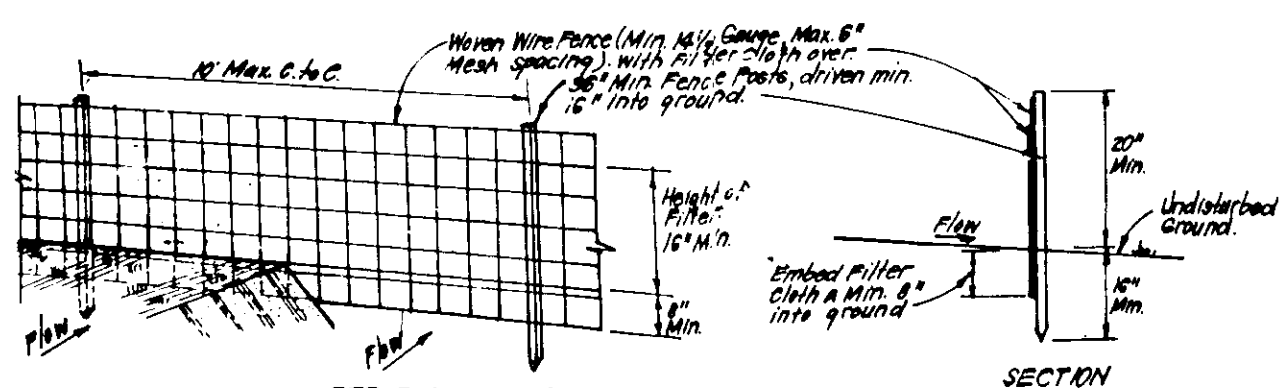

CONSTRUCTION SPECIFICATIONS:

1. Woven wire fabric to be fastened securely to fence posts with wire 1/2" or larger.
2. Filter cloth to be fastened securely to woven wire fabric with 1/2" spaced every 24" at top and mid sections.
3. When 2 sections of filter cloth begin each other they shall be overlapped by 6" and stapled.
4. Main fabric shall be perpendicular to ground and material removed within 24 hours of development in silt fence.

SILT FENCE DETAIL (9)

NO SCALE

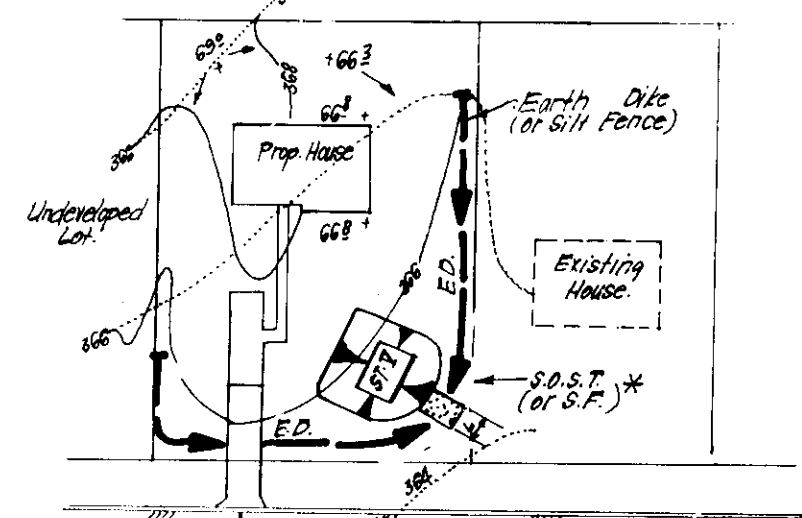

LEGEND

- Contour Interval: 2 FT
- Existing Contour: ---(40)---
- Proposed Contour: ---(41)---
- Spot Elevation: +10.8
- Direction of Drainage: --->---
- Walk out Basement: ---(100)---
- Silt Fence: ---S---S---S---
- Stabilized Construction Entrance: [Symbol]

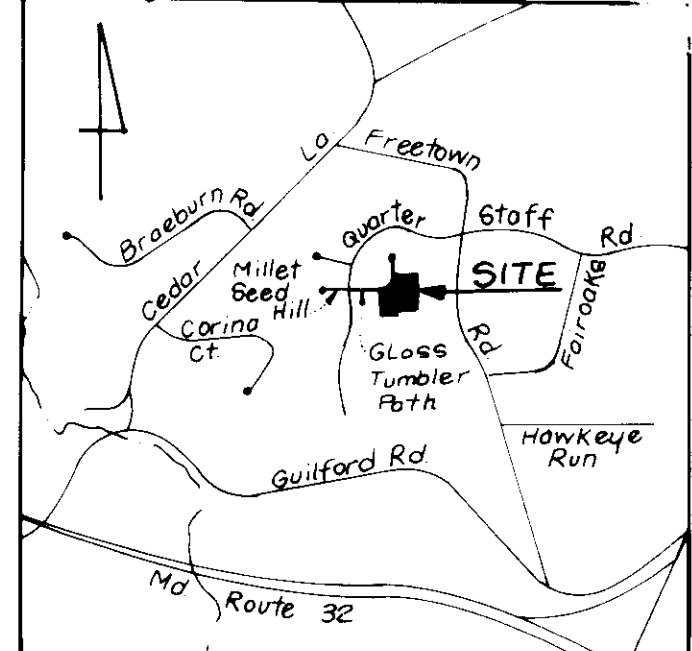

VICINITY MAP

Scale 1" = 200'

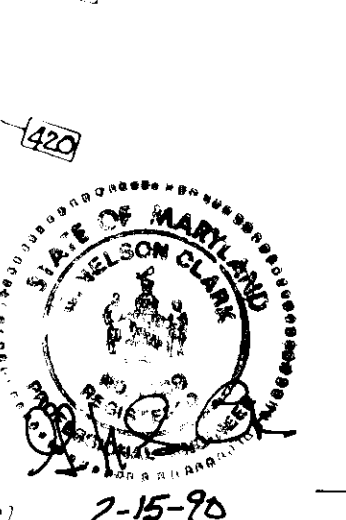
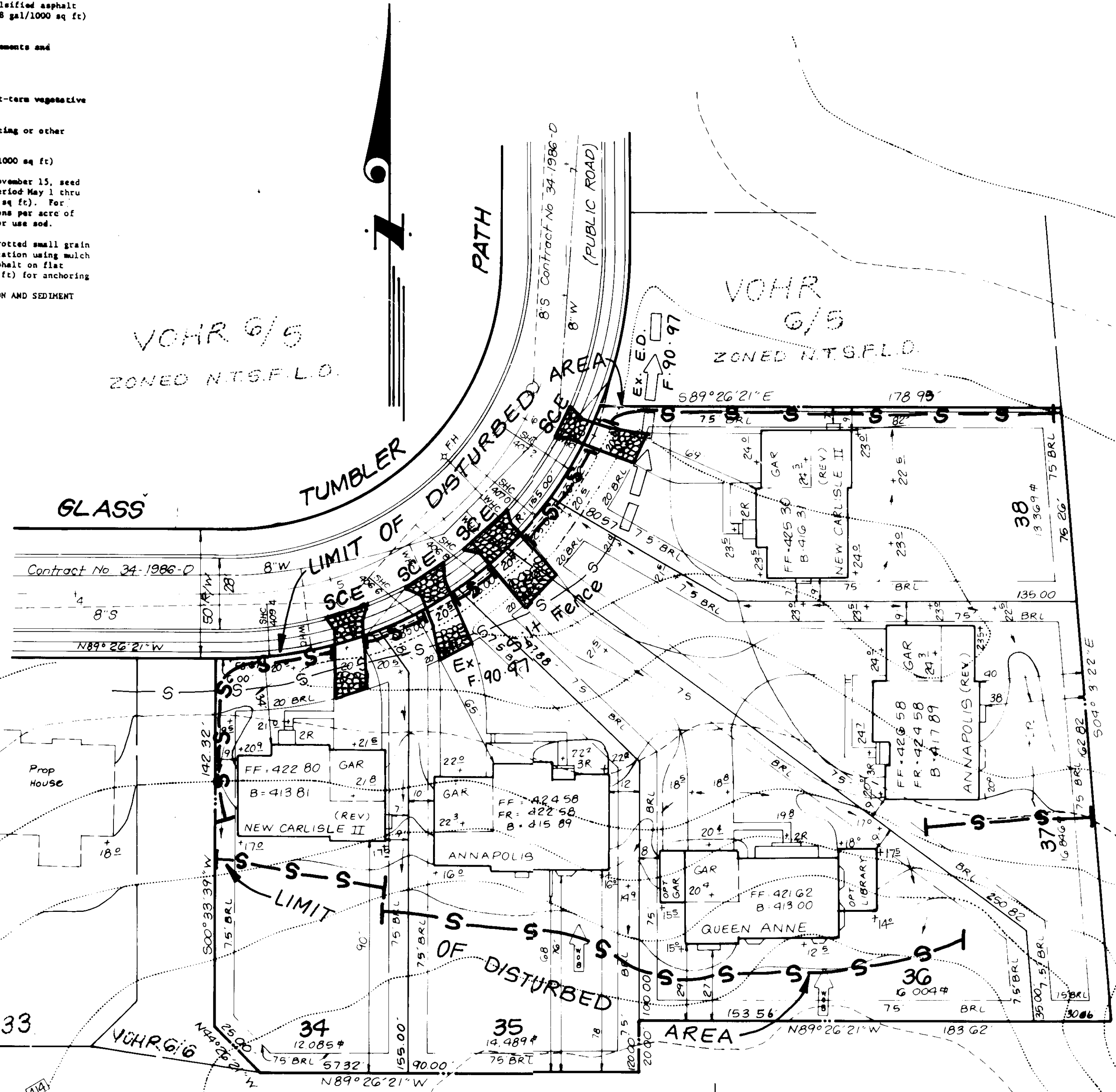

ENGINEER'S CERTIFICATE
I hereby certify that this plan for Erosion and Sediment Control is a practical and workable plan and that the same complies with the provisions of the Subchapter of the State of Maryland Conservation District.

G. Nelson Clark
2-15-90
Date

APPROVED FOR PUBLIC WATER AND PUBLIC SEWERAGE SYSTEMS
HOWARD COUNTY HEALTH DEPARTMENT
4-25-90
DATE

APPROVED FOR HOWARD COUNTY DEPT. OF PLANNING & ZONING
4-17-90
DATE

APPROVED FOR PUBLIC WATER AND PUBLIC SEWERAGE
STORM DRAINAGE SYSTEMS AND PUBLIC ROADS
HOWARD COUNTY DEPARTMENT OF PUBLIC WORKS
4-20-90
DATE

Reviewed for HOWARD COUNTY S.C.D. Name and meets Technical Requirements
Signature
U.S. Soil Conservation Service
THIS DEVELOPMENT PLAN IS APPROVED FOR SOIL EROSION AND SEDIMENT CONTROL BY THE HOWARD COUNTY CONSERVATION DISTRICT.
4/17/90
Date

DEVELOPER'S/BUILDER'S CERTIFICATE
"I/We certify that all development and construction will be done according to this plan of development and site plan for erosion and sediment control and that all responsible personnel involved in the construction project will have a Certificate of Attendance at a Dept. of Natural Resources Approved Training Program for the Control of Sediment and Erosion before beginning the project. I also authorize periodic on-site inspection by the Howard Soil Conservation District or their authorized agents, as are deemed necessary."
Signature of Developer/Builder
2/13/90
Date

OWNER/DEVELOPER:
Howard Research & Development
Land County
10279 Little Patuxent Pkwy.
Columbia, MD 21044

CLARK • FINEFROCK & SACKETT, INC
ENGINEERS • PLANNERS • SURVEYORS
7135 MINSTREL WAY • COLUMBIA, MD 21045 • (301) 381-7500 • BALTO. • (301) 621-8100 • FAX: (301) 621-8100

SEDIMENT / EROSION CONTROL PLAN
LOTS 34 thru 38
COLUMBIA
SECTION 6 AREA 5
5TH ELECTION DISTRICT
HOWARD COUNTY MARYLAND
FOR CONSOLIDATED HOME BUILDERS, INC
6625 Belnick Road
Baltimore, Md 21227

SCALE 1" = 30'
DRAWING 2 OF 2
JOB NO 90-024
FILE NO 90-024 SE

DATE FEB 1990