

- SEPTIC SYSTEM NOTES**
- 1) THE MAXIMUM GALLONS/DAY USAGE SHALL BE 900 GALLONS/DAY BASED ON 5 GALLONS/DAY/SEAT X 190 SEATS.
 - 2) TRENCHES SHALL BE 3' WIDE.
 - 3) THE INLET ELEVATION FOR THE TRENCHES SHALL BE 3 FEET BELOW ORIGINAL GRADE.
 - 4) THE BOTTOM MAXIMUM DEPTH OF THE TRENCHES SHALL BE 5 1/2 FEET BELOW ORIGINAL GRADE.
 - 5) THE EFFECTIVE AREA OF THE TRENCHES BEGIN 3 1/2 FEET BELOW ORIGINAL GRADE.
 - 6) TWO FEET OF STONE SHALL BE PLACED IN THE TRENCHES BELOW THE DISTRIBUTION PIPE.
 - 7) NO KITCHEN OR SHOWERS FACILITIES WILL BE ALLOWED WITHIN THE CHURCH BUILDING.

- SITE ANALYSIS:**
1. ZONING - "R" SEE BOARD OF APPEALS CASE NO. 88-54E
 2. AREA - 3.324 ACRES
 3. PROPOSED USE - CHURCH
 4. FLOOR AREA - 4005 S.F.
 5. BUILDING COVERAGE - 2.8%
 6. GREEN AREA - 2.54 ACRES = 76%
 7. PARKING REQUIREMENTS
NO. OF SPACES REQ. = 190 SEATS @ 1SPACE/3 SEATS = 64
NO. OF SPACES PROVIDED = 66

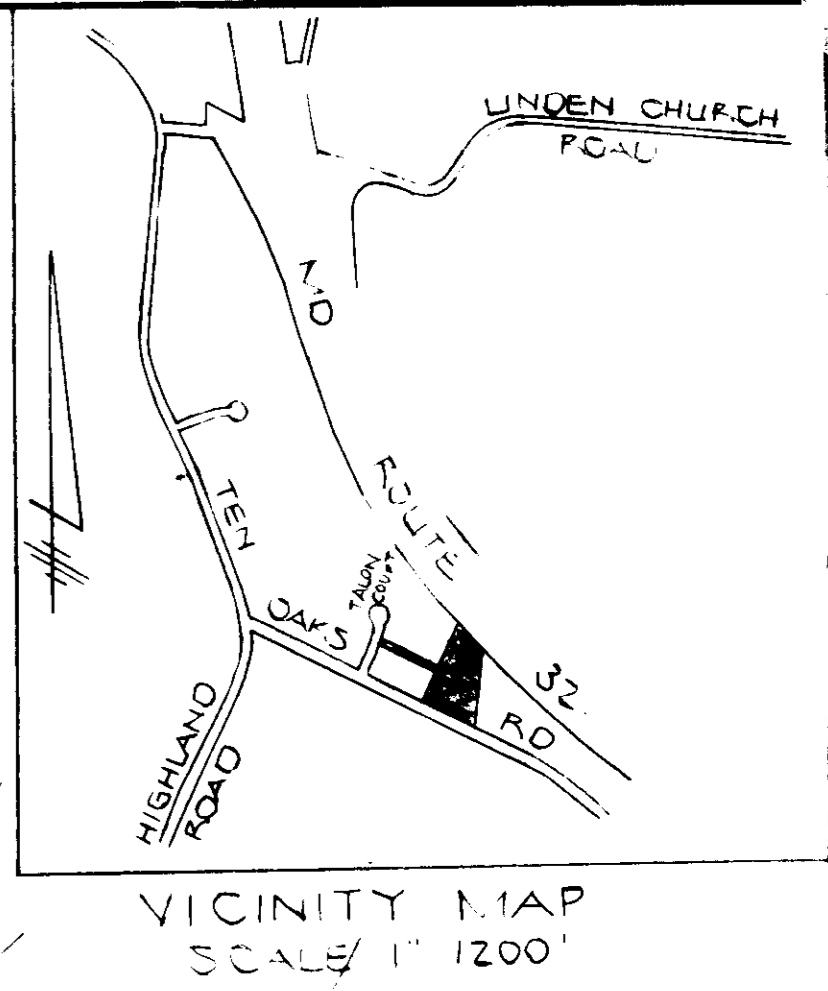

- NOTE:**
CONDITIONS OF APPROVAL:
P.A. CASE 88-54E
1. The Petitioner shall comply with all applicable Federal, State and County laws and regulations; and
 2. All outdoor lighting shall be directed inward so as not to shine on adjacent property, and shall be the minimum necessary for directional lighting and security.
 3. The Petitioner shall re-record the record subdivision plat without the restriction concerning vehicular access onto Ten Oaks Road; and
 4. The Petitioner shall have the ingress and egress restriction along Ten Oaks Road removed in order to provide sole access onto the subject property from Ten Oaks Road only. This special exception shall be void in the event that the restriction is not removed from the subdivision plat within two (2) years from the date of this Order; and
 5. The Petitioner shall insure that adequate landscaping shall be provided to screen all structures, parking and activity areas from residential properties. The trees shall be evergreen trees with a minimum height of four (4) feet when planted. The trees shall be maintained for the life of the special exception; and
 6. The Petitioner shall construct a three (3) foot high berm between the parking lot and residential properties, with landscaping along the top of the berm; and
 7. Any air conditioners, fans or outside appliances shall be adequately screened and buffered for both sight and noise from adjacent properties.

LOT NO.	STREET ADDRESS

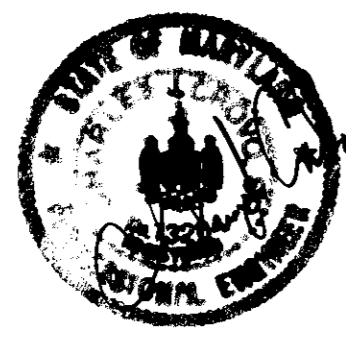

FISHER, COLLINS & CARTER, INC.
CIVIL ENGINEERS & LAND SURVEYORS
8388 COURT AVENUE
ELLICOTT CITY, MARYLAND 21043
(301) 461-2855

ENGINEER'S CERTIFICATE
I HEREBY CERTIFY THAT THIS PLAN FOR EROSION AND SEDIMENT CONTROL REPRESENTS A PRACTICAL AND WORKABLE PLAN BASED ON MY PERSONAL KNOWLEDGE OF THE SITE CONDITIONS AND THAT IT WAS PREPARED IN ACCORDANCE WITH THE REQUIREMENTS OF THE HOWARD SOIL CONSERVATION DISTRICT.

DATE: 2/18/89
SIGNATURE OF ENGINEER: [Signature]

DEVELOPER'S CERTIFICATE
"I/WE CERTIFY THAT ALL DEVELOPMENT AND CONSTRUCTION WILL BE DONE ACCORDING TO THIS PLAN OF DEVELOPMENT AND PLAN FOR EROSION AND SEDIMENT CONTROL AND THAT ALL RESPONSIBLE PERSONNEL INVOLVED IN THE CONSTRUCTION PROJECT WILL HAVE A CERTIFICATE OF ATTENDANCE AT A DEPARTMENT OF NATURAL RESOURCES APPROVED TRAINING PROGRAM FOR THE CONTROL OF SEDIMENT AND EROSION BEFORE BEGINNING THE PROJECT. I ALSO AUTHORIZE PERIODIC ONSITE INSPECTION BY THE HOWARD SOIL CONSERVATION DISTRICT OR THEIR AUTHORIZED AGENTS, AS ARE DEEMED NECESSARY."

DATE: 2/18/89
SIGNATURE OF DEVELOPER: [Signature]

REVIEWED FOR HOWARD SOIL CONSERVATION DISTRICT AND MEETS TECHNICAL REQUIREMENTS

DATE: 1/9/90
U.S. SOIL CONSERVATION SERVICE

THIS DEVELOPMENT IS APPROVED FOR EROSION AND SEDIMENT CONTROL BY THE HOWARD SOIL CONSERVATION DISTRICT.

DATE: 4/19/91
SIGNATURE: [Signature]
HOWARD SOIL CONSERVATION DISTRICT

APPROVED: DEPT. OF PLANNING AND ZONING

DATE: 3-5-90
SIGNATURE: [Signature]
PLANNING DIRECTOR

DATE: 2/21/90
SIGNATURE: [Signature]
CHIEF, DIVISION OF COMMUNITY PLANNING & LAND DEVELOPMENT

APPROVED: HOWARD COUNTY HEALTH DEPARTMENT FOR PRIVATE WATER AND SEWERAGE SYSTEMS

DATE: 2-10-90
SIGNATURE: [Signature]
HEALTH OFFICER

APPROVED: DEPARTMENT OF PUBLIC WORKS FOR PRIVATE WATER & SEWER AND STORM DRAINAGE SYSTEMS AND ROADS.

DATE: 2/1/90
SIGNATURE: [Signature]
DIRECTOR, PUBLIC WORKS

DATE: 1-25-90
SIGNATURE: [Signature]
CHIEF, BUREAU OF ENGINEERING

PROPERTY/SUBDIVISION: EAGLE POINT LANDING, CLARKSVILLE KINGDOM HALL
SECTION/AREA: 17
LOT NO: 17
PLAT NO./L.F. BLOCK NO. ZONE TAX/ZONE ELEC. DIST. CENSUS TR. 2075 21 R 28 5 6031
WATER CODE: N/A SEWER CODE: N/A

SITE DEVELOPMENT PLAN
CLARKSVILLE KINGDOM HALL
LOT 17
EAGLE POINT LANDING
TAX MAP 28 PARCEL 46
ELECT. DIST. 5 HOWARD CO., MD.
AUG. 17 1989 SHEET 1 OF 6
AS-BUILT

STRUCTURE SCHEDULE			
NO.	TYPE	INV. OUT	REMARKS
S-1	CONC. END SECTION	443.27	SD 5.51
S-2	" " "	443.50	" "

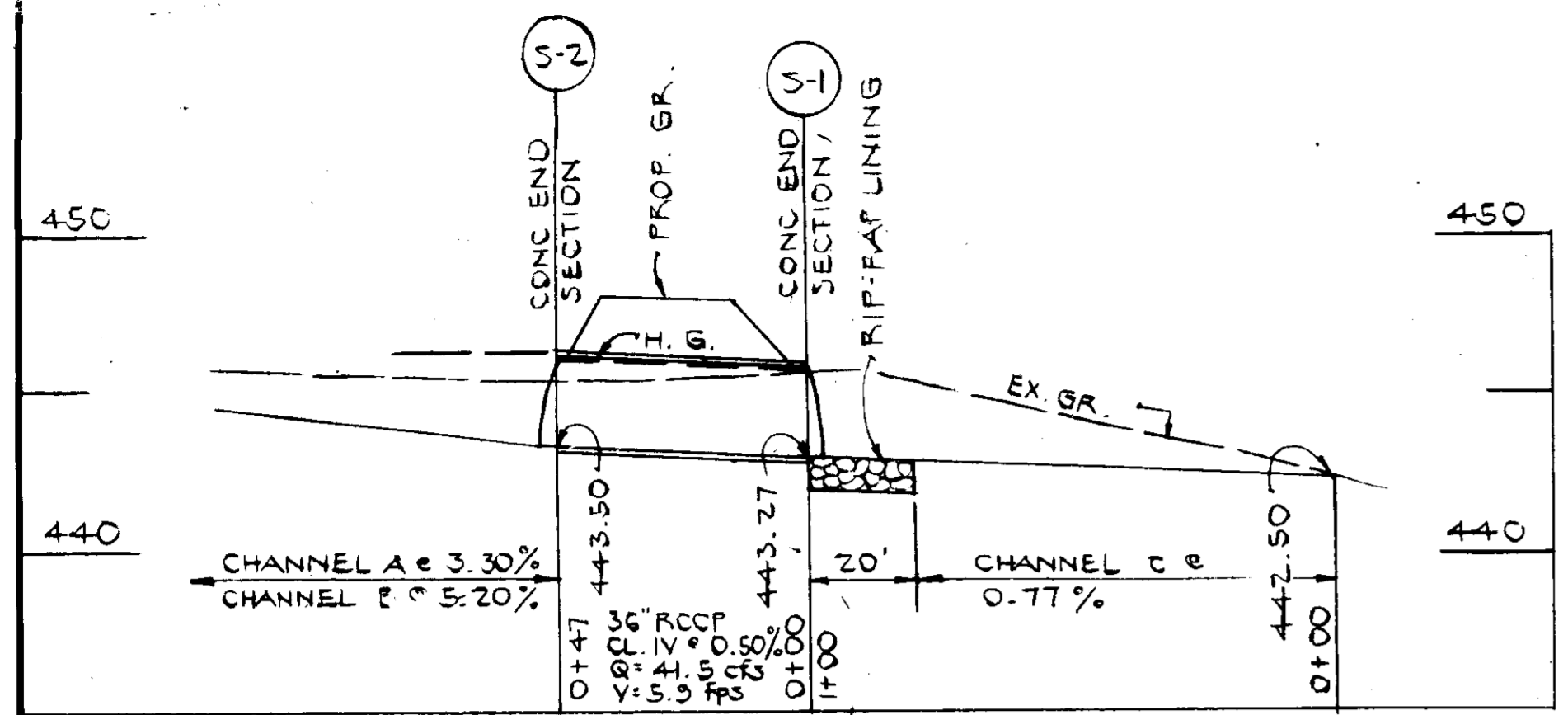

STORM DRAIN PROFILE
SCALE: VERT. 1"=5'; HORIZ. 1"=30'

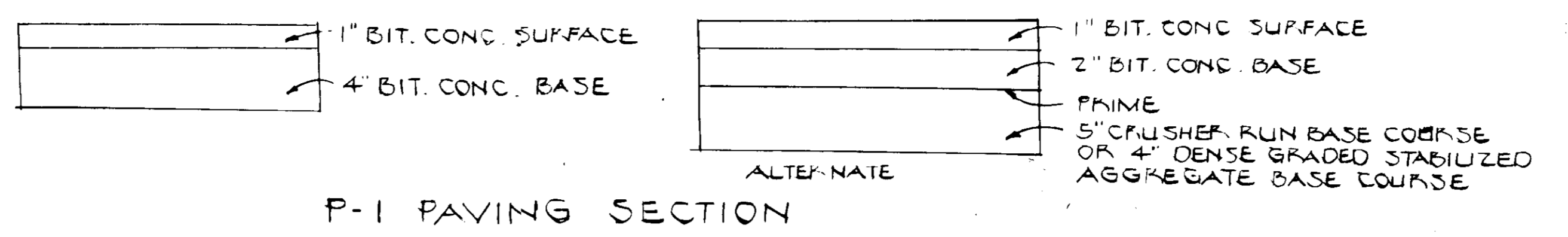

P-1 PAVING SECTION

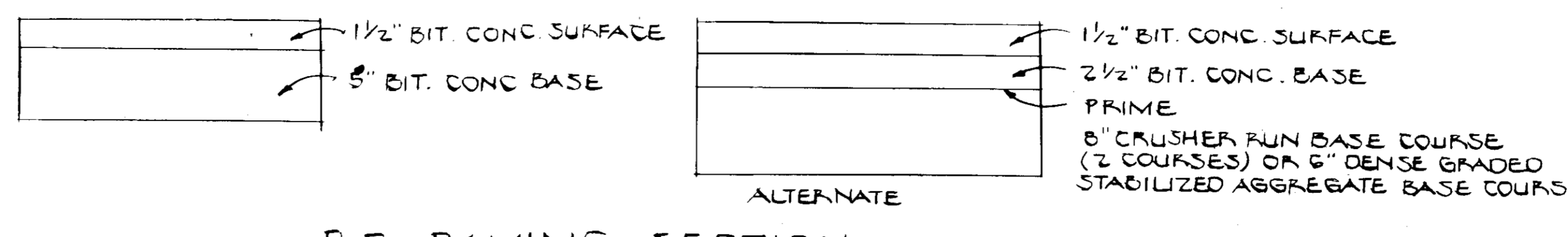

P-2 PAVING SECTION

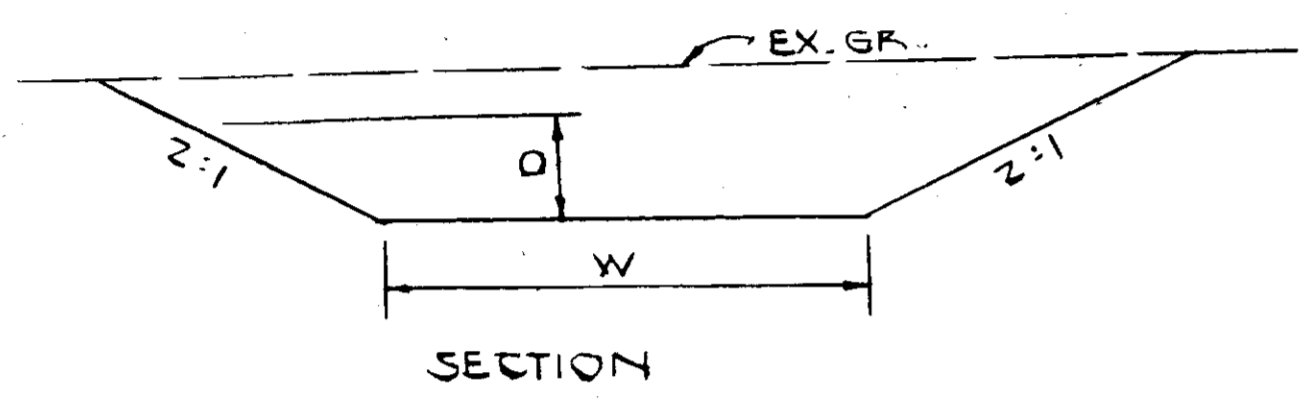

SECTION

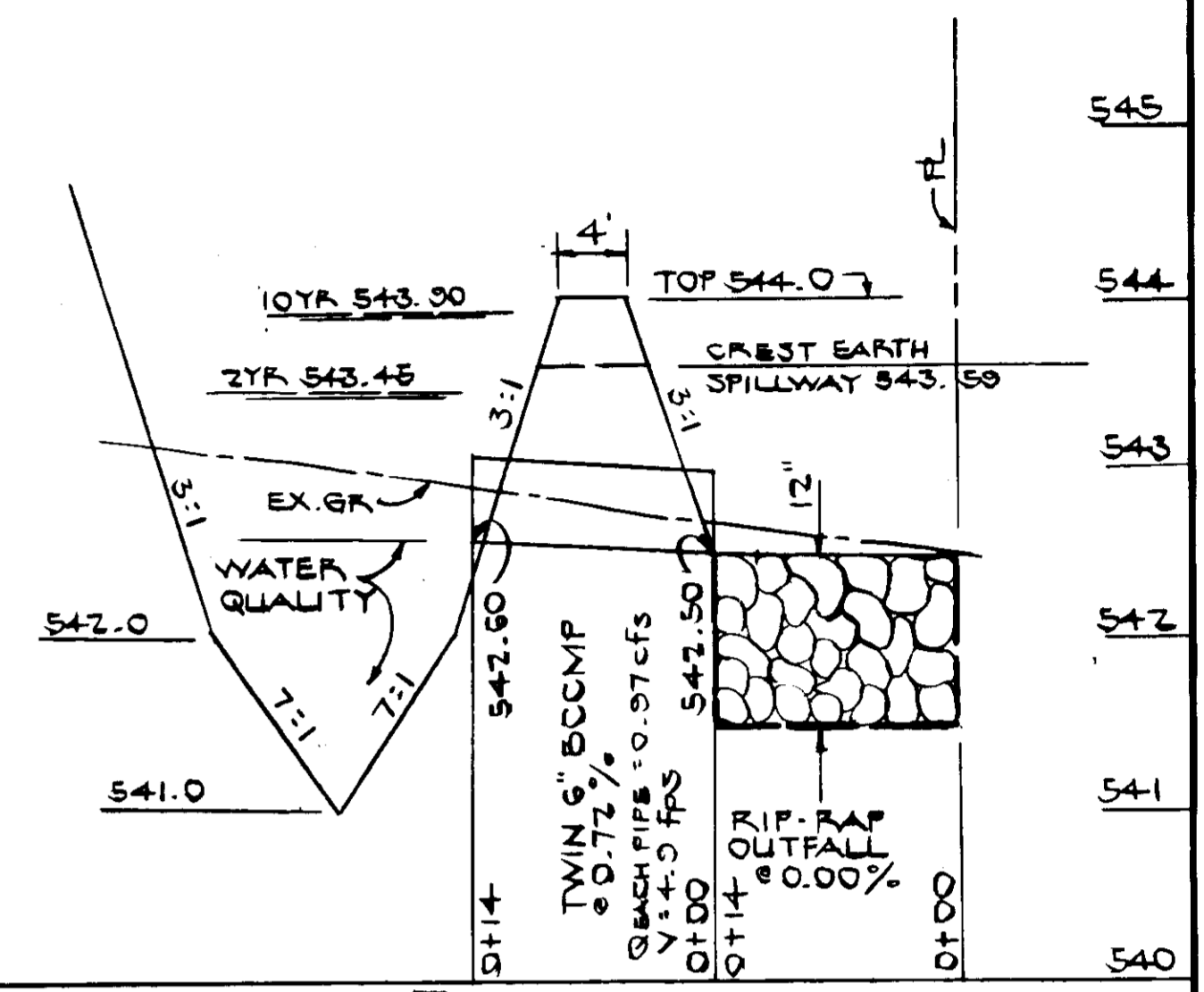

SECTION A-A
SCALE: HORIZ. 1"=10'; VERT. 1"=1'

CHANNEL DESIGN													
CHANNEL	VV	O	A	P	r	r ^{2/3}	S	3/2	n	k	v	Q	Q _{DES}
A	10'	0.37	3.97	11.65	0.34	0.4870	0.033	0.1817	0.030	43.5	4.4	17.5	16.8
B	10'	0.46	4.9	12.01	0.408	0.550	0.052	0.2280	0.035	42.5	5.3	26.0	24.7
C	20'	0.70	14.98	23.1	0.648	0.743	0.0077	0.0677	0.030	43.5	3.3	49.4	41.5

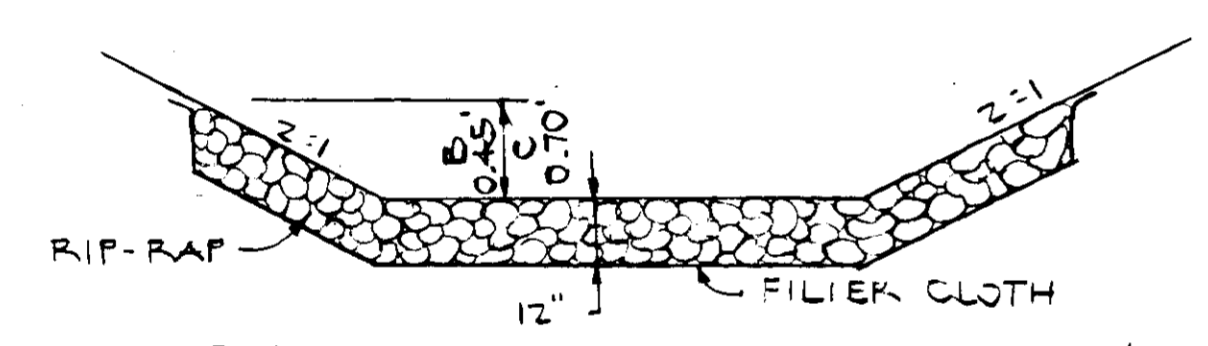

CHANNEL LINING CHANNEL B & C
CHANNEL SECTIONS

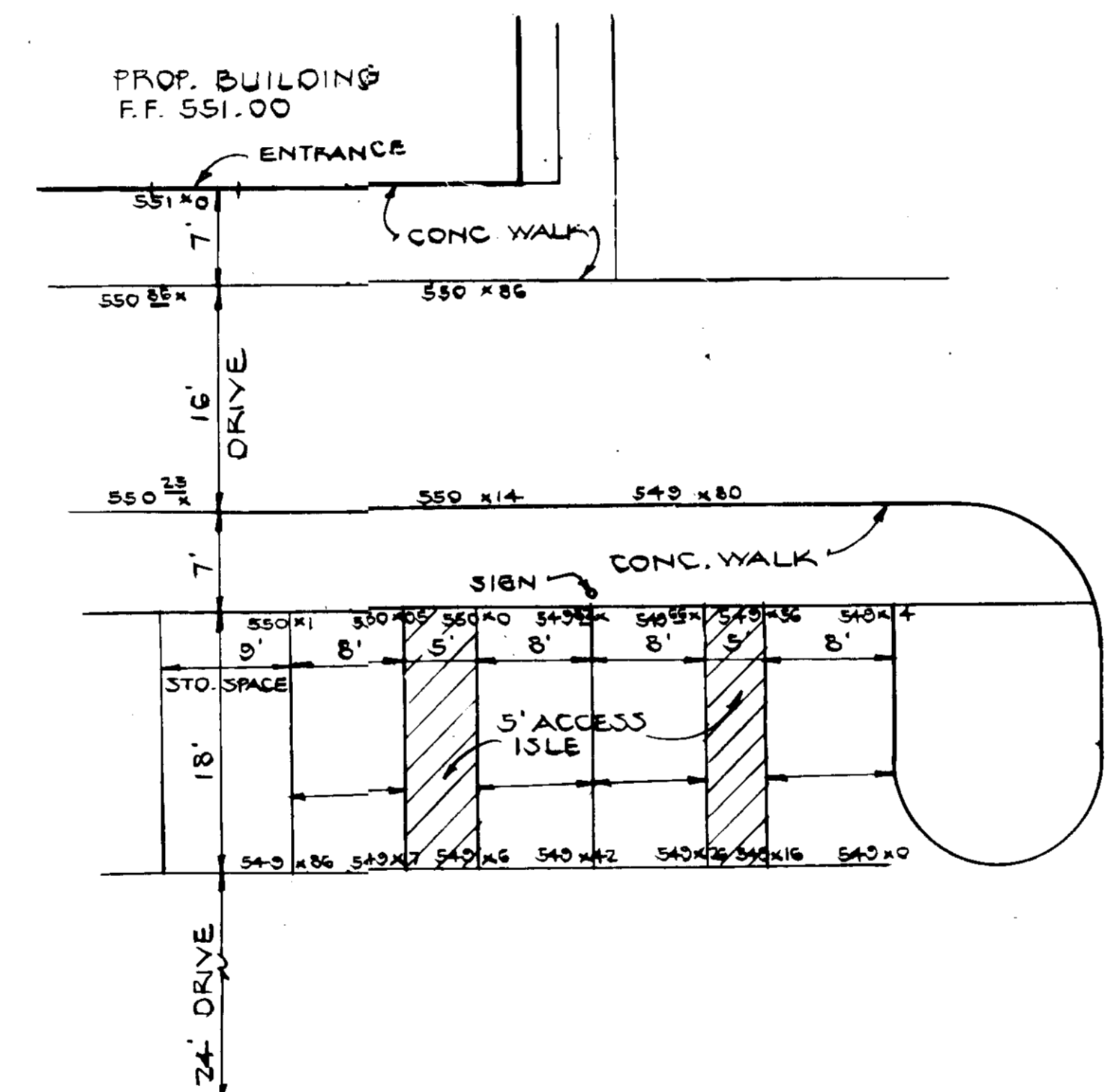

TYPICAL PARKING LAYOUT
SCALE: 1"=10'



NOTE: THE HANDICAPPED SIGN SHALL HAVE A MINIMUM MOUNTING HEIGHT OF 7 FEET MEASURED FROM EXISTING GRADE TO THE BOTTOM EDGE OF THE SIGN.
HANDICAPPED SIGN DETAIL
NOT TO SCALE

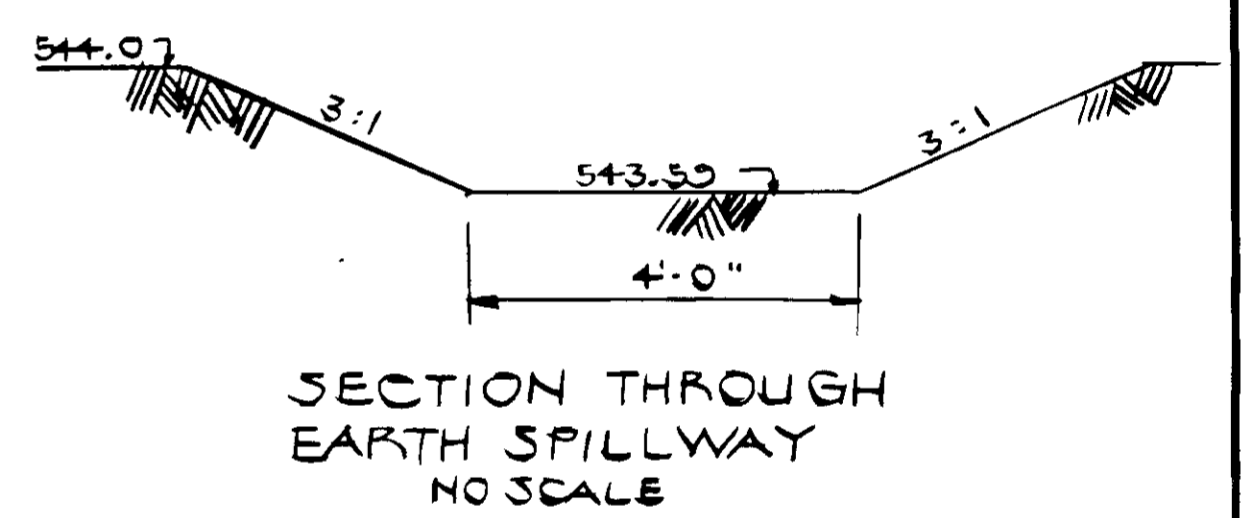

SECTION THROUGH EARTH SPILLWAY
NO SCALE

LOT NO.	STREET ADDRESS
17	5475 TELL OAKS ROAD



FISHER, COLLINS & CARTER, INC.
CIVIL ENGINEERS & LAND SURVEYORS
8388 COURT AVENUE
ELLICOTT CITY, MARYLAND 21043
(301) 461-2855

ENGINEER'S CERTIFICATE
I HEREBY CERTIFY THAT THIS PLAN FOR EROSION AND SEDIMENT CONTROL REPRESENTS A PRACTICAL AND WORKABLE PLAN BASED ON MY PERSONAL KNOWLEDGE OF THE SITE CONDITIONS AND THAT IT WAS PREPARED IN ACCORDANCE WITH THE REQUIREMENTS OF THE HOWARD SOIL CONSERVATION DISTRICT.

STATE OF MARYLAND
PROFESSIONAL ENGINEER
No. 17899
DATE: 8/19/90

DEVELOPER'S CERTIFICATE
"I/WE CERTIFY THAT ALL DEVELOPMENT AND CONSTRUCTION WILL BE DONE ACCORDING TO THIS PLAN OF DEVELOPMENT AND PLAN FOR EROSION AND SEDIMENT CONTROL AND THAT ALL RESPONSIBLE PERSONNEL INVOLVED IN THE CONSTRUCTION PROJECT WILL HAVE A CERTIFICATE OF ATTENDANCE AT A DEPARTMENT OF NATURAL RESOURCES APPROVED TRAINING PROGRAM FOR THE CONTROL OF SEDIMENT AND EROSION BEFORE BEGINNING THE PROJECT. I ALSO AUTHORIZE PERIODIC ONSITE INSPECTION BY THE HOWARD SOIL CONSERVATION DISTRICT OR THEIR AUTHORIZED AGENTS, AS ARE DEEMED NECESSARY."

DATE: 8/19/90
SIGNATURE OF DEVELOPER: [Signature]

REVIEWED FOR HOWARD SOIL CONSERVATION DISTRICT AND MEETS TECHNICAL REQUIREMENTS
DATE: 1/19/90
U.S. SOIL CONSERVATION SERVICE

THIS DEVELOPMENT IS APPROVED FOR EROSION AND SEDIMENT CONTROL BY THE HOWARD SOIL CONSERVATION DISTRICT.
DATE: 4/19/90
SIGNATURE: [Signature]

APPROVED: DEPT. OF PLANNING AND ZONING
DATE: 3/5/90
PLANNING DIRECTOR: [Signature]

CHIEF, DIVISION OF COMMUNITY PLANNING & LAND DEVELOPMENT

APPROVED: HOWARD COUNTY HEALTH DEPARTMENT FOR PRIVATE WATER AND SEWERAGE SYSTEMS
DATE: 2-10-90
HEALTH OFFICER: [Signature]

APPROVED: DEPARTMENT OF PUBLIC WORKS FOR PRIVATE WATER & SEWER AND STORM DRAINAGE SYSTEMS AND ROADS.
DATE: 2/7/90
DIRECTOR, PUBLIC WORKS: [Signature]

CHIEF, BUREAU OF ENGINEERING

PROPERTY/SUBDIVISION: EAGLE POINT LANDING CLARKSVILLE KINGDOM HALL
SECTION/AREA: 17
LOT NO.: 17
PLAT NO./L.F.: 2075
BLOCK NO.: 21
ZONE: R
TAX/ZONE: 2B
ELEC. DIST.: 5
CENSUS TR.: 6031
WATER CODE: N/A
SEWER CODE: N/A

SITE DEVELOPMENT PLAN
CLARKSVILLE KINGDOM HALL
LOT 17
EAGLE POINT LANDING
TAX MAP 28 PARCEL 46
ELECT. DIST. 5 HOWARD CO., MD.
AUG. 17 1989 SHEET 2 OF 6
SDP 90-48

- SEQUENCE OF CONSTRUCTION:
1. OBTAIN GRADING PERMIT
 2. NOTIFY HOWARD CO. OFFICE OF INSPECTION AND PERMITS (992-2437) 24 HOURS PRIOR TO STARTING WORK.
 3. INSTALL STABILIZED CONSTRUCTION ENTRANCE.
 4. INSTALL 36 INCH R.C.C.P. AND CHANNELS A, B AND C. STABILIZE IMMEDIATELY.
 5. INSTALL REMAINING SEDIMENT AND EROSION CONTROL MEASURES.
 6. ROUGH GRADE SITE.
 7. BEGIN BUILDING CONSTRUCTION.
 8. INSTALL SEPTIC SYSTEM.
 9. FINE GRADE SITE.
 10. PLACE SUB-BASE MATERIAL ON AREAS TO BE PAVED.
 11. STABILIZE REMAINDER OF SITE PER PERMANENT SEEDING PROCEDURES.
 12. PAVE PARKING LOT.
 13. REMOVE SEDIMENT AND EROSION CONTROL MEASURES AND STABILIZE THOSE AREAS.

SEDIMENT CONTROL NOTES

- 1) Minimum of 24 hours notice must be given to the Howard County Office of Inspection and Permits prior to the start of any construction. (992-2437)
- 2) All vegetative and structural practices are to be installed according to the provisions of this plan and are to be in accordance with the 1983 MARYLAND STANDARDS AND SPECIFICATIONS FOR SOIL EROSION AND SEDIMENT CONTROL.
- 3) Following initial soil disturbance or redistribution, permanent or temporary stabilization shall be completed within a) 7 calendar days for all perimeter sediment control structures, ditches, perimeter ditches and all slopes greater than 3:1, b) 14 days for all other disturbed or graded areas on the project site.
- 4) All sediment traps/basins shall be fenced and warning signs shall be posted in accordance with No. 1, Chapter 12, of the HOWARD COUNTY DESIGN MANUAL, Storm Drainage.
- 5) All disturbed areas must be stabilized within the time period specified above in accordance with the 1983 MARYLAND STANDARDS AND SPECIFICATIONS FOR SOIL EROSION AND SEDIMENT CONTROL for permanent seeding (Sec. 32) and (Sec. 34), temporary seeding (Sec. 30) and mulching (Sec. 32). Temporary stabilization with mulch alone can only be done when recommended seeding rates do not allow for proper germination and establishment of grasses.
- 6) All sediment control structures are to remain in place and are to be maintained in operative condition until permission for their removal has been obtained from the Howard County Sediment Control Inspector.
- 7) Site Analysis:

Total Area of Site	3.34 Acres
Area Disturbed	2.75 Acres
Area to be seeded or paved	2.75 Acres
Area to be vegetatively stabilized	0.59 Acres
Total Cut	2500 Cu. Yds.
Total Fill	2500 Cu. Yds.
Off-site water/borrow area location	
- 8) Any sediment control practice which is disturbed by grading activity for placement of utilities must be repaired on the same day of disturbance.
- 9) Additional sediment controls may be provided, if deemed necessary by the Howard County DPW sediment control inspector.
- 10) On all sites with disturbed areas in excess of 2 acres, approval of the inspection agency shall be requested upon completion of installation of perimeter ditches and sediment controls, but before proceeding with any other earth disturbance or grading. Other building or grading inspection approvals may not be authorized until this initial approval by the inspection agency has been obtained.

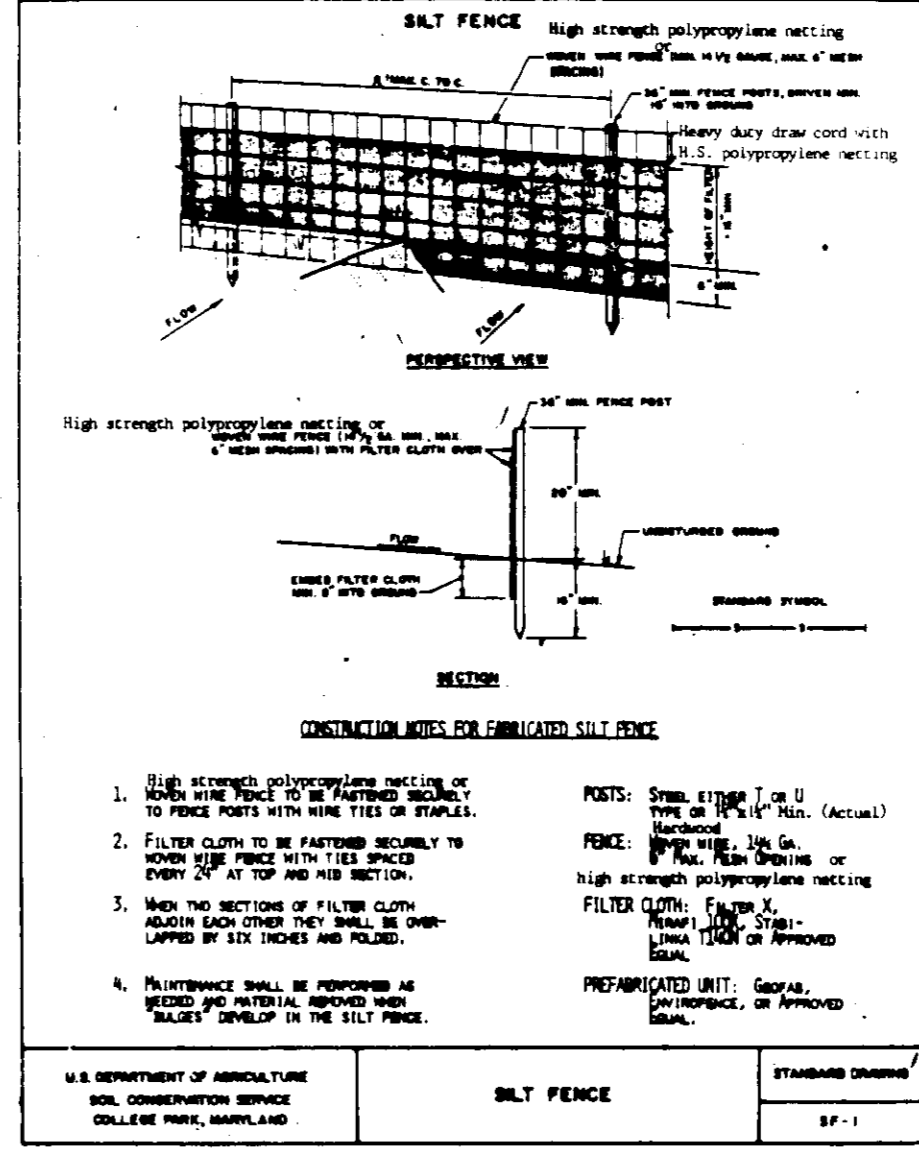
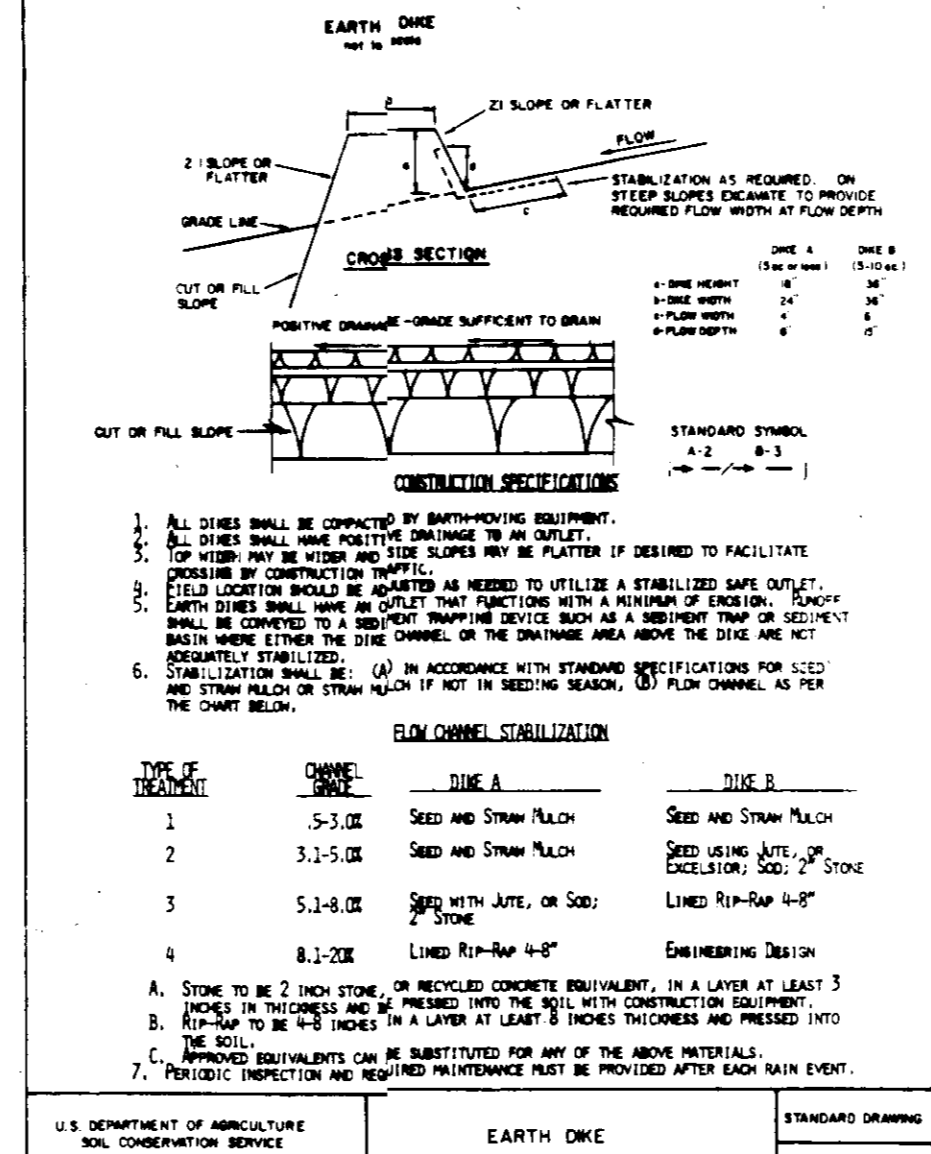
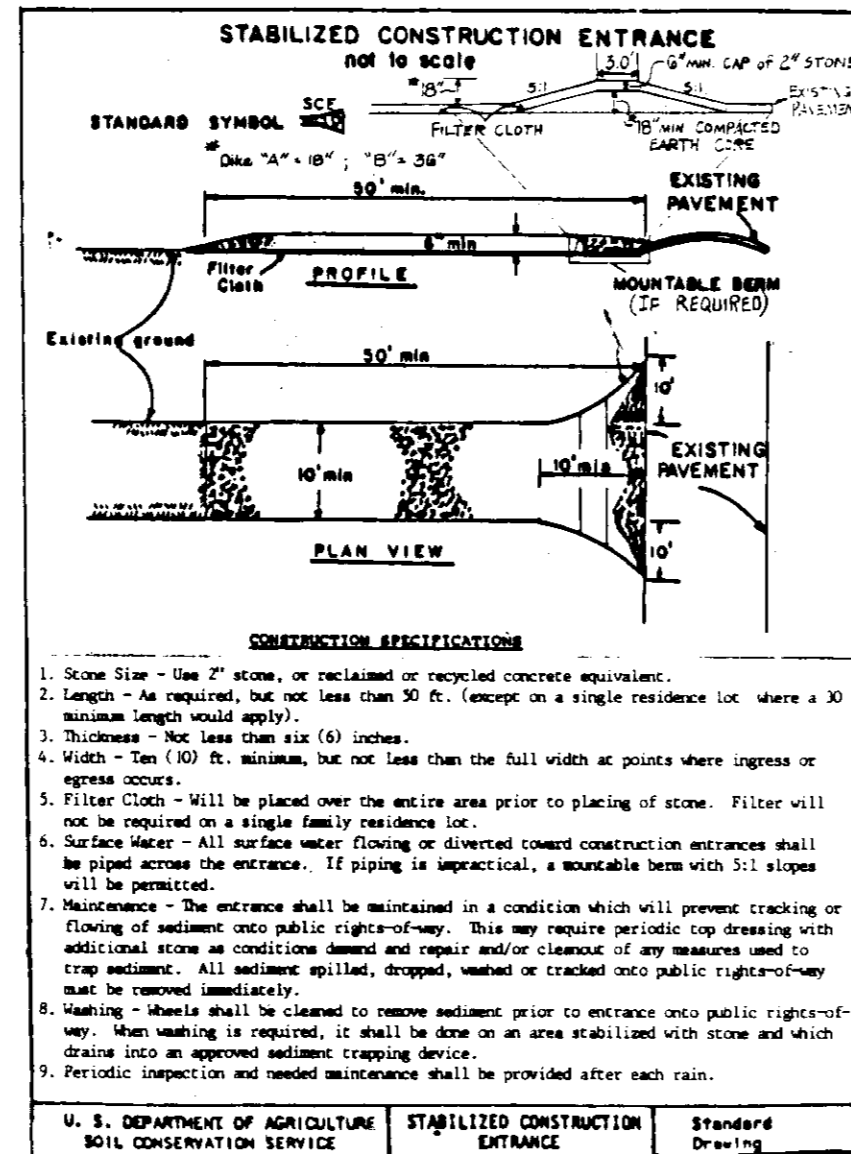

PERMANENT SEEDING NOTES

Apply to graded or cleared areas not subject to immediate further disturbance where a permanent long-lived vegetative cover is needed.

Seeding Preparation: Loosen upper three inches of soil by raking, discing or other acceptable means before seeding.

Soil Amendments: In lieu of soil test recommendations, use one of the following schedules:

- 1) Preferred - Apply 2 tons per acre dolomitic limestone (92 lb/1000 sq ft) and 600 lb per acre 10-10-10 fertilizer (14 lb/1000 sq ft) before seeding. Harrow or disc into upper three inches of soil. At time of seeding, apply 400 lbs per acre (200 gal) ureaform fertilizer (9 lb/1000 sq ft).
- 2) Acceptable - Apply 2 tons per acre dolomitic limestone (92 lb/1000 sq ft) and 1000 lb per acre 10-10-10 fertilizer (23 lb/1000 sq ft) before seeding. Harrow or disc into upper three inches of soil.

Seeding: For the periods March 1 thru April 30, and August 1 thru October 15, seed with 50 lbs per acre (1.4 lb/1000 sq ft) of Kentucky 31 Tall Fescue. For the period May 1 thru July 31, seed with 50 lbs Kentucky 31 Tall Fescue per acre and 2 lbs per acre (.05 lb/1000 sq ft) of seeding lovegrass. During the period of October 16 thru February 28, protect site by: Option (1) 2 tons per acre of well anchored straw mulch and seed as soon as possible in the spring. Option (2) seed with 50 lbs/acre Kentucky 31 Tall Fescue and mulch with 2 tons/acre well anchored straw.

Mulching: Apply 1 1/2 to 2 tons per acre (70 to 90 lb/1000 sq ft) of unrotted small grain straw immediately after seeding. Anchor mulch immediately after application using mulch anchoring tool or 28 gal per acre (8 gal/1000 sq ft) of emulsified asphalt on flat areas. On slopes 8 feet or higher, use 348 gal per acre (8 gal/1000 sq ft) for anchoring.

Maintenance: Inspect all seeded areas and make needed repairs, replacements and transplanting.

TEMPORARY SEEDING NOTES

Apply to graded or cleared areas likely to be redisturbed where a short-term vegetative cover is needed.

Seeding Preparation: Loosen upper three inches of soil by raking, discing or other acceptable means before seeding.

Soil Amendments: Apply 60 lbs per acre 10-10-10 fertilizer (14 lb/1000 sq ft).

Seeding: For periods March 1 thru April 30 and from August 15 thru November 15, seed with 75 bushel per acre of annual ryegrass (2.2 lb/1000 sq ft). For the period May 1 thru August 14, seed with 3 lbs per acre of weeping lovegrass (.07 lb/1000 sq ft). For the period November 16 thru February 28, protect site by applying 2 tons per acre of well anchored straw mulch and seed as soon as possible in the spring, or use sod.

Mulching: Apply 1 1/2 to 2 tons per acre (70 to 90 lb/1000 sq ft) of unrotted small grain straw immediately after seeding. Anchor mulch immediately after application using mulch anchoring tool or 28 gal per acre (8 gal/1000 sq ft) of emulsified asphalt on flat areas. On slopes 8 feet or higher, use 348 gal per acre (8 gal/1000 sq ft) for anchoring.

Refer to the 1983 MARYLAND STANDARDS AND SPECIFICATIONS FOR SOIL EROSION AND SEDIMENT CONTROL for rate and methods not covered.

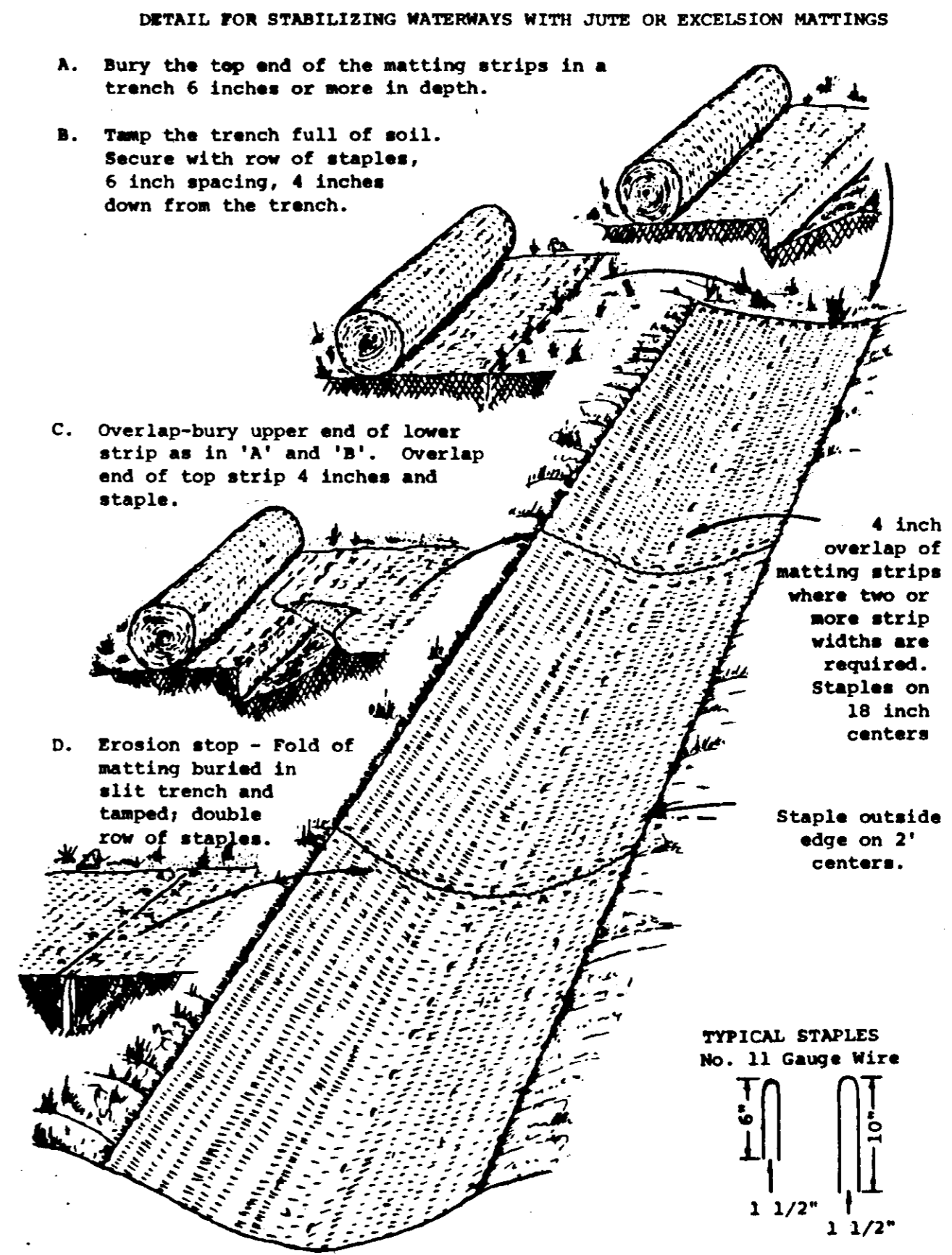
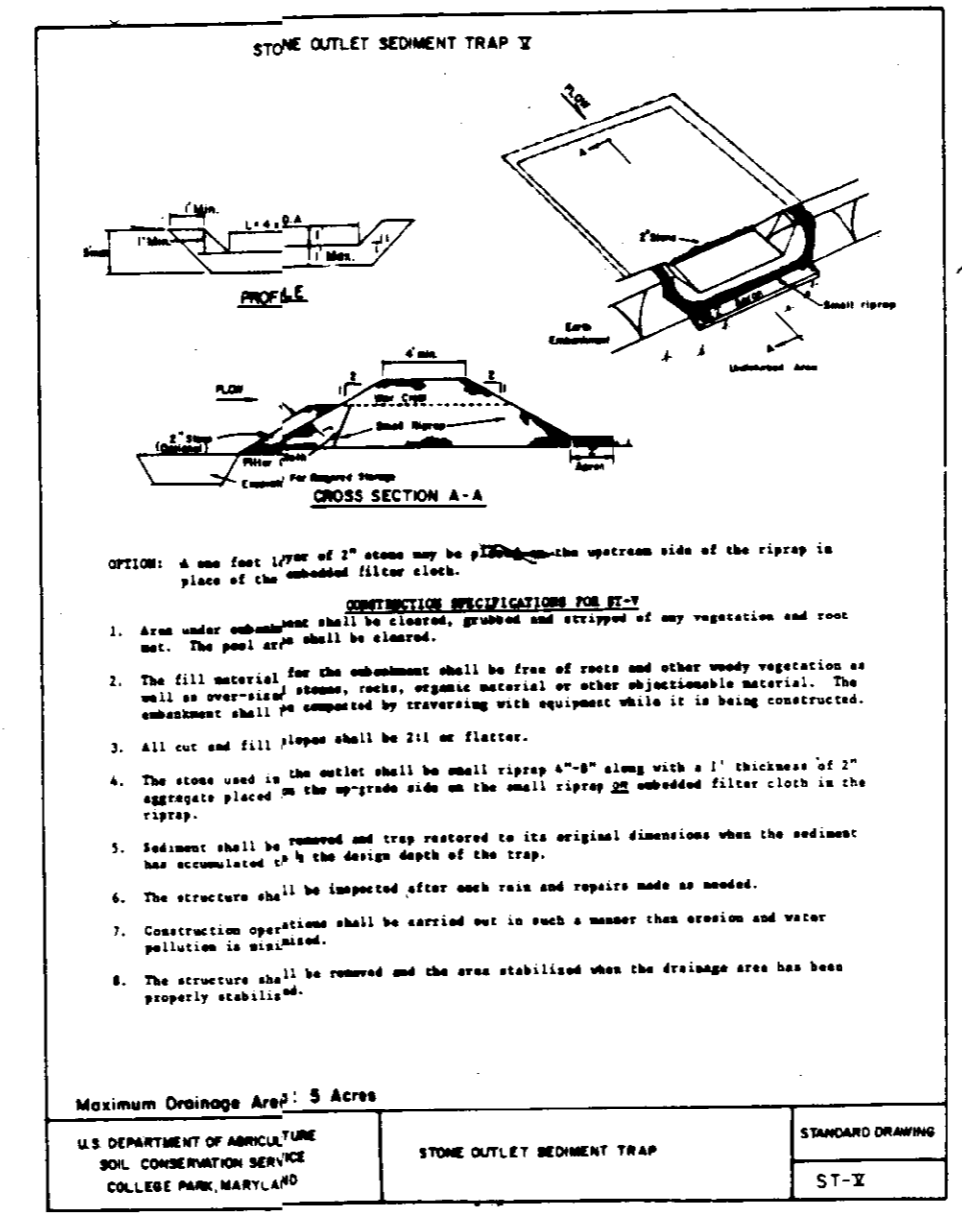

17 5475 TENOAKS ROAD
LOT NO. STREET ADDRESS
ADDRESS CHART



FISHER, COLLINS & CARTER, INC.
CIVIL ENGINEERS & LAND SURVEYORS
8388 COURT AVENUE
ELLCOTT CITY, MARYLAND 21043
(301) 461-2855

ENGINEER'S CERTIFICATE
I HEREBY CERTIFY THAT THIS PLAN FOR EROSION AND SEDIMENT CONTROL REPRESENTS A PRACTICAL AND WORKABLE PLAN BASED ON MY PERSONAL KNOWLEDGE OF THE SITE CONDITIONS AND THAT IT WAS PREPARED IN ACCORDANCE WITH THE REQUIREMENTS OF THE HOWARD SOIL CONSERVATION DISTRICT.

STATE OF MARYLAND
DEPARTMENT OF PUBLIC WORKS
REGISTERED PROFESSIONAL ENGINEER
No. 7320
8/11/89
DATE

DEVELOPER'S CERTIFICATE
I/WE CERTIFY THAT ALL DEVELOPMENT AND CONSTRUCTION WILL BE DONE ACCORDING TO THIS PLAN OF DEVELOPMENT AND PLAN FOR EROSION AND SEDIMENT CONTROL AND THAT ALL RESPONSIBLE PERSONNEL INVOLVED IN THE CONSTRUCTION PROJECT WILL HAVE A CERTIFICATE OF ATTENDANCE AT A DEPARTMENT OF NATURAL RESOURCES APPROVED TRAINING PROGRAM FOR THE CONTROL OF SEDIMENT AND EROSION BEFORE BEGINNING THE PROJECT. I ALSO AUTHORIZE PERIODIC ONSITE INSPECTION BY THE HOWARD SOIL CONSERVATION DISTRICT OR THEIR AUTHORIZED AGENTS, AS ARE DEEMED NECESSARY.

STATE OF MARYLAND
DEPARTMENT OF PUBLIC WORKS
REGISTERED PROFESSIONAL ENGINEER
No. 7320
8/11/89
DATE

REVIEWED FOR HOWARD SOIL CONSERVATION DISTRICT AND MEETS TECHNICAL REQUIREMENTS

John L. Roberts 1/19/90
DATE
HOWARD SOIL CONSERVATION DISTRICT

APPROVED: DEPT. OF PLANNING AND ZONING

W. J. ... 2-5-90
DATE
PLANNING DIRECTOR

W. J. ... 2/21/89
DATE
CHIEF, DIVISION OF COMMUNITY PLANNING & LAND DEVELOPMENT

APPROVED: HOWARD COUNTY HEALTH DEPARTMENT FOR PRIVATE WATER AND SEWERAGE SYSTEMS

John ... 2-11-90
DATE
HEALTH OFFICER

APPROVED: DEPARTMENT OF PUBLIC WORKS FOR PRIVATE WATER & SEWER AND STORM DRAINAGE SYSTEMS AND ROADS.

John ... 2/7/90
DATE
DIRECTOR, PUBLIC WORKS

John ... 1-29-90
DATE
CHIEF, BUREAU OF ENGINEERING

PROPERTY/SUBDIVISION: EAGLE POINT LANDING
CLARKSVILLE KINGDOM HALL
PLAT NO./L.F. BLOCK NO. ZONE TAX/ZONE ELEC. DIST. CENSUS TR.
3075 21 R 26 3 6051
WATER CODE: N/A SEWER CODE: N/A

SEDIMENT CONTROL PLAN
CLARKSVILLE KINGDOM HALL
LOT 17
EAGLE POINT LANDING
TAX MAP 28 PARCEL 46
ELECT. DIST. 5 HOWARD CO., MO.
AUG. 17 1989 SHEET 4 OF 6

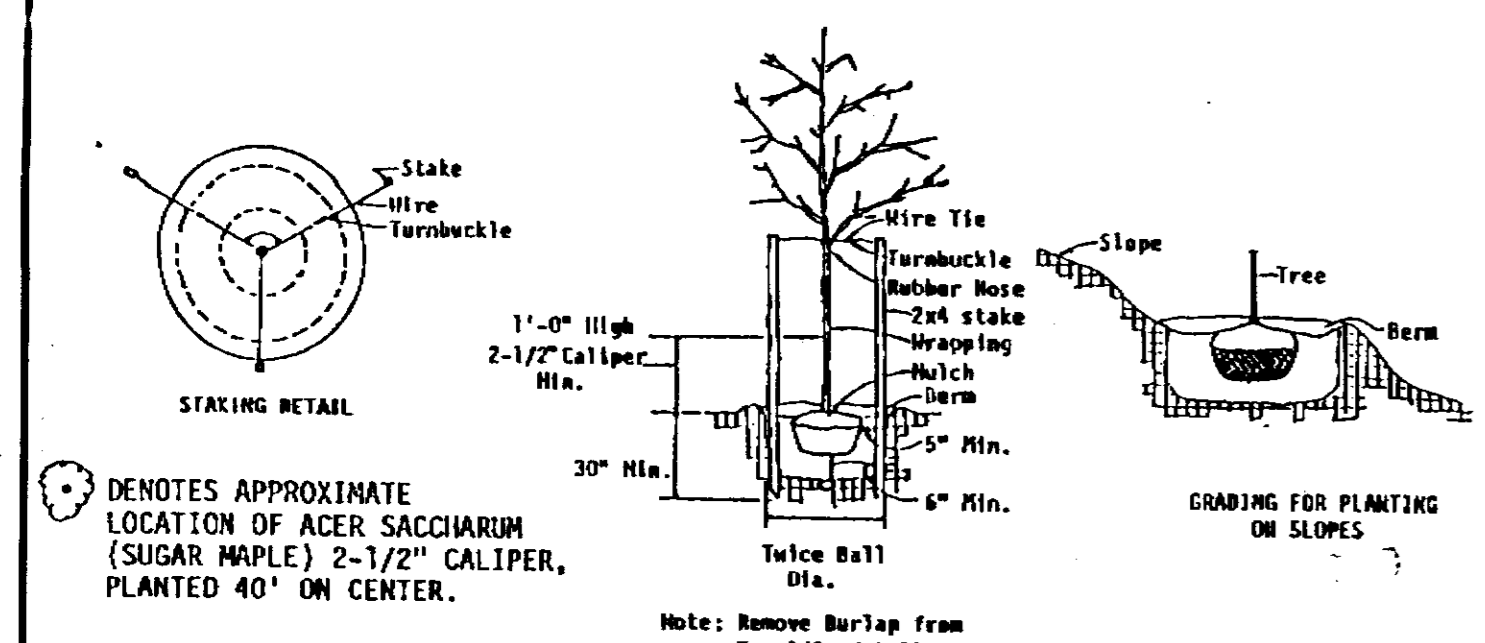
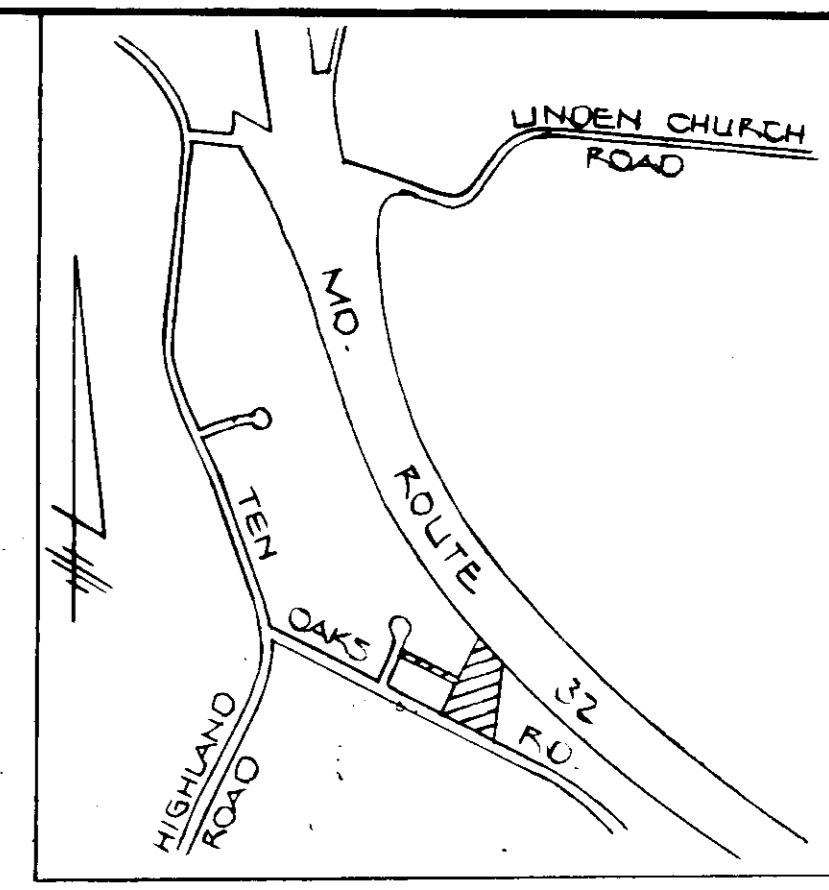
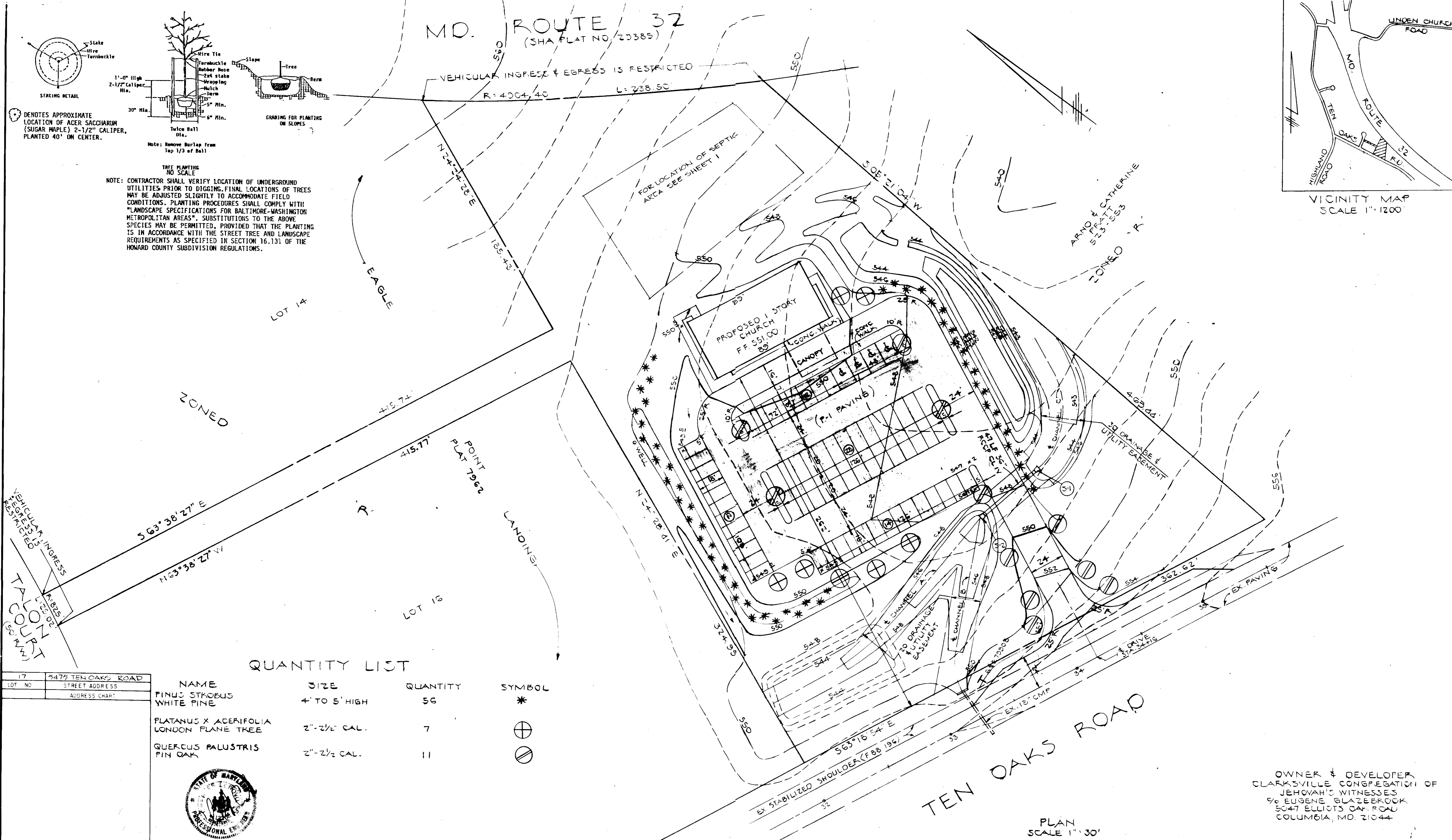

DENOTES APPROXIMATE LOCATION OF ACER SACCHARUM (SUGAR MAPLE) 2-1/2" CALIPER, PLANTED 40' ON CENTER.
 Note: Remove Burlap from Top 1/3 of Ball
 TREE PLANTING NO SCALE
 NOTE: CONTRACTOR SHALL VERIFY LOCATION OF UNDERGROUND UTILITIES PRIOR TO DIGGING. FINAL LOCATIONS OF TREES MAY BE ADJUSTED SLIGHTLY TO ACCOMMODATE FIELD CONDITIONS. PLANTING PROCEDURES SHALL COMPLY WITH "LANDSCAPE SPECIFICATIONS FOR BALTIMORE-WASHINGTON METROPOLITAN AREAS". SUBSTITUTIONS TO THE ABOVE SPECIES MAY BE PERMITTED, PROVIDED THAT THE PLANTING IS IN ACCORDANCE WITH THE STREET TREE AND LANDSCAPE REQUIREMENTS AS SPECIFIED IN SECTION 16.131 OF THE HOWARD COUNTY SUBDIVISION REGULATIONS.

QUANTITY LIST

LOT NO	STREET ADDRESS	NAME	SIZE	QUANTITY	SYMBOL
17	5475 TEN OAKS ROAD	PINUS STROBUS WHITE PINE	4' TO 5' HIGH	56	*
		PLATANUS X ACERIFOLIA LONDON PLANE TREE	2"-2 1/2" CAL.	7	⊕
		QUERCUS PALUSTRIS PIN OAK	2"-2 1/2" CAL.	11	⊙



OWNER & DEVELOPER
 CLARKSVILLE CONGREGATION OF
 JEHOVAH'S WITNESSES
 % EUGENE GLAZEBROOK
 5047 ELLIOTS OAK ROAD
 COLUMBIA, MD. 21044

PLAN
 SCALE 1"=30'

FISHER, COLLINS & CARTER, INC. CIVIL ENGINEERS & LAND SURVEYORS 8388 COURT AVENUE ELLICOTT CITY, MARYLAND 21043 (301) 461-2855	ENGINEER'S CERTIFICATE I HEREBY CERTIFY THAT THIS PLAN FOR EROSION AND SEDIMENT CONTROL REPRESENTS A PRACTICAL AND WORKABLE PLAN BASED ON MY PERSONAL KNOWLEDGE OF THE SITE CONDITIONS AND THAT IT WAS PREPARED IN ACCORDANCE WITH THE REQUIREMENTS OF THE HOWARD SOIL CONSERVATION DISTRICT. SIGNATURE OF ENGINEER DATE 8/19/89	DEVELOPER'S CERTIFICATE I/WE CERTIFY THAT ALL DEVELOPMENT AND CONSTRUCTION WILL BE DONE ACCORDING TO THIS PLAN OF DEVELOPMENT AND PLAN FOR EROSION AND SEDIMENT CONTROL AND THAT ALL RESPONSIBLE PERSONNEL INVOLVED IN THE CONSTRUCTION PROJECT WILL HAVE A CERTIFICATE OF ATTENDANCE AT A DEPARTMENT OF NATURAL RESOURCES APPROVED TRAINING PROGRAM FOR THE CONTROL OF SEDIMENT AND EROSION BEFORE BEGINNING THE PROJECT. I ALSO AUTHORIZE PERIODIC ON-SITE INSPECTION BY THE HOWARD SOIL CONSERVATION DISTRICT OR THEIR AUTHORIZED AGENTS, AS ARE DEEMED NECESSARY. SIGNATURE OF DEVELOPER DATE 8/19/89	REVIEWED FOR HOWARD SOIL CONSERVATION DISTRICT AND MEETS TECHNICAL REQUIREMENTS. SOIL CONSERVATION SERVICE DATE 1/19/90 APPROVED:	APPROVED: DEPT. OF PLANNING AND ZONING PLANNING DIRECTOR DATE 2-5-90 CHIEF, DIVISION OF COMMUNITY PLANNING & LAND DEVELOPMENT	APPROVED: DEPARTMENT OF PUBLIC WORKS FOR PRIVATE WATER & SEWER AND STORM DRAINAGE SYSTEMS AND ROADS. DIRECTOR, PUBLIC WORKS DATE 2/7/90	LANDSCAPE PLAN CLARKSVILLE KINGDOM HALL LOT 17 EAGLE POINT LANDING TAX MAP 28 PARCEL 46 ELECT. DIST. 5 HOWARD CO., MD. AUG. 17 1989 SHEET 5 OF 6
	APPROVED: HOWARD COUNTY HEALTH DEPARTMENT FOR PRIVATE WATER AND SEWERAGE SYSTEMS HEALTH OFFICER DATE 2-11-90	PROPERTY/SUBDIVISION EAGLE POINT LANDING CLARKSVILLE KINGDOM HALL SECTION/AREA LOT NO 17 PLAT NO./L.F. 9075 BLOCK NO. 21 ZONE R 28 TAX/ZONE 5 ELEC. DIST. 5 CENSUS TR. 6021 WATER CODE N/A SEWER CODE N/A				

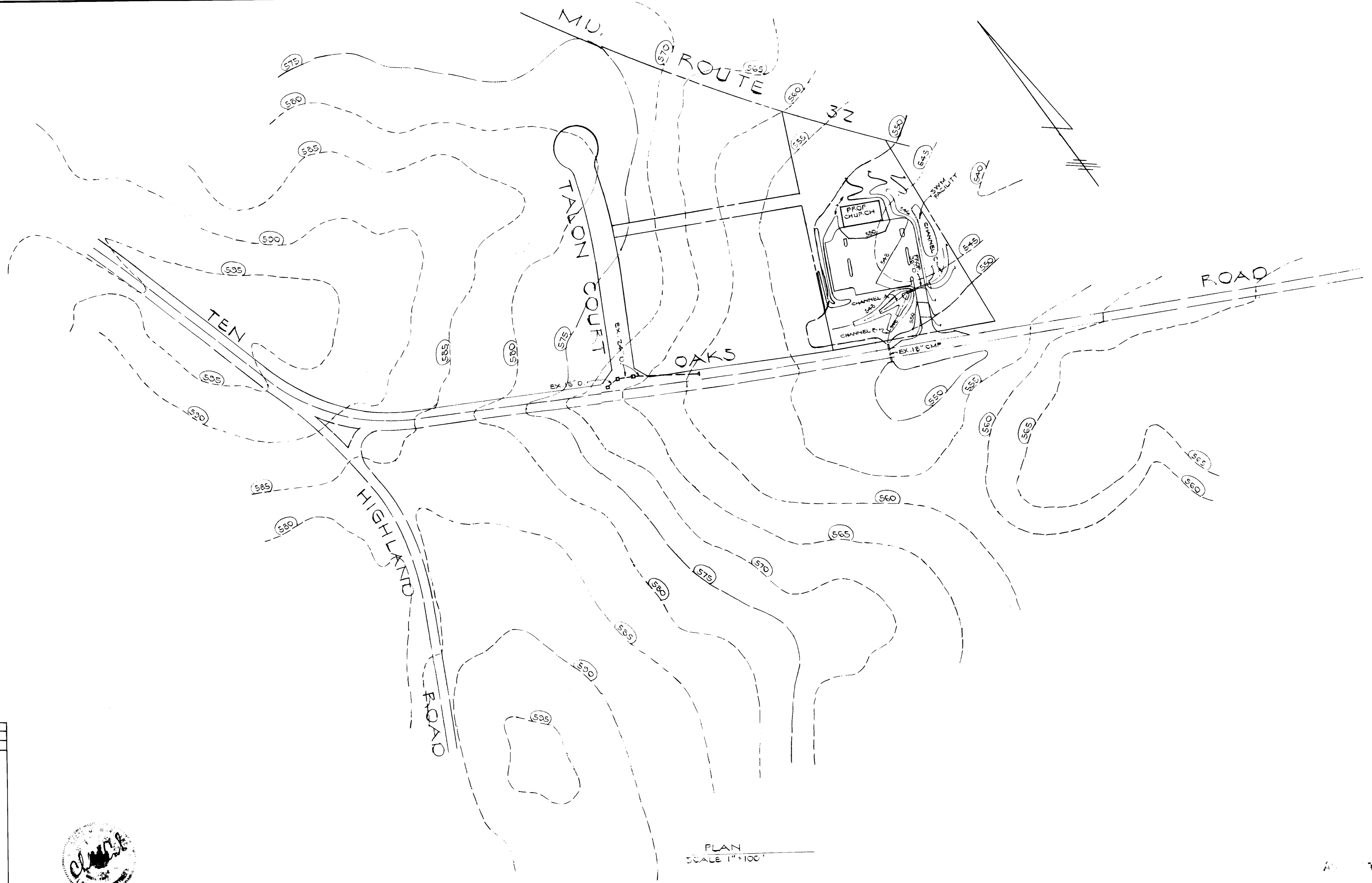

17	5475 TELL OAKS ROAD
LOT NO.	STREET ADDRESS
	ADDRESS CHART



PLAN
SCALE 1"=100'

FISHER, COLLINS & CARTER, INC.
CIVIL ENGINEERS & LAND SURVEYORS
8388 COURT AVENUE
ELLCOTT CITY, MARYLAND 21043
(301) 461-2855

ENGINEER'S CERTIFICATE
I HEREBY CERTIFY THAT THIS PLAN FOR EROSION AND SEDIMENT CONTROL REPRESENTS A PRACTICAL AND WORKABLE PLAN BASED ON MY PERSONAL KNOWLEDGE OF THE SITE CONDITIONS AND THAT IT WAS PREPARED IN ACCORDANCE WITH THE REQUIREMENTS OF THE HOWARD SOIL CONSERVATION DISTRICT.

[Signature]
SIGNATURE OF ENGINEER
8/19/89
DATE

DEVELOPER'S CERTIFICATE
"I/WE CERTIFY THAT ALL DEVELOPMENT AND CONSTRUCTION WILL BE DONE ACCORDING TO THIS PLAN OF DEVELOPMENT AND PLAN FOR EROSION AND SEDIMENT CONTROL AND THAT ALL RESPONSIBLE PERSONNEL INVOLVED IN THE CONSTRUCTION PROJECT WILL HAVE A CERTIFICATE OF ATTENDANCE AT A DEPARTMENT OF NATURAL RESOURCES APPROVED TRAINING PROGRAM FOR THE CONTROL OF SEDIMENT AND EROSION BEFORE BEGINNING THE PROJECT. I ALSO AUTHORIZE PERIODIC ON-SITE INSPECTION BY THE HOWARD SOIL CONSERVATION DISTRICT OR THEIR AUTHORIZED AGENTS, AS ARE DEEMED NECESSARY."

[Signature]
SIGNATURE OF DEVELOPER
8/19/89
DATE

REVIEWED FOR HOWARD SOIL CONSERVATION DISTRICT AND MEETS TECHNICAL REQUIREMENTS

[Signature] 1/19/90
DATE
SOIL CONSERVATION SERVICE

THIS DEVELOPMENT IS APPROVED FOR EROSION AND SEDIMENT CONTROL BY THE HOWARD SOIL CONSERVATION DISTRICT.

APPROVED:

[Signature] 1/19/90
DATE
HOWARD SOIL CONSERVATION DISTRICT

APPROVED DEPT. OF PLANNING AND ZONING

[Signature] 2.5.90
DATE
PLANNING DIRECTOR

[Signature] 2/22/90
DATE
CHIEF, DIVISION OF COMMUNITY PLANNING & LAND DEVELOPMENT

APPROVED: HOWARD COUNTY HEALTH DEPARTMENT FOR PRIVATE WATER AND SEWERAGE SYSTEMS

[Signature] 2.11.90
DATE
HEALTH OFFICER

APPROVED: DEPARTMENT OF PUBLIC WORKS FOR PRIVATE WATER & SEWER AND STORM DRAINAGE SYSTEMS AND ROADS.

[Signature] 2/6/90
DATE
DIRECTOR, PUBLIC WORKS

[Signature] 1.25.90
DATE
CHIEF, BUREAU OF ENGINEERING

PROPERTY/SUBDIVISION	SECTION/AREA	LOT NO.
EAGLE POINT LANDING		17
CLARKSVILLE KINGDOM HALL		
PLAT NO./L.F.	BLOCK NO.	ZONE
9075	21	R
TAX/ZONE	ELEC. DIST.	CENSUS TR.
28	3	6051
WATER CODE	N/A	SEWER CODE
		N/A

DRAINAGE AREA & SOILS MAP
CLARKSVILLE KINGDOM HALL
LOT 17
EAGLE POINT LANDING
TAX MAP 28 PARCEL 46
ELECT. DIST. 5 HOWARD CO., MD.
AUG. 17 1989 SHEET 6 OF 6
SOP 130-48