

- SEDIMENT CONTROL NOTES**
- A minimum of 24 hours notice must be given to the Howard County Office of Inspection and Permit prior to the start of any construction (892-2437).
 - All vegetative and structural practices are to be installed according to the provisions of this plan and are to be in conformance with the 1983 MARYLAND STANDARDS AND SPECIFICATIONS FOR SOIL EROSION AND SEDIMENT CONTROL.
 - Following initial soil disturbance or disturbances, permanent or temporary stabilization shall be completed within: a) 7 calendar days for all perimeter sediment control structures, ditches, perimeter slopes and all slopes greater than 3:1, b) 14 days as to all other disturbed or graded areas on the project site.
 - All sediment traps/basins shown must be fenced and warning signs posted around their perimeter in accordance with Vol. 1, Chapter 12, of the HOWARD COUNTY DESIGN MANUAL, Storm Drainage.
 - All disturbed areas must be stabilized within the time period specified above in accordance with the 1983 MARYLAND STANDARDS AND SPECIFICATIONS FOR SOIL EROSION AND SEDIMENT CONTROL for permanent seeding (Sec. 51) and (Sec. 54), temporary seeding (Sec. 50) and mulching (Sec. 52). Temporary stabilization with mulch alone can only be done when recommended seeding rates do not allow for proper germination and establishment of grasses.
 - All sediment control structures are to remain in place and are to be maintained in operative condition until permission for their removal has been obtained from the Howard County Sediment Control Inspector.
 - Site Analysis:

Total Area of Site	3.1 acres
Area to be roofed or paved	2.8 acres
Area to be vegetatively stabilized	0.3 acres
Total Fill	2.5 cu. yds.
 - Any sediment control practice which is disturbed by grading activity for placement of utilities must be repaired on the same day of disturbance.
 - Additional sediment controls must be provided, if deemed necessary by the Howard County DPW sediment control inspector.
 - Site grading will begin only after all perimeter sediment control measures have been installed and are in a functioning condition.
 - Sediment will be removed from traps when its depth reaches the clean out elevation shown on the plans.

Seeding: For periods March 1 thru April 30, and August 15 thru November 15, seed with 140 lbs. per acre of annual ryegrass (3.2 lbs./1000 sq. ft.). For the period May 1 thru August 14, seed with 3 lbs. per acre of weeping lovegrass (0.3 lbs./1000 sq. ft.). For the period November 15 thru February 28, protect site by applying 2 tons per acre of well anchored straw mulch and seed as soon as possible in the spring.

Mulching: Apply 1-1/2 to 2 tons per acre (70 to 90 lbs./1000 sq. ft.) of unrotted small grain straw immediately after seeding. Another mulch immediately after application using mulch spreading tool or 218 gal. per acre (5 gal./1000 sq. ft.) of emulsified asphalt on flat areas. On slopes 2 feet or higher, use 348 gal. per acre (8 gal./1000 sq. ft.) for anchoring.

Maintenance: Inspect all seeded areas and make needed repairs, replacements and reseedings.

PERMANENT SEEDING NOTES

Apply to graded or cleared areas not subject to immediate further disturbances where a permanent long-lived vegetative cover is needed.

Seedbed Preparation: Loosen upper three inches of soil by raking, disking or other acceptable means before seeding. If NOT PREVIOUSLY LOCATED.

Soil Amendments: Apply 0-20-20 fertilizer at the rate of 600 lbs. per acre. Narrow or deep lines of 0-20-20 fertilizer into the soil to a minimum depth of 3". Low or high maintenance areas will be dropped and leveled. At the time of seeding, apply 400 lbs. of 30-0-0 uniform fertilizer and 500 lbs. of 10-20-20 or equivalent fertilizer per acre.

Seeding: For the periods March 1 thru April 30, and August 1 thru October 15, seed with 40 lbs. per acre (1 lb./1000 sq. ft.) of a mixture of certified "Marion" Kentucky bluegrass, common Kentucky bluegrass @ 40 lbs. per acre (1 lb./1000 sq. ft.) and Red Fescue, Pennlawn or Jamestown @ 20 lbs. per acre (0.5 lb./1000 sq. ft.) for the period May 1 thru July 31, seed with 40-20-20 lb. of weeping lovegrass. During the period of October 16 thru February 28, protect site by (Option 1) 2 tons per acre of well-anchored straw mulch and seed as soon as possible in the spring. (Option 2) use seed. (Option 3) Seed with 40-20-20 lb. specified above and mulch with 2 tons/acre well-anchored straw.

Mulching: Apply 1-1/2 to 2 tons per acre (70 to 90 lbs./1000 sq. ft.) of unrotted small grain straw immediately after seeding. Another mulch immediately after application using mulch anchoring tool or 218 gallons per acre (5 gal./1000 sq. ft.) of emulsified asphalt on flat areas. On slopes 2 feet or higher, use 348 gallons per acre (8 gal./1000 sq. ft.) for anchoring.

Maintenance: Inspect all seeded areas and make needed repairs, replacements and reseedings.

TEMPORARY SEEDING NOTES

Apply to graded or cleared areas likely to be redisturbed where a short-term vegetative cover is needed.

Seedbed Preparation: Loosen upper three inches of soil by raking, disking or other acceptable means before seeding. If NOT PREVIOUSLY LOCATED.

Soil Amendments: Apply 600 lbs. per acre 10-10-10 fertilizer (1 lb./1000 sq. ft.) where soil is highly acidic, apply dolomitic limestone at the rate of 1 ton per acre.

AMT.	SYM.	NAME	PLANT LIST	HEIGHT	REMARKS
3	A	ACER RUBRUM	2-1/2" - 3" Cal.	13-15' HL.	FULL BRANCHING
2	Qc	QUERCUS COCCINEA	2-1/2" - 3" Cal.	12-14' HL.	FULL BRANCHING
3	Pc	PIRUS STRORBUS	2-1/2" - 3" Cal.	8-10' HL.	FULL BRANCHING
1	M	MALUS SNOW CLOUD	2-1/2" - 3" Cal.	8-10' HL.	UNSEEDED FULL HEAD
8	J	JUNIPERUS HORIZONTALIS	18-24" Spread		SPREAD PLUMBOSA
3	In	ILEX NELLE STEVENS	2-1/2" - 3" HL.		SPREAD PLUMBOSA

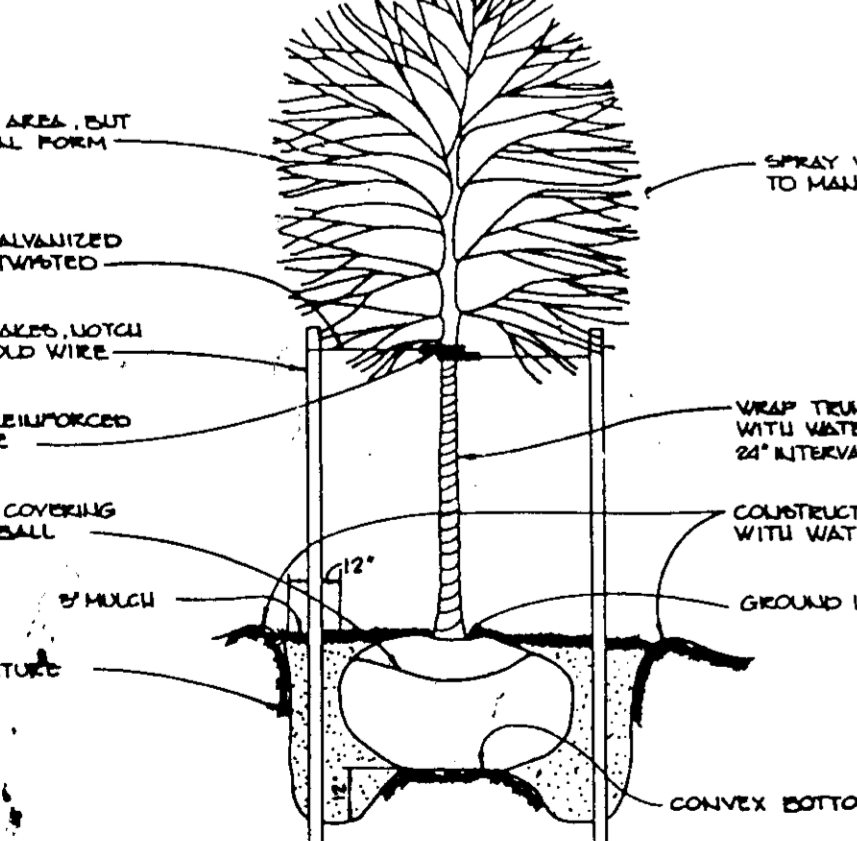

TREE PLANTING DETAIL
SCALE: 1" = 30'-0"

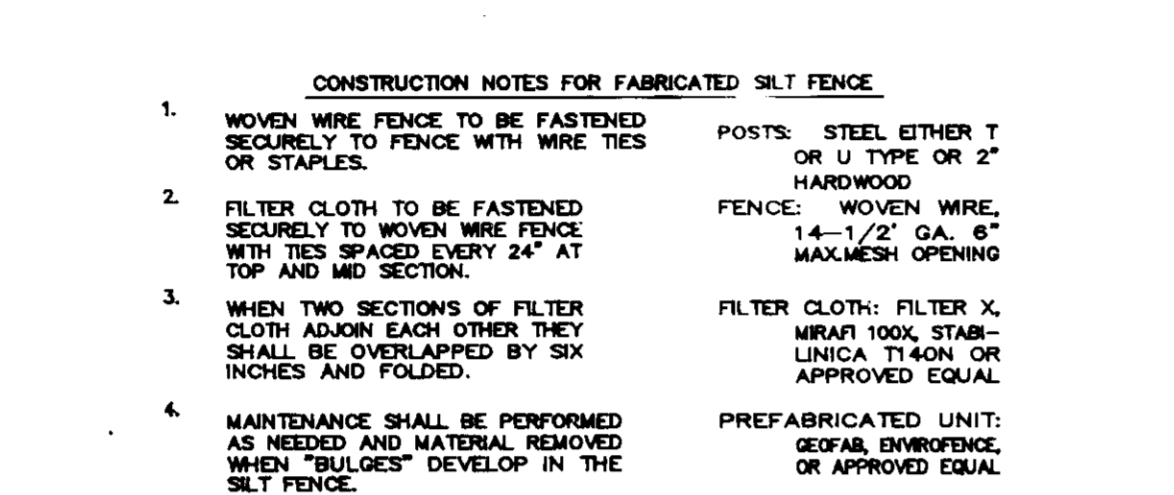
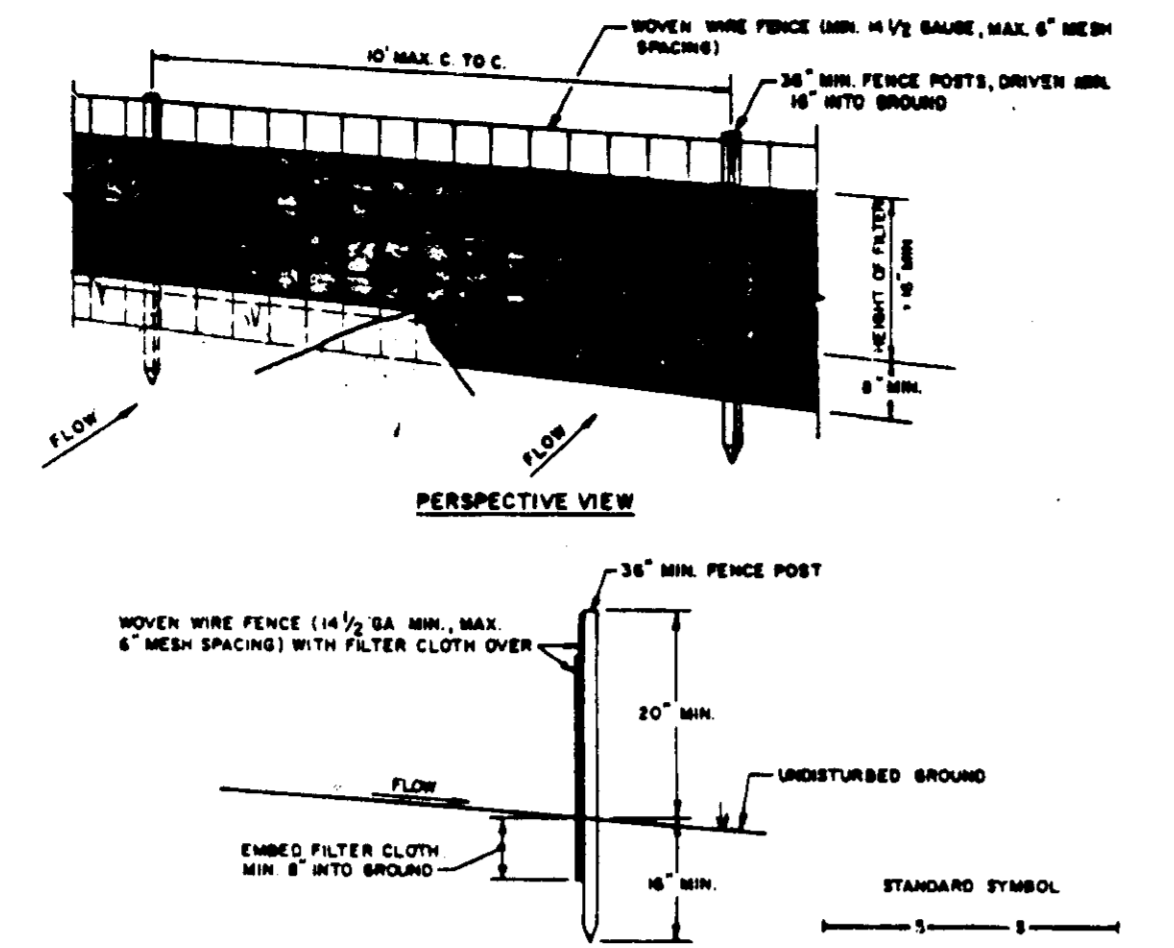

CONSTRUCTION NOTES FOR FABRICATED SILT FENCE

- WOVEN WIRE FENCE TO BE FASTENED SECURELY TO FENCE WITH WIRE TIES OR STAPLES.
- FILTER CLOTH TO BE FASTENED SECURELY TO WOVEN WIRE FENCE WITH TIES SPACED EVERY 24" AT TOP AND MID SECTION.
- WHEN TWO SECTIONS OF FILTER CLOTH ADJOIN EACH OTHER THEY SHALL BE OVERLAPPED BY SIX INCHES AND FOLDED.
- MAINTENANCE SHALL BE PERFORMED AS NEEDED AND MATERIAL REMOVED WHEN "BULGE" DEVELOPS IN THE SILT FENCE.

PERMANENT SEEDING NOTES

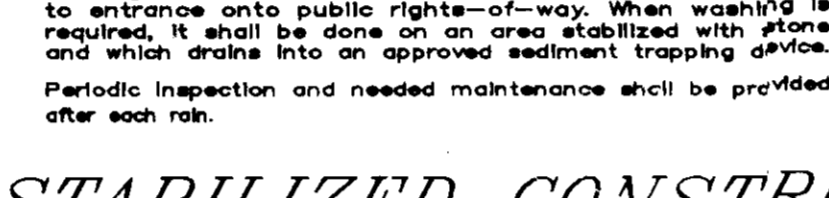
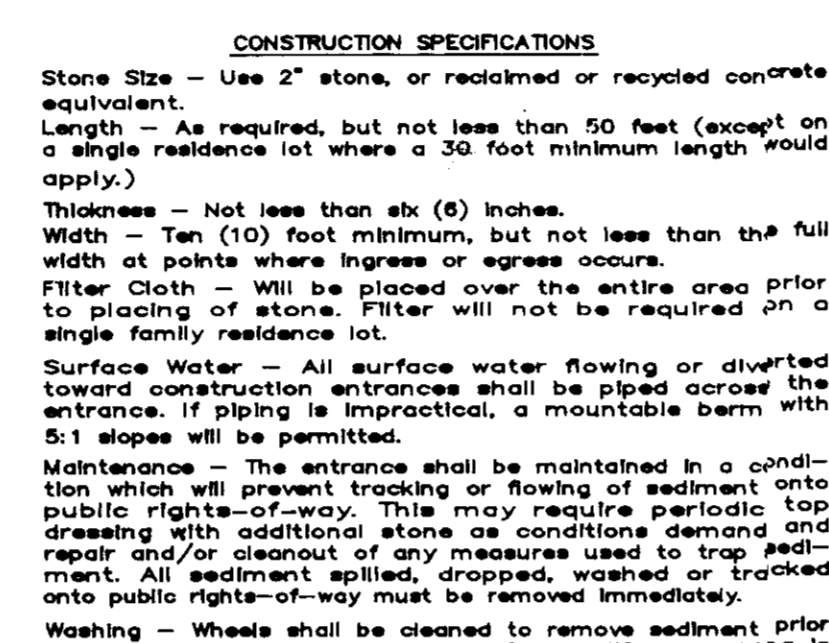
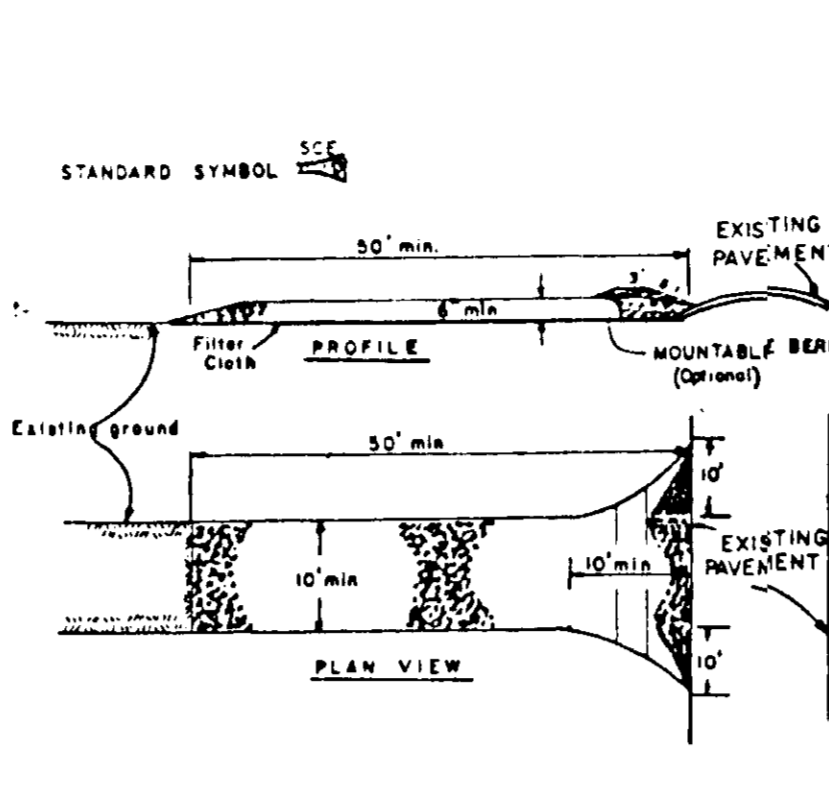

SEQUENCE OF CONSTRUCTION

- Obtain grading permit. (1 DAY)
- Clear for and install silt fence. (1 DAY)
- Rough grade for driveway and remove sidewalk as necessary. Install stabilized construction entrance. (1 DAY)
- Construct house and utility connections.
- Final grade and install driveway, stabilize all disturbed areas according to temp. seeding notes when house is closed-in. (2 DAYS)
- Complete all construction and stabilize all disturbed areas in accordance with permanent seeding notes. (5 DAYS)
- Upon approval of the Department of Public Works sediment control inspector, remove all sediment control devices and seed all remaining disturbed areas in accordance with permanent seeding notes. (1 DAY)

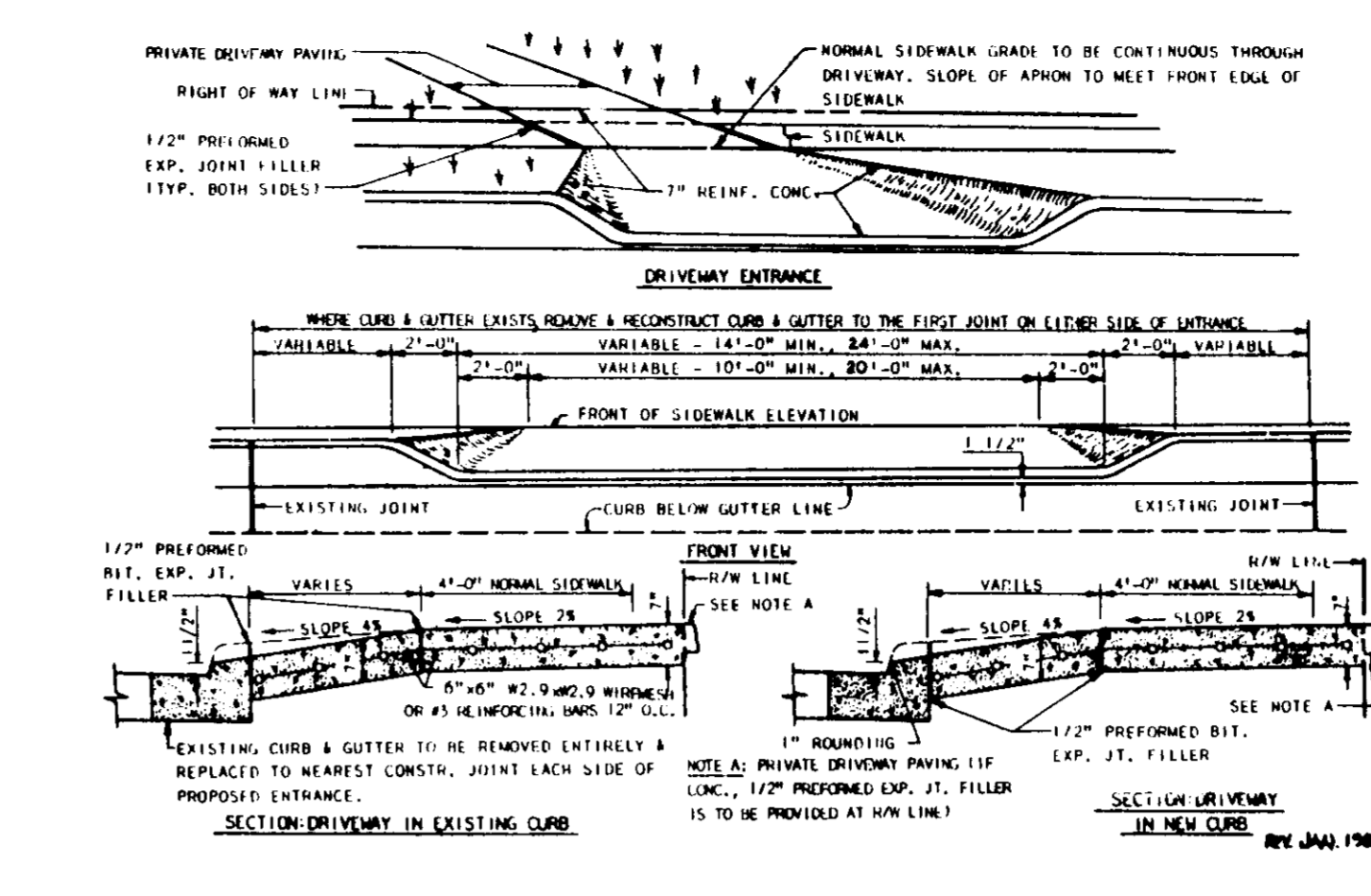

CURVE DATA

NO.	RADIUS	DELTA	LENGTH	TANGENT	BEARING	DISTANCE
6029-6040	375.00'	64°41'35"	423.41'	237.49'	S75°47'11"E	401.28'
6106-6109	275.00'	36°18'32"	174.27'	90.17'	S28°24'20"W	171.37'

POINT TABLE

NO.	DISTANCE	BEARING
6040-6041	35.36'	N01°33'36"E
6041-6109	15.00'	S46°33'36"W

SITE TABULATIONS

TOTAL AREA OF PARCEL	31 AC.
EXISTING ZONING	RT
TOTAL NUMBER OF LOTS (LOT 31)	1
RESIDENTIAL (R.U.F.C.)	1
OPEN SPACE	NA
OPEN SPACE REQUIRED (348)	
PROVIDED (NA)	

NOTE: REF. DWGS. "VILLAGE OF HICKORY RIDGE" SECTION C AREA 1 PARCEL # 1 LOT 1 THRU 60 SHEET 3 OF 3 DATED 2-88 REF. LIBER 1535/FOLIO 193/PLAT 8134

GENERAL NOTES:

- Reference File No. 981-78, P88-81 & P88-82.
- Stormwater Management provided under previously approved plan # P88-199c.
- All work shall be done in accordance with Howard County Design Manual, Vol. 332 Standards, Specifications & Details, for Construction, 1989 Amendments.

RIEMER, MUEGGE & ASSOCIATES, INC.
A Planning, Engineering and Consulting Firm.
3105 North Ridge Road, Ph. No. 301-944-1827
Ellicott City, Md. 21043 FAX: 301-780-9176

DATE: JULY 27, 1989

PUBLIC WATER AND SEWER SERVICE 19 PROVIDED UNDER CONTRACT NO. 34-1437-D

VICINITY MAP
SCALE: NONE

ADDRESS CHART

LOT NUMBER	STREET ADDRESS
31	6982 Silent Dell Lane

SUBDIVISION NAME: VILLAGE OF HICKORY RIDGE SECT. 6 / AREA 1 LOT 31
PLOT # OR C/F: 8134 **BLOCK #:** 6 **ZONE NT/TAX/ZONE MAP:** 41 **ELEC. DIST.:** 5 **CENSUS TR:** 6051
WATER CODE: HO3 **SEWER CODE:** 5758200

APPROVED: FOR PUBLIC WATER AND PUBLIC SEWERAGE SYSTEMS, HOWARD COUNTY HEALTH DEPARTMENT.

James M. Helm
COUNTY HEALTH OFFICER
DATE: 9-19-89

APPROVED: HOWARD COUNTY DEPARTMENT OF PLANNING AND ZONING.

William E. Muegge
DIRECTOR
DATE: 9/27/89

James M. Helm
CHIEF, DIVISION OF COMMUNITY PLANNING & LAND DEVELOPMENT
DATE: 9/20/89

APPROVED: FOR PUBLIC WATER, PUBLIC SEWERAGE, STORM DRAINAGE SYSTEMS, AND PUBLIC ROADS.

HOWARD COUNTY DEPARTMENT OF PUBLIC WORKS

James M. Helm
DIRECTOR
DATE: 9/15/89

William E. Muegge
CHIEF, BUREAU OF ENGINEERING
DATE: 9-15-89

BY THE DEVELOPER:

"I/WE CERTIFY THAT ALL DEVELOPMENT AND CONSTRUCTION WILL BE DONE ACCORDING TO THIS PLAN, AND THAT ANY RESPONSIBLE PERSONNEL INVOLVED IN THE CONSTRUCTION PROJECT WILL HAVE A CERTIFICATE OF ATTENDANCE AT A DEPARTMENT OF NATURAL RESOURCES APPROVED TRAINING PROGRAM FOR THE CONTROL OF SEDIMENT AND EROSION BEFORE BEGINNING THE PROJECT. I also authorize periodic on-site inspections by the Howard Soil Conservation District."

William E. Muegge
DEVELOPER
DATE: 6-30-89

BY THE ENGINEER:

"I CERTIFY THAT THIS PLAN FOR EROSION AND SEDIMENT CONTROL REPRESENTS A PRACTICAL AND WORKABLE PLAN BASED ON MY PERSONAL KNOWLEDGE OF THE SITE CONDITIONS AND THAT IT WAS PREPARED IN ACCORDANCE WITH THE REQUIREMENTS OF THE HOWARD SOIL CONSERVATION DISTRICT."

William E. Muegge
ENGINEER
DATE: 9-20-89

REVIEWED FOR: HOWARD S.C.D.

AND MEETS TECHNICAL REQUIREMENTS

James M. Helm
U.S. SOIL CONSERVATION SERVICE
DATE: 9-1-89

THIS DEVELOPMENT PLAN IS APPROVED FOR SOIL EROSION AND SEDIMENT CONTROL BY THE HOWARD SOIL CONSERVATION DISTRICT.

William E. Muegge
HOWARD S.C.D.
DATE: 9-7-89

DATE	NO.	REVISION

OWNER: HOWARD RESEARCH AND DEVELOPMENT CORP.
10275 LITTLE PATUXENT PARKWAY
COLUMBIA, MARYLAND 21044

DEVELOPER: HOWARD VOCATIONAL CONSTRUCTION CO.
10920 CLARKSVILLE PIKE (RTE. 108)
ELICOTT CITY, MARYLAND 21043

PROJECT: VILLAGE OF HICKORY RIDGE - LOT NO. 31, SECTION 6 / AREA 1
6982 SILENT DELL LANE.
REF. LIBER 1535 / FOLIO 193 / PLAT 8134

AREA: TAX MAP NO. 41 ELECTION DISTRICT 5th PARCEL NO. 22
HOWARD COUNTY, MARYLAND

TITLE: SITE DEVELOPMENT PLAN

LEGEND

EX. CONTOURS: --- 438 ---
PROP. CONTOURS: --- 38 ---

STABILIZED CONSTRUCTION ENTRANCE: [Symbol]

DRIVEWAY-CONCRETE: [Symbol]

LIMIT OF DISTURBED AREA: [Symbol]

BUILDING RESTRICTION LINE: [Symbol]

SILT FENCE: [Symbol]

EDUCATION PLUS

HOARD VOCATIONAL CONSTRUCTION COMPANY

DESIGNED BY: PC
DRAWN BY: DC
PROJECT NO.:
DATE:
SCALE:
DRAWING NO.: 1 of 2

PROFESSIONAL SEAL:

DATE: JULY 27, 1989

S.D.P. 9A-05