

MARYLAND WHOLESALE FOOD CENTER  
SECTION 3, BLOCK A, PARCEL C  
PLAT 6096, ZONED M-2

MD. WHOLESALE FOOD MARKET  
SECTION 3, BLOCK A, PARCEL C  
PLAT 5461, ZONED M-2

**BENCH MARKS**

- BM #1 X-CUT IN HYDRANT HOLD DOWN BOLT  
15100 OCEANO AVE. EL. 232.53
- BM #2 X-CUT 24.25' LEFT 19100 OCEANO AVE.  
EL. 218.73

**VICINITY MAP**  
SCALE 1" = 2000'

**GENERAL NOTES**

- PRIOR TO THE START OF ANY CONSTRUCTION THE CONTRACTOR SHALL STAKE OUT ALL BASELINES, BUILDING LOCATION, CURBS, AND "VERTICAL" SETS AND SETBACKS.
- THE CONTRACTOR SHALL NOTIFY "MISS UTILITY" AT TELEPHONE 800 (301-599-0100) AT LEAST 72 HOURS PRIOR TO STARTING EXCAVATION TO VERIFY ALL LOCATIONS OF EXISTING UTILITIES.
- ALL CONSTRUCTION SHALL BE ACCOMPLISHED IN ACCORDANCE WITH HOWARD COUNTY, DEPARTMENT OF PUBLIC WORKS STANDARDS, SPECIFICATIONS AND REQUIREMENTS.
- THE INFORMATION SHOWN ON THESE PLANS IS FOR THE CONVENIENCE OF THOSE CONCERNED ONLY. THE CORRECTNESS OR COMPLETENESS OF THE INFORMATION SHOWN IS NOT WARRANTED OR GUARANTEED. THE CONTRACTOR SHALL VERIFY ALL INFORMATION TO HIS OWN SATISFACTION.
- THE LOCATIONS OF EXISTING UNDERGROUND UTILITIES ARE SHOWN IN AN APPROXIMATE WAY ONLY. THE CONTRACTOR SHALL DETERMINE THE EXACT LOCATION OF ALL EXISTING UTILITIES BEFORE COMMENCING WORK. HE AGREES TO BE FULLY RESPONSIBLE FOR ANY AND ALL DAMAGES WHICH MIGHT BE OCCASIONED BY HIS FAILURE TO EXACTLY LOCATE AND ALL UNDER GROUND UTILITIES.
- ALL DISTURBED AREAS NOT STABILIZED WITH PAVING BUILDING, SODDING OF MULCH PLANTING AREAS SHALL BE SEEDED AND MULCH.
- S.W.M. HAS BEEN PROVIDED UNDER F-82-120
- SURVEY BASED ON HOWARD COUNTY GEODETIC CONTROL MONUMENT NO. 184001 & MONUMENT NO. 1843007 PARCEL D WAS RECORDED UNDER SURVEY DIVISION, 24 HRS IN ADVANCE OF COMMENCEMENT OF WORK AT 992-2417 OR 792-7272
- STORMWATER MANAGEMENT FOR THIS SITE HAS BEEN PROVIDED FOR IN THE REGIONAL FACILITY (P-82-120)
- ALL ROADS ARE PUBLIC
- SEE S-82-07, P-87-50 & F-89-180
- THE WAREHOUSE USE IS FOR BULK STORAGE ONLY. A HIGHER INTENSITY USE WILL REQUIRE PRIOR APPROVAL FROM THE DEPARTMENT OF PLANNING AND ZONING FOR ADDITIONAL PARKING REQUIREMENT.

**SITE ANALYSIS**

- AREA OF SITE = 9.252 Ac (403,017 S.F.)
  - MAX. BLDG. HT. ALLOWED = 50 FEET
  - PROP. BLDG. HT. = 42.67 FEET
  - ZONING: M-2, TAX MAP 43, PARCEL D.
  - OWNER: J-MARK CONSTRUCTION COMPANY, INC.  
P.O. BOX 1921  
APPLETON, WISCONSIN 54913
  - SITE USE: OFFICE AND WAREHOUSE
- | AREA   | AREA           | % COVERAGE |
|--|----------------|------------|
| A. SITE  | 403,017 S.F.   |            |
| B. PROP BLDG   | = 210,000 S.F. | 52.1%      |
| C. PARKING LOT   | = 86,750 S.F.  | 21.5%      |
| D. BLDG. & PARKING LOT                                 | = 296,750 S.F. | 73.6%      |
| E. LANDSCAPED ISLANDS                                  | = 4,602 S.F.   | 5.3%       |
| F. OPEN SPACE INCL. LANDSCAPED ISLANDS (EXCL. RAILWAY) | = 97,667 S.F.  | 24.2%      |
| G. AREA OF RAILWAY                                     | = 8,600 S.F.   | 2.2%       |

PARKING DATA	
TOTAL FLOOR AREA	= 210,000 S.F. 4.82 AC.
OFFICE AREA	= 3,000 S.F. = 12EMPL. @ 7 P.S./10 EMPL. = 8.4 P.S.
WAREHOUSE AREA	= 207,000 S.F. = 20 EMPL. @ 1 P.S./72 EMPL. = 10 P.S.
TOTAL PARKING REQUIRED	= 18.4 PARKING SPACES
TOTAL PARKING PROVIDED	= 78 PARKING SPACES INC. H.C.

**LEGEND**

- 6" CONC. & 2" CR.
- 6" CONC. & 6" CR.
- SPOT ELEV.

ADDRESS CHART	
LOT NUMBER	STREET ADDRESS
PARCEL D	7970 TAR BAY DRIVE

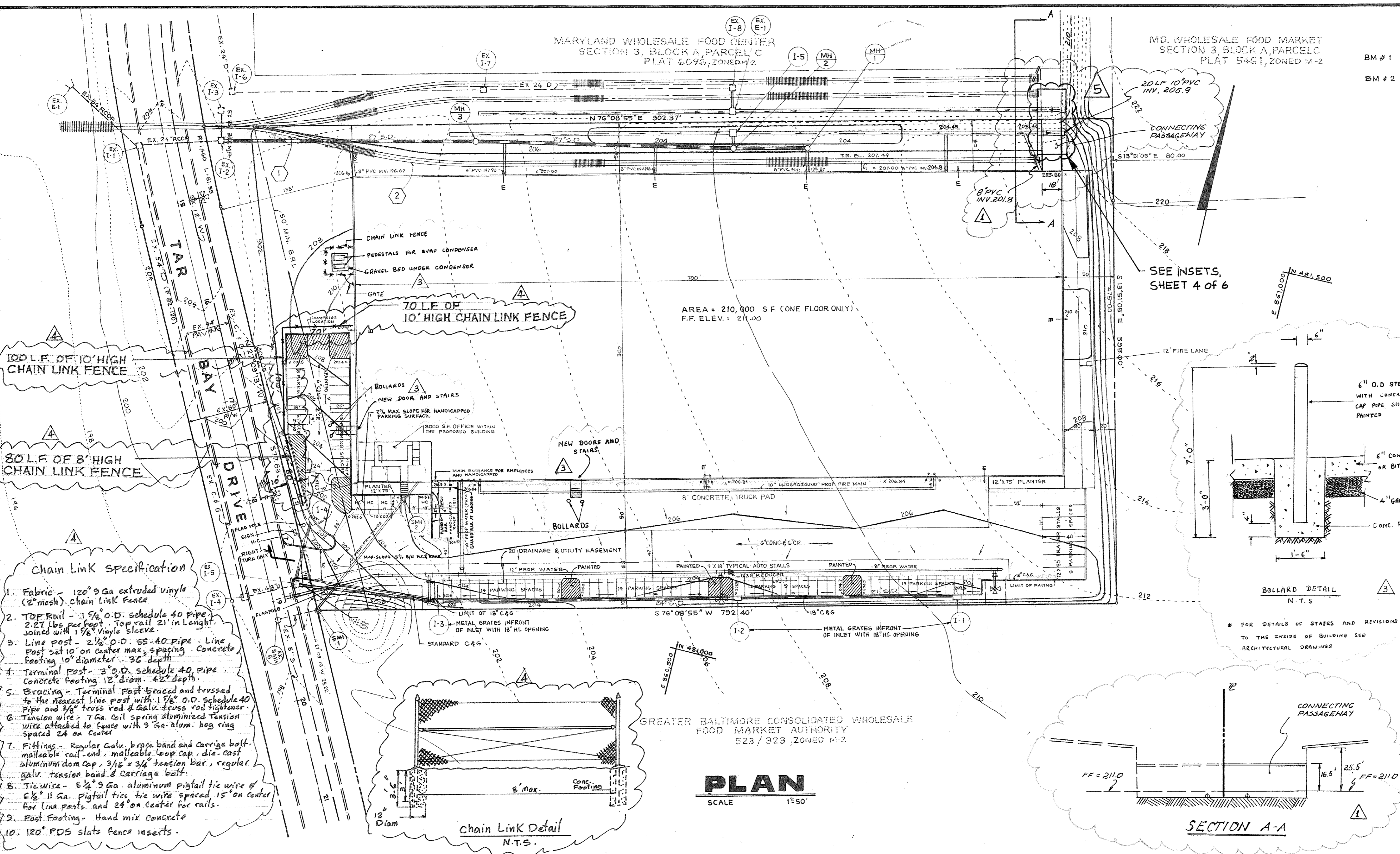

- Chain Link Specification**
- Fabric - 120' 9 Ga. extruded vinyl (2" mesh) chain link fence
  - Top Rail - 1 1/2" O.D. schedule 40 pipe, 2.27 lbs per foot. Top rail 21' in length, joined with 1 1/2" vinyl sleeve.
  - Line Post - 2 1/2" O.D. SS-40 pipe. Line Post set 10' on center max. spacing. Concrete footing 10" diameter, 36" depth.
  - Terminal Post - 3" O.D. schedule 40 pipe. Concrete footing 12" diam., 42" depth.
  - Bracing - Terminal Post braced and trussed to the nearest line post with 1 1/2" O.D. schedule 40 pipe and 3/8" truss rod & Galv. truss rod tightener.
  - Tension wire - 7 Ga. coil spring aluminum tension wire attached to fence with 3/8" alum. hog ring spaced 24" on center.
  - Fittings - Regular Galv. brace band and carriage bolt, malleable rail end, malleable loop cap, die-cast aluminum dom cap, 3/16" x 3/4" tension bar, regular galv. tension band & carriage bolt.
  - Tie wire - 8 1/2" 9 Ga. aluminum pigtail tie wire & 6 1/2" 11 Ga. pigtail tie wire spaced 15" on center for line posts and 24" on center for rails.
  - Post Footing - Hand mix concrete
  - 120" PDS slats fence inserts.

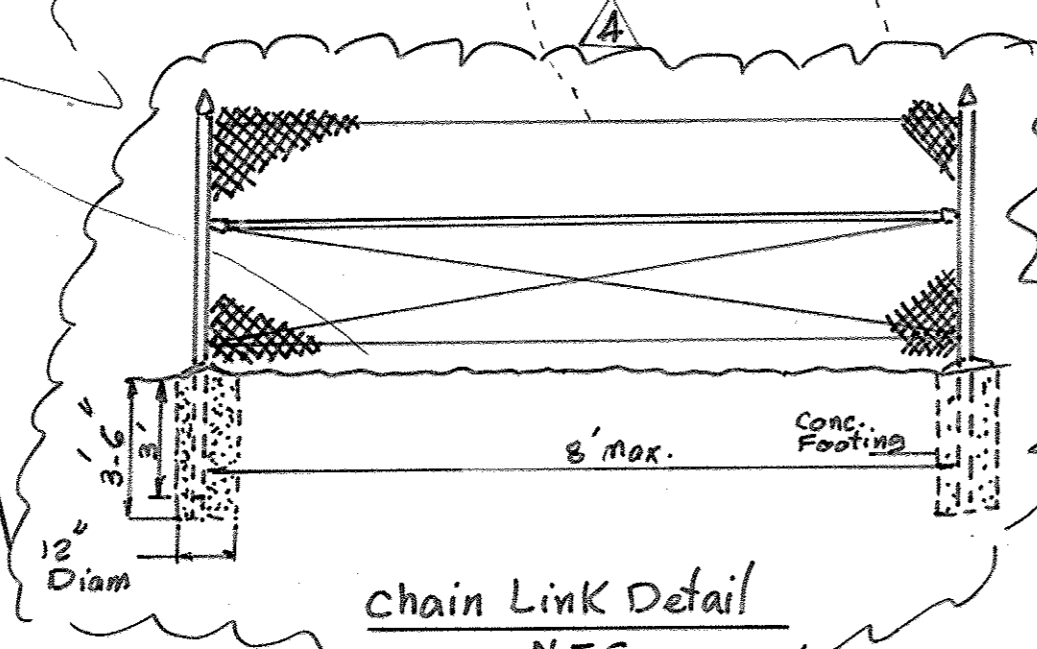

**PLAN**  
SCALE 1" = 50'

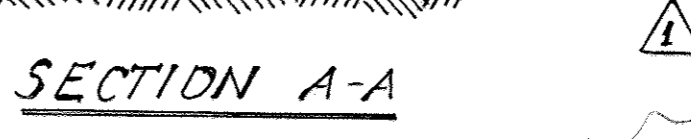

**BUILDING PROFILE**

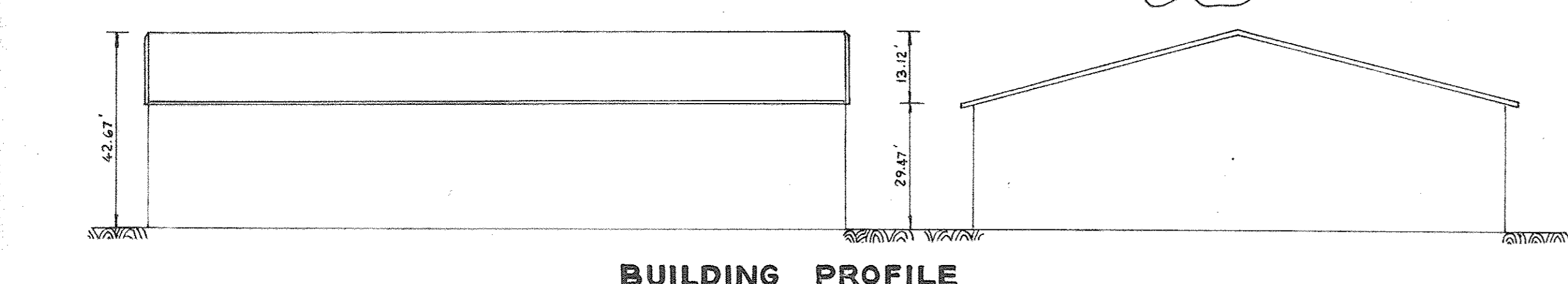

**SEDGHI & ASSOCIATES, LTD**  
Civil Engineers - Site Planners - Surveyors  
3217 Corporate Court  
Ellicott City, MD 21043  
(301) 750-9003

**ENGINEER'S CERTIFICATE**

I HEREBY CERTIFY THAT THIS PLAN FOR EROSION AND SEDIMENT CONTROL REPRESENTS A PRACTICAL AND WORKABLE PLAN BASED ON MY PERSONAL KNOWLEDGE OF THE SITE CONDITIONS AND THAT IT WAS PREPARED IN ACCORDANCE WITH THE REQUIREMENTS OF THE HOWARD SOILS CONSERVATION DISTRICT.

DATE: 2-9-90

SIGNATURE OF ENGINEER: *M. Sedghi*

**DEVELOPER'S CERTIFICATE**

"I/WE CERTIFY THAT ALL DEVELOPMENT AND CONSTRUCTION WILL BE DONE ACCORDING TO THIS PLAN OF DEVELOPMENT AND PLAN FOR EROSION AND SEDIMENT CONTROL AND THAT ALL RESPONSIBLE PERSONNEL INVOLVED IN THE CONSTRUCTION PROJECT WILL HAVE A CERTIFICATE OF ATTENDANCE AT A DEPARTMENT OF NATURAL RESOURCES APPROVED TRAINING PROGRAM FOR THE CONTROL OF SEDIMENT AND EROSION BEFORE BEGINNING THE PROJECT I ALSO AUTHORIZE PERIODIC ONSITE INSPECTION BY THE HOWARD SOIL CONSERVATION DISTRICT OR THEIR AUTHORIZED AGENTS, AS ARE DEEMED NECESSARY"

DATE: 2-7-90

SIGNATURE OF DEVELOPER: *Jacqueline Johnson*

APPROVED: FOR PUBLIC WATER AND PUBLIC SEWERAGE SYSTEMS, HOWARD COUNTY HEALTH DEPARTMENT  
COUNTY HEALTH OFFICER: *J. B. ...* 3-8-90  
DATE: 3-8-90

APPROVED: HOWARD COUNTY DEPT. OF PLANNING & ZONING  
DIRECTOR: *...* 3-7-90  
DATE: 3/7/90

APPROVED: FOR PUBLIC WATER AND PUBLIC SEWERAGE STORM DRAINAGE SYSTEMS AND PUBLIC ROADS HOWARD COUNTY DEPARTMENT OF PUBLIC WORKS  
DIRECTOR: *...* 3-1-90  
DATE: 2-22-90

REVIEWED FOR HOWARD COUNTY SOIL CONSERVATION DISTRICT AND MEETS TECHNICAL REQUIREMENTS  
DATE: 2/20/90

APPROVED: FOR EROSION AND SEDIMENT CONTROL BY THE HOWARD SOIL CONSERVATION DISTRICT  
DATE: 2/20/90

APPROVED DIVISION OF COMMUNITY PLANNING & LAND DEVELOPMENT  
HOWARD COUNTY, MARYLAND

NO	DATE	REVISION	BY
5	3/7/18	FLOOR PLAN DEMO & NEW WORK	CEI
4	4/6/03	Add Chain Link Fence & detail	MS
3	3/21/01	ADD GRAVEL BED AND FENCE ADD DOORS W/ WEST AND SOUTH OF BUILDING	R.P.
1	5/17/90	PARKING ISLANDS, C&G, GRADING	V.G.
1	8/3/90	ADD CONN. PASSAGENAY	V.Z.
NO	DATE	REVISION	BY

SUBDIVISION NAME				SECTION / AREA		PARCEL NO	
MARYLAND WHOLESALE FOOD CNTR				3 / BLOCK A		D	
PLAT NO	BLOCK NO	ZONE	TAX / ZONE	ELEC DIST	CENSUS TR		
S722	21	M-2	43	GTH	6064		
WATER CODE				SEWER CODE			
B 02				3170000			
DESIGNED	MS	SITE DEVELOPMENT PLAN					
DRAWN	V.S.	MARYLAND WHOLESALE FOOD CENTER					
CHECKED	MS	SECTION 3, BLOCK A, PLAT NO 6096 S722					
DATE	2-9-1990	PARCEL D, TAX MAP 43					
HOWARD COUNTY, MARYLAND							
F-89-180 S.D.P.-89-223							
OWNER: J. MARK CONSTRUCTION CO. INC.							
P.O. BOX 1921							
APPLETON, WISCONSIN 54913							
SCALE: 1" = 50'							
DRAWING: 1 OF 6							
JOB NO.							
FILE NO.							

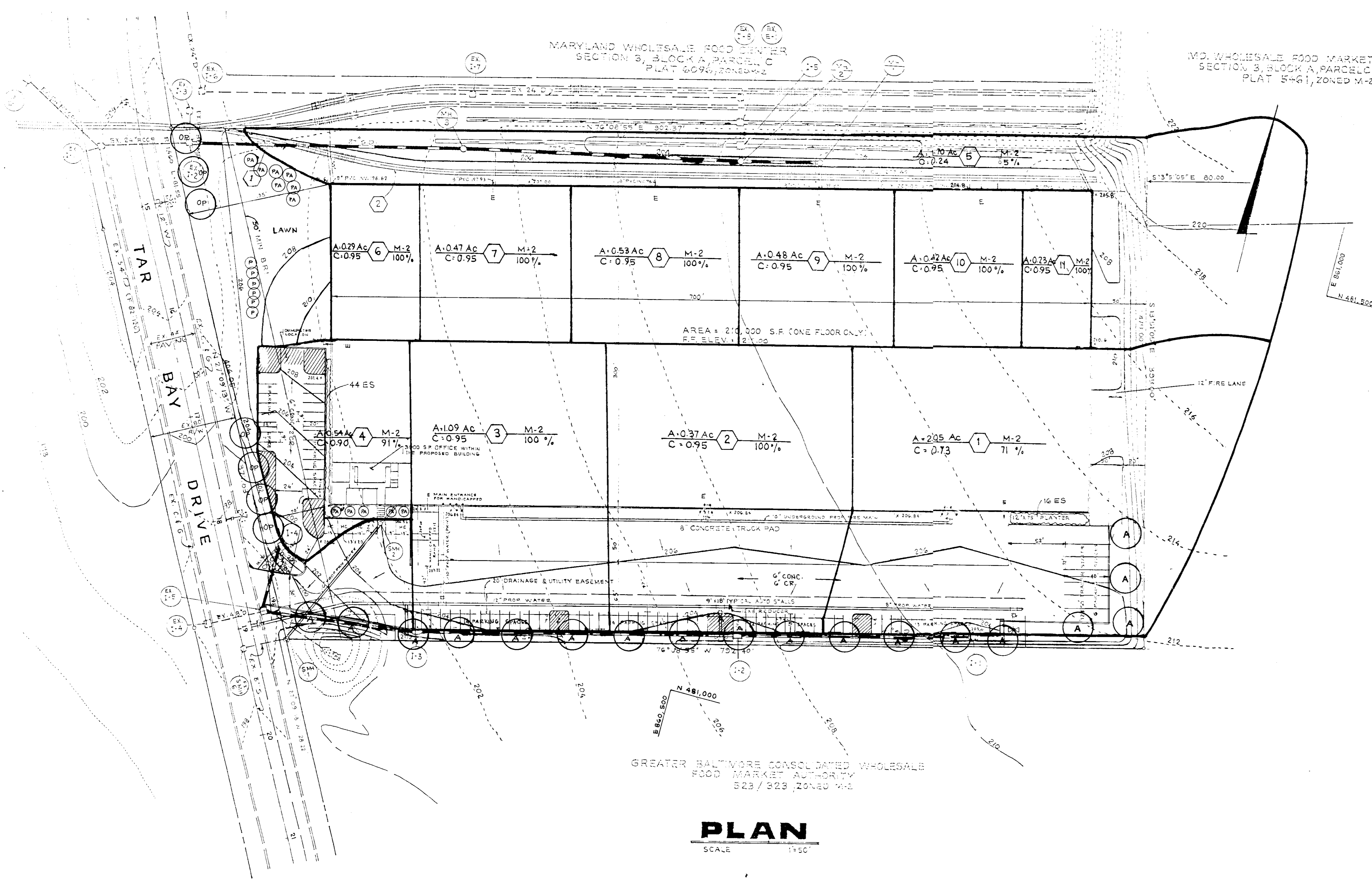

**PLANT LIST**

KEY	QTY	BOTANICAL / COMMON NAME	SIZE / REMARKS
<b>TREES</b>			
A	18	QUERCUS PALUSTRIS PINE OAK	7' H. FULL B.B.B.
<b>SHRUBS</b>			
ES	60	EMMILADIS SIEBOLDIANA SIEBOLD ELANIMOUS	4' H. FULL B.B.B.
<b>EVERGREENS</b>			
OP	7	PLATANUS & ACERIFOLIA LONDON PLANETRICE	7' H. FULL B.B.B.
PA	12	CUPRESSOCYPARIS, LAYLANDII LAYLAND CYPRESS	7' H. FULL B.B.B.
P	6	JUNIPERUS SPARTAN SPARTAN JUNIPER	4' H. FULL B.B.B.

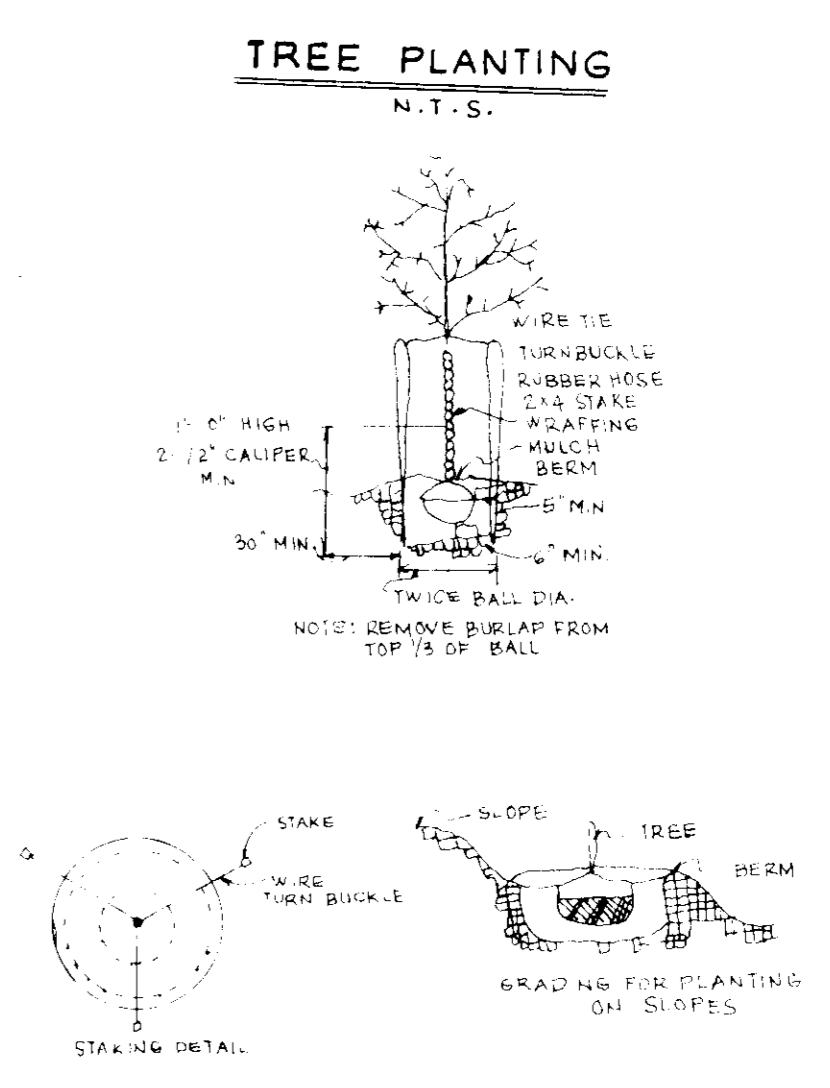

**PLAN**  
SCALE 1/8" = 1'-0"

**SEDGHI & ASSOCIATES, LTD.**  
Civil Engineers • Site Planners • Surveyors  
3217 Corporate Court  
Ellicott City, MD 21043  
(301) 750-9003

<p>APPROVED FOR PUBLIC WATER AND PUBLIC SEWERAGE SYSTEMS, HOWARD COUNTY HEALTH DEPARTMENT</p> <p><i>[Signature]</i> 3-8-90 DATE</p> <p>HOWARD COUNTY DEPT. OF PLANNING &amp; ZONING 3-30-90 DATE</p> <p>APPROVED FOR PUBLIC WATER AND PUBLIC SEWERAGE SYSTEM DRAINAGE SYSTEMS AND PUBLIC ROADS HOWARD COUNTY DEPARTMENT OF PUBLIC WORKS</p> <p><i>[Signature]</i> 3/1/90 DATE</p> <p><i>[Signature]</i> 2-28-90 DATE</p>	<p>REVIEWED FOR HOWARD COUNTY SOIL CONSERVATION DISTRICT AND MEETS TECHNICAL REQUIREMENTS</p> <p><i>[Signature]</i> 3/1/90 DATE</p> <p>US SOIL CONSERVATION SERVICE</p> <p>THIS DEVELOPMENT IS APPROVED FOR EROSION AND SEDIMENT CONTROL BY THE HOWARD COUNTY SOIL CONSERVATION DISTRICT.</p> <p>APPROVED:</p> <p><i>[Signature]</i> 2/28/90 DATE</p> <p>DISTRICT HOWARD SOIL CONSERVATION DISTRICT</p>	<table border="1"> <thead> <tr> <th>DATE</th> <th>NO.</th> <th>DESCRIPTION</th> <th>BY</th> </tr> </thead> <tbody> <tr> <td>11-9-90</td> <td>1</td> <td>PARKING ISLAND, TREES PAVING, SEWER</td> <td>V.S.</td> </tr> </tbody> </table>	DATE	NO.	DESCRIPTION	BY	11-9-90	1	PARKING ISLAND, TREES PAVING, SEWER	V.S.	<p><b>ENGINEER'S CERTIFICATE</b></p> <p>I HEREBY CERTIFY THAT THIS PLAN FOR EROSION AND SEDIMENT CONTROL REPRESENTS A PRACTICAL AND WORKABLE PLAN BASED ON MY PERSONAL KNOWLEDGE OF THE SITE CONDITIONS AND THAT IT WAS PREPARED IN ACCORDANCE WITH THE REQUIREMENTS OF THE HOWARD SOILS CONSERVATION DISTRICT.</p> <p><i>[Signature]</i> 2-9-90</p>	<p><b>DEVELOPER'S CERTIFICATE</b></p> <p>"I/WE CERTIFY THAT ALL DEVELOPMENT AND CONSTRUCTION WILL BE DONE ACCORDING TO THIS PLAN OF DEVELOPMENT AND PLAN FOR EROSION AND SEDIMENT CONTROL AND THAT ALL RESPONSIBLE PERSONNEL INVOLVED IN THE CONSTRUCTION PROJECT WILL HAVE A CERTIFICATE OF ATTENDANCE AT A DEPARTMENT OF NATURAL RESOURCES APPROVED TRAINING PROGRAM FOR THE CONTROL OF SEDIMENT AND EROSION BEFORE BEGINNING THE PROJECT. I ALSO AUTHORIZE PERIODIC ONSITE INSPECTION BY THE HOWARD SOIL CONSERVATION DISTRICT OR THEIR AUTHORIZED AGENTS, AS ARE DEEMED NECESSARY."</p> <p><i>[Signature]</i> 2-7-90 DATE</p>	<table border="1"> <thead> <tr> <th>SUBDIVISION NAME</th> <th>SECTION / AREA</th> <th>PARCEL NO.</th> </tr> </thead> <tbody> <tr> <td>MARYLAND WHOLESALE FOOD CNTR.</td> <td>3/BLOCK A</td> <td>D</td> </tr> </tbody> </table> <table border="1"> <thead> <tr> <th>PLAT NO.</th> <th>BLOCK NO.</th> <th>ZONE</th> <th>TAX / ZONE</th> <th>ELEC. DIST.</th> <th>GEN. DIST.</th> </tr> </thead> <tbody> <tr> <td>8722</td> <td>21</td> <td>M-2</td> <td>43</td> <td>GTH</td> <td>0069</td> </tr> </tbody> </table> <p>WATER CODE: B 02 SEWER CODE: 3170000</p> <p><b>DRAINAGE AREA MAP</b></p> <p><b>MARYLAND WHOLESALE FOOD CENTER</b></p> <p>SECTION 3, BLOCK A, PLAT NO. 00968722 PARCELS, TAX MAP 43 GTH ELECTION DISTRICT HOWARD COUNTY, MARYLAND</p> <p>DATE: 2-9-1990</p> <p>OWNER: J. MARK CONSTRUCTION CO., INC. P.O. BOX 1921 APPLETON, WISCONSIN 54913</p>	SUBDIVISION NAME	SECTION / AREA	PARCEL NO.	MARYLAND WHOLESALE FOOD CNTR.	3/BLOCK A	D	PLAT NO.	BLOCK NO.	ZONE	TAX / ZONE	ELEC. DIST.	GEN. DIST.	8722	21	M-2	43	GTH	0069
DATE	NO.	DESCRIPTION	BY																												
11-9-90	1	PARKING ISLAND, TREES PAVING, SEWER	V.S.																												
SUBDIVISION NAME	SECTION / AREA	PARCEL NO.																													
MARYLAND WHOLESALE FOOD CNTR.	3/BLOCK A	D																													
PLAT NO.	BLOCK NO.	ZONE	TAX / ZONE	ELEC. DIST.	GEN. DIST.																										
8722	21	M-2	43	GTH	0069																										

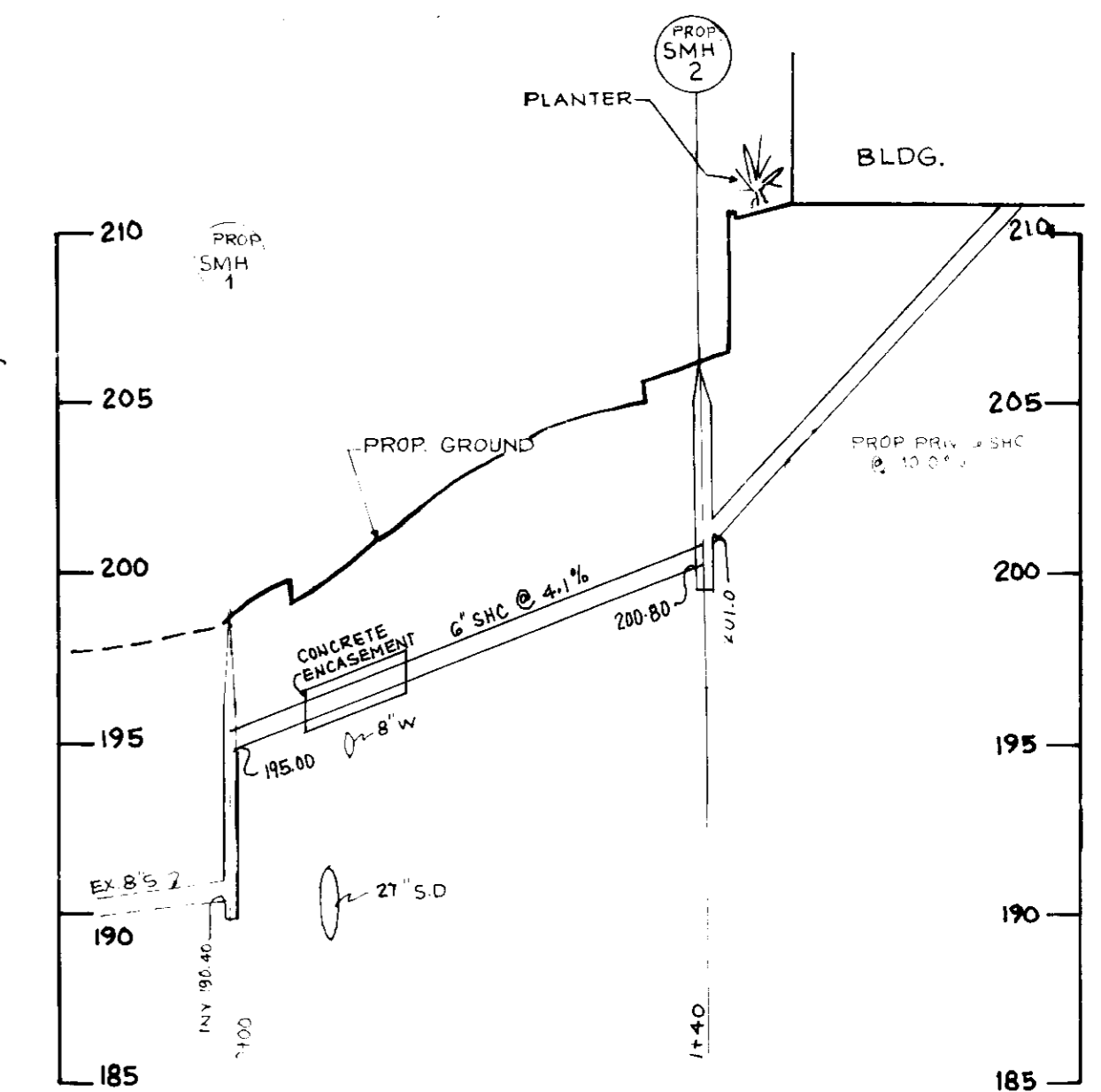
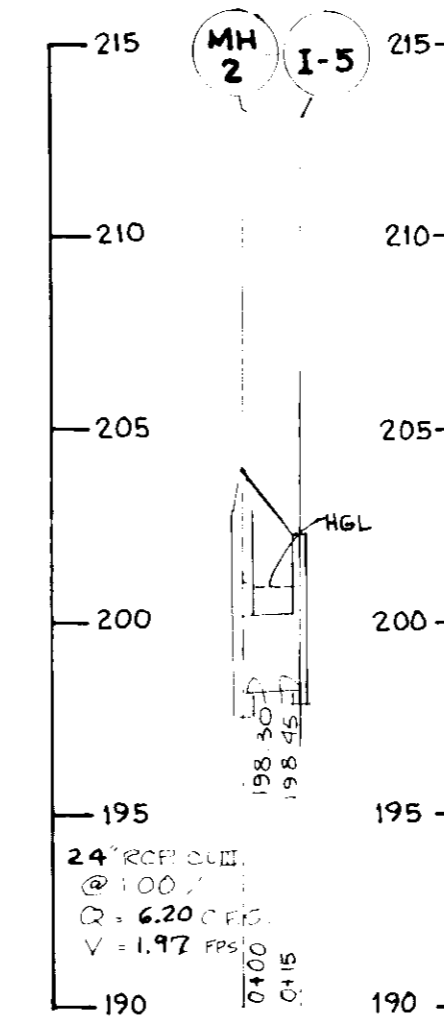
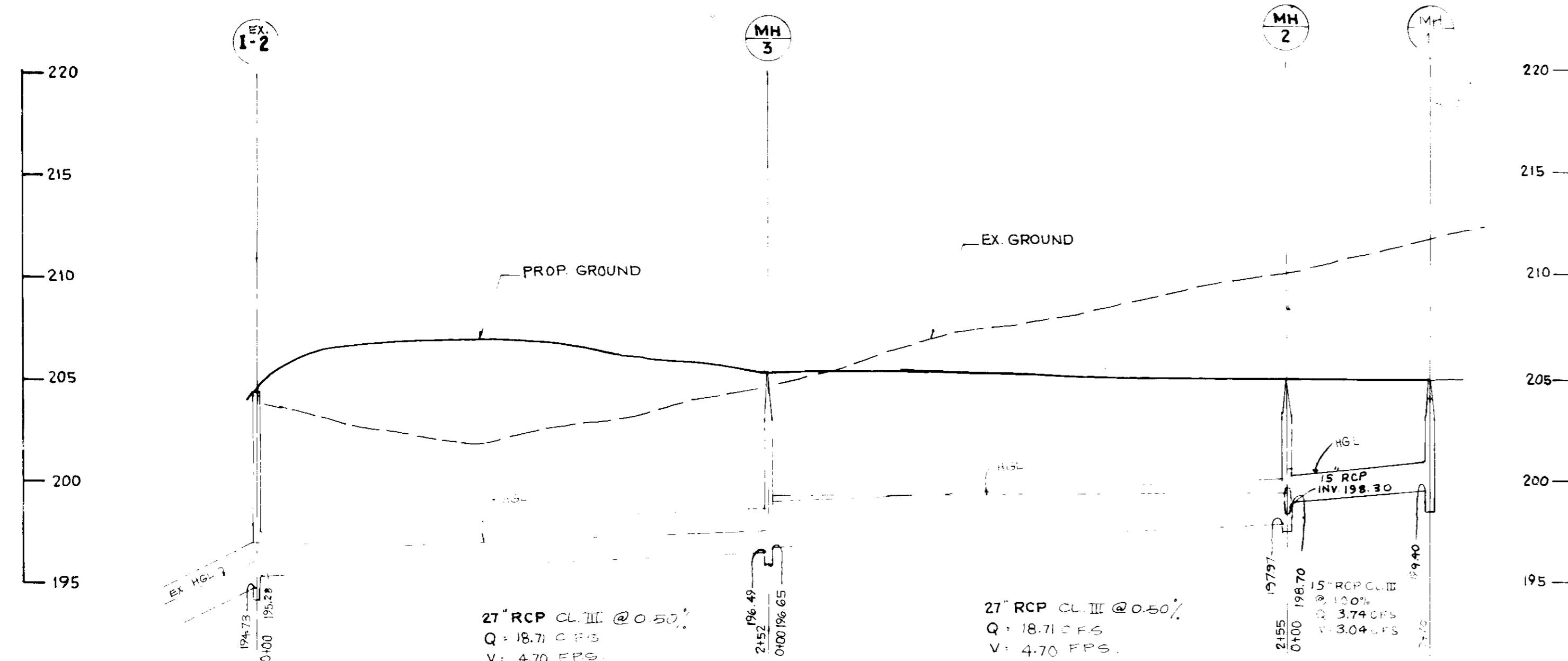
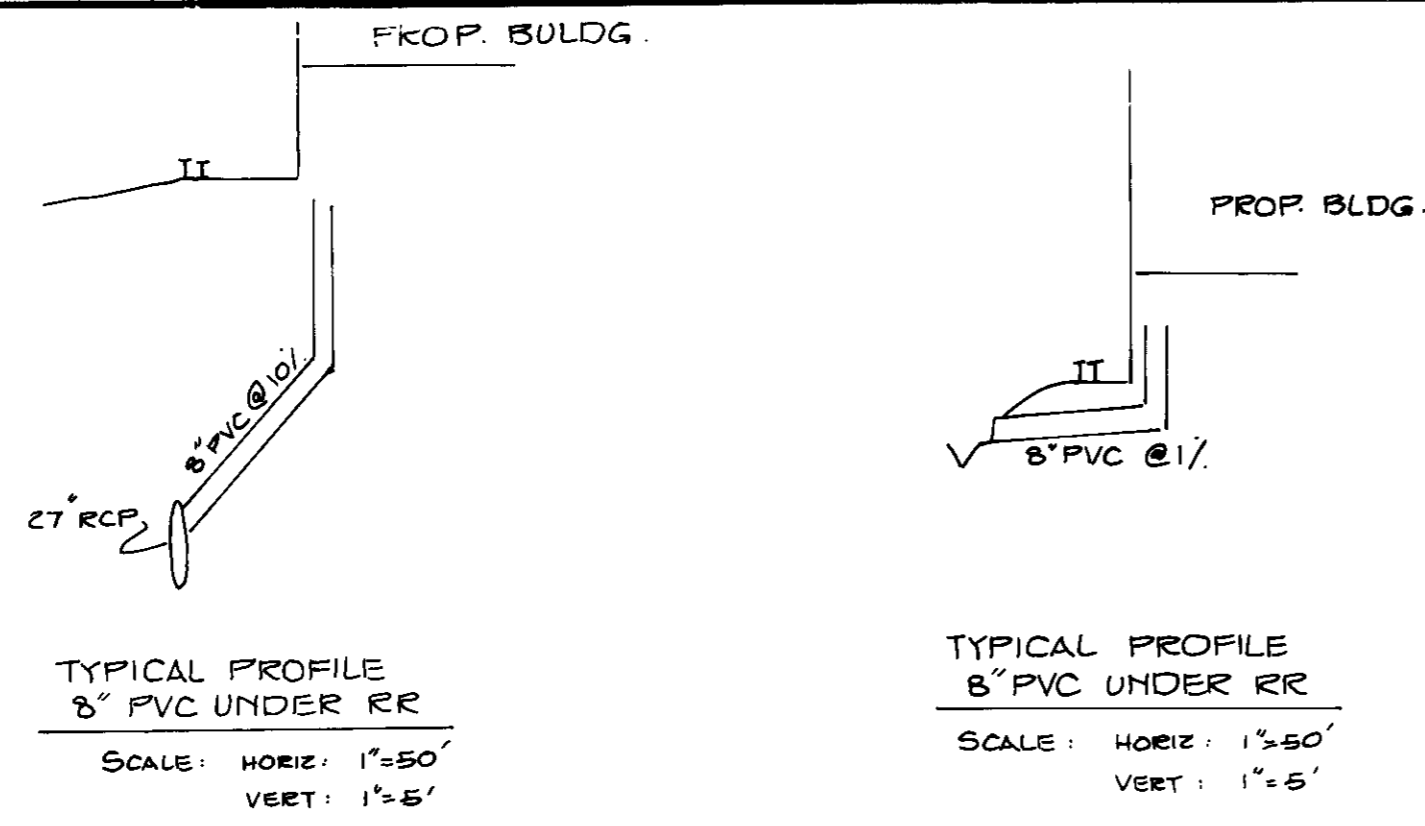

SEWER PROFILE

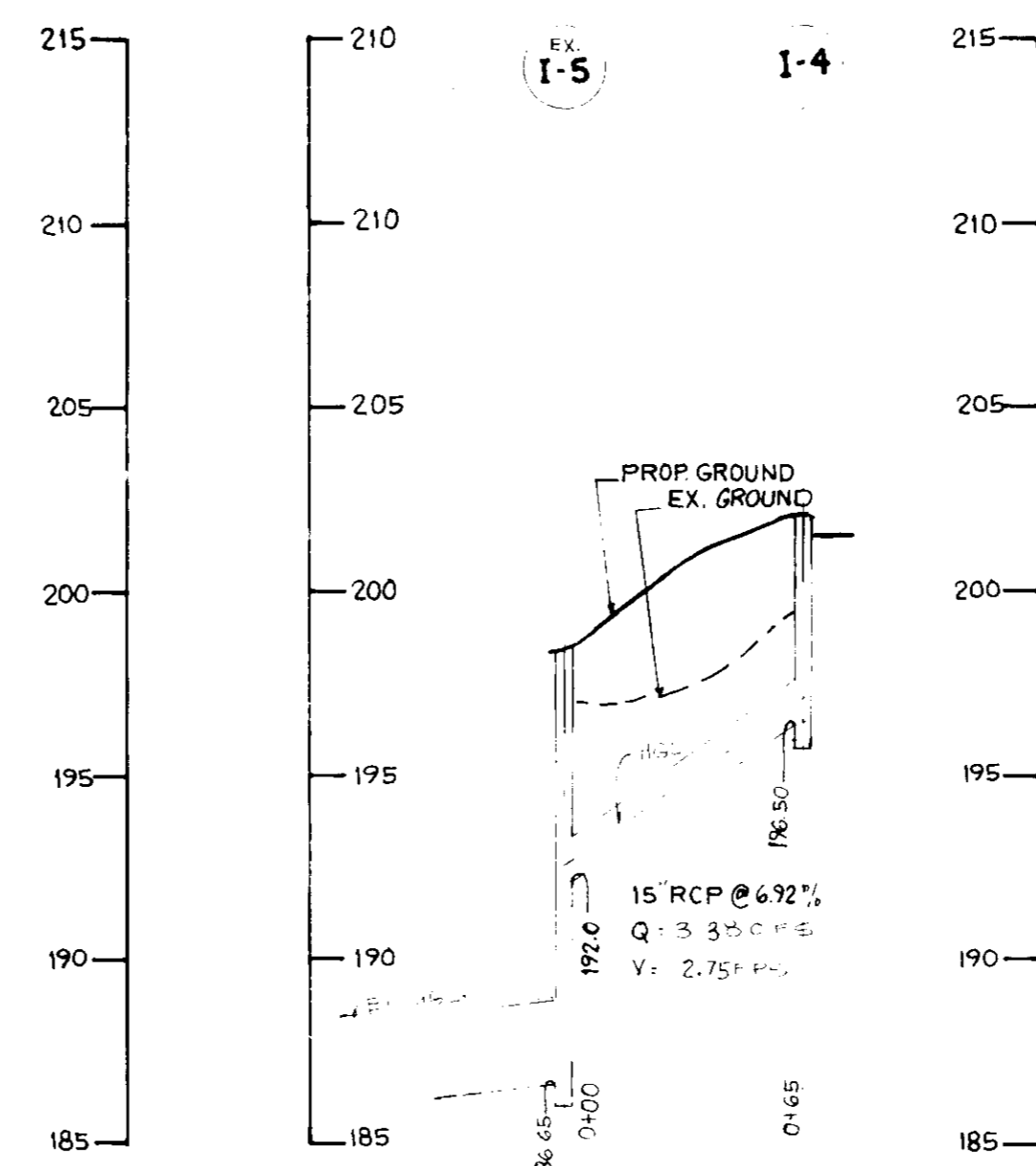
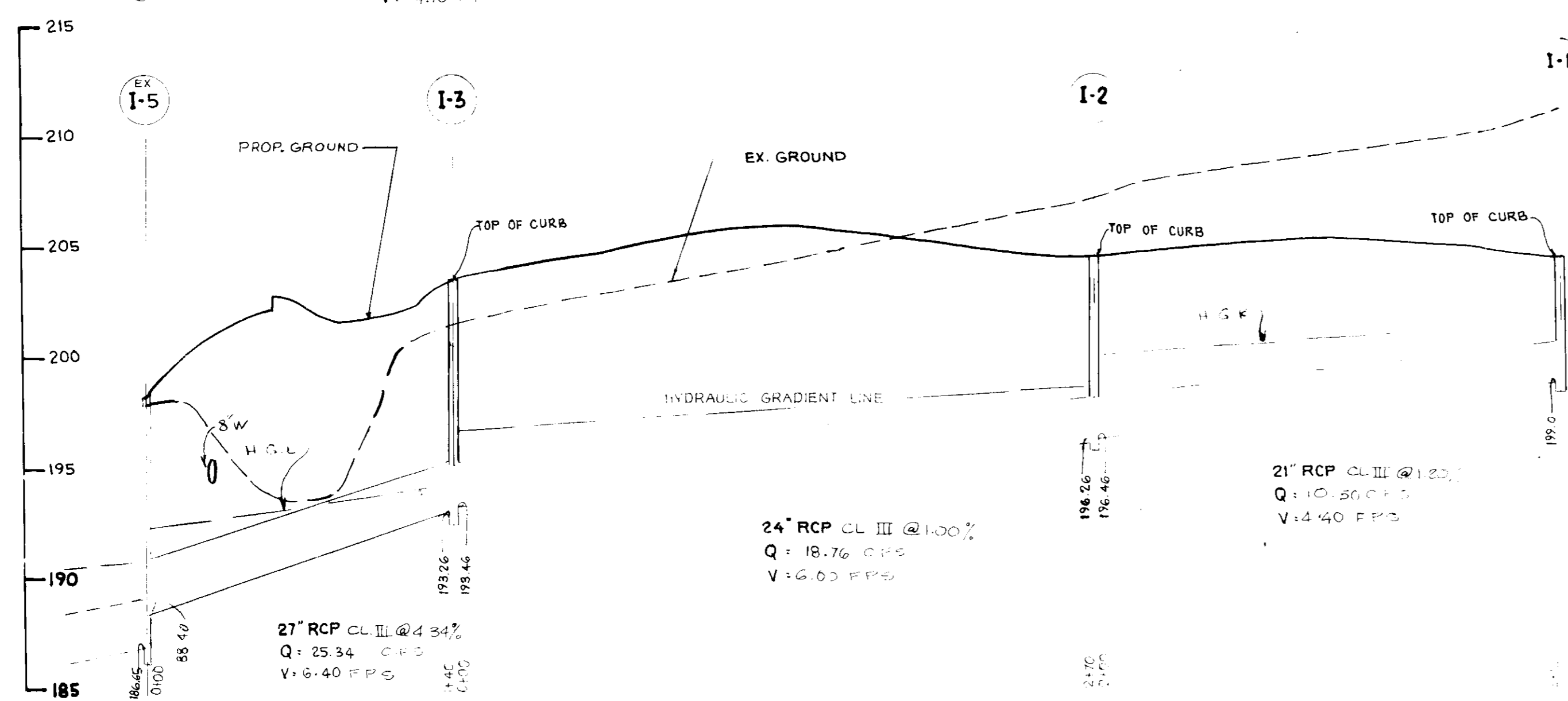

STORM DRAIN STRUCTURE SCHEDULE				
NO	TYPE	TOP EL.	INV. IN	INV. OUT
MH-1	STANDARD PRECAST MANHOLE NO CO G 5 II	205.20	199.43	
MH-2	STANDARD PRECAST MANHOLE NO CO G 5 II	205.5	198.70	197.97
MH-3	STANDARD PRECAST MANHOLE NO CO G 5 II	205.3	196.65	196.45
I-1	E INLET HOWARD COUNTY SD 4.2I	204.53	195.23	196.73
I-1	A-10 INLET HOWARD COUNTY SD 4.02	205.09		199.0
I-2	A-10 INLET HOWARD COUNTY SD 4.02	204.91	196.46	196.26
I-3	A-10 INLET HOWARD COUNTY SD 4.02	203.91	191.46	193.24
I-4	MODIFIED INLET (GRATED)	198.83	187.18	188.25
I-4	A-10 INLET HOWARD COUNTY SD 4.02	202.80	192.6	196.50
I-5	E INLET HOWARD COUNTY SD 4.02	202.56	196.46	196.30

**SEDGHI & ASSOCIATES, LTD.**  
Civil Engineers • Site Planners • Surveyors  
3217 Corporate Court  
Ellicott City, MD 21043  
(301) 750-9003

STORM DRAIN PROFILE

APPROVED FOR PUBLIC WATER AND PUBLIC SEWERAGE SYSTEMS, HOWARD COUNTY HEALTH DEPARTMENT  
*James P. Bohm* 3-8-90  
COUNTY HEALTH OFFICER DATE

APPROVED HOWARD COUNTY DEPT. OF PLANNING & ZONING  
*James P. Bohm* 3-22-90  
DIRECTOR DATE

APPROVED FOR PUBLIC WATER AND PUBLIC SEWERAGE STORM DRAINAGE SYSTEMS AND PUBLIC ROADS HOWARD COUNTY DEPARTMENT OF PUBLIC WORKS  
*James P. Bohm* 3-11-90  
DIRECTOR DATE

*James P. Bohm* 2-23-90  
CHIEF BUREAU OF ENGINEERING DATE

REVIEWED FOR HOWARD COUNTY SOIL CONSERVATION DISTRICT AND MEETS TECHNICAL REQUIREMENTS  
*James P. Bohm* 3/20/90  
U.S. SOIL CONSERVATION SERVICE DATE

THIS DEVELOPMENT IS APPROVED FOR EROSION AND SEDIMENT CONTROL BY THE HOWARD SOIL CONSERVATION DISTRICT  
APPROVED  
*James P. Bohm* 3/20/90  
DISTRICT HOWARD SOIL CONSERVATION DISTRICT DATE

REVISION			
DATE	NO	DESCRIPTION	BY
11-5-90	1	PROP. GRADE, SEWER	V.S.

ENGINEER'S CERTIFICATE  
I HEREBY CERTIFY THAT THIS PLAN FOR EROSION AND SEDIMENT CONTROL REPRESENTS A PRACTICAL AND WORKABLE PLAN BASED ON MY PERSONAL KNOWLEDGE OF THE SITE CONDITIONS AND THAT IT WAS PREPARED IN ACCORDANCE WITH THE REQUIREMENTS OF THE HOWARD SOILS CONSERVATION DISTRICT  
*James P. Bohm*  
SIGNATURE OF ENGINEER  
2-9-90 DATE

DEVELOPER'S CERTIFICATE  
"I HEREBY CERTIFY THAT ALL DEVELOPMENT AND CONSTRUCTION WILL BE DONE ACCORDING TO THIS PLAN OF DEVELOPMENT AND PLAN FOR EROSION AND SEDIMENT CONTROL AND THAT ALL RESPONSIBLE PERSONNEL INVOLVED IN THE CONSTRUCTION PROJECT WILL HAVE A CERTIFICATE OF ATTENDANCE AT A DEPARTMENT OF NATURAL RESOURCES APPROVED TRAINING PROGRAM FOR THE CONTROL OF SEDIMENT AND EROSION BEFORE BEGINNING THE PROJECT. I ALSO AUTHORIZE PERIODIC ON-SITE INSPECTION BY THE HOWARD SOIL CONSERVATION DISTRICT OR THEIR AUTHORIZED AGENTS AS ARE DEEMED NECESSARY."  
*Jacqueline Johnson* 2-7-90  
SIGNATURE OF DEVELOPER DATE

SUBDIVISION NAME MARYLAND WHOLESALE FOOD CTNR	SECTION / AREA 3 BLK A	PARCEL NO D
PLAT NO 8722	BLOCK NO 21	ZONE M-2
TAX / ZONE 43	ELEC DIST 4	CENSUS TR 6044
WATER CODE 802	SEWER CODE 317000	
DESIGNED V.S.	<b>STORM DRAIN &amp; SEWER PROFILE</b>	
DRAWN V.S.	MARYLAND WHOLESALE FOOD CENTER	
CHECKED MS	SECTION 3, BLOCK A, PLAT 8722 PARCEL D TAX MAP 43 6TH ELECTION DISTRICT HOWARD COUNTY, MARYLAND	
DATE 2-9-1990	OWNER J MARK CONSTRUCTION CO. INC P.O. BOX 192 APPLETON, WISCONSIN 54915	SCALE DRAWING JOB NO FILE NO

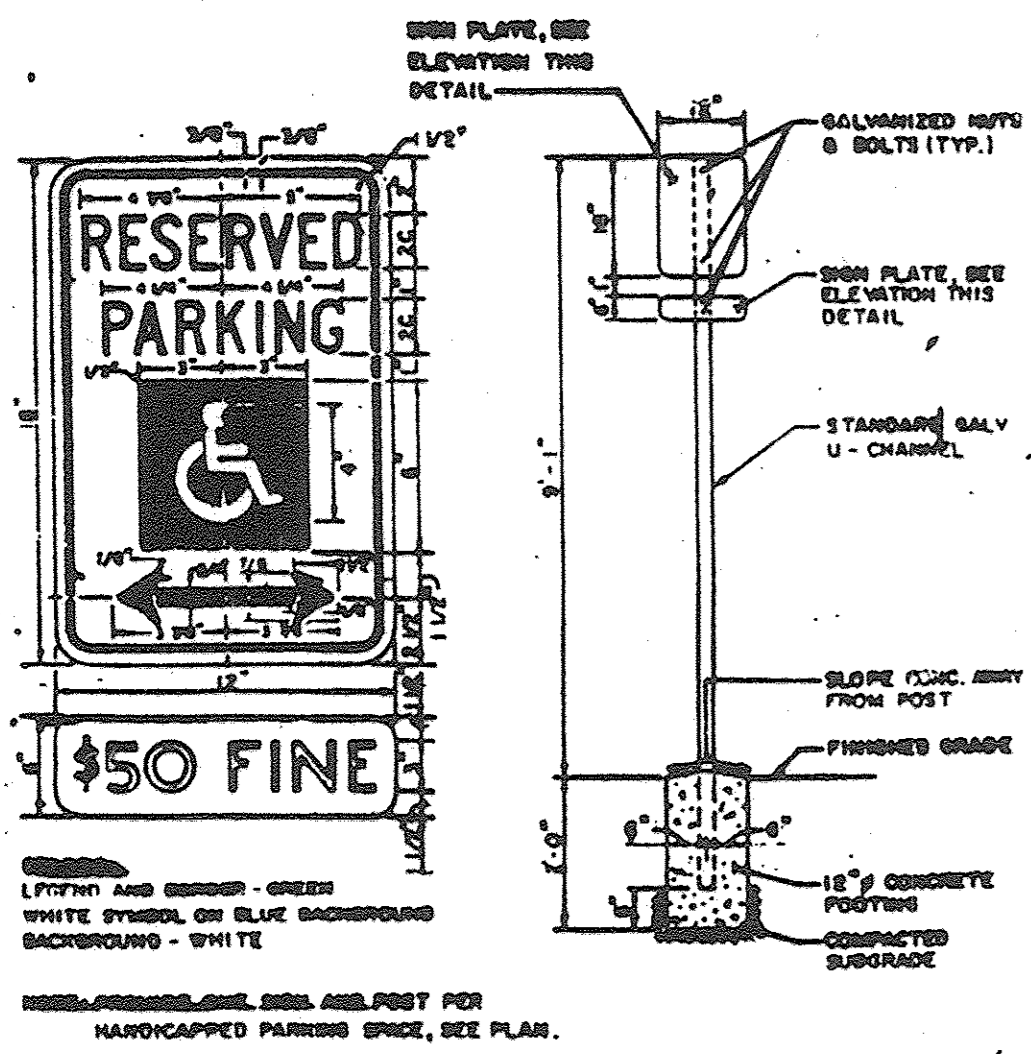

**HANDICAPPED SIGN AND POST**  
NOT TO SCALE

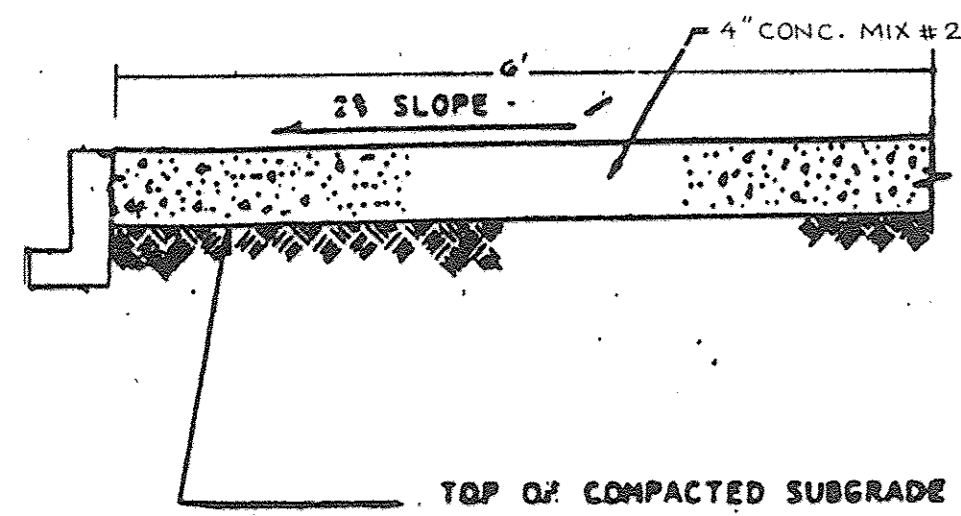

**SIDEWALK DETAIL**  
NO SCALE

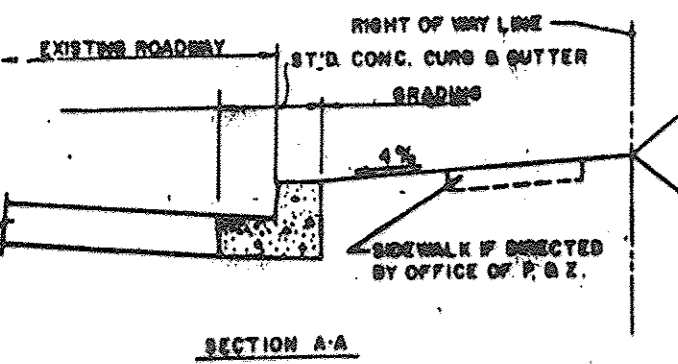
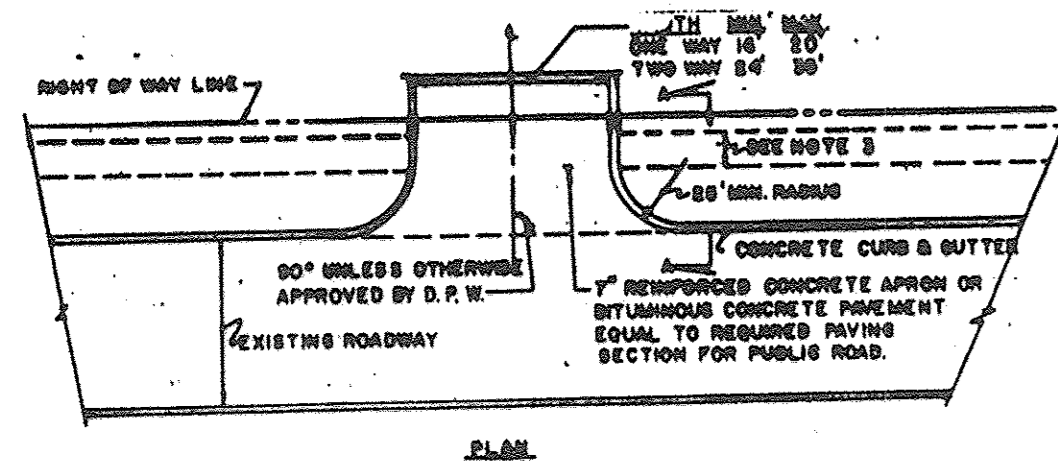

**DRIVEWAY APRON DETAIL**  
NO SCALE

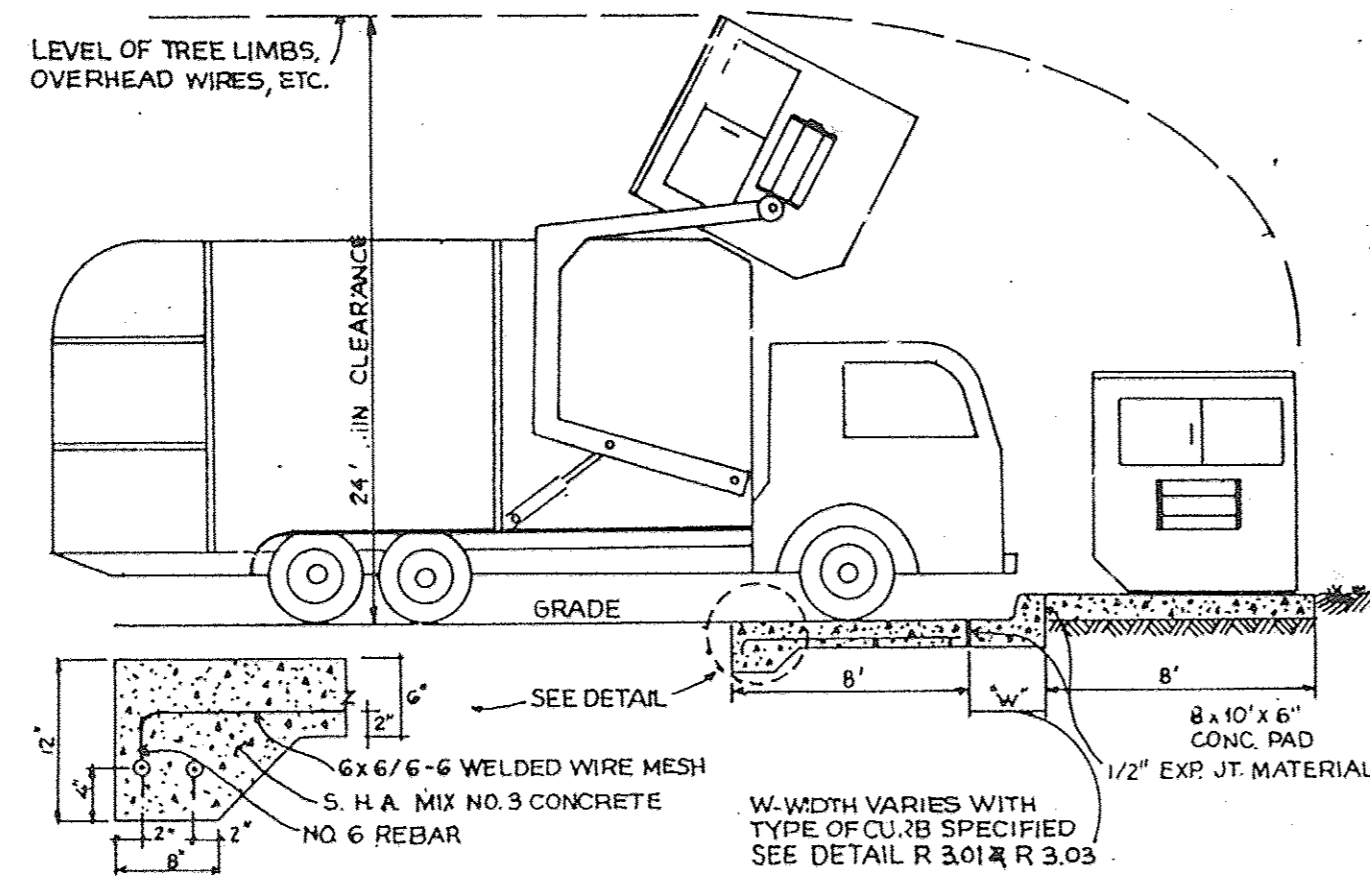

**SOLID WASTE SERVICE PAD**

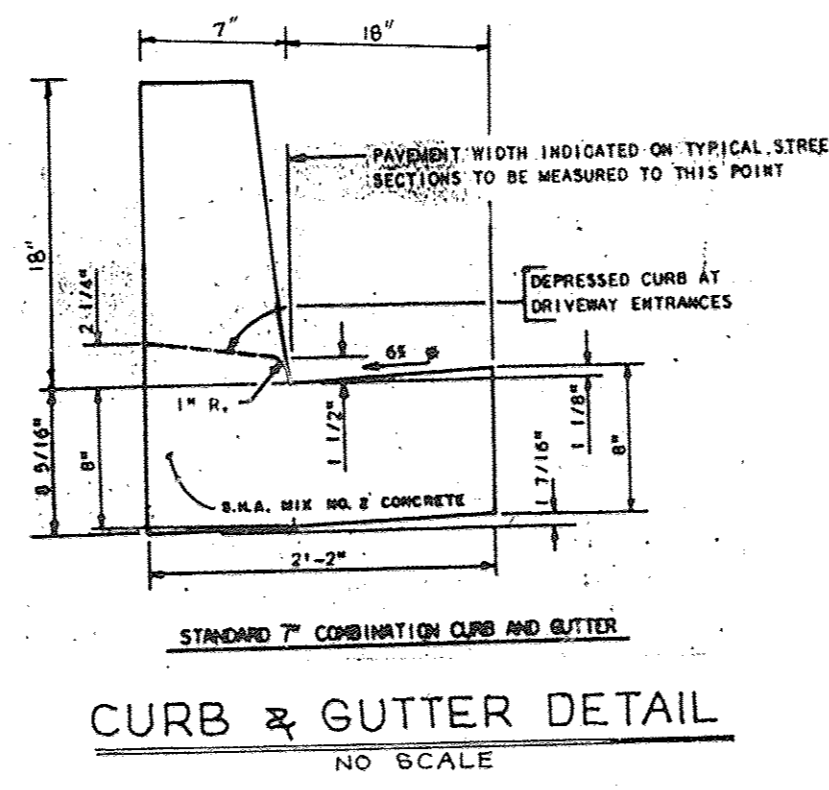

**CURB & GUTTER DETAIL**  
NO SCALE

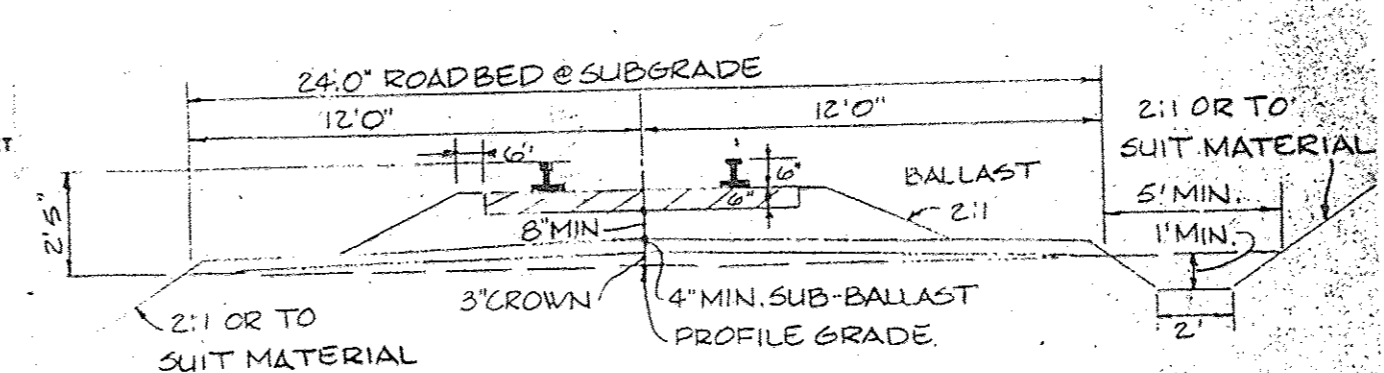

**CLASS 'B' TANGENT TRACK ROADBED SECTION**  
SCALE: 1" = 5'-0"

NOTE: ALL CLEARANCES WILL BE IN ACCORDANCE WITH B&O STANDARDS AND STATE REGULATIONS INDUSTRY TO COMPLETE ALL GRADING AND DRAINAGE AND PERFORM ALL SEDIMENT AND EROSION CONTROL IN COMPLIANCE WITH STATE AND COUNTY REGULATIONS.

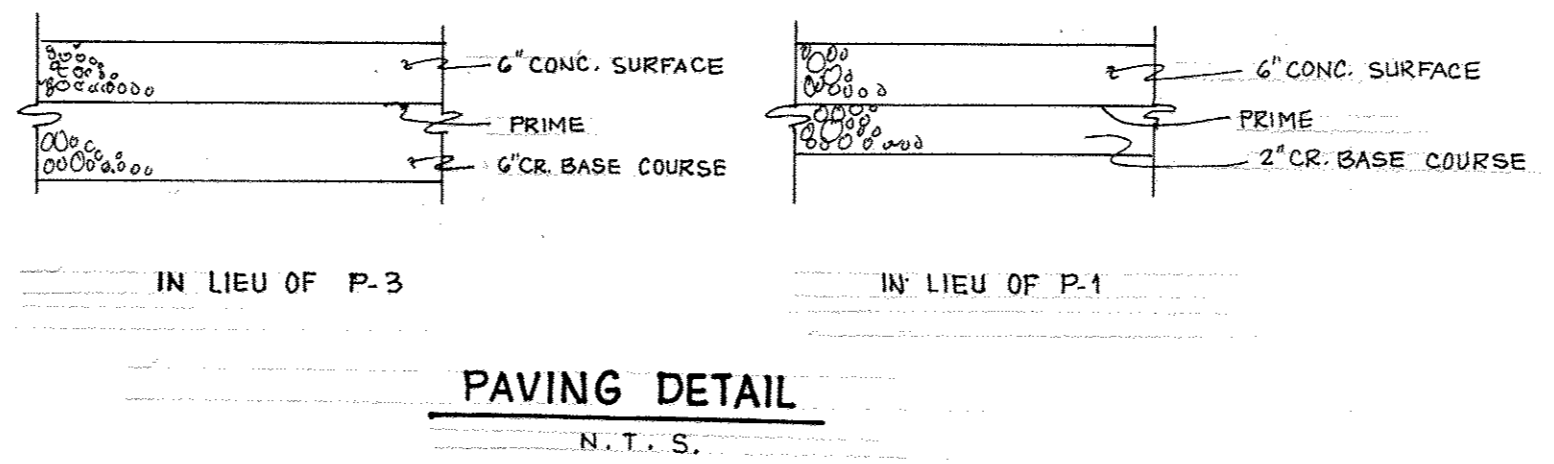

**PAVING DETAIL**  
N.T.S.

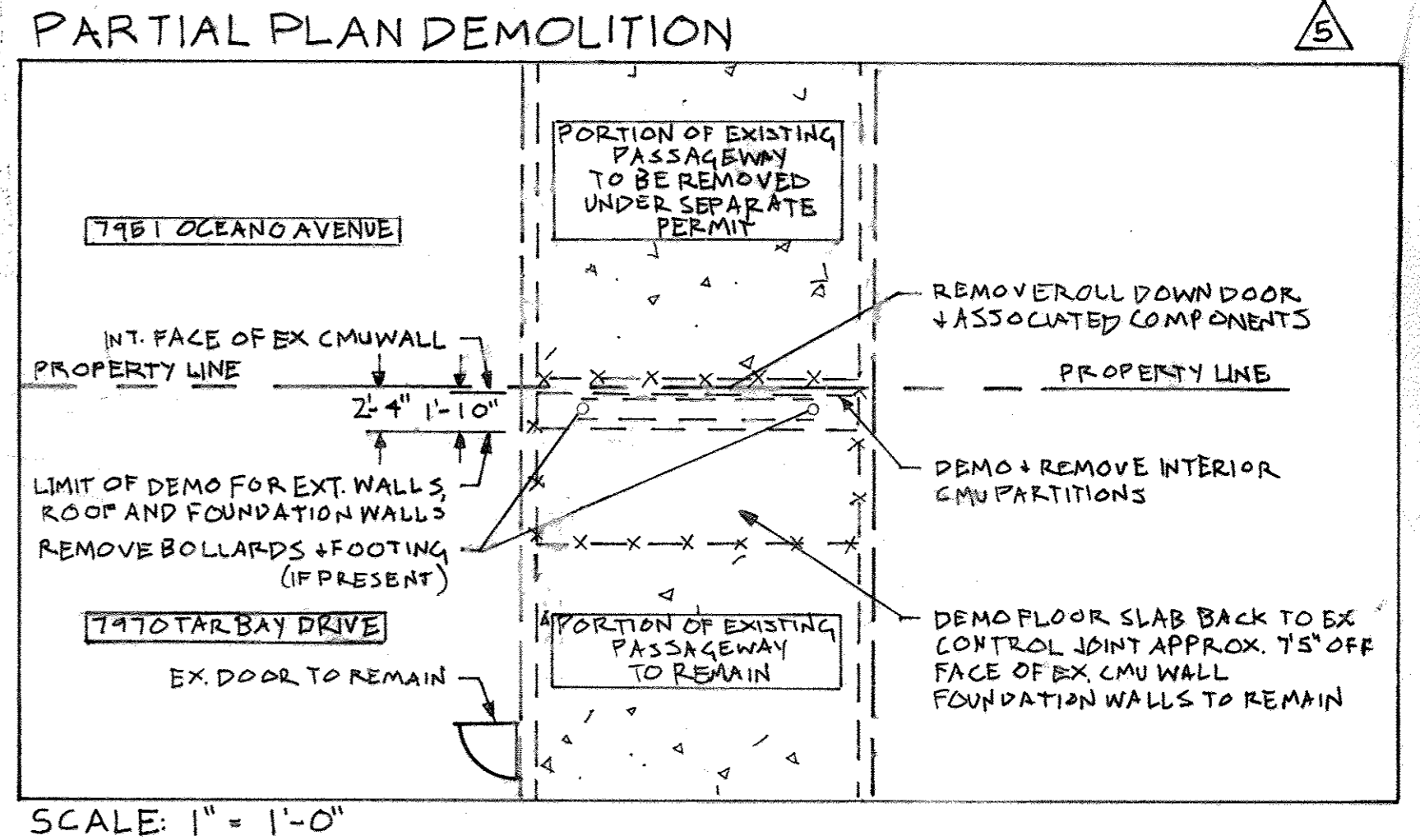

**PARTIAL PLAN DEMOLITION**  
SCALE: 1" = 1'-0"

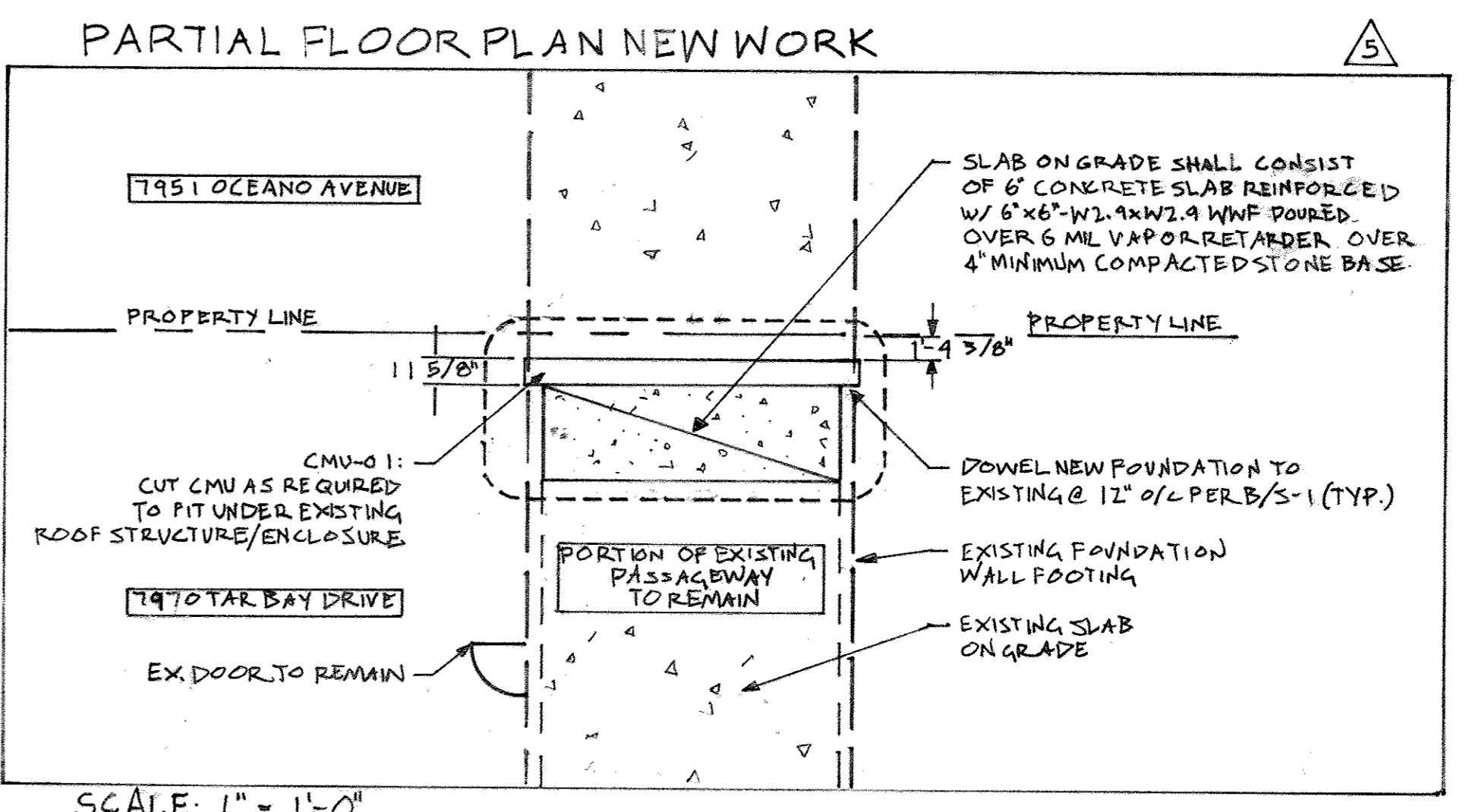

**PARTIAL FLOOR PLAN NEW WORK**  
SCALE: 1" = 1'-0"

CURVE NO.	Δ	RADIUS	DC	T	L (SEC)	BRL (2000)
1	13° 43' 57"	489.28'	12° 30'	55.30'	109.81'	109.86'
2	13° 43' 57"	489.28'	12° 30'	55.30'	109.81'	109.86'

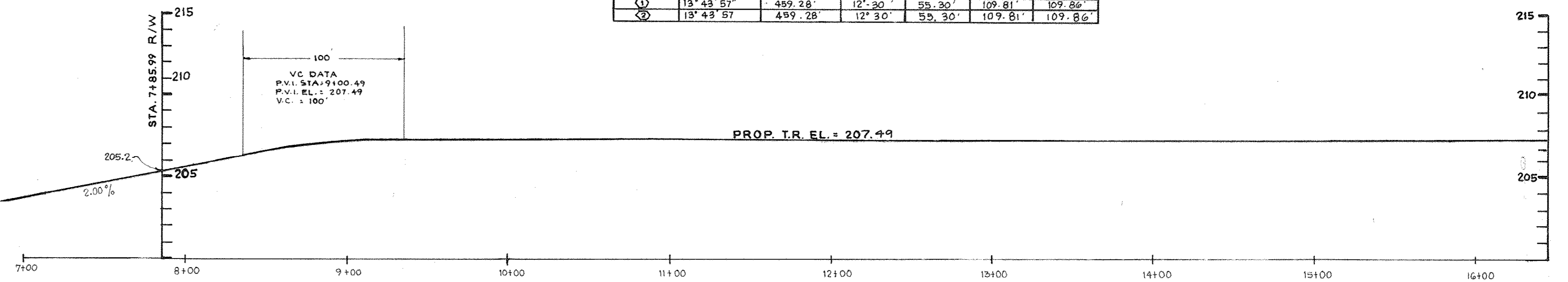

**SEDGHI & ASSOCIATES, LTD.**  
Civil Engineers · Site Planners · Surveyors  
3217 Corporate Court  
Ellicott City, MD 21043  
(301) 750-9003

APPROVED FOR PUBLIC WATER AND PUBLIC SEWERAGE SYSTEMS, HOWARD COUNTY HEALTH DEPARTMENT  
*Joseph Boylan* 3-8-90  
COUNTY HEALTH OFFICER DATE  
APPROVED FOR HOWARD COUNTY, DEPT. OF PLANNING & ZONING  
*John J. ...* 3-20-90  
DIRECTOR DATE  
APPROVED FOR PUBLIC WATER AND PUBLIC SEWERAGE STORM DRAINAGE SYSTEMS AND PUBLIC ROADS HOWARD COUNTY DEPARTMENT OF PUBLIC WORKS  
*James P. ...* 3-1-90  
DIRECTOR DATE  
*William E. ...* 2-23-90  
CHIEF BUREAU OF ENGINEERING DATE

REVIEWED FOR HOWARD COUNTY SOIL CONSERVATION DISTRICT AND MEETS TECHNICAL REQUIREMENTS  
*James H. ...* 2/20/90  
U.S. SOIL CONSERVATION SERVICE DATE  
THIS DEVELOPMENT IS APPROVED FOR EROSION AND SEDIMENT CONTROL BY THE HOWARD SOIL CONSERVATION DISTRICT.  
APPROVED:  
*John K. ...* 2/24/90  
DISTRICT HOWARD SOIL CONSERVATION DISTRICT DATE

**APPROVED**  
DIVISION OF COMMUNITY PLANNING & LAND DEVELOPMENT  
HOWARD COUNTY, MARYLAND  
DATE: \_\_\_\_\_

REVISION  
DATE NO DESCRIPTION BY  
1-8-90 1 PAVING DETAIL, C & G DETAIL V.S.  
3-7-90 5 FLOOR PLAN DEMO + NEW WORK C.E.I.

**ENGINEER'S CERTIFICATE**  
I HEREBY CERTIFY THAT THIS PLAN FOR EROSION AND SEDIMENT CONTROL REPRESENTS A PRACTICAL AND WORKABLE PLAN BASED ON MY PERSONAL KNOWLEDGE OF THE SITE CONDITIONS AND THAT IT WAS PREPARED IN ACCORDANCE WITH THE REQUIREMENTS OF THE HOWARD SOILS CONSERVATION DISTRICT.  
*Mike ...*  
SIGNATURE OF ENGINEER  
4-25-89  
DATE

**DEVELOPER'S CERTIFICATE**  
I/WE CERTIFY THAT ALL DEVELOPMENT AND CONSTRUCTION WILL BE DONE ACCORDING TO THIS PLAN OF DEVELOPMENT AND PLAN FOR EROSION AND SEDIMENT CONTROL AND THAT ALL RESPONSIBLE PERSONNEL INVOLVED IN THE CONSTRUCTION PROJECT WILL HAVE A CERTIFICATE OF ATTENDANCE AT A DEPARTMENT OF NATURAL RESOURCES APPROVED TRAINING PROGRAM FOR THE CONTROL OF SEDIMENT AND EROSION BEFORE BEGINNING THE PROJECT. I ALSO AUTHORIZE PERIODIC ONSITE INSPECTION BY THE HOWARD SOIL CONSERVATION DISTRICT OR THEIR AUTHORIZED AGENTS, AS ARE DEEMED NECESSARY.  
*Jacqueline ...* 2-7-90  
SIGNATURE OF DEVELOPER DATE

SUBDIVISION NAME: MARYLAND WHOLESALE FOOD CTR  
SECTION/AREA: 3, BLK. A  
PARCEL NO: 10  
PLAT NO: 8722  
BLOCK NO: 21  
ZONE: M-2  
TAX/ZONE: 443  
ELEC DIST: 46  
CENSUS TR: 6064  
WATER CODE: 8 02  
SEWER CODE: 3170000

**DETAILS**  
SECTION 3, BLOCK A, PLAT NO. 8722  
PARCEL D, TAX MAP 43  
GTH ELECTION DISTRICT  
HOWARD COUNTY, MARYLAND

OWNER: J. MARK CONSTRUCTION CO. INC.  
P.O. BOX 1921  
APPLETON, WISCONSIN 54913

SCALE: DRAWING 4 OF 6  
JOB NO.  
FILE NO.

**RIPRAP OUTLET SEDIMENT TRAP**

DRAINAGE AREA	8.75 AC
STORAGE REQUIRED	15,942 C.F.
STORAGE PROVIDED	15,942 C.F.
BOTTOM EL.	196
CREST EL.	200
STORAGE EL.	199
CLEAROUT EL.	197.50
TOP EL.	202
BOTTOM DIM	268X14
SIDE SLOPE	2:1

MARYLAND WHOLESALE FOOD CENTER  
SECTION 3, BLOCK A, PARCEL C  
PLAT 6096, ZONED M-2

MD. WHOLESALE FOOD MARKET  
SECTION 3, BLOCK A, PARCEL C  
PLAT 5461, ZONED M-2

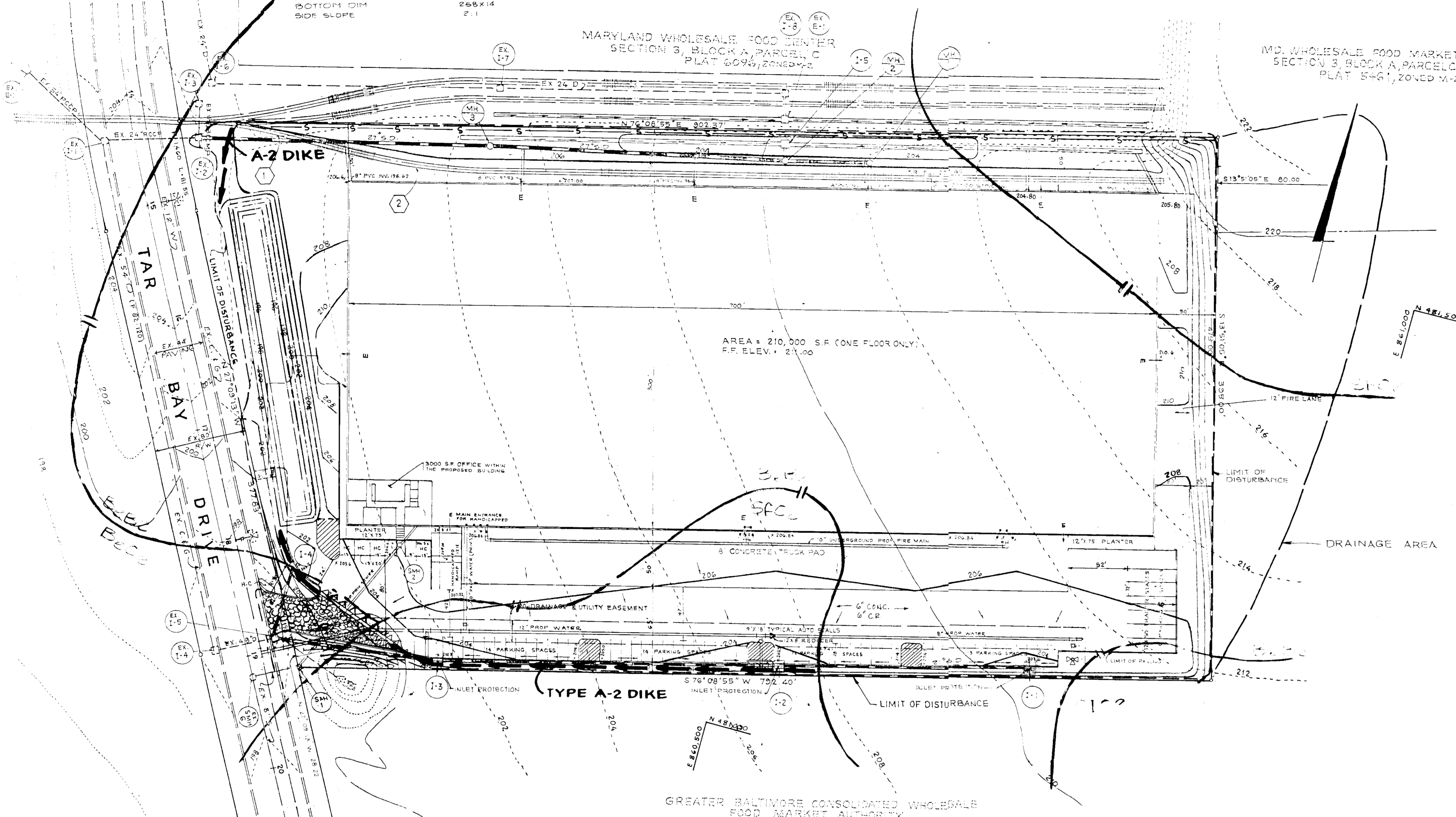

**PLAN**  
SCALE 1"=50'

- SEQUENCE OF CONSTRUCTION
1. Obtain grading permit.
  2. Notify Howard County Office of Inspection and Permits at 992-2437 a minimum of 24 hours prior to the start of any work.
  3. Install stabilized construction entrance.
  4. Construct rip-rap outlet sediment trap.
  5. Install dikes and silt fences.
  6. Clear and grade the site.
  7. Construct utilities and storm drains.
  8. Provide inlet protection for all inlets.
  9. Building construction can be started at this stage.
  10. Construct parking lots and curbs and gutters except the west parking lot.
  11. The contractor will clean the sediment trap when the silt reaches the cleanout elevation.
  12. Seed and mulch all disturbed areas except the west parking area.
  13. With the permission of sediment control inspector, remove sediment trap.
  14. Place silt fence around the location of sediment trap and grade the area.
  15. Construct the west parking and curbs and gutters.
  16. Seed and mulch the remaining area.
  17. With the permission of sediment control inspector, remove all sediment measures.

**SEDIMENT & EROSION CONTROL LEGEND**

- STABILIZED CONSTRUCTION ENTRANCE
- MOUNTABLE BERM
- SEDIMENT TRAP
- INLET PROTECTION
- SOIL LINE
- EARTH DIKE
- DRAINAGE AREA
- LIMIT OF DISTURBANCE
- SILT FENCE

HOWARD COUNTY SOIL MAP - 34

**SEDGHI & ASSOCIATES, LTD.**  
Civil Engineers - Site Planners - Surveyors  
3217 Corporate Court  
Ellicott City, MD 21043  
(301) 750-9003

APPROVED FOR PUBLIC WATER AND PUBLIC SEWERAGE SYSTEMS  
HOWARD COUNTY HEALTH DEPARTMENT  
*John S. ...* 3-8-90  
DATE

APPROVED HOWARD COUNTY DEPT. OF PLANNING & ZONING  
*...* 2-20-90  
DATE

APPROVED FOR PUBLIC WATER AND PUBLIC SEWERAGE  
STORM DRAINAGE SYSTEMS AND PUBLIC ROADS  
HOWARD COUNTY DEPARTMENT OF PUBLIC WORKS  
*James M. ...* 3/1/90  
DATE

*...* 2-23-90  
DATE

REVIEWED FOR HOWARD COUNTY SOIL CONSERVATION  
DISTRICT AND MEETS TECHNICAL REQUIREMENTS  
*...* 1/24/90  
DATE

THIS DEVELOPMENT IS APPROVED FOR EROSION AND SEDIMENT  
CONTROL BY THE HOWARD SOIL CONSERVATION DISTRICT  
APPROVED  
*...* 1/24/90  
DATE

DISTRICT  
HOWARD SOIL CONSERVATION DISTRICT  
*...* 1/24/90  
DATE

REVISION		
DATE	NO.	DESCRIPTION
11-9-90	1	PARKING ISLAND, F.H. ENTRANCE V.S.

**ENGINEER'S CERTIFICATE**

I HEREBY CERTIFY THAT THIS PLAN FOR EROSION AND SEDIMENT CONTROL REPRESENTS A PRACTICAL AND WORKABLE PLAN BASED ON MY PERSONAL KNOWLEDGE OF THE SITE CONDITIONS AND THAT IT WAS PREPARED IN ACCORDANCE WITH THE REQUIREMENTS OF THE HOWARD SOILS CONSERVATION DISTRICT.

*Mick Sedghi* 2-9-90  
SIGNATURE OF ENGINEER DATE

**DEVELOPER'S CERTIFICATE**

I, WE CERTIFY THAT ALL DEVELOPMENT AND CONSTRUCTION WILL BE DONE ACCORDING TO THIS PLAN OF DEVELOPMENT AND PLAN FOR EROSION AND SEDIMENT CONTROL AND THAT ALL RESPONSIBLE PERSONNEL INVOLVED IN THE CONSTRUCTION PROJECT WILL HAVE A CERTIFICATE OF ATTENDANCE AT A DEPARTMENT OF NATURAL RESOURCES APPROVED TRAINING PROGRAM FOR THE CONTROL OF SEDIMENT AND EROSION BEFORE BEGINNING THE PROJECT. I ALSO AUTHORIZE PERIODIC ON-SITE INSPECTION BY THE HOWARD SOIL CONSERVATION DISTRICT OR THEIR AUTHORIZED AGENTS AS ARE DEEMED NECESSARY.

*Jacqueline Jackman* 2-7-90  
SIGNATURE OF DEVELOPER DATE

SUBDIVISION NAME		SECTION / AREA		PARCEL NO.	
MARYLAND WHOLESALE FOOD CENTER		SECTION 3, BLOCK A		D	
PLAT NO.	BLOCK NO.	ZONE	TAX ZONE	ELEC. DIST.	LENUS. TR.
8722	21	M-2	4-B	1-5	...
DESIGNED		<b>SEDIMENT &amp; EROSION CONTROL PLAN &amp; SOIL MAP</b>			
DRAWN		<b>MARYLAND WHOLESALE FOOD CENTER</b>			
CHECKED		SECTION 3, BLOCK A, PLAT # 6096 & 712			
MS.		TAX MAP 43 PARCEL D			
DATE		GTH ELECTION DISTRICT			
2-9-1990		HOWARD COUNTY, MARYLAND			
OWNER		J. MARK CONSTRUCTION CO. INC.			
		P.O. BOX 1921			
		APPLETON, WISCONSIN 54919			

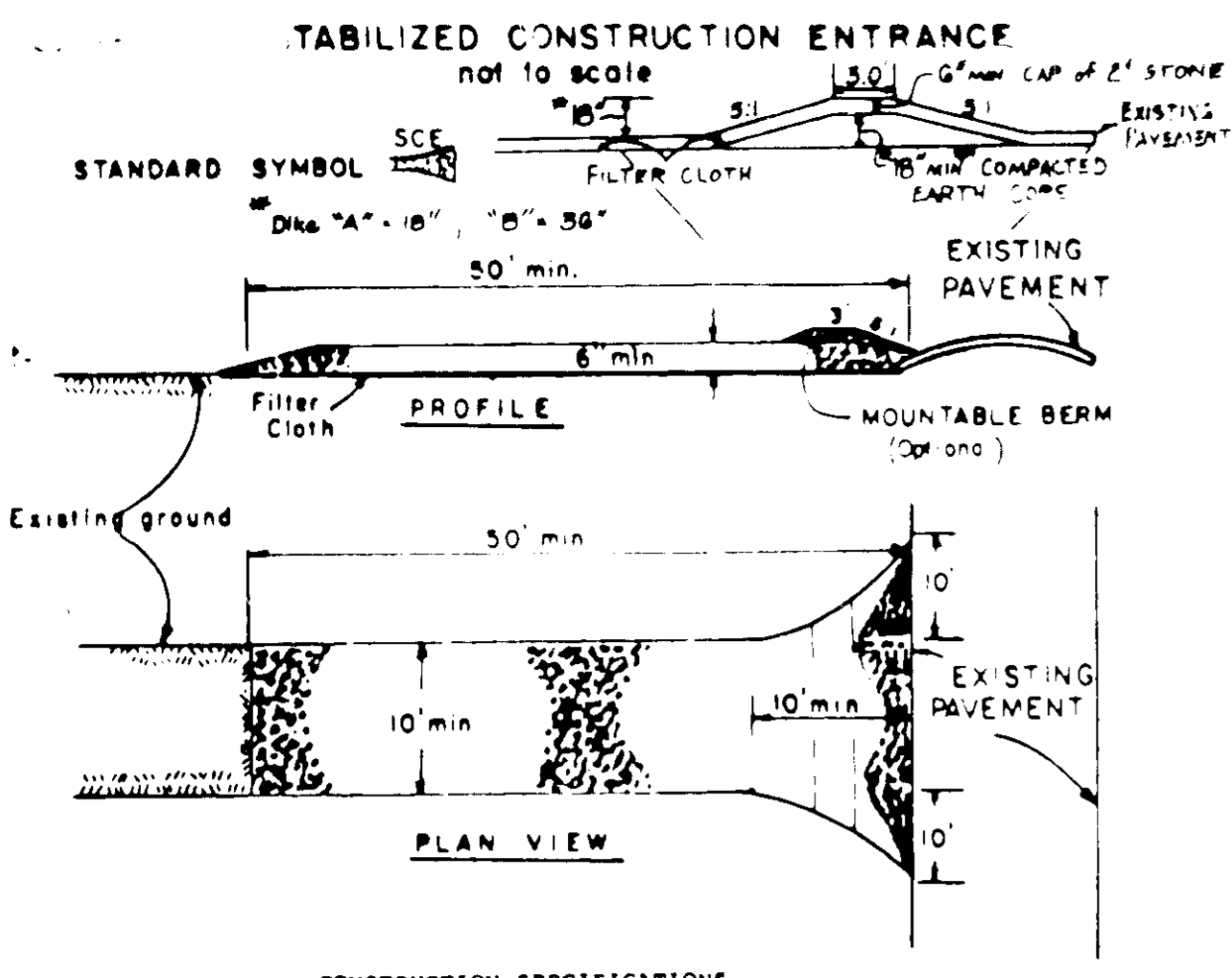

- CONSTRUCTION SPECIFICATIONS**
- Stone Size - Use 2" stone, or reclaimed or recycled concrete equivalent.
  - Length - As required, but not less than 50 feet (except on a single residence lot where a 30 foot minimum length would apply).
  - Thickness - Not less than six (6) inches.
  - Width - Ten (10) foot minimum, but not less than the full width at points where ingress or egress occurs.
  - Filter Cloth - Will be placed over the entire area prior to placing of stone. Filter will not be required on a single family residence lot.
  - Surface Water - All surface water flowing or diverted toward construction entrances shall be piped across the entrance. If piping is impractical, a mountable berm with 5:1 slopes will be permitted.
  - Maintenance - The entrance shall be maintained in a condition which will prevent tracking or flowing of sediment onto public rights-of-way. It may require periodic top dressing with additional stone as conditions demand and repair and/or cleanup of any measures used to trap sediment. All sediment spilled, dropped, washed or tracked onto public rights-of-way must be removed immediately.
  - Washing - Wheels shall be cleaned to remove sediment prior to entrance onto public rights-of-way. When washing is required, it shall be done on an area stabilized with stone and which drains into an approved sediment trapping device.
  - Periodic Inspection and needed maintenance shall be provided after each rain.

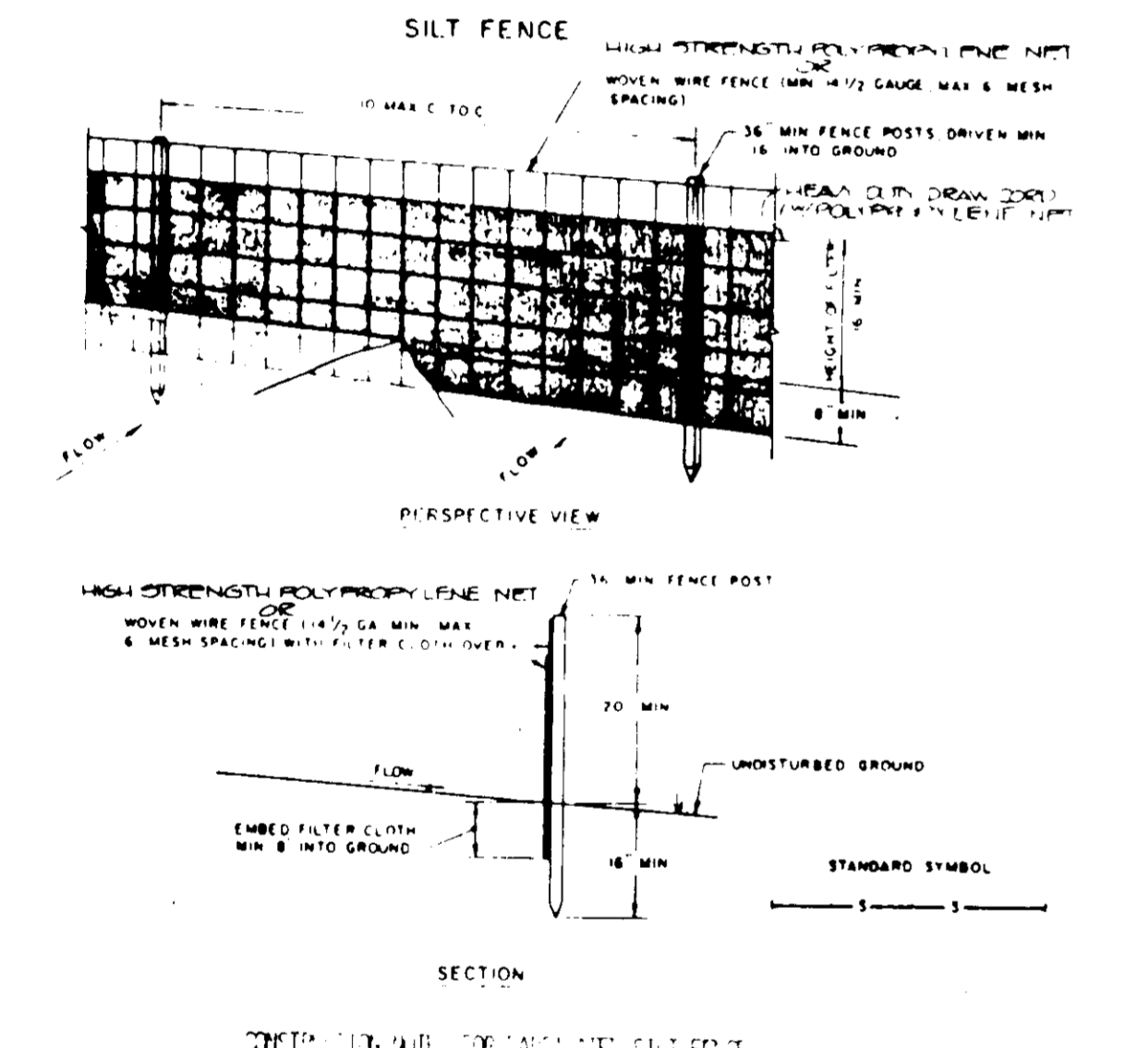

- CONSTRUCTION SPECIFICATIONS**
- MOVIE WIRE FENCE TO BE FASTENED TO WOODEN POSTS WITH WIRE TIES OR STAPLES.
  - FILTER CLOTH TO BE FASTENED TO MOVIE WIRE FENCE WITH WIRE STAPLES EVERY 12" AT TOP AND MID SECTION.
  - WHEN TWO SECTIONS OF FILTER CLOTH ADJOIN EACH OTHER THEY SHALL BE OVERLAPPED BY SIX INCHES AND FOLDED.
  - MAINTENANCE SHALL BE PROVIDED TO REPAIR AND REPLACE WHEN NECESSARY.

APPLY TO GRADED OR CLEARED AREA NOT SUBJECT TO IMMEDIATE FUTURE DISTURBANCE WHERE A PERMANENT LONG LIVED VEGETATIVE COVER IS NEEDED.

- Soil Amendments:** (1) LIME OF SOIL TEST RECOMMENDATION. (2) SOLE OF THE FOLLOWING SCHEDULES:
- Preferred - Apply 2 tons per acre dolomitic limestone (92 lbs./1000 square ft.) and 600 lbs. per acre 10-10-10 fertilizer (14 lbs./1000 sq. ft.) before seeding. Harrow or disk into upper three inches of soil. At time of seeding, apply 400 lbs. per acre 10-10-10 ureaform fertilizer (9 lbs./1000 sq. ft.).
  - Acceptable - Apply 2 tons per acre dolomitic limestone (92 lbs./1000 sq. ft.) and 1000 lbs. per acre 10-10-10 fertilizer (13 lbs./1000 sq. ft.) before seeding. Harrow or disk into upper three inches of soil.

**Seeding:** For the period March 1 thru April 30 and from August 1 thru October 15, seed with 60 lbs. per acre (1.2 lbs./1000 sq. ft.) of Kentucky 31 Tall Fescue. For the period May 1 thru July 15, seed with 50 lbs. Kentucky 31 Tall Fescue per acre and 2 lbs. per acre (.05 lbs./1000 sq. ft.) of creeping lovegrass. During the period of October 16 thru February 28, protect site by: Option (1) 2 tons per acre of well anchored straw mulch and seed as soon as possible in the spring. Option (2) Use sod. Option (3) Seed with 60 lbs./acre Kentucky 31 Tall Fescue and mulch with 2 tons/acre well anchored straw.

**Mulching:** Apply 1 1/2 to 2 tons per acre (70 to 100 lbs./1000 sq. ft.) of unrotted small grain straw immediately after seeding. Anchor mulch immediately after application using mulch anchoring tool or 218 gallons per acre (5 gal./1000 sq. ft.) of emulsified asphalt on flat areas. On slopes 8 feet or higher, use 348 gallons per acre (8 gal./1000 sq. ft.) for anchoring.

**Maintenance:** Inspect all seeded areas and make needed repairs, replacements and reseedings.

**TEMPORARY SLEEDING NOTES:** APPLY TO GRADED OR CLEARED AREA LIKELY TO BE REDISTURBED WHERE A SHORT TERM VEGETATIVE COVER IS NEEDED.

**Soil Amendments:** Apply 60 lbs. per acre 10-10-10 fertilizer (14 lbs./1000 sq. ft.)

**Seeding:** For periods March 1 thru April 30 and from August 1 thru November 15, seed with 24 lbs. per acre of annual ryegrass (2.4 lbs./1000 sq. ft.). For the period May 1 thru August 31, seed with 3 lbs. per acre of creeping lovegrass (.07 lbs./1000 sq. ft.). For the period November 16 thru February 28, protect site by applying 2 tons per acre of well anchored straw mulch and seed as soon as possible in the spring, or use sod.

**Mulching:** Apply 1 1/2 to 2 tons per acre (70 to 100 lbs./1000 sq. ft.) of unrotted small grain straw immediately after seeding. Anchor mulch immediately after application using mulch anchoring tool or 218 gal. per acre (5 gal./1000 sq. ft.) of emulsified asphalt on flat areas. On slopes 8 ft. or higher, use 348 gal. per acre (8 gal./1000 sq. ft.) for anchoring. REFER TO THE 1983 MD. STANDARD AND SPECIFICATIONS FOR SOIL EROSION AND SEDIMENT CONTROL FOR RATE AND METHODS NOT COVERED.

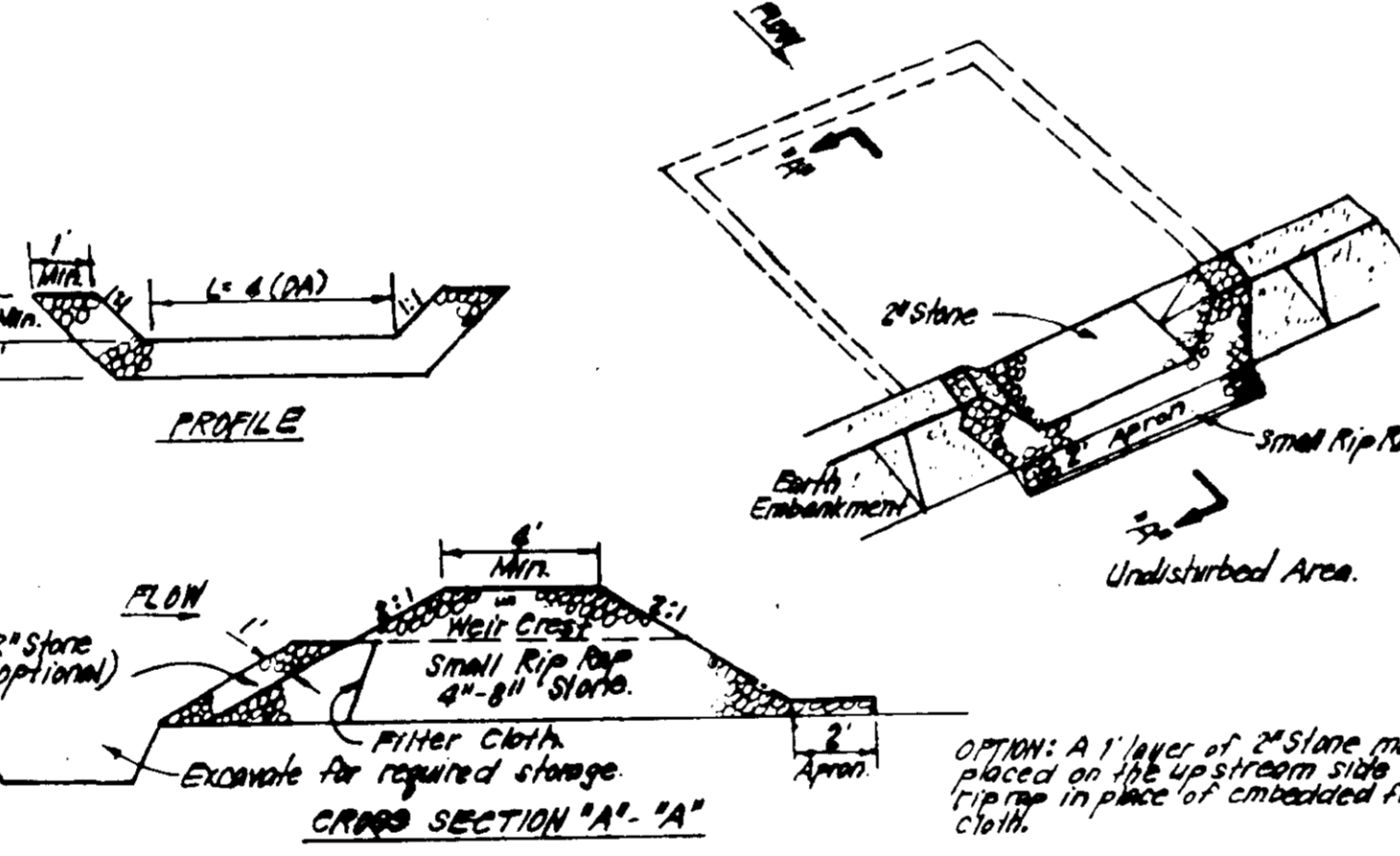

- CONSTRUCTION SPECIFICATIONS:**
- Area under embankment shall be cleared, grubbed and stripped of any vegetation and root mat. The top soil shall be preserved.
  - The fill material for the embankment shall be free of roots and other woody vegetation as well as other sized stones, rocks, organic material or other objectionable material. The embankment shall be compacted by tamping with equipment while it is being constructed.
  - All cut and fill slopes shall be 2:1 or flatter.
  - The stone used in the outlet shall be small rip-rap 4" x 4" x 4" with 1" thickness of 2" aggregate placed on the up-grade side on the small rip-rap or embedded filter cloth in the rip-rap.
  - Sediment shall be removed and trap returned to original dimensions when the sediment has accumulated to the design depth of the trap.
  - The structure shall be inspected after each rain and repairs made as needed.
  - Construction operations shall be carried out in such a manner that erosion and water pollution is minimized.
  - The structure shall be removed and the area stabilized when the drainage area has been properly stabilized.

**STONE OUTLET SEDIMENT TRAP (S.O.S.T.) STV.**  
NO SCALE

**STANDARD AND SPECIFICATIONS FOR VEGETATIVE STABILIZATION WITH SOD**

- SPECIFICATIONS**
- Class of turfgrass sod shall be Maryland or Virginia State Certified, or Maryland or Virginia State approved sod.
  - Sod shall be machine cut to a uniform soil thickness of 3/4 inch, plus or minus 1/4 inch, at the time of cutting. Measurement for thickness shall exclude top growth and thatch.
  - Standard size sections of sod shall be strong enough to support their own weight and retain their size and shape when suspended vertically with a firm grasp on the upper 10 percent of the section.
  - Individual pieces of sod shall be cut to the suppliers width and length. Maximum allowable deviation from standard widths and lengths shall be 5 percent. Broken pads and torn or uneven ends will not be acceptable.
  - Sod shall not be harvested or transplanted when moisture content (excessively dry or wet) may adversely affect its survival.
  - Sod shall be harvested, delivered and installed within a period of 36 hours. Sod not transplanted within this period shall be inspected and approved prior to its installation.

**1. Site Preparation**  
Fertilizer and lime application rates shall be determined by soil tests. Under unusual circumstances where there is insufficient time for a complete soil test, fertilizer and lime materials may be applied in amounts shown under B, below.

- Prior to sodding, the surface shall be cleared of all trash, debris, and of all roots, brush, wire, grade stakes and other objects that would interfere with planting, fertilizing or maintenance operations.
- Where the soil is acid or composed of heavy clays, ground limestone shall be spread at the rate of 2 tons/acre or 100 pounds per 1,000 square feet. In all soils, 1,000 pounds per acre or 25 pounds per 1,000 square feet of 10-10-10 fertilizer or equivalent shall be uniformly applied and mixed into the top 3 inches of soil with the required lime.
- All areas receiving sod shall be uniformly fine graded. Hard-packed earth shall be scarified prior to placement of sod.

**EQUIPMENT CONTROL NOTES**

- A minimum of 24 hours notice must be given to the Howard County Office of Inspection and Permits prior to the start of any construction. (891-2437)
- All vegetative and structural practices are to be installed according to the provisions of this plan and are to be in conformance with the 1983 MARYLAND STANDARDS AND SPECIFICATIONS FOR SOIL EROSION AND SEDIMENT CONTROL.
- Following initial soil disturbance or redisturbance, permanent or temporary stabilization shall be completed within a) 7 calendar days for all perimeter sediment control structures, dikes, perimeter slopes and all slopes greater than 3:1; b) 14 days as to all other disturbed or graded areas on the project site.
- All sediment traps/basins shown must be fenced and warning signs posted around their perimeter in accordance with Vol. 1, Chapter 12, of the HOWARD COUNTY DESIGN MANUAL, Storm Drainage.
- All disturbed areas must be stabilized within the time period specified above in accordance with the 1983 MARYLAND STANDARDS AND SPECIFICATIONS FOR SOIL EROSION AND SEDIMENT CONTROL for permanent seedings (Sec. 31) sod (Sec. 34), temporary seeding (Sec. 30) and mulching (Sec. 31.) Temporary stabilization with mulch alone can only be done when recommended seeding dates do not allow for proper germination and establishment of grasses.
- All sediment control structures are to remain in place and are to be maintained in operative condition until permission for their removal has been obtained from the Howard County Sediment Control Inspector.

**7) Site Analysis:**

Total Area of Site	2.852 Acres
Area Disturbed	2.20 Acres
Area to be roofed or paved	0.97 Acres
Area to be vegetatively stabilized	2.372 Acres
Total Cut	28,000 Cu. yds
Total Fill	36,000 Cu. yds
Offsite waste/borrow area location	N/A

- Any sediment control practice which is disturbed by grading activity for placement of utilities must be repaired on the same day of disturbance.
- Additional sediment control must be provided, if deemed necessary by the Howard County DM sediment control inspector.
- On all sites with disturbed areas in excess of 2 acres, approval of the inspection agency shall be requested upon completion of installation of perimeter erosion and sediment controls, but before proceeding with any other earth disturbance or grading. Other building or grading inspection approvals may not be authorized until this initial approval by the inspection agency is made.
- If houses are to be constructed on "A" or "B" basins, at random, Single Lot Sediment Control as shown below shall be implemented.
- All pipes to be blocked at the end of each day (see detail below).
- The total amount of straw bale dikes/silt fence equals 0.740 L.P.

**GENERAL NOTES**

- Refer to "1983 Maryland Standards and Specifications for Soil Erosion and Sediment Control" for standard details and detailed specifications on each practice specified herein.
- With the approval of the sediment control inspector, minor field adjustments can and will be made to insure the control of any sediment. Changes in sediment control practices require prior approval of the sediment control inspector and the Howard County Soil Conservation District.
- At the end of each working day, all sediment control practices will be inspected and left in operational condition.
- Following initial soil disturbance or redisturbance, permanent or temporary stabilization shall be completed within a) seven calendar days as to the surface of all perimeter controls, dikes, mulches, ditches, perimeter slopes, and all slopes greater than 3 horizontal to 1 vertical (3:1) and b) fourteen days as to all other disturbed or graded areas on the project site.
- Any change to the grading proposed on this plan requires re-submission to Howard County Soil Conservation District for approval.
- Dust control will be provided for all disturbed areas. Refer to 1983 Maryland Standards and Specifications for Soil Erosion and Sediment Control, pp. 881 and 87.02 for acceptable methods and specifications for dust control.
- Any variation from the sequence of operations stated on this plan requires the approval of the sediment control inspector and the Howard County Soil Conservation District prior to the initiation of the change.
- Excess cut or borrow material shall go to or come from, respectively, a site with an approved sediment control plan.

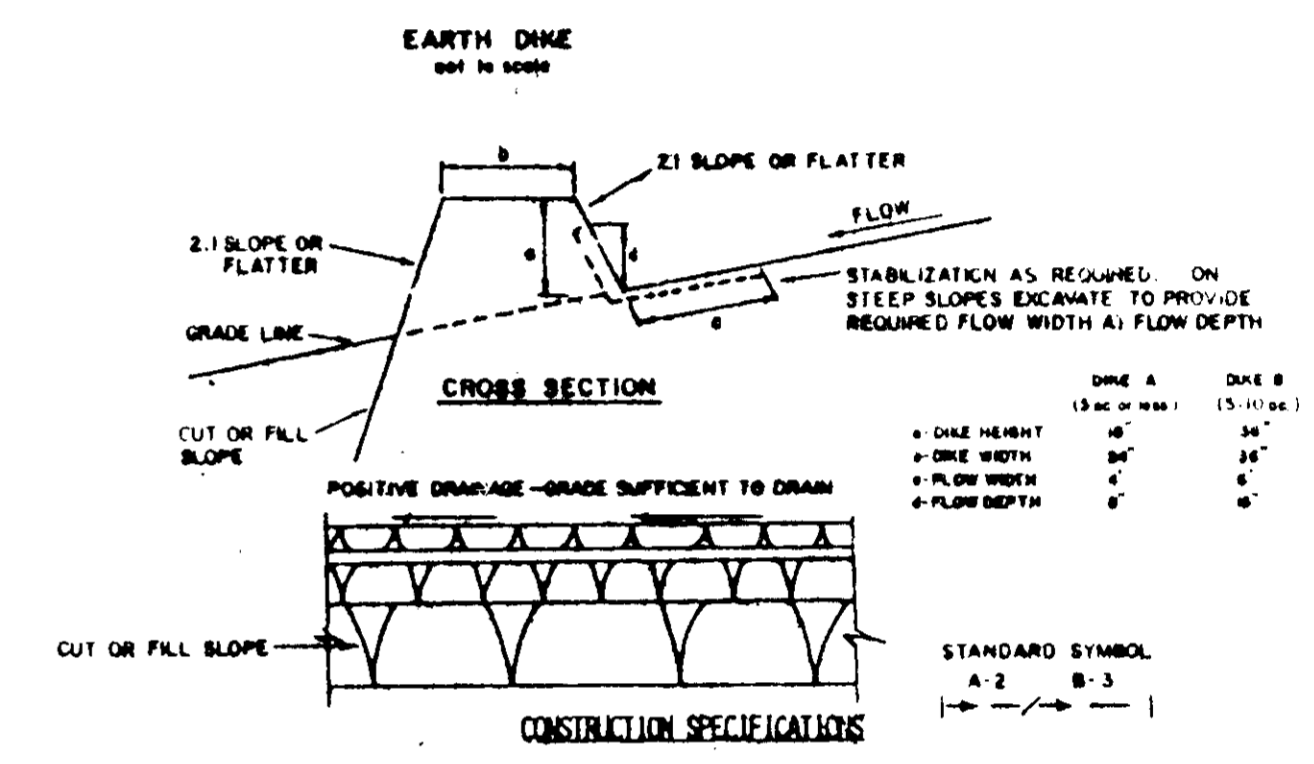

**CONSTRUCTION SPECIFICATIONS**

TYPE OF TREATMENT	CHANNEL TRAP	DIKE A	DIKE B
1	5-3.0K	SEED AND STRAW MULCH	SEED AND STRAW MULCH
2	3.1-5.0K	SEED AND STRAW MULCH	SEED USING JUTE, OR EXCELSTON SOOD; 2" STONE
3	5.1-8.0K	SEED WITH JUTE, OR SOO; 2" STONE	LINED RIP-RAP 4-8"
4	8.1-20K	LINED RIP-RAP 4-8"	EMBANKMENT DESIGN

**EARTH DIKE NO SCALE**

APPROVED FOR PUBLIC WATER AND PUBLIC SEWERAGE SYSTEMS, HOWARD COUNTY HEALTH DEPARTMENT.  
 COUNTY HEALTH OFFICER: *James Boyd* 3-8-90  
 APPROVED FOR HOWARD COUNTY DEPT. OF PLANNING & ZONING.  
 DIRECTOR: *James P. Shaw* 3/30/90  
 CHIEF DIVISION OF COMMUNITY PLANNING & LAND DEVELOPMENT  
 APPROVED FOR PUBLIC WATER AND PUBLIC SEWERAGE, STORM DRAINAGE SYSTEMS AND PUBLIC ROADS, HOWARD COUNTY DEPARTMENT OF PUBLIC WORKS.  
 DIRECTOR: *James P. Shaw* 3/1/90  
 CHIEF BUREAU OF ENGINEERING: *James P. Shaw* 2-23-90

Reviewed for Name: *Howard* SCD and meets technical requirements.  
 Signature: *James P. Shaw* Date: *2/24/90*  
 U.S. SOIL CONSERVATION SERVICE  
 THIS DEVELOPMENT PLAN IS APPROVED FOR SOIL EROSION AND SEDIMENT CONTROL BY HOWARD COUNTY SOIL CONSERVATION DISTRICT.  
 Approved: *James P. Shaw* Date: *2/24/90*

DEVELOPER'S/BUILDER'S CERTIFICATE  
 I HEREBY CERTIFY THAT ALL DEVELOPMENT AND CONSTRUCTION WILL BE DONE IN ACCORDANCE WITH THIS PLAN OF DEVELOPMENT AND PLAN FOR EROSION AND SEDIMENT CONTROL AND THAT ALL RESPONSIBLE PERSONNEL INVOLVED IN THE CONSTRUCTION OF THIS PROJECT WILL HAVE A CERTIFICATE OF ATTENDANCE AT A DEPT. OF NATURAL RESOURCES APPROVED TRAINING PROGRAM FOR THE CONTROL OF SEDIMENT AND EROSION BEFORE BEGINNING THE PROJECT. I ALSO AUTHORIZE PERIODIC ON SITE INSPECTION BY THE HOWARD COUNTY SOIL CONSERVATION DISTRICT OR THEIR AUTHORIZED AGENTS AS ARE DEEMED NECESSARY.  
 DEVELOPER/BUILDER: *Jacqueline Gorman* 2-7-90

ENGINEER'S CERTIFICATE  
 I HEREBY CERTIFY THAT THIS PLAN FOR EROSION AND SEDIMENT CONTROL REPRESENTS A PRACTICAL AND WORKABLE PLAN BASED ON MY PERSONAL KNOWLEDGE OF THE SITE CONDITIONS AND THAT IT WAS PREPARED IN ACCORDANCE WITH THE REQUIREMENTS OF THE HOWARD COUNTY SOIL CONSERVATION DISTRICT.  
 ENGINEER: *James P. Shaw* 2-9-90

**SEDGHI & ASSOCIATES, LTD.**  
 Civil Engineers • Site Planners • Surveyors  
 3217 Corporate Court  
 Ellicott City, MD 21043  
 (301) 750-9003

**SEDIMENT CONTROL DETAIL**  
**MARYLAND WHOLESALE FOOD CENTER**  
 SECTION 3, BLOCK A, PLAT NO. 009487-22  
 PARCEL D, TAX MAP 43  
 6TH ELECTION DISTRICT  
 HOWARD COUNTY, MARYLAND

DESIGNED VS  
 DRAWN VS  
 CHECKED MS  
 DATE 2-9-90

SCALE AS SHOWN  
 DRAWN BY  
 JOE NO  
 FILE NO

OWNER: J. MARK CONSTRUCTION CO. INC. P.O. BOX 1921 APPLETON, WISCONSIN 54912  
 DATE: 2-9-90