

TYPICAL HOUSES

Scale 1" = 30'

NOTE: All units have 1" roof eaves front & rear

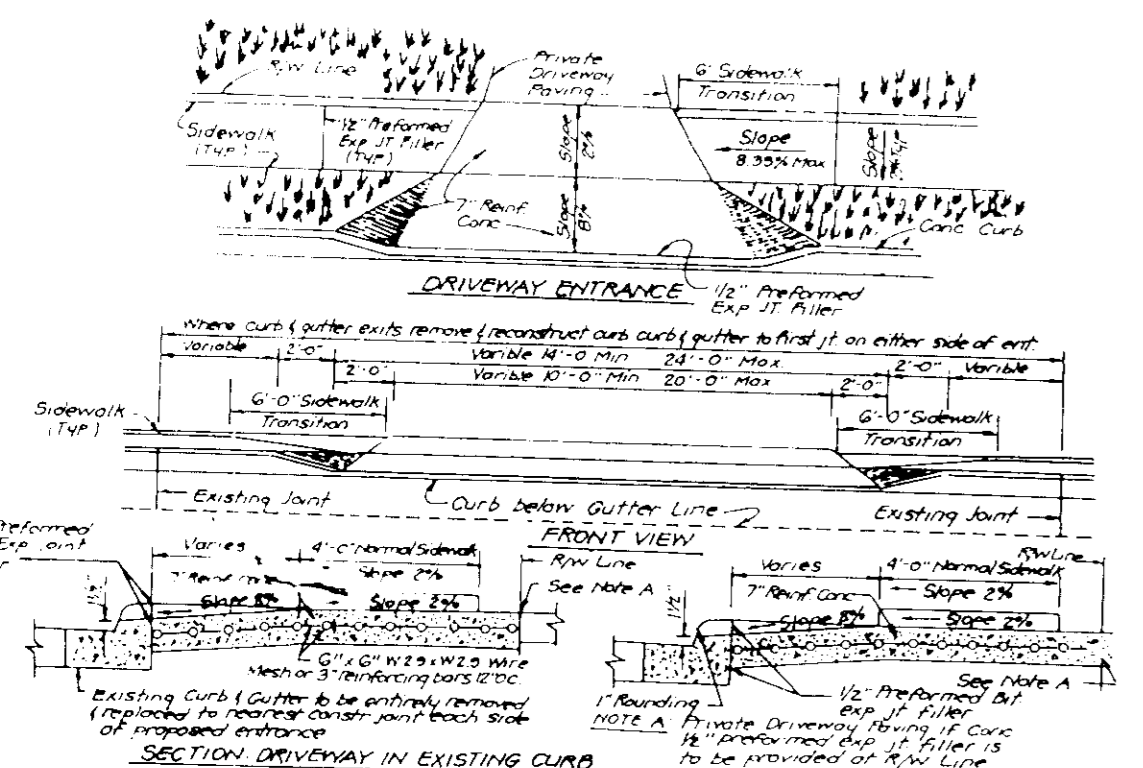

DRIVEWAY ABUTTING CLOSED SECTION WITH STD 7" COMB. CURB & GUTTER & SIDEWALK SET BACK FROM CURB

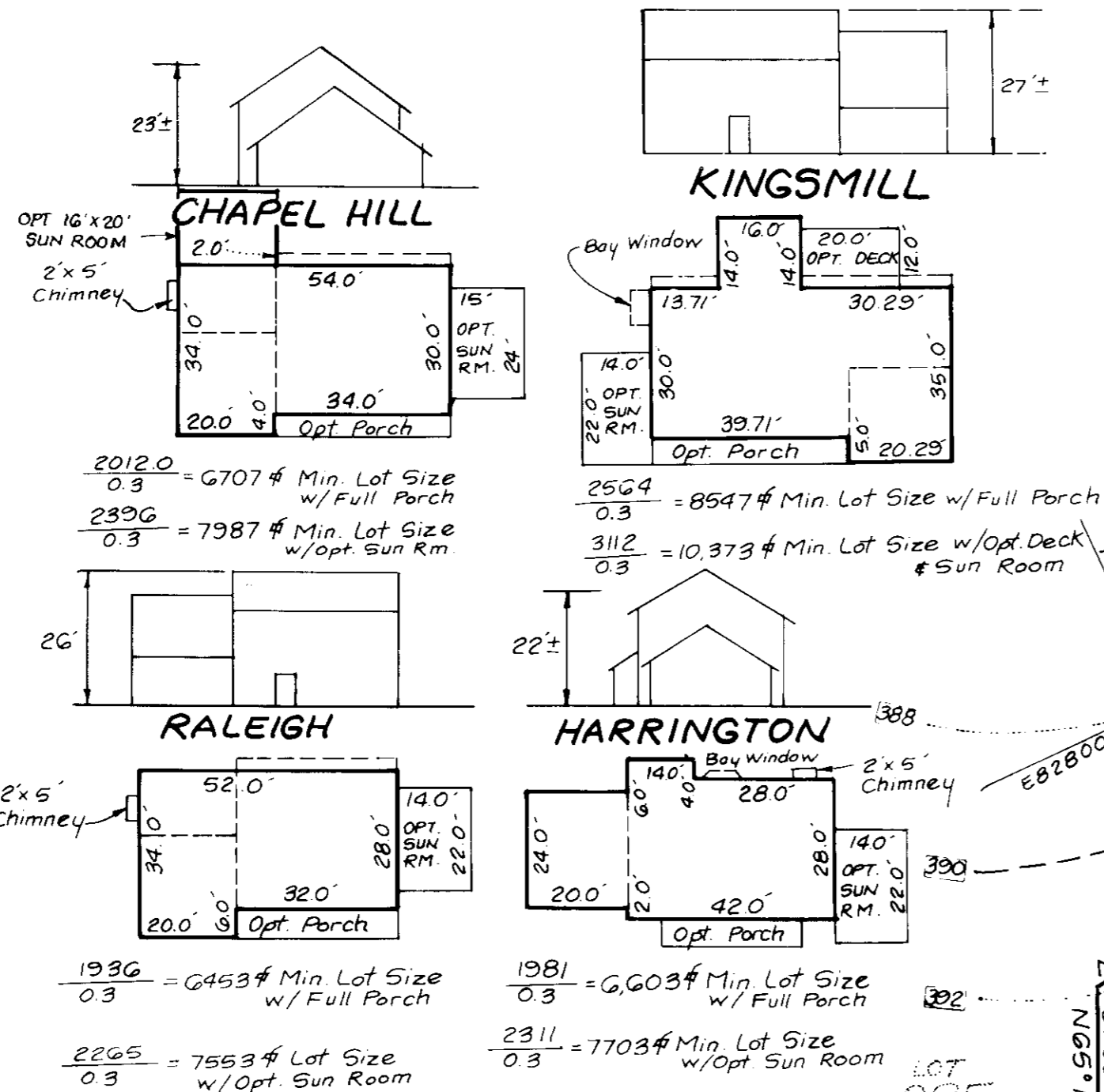

CHapel Hill
2012.0 = 6707# Min Lot Size w/ Full Porch
2306.0 = 7987# Min Lot Size w/ Opt Sun Rm

Kingsmill
2504 = 8547# Min Lot Size w/ Full Porch
3112 = 10,373# Min Lot Size w/ Opt Deck & Sun Room

Raleigh
1936 = 6453# Min Lot Size w/ Full Porch
2295 = 7553# Lot Size w/ Opt Sun Room

Harrington
1981 = 6,603# Min Lot Size w/ Full Porch
2311 = 7703# Min Lot Size w/ Opt Sun Room

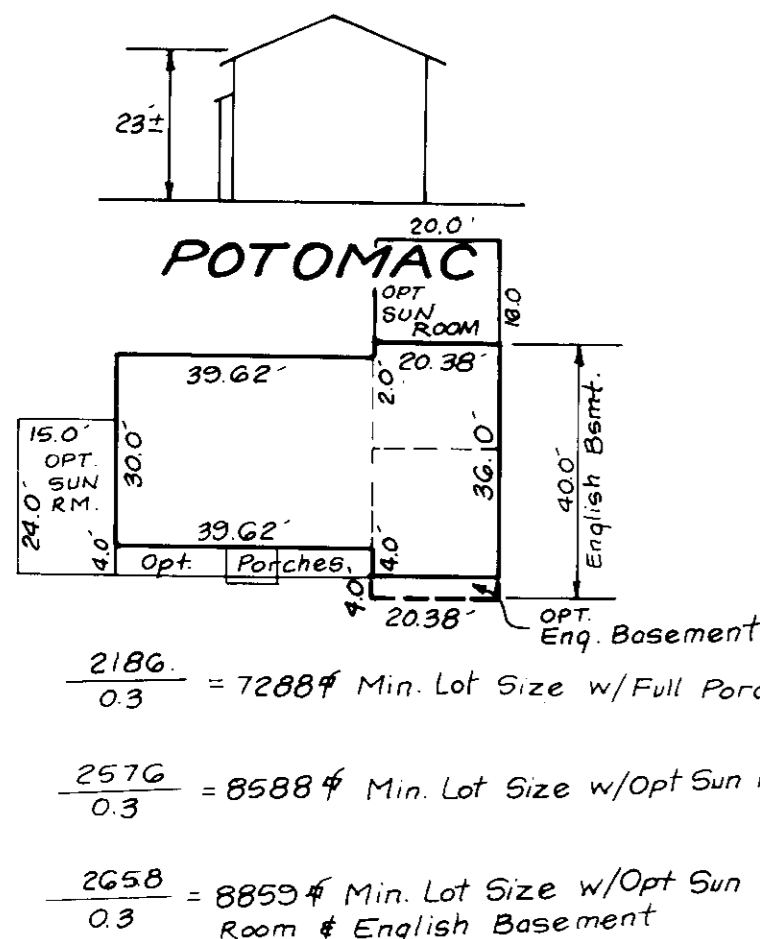

POTOMAC
2186 = 7288# Min Lot Size w/ Full Porch
2576 = 8588# Min Lot Size w/ Opt Sun Room
2658 = 8859# Min Lot Size w/ Opt Sun Room & English Basement

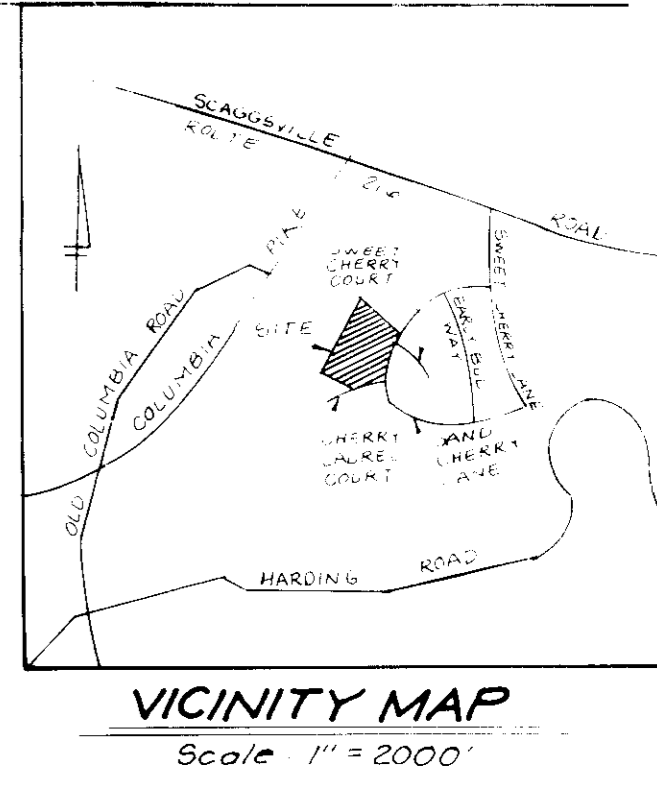

VICINITY MAP
Scale 1" = 2000'

LEGEND

- Contour Interval 2 FT
- Existing Contour (dashed line)
- Proposed Contour (solid line)
- Spot Elevation (+10%)
- Direction of Drainage (arrow)
- Walk out Basement (dotted area)
- Trees to be Saved (cloud symbol)

GENERAL NOTES

- Subject Property zoned R-20 as per Comprehensive Zoning Plan dated 8/2/85
- All horizontal controls are based on Maryland State coordinates
- All vertical controls are based on USGS datum
- All roads are public and existing
- Total number of lots: 11
- Total area of lots: 4.61 Ac
- Topo was field run by Clark, Finerock & Sackett, Inc
- Howard County Reference Numbers: 5-98-109, 2-89-10 & 7-89-55
- Minimum Lot Coverage is 30%

SPECIAL NOTES

- All Road Construction, Storm Drainage Facilities and Public Water and Sewer are shown for reference only. Use approved Howard County plans for all phases of construction

ADDRESS CHART

Lot	STREET	ADDRESS
204	8404	CHERRY LAUREL COURT
205	8376	SAND CHERRY LANE
206	8372	
207	8370	
208	8368	
209	8366	
210	8364	
211	8362	
212	8360	
213	8358	
214	8356	SAND CHERRY LANE

Subdivision Name	CHERRY TREE FARM	Block No	10	Zone	R-20	Tax/Map No	46	Elem. Dist	G	Census Tr	6063
Water Code	E-18	Sewer Code	7602000								

APPROVED: FOR PUBLIC WATER AND PUBLIC SEWERAGE SYSTEMS, HOWARD COUNTY HEALTH DEPARTMENT
 [Signature] DATE 7-31-89
 COUNTY HEALTH OFFICER

APPROVED: HOWARD COUNTY OFFICE OF PLANNING & ZONING
 [Signature] DATE 8/13/89
 PLANNING DIRECTOR

APPROVED: FOR PUBLIC WATER AND PUBLIC SEWERAGE, STORM DRAINAGE SYSTEMS AND PUBLIC ROADS, HOWARD COUNTY DEPARTMENT OF PUBLIC WORKS
 [Signature] DATE 7/26/89
 DIRECTOR

APPROVED: FOR PUBLIC WATER AND PUBLIC SEWERAGE, STORM DRAINAGE SYSTEMS AND PUBLIC ROADS, HOWARD COUNTY DEPARTMENT OF PUBLIC WORKS
 [Signature] DATE 7-25-89
 CHIEF BUREAU OF ENGINEERING

CLARK • FINEROCK & SACKETT INC.
 ENGINEERS • PLANNERS • SURVEYORS
 7135 MINSTREL WAY • COLUMBIA MD 21045 • (301) 381-7500 • BALTO • (410) 611-1111 • WASH

DESIGNED: J.M.E.
DRAWN: BAR
CHECKED: J.M.E.
DATE: April 1989

SITE DEVELOPMENT PLAN
 SECTION 1 AREA 3
 LOTS 204-214

CHERRY TREE FARM
 6TH ELECTION DISTRICT
 HOWARD COUNTY, MARYLAND

OWNER / DEVELOPER:
 CHERRY TREE VENTURE
 6301 IVY LANE SUITE 714
 GREENBELT, MD 20770

SCALE: 1" = 30'
DRAWING: 1 of 3
JOB NO: 89-049
FILE NO: 89-049X

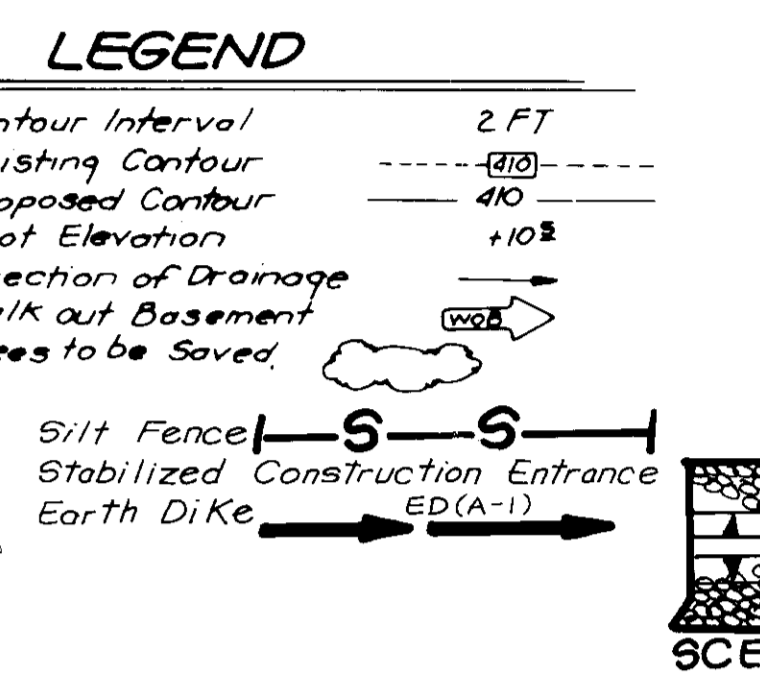
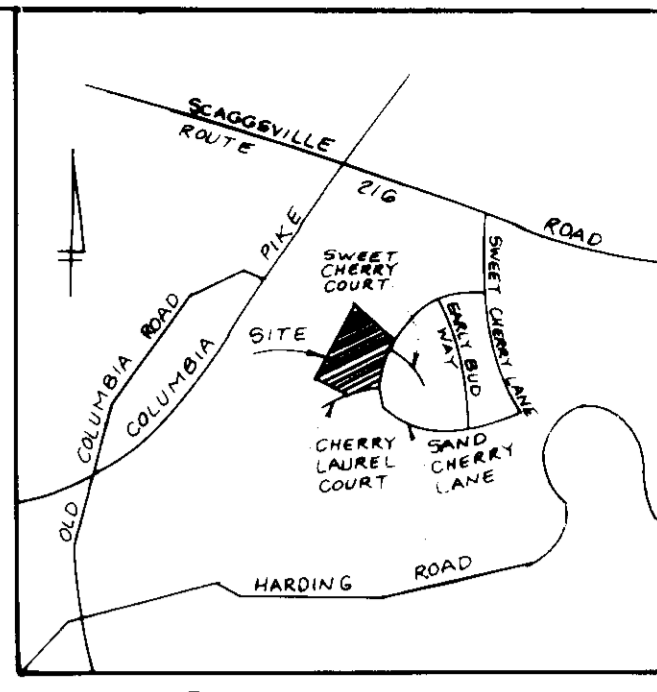

DEVELOPER'S/BUILDER'S CERTIFICATE

I/We certify that all development and construction will be done according to this plan of development and plan for erosion and sediment control and that all responsible personnel involved in the construction project will have a Certificate of Attendance at a Dept. of Natural Resources Approved Training Program for the Control of Sediment and Erosion before beginning the project. I also authorize periodic on-site inspection by the Howard Soil Conservation District or their authorized agents, as are deemed necessary.

[Signature] 4-27-89
Signature of Developer/Builder Date

Reviewed for Name S.G.D. and meets Technical Requirements
Signature Date
U.S. Soil Conservation Service

THIS DEVELOPMENT PLAN IS APPROVED FOR SOIL EROSION AND SEDIMENT CONTROL BY THE HOWARD SOIL CONSERVATION DISTRICT.

[Signature] Date

Subdivision Name	CHERRY TREE FARM	Section	1	Area	3	Lots	204-214
Plot No.	8616	Block No.	10	Zone	R-20	Elec. Dist.	4G
Water Code	E-18	Sewer Code	7G02000				6063

CLARK • FINEFROCK & SACKETT, INC.
ENGINEERS • PLANNERS • SURVEYORS
7135 MINISTREL WAY • COLUMBIA MD 21045 • (301) 381-7500 • BALTO • (301) 621-8100 • WASH

DESIGNED KIWM
DRAWN BAR
CHECKED KIWM
DATE April 1989

SCALE 1" = 30'
DRAWING 2 of 3
JOB NO. 89-049
FILE NO. 89-0495E

FOR: N.V. HOMES, INC.
10230 New Hampshire Ave. # 203
Silver Spring MD 20903

ENGINEER'S CERTIFICATE

I hereby certify that this plan for Erosion and Sediment Control represents a practical and workable plan based on my personal knowledge of the site conditions and that it was prepared in accordance with the requirements of the Howard Soil Conservation District.

[Signature] 4-27-89
G. Nelson Clark Date

OWNER / DEVELOPER:
CHERRY TREE VENTURE
6301 IVY LANE SUITE 714
GREENBELT, MD 20770

Refurbish Ex. TRAP #1 505T (ST-V)
(SDP-88-207) to specifications shown
DA = 1.30 Ac.
Storage Req'd = 3420 cf
Storage Provided = 3420 cf
Depth = 4'
Top of Stone Elev = 393.00
Bottom Elev = 388.00
Clean Out Elev = 390.00
Bottom Dimensions = 53'x11'
1:1 Side Slopes in cut

- PERMANENT SEEDING NOTES**
- Apply to graded or cleared areas not subject to immediate further disturbance where a permanent long-lived vegetative cover is needed.
- Seeded Preparation:** Loosen upper three inches of soil by raking, discing or other acceptable means before seeding, if not previously loosened.
- Soil Amendments:** In lieu of soil test recommendations, use one of the following schedules:
- Preferred - Apply 2 tons per acre dolomitic limestone (92 lbs/1000 sq ft) and 400 lbs per acre 10-10-10 fertilizer (14 lbs/1000 sq ft) before seeding. Harrow or disc into upper three inches of soil. At time of seeding, apply 400 lbs per acre 30-0-0 ureaform fertilizer (9 lbs/1000 sq ft).
 - Acceptable - Apply 2 tons per acre dolomitic limestone (92 lbs/1000 sq ft) and 1000 lbs per acre 10-10-10 fertilizer (23 lbs/1000 sq ft) before seeding. Harrow or disc into upper three inches of soil.
- Seeding:** For the periods March 1 thru April 30, and August 1 thru October 15, seed with 60 lbs per acre (1.4 lbs/1000 sq ft) of Kentucky 31 Tall Fescue. For the period May 1 thru July 31, seed with 60 lbs Kentucky 31 Tall Fescue per acre and 2 lbs per acre (.05 lbs/1000 sq ft) of weeping lovegrass. During the period of October 16 thru February 28, protect site by: Option (1) 2 tons per acre of well anchored straw mulch and seed as soon as possible in the spring. Option (2) Use sod. Option (3) Seed with 60 lbs/acre Kentucky 31 Tall Fescue and mulch with 2 tons/acre well anchored straw.
- Mulching:** Apply 1 1/2 to 2 tons per acre (70 to 90 lbs/1000 sq ft) of unrotted small grain straw immediately after seeding. Anchor mulch immediately after application using mulch anchoring tool or 218 gallons per acre (5 gal/1000 sq ft) of emulsified asphalt on flat areas. On slopes 8 feet or higher, use 348 gallons per acre (8 gal/1000 sq ft) for anchoring.
- Maintenance:** - Inspect all seeded areas and make needed repairs, replacements and reseedings.
- TEMPORARY SEEDING NOTES**
- Apply to graded or cleared areas likely to be redisturbed where a short-term vegetative cover is needed.
- Seeded Preparation:** Loosen upper three inches of soil by raking, discing or other acceptable means before seeding, if not previously loosened.
- Soil Amendments:** Apply 600 lbs per acre 10-10-10 fertilizer (14 lbs/1000 sq ft).
- Seeding:** For periods March 1 thru April 30 and from August 15 thru November 15, seed with 2 1/2 bushel per acre of annual ryegrass (3.2 lbs/1000 sq ft). For the period May 1 thru August 14, seed with 3 lbs per acre of weeping lovegrass (.07 lbs/1000 sq ft). For the period November 16 thru February 28, protect site by applying 2 tons per acre of well anchored straw mulch and seed as soon as possible in the spring, or use sod.
- Mulching:** Apply 1 1/2 to 2 tons per acre (70 to 90 lbs/1000 sq ft) of unrotted small grain straw immediately after seeding. Anchor mulch immediately after application using mulch anchoring tool or 218 gal per acre (5 gal/1000 sq ft) of emulsified asphalt on flat areas. On slopes 8 ft or higher, use 348 gal per acre (8 gal/1000 sq ft) for anchoring.
- Refer to the 1983 MARYLAND STANDARDS AND SPECIFICATIONS FOR SOIL EROSION AND SEDIMENT CONTROL for rate and methods not covered.
- SEEDING CONTROL NOTES**
- A minimum of 24 hours notice must be given to the Howard County Office of Inspection and Permits prior to the start of any construction. (992-2437)
 - All vegetative and structural practices are to be installed according to the provisions of this plan and are to be in conformance with the 1983 MARYLAND STANDARDS AND SPECIFICATIONS FOR SOIL EROSION AND SEDIMENT CONTROL.
 - Following initial soil disturbance or redisturbance, permanent or temporary stabilization shall be completed within: a) 7 calendar days for all perimeter sediment control structures, dikes, perimeter slopes and all slopes greater than 3:1; b) 14 days as to all other disturbed or graded areas on the project site.
 - All sediment traps/basins shown must be fenced and warning signs posted around their perimeter in accordance with Vol. 1, Chapter 12, of the HOWARD COUNTY DESIGN MANUAL, Storm Drainage.
 - All disturbed areas must be stabilized within the time period specified above in accordance with the 1983 MARYLAND STANDARDS AND SPECIFICATIONS FOR SOIL EROSION AND SEDIMENT CONTROL for permanent seedings (Sec. 51) and (Sec. 54), temporary seedings (Sec. 50) and mulching (Sec. 52). Temporary stabilization with mulch alone can only be done when recommended seeding rates do not allow for proper germination and establishment of grasses.
 - All sediment control structures are to remain in place and are to be maintained in operative condition until permission for their removal has been obtained from the Howard County Sediment Control Inspector.
 - Site Analysis:

Total Area of Site	4.61 Acres
Area Disturbed	2.80 Acres
Area to be roofed or paved	1.00 Acres
Area to be vegetatively stabilized	1.74 Acres
Total Cut	2374 Cu. Yds
Total Fill	2374 Cu. Yds
Offsite waste/borrow area location	N/A
 - Any sediment control practice which is disturbed by grading activity for placement of utilities must be repaired on the same day of disturbance.
 - Additional sediment control may be provided, if deemed necessary by the Howard County DPM sediment control inspector.
 - On all sites with disturbed areas in excess of 2 acres, approval of the inspection agency shall be requested upon completion of installation of perimeter erosion and sediment controls, but before proceeding with any other earth disturbance or grading. Other building or grading inspection approvals may not be authorized until this initial approval by the inspection agency is made.
 - If houses are to be constructed on an "As-Built" basis, at least one Single Lot Sediment Control as shown below shall be implemented.
 - All inlets to be blocked at the end of each day (see detail below). N/A
 - The total amount of straw bale dikes/silt fence equals 1440 L.F.

- CONSTRUCTION SEQUENCE:**
- Obtain Grading Permit and Install Sediment and Erosion Control Devices and Stabilize. 7
 - Excavate for Foundations and Rough Grade & Temporarily Stabilize. 30
 - Construct Structures, Sidewalks and Driveways. 120
 - Final Grade and stabilize in accordance with Stds. & Specs. 30
 - Upon approval of the sediment control inspector. 7
- Remove sediment and erosion controls and stabilize.*

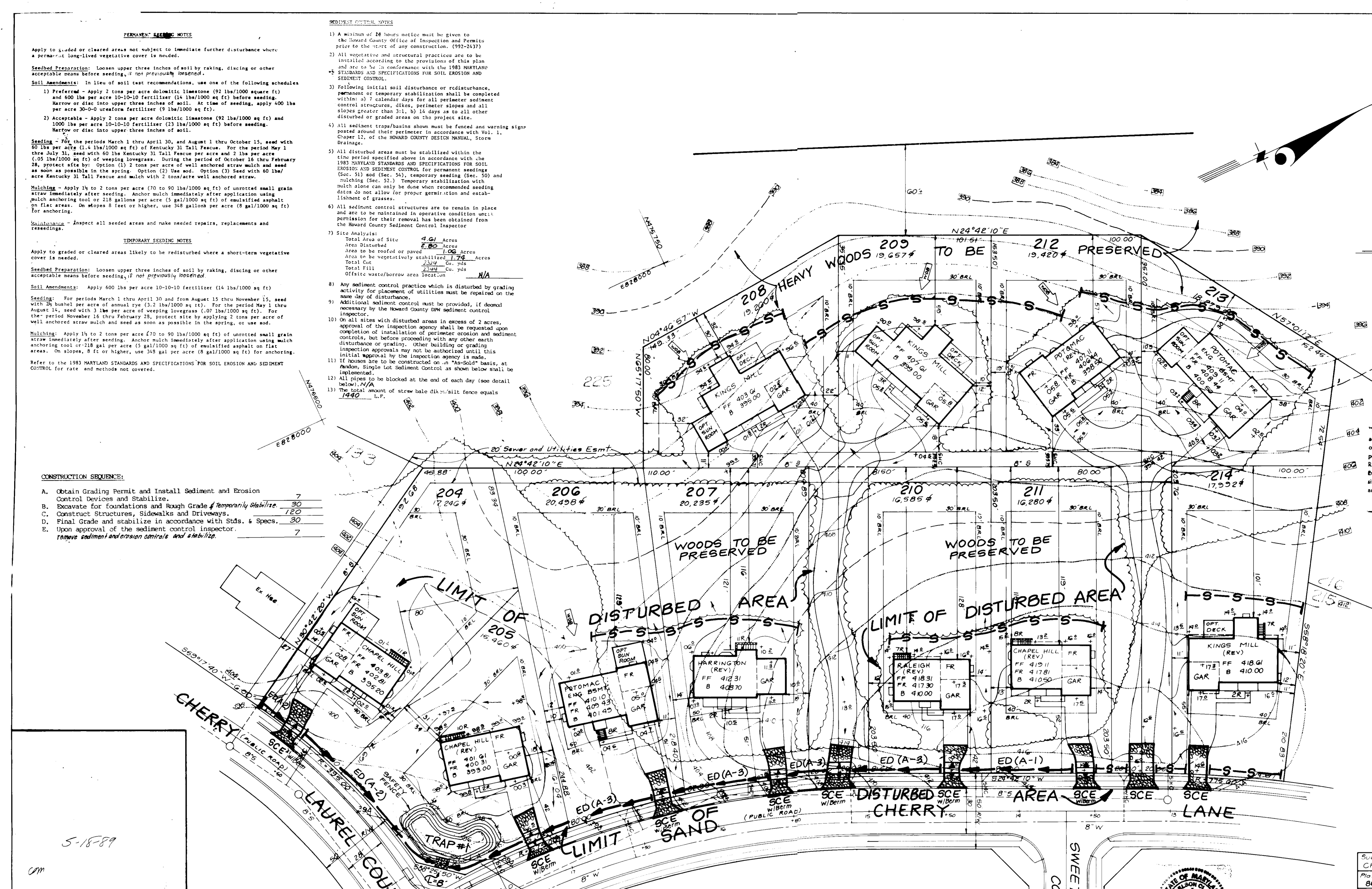

APPROVED: FOR PUBLIC WATER AND PUBLIC SEWERAGE SYSTEMS, HOWARD COUNTY HEALTH DEPARTMENT
[Signature] 7/31/89
COUNTY HEALTH OFFICER DATE

APPROVED: HOWARD COUNTY OFFICE OF PLANNING & ZONING
[Signature] 8/15/89
PLANNING DIRECTOR DATE

APPROVED: FOR PUBLIC WATER AND PUBLIC SEWERAGE, STORM DRAINAGE SYSTEMS AND PUBLIC ROADS, HOWARD COUNTY DEPARTMENT OF PUBLIC WORKS
[Signature] 7/26/89
DIRECTOR DATE

APPROVED: FOR PUBLIC WATER AND PUBLIC SEWERAGE, STORM DRAINAGE SYSTEMS AND PUBLIC ROADS, HOWARD COUNTY DEPARTMENT OF PUBLIC WORKS
[Signature] 7-25-89
CHIEF BUREAU OF ENGINEERING DATE

