

DRIVEWAY ABUTTING CLOSED SECTION WITH STD. 7" COMB CURB & GUTTER & SIDEWALK SET BACK FROM CURB

SEEDING CONTROL NOTES

- A minimum of 24 hours notice must be given to the Howard County Office of Inspection and Permitting prior to the start of any construction. (992-2317)
- All vegetative and structural practices are to be installed according to the provisions of this plan and as to be in conformance with the 1983 MARYLAND STANDARDS AND SPECIFICATIONS FOR SOIL EROSION AND SEDIMENT CONTROL.
- Following initial soil disturbance or redistribution, permanent or temporary stabilization shall be completed within: a) 7 calendar days for all perimeter sediment control structures, dikes, perimeter slopes and all slopes greater than 3:1; b) 14 days for all other disturbed or graded areas on the project site.
- All sediment traps/basins shown must be fenced and warning signs posted around their perimeter in accordance with Vol. 1, Chapter 22, of the HOWARD COUNTY DESIGN MANUAL, Storm Drainage.
- All disturbed areas must be stabilized within the time period specified above in accordance with the 1983 MARYLAND STANDARDS AND SPECIFICATIONS FOR SOIL EROSION AND SEDIMENT CONTROL for permanent seedings (Sec. 31) and (Sec. 32), temporary seedings (Sec. 30) and mulching (Sec. 32). Temporary stabilization with mulch alone can only be done when recommended seeding dates do not allow for proper germination and establishment of grasses.
- All sediment control structures are to remain in place and are to be maintained in operative condition until permission for their removal has been obtained from the Howard County Sediment Control Inspector.
- Site Analysis:

Total Area of Site	1.36 Acres
Area Disturbed	1.1 Acres
Area to be seeded or paved	0.89 Acres
Area to be vegetatively stabilized	0.90 Acres
Total Cut	576 Cu. yds
Total Fill	292 Cu. yds
Offsite waste/borrow area location	N/A

CONSTRUCTION SEQUENCE:

- Obtain Grading Permit and Install Sediment and Erosion Control Devices and Stabilize.
- Excavate for Foundations and Rough Grade & Temporarily Stabilize.
- Construct Structures, Sidewalks and Driveways.
- Final Grade and stabilize in accordance with Stds. & Specs.
- Upon approval of the sediment control inspector, remove sediment and erosion controls and stabilize.

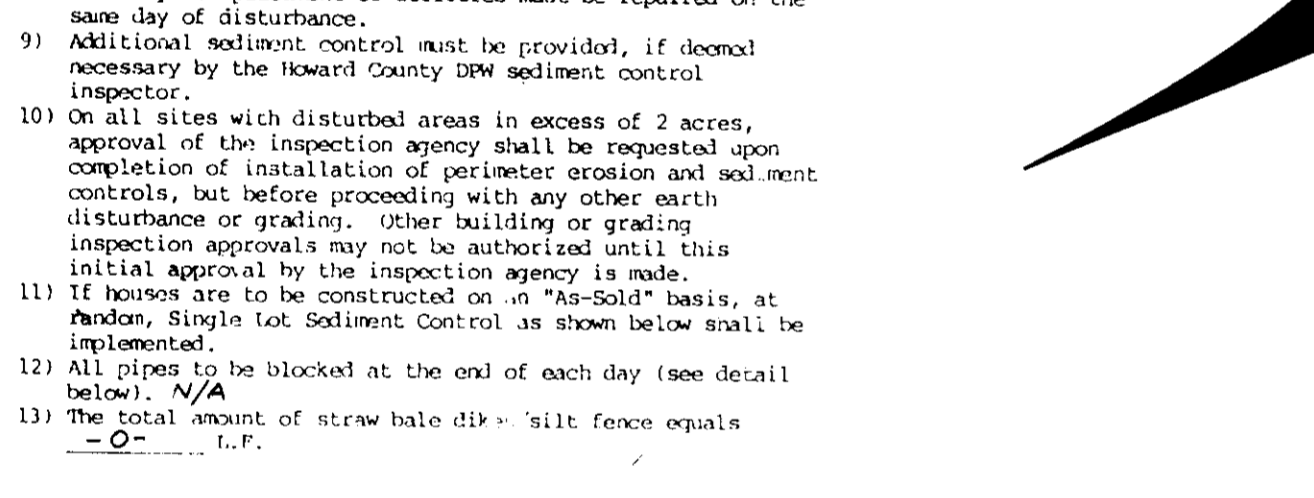

CONSTRUCTION SPECIFICATIONS

- Stone for Use: 2" stone in maximum of required thickness.
- Length: As required, but not less than 12" for stone.
- Thickness: Not less than 4" for stone.
- Width: Not less than 4" for stone.
- Filter Cloth: Will be placed over the entire area prior to placing of stone. Filter cloth will be secured in a single family residence.
- Surface Material: All surface water. Downstream of the sediment control structures shall be paved across the entrance. If paving is impractical, a mulch area with 5" depth will be provided.
- Maintenance: The entrance shall be maintained in a condition where prevent tracking of sediment onto public roads. The filter cloth shall be replaced or repaired as needed. The filter cloth shall be replaced or repaired as needed. The filter cloth shall be replaced or repaired as needed.
- Regrading: Where regrading is required, the regrading shall be done in accordance with the 1983 MARYLAND STANDARDS AND SPECIFICATIONS FOR SOIL EROSION AND SEDIMENT CONTROL.
- Final Grade: Final grade shall be in accordance with the 1983 MARYLAND STANDARDS AND SPECIFICATIONS FOR SOIL EROSION AND SEDIMENT CONTROL.

STABILIZED CONSTRUCTION ENTRANCE (SCE)

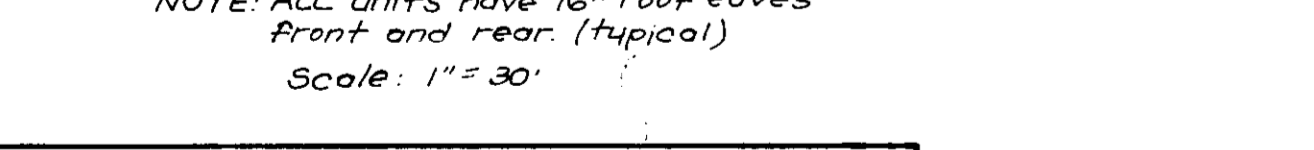

STONE OUTLET SEDIMENT TRAP (SOST) STY.



TEMPORARY SEEDING NOTES

- Apply to graded or cleared areas likely to be redistributed where a short-term vegetative cover is needed.
- Seedbed Preparation: Loosen upper three inches of soil by raking, discing or other acceptable means before seeding, if not previously loosened.
- Soil Amendments: Apply 600 lbs per acre 10-10-10 fertilizer (14 lbs/1000 sq ft).
- Seeding: For periods March 1 thru April 30 and from August 15 thru November 15, seed with 25 bushel per acre of annual ryegrass (3.2 lbs/1000 sq ft). For the period May 1 thru August 14, seed with 3 lbs per acre of weeping lovegrass (.07 lbs/1000 sq ft). For the period November 16 thru February 28, protect site by applying 2 tons per acre of well anchored straw mulch and seed as soon as possible in the spring. Option (2) Use sod. Option (3) Seed with 60 lbs/acre Kentucky 31 Tall Fescue and mulch with 2 tons/acre well anchored straw.
- Mulching: Apply 1 1/2 to 2 tons per acre (70 to 90 lbs/1000 sq ft) of untreated small grain straw immediately after seeding. Anchor mulch immediately after application using mulch anchoring tool or 218 gallons per acre (5 gal/1000 sq ft) of emulsified asphalt on flat areas. On slopes 8 feet or higher, use 348 gallons per acre (8 gal/1000 sq ft) for anchoring.
- Maintenance: Inspect all seeded areas and make needed repairs, replacements and reseedings.

GENERAL NOTES

- Subject property zoned R-20 as per B. 2.85 Comprehensive Zoning Plan.
- The coordinates shown hereon are based on The Maryland State Grid System and derived from the following Howard County Control Stations: 3441004-R and 3442003-R.
- All roadways are public and existing.
- Total area included in this submission: 1.36A.
- Total number of lots: 3.
- Any damage to county owned right-of-ways shall be corrected at the Developer's expense.
- Maximum lot coverage is 30%.
- Reference plans S-88-07 P.88-41 and F.88-232.
- The Contractor or Developer shall contact the Construction Inspection Survey Division, 24 hours in advance of commencement of work at 792-8330.
- The existing topography shown was field run by Clark, Finerock & Sackett, Inc. on January 27, 1989.

SPECIAL NOTES

- Approved Road Construction Plans shall be used for all utility utilities.
- Public water and sewer shown for reference only. For more detailed information see water and sewer plans Contract No. 89-1800-21.
- The water and sewer base connections not included in a Developer's Agreement shall conform to Howard County Plumbing Code. The on-site WIC shall be 4" and the SHC shall be 4" iron stormwater management provided for by F-88-232.

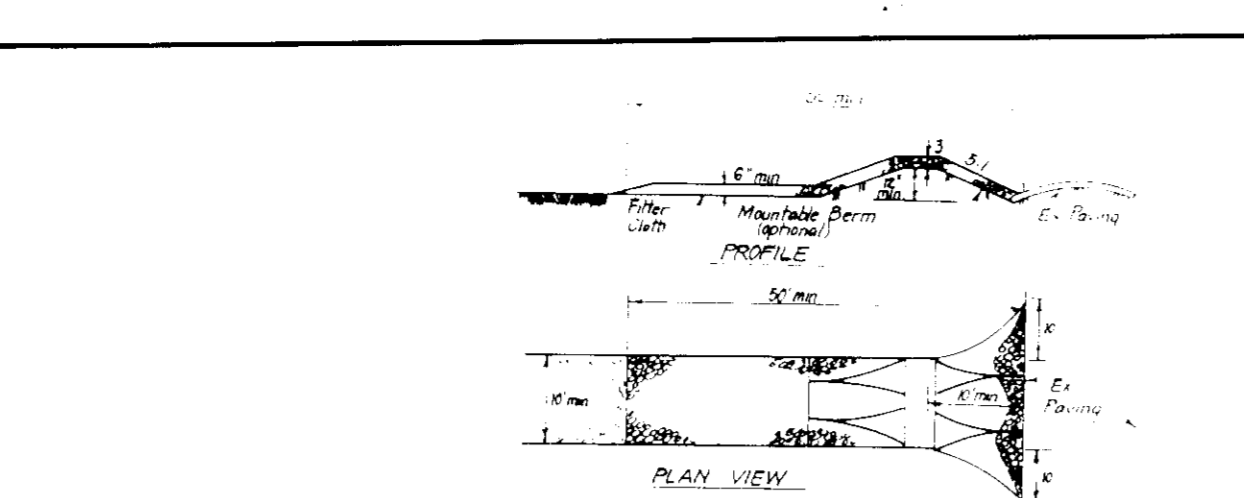

STABILIZED CONSTRUCTION ENTRANCE (SCE)

- Stone for Use: 2" stone in maximum of required thickness.
- Length: As required, but not less than 12" for stone.
- Thickness: Not less than 4" for stone.
- Width: Not less than 4" for stone.
- Filter Cloth: Will be placed over the entire area prior to placing of stone. Filter cloth will be secured in a single family residence.
- Surface Material: All surface water. Downstream of the sediment control structures shall be paved across the entrance. If paving is impractical, a mulch area with 5" depth will be provided.
- Maintenance: The entrance shall be maintained in a condition where prevent tracking of sediment onto public roads. The filter cloth shall be replaced or repaired as needed. The filter cloth shall be replaced or repaired as needed. The filter cloth shall be replaced or repaired as needed.
- Regrading: Where regrading is required, the regrading shall be done in accordance with the 1983 MARYLAND STANDARDS AND SPECIFICATIONS FOR SOIL EROSION AND SEDIMENT CONTROL.
- Final Grade: Final grade shall be in accordance with the 1983 MARYLAND STANDARDS AND SPECIFICATIONS FOR SOIL EROSION AND SEDIMENT CONTROL.

STONE OUTLET SEDIMENT TRAP (SOST) STY.



TEMPORARY SEEDING NOTES

- Apply to graded or cleared areas likely to be redistributed where a short-term vegetative cover is needed.
- Seedbed Preparation: Loosen upper three inches of soil by raking, discing or other acceptable means before seeding, if not previously loosened.
- Soil Amendments: Apply 600 lbs per acre 10-10-10 fertilizer (14 lbs/1000 sq ft).
- Seeding: For periods March 1 thru April 30 and from August 15 thru November 15, seed with 25 bushel per acre of annual ryegrass (3.2 lbs/1000 sq ft). For the period May 1 thru August 14, seed with 3 lbs per acre of weeping lovegrass (.07 lbs/1000 sq ft). For the period November 16 thru February 28, protect site by applying 2 tons per acre of well anchored straw mulch and seed as soon as possible in the spring. Option (2) Use sod. Option (3) Seed with 60 lbs/acre Kentucky 31 Tall Fescue and mulch with 2 tons/acre well anchored straw.
- Mulching: Apply 1 1/2 to 2 tons per acre (70 to 90 lbs/1000 sq ft) of untreated small grain straw immediately after seeding. Anchor mulch immediately after application using mulch anchoring tool or 218 gallons per acre (5 gal/1000 sq ft) of emulsified asphalt on flat areas. On slopes 8 feet or higher, use 348 gallons per acre (8 gal/1000 sq ft) for anchoring.
- Maintenance: Inspect all seeded areas and make needed repairs, replacements and reseedings.

GENERAL NOTES

- Subject property zoned R-20 as per B. 2.85 Comprehensive Zoning Plan.
- The coordinates shown hereon are based on The Maryland State Grid System and derived from the following Howard County Control Stations: 3441004-R and 3442003-R.
- All roadways are public and existing.
- Total area included in this submission: 1.36A.
- Total number of lots: 3.
- Any damage to county owned right-of-ways shall be corrected at the Developer's expense.
- Maximum lot coverage is 30%.
- Reference plans S-88-07 P.88-41 and F.88-232.
- The Contractor or Developer shall contact the Construction Inspection Survey Division, 24 hours in advance of commencement of work at 792-8330.
- The existing topography shown was field run by Clark, Finerock & Sackett, Inc. on January 27, 1989.

SPECIAL NOTES

- Approved Road Construction Plans shall be used for all utility utilities.
- Public water and sewer shown for reference only. For more detailed information see water and sewer plans Contract No. 89-1800-21.
- The water and sewer base connections not included in a Developer's Agreement shall conform to Howard County Plumbing Code. The on-site WIC shall be 4" and the SHC shall be 4" iron stormwater management provided for by F-88-232.

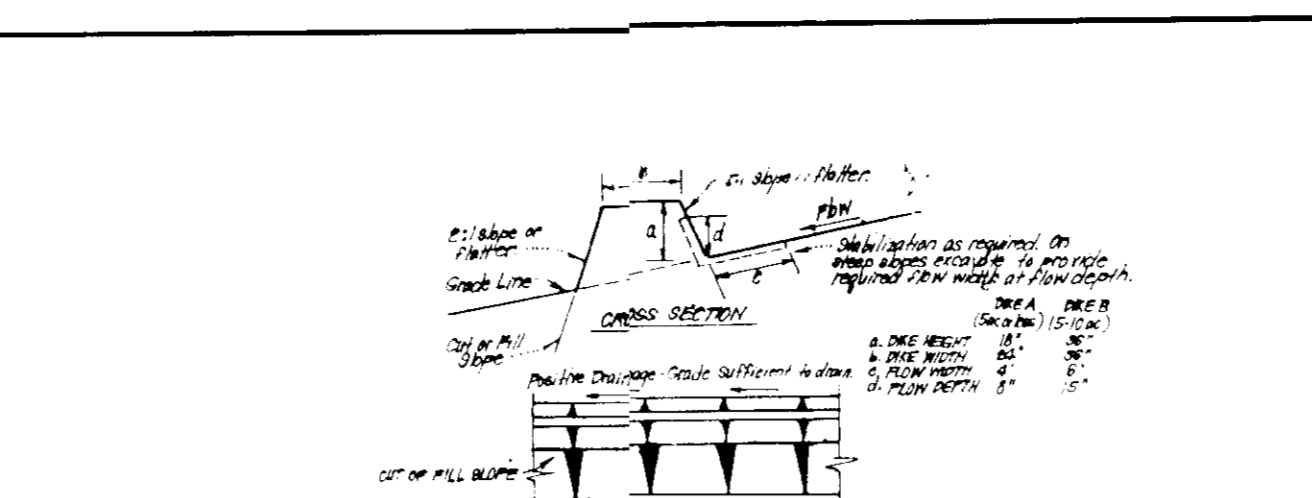

STABILIZED CONSTRUCTION ENTRANCE (SCE)

- Stone for Use: 2" stone in maximum of required thickness.
- Length: As required, but not less than 12" for stone.
- Thickness: Not less than 4" for stone.
- Width: Not less than 4" for stone.
- Filter Cloth: Will be placed over the entire area prior to placing of stone. Filter cloth will be secured in a single family residence.
- Surface Material: All surface water. Downstream of the sediment control structures shall be paved across the entrance. If paving is impractical, a mulch area with 5" depth will be provided.
- Maintenance: The entrance shall be maintained in a condition where prevent tracking of sediment onto public roads. The filter cloth shall be replaced or repaired as needed. The filter cloth shall be replaced or repaired as needed. The filter cloth shall be replaced or repaired as needed.
- Regrading: Where regrading is required, the regrading shall be done in accordance with the 1983 MARYLAND STANDARDS AND SPECIFICATIONS FOR SOIL EROSION AND SEDIMENT CONTROL.
- Final Grade: Final grade shall be in accordance with the 1983 MARYLAND STANDARDS AND SPECIFICATIONS FOR SOIL EROSION AND SEDIMENT CONTROL.

STONE OUTLET SEDIMENT TRAP (SOST) STY.

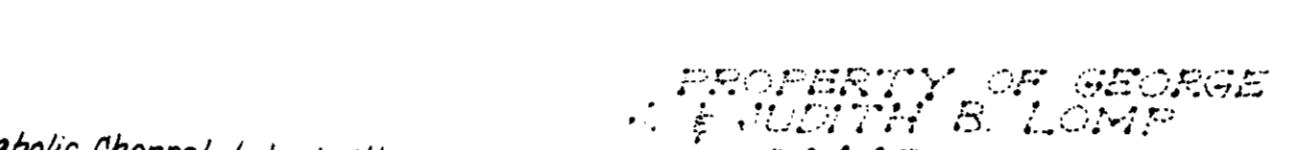

TEMPORARY SEEDING NOTES

- Apply to graded or cleared areas likely to be redistributed where a short-term vegetative cover is needed.
- Seedbed Preparation: Loosen upper three inches of soil by raking, discing or other acceptable means before seeding, if not previously loosened.
- Soil Amendments: Apply 600 lbs per acre 10-10-10 fertilizer (14 lbs/1000 sq ft).
- Seeding: For periods March 1 thru April 30 and from August 15 thru November 15, seed with 25 bushel per acre of annual ryegrass (3.2 lbs/1000 sq ft). For the period May 1 thru August 14, seed with 3 lbs per acre of weeping lovegrass (.07 lbs/1000 sq ft). For the period November 16 thru February 28, protect site by applying 2 tons per acre of well anchored straw mulch and seed as soon as possible in the spring. Option (2) Use sod. Option (3) Seed with 60 lbs/acre Kentucky 31 Tall Fescue and mulch with 2 tons/acre well anchored straw.
- Mulching: Apply 1 1/2 to 2 tons per acre (70 to 90 lbs/1000 sq ft) of untreated small grain straw immediately after seeding. Anchor mulch immediately after application using mulch anchoring tool or 218 gallons per acre (5 gal/1000 sq ft) of emulsified asphalt on flat areas. On slopes 8 feet or higher, use 348 gallons per acre (8 gal/1000 sq ft) for anchoring.
- Maintenance: Inspect all seeded areas and make needed repairs, replacements and reseedings.

GENERAL NOTES

- Subject property zoned R-20 as per B. 2.85 Comprehensive Zoning Plan.
- The coordinates shown hereon are based on The Maryland State Grid System and derived from the following Howard County Control Stations: 3441004-R and 3442003-R.
- All roadways are public and existing.
- Total area included in this submission: 1.36A.
- Total number of lots: 3.
- Any damage to county owned right-of-ways shall be corrected at the Developer's expense.
- Maximum lot coverage is 30%.
- Reference plans S-88-07 P.88-41 and F.88-232.
- The Contractor or Developer shall contact the Construction Inspection Survey Division, 24 hours in advance of commencement of work at 792-8330.
- The existing topography shown was field run by Clark, Finerock & Sackett, Inc. on January 27, 1989.

SPECIAL NOTES

- Approved Road Construction Plans shall be used for all utility utilities.
- Public water and sewer shown for reference only. For more detailed information see water and sewer plans Contract No. 89-1800-21.
- The water and sewer base connections not included in a Developer's Agreement shall conform to Howard County Plumbing Code. The on-site WIC shall be 4" and the SHC shall be 4" iron stormwater management provided for by F-88-232.

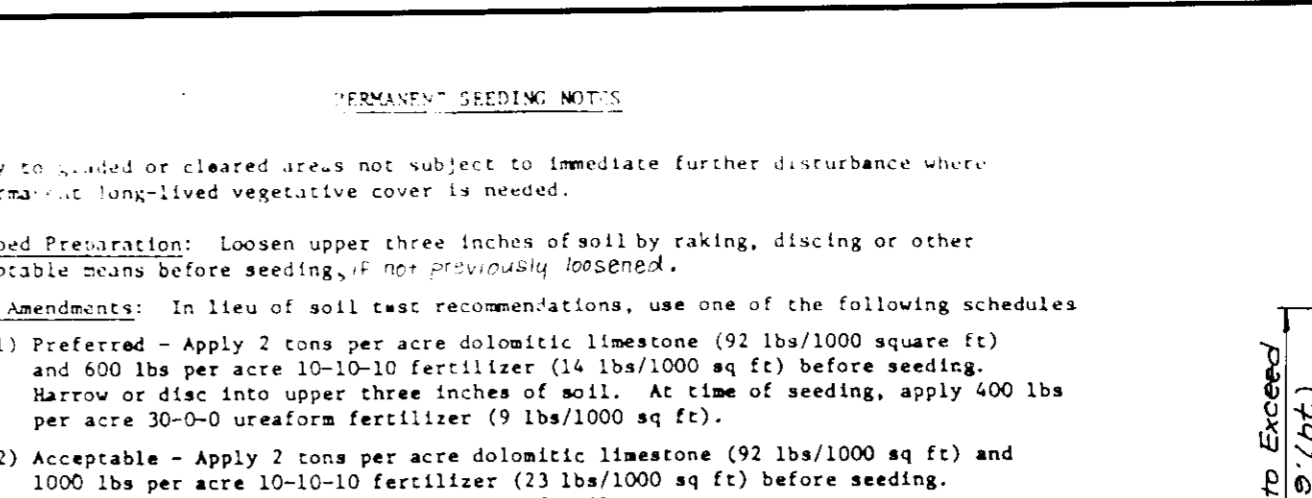

TYPICAL RETAINING WALL

- Apply to graded or cleared areas not subject to immediate further disturbance where a permanent long-lived vegetative cover is needed.
- Seedbed Preparation: Loosen upper three inches of soil by raking, discing or other acceptable means before seeding, if not previously loosened.
- Soil Amendments: In lieu of soil test recommendations, use one of the following schedules:
 - Preferred - Apply 2 tons per acre dolomitic limestone (92 lbs/1000 square ft) and 600 lbs per acre 10-10-10 fertilizer (14 lbs/1000 sq ft) before seeding. Narrow or disc into upper three inches of soil. At time of seeding, apply 400 lbs per acre 30-0-0 ureaformal fertilizer (9 lbs/1000 sq ft).
 - Acceptable - Apply 2 tons per acre dolomitic limestone (92 lbs/1000 sq ft) and 1000 lbs per acre 10-10-10 fertilizer (23 lbs/1000 sq ft) before seeding. Narrow or disc into upper three inches of soil.
- Seeding: For the periods March 1 thru April 30, and August 1 thru October 15, seed with 60 lbs per acre (1.4 lbs/1000 sq ft) of Kentucky 31 Tall Fescue. For the period May 1 thru July 31, seed with 60 lbs Kentucky 31 Tall Fescue per acre and 2 lbs per acre (.05 lbs/1000 sq ft) of weeping lovegrass. During the period of October 16 thru February 28, protect site by: Option (1) 2 tons per acre of well anchored straw mulch and seed as soon as possible in the spring. Option (2) Use sod. Option (3) Seed with 60 lbs/acre Kentucky 31 Tall Fescue and mulch with 2 tons/acre well anchored straw.
- Mulching: Apply 1 1/2 to 2 tons per acre (70 to 90 lbs/1000 sq ft) of untreated small grain straw immediately after seeding. Anchor mulch immediately after application using mulch anchoring tool or 218 gallons per acre (5 gal/1000 sq ft) of emulsified asphalt on flat areas. On slopes 8 feet or higher, use 348 gallons per acre (8 gal/1000 sq ft) for anchoring.
- Maintenance: Inspect all seeded areas and make needed repairs, replacements and reseedings.

GENERAL NOTES

- Subject property zoned R-20 as per B. 2.85 Comprehensive Zoning Plan.
- The coordinates shown hereon are based on The Maryland State Grid System and derived from the following Howard County Control Stations: 3441004-R and 3442003-R.
- All roadways are public and existing.
- Total area included in this submission: 1.36A.
- Total number of lots: 3.
- Any damage to county owned right-of-ways shall be corrected at the Developer's expense.
- Maximum lot coverage is 30%.
- Reference plans S-88-07 P.88-41 and F.88-232.
- The Contractor or Developer shall contact the Construction Inspection Survey Division, 24 hours in advance of commencement of work at 792-8330.
- The existing topography shown was field run by Clark, Finerock & Sackett, Inc. on January 27, 1989.

SPECIAL NOTES

- Approved Road Construction Plans shall be used for all utility utilities.
- Public water and sewer shown for reference only. For more detailed information see water and sewer plans Contract No. 89-1800-21.
- The water and sewer base connections not included in a Developer's Agreement shall conform to Howard County Plumbing Code. The on-site WIC shall be 4" and the SHC shall be 4" iron stormwater management provided for by F-88-232.

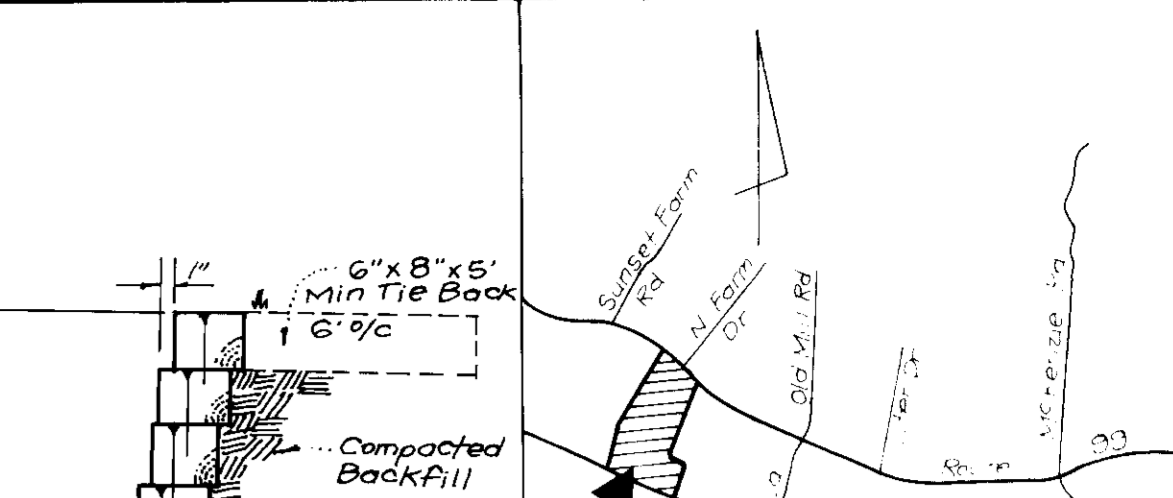

VICINITY MAP

- Apply to graded or cleared areas likely to be redistributed where a short-term vegetative cover is needed.
- Seedbed Preparation: Loosen upper three inches of soil by raking, discing or other acceptable means before seeding, if not previously loosened.
- Soil Amendments: Apply 600 lbs per acre 10-10-10 fertilizer (14 lbs/1000 sq ft).
- Seeding: For periods March 1 thru April 30 and from August 15 thru November 15, seed with 25 bushel per acre of annual ryegrass (3.2 lbs/1000 sq ft). For the period May 1 thru August 14, seed with 3 lbs per acre of weeping lovegrass (.07 lbs/1000 sq ft). For the period November 16 thru February 28, protect site by applying 2 tons per acre of well anchored straw mulch and seed as soon as possible in the spring. Option (2) Use sod. Option (3) Seed with 60 lbs/acre Kentucky 31 Tall Fescue and mulch with 2 tons/acre well anchored straw.
- Mulching: Apply 1 1/2 to 2 tons per acre (70 to 90 lbs/1000 sq ft) of untreated small grain straw immediately after seeding. Anchor mulch immediately after application using mulch anchoring tool or 218 gallons per acre (5 gal/1000 sq ft) of emulsified asphalt on flat areas. On slopes 8 feet or higher, use 348 gallons per acre (8 gal/1000 sq ft) for anchoring.
- Maintenance: Inspect all seeded areas and make needed repairs, replacements and reseedings.

GENERAL NOTES

- Subject property zoned R-20 as per B. 2.85 Comprehensive Zoning Plan.
- The coordinates shown hereon are based on The Maryland State Grid System and derived from the following Howard County Control Stations: 3441004-R and 3442003-R.
- All roadways are public and existing.
- Total area included in this submission: 1.36A.
- Total number of lots: 3.
- Any damage to county owned right-of-ways shall be corrected at the Developer's expense.
- Maximum lot coverage is 30%.
- Reference plans S-88-07 P.88-41 and F.88-232.
- The Contractor or Developer shall contact the Construction Inspection Survey Division, 24 hours in advance of commencement of work at 792-8330.
- The existing topography shown was field run by Clark, Finerock & Sackett, Inc. on January 27, 1989.

SPECIAL NOTES

- Approved Road Construction Plans shall be used for all utility utilities.
- Public water and sewer shown for reference only. For more detailed information see water and sewer plans Contract No. 89-1800-21.
- The water and sewer base connections not included in a Developer's Agreement shall conform to Howard County Plumbing Code. The on-site WIC shall be 4" and the SHC shall be 4" iron stormwater management provided for by F-88-232.

ADDRESS CHART

LOT NO.	STREET ADDRESS
10	10025 EMILY FOX COURT
12	10021 " " " "
13	10017 " " " "

SINGLE LOT SEDIMENT CONTROL PLAN

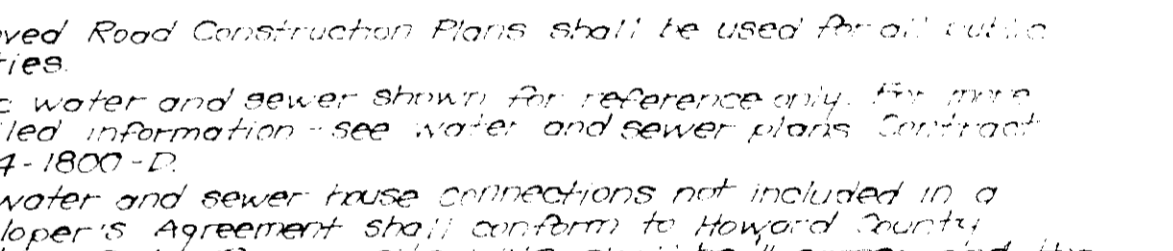

FOR LOTS 10 AND 12: BASEMENTS WILL NOT SEWER BY GRAVITY

APPROVED FOR PUBLIC WATER AND PUBLIC SEWERAGE SYSTEMS.
 HOWARD COUNTY HEALTH DEPARTMENT
 COUNTY HEALTH OFFICER: [Signature] DATE: 5-5-89
 APPROVED: HOWARD COUNTY OFFICE OF PLANNING & ZONING
 PLANNING DIRECTOR: [Signature] DATE: 5-18-89
 DIVISION OF COMMUNITY PLANNING AND LAND DEVELOPMENT
 APPROVED: FOR PUBLIC WATER AND PUBLIC SEWERAGE, STORM DRAINAGE SYSTEMS AND PUBLIC WORKS
 HOWARD COUNTY DEPARTMENT OF PUBLIC WORKS
 DIRECTOR: [Signature] DATE: 5/3/89
 CHIEF BUREAU OF ENGINEERING: [Signature] DATE: 5-3-89

Reviewed by: Howard SCD
 [Signature] DATE: 4/27/89
 US SEN CONSULTANT
 THIS DEVELOPMENT IS PUBLICLY APPROVED
 CONTAINS NO FEDERAL FUNDS
 Approved: [Signature] Date: [Signature]

DEVELOPER'S/ENGINEER'S CERTIFICATE
 "The setting of all development and construction will be done in accordance with the plan of development and shall be erosion and sediment control and that all responsible persons are aware of the construction plan and have a Certificate of Attendance at a Dept. of Natural Resources Approved Training Program for the Control of Sediment and Erosion before beginning the project. I do also authorize periodic site inspections by the Howard Soil Conservation District or their authorized agents, as are deemed necessary."
 Signature of Developer/Builder: [Signature] Date: 2-17-89

ENGINEER'S CERTIFICATE
 I hereby certify that this plan for Erosion and Sediment Control represents a professional and workable plan based on my personal knowledge of the site conditions and that it was prepared in accordance with the requirements of the Howard Soil Conservation District.
 Signature: [Signature] Date: 2-21-89
 G. Nelson Clark

CLARK • FINEYROCK & SACKETT, INC.
 ENGINEERS • PLANNERS • SURVEYORS
 7135 Minstrel Way • Columbia, Md 21045 • (301) 381-7500 • Balt. • (301) 621-8100 Wash.
 DESIGNED: JME
 DRAWN: BAR, BAL
 CHECKED: JME, JMM
 DATE: Feb 1989
 SCALE: 1" = 30'
 DRAWING: 1 OF 1
 JOB NO: 89-009
 FILE NO: 89-009 X
 SITE DEVELOPMENT and SEDIMENT and EROSION CONTROL PLAN
 LOTS 10, 12 and 13
 FOXWOOD
 2ND ELECTION DISTRICT
 HOWARD COUNTY, MARYLAND
 FOR: THE RYLAND GROUP, INC
 10221 Wincopin Circle
 Columbia, Maryland 21044

STATE OF MARYLAND
 REGISTERED PROFESSIONAL ENGINEER
 No. 12189
 Date: 2-21-89