

CONSTRUCTION NOTES FOR SILT FENCE

1. MESH WITH PLAN TO BE FASTENED SECURELY TO FENCE POSTS WITH 4" x 4" x 1/2" GALV. NAILS EVERY 24" AT TOP AND MID SECTION.
2. FILTER CLOTH TO BE FASTENED SECURELY TO MESH WITH PLAN TO BE FASTENED SECURELY TO FENCE POSTS WITH 4" x 4" x 1/2" GALV. NAILS EVERY 24" AT TOP AND MID SECTION.
3. WHEN THE SETTING OF FILTER CLOTH BEGINS EACH OTHER END SHALL BE OPENED UP BY 6" TO 8" TO ALLOW FOR SETTLEMENT.
4. NO TENSILE STRESS TO BE APPLIED TO FILTER CLOTH AT ANY TIME.

CONSTRUCTION SPECIFICATIONS

1. Stone Size - Less than 2" stone, or reclaimed or recycled concrete equivalent.
2. Length - As required, but not less than 50 feet (except on a single test-ditch 100' where a 30' foot minimum length would apply).
3. Thickness - Not less than six (6) inches.
4. Width - Ten (10) foot minimum, but not less than the full width at points where a change of course occurs.
5. Filter Cloth - Will be placed over the entire area prior to placing of stone. Filter will not be required on a slope of less than 1:1.
6. Surface Water - All surface water flowing or diverted toward construction entrance shall be piped across the entrance. If piping is impractical, a portable berm with 5:1 slopes will be permitted.
7. Maintenance - The entrance shall be maintained in a condition which will prevent tracking or flowing of sediment onto public rights-of-way. This may require periodic top dressing with additional stone as conditions demand and repair and/or cleanup of any measures used to trap sediment. All sediment applied, dropped, washed or tracked onto public rights-of-way must be removed immediately.
8. Washing - Wheels shall be cleaned to remove sediment prior to entrance onto public rights-of-way. When washing is required, it shall be done on an area stabilized with stone and which drains into an approved sediment trapping device.
9. Periodic inspection and needed maintenance shall be provided after each rain.

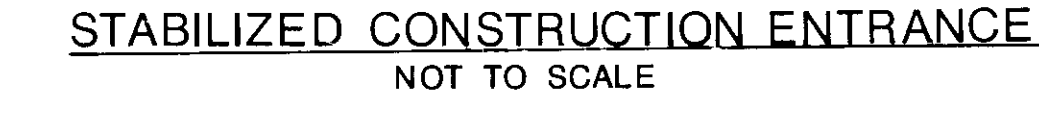
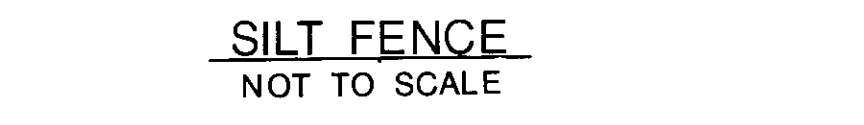

SEEDING NOTES

1. A MINIMUM OF 24 HOURS NOTICE MUST BE GIVEN TO THE HOWARD COUNTY OFFICE OF INSPECTION AND PERMITS PRIOR TO THE START OF ANY CONSTRUCTION (892-2437).
2. ALL VEGETATIVE AND STRUCTURAL PRACTICES ARE TO BE INSTALLED ACCORDING TO THE PROVISIONS OF THIS PLAN AND ARE TO BE IN CONFORMANCE WITH THE 1983 MARYLAND STANDARDS AND SPECIFICATIONS FOR SOIL EROSION AND SEDIMENT CONTROL.
3. FOLLOWING INITIAL SOIL DISTURBANCE OR REDISTURBANCE, PERMANENT OR TEMPORARY STABILIZATION SHALL BE COMPLETED WITHIN A 7 CALENDAR DAYS FOR ALL PERMITS. SEDIMENT CONTROL STRUCTURES, DIKES, PERIMETER SLOPES AND ALL SLOPES GREATER THAN 3:1, 8:1, 14:1 DATES AS TO ALL OTHER DISTURBED OR GRADED AREAS ON THE PROJECT SITE.
4. ALL SEDIMENT TRAPS/BASINS SHOWN MUST BE FENCED AND MARKING SIGNS POSTED AROUND THEIR PERIMETER IN ACCORDANCE WITH VOL. 1, CHAPTER 12, OF THE HOWARD COUNTY DESIGN MANUAL, STORM DRAINAGE.
5. ALL DISTURBED AREAS MUST BE STABILIZED WITHIN THE TIME PERIOD SPECIFIED ABOVE IN ACCORDANCE WITH THE 1983 MARYLAND STANDARDS AND SPECIFICATIONS FOR SOIL EROSION AND SEDIMENT CONTROL FOR PERMANENT SEEDINGS (SEC. 511 AND SEC. 54), TEMPORARY SEEDING (SEC. 501 AND MULCHING (SEC. 52), TEMPORARY STABILIZATION WITH MULCH ALONE CAN ONLY BE DONE WHEN RECOMMENDED SEEDING DATES DO NOT ALLOW FOR PROPER GERMINATION AND ESTABLISHMENT OF GRASSES.
6. ALL SEDIMENT CONTROL STRUCTURES ARE TO REMAIN IN PLACE AND ARE TO BE MAINTAINED IN OPERATIVE CONDITION UNTIL PERMITS FOR THEIR REMOVAL HAS BEEN OBTAINED FROM THE HOWARD COUNTY SEDIMENT CONTROL INSPECTOR.
7. SITE ANALYSIS:
 - TOTAL AREA OF SITE: 0.83 ACRES
 - AREA TO BE REGRADED OR PAVED: 0.12 ACRES
 - AREA TO BE VEGETATIVELY STABILIZED: 0.33 ACRES
 - TOTAL CUT: 10,000 CU YDS
 - OFFSITE WASTE/BORROW AREA LOCATION: SEE PLAN
8. ANY SEDIMENT CONTROL PRACTICE WHICH IS DISTURBED BY GRADING ACTIVITIES FOR PLACEMENT OF UTILITIES MUST BE REPAIRED ON THE SAME DAY OF DISTURBANCE.

PERMANENT SEEDING NOTES

APPLY TO GRADED OR CLEARED AREA NOT SUBJECT TO IMMEDIATE FURTHER DISTURBANCE WHERE A PERMANENT, LONG-LIVED VEGETATIVE COVER IS NEEDED.

SEEDBED PREPARATION: LOOSEN UPPER THREE-INCHES OF SOIL BY RAKING, DISCING OR OTHER ACCEPTABLE MEANS BEFORE SEEDING.

SOIL AMENDMENTS: IN LIEU OF SOIL TEST RECOMMENDATIONS, USE ONE OF THE FOLLOWING SCHEDULE:

- 1) PREFERRED - APPLY 2 TONS PER ACRE DOLOMITIC LIMESTONE (92 LBS/1000 SQ FT) AND 600 LBS PER ACRE 10-10-10 FERTILIZER (14 LBS/1000 SQ FT) BEFORE SEEDING.
- 2) ACCEPTABLE - APPLY 2 TONS PER ACRE DOLOMITIC LIMESTONE (92 LBS/1000 SQ FT) AND 1000 LBS PER ACRE 10-10-10 FERTILIZER (23 LBS/1000 SQ FT) BEFORE SEEDING.

SEEDING: FOR PERIODS MARCH 1 THRU APRIL 30, AND AUGUST 1 THRU OCTOBER 15, SEED WITH 20 BUSHELS PER ACRE OF KENTUCKY 31 TALL FESCUE PER ACRE AND 2 LBS PER ACRE (0.5 LBS/1000 SQ FT) OF WHEATING LOVEGRASS DURING THE PERIOD OF OCTOBER 16 THRU FEBRUARY 28. PROTECT SITE BY OPTION (1) 2 TONS PER ACRE OF WELL ANCHORED STRAW MULCH AND SEED AS SOON AS POSSIBLE IN THE SPRING. OPTION (2) USE SOO. OPTION (3) SEED WITH 60 LBS/ACRE KENTUCKY 31 TALL FESCUE AND MULCH WITH 2 TONS/ACRE WELL ANCHORED STRAW MULCH. APPLY 1 1/2 TONS PER ACRE (70 TO 90 LBS/1000 SQ FT) OF UNROTTED SMALL GRAIN STRAW IMMEDIATELY AFTER SEEDING. ANCHOR MULCH IMMEDIATELY AFTER APPLICATION USING MULCH ANCHORING TOOL OR 218 GALLONS PER ACRE (5 GAL/1000 SQ FT) OF EMULSIFIED ASPHALT ON FLAT AREAS. ON SLOPES 8 FT OR HIGHER, USE 348 GALLONS PER ACRE (8 GAL/1000 SQ FT) FOR ANCHORING.

MULCHING: APPLY 1 1/2 TONS PER ACRE (70 TO 90 LBS/1000 SQ FT) OF UNROTTED SMALL GRAIN STRAW IMMEDIATELY AFTER SEEDING. ANCHOR MULCH IMMEDIATELY AFTER APPLICATION USING MULCH ANCHORING TOOL OR 218 GAL PER ACRE (5 GAL/1000 SQ FT) OF EMULSIFIED ASPHALT ON FLAT AREAS. ON SLOPES 8 FT OR HIGHER, USE 348 GAL PER ACRE (8 GAL/1000 SQ FT) FOR ANCHORING.

REFER TO THE 1983 MARYLAND STANDARDS AND SPECIFICATIONS FOR SOIL EROSION AND SEDIMENT CONTROL FOR RATE AND METHODS NOT COVERED.

ENGINEER'S CERTIFICATE

I CERTIFY THAT THIS PLAN FOR EROSION AND SEDIMENT CONTROL REPRESENTS A PRACTICAL AND WORKABLE PLAN BASED ON MY PERSONAL KNOWLEDGE OF THE SITE CONDITIONS AND THAT IT WAS PREPARED IN ACCORDANCE WITH THE REQUIREMENTS OF THE HOWARD COUNTY SOIL CONSERVATION DISTRICT.

DATE: 1/14/89

DEVELOPER'S CERTIFICATE

I HEREBY CERTIFY THAT ALL DEVELOPMENT AND CONSTRUCTION WILL BE DONE ACCORDING TO THIS PLAN OF DEVELOPMENT AND PLAN FOR EROSION AND SEDIMENT CONTROL AND THAT ANY RESPONSIBLE PERSONNEL INVOLVED IN THE CONSTRUCTION PROJECT WILL USE A CERTIFICATE OF ATTENDANCE AT THE DEPARTMENT OF NATURAL RESOURCES APPROVED TRAINING PROGRAM FOR THE CONTROL OF SEDIMENT AND EROSION BEFORE BEGINS THE PROJECT. I ALSO AUTHORIZE RESIDUAL INSPECTION BY THE HOWARD COUNTY SOIL CONSERVATION DISTRICT OR THEIR AUTHORIZED AGENTS AS ARE DEEMED NECESSARY.

DATE: 1/14/89

REVIEWED FOR HOWARD COUNTY SOIL CONSERVATION DISTRICT AND MEETS TECHNICAL REQUIREMENTS.

DATE: 1/14/89

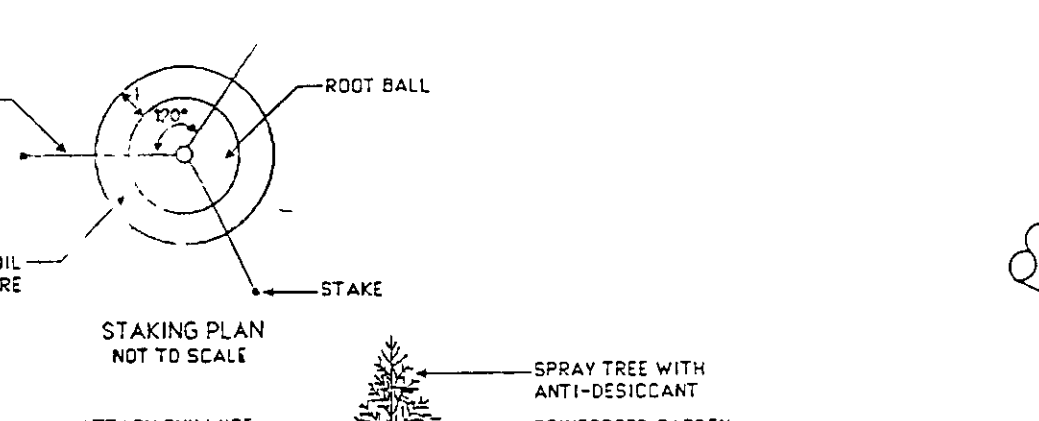

APPROVED FOR PUBLIC WATER AND PUBLIC SEWERAGE SYSTEMS, HOWARD COUNTY HEALTH DEPARTMENT

DATE: 5-30-89

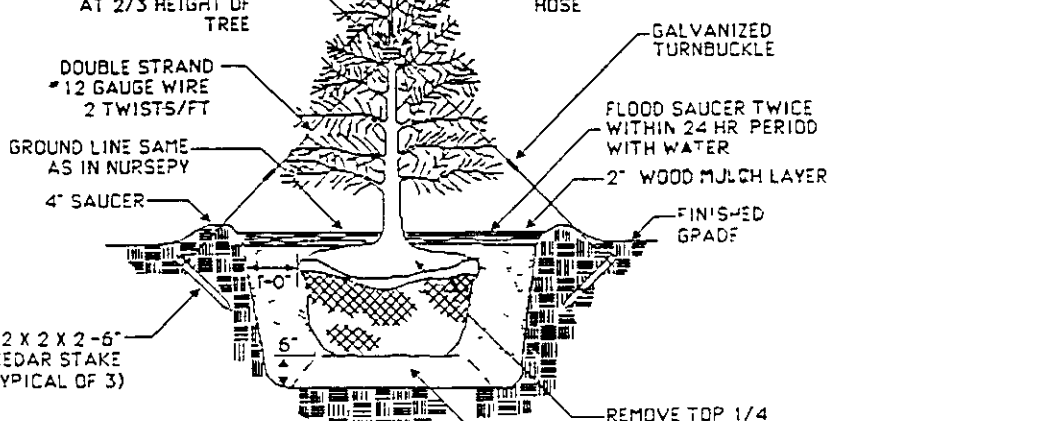

APPROVED FOR HOWARD COUNTY DIVISION OF COMMUNITY PLANNING AND LAND DEVELOPMENT

DATE: 6-26-89

EVERGREEN TREE PLANTING

NOT TO SCALE

DATE: 7-17-89

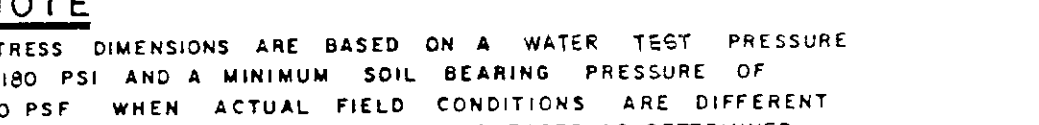
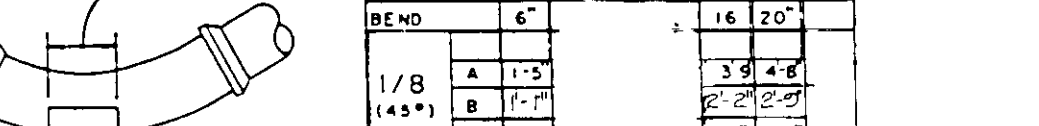
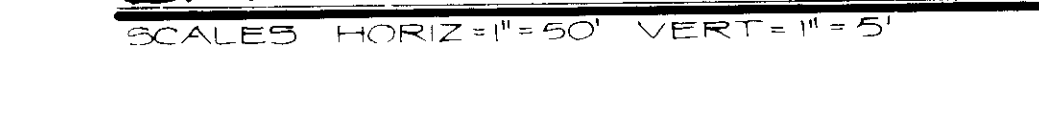
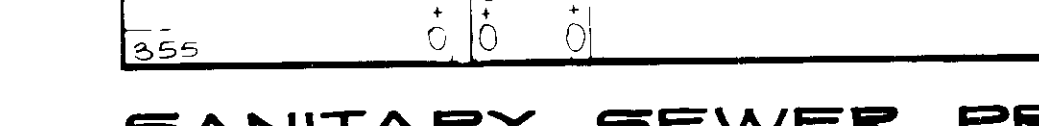
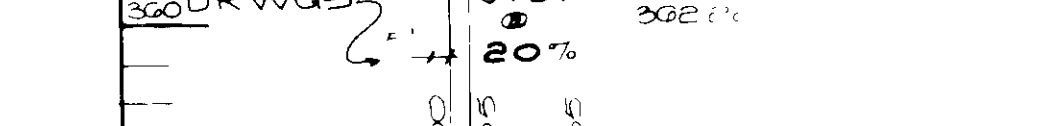
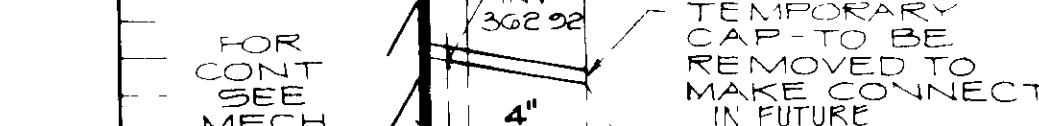
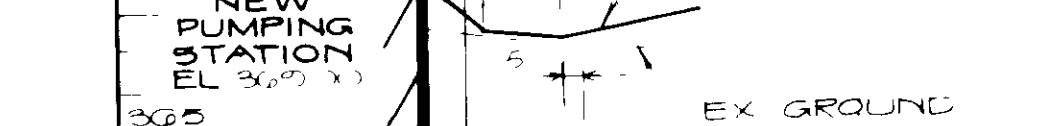
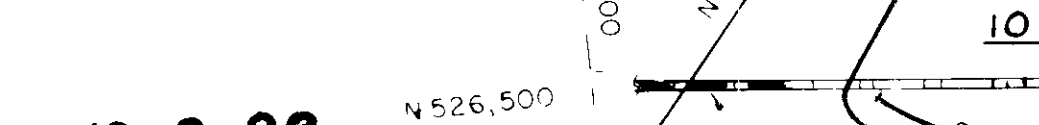
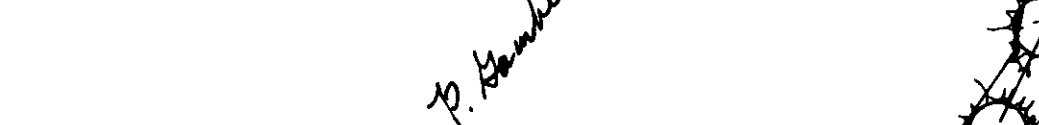
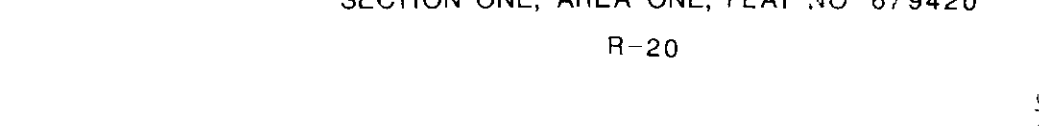
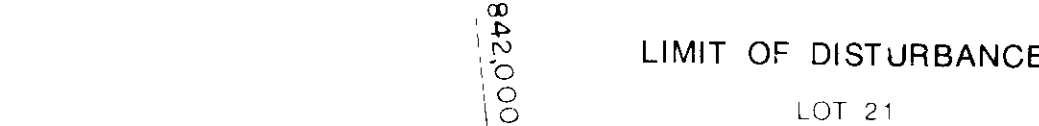
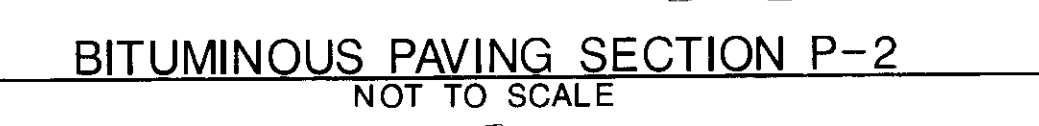

LOT 18
ENCHANTED FOREST ESTATES
SECTION ONE, AREA ONE, PLAT NO 679420
R-20

NOTE:
FOR LOCATION OF STABILIZED CONSTRUCTION ENTRANCE SEE SHEET 2 OF 64

LOT 47

LOT 21

ENCHANTED FOREST ESTATES
SECTION ONE, AREA ONE, PLAT NO 679420
R-20

PROP ACCESS ROAD

PROP. PUMPING STATION
1st FL EL. 369.00

LIMIT OF WATER LINE CONTRACT NO. 44-1747

LIMIT OF DISTURBANCE

20' WATER (BY OTHERS) CONTRACT NO. 44-1747

11'S ROUTE 40
HEIGHT OF WAY LINE

NEW TREE LINE

NEW TREE LINE

NEW TREE LINE

NEW TREE LINE

NEW TREE LINE

NEW TREE LINE

NEW TREE LINE

NEW TREE LINE

NEW TREE LINE

NEW TREE LINE

NEW TREE LINE

NEW TREE LINE

NEW TREE LINE

NEW TREE LINE

NEW TREE LINE

NEW TREE LINE

NEW TREE LINE

NEW TREE LINE

PLANT SCHEDULE

KEY	QTY	BOTANICAL NAME	SIZE	ROOT
PA	6	PIEA ALBIS	5'-6"	B4B
PN	19	FINUS NIGRA/AUSTRIAN PINE	5'-6"	B4B
PS	6	FINUS STROBUS/WHITE PINE	5'-6"	B4B
AR	5	ACER RUBRUM/OCT BLOSSOM RED MAPLE	1 1/2'-2'	B4B
CP	5	CRATAEGUS PHAEOPHYLLA/NORWAY SPRUCE	1 1/2'-2'	B4B
IG	10	ILEX GLABRA/COMPACT INK MAHONY	1 1/2'-2'	CONT
PM	6	FINUS MUCCO/COMPACT MUGGO PINE	1 1/2'-2'	CONT
PL	2	FINUS LAURECEASUS/OCTO LUXXEN CHERRY LAUREL	B4B	CONT

CONSTRUCTION NOTES

1. OBTAIN GRADING PERMIT.
2. CONSTRUCT STABILIZED CONSTRUCTION ENTRANCE, SILT FENCE, AND STABILIZE WITH TEMPORARY SEEDING.
3. GRADE ROAD TO SUBGRADE AND EXCAVATE THE LOCATION OF PUMPING STATION TO ELEV. 388.00; AS SKETCH SHOWN BELOW. SLOPES TO BE 2:1 MAX. UPWARD UNTIL THEY MEET EXISTING GRADE. STABILIZE DISTURBED AREA WITH TEMPORARY SEEDING.
4. INSTALL SURGE RELIEF DRAIN PIPE AND PROPOSED WATER LINE CONSTRUCT THE PUMPING STATION.
5. LAY BASE COURSE OF ROAD.
6. FINISH THE ROAD PAVING.
7. STABILIZE REMAINING DISTURBED AREA AND PLANTINGS.

LEGEND

EXISTING NEW

STRUCTURE

CONTOUR

CONCRETE PAVING

BITUMINOUS PAVING

WATER LINE

STORM DRAIN

SANITARY SEWER

CLEANOUT

WATER VALVE

SPOT ELEVATION

FENCE

TREE LINE

RIP-RAP

BASELINE OF CONSTRUCTION

DECIDUOUS TREE

EVERGREEN TREE

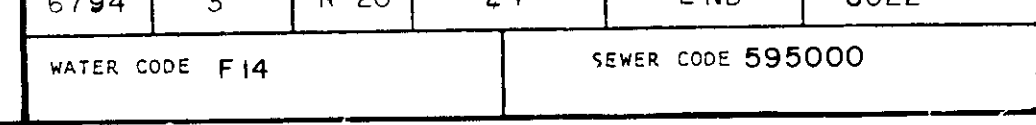
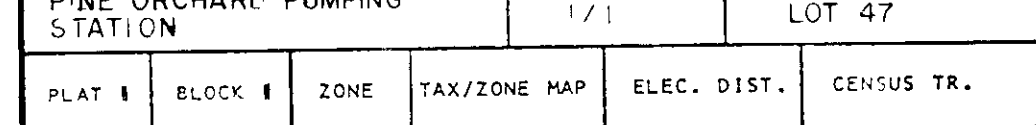
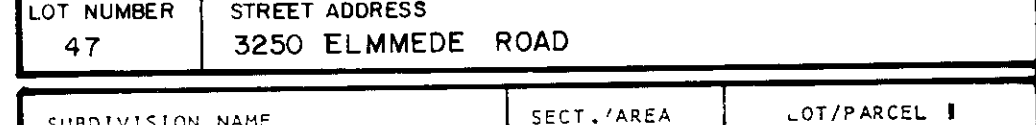
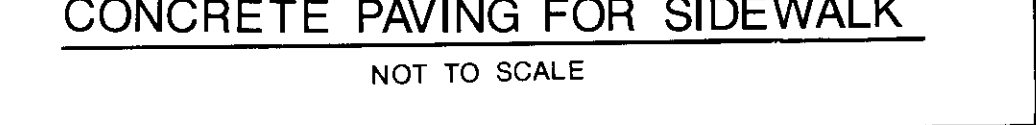
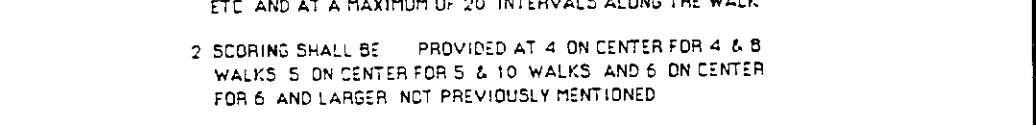
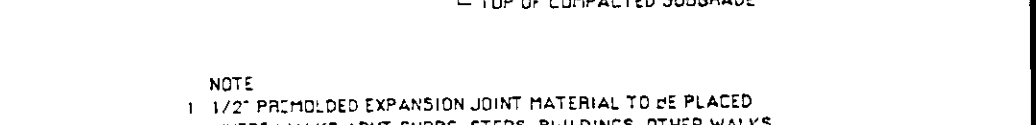
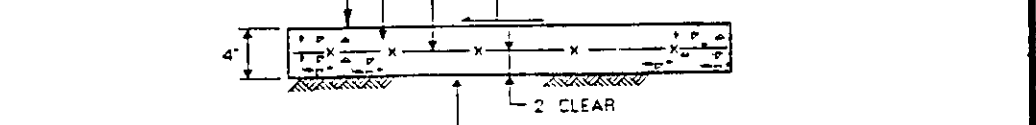
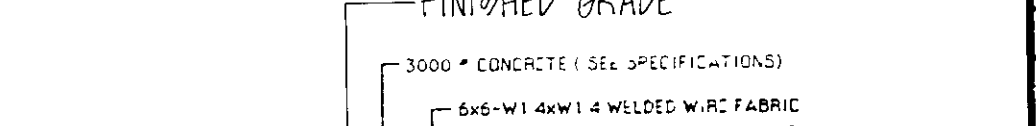
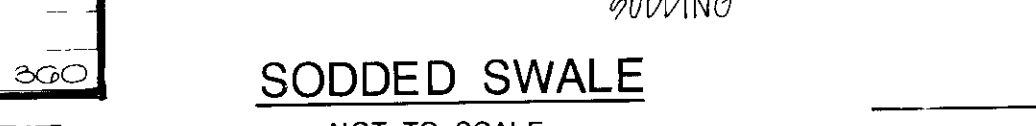
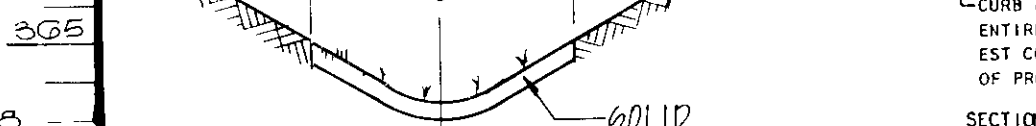
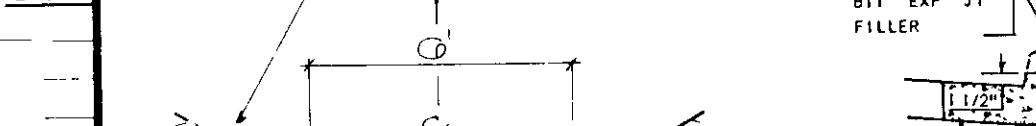
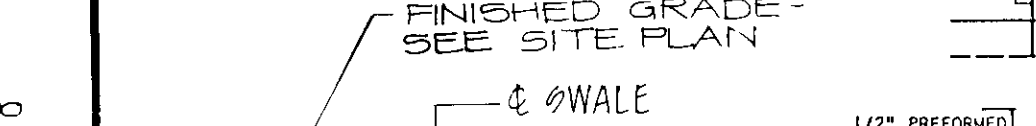
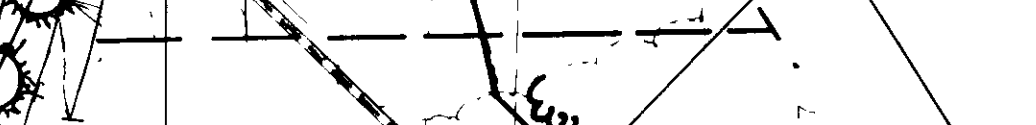
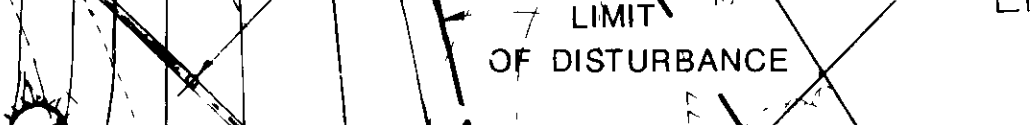
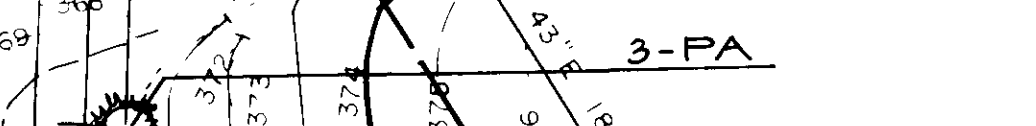
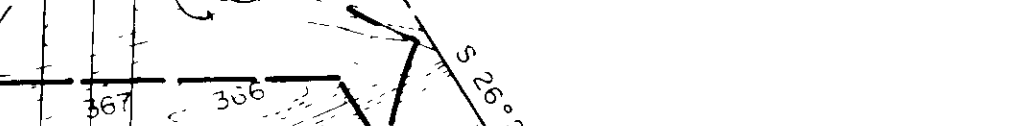
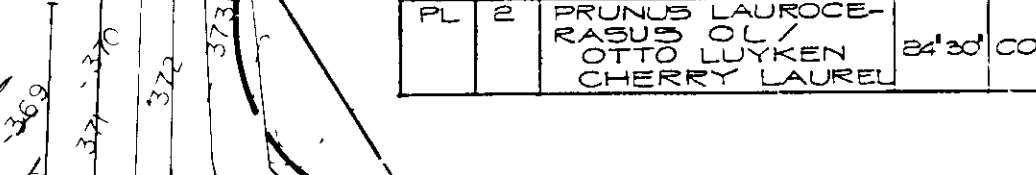

CONSTRUCTION NOTES

1. OBTAIN GRADING PERMIT.
2. CONSTRUCT STABILIZED CONSTRUCTION ENTRANCE, SILT FENCE, AND STABILIZE WITH TEMPORARY SEEDING.
3. GRADE ROAD TO SUBGRADE AND EXCAVATE THE LOCATION OF PUMPING STATION TO ELEV. 388.00; AS SKETCH SHOWN BELOW. SLOPES TO BE 2:1 MAX. UPWARD UNTIL THEY MEET EXISTING GRADE. STABILIZE DISTURBED AREA WITH TEMPORARY SEEDING.
4. INSTALL SURGE RELIEF DRAIN PIPE AND PROPOSED WATER LINE CONSTRUCT THE PUMPING STATION.
5. LAY BASE COURSE OF ROAD.
6. FINISH THE ROAD PAVING.
7. STABILIZE REMAINING DISTURBED AREA AND PLANTINGS.

LEGEND

EXISTING NEW

STRUCTURE

CONTOUR

CONCRETE PAVING

BITUMINOUS PAVING

WATER LINE

STORM DRAIN

SANITARY SEWER

CLEANOUT

WATER VALVE

SPOT ELEVATION

FENCE

TREE LINE

RIP-RAP

BASELINE OF CONSTRUCTION

DECIDUOUS TREE

EVERGREEN TREE

