

ELEVATIONS			
LOT NO	INVERT	LOT NO	INVERT
523	436.40	521	437.69
524	435.36	722	444.35
525	431.95	749	439.99
526	435.11	750	439.45
527	436.28	597	430.45
528	437.03	598	429.24
529	437.75	599	429.25
530	438.97	600	439.76

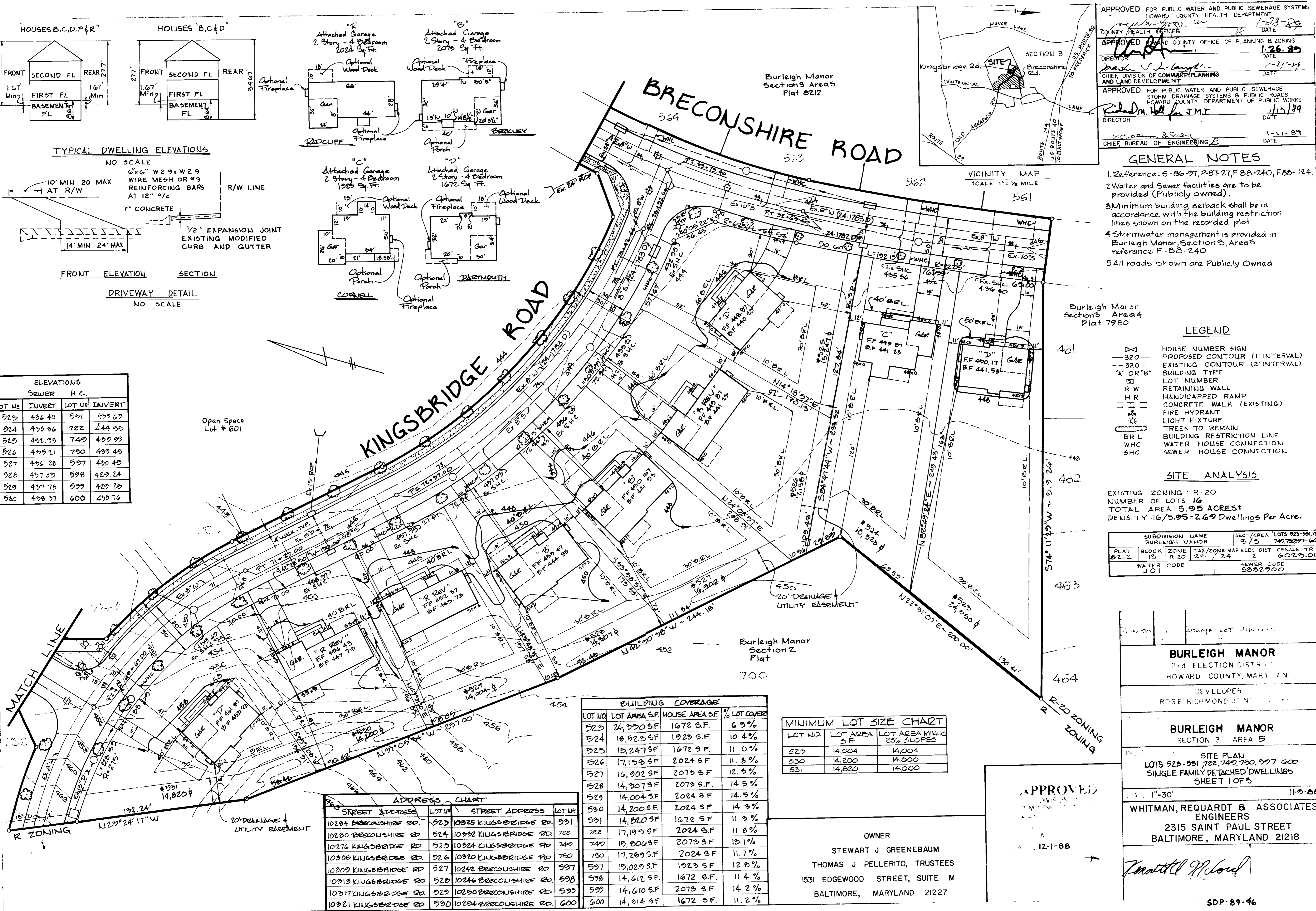

APPROVED FOR PUBLIC WATER AND PUBLIC SEWERAGE SYSTEMS
 HOWARD COUNTY HEALTH DEPARTMENT
 COUNTY HEALTH OFFICER: [Signature] DATE: 1-23-89
 APPROVED FOR PLANNING & ZONING
 HOWARD COUNTY OFFICE OF PLANNING & ZONING
 DIRECTOR: [Signature] DATE: 1-26-89
 CHIEF, DIVISION OF COMMUNITY PLANNING AND LAND DEVELOPMENT
 APPROVED FOR PUBLIC WATER AND PUBLIC SEWERAGE STORM DRAINAGE SYSTEMS & PUBLIC WORKS
 HOWARD COUNTY DEPARTMENT OF PUBLIC WORKS
 DIRECTOR: [Signature] DATE: 1-17-89
 CHIEF, BUREAU OF ENGINEERING

- GENERAL NOTES**
- Reference: S-86-97, P-87-27, F-88-240, F-88-124.
 - Water and Sewer facilities are to be provided (Publicly owned).
 - Minimum building setback shall be in accordance with the building restriction lines shown on the recorded plot.
 - Stormwater management is provided in Burleigh Manor Section 3, Area 5 reference F-88-240.
 - All roads shown are Publicly Owned.

- LEGEND**
- HOUSE NUMBER SIGN
 - 320 PROPOSED CONTOUR (1' INTERVAL)
 - 320 EXISTING CONTOUR (2' INTERVAL)
 - "A" OR "B" BUILDING TYPE
 - R/W LOT NUMBER
 - R/W RETAINING WALL
 - H/R HANDICAPPED RAMP
 - CONCRETE WALK (EXISTING)
 - FIRE HYDRANT
 - LIGHT FIXTURE
 - TREES TO REMAIN
 - BRL BUILDING RESTRICTION LINE
 - WHC WATER HOUSE CONNECTION
 - SHC SEWER HOUSE CONNECTION

SITE ANALYSIS

EXISTING ZONING: R-20
 NUMBER OF LOTS: 16
 TOTAL AREA: 5.95 ACRES
 DENSITY: 16/5.95 = 2.69 Dwellings Per Acre.

SUBDIVISION NAME		SECT/AREA	LOTS 523-591, 722-749, 750-997-600
BURLEIGH MANOR		3/5	749, 750-997-600
PLAT	BLOCK	ZONE	TAX/ZONE MAP
B212	13	R-20	23, 24
WATER CODE		SEWER CODE	
J01		5882900	

BUILDING COVERAGE

LOT NO	LOT AREA SF	HOUSE AREA SF	% LOT COVER
523	24,350 SF	1672 SF	6.9%
524	18,523 SF	1923 SF	10.4%
525	15,247 SF	1672 SF	11.0%
526	17,153 SF	2024 SF	11.8%
527	16,902 SF	2073 SF	12.3%
528	14,307 SF	2073 SF	14.5%
529	14,004 SF	2024 SF	14.5%
530	14,200 SF	2024 SF	14.3%
531	14,820 SF	1672 SF	11.3%
722	17,193 SF	2024 SF	11.8%
749	15,804 SF	2073 SF	13.1%
750	17,289 SF	2024 SF	11.7%
597	15,029 SF	1723 SF	12.8%
598	14,612 SF	1672 SF	11.4%
599	14,610 SF	2073 SF	14.2%
600	14,914 SF	1672 SF	11.2%

MINIMUM LOT SIZE CHART

LOT NO	LOT AREA SF	LOT AREA MINUS 25% SLOPES
529	14,004	14,004
530	14,200	14,000
531	14,820	14,000

ADDRESS CHART

STREET ADDRESS	LOT NO	STREET ADDRESS	LOT NO
10204 BRECONSHIRE RD.	523	10225 KINGSBRIDGE RD.	531
10200 BRECONSHIRE RD.	524	10932 KINGSBRIDGE RD.	722
10276 KINGSBRIDGE RD.	525	10924 KINGSBRIDGE RD.	749
10305 KINGSBRIDGE RD.	526	10920 KINGSBRIDGE RD.	750
10309 KINGSBRIDGE RD.	527	10242 BRECONSHIRE RD.	597
10213 KINGSBRIDGE RD.	528	10246 BRECONSHIRE RD.	598
10317 KINGSBRIDGE RD.	529	10250 BRECONSHIRE RD.	599
10321 KINGSBRIDGE RD.	530	10254 BRECONSHIRE RD.	600

OWNER
 STEWART J GREENBAUM
 THOMAS J PELLERITO, TRUSTEES
 1531 EDGEWOOD STREET, SUITE M
 BALTIMORE, MARYLAND 21227

APPROVED
 DIVISION OF PUBLIC WORKS
 DATE: 12-1-88

Change LOT NUMBERS

BURLEIGH MANOR
 2nd ELECTION DISTRICT
 HOWARD COUNTY, MARYLAND

DEVELOPER
 ROSE RICHMOND JUNT

BURLEIGH MANOR
 SECTION 3 AREA 5

SITE PLAN
 LOTS 523-591, 722, 749, 750, 597-600
 SINGLE FAMILY DETACHED DWELLINGS
 SHEET 1 OF 3

SCALE: 1"=30' DATE: 11-9-88

WHITMAN, REQUARDT & ASSOCIATES
 ENGINEERS
 2315 SAINT PAUL STREET
 BALTIMORE, MARYLAND 21218

[Signature]

APPROVED FOR PUBLIC WATER AND PUBLIC SEWERAGE SYSTEMS
 HOWARD COUNTY HEALTH DEPARTMENT
 COUNTY HEALTH OFFICER *[Signature]* DATE 1-27-89
 APPROVED HOWARD COUNTY OFFICE OF PLANNING & ZONING
 DIRECTOR *[Signature]* DATE 1-26-89
 CHIEF DIVISION OF COMMUNITY PLANNING AND LAND DEVELOPMENT DATE 1-27-89
 APPROVED FOR PUBLIC WATER AND PUBLIC SEWERAGE STORM DRAINAGE SYSTEMS & PUBLIC ROADS
 HOWARD COUNTY DEPARTMENT OF PUBLIC WORKS
 DIRECTOR *[Signature]* DATE 1/17/89
 CHIEF, BUREAU OF ENGINEERING *[Signature]* DATE 1-17-89

Stewart J. Greenebaum &
 Thomas J. Pellerito Trustees
 1765/304

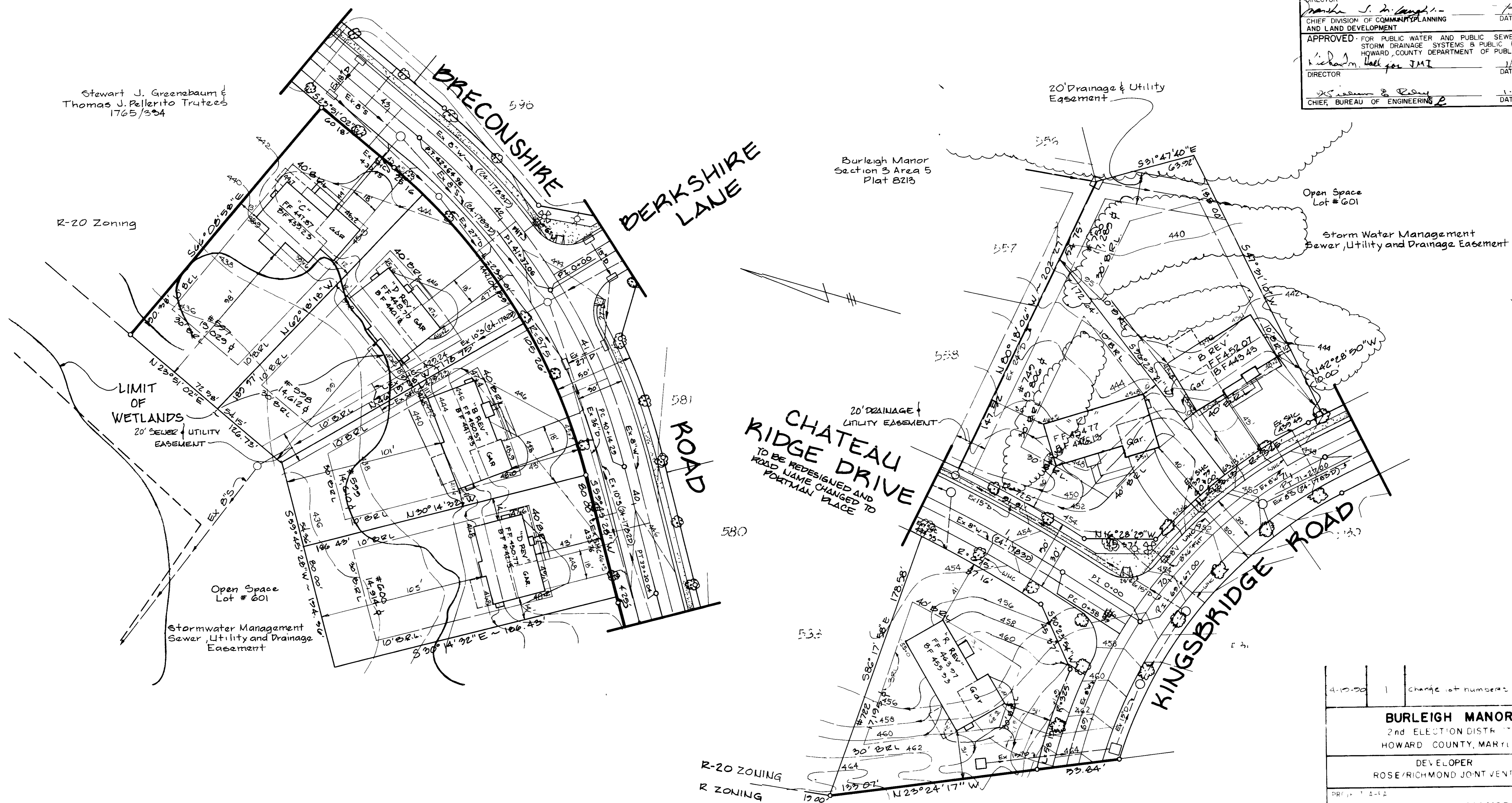

CHATEAU RIDGE DRIVE
 TO BE REDESIGNED AND
 ROAD NAME CHANGED TO
 PORTMAN PLACE

R-20 ZONING
 R ZONING

Burleigh Manor
 Section 2 Plat

OWNER
 STEWART J GREENEBAUM
 THOMAS J PELLERITO, TRUSTEES
 1531 EDGEWOOD STREET, SUITE M
 BALTIMORE, MARYLAND 21227

12-1-88

4-10-88	1	Change of numbers
BURLEIGH MANOR 2nd ELECTION DISTRICT HOWARD COUNTY, MARYLAND		
DEVELOPER ROSE/RICHMOND JOINT VENTURE		
BURLEIGH MANOR SECTION 3 AREA 5		
PROJECT SITE PLAN LOTS 529-531, 722, 742, 750 & 597-600 SINGLE FAMILY DETACHED DWELLINGS SHEET 2 OF 3		
SCALE 1"=30'		11-9-88
WHITMAN, REQUARD & ASSOCIATES ENGINEERS 2315 SAINT PAUL STREET BALTIMORE MARYLAND 21218		

[Signature]

SEQUENCE OF CONSTRUCTION:

1. Obtain grading permit
2. Install and stabilize all sediment and erosion control measures. (1 Week)
3. Construct dwellings and appurtenance. (18 Months)
4. Stabilize site as per permanent seeding specifications.
5. Remove temporary sediment control measures and stabilize any remaining areas.
6. Temporary sediment control may be removed as individual lots are completed and stabilized.

Soil erosion control measures shall be installed and maintained in accordance with the following schedule:

1. Erosion Control Measures shall be installed and maintained in accordance with the following schedule:

2. Erosion Control Measures shall be installed and maintained in accordance with the following schedule:

3. Erosion Control Measures shall be installed and maintained in accordance with the following schedule:

4. Erosion Control Measures shall be installed and maintained in accordance with the following schedule:

5. Erosion Control Measures shall be installed and maintained in accordance with the following schedule:

6. Erosion Control Measures shall be installed and maintained in accordance with the following schedule:

7. Erosion Control Measures shall be installed and maintained in accordance with the following schedule:

8. Erosion Control Measures shall be installed and maintained in accordance with the following schedule:

9. Erosion Control Measures shall be installed and maintained in accordance with the following schedule:

10. Erosion Control Measures shall be installed and maintained in accordance with the following schedule:

Jorge M. Boyd mo 1-23-89
 [Signature]
 1.26.89
 1/4/89
 1/17/89
 1-17-89

LEGEND

[Symbol]	Limit of Disturbance
[Symbol]	Earth Dike
[Symbol]	Silt Fence
[Symbol]	Stabilized Construction Entrance
[Symbol]	Lot Number
[Symbol]	Inlet Protection

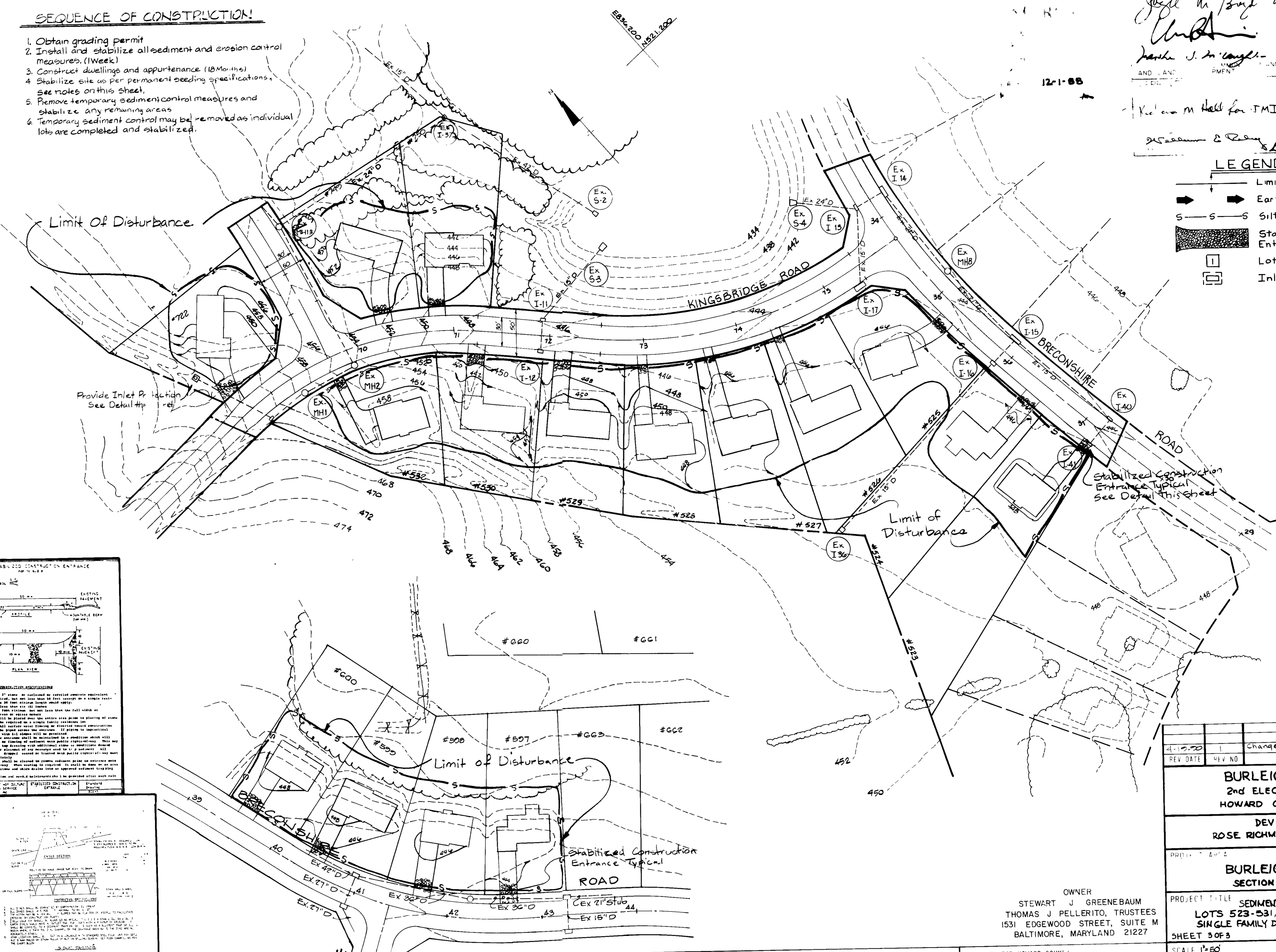

TOPSOIL SEEDING NOTES

1. Topsoil Seeding Notes shall be installed and maintained in accordance with the following schedule:

2. Topsoil Seeding Notes shall be installed and maintained in accordance with the following schedule:

3. Topsoil Seeding Notes shall be installed and maintained in accordance with the following schedule:

4. Topsoil Seeding Notes shall be installed and maintained in accordance with the following schedule:

5. Topsoil Seeding Notes shall be installed and maintained in accordance with the following schedule:

6. Topsoil Seeding Notes shall be installed and maintained in accordance with the following schedule:

7. Topsoil Seeding Notes shall be installed and maintained in accordance with the following schedule:

8. Topsoil Seeding Notes shall be installed and maintained in accordance with the following schedule:

9. Topsoil Seeding Notes shall be installed and maintained in accordance with the following schedule:

10. Topsoil Seeding Notes shall be installed and maintained in accordance with the following schedule:

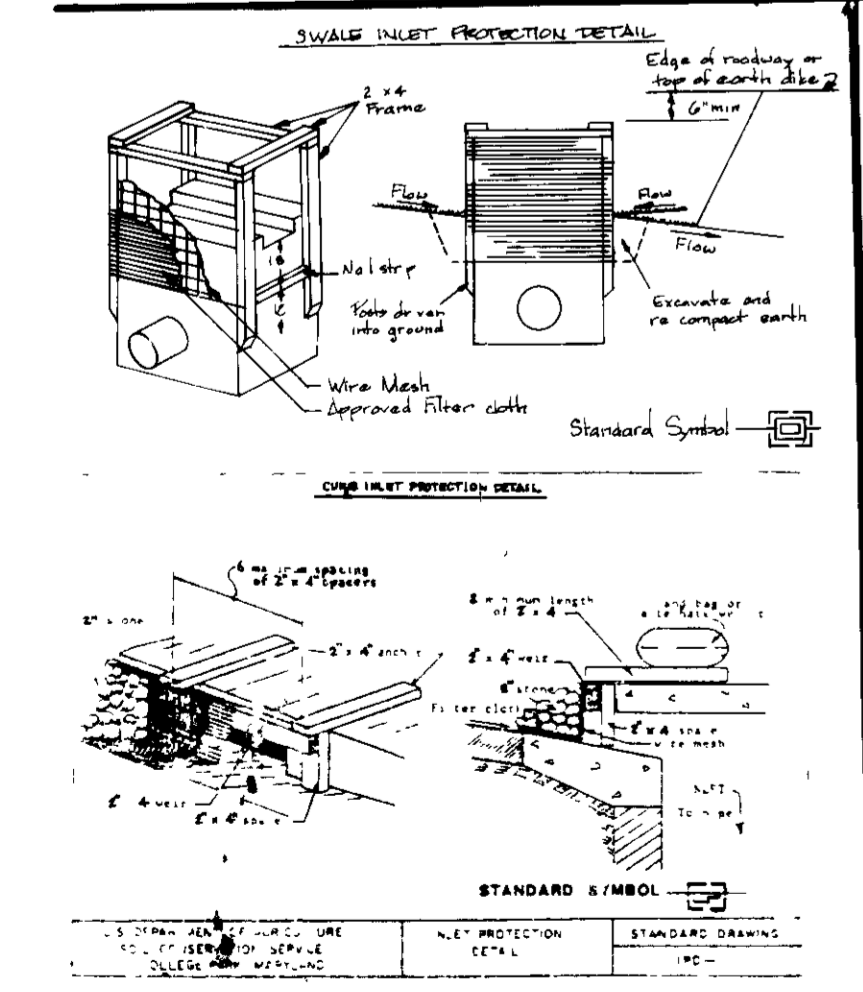
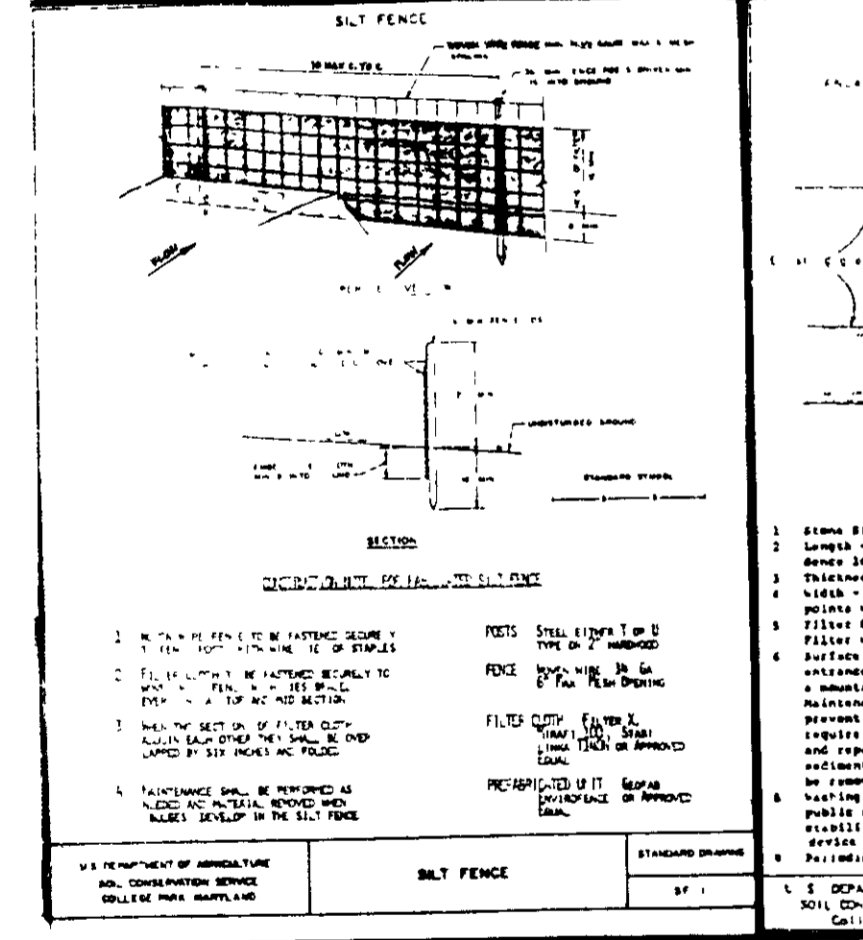

CONSTRUCTION SPECIFICATIONS

1. Erosion Control Measures shall be installed and maintained in accordance with the following schedule:

2. Erosion Control Measures shall be installed and maintained in accordance with the following schedule:

3. Erosion Control Measures shall be installed and maintained in accordance with the following schedule:

4. Erosion Control Measures shall be installed and maintained in accordance with the following schedule:

5. Erosion Control Measures shall be installed and maintained in accordance with the following schedule:

6. Erosion Control Measures shall be installed and maintained in accordance with the following schedule:

7. Erosion Control Measures shall be installed and maintained in accordance with the following schedule:

8. Erosion Control Measures shall be installed and maintained in accordance with the following schedule:

9. Erosion Control Measures shall be installed and maintained in accordance with the following schedule:

10. Erosion Control Measures shall be installed and maintained in accordance with the following schedule:

CONSTRUCTION SPECIFICATIONS

1. Erosion Control Measures shall be installed and maintained in accordance with the following schedule:

2. Erosion Control Measures shall be installed and maintained in accordance with the following schedule:

3. Erosion Control Measures shall be installed and maintained in accordance with the following schedule:

4. Erosion Control Measures shall be installed and maintained in accordance with the following schedule:

5. Erosion Control Measures shall be installed and maintained in accordance with the following schedule:

6. Erosion Control Measures shall be installed and maintained in accordance with the following schedule:

7. Erosion Control Measures shall be installed and maintained in accordance with the following schedule:

8. Erosion Control Measures shall be installed and maintained in accordance with the following schedule:

9. Erosion Control Measures shall be installed and maintained in accordance with the following schedule:

10. Erosion Control Measures shall be installed and maintained in accordance with the following schedule:

REV. DATE	REV. NO.	REVISION DESCRIPTION
4-15-88	1	Change lot numbers

BURLEIGH MANOR
 2nd ELECTION DISTRICT
 HOWARD COUNTY, MARYLAND

DEVELOPER
 ROSE RICHMOND JOINT VENTURE

BURLEIGH MANOR
 SECTION 3 AREA 5

PROJECT TITLE
 SEDIMENT CONTROL PLAN & DETAILS
 LOTS 523-531, 722, 749, 750 & 597-600
 SINGLE FAMILY DETACHED DWELLINGS

SHEET 3 OF 3

SCALE 1"=50' 11-9-88

WHITMAN, REQUARD & ASSOCIATES
 ENGINEERS
 2315 SAINT PAUL STREET
 BALTIMORE MARYLAND 21218

Kenneth A. McCord
 REGISTERED ENGINEER NO 1974

CERTIFICATION BY THE ENGINEER

I, **Kenneth A. McCord**, DATE 11/7/88

CERTIFICATION BY THE DEVELOPER

I, **David L. Carney**, DATE 11/11/88

REVIEWED FOR HOWARD COUNTY
 S.C.D. AND MEETS TECHNICAL REQUIREMENTS

Stephen L. Spitzer 1/17/89