

NOTE: A Where curb & gutter exists, move & reconstruct curb & gutter to first joint on either side

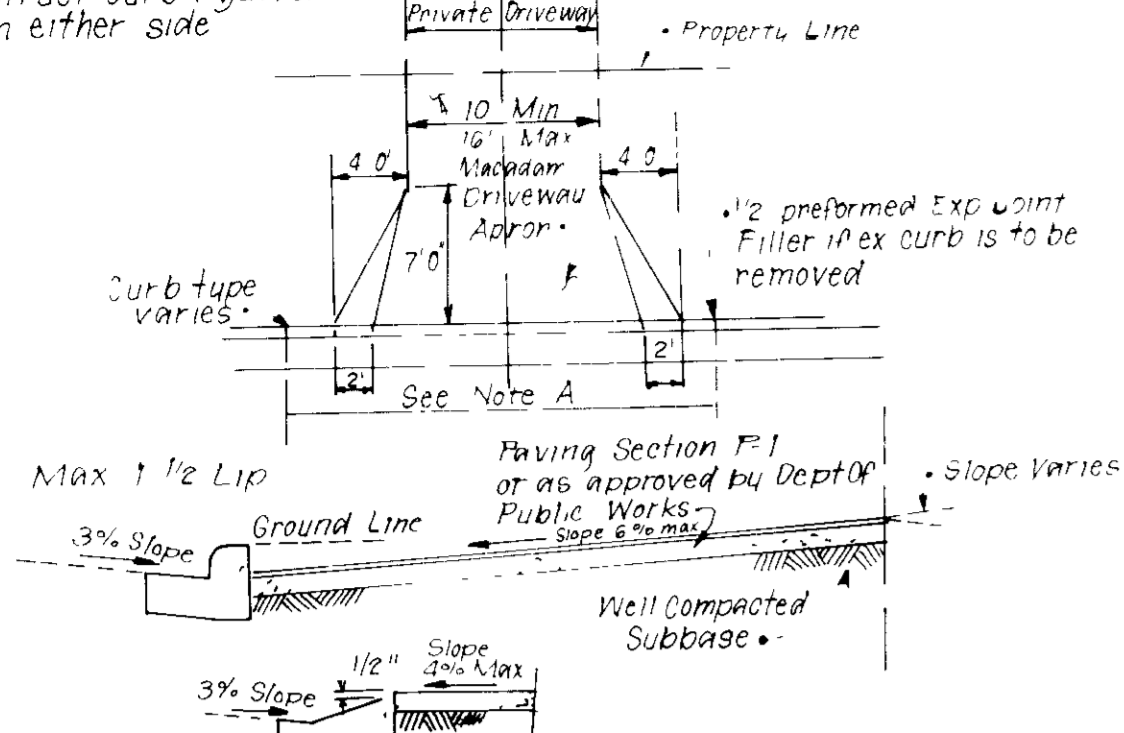

Provide Ho Co Std 561 metal end section at each end of culvert

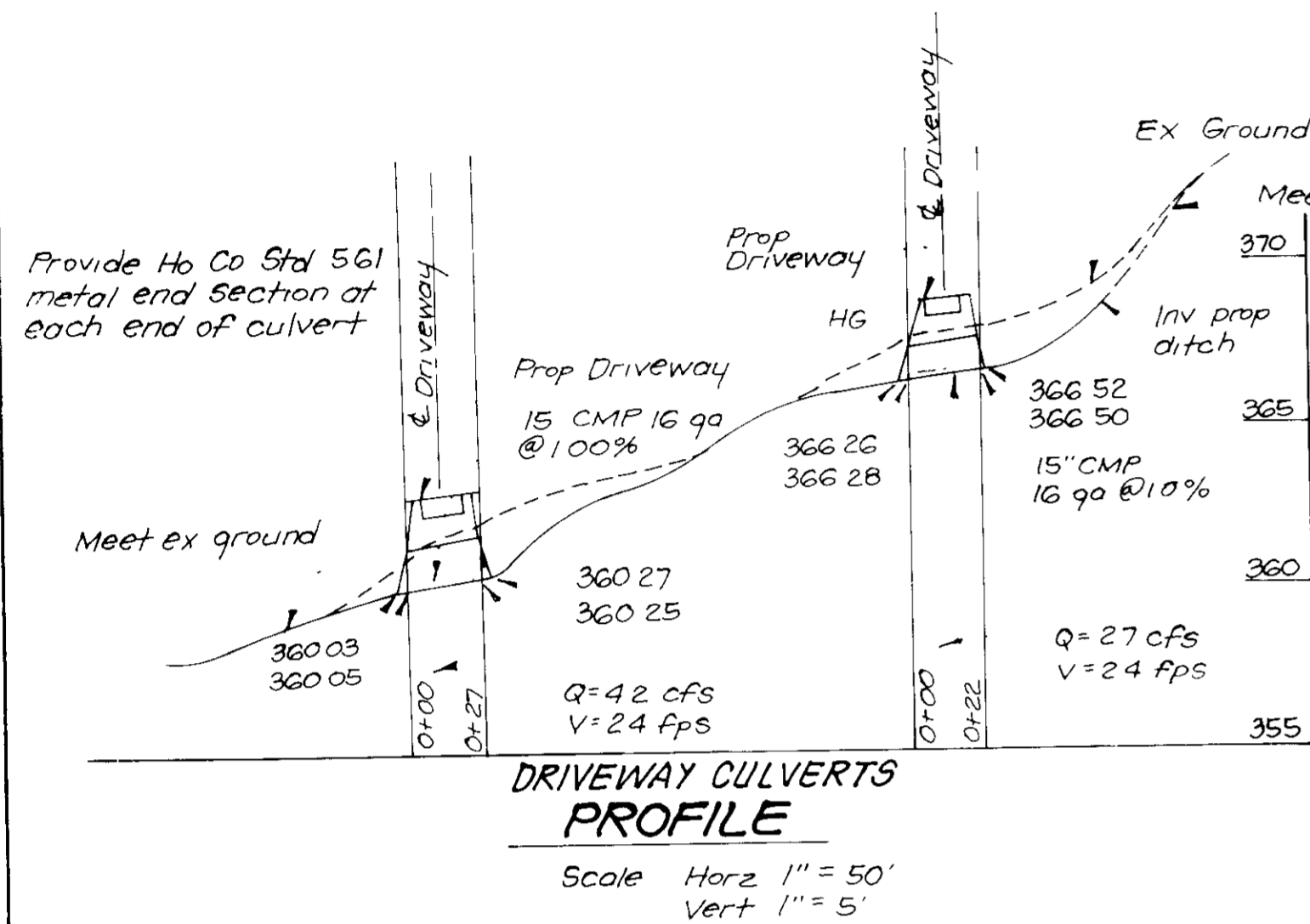

STORM DRAIN NOTES

- All storm drain & paving shall be in accordance with the latest edition and specifications of Ho Co & Md SHA
- Types of storm drainage refer to the Standard details of Ho Co & Md SHA
- Trench composition for storm drains within road or street right of way limits shall be in accordance with Ho Co Design Manual, Vol. III, Sec 6-201
- Information concerning underground utilities was obtained from available records, but the contractor must determine the exact location and elevation of mains by digging test pits, by hand, at all utility crossings, well in advance of construction
- All utility companies shall be notified 24 hrs in advance of construction
- The contractor or developer shall contact the Construction Inspection / Survey Division 24 hrs in advance of commencement of work at 792-7272

APPROVED FOR PUBLIC WATER AND PUBLIC SEWERAGE SYSTEMS
HOWARD COUNTY HEALTH DEPARTMENT
DATE: 6-5-89

APPROVED FOR PLANNING AND ZONING
HOWARD COUNTY OFFICE OF PLANNING AND ZONING
DATE: 6.12.89

APPROVED FOR PUBLIC WATER AND PUBLIC SEWERAGE
STORM DRAINAGE SYSTEMS AND PUBLIC ROADS
HOWARD COUNTY DEPARTMENT OF PUBLIC WORKS
DATE: 6-1-89

APPROVED FOR PUBLIC WATER AND PUBLIC SEWERAGE SYSTEMS AND PUBLIC ROADS
HOWARD COUNTY DEPARTMENT OF PUBLIC WORKS
DATE: 11-23-88

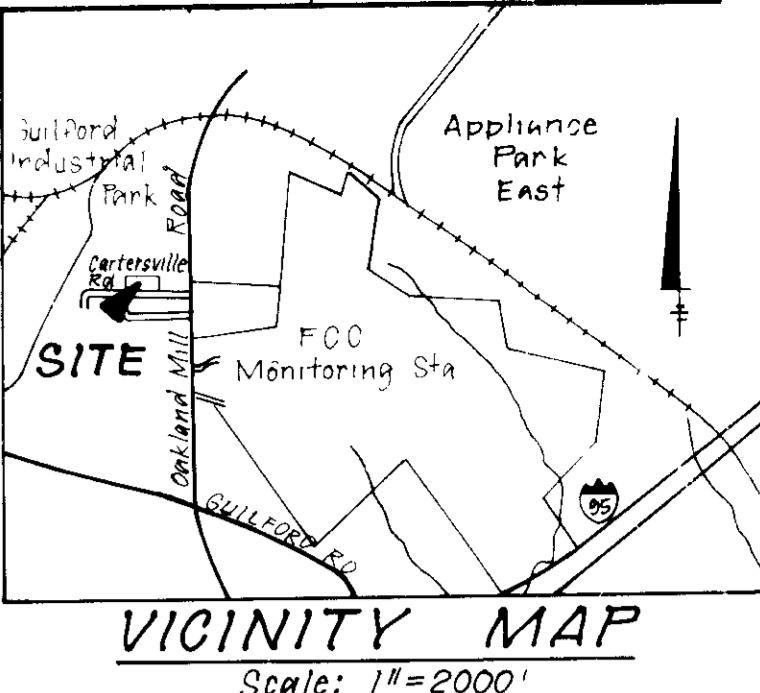
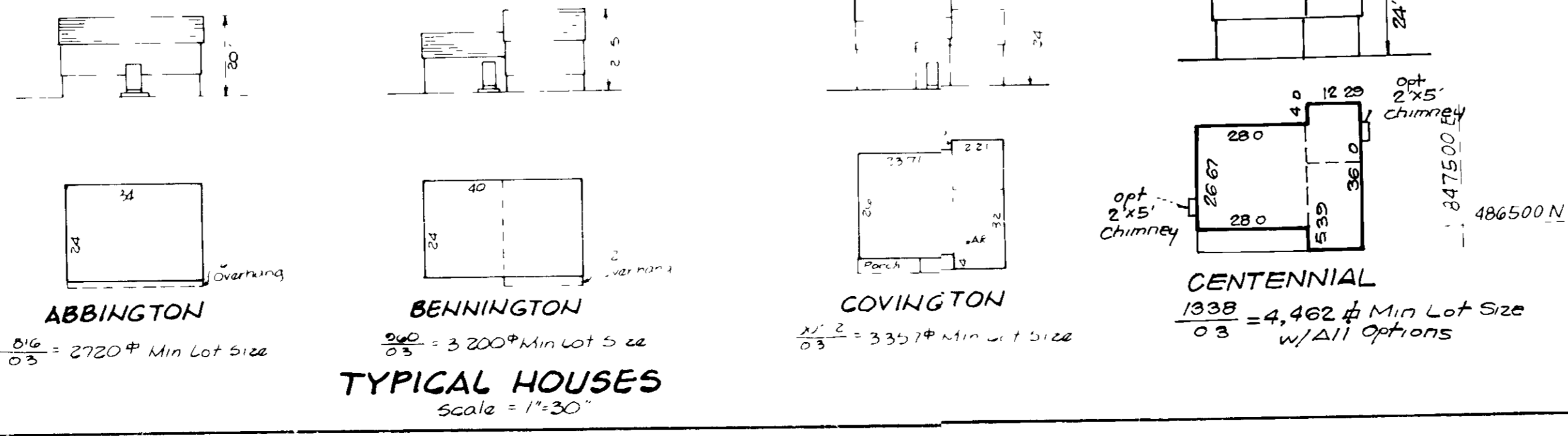

Revise #	Revise Description	Date
1	Revise # 1 of lot 106, Add hse typical	77-92
REVISIONS		

LEGEND

- 1 Contour Interval
- 2 Existing Contour
- 3 Proposed Contour
- 4 Spot Elevation
- 5 Direction of drainage
- 6 Walk-out basement
- 7 Existing Trees
- 8 Trees to be saved
- 9 Street Address Sign

ADDRESS CHART

LOT NO	STREET ADDRESS
103	7335 HIDDEN COVE
104	7339
105	7343
106	7347
107	7351
108	7355
109	7359
110	7363

- GENERAL NOTES**
- Subject property is zoned R-12 per 8-2-85 Comprehensive Zoning Plan
 - The coordinates shown hereon are based on the Maryland State Grid System and are derived from the following Howard County Control Stations
 - All roadways are public and existing
 - Total area included in this submission is 2.529 Ac
 - Total number of lots is 8
 - Any damage to County owned rights-of-way shall be corrected at the developer's expense
 - Maximum lot coverage is 30%
 - Reference plans F-82-150, 3-87-87, P-85-13
 - The contractor or developer shall contact the Construction Inspection / Survey Division 24 hours in advance of commencement of work at 792-2930
 - Topography was field located by Clark, Finrock & Sackett

- SPECIAL NOTES**
- Approved Road Construction Plans shall be used for all public utilities
 - Public water and sewer shown for reference only. For more detailed information see water and sewer plans 405 WES
 - Stormwater management provided - Carters Cove 5601 Area F-87-75
 - The water and sewer house connections not included in a Developers Agreement shall conform to Howard County Plumbing Code. The on site WHC shall be 1" copper and the SHC shall be 4" iron

SUBDIVISION NAME CARTERS COVE	SECT AREA 2	LOTS 103-110
PLAT # R-12	BLOCK # 42	TAXI ZONE MAP ELEC DIST G
WATER CODE F-14	SEWER CODE S-20100	

CLARK • FINEPROCK & SACKETT, INC
ENGINEERS • PLANNERS • SURVEYORS

SITE DEVELOPMENT PLAN
LOTS 103-110
CARTERS COVE
SECTION 2
6th ELECTION DISTRICT
HOWARD COUNTY, MARYLAND

DATE: For Crystal Hill Inv. Inc. 10005 Columbia, MD 21032
OCT 1988

SCALE: 1" = 30'

JOB NO: 88-009
FILE NO: 82-002



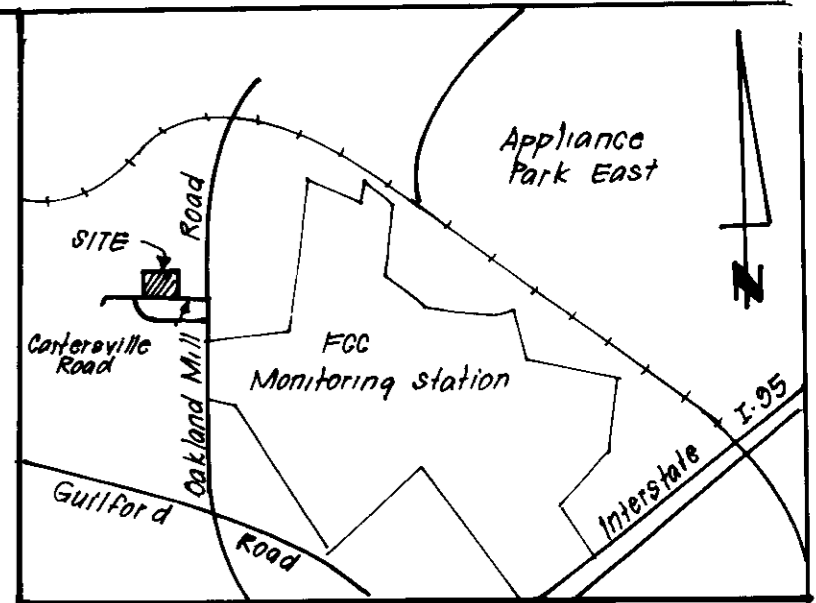

VICINITY MAP
Scale 1"=2000

(F-88-159)
EX. TRAP SOST (ST-V)
Drainage Area 2.9 Ac
Storage Required 5220 CF
Storage Provided 5280 CF
Crest Elevation 357.0
Bottom Elevation 352.0
Clean Out Elevation 354.5
Crest Width 12'
Depth 4'
Bottom Dimensions: 54x15'

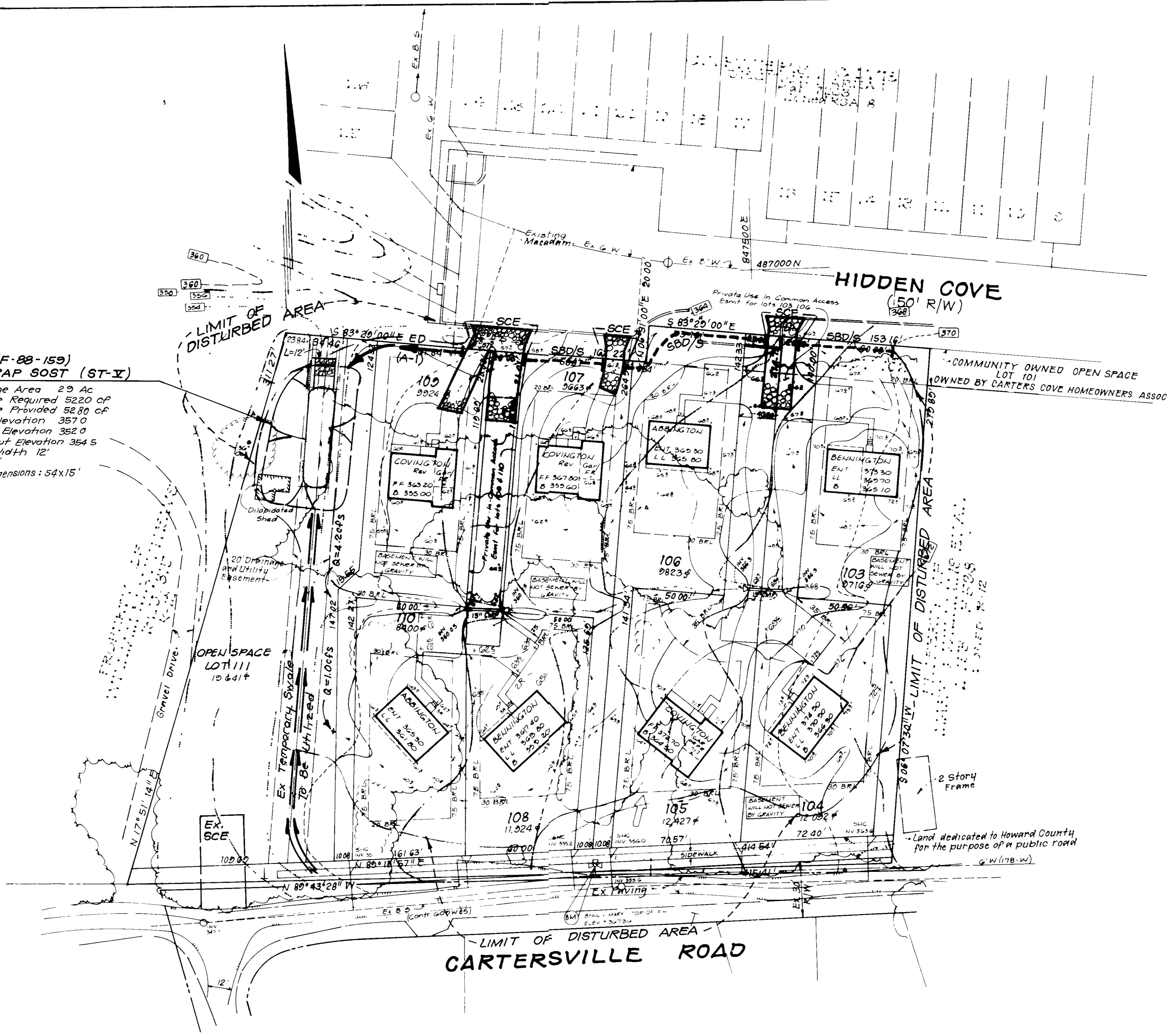

LEGEND

- 1 Contour Interval 2 Ft
- 2 Existing Contour 410
- 3 Proposed Contour 410
- 4 Spot Elevation +10.5
- 5 Direction of drainage
- 6 Walk-out basement
- 7 Existing Trees
- 8 Trees to be saved
- 9 Street Address Sign
- 10 Straw Bale Dike/Silt Fence
- 11 Earth Dike
- 12 Temporary Swale (Existing)
- 13 Stabilized Construction Entrance

AUTHORIZATION NOTE

Security Development Corporation authorizes Crystal Hill Inv. Inc. to utilize the existing sediment and erosion control measures shown on plan # 88-159 for sediment control for this project. If Security Development Corp removes the existing sediment and erosion control measures prior to completion of SDP 89-85 a revised sediment and erosion control plan shall be required.

Stephen Broeden v.p.
Name: Stephen Broeden Date: 10-31-88

APPROVED FOR PUBLIC WATER AND PUBLIC SEWERAGE SYSTEMS HOWARD COUNTY HEALTH DEPARTMENT	<i>Joseph M. Boyd</i> v.p. DATE: 6-5-89
APPROVED HOWARD COUNTY OFFICE OF PLANNING & ZONING	<i>Charles</i> DATE: 6-12-89
CHIEF DIVISION OF COMMUNITY PLANNING AND LAND DEVELOPMENT	<i>Mark S. DeWalt</i> DATE: 6-2-89
APPROVED FOR PUBLIC WATER AND PUBLIC SEWERAGE SYSTEMS AND PUBLIC ROADS HOWARD COUNTY DEPARTMENT OF PUBLIC WORKS	<i>James</i> DATE: 6/1/89
CHIEF BUREAU OF ENGINEERING	<i>James</i> DATE: 5-28-89

11-23-88

Reviewed for S.C.D.
John
U.S. Soil Conservation Service
DEVELOPMENT PLAN IS APPROVED FOR SOIL EROSION AND SEDIMENT CONTROL BY THE HOWARD SOIL CONSERVATION DISTRICT.

DEVELOPER'S CERTIFICATE
I/We certify that all development and construction will be done according to the plan of development and for erosion and sediment control and that all responsible personnel involved in the construction project will have a Certificate of Attendance at a Dept. of Natural Resources Approved Training Program for the Control of Sediment and Erosion before beginning the project. I/We also authorize periodic on-site inspection by the Howard Soil Conservation District or their authorized agents, as are deemed necessary.

Steven Murray
Signature of Developer/Builder Date: 10/31/88

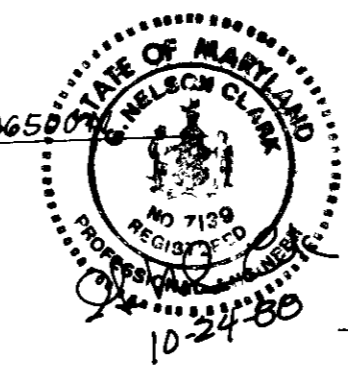

ENGINEER'S CERTIFICATE
I hereby certify that this plan for Erosion and Sediment Control represents a practical and workable plan based on my personal knowledge of the site conditions and that it was prepared in accordance with the requirements of the Howard Soil Conservation District.

G. Nelson Clark
Signature of Engineer Date: 10-24-88

CLARK • FINEFROCK & SACKETT, INC. ENGINEERS • PLANNERS • SURVEYORS 7135 MINTREL WAY • COLUMBIA MD 21045 • (301) 381-7500 - BALTO. • (301) 621-8100 - WASH.		
DESIGNED KIW	SEDIMENT & EROSION CONTROL PLAN LOTS 103-110 CARTERS COVE SECTION 2 6TH ELECTION DISTRICT HOWARD COUNTY, MARYLAND	SCALE 1"=30'
DRAWN BAL		DRAWING 2 OF 3
CHECKED KIW		JOB NO. 88-099
DATE Oct 1988		FILE NO. 88-099-SE
For Crystal Hill Inv. Inc. 10005 Old Columbia Rd. Columbia Md 21046		SDP-89-85

PERMANENT SEEDING NOTES

- Apply to graded or cleared areas not subject to immediate further disturbance where a permanent vegetative cover is needed.
- Soil Preparation - Loosen upper three inches of soil by raking, discing or other means.
- Seeding - For the periods March 1 thru April 30, and August 1 thru October 15, seed with 60 lbs per acre (1.4 lbs/1000 sq ft) of Kentucky 31 Tall Fescue per acre and 2 lbs per acre of 10-10-10 fertilizer (2.3 lbs/1000 sq ft) before seeding. For the period May 1 thru July 31, seed with 60 lbs Kentucky 31 Tall Fescue per acre and 2 lbs per acre of 10-10-10 fertilizer (2.3 lbs/1000 sq ft) before seeding. For the period October 16 thru February 28, protect site by Option (1) 2 tons per acre of well anchored straw mulch and seed as soon as possible in the spring. Option (2) Use sod. Option (3) Seed with 60 lbs/acre Kentucky 31 Tall Fescue and mulch with 2 tons/acre well anchored straw.
- Mulching - Apply 1 1/2 to 2 tons per acre (70 to 90 lbs/1000 sq ft) of unrotted small grain straw immediately after seeding. Anchor mulch immediately after application using anchoring tool or 218 gal per acre (5 gal/1000 sq ft) of emulsified asphalt on flat areas. On slopes 8 feet or higher, use 348 gallons per acre (8 gal/1000 sq ft) for anchoring.
- Inspection - Inspect all seeded areas and make needed repairs, replacements and reseedings.

TEMPORARY SEEDING NOTES

- Apply to graded or cleared areas likely to be redistributed where a short-term vegetative cover is needed.
- Soil Preparation - Loosen upper three inches of soil by raking, discing or other acceptable means before seeding, if not previously verified.
- Seeding - For the periods March 1 thru April 30 and August 1 thru October 15, seed with 25 bushel per acre of annual rye (3.2 lbs/1000 sq ft). For the period May 1 thru August 15, seed with 3 lbs per acre of weeping lovegrass (0.7 lbs/1000 sq ft). For the period November 16 thru February 28, protect site by applying 2 tons per acre of well anchored straw mulch and seed as soon as possible in the spring, or use sod.
- Mulching - Apply 1 1/2 to 2 tons per acre (70 to 90 lbs/1000 sq ft) of unrotted small grain straw immediately after seeding. Anchor mulch immediately after application using anchoring tool or 218 gal per acre (5 gal/1000 sq ft) of emulsified asphalt on flat areas. On slopes 8 feet or higher, use 348 gal per acre (8 gal/1000 sq ft) for anchoring.
- Refer to the 1981 MARYLAND STANDARDS AND SPECIFICATIONS FOR SOIL EROSION AND SEDIMENT CONTROL for site and methods not covered.

TEMPORARY SEEDING NOTES

- Apply to graded or cleared areas likely to be redistributed where a short-term vegetative cover is needed.
- Soil Preparation - Loosen upper three inches of soil by raking, discing or other acceptable means before seeding, if not previously verified.
- Seeding - For the periods March 1 thru April 30 and August 1 thru October 15, seed with 25 bushel per acre of annual rye (3.2 lbs/1000 sq ft). For the period May 1 thru August 15, seed with 3 lbs per acre of weeping lovegrass (0.7 lbs/1000 sq ft). For the period November 16 thru February 28, protect site by applying 2 tons per acre of well anchored straw mulch and seed as soon as possible in the spring, or use sod.
- Mulching - Apply 1 1/2 to 2 tons per acre (70 to 90 lbs/1000 sq ft) of unrotted small grain straw immediately after seeding. Anchor mulch immediately after application using anchoring tool or 218 gal per acre (5 gal/1000 sq ft) of emulsified asphalt on flat areas. On slopes 8 feet or higher, use 348 gal per acre (8 gal/1000 sq ft) for anchoring.
- Refer to the 1981 MARYLAND STANDARDS AND SPECIFICATIONS FOR SOIL EROSION AND SEDIMENT CONTROL for site and methods not covered.

CONSTRUCTION SEQUENCE:

No of Days	Task
1	Obtain Grading Permit
2	Repair as necessary existing trap (F 88 159)
3	Install Sediment and erosion control devices and stabilize
4	Excavate for foundations and rough grade and temporarily stabilize
5	Construct structures, sidewalks and driveways
6	Final grade and stabilize in accordance with stds and specs
7	Upon approval of Sediment Control Inspector remove existing trap, sediment and erosion controls and stabilize

CONSTRUCTION SEQUENCE:

No of Days	Task
1	Obtain Grading Permit
2	Repair as necessary existing trap (F 88 159)
3	Install Sediment and erosion control devices and stabilize
4	Excavate for foundations and rough grade and temporarily stabilize
5	Construct structures, sidewalks and driveways
6	Final grade and stabilize in accordance with stds and specs
7	Upon approval of Sediment Control Inspector remove existing trap, sediment and erosion controls and stabilize

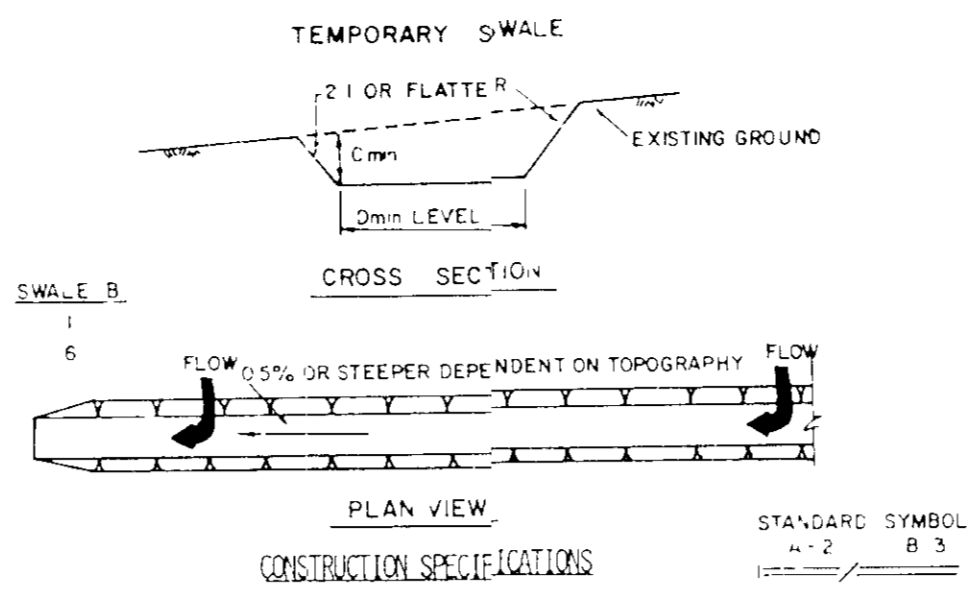

TEMPORARY SWALE
CONSTRUCTION SPECIFICATIONS

- ALL TEMPORARY SWALES SHALL HAVE UNINTERRUPTED POSITIVE GRADE TO AN OUTLET.
- DIVERTED RUNOFF FROM A DISTURBED AREA SHALL BE CONVEYED TO A SEDIMENT TRAPPING DEVICE.
- DIVERTED RUNOFF FROM AN UNDISTURBED AREA SHALL OUTLET DIRECTLY INTO AN UNDISTURBED STABILIZED AREA AT NON-EROSIVE VELOCITY.
- ALL TREES, BRUSH, STUMPS, OBSTRUCTIONS, AND OTHER OBJECT-DAMAGEABLE MATERIAL SHALL BE REMOVED AND DISPOSED OF SO AS NOT TO INTERFERE WITH THE PROPER FUNCTIONING OF THE SWALE.
- THE SWALE SHALL BE EXCAVATED OR SHAPED TO LINE, GRADE, AND CROSS SECTION AS REQUIRED TO MEET THE CONTENTS SPECIFIED HEREIN AND BE FREE OF BANK PROJECTIONS OR OTHER IRREGULARITIES WHICH WILL IMPAIR NORMAL FLOW.
- FILLS SHALL BE COMPACTED BY EARTH MOVING EQUIPMENT.
- ALL EARTH REMOVED AND NOT NEEDED ON CONSTRUCTION SHALL BE PLACED SO THAT IT WILL NOT INTERFERE WITH THE FUNCTIONING OF THE SWALE.
- STABILIZATION SHALL BE AS PER THE CHART BELOW.

DEPTH OF DISTURBANCE	CHANNEL WIDTH	DIKE A (5 AC OR LESS)	DIKE B (5 AC - 10 AC)
1	0-3' OR	SEED AND STRAW MULCH	SEED AND STRAW MULCH
2	3-5' OR	SEED AND STRAW MULCH	SEED USING JUTE OR EXCELSTOR
3	5-8' OR	SEED WITH JUTE OR EXCELSTOR, SOD	LINED RIP-RAP 4-8" RECYCLED CONCRETE EQUIVALENT
4	8-12' OR	LINED 4-8" RIP-RAP	ENGINEERED DESIGN

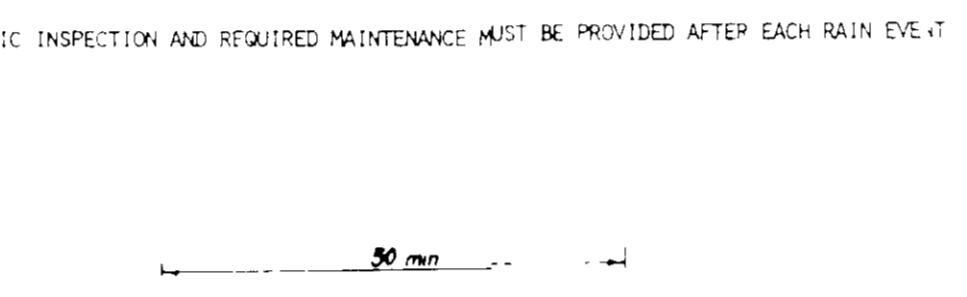

STABILIZED CONSTRUCTION ENTRANCE (SCE)
NO SCALE

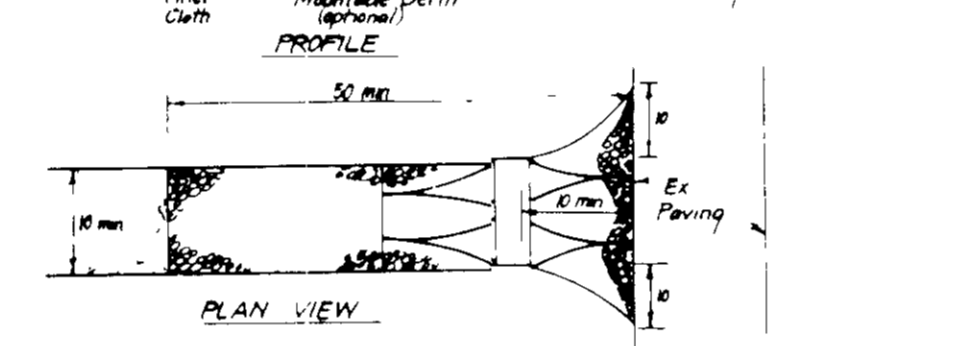

STONE OUTLET SEDIMENT TRAP (S.O.S.T.) STV.
NO SCALE

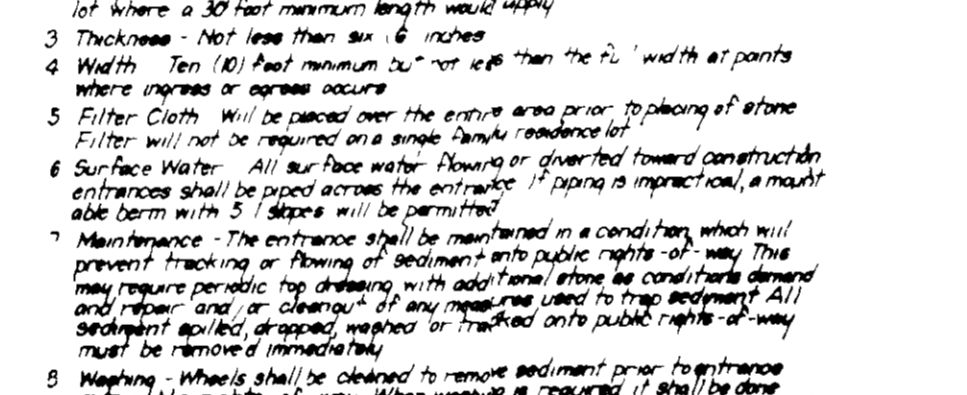

EARTH DIKE DETAIL (E.D.)
NO SCALE

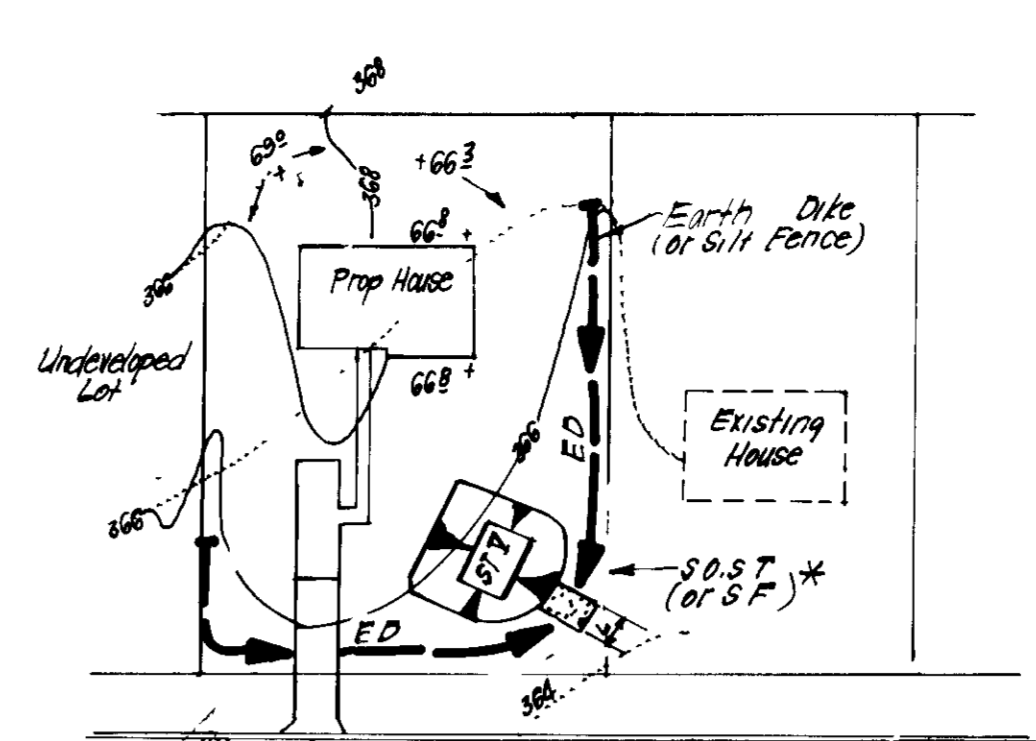

SINGLE LOT SEDIMENT CONTROL PLAN
NO SCALE

*NOTE: Single lot detail can not be utilized if any two lots sharing common property lines are to be disturbed at the same time or on any lots showing a sediment trap

NO. OF LOTS (S.V.)	PAVING	PAVING	PAVING
1	1/4 AC	1/4 AC	1/4 AC
2	1/2 AC	1/2 AC	1/2 AC
3	3/4 AC	3/4 AC	3/4 AC
4	1 AC	1 AC	1 AC
5	1 1/4 AC	1 1/4 AC	1 1/4 AC
6	1 1/2 AC	1 1/2 AC	1 1/2 AC
7	1 3/4 AC	1 3/4 AC	1 3/4 AC
8	2 AC	2 AC	2 AC
9	2 1/4 AC	2 1/4 AC	2 1/4 AC
10	2 1/2 AC	2 1/2 AC	2 1/2 AC
11	2 3/4 AC	2 3/4 AC	2 3/4 AC
12	3 AC	3 AC	3 AC
13	3 1/4 AC	3 1/4 AC	3 1/4 AC
14	3 1/2 AC	3 1/2 AC	3 1/2 AC
15	3 3/4 AC	3 3/4 AC	3 3/4 AC
16	4 AC	4 AC	4 AC
17	4 1/4 AC	4 1/4 AC	4 1/4 AC
18	4 1/2 AC	4 1/2 AC	4 1/2 AC
19	4 3/4 AC	4 3/4 AC	4 3/4 AC
20	5 AC	5 AC	5 AC



SEDIMENT TRAP
NO SCALE

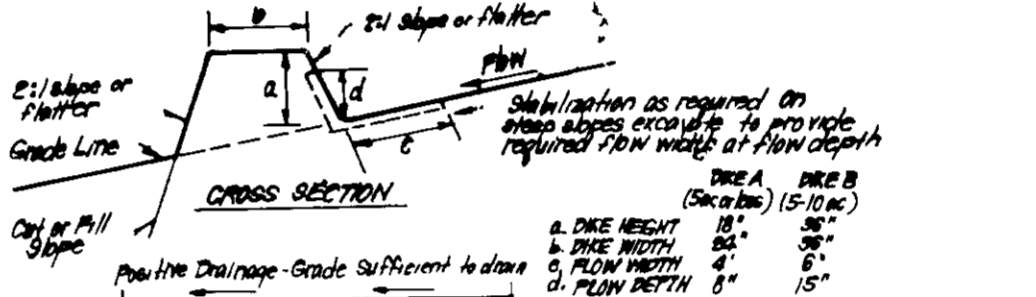

STONE OUTLET SEDIMENT TRAP (S.O.S.T.) STV.
NO SCALE

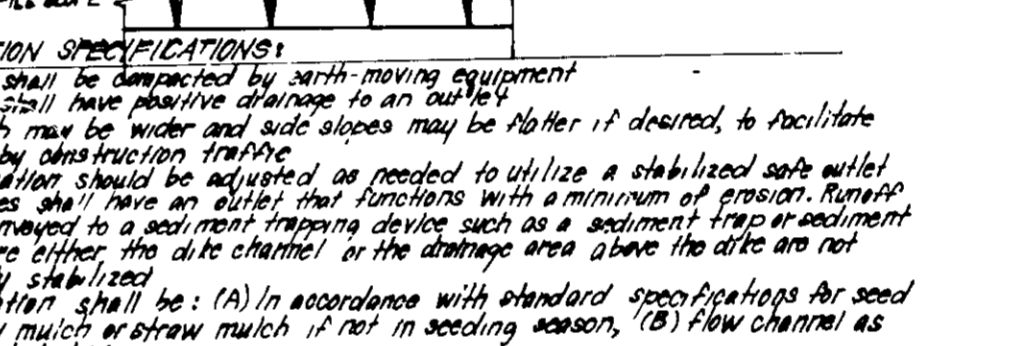

EARTH DIKE DETAIL (E.D.)
NO SCALE

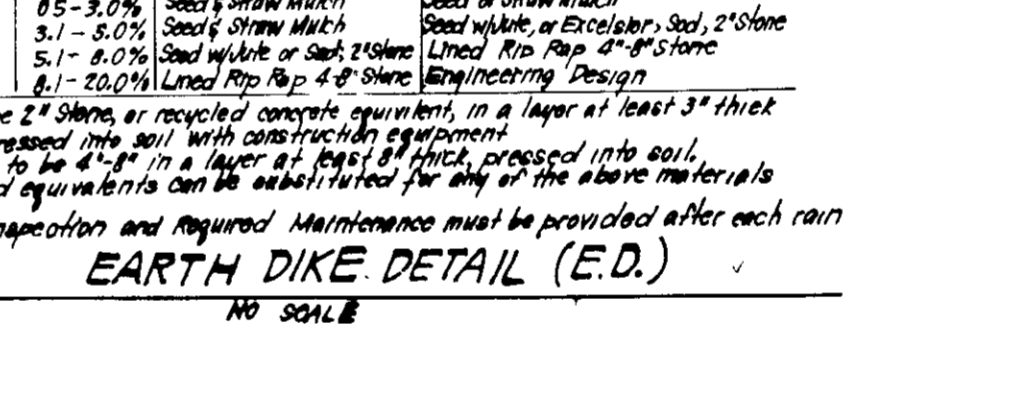

SEDIMENT TRAP
NO SCALE

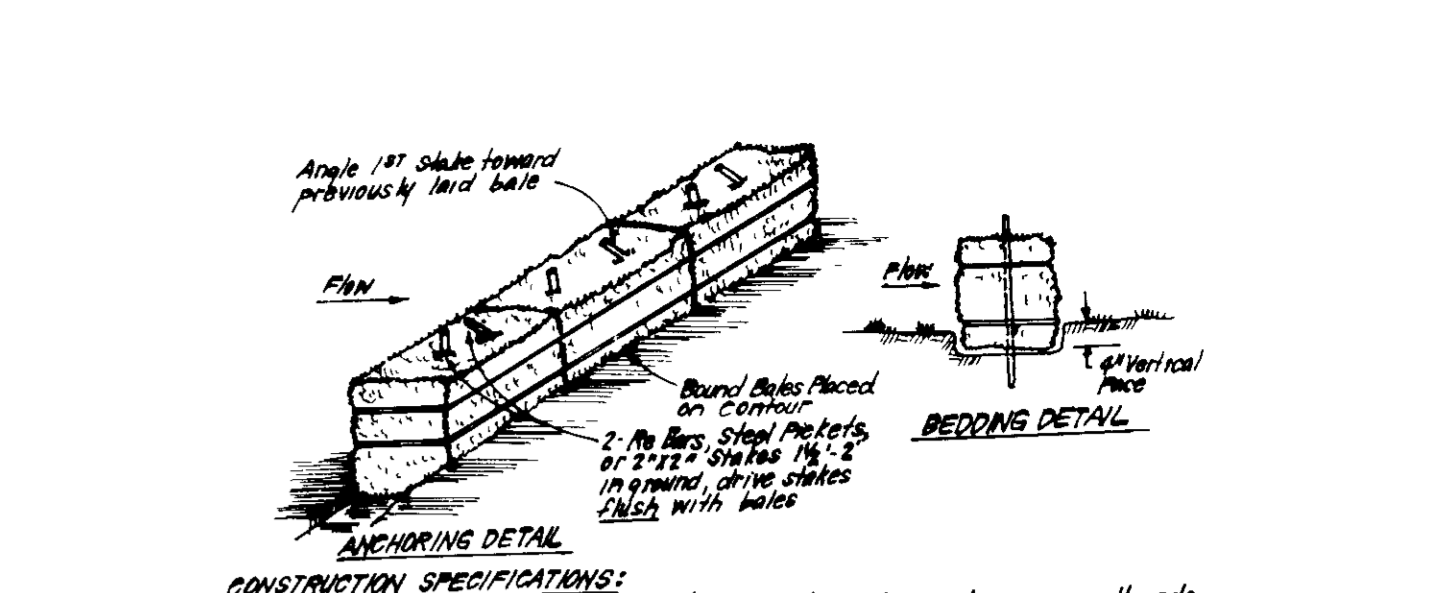

STRAIN BALE DIKE DETAIL (SBD)
NO SCALE

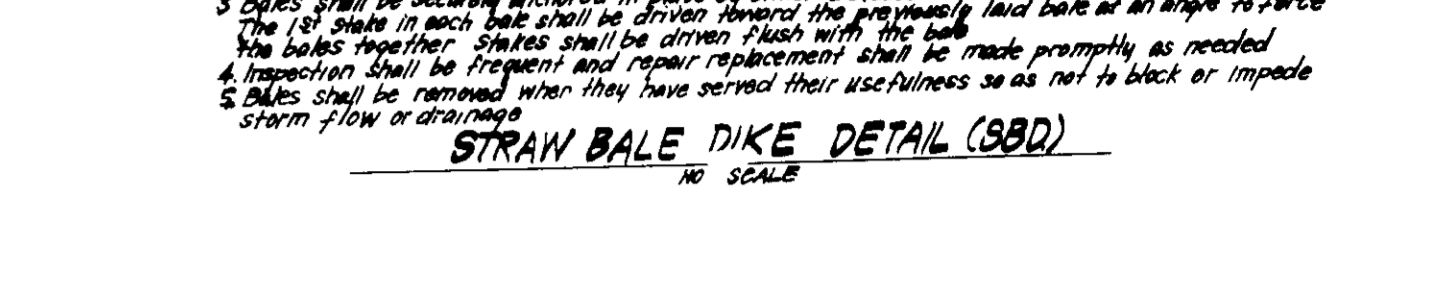

STONE OUTLET SEDIMENT TRAP (S.O.S.T.) STV.
NO SCALE

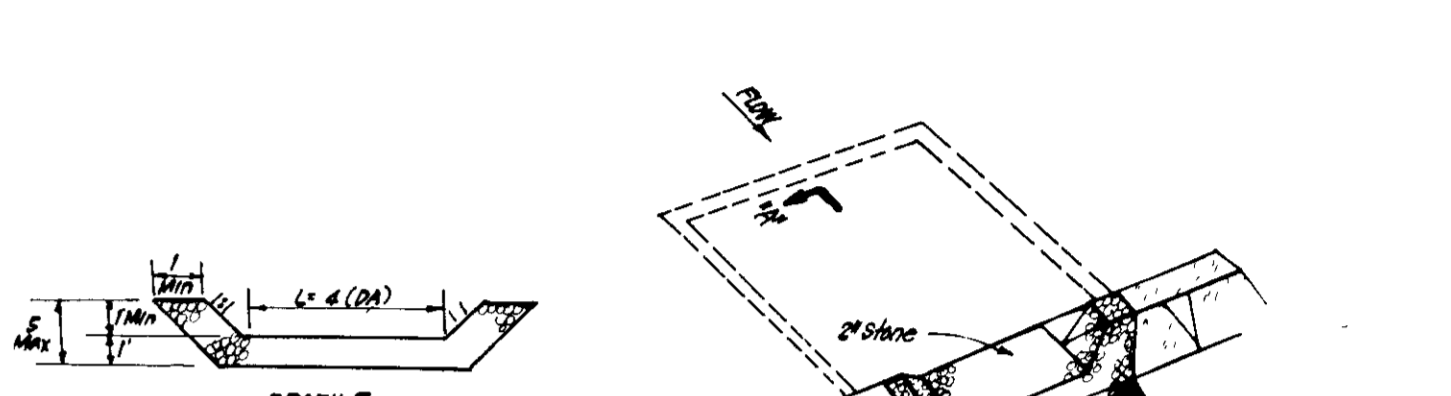

EARTH DIKE DETAIL (E.D.)
NO SCALE

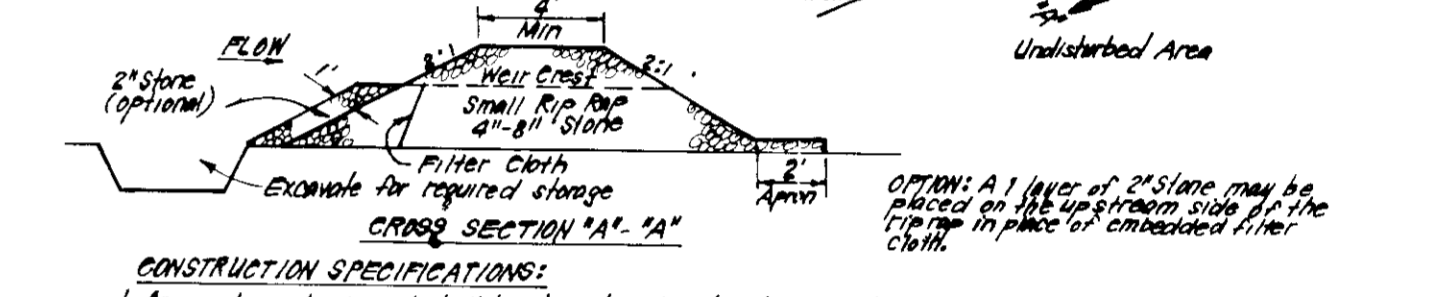

SEDIMENT TRAP
NO SCALE

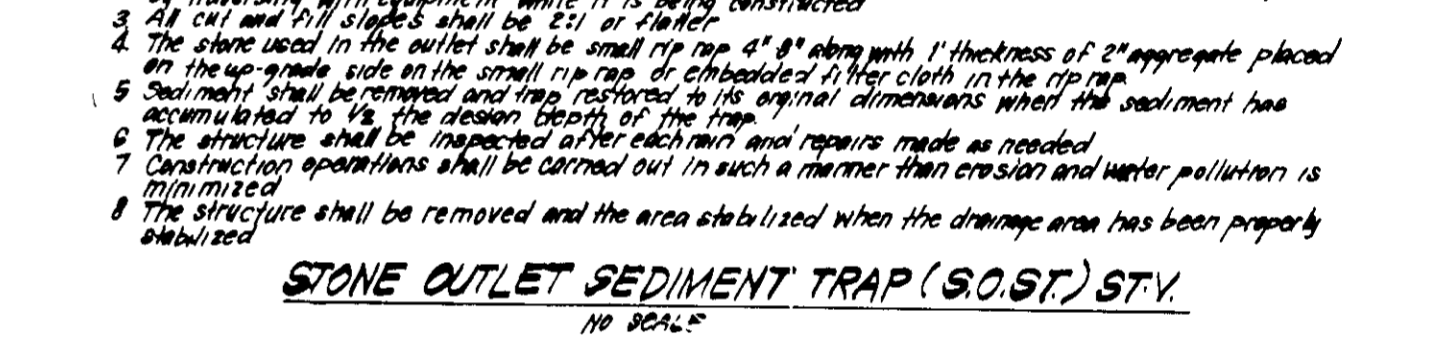

STONE OUTLET SEDIMENT TRAP (S.O.S.T.) STV.
NO SCALE



EARTH DIKE DETAIL (E.D.)
NO SCALE

APPROVED FOR PUBLIC WATER AND PUBLIC SEWERAGE SYSTEMS
HOWARD COUNTY HEALTH DEPARTMENT

APPROVED HOWARD COUNTY OFFICE OF PLANNING & ZONING

APPROVED FOR PUBLIC WATER AND PUBLIC SEWERAGE
STORM DRAINAGE SYSTEMS AND PUBLIC ROADS
HOWARD COUNTY DEPARTMENT OF PUBLIC WORKS

Viewed for **Howard S.C.D.**

U.S. Soil Conservation Service

DEVELOPER'S CERTIFICATE

ENGINEER'S CERTIFICATE

DESIGNED BY **KIW**

DRAWN BY **BAL**

CHECKED BY **KIW**

DATE **Oct. 1988**

CLARK • FINEFROCK & SACKETT, INC.

ENGINEERS • PLANNERS • SURVEYORS

7135 MINSTREL WAY • COLUMBIA MD 21045 • (301) 381-7500 - BALTO • (301) 621-8100 - WASH

DESIGNED **KIW**

DRAWN **BAL**

CHECKED **KIW**

DATE **Oct. 1988**

SEDIMENT & EROSION CONTROL PLAN

LOTS 103-110

GARTERS COVE SECTION 2

6TH ELECTION DISTRICT HOWARD COUNTY, MARYLAND

For Crystal Hill Inv. Inc
10005 Old Columbia Road
Columbia Md 21046