

G-1	2502 RONNAN CASTLE COURT
G-2	2505
G-3	2507
G-4	2509
G-5	2511
G-6	2513
G-7	2515
G-8	2517 RONNAN CASTLE COURT
G-9	2414 CHIPPENHAM DRIVE
G-10	2412
G-11	2410
G-12	2408
G-13	2406
G-14	2404
G-15	2402
G-16	2400
G-17	2401
G-18	2403
G-19	2405
G-20	2407
G-21	2409
G-22	2411
G-23	2413
G-24	2415 CHIPPENHAM DRIVE

8-31-88

HOWARD COUNTY APPROVAL

APPROVED FOR PUBLIC WATER AND PUBLIC SEWERAGE SYS EM,
HOWARD COUNTY HEALTH DEPARTMENT

[Signature] 3-24-89 DATE

APPROVED HOWARD COUNTY OFFICE OF PLANNING AND ZONING

[Signature] 4-6-89 DATE

PLANNING DIRECTOR

[Signature] 4-4-89 DATE

CHIEF, DIVISION OF COMMUNITY PLANNING AND LAND DEVELOPMENT

APPROVED FOR PUBLIC WATER, PUBLIC SEWERAGE, PUBLIC STORM DRAINAGE SYSTEMS AND PUBLIC ROADS

HOWARD COUNTY DEPARTMENT OF PUBLIC WORKS

[Signature] 3/2/89 DATE

DIRECTOR

[Signature] 3-21-89 DATE

CHIEF, BUREAU OF ENGINEERING

BOWLING BROOK FARMS

SECTION 4 AREA 1

PARCEL G

LOTS G-1 THRU G-103

A RESUBDIVISION OF LOT 216 BOWLING BROOK FARMS

PARCEL E-515 BOWLING BROOK FARMS

TAX MAP 47 PARCEL 141

F 632

L 1394

SITE DEVELOPMENT PLAN

OTHER: CHINA

DES: S 41

MJK 1"=20'

DRWN: H 11

CADD: J DW 11 23 24

DATE: 2 89

FILE: 2184-1-7

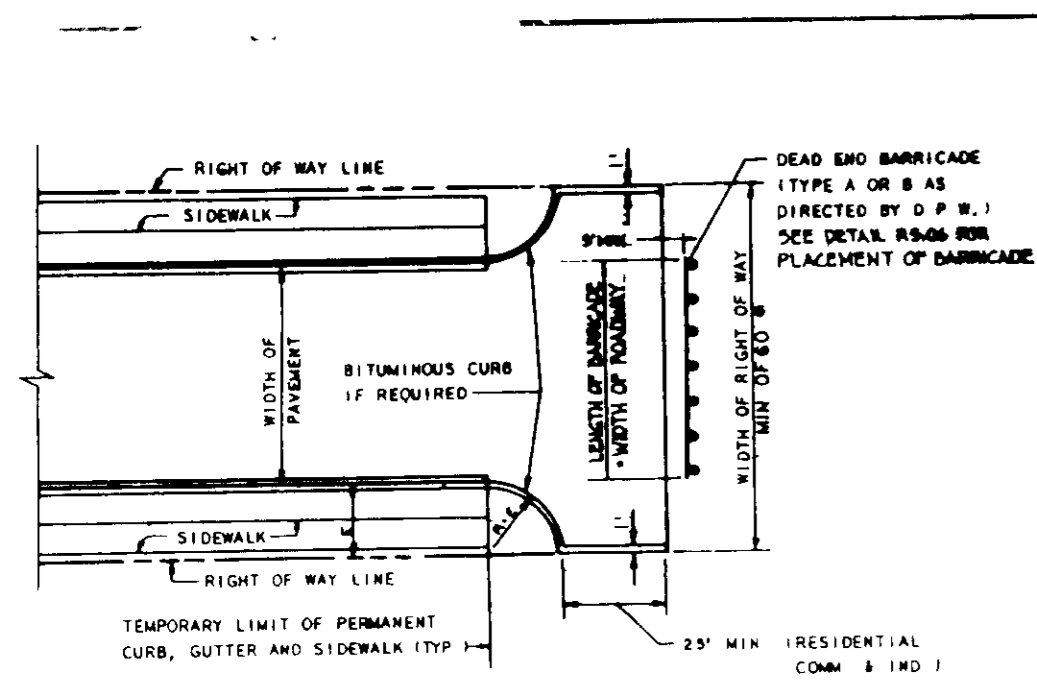

- NOTES**
1. A TEE TURN-AROUND SHALL BE USED IN LIEU OF A CUL-DE-SAC ONLY IF THE STREET IS TO BE EXTENDED IN THE FUTURE.
 2. BITUMINOUS CURB SHALL EXTEND AROUND THE TEE TURN-AROUND IF AND AS REQUIRED TO CONTROL CURB DRAINAGE FROM THE ROADWAY SECTION.
 3. REFER TO STANDARD # 504 FOR TYPICAL ROADWAY PROFILE OF TEMPORARY LIMIT OF PAVING.
 4. FOR LOCAL ROADS, PROVIDE'S REVERSIBLE EASEMENT EACH END OF THE TEE.
 5. PROVIDE EASEMENTS AS REQUIRED FOR PLACEMENT OF BARRICADE AND ANY NECESSARY GRADING (SEE DETAIL AD 06.)

HOWARD COUNTY, MARYLAND
DEPARTMENT OF PUBLIC WORKS
Approved: *[Signature]*
Chief, Bureau of Engineering

TEMPORARY TEE TURN-AROUND
NO SCALE
REV. JAN 1988

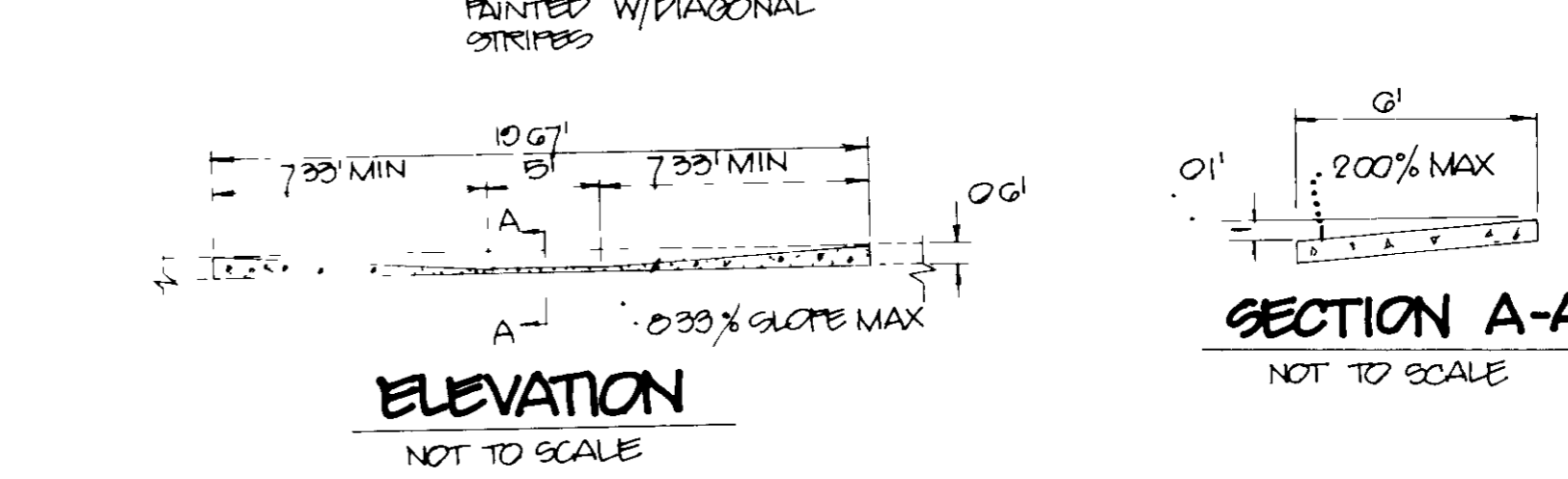
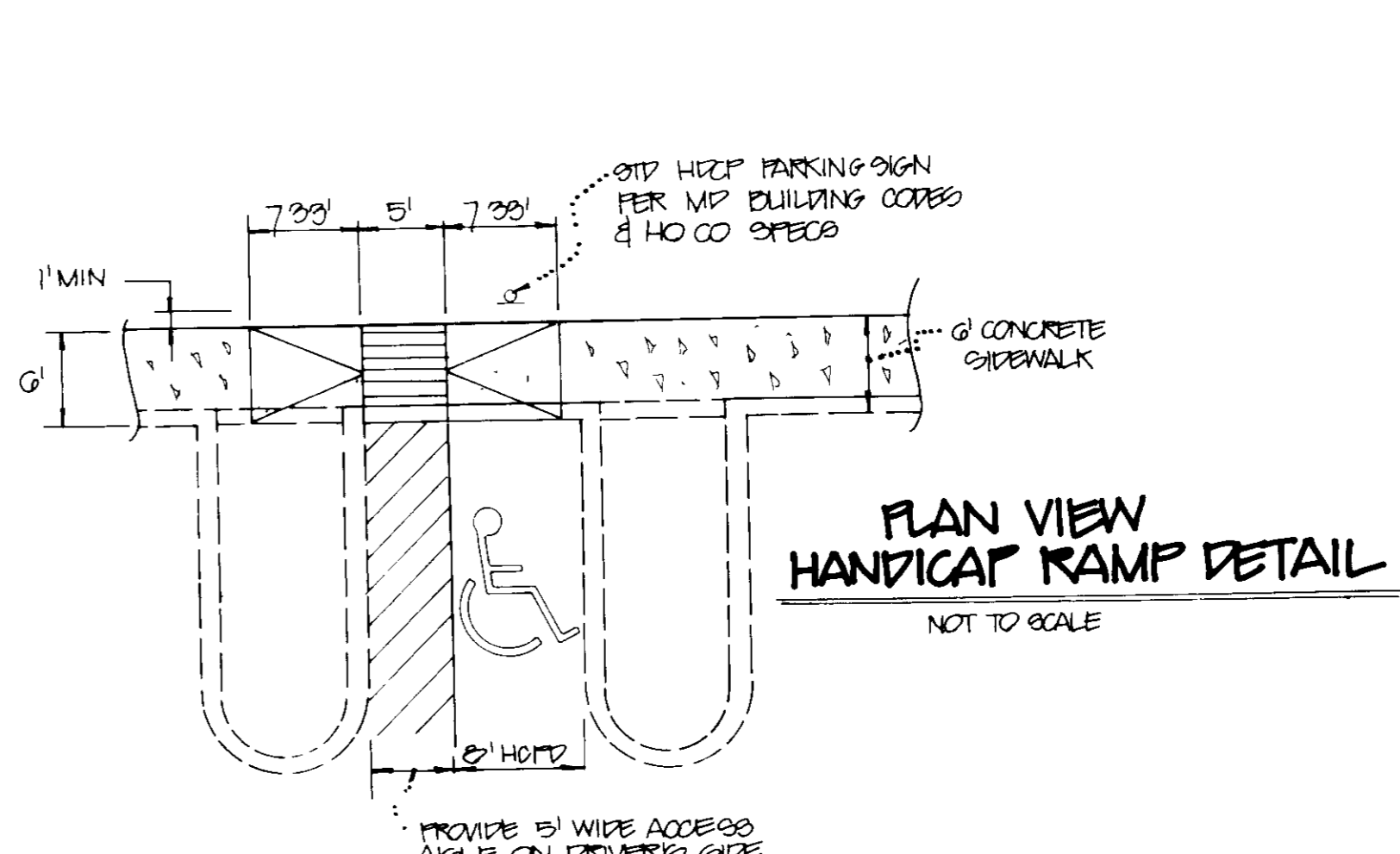
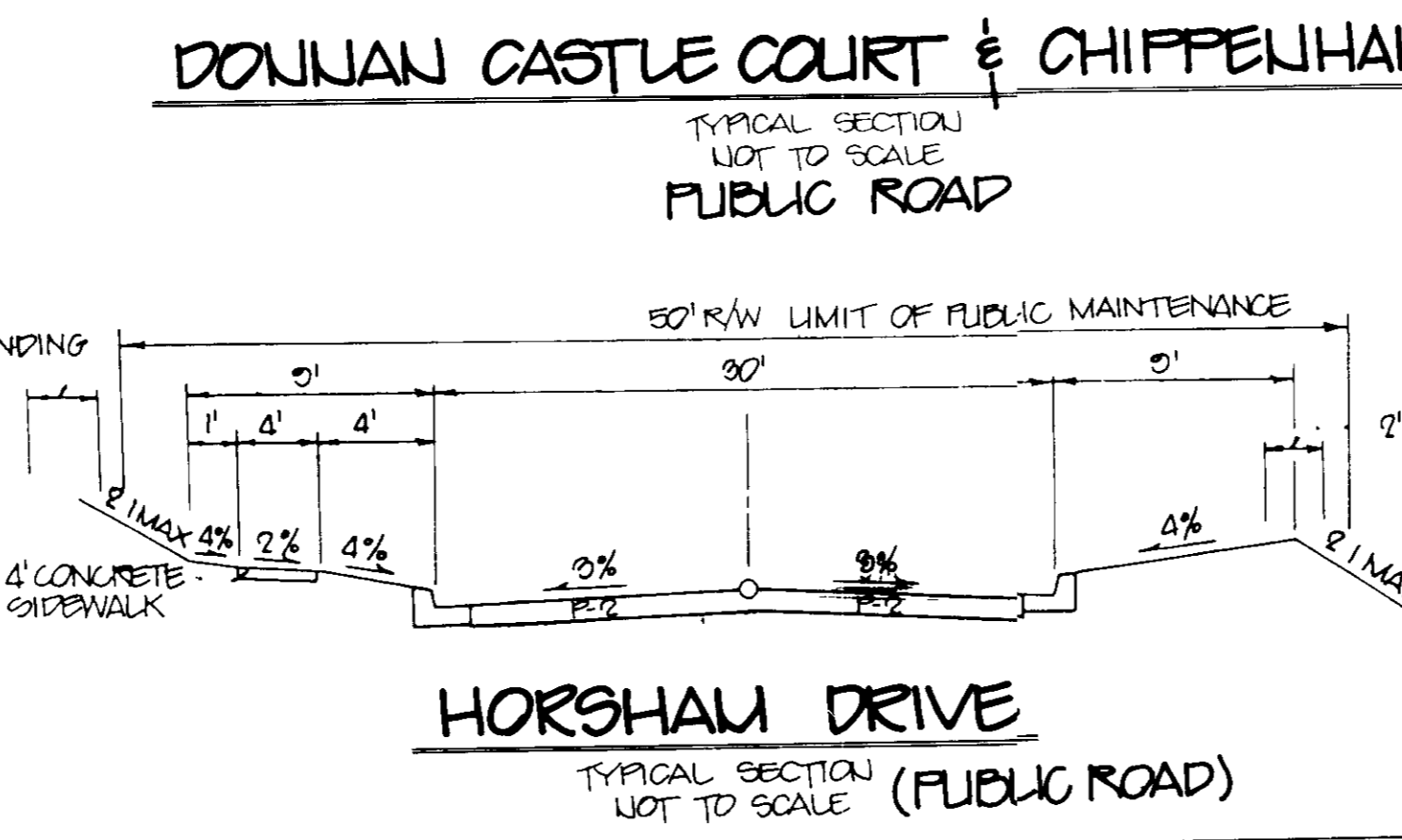
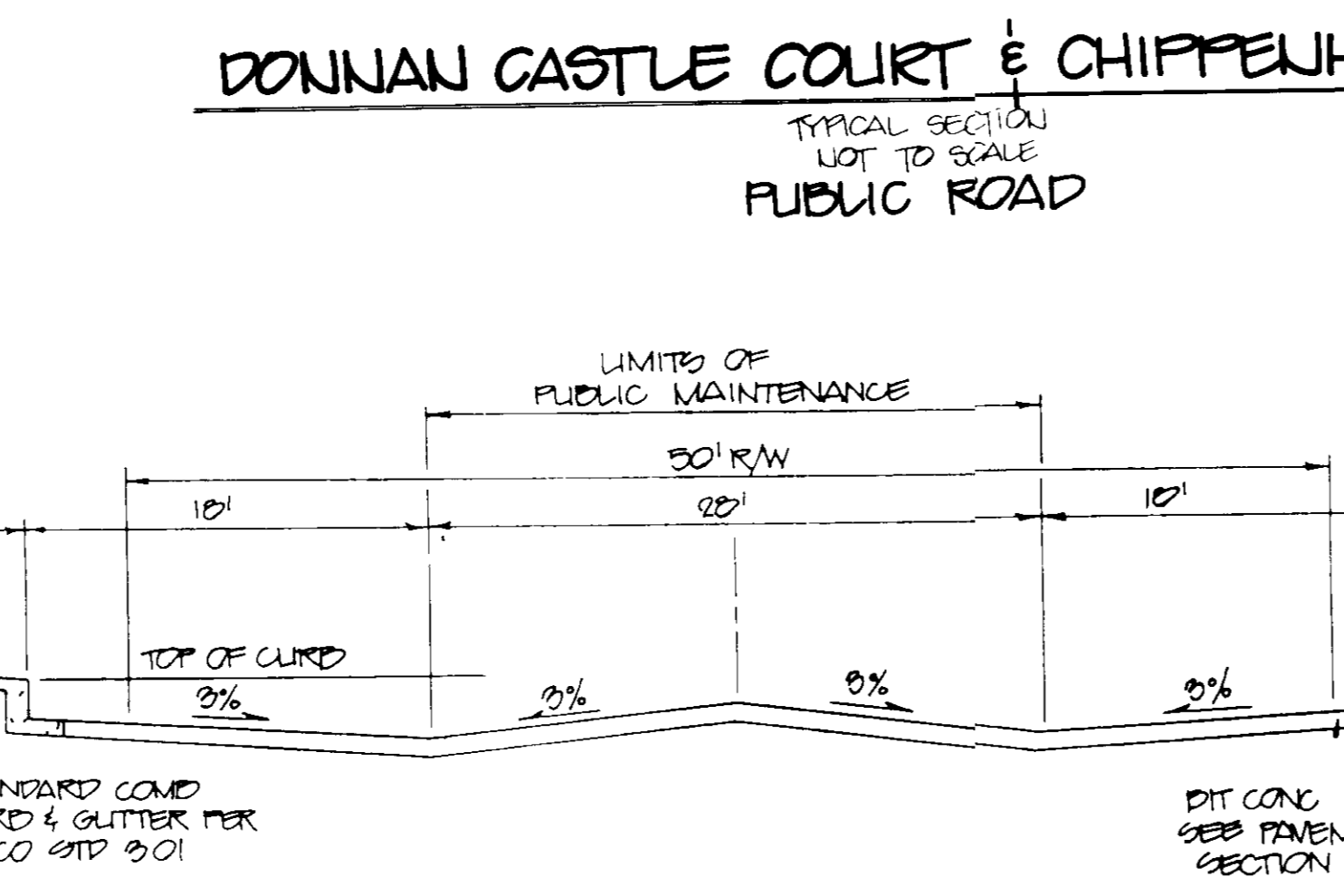
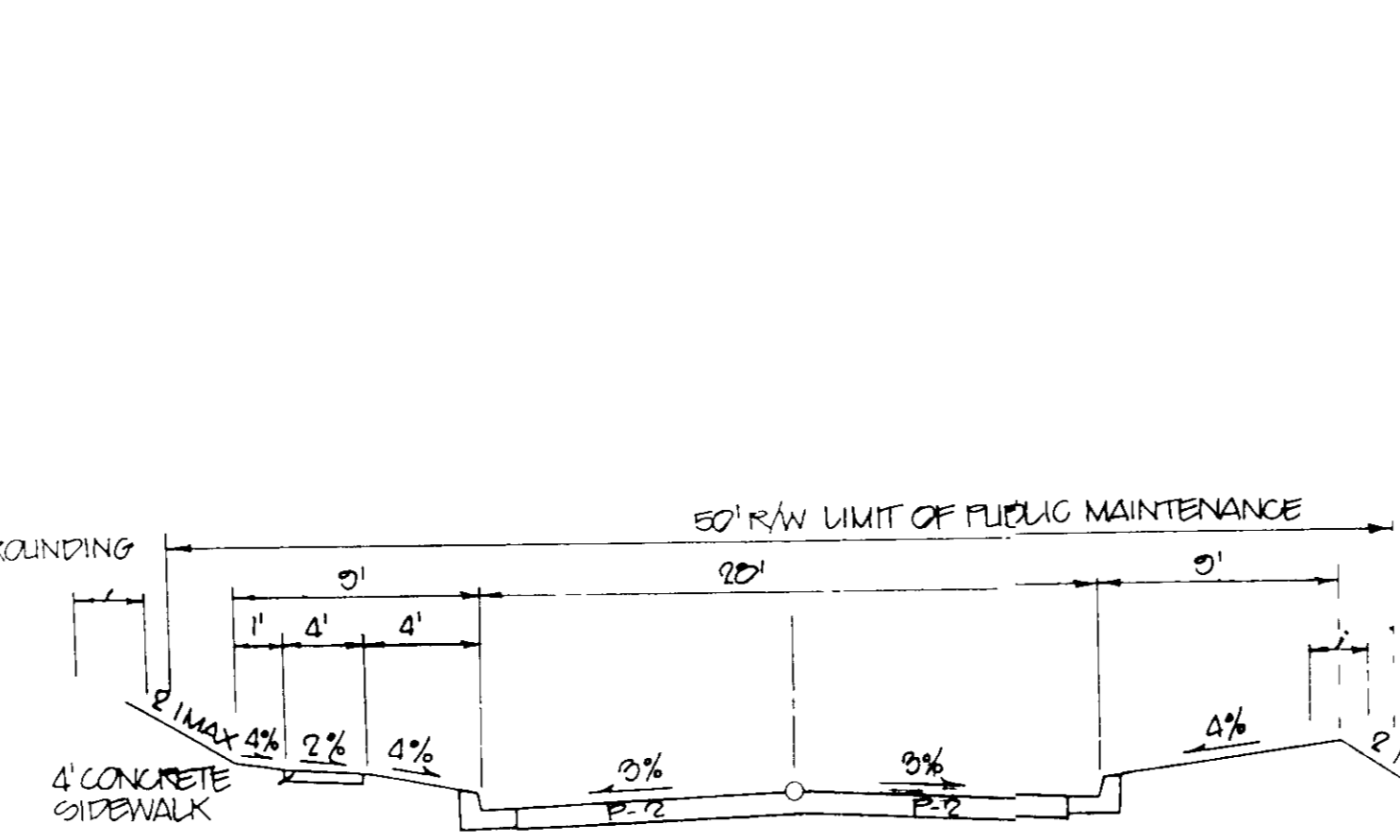
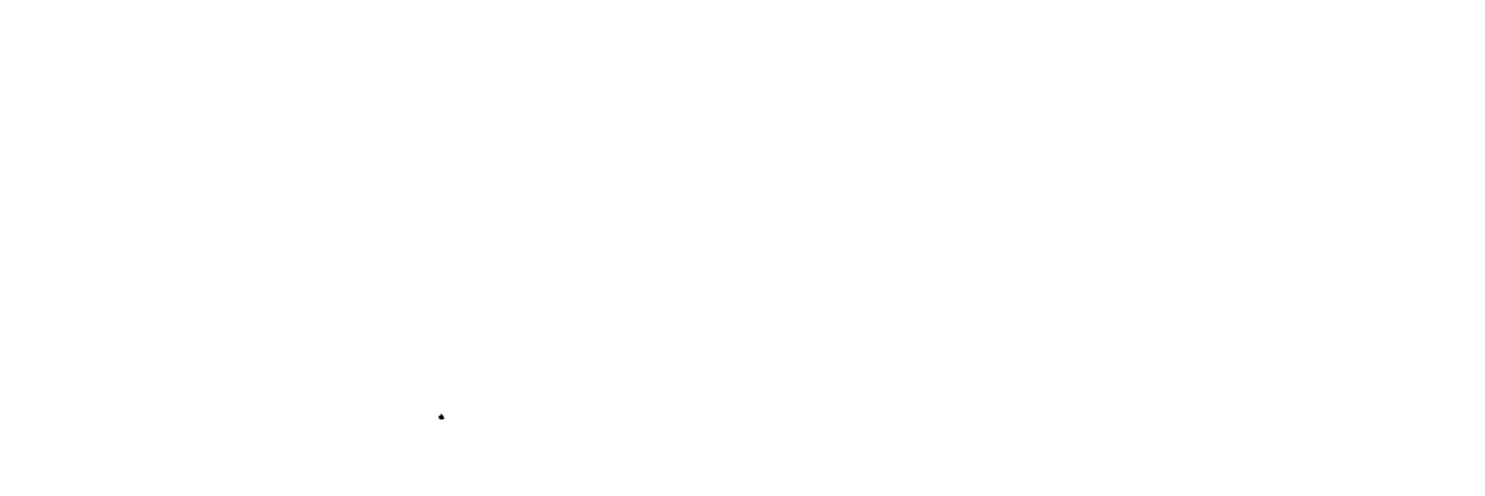
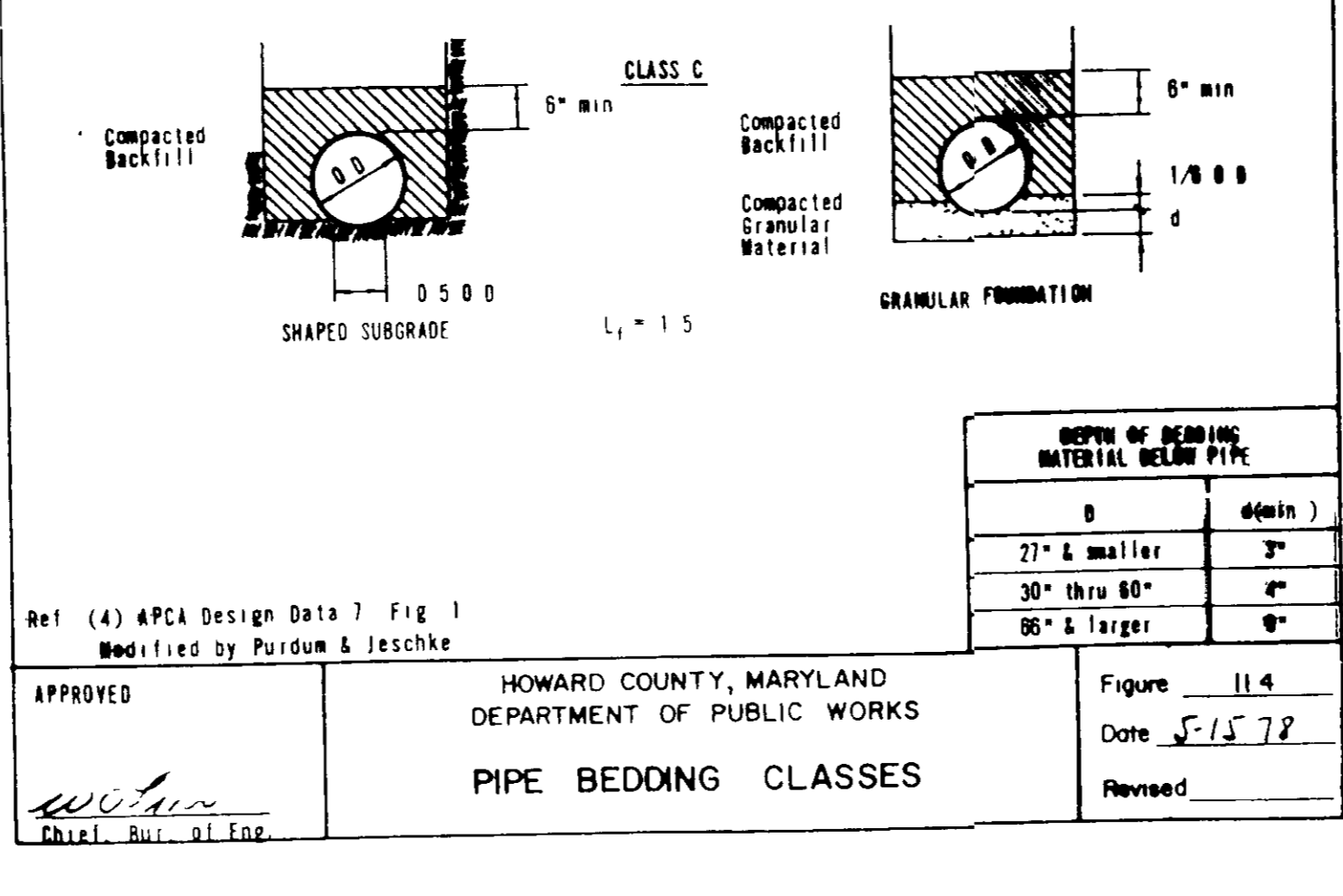
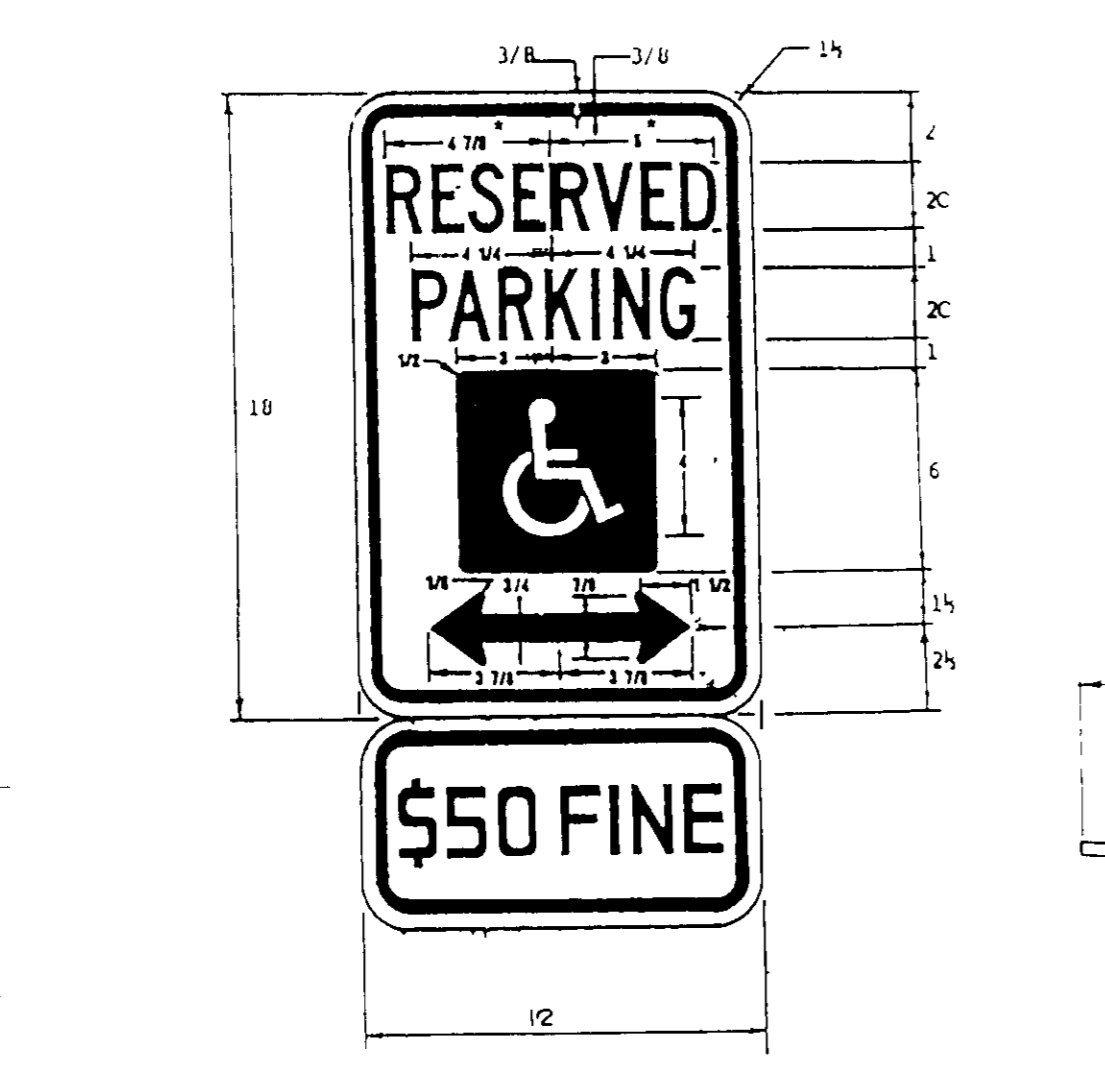
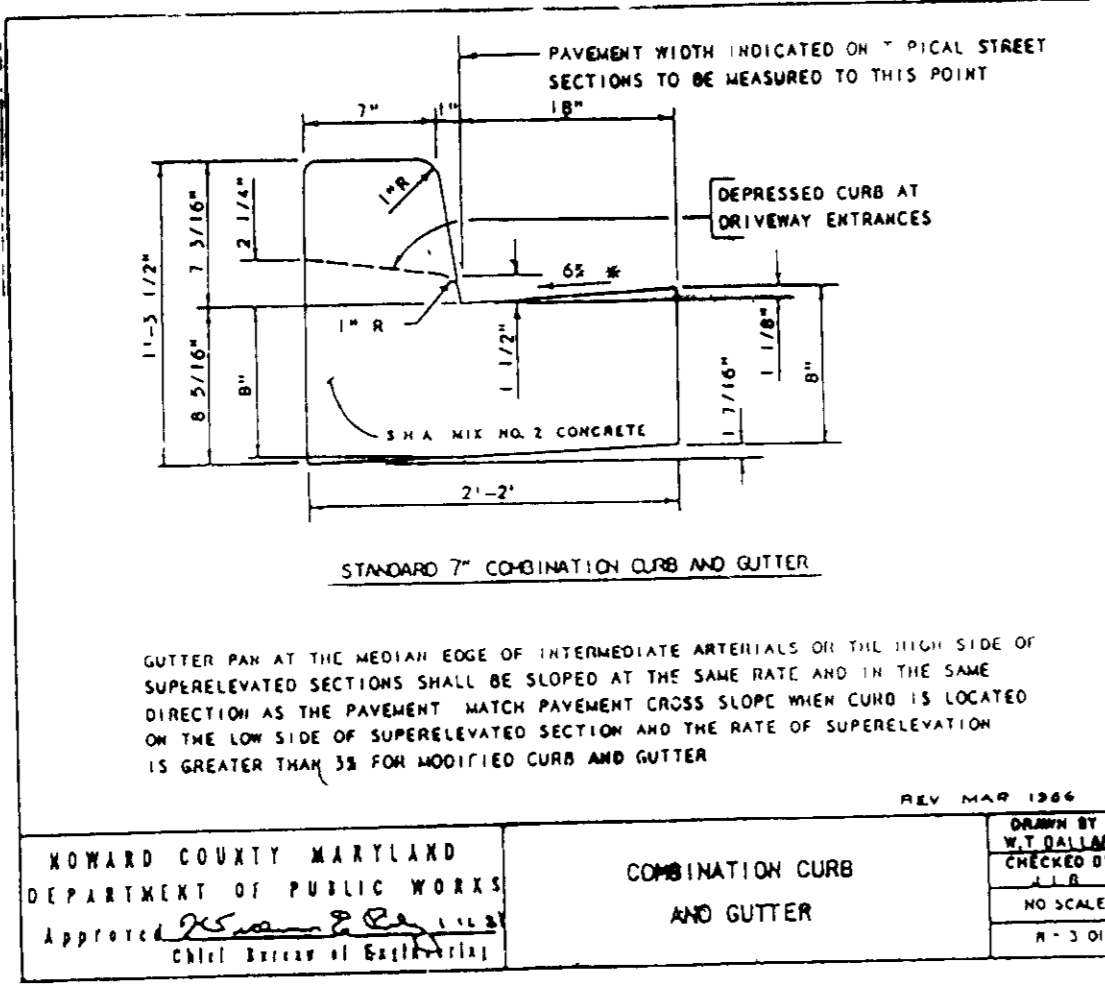
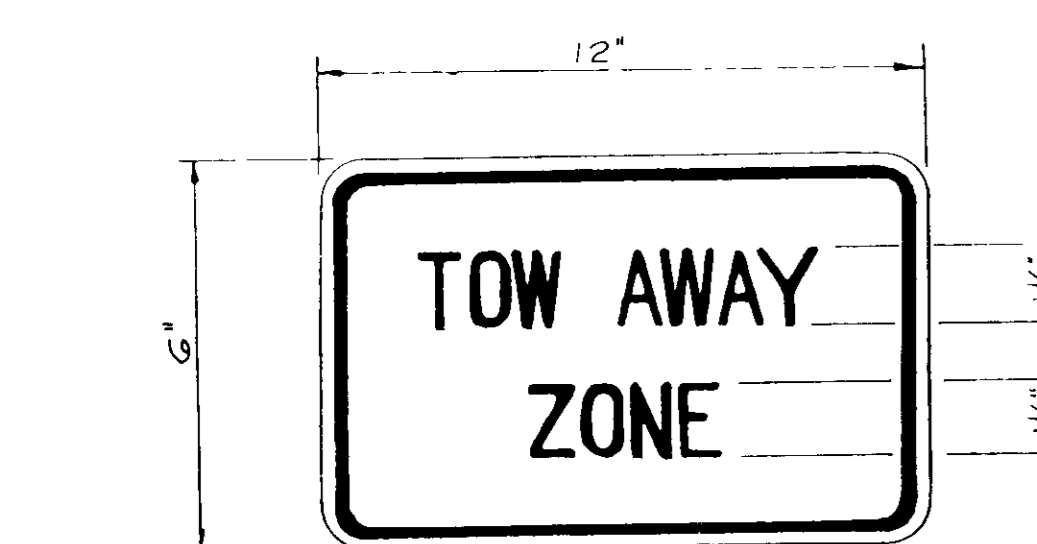
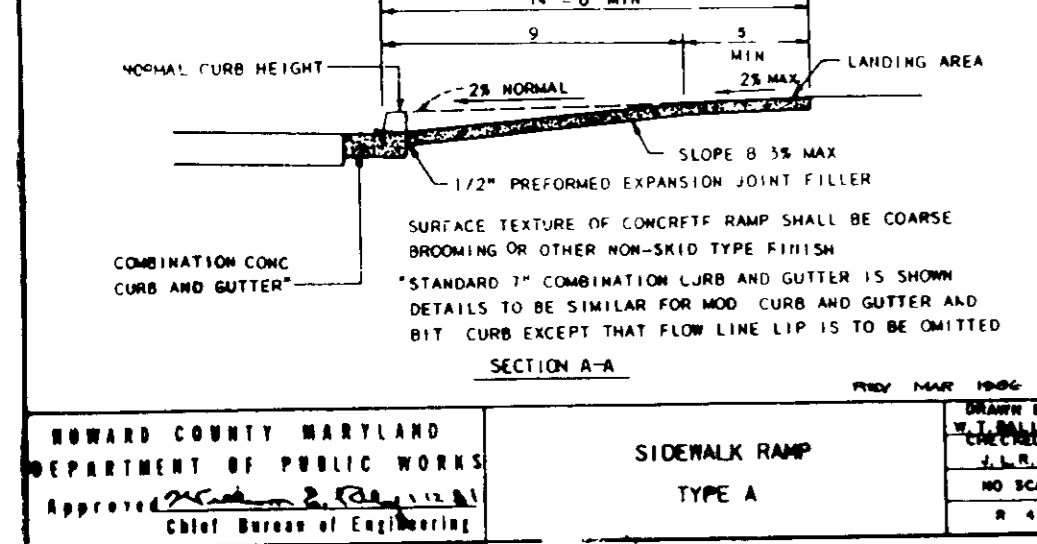
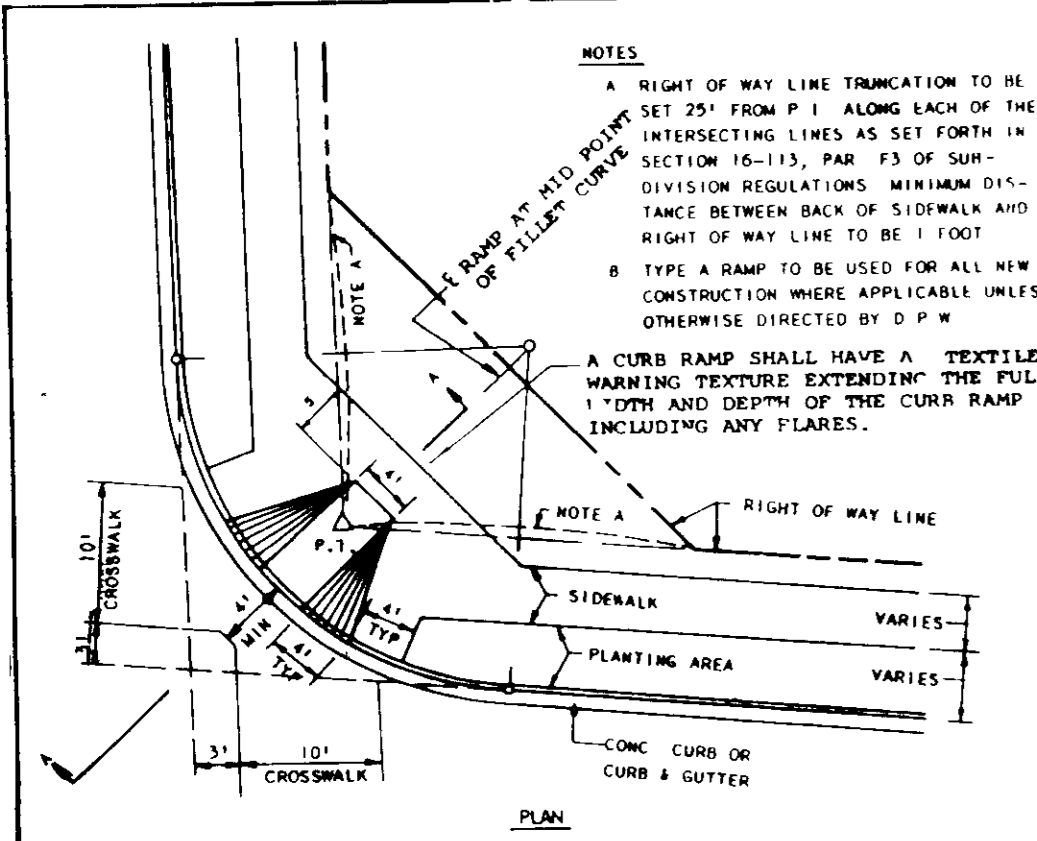

8-31-88
LKS

APPROVED FOR PUBLIC WATER AND PUBLIC SEWERAGE SYSTEM,
HOWARD COUNTY HEALTH DEPARTMENT

[Signature] 5-24-89
COUNTY HEALTH OFFICER DATE

APPROVED HOWARD COUNTY OFFICE OF PLANNING AND ZONING

[Signature] 4-6-89
PLANNING DIRECTOR DATE

[Signature] 4-4-89
CHIEF, DIVISION OF COMMUNITY PLANNING AND LAND DEVELOPMENT DATE

APPROVED FOR PUBLIC WATER, PUBLIC SEWERAGE, PUBLIC STORM DRAINAGE SYSTEMS AND PUBLIC ROADS

[Signature] 3-21-89
DIRECTOR DATE

[Signature] 3-21-89
CHIEF, BUREAU OF ENGINEERING DATE

HOWARD COUNTY DEPARTMENT OF PUBLIC WORKS

OWNER/DEVELOPER
GORMAN ROAD LIMITED PARTNERSHIP
C/O JAMES P. KNOTT DEVELOPMENT CORPORATION
110 WEST ROAD, SUITE 203
TOWSON, MARYLAND 21204

PHRA
Professional Firm
1100 West Road, Suite 203
Towson, Maryland 21286
Tel: 410-288-2220

DATE: 7-20-88
REVISION: 10-6-88
ISSUED TO: HOWARD COUNTY
ISSUED BY: MJK
CHECKED BY: J.P.W.
DATE: 7-20-88

PROJECT: BOWLING BROOK FARMS SECTION 4, AREA 1
PARCEL G LOTS G-1 THRU G-103
A RESUBDIVISION OF LOT 216 BOWLING BROOK FARMS
SIXTH ELECTION DISTRICT L-1394 P-632
TAX MAP 47 PARCEL 141

SHEET 4 OF 9
FILE: 204-1-7

SDP-89-19

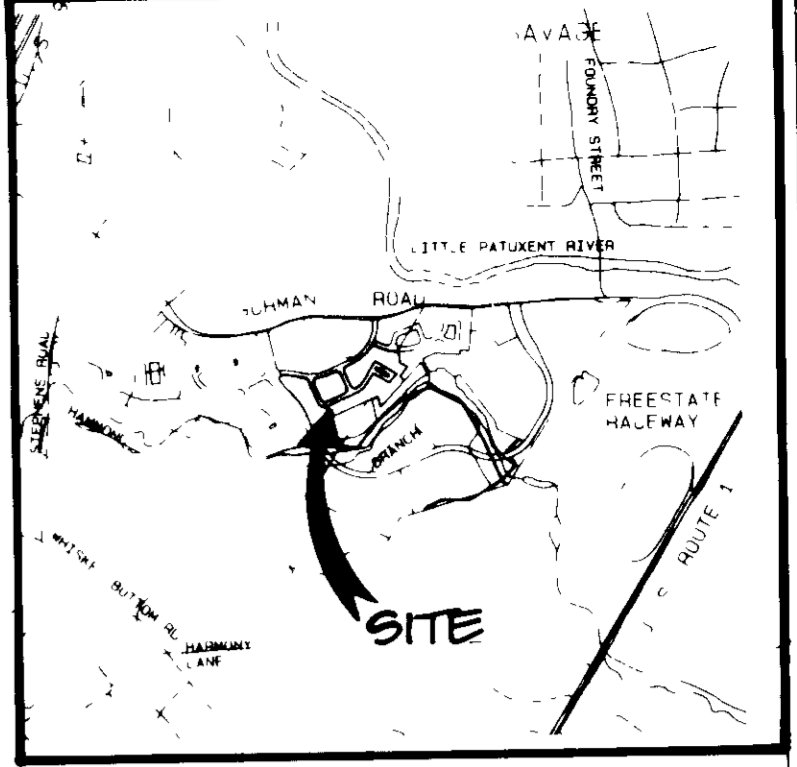
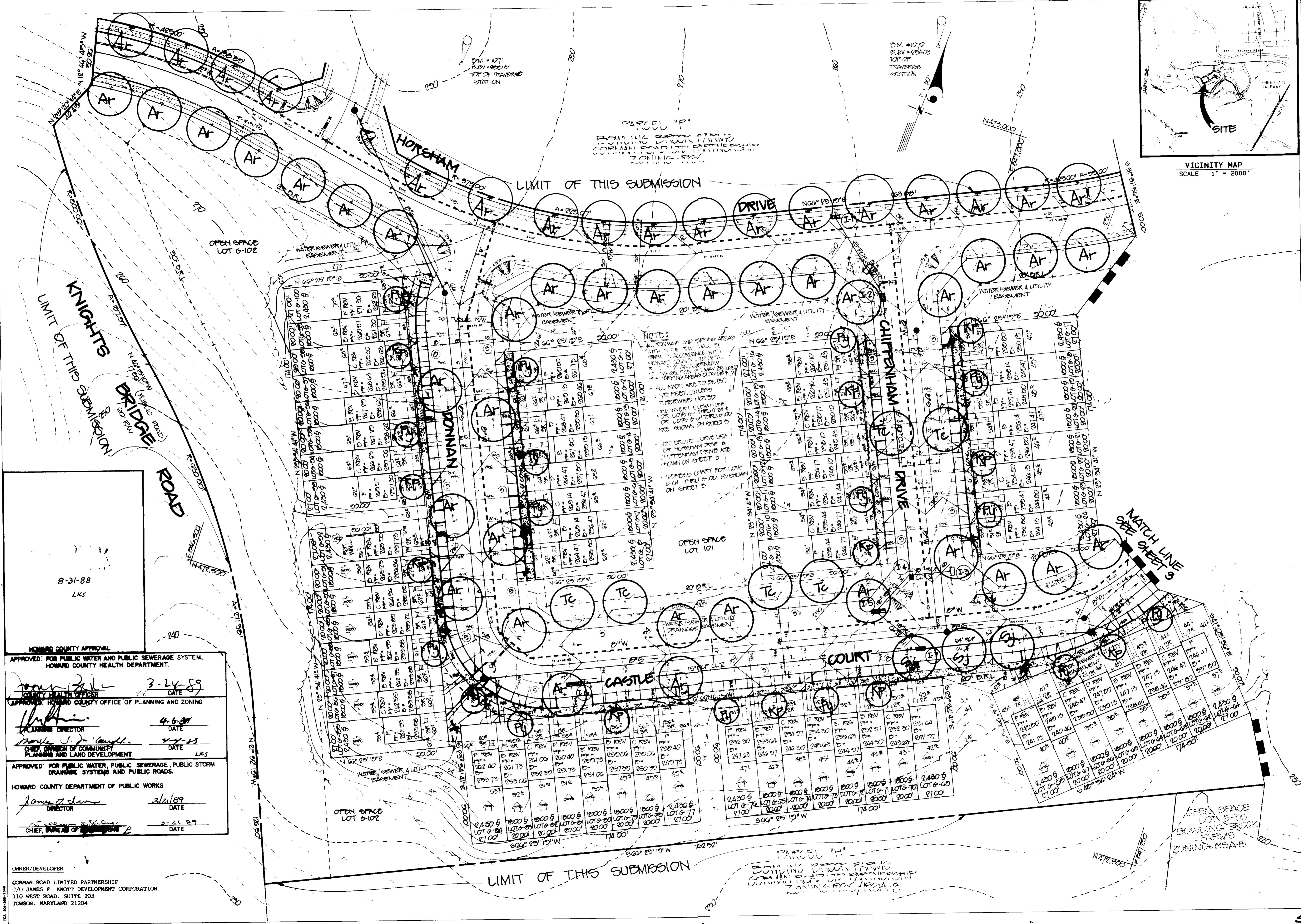

PHRA
 Office: 110 West Road, Suite 203, Towson, MD 21286
 Phone: 410-281-2220
 Fax: 410-281-2221

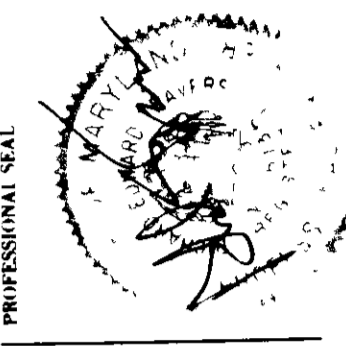

DATE: 7-20-89
 ISSUED TO: HOWARD CO
 REVISIONS: 1. 7-20-89 ORIGINALS RETURNED TO HOWARD CO
 2. 7-20-89 ORIGINALS RETURNED TO HOWARD CO
 3. 7-20-89 ORIGINALS RETURNED TO HOWARD CO

BOWLING BROOK FARMS
 SECTION 4 AREA 1
 PARCEL G
 LOTS G-1 THRU G-103
 A RESUBDIVISION OF LOT 218 BOWLING BROOK FARMS
 STATE ELECTION DISTRICT C-1394
 TAX MAP 47 PARCEL 141 F.632

PROJECT: SURVEY CHECKED
 OTHERS: DESIGN SCALE: 1" = 30'
 MJK DRAWN DATE
 CAP/DJ/DW SHEET 5 OF 9
 FILE: 2184-1-7

8-31-88 LKS

HOWARD COUNTY APPROVAL
 APPROVED FOR PUBLIC WATER AND PUBLIC SEWERAGE SYSTEM,
 HOWARD COUNTY HEALTH DEPARTMENT.
 [Signature] 3-24-89 DATE
 COUNTY HEALTH OFFICER

APPROVED: HOWARD COUNTY OFFICE OF PLANNING AND ZONING
 [Signature] 4-6-89 DATE
 PLANNING DIRECTOR

APPROVED FOR PUBLIC WATER, PUBLIC SEWERAGE, PUBLIC STORM
 DRAINAGE SYSTEMS AND PUBLIC ROADS.
 [Signature] 4-2-89 DATE
 CHIEF, DIVISION OF COMMUNITY
 PLANNING AND LAND DEVELOPMENT

HOWARD COUNTY DEPARTMENT OF PUBLIC WORKS
 [Signature] 3/21/89 DATE
 DIRECTOR

[Signature] 3-21-89 DATE
 CHIEF, BUREAU OF ENGINEERING

OWNER/DEVELOPER
 CORMAN ROAD LIMITED PARTNERSHIP
 C/O JAMES F. KNOTT DEVELOPMENT CORPORATION
 110 WEST ROAD, SUITE 203
 TOWSON, MARYLAND 21284

8-31-88
LKS

HOWARD COUNTY APPROVAL
APPROVED FOR PUBLIC WATER AND PUBLIC SEWERAGE SYSTEM,
HOWARD COUNTY HEALTH DEPARTMENT

[Signature] 5-24-89
COUNTY HEALTH OFFICER DATE

APPROVED HOWARD COUNTY OFFICE OF PLANNING AND ZONING

[Signature] 4-4-89
PLANNING DIRECTOR DATE

[Signature] 7-4-89
CHIEF, DIVISION OF COMMUNITY PLANNING AND LAND DEVELOPMENT DATE

APPROVED FOR PUBLIC WATER, PUBLIC SEWERAGE, PUBLIC STORM DRAINAGE SYSTEMS AND PUBLIC ROADS

HOWARD COUNTY DEPARTMENT OF PUBLIC WORKS

[Signature] 3/21/89
DIRECTOR DATE

[Signature] 8/21/89
CHIEF, BUREAU OF ENGINEERING DATE

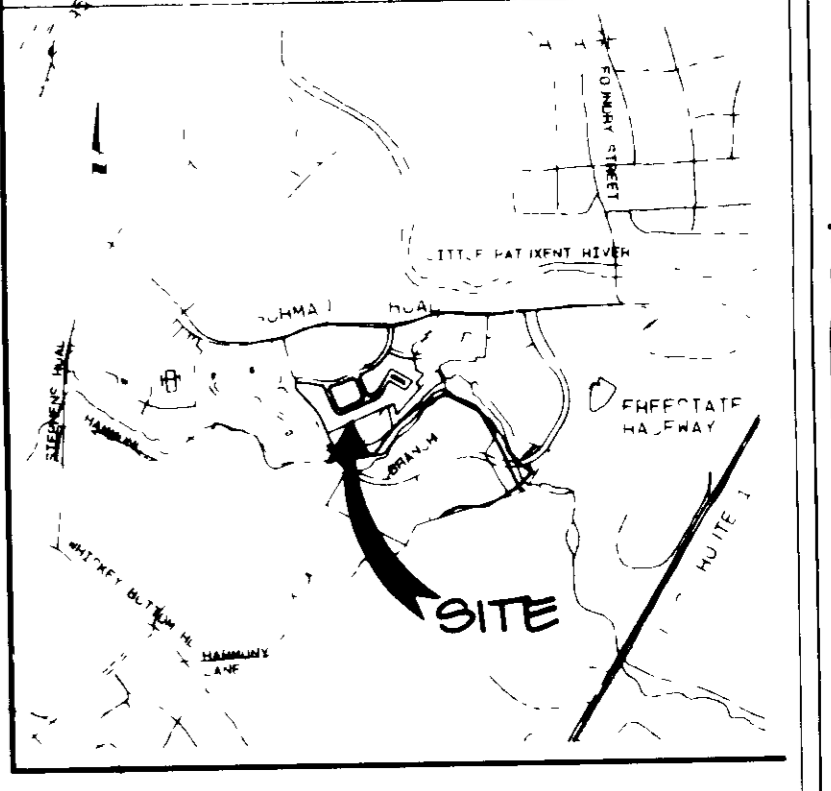

PH&A
Professional Services, Inc.
110 West Road, Suite 203
Towson, Maryland 21284
Tel: 410-281-1220

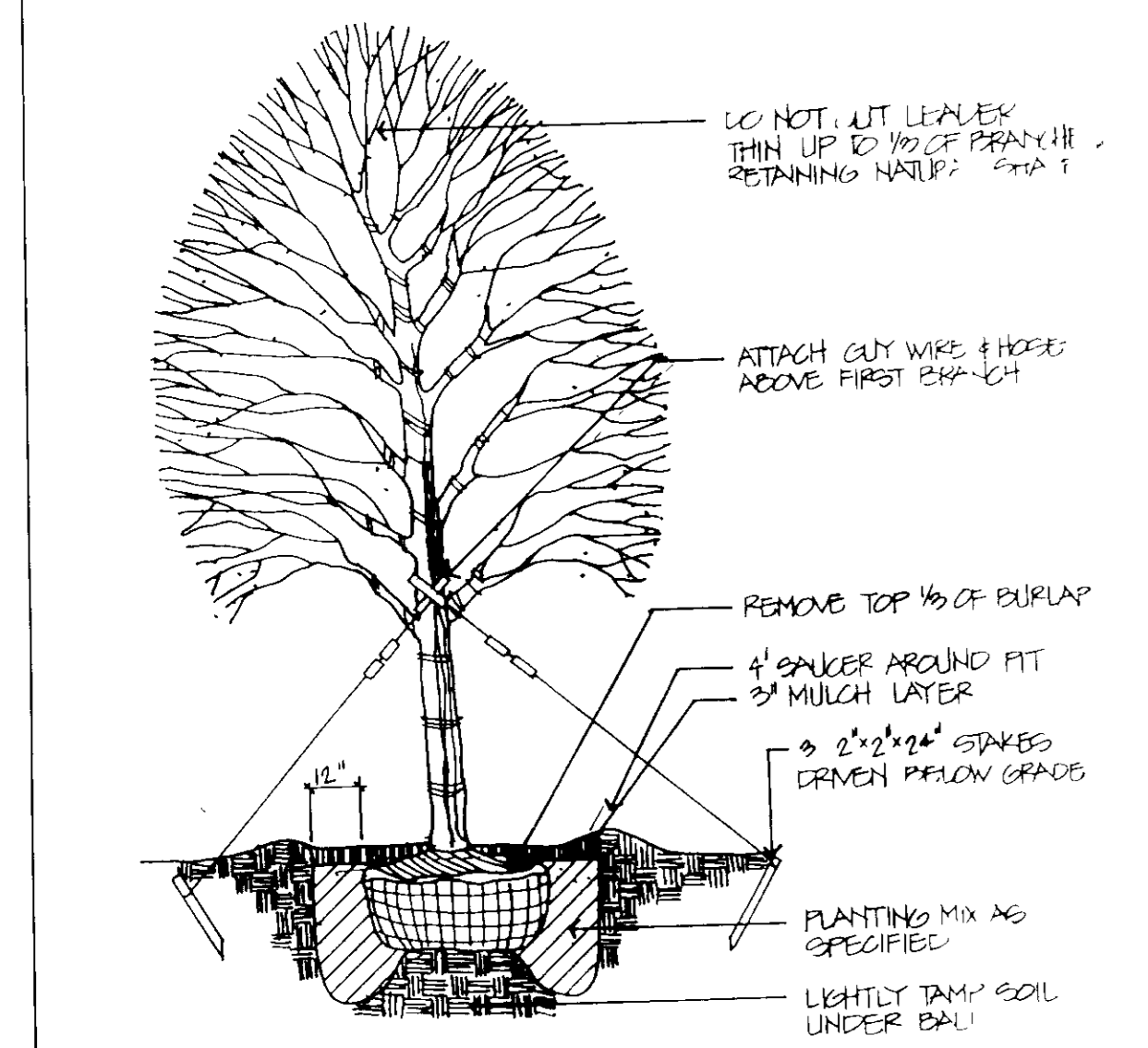

Large Shade Tree Planting
not to scale

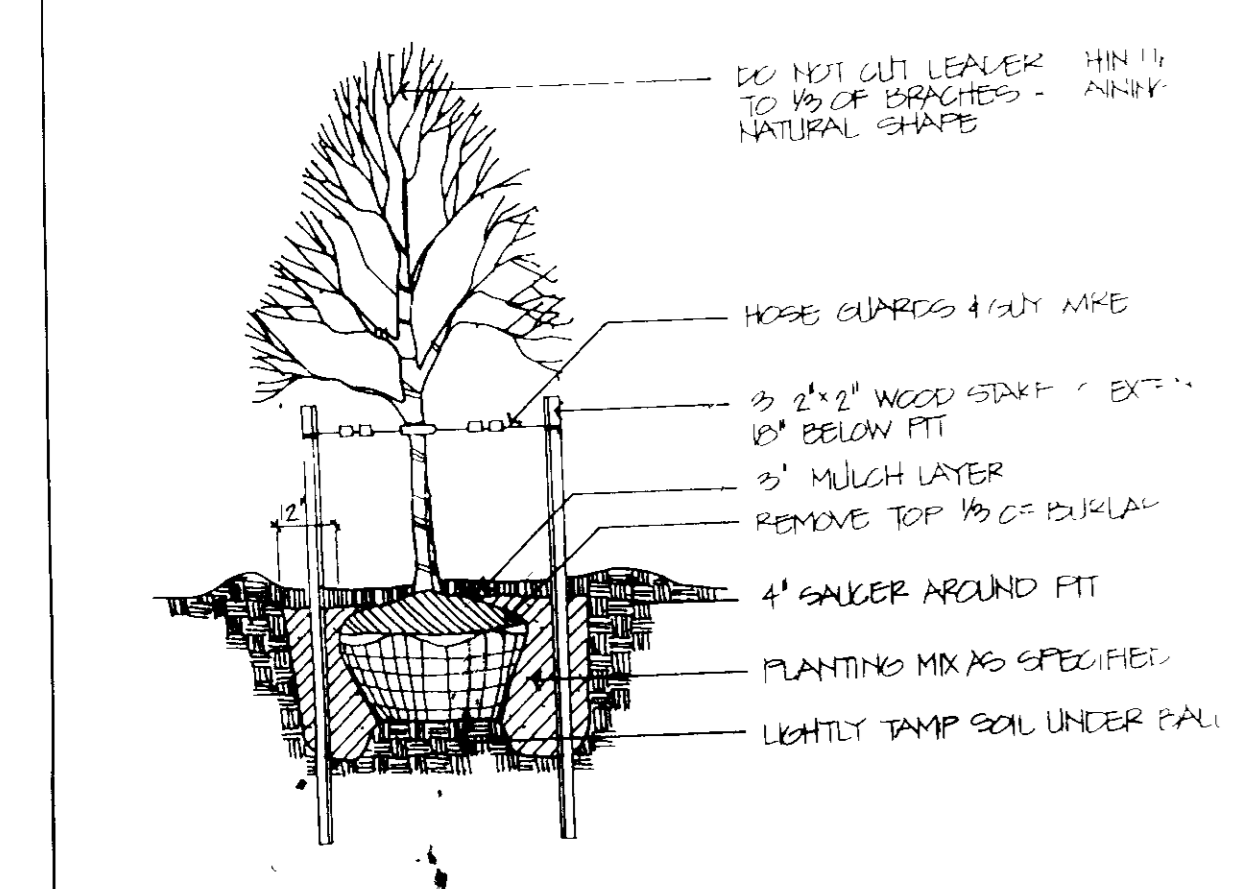

Small Deciduous Tree Planting
not to scale

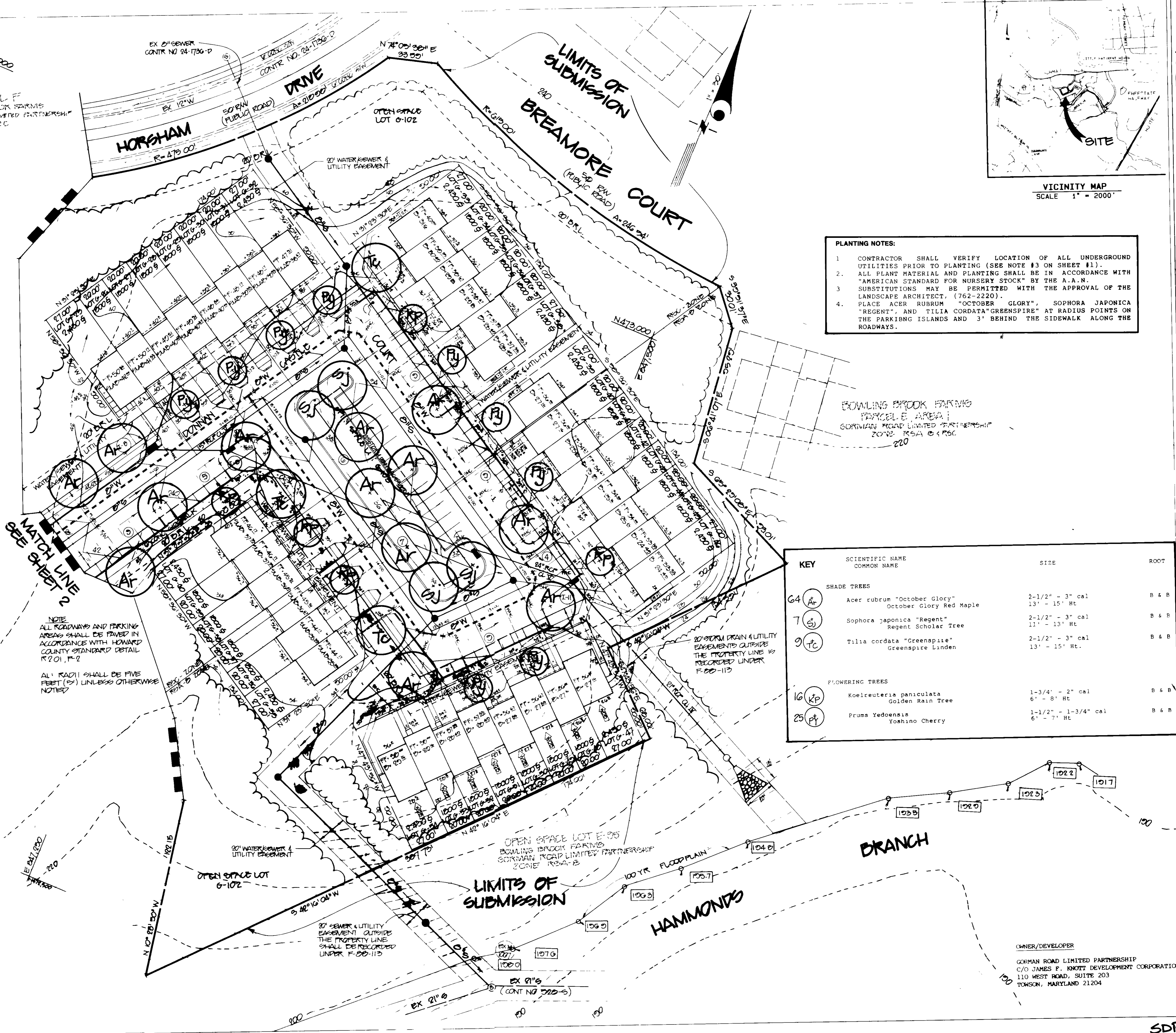

PLANTING NOTES:

- CONTRACTOR SHALL VERIFY LOCATION OF ALL UNDERGROUND UTILITIES PRIOR TO PLANTING (SEE NOTE #3 ON SHEET #1).
- ALL PLANT MATERIAL AND PLANTING SHALL BE IN ACCORDANCE WITH "AMERICAN STANDARD FOR NURSERY STOCK" BY THE A.A.N.
- SUBSTITUTIONS MAY BE PERMITTED WITH THE APPROVAL OF THE LANDSCAPE ARCHITECT, (762-2220).
- PLACE ACER RUBRUM "OCTOBER GLORY", SOPHORA JAPONICA "REGENT", AND TILIA CORDATA "GREENSPIRE" AT RADIUS POINTS ON THE PARKING ISLANDS AND 3' BEHIND THE SIDEWALK ALONG THE ROADWAYS.

KEY	SCIENTIFIC NAME COMMON NAME	SIZE	ROOT
SHADE TREES			
G4 (Ar)	Acer rubrum "October Glory" October Glory Red Maple	2-1/2" - 3" cal 13' - 15' Ht.	B & B
7 (Sj)	Sophora japonica "Regent" Regent Scholar Tree	2-1/2" - 3" cal 11' - 13' Ht.	B & B
9 (Tc)	Tilia cordata "Greenspire" Greenspire Linden	2-1/2" - 3" cal 13' - 15' Ht.	B & B
FLOWERING TREES			
16 (Kp)	Koeleruteria paniculata Golden Rain Tree	1-3/4" - 2" cal 6' - 8' Ht.	B & B
25 (Py)	Prunus Yedoensis Yoshino Cherry	1-1/2" - 1-3/4" cal 6' - 7' Ht.	B & B

PROFESSIONAL SEAL

ISSUED TO HOWARD COUNTY 7/00/00

ISSUED PER HOLO COMMUNITAS DATED 8/02/00 ORIGINALS ISSUED TO HO CO 10/06/00 MJK

ISSUED TO HO CO FOR SIGNATURE 9/10/00 MAJJK

LANDSCAPE PLAN

BOWLING BROOK FARMS
SECTION 4 AREA 1
PARCEL G LOTS G-1 THRU G-103
A RESUBDIVISION OF LOT 216 BOWLING BROOK FARMS
SIXTH ELECTION DISTRICT
TAX MAP 47 PARCEL 141

OWNER/DEVELOPER
GORMAN ROAD LIMITED PARTNERSHIP
C/O JAMES P. KNOTT DEVELOPMENT CORPORATION
110 WEST ROAD, SUITE 203
TOWSON, MARYLAND 21204

DATE 7/00/00

SHEET 6 OF 9

FILE 2104-1-7

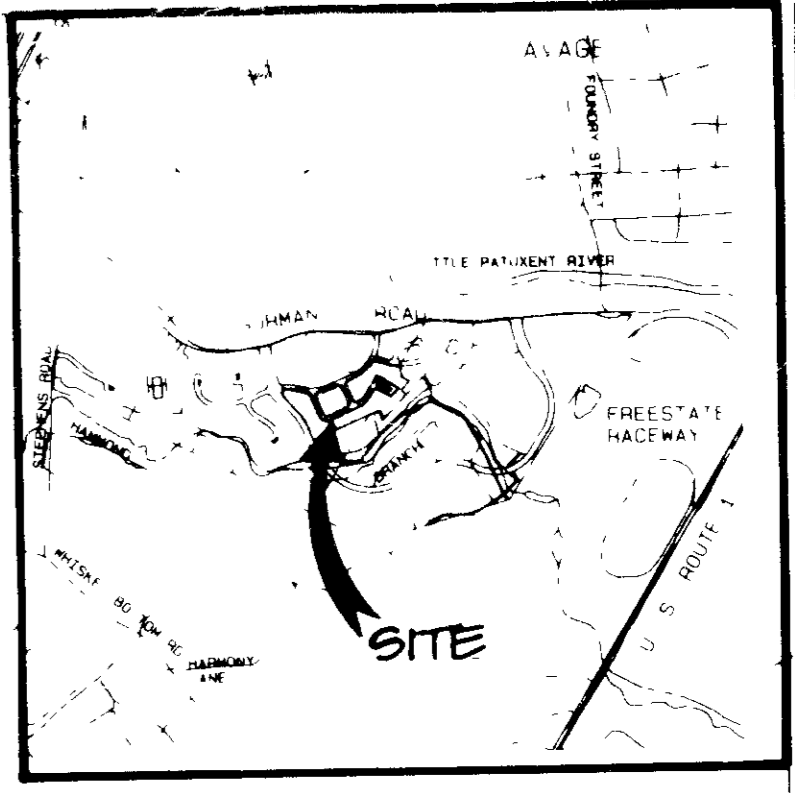

VICINITY MAP
 SCALE 1" = 2000'

John Hahn 3/17/89
Steph Z. Kim 3/17/89

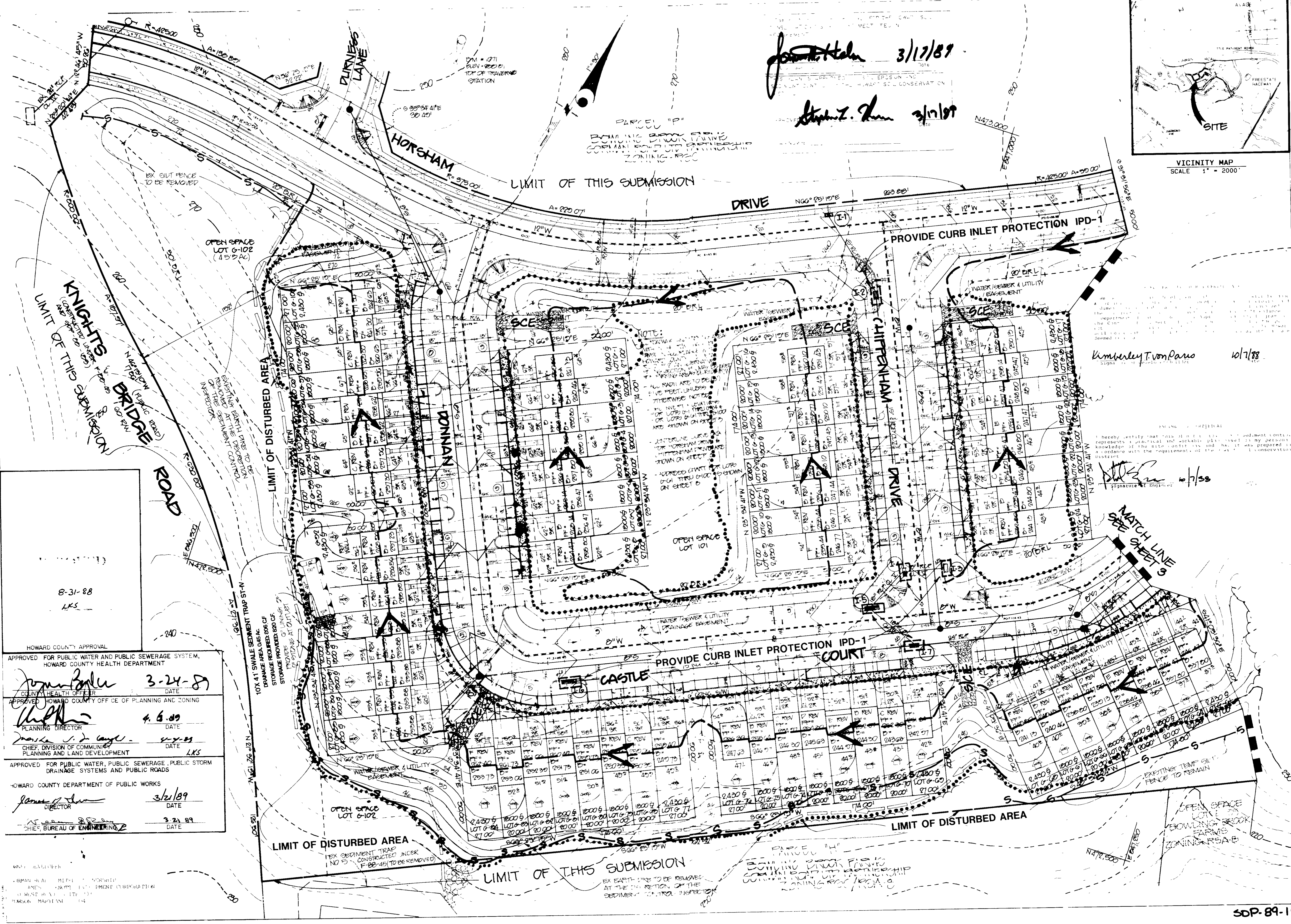

Kimberly T. von Pauw 10/7/88

John Hahn 10/7/88

8-31-88
 LKS

HOWARD COUNTY APPROVAL	
APPROVED FOR PUBLIC WATER AND PUBLIC SEWERAGE SYSTEM, HOWARD COUNTY HEALTH DEPARTMENT	
<i>John Baker</i>	3-24-89
COUNTY HEALTH OFFICER	DATE
APPROVED HOWARD COUNTY OFFICE OF PLANNING AND ZONING	
<i>Chick</i>	4-6-89
PLANNING DIRECTOR	DATE
<i>Mark S. J. Campbell</i>	4-9-89
CHIEF, DIVISION OF COMMUNITY PLANNING AND LAND DEVELOPMENT	DATE
LKS	
APPROVED FOR PUBLIC WATER, PUBLIC SEWERAGE, PUBLIC STORM DRAINAGE SYSTEMS AND PUBLIC ROADS	
HOWARD COUNTY DEPARTMENT OF PUBLIC WORKS	
<i>James J. Shaw</i>	3/21/89
DIRECTOR	DATE
<i>AS</i>	3-21-89
CHIEF, BUREAU OF ENGINEERING	DATE

BOWLING BROOK FARMS
 SECTION 4 AREA 1
 PARCEL G LOTS G-1 THRU G-103
 A RE-SUBDIVISION OF LOT 216 BOWLING BROOK FARMS SIXTH ELECTION DISTRICT
 TAX MAP 47 PARCEL 151
 F-432

PROJECT	PLAN
SURVEY	CHECKED
OTHER	SCALE
MJK	1" = 30'
DRAWN	DATE
CADD/JDW	7-28-88
SHEET 8	OF 9
FILE	

