

DRIVEWAY ABUTTING CLOSED SECTION WITH MODIFIED COMB CURB & GUTTER & SIDEWALK

Soil erosion control measures shall be installed and maintained throughout the construction period. The following schedule shall be followed:

1. Erosion control measures shall be installed within 14 days of the start of construction.

2. Erosion control measures shall be maintained throughout the construction period.

3. Erosion control measures shall be removed only after the final grading and stabilization of the site.

TEMPORARY SEEDING NOTES

1. Seeding shall be done on all disturbed areas immediately after grading and stabilization.

2. Seeding shall be done in accordance with the Maryland Standards and Specifications for Soil Erosion and Sediment Control.

3. Seeding shall be done in accordance with the following schedule:

- March 1 thru April 15: 1 lb/1000 sq ft of Kentucky 31 Tall Fescue
- April 16 thru May 15: 1 lb/1000 sq ft of Kentucky 31 Tall Fescue
- May 16 thru June 15: 1 lb/1000 sq ft of Kentucky 31 Tall Fescue
- June 16 thru July 15: 1 lb/1000 sq ft of Kentucky 31 Tall Fescue
- July 16 thru August 15: 1 lb/1000 sq ft of Kentucky 31 Tall Fescue
- August 16 thru September 15: 1 lb/1000 sq ft of Kentucky 31 Tall Fescue
- September 16 thru October 15: 1 lb/1000 sq ft of Kentucky 31 Tall Fescue
- October 16 thru November 15: 1 lb/1000 sq ft of Kentucky 31 Tall Fescue
- November 16 thru December 15: 1 lb/1000 sq ft of Kentucky 31 Tall Fescue
- December 16 thru January 15: 1 lb/1000 sq ft of Kentucky 31 Tall Fescue
- January 16 thru February 15: 1 lb/1000 sq ft of Kentucky 31 Tall Fescue
- February 16 thru March 15: 1 lb/1000 sq ft of Kentucky 31 Tall Fescue

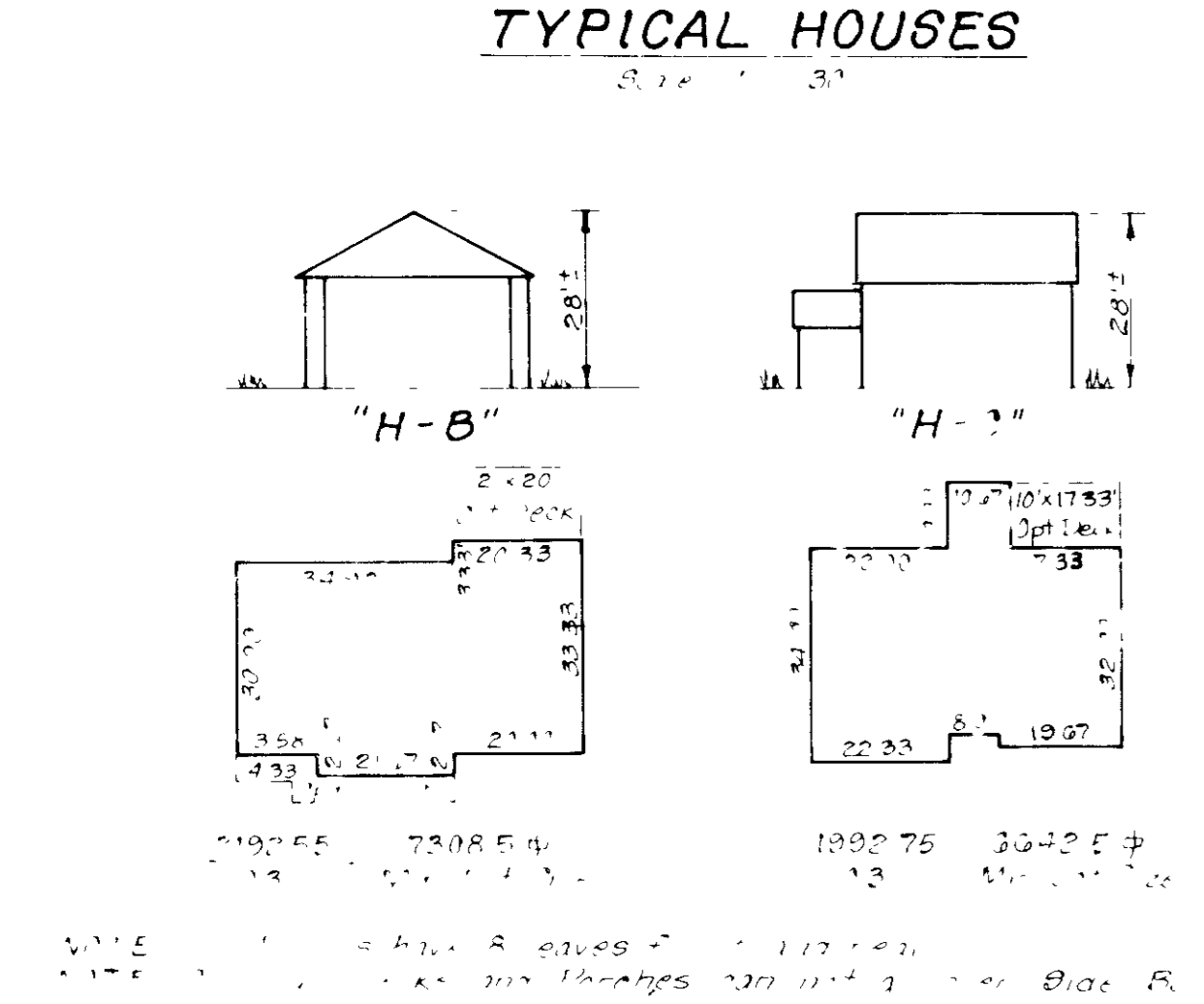

ADDRESS CHART

LOT No.	STREET ADDRESS
234	8166 Tamar Drive
235	8168 Tamar Drive

APPROVED FOR PUBLIC WATER AND PUBLIC SEWERAGE SYSTEMS AND PUBLIC ROADS

HOWARD COUNTY DEPARTMENT OF PUBLIC WORKS

8-18-88

1-5

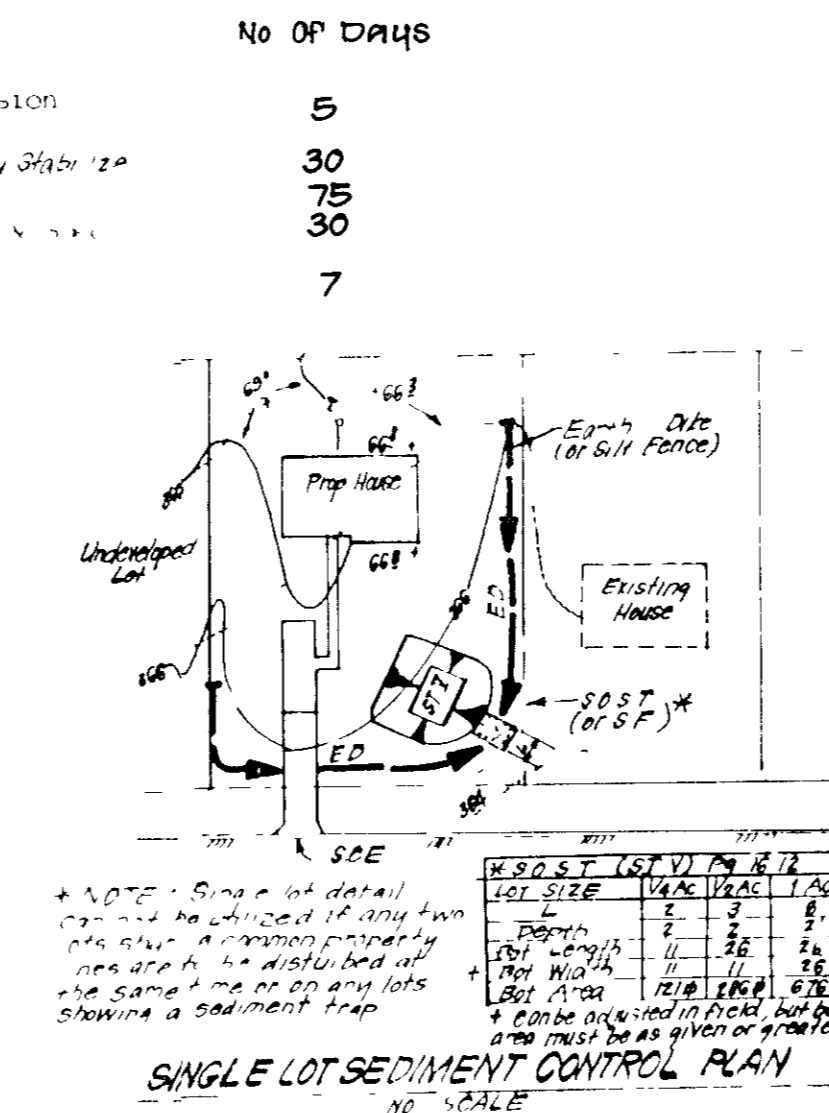
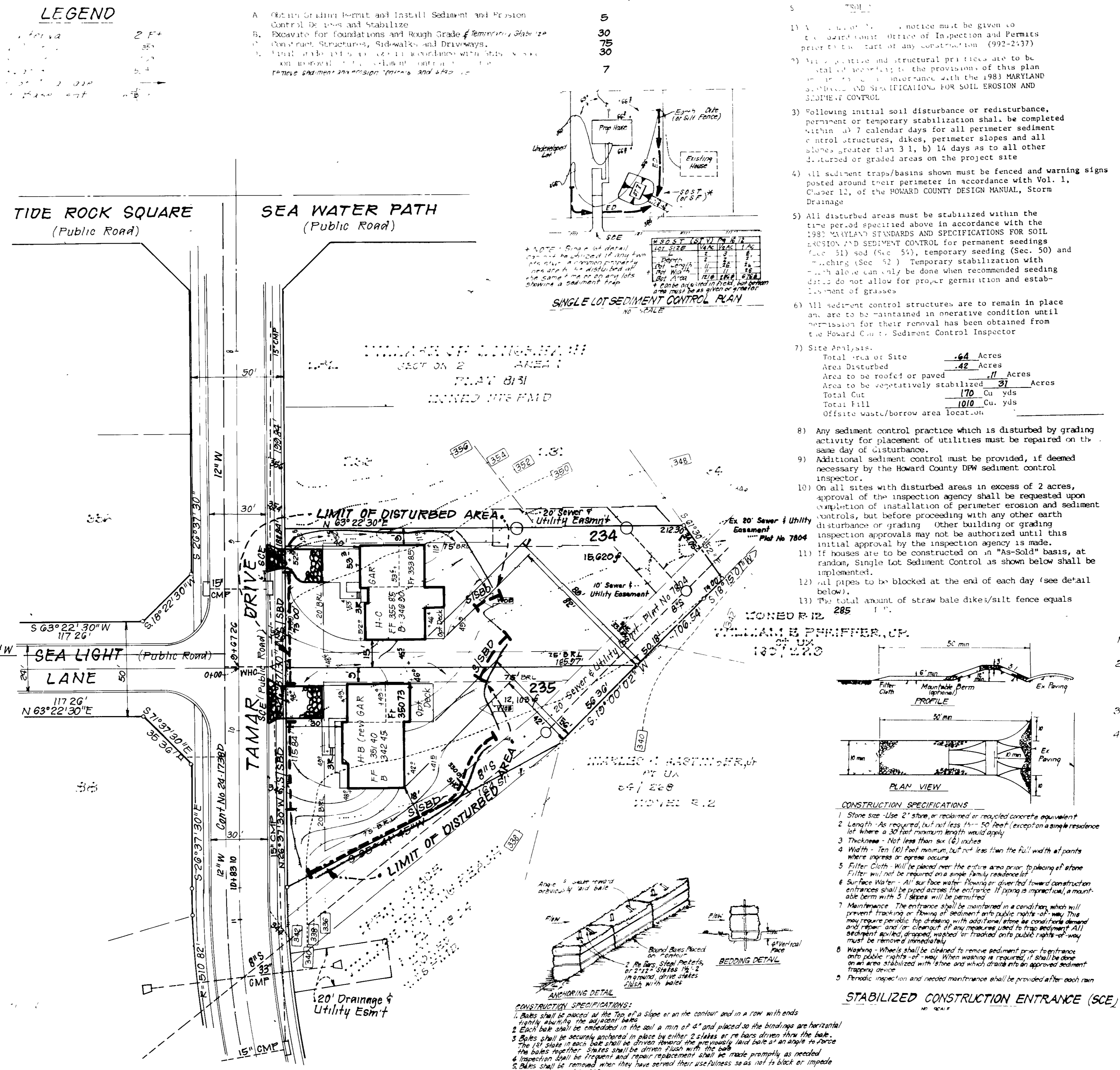

- Notice must be given to the Board of Public Works prior to the start of any construction.
- All erosion and sediment control practices are to be installed in accordance with the 1981 MARYLAND STANDARDS AND SPECIFICATIONS FOR SOIL EROSION AND SEDIMENT CONTROL.
- Following initial soil disturbance or redistribution, permanent or temporary stabilization shall be completed within 14 calendar days for all perimeter sediment control structures, dikes, perimeter slopes and all slopes greater than 3:1, 14 days as to all other disturbed or graded areas on the project site.
- All sediment traps/basins shown must be fenced and warning signs posted around their perimeter in accordance with Vol. 1, Chapter 12, of the HOWARD COUNTY DESIGN MANUAL, Storm Drainage.
- All disturbed areas must be stabilized within the time period specified above in accordance with the 1981 MARYLAND STANDARDS AND SPECIFICATIONS FOR SOIL EROSION AND SEDIMENT CONTROL for permanent seedings (Sec. 51) and (Sec. 52), temporary seedings (Sec. 50) and mulching (Sec. 52). Temporary stabilization with mulch alone can only be done when recommended seedings do not allow for proper germination and establishment of grasses.
- All sediment control structures are to remain in place and are to be maintained in operative condition until permission for their removal has been obtained from the Howard County Sediment Control Inspector.
- Site Analysis:
 - Total Area of Site: .64 Acres
 - Area to be roofed or paved: .42 Acres
 - Area to be vegetatively stabilized: .21 Acres
 - Total Cut: 170 Cu. yds
 - Total Fill: 1010 Cu. yds
 - Offsite waste/borrow area location: []
- Any sediment control practice which is disturbed by grading activity for placement of utilities must be repaired on the same day of disturbance.
- Additional sediment control must be provided, if deemed necessary by the Howard County DPM sediment control inspector.
- On all sites with disturbed areas in excess of 2 acres, approval of the inspection agency shall be requested upon completion of installation of perimeter erosion and sediment controls, but before proceeding with any other earth disturbance or grading. Other building or grading inspection approvals may not be authorized until this initial approval by the inspection agency is made.
- If houses are to be constructed on a "As-Built" basis, at random, single lot Sediment Control as shown below shall be implemented.
- All pipes to be blocked at the end of each day (see detail below).
- The total amount of straw bale dikes/silt fence equals 285.

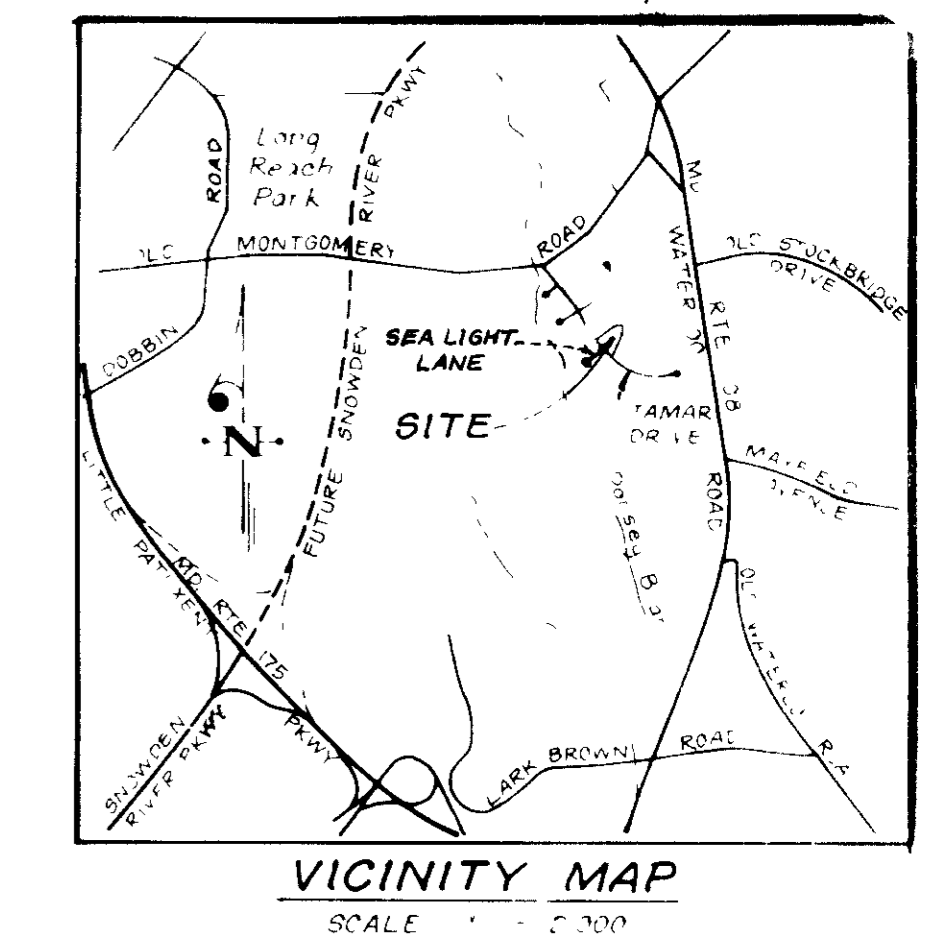
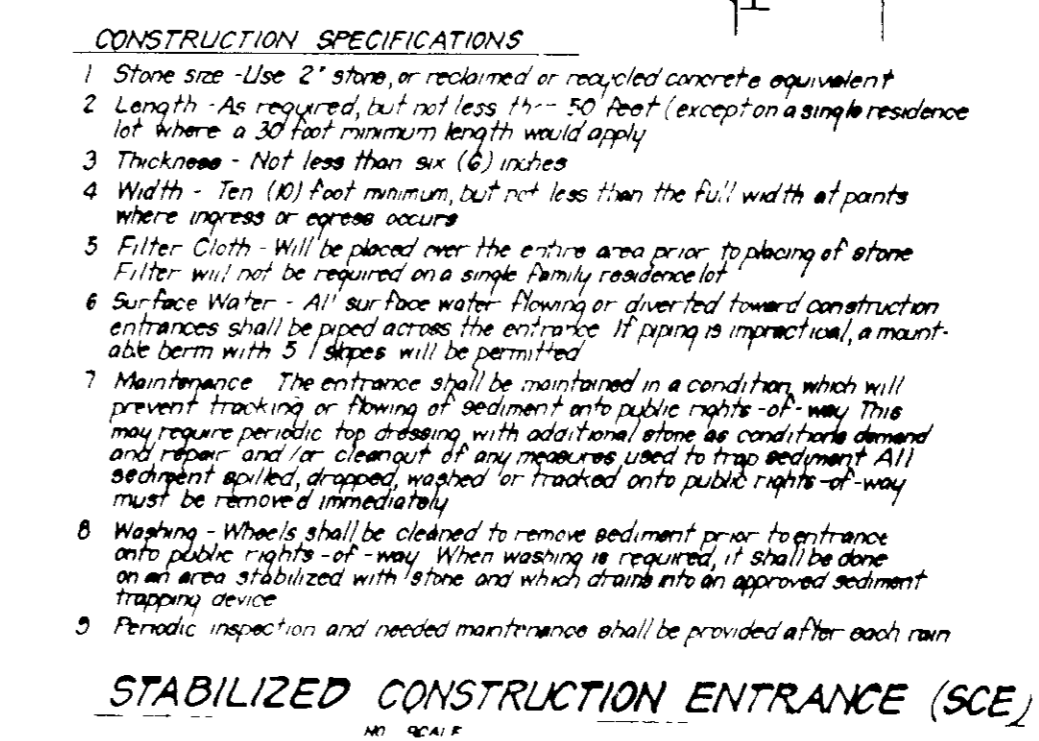
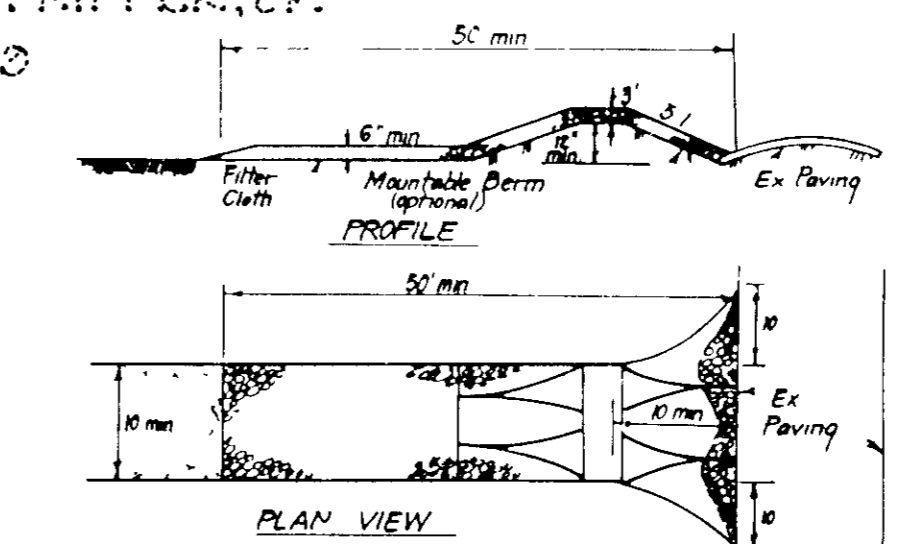

- GENERAL NOTES**
- Subject property zoned NT per Comprehensive Zoning Plan dated 8/2/85
 - The coordinates shown herein are based on the Maryland State Grid System and derived from the following Howard County Control Stations 2544002 and 2544008
 - All roads are public and existing
 - Any damage to county owned rights-of-way to be repaired at the Developer's expense
 - Total area included: .64 Acres
 - Total number of lots: 2
 - Reference Final Development Plan Criteria Section Two, Chapter 96
 - Maximum lot coverage is 30%
 - The Contractor or Developer shall contact the Inspection/Survey Division, 24 hrs. in advance of commencement of work at 792-2630
 - Existing topography taken from plans prepared by Fisher, Williams and Carter, Inc.
 - Reference file numbers S87-39, P87-60, F88-78 & F88-272

- SPECIAL NOTES**
- Approved Road Construction Plans shall be used for public utilities
 - The water and sewer house connections shall be in accordance with a Developer's Agreement with the Howard County Plumbing Code. The water and sewer connections shall be in accordance with the SHC shall be 4 inches
 - Stormwater Management provided in the Village of Long Reach, F 88-78
 - Public water and sewer shall be installed in accordance with more detailed information in the Water and Sewer Contract No. 24-1738-D

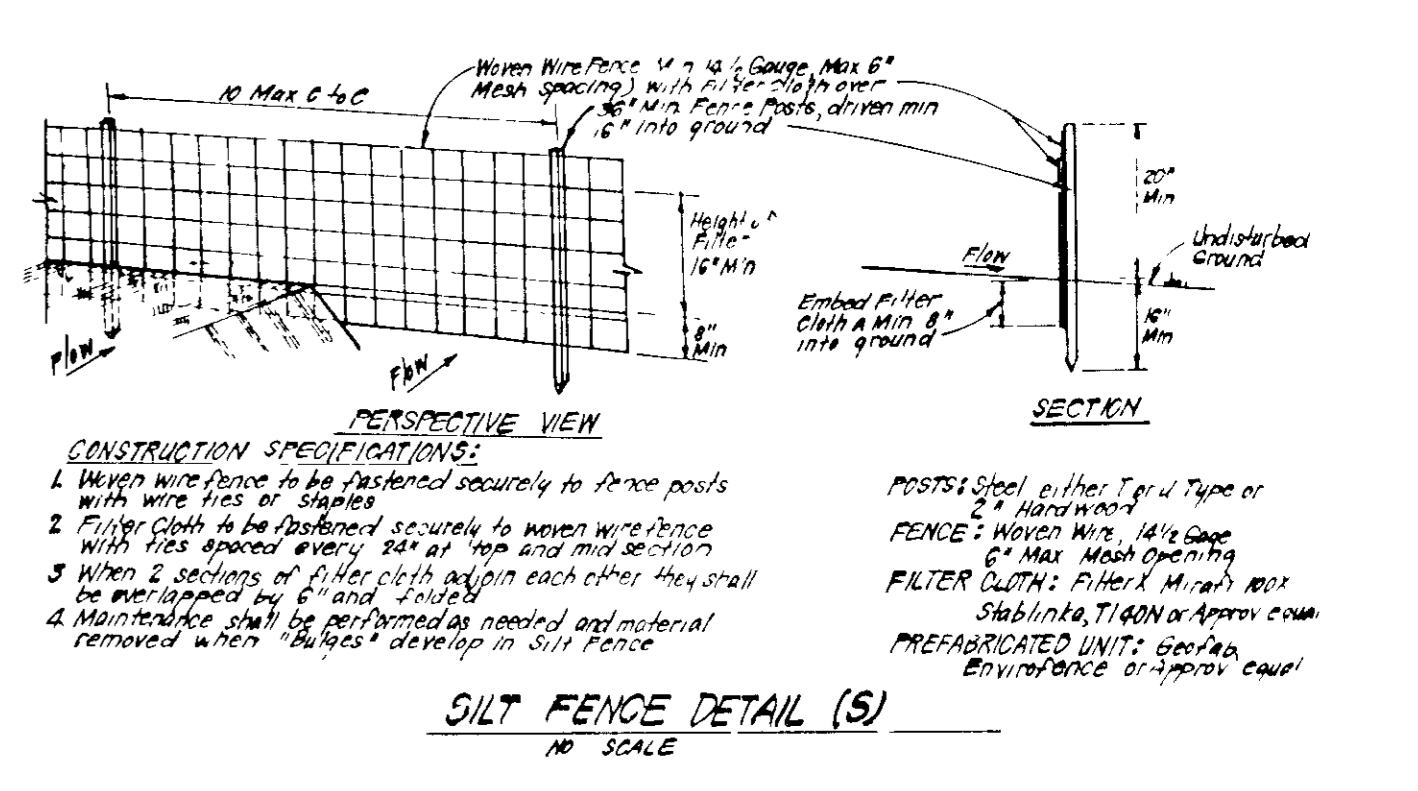

Reviewed for HOWARD COUNTY S&D and meets Technical Requirements

Signature: []

U.S. Soil Conservation Service

THIS DEVELOPMENT PLAN IS APPROVED FOR SOIL EROSION AND SEDIMENT CONTROL BY THE HOWARD SOIL CONSERVATION DISTRICT.

Signature: []

Date: 10/13/88

DEVELOPER'S/BUILDER'S CERTIFICATE

I/We certify that all development and construction will be done according to the plan of development and plan for erosion and sediment control and that all responsible personnel involved in the construction project will have a Certificate of Attendance at a Dept. of Natural Resources Approved Training Program for the Control of Sediment and Erosion before beginning the project. I also authorize periodic site inspection by the Howard Soil Conservation District or their authorized agents, as are deemed necessary.

Signature: []

Date: 7-22-88

ENGINEER'S CERTIFICATE

I hereby certify that this plan for Erosion and Sediment Control represents a practical and workable plan based on my personal knowledge of the site conditions and that it was prepared in accordance with the requirements of the Howard Soil Conservation District.

Signature: []

Date: 7-21-88

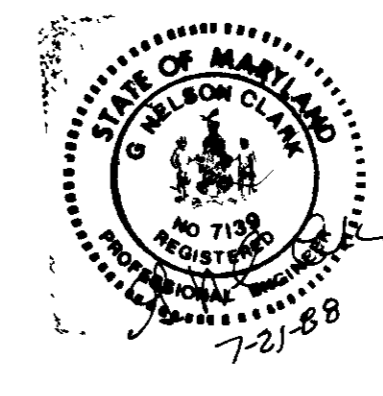

SUBDIVISION NAME - COLUMBIA	SECT./AREA	PLAT
VILLAGE OF LONG REACH	2/1	234+235
PLAT No. of LIF/BLOCK No.	ZONE	TAX MAP No. ELEC. DIST. CENSUS TR.
8/31	S&MD	37
WATER CODE	SEWER CODE	
E07	34G0000	

CLARK • FINEFROCK & SACKETT, INC.

ENGINEERS • PLANNERS • SURVEYORS

7135 MINSTREL WAY • COLUMBIA, MD 21045 • (301) 381-7200 • BALTO. • (301) 621-6100 • WASH.

SITE DEVELOPMENT & SEDIMENT & EROSION CONTROL PLAN

DESIGNER: CMS

DRAWN: GRS

CHECKED: CMS

DATE: 7-1988

LOTS 234 & 235

COLUMBIA

VILLAGE OF LONG REACH

SECTION 2 AREA 1

6TH ELECTION DISTRICT

HOWARD COUNTY, MARYLAND

DRAWING: 1 of 1

JOB NO: 88-064

FILE NO: 88-064 X

FOR: HALLMARK BUILDERS, INC

PO BOX 1018

COLUMBIA, MARYLAND 21044

SOP-89-16