

NOTE: THIS PLAN IS A REVISION TO SDD T2-120C. THE REASON FOR THIS REVISION IS TO ALIGN THE ENTRANCE WITH THE PROPOSED R/W ON THE OPPOSITE SIDE OF MCGAW ROAD.

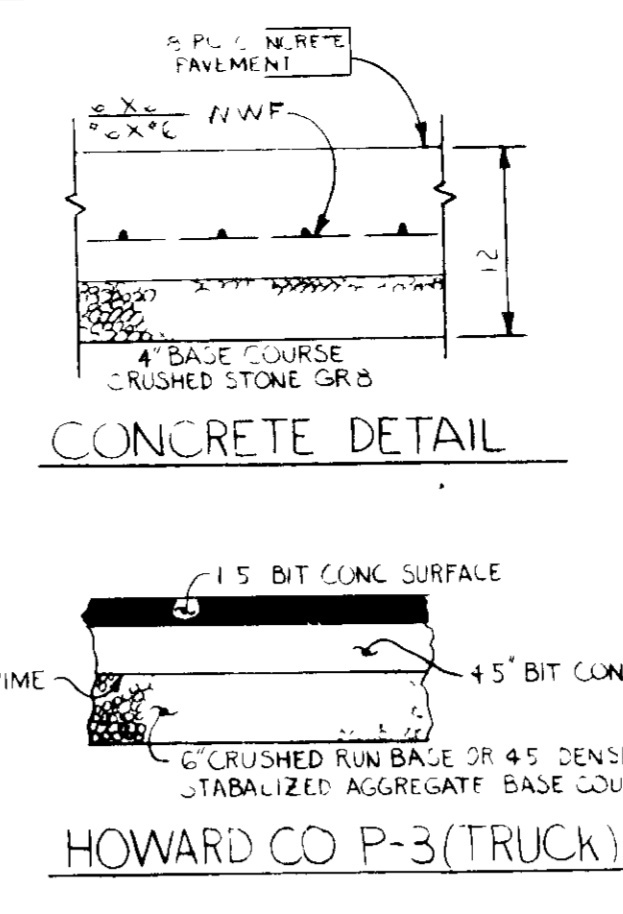

LEGEND

- EX GROUND
- PROP GRADE
- TRACT OUTLINE
- R/W LINE
- PAVING SECTION-P-3
- LIMIT OF SUBMITAL

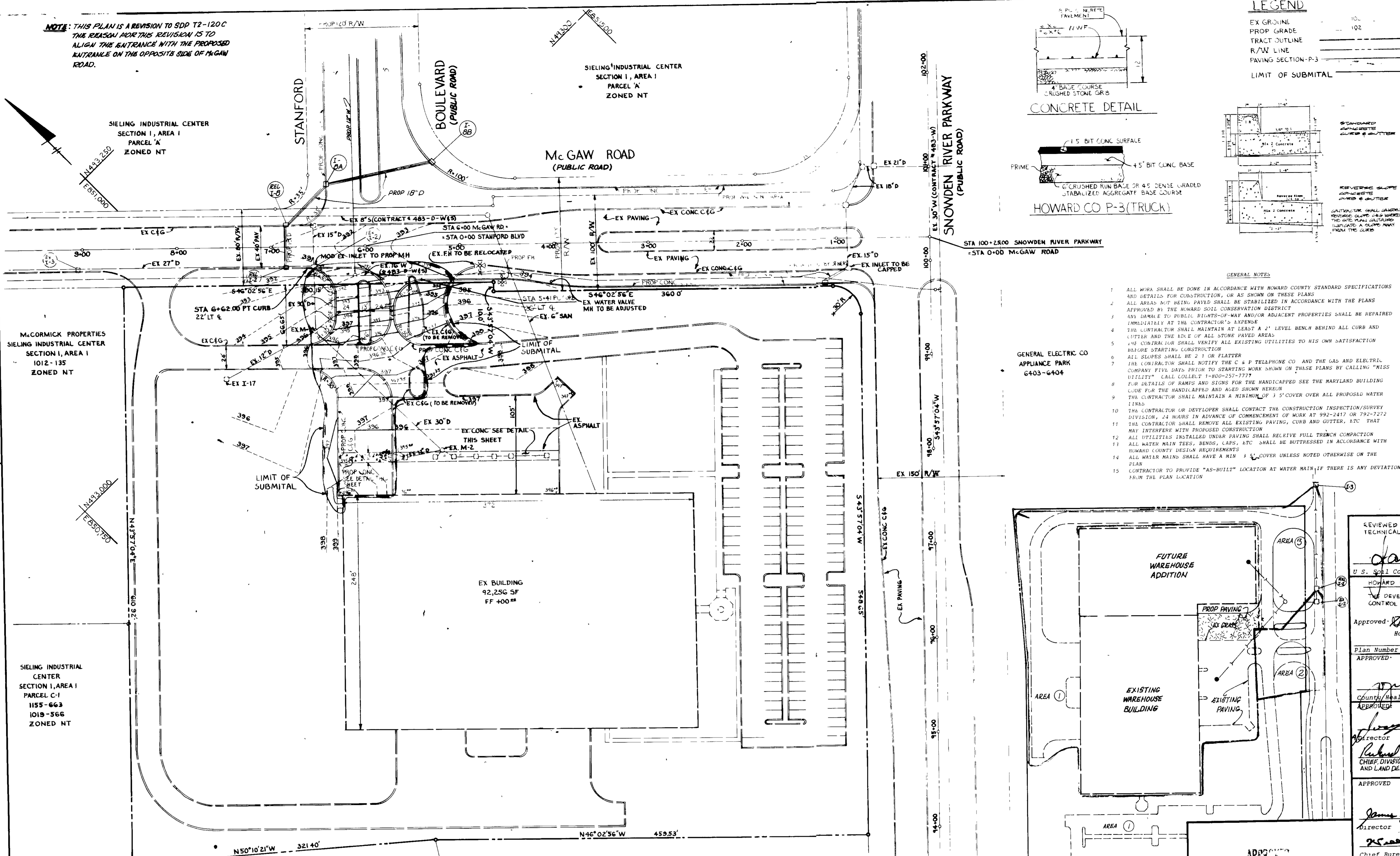
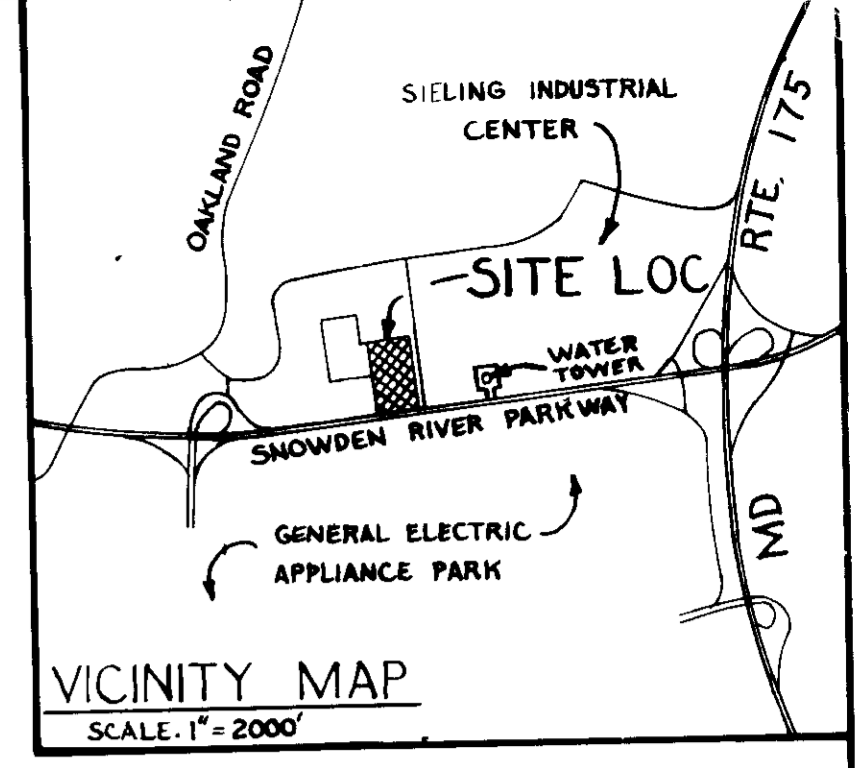

BENCHMARK # 234-4001 ELEV. 307.493
N 491.333 018 E 858.206 723 STANDARD CONCRETE MONUMENT SET FLUSH WITH SURFACE.
BENCHMARK # 234-3001 ELEV. 288.241
N 492.140 801 E 857.226 671 3/4" IRON BAR SET 0.3' BELOW SURFACE.

SITE DATA
 TOTAL AREA OF SITE = 10.5 AC.
 EXISTING ZONING = NEWTOWN EMPLOYMENT INDUSTRIAL DISTRICT
 EXISTING USE = OFFICE/WAREHOUSE
 EXISTING TOTAL FLOOR AREA = 92,256 SF
 PROPERTY REFERENCES STATE FARM LIFE INS CO
 SIELING IND. CENTER SECTION I, AREA I PLAT 5172 DEED 657-350

AREA OF SUBMITAL = 0.62 AC.
 % OPEN SPACE = 5.30 AC / 10.5 AC = 50.48%
 % BUILDING COVERAGE W/ PAVING = 5.20 AC / 10.5 AC = 49.52%

AREA TO BE DISTURBED = 0.62 AC.
 AREA TO BE VEGETATIVELY STABILIZED = 0.22 AC.

RCN FOR THE EXISTING AREA DRAINING TO T-2 I-3-BB RCN FOR THE PROPOSED AREA DRAINING TO T-2 I-3-BB FIC REMAIN UNCHANGED THEREFORE NO INCREASE IN RUN OFF BECAUSE OF MINIMAL AMOUNT OF ADDITIONAL PAVING NO SWM IS NEEDED
 NOTE: THE SITE WILL BE FAVORABLY IMPACTED BY THE PROPOSED REGIONAL SWM POND IN COLUMBIA CORPORATE PARK (SDD 97-193)

- GENERAL NOTES**
- ALL WORK SHALL BE DONE IN ACCORDANCE WITH HOWARD COUNTY STANDARD SPECIFICATIONS AND DETAILS FOR CONSTRUCTION, OR AS SHOWN ON THESE PLANS.
 - ALL AREAS NOT BEING PAVED SHALL BE STABILIZED IN ACCORDANCE WITH THE PLANS APPROVED BY THE HOWARD SOIL CONSERVATION DISTRICT.
 - ANY DAMAGE TO PUBLIC RIGHTS-OF-WAY AND/OR ADJACENT PROPERTIES SHALL BE REPAIRED IMMEDIATELY AT THE CONTRACTOR'S EXPENSE.
 - THE CONTRACTOR SHALL MAINTAIN AT LEAST A 2' LEVEL BENCH BEHIND ALL CURB AND CUTS AND THE SIDE OF ALL STONE PAVED AREAS.
 - THE CONTRACTOR SHALL VERIFY ALL EXISTING UTILITIES TO HIS OWN SATISFACTION BEFORE STARTING CONSTRUCTION.
 - ALL SLOPES SHALL BE 2:1 OR FLATTER.
 - THE CONTRACTOR SHALL NOTIFY THE C & P TELEPHONE CO AND THE GAS AND ELECTRIC COMPANY FIVE DAYS PRIOR TO STARTING WORK SHOWN ON THESE PLANS BY CALLING "MISS DILLITY" CALL COLLECT 1-800-257-7777.
 - FOR DETAILS OF HANDS AND SIGNS FOR THE HANDICAPPED SEE THE MARYLAND BUILDING CODE FOR THE HANDICAPPED AND AS SHOWN HEREIN.
 - THE CONTRACTOR SHALL MAINTAIN A MINIMUM OF 3' COVER OVER ALL PROPOSED WATER LINES.
 - THE CONTRACTOR OR DEVELOPER SHALL CONTACT THE CONSTRUCTION INSPECTION/SURVEY DIVISION, 24 HOURS IN ADVANCE OF COMMENCEMENT OF WORK AT 992-2417 OR 792-7272.
 - THE CONTRACTOR SHALL REMOVE ALL EXISTING PAVING, CURB AND GUTTER, ETC THAT MAY INTERFERE WITH PROPOSED CONSTRUCTION.
 - ALL UTILITIES INSTALLED UNDER PAVING SHALL RECEIVE FULL TRENCH COMPACTION.
 - ALL WATER MAIN TEES, BENDS, CAPS, ETC SHALL BE BUTTRESSED IN ACCORDANCE WITH HOWARD COUNTY DESIGN REQUIREMENTS.
 - ALL WATER MAINS SHALL HAVE A MIN 18" COVER UNLESS NOTED OTHERWISE ON THE PLAN.
 - CONTRACTOR TO PROVIDE "AS-BUILT" LOCATION AT WATER MAIN IF THERE IS ANY DEVIATION FROM THE PLAN LOCATION.

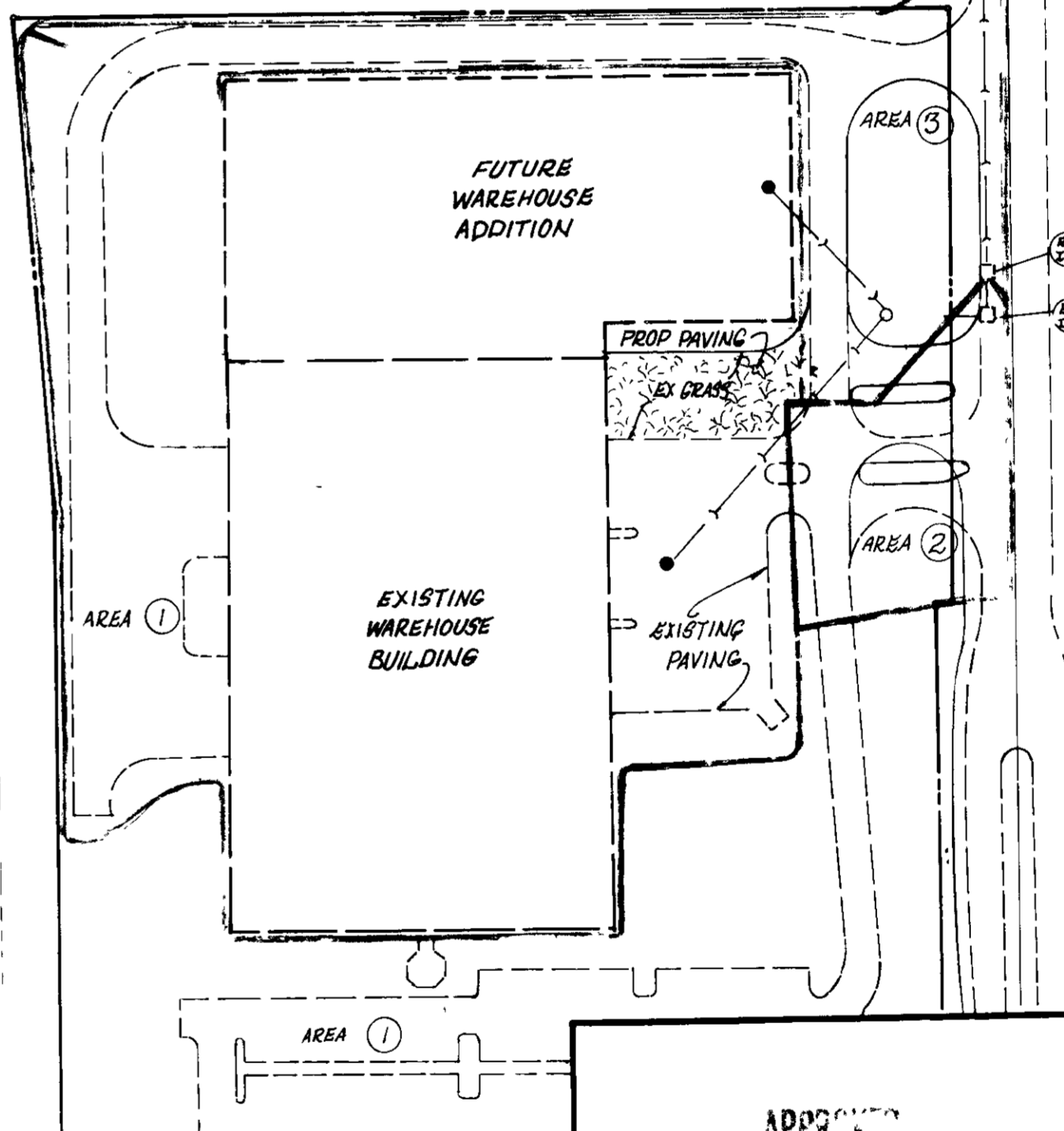

REVIEWED FOR HOWARD SOIL CONSERVATION DISTRICT AND MEETS TECHNICAL REQUIREMENTS.

James M. Helm 9/6/88 Date
 U.S. Soil Conservation Service

APPROVED FOR HOWARD COUNTY SOIL CONSERVATION DISTRICT
Stephen L. Fisher 9/6/88 Date
 Howard Soil Conservation District

Plan Number: APPROVED For public water and public sewerage systems
 Howard County Health Department.

APPROVED For public water and public sewerage storm drainage systems and public roads Howard County Department of Public Works.
James M. Helm 12-19-87 Date
 Director

APPROVED For public water and public sewerage storm drainage systems and public roads Howard County Department of Public Works.
Richard Bloodgood 12/27/85 Date
 Director

APPROVED For public water and public sewerage storm drainage systems and public roads Howard County Department of Public Works.
James M. Helm 12/15/89 Date
 Director

APPROVED For public water and public sewerage storm drainage systems and public roads Howard County Department of Public Works.
James M. Helm 12-14-87 Date
 Chief Bureau of Engineering

ADDRESS CHART

BUILDING #	STREET ADDRESS
PARCEL D	8955 Mc GAW RD

APPROVED
 HOWARD COUNTY
 DATE 7-28-88

PLAN SCALE: 1"=50'

UNITED STATES POSTAL SERVICE
 SIELING INDUSTRIAL CENTER
 SECTION I, AREA I
 638-196
 ZONED NT

LEROY M MERRIT
 1203-140
 1368-544
 ZONED M-1

DRAINAGE AREA FOR EXISTING CONDITION
 INLET #2 AREA 1 5.90 AC ±, C=0.64, 37% ROOT, 16% PAVING, 47% GRASS
 AREA 2 0.62 AC ±, C=0.70, 61% PAVING, 39% GRASS
 INLET #3 AREA 3 1.27 AC ±, C=0.70, 63% PAVING, 37% GRASS

DRAINAGE AREA FOR PROPOSED CONDITION
 INLET #2 AREA 2 0.62 AC ±, C=0.70, 62% PAVING, 38% GRASS
 AREA 3 1.27 AC ±, C=0.70, 63% PAVING, 37% GRASS

DRAINAGE AREA FOR FUTURE CONDITION
 INLET #2 AREA 2 0.62 AC ±, C=0.70, 62% PAVING, 38% GRASS
 AREA 3 1.27 AC ±, C=0.70, 63% PAVING, 37% GRASS

NOTE: STORM DRAIN SYSTEM FOR EXISTING STRUCTURES I-2 AND I-3 WAS DESIGNED FOR FUTURE ULTIMATE CONDITION.

GEORGE WILLIAM STEPHENS, JR. AND ASSOCIATES, INC.
 CIVIL ENGINEERS & LAND SURVEYORS
 303 ALLEGHENY AVENUE
 TOWSON, MARYLAND 21204
 (301)825-8120

ENGINEER'S CERTIFICATE
 I CERTIFY THAT THIS PLAN FOR CONSTRUCTION, EROSION AND SEDIMENT CONTROL REPRESENTS A PRACTICAL AND WORKABLE PLAN BASED ON MY PERSONAL KNOWLEDGE OF THE SITE CONDITIONS. THIS PLAN WAS PREPARED IN ACCORDANCE WITH THE REQUIREMENTS OF THE HOWARD SOIL CONSERVATION DISTRICT. I HAVE NOTIFIED THE DEVELOPER THAT HE MUST PROVIDE THE HOWARD SOIL CONSERVATION DISTRICT WITH A RED-LINED "AS-BUILT" OF THE POND WITHIN 30 DAYS OF COMPLETION.

George William Stephens, Jr. 8/10/88 DATE
 ENGINEER TAPORATA (UNLICENSED) REG. NO.

OWNER
 STATE FARM INSURANCE COMPANY
 INVESTMENT DEPT/ REAL ESTATE B-4
 ONE STATE FARM PLAZA
 BLOOMINGTON, ILLINOIS 61710
 1-800-766-2361

DEVELOPER'S CERTIFICATE
 I CERTIFY THAT ALL DEVELOPMENT AND/OR CONSTRUCTION WILL BE DONE ACCORDING TO THESE PLANS AND THAT ANY RESPONSIBLE PERSONNEL INVOLVED IN THIS CONSTRUCTION PROJECT WILL HAVE A CERTIFICATE OF ATTENDANCE AT A DEPT. OF NATURAL RESOURCES APPROVED TRAINING PROGRAM FOR THE CONTROL OF SEDIMENT AND EROSION BEFORE BEGINNING THE PROJECT. I ALSO AUTHORIZE PERIODIC ON-SITE INSPECTION BY THE HOWARD SOIL CONSERVATION DISTRICT OR OTHER AUTHORIZED AGENCIES AS ARE DEEMED NECESSARY. DEVIATION FROM THIS PLAN WILL NOT BE MADE UNLESS AUTHORIZED BY THE HOWARD SOIL CONSERVATION DISTRICT.

DEVELOPER DATE

DESIGNED BY: WZ
 DRAWN BY: RGB
 CHECKED BY: PC
 REVISIONS

SITE PLAN
 PARCEL D
 SIELING INDUSTRIAL CENTER
 SECTION I, AREA I
 HOWARD CO. MD. ELECTION DISTRICT 6
 AUGUST 10, 1987

SH. LT 1 OF 2
 SDD-84-03

