

- 1. ZONING R-12
- 2. TOTAL NO. LOTS THIS PLAN = 6
- 3. GREEN AREA 1.27 AC ± = 84%
- 4. BLDG. COVERAGE 0.24 AC ± = 13.2%
- 5. 0 DENOTES STREET TREES PER F 88-15
- 6. NO WETLANDS EXIST BEYOND THE STREAM BANKS
- 7. 100 YR FLOOD PLAIN
- 8. 100 YR FLOOD PLAIN

NOTE:
THE STREAM BUFFER INDICATED ON THIS SITE DEVELOPMENT PLAN DOES NOT AFFECT THE INITIAL CONSTRUCTION OF A RESIDENTIAL UNIT ON A LOT. IT DOES PROHIBIT SUBSEQUENT CLEARING, GRADING OR CONSTRUCTION IN THE BUFFER AREA. MAINTENANCE OF RESIDENCES, LANDSCAPING AND UTILITIES IS PERMITTED.

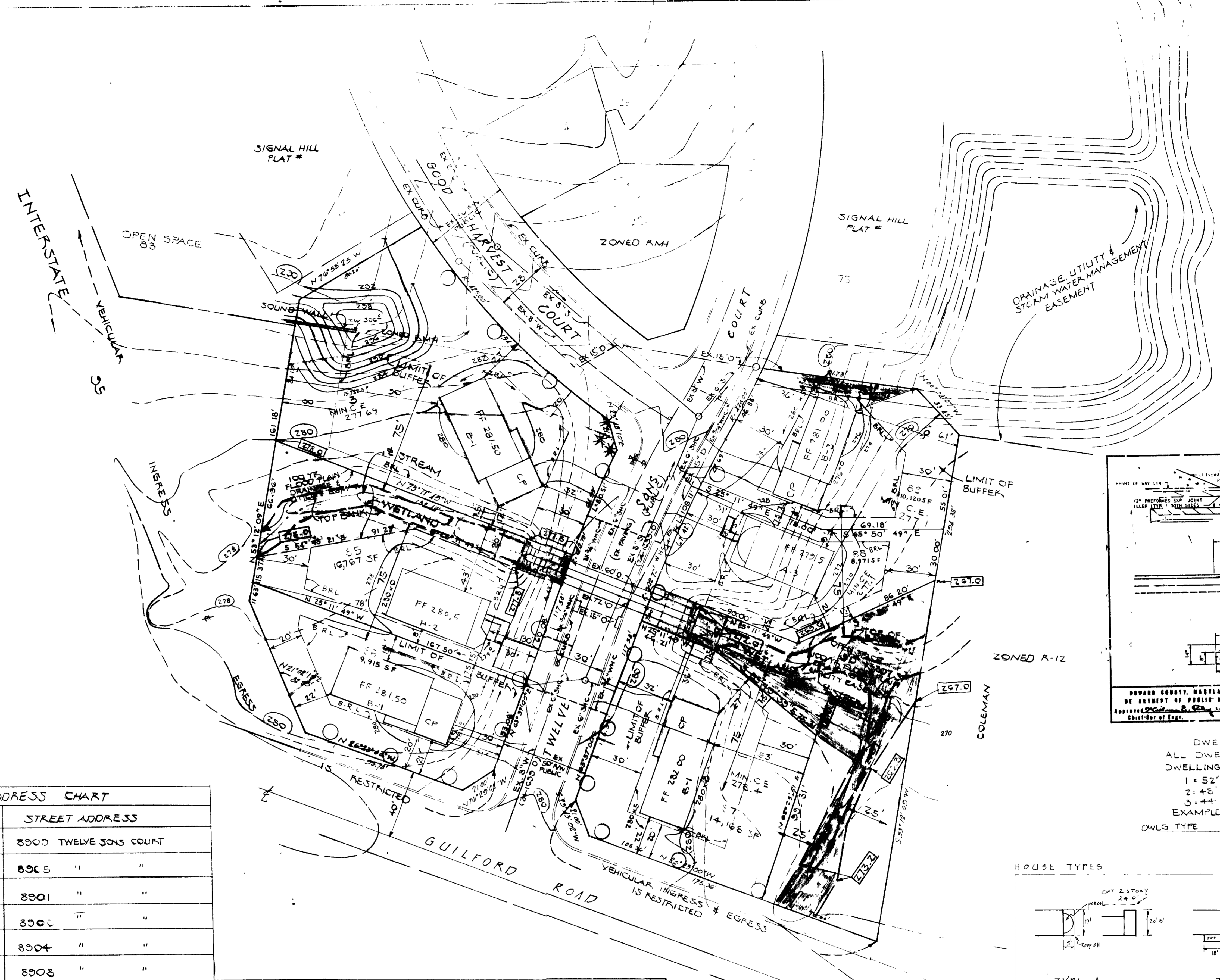
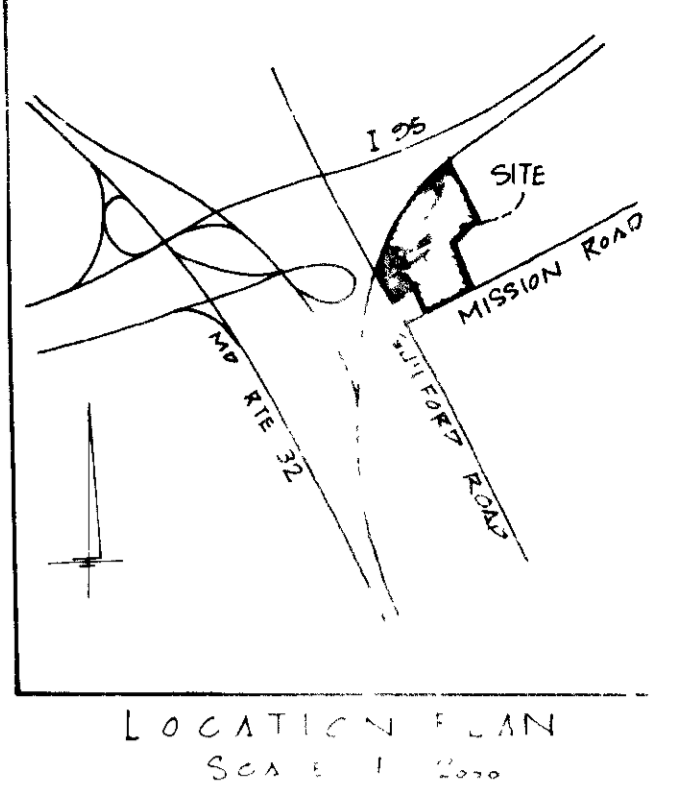

LOT DATA			
LOT NO	AREA (SF)	BLDG. COVER	BLDG. AREA
86	3315	0	1050
85	16767	8350	8417
3	15722	4400	1350
82	10120	450	34
83	3071	501	1434
87	14168	1100	1320

* INCLUDES FLOODPLAIN

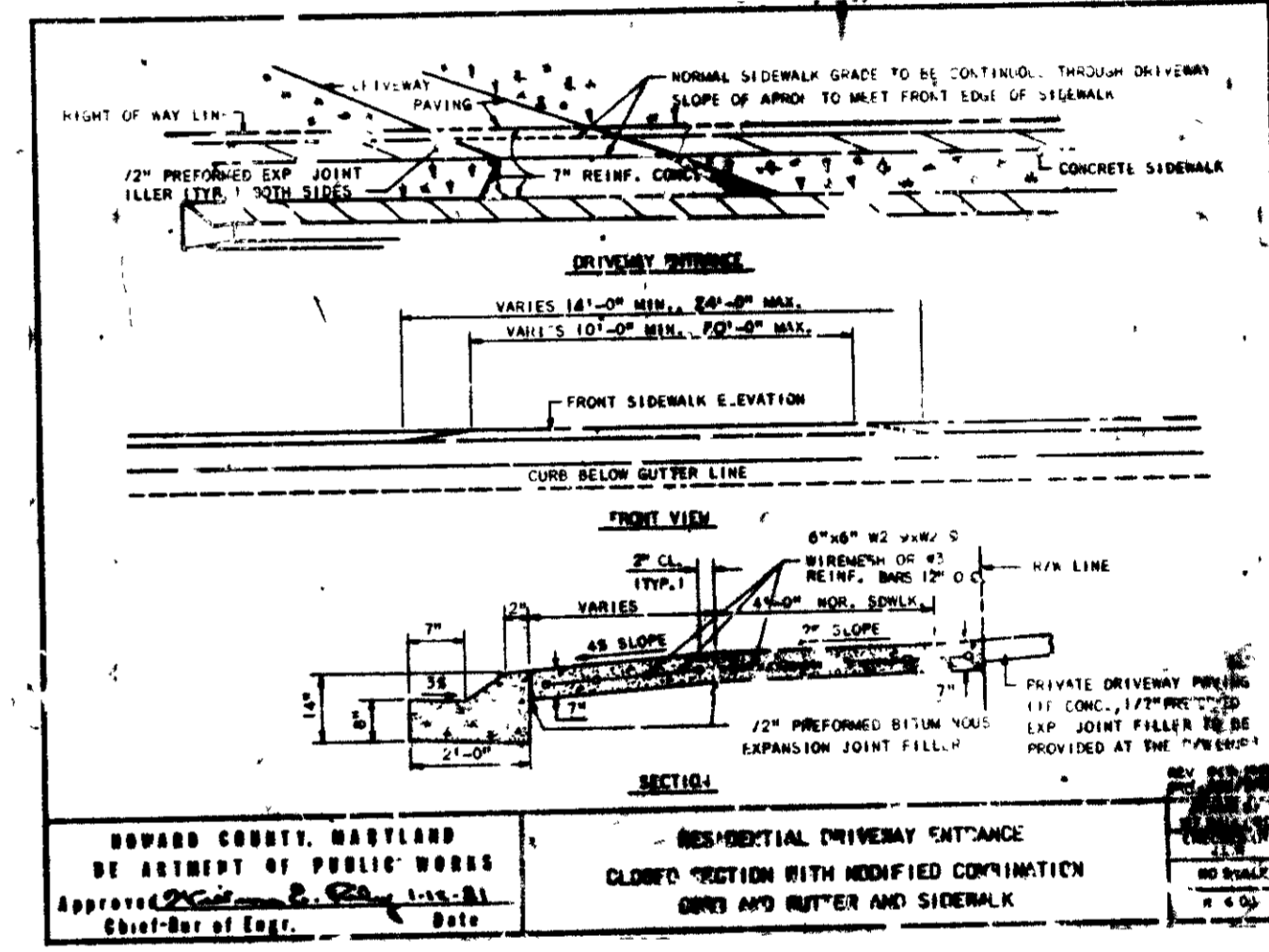

DWELLING TYPES & ELEVATIONS
ALL DWELLINGS ARE 28' WIDE
DWELLING LENGTHS ARE AS FOLLOWS
1 = 52'
2 = 45'
3 = 44'
EXAMPLE
DWLG TYPE (1)-(2) DWLG LENGTH

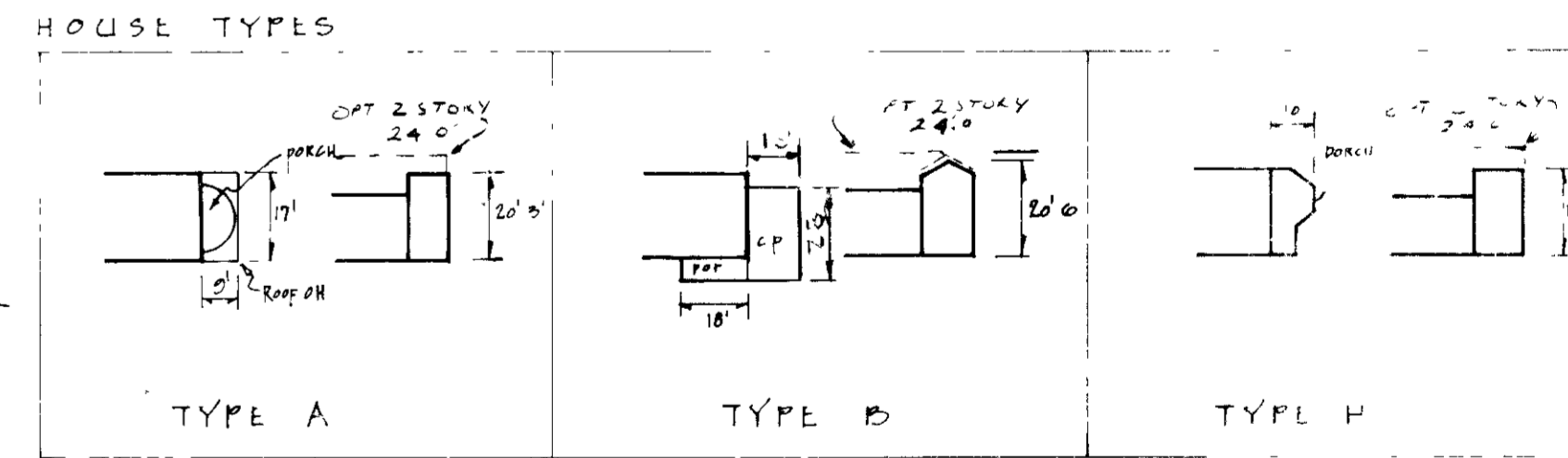

ADDRESS CHART	
LOT NO	STREET ADDRESS
3	8300 TWELVE SONS COURT
85	8305 " "
86	8301 " "
87	8302 " "
83	8304 " "
80	8308 " "

THIS PLAN IS APPROVED FOR SOIL EROSION AND SEDIMENT CONTROL BY THE HOWARD S.D.P.
John P. Blunt 10/5/89 DATE
APPROVED FOR HOWARD S.D. AND METS TECHNICAL SERVICES
James H. ... 10/5/89 DATE
BY SOIL CONSERVATION SERVICE

APPROVED: HOWARD COUNTY DEPT. OF PLANNING & ZONING
Howard Keith 12/12/89 DATE
MANAGING DIRECTOR
Mark J. ... 12/12/89 DATE
CHIEF, DIVISION OF COMMUNITY PLANNING & LAND DEVELOPMENT
APPROVED FOR PUBLIC WATER & PUBLIC SEWERAGE SYSTEMS
HOWARD COUNTY HEALTH DEPARTMENT
George M. Boyd 10-23-89 DATE
COUNTY HEALTH OFFICER
APPROVED FOR PUBLIC WATER, PUBLIC SEWER, STORM DRAINAGE SYSTEMS & PUBLIC ROADS
HOWARD COUNTY DEPT. OF PUBLIC WORKS
James ... 10/30/89 DATE
DIRECTOR
... 10/30/89 DATE
CHIEF BUREAU OF ENGINEERING

CERTIFICATION BY DEVELOPER
I CERTIFY THAT ALL DEVELOPMENT AND/OR CONSTRUCTION WILL BE DONE ACCORDING TO THIS PLAN OF DEVELOPMENT AND PLAN FOR EROSION & SEDIMENT CONTROL THAT ALL RESPONSIBLE PERSONNEL INVOLVED WITH THE CONSTRUCTION PROJECT WILL HAVE A CERTIFICATE OF ATTENDANCE AT A DEPT. OF NATURAL RESOURCES APPROVED TRAINING PROGRAM FOR THE CONTROL OF SEDIMENT & EROSION BEFORE BEGINNING THE PROJECT.
I ALSO AUTHORIZE PERIODIC ON-SITE INSPECTIONS BY THE HOWARD SOIL CONSERVATION DISTRICT OR THEIR AUTHORIZED AGENTS AS ARE DEEMED NECESSARY.
Ethan Grossman 9/1/89 DATE
SIGNATURE

CERTIFICATION BY ENGINEER
I CERTIFY THAT THIS PLAN OF DEVELOPMENT & PLAN FOR EROSION & SEDIMENT CONTROL REPRESENTS A PRACTICAL & WORKABLE PLAN BASED ON MY KNOWLEDGE OF THE SITE CONDITIONS & THAT IT WAS PREPARED IN ACCORDANCE WITH THE REQUIREMENTS OF THE HOWARD COUNTY SOIL CONSERVATION DISTRICT.
Walter Parr 9/1/89 DATE
SIGNATURE



OWNER AND DEVELOPER:
ETHAN GROSSMAN, TRUSTEE

M. & H. DEVELOPMENT ENGINEERS INC.
200 E. JOPPA ROAD
TOWSON, MD 21204
PH. 828-2060

SITE DEVELOPMENT PLAN
Lots 3 & 80 THRU 86
SIGNAL HILL
SEE PLAT # 7758 & 8736
6TH ELECTION DISTRICT
SCALE 1" = 30'
TAX MAP 42 PARCEL 7G
SHEET 1 OF 2
HOWARD COUNTY, MARYLAND
DATE MARCH 22, 1989
SEE OPZ FILL
S87-04 F8'
P87-20 F8'-6"
P88-10
AA 87-32
SDP 88-75
SDP 88-126
SDP 88-133

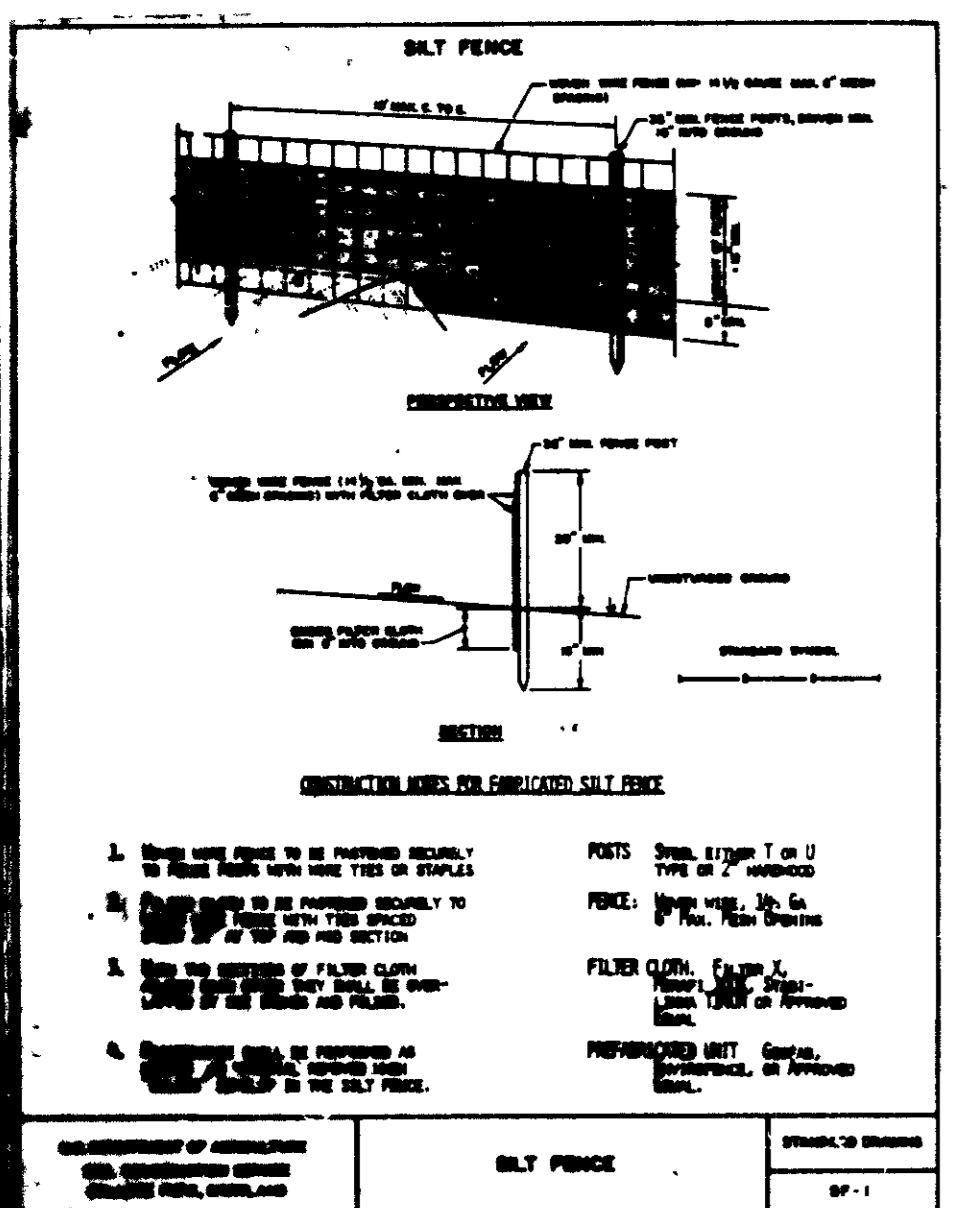
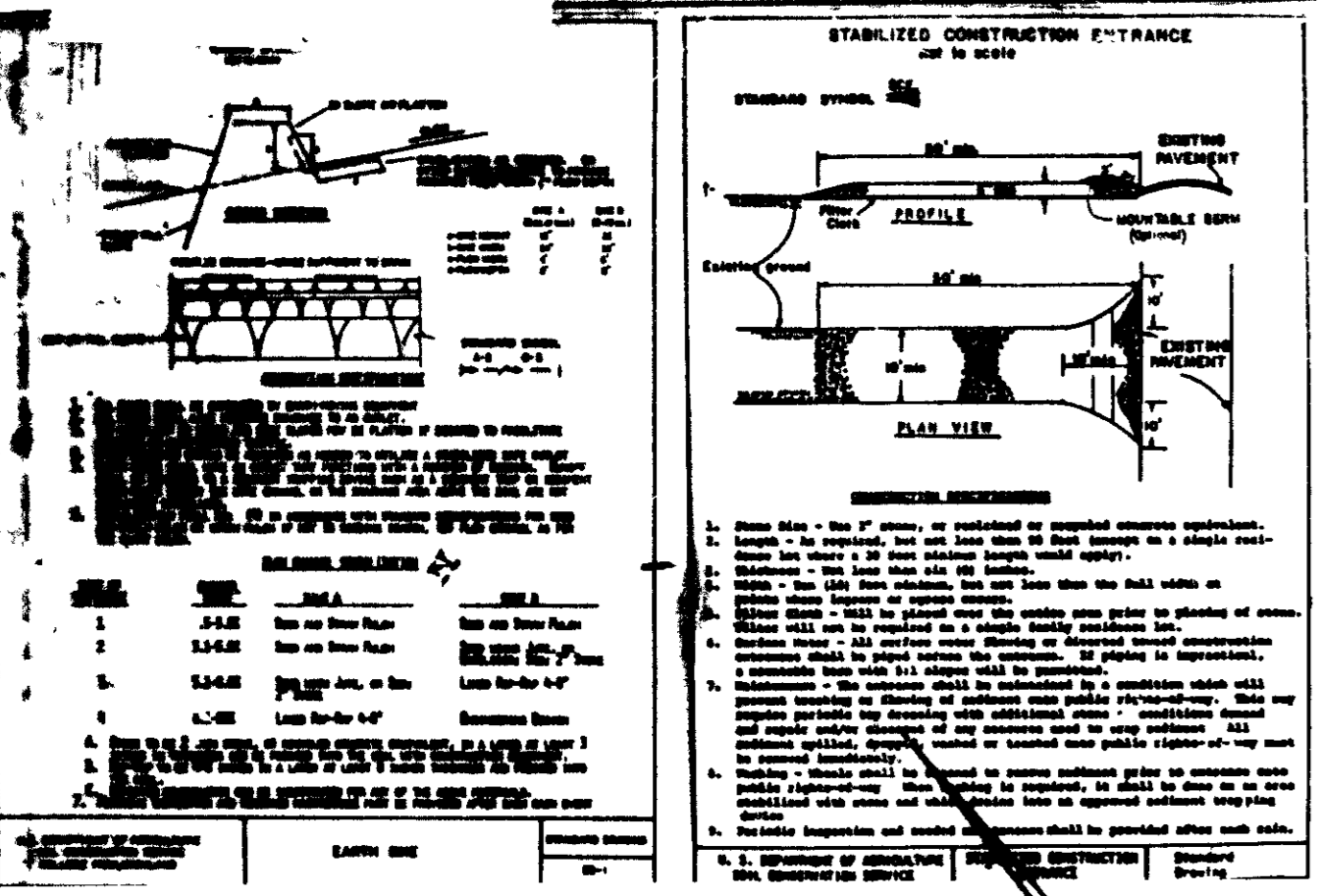

GENERAL NOTES

1. This plan is approved for soil erosion and sediment control.
2. The owner shall be responsible for the maintenance of all sediment control devices.
3. The owner shall be responsible for the removal of all sediment control devices upon completion of construction.
4. The owner shall be responsible for the repair of all sediment control devices if they become inoperative.
5. The owner shall be responsible for the maintenance of all sediment control devices.

THIS PLAN IS APPROVED FOR SOIL EROSION AND SEDIMENT CONTROL BY THE HOWARD COUNTY DEPT. OF PLANNING & ZONING.

[Signature] 10/5/89
 DATE

APPROVED FOR HOWARD S.C.D. AND W.P.S. TECHNICAL DEPARTMENT.

[Signature] 10/5/89
 DATE

APPROVED: HOWARD COUNTY DEPT. OF PLANNING & ZONING

[Signature] 12/12/89
 DATE

[Signature] 12/1/89
 DATE

APPROVED FOR PUBLIC WATER & PUBLIC SEWERAGE SYSTEMS
 HOWARD COUNTY HEALTH DEPARTMENT

[Signature] 10-23-89
 DATE

APPROVED FOR PUBLIC WATER, PUBLIC SEWER, STORM DRAINAGE SYSTEMS & PUBLIC ROADS
 HOWARD COUNTY DEPT. OF PUBLIC WORKS

[Signature] 10/20/89
 DATE

[Signature] 10-20-89
 DATE

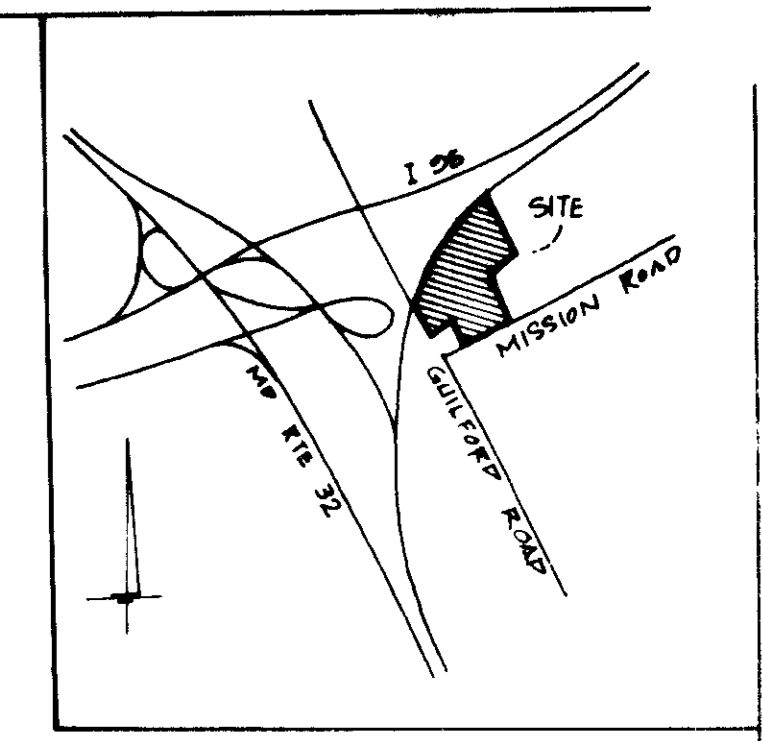
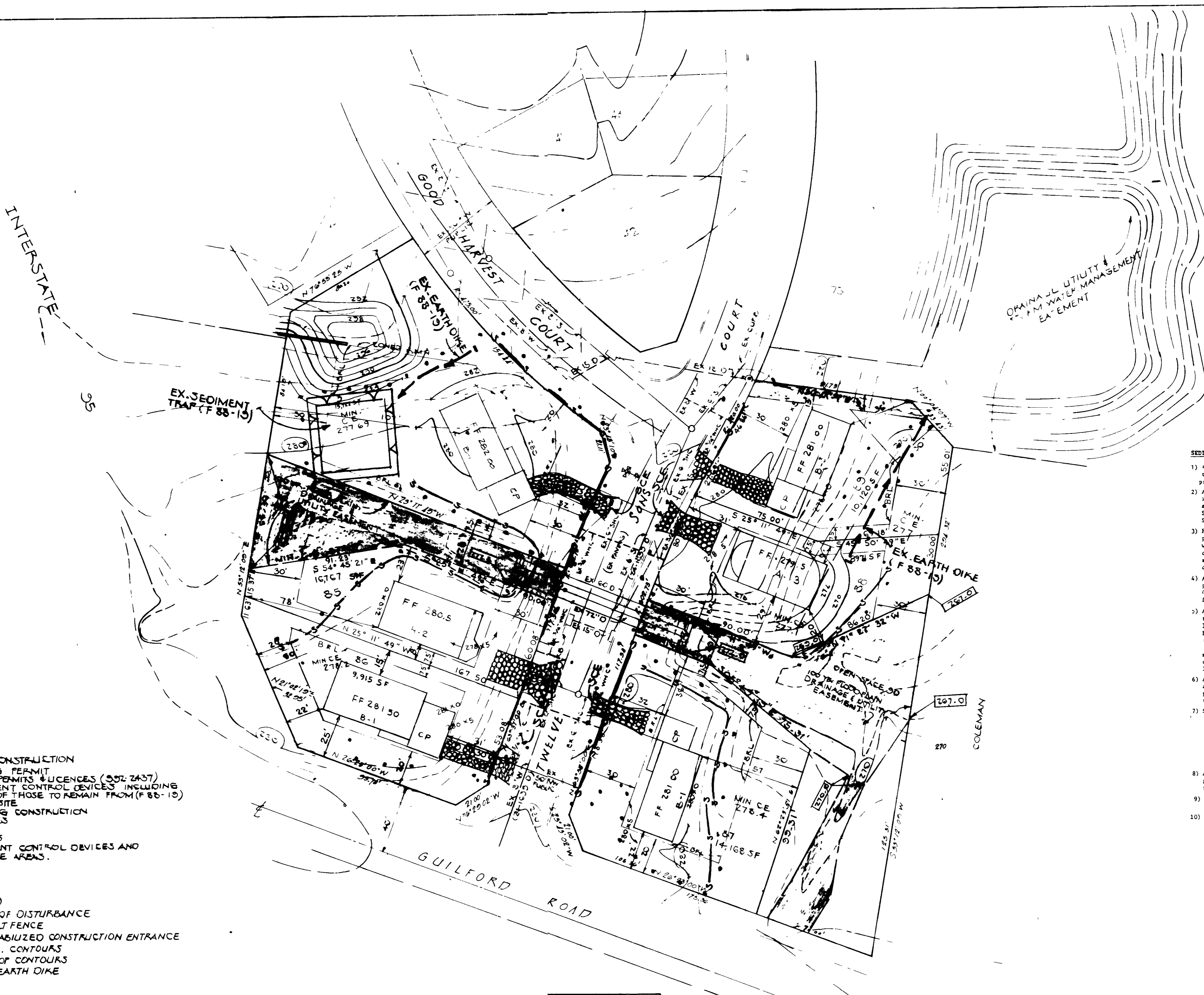

- SEQUENCE OF CONSTRUCTION**
1. OBTAIN GRADING PERMIT
 2. NOTIFY DEPT. OF PERMITS & LICENCES (302-2437)
 3. INSTALL SEDIMENT CONTROL DEVICES INCLUDING MAINTENANCE OF THOSE TO REMAIN FROM (F 88-10)
 4. ROUGH GRADE SITE
 5. BEGIN BUILDING CONSTRUCTION
 6. INSTALL UTILITIES
 7. STABILIZE SITE
 8. PAVE DRIVEWAYS
 9. REMOVE SEDIMENT CONTROL DEVICES AND STABILIZE THOSE AREAS.

- LEGEND**
- LIMIT OF DISTURBANCE
 - - - - - SILT FENCE
 - SCE STABILIZED CONSTRUCTION ENTRANCE
 - (---) EX. CONTOURS
 - PROP CONTOURS
 - EARTH OIKE

- SEDIMENT CONTROL NOTES**
- 1) A minimum of 24 hours notice must be given to the Howard County Office of Inspection and Permits prior to the start of any construction (992-2437)
 - 2) All vegetative and structural practices are to be installed according to the provisions of this plan and are to be in conformance with the 1983 MARYLAND STANDARDS AND SPECIFICATIONS FOR SOIL EROSION AND SEDIMENT CONTROL.
 - 3) Following initial soil disturbance or redistribution, permanent or temporary stabilization shall be completed within a) 7 calendar days for all perimeter sediment control structures, dikes, perimeter slopes and all slopes greater than 2:1; b) 14 days for all other disturbed or graded areas on the project site.
 - 4) All sediment traps/basins shown must be fenced and warning signs posted around their perimeter in accordance with Vol. 1, Chapter 12, of the HOWARD COUNTY DESIGN MANUAL, Storm Drainage.
 - 5) All disturbed areas must be stabilized within the time period specified above in accordance with the 1983 MARYLAND STANDARDS AND SPECIFICATIONS FOR SOIL EROSION AND SEDIMENT CONTROL for permanent seedings (Sec. 31) and (Sec. 54), temporary seeding (Sec. 50) and mulching (Sec. 52). Temporary stabilization with mulch alone can only be done when recommended seedling dates do not allow for proper germination and establishment of grasses.
 - 6) All sediment control structures are to remain in place and are to be maintained in operative condition until permission for their removal has been obtained from the Howard County Sediment Control Inspector.
 - 7) Site Analysis

Total Area of Site	6.4 Acres
Area Disturbed	6.4 Acres
Area to be roofed or paved	1.1 Acres
Area to be vegetatively stabilized	4.7 Acres
Total Cut	6500 Cu. yds
Total Fill	6500 Cu. yds
Offsite waste/borrow area location	NA
 - 8) Any sediment control practice which is disturbed by grading activity for placement of utilities must be repaired on the same day of disturbance.
 - 9) Additional sediment controls must be provided, if deemed necessary by the Howard County DPW sediment control inspector.
 - 10) On all sites with disturbed areas in excess of 2 acres, approval of the inspection agency shall be requested upon completion of installation of perimeter erosion and sediment control, but before proceeding with any other earth disturbance or grading. Other building or grading inspection approvals may not be authorized until this initial approval by the inspection agency is made.

CERTIFICATION BY DEVELOPER

I CERTIFY THAT ALL DEVELOPMENT AND/OR CONSTRUCTION WILL BE DONE ACCORDING TO THIS PLAN OF DEVELOPMENT AND PLAN FOR EROSION & SEDIMENT CONTROL THAT ALL RESPONSIBLE PERSONNEL INVOLVED WITH THE CONSTRUCTION PROJECT WILL HAVE A CERTIFICATE OF ATTENDANCE AT A DEPT. OF NATURAL RESOURCES APPROVED TRAINING PROGRAM FOR THE CONTROL OF SEDIMENT & EROSION BEFORE BEGINNING THE PROJECT.

I ALSO AUTHORIZE PERIODIC ONSITE INSPECTIONS BY THE HOWARD SOIL CONSERVATION DISTRICT OR THEIR AUTHORIZED AGENTS AS ARE DEEMED NECESSARY.

 SIGNATURE

 DATE

CERTIFICATION BY ENGINEER

I CERTIFY THAT THIS PLAN OF DEVELOPMENT & PLAN FOR EROSION & SEDIMENT CONTROL REPRESENTS A PRACTICAL & WORKABLE PLAN BASED ON MY KNOWLEDGE OF THE SITE CONDITIONS & THAT IT WAS PREPARED IN ACCORDANCE WITH THE REQUIREMENTS OF THE HOWARD COUNTY SOIL CONSERVATION DISTRICT.

[Signature]
 DATE 6/6/89

OWNER AND DEVELOPER:

ETHAN GROSSMAN, TRUSTEE
 732-2052

M. & H. DEVELOPMENT ENGINEERS INC.
 200 E. JOPPA ROAD
 TOWSON, MD 21204
 PH. 828-5000

1-10-89

SEDIMENT CONTROL PLAN

LOTS 2 & 3 OF TRACT 20
 SIGNAL HILL PLAT TWO

SEE PLAT # 7758 & 8736
 6TH ELECTION DISTRICT

SCALE 1" = 30'

DATE: MARCH 22, 1988
 S.D.P. 88-248