

DRIVEWAY ABUTTING CLOSED SECTION WITHOUT CONCRETE SIDEWALK

DRIVEWAY ABUTTING CLOSED SECTION WITH STD 7" COMB CURB & GUTTER & SIDEWALK SET BACK FROM CURB

| LOT NO | STREET ADDRESS          |
|--------|-------------------------|
| 279    | 2901 CYPRESS BAY COURT  |
| 280    | 2905 CYPRESS BAY COURT  |
| 281    | 2909 CYPRESS BAY COURT  |
| 282    | 2913 CYPRESS BAY COURT  |
| 283    | 2917 CYPRESS BAY COURT  |
| 284    | 2921 CYPRESS BAY COURT  |
| 285    | 2925 CYPRESS BAY COURT  |
| 286    | 2930 CYPRESS BAY COURT  |
| 287    | 2935 Pebble Beach Drive |
| 288    | 2940 Pebble Beach Drive |

**GENERAL NOTES:**

- The land included is zoned R-20 per 8-2-85 Comprehensive Zoning Plan
- Coordinates are based on Md State Grid System, and projected from Howard County Monuments 3440001 & 3440002
- All roads are public & existing
- Any damage to county owned rights-of-way shall be corrected at the Developer's expense
- Total area included 9.007Ac
- Total number of lots 20
- The contractor or the developer shall contact the Construction Inspection/Survey Division 24 hrs in advance of commencement of work at 792-2630
- Maximum building coverage is 30%
- Reference file numbers SB-20, P87-29; P88-33

| NO | REVISION   | DATE    |
|----|--|---------|
| 1  | Raise fees & rev grids on Lots 281, 282, 284, 287 & 288 Moved house forward on 287 | 3-30-88 |

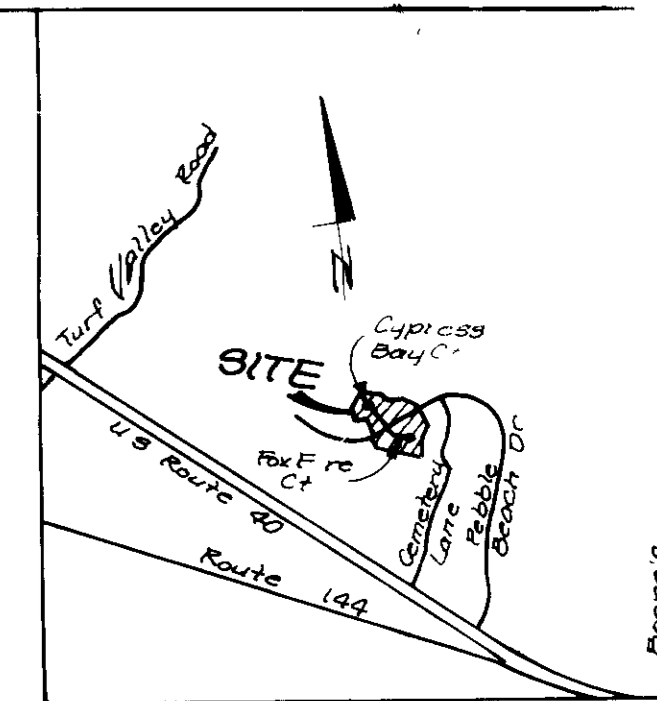

**LEGEND**

- Contour Interval: 2 FT
- Existing Contour: [Symbol]
- Proposed Contour: [Symbol]
- Spot Elevation: +10'
- Direction of Drainage: [Symbol]
- Walk out Basement: [Symbol]
- Trees to be Saved: [Symbol]

**SPECIAL NOTES:**

- Approved Road Construction Plans shall be used for all public utilities
- Public water & sewer shown for reference only For more detailed information see water & sewer plans Contract No 24-1676-D
- The water & sewer house connections not included in a 'Developer's Agreement' shall conform to Howard County Plumbing Code The onsite WHC shall be 1" copper and the SHC shall be 4" iron
- For flag or pipe stem lots, refuse collection, snow removal and road maintenance to be provided at the junction of flag or pipe stem and the road R/W and not onto flag or pipe stem driveway

NOTE Existing topo was field run by Clark, FineFrock & Sackett, Inc on 3.3.88

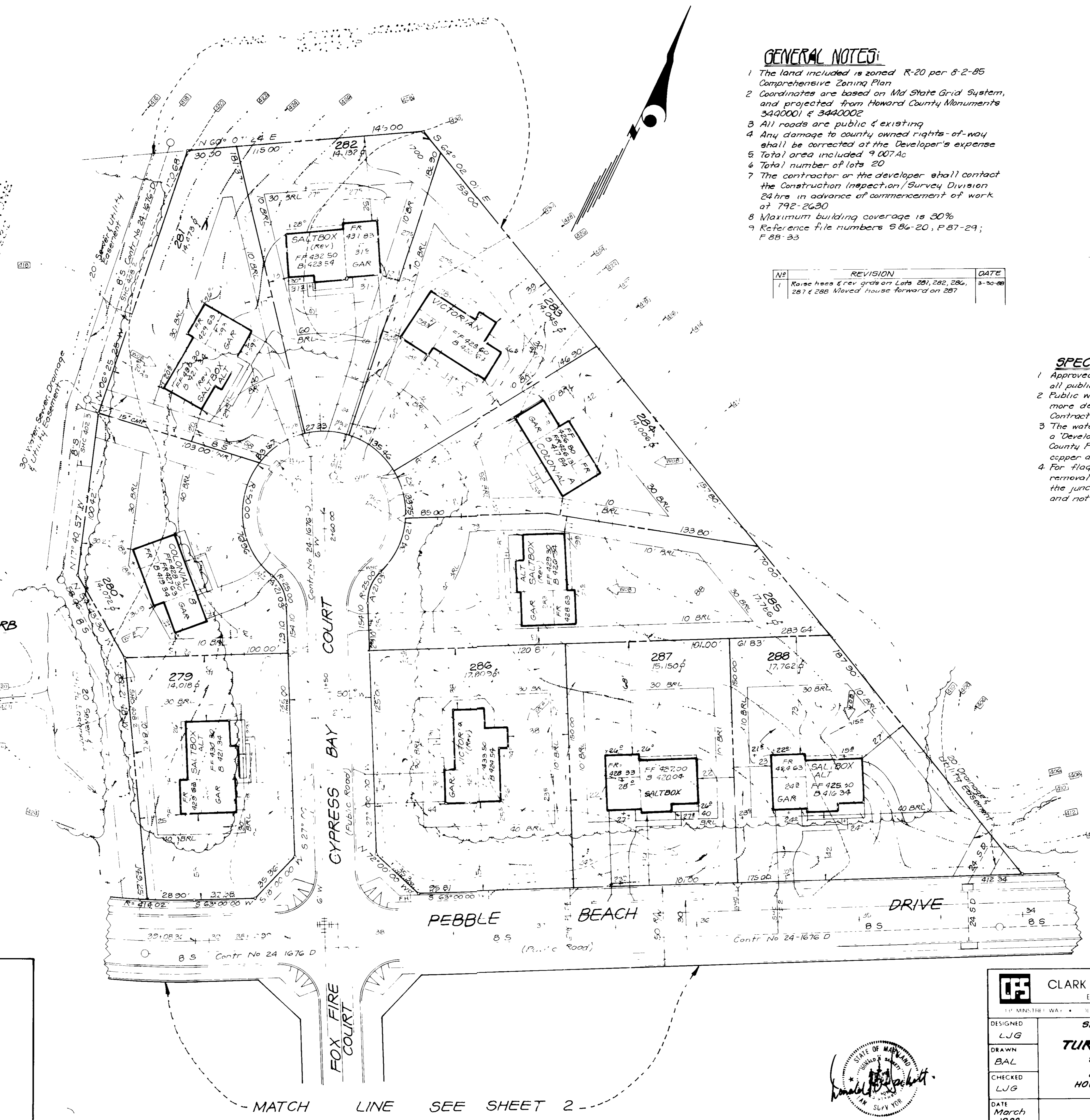

|                      |     |         |
|----------------------|-----|---------|
| Turf Valley Overlook | 2/1 | 188-197 |
| 7635                 | 24  | R-20    |
| 16                   | 2nd | 6021    |
| H: 07                |     | 5992000 |

APPROVED FOR PUBLIC WATER AND PUBLIC SEWERAGE SYSTEMS  
HOWARD COUNTY HEALTH DEPARTMENT

APPROVED HOWARD COUNTY OFFICE OF PLANNING & ZONING

APPROVED FOR PUBLIC WATER AND PUBLIC SEWERAGE STORM DRAINAGE SYSTEMS AND PUBLIC ROADS  
HOWARD COUNTY DEPARTMENT OF PUBLIC WORKS

4-7-88

**CLARK • FINEFROCK & SACKETT, INC**  
ENGINEERS • PLANNERS • SURVEYORS

DESIGNED LUG  
DRAWN BAL  
CHECKED LUG

**SITE DEVELOPMENT PLAN**  
LOTS 188-197 & 279-288  
**TURF VALLEY OVERLOOK**  
SECTION 2 AREA 1  
2ND ELECTION DISTRICT  
HOWARD COUNTY, MARYLAND

SCALE 1" = 30'  
DRAWING 1st 5  
JOB NO 86-121  
FILE NO 86-121 X

DATE March 1988  
FOR FIRETTI BLDGS, Inc  
10904 Baltimore W. Chona? Pike  
Ellicott City, Maryland 21043

SDP-88-161



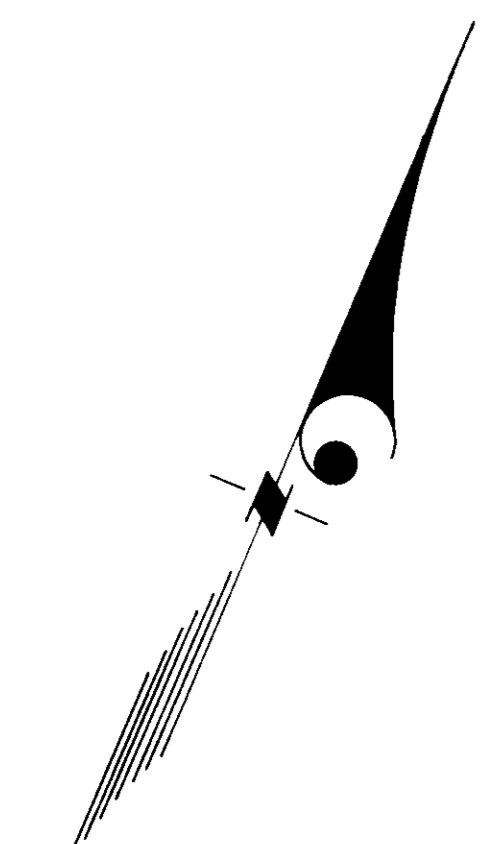

MATCH LINE SEE SHEET 1

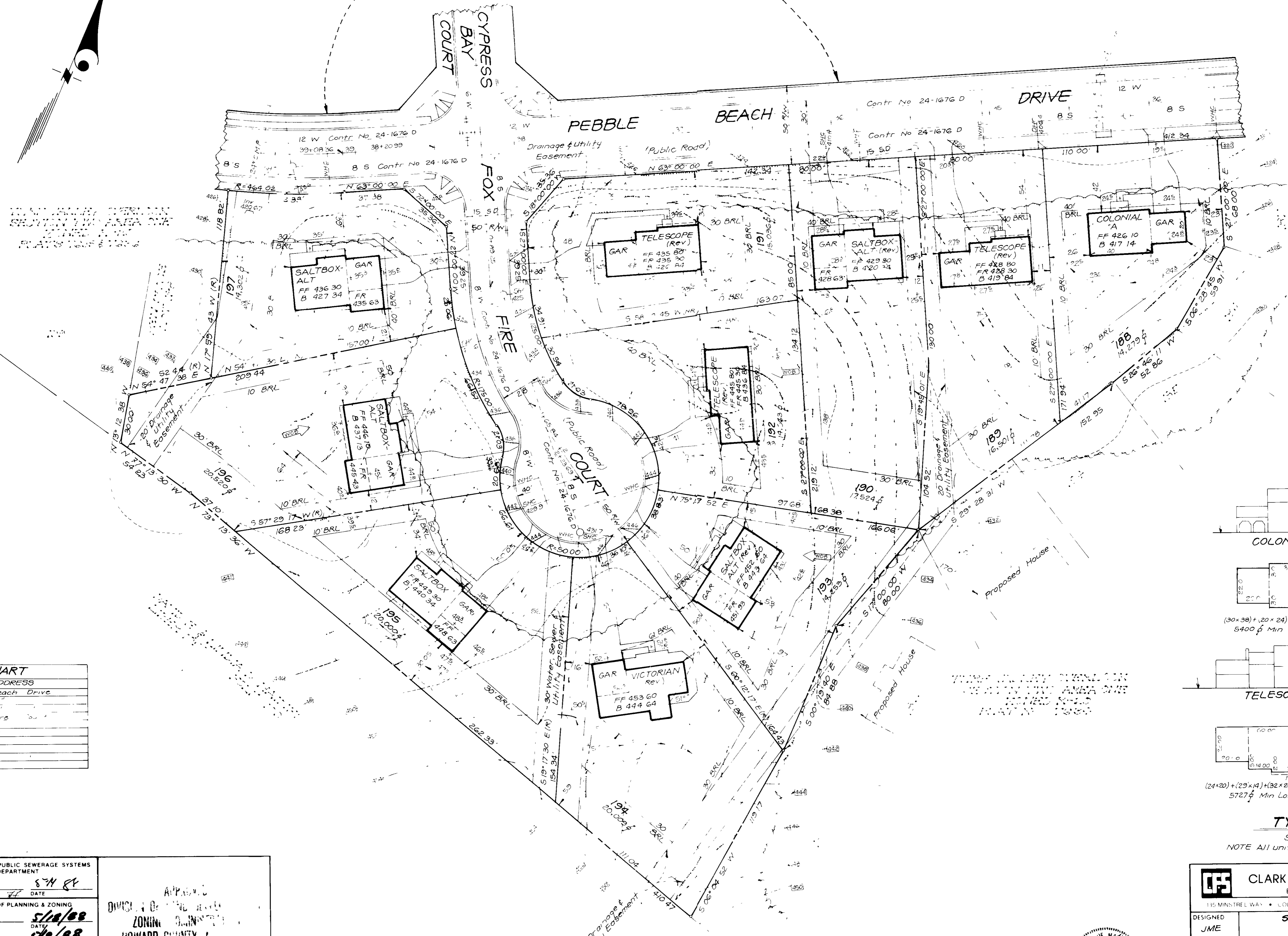

| LOT NO | STREET ADDRESS          |
|--------|-------------------------|
| 188    | 2946 Pebble Beach Drive |
| 189    | 2942                    |
| 190    | 2938                    |
| 191    | 2903 Fox Fire           |
| 192    | 2907                    |
| 193    | 2911                    |
| 194    | 2914                    |
| 195    | 2910                    |
| 196    | 2906                    |
| 197    | 2902                    |

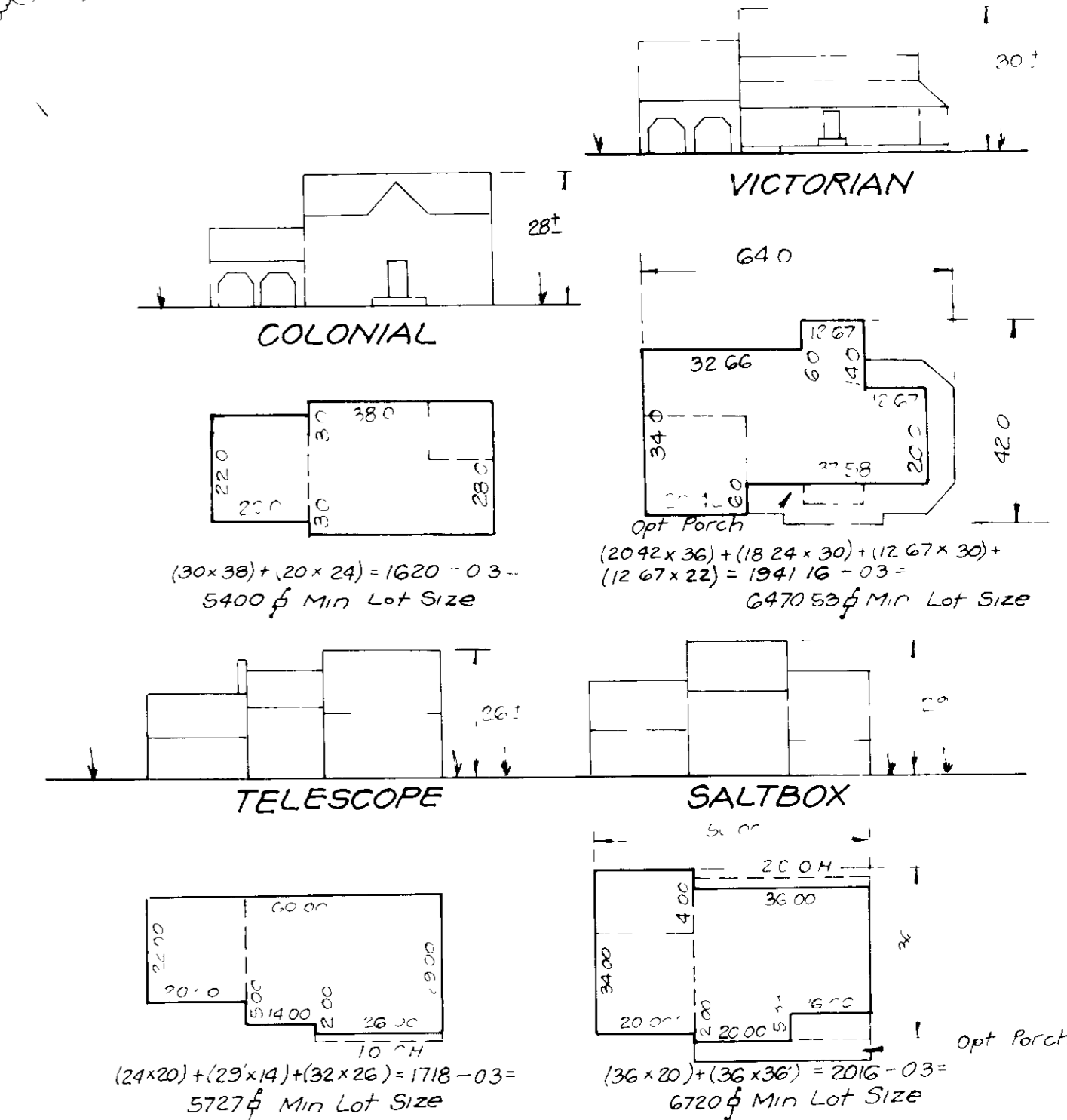

**TYPICAL HOUSES**

Scale 1" = 30'  
NOTE All units have 1 roof eaves front & rear

APPROVED FOR PUBLIC WATER AND PUBLIC SEWERAGE SYSTEMS  
HOWARD COUNTY HEALTH DEPARTMENT

APPROVED HOWARD COUNTY OFFICE OF PLANNING & ZONING

APPROVED FOR PUBLIC WATER AND PUBLIC SEWERAGE  
STORM DRAINAGE SYSTEMS AND PUBLIC ROADS  
HOWARD COUNTY DEPARTMENT OF PUBLIC WORKS

APPROVED  
DIVISION OF PLANNING & ZONING  
HOWARD COUNTY, MARYLAND  
DATE 4-7-88

**CLARK • FINEFROCK & SACKETT, INC**  
ENGINEERS • PLANNERS • SURVEYORS

115 MINNISTREL WAY • COLUMBIA, MD 21047 • (410) 261-2100 • BAL • S • M • D

|                       |   |   |                     |
|-----------------------|---|---|---------------------|
| DESIGNED<br>JME       | <b>SITE DEVELOPMENT PLAN</b><br>LOTS 188-197 & 279-288<br><b>TURF VALLEY OVERLOOK</b><br>SECTION 2 AREA 1<br>2nd ELECTION DISTRICT<br>HOWARD COUNTY, MARYLAND | SCALE<br>1" = 30'   |                     |
| DRAWN<br>BAL          |   | DRAWING<br>2 OF 5   |                     |
| CHECKED<br>LWG        |   | JOB NO<br>86-121  |                     |
| DATE<br>February 1988 |   | FOR FIRETTI ELDERS, Inc<br>10304 Baltimore National Pike<br>Ellicott City, Maryland 21043 | FILE NO<br>86-121 X |
|                       |   |   | SDP-88-161          |

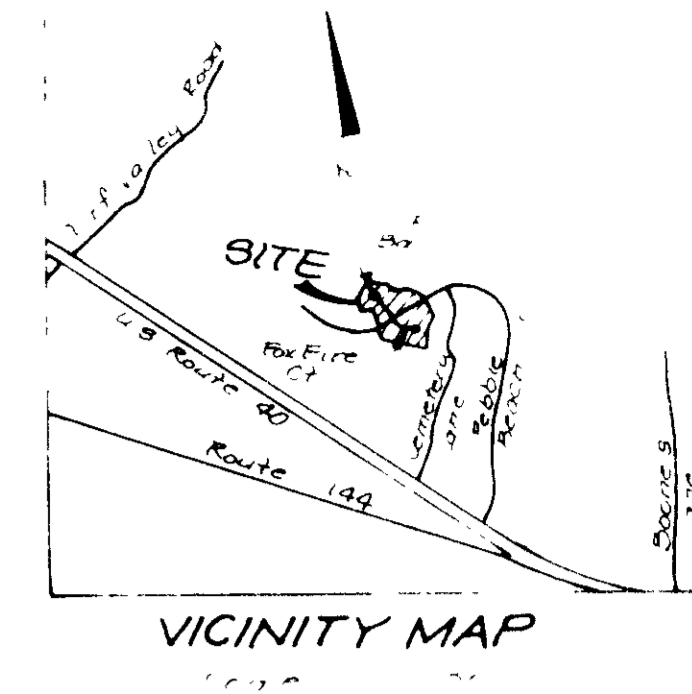

**LEGEND**

- Contour Interval
- Existing Contour
- Proposed Contour
- Spot Elevation
- Direction of Drainage
- Walk out Basement
- Trees to be Saved
- Existing Trees
- Strawbale Dike/Silt Fence
- Stabilized Construction Entrance
- Earth Dike
- Inlet Protection Dike

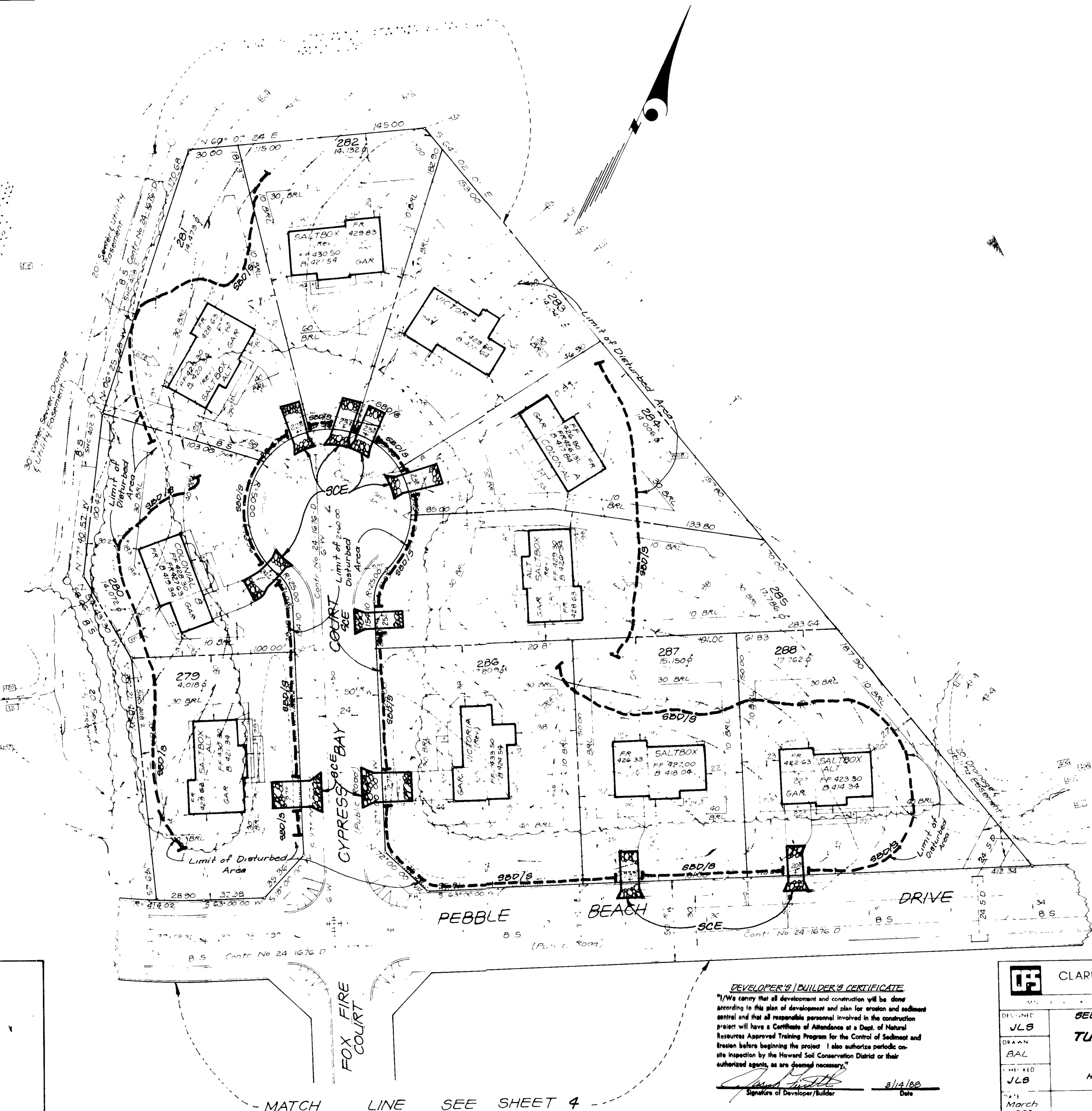

Reviewed for Howard Name S.C.D.  
and meets Technical Requirements  
Signature \_\_\_\_\_ Date \_\_\_\_\_  
U.S. Soil Conservation Service

THIS DEVELOPMENT PLAN IS APPROVED FOR SOIL EROSION AND SEDIMENT CONTROL BY THE HOWARD SOIL CONSERVATION DISTRICT.

*Stephen J. Miller* 4/21/88  
Approved Date

NOTE: Existing road was for utility work. Fire Frock & Sackett, Inc. 3/2/88

**ENGINEER'S CERTIFICATE**

I hereby certify that this plan for Erosion and Sediment Control represents a practical and workable plan based on my personal knowledge of the site conditions and that it was prepared in accordance with the requirements of the Howard Soil Conservation District.

*G. Nelson Clark* 4/21/88  
G. Nelson Clark  
Professional Engineer  
No. 7180  
Professional Engineer

APPROVED FOR PUBLIC WATER AND PUBLIC SEWERAGE SYSTEMS  
HOWARD COUNTY HEALTH DEPARTMENT  
DATE 5/14/88  
APPROVED HOWARD COUNTY OFFICE OF PLANNING & ZONING  
DATE 5/18/88  
APPROVED FOR PUBLIC WATER AND PUBLIC SEWERAGE  
STORM DRAINAGE SYSTEMS AND PUBLIC ROADS  
HOWARD COUNTY DEPARTMENT OF PUBLIC WORKS  
DATE 5-10-88

APPROVED  
DIVISION OF LAND USE PLANNING ADMINISTRATION  
HOWARD COUNTY, M.D.  
DATE 4-7-88

**DEVELOPER'S/BUILDER'S CERTIFICATE**

"I/We certify that all development and construction will be done according to this plan of development and plan for erosion and sediment control and that all responsible personnel involved in the construction project will have a Certificate of Attendance at a Dept. of Natural Resources Approved Training Program for the Control of Sediment and Erosion before beginning the project. I also authorize periodic on-site inspection by the Howard Soil Conservation District or their authorized agents, as are deemed necessary."

*Frank J. Sackett* 4/14/88  
Signature of Developer/Builder Date

|   |   |
|---|---|
| <b>CLARK • FINEFROCK &amp; SACKETT INC.</b> |   |
| DESIGNED<br><b>JLB</b>                      | <b>SEDIMENT EROSION CONTROL PLAN</b>  |
| DRAWN<br><b>BAL</b>                         | <b>LOTS 188-197 &amp; 279-288</b>   |
| CHECKED<br><b>JLB</b>                       | <b>TURF VALLEY OVERLOOK</b>   |
| DATE<br>March 1988                          | <b>SECTION 2 AREA 1</b>   |
|   | <b>2ND ELECTION DISTRICT</b>  |
|   | <b>HOWARD COUNTY, MARYLAND</b>  |
|   | FOR FIRETTI BLOIS, Inc.<br>10304 Baltimore National Pike<br>Clifford City, Maryland 21043 |

MATCH LINE SEE SHEET 4

SDP-88-161

MATCH LINE SEE SHEET 3

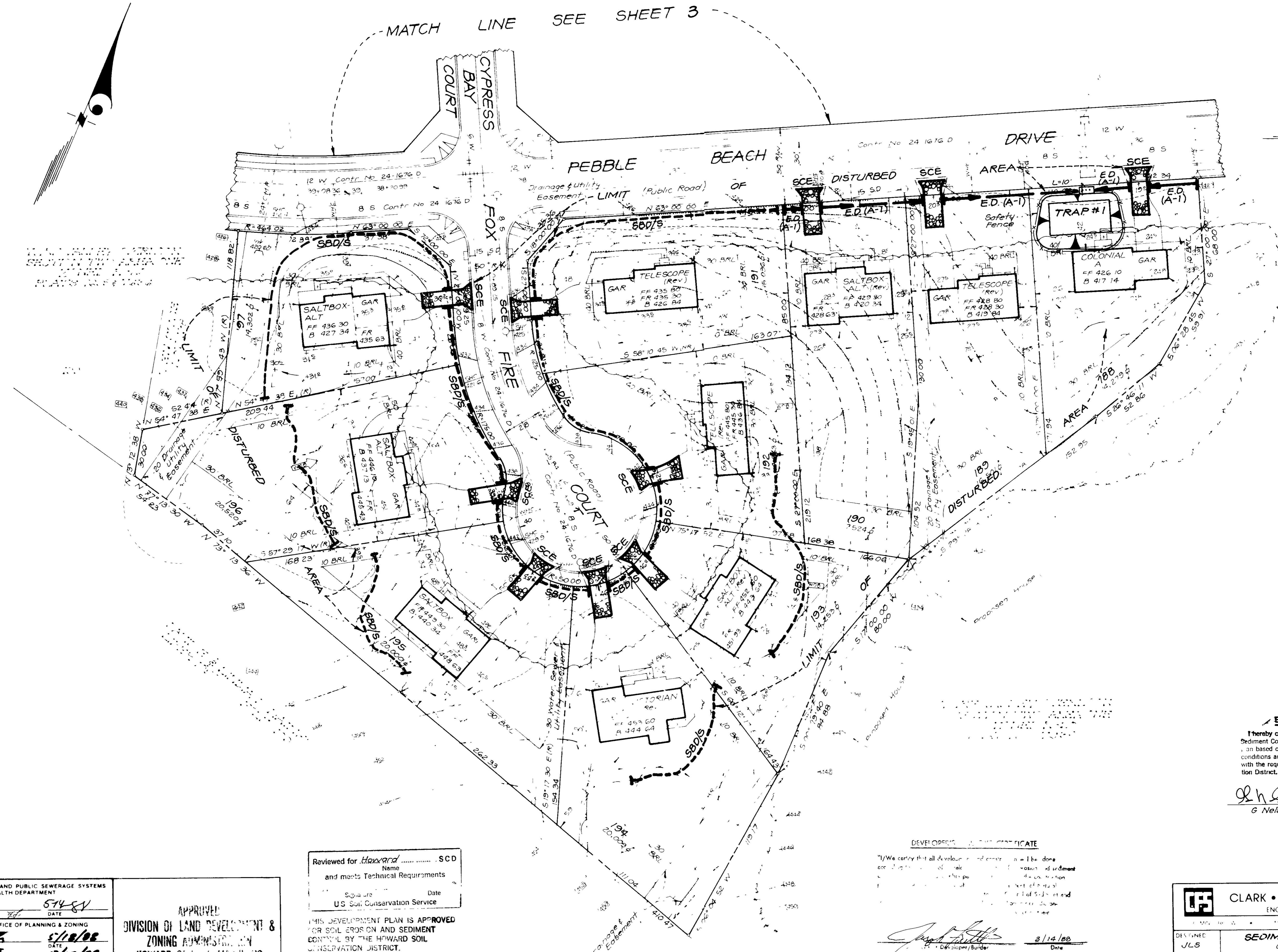
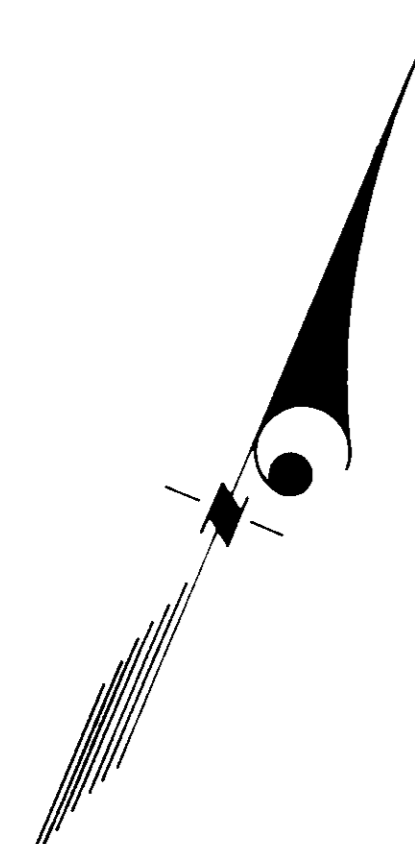

**TRAP No. 1 SOST ST V \***

Drainage Area .25 Acres  
 Storage Required 25x1800 = 4500 cf  
 Storage Provided 4500 cf  
 Depth 4'  
 Top of Stone Crest 420.0  
 Bottom Elevation 415.0  
 Cleanout Elevation 417.0  
 Bottom Dimension 41'x20'  
 \* 1:1 Side Slopes in cut

**ENGINEER'S CERTIFICATE**

I hereby certify that this plan for Erosion and Sediment Control represents a practical and workable plan based on my personal knowledge of the site conditions and that it was prepared in accordance with the requirements of the Howard Soil Conservation District.

*G. Nelson Clark*  
 G. Nelson Clark  
 Date 2-11-88



**DEVELOPER'S CERTIFICATE**

I/We certify that all development and construction will be done in accordance with the erosion and sediment control plan shown on this drawing and that the construction will be done in accordance with the requirements of the Howard Soil Conservation District.

*Joseph Smith*  
 Joseph Smith  
 Date 2/14/88

APPROVED FOR PUBLIC WATER AND PUBLIC SEWERAGE SYSTEMS  
 HOWARD COUNTY HEALTH DEPARTMENT  
 COUNTY HEALTH OFFICER  
 DATE 5/14/88

APPROVED HOWARD COUNTY OFFICE OF PLANNING & ZONING  
 PLANNING DIRECTOR  
 DATE 5/14/88

APPROVED FOR PUBLIC WATER AND PUBLIC SEWERAGE  
 STORM DRAINAGE SYSTEMS AND PUBLIC ROADS  
 HOWARD COUNTY DEPARTMENT OF PUBLIC WORKS  
 DIRECTOR  
 DATE 5/14/88

APPROVED  
 DIVISION OF LAND DEVELOPMENT &  
 ZONING ADMINISTRATION  
 HOWARD COUNTY, MARYLAND  
 DATE 4-7-88

Reviewed for Howard County SCD  
 Name  
 and meets Technical Requirements  
 Signature Date  
 U.S. Soil Conservation Service

THIS DEVELOPMENT PLAN IS APPROVED  
 FOR SOIL EROSION AND SEDIMENT  
 CONTROL BY THE HOWARD SOIL  
 CONSERVATION DISTRICT.  
*Stephen F. Martin*  
 Approved Date 4/22/88

|   |  |                      |
|---|--|----------------------|
| <b>CLARK • FINEROCK &amp; SACKETT, INC.</b><br>ENGINEERS • PLANNERS • SURVEYORS |  |                      |
| DESIGNED<br>JLS   | <b>SEDIMENT &amp; EROSION CONTROL PLAN</b><br>LOTS 188-197 & 279-288<br><b>TURF VALLEY OVERLOOK</b><br>SECTION 2 AREA 1<br>2ND ELECTION DISTRICT,<br>HOWARD COUNTY, MARYLAND | SCALE<br>1" = 30'    |
| DRAWN<br>BAL  |  | DRAWING<br>4 OF 5    |
| CHECKED<br>JLS  |  | JOB NO.<br>86-121    |
| DATE<br>March 1988  | FOR FRETTE ELDERS, Inc<br>2304 Baltimore National Pike<br>Ellicott City, Maryland 21043  | FILE NO.<br>86-1218E |

**CONSTRUCTION SEQUENCE**

|  | NO. of Days |
|--|-------------|
| 1 Obtain grading permit  | 7           |
| 2 Install sediment & erosion control measures  | 30          |
| 3 Clear & rough grade site   | 60          |
| 4 Construct house, driveways & walks except on lot 188   | 120         |
| 5 Fine grade & stabilize all disturbed areas on site in accordance with state specs                      | 30          |
| 6 Upon approval of Sediment Control Inspector remove sediment & erosion control measures & stabilize     | 14          |
| 7 Install straw bale dikes/silt fence and construct house, driveway & walk on lot 188                    | 30          |
| 8 Fine grade & stabilize area disturbed on lot 188   | 14          |
| 9 Upon approval of the Sediment Control Inspector remove sediment & erosion control measures & stabilize | 14          |

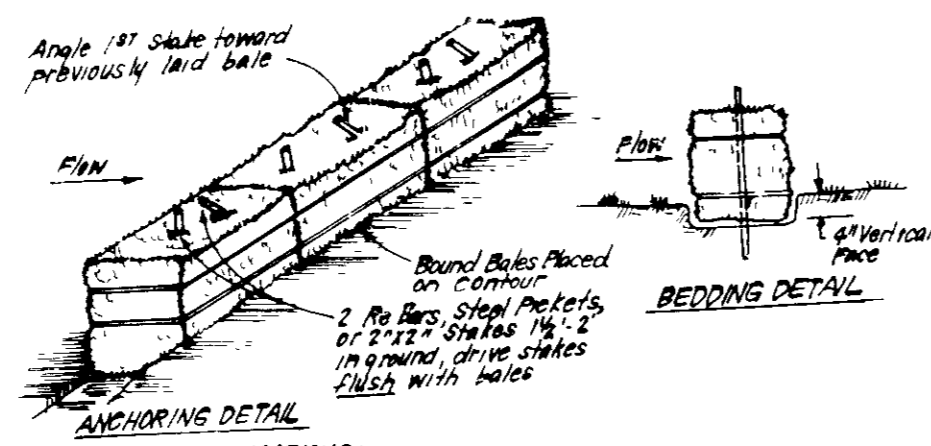

**CONSTRUCTION SPECIFICATIONS:**  
 1. Bales shall be placed at the top of a slope or on the contour and in a row with ends tightly abutting the adjacent bales.  
 2. Each bale shall be embedded in the soil a min. of 4" and placed so the bindings are horizontal.  
 3. Bales shall be securely anchored in place by either 2 stakes or re bars driven thru the bale. The 1st stake in each bale shall be driven thru the preexisting hole and the 2nd stake shall be driven thru the bale.  
 4. Inspection shall be frequent and repair replacement shall be made promptly as needed.  
 5. Bales shall be removed when they have served their usefulness so as not to block or impede storm flow or drainage.

**STRAW BALE DIKE DETAIL (SBD)**

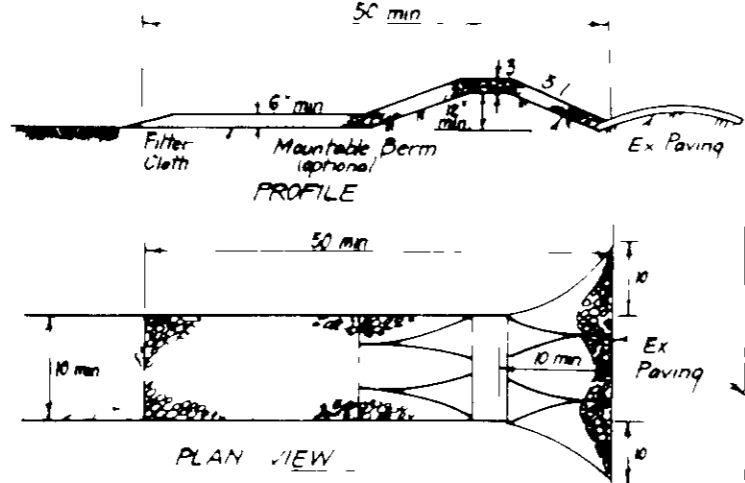

**CONSTRUCTION SPECIFICATIONS:**  
 1. Stone size: Use 2" stone or smaller for reduced concrete equivalent.  
 2. Length: As long as possible, but not less than 12" in a single residence.  
 3. Thickness: Not less than 6" when stone is 2" or larger.  
 4. Width: Not less than 12" when stone is 2" or larger.  
 5. Filter Cloth: A filter cloth shall be placed over the entire area prior to placing of stone. Filter cloth shall be secured to a single family residence.  
 6. Surface Water: All surface water flowing or spilled toward construction entrances shall be piped across the entrance. If piping is impractical, a mound side berm with 3" steps will be permitted.  
 7. Maintenance: The entrance shall be maintained in a condition which will prevent tracking or flowing of sediment onto public rights of way. This may require periodic watering, with additional water for concrete demand and repair work or clearing of any material used to trap sediment. All sediment applied, dropped, washed or tracked onto public rights of way must be removed immediately.  
 8. Weeping: Weeds shall be cleared to remove sediment prior to entrance onto public rights of way. When weeding is required, it shall be done on an area stabilized with stone and which drains into an approved treatment trapping device.  
 9. Periodic inspection and required maintenance shall be provided after each rain.

**STABILIZED CONSTRUCTION ENTRANCE (SCE)**

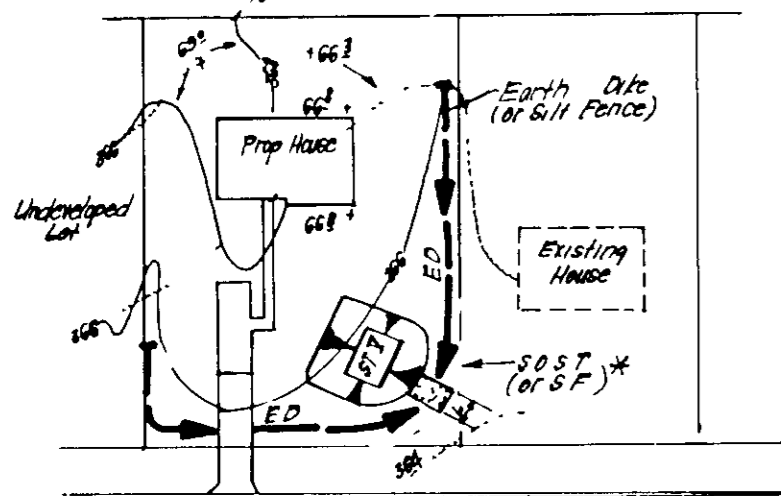

| LOT SIZE   | NO. OF STONES | NO. OF FILTER CLOTHS |
|------------|---------------|----------------------|
| 1/2 Acre   | 100           | 1                    |
| 3/4 Acre   | 150           | 1                    |
| 1 Acre     | 200           | 1                    |
| 1 1/4 Acre | 250           | 1                    |
| 1 1/2 Acre | 300           | 1                    |
| 2 Acre     | 400           | 1                    |
| 3 Acre     | 500           | 1                    |
| 4 Acre     | 600           | 1                    |
| 5 Acre     | 700           | 1                    |
| 6 Acre     | 800           | 1                    |
| 7 Acre     | 900           | 1                    |
| 8 Acre     | 1000          | 1                    |
| 9 Acre     | 1100          | 1                    |
| 10 Acre    | 1200          | 1                    |

**SINGLE LOT SEDIMENT CONTROL PLAN**

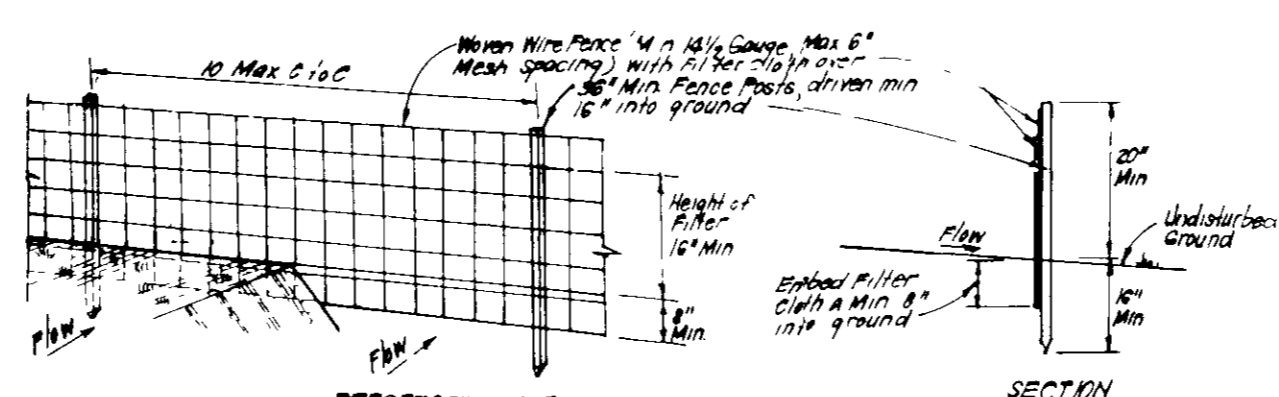

**CONSTRUCTION SPECIFICATIONS:**  
 1. Weep wire fence to be installed securely to fence posts with wire tied to staples.  
 2. Filter cloth to be fastened securely to weep wire fence with ties spaced every 30" at top and mid section.  
 3. When 2 sections of filter cloth meet, each other they shall be interlaced by 6" and stapled.  
 4. Maintenance shall be performed as needed and material removed when it impedes development in silt fence.

**SILT FENCE DETAIL (S)**

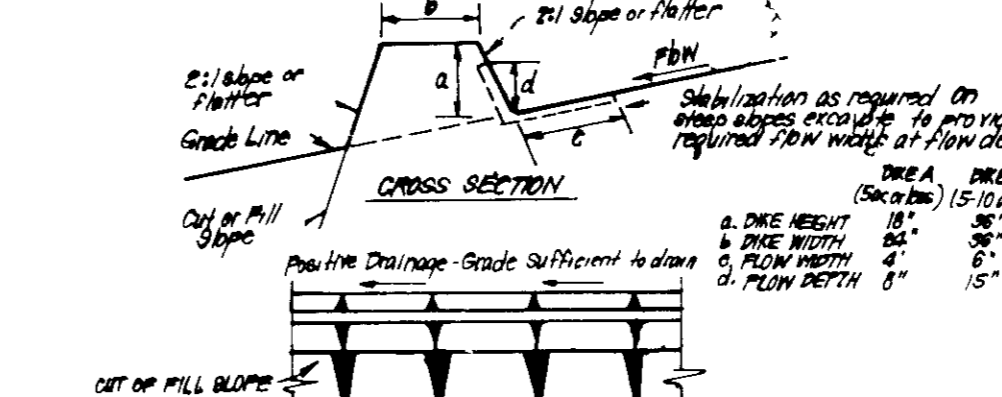

**CONSTRUCTION SPECIFICATIONS:**  
 1. All dikes shall be constructed by earth moving equipment.  
 2. All dikes shall have positive drainage to an outlet.  
 3. Dip north may be wider and side slopes may be flatter if desired to facilitate crossing by construction traffic.  
 4. Field location should be adjusted as needed to utilize a stabilized slope without disturbing adjacent areas.  
 5. Earth dikes shall have an outlet that functions with a minimum of erosion. Runoff shall be conveyed to a sediment trapping device such as a sediment trap or sediment basin where it enters the drainage area above the dike and not directly into the stream.  
 6. Sediment traps shall be (A) in accordance with standard specifications for seed and straw mulch or straw mulch (B) in accordance with standard specifications for seed and straw mulch or straw mulch (C) in accordance with standard specifications for seed and straw mulch or straw mulch (D) in accordance with standard specifications for seed and straw mulch or straw mulch.

| TYPE OF TREATMENT | CHANNEL GRADE | DIKE A                 | DIKE B                 |
|-------------------|---------------|------------------------|------------------------|
| 1                 | 15-20%        | Seed/Straw Mulch       | Seed/Straw Mulch       |
| 2                 | 5-10%         | Seed/Straw Mulch       | Seed/Straw Mulch       |
| 3                 | 5-10%         | Seed/Straw Mulch       | Seed/Straw Mulch       |
| 4                 | 1-20.0%       | Lined Rip Rap 4' Stone | Lined Rip Rap 4' Stone |

**FLOW CHANNEL STABILIZATION**

**EARTH DIKE DETAIL (E.D.)**

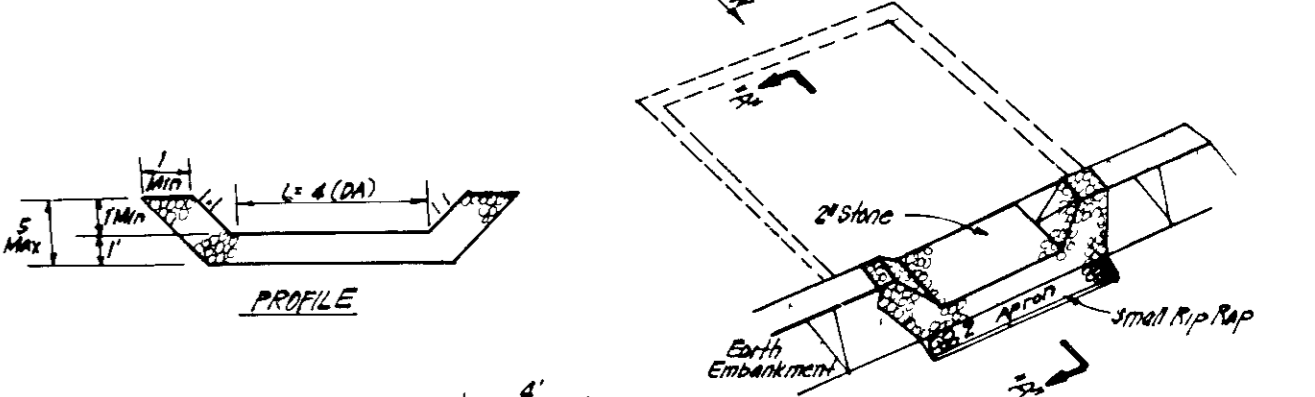

**CONSTRUCTION SPECIFICATIONS:**  
 1. Any under embankment shall be cleared, grubbed and stripped of any vegetation and root mat. The soil shall then be compacted.  
 2. The fill material for the embankment shall be free of rocks and other hard objects as well as any debris, sticks, rocks, organic material or other objectionable material. The embankment shall be compacted by tamping with equipment while it is being constructed.  
 3. All cut and fill slopes shall be 2:1 or flatter.  
 4. The structure shall be constructed with a 4" stone rip rap 4" stone with 1" thickness of 2" aggregate placed on the up-slope side of the stone rip rap.  
 5. Sediment shall be removed and traps restored to its original dimensions when the sediment has accumulated to 1/2 the design depth of the trap.  
 6. The structure shall be inspected after each rain and repairs made as needed.  
 7. Construction operations shall be carried out in such a manner that erosion and water pollution is minimized.  
 8. The structure shall be removed and the area stabilized when the drainage area has been properly stabilized.

**STONE OUTLET SEDIMENT TRAP (SOST) STV**

**ENGINEER'S CERTIFICATE**

I hereby certify that this plan for Erosion and Sediment Control represents a practical and workable plan based on my personal knowledge of the site conditions and that it was prepared in accordance with the requirements of the Howard Soil Conservation District.

Signature: Nelson Clark  
 Date: 3-11-88

**DEVELOPER'S/BUILDER'S CERTIFICATE**

I/We certify that all development and construction will be done according to this plan of development and plan for erosion and sediment control and that all responsible persons involved in the construction project will have a Certificate of Attendance at a Dept. of Natural Resources Approved Training Program for the Control of Sediment and Erosion before beginning the project. I also authorize periodic on-site inspection by the Howard Soil Conservation District or their authorized agents, as are deemed necessary.

Signature: [Signature]  
 Date: [Date]

APPROVED FOR PUBLIC WATER AND PUBLIC SEWERAGE SYSTEMS  
 HOWARD COUNTY HEALTH DEPARTMENT  
 [Signature] 5-11-88  
 APPROVED HOWARD COUNTY OFFICE OF PLANNING & ZONING  
 [Signature] 5/10/88  
 APPROVED FOR PUBLIC WATER AND PUBLIC SEWERAGE  
 STORM DRAINAGE SYSTEMS AND PUBLIC ROADS  
 HOWARD COUNTY DEPARTMENT OF PUBLIC WORKS  
 [Signature] 5-10-88

DIVISION OF LAND USE  
 ZONING ADMINISTRATION  
 APPROVED  
 [Signature]  
 DATE: 4-7-88

Reviewed for [Signature] S.C.D.  
 and meets Technical Requirements  
 [Signature] Date  
 U.S. Soil Conservation Service

THIS DEVELOPMENT PLAN IS APPROVED FOR SOIL EROSION AND SEDIMENT CONTROL BY THE HOWARD SOIL CONSERVATION DISTRICT.  
 Approved [Signature] Date [Date]

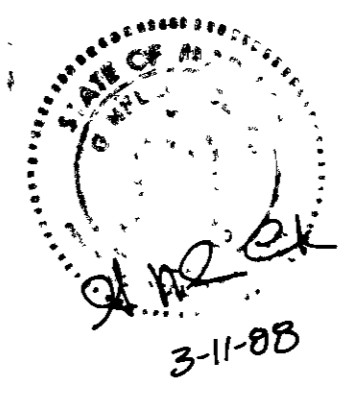

CLARK • FINEBROCK & SACKETT INC.  
 7135 Minnetonka Way • Columbia, Md 21045 • (301) 381-7500 Fax (301) 621-8100 Wash DC  
**SEDIMENT & EROSION CONTROL PLAN**  
 LOTS 188-197 & 279-288  
**TURF VALLEY OVERLOOK**  
 SECTION 2 AREA 1  
 2ND ELECTION DISTRICT  
 HOWARD COUNTY, MARYLAND  
 FOR PIRETTI BLDGS, Inc  
 10304 Baltimore National Pike  
 Ellicott City, Maryland 21043  
 5DP-88-161