

SHEET INDEX	
NO	DESCRIPTION
1	TITLE SHEET
2	SITE DEVELOPMENT PLAN
3	DRAINAGE AREA MAP
4	GRADING AND SEDIMENT CONTROL PLAN
5	LANDSCAPE PLAN
6	PROFILE AND CONSTRUCTION DETAIL SHEET
7	SEDIMENT CONTROL DETAIL SHEET
8	SOILS AREA MAP

SITE DEVELOPMENT PLAN

RMIC / HILLCROFT OFFICE BUILDING

SUBDIVISION OF PARCEL E-3

A RESUBDIVISION OF PARCEL E-2

SECTION 5 AREA 1

6TH ELECTION DISTRICT

HOWARD COUNTY, MARYLAND

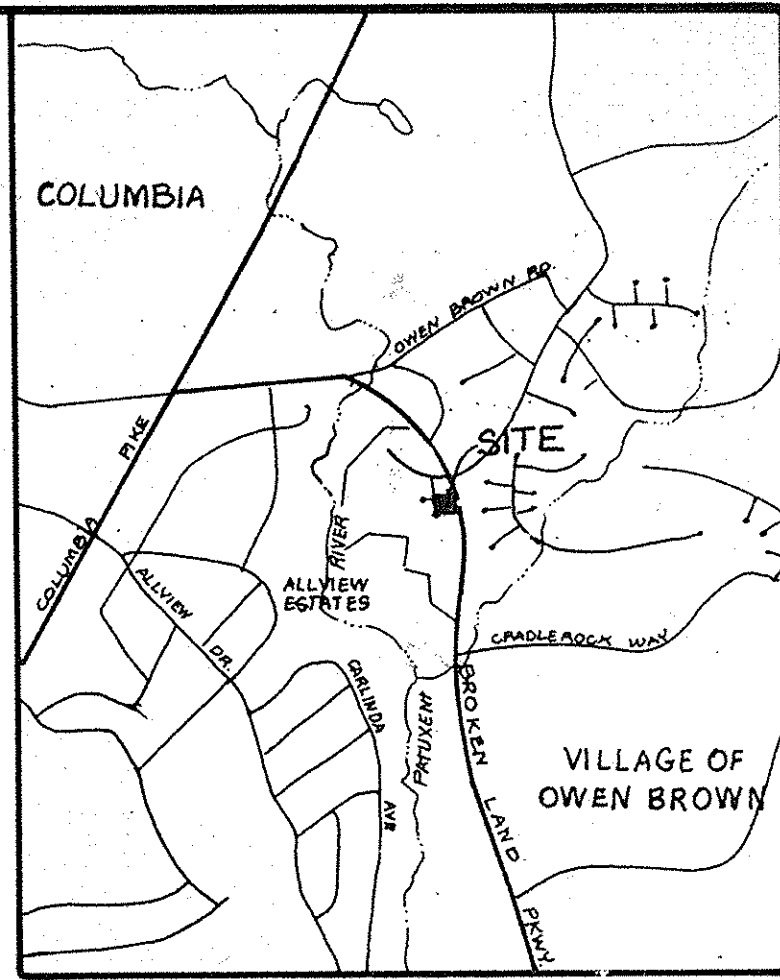

VICINITY MAP
SCALE: 1" = 2000'

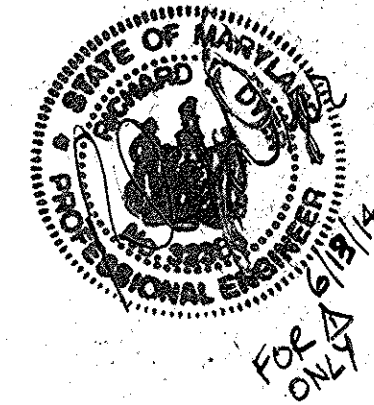

REV	DATE	DESCRIPTION	APPROVED
1	6/15/14	VERIZON WIRELESS INSTALLATION	

- GENERAL NOTES**
- ALL WATER LINES SHALL BE CONSTRUCTED A MINIMUM OF 42" COVER BELOW FINISHED GRADE.
 - ALL WORK SHALL BE PERFORMED IN ACCORDANCE WITH THE HOWARD COUNTY DESIGN MANUAL, VOL. IV, I.E., STANDARD SPECIFICATIONS AND DETAILS FOR CONSTRUCTION.
 - APPROXIMATE LOCATION OF EXISTING UTILITIES ARE SHOWN. THE CONTRACTOR SHALL TAKE ALL NECESSARY PRECAUTIONS TO PROTECT THE EXISTING UTILITIES AND MAINTAIN UNINTERRUPTED SERVICE. ANY DAMAGE INCURRED DUE TO CONTRACTOR'S OPERATION SHALL BE REPAIRED IMMEDIATELY AT THE CONTRACTOR'S EXPENSE.
 - THE CONTRACTOR SHALL TEST PIT EXISTING UTILITIES, WHERE DIRECTED BY THE ENGINEER. A MINIMUM OF TWO WEEKS IN ADVANCE OF CONSTRUCTION OPERATIONS.
 - CONTRACTOR SHALL NOTIFY THE FOLLOWING UTILITIES AT LEAST FIVE (5) DAYS BEFORE STARTING WORK ON THESE DRAWINGS:
 - MISS UTILITY 1-800-257-7777
 - CEP TELEPHONE COMPANY 725-9976
 - HOWARD CO. BUREAU OF UTILITIES 992-2266
 - AT&T CABLE LOCATION DIVISION 393-3553
 - BALTIMORE GAS & ELECTRIC COMPANY 685-0123
 - STATE HIGHWAY ADMINISTRATION 531-5533
 - HOWARD CO. CONSTRUCTION/INSPECTION SURVEY DIVISION (24 HOURS NOTICE PRIOR TO COMMENCEMENT OF WORK) 792-7272
 - ALL PIPE ELEVATIONS SHOWN ARE INVERT ELEVATIONS.
 - THE CONTRACTOR SHALL PROVIDE A JOINT IN ALL SEWER MAINS WITHIN 2'-0" OF EXTERIOR MANHOLE WALLS.
 - PROFILE STATIONS SHALL BE ADJUSTED AS NECESSARY TO CONFORM TO PLAN DIMENSIONS.
 - NO PIPE SHALL BE LAID UNTIL LINES OF EXCAVATION HAVE BEEN BROUGHT TO SUBGRADE.
 - TOPO TAKEN FROM FIELD RUN SURVEY DATED 4/7/87 BY HOWARD RESEARCH & DEVELOPMENT CORPORATION.
 - ALL PLAN DIMENSIONS ARE TO FACE OF CURB UNLESS OTHERWISE NOTED.
 - SITE LIGHTING TO BE DIRECTED INWARD AND DOWNWARD AWAY FROM ALL RESIDENTIAL AREAS.
 - A WAIVER HAS BEEN GRANTED FOR STORM WATER MANAGEMENT. (F-87-02)
 - ALL THE FINAL PLAN CRITERIA IS BASED ON COLUMBIA COMMERCIAL AND INDUSTRIAL DEVELOPMENT GUIDELINES.
 - PLAN REFERENCE TO F-88-172
 - BUILDING USE: GENERAL OFFICE
 - FINAL DEVELOPMENT PLAN PHASE 149-A-11

SITE ANALYSIS

A: Area of Parcel E-3	: 3.34 AC. (145490.5 SQ. FT.)
B: Area of Proposed Site	: 3.34 AC. (145490.5 SQ. FT.)
C: Present Zoning	: New Town
D: Proposed Use	: NEW TOWN EMPLOYMENT CENTER COMMERCIAL
E: Total Building Area	: 0.922 AC. (40165 SQ. FT.)
F: Parking Required	: Two Spaces / 1000 SQ. FT.
* Spaces Required	: 80.32
G: Parking Spaces Provided	: 201
I: Handicapped SP. Required	: 6.00
J: Handicapped SP. Provided	: 6.00
K: Open Space Required	: 0.334 AC. (10% of Prop. Site Area)
L: Open Space Provided	: 1.284 AC.
M: Landscaped Islands REQ.	: 0.67 AC. (20% of Prop. Site Area)
N: Landscaped Islands Prov.	: 0.96 AC.
O: Parking Area	: 1.19 AC.
P: Building Coverage	: 0.28 %
Q: VERIZON WIRELESS DIESEL GENERATOR WITHIN SCREEN WALL	: 160 SQ. FT.
R: VERIZON WIRELESS EQUIPMENT PLATFORM WITH OPEN ORATING ON CONCRETE PIERS	: 160 SQ. FT.

- UNDER REVISION #1 THE PROPOSED VERIZON WIRELESS FACILITIES MAKE UP A LAND DEVELOPMENT PROJECT THAT WILL DISTURB LESS THAN 5,000 SQ. FT. OF LAND AREA AND ARE EXEMPT FROM STORMWATER MANAGEMENT REQUIREMENTS. THE LIMIT OF DISTURBANCE IS 320 SQ. FT. WHICH IS EXEMPT FROM STORMWATER MANAGEMENT CRITERIA UNDER REDEVELOPMENT.
- THIS SITE IS SUBJECT TO THE CRITERIA LISTED UNDER FDP-PHASE 149-A-11, AS RECORDED AS PLAT 3054-A1131-1135.
- ON JUNE 5, 2014 THE HOWARD COUNTY PLANNING BOARD VOTE 5-0 TO APPROVE A SETBACK ADJUSTMENT OF THE 30 FOOT STRUCTURE SETBACK FROM A PUBLIC RIGHT-OF-WAY TO 14 FEET TO ALLOW THE ADDITION OF A 4' X 6' CONCRETE PAD STRUCTURE TO ACCOMMODATE A STANDBY DIESEL GENERATOR TO SUPPORT AN EQUIPMENT SHELTER TO POWER WIRELESS COMMUNICATION ANTENNAS.

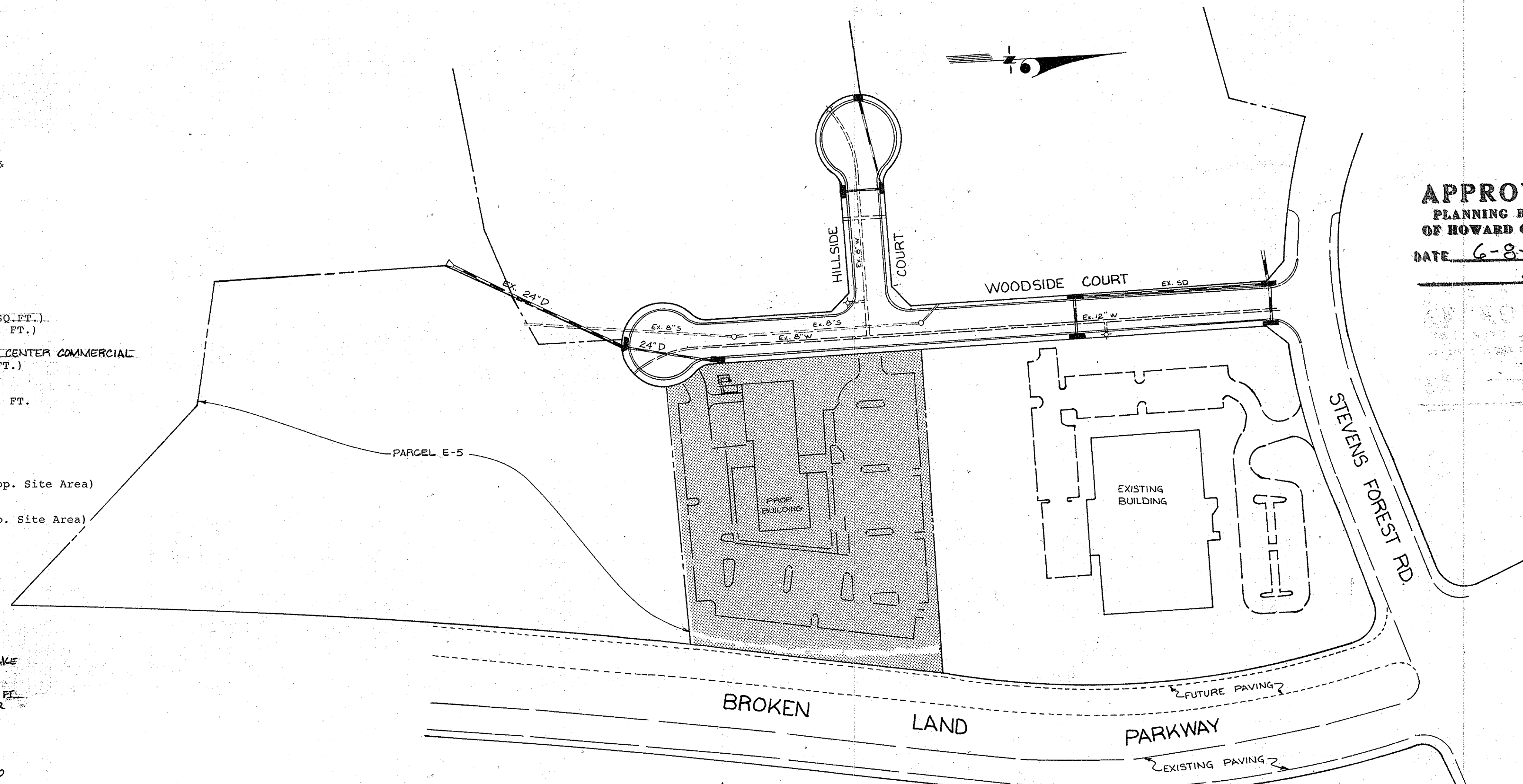

APPROVED
PLANNING BOARD
OF HOWARD COUNTY
DATE 6-8-88
J.B.

ADDRESS CHART

BLDG.	ADDRESS
	6325 WOODSIDE COURT

TITLE SHEET

SUBDIVISION NAME	SECT/AREA	PARCEL NO			
VILLAGE OF OWEN BROWN	5 / 1	E-3			
PLAT NO OR L/F	BLOCK NO	ZONE	TAX/ZONE MAP/ELEC. DIST	CENSUS TR	
6756 / 7723	14	NEW TOWN	36	6TH	6067.01
WATER CODE	SEWER CODE				
E-13	5410000 & 5430000				

APPROVED: FOR PUBLIC WATER AND PUBLIC SEWERAGE STORM DRAINAGE SYSTEMS AND PUBLIC ROADS
HOWARD COUNTY DEPARTMENT OF PUBLIC WORKS

James A. Kelly 7/13/88
DIRECTOR DATE
James A. Kelly 7-13-88
CHIEF BUREAU OF ENGINEERING DATE

APPROVED: HOWARD COUNTY OFFICE OF PLANNING AND ZONING
W. H. ... 7-25-88
DIRECTOR DATE
Wanda S. ... 7-21-88
CHIEF, DIVISION OF COMMUNITY PLANNING AND LAND DEVELOPMENT DATE

PARCEL E-3 PROPERTY INFORMATION
PROPERTY OWNER: 6325 WOODSIDE LLC
ADDRESS: 6325 WOODSIDE COURT
COLUMBIA, MD 21046
PHONE NUMBER: 410-740-7479

APPROVED: FOR PUBLIC WATER AND PUBLIC SEWERAGE SYSTEMS
HOWARD COUNTY HEALTH DEPARTMENT
J. ... 7-14-88
COUNTY HEALTH OFFICER DATE

KIDDE CONSULTANTS, INC.
ENGINEERS • PLANNERS • SURVEYORS
1100 WEST STREET / SUITE 100 / LAUREL, MD 20737
(Wash.) (301) 953-1911 / 792-8086 (Balt.)

DATE	REVISION	BY
6/20	PL. PLAT & PARCEL NOS.	SK.

SURVEYED BY: HRD
COMPUTED BY:
DRAWN BY: SK
CHECKED BY: RA
Drwg. No. 1 of 8

DATE FEBRUARY 1988 SCALE 1" = 100'

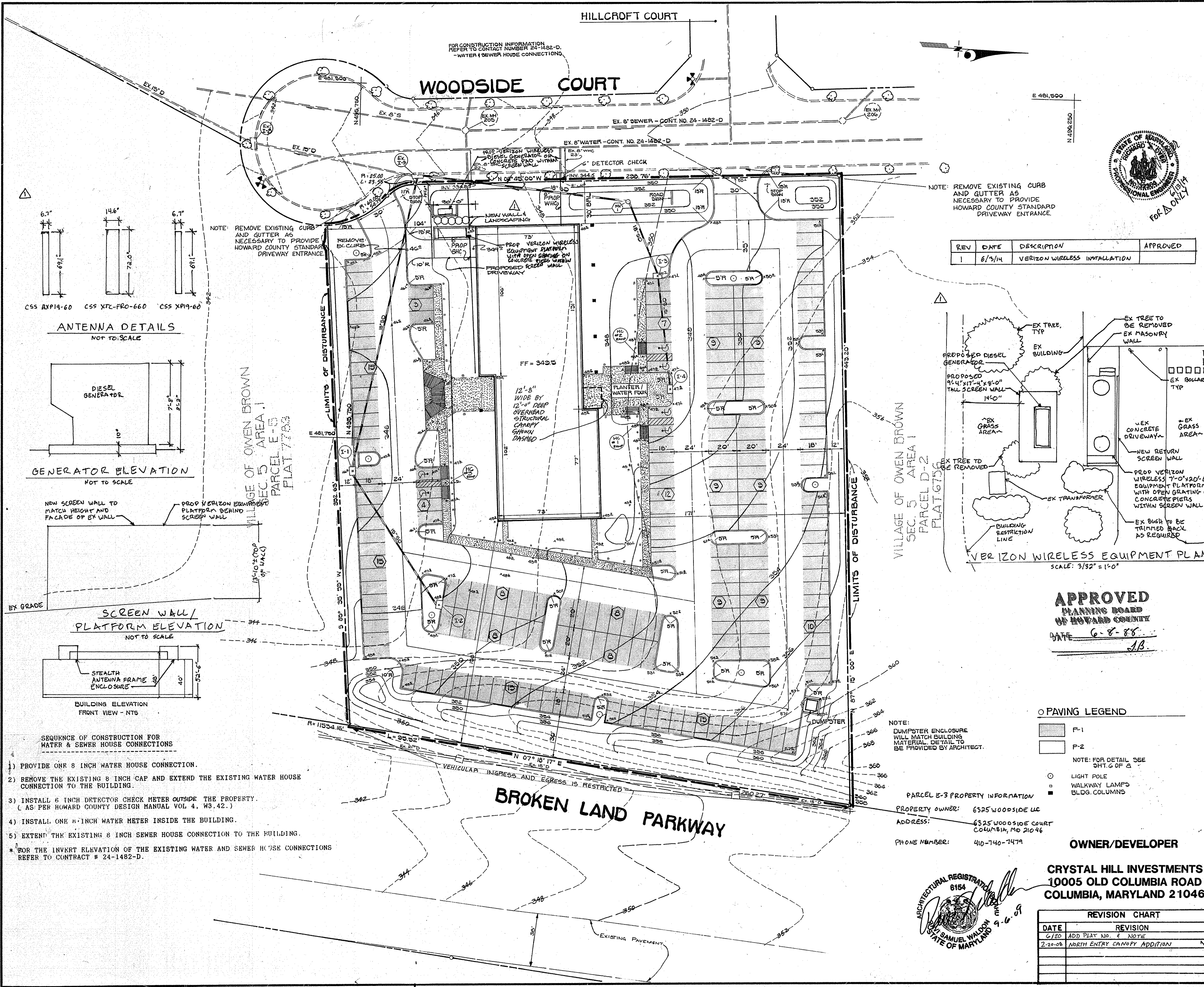

HILLCROFT COURT

WOODSIDE COURT

BROKEN LAND PARKWAY

FOR CONSTRUCTION INFORMATION REFER TO CONTRACT NUMBER 24-1482-D. WATER & SEWER HOUSE CONNECTIONS.

NOTE: REMOVE EXISTING CURB AND GUTTER AS NECESSARY TO PROVIDE HOWARD COUNTY STANDARD DRIVEWAY ENTRANCE.

NOTE: REMOVE EXISTING CURB AND GUTTER AS NECESSARY TO PROVIDE HOWARD COUNTY STANDARD DRIVEWAY ENTRANCE.

REV	DATE	DESCRIPTION	APPROVED
1	6/3/14	VERIZON WIRELESS INSTALLATION	

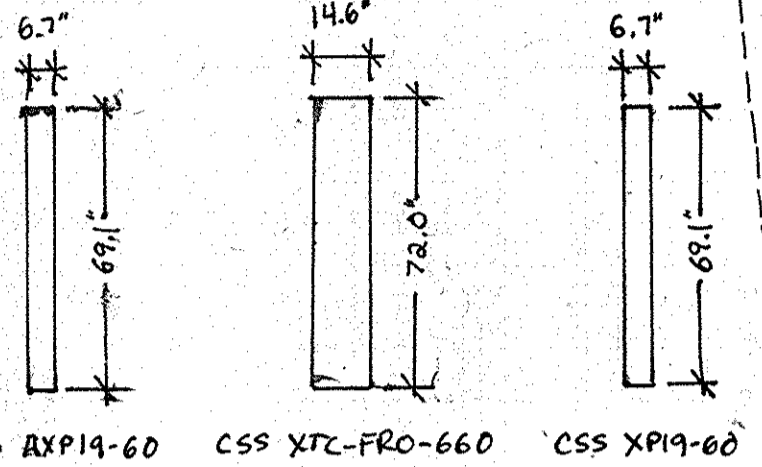

ANTENNA DETAILS NOT TO SCALE

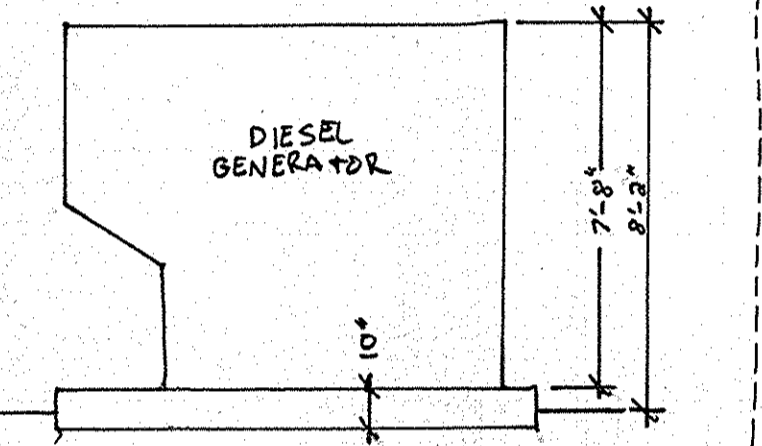

GENERATOR ELEVATION NOT TO SCALE

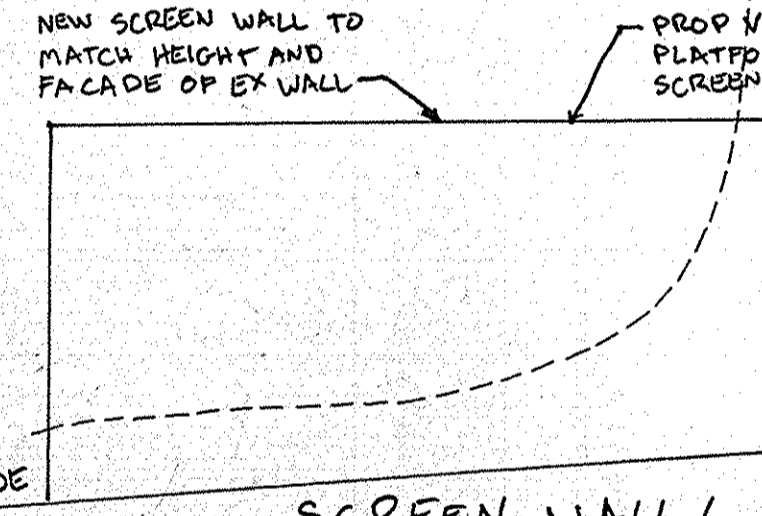

SCREEN WALL / PLATFORM ELEVATION NOT TO SCALE

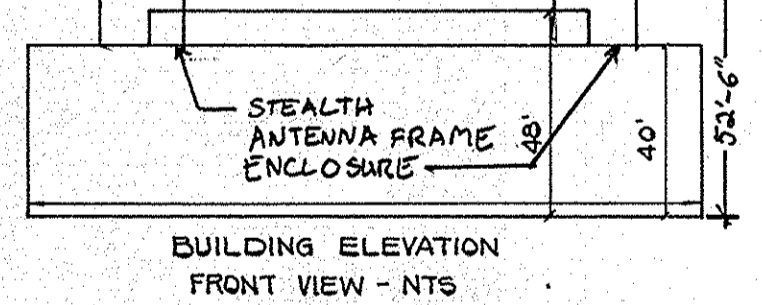

BUILDING ELEVATION FRONT VIEW - NTS

- SEQUENCE OF CONSTRUCTION FOR WATER & SEWER HOUSE CONNECTIONS
- 1) PROVIDE ONE 8 INCH WATER HOUSE CONNECTION.
 - 2) REMOVE THE EXISTING 8 INCH CAP AND EXTEND THE EXISTING WATER HOUSE CONNECTION TO THE BUILDING.
 - 3) INSTALL 6 INCH DETECTOR CHECK METER OUTSIDE THE PROPERTY. (AS PER HOWARD COUNTY DESIGN MANUAL VOL 4, #3.42.)
 - 4) INSTALL ONE 1/2 INCH WATER METER INSIDE THE BUILDING.
 - 5) EXTEND THE EXISTING 8 INCH SEWER HOUSE CONNECTION TO THE BUILDING.
- * FOR THE INVERT ELEVATION OF THE EXISTING WATER AND SEWER HOUSE CONNECTIONS REFER TO CONTRACT # 24-1482-D.

APPROVED
PLANNING BOARD
OF HOWARD COUNTY
DATE 6-8-88
J.B.

PAVING LEGEND
F-1
F-2
NOTE: FOR DETAIL SEE SHT. 6 OF 8
○ LIGHT POLE
□ WALKWAY LAMPS
■ BLDG. COLUMNS

NOTE: DUMPSTER ENCLOSURE WILL MATCH BUILDING MATERIAL. DETAIL TO BE PROVIDED BY ARCHITECT.

PARCEL E-3 PROPERTY INFORMATION
PROPERTY OWNER: 6325 WOODSIDE LLC
ADDRESS: 6325 WOODSIDE COURT COLUMBIA, MD 21046
PHONE NUMBER: 410-740-7479

OWNER/DEVELOPER
CRYSTAL HILL INVESTMENTS
10005 OLD COLUMBIA ROAD
COLUMBIA, MARYLAND 21046

REVISION CHART

DATE	REVISION
6/20	ADD PLAN NO. & NOTE
2-20-08	NORTH ENTRY CANOPY ADDITION

APPROVED: FOR PUBLIC WATER AND PUBLIC SEWERAGE STORM DRAINAGE SYSTEMS AND PUBLIC ROADS HOWARD COUNTY DEPARTMENT OF PUBLIC WORKS
James P. ... 7/13/88
Director DATE

REVIEWED FOR HOWARD SOIL CONSERVATION DISTRICT AND MEETS TECHNICAL REQUIREMENTS.

James M. ... 6/23/88
U.S. SOIL CONSERVATION SERVICE DATE

THIS DEVELOPMENT PLAN IS APPROVED FOR SOIL EROSION & SEDIMENT CONTROL BY THE HOWARD SOIL CONSERVATION DISTRICT.

Stephen L. ... 6/23/88
HOWARD SOIL CONSERVATION DISTRICT DATE

APPROVED: FOR PUBLIC WATER AND PUBLIC SEWERAGE SYSTEMS HOWARD COUNTY HEALTH DEPARTMENT
John ... 7-14-88
COUNTY HEALTH OFFICER DATE

APPROVED: HOWARD COUNTY OFFICE OF PLANNING AND ZONING
Director 7.25.88
DATE
Chief, Division of Community Planning and Land Development 7-21-88
DATE

ENGINEERS CERTIFICATE
"I CERTIFY THAT THIS PLAN FOR EROSION & SEDIMENT CONTROL REPRESENTS A PRACTICAL AND WORKABLE PLAN BASED ON MY PERSONAL KNOWLEDGE OF THE SITE CONDITIONS AND THAT IT WAS PREPARED IN ACCORDANCE WITH THE REQUIREMENTS OF THE HOWARD SOIL CONSERVATION DISTRICT."

John ... 6/16/88
ENGINEERS SIGNATURE DATE

DEVELOPERS CERTIFICATE
"I/WE CERTIFY THAT ALL DEVELOPMENT & CONSTRUCTION WILL BE DONE ACCORDING TO THIS PLAN, AND THAT ANY RESPONSIBLE PERSONNEL INVOLVED IN THE CONSTRUCTION PROJECT WILL HAVE A CERTIFICATE OF ATTENDANCE AT A DEPARTMENT OF NATURAL RESOURCES APPROVED TRAINING PROGRAM FOR THE CONTROL OF SEDIMENT & EROSION BEFORE BEGINNING THE PROJECT. I ALSO AUTHORIZE PERIODIC ON-SITE INSPECTION BY THE HOWARD SOIL CONSERVATION DISTRICT."

James M. ... 6/16/88
DEVELOPERS SIGNATURE DATE

SITE DEVELOPMENT PLAN
VILLAGE OF OWEN BROWN
RMIC/HILLCROFT OFFICE BUILDING

SUBDIVISION OF PARCEL E-3 RE-SUBDIVISION OF PARCEL E-2 SECTION 5 AREA 1 6TH ELECTION DISTRICT HOWARD COUNTY, MARYLAND

KIDDE CONSULTANTS, INC.
ENGINEERS • PLANNERS • SURVEYORS
1100 WEST STREET, SUITE 100 • JARL, MD 20707
(Wash. 1 (301) 953-1821 • 7x/24 - 88 (intl.)

SHEET 2 OF 3
DATE FEB, 1988 SCALE 1" = 30'

SDP-88-146

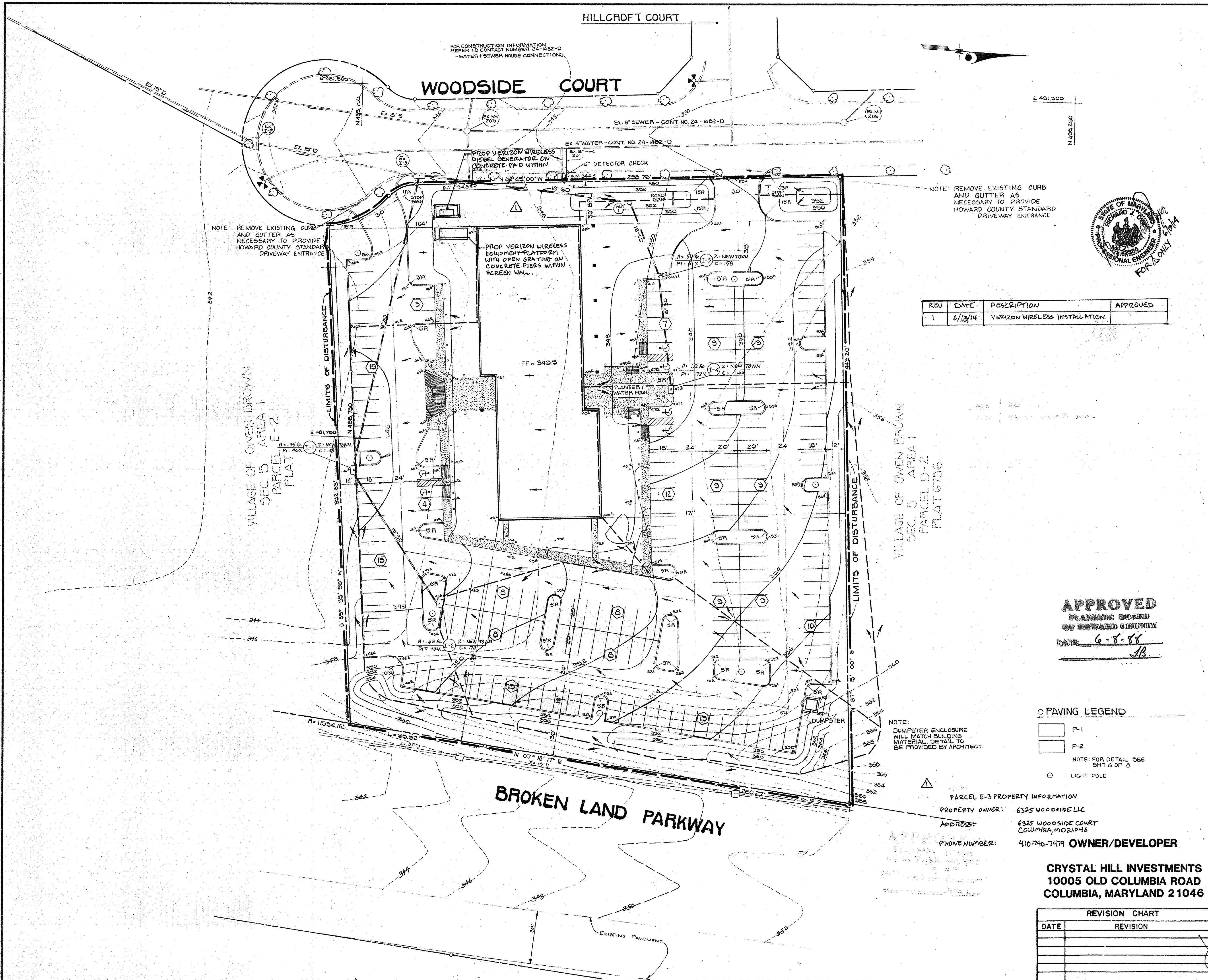

APPROVED: FOR PUBLIC WATER AND PUBLIC SEWERAGE STORM DRAINAGE SYSTEMS AND PUBLIC ROADS HOWARD COUNTY DEPARTMENT OF PUBLIC WORKS

James M. Shea 7/13/88
DIRECTOR DATE

William S. Carey 7-13-88
CHIEF BUREAU OF ENGINEERING DATE

REVIEWED FOR HOWARD SOIL CONSERVATION DISTRICT AND MEETS TECHNICAL REQUIREMENTS

James M. Helm 6/23/88
US SOIL CONSERVATION SERVICE DATE

THIS DEVELOPMENT PLAN IS APPROVED FOR SOIL EROSION & SEDIMENT CONTROL BY THE HOWARD SOIL CONSERVATION DISTRICT.

Stephen L. Pelt 6/23/88
HOWARD SOIL CONSERVATION DISTRICT DATE

APPROVED: FOR PUBLIC WATER AND PUBLIC SEWERAGE SYSTEMS HOWARD COUNTY HEALTH DEPARTMENT

Gregory Boyle 7-14-88
COUNTY HEALTH OFFICER DATE

APPROVED: HOWARD COUNTY OFFICE OF PLANNING AND ZONING

W. J. ... 7-25-88
DIRECTOR DATE

Donald J. ... 7-21-88
CHIEF, DIVISION OF COMMUNITY PLANNING AND LAND DEVELOPMENT DATE

ENGINEERS CERTIFICATE
"I CERTIFY THAT THIS PLAN FOR EROSION & SEDIMENT CONTROL REPRESENTS A PRACTICAL AND WORKABLE PLAN BASED ON MY PERSONAL KNOWLEDGE OF THE SITE CONDITIONS AND THAT IT WAS PREPARED IN ACCORDANCE WITH THE REQUIREMENTS OF THE HOWARD SOIL CONSERVATION DISTRICT."

John Ed ... 6/16/88
ENGINEERS SIGNATURE DATE

DEVELOPERS CERTIFICATE
"I/WE CERTIFY THAT ALL DEVELOPMENT & CONSTRUCTION WILL BE DONE ACCORDING TO THIS PLAN, AND THAT ANY RESPONSIBLE PERSONNEL INVOLVED IN THE CONSTRUCTION PROJECT WILL HAVE A CERTIFICATE OF ATTENDANCE AT A DEPARTMENT OF NATURAL RESOURCES APPROVED TRAINING PROGRAM FOR THE CONTROL OF SEDIMENT & EROSION BEFORE BEGINNING THE PROJECT. I ALSO AUTHORIZE PERIODIC ON-SITE INSPECTION BY THE HOWARD SOIL CONSERVATION DISTRICT."

James M. ... 6-16-88
DEVELOPERS SIGNATURE DATE

DRAINAGE AREA MAP
VILLAGE OF OWEN BROWN
RMIC/HILLCROFT OFFICE BUILDING

SUBDIVISION OF PARCEL E-3 RE-SUBDIVISION OF PARCEL E-2 SECTION 5 AREA 1 6TH ELECTION DISTRICT HOWARD COUNTY, MARYLAND

KIDDE CONSULTANTS, INC.
ENGINEERS • PLANNERS • SURVEYORS
1100 WEST STREET SUITE 1001 41REI MD 20707
WASH DC 20011 953-1821 78 --86 (B&H)

SHEET 3 OF 8
DATE FEB., 1988 SCALE 1" = 30'

REV	DATE	DESCRIPTION	APPROVED
1	6/13/14	VERIZON WIRELESS INSTALLATION	

APPROVED
PLANNING BOARD
OF HOWARD COUNTY
DATE 6-8-88
AB

- PAVING LEGEND
- P-1
 - P-2
 - LIGHT POLE
- NOTE: FOR DETAIL SEE SHT G OF A

PARCEL E-3 PROPERTY INFORMATION
PROPERTY OWNER: 6325 WOODSIDE LLC
ADDRESS: 6325 WOODSIDE COURT COLUMBIA, MD 21046
PHONE NUMBER: 410-740-7479 OWNER/DEVELOPER

CRYSTAL HILL INVESTMENTS
10005 OLD COLUMBIA ROAD
COLUMBIA, MARYLAND 21046

REVISION CHART

DATE	REVISION

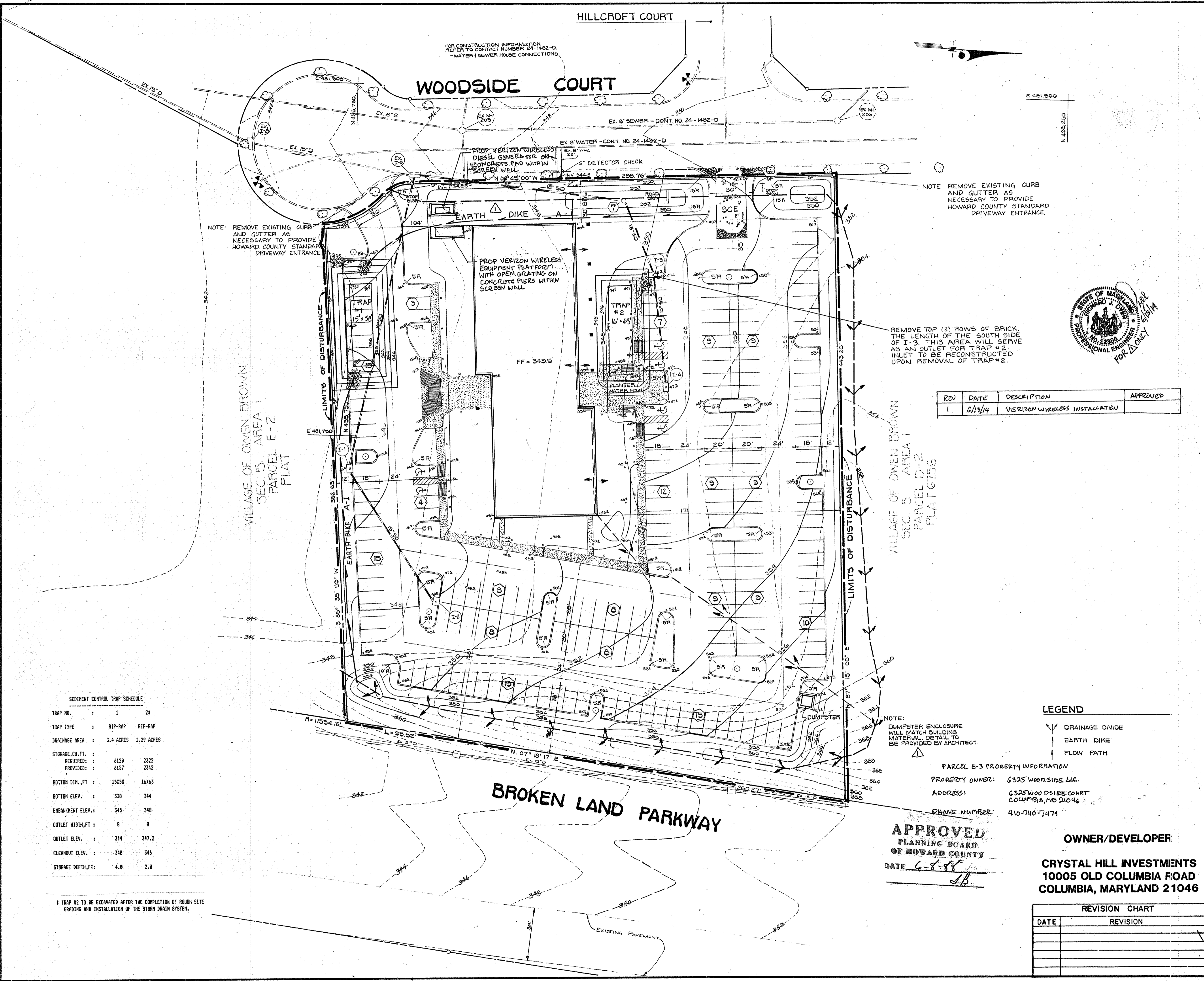

APPROVED: FOR PUBLIC WATER AND PUBLIC SEWERAGE STORM DRAINAGE SYSTEMS AND PUBLIC ROADS HOWARD COUNTY DEPARTMENT OF PUBLIC WORKS

James P. Lee 7/13/88
DIRECTOR DATE
Richard S. Reed 7-13-88
CHIEF BUREAU OF ENGINEERING DATE

REVIEWED FOR HOWARD SOIL CONSERVATION DISTRICT AND MEETS TECHNICAL REQUIREMENTS

James M. Helm 6/23/88
US SOIL CONSERVATION SERVICE DATE

THIS DEVELOPMENT PLAN IS APPROVED FOR SOIL EROSION & SEDIMENT CONTROL BY THE HOWARD SOIL CONSERVATION DISTRICT.

Stephen J. Cohen 6/27/88
HOWARD SOIL CONSERVATION DISTRICT DATE

APPROVED: FOR PUBLIC WATER AND PUBLIC SEWERAGE SYSTEMS HOWARD COUNTY HEALTH DEPARTMENT

Joyce B. G. ... 7-14-88
COUNTY HEALTH OFFICER DATE

APPROVED: HOWARD COUNTY OFFICE OF PLANNING AND ZONING

... 7-25-88
DIRECTOR DATE
... 7-21-88
CHIEF, DIVISION OF COMMUNITY PLANNING AND LAND DEVELOPMENT DATE

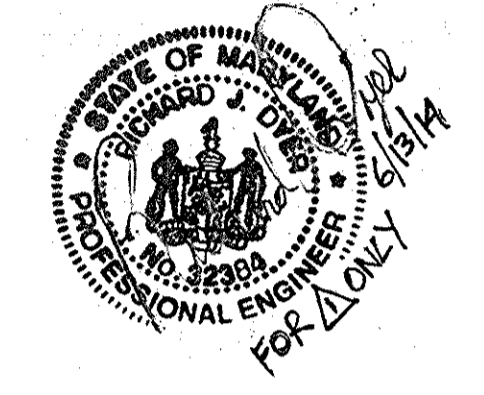

REV	DATE	DESCRIPTION	APPROVED
1	6/13/84	VERIZON WIRELESS INSTALLATION	

ENGINEERS CERTIFICATE
"I CERTIFY THAT THIS PLAN FOR EROSION & SEDIMENT CONTROL REPRESENTS A PRACTICAL AND WORKABLE PLAN BASED ON MY PERSONAL KNOWLEDGE OF THE SITE CONDITIONS AND THAT IT WAS PREPARED IN ACCORDANCE WITH THE REQUIREMENTS OF THE HOWARD SOIL CONSERVATION DISTRICT."

John S. ... 6/16/88
ENGINEERS SIGNATURE DATE

DEVELOPERS CERTIFICATE
"I/WE CERTIFY THAT ALL DEVELOPMENT & CONSTRUCTION WILL BE DONE ACCORDING TO THIS PLAN, AND THAT ANY RESPONSIBLE PERSONNEL INVOLVED IN THE CONSTRUCTION PROJECT WILL HAVE A CERTIFICATE OF ATTENDANCE AT A DEPARTMENT OF NATURAL RESOURCES APPROVED TRAINING PROGRAM FOR THE CONTROL OF SEDIMENT & EROSION BEFORE BEGINNING THE PROJECT. I ALSO AUTHORIZE PERIODIC ON-SITE INSPECTION BY THE HOWARD SOIL CONSERVATION DISTRICT."

James M. ... 6/16/88
DEVELOPERS SIGNATURE DATE

GRADING & SEDIMENT CONTROL
VILLAGE OF OWEN BROWN
RMIC/HILLCROFT OFFICE BUILDING

SUBDIVISION OF PARCEL E-3 RE-SUBDIVISION OF PARCEL E-2
SECTION 5 AREA 1
6TH ELECTION DISTRICT
HOWARD COUNTY, MARYLAND

KIDDE CONSULTANTS, INC.
ENGINEERS • PLANNERS • SURVEYORS
1100 WEST STREET SUITE 100 AIREL MD 20707
WASH. (301) 953-1821 TX (86) (Balt.)

SHEET 4 OF 6
DATE FEB, 1988 SCALE 1" = 30'

SEDIMENT CONTROL TRAP SCHEDULE

TRAP NO.	1	28
TRAP TYPE	RIP-RAP	RIP-RAP
DRAINAGE AREA	3.4 ACRES	1.29 ACRES
STORAGE, CU.FT.		
REQUIRED:	6120	2322
PROVIDED:	6157	2342
BOTTOM DIM., FT.	15X58	16X63
BOTTOM ELEV.	338	344
EMBANKMENT ELEV.	345	348
OUTLET WIDTH, FT.	8	8
OUTLET ELEV.	344	347.2
CLEANOUT ELEV.	348	346
STORAGE DEPTH, FT.	4.8	2.8

TRAP #2 TO BE EXCAVATED AFTER THE COMPLETION OF ROUGH SITE GRADING AND INSTALLATION OF THE STORM DRAIN SYSTEM.

LEGEND

- DRAINAGE DIVIDE
- EARTH DIKE
- FLOW PATH

PARCEL E-3 PROPERTY INFORMATION
PROPERTY OWNER: 6325 WOODSIDE LLC.
ADDRESS: 6325 WOODSIDE COURT COLUMBIA, MD 21046
PHONE NUMBER: 410-746-7474

APPROVED
PLANNING BOARD OF HOWARD COUNTY
DATE 6-8-88
J.B.

OWNER/DEVELOPER
CRYSTAL HILL INVESTMENTS
10005 OLD COLUMBIA ROAD
COLUMBIA, MARYLAND 21046

REVISION CHART

DATE	REVISION

HILLCROFT COURT

WOODSIDE COURT

FOR CONSTRUCTION INFORMATION REFER TO CONTRACT NUMBER 24-1482-D WATER & SEWER HOUSE CONNECTIONS

EX. 8" SEWER - CONT. NO. 24-1482-D

EX. 8" WATER - CONT. NO. 24-1482-D

PROP. VERIZON WIRELESS DIESEL GENERATOR ON CONCRETE PAD WITHIN SCREEN WALL

6" DETECTOR CHECK

NOTE: REMOVE EXISTING CURB AND GUTTER AS NECESSARY TO PROVIDE HOWARD COUNTY STANDARD DRIVEWAY ENTRANCE.

NOTE: REMOVE EXISTING CURB AND GUTTER AS NECESSARY TO PROVIDE HOWARD COUNTY STANDARD DRIVEWAY ENTRANCE.

ALL TREES TO BE WINED THESE STAKES PER TREE SET TREE BALL 1/2 OUT OF THE GROUND

NEVER CUT LEADER RUBBER HOSES 1/2 UP TREE GUTTWIRES WITH TUBEBUNDLES 2" x 2" x 8' HARDWOOD STAKES CUT & REMOVE CRACK FROM TOP 1/2 OF TREE BALL 4-5" MULCH SAUCER AROUND TREE 3" SOIL WELL PLANTING SOIL AS SPECIFIED REMOVE NON BIO-DEGRADABLE WIRE BASKETS AND COPE UPRIGHT STAKES EXTENDED FROM DESIGN 10' MIN.

Evergreen Tree Planting Detail No Scale

PLANTING PROCEDURES FOR POT BOUND CONTAINER GROWN PLANTS 1. REMOVE THE PLANT EITHER BY CUTTING OR INVERTING THE CONTAINER. 2. USE A KNIFE OR SHARP BLADE TO CUT THROUGH BOTTOM HALF OF THE ROOT BALL. 3. BUTTERFLY THE ROOT BALL TO BRING THE ROOT SYSTEM CLOSER TO THE SURFACE. 4. PLANT SAUCERS 1" TO 2" ABOVE EXISTING GRADE.

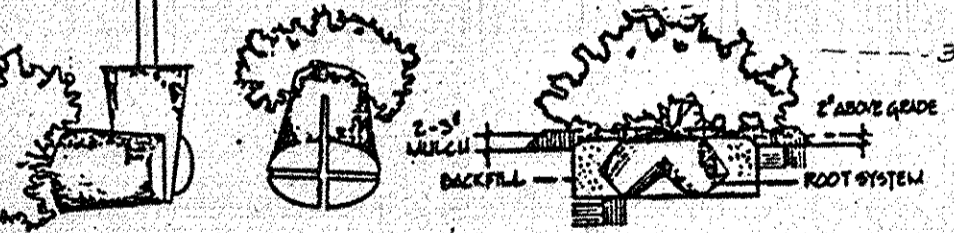

Butterfly Detail For Pot Bound Plants No Scale

SEQUENCE OF CONSTRUCTION FOR WATER & SEWER HOUSE CONNECTIONS

- 1) PROVIDE ONE 8 INCH WATER HOUSE CONNECTION.
2) REMOVE THE EXISTING 8 INCH CAP AND EXTEND THE EXISTING WATER HOUSE CONNECTION TO THE BUILDING.
3) INSTALL 6 INCH DETECTOR CHECK METER OUTSIDE THE PROPERTY.
4) INSTALL ONE 8 INCH WATER METER INSIDE THE BUILDING.
5) EXTEND THE EXISTING 8 INCH SEWER HOUSE CONNECTION TO THE BUILDING.

* FOR THE INVERT ELEVATION OF THE EXISTING WATER AND SEWER HOUSE CONNECTIONS REFER TO CONTRACT # 24-1482-D.

Table with 4 columns: REV, DATE, DESCRIPTION, APPROVED. Row 1: 1, 6/13/14, VERIZON WIRELESS INSTALLATION, [Signature]

BROKEN LAND PARKWAY

Deciduous Tree Planting Detail No Scale

Plant List table with columns: Symbol, Name, Size, Quantity. Includes entries for Tilia C. 'Littleleaf', Acer Rubrum, Abelia Grandifolia, Pinus Strobus, Euonymus Alatus, Vinca Minor, and Annual Flowering Bed.

PAVING LEGEND

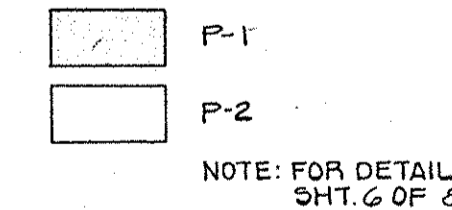

NOTE: DUMPSTER ENCLOSURE WILL MATCH BUILDING MATERIAL. DETAIL TO BE PROVIDED BY ARCHITECT.

APPROVED PLANNING BOARD OF HOWARD COUNTY DATE 6-8-88

OWNER/DEVELOPER CRYSTAL HILL INVESTMENTS 10005 OLD COLUMBIA ROAD COLUMBIA, MARYLAND 21046

REVISION CHART table with columns: DATE, REVISION.

APPROVED: FOR PUBLIC WATER AND PUBLIC SEWERAGE STORM DRAINAGE SYSTEMS AND PUBLIC ROADS HOWARD COUNTY DEPARTMENT OF PUBLIC WORKS

Director James M. Helm 7/13/88 DATE
Chief Bureau of Engineering William B. Ryan 7.13.88 DATE

REVIEWED FOR HOWARD SOIL CONSERVATION DISTRICT AND MEETS TECHNICAL REQUIREMENTS.

James M. Helm 6/23/88 DATE
US SOIL CONSERVATION SERVICE

THIS DEVELOPMENT PLAN IS APPROVED FOR SOIL EROSION & SEDIMENT CONTROL BY THE HOWARD SOIL CONSERVATION DISTRICT.

Stephen R. Miller 6/23/88 DATE
HOWARD SOIL CONSERVATION DISTRICT

APPROVED: FOR PUBLIC WATER AND PUBLIC SEWERAGE SYSTEMS HOWARD COUNTY HEALTH DEPARTMENT

Jaylene Tyler 7-14-88 DATE
COUNTY HEALTH DEPARTMENT

APPROVED: HOWARD COUNTY OFFICE OF PLANNING AND ZONING DIRECTOR 7.25.88 DATE

David J. Langdon 7-21-88 DATE
CHIEF, DIVISION OF COMMUNITY PLANNING AND LAND DEVELOPMENT

ENGINEERS CERTIFICATE I CERTIFY THAT THIS PLAN FOR EROSION & SEDIMENT CONTROL REPRESENTS A PRACTICAL AND WORKABLE PLAN BASED ON MY PERSONAL KNOWLEDGE OF THE SITE CONDITIONS AND THAT IT WAS PREPARED IN ACCORDANCE WITH THE REQUIREMENTS OF THE HOWARD SOIL CONSERVATION DISTRICT.

dm Solamot 6/16/88 DATE
ENGINEERS SIGNATURE

DEVELOPERS CERTIFICATE I/WE CERTIFY THAT ALL DEVELOPMENT & CONSTRUCTION WILL BE DONE ACCORDING TO THIS PLAN, AND THAT ANY RESPONSIBLE PERSONNEL INVOLVED IN THE CONSTRUCTION PROJECT WILL HAVE A CERTIFICATE OF ATTENDANCE AT A DEPARTMENT OF NATURAL RESOURCES APPROVED TRAINING PROGRAM FOR THE CONTROL OF SEDIMENT & EROSION BEFORE BEGINNING THE PROJECT. I ALSO AUTHORIZE PERIODIC ON-SITE INSPECTION BY THE HOWARD SOIL CONSERVATION DISTRICT.

Janna M. Cecelon 6-16-88 DATE
DEVELOPERS SIGNATURE

LANDSCAPING PLAN VILLAGE OF OWEN BROWN RMIC/HILLCROFT OFFICE BUILDING

SUBDIVISION OF PARCEL E-3 RE-SUBDIVISION OF PARCEL E-2 SECTION 5 AREA 1 6TH ELECTION DISTRICT HOWARD COUNTY, MARYLAND

KIDDE CONSULTANTS, INC. ENGINEERS & PLANNERS - SURVEYORS 1100 WEST STREET, SUITE 100, LUREL, MD 20870. SHEET 5 OF 8. DATE FEB. 1988 SCALE 1" = 30'

SDP-88-146

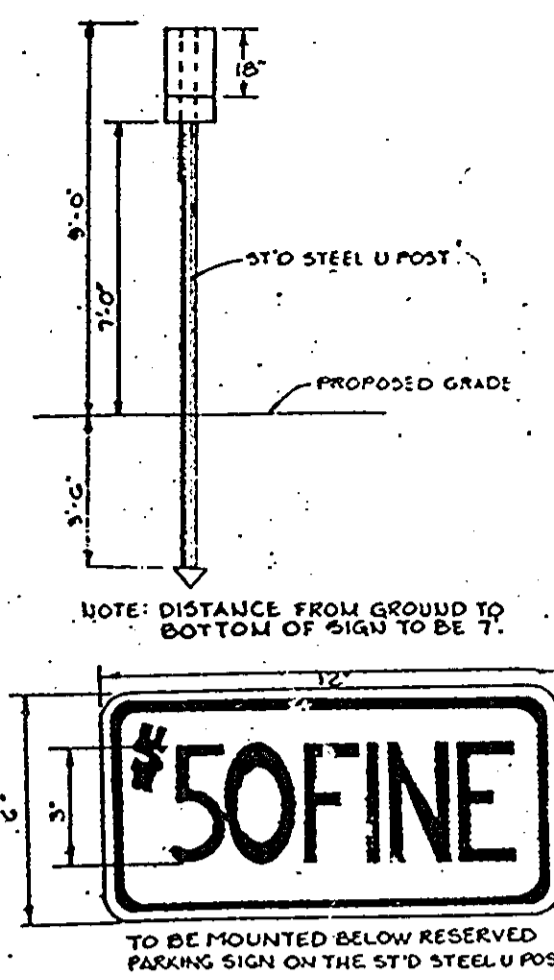

HANDICAP SIGN
NO SCALE

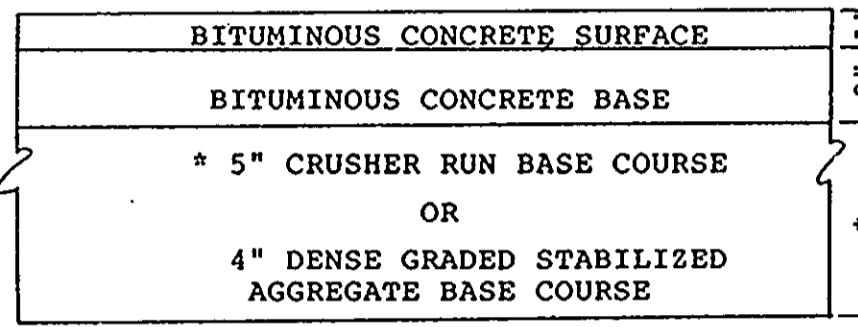

(ALTERNATE)

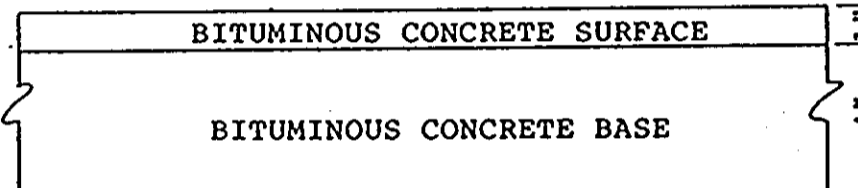

HOWARD COUNTY DESIGN MANUAL VOL. IV
STANDARD SPECIFICATIONS AND DETAILS
FOR CONSTRUCTION (DRAWING R-2.01)

(5\"/>

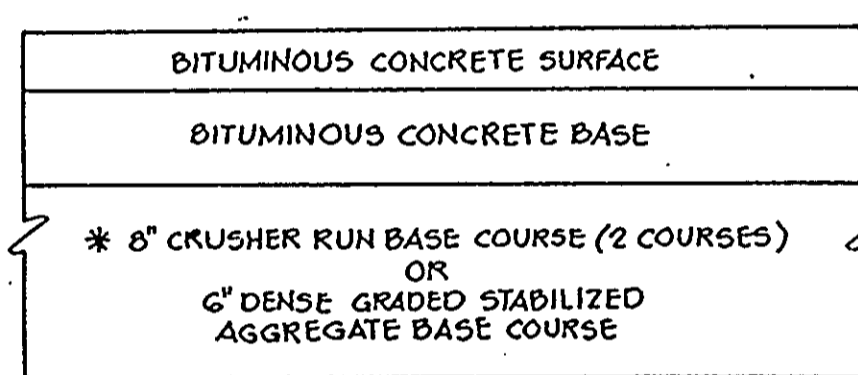

(ALTERNATE)

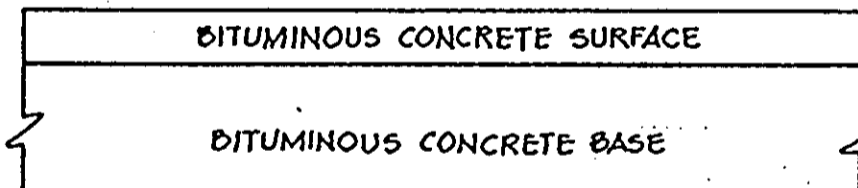

HOWARD COUNTY DESIGN MANUAL VOLUME III
STANDARD SPECIFICATIONS AND DETAILS FOR
CONSTRUCTION (DRAWING R-2.01)

6 1/2\"/>

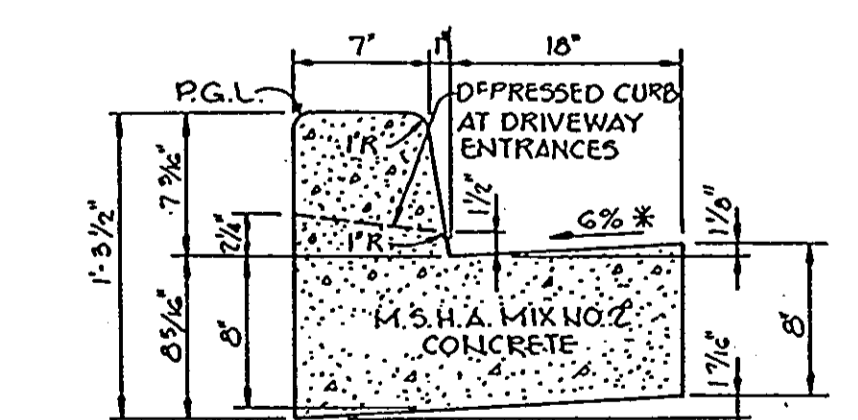

HOWARD COUNTY DESIGN MANUAL VOLUME IV
STANDARD SPECIFICATIONS AND DETAILS FOR
CONSTRUCTION (DRAWING R-3.01)

* GUTTER PAN AT THE MEDIAN EDGE OF INTERMEDIATE
ARTERIALS OR THE HIGH SIDE OF SUPERELEVATED
SECTIONS SHALL BE SLOPED AT THE SAME RATE
AS THE PAVEMENT.

STANDARD 7\"/>

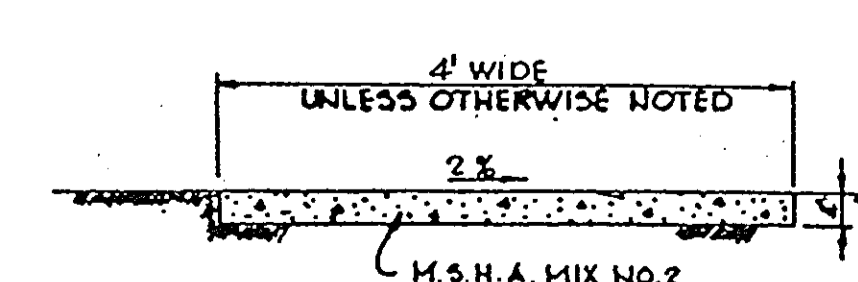

SIDEWALK DETAIL
No Scale

- SEQUENCE OF CONSTRUCTION**
1. OBTAIN GRADING PERMIT. 1 DAY
 2. INSTALL ALL SEDIMENT CONTROL DEVICES, INCLUDING SEE, SILT FENCE, EARTH DIKES, AND TRAP #1. DO NOT INSTALL TRAP #2. 3 DAYS
 3. ROUGH GRADE SITE FOR PARKING AND BUILDING AREAS. 2 WEEKS
 4. CONSTRUCT BUILDINGS. 1 MONTH
 5. FINE GRADE FOR PARKING. 1 WEEK
 6. INSTALL ALL UTILITIES. 3 DAYS
 7. INSTALL STORM DRAIN SYSTEM AND IMMEDIATELY BLOCK ALL INLETS. 4 DAYS
 8. INSTALL SEDIMENT TRAP #2. 1 DAY
 9. INSTALL ALL CURB AND GUTTER, EXCEPT IN AREA OF TRAPS. 1 WEEK
 10. STABILIZE ALL COMPLETED AREAS WITH KENTUCKY 31 TALL FESCUE. 2 DAYS
 11. REMOVE SEDIMENT TRAP(S) AND EARTH DIKES, AND INSTALL SILT FENCE AT PROPERTY LINE BEHIND WHERE TRAP 1 WAS LOCATED. ALSO INSTALL SILT FENCE AROUND AREA WHERE TRAP 2 WAS LOCATED. 5 DAYS
 12. CONSTRUCT REMAINDER OF PARKING AREA. 1 WEEK
 13. WITH PERMISSION OF THE SEDIMENT CONTROL INSPECTOR, REMOVE ALL SEDIMENT CONTROL DEVICES AND IMMEDIATELY STABILIZE ALL AREAS. 4 DAYS

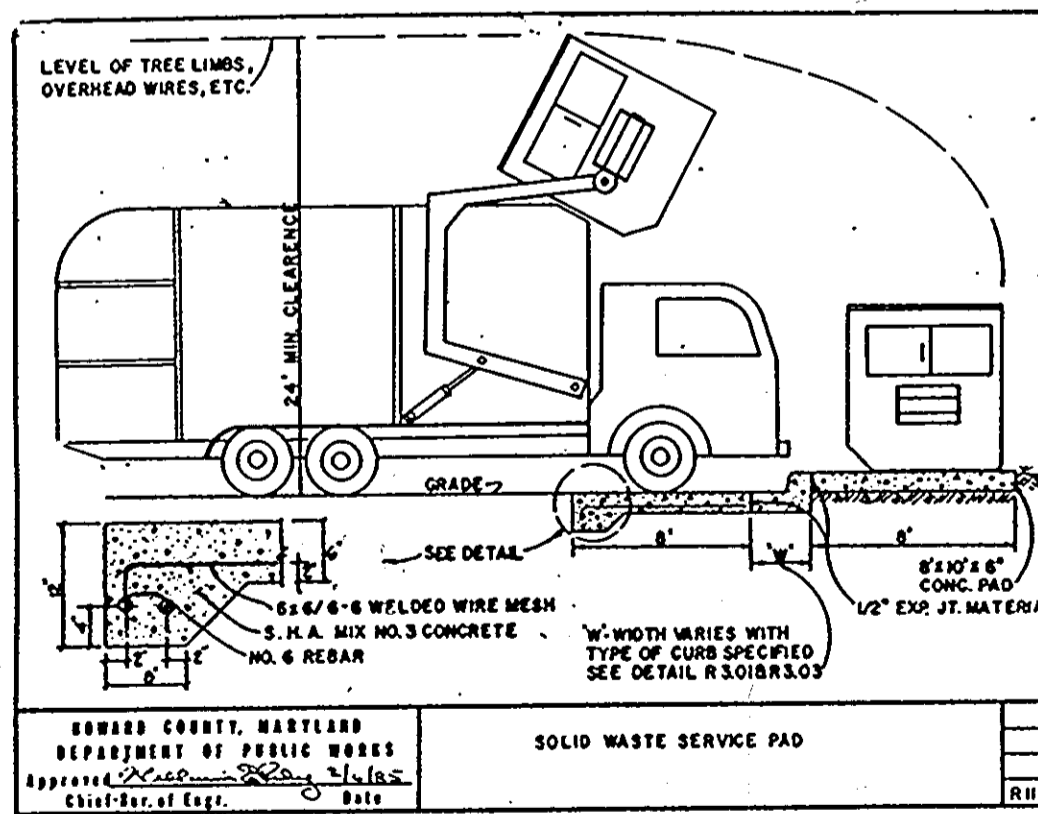

DRAINAGE STRUCTURE SCHEDULE

NO.	TYPE	INLET IN	INLET OUT	TOP ELEV	REMARKS
1-1	HO CO STD A-5	342.75	348.82	345.38	SEE HO CO STD DETAIL SD 4.81
1-2	HO CO STD A-5	-----	342.75	348.18	SEE HO CO STD DETAIL SD 4.81
M-1	HO. CO. STD MANHOLE	341.93	341.25	358.88	SEE HO CO STD DETAIL SD 4.81
1-3	HO CO STD A-5	343.45	342.58	347.88	SEE HO CO STD DETAIL SD 4.81
1-4	HO CO STD A-5	-----	344.25	347.28	SEE HO CO STD DETAIL SD 4.81

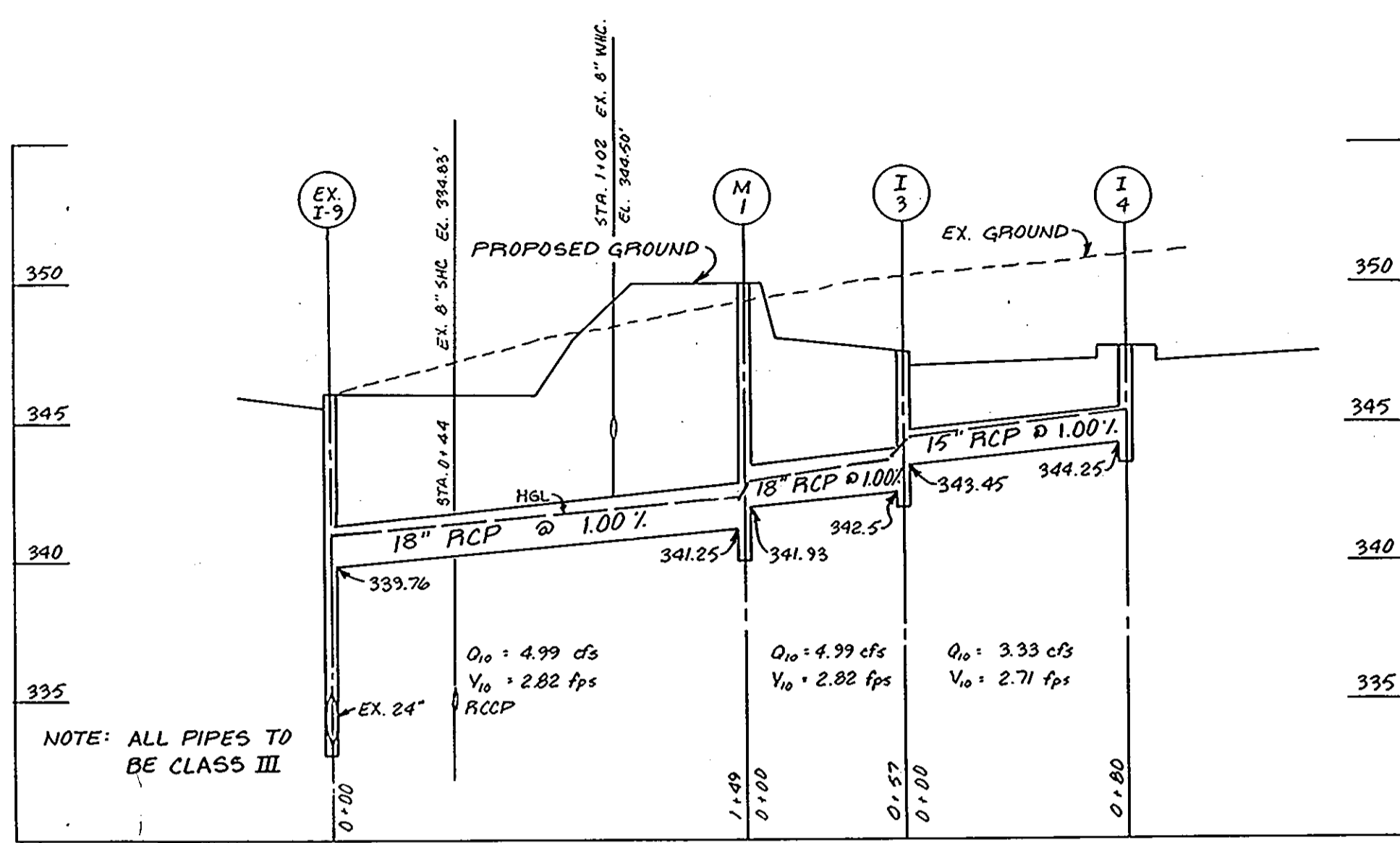

PROFILE - I-4 TO EXISTING I-9

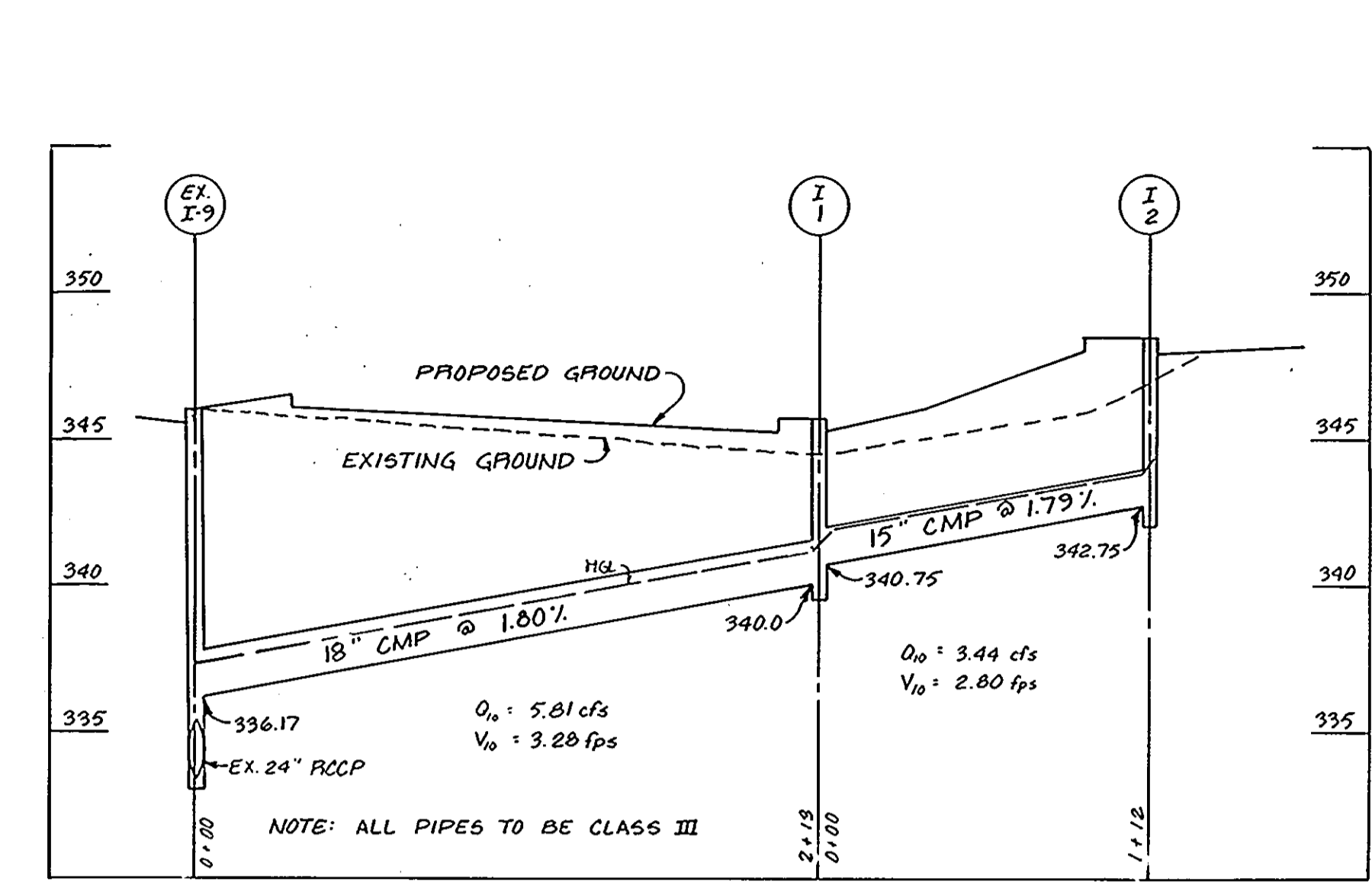

PROFILE - I-2 TO EXISTING I-9

STORM DRAIN PROFILE SCALE: VERT. 1"=5' HORZ. 1"=50'

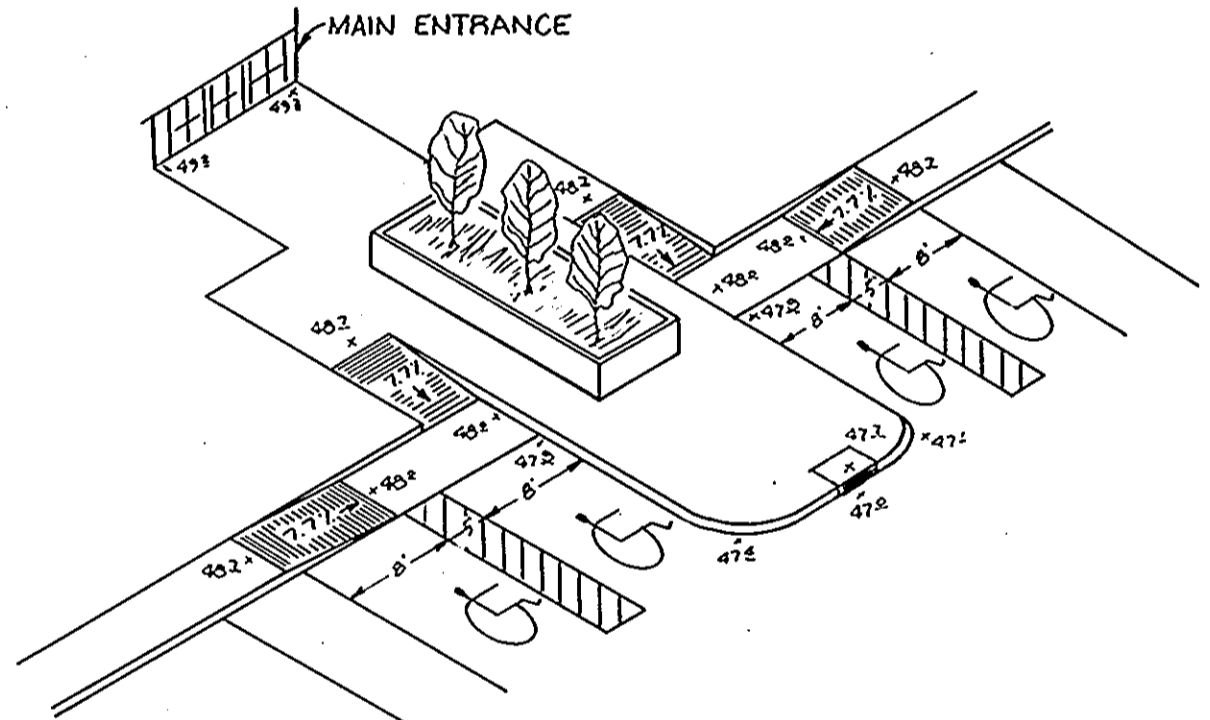

MAIN ENTRANCE HANDICAP RAMP #1 & #2
NO SCALE

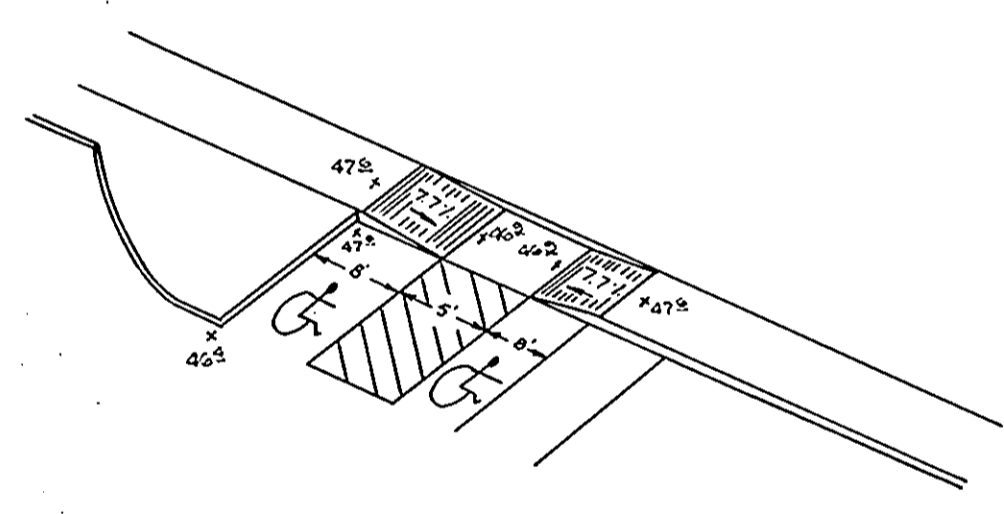

REAR ENTRANCE HANDICAP RAMP #3
NO SCALE

REVIEWED FOR HOWARD SOIL CONSERVATION DISTRICT AND MEETS TECHNICAL REQUIREMENTS.
James M. Helm 6/23/88
U.S. SOIL CONSERVATION SERVICE DATE

THIS DEVELOPMENT PLAN IS APPROVED FOR SOIL EROSION & SEDIMENT CONTROL BY THE HOWARD SOIL CONSERVATION DISTRICT.
Stephen L. Fisher 6/23/88
HOWARD SOIL CONSERVATION DISTRICT DATE

APPROVED: FOR PUBLIC WATER AND PUBLIC SEWERAGE SYSTEMS
HOWARD COUNTY HEALTH DEPARTMENT
Joseph B. ... 7-14-88
COUNTY HEALTH OFFICER DATE

APPROVED: FOR PUBLIC WATER AND PUBLIC SEWERAGE STORM DRAINAGE SYSTEMS AND PUBLIC ROADS
HOWARD COUNTY DEPARTMENT OF PUBLIC WORKS
James M. ... 7/13/88
DIRECTOR DATE
William R. ... 7-15-88
CHIEF BUREAU OF ENGINEERING DATE

APPROVED: HOWARD COUNTY OFFICE OF PLANNING AND ZONING
William R. ... 7-25-88
DIRECTOR DATE
David C. ... 7-21-88
CHIEF, DIVISION OF COMMUNITY PLANNING AND LAND DEVELOPMENT DATE

ENGINEERS CERTIFICATE
"I CERTIFY THAT THIS PLAN FOR EROSION & SEDIMENT CONTROL REPRESENTS A PRACTICAL AND WORKABLE PLAN BASED ON MY PERSONAL KNOWLEDGE OF THE SITE CONDITIONS AND THAT IT WAS PREPARED IN ACCORDANCE WITH THE REQUIREMENTS OF THE HOWARD SOIL CONSERVATION DISTRICT."

John ... 6/16/88
ENGINEERS SIGNATURE DATE

DEVELOPERS CERTIFICATE
"I/WE CERTIFY THAT ALL DEVELOPMENT & CONSTRUCTION WILL BE DONE ACCORDING TO THIS PLAN, AND THAT ANY RESPONSIBLE PERSONNEL INVOLVED IN THE CONSTRUCTION PROJECT WILL HAVE A CERTIFICATE OF ATTENDANCE AT A DEPARTMENT OF NATURAL RESOURCES APPROVED TRAINING PROGRAM FOR THE CONTROL OF SEDIMENT & EROSION BEFORE BEGINNING THE PROJECT. I ALSO AUTHORIZE PERIODIC ON-SITE INSPECTION BY THE HOWARD SOIL CONSERVATION DISTRICT."

James M. ... 2/19-88
DEVELOPERS SIGNATURE DATE

PROFILE & CONSTRUCTION DETAIL SHEET
RMIC/HILLCROFT OFFICE BLDG.
VILLAGE OF OWEN BROWN
SUBDIVISION OF PARCEL E-3 RE-SUBDIVISION OF PARCEL E-2
SECTION 5 AREA 1
6TH ELECTION DISTRICT
HOWARD COUNTY, MARYLAND

KIDDE CONSULTANTS, INC.
ENGINEERS • PLANNERS • SURVEYORS
1100 WEST STREET SUITE 100 LAUREL MD 20701
(301) 301-9153 FAX: (301) 792-8288 (B&I)
SHEET 6 OF 8
DATE: FEBRUARY 1988 SCALE: AS SHOWN

APPROVED
PLANNING BOARD
OF HOWARD COUNTY
DATE 6-8-88
LB

OWNER/DEVELOPER
CRYSTAL HILL INVESTMENTS
1005 OLD COLUMBIA ROAD
COLUMBIA, MARYLAND 21046

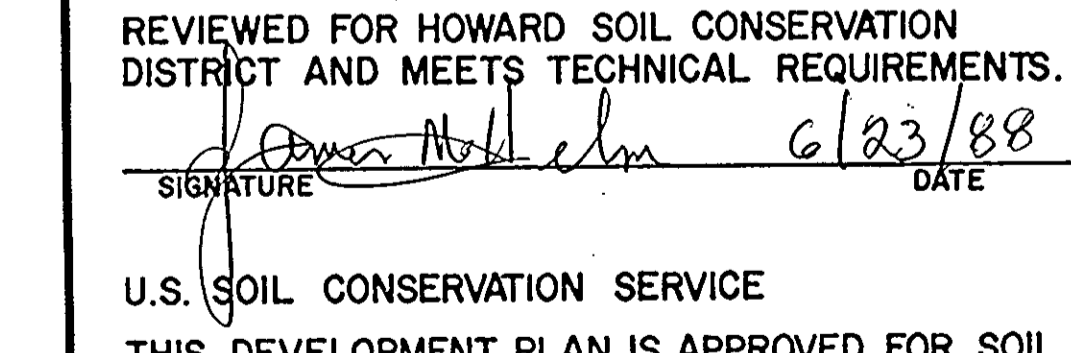
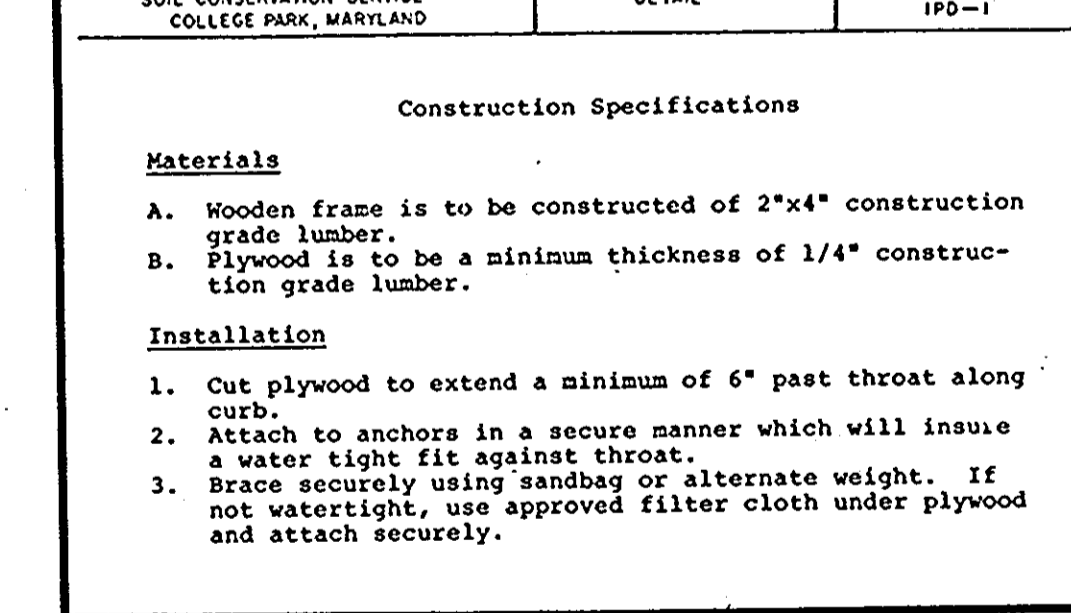
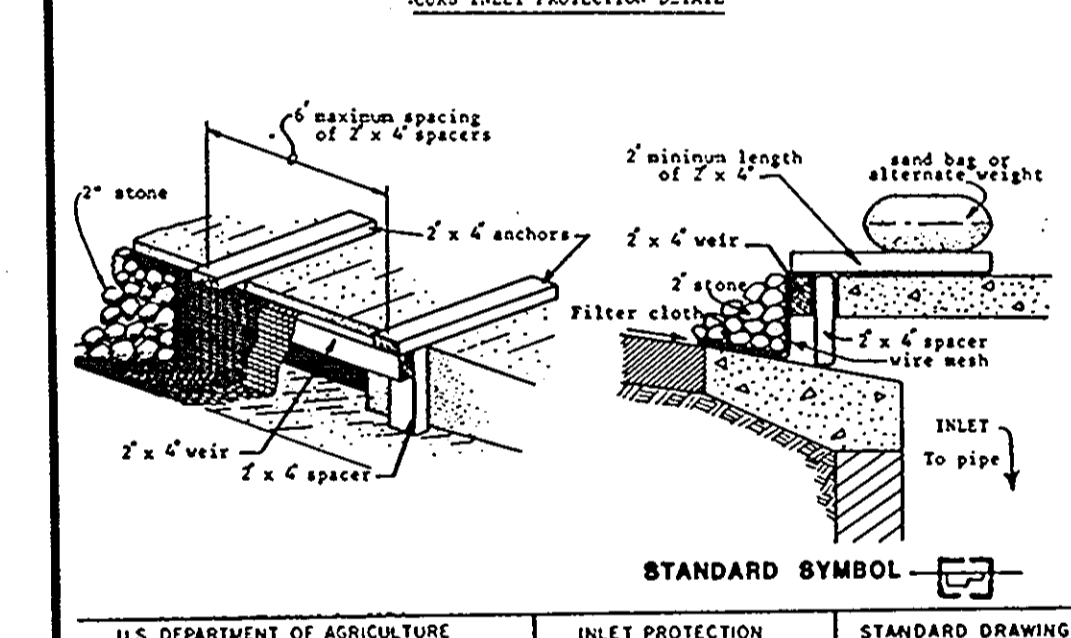
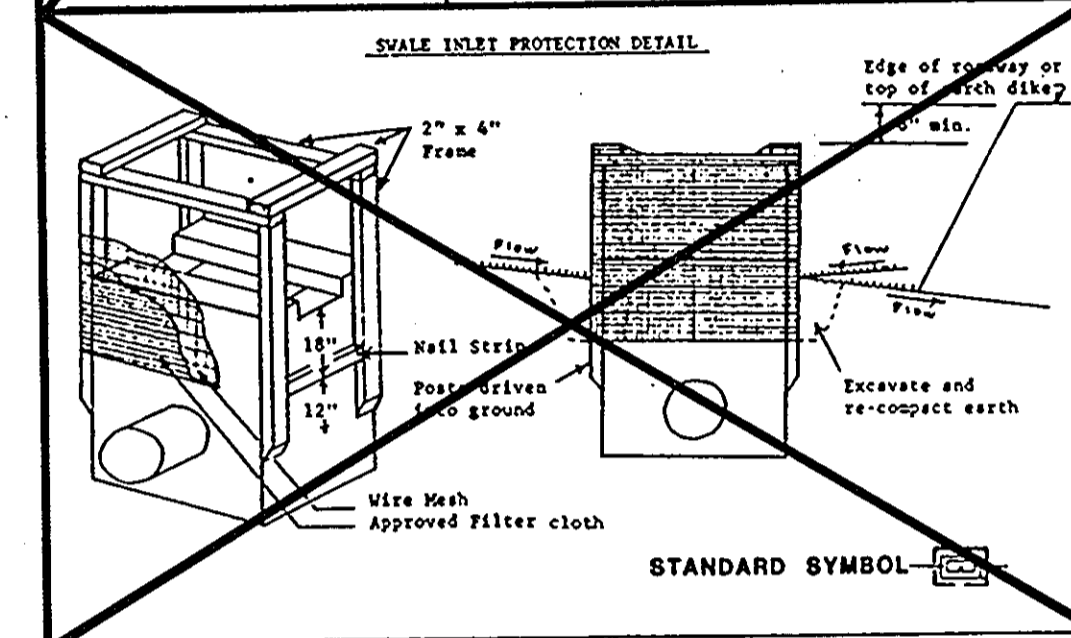
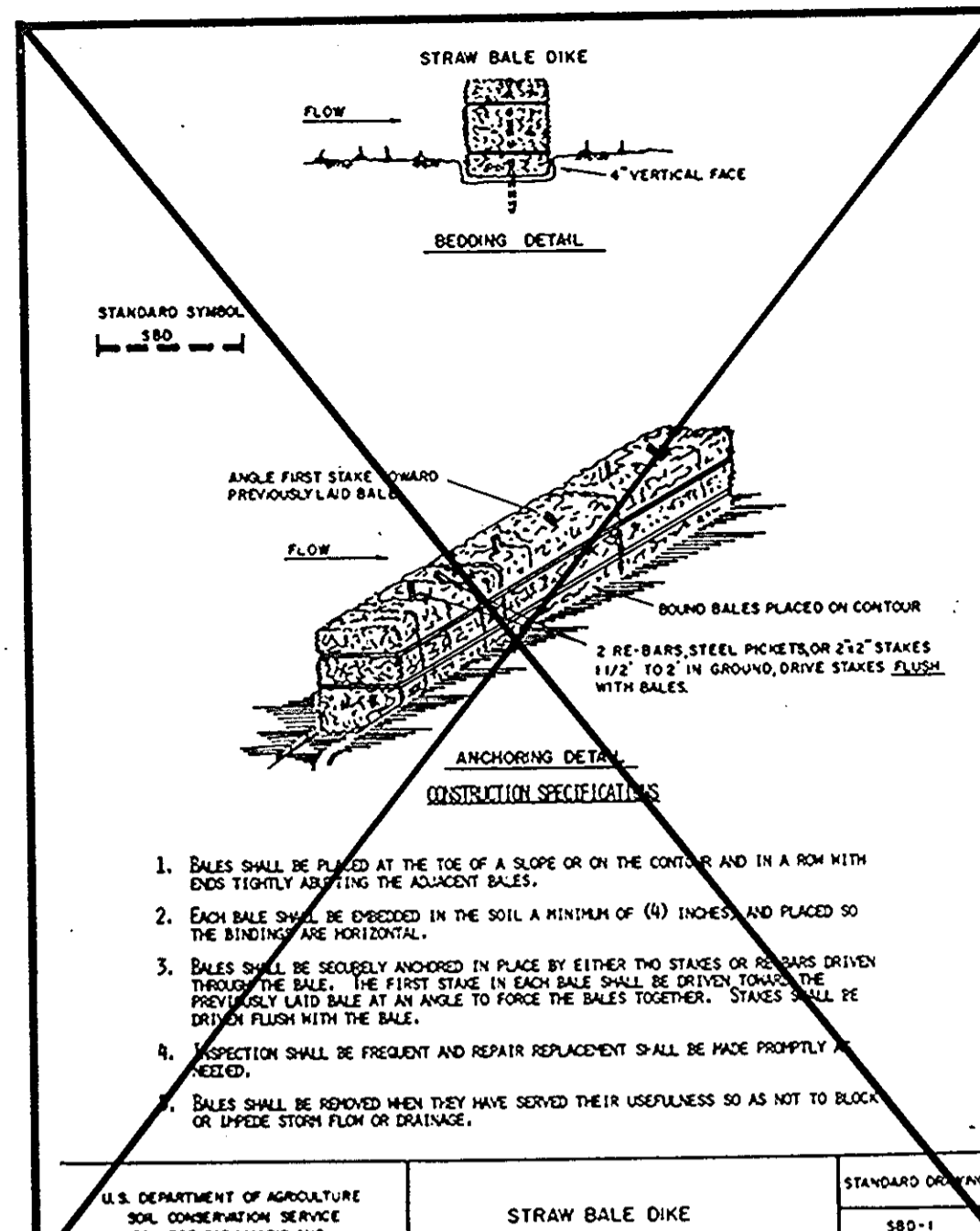

PERMANENT SEEDING NOTES

Apply to graded or cleared areas not subject to immediate further disturbance where a permanent long-lived vegetative cover is needed.

Seeding Preparation: Loosen upper three inches of soil by raking, discing or other acceptable means before seeding, IF NOT PREVIOUSLY LOOSENED.

Soil Amendments: In lieu of soil test recommendations, use one of the following schedules:

- 1) Preferred - Apply 2 tons per acre dolomitic limestone (92 lbs/1000 sq ft) and 600 lbs per acre 10-10-10 fertilizer (14 lbs/1000 sq ft) before seeding; harrow or disc into upper three inches of soil. At time of seeding, apply 400 lbs per acre 30-0-0 urea fertilizer (9 lbs/1000 sq ft).
- 2) Acceptable - Apply 2 tons per acre dolomitic limestone (92 lbs/1000 sq ft) and 1000 lbs per acre 10-10-10 fertilizer (23 lbs/1000 sq ft) before seeding; harrow or disc into upper three inches of soil.

Seeding - For the periods March 1 thru April 30, and August 1 thru October 15, seed with 60 lbs per acre (1.4 lbs/1000 sq ft) of Kentucky 31 Tall Fescue. For the period May 1 thru July 31, seed with 60 lbs per acre 10-10-10 fertilizer (14 lbs/1000 sq ft) before seeding; harrow or disc into upper three inches of soil. During the period of October 16 thru February 28, protect site by: Option (1) 2 tons per acre of well anchored straw mulch and seed as soon as possible in the spring. Option (2) Use sod. Option (3) Seed with 60 lbs/acre Kentucky 31 Tall Fescue and mulch with 2 tons/acre well anchored straw.

Mulching - Apply 1 1/2 to 2 tons per acre (70 to 90 lbs/1000 sq ft) of unrotted small grain straw immediately after seeding. Anchor mulch immediately after application using mulch anchoring tool or 2 1/2 gal per acre of emulsified asphalt on flat areas; on slopes 8 feet or higher, use 348 gallons per acre (8 gal/1000 sq ft) for anchoring.

Maintenance - Inspect all seeded areas and make needed repairs, replacements and reseedings.

TEMPORARY SEEDING NOTES

Apply to graded or cleared areas likely to be redisturbed where a short-term vegetative cover is needed.

Seeding Preparation: Loosen upper three inches of soil by raking, discing or other acceptable means before seeding, IF NOT PREVIOUSLY LOOSENED.

Soil Amendments: Apply 600 lbs per acre 10-10-10 fertilizer (14 lbs/1000 sq ft)

Seeding: For periods March 1 thru April 30 and from August 15 thru November 15, seed with 25 bushel per acre of annual ryegrass (3.2 lbs/1000 sq ft). For the period May 1 thru August 14, seed with 3 lbs per acre of vernal ryegrass (.07 lbs/1000 sq ft). For the period November 16 thru February 28, protect site by applying 2 tons per acre of well anchored straw mulch and seed as soon as possible in the spring, or use sod.

Mulching: Apply 1 1/2 to 2 tons per acre (70 to 90 lbs/1000 sq ft) of unrotted small grain straw immediately after seeding. Anchor mulch immediately after application using mulch anchoring tool or 2 1/2 gal per acre (5 gal/1000 sq ft) of emulsified asphalt on flat areas; on slopes, 8 ft or higher, use 348 gal per acre (8 gal/1000 sq ft) for anchoring.

Refer to the 1983 MARYLAND STANDARDS AND SPECIFICATIONS FOR SOIL EROSION AND SEDIMENT CONTROL for rate and methods not covered.

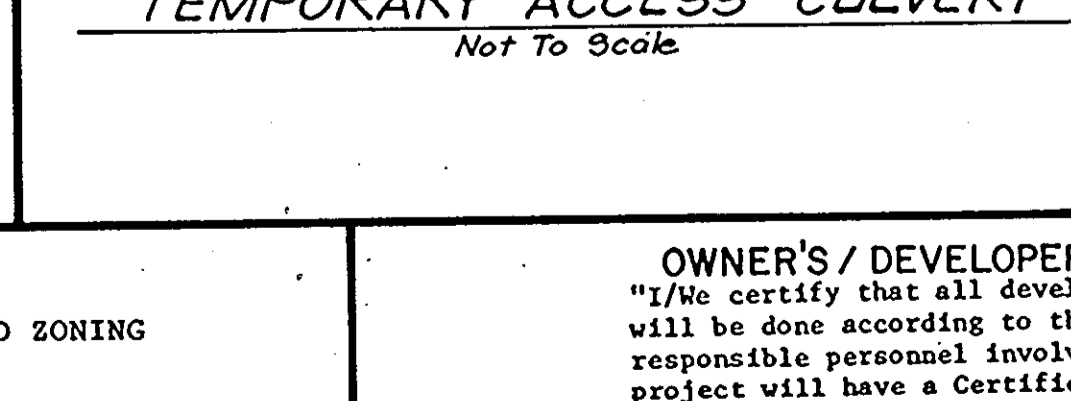
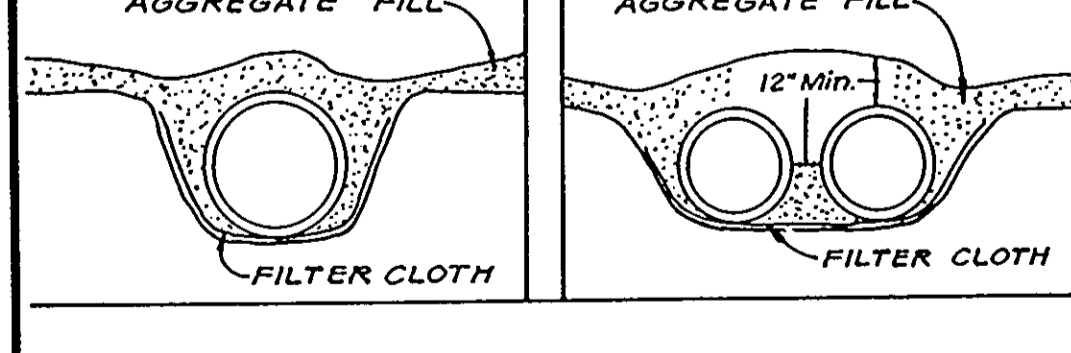
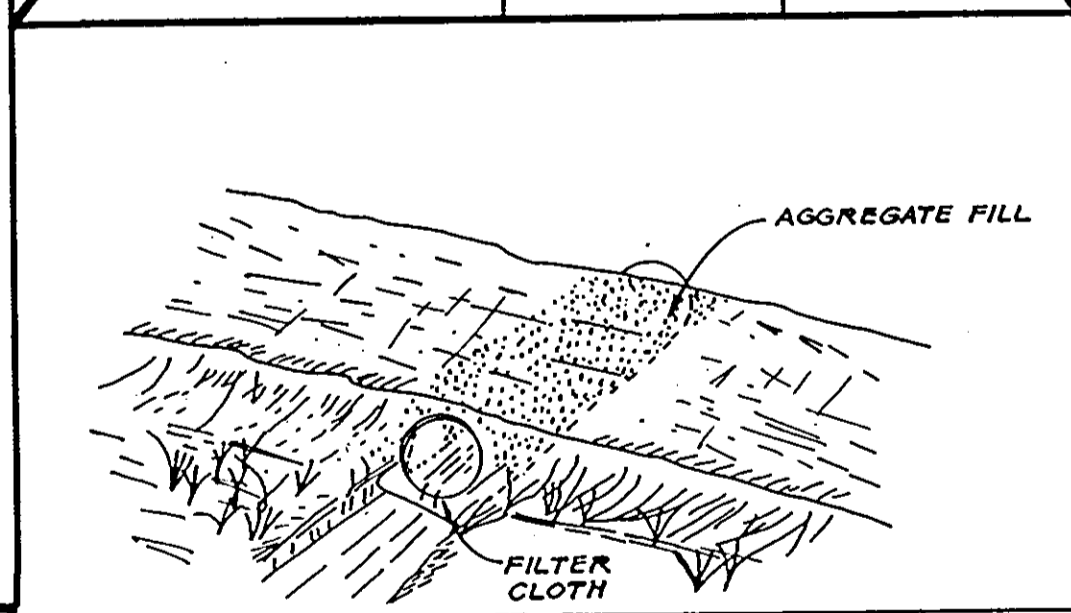
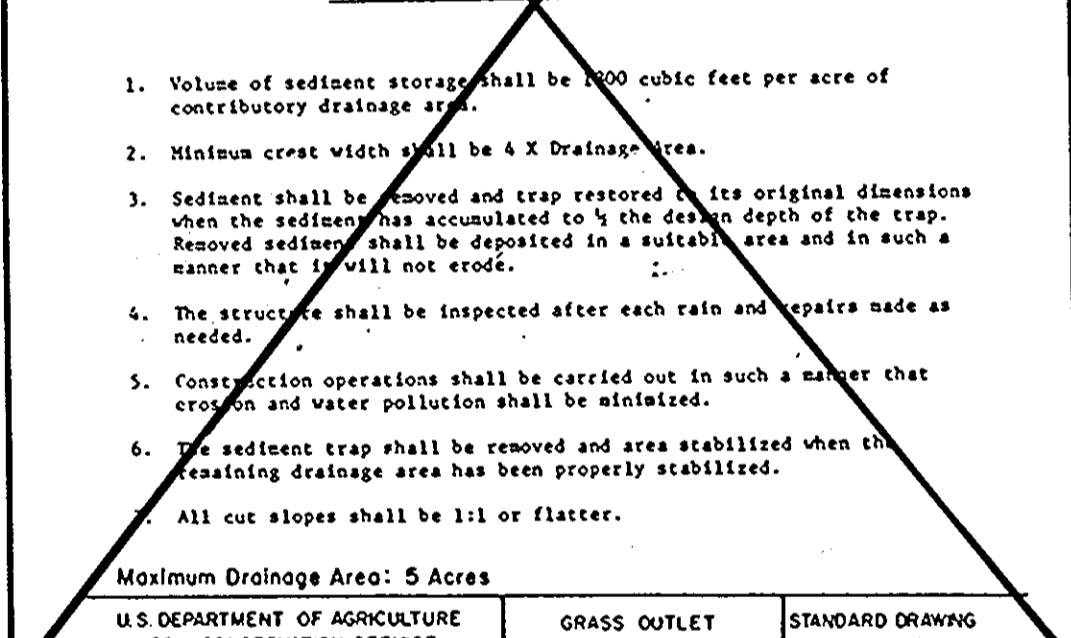
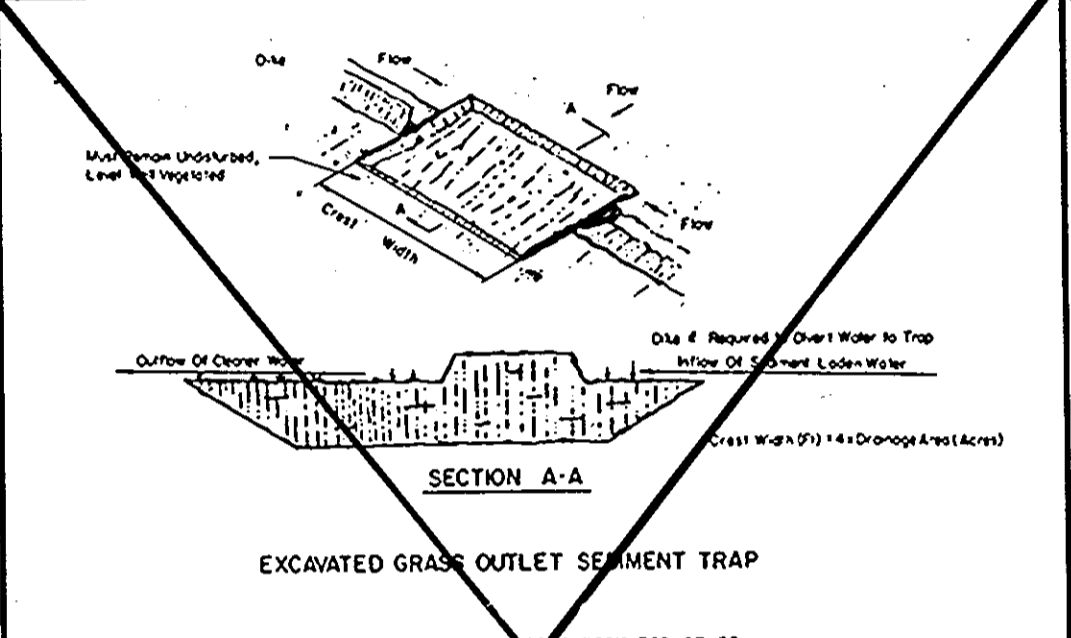
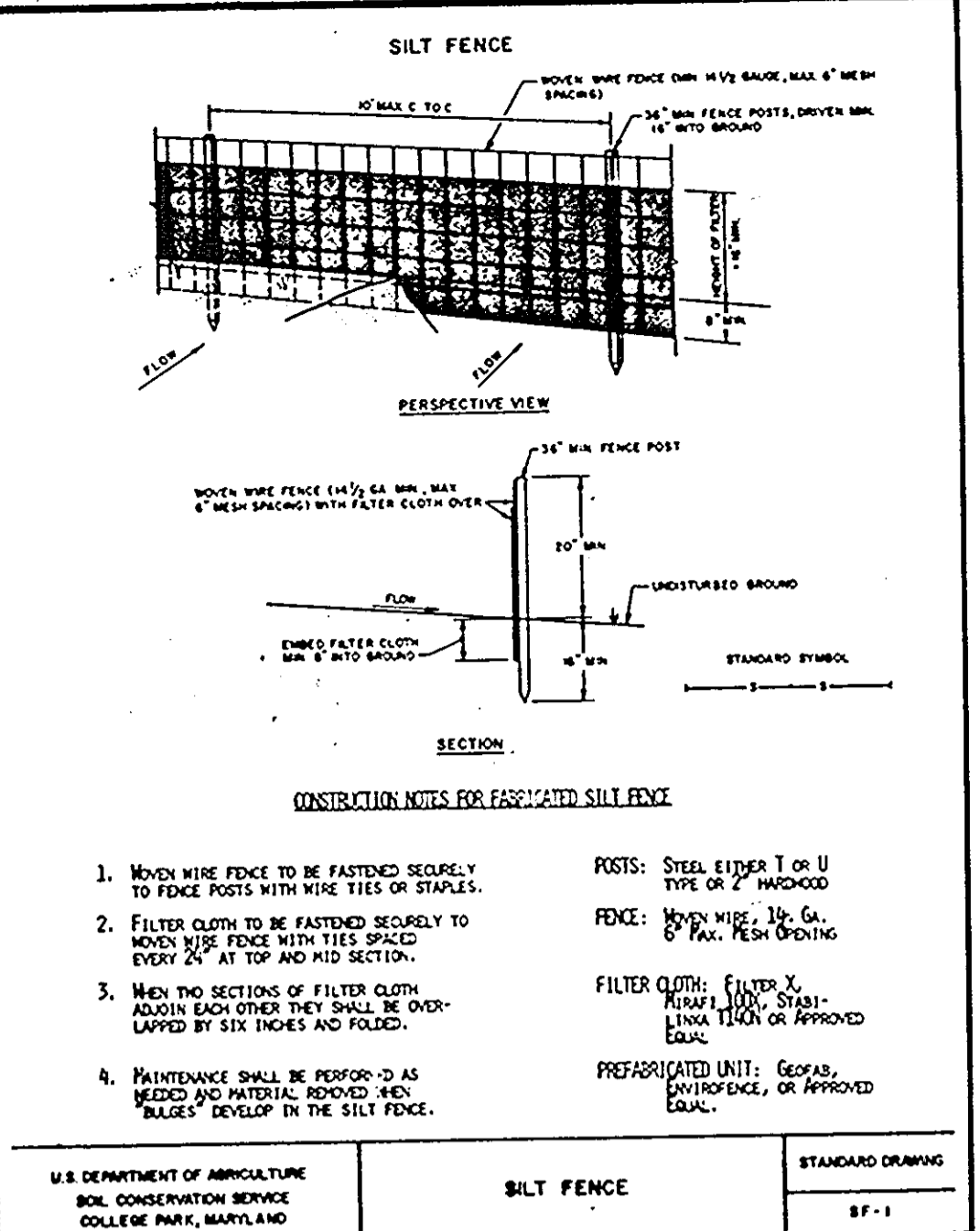

CONSTRUCTION SPECIFICATIONS FOR ST-II

1. Volume of sediment storage shall be 1000 cubic feet per acre of contributory drainage area.
2. Minimum crest width shall be 4' X Drainage Area.
3. Sediment shall be removed and trap restored to its original dimensions when the sediment has accumulated to 1/2 the design depth of the trap. Removed sediment shall be deposited in a suitable area and in such a manner that it will not erode.
4. The structure shall be inspected after each rain and repairs made as needed.
5. Construction operations shall be carried out in such a manner that erosion and water pollution shall be minimized.
6. The sediment trap shall be removed and area stabilized when the existing drainage area has been properly stabilized.

All out slopes shall be 1:1 or flatter.

CONSTRUCTION SPECIFICATIONS FOR ST-VI

1. The area under embankment shall be cleared, grubbed and stripped of any vegetation and root mat. The pool area shall be cleared.
2. The fill material for the embankment shall be free of roots and other woody vegetation as well as oversized stones, rocks, organic material or other objectionable material. The embankment shall be compacted by leveling with equipment while it is being constructed. Maximum height of embankment shall be five (5) feet, measured at centerline of embankment.
3. All fill slopes shall be 2:1 or flatter; cut slopes 1:1 or flatter.
4. Elevation of the top of any dike directing water into trap must equal or exceed the height of embankment.
5. Storage area provided shall be figured by computing the volume available behind the outlet channel up to an elevation of one (1) foot below the level weir crest.
6. Filter cloth shall be placed over the bottom and fabric of the outlet channel prior to placement of stone. Sections of fabric must overlap at least one (1) foot with section nearest the entrance placed on top. Fabric shall be embedded at least six (6) inches into existing ground at entrance of outlet channel.
7. Stone used in the outlet channel shall be four (4) to eight (8) inches (riprap). To provide a filtering effect, a layer of filter cloth shall be embedded one (1) foot back into the upstream face of the outlet stone or one (1) foot thick layer of two (2) inch or finer aggregate shall be placed on the upstream face of the outlet.
8. Sediment shall be removed and trap restored to its original dimensions when the sediment has accumulated to 1/2 the design depth of the trap. Removed sediment shall be deposited in a suitable area and in such a manner that it will not erode.
9. The structure shall be inspected after each rain and repaired as needed.
10. Construction operations shall be carried out in such a manner that erosion and water pollution are minimized.
11. The structure shall be removed and the area stabilized when the drainage area has been properly stabilized.
12. Drainage area for this practice is limited to 15 acres or less.

CONSTRUCTION SPECIFICATIONS FOR ST-VI

1. Area under embankment shall be cleared, grubbed and stripped of any vegetation and root mat. The pool area shall be cleared.
2. The fill material for the embankment shall be free of roots and other woody vegetation as well as oversized stones, rocks, organic material or other objectionable material. The embankment shall be compacted by leveling with equipment while it is being constructed. Maximum height of embankment shall be five (5) feet, measured at centerline of embankment.
3. All fill slopes shall be 2:1 or flatter; cut slopes 1:1 or flatter.
4. Elevation of the top of any dike directing water into trap must equal or exceed the height of embankment.
5. Storage area provided shall be figured by computing the volume available behind the outlet channel up to an elevation of one (1) foot below the level weir crest.
6. Filter cloth shall be placed over the bottom and fabric of the outlet channel prior to placement of stone. Sections of fabric must overlap at least one (1) foot with section nearest the entrance placed on top. Fabric shall be embedded at least six (6) inches into existing ground at entrance of outlet channel.
7. Stone used in the outlet channel shall be four (4) to eight (8) inches (riprap). To provide a filtering effect, a layer of filter cloth shall be embedded one (1) foot back into the upstream face of the outlet stone or one (1) foot thick layer of two (2) inch or finer aggregate shall be placed on the upstream face of the outlet.
8. Sediment shall be removed and trap restored to its original dimensions when the sediment has accumulated to 1/2 the design depth of the trap. Removed sediment shall be deposited in a suitable area and in such a manner that it will not erode.
9. The structure shall be inspected after each rain and repaired as needed.
10. Construction operations shall be carried out in such a manner that erosion and water pollution are minimized.
11. The structure shall be removed and the area stabilized when the drainage area has been properly stabilized.
12. Drainage area for this practice is limited to 15 acres or less.

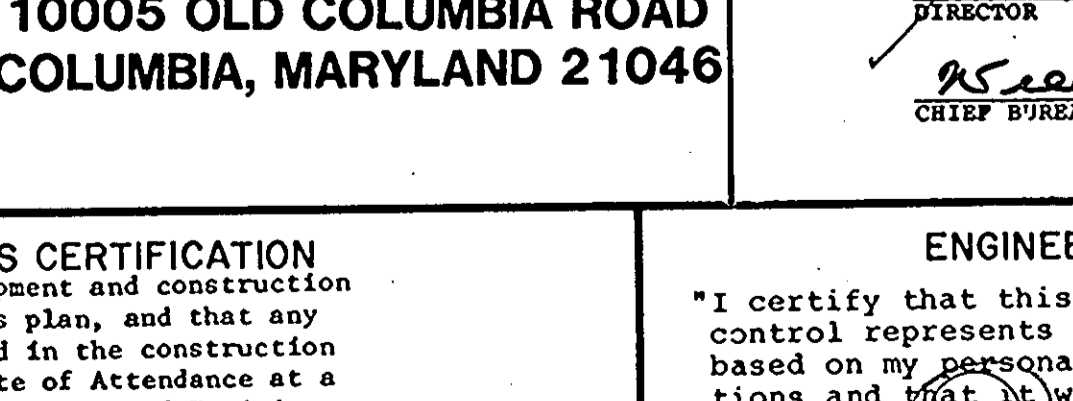
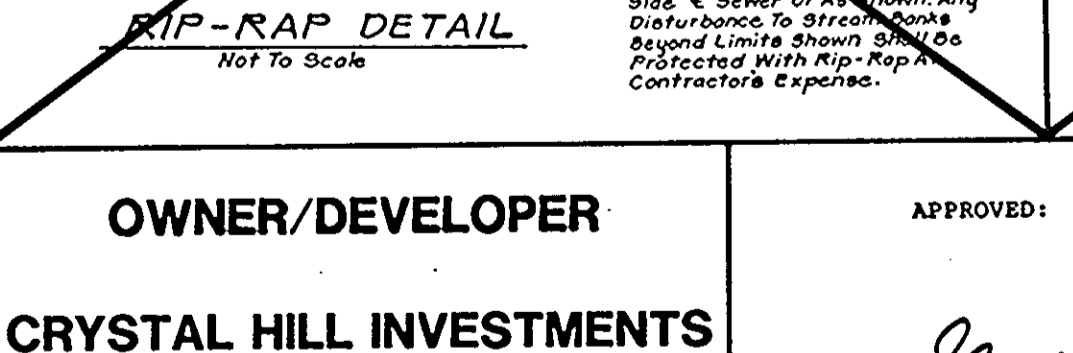
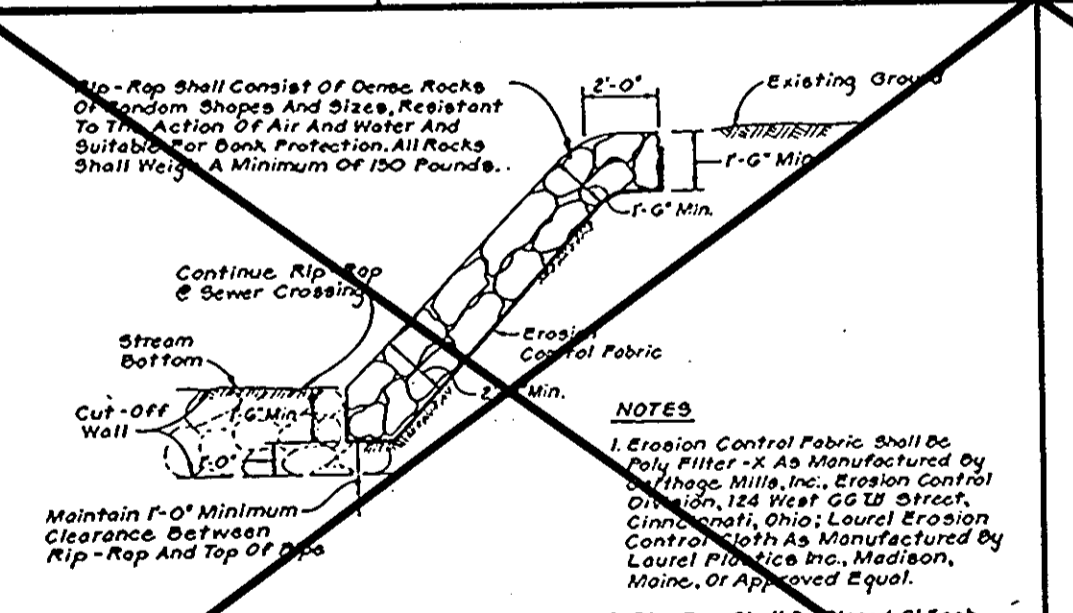
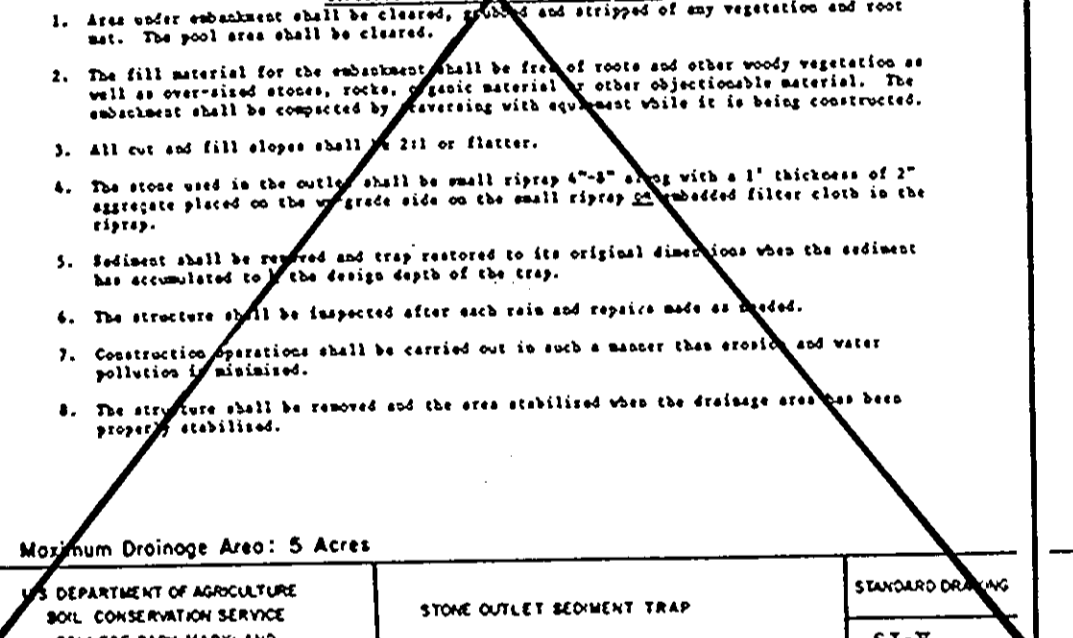
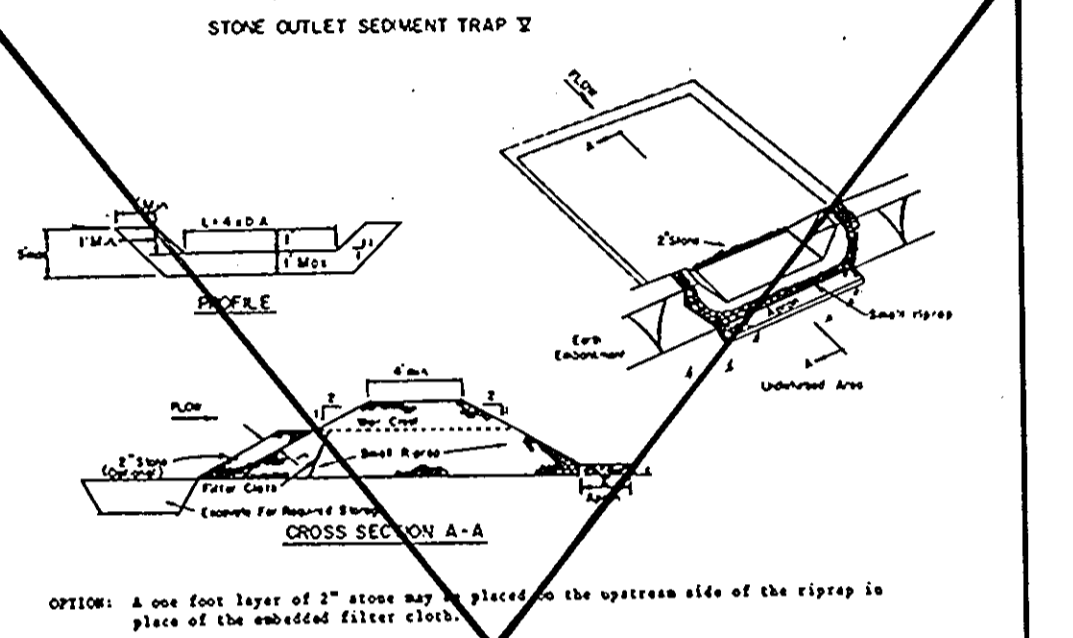
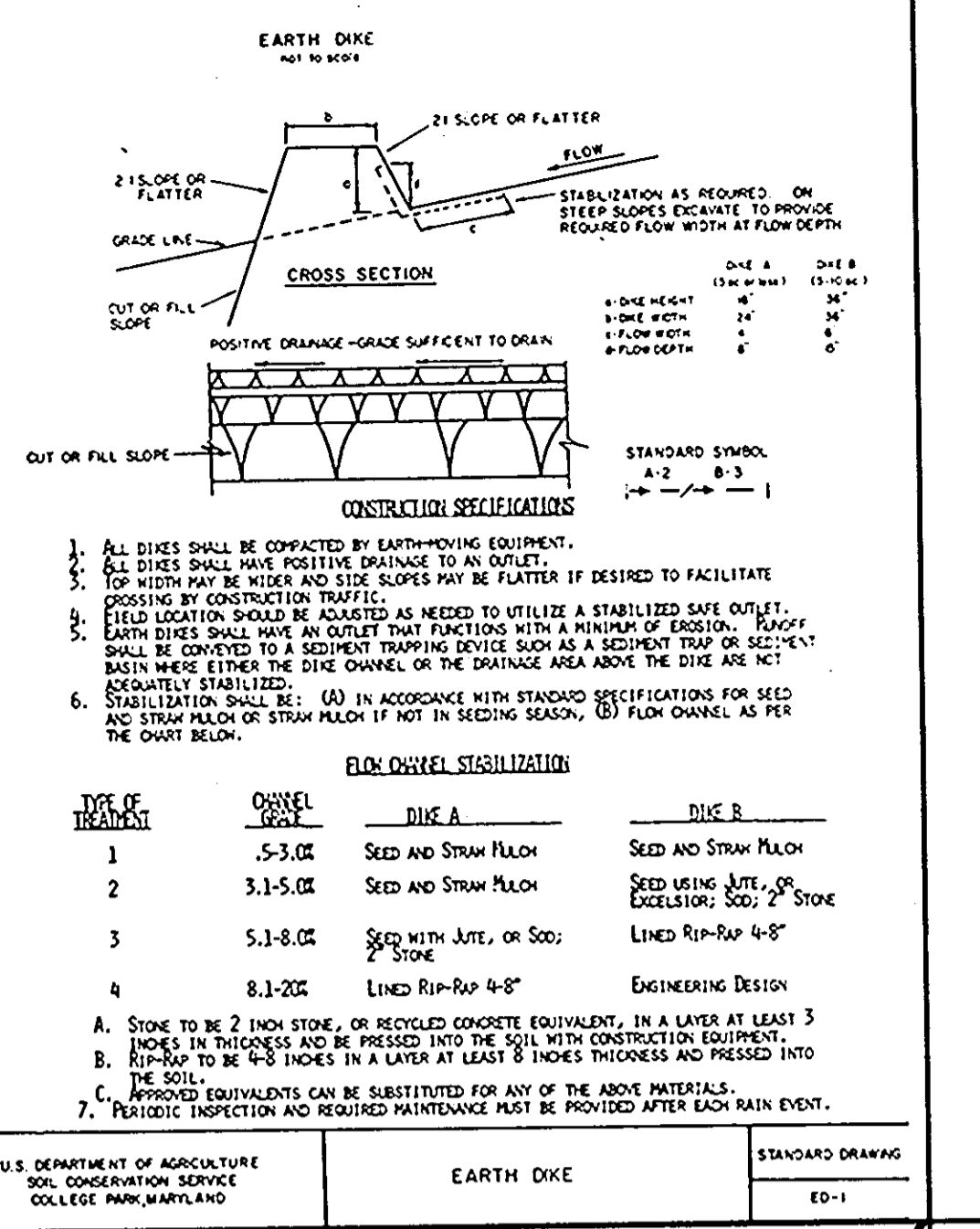

SOIL CONSERVATION MEASURES AT SMALL STREAM CROSSING

Contributing Drainage Area (Acres)	Depth of Channel (Feet)	Length of Weir (b) (Feet)
1	1.5	4.0
2	1.5	5.0
3	1.5	6.0
4	1.5	10.0
5	1.5	12.0
6	1.5	14.0
7	1.5	16.0
8	2.0	10.0
9	2.0	10.0
10	2.0	12.0
11	2.0	14.0
12	2.0	16.0
13	2.0	16.0
14	2.0	16.0
15	2.0	18.0

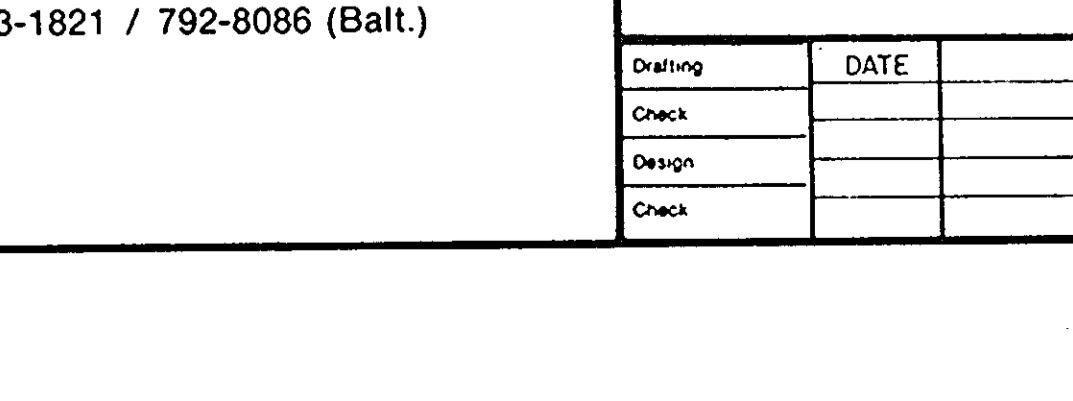
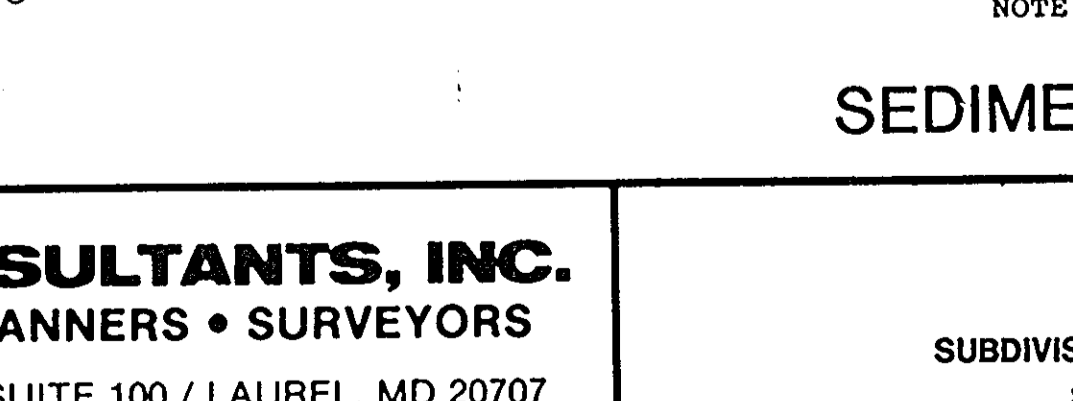
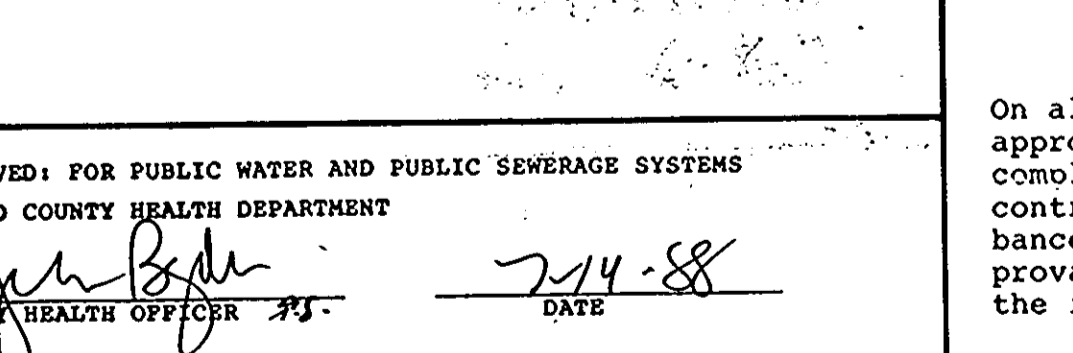
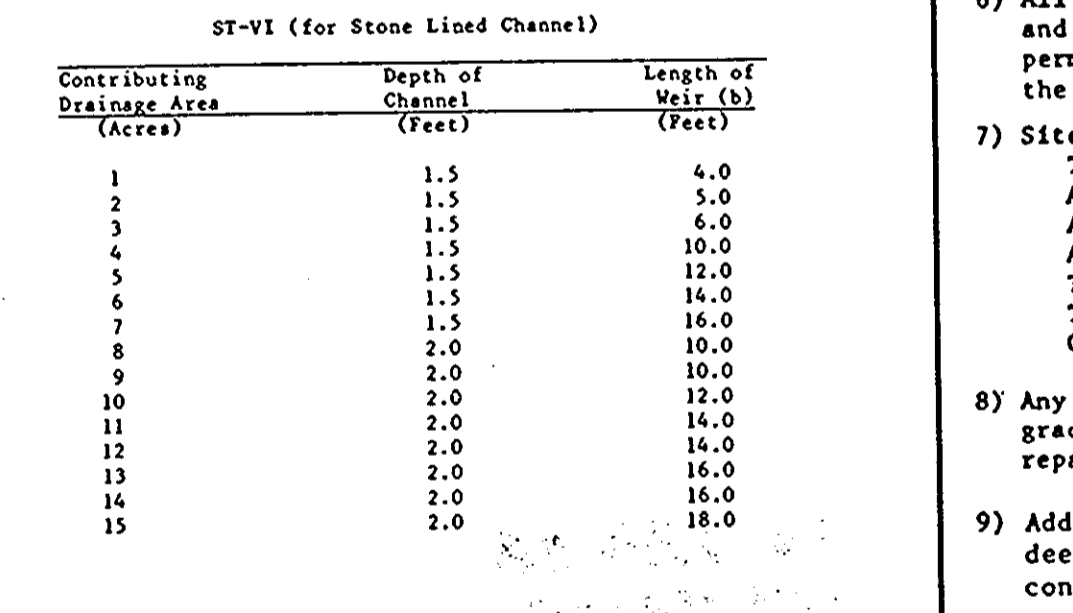
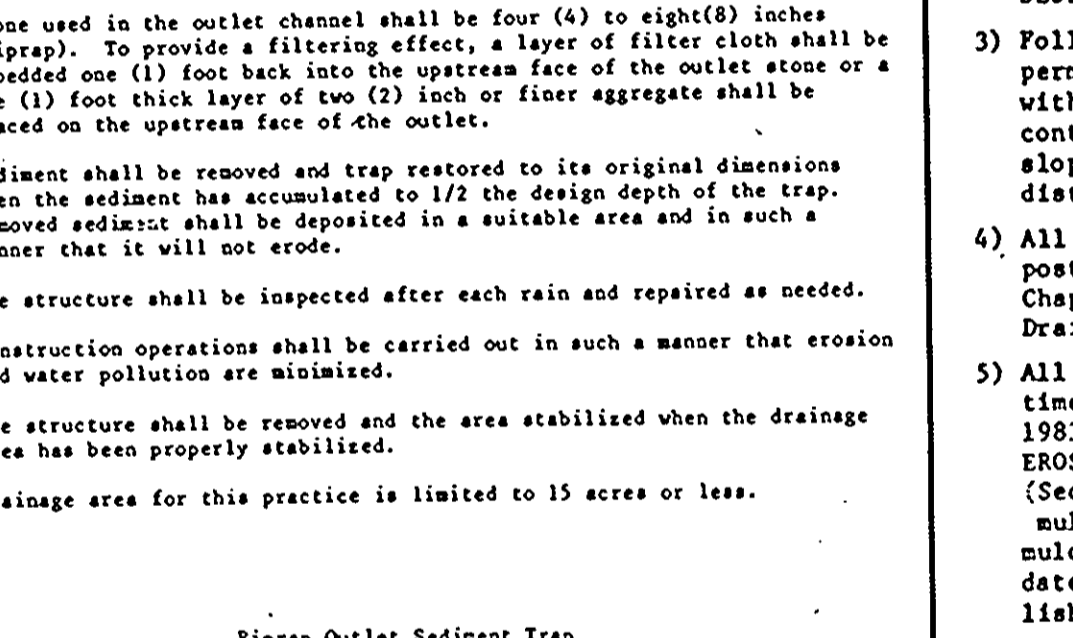
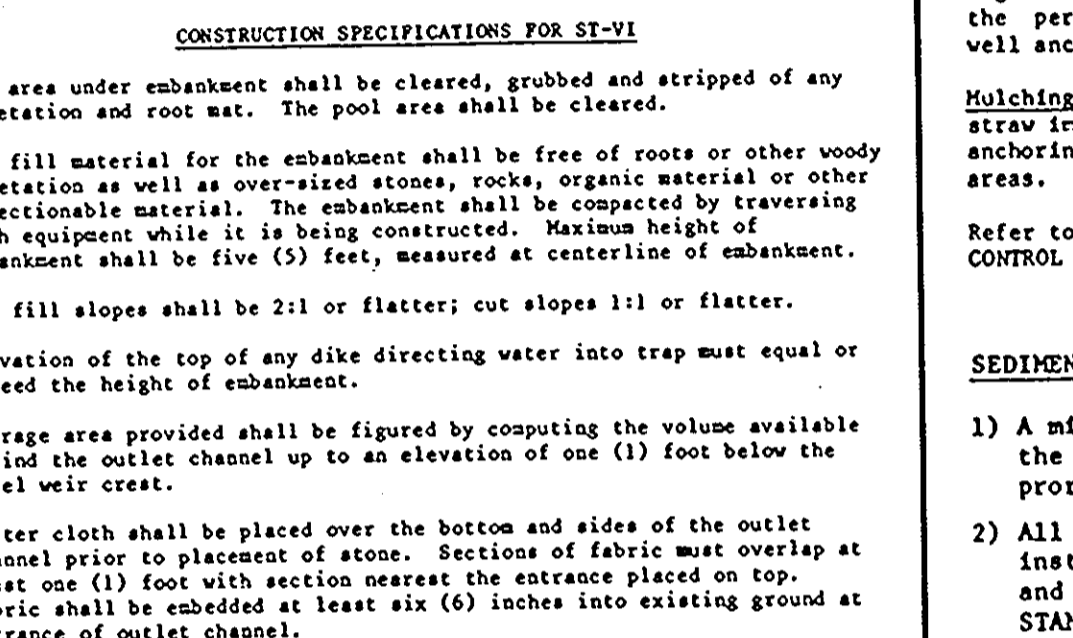
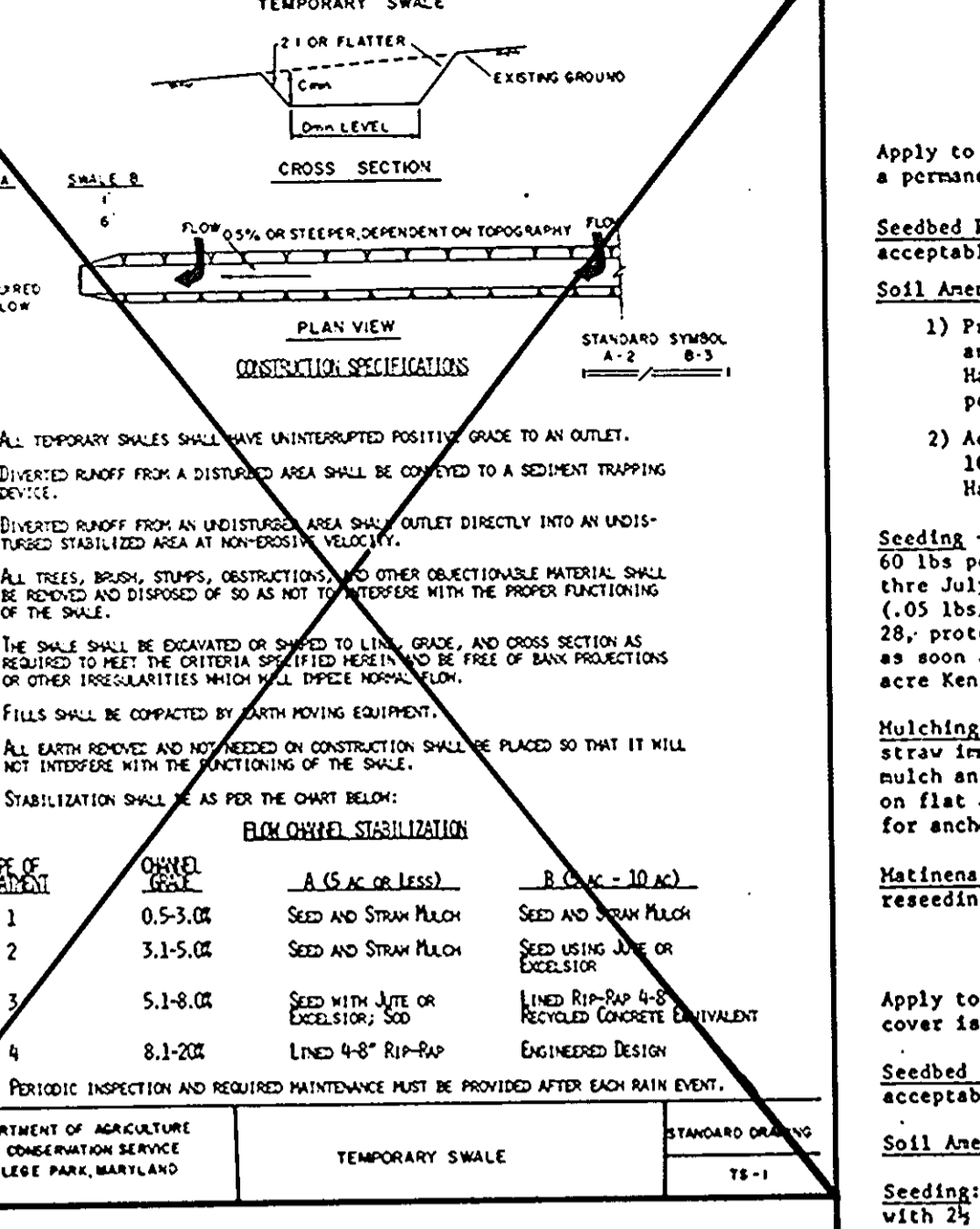
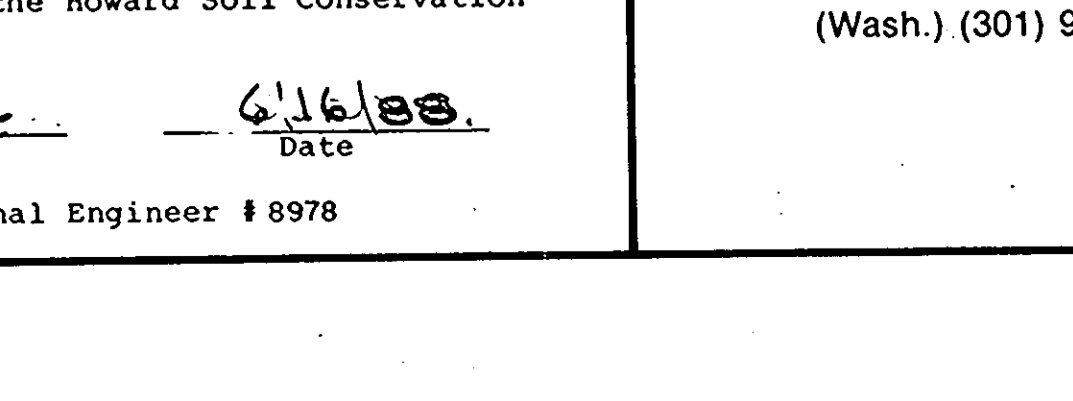
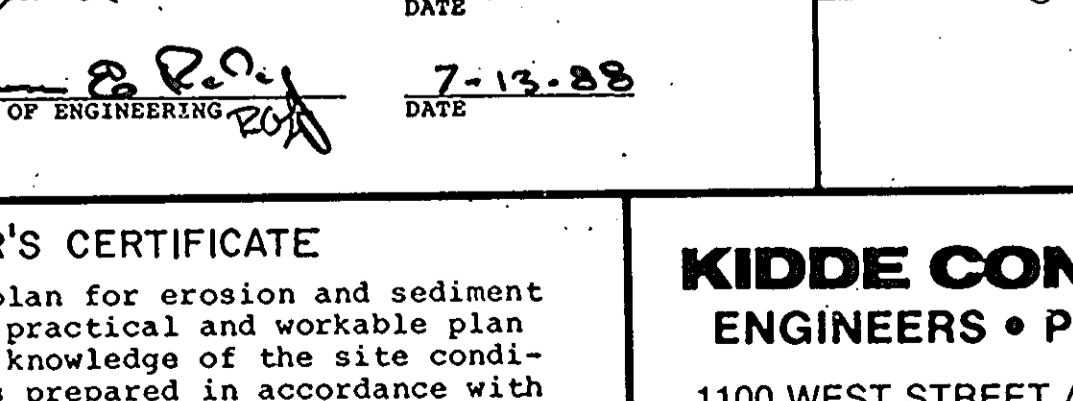
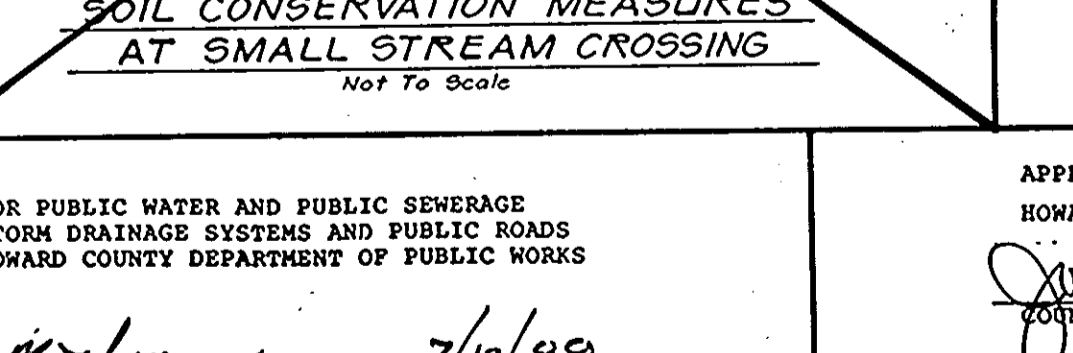
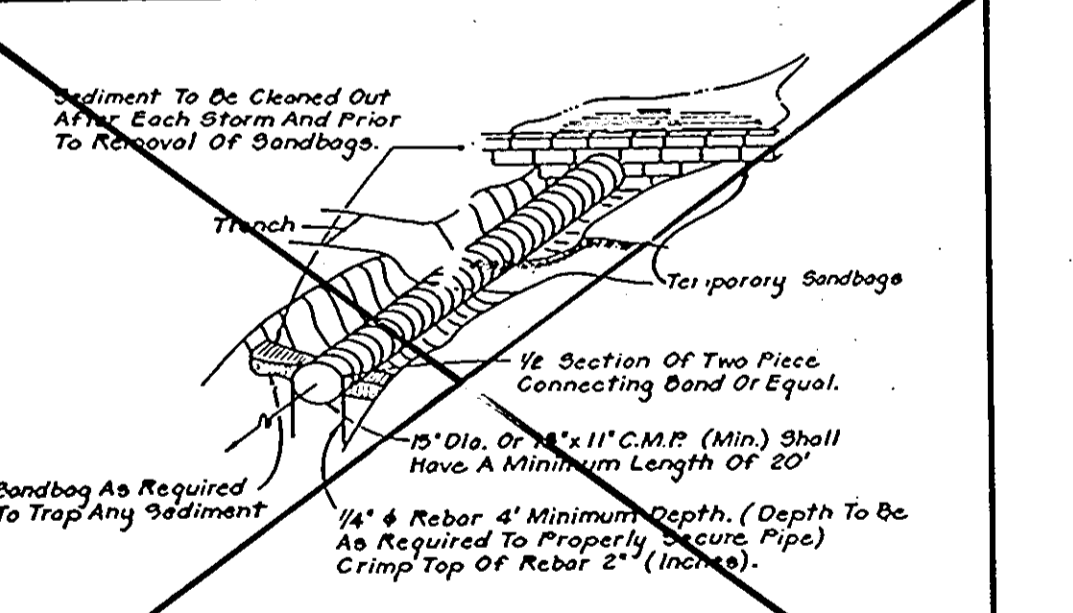
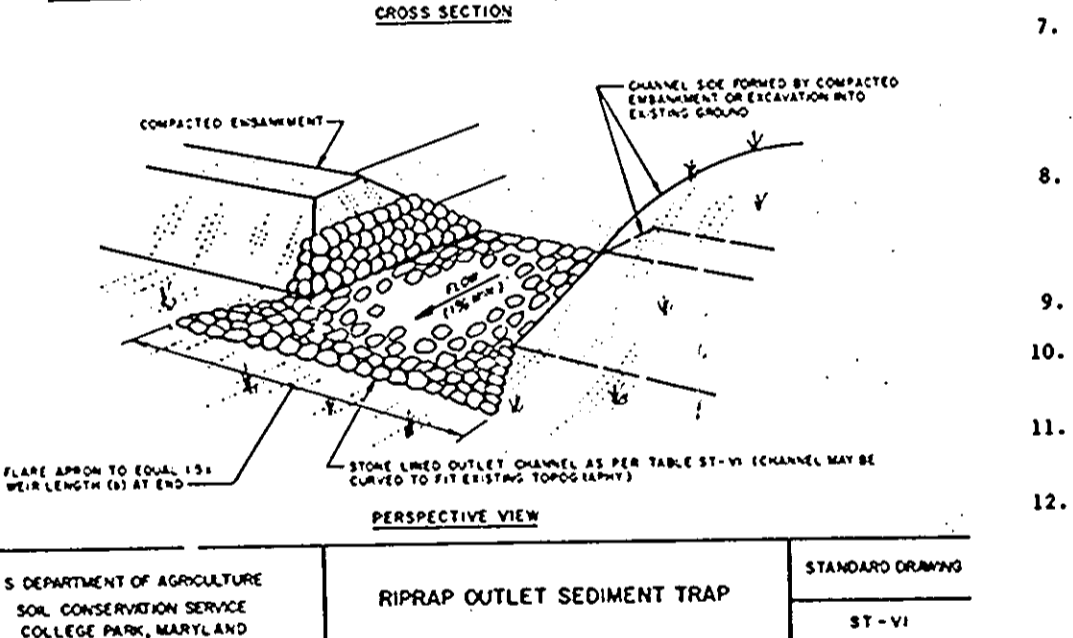
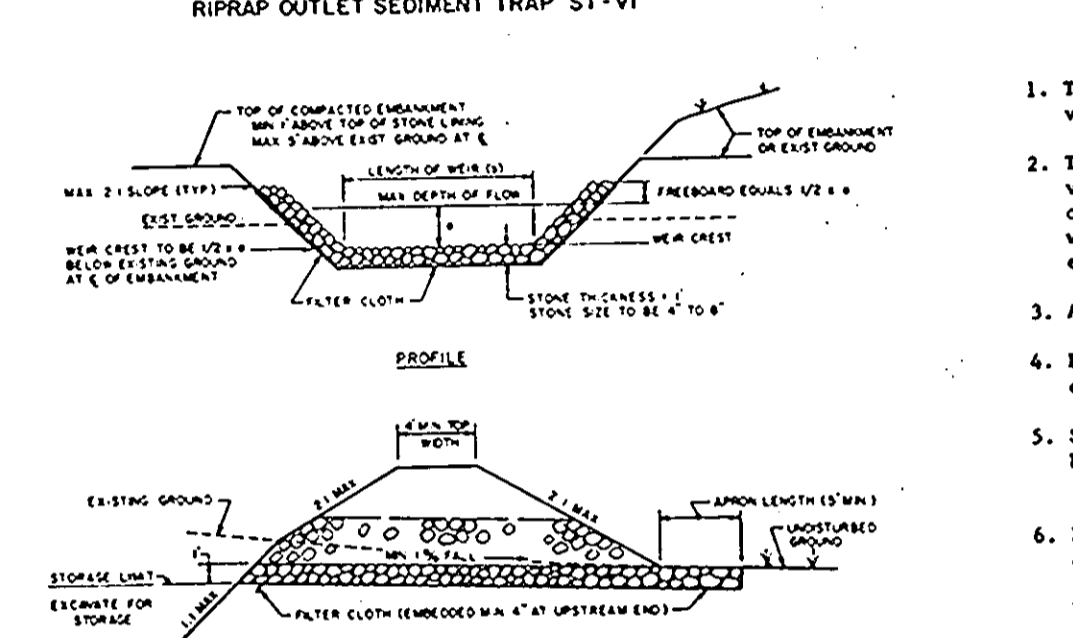
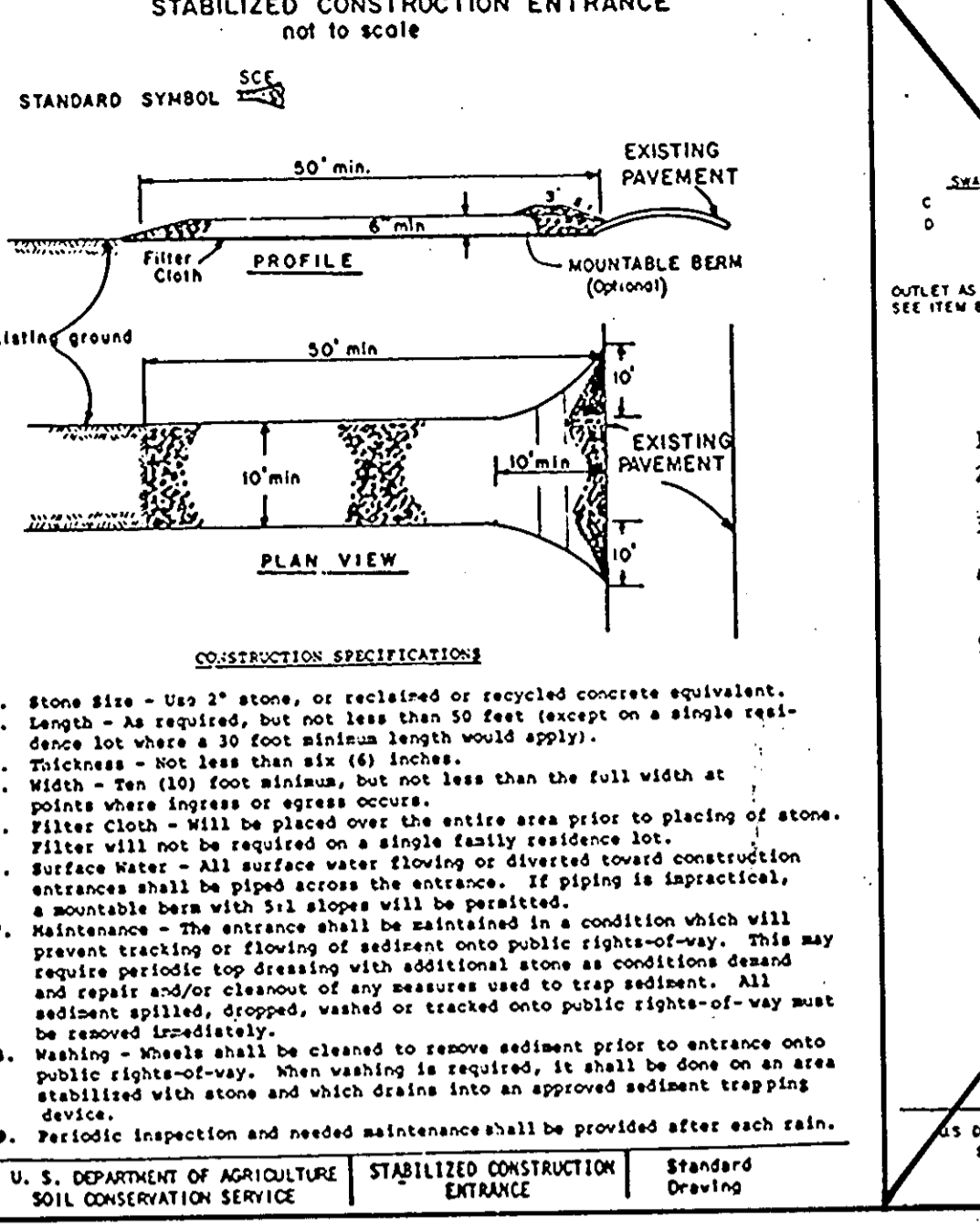

OWNER/DEVELOPER
CRYSTAL HILL INVESTMENTS
1005 OLD COLUMBIA ROAD
COLUMBIA, MARYLAND 21046

ENGINEER'S CERTIFICATE
I certify that this plan for erosion and sediment control represents a practical and workable plan based on my personal knowledge of the site conditions and that it was prepared in accordance with the requirements of the Howard Soil Conservation District.
John E. Johnson
DATE: 6/16/88
REGISTERED PROFESSIONAL ENGINEER # 8978

APPROVED FOR PUBLIC WATER AND PUBLIC SEWERAGE
HOWARD COUNTY HEALTH DEPARTMENT
John E. Johnson
DATE: 7/13/88
CHIEF BUREAU OF ENGINEERING

APPROVED FOR PUBLIC WATER AND PUBLIC SEWERAGE SYSTEMS
HOWARD COUNTY HEALTH DEPARTMENT
John E. Johnson
DATE: 7/14/88
COUNTY HEALTH OFFICER

APPROVED
PLANNING BOARD
OF HOWARD COUNTY
DATE: 6-8-88

ON ALL SITES WITH DISTURBED AREAS IN EXCESS OF 2 ACRES, APPROVAL OF THE INSPECTION AGENCY SHALL BE REQUESTED UPON COMPLETION OF INSTALLATION OF PERIMETER EROSION AND SEDIMENT CONTROL, BUT BEFORE PROCEEDING WITH ANY OTHER EARTH DISTURBANCE OR GRADING. OTHER BUILDING OR GRADING INSPECTION APPROVALS MAY NOT BE AUTHORIZED UNTIL THIS INITIAL APPROVAL BY THE INSPECTION AGENCY IS MADE.

NOTE: FOR SEQUENCE OF CONSTRUCTIONS, SEE SHEET 6 OF 8.

OWNER'S / DEVELOPER'S CERTIFICATION
"I/We certify that all development and construction will be done according to this plan, and that any responsible personnel involved in the construction project will have a Certificate of Attendance at a Department of Natural Resources Approved Training Program for the Control of Sediment and Erosion before beginning the project. I also authorize periodic on-site inspection by the Howard Soil Conservation District."
Signature: *Dana M. Cheslow* Date: 6/16/88
Name: Dana M. Cheslow Title: Pres. Director Phone No. 381-4444
Firm: Crystal Hill Investments Complete Address: 1005 Old Columbia Rd. Columbia, MD 21046

SEDIMENT CONTROL DETAIL SHEET
RMIC/HILLCROFT
OFFICE BUILDING
VILLAGE OF OWEN BROWN
SUBDIVISION OF PARCEL E-3, RE-SUBDIVISION OF PARCEL E-2
SECTION 5 AREA 1, 6TH ELECTION DISTRICT
HOWARD COUNTY, MARYLAND

Drafting	DATE	REVISIONS	SHEET	DATE	JOB NUMBER
Check			7	FEBRUARY 1988	
Design			OF	SCALE	
Check			8	AS SHOWN	

SDP-88-146

REVIEWED FOR HOWARD SOIL CONSERVATION DISTRICT AND MEETS TECHNICAL REQUIREMENTS.
James A. Johnson 6/23/88
SIGNATURE DATE

U.S. SOIL CONSERVATION SERVICE
THIS DEVELOPMENT PLAN IS APPROVED FOR SOIL EROSION AND SEDIMENT CONTROL BY THE HOWARD SOIL CONSERVATION DISTRICT.
James A. Johnson 6/23/88
Approved Howard S.C.D. DATE

APPROVED
HOWARD COUNTY OFFICE OF PLANNING AND ZONING
James A. Johnson 7-25-88
DIRECTOR DATE

APPROVED
HOWARD COUNTY OFFICE OF PLANNING AND ZONING
James A. Johnson 7-22-88
CHIEF, DIVISION OF COMMUNITY PLANNING AND LAND DEVELOPMENT DATE

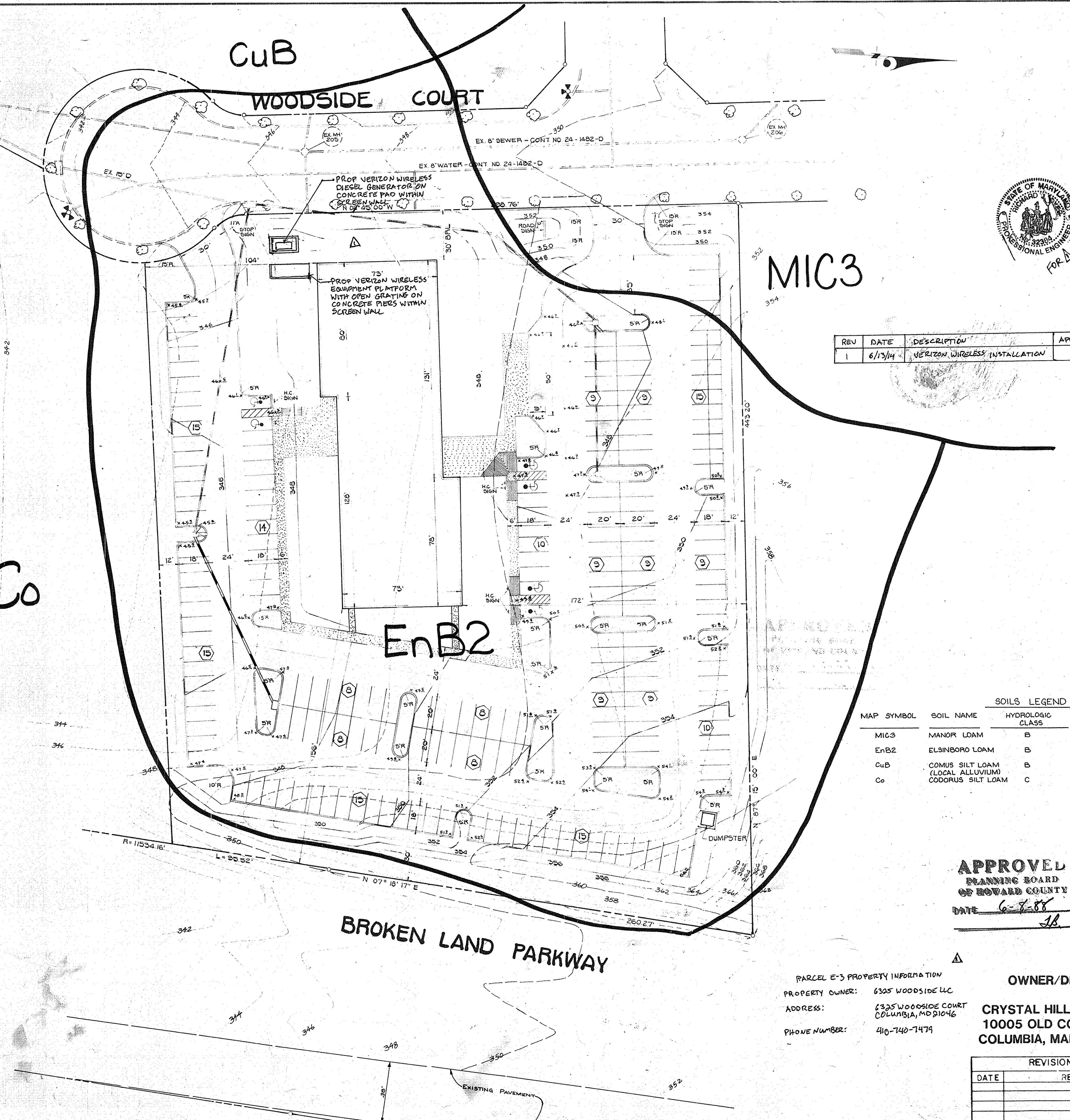

CuB

WOODSIDE COURT

MIC3

Co

EnB2

BROKEN LAND PARKWAY

REV	DATE	DESCRIPTION	APPROVED
1	6/13/14	VERIZON WIRELESS INSTALLATION	

MAP SYMBOL	SOIL NAME	HYDROLOGIC CLASS	DESCRIPTION
MIC3	MANOR LOAM	B	8 - 15% SLOPES, SEVERELY ERODED
EnB2	ELLSBORO LOAM	B	3-8% SLOPES, MODERATELY ERODED
CuB	COMUS SILT LOAM (LOCAL ALLUVIUM)	B	5-8% SLOPES
Co	CODORUS SILT LOAM	C	NEARLY LEVEL

APPROVAL
PLANNING BOARD
OF HOWARD COUNTY
DATE 6-16-88
JB

PARCEL E-3 PROPERTY INFORMATION
PROPERTY OWNER: 6325 WOODSIDE LLC
ADDRESS: 6325 WOODSIDE COURT
COLUMBIA, MD 21046
PHONE NUMBER: 410-740-7474

OWNER/DEVELOPER
CRYSTAL HILL INVESTMENTS
10005 OLD COLUMBIA ROAD
COLUMBIA, MARYLAND 21046

REVISION CHART	
DATE	REVISION

APPROVED: FOR PUBLIC WATER AND PUBLIC SEWERAGE, STORM DRAINAGE SYSTEMS AND PUBLIC ROADS
HOWARD COUNTY DEPARTMENT OF PUBLIC WORKS

James M. ... 7/13/88
DIRECTOR DATE
William B. ... 7-13-88
CHIEF BUREAU OF ENGINEERING DATE

REVIEWED FOR HOWARD SOIL CONSERVATION DISTRICT AND MEETS TECHNICAL REQUIREMENTS

John M. Helm 6/23/88
US SOIL CONSERVATION SERVICE DATE

THIS DEVELOPMENT PLAN IS APPROVED FOR SOIL EROSION & SEDIMENT CONTROL BY THE HOWARD SOIL CONSERVATION DISTRICT

HOWARD SOIL CONSERVATION DISTRICT DATE

APPROVED: FOR PUBLIC WATER AND PUBLIC SEWERAGE SYSTEMS
HOWARD COUNTY HEALTH DEPARTMENT

John ... 7-14-88
COUNTY HEALTH OFFICER DATE

APPROVED: HOWARD COUNTY OFFICE OF PLANNING AND ZONING

... 7-25-88
DIRECTOR DATE
... 7-21-88
CHIEF, DIVISION OF COMMUNITY PLANNING AND LAND DEVELOPMENT DATE

ENGINEERS CERTIFICATE
"I CERTIFY THAT THIS PLAN FOR EROSION & SEDIMENT CONTROL REPRESENTS A PRACTICAL AND WORKABLE PLAN BASED ON MY PERSONAL KNOWLEDGE OF THE SITE CONDITIONS AND THAT IT WAS PREPARED IN ACCORDANCE WITH THE REQUIREMENTS OF THE HOWARD SOIL CONSERVATION DISTRICT."

John ... 6/16/88
ENGINEER'S SIGNATURE DATE

DEVELOPERS CERTIFICATE
"WE CERTIFY THAT ALL DEVELOPMENT & CONSTRUCTION WILL BE DONE ACCORDING TO THIS PLAN, AND THAT ANY RESPONSIBLE PERSONNEL INVOLVED IN THE CONSTRUCTION PROJECT WILL HAVE A CERTIFICATE OF ATTENDANCE AT A DEPARTMENT OF NATURAL RESOURCES APPROVED TRAINING PROGRAM FOR THE CONTROL OF SEDIMENT & EROSION BEFORE BEGINNING THE PROJECT. I ALSO AUTHORIZE PERIODIC ON-SITE INSPECTION BY THE HOWARD SOIL CONSERVATION DISTRICT"

... 6-16-88
DEVELOPERS SIGNATURE DATE

SOILS MAP
HOWARD COUNTY SOIL SURVEY MAP #29
RMIC/HILLCROFT OFFICE BLDG.
VILLAGE OF OWEN BROWN
SUBDIVISION OF PARCEL E-3 RE-SUBDIVISION OF PARCEL E-2
SECTION 5 - AREA 1
6TH ELECTION DISTRICT
HOWARD COUNTY, MARYLAND

KIDDE CONSULTANTS, INC.
ENGINEERS • PLANNERS • SURVEYORS
1100 WEST GREEN STREET, SUITE 100, ELAB, MD 20747
APPROVED: ...
PROFESSIONAL ENGINEER
DATE: FEBRUARY 1988
SHEET 8 OF 8
SCALE: 1" = 30'