

DWELLING TYPES & ELEVATIONS

ALL DWELLINGS ARE 24' WIDE
 DWELLING LENGTHS ARE AS FOLLOWS:
 1 - 24'
 2 - 24'
 3 - 24'
 4 - 40'
 5 - 40'
 6 - 56'
 7 - 56'

EXAMPLE: (E) DWLS SIZE
 (H) DWLS TYPE

- GENERAL NOTES**
1. AREA = 3.342 AC ±
 2. ZONING - RMH
 3. TOTAL NO LOTS THIS PLAN = 20
 4. GREEN AREA = 2.0 AC = 60%
 5. BLOS COVERAGE = 0.80 AC = 24%
 6. ONLY MOBILE HOMES AND MANUFACTURED DWLS ARE ALLOWED ON THESE LOTS
 7. SEE F 88-10 FOR SEDIMENT CONTROL PLANS
 8. NOTE NO CONSTRUCTION MAY BEGIN ON LOTS 21 AND 61 UNTIL SEDIMENT TRAPS ARE REMOVED
 9. ○ DENOTES STREET TREES (SEE F 88-10)

SEWER INVERTS

LOT #	INVERT @ RL	LOT #	INVERT @ RL
15	50	2	06
16	51	3	06
17	52	4	06
18	53	5	06
19	54	6	06
20	55	7	06
21	56	8	06
22	57	9	06
23	58	10	06
24	59	11	06
25	60	12	06
26	61	13	06
27	62	14	06
28	63	15	06
29	64	16	06
30	65	17	06
31	66	18	06

THIS PLAN IS APPROVED FOR SOIL EROSION AND SEDIMENT CONTROL BY THE HOWARD S.C.D.
 DATE 5-13-88
 HOWARD S.C.D.

REVIEWED FOR HOWARD S.C.D. AND MEETS TECHNICAL REQUIREMENTS
 DATE 5-13-88
 U.S. SOIL CONSERVATION SERVICE

APPROVED HOWARD COUNTY OFFICE OF PLANNING & ZONING
 DATE 6-16-88
 PLANNING DIRECTOR

APPROVED FOR PUBLIC WATER & PUBLIC SEWERAGE SYSTEMS AND 170 COUNTY HEALTH DEPARTMENT
 DATE 5-27-88
 COUNTY HEALTH OFFICER

APPROVED FOR PUBLIC WATER, PUBLIC SEWER, STORM DRAINAGE SYSTEMS & PUBLIC ROADS
 HOWARD COUNTY DEPT. OF PUBLIC WORKS
 DATE 5-19-88
 DIRECTOR

CHIEF BUREAU OF ENGINEERING DATE 5/18/88

CERTIFICATION BY DEVELOPER

I CERTIFY THAT ALL DEVELOPMENT AND/OR CONSTRUCTION WILL BE DONE ACCORDING TO THIS PLAN OF DEVELOPMENT AND PLAN FOR EROSION & SEDIMENT CONTROL & THAT ALL RESPONSIBLE PERSONNEL INVOLVED WITH THE CONSTRUCTION PROJECT WILL HAVE A CERTIFICATE OF ATTENDANCE AT A DEPT. OF NATURAL RESOURCES APPROVED TRAINING PROGRAM FOR THE CONTROL OF SEDIMENT & EROSION BEFORE BEGINNING THE PROJECT.
 I ALSO AUTHORIZE PERIODIC, ON-SITE INSPECTIONS BY THE HOWARD SOIL CONSERVATION DISTRICT OR THEIR AUTHORIZED AGENTS AS ARE DEEMED NECESSARY.

DATE 6-17-88
 DATE 6-16-88
 DATE 5-27-88
 DATE 5-19-88

SIGNATURE
 DATE

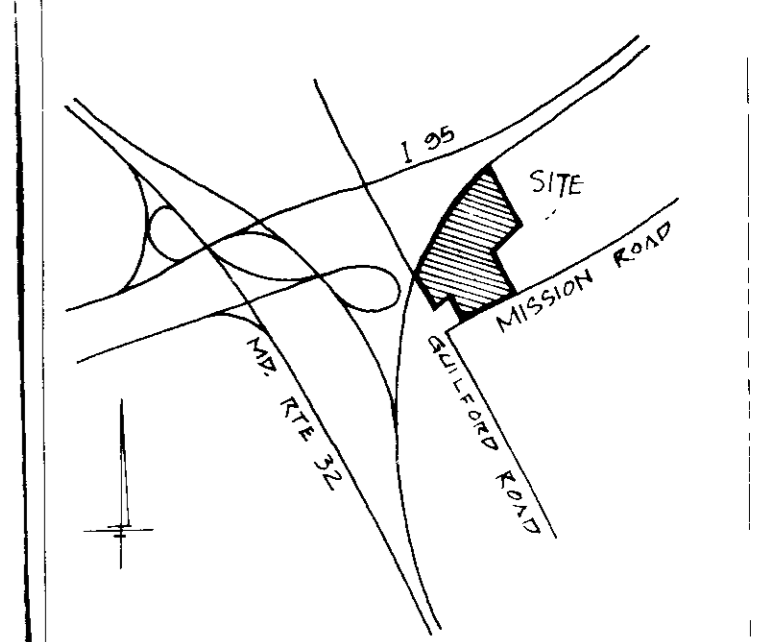
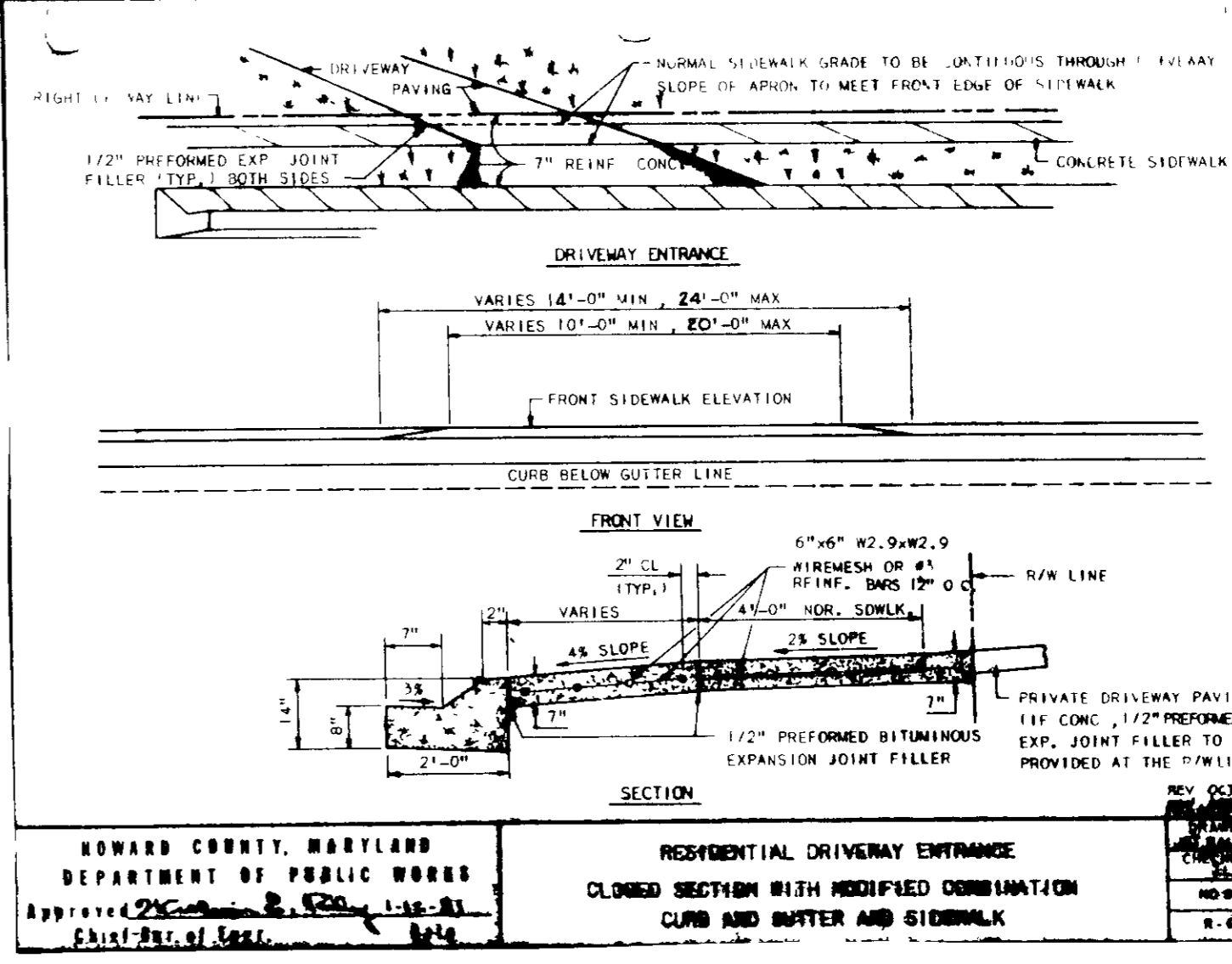
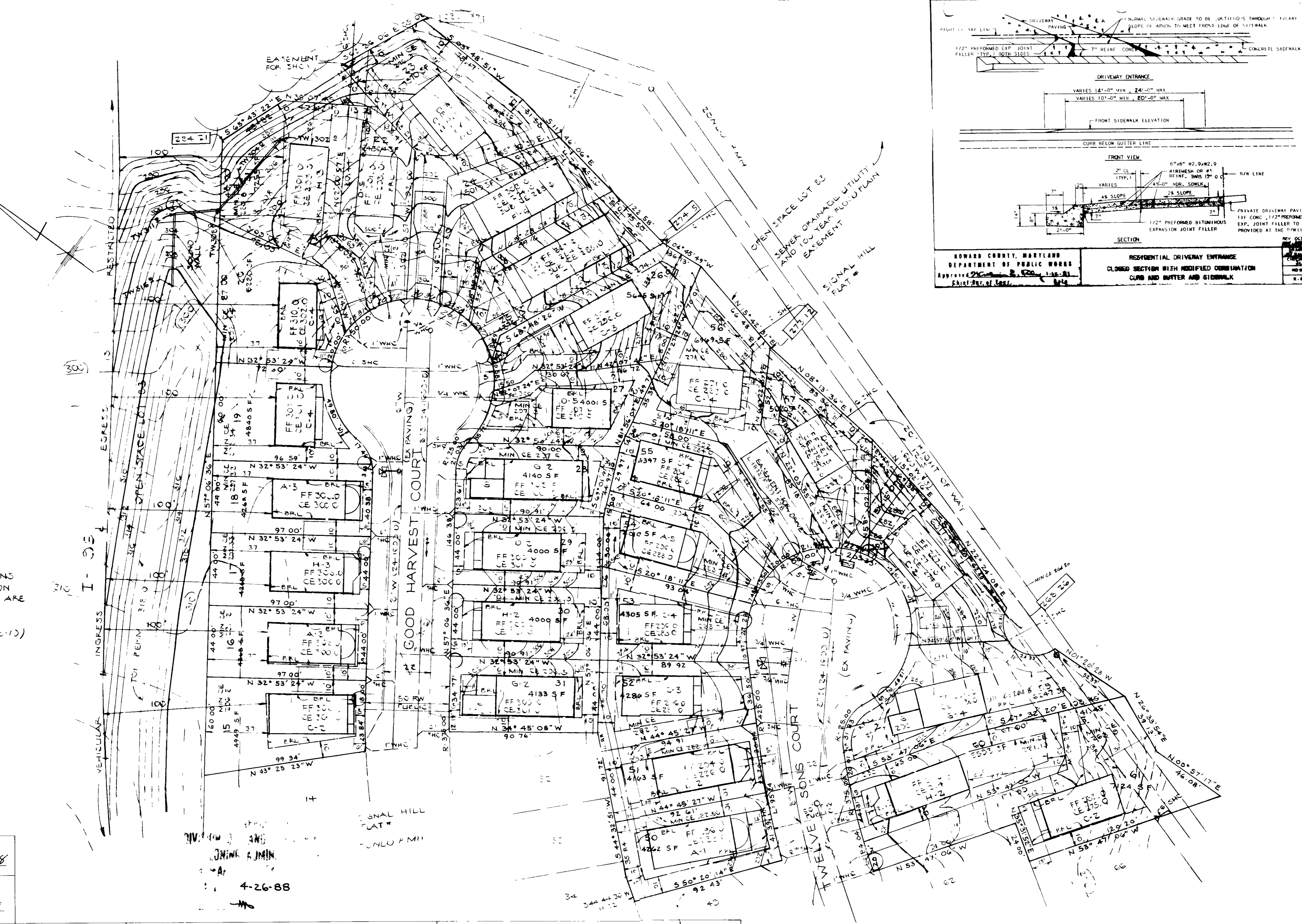

LOCATION PLAN
 SCALE: 1" = 200'

HOWARD COUNTY, MARYLAND
 DEPARTMENT OF PUBLIC WORKS
 Approved: [Signature]
 Chief Div. of Engg.

RESIDENTIAL DRIVEWAY ENTRANCE
 CLOSED SECTION WITH MODIFIED COMBINATION CURB AND GUTTER AND SIDEWALK

LOT DATA

LOT NO	AREA (SF)	BLOS COVERAGE
15	4040	1352
16	4268	1272
17	4268	1478
18	4268	1272
19	4240	1056
20	5280	1656
21	7255	1240
22	4364	1136
23	7570	1356
24	5010	1536
25	4876	1716
26	5648	1156
27	4001	1506
28	4140	1536
29	4000	1444
30	4000	1444
31	4133	1536
50	4262	1464
51	4161	1444
52	4236	1156
53	4305	1156
54	4010	1506
55	4337	1536
56	6360	1536
57	5020	1536
58	5777	1536
59	6708	1444
60	5593	1444
61	6715	1476

STREET ACQUISITION

LOT NO	STREET ACQUISITION	STREET ACQUISITION
15	8391 GIGGUM HWY	11' 0"
16	8391 GIGGUM HWY	11' 0"
17	8391 GIGGUM HWY	11' 0"
18	8391 GIGGUM HWY	11' 0"
19	8391 GIGGUM HWY	11' 0"
20	8391 GIGGUM HWY	11' 0"
21	8391 GIGGUM HWY	11' 0"
22	8391 GIGGUM HWY	11' 0"
23	8391 GIGGUM HWY	11' 0"
24	8391 GIGGUM HWY	11' 0"
25	8391 GIGGUM HWY	11' 0"
26	8391 GIGGUM HWY	11' 0"
27	8391 GIGGUM HWY	11' 0"
28	8391 GIGGUM HWY	11' 0"
29	8391 GIGGUM HWY	11' 0"
30	8391 GIGGUM HWY	11' 0"
31	8391 GIGGUM HWY	11' 0"
50	8391 GIGGUM HWY	11' 0"
51	8391 GIGGUM HWY	11' 0"
52	8391 GIGGUM HWY	11' 0"
53	8391 GIGGUM HWY	11' 0"
54	8391 GIGGUM HWY	11' 0"
55	8391 GIGGUM HWY	11' 0"
56	8391 GIGGUM HWY	11' 0"
57	8391 GIGGUM HWY	11' 0"
58	8391 GIGGUM HWY	11' 0"
59	8391 GIGGUM HWY	11' 0"
60	8391 GIGGUM HWY	11' 0"
61	8391 GIGGUM HWY	11' 0"

SUBDIVISION NAME
 SIGNAL HILL

PLAT NO OR LOT BLOCK NO. ZONE
 7757-7760 24 RMH

TAX ZONE MAP LOT DIST. LENGTH IN FEET
 42 6 6044

WATER CODE
 E-14

SEWER CODE
 4400900

SEE 012 FILED
 SEC 24 F 87 20
 FC-12, AA 87 20
 SDP-88-137

SHEET 1 OF 2
 HOWARD COUNTY, MARYLAND
 DATE: JAN. 25, 1988
 SDP-88-137

CERTIFICATION BY ENGINEER

I CERTIFY THAT THIS PLAN OF DEVELOPMENT & PLAN FOR EROSION & SEDIMENT CONTROL REPRESENTS A PRACTICAL & WORKABLE PLAN BASED ON MY KNOWLEDGE OF THE SITE CONDITIONS & THAT IT WAS PREPARED IN ACCORDANCE WITH THE REQUIREMENTS OF THE HOWARD COUNTY SOIL CONSERVATION DISTRICT.

DATE 6-16-88
 DATE 6-16-88
 DATE 5-27-88
 DATE 5-19-88

SIGNATURE
 DATE

OWNER AND DEVELOPER:
 ETHAN GROSSMAN, TRUSTEE
 10750 HICKORY RIDGE ROAD
 COLUMBIA, MD 21044

M & H. DEVELOPMENT ENGINEERS INC.
 200 E. JOPPA ROAD
 TOWSON, MD. 21204
 PH. 828.2000

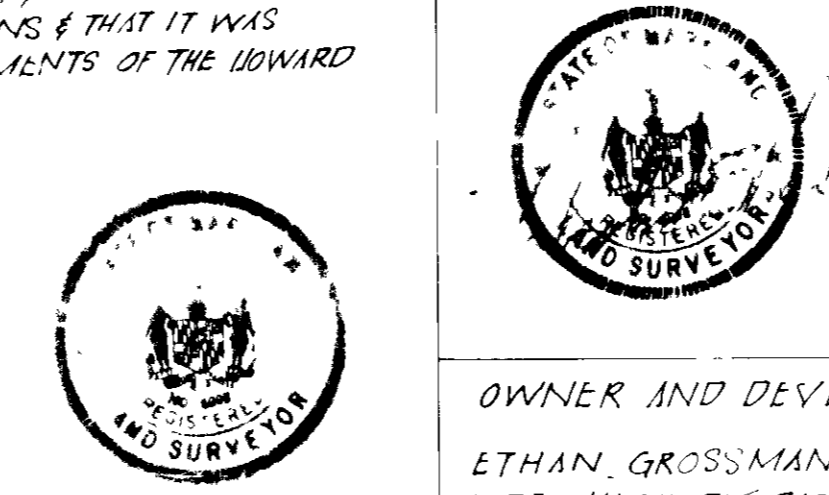

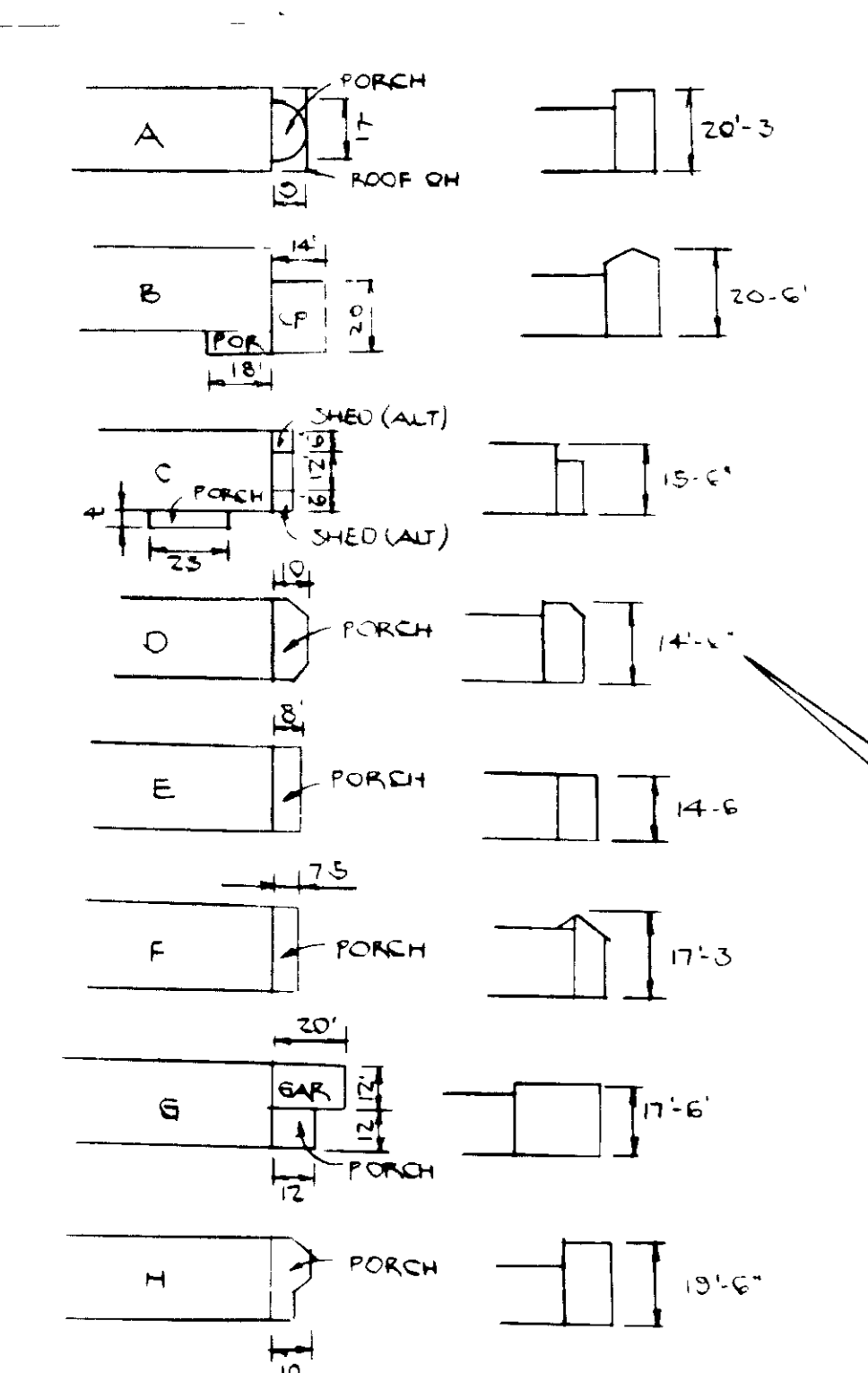

DWELLING TYPES & ELEVATIONS
 ALL DWELLINGS ARE 24' WIDE
 DWELLING LENGTHS ARE AS FOLLOWS:
 1 - 52' 4'-0" 7'-6"
 2 - 48' 5'-0" 7'-6"
 3 - 44' 6'-0" 7'-6"
 EXAMPLE: ① ② DWLS SIDE
 ③ ④ DWLS TYPE

GENERAL NOTES
 1. AREA = 3.342 AC ±
 2. ZONING = RMZ
 3. TOTAL NO. LOTS THIS PLAN = 23
 4. GREEN AREA = 2.0 AC ± 60%
 5. BLDG COVERAGE = 0.80 AC ± 4%
 6. ONLY MOBILE HOMES AND MANUFACTURED DWELLS ARE ALLOWED ON THESE LOTS
 7. SEE F 88-10 FOR SEDIMENT CONTROL PLANS
 NOTE: NO CONSTRUCTION MAY BEGIN ON LOTS 21 AND 21 UNTIL SEDIMENT TRAPS ARE REMOVED
 8. DEN. 153 STREET TREES (SEE F 88-10)

SEQUENCE OF CONSTRUCTION
 1. OBTAIN GRADING PERMIT
 2. NOTIFY DEPT. OF PERMITS & LICENCES (202-241-977)
 3. INSTALL SEDIMENT CONTROL DEVICES INCLUDING MAINTENANCE OF THESE TO REMAIN FROM F 88-10
 4. EXCAVATE GRADE
 5. BEGIN FOUNDATION & CONSTRUCTION
 6. INSTALL UTILITIES
 7. STABILIZE EROSION CONTROL DEVICES
 8. PAVE DRIVEWAYS
 9. REMOVE REMAINING SEDIMENT CONTROL DEVICES AND STABILIZE THESE AREAS

THIS PLAN IS APPROVED FOR SOIL EROSION AND SEDIMENT CONTROL BY THE HOWARD S.C.D.
 5-13-88
 DATE
 APPROVED FOR HOWARD S.C.D. AND MEETS TECHNICAL REQUIREMENTS
 5-13-88
 DATE
 APPROVED FOR HOWARD COUNTY OFFICE OF PLANNING & ZONING

APPROVED FOR PUBLIC WATER, PUBLIC SEWER, STORM DRAINAGE SYSTEMS & PUBLIC ROADS
 5-11-88
 DATE
 CHIEF BUREAU OF ENGINEERING 5/11/88

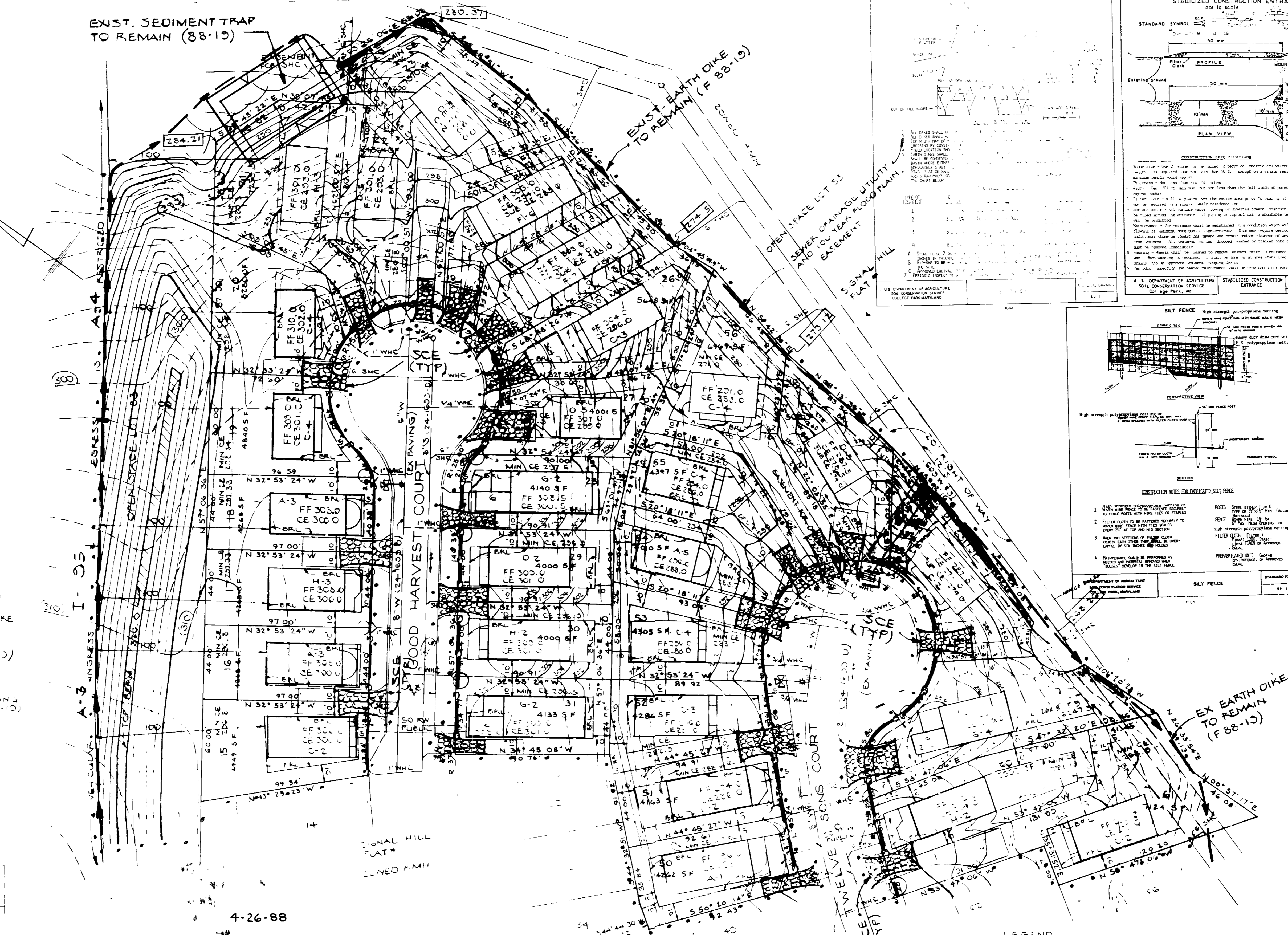

CERTIFICATION BY DEVELOPER
 I CERTIFY THAT ALL DEVELOPMENT AND CONSTRUCTION WILL BE DONE ACCORDING TO THIS PLAN OF DEVELOPMENT AND PLAN FOR EROSION & SEDIMENT CONTROL & THAT ALL RESPONSIBLE PERSONNEL INVOLVED WITH THE CONSTRUCTION PROJECT WILL HAVE A CERTIFICATE OF ATTENDANCE AT A DEPT. OF NATURAL RESOURCES APPROVED TRAINING PROGRAM FOR THE CONTROL OF SEDIMENT & EROSION BEFORE BEGINNING THE PROJECT.
 I ALSO AUTHORIZE PERIODIC ON-SITE INSPECTIONS BY THE HOWARD SOIL CONSERVATION DISTRICT OR THEIR AUTHORIZED AGENTS AS ARE DEMAND NECESSARY.
 DATE: 6/17/88
 DATE: 6/16/88
 DATE: 5-2-88

CERTIFICATION BY ENGINEER
 I CERTIFY THAT THIS PLAN OF DEVELOPMENT & PLAN FOR EROSION & SEDIMENT CONTROL REPRESENTS A PRACTICAL & WORKABLE PLAN BASED ON MY KNOWLEDGE OF THE SITE CONDITIONS & THAT IT WAS PREPARED IN ACCORDANCE WITH THE REQUIREMENTS OF THE HOWARD COUNTY SOIL CONSERVATION DISTRICT.
 STATE OF MARYLAND
 PROFESSIONAL ENGINEER
 DATE: 5/11/88

OWNER AND DEVELOPER:
 ETHAN GROSSMAN, TRUSTEE
 10750 HICKORY RIDGE ROAD
 COLUMBIA, MD 21044
 M & H. DEVELOPMENT ENGINEERS INC.
 200 E. JOPPA ROAD
 TOWSON, MD 21284
 PH 828 0000

LEGEND
 LIMIT OF DISTURBANCE
 EARTH DIKE
 SILT FENCE
 STABILIZED CONSTRUCTION ENTRANCE
 EX. CONT. UP 5 (ETD)
 PROP. CONT. UP 5
 * NOTE: NO BUILDING CONSTRUCTION SHALL BEGIN ON LOT 21 UNTIL THE SEDIMENT TRAP IS REMOVED.

SEDIMENT CONTROL PLAN
 LOTS 15 THRU 31 AND SOUTH 61
 SIGNAL HILL FLAT #
 2ND ELECTION DISTRICT
 SHEET # OF 2
 HOWARD COUNTY, MARYLAND
 DATE: JAN 25, 1988
 SDP-88-137

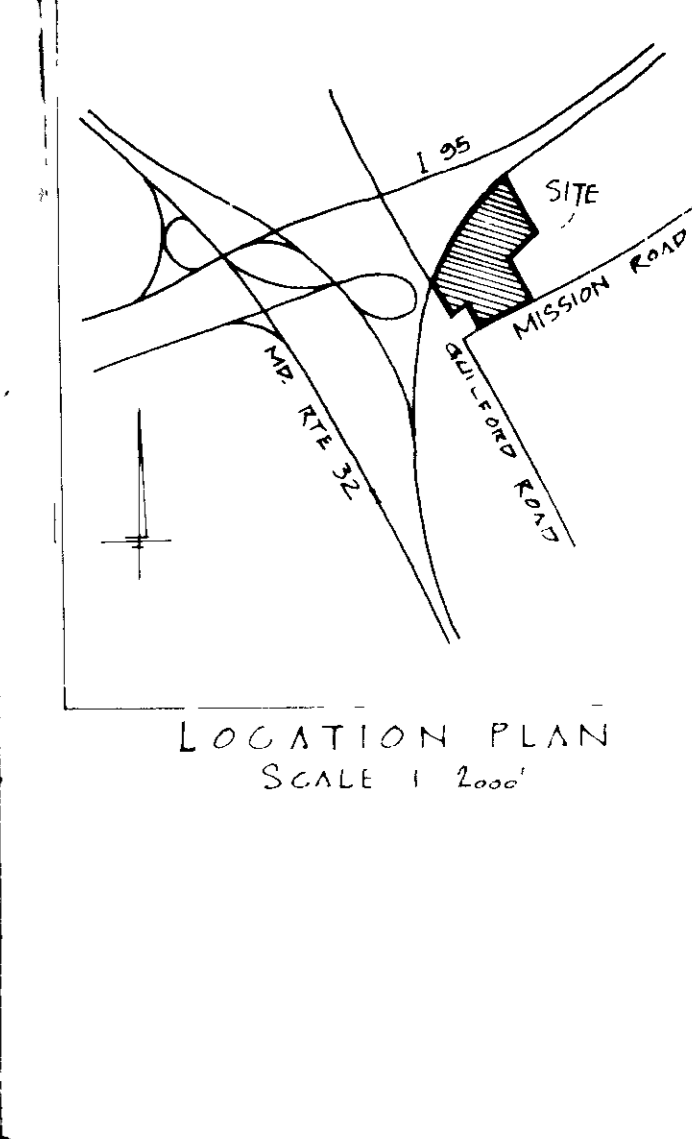
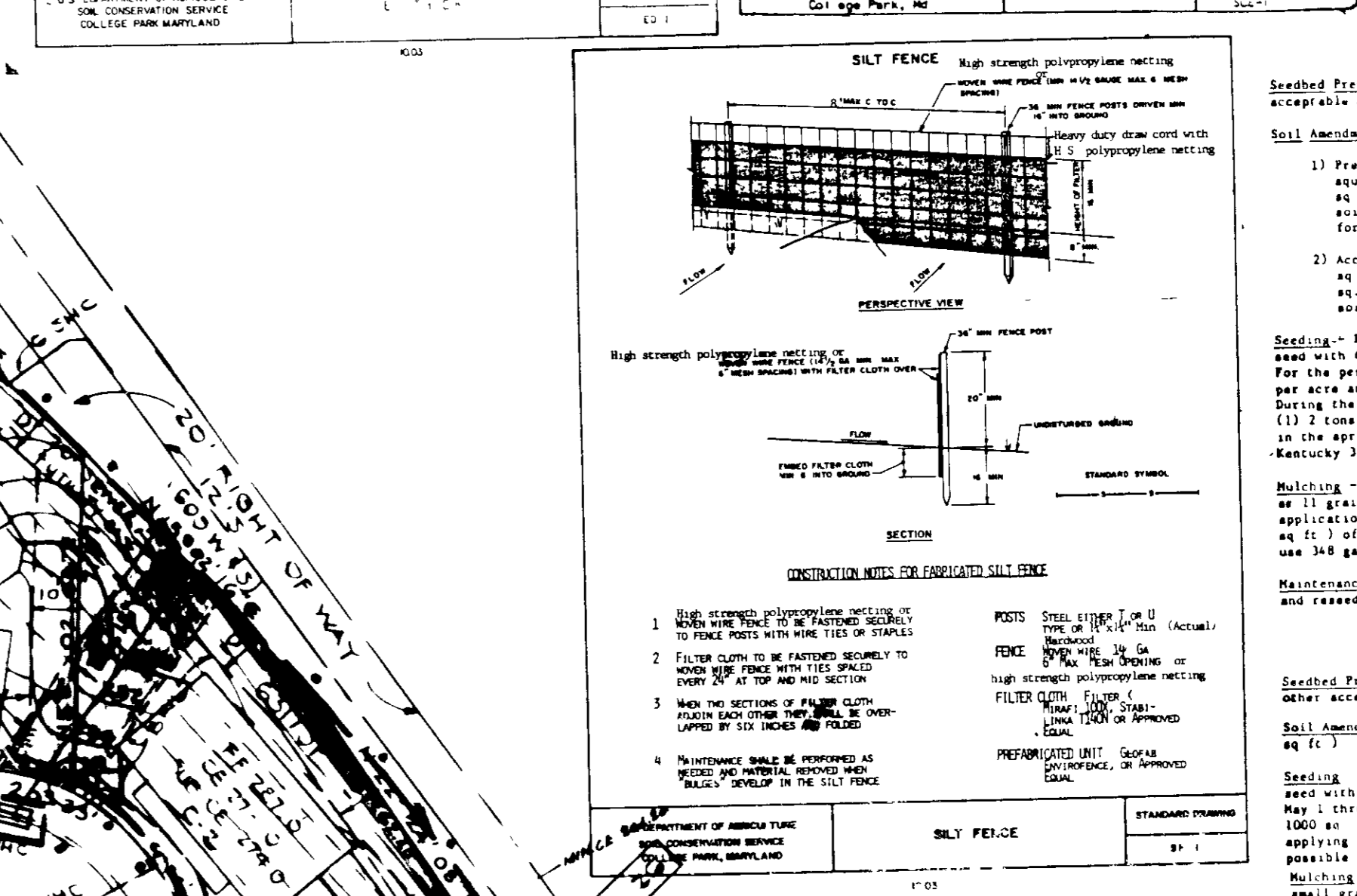
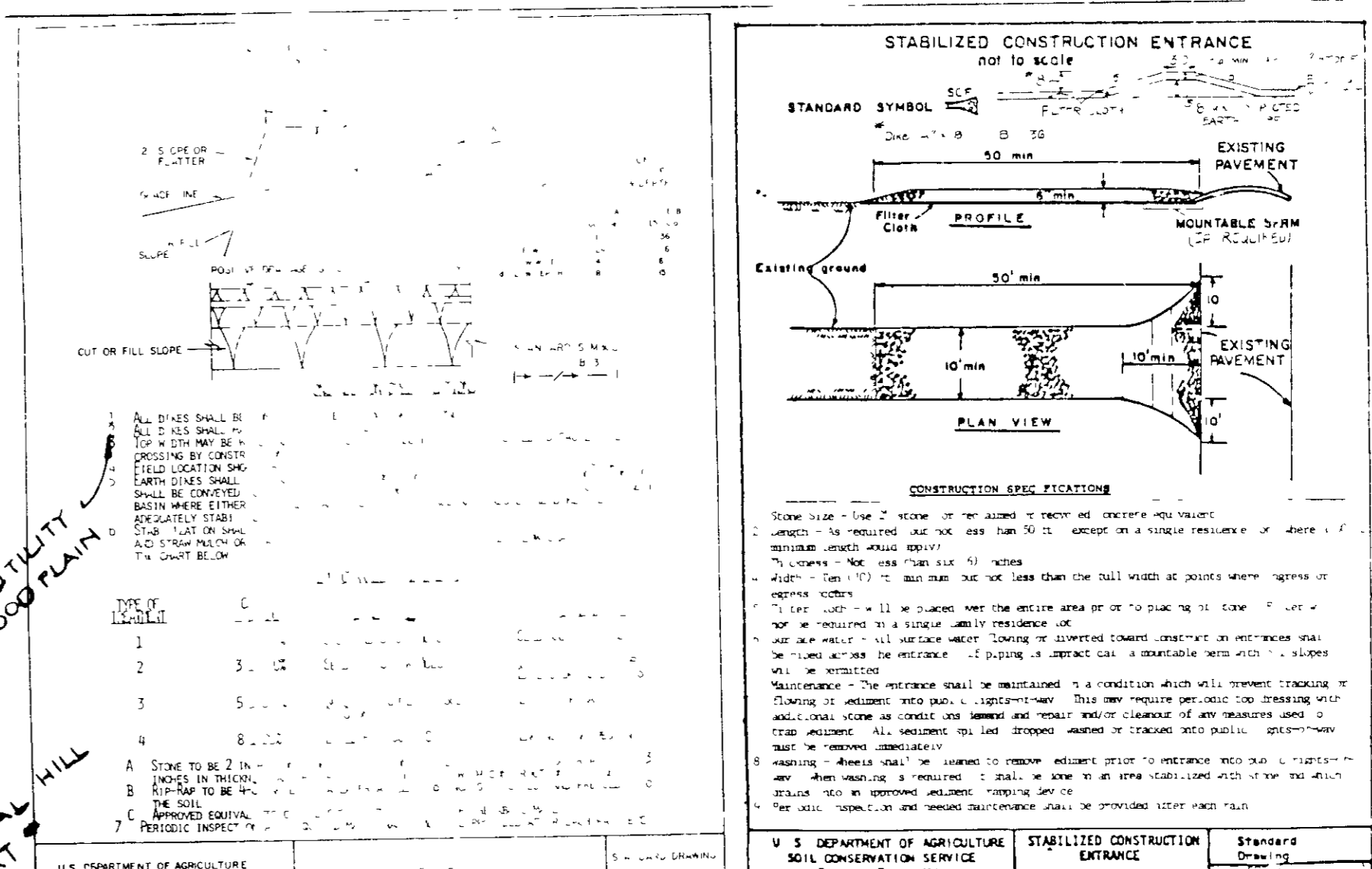

PERMANENT SEEDING NOTES
 Seeding Preparation: Loosen upper 3 inches of soil by raking, disking or other acceptable means before seeding.
 Soil Amendments: Use one of the following schedules:
 1) Preferred - Apply 2 tons per acre dolomitic limestone (92 lbs/1000 sq ft) and 800 lbs per acre 10-10-10 fertilizer (14 lbs/1000 sq ft) before seeding. Narrow or disk into upper three inches of soil. At time of seeding, apply 100 lbs per acre 10-10-10 fertilizer (9 lbs/1000 sq ft).
 2) Acceptable - Apply 2 tons per acre dolomitic limestone (92 lbs/1000 sq ft) and 1000 lbs per acre 10-10-10 fertilizer (23 lbs/1000 sq ft) before seeding. Narrow or disk into upper three inches of soil.
 Seeding: For the period March 1 thru April 30 and August 1 thru October 15 seed with 40 lbs per acre (14 lbs/1000 sq ft) of Kentucky 31 tall fescue. For the period May 1 thru July 31, seed with 80 lbs Kentucky 31 tall fescue per acre and 2 lbs per acre (28 lbs/1000 sq ft) of meadow bromegrass. During the period of October 15 thru February 28, plant as by Option (1) 2 tons per acre of well mixed Kentucky 31 and seed as soon as possible in the spring. Option (2) Seed with 80 lbs the Kentucky 31 tall fescue and mulch with 2 concrete well anchored straw.
 Mulching: Apply 18 to 2 tons per acre (70 to 90 lbs/1000 sq ft) of untreated straw immediately after seeding. Another mulch immediately after application using mulch anchoring tool or 218 gallons per acre 15 ga/1000 sq ft of emulsified asphalt on flat areas. On slopes 8 ft or higher, use 348 gallons per acre 15 ga/1000 sq ft for anchoring.
 Maintenance: Inspect all seeded areas and make needed repairs, replacements and reseedings.

TEMPORARY SEEDING NOTES
 Seeding Preparation: Loosen upper 3 inches of soil by raking, disking or other acceptable means before seeding.
 Soil Amendments: Apply 600 lbs per acre 10-10-10 fertilizer (14 lbs/1000 sq ft).
 Seeding: For the period March 1 thru April 30 and from August 15 thru Nov 15, seed with 20 lbs per acre of annual ryegrass (32 lbs/1000 sq ft). For the period May 1 thru August 14, seed with 3 lbs per acre of vernal ryegrass (4 lbs/1000 sq ft). For the period November 1 thru February 28, plant as by Option (1) 2 tons per acre of well mixed Kentucky 31 and seed as soon as possible in the spring, or use and
 Mulching: Apply 18 to 2 tons per acre (70-90 lbs/1000 sq ft) of untreated straw immediately after seeding. Another mulch immediately after application using mulch anchoring tool or 218 gal per acre (15 gal/1000 sq ft) of emulsified asphalt on flat areas. On slopes 8 ft or higher, use 348 gal per acre (18 gal/1000 sq ft) for anchoring.