

**DWELLING TYPES & ELEVATIONS**  
 ALL DWELLINGS ARE 24' WIDE  
 DWELLING LENGTHS ARE AS FOLLOWS:  
 1. 52'  
 2. 48'  
 3. 44'

EXAMPLE DWLG SIZE  
 DWLG TYPE

**GENERAL NOTES**  
 1. AREA = 4.30 AC  
 2. ZONING = R-MH  
 3. TOTAL NO LOTS THIS PLAN = 41  
 4. GREEN AREA = 2.81 AC = 64%  
 5. BLDG COVERAGE = 1.06 AC = 24%  
 6. ONLY MOBILE HOMES AND MANUFACTURED DWLG'S ARE ALLOWED ON THE LOTS.  
 7. SEE F 88-13 FOR SEDIMENT CONTROL PLANS  
 8. NOTE: NO CONSTRUCTION MAY BEGIN ON LOTS 66, 67 & 68 UNTIL SEDIMENT TRAP IS REMOVED.

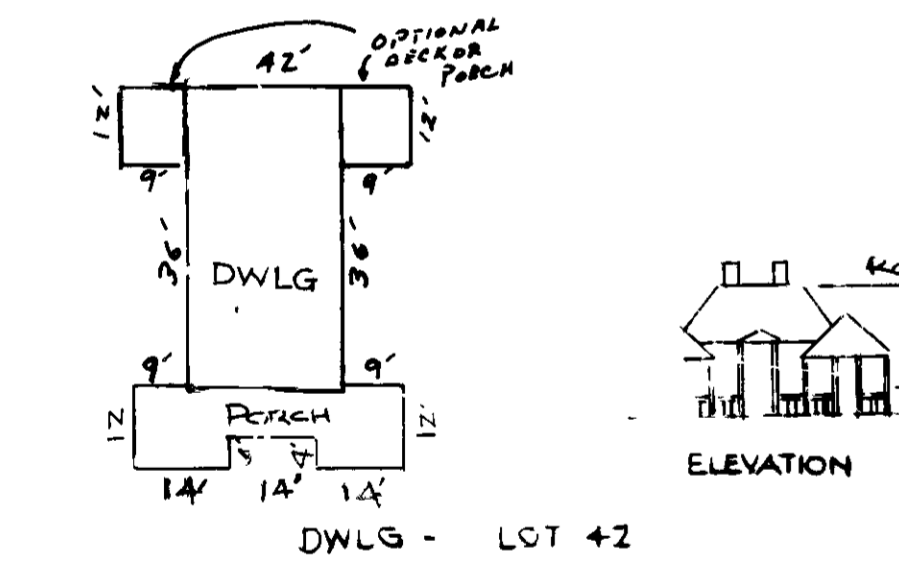

THIS PLAN IS APPROVED FOR SOIL EROSION AND SEDIMENT CONTROL BY THE HOWARD S.C.D.  
 Signature: *Stephen R. Gehr* 5-11-88  
 HOWARD S.C.D. DATE

APPROVED FOR HOWARD S.C.D. AND MEETS TECHNICAL REQUIREMENTS  
 Signature: *James M. McNeil* 5-11-88  
 CLS SOIL CONSERVATION SERVICE DATE

APPROVED: HOWARD COUNTY OFFICE OF PLANNING & ZONING  
 Signature: *James R. Kutt* 5/20/88  
 PLANNING DIRECTOR DATE

APPROVED: DIVISION OF COMMUNITY PLANNING & LAND DEVELOPMENT  
 Signature: *James R. Kutt* 5/20/88  
 DATE

APPROVED: FOR PUBLIC WATER & PUBLIC SEWERAGE SYSTEMS  
 HOWARD COUNTY HEALTH DEPARTMENT  
 Signature: *James R. Kutt* 5-18-88  
 DATE

APPROVED: FOR PUBLIC WATER, PUBLIC SEWER, STORM DRAINAGE SYSTEMS & PUBLIC ROADS  
 HOWARD COUNTY DEPT. OF PUBLIC WORKS  
 Signature: *James R. Kutt* 5/17/88  
 DATE

APPROVED: COUNTY BUREAU OF ENGINEERING  
 Signature: *James R. Kutt* 5/16/88  
 DATE



**DEVELOPER'S CERTIFICATE**  
 I HEREBY CERTIFY THAT ALL DEVELOPMENT AND CONSTRUCTION WILL BE DONE ACCORDING TO THIS PLAN OF DEVELOPMENT AND PLAN FOR EROSION AND SEDIMENT CONTROL AND THAT ALL RESPONSIBLE PERSONNEL INVOLVED IN THE CONSTRUCTION PROJECT WILL HAVE A CERTIFICATE OF ATTENDANCE AT A DEPARTMENT OF NATURAL RESOURCES APPROVED TRAINING PROGRAM FOR THE CONTROL OF SEDIMENT AND EROSION BEFORE BEGINNING THE PROJECT. I ALSO AUTHORIZE PERIODIC ON-SITE INSPECTION BY THE HOWARD SOIL CONSERVATION DISTRICT OR THEIR AUTHORIZED AGENTS, AS ARE DEEMED NECESSARY.

**ENGINEER'S CERTIFICATE**  
 I HEREBY CERTIFY THAT THIS PLAN FOR EROSION AND SEDIMENT CONTROL, REPRESENTS A PRACTICAL AND FEASIBLE PLAN BASED ON MY PERSONAL KNOWLEDGE OF THE SITE AND THAT IT WAS PREPARED IN ACCORDANCE WITH THE REQUIREMENTS OF THE HOWARD SOIL CONSERVATION DISTRICT.

Signature: *Walter E. Huthins* 4/26/88  
 DATE

**OWNER AND DEVELOPER:**  
 ETHAN GROSSMAN, TRUSTEE  
 10730 HICKORY RIDGE ROAD  
 COLUMBIA, MD 21044  
 706-66-1111

**M. & H. DEVELOPMENT ENGINEERS INC.**  
 200 E. JOPPA ROAD  
 TOWSON, MD 21284  
 PH. 828-9000

**SITE DEVELOPMENT PLAN**  
 Lots 4-14, 32-43, 62-68 & 71-75  
 SIGNAL HILL PLAT NO.  
 6<sup>TH</sup> ELECTION DISTRICT  
 SCALE 1"=30' TAX MAP 42 PARCEL 76

**SEE OP.2. FILES**  
 3 87-04  
 P 87-20  
 F 88-10  
 AA 87-32  
 SOP 88-73  
 SOP 88-137

**SHEET 1 OF 2**  
 HOWARD COUNTY, MARYLAND  
 DATE: DEC 23, 1987  
 SDP-88-126

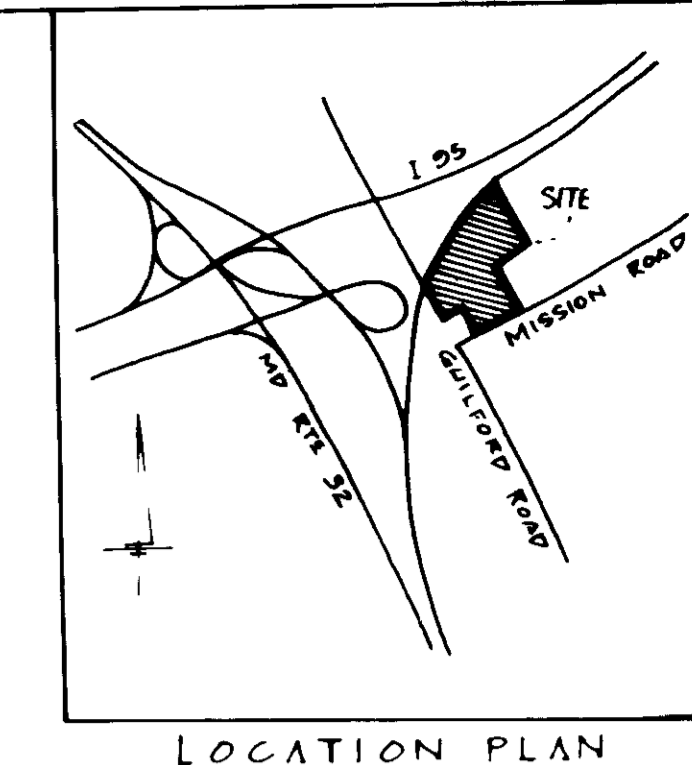
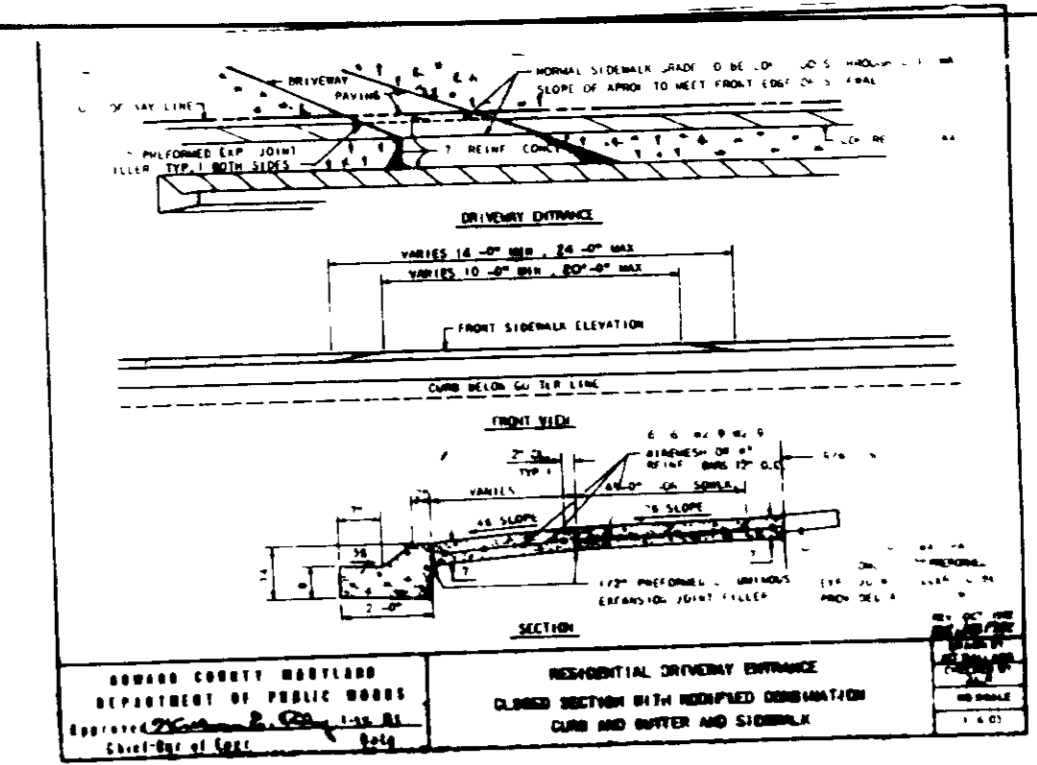

LOCATION PLAN  
 SCALE 1"=200'

**LOT DATA**

LOT NO.	AREA (SQ) GROSS	AREA (SQ) NET	AREA (SQ) BLDG	%
4	4006	4006	1044	26.1%
5	4153	4153	332	8.0%
6	5427	5427	344	6.3%
7	5287	5287	554	10.5%
8	4401	4401	358	8.1%
9	4400	4400	344	7.8%
10	4400	4400	344	7.8%
11	4400	4400	344	7.8%
12	4420	4420	242	5.5%
13	4685	4685	40	0.9%
14	4719	4719	152	3.2%
32	4224	4224	236	5.6%
33	4234	4234	152	3.6%
34	4142	4142	362	8.7%
35	4032	4032	444	11.0%
36	4032	4032	344	8.5%
37	4032	4032	1632	40.4%
38	4140	4140	1344	32.5%
39	4070	4070	444	10.9%
40	4102	4102	1344	32.8%
41	4004	4004	352	8.8%
42	4002	4002	352	8.8%
44	4001	4001	444	11.1%
45	4030	4030	362	9.0%
46	4100	4100	444	10.8%
47	4102	4102	344	8.4%
48	4066	4066	512	12.6%
49	4160	4160	344	8.0%
62	4000	4000	1536	38.4%
63	4004	4004	444	11.1%
64	4004	4004	444	11.1%
65	4072	4072	444	10.9%
66	3962	3962	272	6.9%
67	3610	3610	344	9.5%
68	5115	4448	186	4.2%
71	4030	4030	56	1.4%
72	4034	4034	342	8.5%
73	4217	4010	444	10.6%
74	4001	4001	1532	38.3%
75	4016	4016	440	11.0%
42	7636	7636	1824	23.9%

EXCLUDES AREA WITH SLOPE OF 25% & FLAG PORTION OF LOT.

**ADDRESS CHART**

Lot No.	Address	Lot No.	Address
4	8907 Good Harvest Ct	43	8925 Thurston Squire Ct
5	8911 "	44	8919 "
6	8915 "	45	8933 "
7	8919 "	46	8937 "
8	8923 "	47	8941 "
9	8927 "	48	8945 "
10	8931 "	49	8949 "
11	8935 "	50	8953 "
12	8939 "	51	8957 "
13	8943 "	52	8961 "
14	8947 "	53	8965 "
32	8941 "	66	8907 "
33	8945 "	67	8911 "
34	8949 "	68	8915 "
35	8953 "	71	8906 "
36	8957 "	72	8902 "
37	8961 "	73	8914 Thurston Squire Ct
38	8965 "	74	8918 "
39	8969 "	75	8922 "
40	8973 "		
41	8977 "		
42	8981 Thurston Squire Ct		

**DEPARTMENT OF LAND DEVELOPMENT & ZONING ADMINISTRATION**  
 HOWARD COUNTY, MARYLAND  
 DATE: 4-8-88

**DEPARTMENT OF LAND DEVELOPMENT & ZONING ADMINISTRATION**  
 HOWARD COUNTY, MARYLAND  
 DATE: DEC 23, 1987  
 SDP-88-126

