

TYPICAL DWELLING ELEVATIONS
NO SCALE

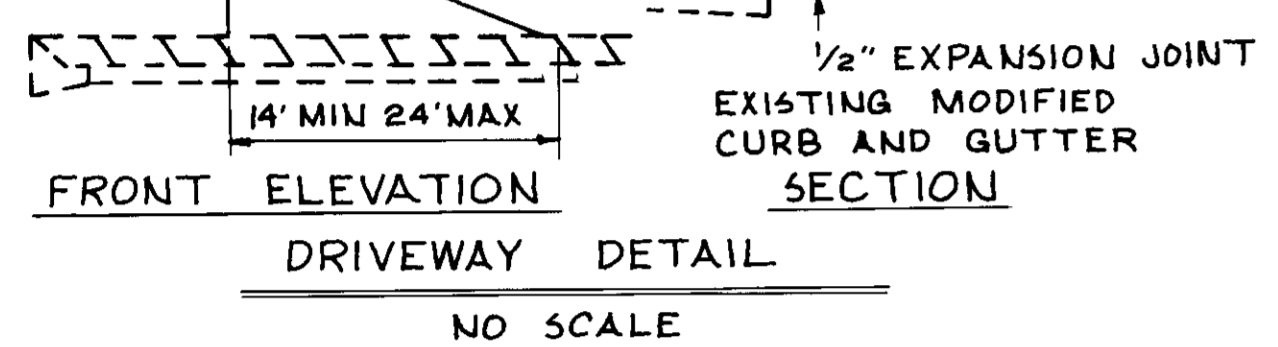

FRONT ELEVATION
DRIVEWAY DETAIL
NO SCALE

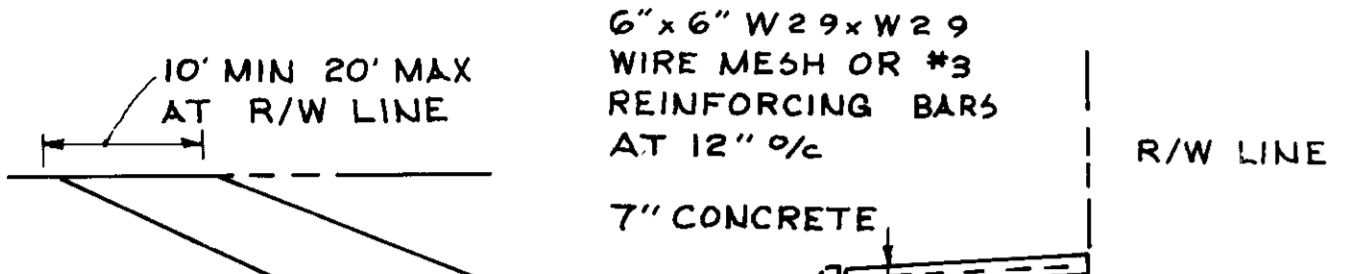
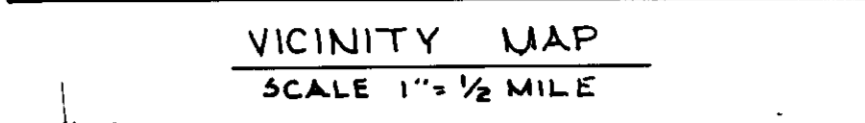

VICINITY MAP
SCALE 1" = 1/2 MILE

APPROVED FOR PUBLIC WATER AND PUBLIC SEWERAGE SYSTEMS
HOWARD COUNTY HEALTH DEPARTMENT
COUNTY HEALTH OFFICER [Signature] DATE 1-22-88
APPROVED HOWARD COUNTY OFFICE OF PLANNING & ZONING
DIRECTOR [Signature] DATE 1-22-88
DIVISION OF COMMUNITY PLANNING AND LAND DEVELOPMENT
DATE 11/26/88
APPROVED FOR PUBLIC WATER AND PUBLIC SEWERAGE
STORM DRAINAGE SYSTEMS & PUBLIC ROADS
HOWARD COUNTY DEPARTMENT OF PUBLIC WORKS
DIRECTOR [Signature] DATE 11/20/88
CHIEF, BUREAU OF ENGINEERING [Signature] DATE 1-18-88

GENERAL NOTES

- 1 RECORDING REFERENCE FOR LOTS 390 THRU 394 IS PLAT
- 2 WATER AND SEWER FACILITIES ARE TO BE PROVIDED (PUBLICLY OWNED)
- 3 GARAGES SHALL BE USED FOR PARKING PURPOSES ONLY IN ACCORDANCE WITH SECTION 127 B 2 b (18) OF THE HOWARD COUNTY ZONING REGULATIONS
- 4 MINIMUM BUILDING SETBACKS SHALL BE IN ACCORDANCE WITH THE BUILDING RESTRICTION LINES SHOWN ON THE RECORDED PLATS
- 5 STORMWATER MANAGEMENT IS PROVIDED IN BURLEIGH MANOR SECTION 4 AREA 3 REFERENCE F-87-180

LEGEND

- ☒ HOUSE NUMBER SIGN
- - - 320 - - PROPOSED CONTOUR (1' INTERVAL)
- - - 320 - - EXISTING CONTOUR (2' INTERVAL)
- 'A' or 'B' BUILDING TYPE
- Ⓜ LOT NUMBER
- R/W RETAINING WALL
- H.R. HANDICAPPED RAMP
- CONCRETE WALK (EXISTING)
- ⊙ FIRE HYDRANT
- ⊙ LIGHT FIXTURE
- ⊙ TREES TO REMAIN
- BRL BUILDING RESTRICTION
- WHC WATER HOUSE CONNECTION
- SHC SEWER HOUSE CONNECTION

SITE ANALYSIS

EXISTING ZONING - R-20
NUMBER OF LOTS - 5
TOTAL AREA = 2.102 ACRES
DENSITY = 5/2.102 = 2.38 DWELLINGS/ACRE

SUBDIVISION NAME		SECT/AREA	LOT #
BURLEIGH MANOR		3 / 2	390 THRU 394
PLAT	BLOCK	ZONE	TAX / ZONE MAP ELEC. DIST
7550-7599	13	R-20	24 2 6023.01
WATER CODE		SEWER CODE	
FIS		SB4600	

REV DATE	REV NO	REVISION	DESCRIPTION
BURLEIGH MANOR 2nd ELECTION DISTRICT HOWARD COUNTY, MARYLAND			
DEVELOPER ROSE/RICHMOND JOINT VENTURE			
PROJECT AREA BURLEIGH MANOR SECTION 3 AREA 2			
PROJECT TITLE LOTS 390 THRU 394 SINGLE FAMILY DETACHED DWELLINGS SITE PLAN			
SHEET 1 OF 2		DATE 10/7/87	
SCALE 1" = 50'		DATE 12-9-87	
WHITMAN, REQUARDT AND ASSOCIATES ENGINEERS BALTIMORE, MARYLAND			

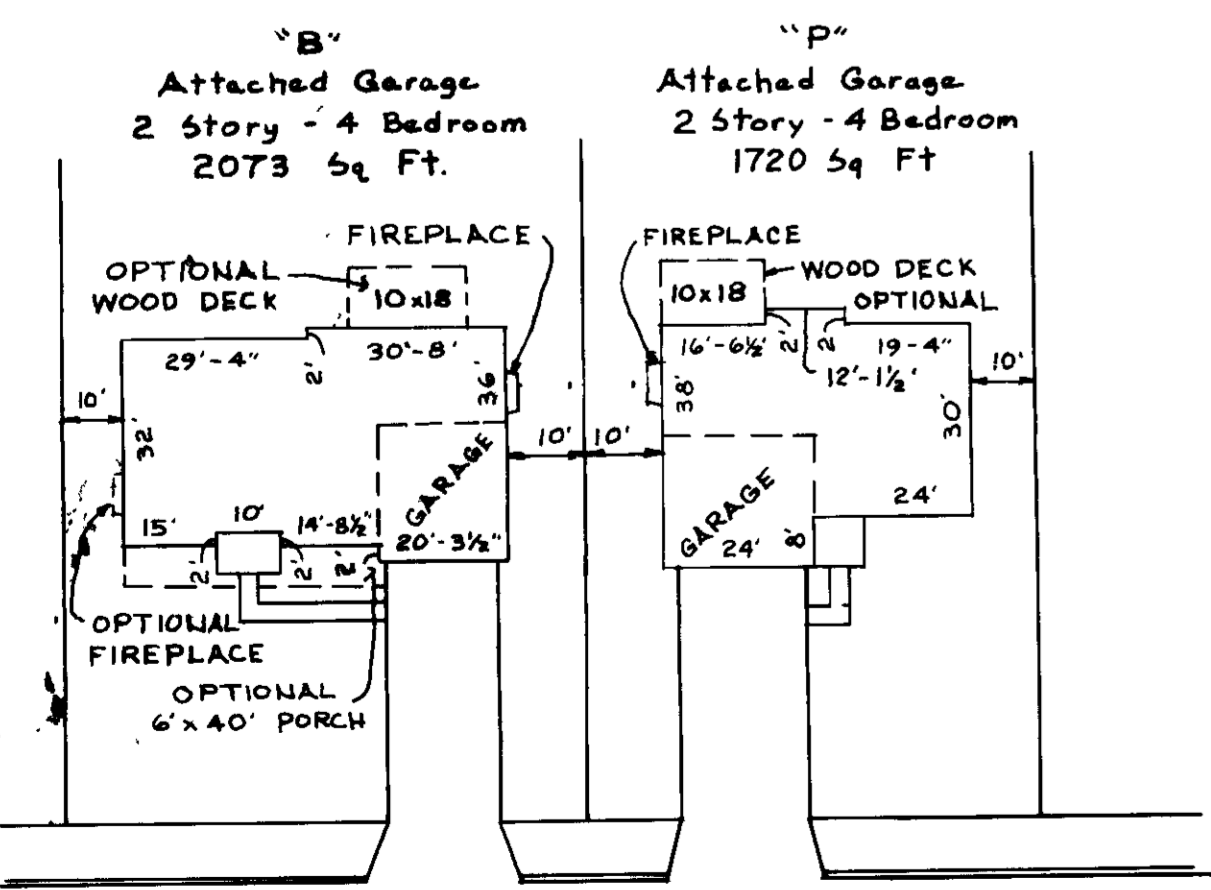

BERKELEY PRINCETON
SCALE 1" = 30'

ADDRESS CHART				BUILDING COVERAGE			
STREET ADDRESS	LOT	LOT NO	INVERT	LOT NO	LOT AREA - S F	HOUSE AREA - S F	% LOT COVERAGE
3910 WHITE ROSE WAY	390	390	447.62	390	20,000	2,073	10.4
3912 " "	391	391	447.62	391	18,000	2,073	11.5
3914 " "	392	392	449.84	392	18,000	1,720	9.6
3916 " "	393	393	451.59	393	18,000	2,073	11.5
3918 " "	394	394	451.59	394	17,555	1,720	9.8

OWNER
GERALD M KATZ &
THOMAS J PELLERITO, TRUSTEES
1531 EDGEWOOD STREET, SUITE M
BALTIMORE, MARYLAND 21227

[Signature]
KENNETH A. MCCORD
REGISTERED ENGINEER NO 1974

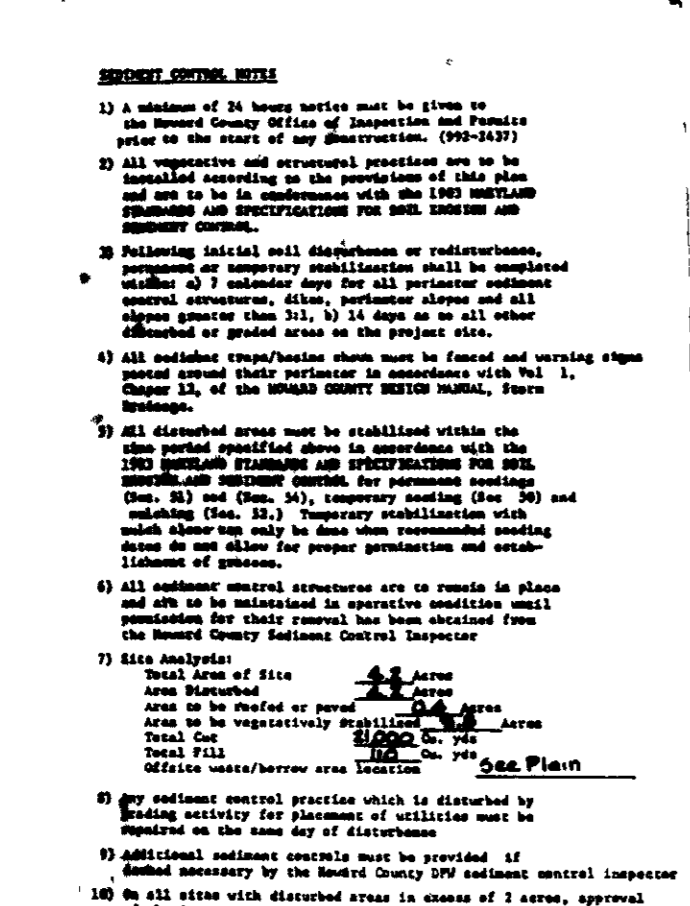
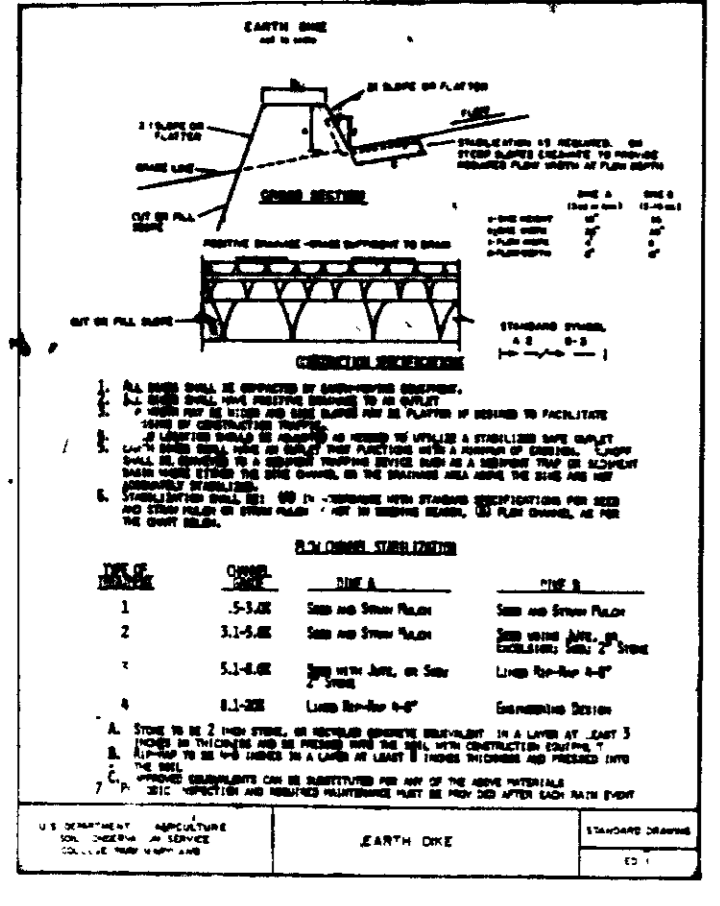
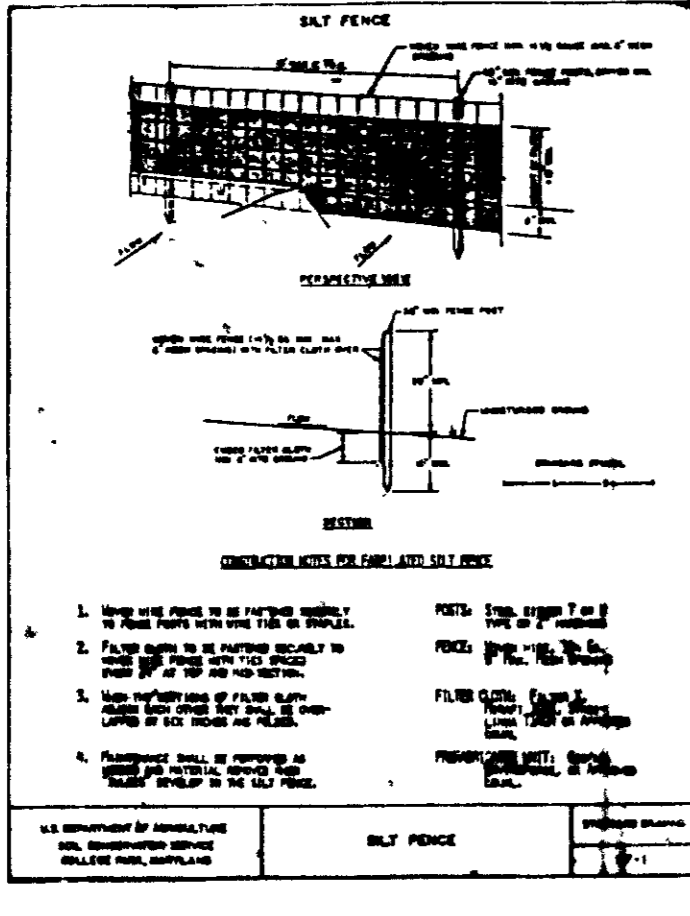
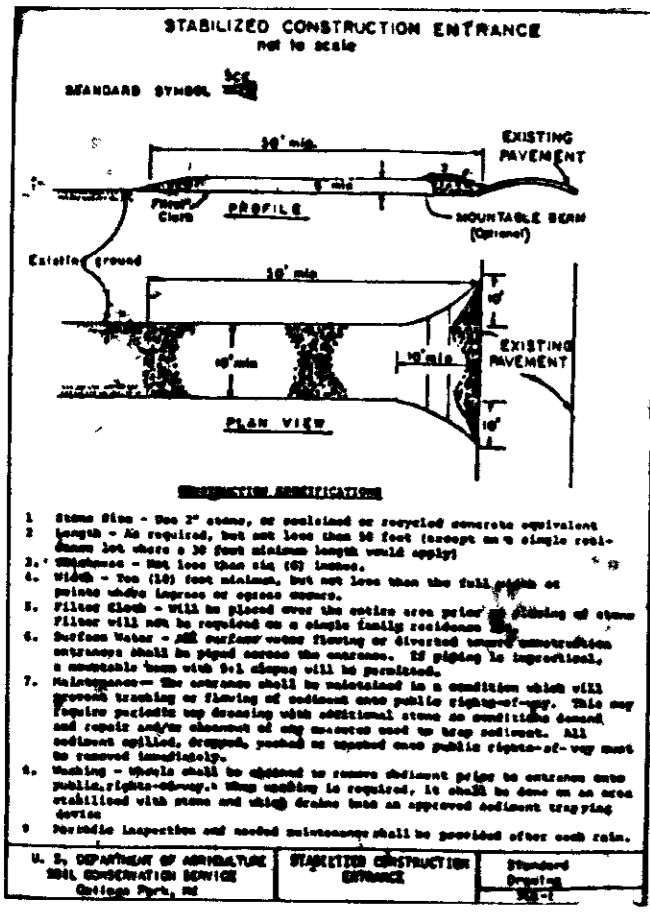

PERMANENT VEGETATION

Apply to graded or cleared areas not subject to immediate further disturbance where a permanent vegetative cover is desired.

SOIL CONSERVATION DISTRICT

Apply to graded or cleared areas not subject to immediate further disturbance where a permanent vegetative cover is desired.

SOIL CONSERVATION DISTRICT

Apply to graded or cleared areas not subject to immediate further disturbance where a permanent vegetative cover is desired.

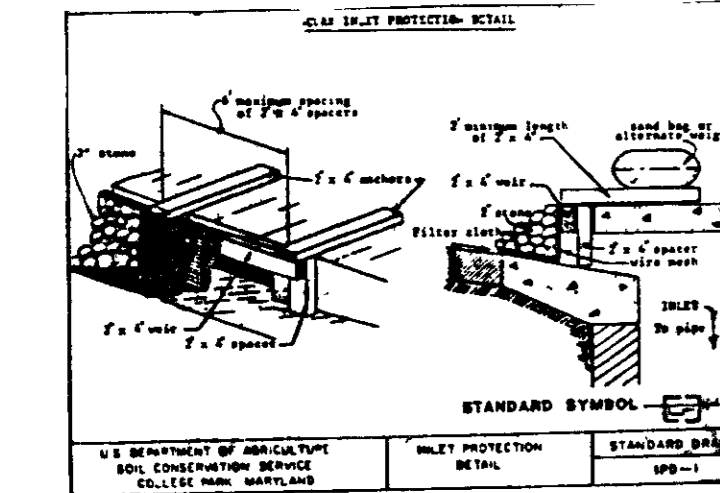

OWNER

GERALD M. KATZ &
THOMAS J. PELLERITO, TRUSTEES
1531 EDGEWOOD STREET, SUITE M
BALTIMORE, MARYLAND 21227

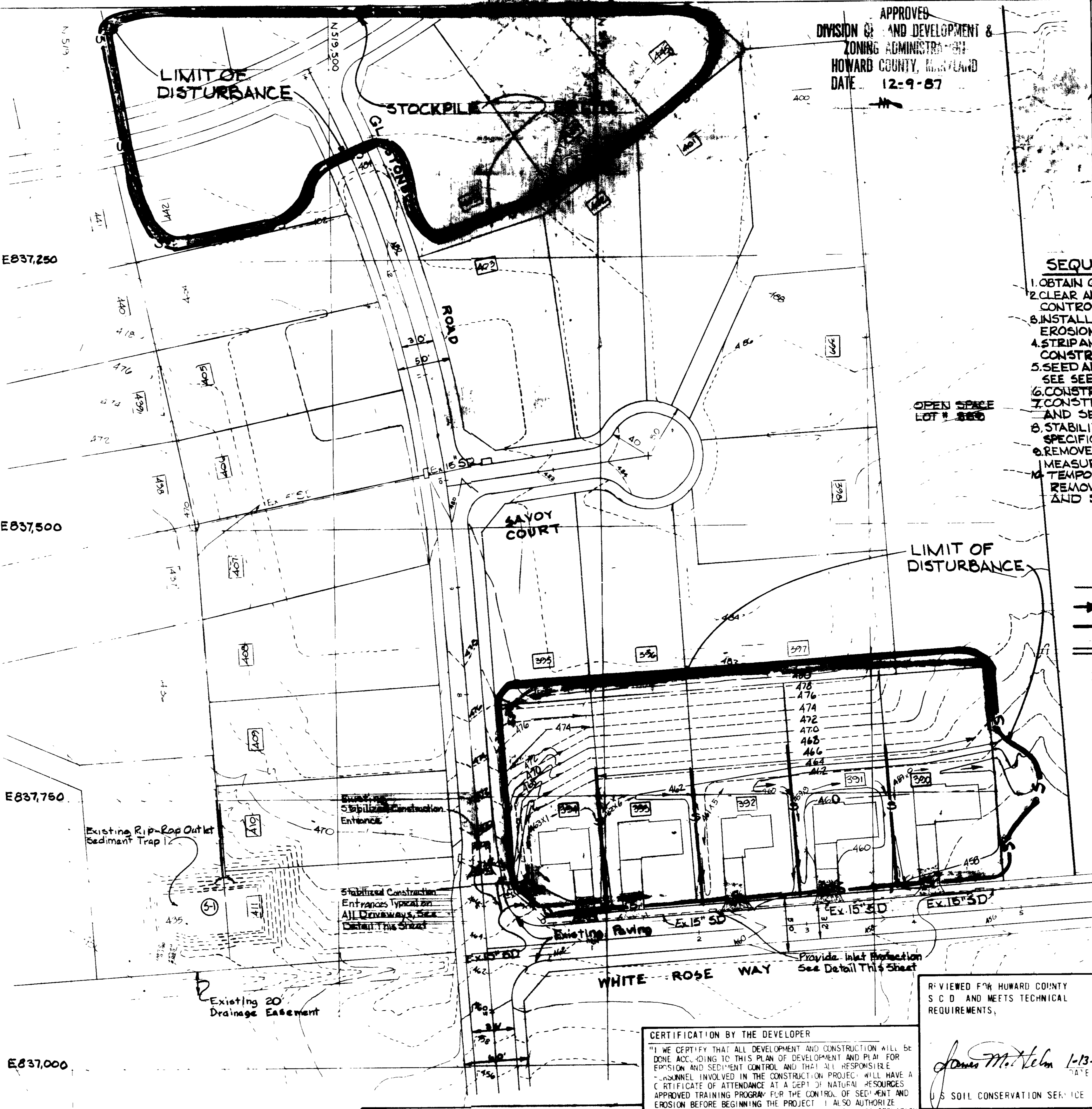

APPROVED
DIVISION OF LAND DEVELOPMENT &
ZONING ADMINISTRATION
HOWARD COUNTY, MARYLAND
DATE 12-9-87

APPROVED FOR PUBLIC WATER AND PUBLIC SEWERAGE SYSTEMS
HOWARD COUNTY HEALTH DEPARTMENT
COUNTY HEALTH OFFICER
APPROVED HOWARD COUNTY OFFICE OF PLANNING & ZONING
DIVISION OF COMMUNITY PLANNING AND LAND DEVELOPMENT
APPROVED FOR PUBLIC WATER AND PUBLIC SEWERAGE SYSTEMS & PUBLIC WORKS
HOWARD COUNTY DEPARTMENT OF PUBLIC WORKS
CHIEF BUREAU OF ENGINEERING

- SEQUENCE OF CONSTRUCTION**
1. OBTAIN GRADING PERMIT.
 2. CLEAR AND GRUB FOR SEDIMENT AND EROSION CONTROL MEASURES OR DEVICES ONLY. (1 DAY)
 3. INSTALL AND STABILIZE ALL SEDIMENT AND EROSION CONTROL MEASURES AND DEVICES. (1 DAY)
 4. STRIP AND ROUGH GRADE LIMITS OF CONSTRUCTION. (2 WEEKS)
 5. SEED ALL SLOPES WITH TEMPORARY SEEDING, SEE SEEDING NOTES ON THIS SHEET. (1 DAY)
 6. CONSTRUCT ALL UTILITIES AND REPLACE PAVING. (2 WEEKS)
 7. CONSTRUCT DWELLINGS AND APPURTENANCES AND SEED YARDS. (8 MONTHS)
 8. STABILIZE SITE AS PER PERMANENT SEEDING SPECIFICATIONS, SEE NOTES ON THIS SHEET.
 9. REMOVE TEMPORARY SEDIMENT CONTROL MEASURES STABILIZE ANY REMAINING AREAS.
 10. TEMPORARY SEDIMENT CONTROL MAY BE REMOVED AS INDIVIDUAL LOTS ARE COMPLETED AND STABILIZED.

- LEGEND**
- +— DRAINAGE AREA LINE
 - >— EARTH DIKE
 - S— SILT FENCE
 - |— STABILIZED CONSTRUCTION ENTRANCE
 - 1 LOT NUMBER

CERTIFICATION BY THE ENGINEER

I CERTIFY THAT THIS PLAN FOR EROSION AND SEDIMENT CONTROL REPRESENTS A PRACTICAL AND WORKABLE PLAN BASED ON MY PERSONAL KNOWLEDGE OF THE SITE CONDITIONS AND THAT IT WAS PREPARED IN ACCORDANCE WITH THE REQUIREMENTS OF THE HOWARD SOIL CONSERVATION DISTRICT.

Kenneth A. McCord 10/7/87
KENNETH A. MCCORD DATE

CERTIFICATION BY THE DEVELOPER

I CERTIFY THAT ALL DEVELOPMENT AND CONSTRUCTION WILL BE DONE ACCORDING TO THIS PLAN OF DEVELOPMENT AND PLAN FOR EROSION AND SEDIMENT CONTROL AND THAT ALL RESPONSIBLE PERSONNEL INVOLVED IN THE CONSTRUCTION PROJECT WILL HAVE A CERTIFICATE OF ATTENDANCE AT A GEP-31 NATURAL RESOURCES APPROVED TRAINING PROGRAM FOR THE CONTROL OF SEDIMENT AND EROSION BEFORE BEGINNING THE PROJECT. I ALSO AUTHORIZE PERIODIC ON SITE INSPECTION BY THE HOWARD SOIL CONSERVATION DISTRICT OR THEIR AUTHORIZED AGENTS AS ARE DEEMED NECESSARY.

James M. Nelson 1-13-88
JAMES M. NELSON DATE

REVIEWED FOR HOWARD COUNTY S.C.D. AND MEETS TECHNICAL REQUIREMENTS.

APPROVED
Stephen S. ...
1/13/88

REV. DATE	REV. NO.	REVISION DESCRIPTION
		BURLEIGH MANOR 2nd ELECTION DISTRICT HOWARD COUNTY, MARYLAND
		DEVELOPER ROSE / RICHMOND JOINT VENTURE
		PROJECT AREA BURLEIGH MANOR SECTION 3 AREA 2 Lots 390-399
		PROJECT TITLE SEDIMENT CONTROL PLAN AND DETAILS SHEET 2 OF 2
		SCALE: 1"=50' DATE 10-7-87
		WHITMAN, REQUARD AND ASSOCIATES ENGINEERS BALTIMORE, MARYLAND
		Kenneth A. McCord REGISTERED ENGINEER NO. 1874