

CORRIDOR NORTH  
PARCEL B  
PLAT 6326  
ZONED M-2

CORRIDOR NORTH  
PARCEL C  
PLATS 6326 & 6327  
ZONED M-2

- LEGEND:**
1. Contour Interval 2 Ft.
  2. Existing Contour
  3. Proposed Contour 190
  4. Spot Elevation +90 ±
  5. Direction of Drainage
  6. Proposed Storm Drain
  7. Handicap Parking Spaces
  8. Timber Retaining Wall

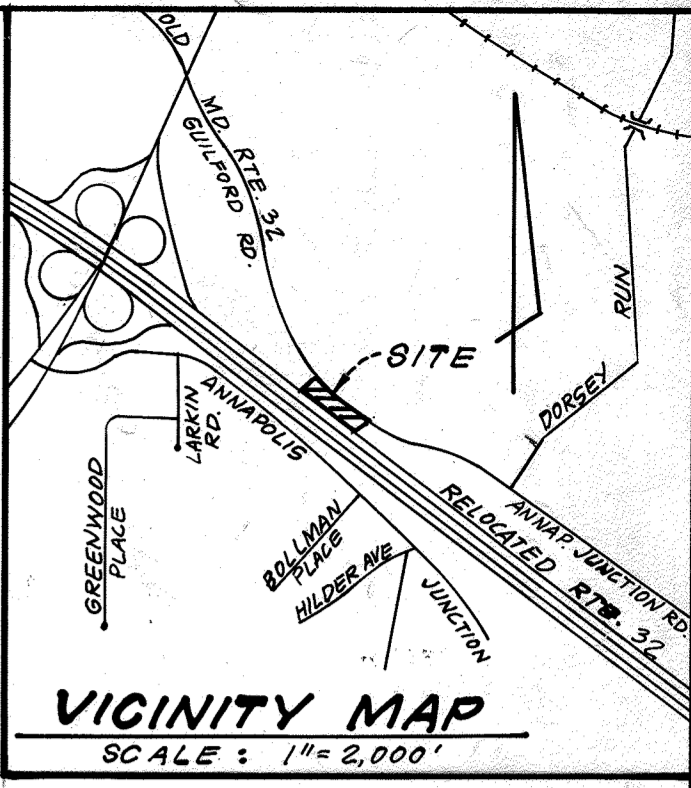

**BUILDING TYPE**

No. Scale  
BENCH MARK #1  
Nail in B.G. & E.  
Pole # 363147  
Elev = 177.30

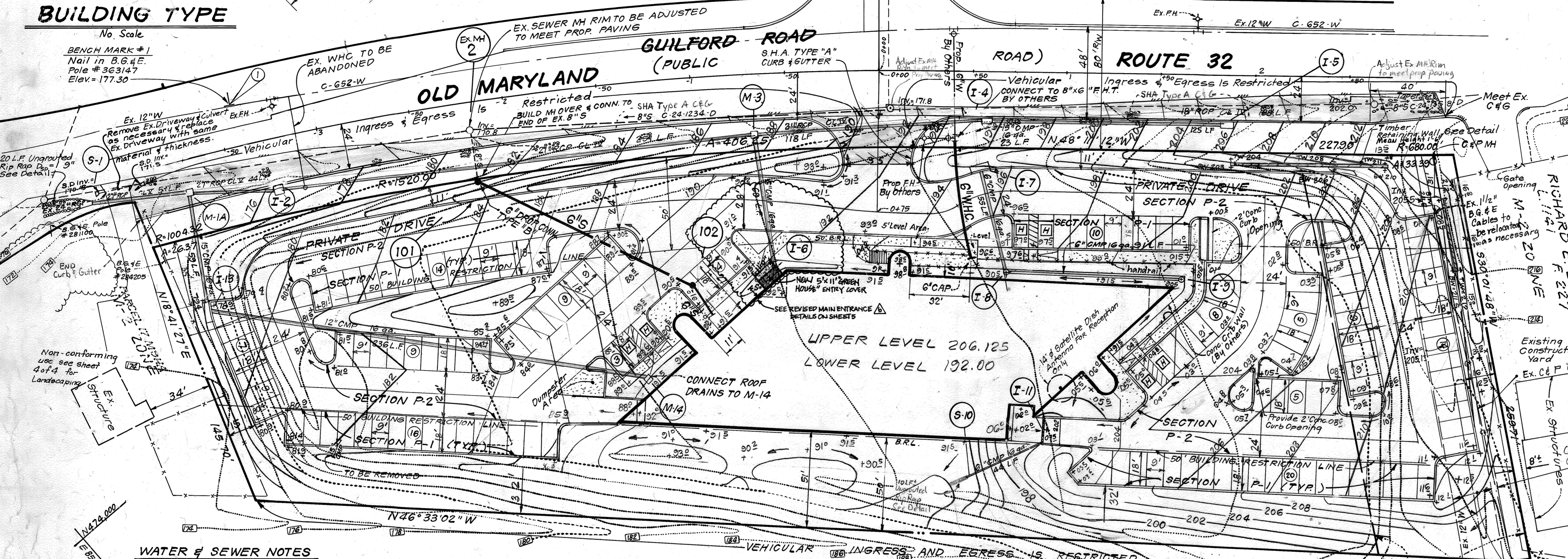

**GENERAL NOTES:**

1. All materials and construction to be in accordance with Howard County Road Construction Code and Specifications.
2. Trench bedding for storm drainage to be in accordance with Ho. Co. Std. G 2.01.
3. Any damage to county owned rights of way shall be corrected at the developers expense.
4. Installation of Traffic Control Devices shall be in accordance with the latest edition of "The Manual of Uniform Traffic Controls".
5. Topography was compiled from field survey.
6. All driveways to be privately owned and maintained.
7. All coordinates are based on Howard County Geodetic Control Traverse which is based on the Maryland State Plane Coordinate System.
8. Information concerning underground utilities was obtained from available records, but the contractor must determine the exact location and elevation of the mains by digging test pits, by hand, at all utility crossings, well in advance of construction.
9. The contractor or developer shall contact the Construction Inspection / Survey Division 24 hrs. in advance of commencement of work at 992-2417 or 792-7272.
10. The developer agrees to work with the Department of Licenses and Inspections to resolve any problems caused by roof water discharge.
11. All roof drains to be connected to storm drain as shown on plan.
12. Storm Water Management provided in a Central Facility. See previously Approved Plans F-84-179.
13. Handicap parking signs shall be placed in approximate locations shown in plan in accordance with the "Maryland Building Code for the Handicapped" Section 5.01 to 7.05.
14. See Office of Planning & Zoning Files S 83-19, F84-179, VP 84-11 & VP 85-107.

**WATER & SEWER NOTES**

1. All Sewer Mains shall be P.V.C., C.S.P.X., V.C.P.X., or A.C.P. class 2400.
2. All Construction methods and materials for on-site Water and Sewer systems shall follow the current edition of the Howard County Plumbing Code, supplemented by the Howard County 3rd Details and Specifications where necessary.
3. Sewer House Connection shall be built within 5 ft. of Building.

MARYLAND (PUBLIC ROAD)  
SRC PLAT 45942

ROUTE 32

**SEWER CONNECTION NOTE**

The owner shall provide a separate and independent sewer connection for each tenant or occupant of any building, shown on this site development plan, who will discharge non-domestic waste to the public sewerage system if this waste is regulated under Section 18.122 A of the Howard County Code. Each separate and independent sewer connection shall include a standard manhole and other waste pretreatment devices as required and approved by Howard County. Waste lines on the interior of the building shall be designed, constructed or modified such that non-domestic waste will be discharged to the separate and independent sewer connection. No tenant or occupant of any building shown on this site development plan shall discharge regulated non-domestic waste to the public sewerage system prior to installation of the separate and independent sewer connection and related interior waste lines. The above requirements shall apply to all initial and future occupants or tenants.

Reviewed for... **HOWARD** S.C.D.  
Name  
and meets Technical Requirements  
*Chen, M. J.* 10/15/87  
Signature Date  
U.S. Soil Conservation Service

THIS DEVELOPMENT PLAN IS APPROVED FOR SOIL EROSION AND SEDIMENT CONTROL BY THE HOWARD SOIL CONSERVATION DISTRICT.

*Stephen L. Smith* 10/15/87  
Approved Date

**DEVELOPER'S/BUILDER'S CERTIFICATE**

"I/We certify that all development and construction will be done according to this plan of development and plan for erosion and sediment control and that all responsible personnel involved in the construction project will have a Certificate of Attendance at a Dept. of Natural Resources Approved Training Program for the Control of Sediment and Erosion before beginning the project. I also authorize periodic on-site inspection by the Howard Soil Conservation District or their authorized agents, as are deemed necessary."

*M.V. Dammer* 6-9-87  
Signature of Developer/Builder Date

**ENGINEER'S CERTIFICATE**

I hereby certify that this plan for Erosion and Sediment Control represents a practical and workable plan based on my personal knowledge of the site conditions and that it was prepared in accordance with the requirements of the Howard Soil Conservation District.

*Jeffrey J. Schwab* 6/10/87  
Date

**ADDRESS CHART**

LOT NUMBER	STREET	ADDRESS
Parcel A	10620 Guilford Road	
SUBDIVISION NAME	SECT./AREA	PARCEL #
CORRIDOR NORTH	A	
PLAT BLOCK#	ZONE	TAX ZONE MAP/ELEC. DIST. CENSUS TR.
6326 13	M-2	48 P18 GTH G064
WATER CODE	SEWER CODE	
B02	4150000	

**CLARK · FINEFROCK & SACKETT**  
ENGINEERS · PLANNERS · SURVEYORS

7135 MINSTREL WAY, COLUMBIA, MARYLAND 21045 (301) 381-7500 BALTO (301) 621-8100 WASH.

DESIGNED	SITE DEVELOPMENT PLAN	SCALE
JLS	PARCEL "A"	1" = 30'
DRAWN	<b>CORRIDOR NORTH</b>	DRAWING
VLM		1 OF 5
CHECKED		JOB NO.
JLS	6TH ELECTION DISTRICT	87-037
DATE	HOWARD COUNTY, MARYLAND	FILE NO.
6-3-87	FOR: BRITAM	
	9030 Red Branch Rd, Suite 250	
	Columbia, Maryland 21045	

APPROVED  
DIVISION OF LAND DEVELOPMENT & ZONING ADMINISTRATION  
HOWARD COUNTY, MARYLAND  
DATE: 9-30-87  
*KMM*

APPROVED: FOR PUBLIC WATER AND PUBLIC SEWERAGE SYSTEMS,  
HOWARD COUNTY HEALTH DEPARTMENT  
COUNTY HEALTH OFFICER: *[Signature]* 10-26-87  
DATE  
APPROVED: HOWARD COUNTY OFFICE OF PLANNING & ZONING  
PLANNING DIRECTOR: *[Signature]* 11-3-87  
DATE  
CHIEF DIVISION OF LAND DEVELOPMENT AND ZONING ADMINISTRATION: *[Signature]* 10-28-87  
DATE  
APPROVED: FOR PUBLIC WATER AND PUBLIC SEWERAGE, STORM DRAINAGE SYSTEMS AND PUBLIC ROADS  
HOWARD COUNTY DEPARTMENT OF PUBLIC WORKS  
DIRECTOR: *[Signature]* 10-20-87  
DATE  
CHIEF BUREAU OF ENGINEERING: *[Signature]*

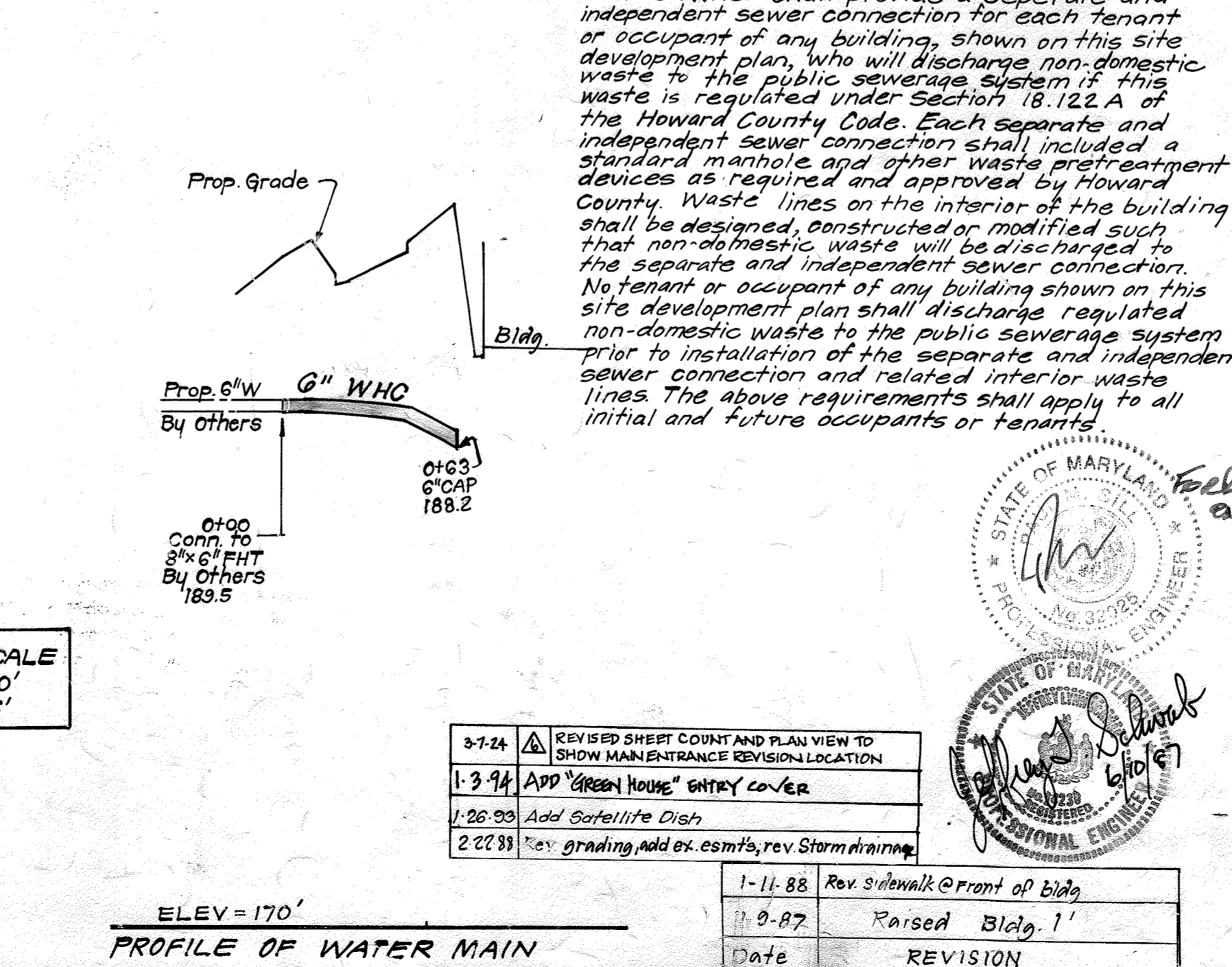
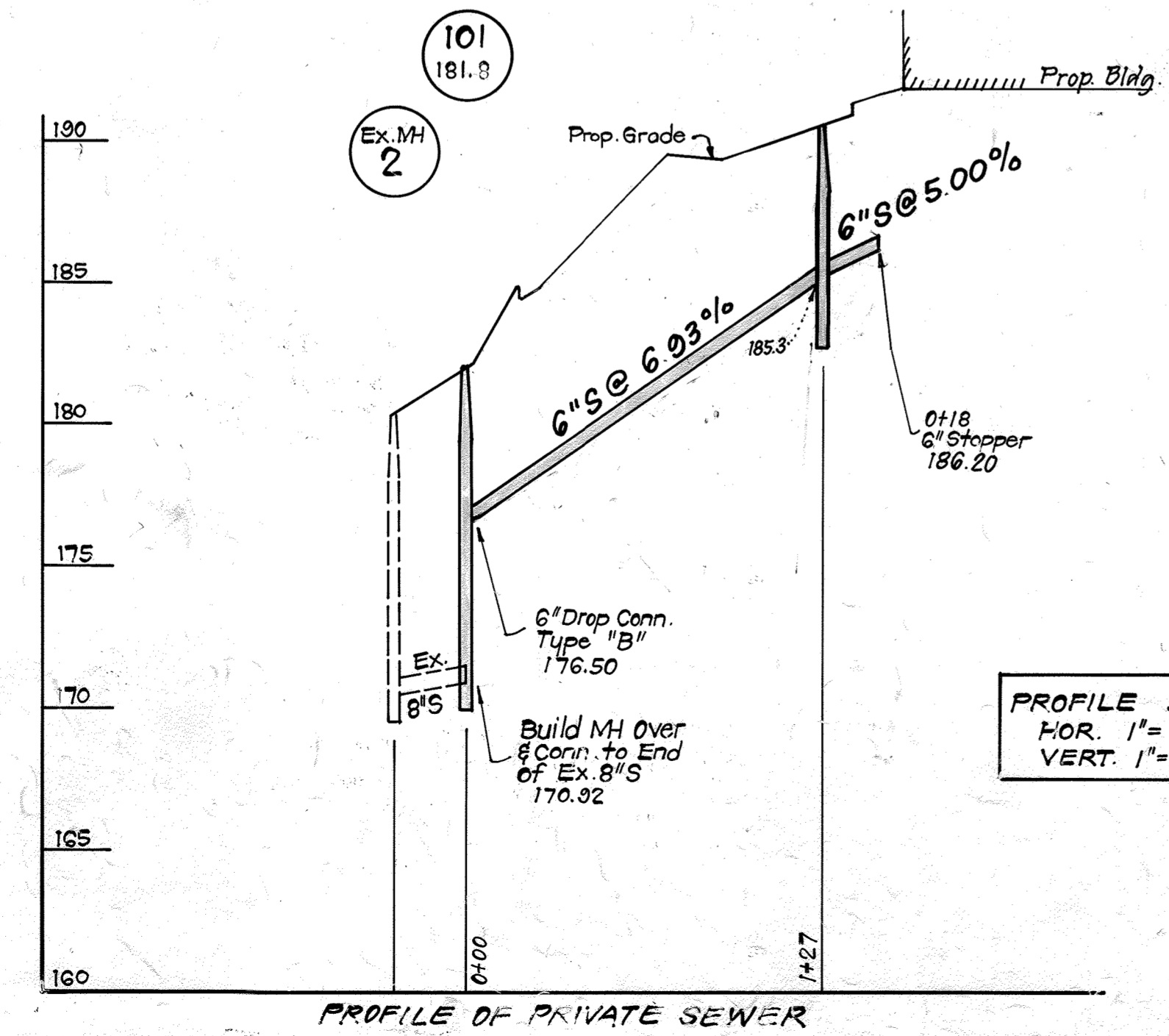

NO.	DESCRIPTION	DATE
3-7-84	REVISED SHEET COUNT AND PLAN VIEW TO SHOW MAIN ENTRANCE REVISION LOCATION	
1-9-84	ADD "GREEN HOUSE" ENTRY COVER	
1-26-85	ADD SATELLITE DISH	
2-22-85	REV. GRADING, ADD EX. ESMTS, REV. STORM DRAINAGE	
1-11-88	REV. SIDEWALK FRONT OF BLDG	
9-9-87	RAISED BLDG. 1'	

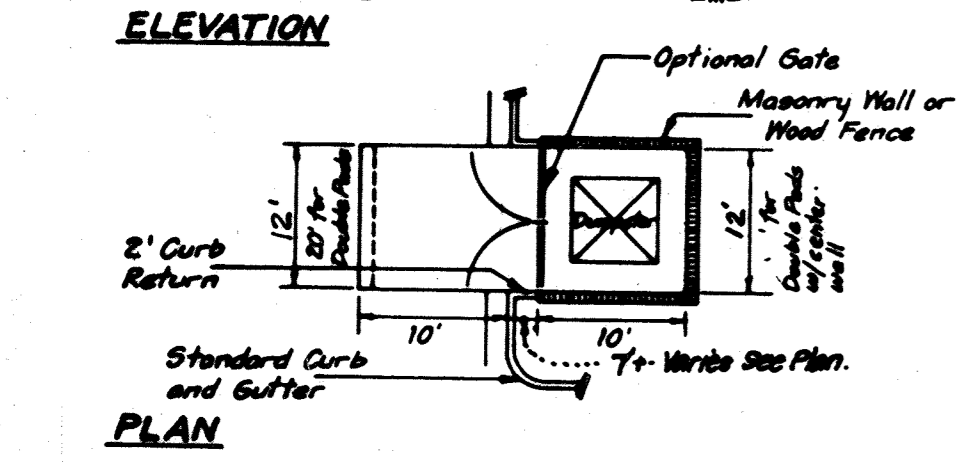
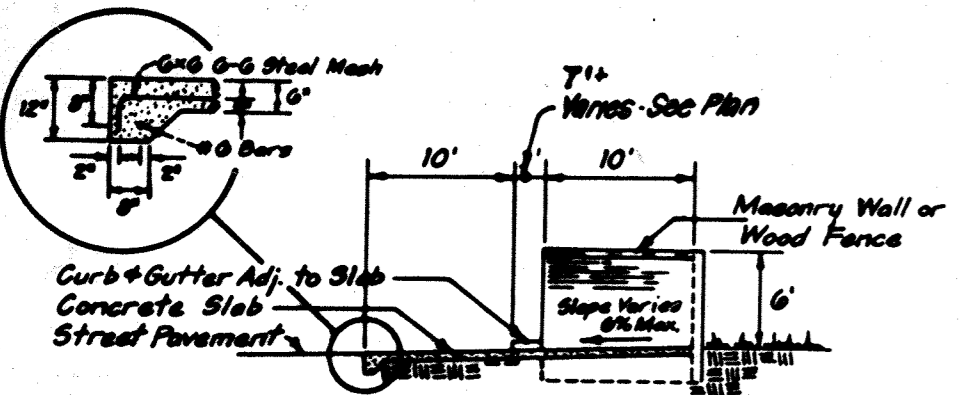

**DUMPSTER PAD & ENCLOSURE**  
No Scale

Notes:  
1. Materials and Construction to be in accordance with Ho. Co. Std. of Specs  
2. See plan view for limits of conc. paving, shown thus:

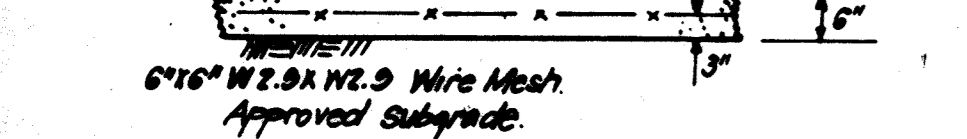

**CONCRETE PAVING DETAIL - DUMPSTER AREA**  
No Scale

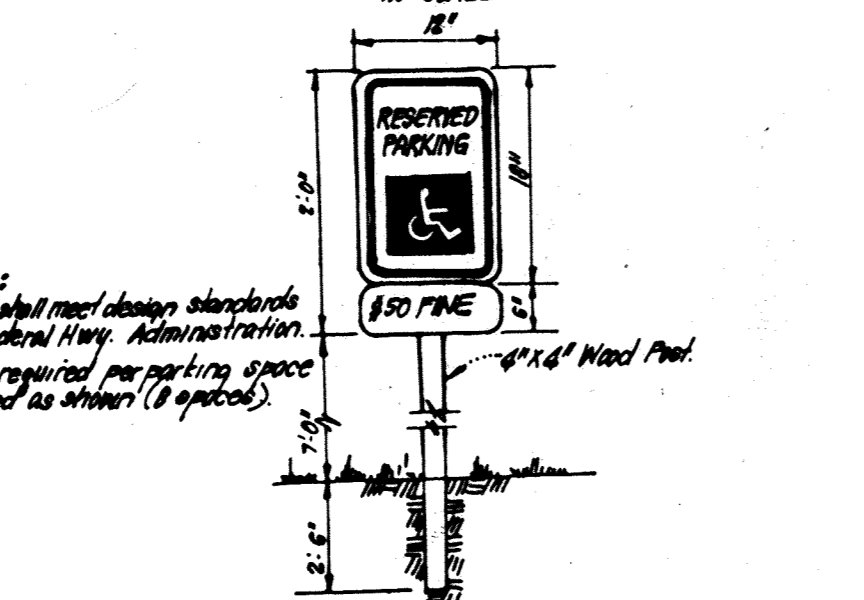
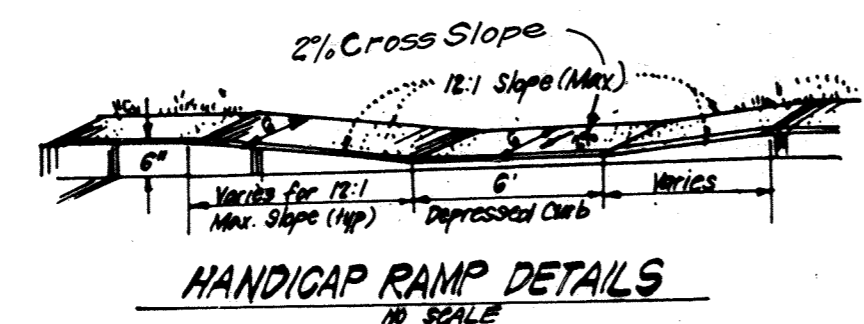

**HANDICAP PARKING SIGN DETAIL**  
No Scale

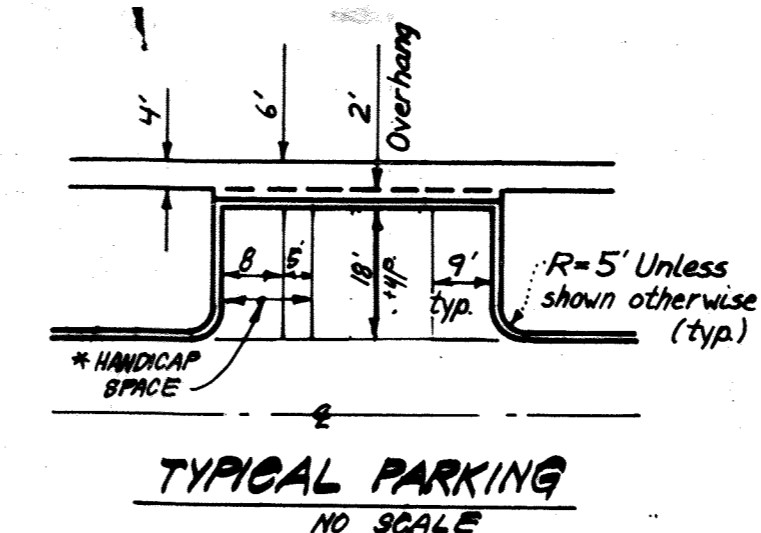

**TYPICAL PARKING**  
NO SCALE

\* Two 8' Handicap Spaces may share One 5' Aisle

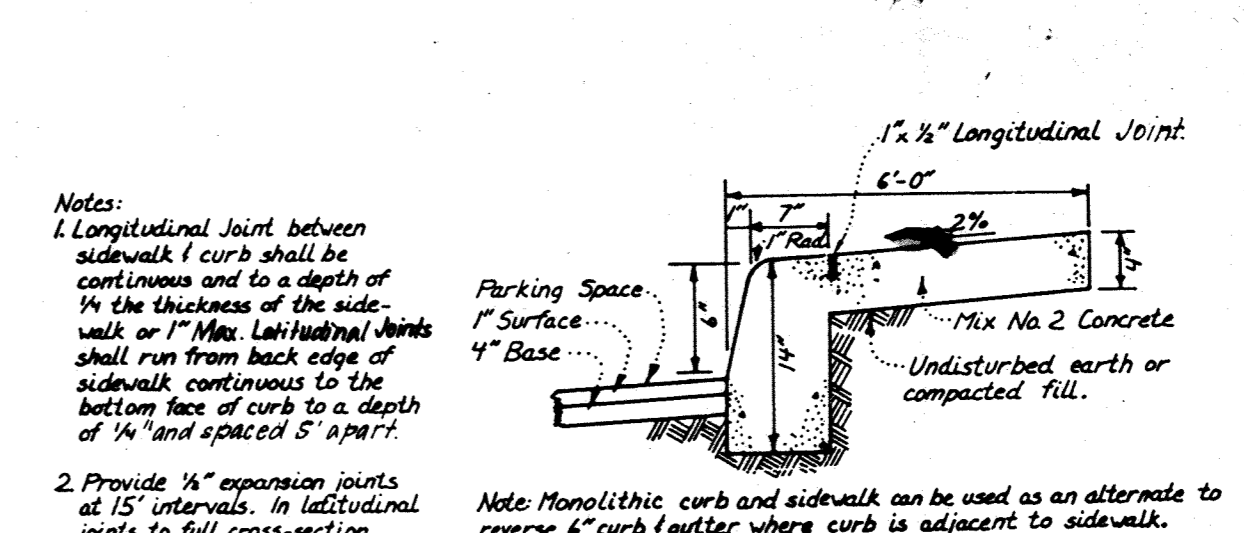

**MONOLITHIC CURB & SIDEWALK - PRIVATE PARKING AREA**  
NO SCALE

Notes:  
1. Longitudinal joint between sidewalk & curb shall be continuous and to a depth of 1/4 the thickness of the sidewalk or 1" Min. Latitudinal joints shall run from back edge of sidewalk continuous to the bottom face of curb to a depth of 1/4" and spaced @ 8' MIN.  
2. Provide 1/4" expansion joints at 15' intervals in individual joints to full cross-section.

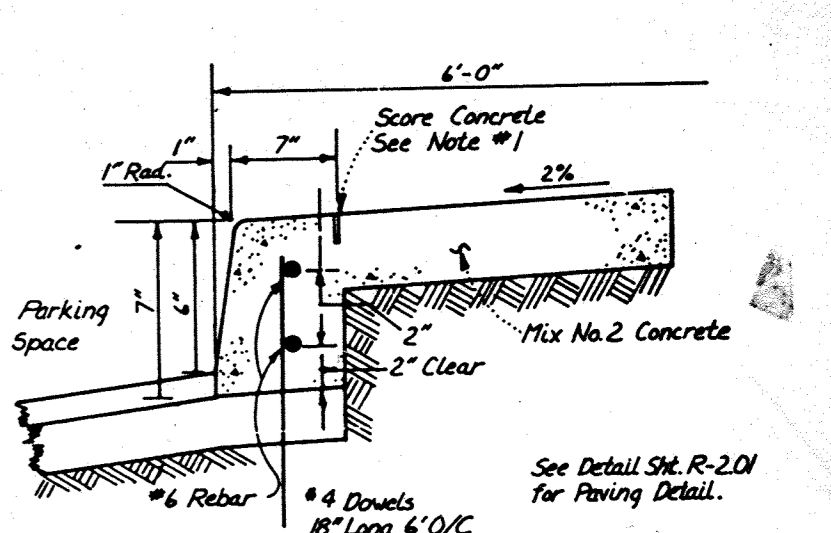

**ALTERNATE SECTION**  
NO SCALE

Bituminous Conc. Surface	1 1/4"
Bituminous Conc. Base	2"
Prime	
5" Crusher Run Base Course	5"
4" Dense Graded Stabilized Aggregate Base Course	4"

**ALTERNATE PAVING SECTION FOR PUBLIC ROADS**  
(SECTION P-2)

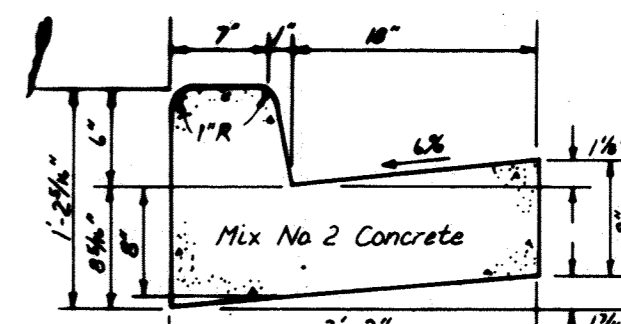

**STANDARD 6' COMBINATION CURB & GUTTER**  
NO SCALE

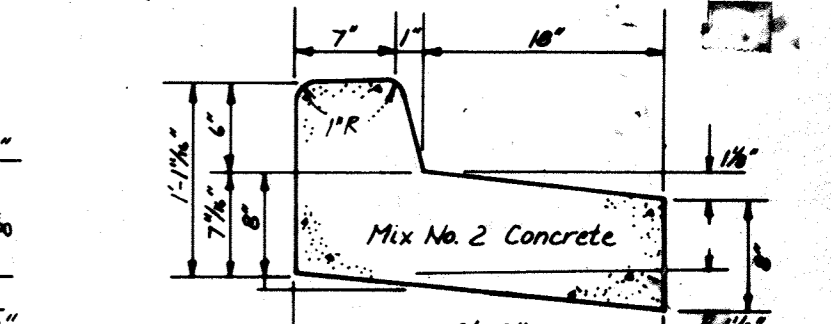

**REVERSE 6' COMBINATION CURB & GUTTER**  
NO SCALE

No.	TYPE	INV. IN	INV. OUT	TOP ELEVATION	REMARKS	LOCATION
S-1	Conc. End Section	170.07	170.00		SHA Std. Md. 388.02	21" Dia. See Plan
I-2	Sha. 5'	172.50	172.00	176.03	SHA Std. Md. 374.31	
M-3	Std. Shallow Manhole	181.0/185.0	180.75	187.4	SHA Std. Md. 383.0	4' Sq.
I-4	SHA 5'	185.0/185.33	184.83	195.52	SHA Std. Md. 374.31	
I-5	SHA 5'	198.97	206.00	206.14	SHA Std. Md. 374.31	
I-6	Yard Inlet		186.00	190.3	Ho. Co. Std. SD.4.14	2' Rd.
I-7	A-10 W/Deflectors	186.50	185.75	195.84	Ho. Co. Std. SD.4.02	W:2'6"
I-8	Yard Inlet	187.00	186.90	190.5	Ho. Co. Std. SD.4.14	2' Rd.
I-9	Yard Inlet		187.50	190.5	Ho. Co. Std. SD.4.14	2' Rd.
I-11	C-Inlet		198.00	201.5	Ho. Co. Std. SD.4.15	W:1'
S-12	Metal End Section	171.77	171.65		Ho. Co. Std. SD.5.61	15" Dia.
I-13	A-10 Inlet	175.64	175.00	179.40	Ho. Co. Std. SD.4.02	W:2'6"
M-1A	Shallow Brick Manhole		184.50	190.0	Ho. Co. Std. GS.05	4' Sq.
M-1A	Shallow Brick Manhole		170.70	174.8	SHA Std. Md. 383.0	4' Sq.

Δ All inverts to be fully developed  
\* See Ho. Co. Std. SD. 4.83 for Inlet Deflectors.

SIZE	TYPE	LENGTH
6"	CMP 16 ga.	259 L.F.
12"	CMP 16 ga.	236 L.F.
15"	CMP 16 ga.	84 L.F.
18"	RCP CL IV	188 L.F.
21"	RCP CL IV	364 L.F.
27"	RCP CL V	95 L.F.

\* 2 1/2" x 1/2" Corr.

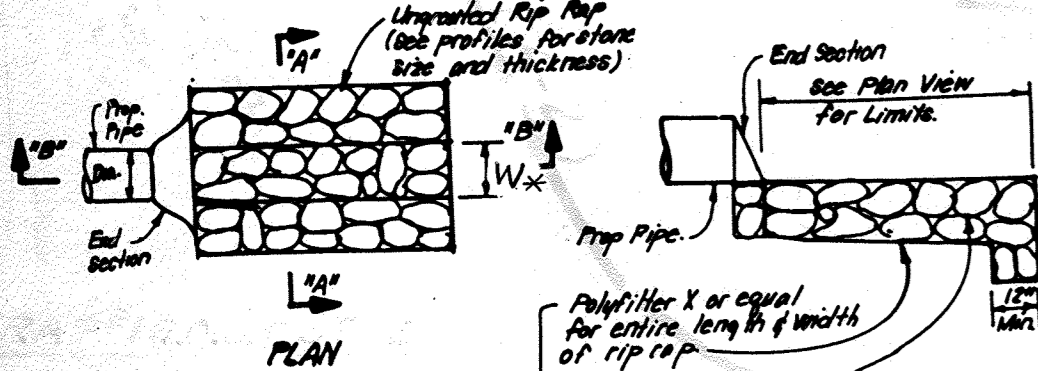
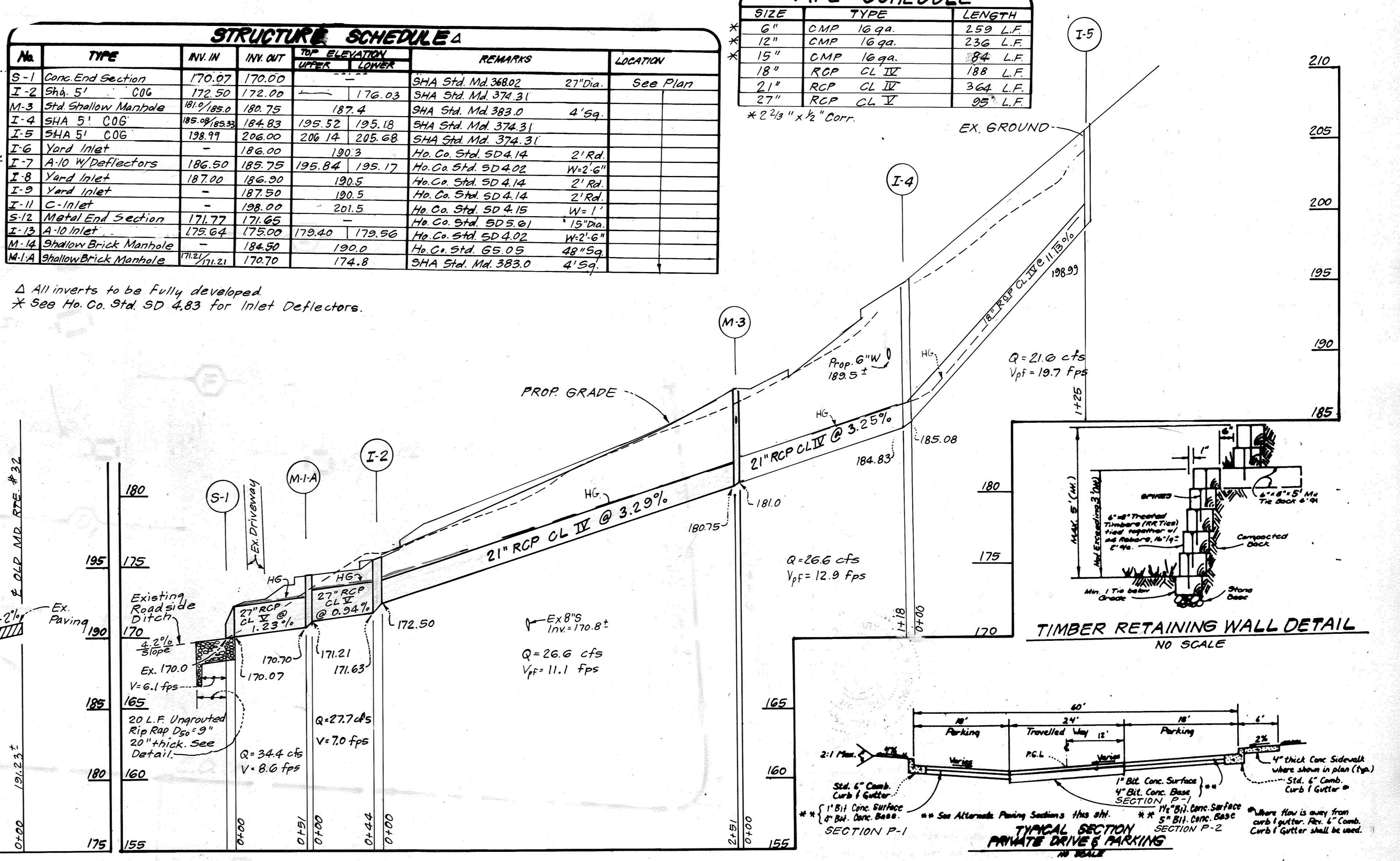
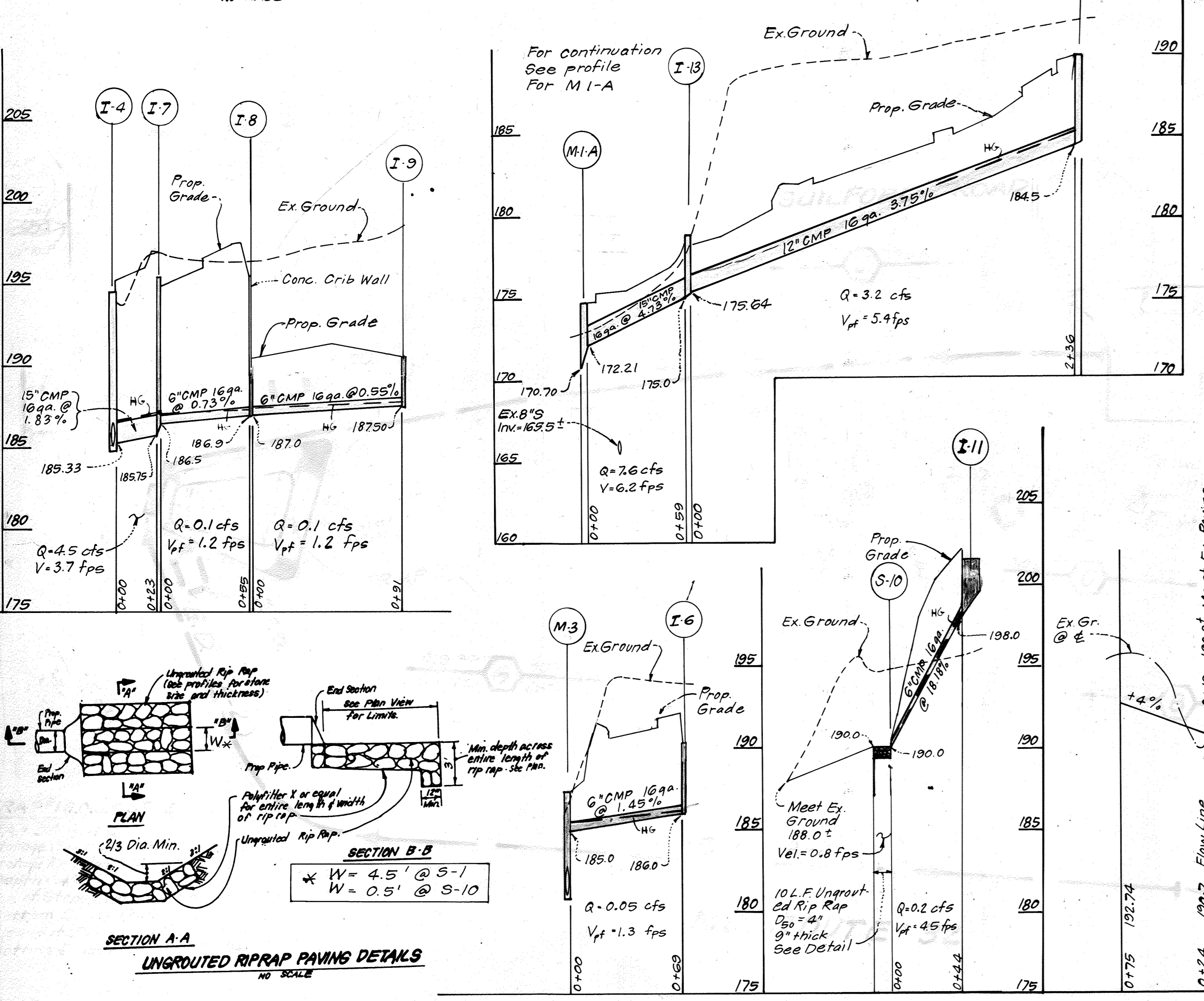

**UNGRADED RIPRAP PAVING DETAILS**  
NO SCALE

SECTION A-A  
SECTION B-B  
\* W = 4.5' @ S-1  
W = 0.5' @ S-10

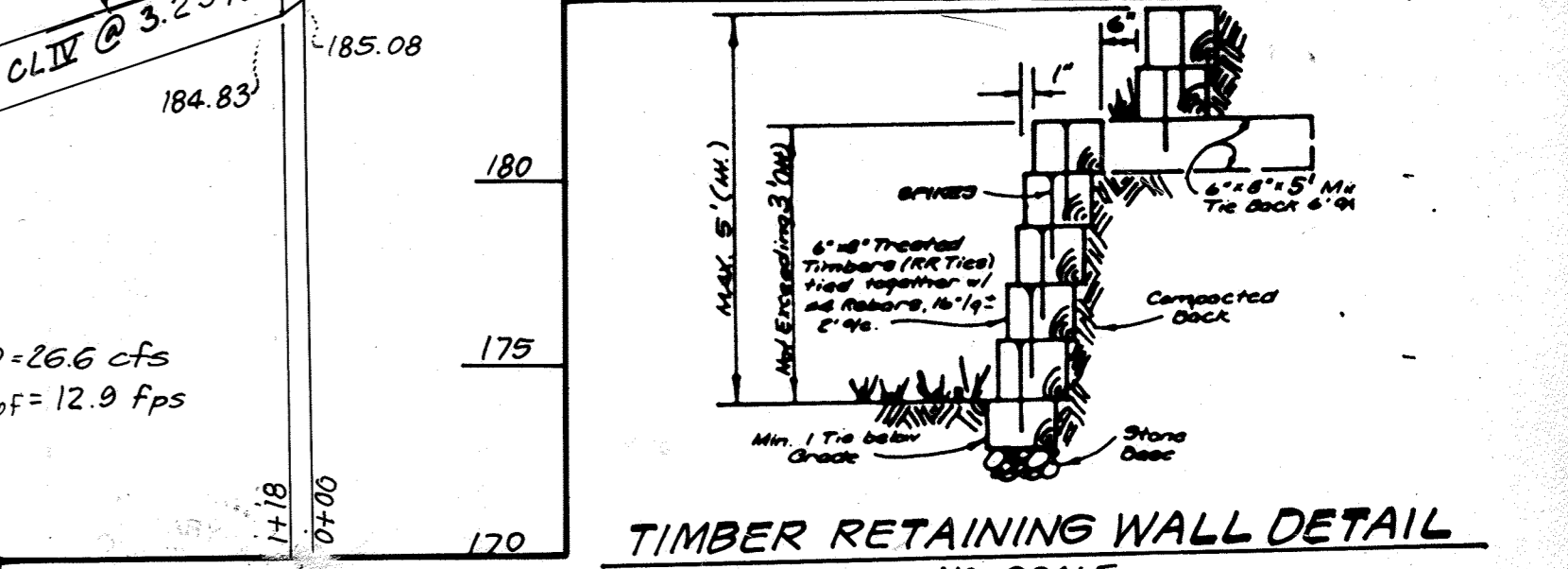

**TIMBER RETAINING WALL DETAIL**  
NO SCALE

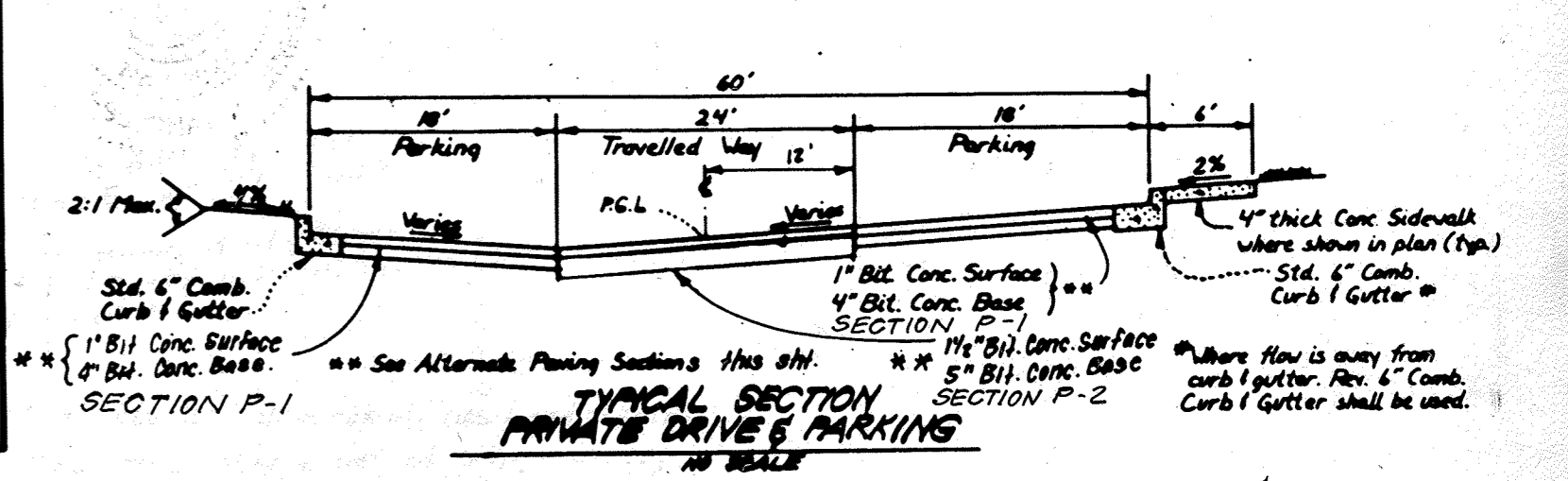

**TYPICAL SECTION PRIVATE DRIVE & PARKING**  
NO SCALE

APPROVED FOR PUBLIC WATER AND PUBLIC SEWERAGE SYSTEMS, HOWARD COUNTY HEALTH DEPARTMENT  
 COUNTY HEALTH OFFICE (16)  
 APPROVED FOR PLANNING & ZONING  
 DIVISION OF LAND DEVELOPMENT & ZONING ADMINISTRATION  
 HOWARD COUNTY, MARYLAND  
 APPROVED FOR PUBLIC WATER AND PUBLIC SEWERAGE, STORM DRAINAGE SYSTEMS AND PUBLIC ROADS  
 HOWARD COUNTY DEPARTMENT OF PUBLIC WORKS

APPROVED  
 DIVISION OF LAND DEVELOPMENT & ZONING ADMINISTRATION  
 HOWARD COUNTY, MARYLAND  
 DATE 9-30-87

Reviewed for HOWARD S.C.D.  
 and meets Technical Requirements  
 U.S. Soil Conservation Service  
 THIS DEVELOPMENT PLAN IS APPROVED FOR SOIL EROSION AND SEDIMENT CONTROL BY THE HOWARD SOIL CONSERVATION DISTRICT.

DEVELOPER'S/BUILDER'S CERTIFICATE  
 I/We certify that all development and construction will be done according to this plan of development and plan for erosion and sediment control and that all responsible personnel involved in the construction project will have a Certificate of Attendance at a Dept. of Natural Resources Approved Training Program for the Control of Sediment and Erosion before beginning the project. I also authorize periodic on-site inspection by the Howard Soil Conservation District or their authorized agents, as are deemed necessary.

ENGINEER'S CERTIFICATE  
 I hereby certify that this plan for Erosion and Sediment Control represents a practical and workable plan based on my personal knowledge of the site conditions and that it was prepared in accordance with the requirements of the Howard Soil Conservation District.

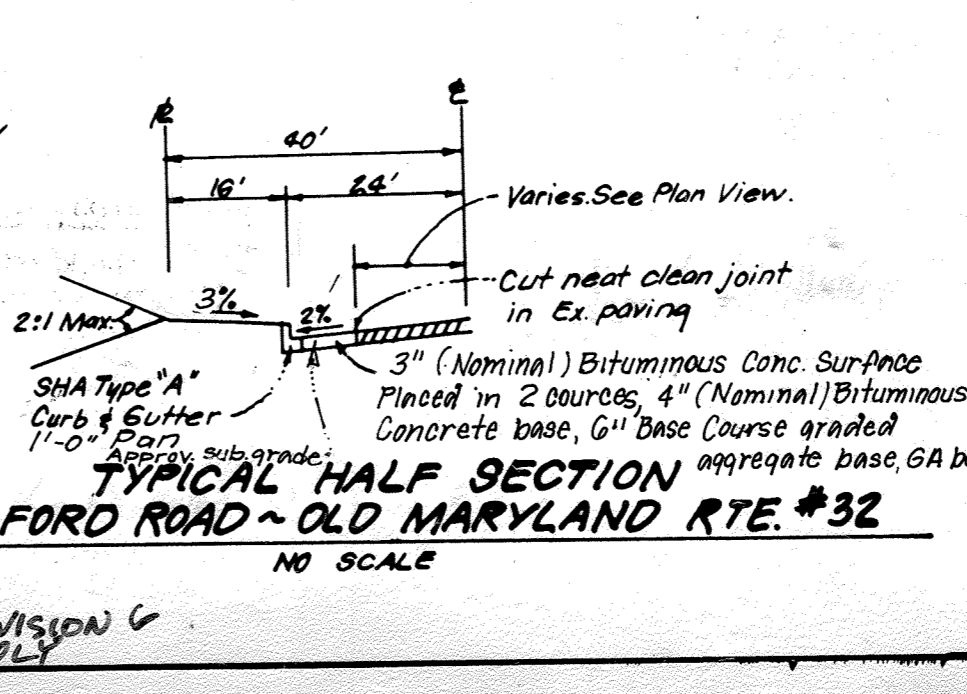

**TYPICAL HALF SECTION**  
NO SCALE

CLARK • FINEFROCK & SACKETT  
 ENGINEERS • PLANNERS • SURVEYORS  
 7135 MINSTREL WAY, COLUMBIA, MD. 21045  
 STORM DRAIN PROFILES & PAVING DETAILS  
 PARCEL "A"  
**CORRIDOR NORTH**  
 6TH ELECTION DISTRICT  
 HOWARD COUNTY, MARYLAND  
 FOR: BRITAM  
 3030 Red Branch Rd., Suite 250  
 Columbia, Md. 21045

SDP-87-246

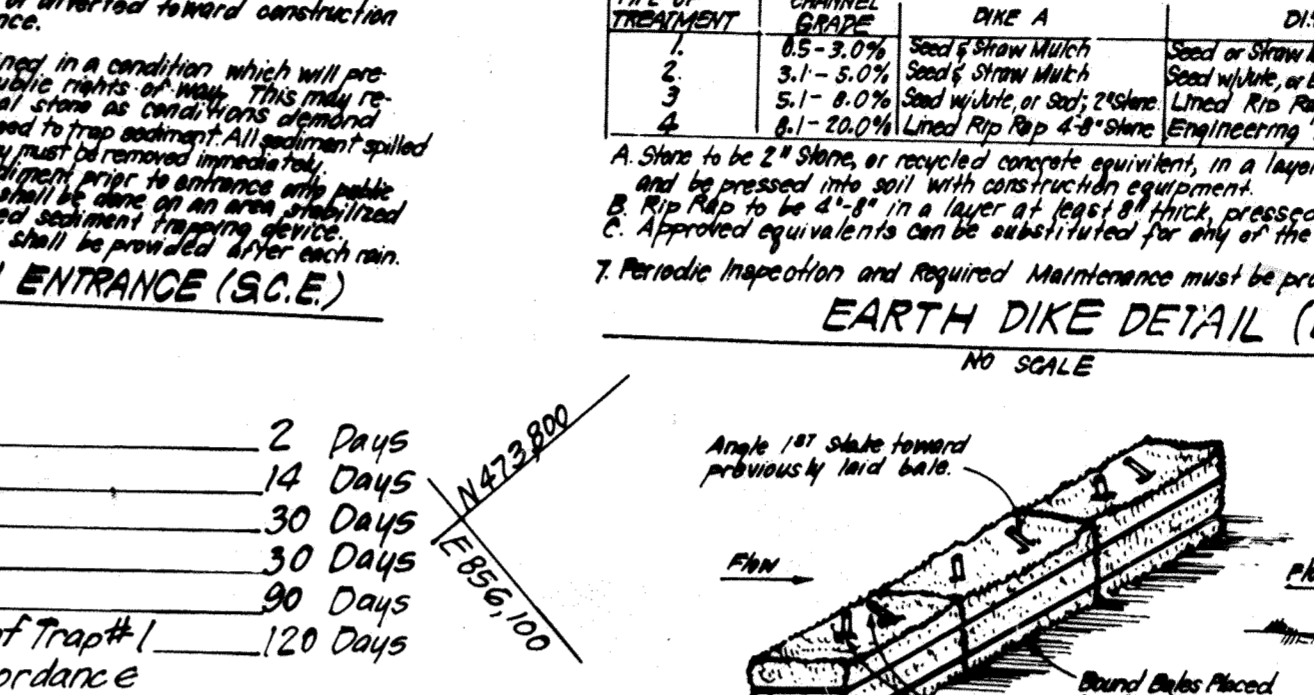
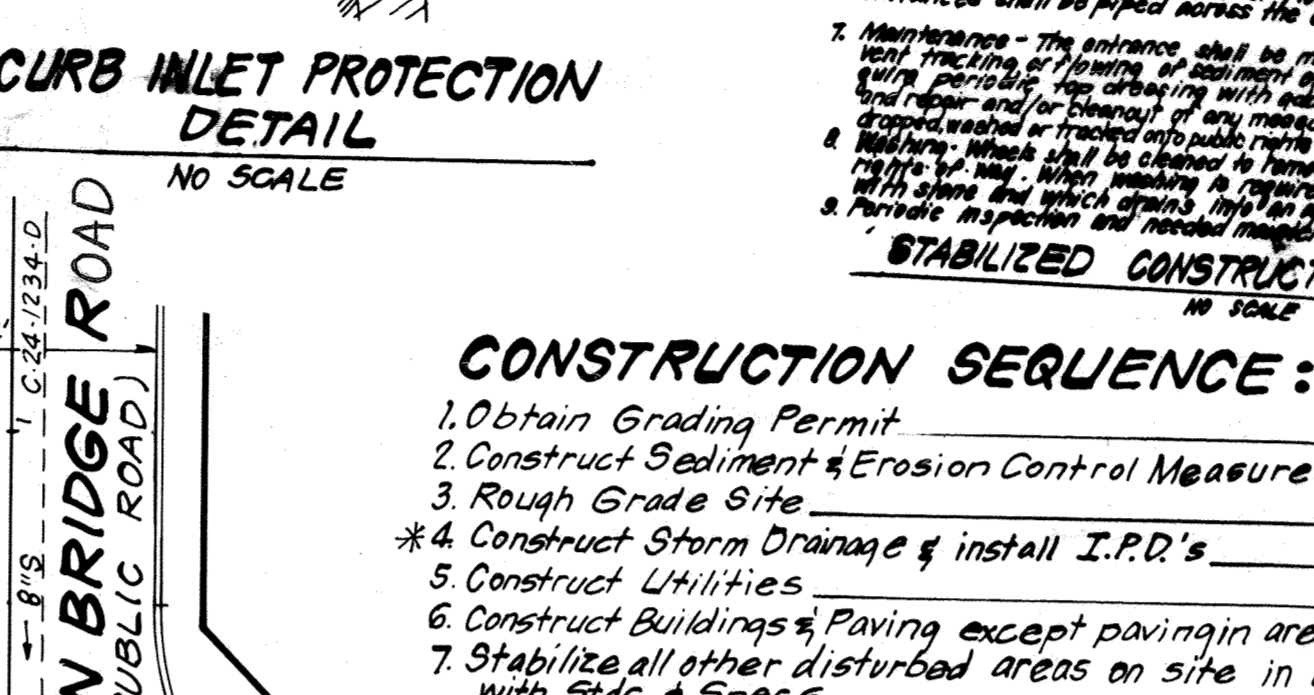
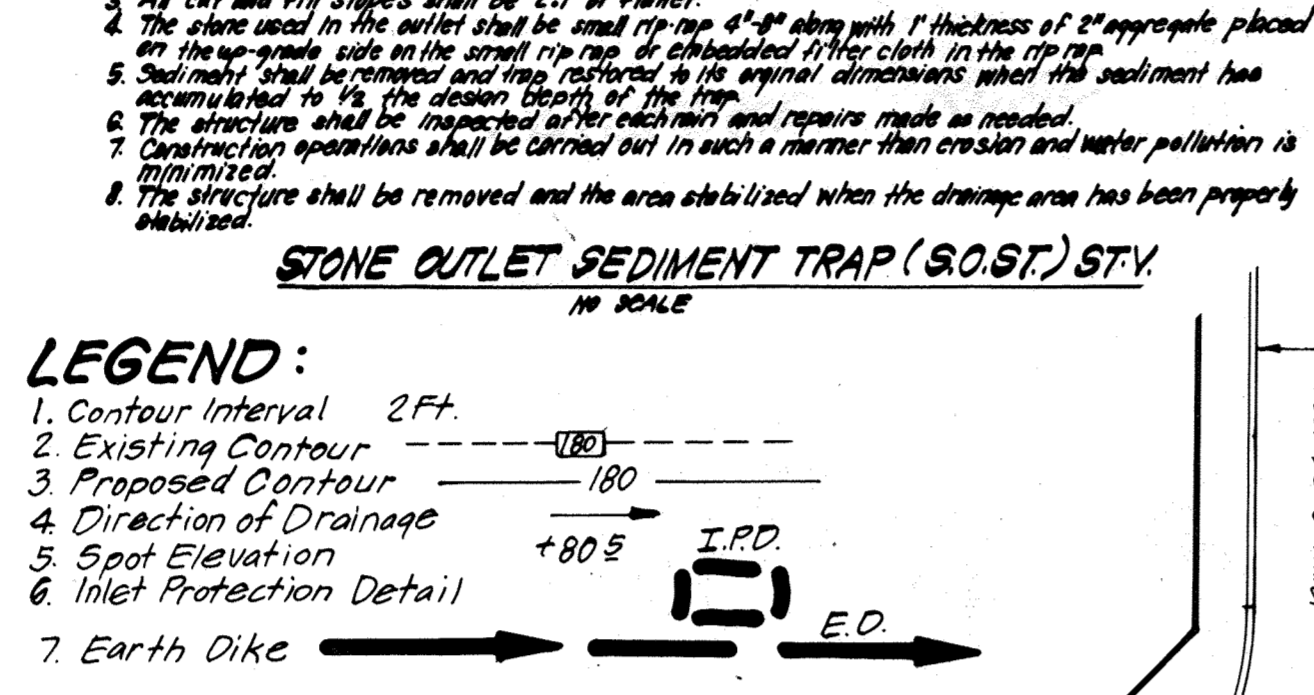
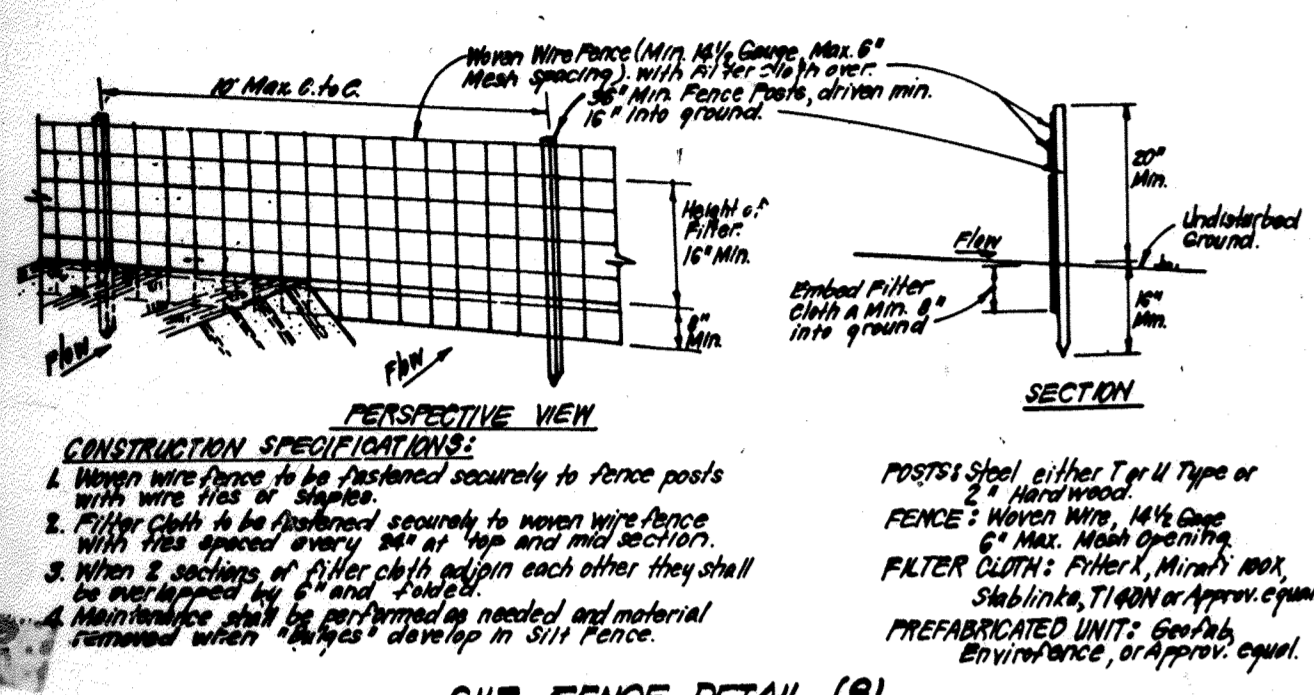
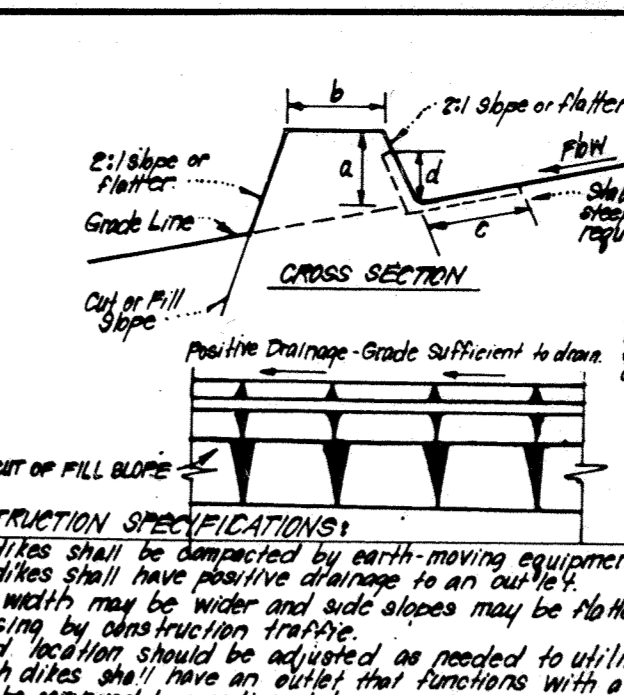
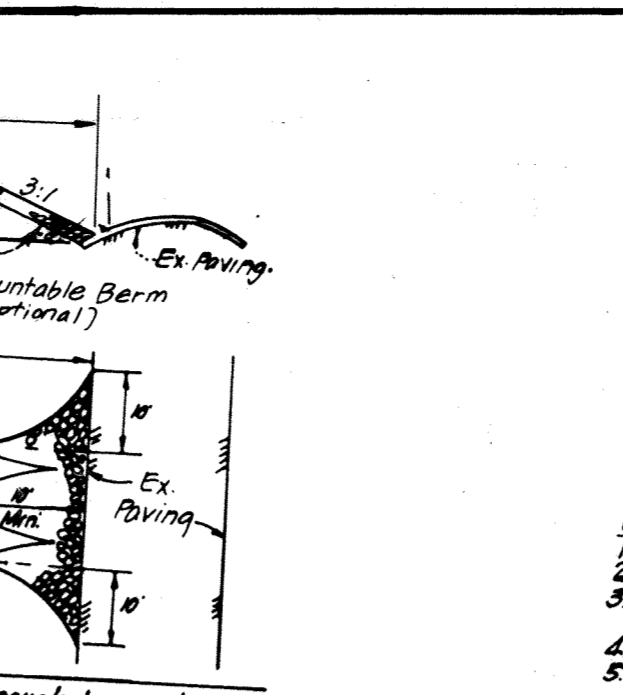
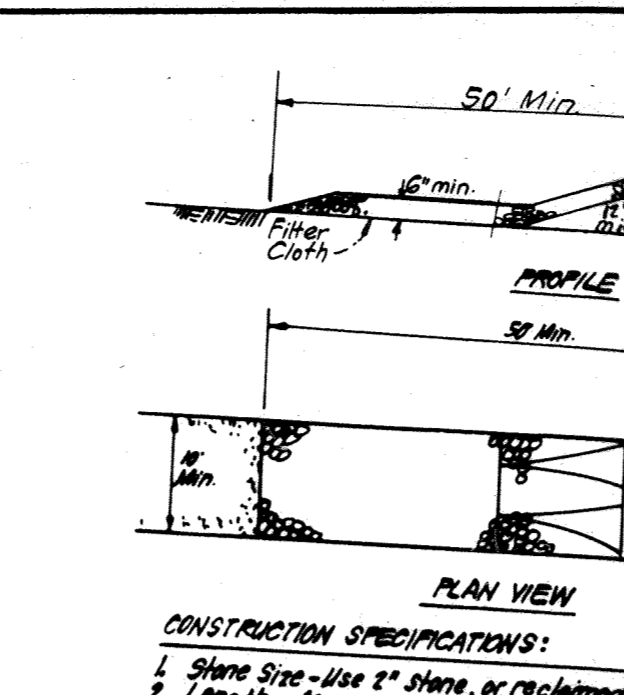
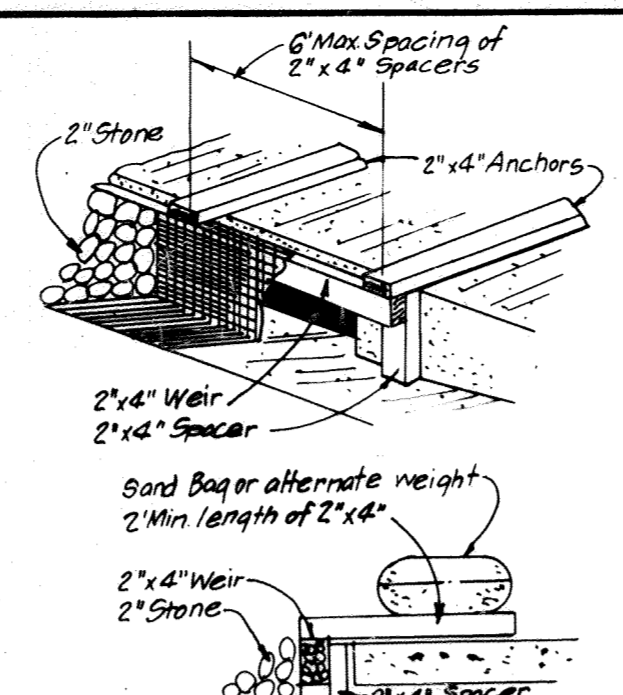
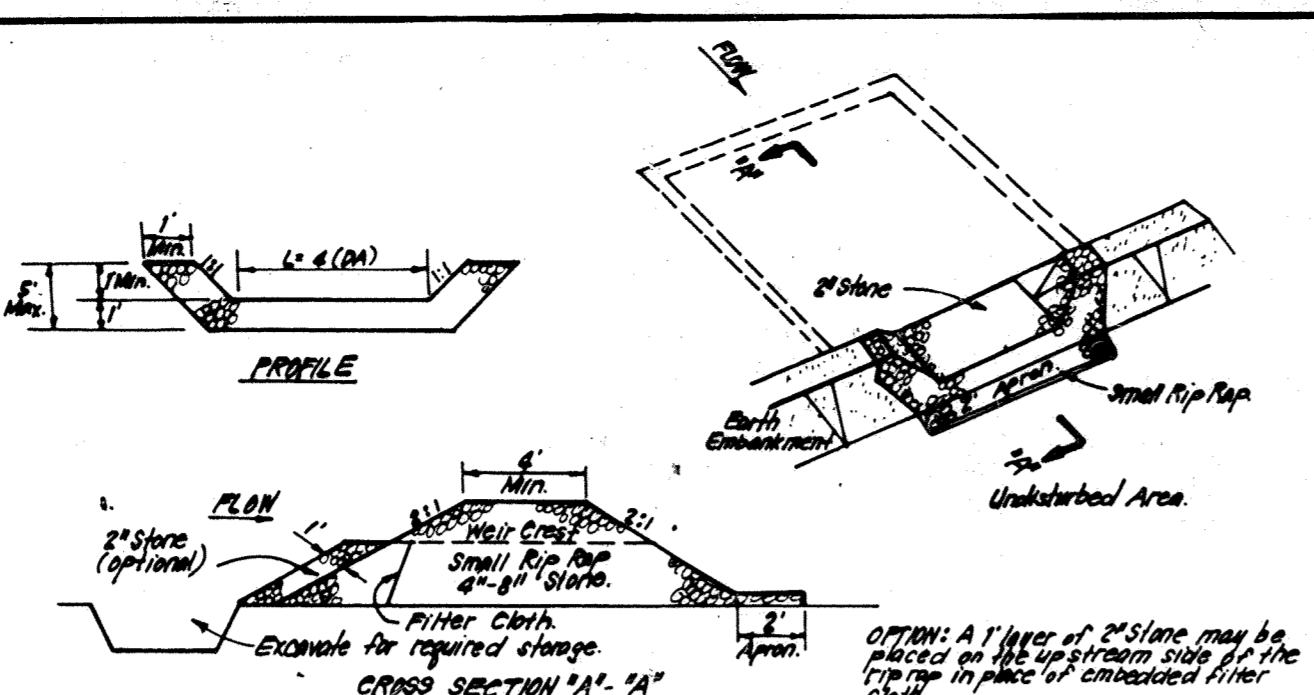
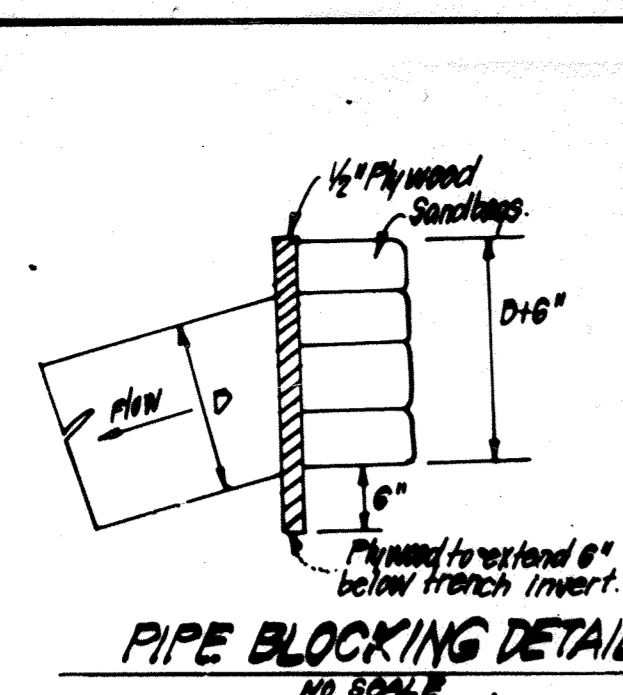
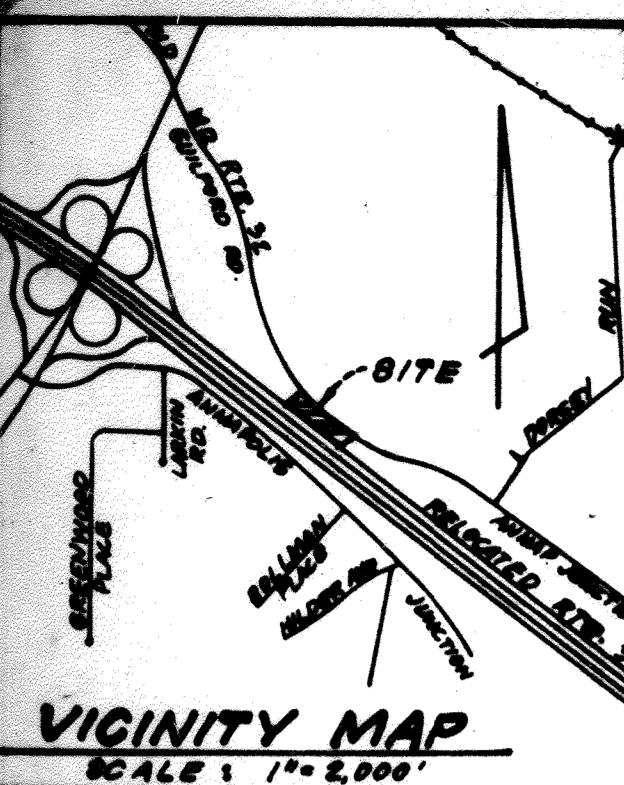

**SEEDING CONTROL NOTES**

- A minimum of 24 hours notice must be given to the Board County Office of Inspection and Permitting prior to the start of any seeding.
- All vegetative and structural practices are to be installed according to the provisions of this plan and are to be in conformance with the 1983 HARTLAND STANDARDS AND SPECIFICATIONS FOR SOIL EROSION AND SEDIMENT CONTROL.
- Following initial soil disturbance or redistribution, permanent or temporary stabilization shall be completed within: a) 7 calendar days for all permanent sediment control structures, dikes, perimeter slopes and all slopes greater than 3:1, b) 14 days as to all other disturbed or graded areas on the project site.
- All sediment traps/basins shall be seeded and warning signs posted around their perimeter in accordance with Vol. 1, Chapter 12, of the HOWARD COUNTY DESIGN MANUAL, Storm Drainage.
- All disturbed areas must be stabilized within the time period specified in accordance with the 1983 HARTLAND STANDARDS AND SPECIFICATIONS FOR SOIL EROSION AND SEDIMENT CONTROL for permanent seedings (Sec. 31) and (Sec. 34), temporary seedings (Sec. 30) and mulching (Sec. 31). Temporary stabilization with mulch alone can only be done when recommended seeding rates do not allow for proper germination and establishment of grasses.
- All sediment control structures are to remain in place and are to be maintained in operative condition until permanent seeding has been obtained from the Howard County Sediment Control Inspector.
- Site Analysis:
  - Total Area of Site: 3,020 Acres
  - Area Disturbed: 2,300 Acres
  - Area to be seeded or paved: 2,024 Acres
  - Area to be vegetatively stabilized: 2,062 Acres
  - Total Cut: 1,750 Cu. Yds
  - Total Fill: 1,800 Cu. Yds
  - Office waste/borrow area location: N/A
- Any sediment control practice which is disturbed by grading activity for placement of utilities must be repaired on the same day of disturbance.
- Additional sediment control must be provided, if deemed necessary by the Board County I&P sediment control inspector.
- On all sites with disturbed areas in excess of 2 acres, approval of the inspection agency shall be required upon completion of installation of perimeter erosion and sediment control, but before proceeding with any other earth disturbance or grading. Other building or grading inspection approvals may not be authorized until this initial approval by the inspection agency is made.
- Approved vegetation can be established for any of the above materials.
- Periodic inspection and required Maintenance must be provided after each rain.

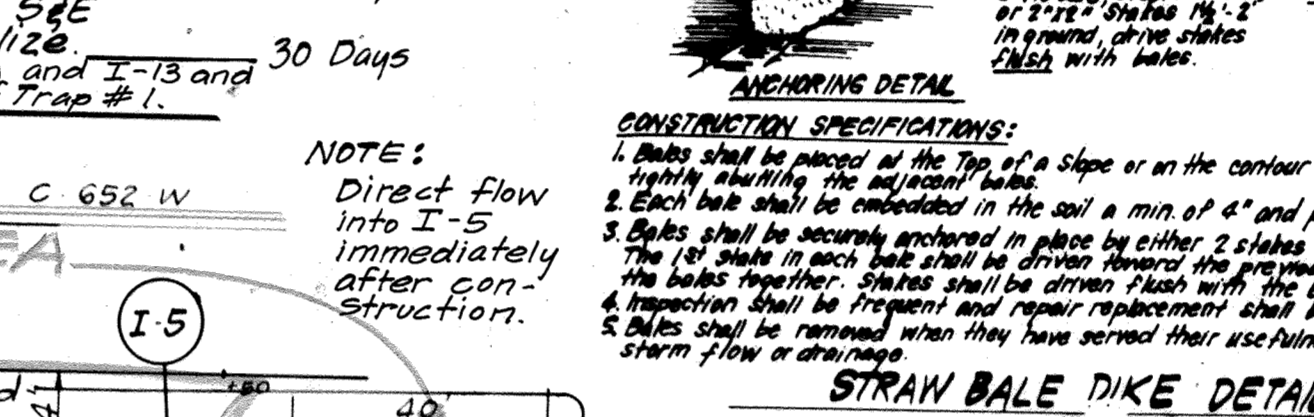
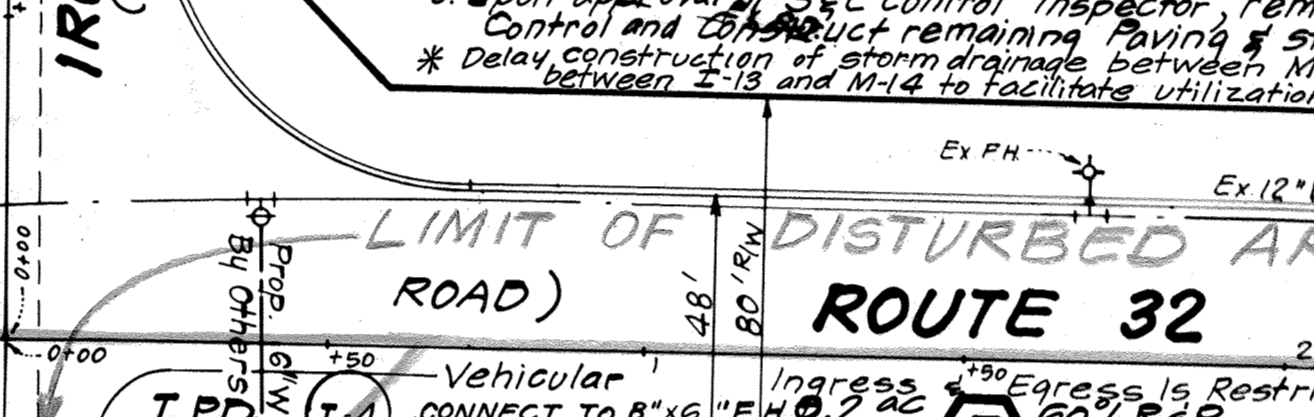
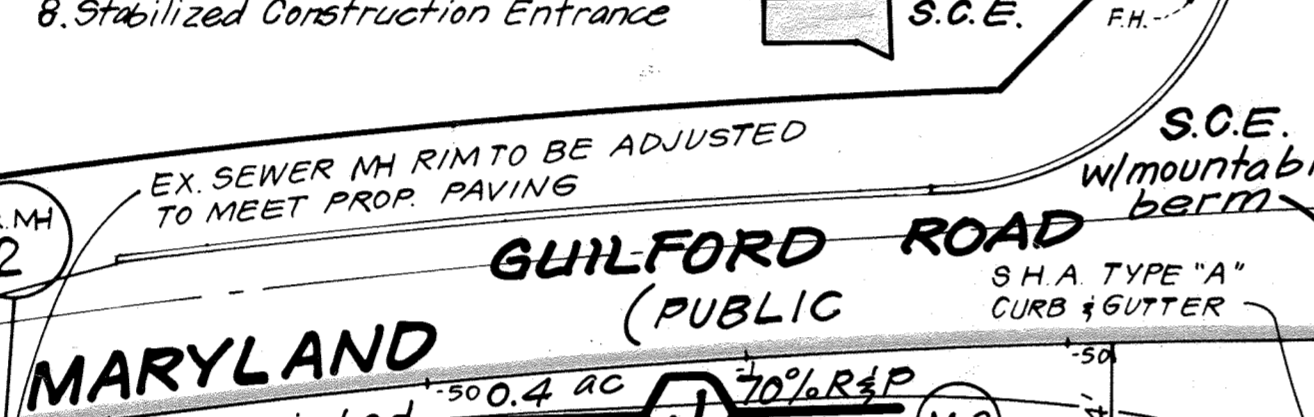
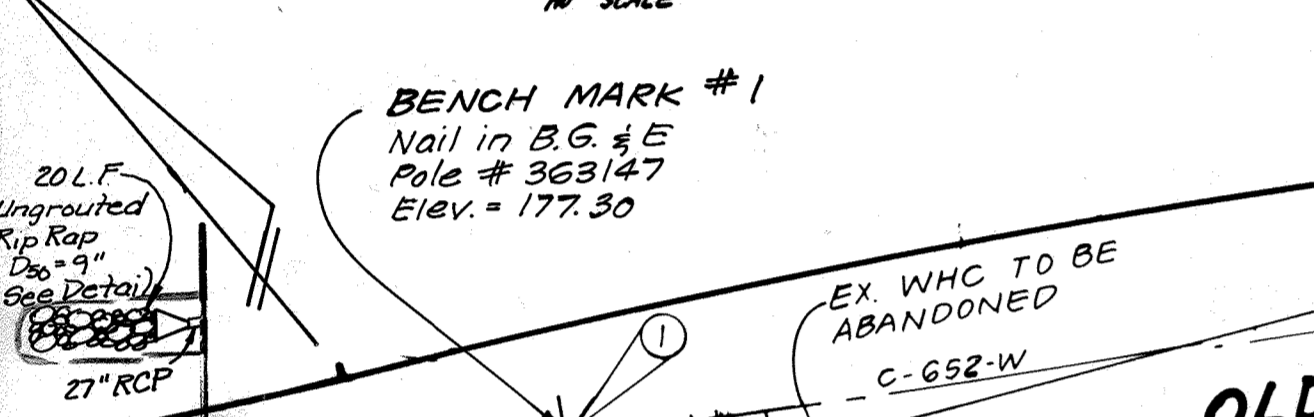

**PERMANENT SEEDING NOTES**

Apply to graded or cleared areas not subject to immediate further disturbance where a permanent long-term vegetative cover is needed.

**Soil Preparation:** Loosen upper three inches of soil by raking, discing or other acceptable means before seeding.

**Soil Amendments:** In lieu of soil test recommendations, use one of the following schedules:

- Preferred - Apply 2 tons per acre dolomitic limestone (92 lb/1000 sq ft) and 600 lbs per acre 10-10-10 fertilizer (14 lb/1000 sq ft) before seeding. Harrow or disc into upper three inches of soil at time of seeding, apply 400 lbs per acre 30-0-0 ureaform fertilizer (9 lb/1000 sq ft).
- Acceptable - Apply 2 tons per acre dolomitic limestone (92 lb/1000 sq ft) and 1000 lbs per acre 10-10-10 fertilizer (21 lb/1000 sq ft) before seeding. Harrow or disc into upper three inches of soil.

**Seeding -** For the periods March 1 thru April 30, and August 1 thru October 15, seed with 60 lbs per acre (1.4 lb/1000 sq ft) of Kentucky 31 Tall Fescue. For the period May 1 thru July 31, seed with 31 Tall Fescue per acre and 2 lbs per acre (.05 lb/1000 sq ft) of weeping lovegrass. During the period of October 16 thru February 28, protect site by: Option (1) 2 tons per acre of well anchored straw mulch and seed as soon as possible in the spring. Option (2) Use sod. Option (3) Seed with 60 lbs/acre Kentucky 31 Tall Fescue and mulch with 2 tons/acre well anchored straw.

**Mulching -** Apply 1 1/2 to 2 tons per acre (10 to 20 lb/1000 sq ft) of unrotted small grain straw immediately after seeding. Anchor mulch immediately after application using mulch anchoring tool or 218 gallons per acre (5 gal/1000 sq ft) of emulsified asphalt on flat areas. On slopes 8 feet or higher, use 348 gallons per acre (8 gal/1000 sq ft) for anchoring.

**Maintenance -** Inspect all seeded areas and make needed repairs, replacements and reseedings.

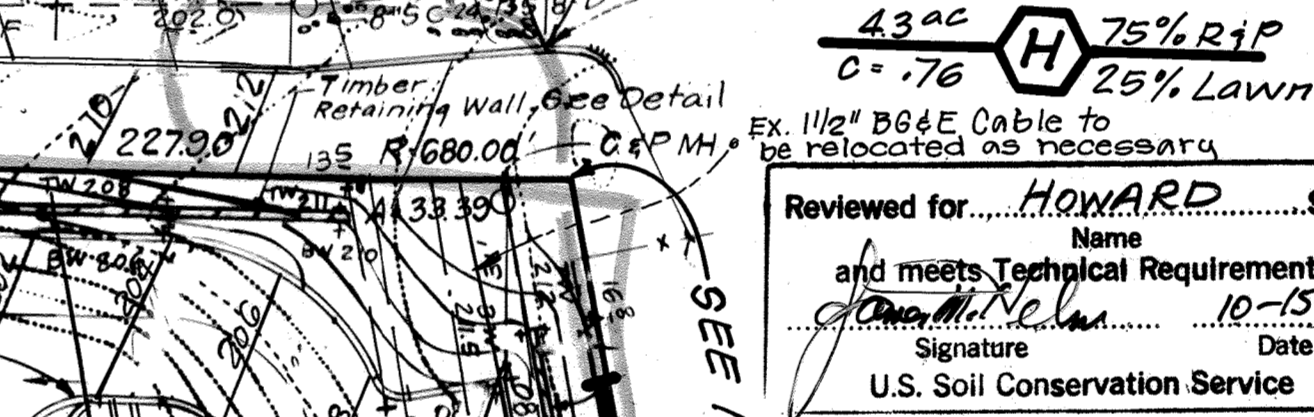
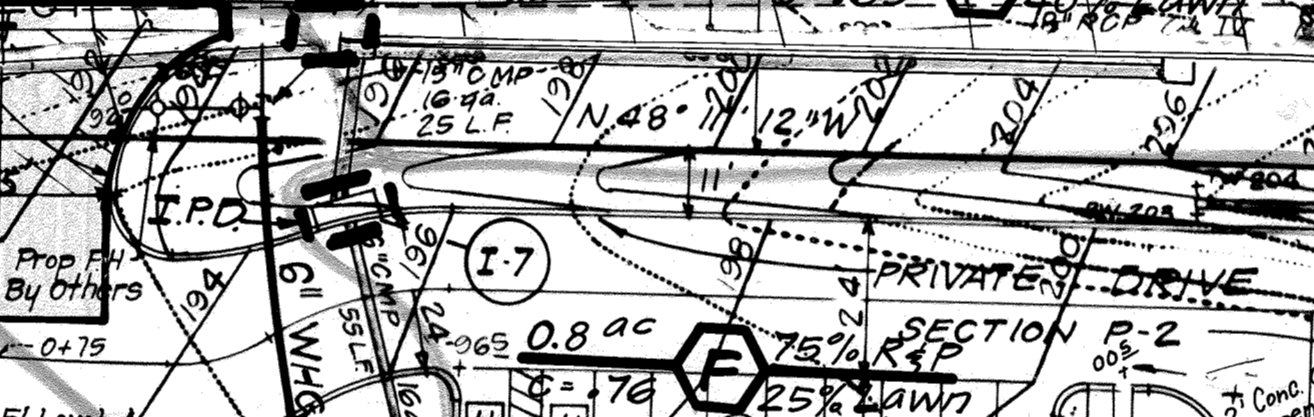
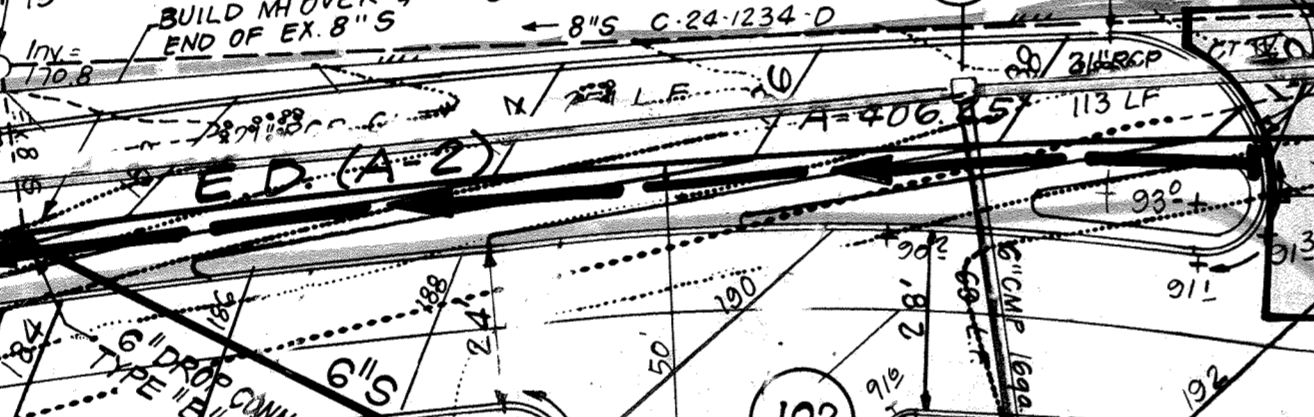
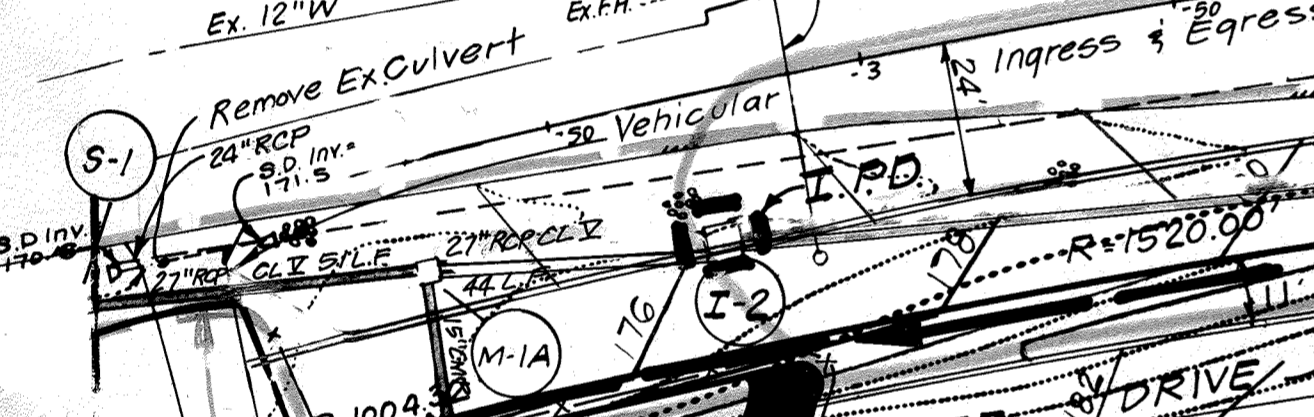

**APPROVED FOR PUBLIC WATER AND PUBLIC BEVERAGE SYSTEMS**  
HOWARD COUNTY HEALTH DEPARTMENT  
10-26-87

**APPROVED FOR HOWARD COUNTY OFFICE OF PLANNING & ZONING**  
11-3-87

**APPROVED FOR PUBLIC WATER AND PUBLIC BEVERAGE SYSTEMS, STORM DRAINAGE SYSTEMS AND PUBLIC ROADS**  
HOWARD COUNTY DEPARTMENT OF PUBLIC WORKS  
9-30-87

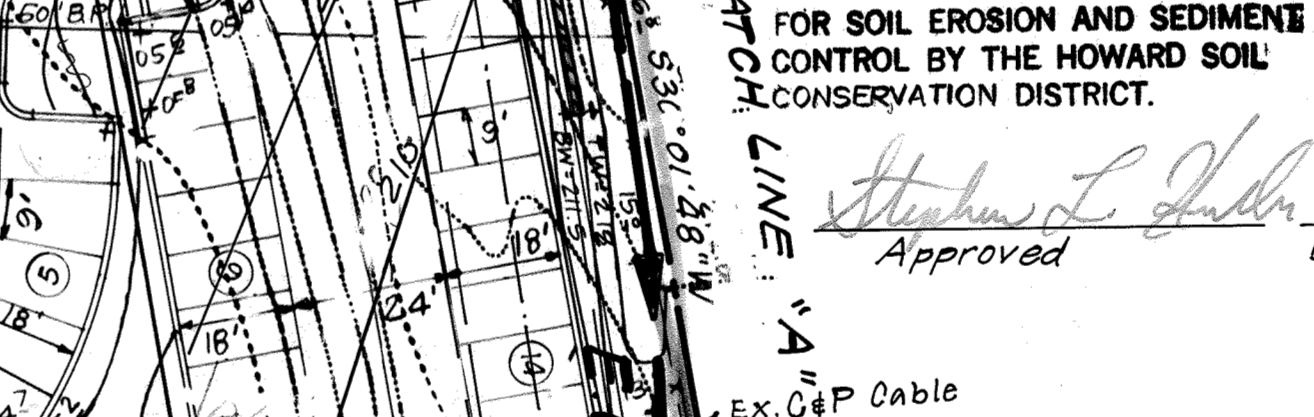
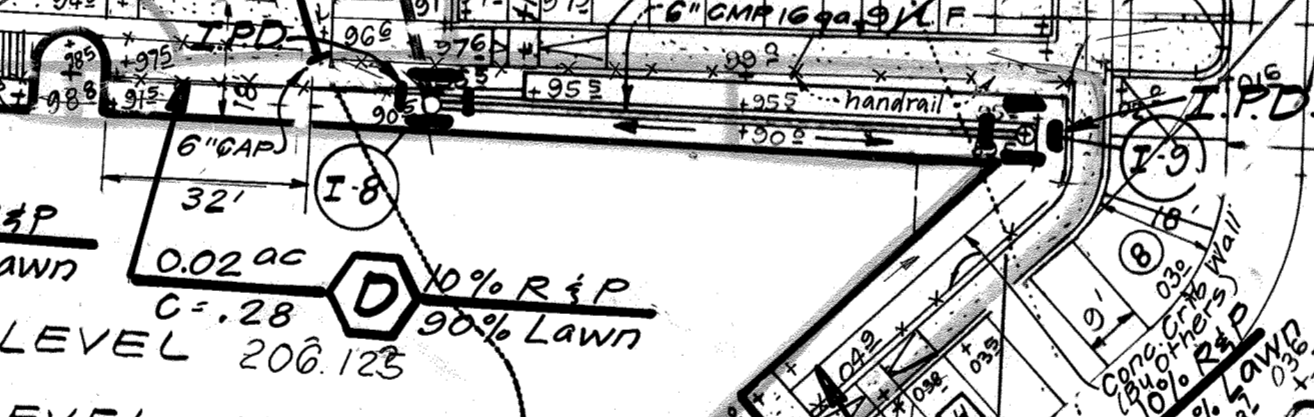
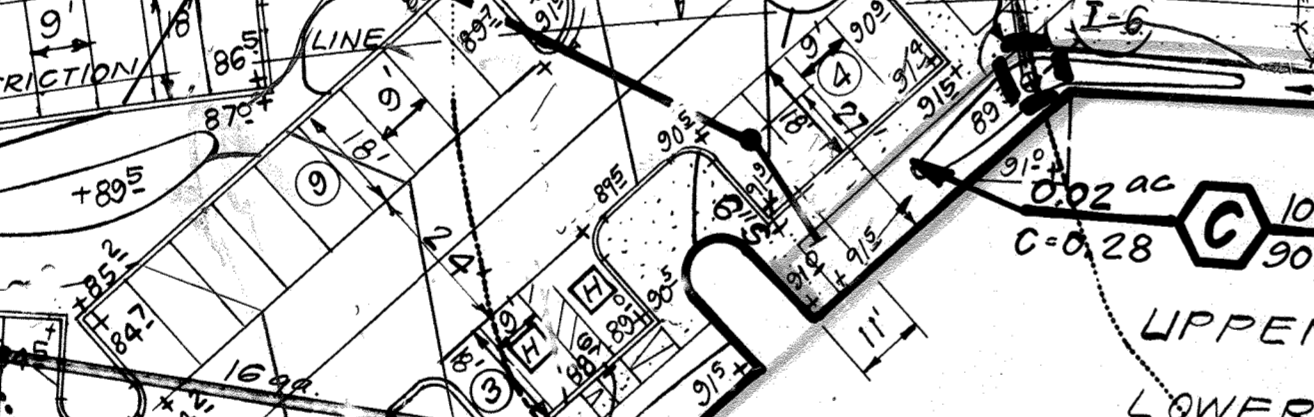
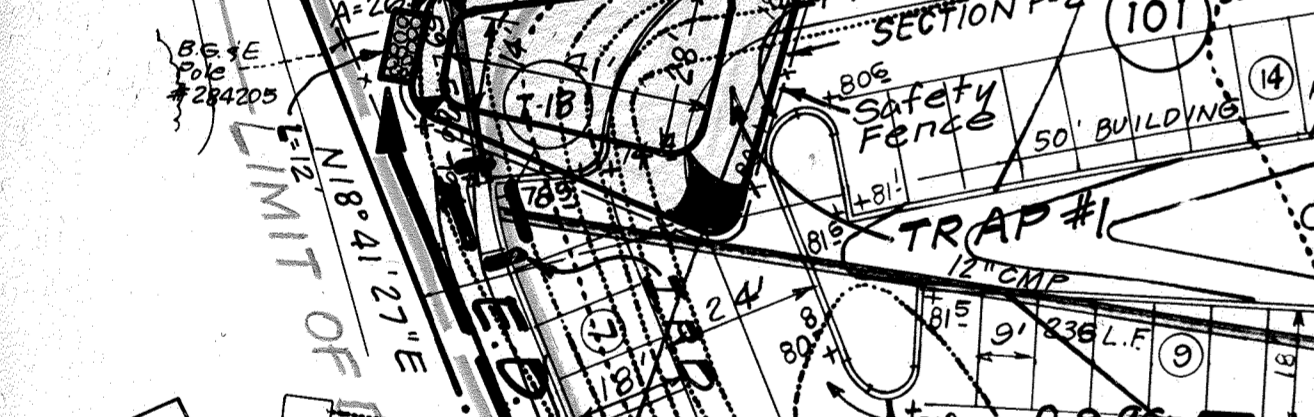

**APPROVED FOR PUBLIC WATER AND PUBLIC BEVERAGE SYSTEMS**  
HOWARD COUNTY HEALTH DEPARTMENT  
10-26-87

**APPROVED FOR HOWARD COUNTY OFFICE OF PLANNING & ZONING**  
11-3-87

**APPROVED FOR PUBLIC WATER AND PUBLIC BEVERAGE SYSTEMS, STORM DRAINAGE SYSTEMS AND PUBLIC ROADS**  
HOWARD COUNTY DEPARTMENT OF PUBLIC WORKS  
9-30-87

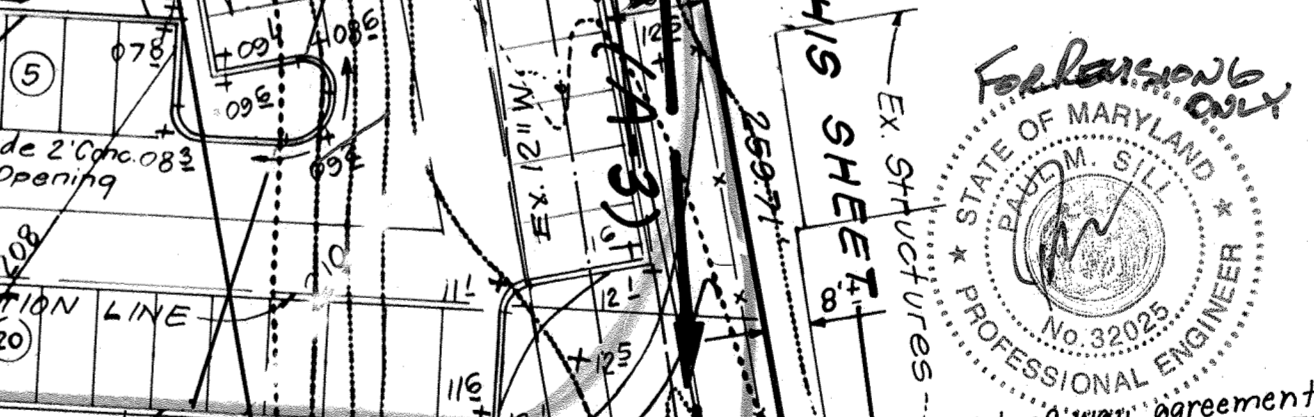
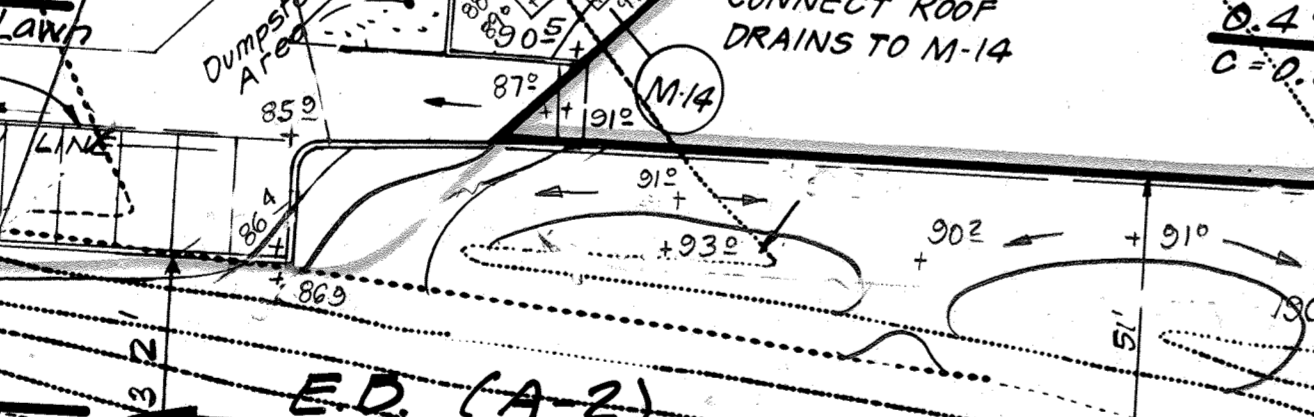
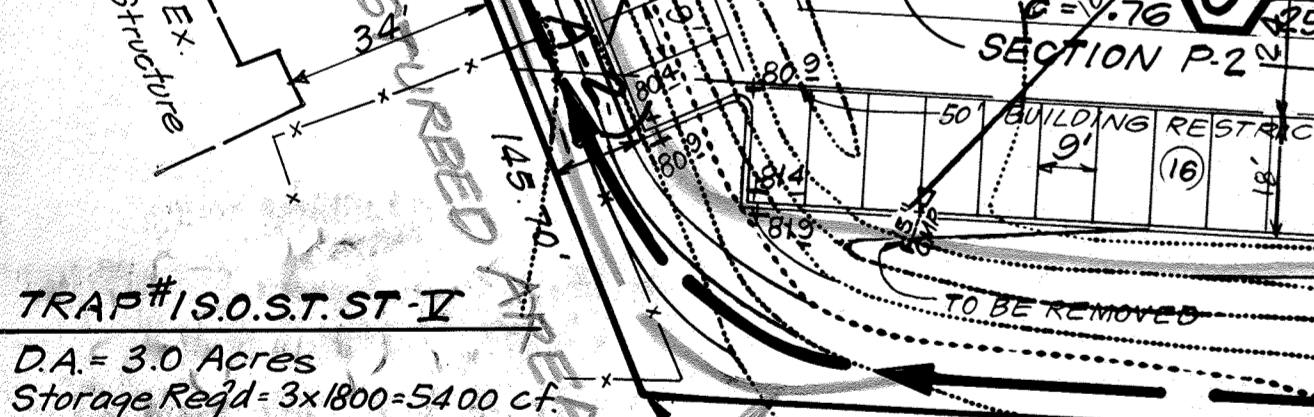

**APPROVED FOR PUBLIC WATER AND PUBLIC BEVERAGE SYSTEMS**  
HOWARD COUNTY HEALTH DEPARTMENT  
10-26-87

**APPROVED FOR HOWARD COUNTY OFFICE OF PLANNING & ZONING**  
11-3-87

**APPROVED FOR PUBLIC WATER AND PUBLIC BEVERAGE SYSTEMS, STORM DRAINAGE SYSTEMS AND PUBLIC ROADS**  
HOWARD COUNTY DEPARTMENT OF PUBLIC WORKS  
9-30-87

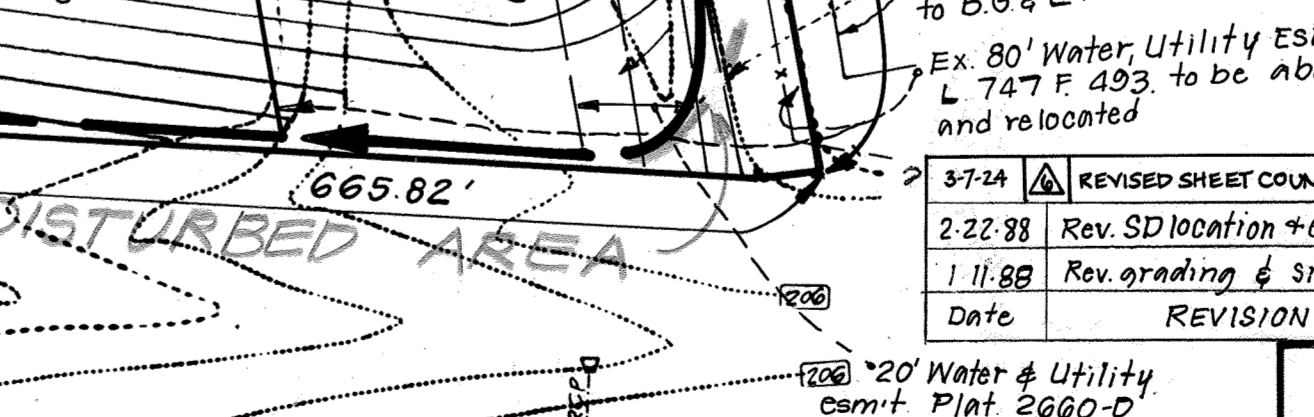
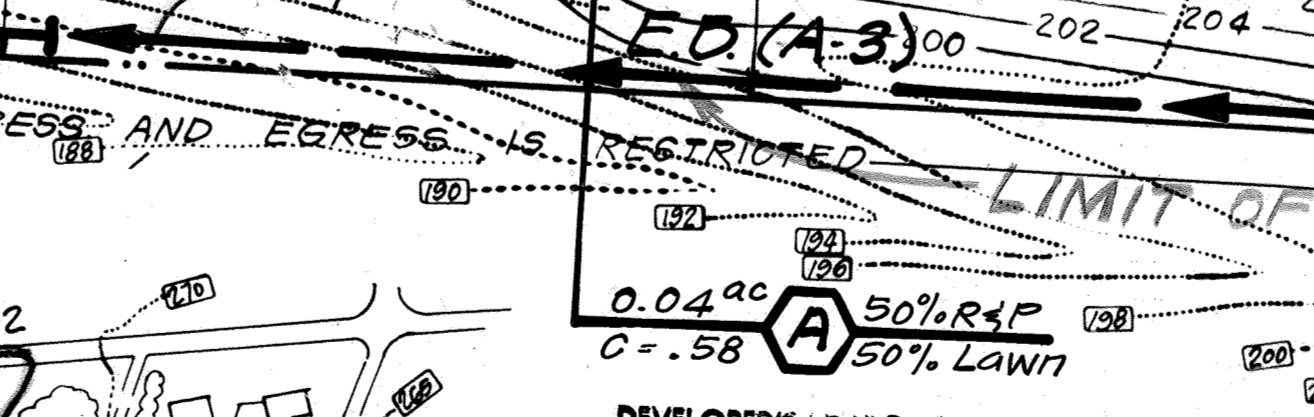
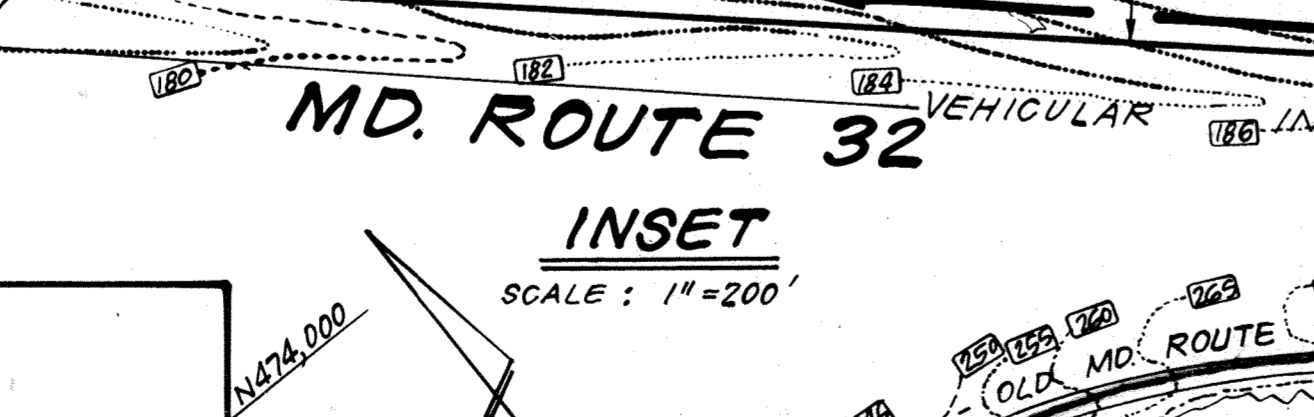
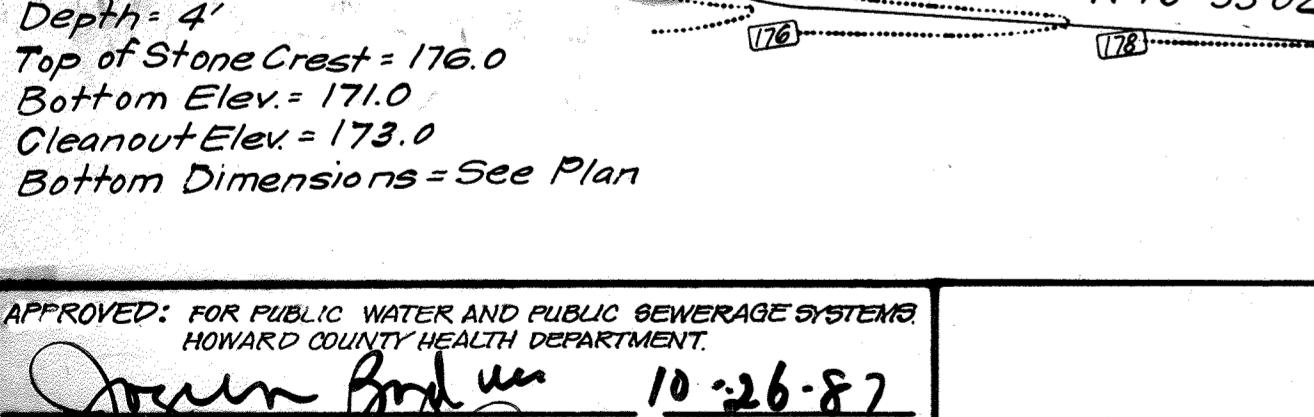

**APPROVED FOR PUBLIC WATER AND PUBLIC BEVERAGE SYSTEMS**  
HOWARD COUNTY HEALTH DEPARTMENT  
10-26-87

**APPROVED FOR HOWARD COUNTY OFFICE OF PLANNING & ZONING**  
11-3-87

**APPROVED FOR PUBLIC WATER AND PUBLIC BEVERAGE SYSTEMS, STORM DRAINAGE SYSTEMS AND PUBLIC ROADS**  
HOWARD COUNTY DEPARTMENT OF PUBLIC WORKS  
9-30-87

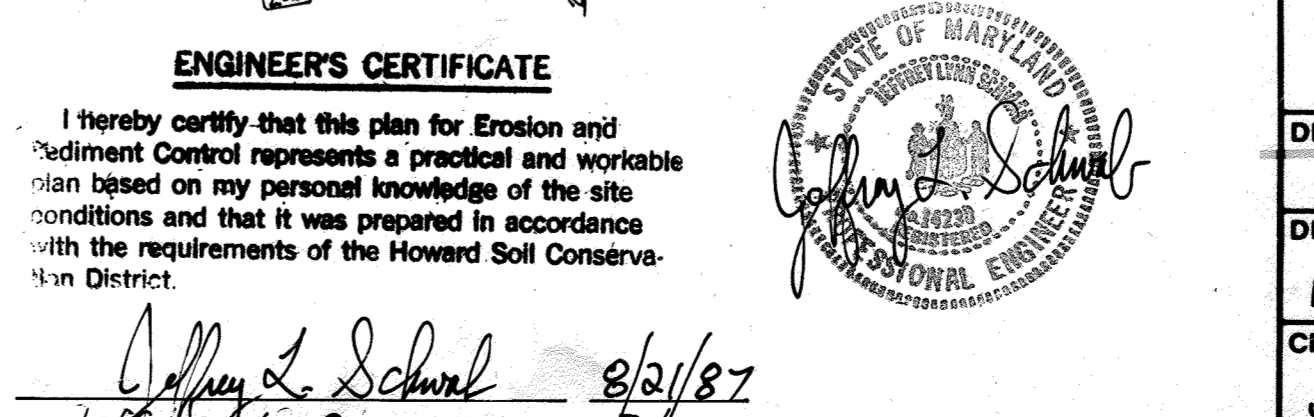
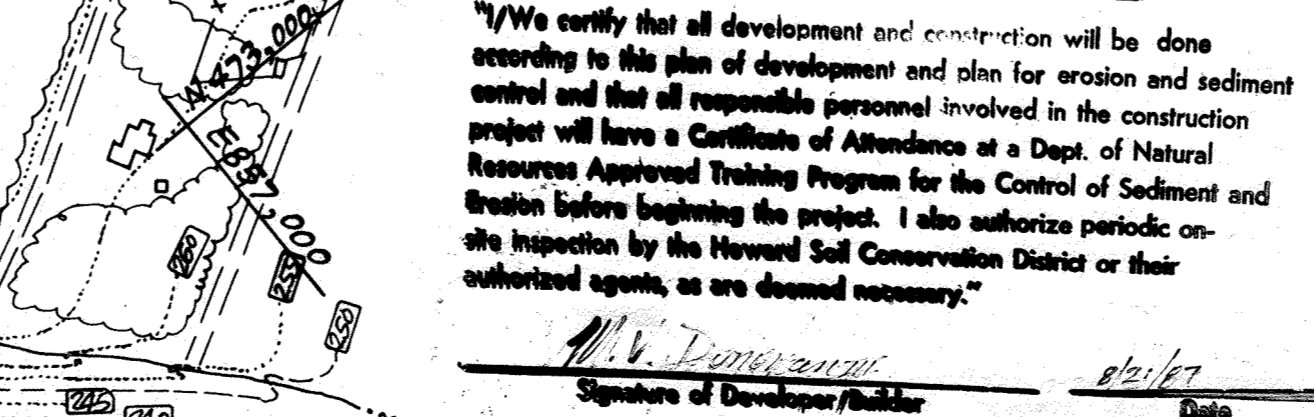
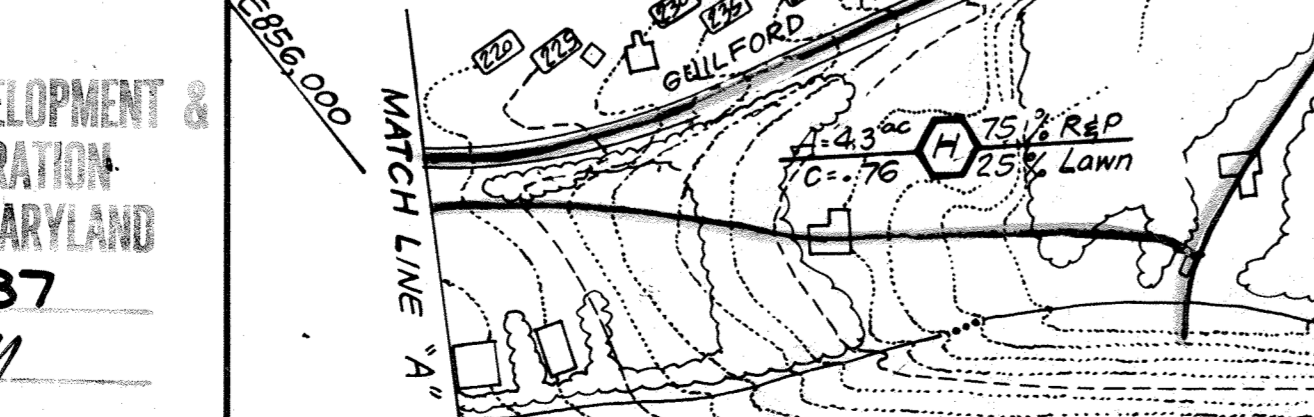
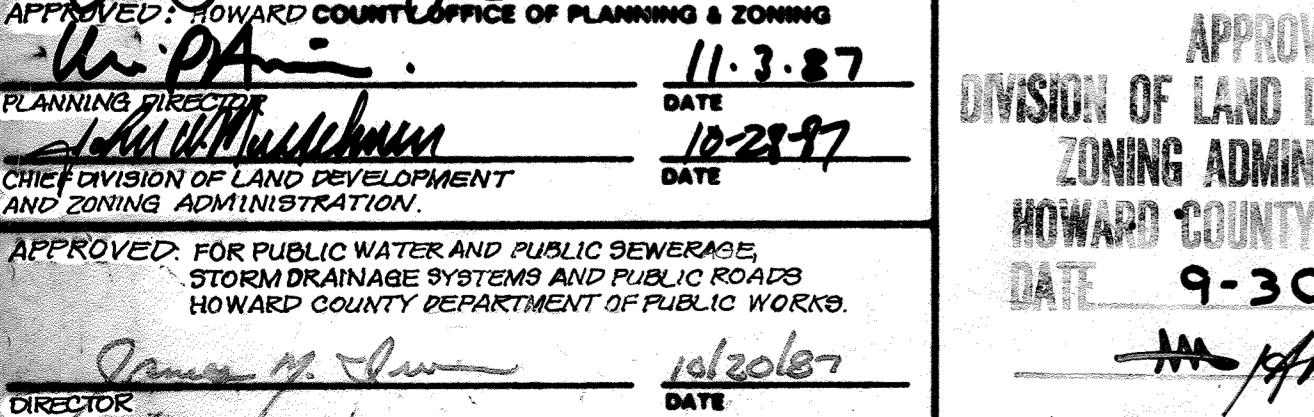

**APPROVED FOR PUBLIC WATER AND PUBLIC BEVERAGE SYSTEMS**  
HOWARD COUNTY HEALTH DEPARTMENT  
10-26-87

**APPROVED FOR HOWARD COUNTY OFFICE OF PLANNING & ZONING**  
11-3-87

**APPROVED FOR PUBLIC WATER AND PUBLIC BEVERAGE SYSTEMS, STORM DRAINAGE SYSTEMS AND PUBLIC ROADS**  
HOWARD COUNTY DEPARTMENT OF PUBLIC WORKS  
9-30-87

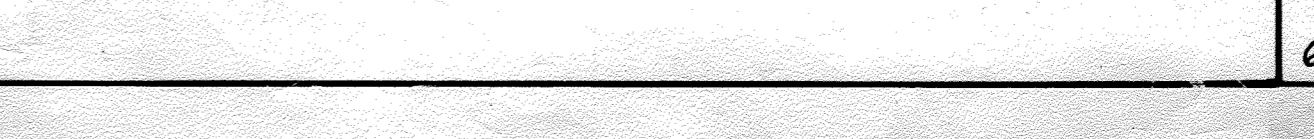
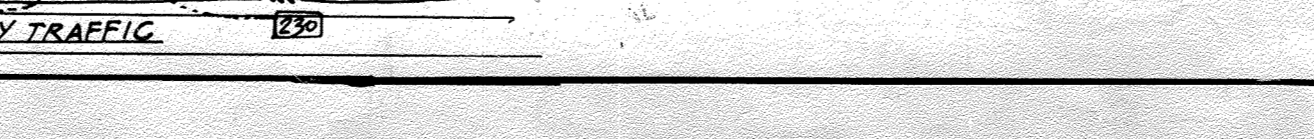
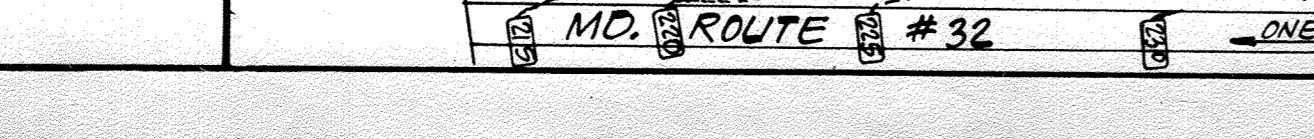
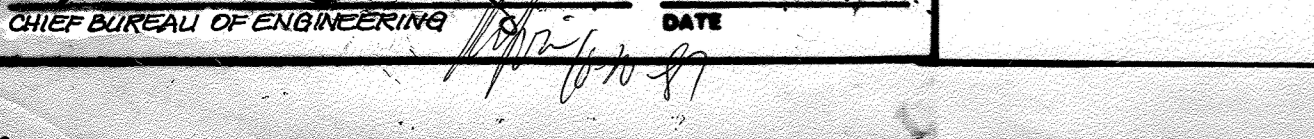

**APPROVED FOR PUBLIC WATER AND PUBLIC BEVERAGE SYSTEMS**  
HOWARD COUNTY HEALTH DEPARTMENT  
10-26-87

**APPROVED FOR HOWARD COUNTY OFFICE OF PLANNING & ZONING**  
11-3-87

**APPROVED FOR PUBLIC WATER AND PUBLIC BEVERAGE SYSTEMS, STORM DRAINAGE SYSTEMS AND PUBLIC ROADS**  
HOWARD COUNTY DEPARTMENT OF PUBLIC WORKS  
9-30-87

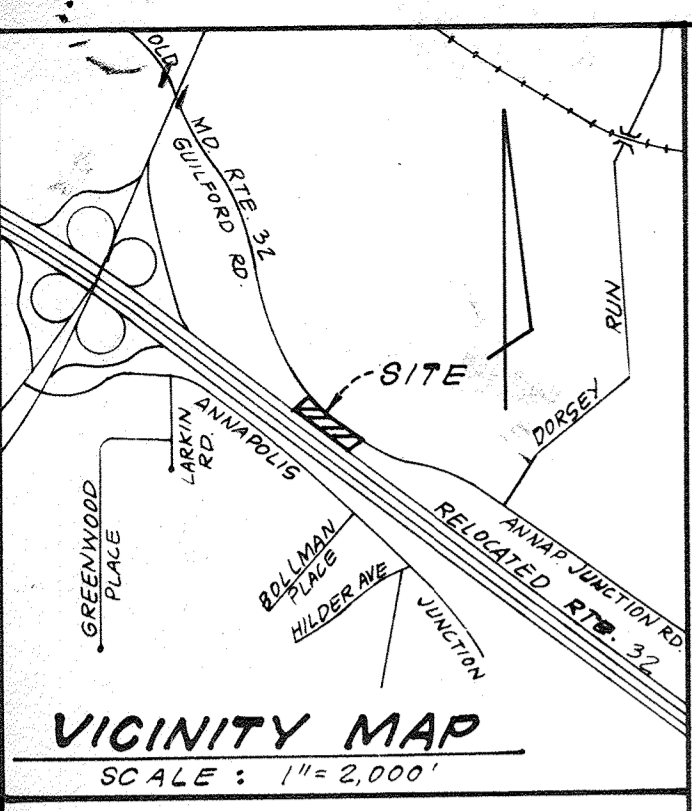

CORRIDOR NORTH  
PARCEL B  
PLAT 6326  
ZONED M-2

CORRIDOR NORTH  
PARCEL C  
PLATS 6326 & 6327  
ZONED M-2

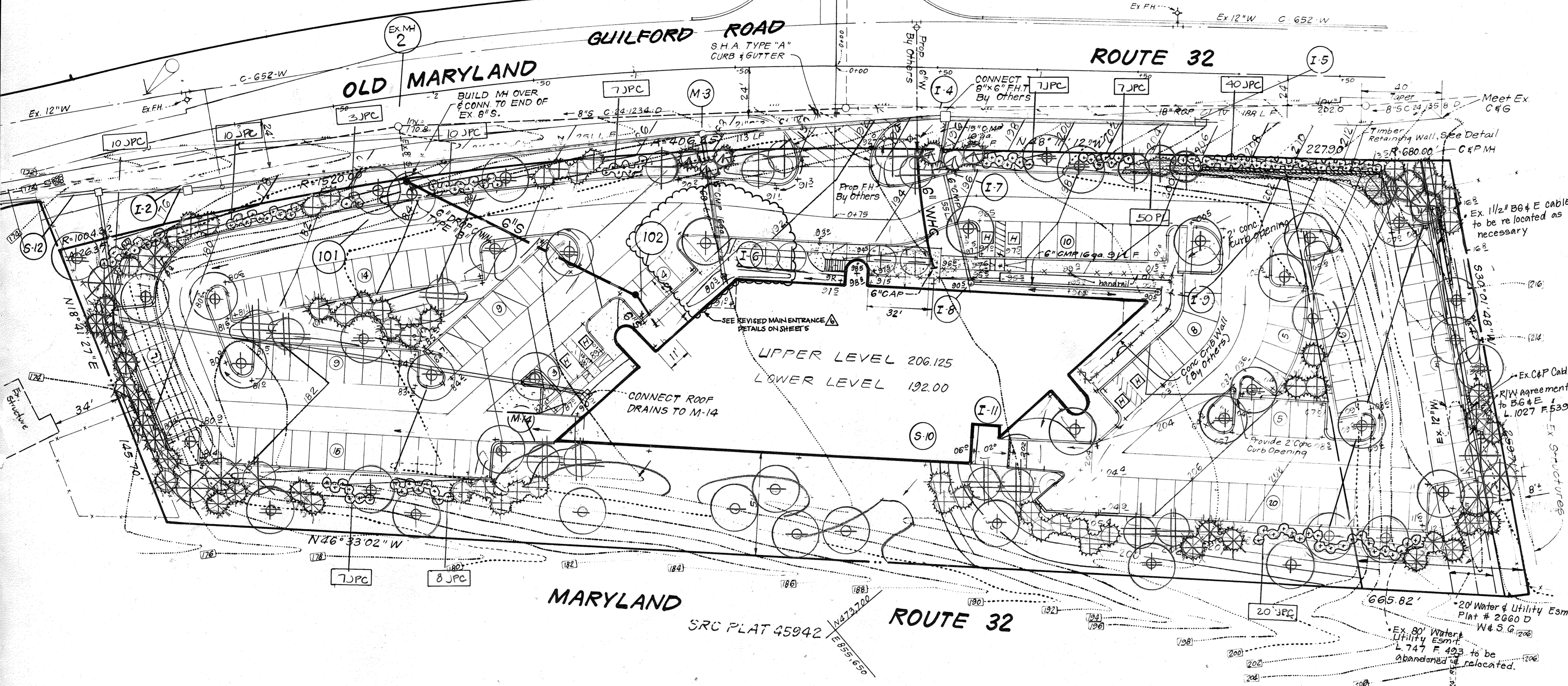
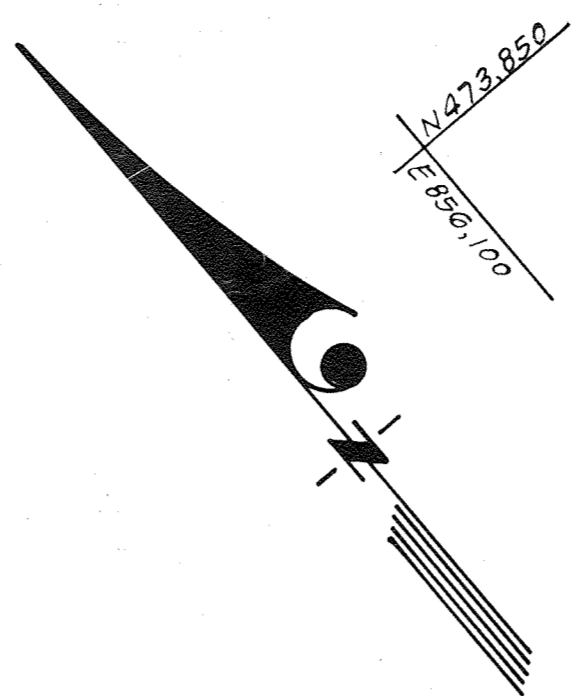

**PLANT SCHEDULE**

KEY	PLANT NAME	SIZE	QUANT	REMARKS
⊕	ACEP RUBRUM 'RED SUNSET'	2 1/2-3' CAL	21	B & B
⊕	RED SUNSET MAPLE	8-10 HT.		HEAVY HEADS
⊕	ACEP SACC. 'GREEN MOUNTAIN'		18	
⊕	GREEN MOUNTAIN SUGAR MAPLE			
⊕	QUERCUS PALUSTRIS		5	
⊕	PIN OAK			
⊕	PRUNUS SEPP. 'KWANZA'	2-2 1/2' CAL	12	
⊕	KWANZAN CHERRY	8-10' HT.		
⊕	ACEP GINNALA		9	
⊕	AMUR MAPLE			
⊕	CRATAEGUS PHAENOPYRUM		11	
⊕	WASHINGTON HAWTHORN			
⊕	PINUS STROBUS	6-8' HT.	25	B & B HEAVY
⊕	EASTERN WHITE PINE			
⊕	PINUS THUNBERGII		39	
⊕	JAPANESE BLACK PINE			
⊕	PINUS NIGRA		6	
⊕	AUSTRIAN PINE			
⊕	JUNIPERUS C. PFITZEBIANA COMPACTA	24-30" SP.	129	B & B HEAVY ± 4' O.C.
⊕	COMPACT PFITZER JUNIPER			
⊕	PYRACANTHA COCCINEA 'LOWBOY'	18-24" SP.	50	B & B HEAVY ± 3' O.C.
⊕	LOWBOY PYRACANTHA			

**NOTE:**

- CONTRACTOR SHALL VERIFY LOCATION OF UNDERGROUND UTILITIES PRIOR TO DIGGING.
- ALL PLANTING SHALL BE DONE IN ACCORDANCE WITH COLUMBIA H.P.D. PLANTING SPECIFICATIONS.
- SUBSTITUTIONS MAY BE PERMITTED WITH THE APPROVAL OF THE LANDSCAPE ARCHITECT, (621-8100).

8-31-87 REVISED AS PER COUNTY COMMENTS (COMPELABLE ELEMENTS).  
7-9-87 REVISED TO MEET H.P.D. STANDARDS.

APPROVED  
DIVISION OF LAND DEVELOPMENT &  
ZONING ADMINISTRATION  
HOWARD COUNTY, MARYLAND  
DATE 9-30-87

APPROVED: FOR PUBLIC WATER AND PUBLIC SEWERAGE SYSTEMS.  
HOWARD COUNTY HEALTH DEPARTMENT  
DATE 11-26-87

APPROVED: HOWARD COUNTY OFFICE OF PLANNING & ZONING  
DATE 11-3-87

APPROVED: FOR PUBLIC WATER AND PUBLIC SEWERAGE,  
STORM DRAINAGE SYSTEMS AND PUBLIC ROADS  
HOWARD COUNTY DEPARTMENT OF PUBLIC WORKS  
DATE 10-28-87

APPROVED: FOR PUBLIC WATER AND PUBLIC SEWERAGE,  
STORM DRAINAGE SYSTEMS AND PUBLIC ROADS  
HOWARD COUNTY DEPARTMENT OF PUBLIC WORKS  
DATE 10-20-87

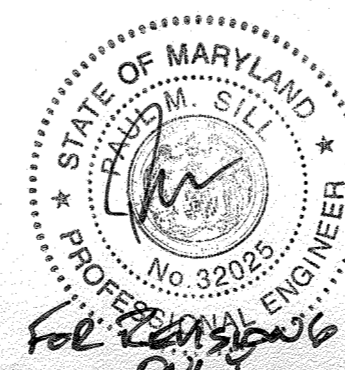

Date	REVISION
3-7-88	REVISED SHEET COUNT AND PLAN VIEW TO SHOW MAIN ENTRANCE REVISION LOCATION
2-22-88	Rev. grading, added comm'ts. Revised storm drainage.
1-11-87	Rev. grading, change sidewalk front of blk



**CLARK • FINEFROCK & SACKETT**  
ENGINEERS • PLANNERS • SURVEYORS  
11315 LOCKWOOD DRIVE SILVER SPRING, MARYLAND 20904 (301) 593-3400

**LANDSCAPE PLANTING PLAN**  
PARCEL "A"  
CORRIDOR NORTH  
6<sup>th</sup> ELECTION DISTRICT  
HOWARD COUNTY, MARYLAND  
POP: BRITAM  
9030 RED BRANCH ROAD SUITE 250  
COLUMBIA, MD 21045

DESIGNED: KBN  
DRAWN: KBN  
CHECKED: WHT  
DATE: 6-2-87

SCALE: 1" = 30'  
DRAWING: 40F5  
JOB NO.: 87-037  
FILE NO.: 87-037-15

