

**TEMPORARY SEEDING NOTES**

A. **SEEDBED PREPARATION** - Loosen upper 3 inches of soil by disking, raking, or other acceptable means.

B. **SOIL AMENDMENTS** - Apply 600 lbs. (15 lbs./1000 sq.ft.) of 10-20-10 fertilizer.

C. **SEEDING** - For the periods March 1 thru April 30, and from August 15 thru November 15, seed with 2 1/2 bushels per acre (3.2 pounds/1000 sq.ft. of annual ryegrass). For the period May 1 thru August 14 seed with 3 pounds per acre (0.07 lbs./1000 sq.ft.) with Weeping Lovegrass.

D. **MULCHING** - Apply 1.5 to 2 tons per acre (70 to 90 pounds per 1000 sq.ft.) of unrotted small grain straw immediately after seeding. Anchor mulch immediately after application using 200 gallons per acre (5 gallons per 1000 sq.ft.) of emulsified asphalt on flat areas. On slopes 8 feet or higher use 348 gallons per acre (8 gallons per 1000 sq.ft.).

**PERMANENT SEEDING NOTES**

A. **SEEDBED PREPARATION** - Loosen upper 3 inches of soil by raking, disking or other acceptable means before seeding.

B. **SOIL AMENDMENTS** - Apply 2 tons per acre dolomitic limestone (92 lbs./1000 sq.ft.) and 600 lbs per acre (20.0 lbs./1000 sq. ft.) fertilizer. Harrow or disc line and fertilize into upper three inches of soil. At time of seeding, apply 400 lbs. per acre (99.2 lbs./1000 sq.ft.) of 38-0-0 ureaform fertilizer and 500 lbs. per acre (11.5 lbs./1000 sq.ft.) of 10-20-20 fertilizer.

C. **SEEDING** - For the periods March 1 thru April 30, and August 1 thru October 15, seed with 60 lbs. per acre (1.4 lbs./1000 sq.ft.) of Kentucky 31 Tall Fescue. For the period May 1 thru July 31, seed with 60 lbs. Kentucky 31 Tall Fescue per acre and 2 lbs. per acre (.05 lbs./1000 sq.ft.) of weeping lovegrass. During the period of October 16 thru February 28, protect site by: Option (1) - 2 tons per acre of well anchored straw mulch and seed as soon as possible in the spring. Option (2) - Use sod. Option (3) - seed with 60 lbs./acre Kentucky 31 Tall Fescue and mulch with 2 tons/acre well anchored straw.

D. **MULCHING** - Apply 1-1/2 to 2 tons per acre (70 to 90 lbs./1000 sq.ft.) of unrotted small grain straw immediately after seeding. Anchor mulch immediately after seeding. Anchor mulch immediately after application using 200 gallons per acre (5 gallons/1000 sq.ft.) of emulsified asphalt on flat areas. On slopes 8 feet or higher, use 348 gallons per acre (8 gallons/1000 sq.ft.) for anchoring.

E. **MAINTENANCE** - Inspect all seeded areas and make needed repairs, replacements, and reseedings.

- GENERAL NOTES**
- THE LAND INCLUDED IS ZONED R-20
  - COORDINATES SHOWN ARE EXTENSIONS MADE FROM THE MARYLAND STATE PLANE COORDINATE SYSTEM. BEARINGS REFER TO THE TRUE NORTH AND ARE BASED ON HOWARD COUNTY GEODETIC SURVEY.
  - THE AREA COVERED IN THIS SUBMISSION IS LOCATED ON TAX MAP 17
  - THE TOTAL AREA ON THIS PLAN IS 270,000 SQ. FT. (6.2 A.)
  - ALL ROADS ARE PUBLIC AND EXISTING.
  - ANY DAMAGE TO COUNTY OWNED RIGHT-OF-WAYS SHALL BE CORRECTED AT THE DEVELOPER'S EXPENSE.
  - TOTAL NUMBER OF LOTS IN THIS SUBMISSION ARE 16
  - STREET TREES WILL BE PROVIDED IN ACCORDANCE WITH SECTION 16.131 OF THE HOWARD COUNTY SUBDIVISION REGULATIONS BY THE DEVELOPER.

**"ADDRESS CHART"**

LOT NUMBER	STREET ADDRESS
83	10380 BOCA RATON DRIVE
84	10376 " " " "
85	10372 " " " "
86	10368 " " " "
87	10367 PINEHURST COURT
88	10311 " " " "
89	10315 " " " "
90	10310 " " " "
91	10323 " " " "
92	10334 " " " "
94	10330 " " " "
95	10326 " " " "
96	10322 " " " "
97	10318 " " " "
98	10314 " " " "
99	" OPEN SPACE "
100	10306 PINEHURST COURT
101	10302 " " " "
102	10346 BOCA RATON DRIVE

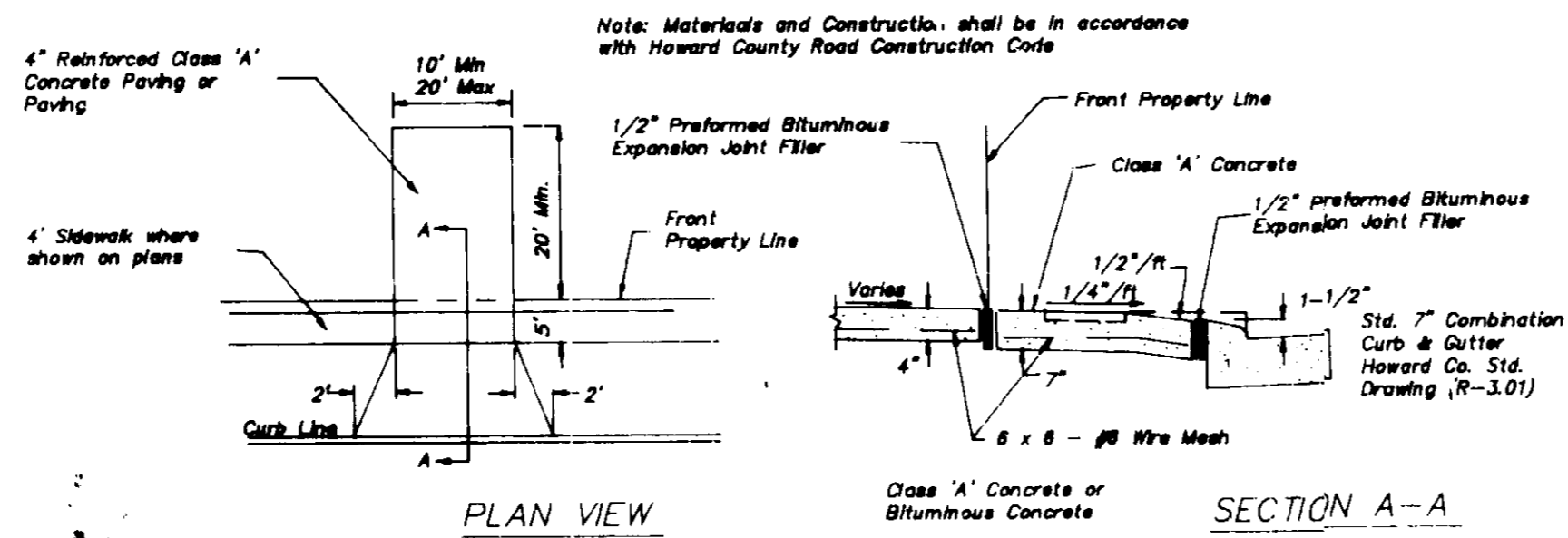
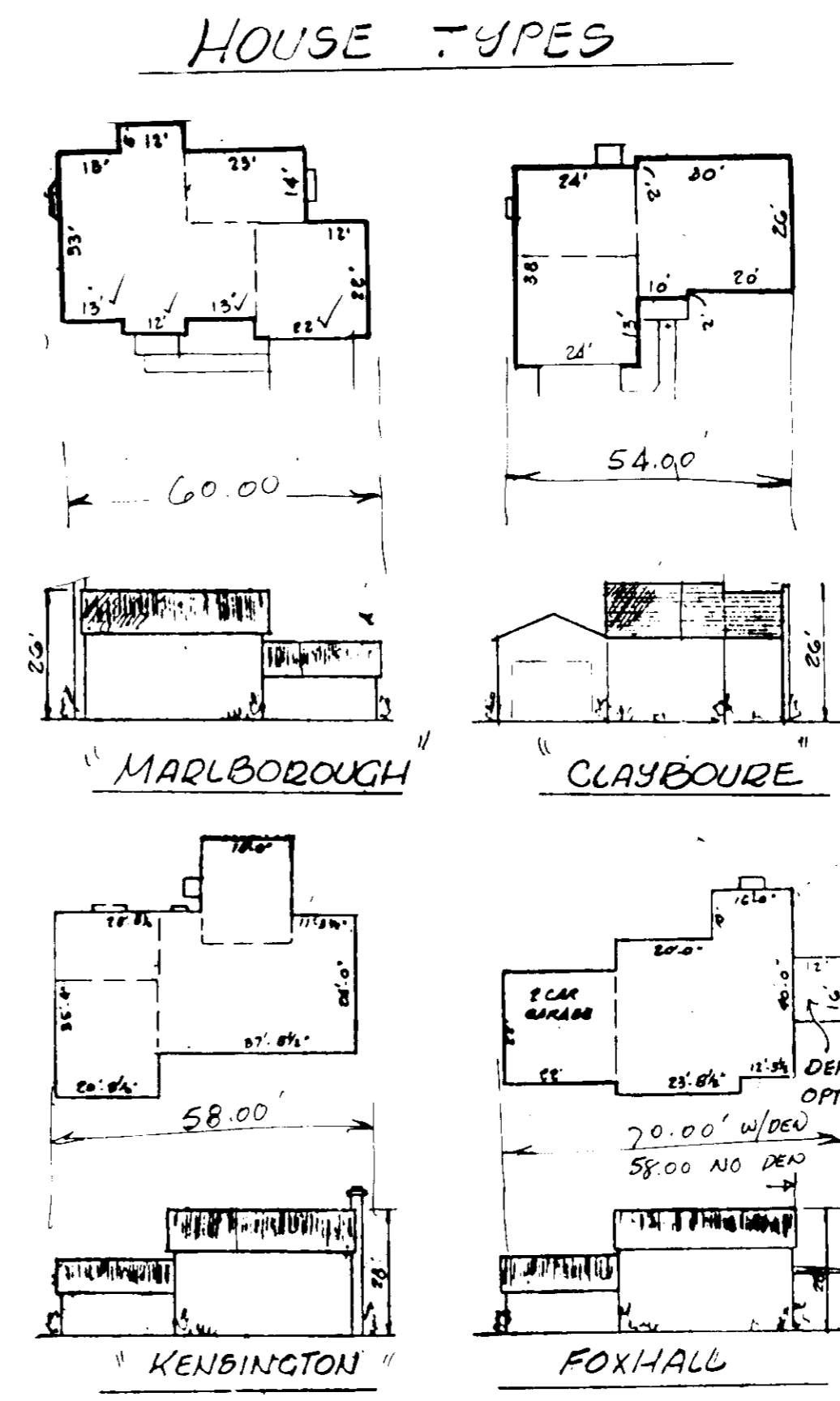

**APPROVED**  
**DIVISION OF LAND DEVELOPMENT & ZONING ADMINISTRATION**  
**HOWARD COUNTY, MARYLAND**  
DATE **7-16-87**

REVIEWED FOR HOWARD SCD AND MEETS TECHNICAL REQUIREMENTS  
DATE **7-31-87**  
SIGNATURE **[Signature]**  
U.S. SOIL CONSERVATION SERVICE

THIS DEVELOPMENT PLAN IS APPROVED FOR SOIL EROSION AND SEDIMENT CONTROL BY THE HOWARD SOIL CONSERVATION DISTRICT  
DATE **7/31/87**  
SIGNATURE **[Signature]**  
APPROVED

DEVELOPERS/BUILDER'S CERTIFICATE  
I/WE CERTIFY THAT ALL DEVELOPMENT AND CONSTRUCTION WILL BE DONE ACCORDING TO THIS PLAN OF DEVELOPMENT AND PLAN FOR EROSION AND SEDIMENT CONTROL AND THAT ALL RESPONSIBLE PERSONS INVOLVED IN THE CONSTRUCTION PROJECT WILL HAVE A CERTIFICATE OF ATTENDANCE AT A DEPT OF NATURAL RESOURCES APPROVED TRAINING PROGRAM FOR THE CONTROL OF SEDIMENT AND EROSION CONTROL BEFORE BEGINNING THE PROJECT. I ALSO AUTHORIZE PERIODIC ON-SITE INSPECTION BY THE HOWARD SOIL CONSERVATION DISTRICT OF THEIR AUTHORIZED AGENTS AS DEEMED NECESSARY.  
DATE **7/13/87**  
SIGNATURE **[Signature]**  
SIGNATURE OF DEVELOPER / BUILDER

ENGINEER'S CERTIFICATE  
I CERTIFY THAT THIS PLAN FOR EROSION AND SEDIMENT CONTROL REPRESENTS A PRACTICAL AND WORKABLE PLAN BASED ON MY PERSONAL KNOWLEDGE OF SITE CONDITIONS AND THAT IT WAS PREPARED IN ACCORDANCE WITH THE REQUIREMENTS OF THE HOWARD SOIL CONSERVATION DISTRICT.  
DATE **7/13/87**  
SIGNATURE **[Signature]**  
ENGINEER # **11641**

LAND DESIGN ASSOCIATES  
718 HIGHWOOD DRIVE,  
BALTIMORE MD. 21212,  
301/323-0805.  
REVISIONS:

**TURF VALLEY OVERLOOK**  
**SECTION J AREA I**  
**DEVELOPMENT & SEDIMENT CONTROL PLAN**  
ACRES **83-91 AND 99-102 (18 LOTS)**  
SECOND ELECTION DISTRICT  
HOWARD COUNTY, MARYLAND  
DESIGNED PLW: **[Signature]**  
DRAWN PC: **[Signature]**  
CHECKED PLW: **[Signature]**  
SCALE AS SHOWN  
SHEET **2012**  
DATE **7/18/87**

**SEDIMENT CONTROL NOTES**

- A minimum of 24 hours notice must be given to the Howard County Office of Inspections and Permits prior to the start of construction (992-2437)
- All vegetative and structural practices are to be installed according to the provisions of this plan and are to be in compliance with the 1983 MARYLAND STANDARDS AND SPECIFICATIONS FOR SOIL EROSION AND SEDIMENT CONTROL.
- Following initial soil disturbance or redistribution, permanent or temporary stabilization shall be completed within a 7 calendar days for all perimeter sediment control structures, dikes, perimeter slopes and all slopes greater than 3:1, b) 14 days as to all other disturbed or graded areas on the project site.
- All sediment traps/basins shown must be fenced and warning signs posted around their perimeter in accordance with Vol. 1, Chapter 12, of the HOWARD COUNTY DESIGN MANUAL - Storm Drainage.
- All disturbed areas must be stabilized within the time period specified above in accordance with the 1983 MARYLAND STANDARDS AND SPECIFICATIONS FOR SOIL EROSION AND SEDIMENT CONTROL for permanent seedings (Sec. 51), and (Sec. 54), temporary seeding (Sec. 50) and mulching (Sec. 52) when recommended seeding dates do not allow for permanent establishment of grasses. Sediment control structures are to remain in place until their removal has been obtained from the Sediment Control Inspector.
- Site Analysis:  
Total Area of Site: **6.20** acres  
Area to be roofed or paved: **1.53** acres  
Area to be vegetatively stabilized: **4.67** acres  
Total Cut: **3,350** cu. yds.  
Total Fill: **3,350** cu. yds.  
Offsite waste/borrow area location: **None**
- Any sediment control practice which is disturbed by grading activity for placement of utilities, must be repaired on the same day of disturbance.
- Additional sediment controls must be provided, if deemed necessary by the Howard County DPW sediment control inspector.
- On all sites with disturbed areas in excess of 2 acres, approval of the inspection agency shall be requested upon completion of installation of perimeter erosion and sediment controls, but before proceeding with any other earth disturbance or grading. Other building or grading inspection approvals may not be authorized until this initial approval by the inspection agency is made.  
TOTAL AMOUNT OF SILT FENCE: **1,610 L.F.**  
TOTAL AMOUNT OF PDS: **780 L.F.**  
TOTAL AMOUNT OF SODS: **3**

**Construction Sequence**

The sequence of construction must include, as a minimum, a schedule and time frame for the following activities:

- Obtain a grading permit.
- Clearing and grubbing for the installation of perimeter controls. N/A
- Remaining clearing and grubbing N/A
- Grading roads and site. (SITE ONLY)
- Utility installation and treatment of storm drains (i.e. blocking or diverting to traps)
- Final grading and stabilization
- Removal of controls. APPROVAL ONLY HCS-09