

REVIEWED FOR HOWARD SOIL CONSERVATION DISTRICT AND MEETS TECHNICAL REQUIREMENTS
 James M. Williams 7/15/87
 U.S. SOIL CONSERVATION SERVICE DATE

THIS DEVELOPMENT IS APPROVED FOR EROSION AND SEDIMENT CONTROL BY THE HOWARD SOIL CONSERVATION DISTRICT.
 APPROVED: James M. Williams 7/15/87
 DISTRICT: HOWARD SOIL CONSERVATION DISTRICT

APPROVED
PLANNING BOARD
OF HOWARD COUNTY
 DATE: 4-29-87
 [Signature]

DEVELOPER'S CERTIFICATE
 I/WE CERTIFY THAT ALL DEVELOPMENT AND CONSTRUCTION WILL BE DONE ACCORDING TO THIS PLAN OF DEVELOPMENT AND PLAN FOR EROSION AND SEDIMENT CONTROL AND THAT ALL RESPONSIBLE PERSONNEL INVOLVED IN THE CONSTRUCTION PROJECT WILL HAVE A CERTIFICATE OF ATTENDANCE AT A DEPARTMENT OF NATURAL RESOURCES APPROVED TRAINING PROGRAM FOR THE CONTROL OF SEDIMENT AND EROSION BEFORE BEGINNING THE PROJECT. I ALSO AUTHORIZE PERIODIC ONSITE INSPECTION BY THE HOWARD SOIL CONSERVATION DISTRICT OR THEIR AUTHORIZED AGENTS, AS ARE DEEMED NECESSARY.
 James M. Williams 6/24/87
 SIGNATURE OF DEVELOPER DATE

ENGINEER'S CERTIFICATE
 I HEREBY CERTIFY THAT THIS PLAN FOR EROSION AND SEDIMENT CONTROL REPRESENTS A PRACTICAL AND WORKABLE PLAN BASED ON MY PERSONAL KNOWLEDGE OF THE SITE CONDITIONS AND THAT IT WAS PREPARED IN ACCORDANCE WITH THE REQUIREMENTS OF THE HOWARD SOIL CONSERVATION DISTRICT.
 [Signature] 6/24/87
 SIGNATURE OF ENGINEER DATE

APPROVED: OFFICE OF PLANNING AND ZONING
 [Signature] 7-27-87
 PLANNING DIRECTOR DATE
 [Signature] 7-27-87
 CHIEF, DIVISION OF LAND DEVELOPMENT AND ZONING ADMINISTRATION DATE

APPROVED: HOWARD COUNTY HEALTH DEPARTMENT FOR PUBLIC WATER AND SEWERAGE SYSTEMS
 [Signature] 7-22-87
 HEALTH OFFICER DATE

APPROVED: DEPARTMENT OF PUBLIC WORKS FOR PUBLIC WATER & SEWER AND STORM DRAINAGE SYSTEMS AND ROADS.
 [Signature] 7/21/87
 DIRECTOR, PUBLIC WORKS DATE

NE 20' 20' 20' 7-21-87
 CHIEF, BUREAU OF ENGINEERING DATE

SUBDIVISION	SECTION/AREA	PARCEL/LOT NO.
E.G.U. SUBDIVISION	2/4	C-2
PLAT NO.	BLOCK NO. ZONE	ELEC. DIST.
GG79	9 NT/IND 4C	G061.03
WATER CODE	SEWER CODE	
E06	9280000	

Dewberry & Davis
 ARCHITECTS-ENGINEERS-PLANNERS-SURVEYORS
 8800 N. RIDGE ROAD
 ELLICOTT CITY, MD. 21048
 TEL. (410) 461-7478

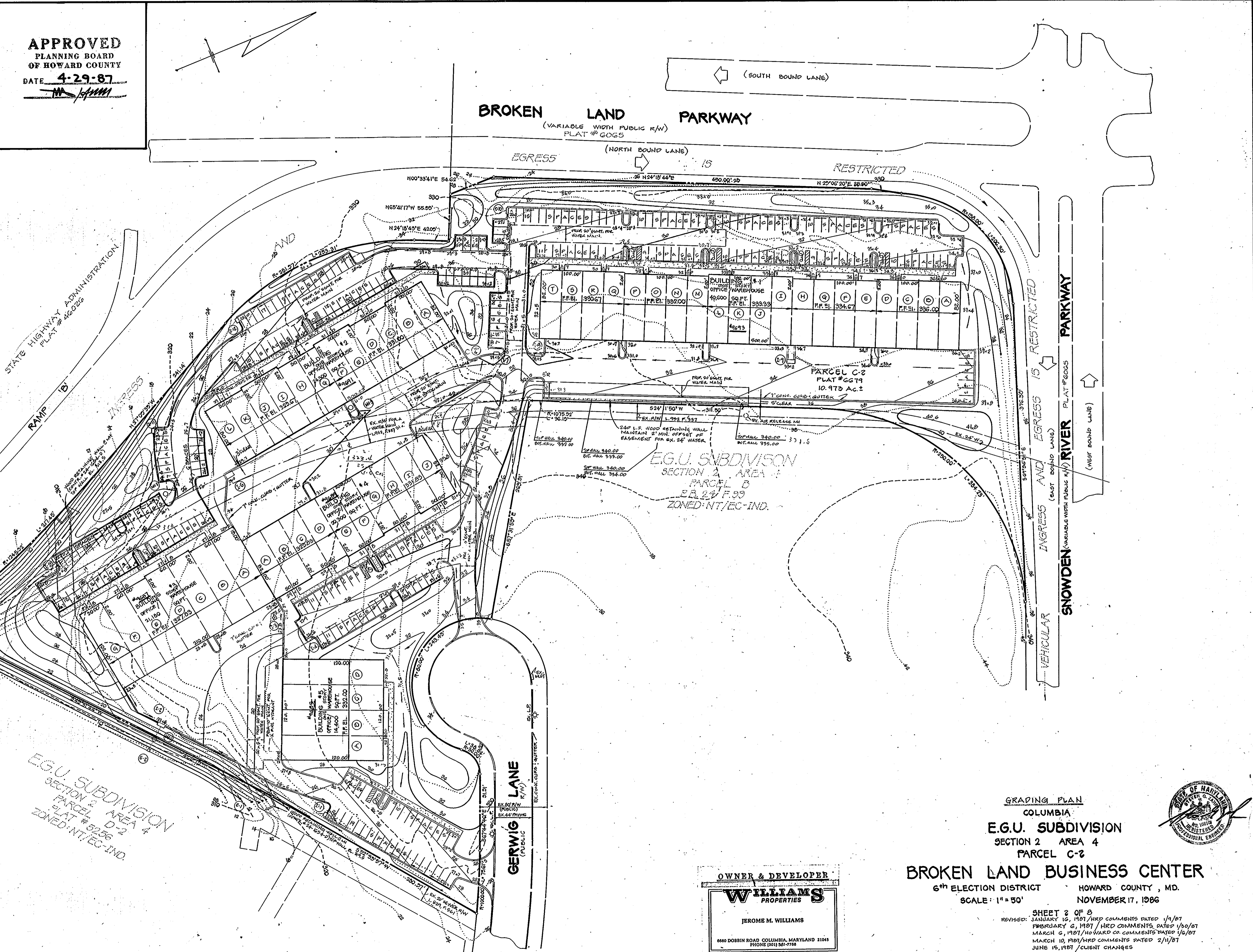

EGU SUBDIVISION
 SECTION 2 AREA 4
 PARCEL D-2
 PLAT # 5256
 ZONED NT/EC-IND

OWNER & DEVELOPER
WILLIAMS
 PROPERTIES
 JEROME M. WILLIAMS
 6660 DOBBIN ROAD COLUMBIA, MARYLAND 21045
 PHONE (301) 581-9768

GRADING PLAN
 COLUMBIA
E.G.U. SUBDIVISION
 SECTION 2 AREA 4
 PARCEL C-2
BROKEN LAND BUSINESS CENTER
 6th ELECTION DISTRICT HOWARD COUNTY, MD.
 SCALE: 1" = 30' NOVEMBER 17, 1986

SHEET 2 OF 8
 REVISED: JANUARY 16, 1987/HRD COMMENTS DATED 1/9/87
 FEBRUARY 6, 1987/HRD COMMENTS DATED 1/30/87
 MARCH 6, 1987/HOWARD CO. COMMENTS DATED 1/6/87
 MARCH 10, 1987/HRD COMMENTS DATED 2/11/87
 JUNE 15, 1987/CLIENT CHANGES



REVIEWED FOR HOWARD SOIL CONSERVATION DISTRICT AND MEETS TECHNICAL REQUIREMENTS
 U.S. SOIL CONSERVATION SERVICE 7-15-87 DATE
 THIS DEVELOPMENT IS APPROVED FOR EROSION AND SEDIMENT CONTROL BY THE HOWARD SOIL CONSERVATION DISTRICT.
 APPROVED: *[Signature]* 7/15/87 DATE
 HOWARD SOIL CONSERVATION DISTRICT

DEVELOPER'S CERTIFICATE
 I/WE CERTIFY THAT ALL DEVELOPMENT AND CONSTRUCTION WILL BE DONE ACCORDING TO THIS PLAN OF DEVELOPMENT AND PLAN FOR EROSION AND SEDIMENT CONTROL AND THAT ALL RESPONSIBLE PERSONNEL INVOLVED IN THE CONSTRUCTION PROJECT WILL HAVE A CERTIFICATE OF ATTENDANCE AT A DEPARTMENT OF NATURAL RESOURCES APPROVED TRAINING PROGRAM FOR THE CONTROL OF SEDIMENT AND EROSION BEFORE BEGINNING THE PROJECT. I ALSO AUTHORIZE PERIODIC ONSITE INSPECTION BY THE HOWARD SOIL CONSERVATION DISTRICT OR THEIR AUTHORIZED AGENTS, AS ARE DEEMED NECESSARY.
 SIGNATURE OF DEVELOPER: *[Signature]* 6/24/87 DATE

ENGINEER'S CERTIFICATE
 I HEREBY CERTIFY THAT THIS PLAN FOR EROSION AND SEDIMENT CONTROL REPRESENTS A PRACTICAL AND WORKABLE PLAN BASED ON MY PERSONAL KNOWLEDGE OF THE SITE CONDITIONS AND THAT IT WAS PREPARED IN ACCORDANCE WITH THE REQUIREMENTS OF THE HOWARD SOIL CONSERVATION DISTRICT.
 SIGNATURE OF ENGINEER: *[Signature]* 7/27/87 DATE

APPROVED: OFFICE OF PLANNING AND ZONING
 PLANNING DIRECTOR: *[Signature]* 7-27-87 DATE
 CHIEF, DIVISION OF LAND DEVELOPMENT AND ZONING ADMINISTRATION: *[Signature]* 7-27-87 DATE

APPROVED: HOWARD COUNTY HEALTH DEPARTMENT FOR PUBLIC WATER AND SEWERAGE SYSTEMS
 HEALTH OFFICER: *[Signature]* 7-22-87 DATE

APPROVED: DEPARTMENT OF PUBLIC WORKS FOR PUBLIC WATER & SEWER AND STORM DRAINAGE SYSTEMS AND ROADS.
 DIRECTOR, PUBLIC WORKS: *[Signature]* 7/21/87 DATE

CHIEF, BUREAU OF ENGINEERING: *[Signature]* 7-21-87 DATE

SUBDIVISION	SECTION/AREA	PARCEL/LOT NO.
E.G.U. SUBDIVISION	2/4	C-2
PLAT NO.	BLOCK/ZONE	TAX/ZONE
6279	7	4Z
WATER CODE	ELEC. DIST.	CENSUS TR.
E 06	G 7	0041.03
	SEWER CODE	
	5280000	

APPROVED
 PLANNING BOARD
 OF HOWARD COUNTY
 DATE: 4-29-87
[Signature]

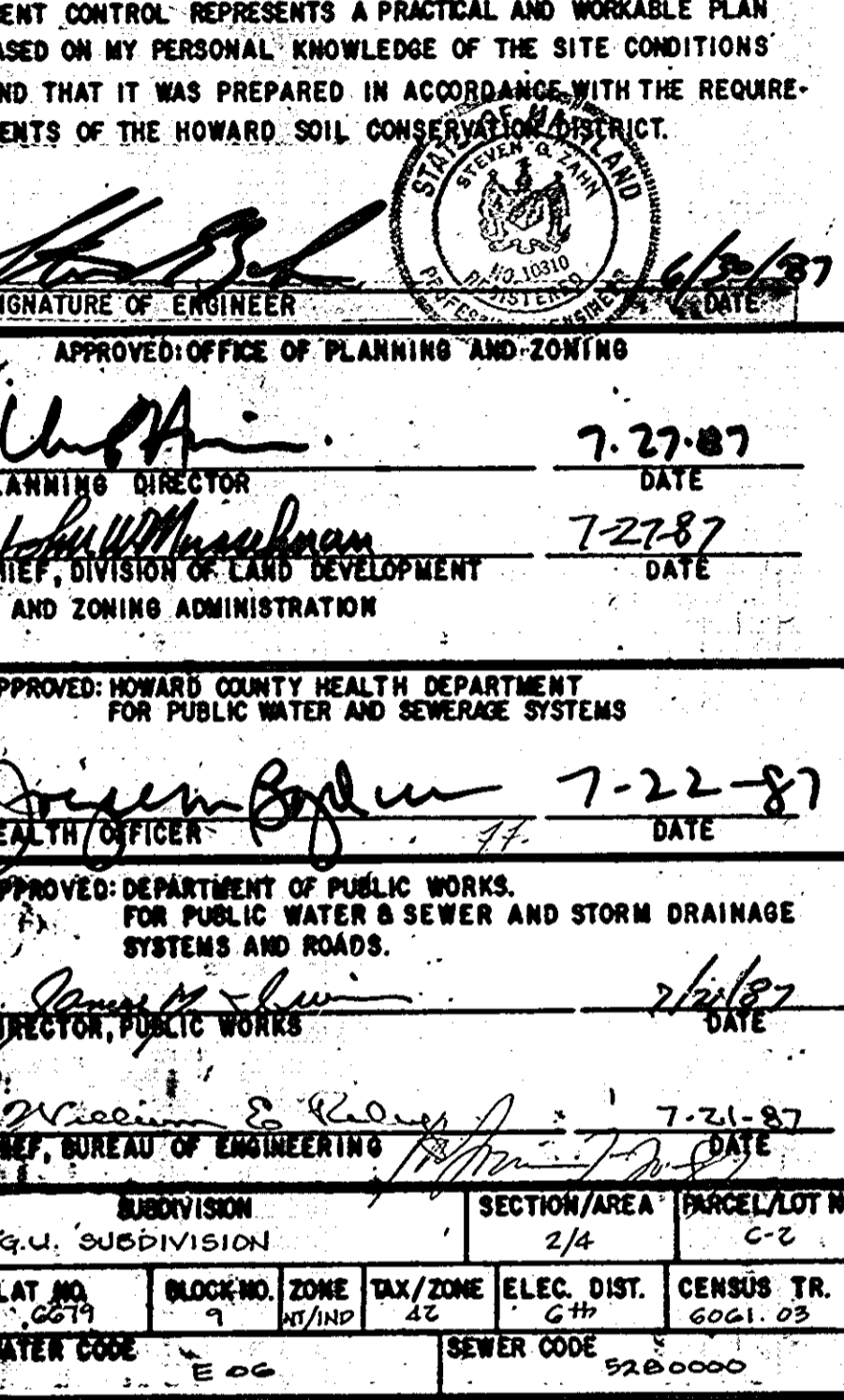

BROKEN LAND PARKWAY
 (VARIABLE WIDTH PUBLIC R/W)
 PLAT # 6065

EGRESS (NORTH BOUND LANE) 15
 RESTRICTED

E.G.U. SUBDIVISION
 SECTION 2 AREA 4
 PARCEL D
 P.B. 24 F.99
 ZONED NT/EC-IND.

UTILITY CONSTRUCTION NOTES:

1. NO ENCROACHMENT OF BUILDING FOUNDATIONS WILL BE ALLOWED WITHIN THE EXISTING 24" WATER MAIN EASEMENTAL FOUNDATIONS. SHOULD MAINTAIN THREE FOOT (3') MINIMUM CLEARANCE FROM THE EASEMENTAL LINE.
2. THE CONTRACTOR SHALL MAINTAIN TRAVELING THE EXISTING 24" WATER MAIN WITH HEAVY CONSTRUCTION EQUIPMENT.
3. THE CONTRACTOR SHALL ACCURATELY ESTABLISH THE EXISTING 24" WATER MAIN AND THE EXISTING SEWERAGE SYSTEMS REMAINING CONSTRUCTION.
4. THE CONTRACTOR SHALL NOTIFY THE HOWARD COUNTY BUREAU OF UTILITIES 24 HOURS PRIOR TO BEGINNING CONSTRUCTION OR GRADING OPERATIONS.
5. THE CONTRACTOR SHALL BE LIABLE FOR ANY OR ALL DAMAGES INCURRED TO EXISTING UTILITIES AS A RESULT OF THE CONTRACTORS CONSTRUCTION OR GRADING OPERATIONS.
6. THE OWNER SHALL PROVIDE A SEPARATE AND INDEPENDENT GSENER CONNECTION FOR EACH TENANT OR OCCUPANT OF ANY BUILDING SHOWN ON THIS PLAN, WHO WILL DISCHARGE NON-CONCRETE WASTE TO THE PUBLIC SEWERAGE SYSTEM IF THE WASTE IS REGULATED UNDER SECTION 15.122A OF THE HOWARD COUNTY CODES. EACH SEPARATE AND INDEPENDENT GSENER CONNECTION SHALL INCLUDE A STANDARD MANHOLE AND OTHER NECESSARY RESTRAINT DEVICES AS REQUIRED AND APPROVED BY HOWARD COUNTY. WASTE LINES AT THE INTERIOR OF THE BUILDING SHALL BE DESIGNED, CONSTRUCTED OR MODIFIED SUCH THAT NON-CONCRETE WASTE WILL BE DISCHARGED TO THE SEPARATE AND INDEPENDENT GSENER CONNECTION. NO TENANT OR OCCUPANT OF ANY BUILDING SHOWN ON THIS PLAN SHALL DISCHARGE REGULATED NON-CONCRETE WASTE TO THE PUBLIC SEWERAGE SYSTEM PRIOR TO INSTALLATION OF THE SEPARATE AND INDEPENDENT GSENER CONNECTION AND RELATED INTERIOR WASTE LINES. THE ABOVE REQUIREMENTS SHALL APPLY TO ALL INITIAL AND FUTURE OCCUPANTS OR TENANTS.
7. BEFORE BEGINNING CONSTRUCTION AND GRADING WITHIN THE AREA OF THE EXISTING 24" WATER MAIN EASEMENT, THE CONTRACTOR SHALL TEST FIT THE EXISTING 24" WATER MAIN AND THE OUT AREAS OF PROPOSED GRADING. THE CONTRACTOR SHOULD ALSO TEST FIT THE AREAS FOR BUILDING #2 - BAY (1) AND BUILDING #4 - BAY (2) BEFORE CONSTRUCTION OR GRADING BEGINS. THE PROPOSED TEST FIT AREAS SHOWN THIRTY (30) FEET.
8. FOR RELOCATION CONSTRUCTION - SEQUENCE OF 10" SANITARY SEWER SEE CONTR. #24-1024-D.

Dewberry & Davis
 ARCHITECTS-ENGINEERS-PLANNERS-SURVEYORS
 8800 N. RIDGE ROAD
 BELLGROVE CITY, MD. 21048
 TELE. (301) 481-7478

OWNER & DEVELOPER
WILLIAMS
 PROPERTIES
 JEROME M. WILLIAMS
 6440 DOBBIN ROAD COLUMBIA, MARYLAND 21045
 PHONE (301) 529-7708

UTILITY PLAN
 COLUMBIA
E.G.U. SUBDIVISION
 SECTION 2 AREA 4
 PARCEL C-2
BROKEN LAND BUSINESS CENTER
 6th ELECTION DISTRICT HOWARD COUNTY, MD.
 SCALE: 1" = 50'
 NOVEMBER 17, 1986

SHEET 3 OF 8
 REVISED: JANUARY 15, 1987 / HED COMMENTS DATED 1/19/87
 FEBRUARY 5, 1987 / HED COMMENTS DATED 1/26/87
 MARCH 6, 1987 / HOWARD CO. COMMENTS DATED 1/6/87
 MARCH 10, 1987 / HED COMMENTS DATED 2/11/87
 JUNE 15, 1987 / CLIENT CHANGES.



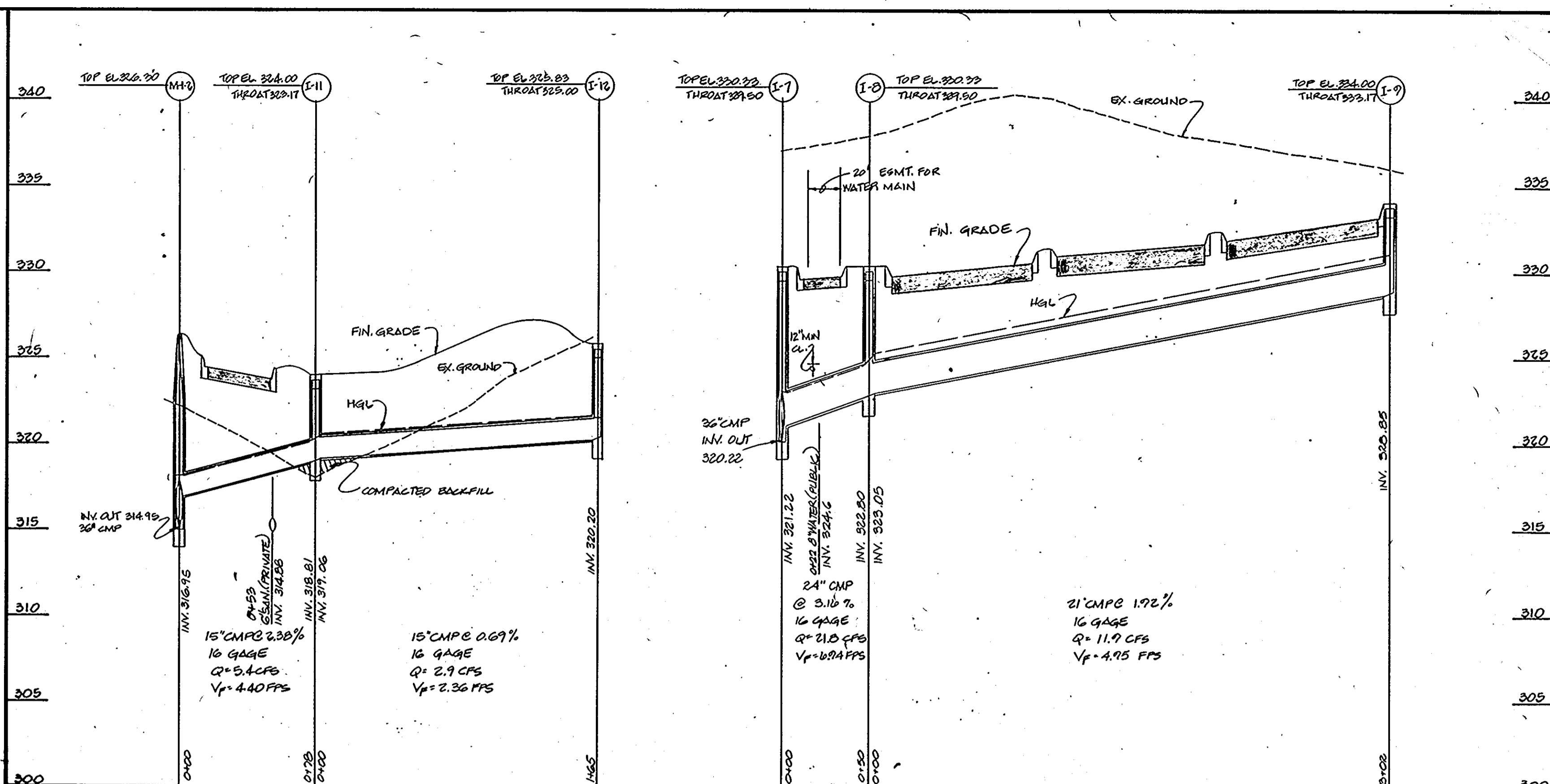
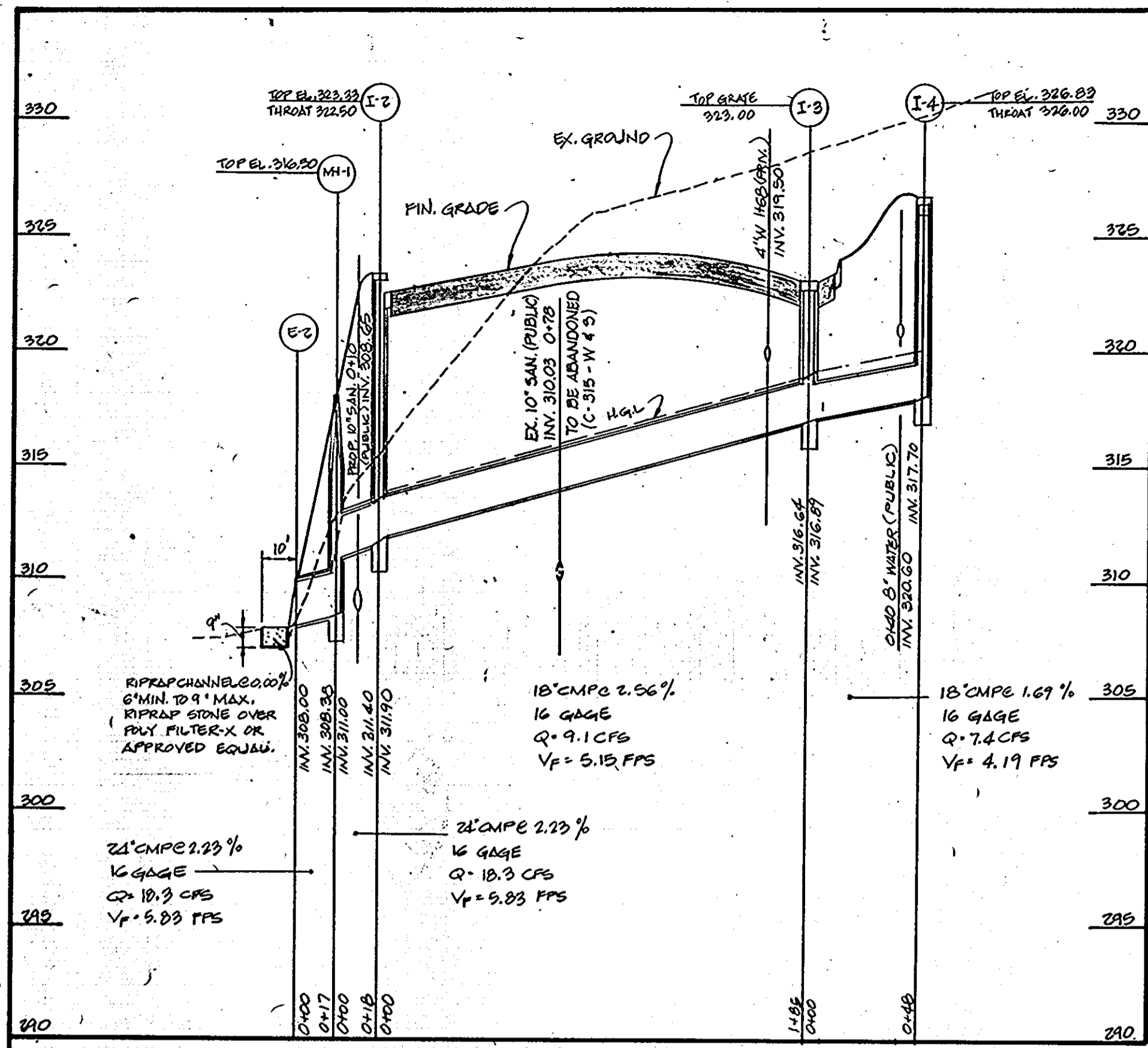

STRUCTURE SCHEDULE

NO.	TYPE	TOP ELEV.	INV. IN	INV. OUT	REMARKS
I-1	A-5	324.33	---	320.00	SD 4.01
I-2	A-10	323.33	311.90	311.40	SD 4.02
I-3	A-5	323.00	316.89	316.64	SD 4.22
I-4	A-5	326.83	---	317.70	SD 4.01
I-5	A-5	322.00	312.25	312.00	SD 4.01
I-6	A-10	329.85	316.49	316.24	SD 4.02
I-7	A-5	330.33	320.37	320.22	SD 4.01
I-8	A-10	330.33	323.05	322.80	SD 4.02
I-9	A-10	334.00	---	328.85	SD 4.02
I-10	A-10	336.83	---	321.31	SD 4.92
I-11	A-5	324.00	319.06	318.81	SD 4.01
I-12	A-5	325.83	---	320.20	SD 4.01
ME-1	STD	316.50	311.00	308.39	G 5.01
ME-2	STD	326.30	315.20	314.95	G 5.02
ME-3	STD	331.00	318.20	318.01	G 5.02
ME-4	STD	331.20	319.91	319.66	G 5.02
E-1	METAL END SECT.	311.25	---	310.00	SD 5.61
E-2	METAL END SECT.	310.00	---	308.40	SD 5.61
E-3	METAL END SECT.	311.00	---	308.00	SD 5.61

All details refer to Howard County standard specifications and details for construction unless otherwise noted.

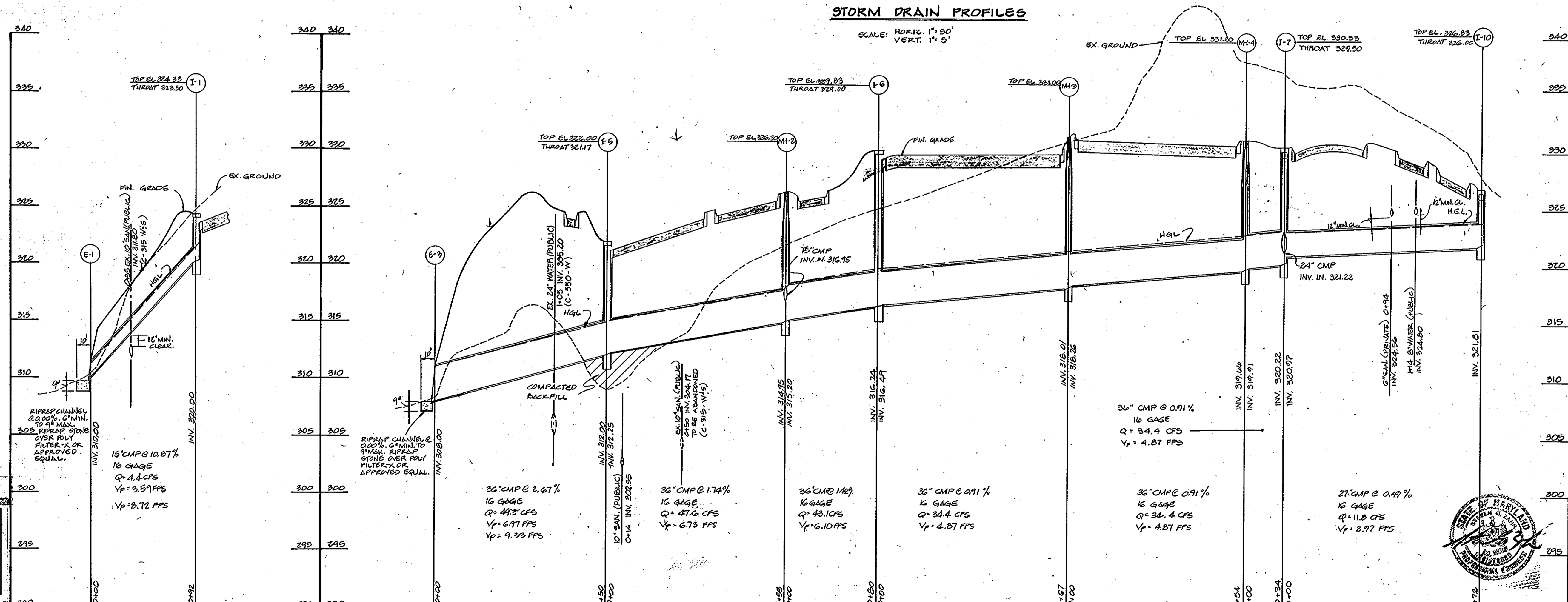

APPROVED
PLANNING BOARD
OF HOWARD COUNTY
DATE 4-29-87

OWNER & DEVELOPER
WILLIAMS PROPERTIES
JEROME M. WILLIAMS
6660 DOBBIN ROAD COLUMBIA, MARYLAND 21046
PHONE (301) 561-7768

ENGINEER'S CERTIFICATE
I HEREBY CERTIFY THAT THIS PLAN FOR EROSION AND SEDIMENT CONTROL REPRESENTS A PRACTICAL AND WORKABLE PLAN BASED ON MY PERSONAL KNOWLEDGE OF THE SITE CONDITIONS AND THAT IT WAS PREPARED IN ACCORDANCE WITH REQUIREMENTS OF THE HOWARD SOIL CONSERVATION DISTRICT.

Signature: *[Signature]* DATE: 6/24/87

DEVELOPER'S CERTIFICATE
I/WE CERTIFY THAT ALL DEVELOPMENT AND CONSTRUCTION WILL BE DONE ACCORDING TO THIS PLAN OF DEVELOPMENT AND PLAN FOR EROSION AND SEDIMENT CONTROL AND THAT ALL RESPONSIBLE PERSONNEL INVOLVED IN THE CONSTRUCTION PROJECT WILL HAVE A CERTIFICATE OF ATTENDANCE AT A DEPARTMENT OF NATURAL RESOURCES APPROVED TRAINING PROGRAM FOR THE CONTROL OF SEDIMENT AND EROSION BEFORE BEGINNING THE PROJECT. I ALSO AUTHORIZE PERIODIC ON-SITE INSPECTION BY THE HOWARD SOIL CONSERVATION DISTRICT OR THEIR AUTHORIZED AGENTS, AS ARE DEEMED NECESSARY.

Signature: *[Signature]* DATE: 6/24/87

REVIEWED FOR HOWARD SOIL CONSERVATION DISTRICT AND MEETS TECHNICAL REQUIREMENTS.

Signature: *[Signature]* DATE: 7/15/87
U.S. SOIL CONSERVATION SERVICE

Signature: *[Signature]* DATE: 7/15/87
HOWARD SOIL CONSERVATION DISTRICT

APPROVED: OFFICE OF PLANNING AND ZONING
Signature: *[Signature]* DATE: 7-27-87
PLANNING DIRECTOR

Signature: *[Signature]* DATE: 7-27-87
CHIEF, DIVISION OF LAND DEVELOPMENT AND ZONING ADMINISTRATION

APPROVED: HOWARD COUNTY HEALTH DEPARTMENT FOR PUBLIC WATER AND SEWERAGE SYSTEMS.
Signature: *[Signature]* DATE: 7-22-87
HEALTH OFFICER

APPROVED: DEPARTMENT OF PUBLIC WORKS FOR PUBLIC WATER AND SEWER AND STORM DRAINAGE SYSTEMS AND ROADS.
Signature: *[Signature]* DATE: 7/16/87
DIRECTOR, PUBLIC WORKS

Signature: *[Signature]* DATE: 7-21-87
CHIEF, BUREAU OF ENGINEERING

SUBDIVISION NAME: E.G.U. SUBDIVISION
SECTION/AREA: C-2
FLAT NO.: 9
BLOCK NO.: 14
ZONE: 42
ELEC. DIST.: 6TH
CENSUS TR.: 6061.03
WATER CODE: E.06
SEWER CODE: 5280000

STORM DRAIN PROFILES
COLUMBIA
E.G.U. SUBDIVISION
SECTION 2 AREA 4
PARCEL C-2
BROKEN LAND BUSINESS CENTER
6TH ELECTION DISTRICT HOWARD CO., MD.
SCALE AS SHOWN
NOVEMBER 17, 1986
REVISED: JUNE 15, 1987
SHEET 4 OF 8

Dewberry & Davis
ARCHITECTS-ENGINEERS-PLANNERS-SURVEYORS
3800 N. RIDGE ROAD
ELLICOTT CITY MD. 21048
TELE. (301) 461-7478



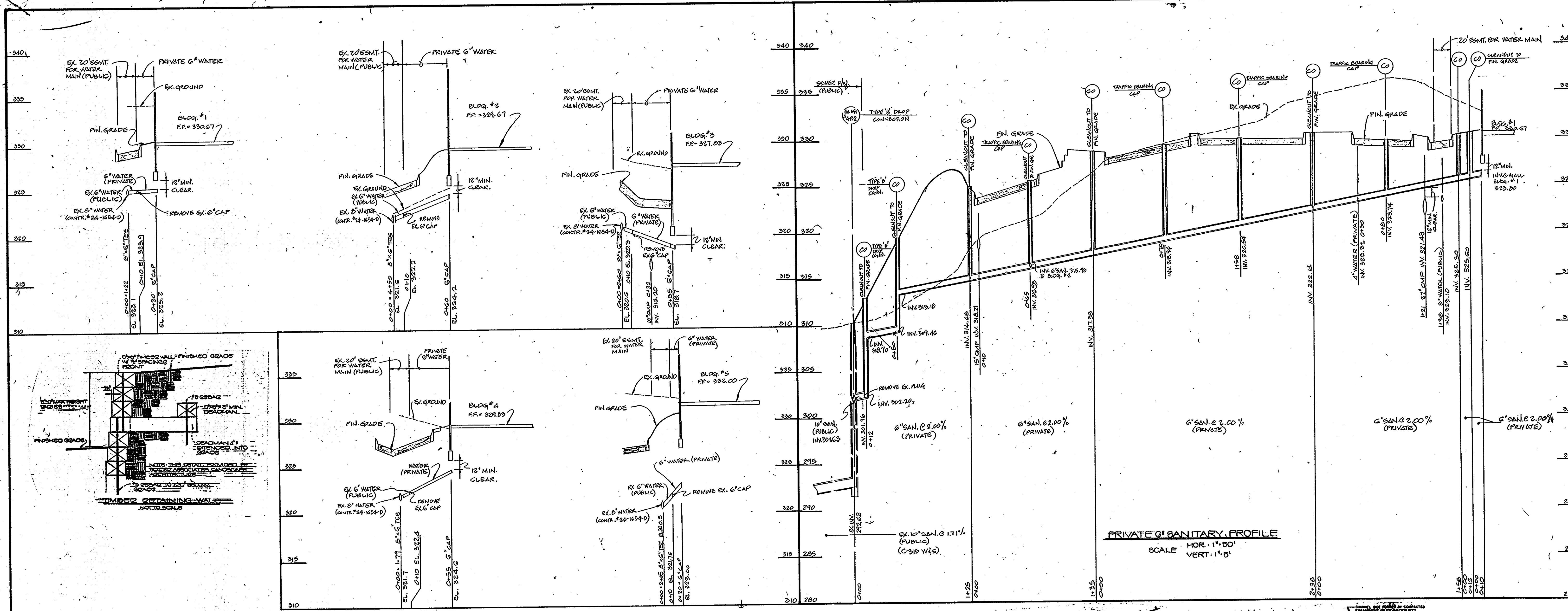

PRIVATE 6" WATER CONNECTION PROFILES
SCALE: HORIZ. 1" = 50'
VERT. 1" = 5'

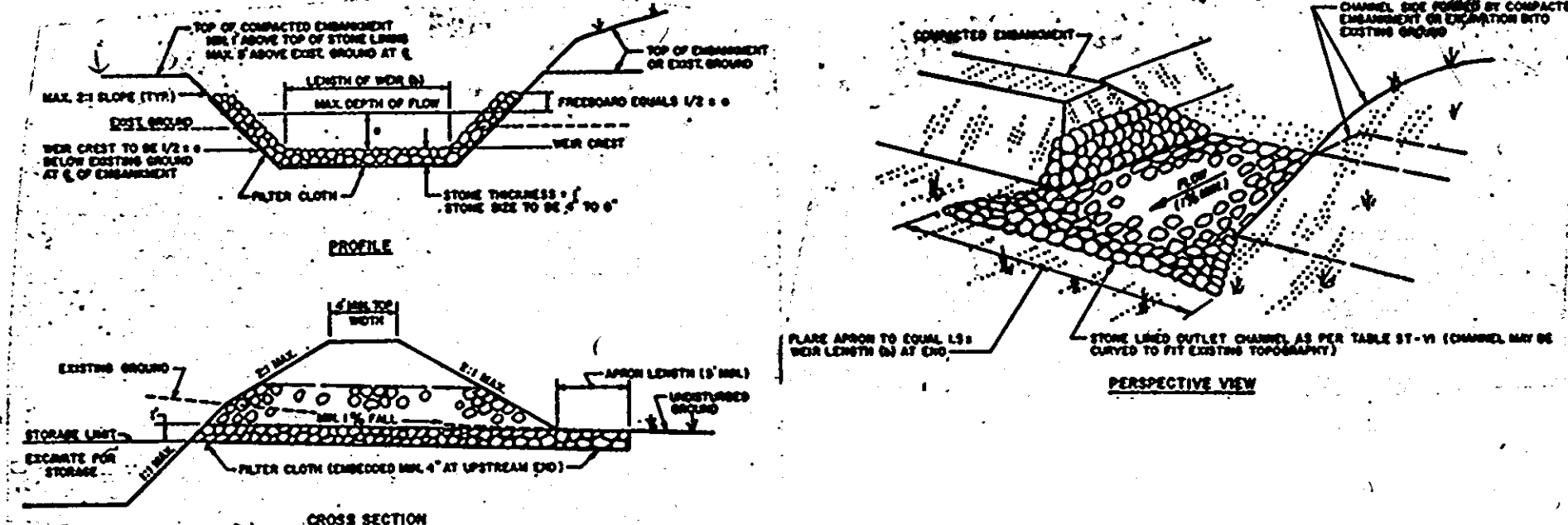

- CONSTRUCTION SPECIFICATIONS**
- The area under embankment shall be cleared, grubbed and stripped of any vegetation and root mat. The pool area shall be cleared.
 - The fill material for the embankment shall be free of roots or other woody vegetation as well as over-sized stones, rocks, organic material or other objectionable material. The embankment shall be compacted by traversing with equipment while it is being constructed. Maximum height of embankment shall be five (5) feet, measured at centerline of embankment.
 - All fill slopes shall be 2:1 or flatter; cut slopes 1:1 or flatter.
 - Elevation of the top of any dike directing water into trap must equal or exceed the height of embankment.
 - Storage area provided shall be figured by computing the volume available behind the outlet channel up to an elevation of one (1) foot below the level weir crest.
 - Filter cloth shall be placed over the bottom and sides of the outlet channel prior to placement of stones. Sections of fabric must overlap at least one (1) foot with section nearest the entrance placed on top. Fabric shall be embedded at least six (6) inches into existing ground at entrance of outlet channel.
 - Stones used in the outlet channel shall be four (4) to eight (8) inches (riprap). To provide a filtering effect, a layer of filter cloth shall be embedded one (1) foot back into the upstream face of the outlet stone or a one (1) foot thick layer of two (2) inch or finer aggregate shall be placed on the upstream face of the outlet.
 - Sediment shall be removed and trap restored to its original dimensions when the sediment has accumulated to 1/2 the design depth of the trap. Removed sediment shall be deposited in a suitable area and in such a manner that it will not erode.
 - The structure shall be inspected after each rain and repaired as needed.
 - Construction operations shall be carried out in such a manner that erosion and water pollution are minimized.
 - The structure shall be removed and the area stabilized when the drainage area has been properly stabilized.
 - Breakage area for this practice is limited to 15 acres or less.

RIP-RAP OUTLET SEDIMENT TRAP
NOT TO SCALE

APPROVED
PLANNING BOARD
OF HOWARD COUNTY
DATE 4-29-87



OWNER & DEVELOPER
WILLIAMS PROPERTIES
JEROME M. WILLIAMS
6000 DOBSON ROAD, COLUMBIA, MARYLAND 21046
PHONE (301) 281-7700

Dewberry & Davis
ARCHITECTS-ENGINEERS-PLANNERS-SURVEYORS
8800 N. RIDGE ROAD
ELLICOTT CITY MD. 21048
TELE. (301) 461-7478

ENGINEER'S CERTIFICATE
I HEREBY CERTIFY THAT THIS PLAN FOR EROSION AND SEDIMENT CONTROL REPRESENTS A PRACTICAL AND WORKABLE PLAN BASED ON MY PERSONAL KNOWLEDGE OF THE SITE CONDITIONS AND THAT IT WAS PREPARED IN ACCORDANCE WITH REQUIREMENTS OF THE HOWARD SOIL CONSERVATION DISTRICT.
DATE 4/29/87

DEVELOPER'S CERTIFICATE
"I/WE CERTIFY THAT ALL DEVELOPMENT AND CONSTRUCTION WILL BE DONE ACCORDING TO THIS PLAN OF DEVELOPMENT AND PLAN FOR EROSION AND SEDIMENT CONTROL AND THAT ALL RESPONSIBLE PERSONNEL INVOLVED IN THE CONSTRUCTION PROJECT WILL HAVE A CERTIFICATE OF ATTENDANCE AT A DEPARTMENT OF NATURAL RESOURCES APPROVED TRAINING PROGRAM FOR THE CONTROL OF SEDIMENT AND EROSION BEFORE BEGINNING THE PROJECT. I ALSO AUTHORIZE PERIODIC ON-SITE INSPECTION BY THE HOWARD SOIL CONSERVATION DISTRICT OR THEIR AUTHORIZED AGENTS, AS ARE DEEMED NECESSARY."
DATE 4/29/87

REVIEWED FOR HOWARD SOIL CONSERVATION DISTRICT AND MEETS TECHNICAL REQUIREMENTS.
DATE 7/15/87

THIS DEVELOPMENT IS APPROVED FOR EROSION AND SEDIMENT CONTROL BY THE HOWARD SOIL CONSERVATION DISTRICT.
DATE 7/15/87

APPROVED: OFFICE OF PLANNING AND ZONING
DATE 7-27-87

CHIEF, DIVISION OF LAND DEVELOPMENT AND ZONING ADMINISTRATION
DATE 7-27-87

APPROVED: HOWARD COUNTY HEALTH DEPARTMENT FOR PUBLIC WATER AND SEWERAGE SYSTEMS.
DATE 7-22-87

APPROVED: DEPARTMENT OF PUBLIC WORKS FOR PUBLIC WATER AND SEWER AND STORM DRAINAGE SYSTEMS AND ROADS.
DATE 7/21/87

CHIEF, BUREAU OF ENGINEERING
DATE 7-21-87

SUBDIVISION NAME	SECTION/AREA	PARCEL NUMBER
E.G.U. SUBDIVISION	7/4	6-2
PLAT NO. / BLOCK NO.	TAX/ZONE	ELEC. DIST.
6679 / 9	NY/ND	46
WATER CODE	SEWER CODE	CENSUS TR.
8-00	5100000	6021.02

PRIVATE WATER & SANITARY PROFILES (DETAIL)
COLUMBIA
E.G.U. SUBDIVISION
SECTION 2 AREA 4
PARCEL C-2
BROKEN LAND BUSINESS CENTER
6TH ELECTION DISTRICT HOWARD CO., MD.
SCALE: AS SHOWN
REVISED: JUNE 15, 1987
NOVEMBER 17, 1987
SHEET 5 OF 8

REVIEWED FOR HOWARD SOIL CONSERVATION DISTRICT AND MEETS TECHNICAL REQUIREMENTS
 James M. Williams 7/15/87
 U.S. SOIL CONSERVATION SERVICE DATE

THIS DEVELOPMENT IS APPROVED FOR EROSION AND SEDIMENT CONTROL BY THE HOWARD SOIL CONSERVATION DISTRICT.
 APPROVED: John R. Roberts 7/15/87
 DISTRICT HOWARD SOIL CONSERVATION DISTRICT DATE

APPROVED
PLANNING BOARD
OF HOWARD COUNTY
 DATE 4-29-87
 [Signature]

DEVELOPER'S CERTIFICATE
 I/WE CERTIFY THAT ALL DEVELOPMENT AND CONSTRUCTION WILL BE DONE ACCORDING TO THIS PLAN OF DEVELOPMENT AND PLAN FOR EROSION AND SEDIMENT CONTROL AND THAT ALL RESPONSIBLE PERSONNEL INVOLVED IN THE CONSTRUCTION PROJECT WILL HAVE A CERTIFICATE OF ATTENDANCE AT A DEPARTMENT OF NATURAL RESOURCES APPROVED TRAINING PROGRAM FOR THE CONTROL OF SEDIMENT AND EROSION BEFORE BEGINNING THE PROJECT. I ALSO AUTHORIZE PERIODIC ONSITE INSPECTION BY THE HOWARD SOIL CONSERVATION DISTRICT OR THEIR AUTHORIZED AGENTS, AS ARE DEEMED NECESSARY.
 James M. Williams 6/29/87
 SIGNATURE OF DEVELOPER DATE

ENGINEER'S CERTIFICATE
 I HEREBY CERTIFY THAT THIS PLAN FOR EROSION AND SEDIMENT CONTROL REPRESENTS A PRACTICAL AND WORKABLE PLAN BASED ON MY PERSONAL KNOWLEDGE OF THE SITE CONDITIONS AND THAT IT WAS PREPARED IN ACCORDANCE WITH THE REQUIREMENTS OF THE HOWARD SOIL CONSERVATION DISTRICT.
 [Signature] 6/30/87
 SIGNATURE OF ENGINEER DATE

APPROVED: OFFICE OF PLANNING AND ZONING
 Chris A. Amis 7-27-87
 PLANNING DIRECTOR DATE
 [Signature] 7-27-87
 CHIEF, DIVISION OF LAND DEVELOPMENT AND ZONING ADMINISTRATION DATE

APPROVED: HOWARD COUNTY HEALTH DEPARTMENT FOR PUBLIC WATER AND SEWERAGE SYSTEMS
 [Signature] 7-22-87
 HEALTH OFFICER DATE

APPROVED: DEPARTMENT OF PUBLIC WORKS FOR PUBLIC WATER & SEWER AND STORM DRAINAGE SYSTEMS AND ROADS.
 [Signature] 7/21/87
 DIRECTOR, PUBLIC WORKS DATE

APPROVED: CHIEF, BUREAU OF ENGINEERING
 [Signature] 7-21-87
 CHIEF, BUREAU OF ENGINEERING DATE

SUBDIVISION		SECTION/AREA	PARCEL/LOT NO.
E.G.U. SUBDIVISION		2/4	C-2
PLAT NO.	BLOCK NO.	TAX/ZONE	ELEC. DIST.
GG79	9	CM/IND	CG1
WATER CODE		SEWER CODE	
E06		9280000	

- DESIGN DATA**
SEDIMENT TRAP #2
1. DRAINAGE AREA TO TRAP: 5.40 AC.±
 2. TYPE OF TRAP: RIPRAP OUTLET
 3. VOLUME OF STORAGE REQUIRED: 362 C.Y.
 4. VOLUME OF STORAGE PROVIDED: 365 C.Y.
 5. TRAP SIZE (BOTTOM DIMENSIONS): 64' X 32'
 6. TRAP DEPTH: 4'
 7. LENGTH OF WEIR: 14.0'
 8. DEPTH OF CHANNEL IN WEIR: 1.5'
 9. TOP OF EMBANKMENT: 328.25
 10. WEIR CREST EL.: 325.00
 11. BOTTOM TRAP EL.: 322.00
 12. CLEANOUT EL.: 322.00

NOTE: ALL SEDIMENT TRAPS MUST BE FENCED AND WARNING SIGNS POSTED AROUND THEIR PERIMETER IN ACCORDANCE WITH VOL. I CHAPTER 12, OF THE HOWARD COUNTY DESIGN MANUAL, STORM DRAINAGE.

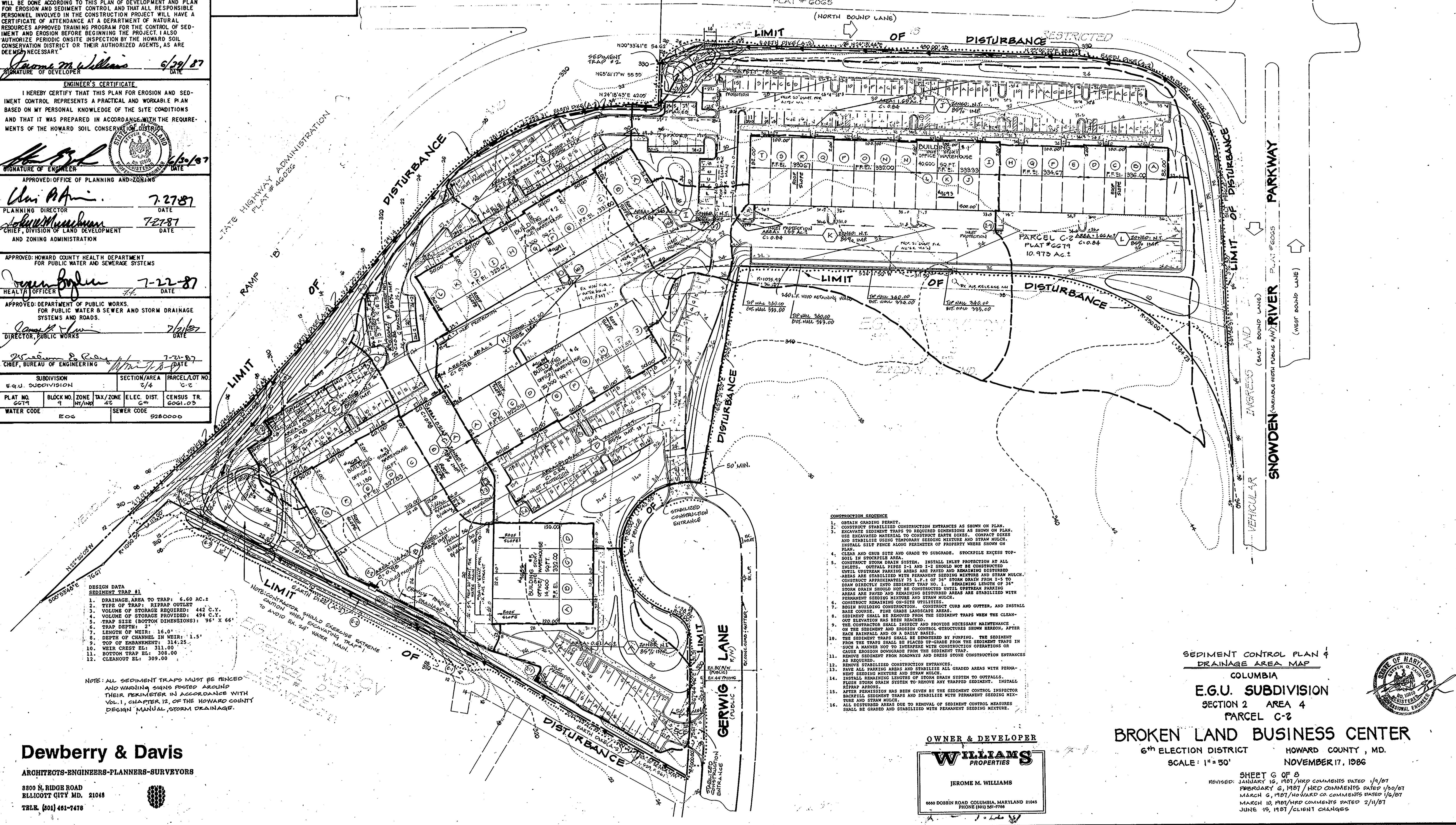

- CONSTRUCTION SEQUENCE**
1. OBTAIN GRADING PERMIT.
 2. CONSTRUCT STABILIZED CONSTRUCTION ENTRANCES AS SHOWN ON PLAN.
 3. EXCAVATE SEDIMENT TRAPS TO REQUIRED DIMENSIONS AS SHOWN ON PLAN. USE EXCAVATED MATERIAL TO CONSTRUCT EARTH DIKES. CONTACT DIKES AND STABILIZE USING TEMPORARY SEEDING MIXTURE AND STRAW MULCH. INSTALL SILT FENCE ALONG PERIMETER OF PROPERTY WHERE SHOWN ON PLAN.
 4. CLEAN AND GRUB SITE AND GRADE TO SUBGRADE. STOCKPILE EXCESS TOPSOIL IN STOCKPILE AREA.
 5. CONSTRUCT STORM DRAIN SYSTEM. INSTALL INLET PROTECTION AT ALL INLETS. OUTFALL PIPES I-1 AND I-2 SHOULD NOT BE CONSTRUCTED UNTIL UPSTREAM PARKING AREAS ARE PAVED AND REMAINING DISTURBED AREAS ARE STABILIZED WITH PERMANENT SEEDING MIXTURE AND STRAW MULCH. CONSTRUCT APPROXIMATELY 75 L.F. OF 36" STORM DRAIN FROM I-5 TO DRAIN DIRECTLY INTO SEDIMENT TRAP NO. 1. REMAINING LENGTH OF 36" STORM DRAIN SHOULD NOT BE CONSTRUCTED UNTIL UPSTREAM PARKING AREAS ARE PAVED AND REMAINING DISTURBED AREAS ARE STABILIZED WITH PERMANENT SEEDING MIXTURE AND STRAW MULCH.
 6. CONSTRUCT REMAINING ONE-TWO UTILITIES.
 7. BEGIN BUILDING CONSTRUCTION. CONSTRUCT CURBS AND GUTTER, AND INSTALL BASE COURSE. FIELD GRADE LANDSCAPE AREAS.
 8. SEDIMENT SHALL BE REMOVED FROM THE SEDIMENT TRAPS WHEN THE CLEANOUT ELEVATION HAS BEEN REACHED.
 9. THE CONTRACTOR SHALL INSPECT AND PROVIDE NECESSARY MAINTENANCE ON THE SEDIMENT AND EROSION CONTROL STRUCTURES SHOWN HEREON, AFTER EACH RAINFALL AND ON A DAILY BASIS.
 10. THE SEDIMENT TRAPS SHALL BE DEMATERIALIZED BY PUMPING. THE SEDIMENT FROM THE TRAPS SHALL BE HEAVED UP-GRADE FROM THE SEDIMENT TRAP IN SUCH A MANNER NOT TO INTERFERE WITH CONSTRUCTION OPERATIONS OR CAUSE EROSION DOWNGRADE FROM THE SEDIMENT TRAP.
 11. REMOVE SEDIMENT FROM ROADWAYS AND DRESS STONE CONSTRUCTION ENTRANCES AS REQUIRED.
 12. REMOVE STABILIZED CONSTRUCTION ENTRANCES.
 13. PAVE ALL PARKING AREAS AND STABILIZE ALL GRADED AREAS WITH PERMANENT SEEDING MIXTURE AND STRAW MULCH.
 14. INSTALL REMAINING LENGTHS OF STORM DRAIN SYSTEM TO OUTFALLS. PLACE STORM DRAIN SYSTEM TO REMOVE ANY TRAPPED SEDIMENT. INSTALL RIPRAP APPROX.
 15. AFTER PERMISSION HAS BEEN GIVEN BY THE SEDIMENT CONTROL INSPECTOR BACKFILL SEDIMENT TRAPS AND STABILIZE WITH PERMANENT SEEDING MIXTURE AND STRAW MULCH.
 16. ALL DISTURBED AREAS DUE TO REMOVAL OF SEDIMENT CONTROL MEASURES SHALL BE GRADED AND STABILIZED WITH PERMANENT SEEDING MIXTURE.

- DESIGN DATA**
SEDIMENT TRAP #1
1. DRAINAGE AREA TO TRAP: 6.60 AC.±
 2. TYPE OF TRAP: RIPRAP OUTLET
 3. VOLUME OF STORAGE REQUIRED: 442 C.Y.
 4. VOLUME OF STORAGE PROVIDED: 494 C.Y.
 5. TRAP SIZE (BOTTOM DIMENSIONS): 96' X 66'
 6. TRAP DEPTH: 2'
 7. LENGTH OF WEIR: 16.0'
 8. DEPTH OF CHANNEL IN WEIR: 1.5'
 9. TOP OF EMBANKMENT: 314.25
 10. WEIR CREST EL.: 311.00
 11. BOTTOM TRAP EL.: 308.00
 12. CLEANOUT EL.: 309.00

NOTE: ALL SEDIMENT TRAPS MUST BE FENCED AND WARNING SIGNS POSTED AROUND THEIR PERIMETER IN ACCORDANCE WITH VOL. I, CHAPTER 12, OF THE HOWARD COUNTY DESIGN MANUAL, STORM DRAINAGE.

Dewberry & Davis
 ARCHITECTS-ENGINEERS-PLANNERS-SURVEYORS
 8800 N. RIDGE ROAD
 ELLICOTT CITY MD. 21118
 TEL: (301) 461-7478

OWNER & DEVELOPER
WILLIAMS
 PROPERTIES
 JEROME M. WILLIAMS
 6660 DOBBIN ROAD COLUMBIA, MARYLAND 21045
 PHONE (301) 261-7768

SEDIMENT CONTROL PLAN &
 DRAINAGE AREA MAP
 COLUMBIA
 E.G.U. SUBDIVISION
 SECTION 2 AREA 4
 PARCEL C-2
BROKEN LAND BUSINESS CENTER
 6th ELECTION DISTRICT HOWARD COUNTY, MD.
 SCALE: 1" = 30'
 NOVEMBER 17, 1986



SHEET G OF 8
 JANUARY 10, 1987/HRD COMMENTS DATED 1/19/87
 FEBRUARY 6, 1987/HRD COMMENTS DATED 1/30/87
 MARCH 6, 1987/HOWARD CO. COMMENTS DATED 1/30/87
 MARCH 10, 1987/HRD COMMENTS DATED 2/11/87
 JUNE 15, 1987/CLIENT CHANGES

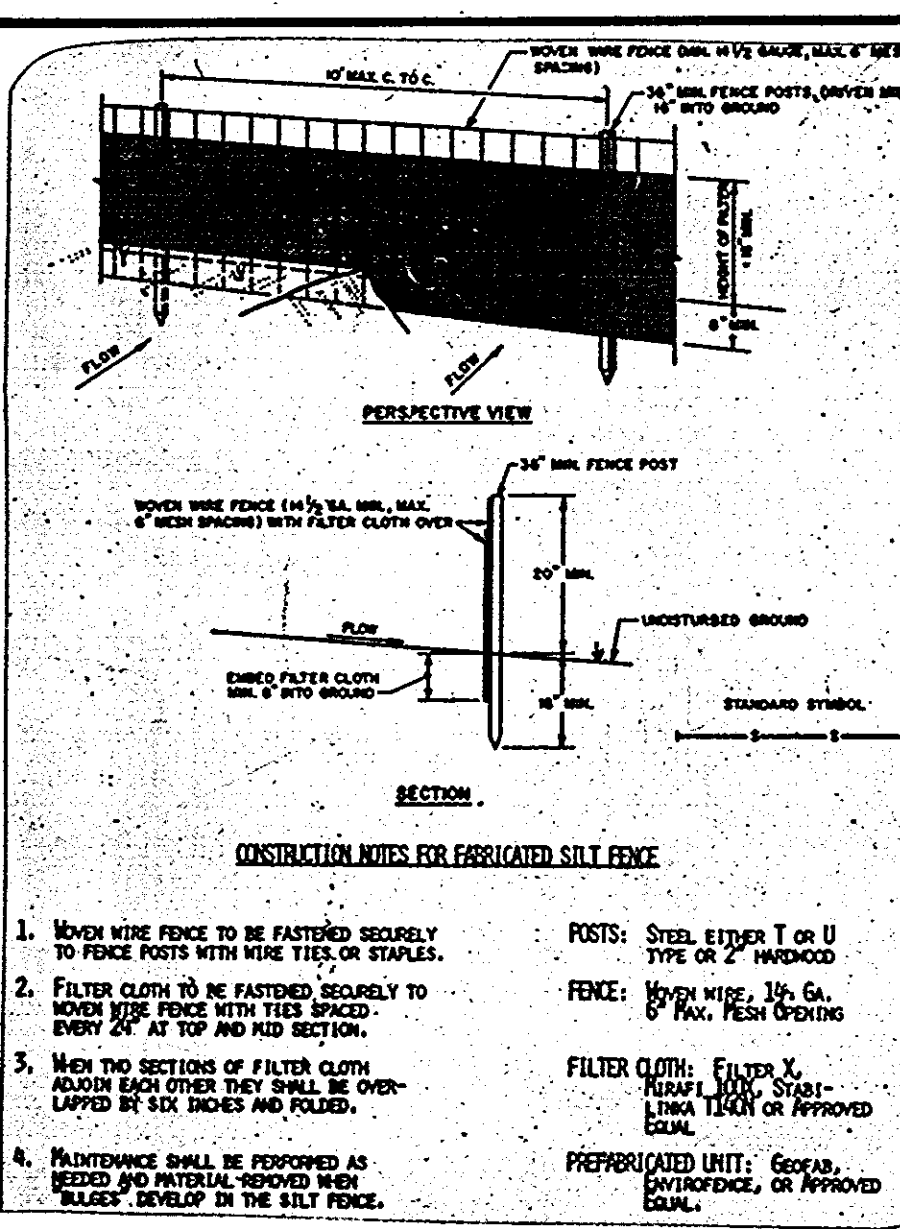

SILT FENCE
NOT TO SCALE

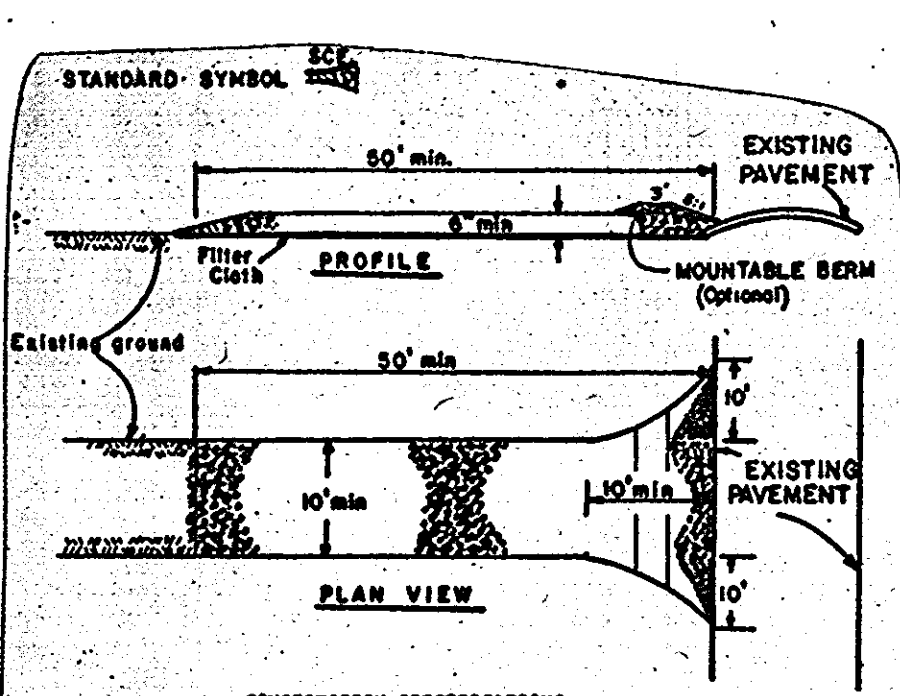

- CONSTRUCTION SPECIFICATIONS:**
- Stone size - Use 2" stone, or recycled concrete equivalent.
 - Length - As required, but not less than 50 feet (except on a single residence lot where a 30 foot minimum length would apply).
 - Thickness - Not less than six (6) inches.
 - Width - Ten (10) foot minimum, but not less than the full width at points where ingress or egress occurs.
 - Filter cloth - Will be placed over the entire area prior to placing of stone. Filter will not be required on a single family residence lot.
 - Surface water - All surface water flowing or diverted toward construction entrances shall be placed across the entrance. If piping is impractical, a removable berm with 8:1 slopes will be permitted.
 - Maintenance - The entrance shall be maintained in a condition which will prevent tracking or flowing of sediment onto public rights-of-way. This may require periodic top dressing with additional stone as conditions demand and repair and/or cleaning of any measures used to trap sediment. All sediment spilled, dropped, washed or tracked onto public rights-of-way must be removed immediately.
 - Washing - Wheels shall be cleaned to remove sediment prior to entrance onto public rights-of-way. When washing is required, it shall be done on an area stabilized with stone and which drains into an approved sediment trapping device.
 - Periodic inspection and needed maintenance shall be provided after each rain.

STABILIZED CONSTRUCTION ENTRANCE
NOT TO SCALE

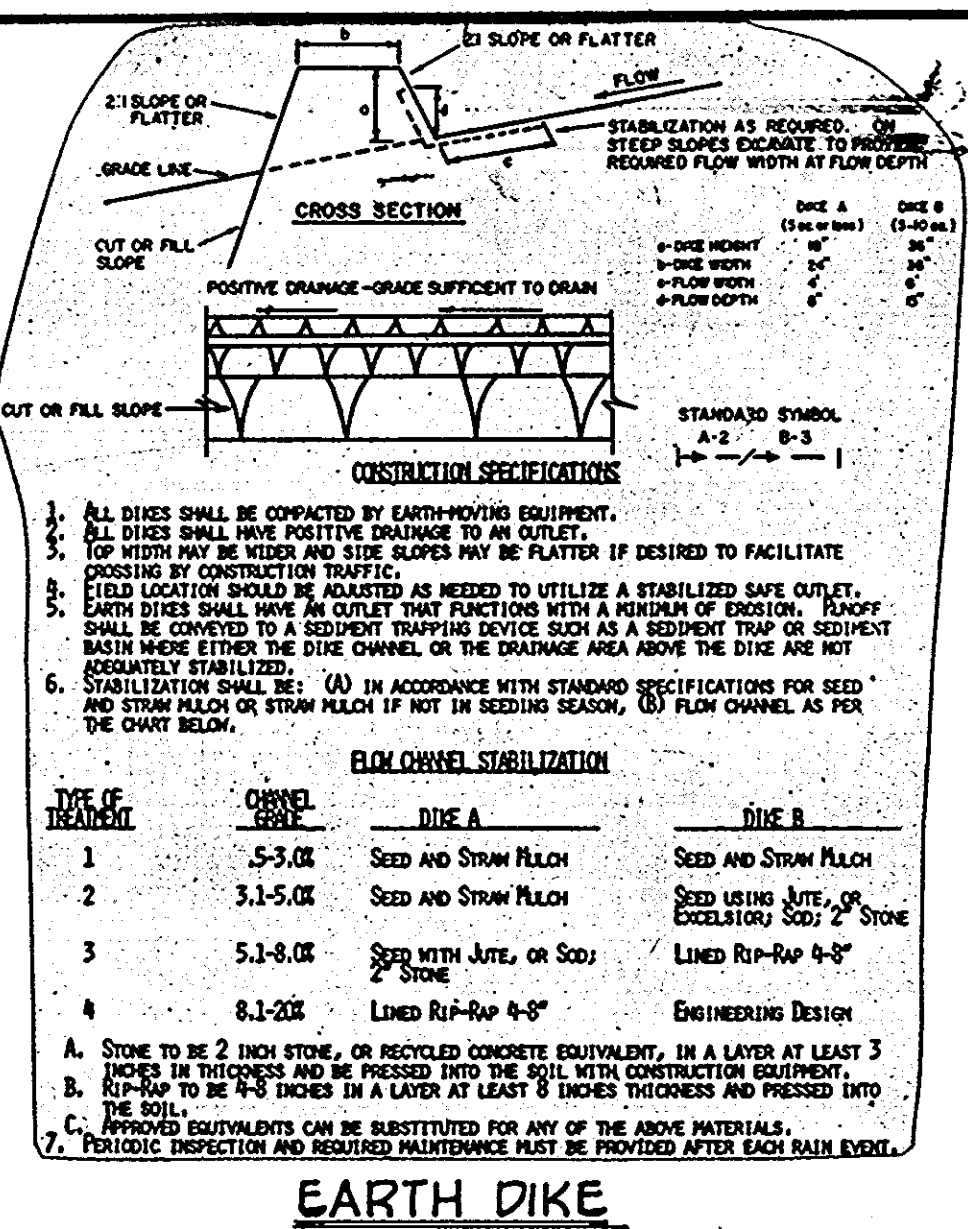
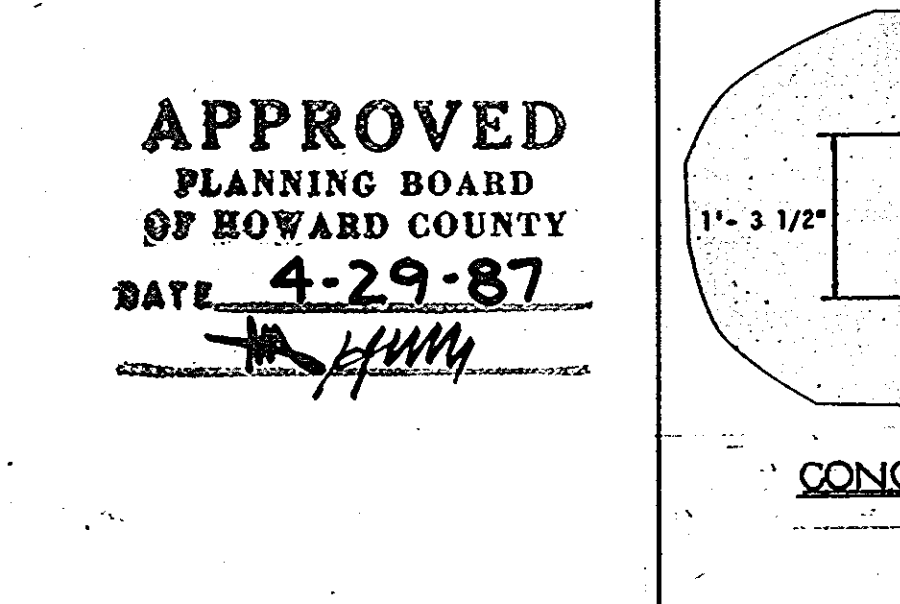
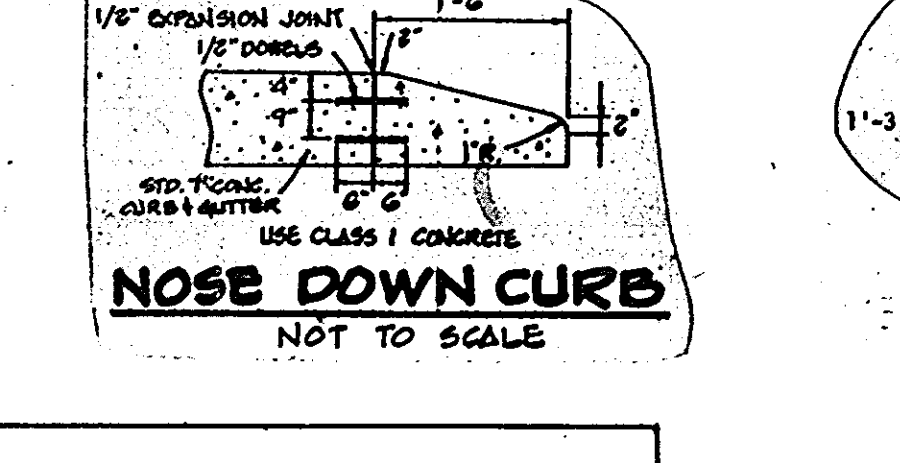

STRAW BALE DIKE
NOT TO SCALE

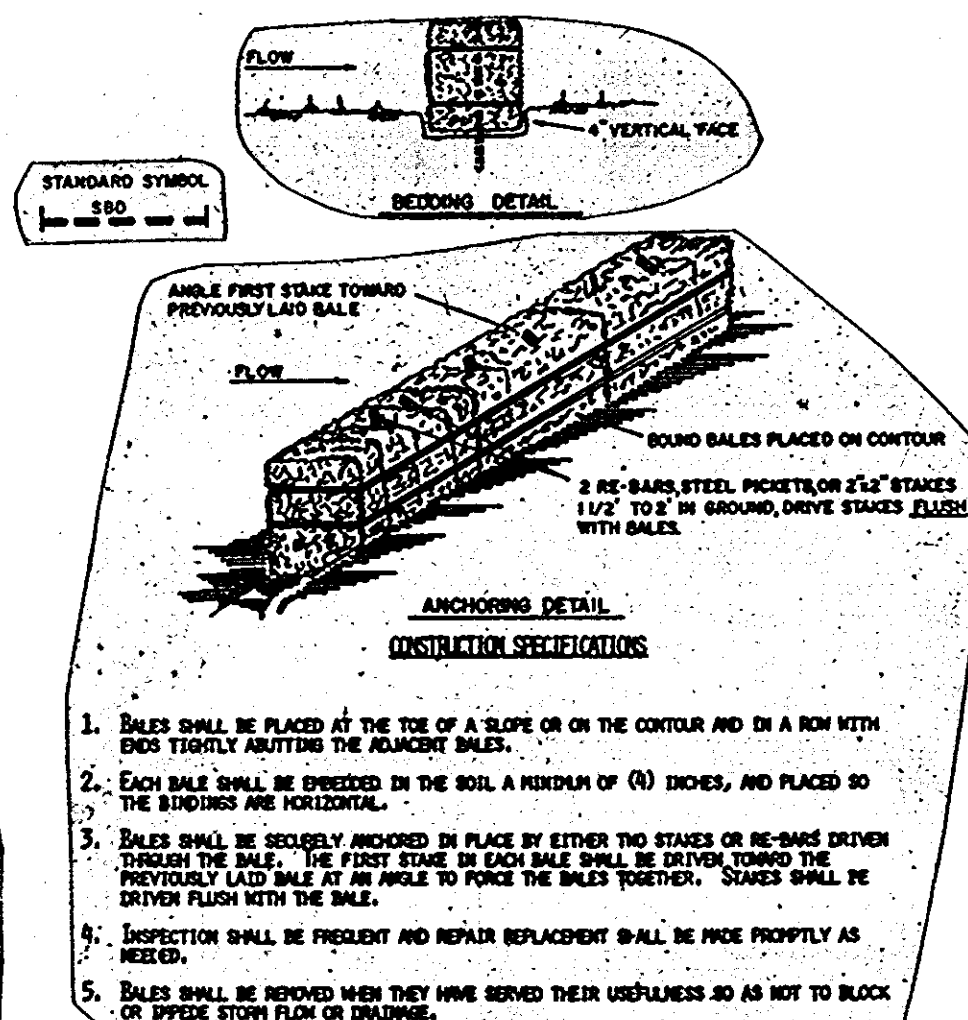

STRAW BALE DIKE
NOT TO SCALE

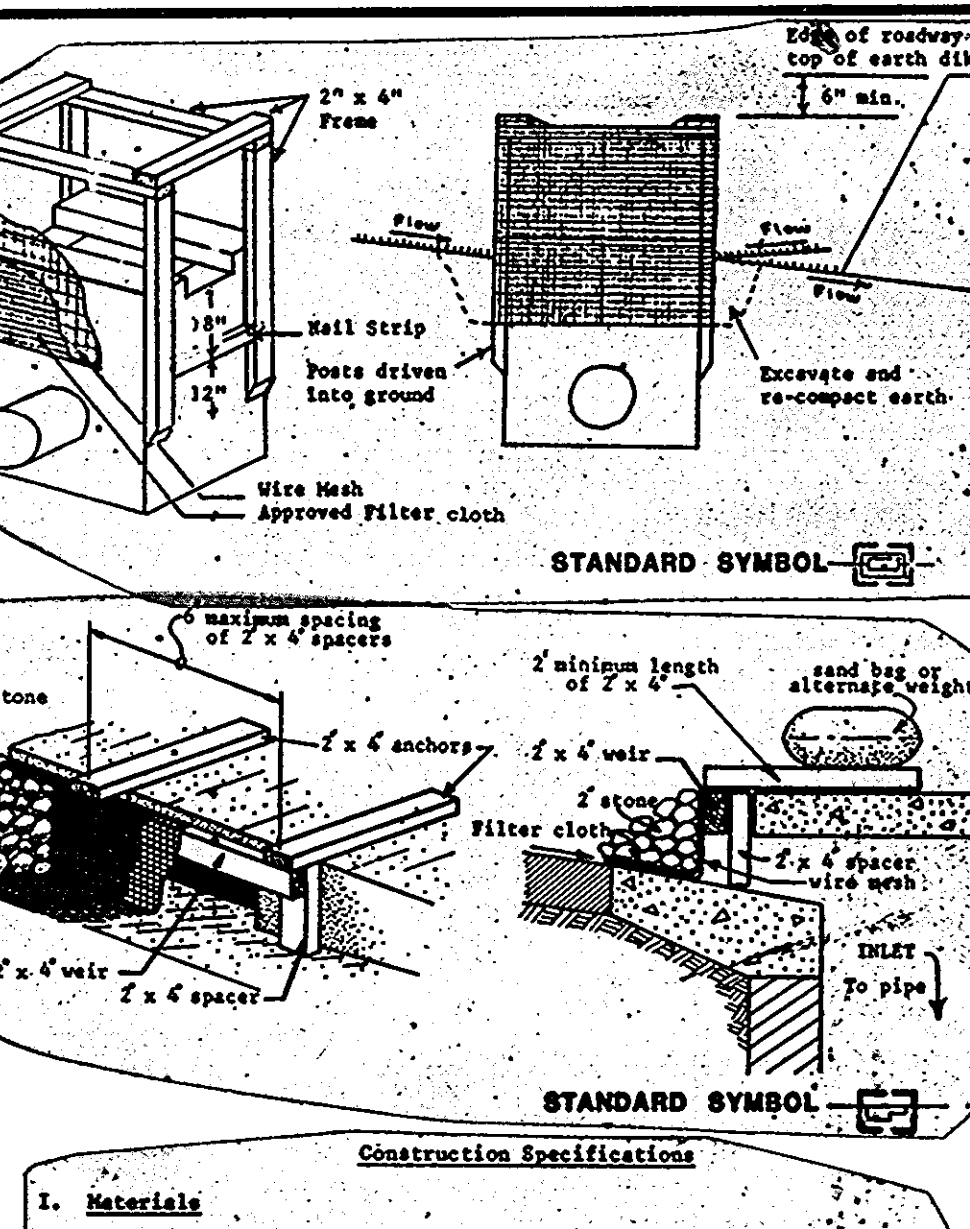
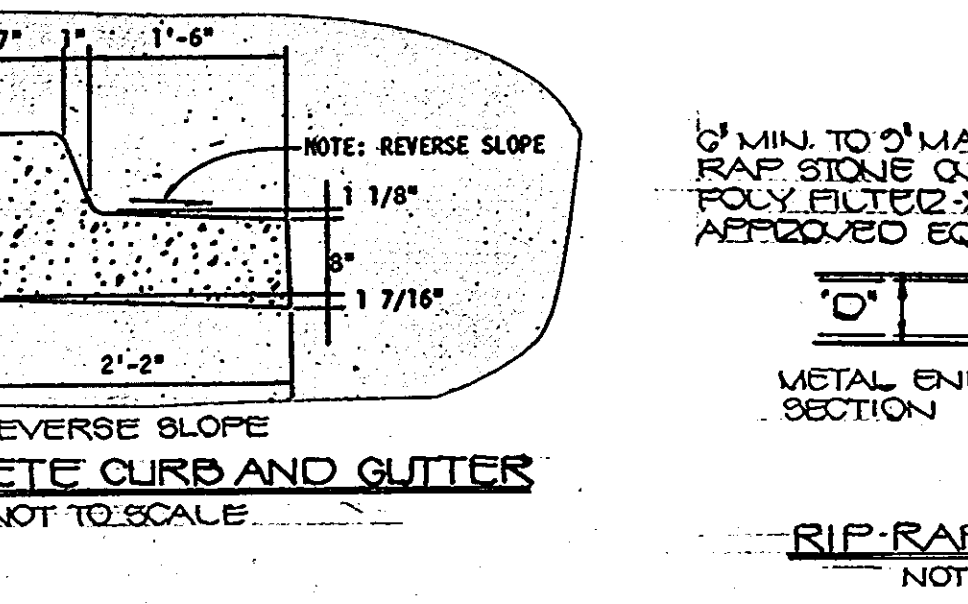
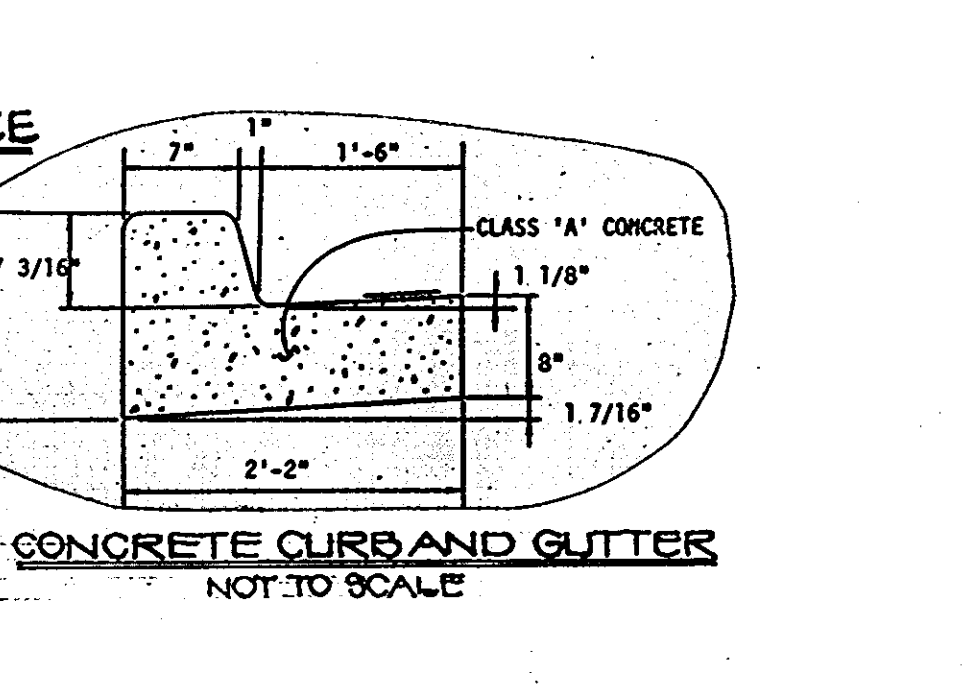

STORM DRAIN INLET PROTECTION
NOT TO SCALE

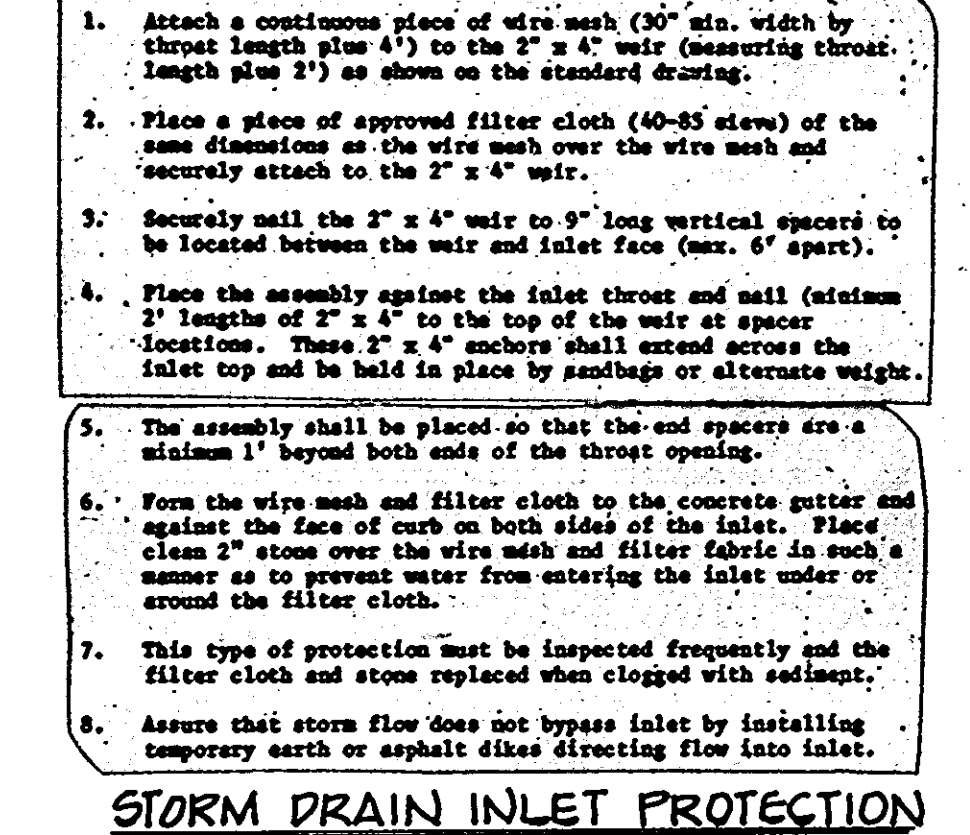
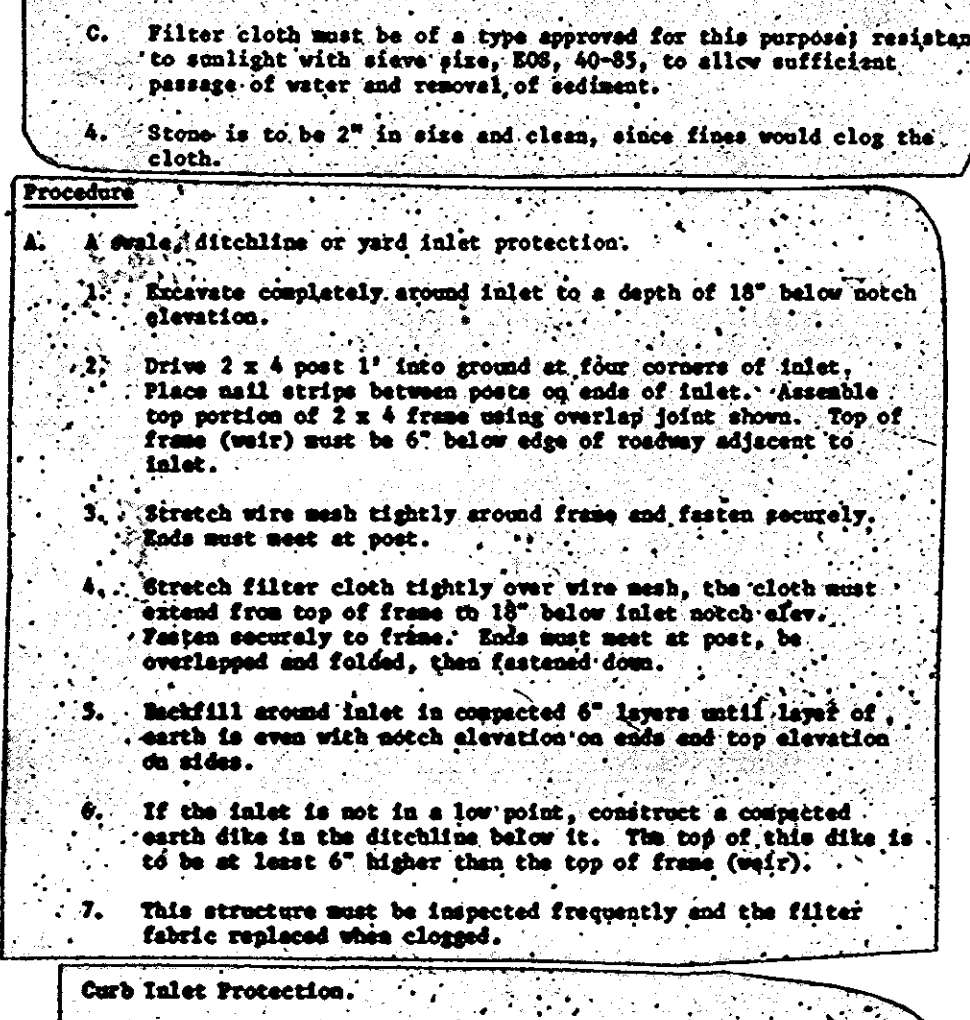

RIP-RAP OUTFALL DETAIL
NOT TO SCALE

QIP CHANNEL DATA	Q	L	W
E-1	10'	10'	5.0'
E-2	10'	10'	5'
E-3	10'	10'	7'

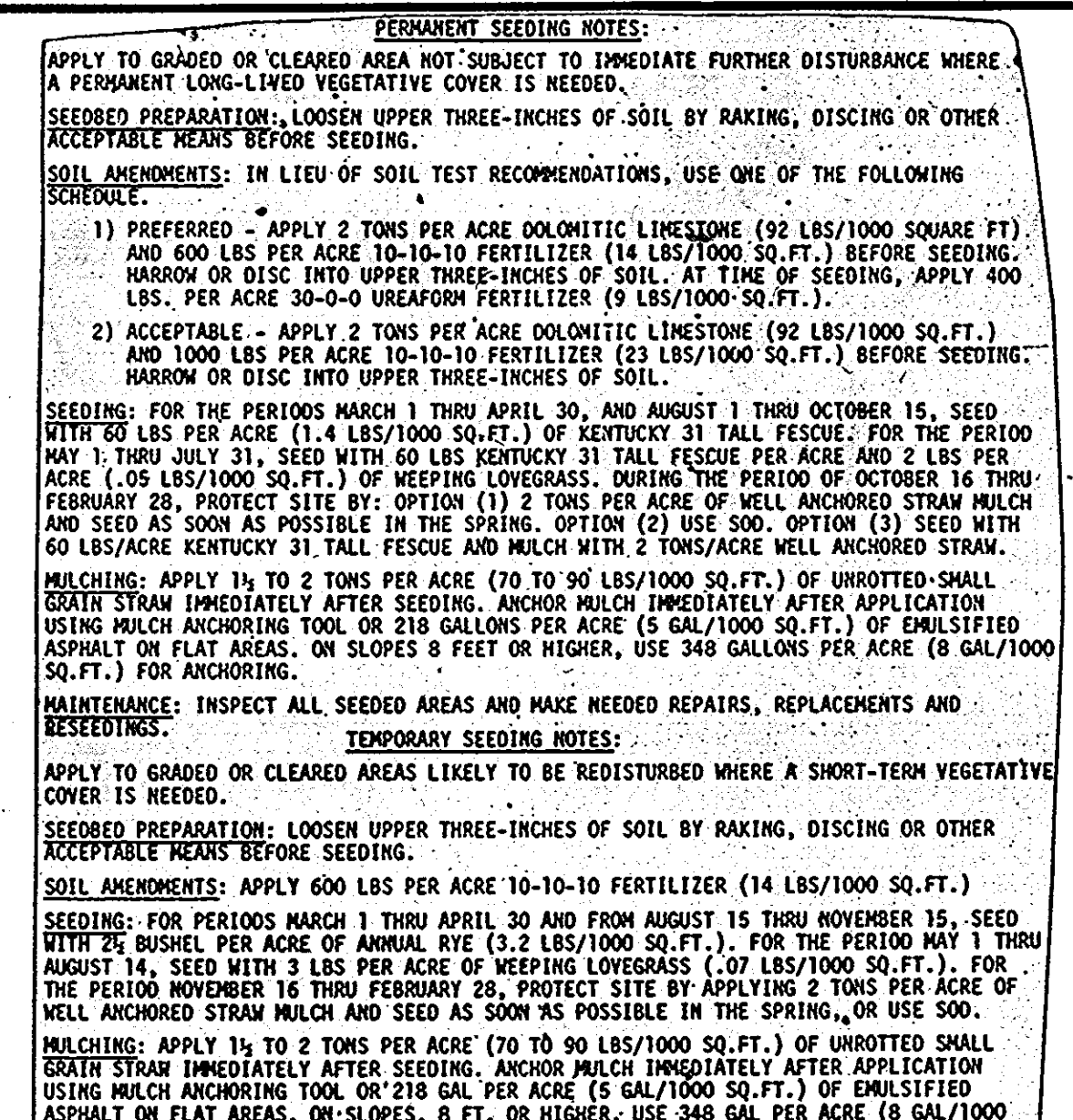

TREE PLANTING
NOT TO SCALE

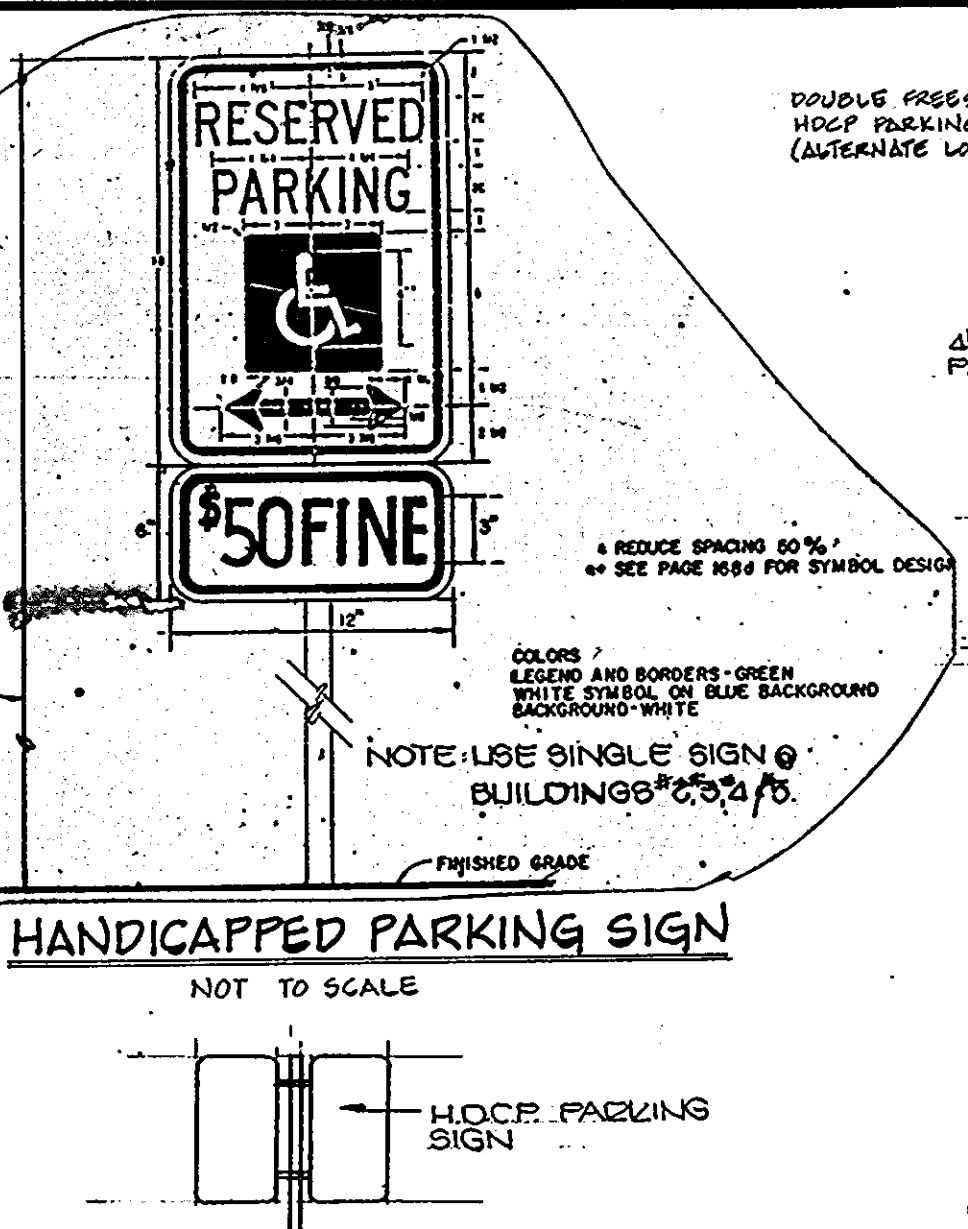
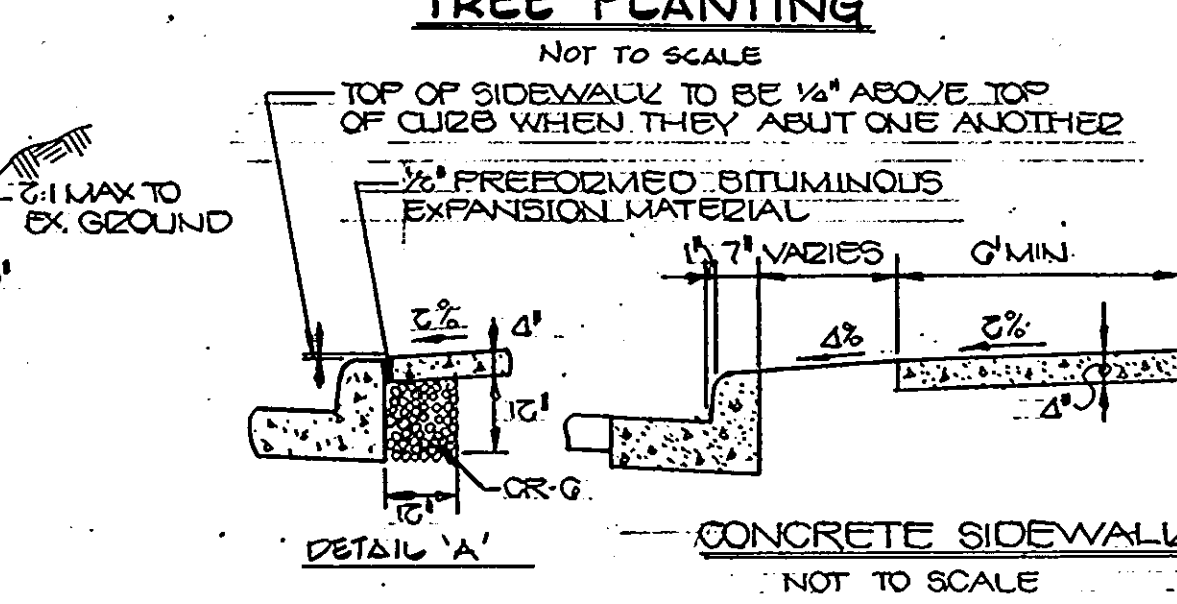
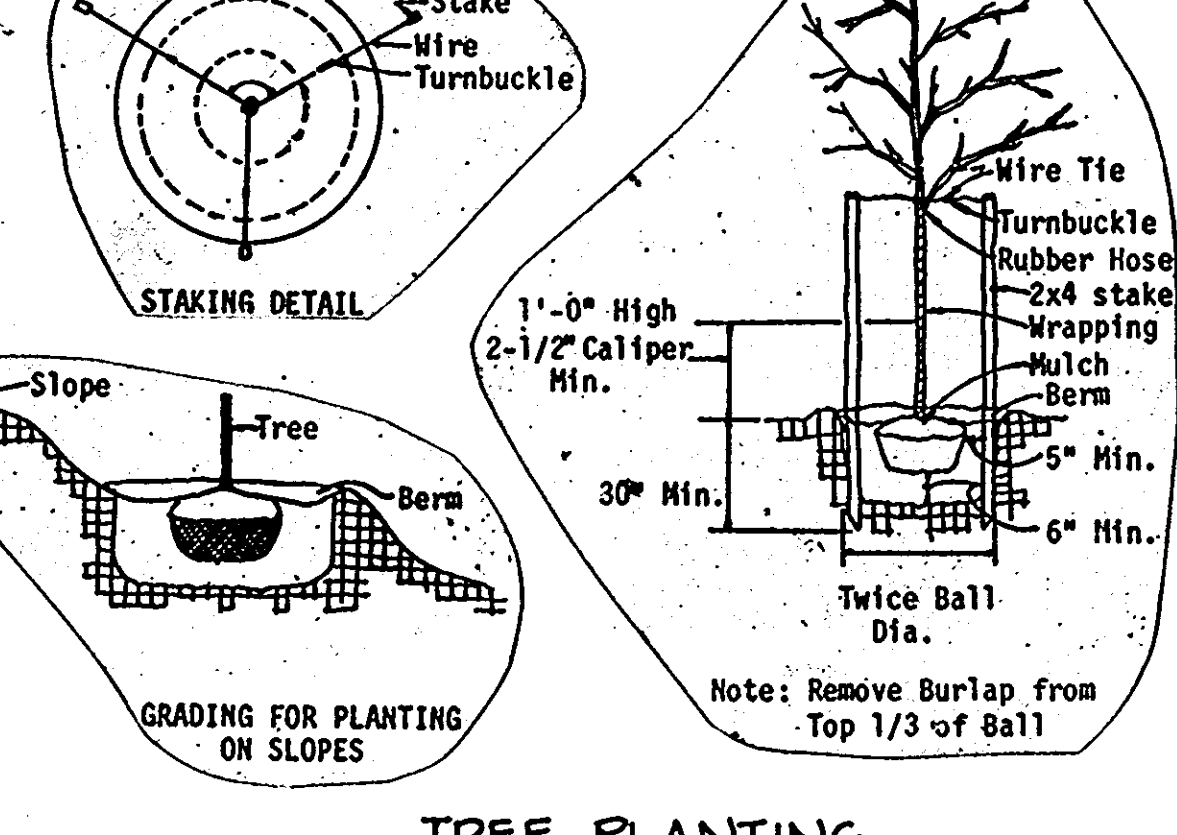
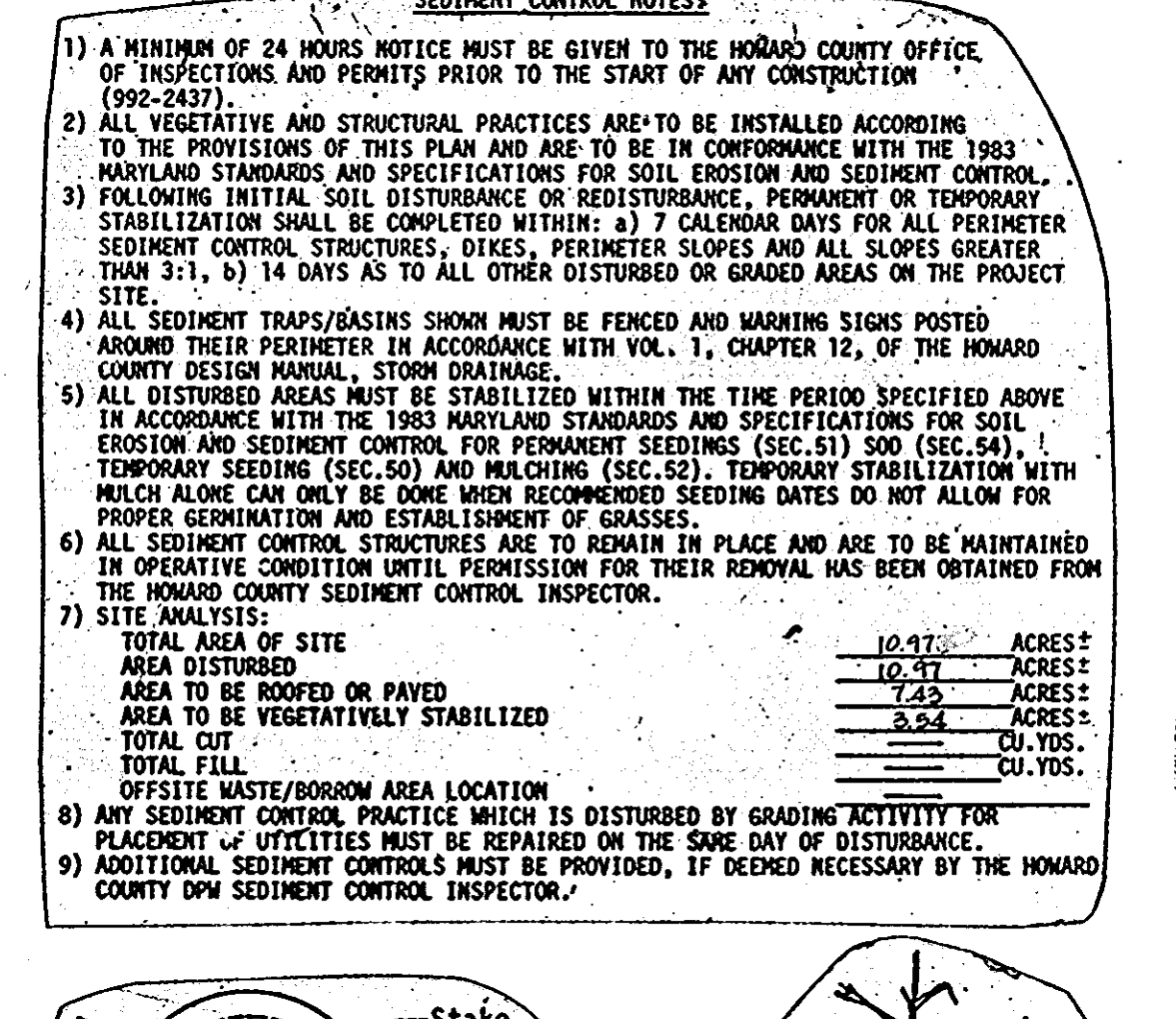

HANDICAPPED PARKING SIGN
NOT TO SCALE

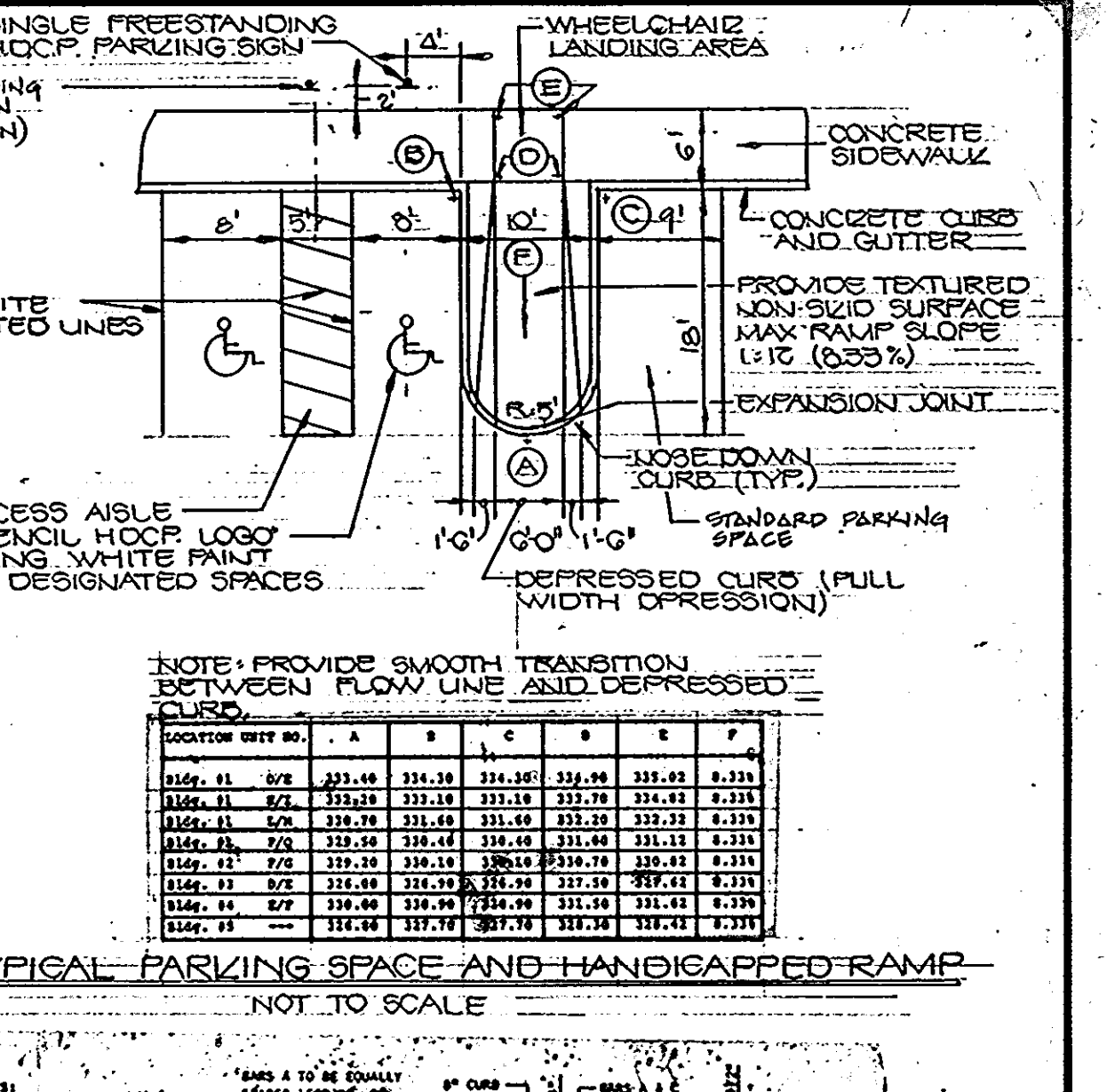
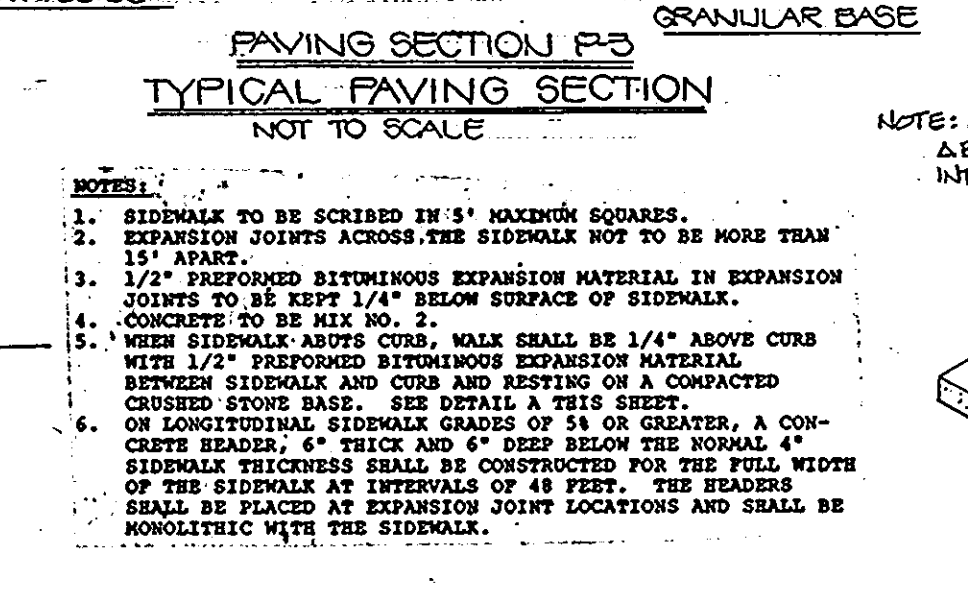
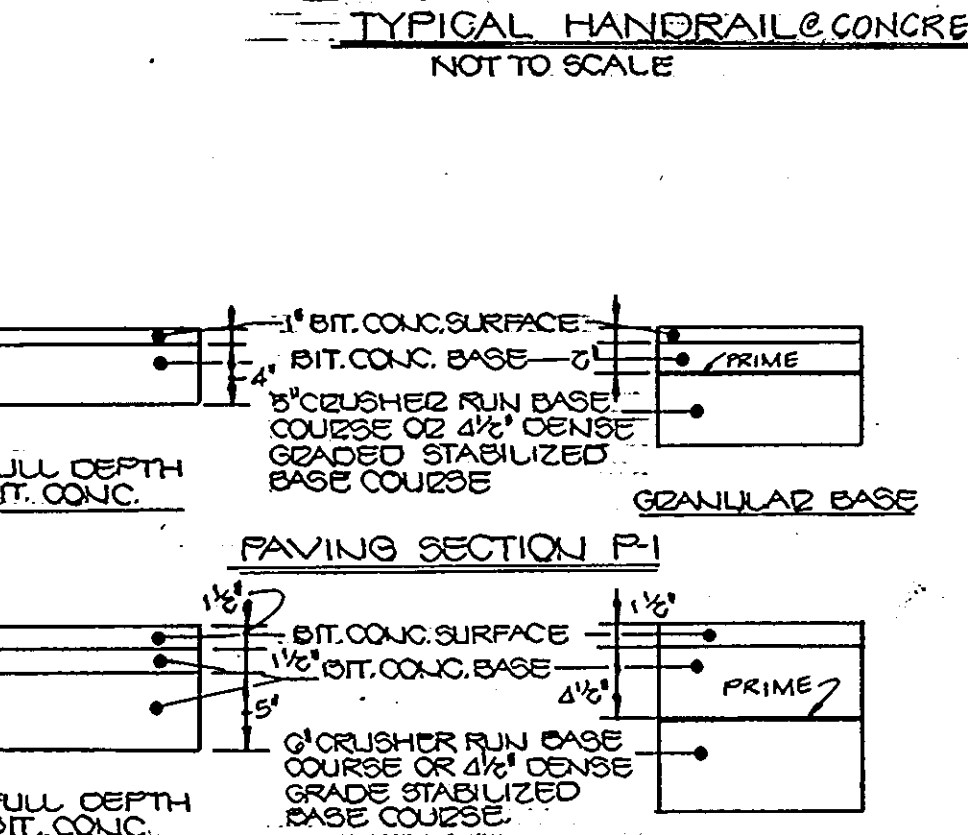
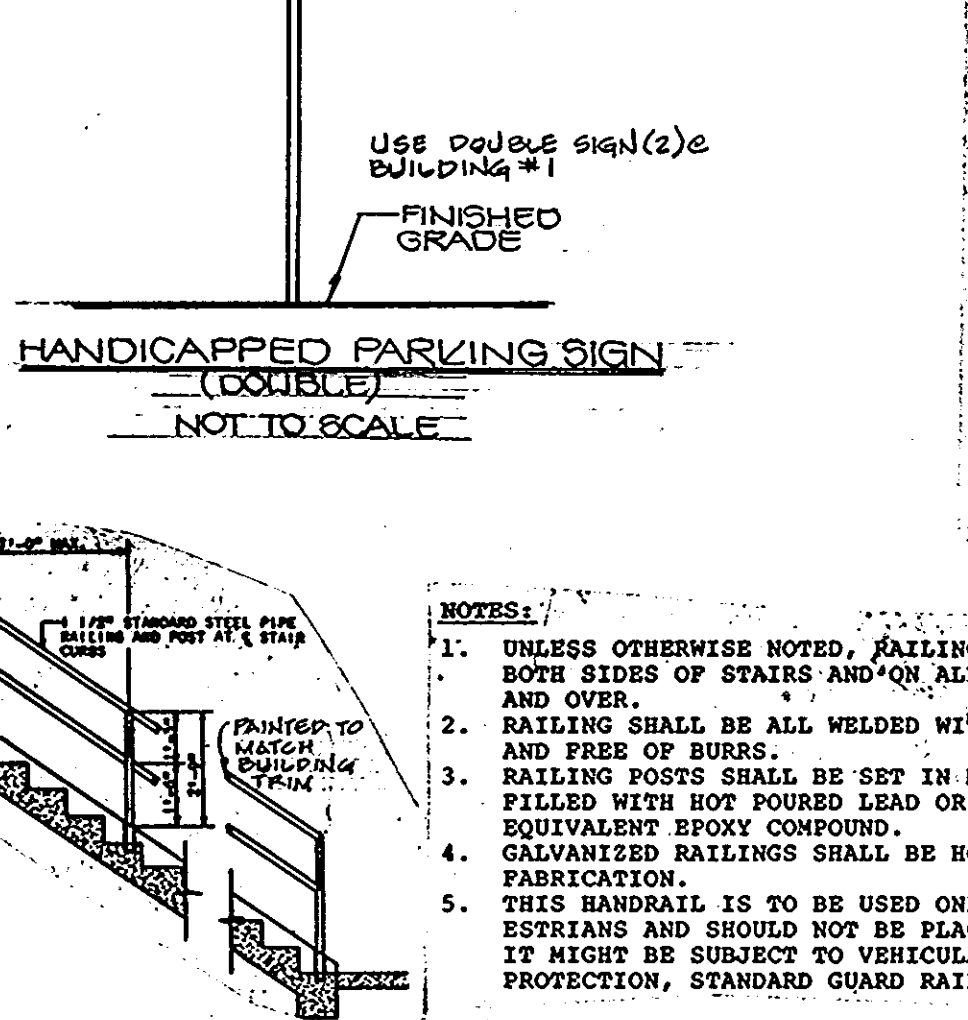

TYPICAL PARKING SPACE AND HANDICAPPED RAMP
NOT TO SCALE

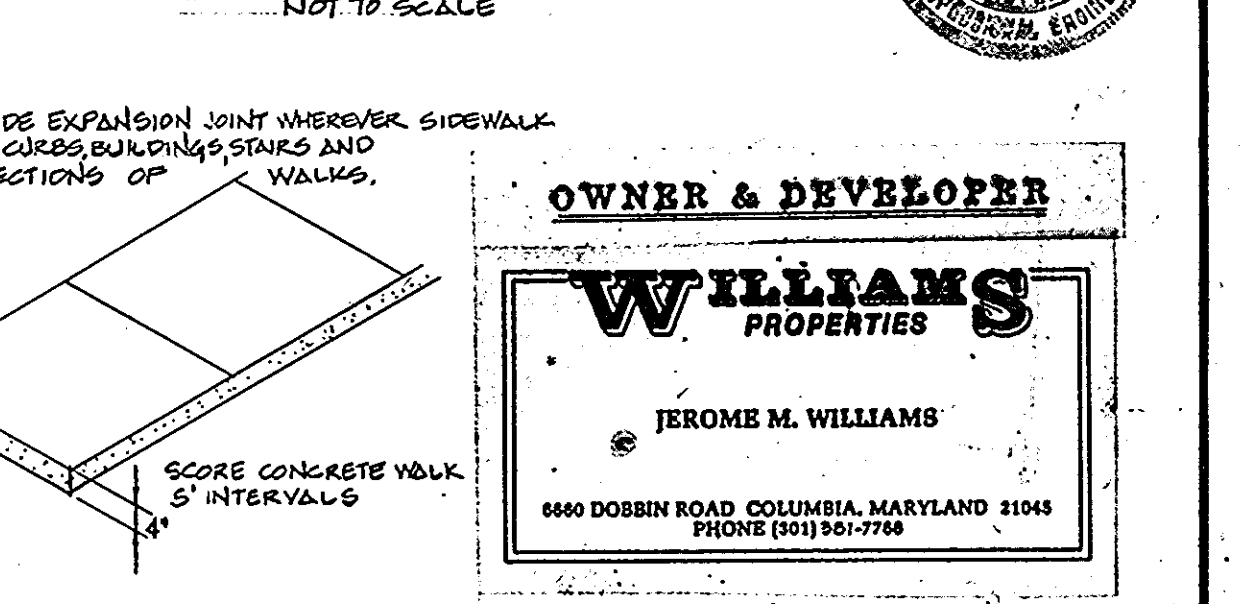
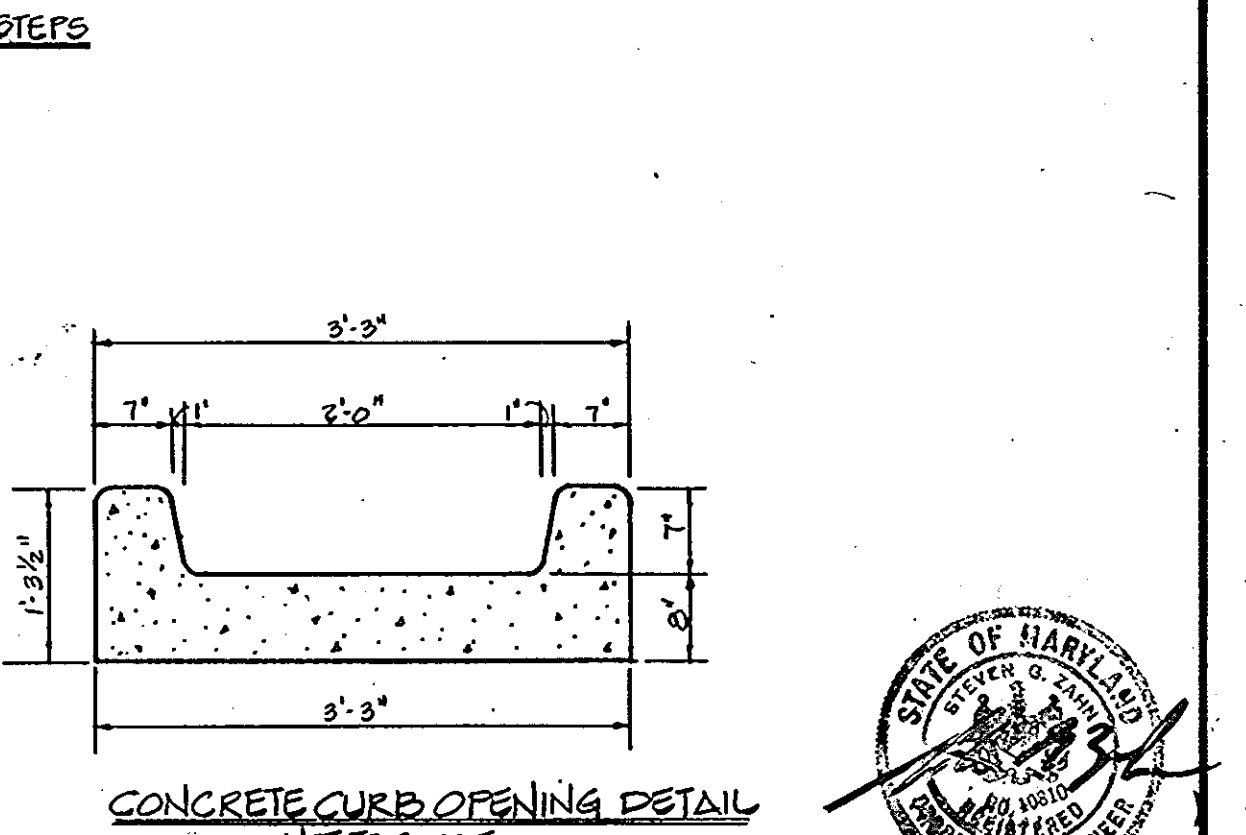
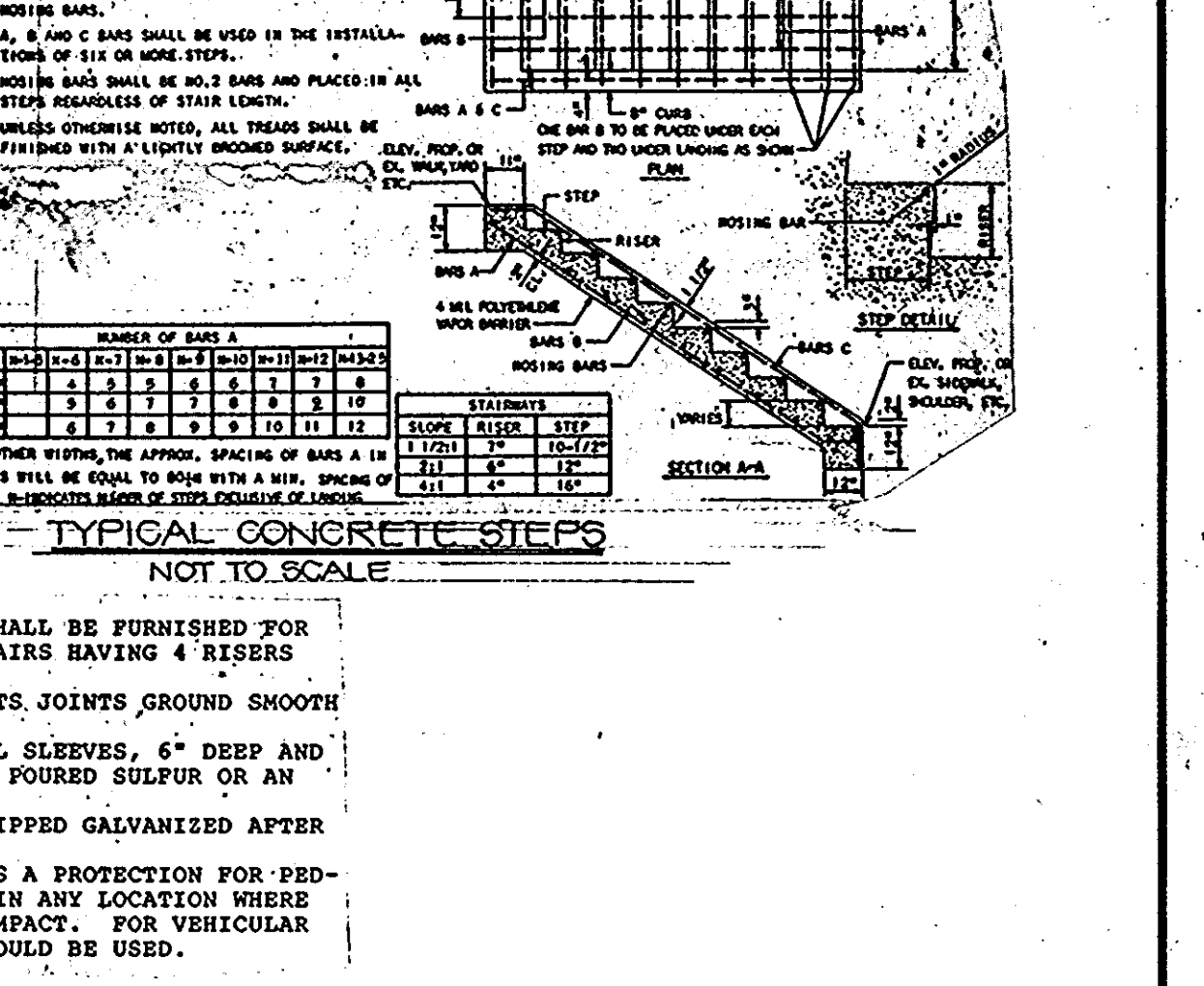

Dewberry & Davis
ARCHITECTS-ENGINEERS-PLANNERS-SURVEYORS

8800 N. RIDGE ROAD
ELLICOTT CITY MD. 21048
TEL: (301) 461-7478

ENGINEER'S CERTIFICATE

I HEREBY CERTIFY THAT THIS PLAN FOR EROSION AND SEDIMENT CONTROL REPRESENTS A PRACTICAL AND WORKABLE PLAN BASED ON MY PERSONAL KNOWLEDGE OF THE SITE CONDITIONS AND THAT IT WAS PREPARED IN ACCORDANCE WITH THE REQUIREMENTS OF THE HOWARD SOIL CONSERVATION DISTRICT.

APPROVED: [Signature] DATE 6/20/87

DEVELOPER'S CERTIFICATE

I/WE CERTIFY THAT ALL DEVELOPMENT AND CONSTRUCTION WILL BE DONE ACCORDING TO THIS PLAN OF DEVELOPMENT AND PLAN FOR EROSION AND SEDIMENT CONTROL, AND THAT ALL RESPONSIBLE PERSONNEL INVOLVED IN THE CONSTRUCTION PROJECT WILL HAVE A CERTIFICATE OF ATTENDANCE AT A DEPARTMENT OF NATURAL RESOURCES APPROVED TRAINING PROGRAM FOR THE CONTROL OF SEDIMENT AND EROSION BEFORE BEGINNING THE PROJECT. I/WE AUTHORIZE PERIODIC ON-SITE INSPECTION BY THE HOWARD SOIL CONSERVATION DISTRICT OR THEIR AUTHORIZED AGENTS, AS ARE DEEMED NECESSARY.

APPROVED: [Signature] DATE 6/24/87

REVIEWED FOR HOWARD SOIL CONSERVATION DISTRICT AND MEETS TECHNICAL REQUIREMENTS

APPROVED: [Signature] DATE 7/18/87

APPROVED: OFFICE OF PLANNING AND ZONING

APPROVED: [Signature] DATE 7-27-87

APPROVED: HOWARD COUNTY HEALTH DEPARTMENT FOR PUBLIC WATER AND SEWERAGE SYSTEMS

APPROVED: [Signature] DATE 7-27-87

APPROVED: DEPARTMENT OF PUBLIC WORKS, FOR PUBLIC WATER & SEWER AND STORM DRAINAGE SYSTEMS AND ROADS.

APPROVED: [Signature] DATE 7/21/87

SUBDIVISION	SECTION/AREA	PARCEL
EQU. SUBDIVISION	2/4	C-2

PLAT NO. 6674
BLOCK NO. 9
ZONE RT/HR
TAX/ZONE 4C
ELEC. DIST. 6TH
CENSUS TR. 6001.03
SEWER CODE 528000

NOTES AND DETAILS

COLUMBIA
EQU. SUBDIVISION
SECTION 2 AREA 4
PARCEL C-2

BROKEN LAND BUSINESS CENTER

6TH ELECTION DISTRICT HOWARD CO, MD

SCALE: AS SHOWN
REVISED: JUNE 15, 1987
NOVEMBER 11, 1986
SHEET 7 OF 8



OWNER & DEVELOPER

WILLIAMS PROPERTIES

JEROME M. WILLIAMS

6660 DOBBIN ROAD COLUMBIA, MARYLAND 21046
PHONE (301) 861-7768

