

INDEX OF SHEETS	
SHEET NO.	TITLE
1	TITLE SHEET
2	SITE DEVELOPMENT PLAN
3	SITE DEVELOPMENT PLAN
4	SITE DEVELOPMENT PLAN
5	PROFILE - 8" PRIVATE SANITARY
6	PROFILES - PRIVATE STORM DRAINS AND PRIVATE 4" WATER LINE
7	PROFILES - PRIVATE STORM DRAINS
8	NOTES AND DETAILS

- SITE ANALYSIS:
  - AREA OF PARCEL: 37.081 AC. ±
  - LIMIT OF SUBMISSION: 7.35 AC. ±
  - PRESENT ZONING: M-1 (MANUFACTURING-LIGHT)
  - BUILDING COVERAGE: 8.375 ACRES (23%)
  - OPEN SPACE (TOTAL SITE): 21.808 ACRES (59%)
  - PROPOSED USE: INTENDED USE OF BUILDING SHALL BE ESTABLISHED ON A FUTURE SITE DEVELOPMENT PLAN SUBMISSION.
  - PARKING REQUIRED: PARKING REQUIREMENTS TO BE ESTABLISHED ON A FUTURE SITE DEVELOPMENT PLAN SUBMISSION.
- PLAT REFERENCE: GC15 / GC15
- PROPERTY IS SHOWN ON TAX MAP 42 AND 43, PART OF PARCEL 587.
- THIS PLAN SUBJECT TO VP-85-34 AND VP-86-135.
- THE CONTRACTOR SHALL NOTIFY THE HOWARD COUNTY CONSTRUCTION INSPECTION/PERMITS DIVISION 24 HOURS PRIOR TO COMMENCEMENT OF WORK AT 992-2455.
- ALL PAVING AND UTILITY CONSTRUCTION SHALL BE IN ACCORDANCE WITH THE HOWARD COUNTY ROAD CONSTRUCTION CODE AND STANDARD SPECIFICATIONS.
- EXISTING UTILITIES SHOWN HEREON HAVE BEEN LOCATED FROM FIELD AND OFFICE INFORMATION. THE CONTRACTOR SHALL DETERMINE THE EXACT LOCATION OF EXISTING UTILITIES TO HIS OWN SATISFACTION BEFORE MAKING ANY CONNECTION THERETO OR EXCAVATING IN THE AREA THEREOF.
- THE CONTRACTOR SHALL NOTIFY MISS UTILITY 559-0100 A MINIMUM OF THREE DAYS PRIOR TO BEGINNING ANY CONSTRUCTION SHOWN HEREON.
- STORMWATER MANAGEMENT IS NOT REQUIRED FOR THIS SITE AS SHOWN ON THESE DRAWINGS. IN THE EVENT OF FUTURE SITE IMPROVEMENTS (BUILDING ADDITIONS, PARKING LOT ENLARGEMENT, ETC.) STORMWATER MANAGEMENT WILL BE REQUIRED FOR THOSE IMPROVEMENTS ONLY ON A FUTURE SITE DEVELOPMENT PLAN SUBMISSION.
- EXISTING UTILITY LINES WHICH ARE NOTED ON THE PLANS TO BE ABANDONED SHALL BE PLUGGED WITH A BRICK AND MORTAR BULKHEAD AT BOTH ENDS OF THE ABANDONED LINE, EXCEPT AS NOTED. ABANDONED WATER MAINS SHALL BE PROVIDED WITH A CAP AND/OR PLUG AS APPLICABLE AND BUTTRESS PER HOWARD COUNTY STANDARDS.
- THE CONTRACTOR WILL BE RESPONSIBLE FOR DETERMINING THE PRESENT STATUS OF EXISTING UTILITY DISCONNECTIONS SHOWN ON THE PLANS. IF THE ABOVE UTILITY DISCONNECTIONS HAVE NOT BEEN MADE, THE CONTRACTOR WILL BE RESPONSIBLE FOR MAKING SUCH UTILITY DISCONNECTIONS WITHIN THE LIMITS OF THE DRYER BUILDING PARCEL 'L'.
- THE CONTRACTOR WILL BE LIABLE FOR ANY AND ALL DAMAGES CAUSED BY THE CONTRACTORS NEGLIGENCE TO VERIFY AND MAKE ANY AND ALL UTILITY DISCONNECTIONS.

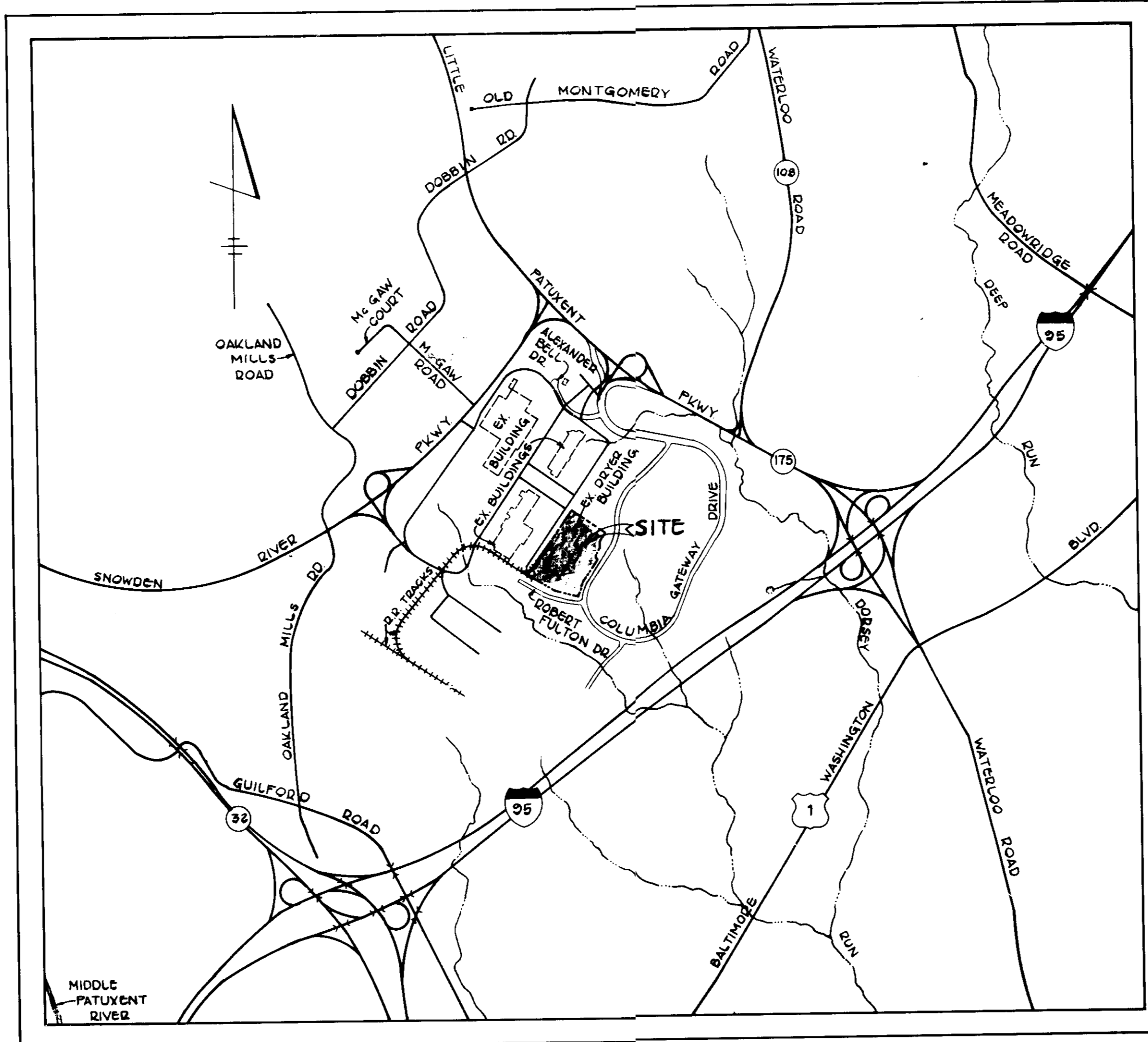

LOCATION MAP  
SCALE: 1" = 2000'

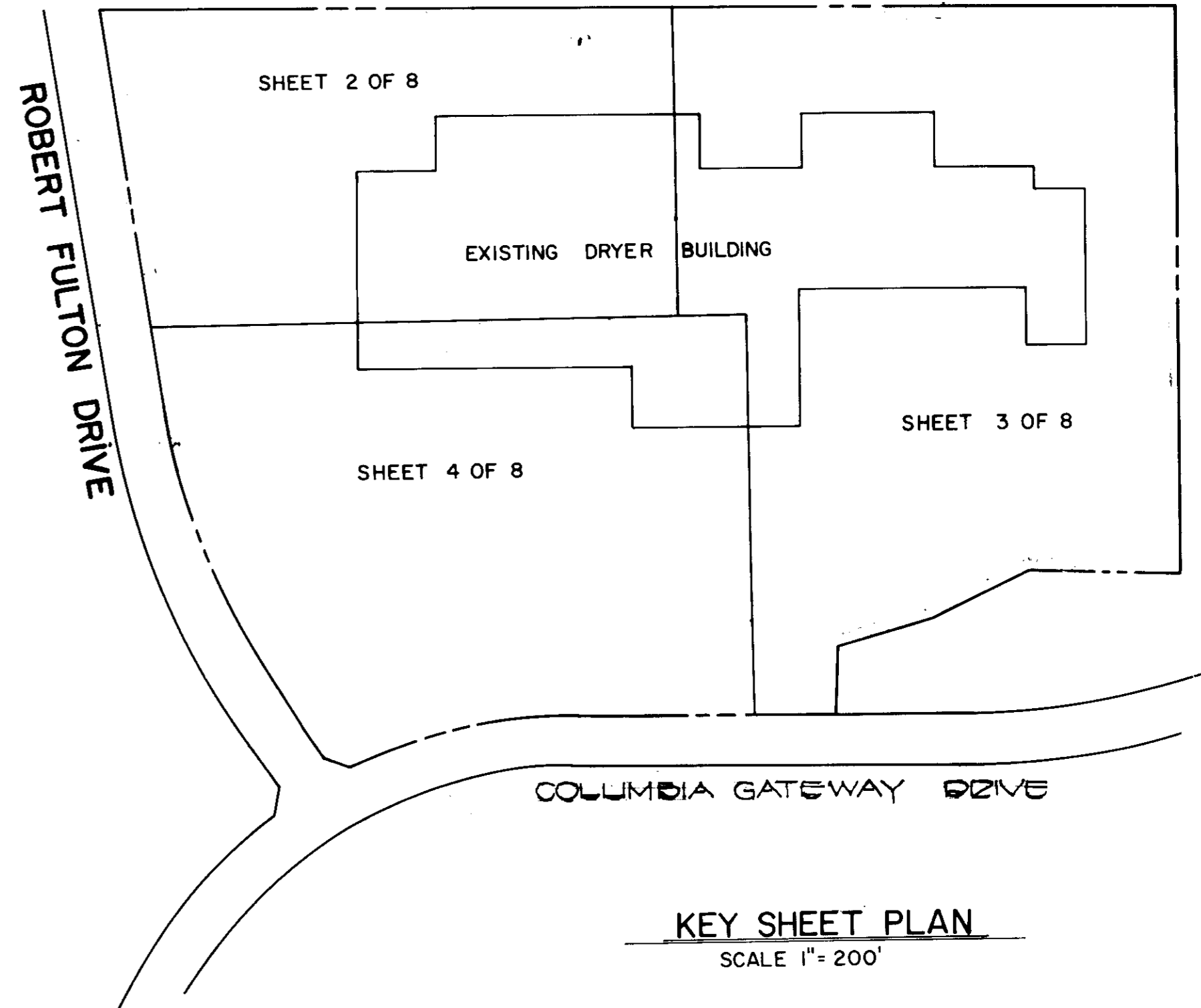

KEY SHEET PLAN  
SCALE: 1" = 200'

# COLUMBIA GATEWAY PARCEL 'L' DRYER BUILDING HOWARD COUNTY, MARYLAND

STRUCTURE SCHEDULE						
NO.	TYPE	INV. IN	INV. OUT	TOP ELEV.	REMARKS	
I-1	TYPE "D"	--	335.13	339.3		S.D. 4.11
I-2	TYPE "S"	--	336.25	344.20		S.D. 4.22
I-3	TYPE "D"	--	336.25	344.20		S.D. 4.11
I-4	TYPE "S"	--	343.15	348.6		S.D. 4.22
I-5	TYPE "S"	--	343.15	348.6		S.D. 4.22
I-6	TYPE "S"	334.73	334.48	346.5		S.D. 4.22
MH-1	STANDARD MANHOLE (5'-0")	329.37	329.37	350.0		6.5.02
MH-2	STANDARD MANHOLE (5'-0")	329.96	329.46	350.0		6.5.02
MH-3	STANDARD MANHOLE (5'-0")	338.50	337.19	349.8		6.5.02
MH-4	STANDARD MANHOLE (5'-0")	343.31	338.97	350.9		6.5.02
MH-5	STANDARD MANHOLE (5'-0")	341.55	340.30	350.3		6.5.02
MH-6	STANDARD MANHOLE (5'-0")	342.57	341.12	349.8		6.5.02
MH-7	STANDARD MANHOLE (5'-0")	344.10	343.85	350.6		6.5.01
MH-8	STANDARD MANHOLE (5'-0")	344.10	343.85	350.6		6.5.01
MH-9	STANDARD MANHOLE (4'-0")	344.10	343.85	350.6		6.5.01
MH-10	STANDARD MANHOLE (4'-0")	344.10	343.85	350.6		6.5.01
MH-11	STANDARD MANHOLE (4'-0")	343.00	342.80	350.0		6.5.01
MH-12	STANDARD MANHOLE (5'-0")	342.33	341.73	349.8		6.5.02
MH-13	STANDARD MANHOLE (5'-0")	328.69	328.59	346.0		6.5.02
MH-14	STANDARD MANHOLE (4'-0")	336.34	336.24	330.1		6.5.01

ADDRESS CHART		
PARCEL NO.	STREET	ADDRESS
L	DRYER BLDG	725 COLUMBIA GATEWAY DRIVE

NOTE: THE PURPOSE OF THIS SITE DEVELOPMENT PLAN IS FOR PRIVATE ON-SITE UTILITY RELOCATIONS, CONNECTIONS AND THE CONSTRUCTION OF ON-SITE ENTRANCE ROADS ONLY-NOT FOR USE OR OCCUPANCY OF THE EXISTING BUILDING.

OWNER & DEVELOPER  
THE HOWARD RESEARCH & DEVELOPMENT CORPORATION  
10275 LITTLE PATUXENT PARKWAY  
COLUMBIA, MD. 21044  
TELE: (301) 992-6000

7-1-86  
*[Signature]*  
FISHER, COLLINS & CARTER, INC.  
CIVIL ENGINEERS & LAND SURVEYORS  
8388 COURT AVENUE  
ELLCOTT CITY, MARYLAND 21043  
(301) 461-2855

*Charles Cook*  
SIGNATURE OF ENGINEER  
7/25/86  
DATE

CHANGES TO STRUCTURE SCHEDULE		DATE
NO.	BY	DATE
1	D.A.N.	4-2-87

DEVELOPER'S CERTIFICATE  
"I/WE CERTIFY THAT ALL DEVELOPMENT AND CONSTRUCTION WILL BE DONE ACCORDING TO THIS PLAN OF DEVELOPMENT AND PLAN FOR EROSION AND SEDIMENT CONTROL AND THAT ALL RESPONSIBLE PERSONNEL INVOLVED IN THE CONSTRUCTION PROJECT WILL HAVE A CERTIFICATE OF ATTENDANCE AT A DEPARTMENT OF NATURAL RESOURCES APPROVED TRAINING PROGRAM FOR THE CONTROL OF SEDIMENT AND EROSION BEFORE BEGINNING THE PROJECT. I ALSO AUTHORIZE PERIODIC ONSITE INSPECTION BY THE HOWARD SOIL CONSERVATION DISTRICT OR THEIR AUTHORIZED AGENTS, AS ARE DEEMED NECESSARY."  
*John H. Nig*  
SIGNATURE OF DEVELOPER  
7-25-86  
DATE

REVIEWED FOR HOWARD SOIL CONSERVATION DISTRICT AND MEETS TECHNICAL REQUIREMENTS  
U.S. SOIL CONSERVATION SERVICE  
DATE  
THIS DEVELOPMENT IS APPROVED FOR EROSION AND SEDIMENT CONTROL BY THE HOWARD SOIL CONSERVATION DISTRICT.  
APPROVED:  
DISTRICT  
HOWARD SOIL CONSERVATION DISTRICT  
DATE

APPROVED: OFFICE OF PLANNING AND ZONING  
PLANNING DIRECTOR  
DATE  
CHIEF, DIVISION OF LAND DEVELOPMENT AND ZONING ADMINISTRATION  
APPROVED: HOWARD COUNTY HEALTH DEPARTMENT FOR PUBLIC WATER AND SEWERAGE SYSTEMS  
HEALTH OFFICER  
DATE

APPROVED: DEPARTMENT OF PUBLIC WORKS FOR PUBLIC WATER & SEWER AND STORM DRAINAGE SYSTEMS AND ROADS.  
DIRECTOR, PUBLIC WORKS  
DATE  
CHIEF, BUREAU OF ENGINEERING  
DATE  
SUBDIVISION  
COLUMBIA GATEWAY - DRYER BUILDING  
SECTION/AREA  
PARCEL  
PLAT NOS. BLOCK NO. ZONE TAX/ZONE ELEC. DIST. CENSUS TR.  
WATER CODE SEWER CODE

TITLE SHEET  
COLUMBIA GATEWAY  
PARCEL 'L'  
DRYER BUILDING  
TAX MAPS NO. 42 & 43  
SIXTH ELECTION DISTRICT  
HOWARD COUNTY, MARYLAND  
SCALE: AS SHOWN MAY 27, 1986  
SHEET 1 OF 8  
REVISED JULY 7, 1986  
SOP 00-200

PAVING LEGEND

- NEW PAVING
- PAVING RESURFACE COURSE (AS REQUIRED BY SITE CONDITIONS)
- EXISTING PAVING TO BE REMOVED

GENERAL ELECTRIC COMPANY  
APPLIANCE PARK EAST  
PARCEL 'L'  
PLAT # 0012 / 0013  
ZONE B-D-M-1

SEE SHEET 5 OF 8 FOR 8 INCH SEWER MAIN PROFILES

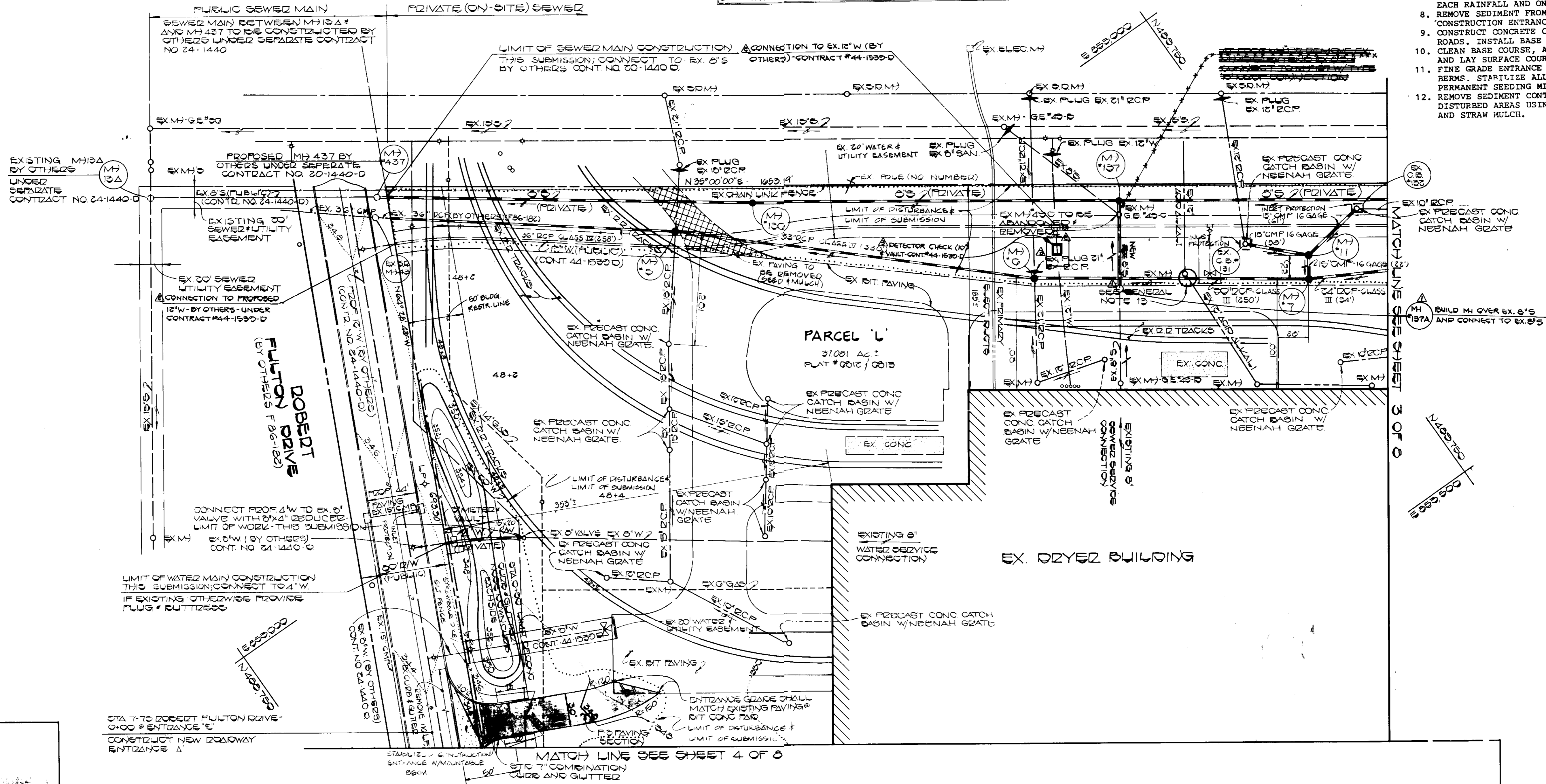

CONSTRUCTION SEQUENCE:

1. OBTAIN GRADING PERMIT.
2. CONSTRUCT STABILIZED CONSTRUCTION ENTRANCES AS SHOWN ON PLAN.
3. INSTALL STRAW BALE DIKE OR SILT FENCE AS SHOWN ON PLAN.
4. BEGIN PAVEMENT REMOVAL OF EXISTING MACADAM. BEGIN STORM DRAIN CONSTRUCTION. PROVIDE INLET PROTECTION AT ALL INLETS UPON COMPLETION OF INLET CONSTRUCTION.
5. BEGIN UTILITY CONSTRUCTION AND EXISTING UTILITY DISCONNECTIONS. THE CONTRACTOR SHALL PLACE STRAW BALE DIKES OR SILT FENCE DOWNGRADE OF ANY DISTURBED AREA AT THE END OF EACH WORKING DAY DURING ALL UTILITY CONSTRUCTION (INCLUDING STORM DRAINS).
6. GRADE ENTRANCE ROADS TO SUBGRADE START CONSTRUCTION OF LANDSCAPE BERMS.
7. THE CONTRACTOR SHALL INSPECT AND PROVIDE NECESSARY MAINTENANCE ON THE SEDIMENT AND EROSION CONTROL STRUCTURES SHOWN HEREON, AFTER EACH RAINFALL AND ON A DAILY BASIS.
8. REMOVE SEDIMENT FROM ROADWAYS AND DRESS STABILIZED CONSTRUCTION ENTRANCES AS REQUIRED.
9. CONSTRUCT CONCRETE CURB AND GUTTER AT ENTRANCE ROADS. INSTALL BASE COURSE.
10. CLEAN BASE COURSE. APPLY TACK COAT TO BASE COURSE AND LAY SURFACE COURSE.
11. FINE GRADE ENTRANCE ROAD SHOULDERS AND LANDSCAPE BERMS. STABILIZE ALL DISTURBED AREAS USING PERMANENT SEEDING MIXTURE AND STRAW MULCH.
12. REMOVE SEDIMENT CONTROL MEASURES AND STABILIZE DISTURBED AREAS USING PERMANENT SEEDING MIXTURE AND STRAW MULCH.

PLAN  
1"=50'

NO.	BY	REVISION	DATE
1	D.A.N.	ADD WATER VAULT.	4-2-87
2	D.A.N.	ADD 12" W. CONNECTION.	4-2-87
3	D.A.N.	ADD MH #137A.	4-2-87

NOTE: THE PURPOSE OF THIS SITE DEVELOPMENT PLAN IS FOR PRIVATE ON-SITE UTILITY RELOCATIONS, CONNECTIONS AND THE CONSTRUCTION OF ON-SITE ENTRANCE ROADS ONLY-NOT FOR USE OR OCCUPANCY OF THE EXISTING BUILDING.

OWNER & DEVELOPER  
THE HOWARD RESEARCH & DEVELOPMENT CORPORATION  
10275 LITTLE PATUXENT PARKWAY  
COLUMBIA, MD. 21044  
TELE: (301) 992-6000

FISHER, COLLINS & CARTER, INC.  
CIVIL ENGINEERS & LAND SURVEYORS  
8388 COURT AVENUE  
ELLCOTT CITY, MARYLAND 21043  
(301) 461-2855

ENGINEER'S CERTIFICATE  
I HEREBY CERTIFY THAT THIS PLAN FOR EROSION AND SEDIMENT CONTROL REPRESENTS A PRACTICAL AND WORKABLE PLAN BASED ON MY PERSONAL KNOWLEDGE OF THE SITE CONDITIONS AND THAT IT WAS PREPARED IN ACCORDANCE WITH THE REQUIREMENTS OF THE HOWARD SOIL CONSERVATION DISTRICT.  
*Charles Conch*  
SIGNATURE OF ENGINEER  
7/25/86  
DATE

DEVELOPER'S CERTIFICATE  
"I/WE CERTIFY THAT ALL DEVELOPMENT AND CONSTRUCTION WILL BE DONE ACCORDING TO THIS PLAN OF DEVELOPMENT AND PLAN FOR EROSION AND SEDIMENT CONTROL AND THAT ALL RESPONSIBLE PERSONNEL INVOLVED IN THE CONSTRUCTION PROJECT WILL HAVE A CERTIFICATE OF ATTENDANCE AT A DEPARTMENT OF NATURAL RESOURCES APPROVED TRAINING PROGRAM FOR THE CONTROL OF SEDIMENT AND EROSION BEFORE BEGINNING THE PROJECT. I ALSO AUTHORIZE PERIODIC ONSITE INSPECTION BY THE HOWARD SOIL CONSERVATION DISTRICT OR THEIR AUTHORIZED AGENTS, AS ARE DEEMED NECESSARY."  
*John L. Fulen*  
SIGNATURE OF DEVELOPER  
7-25-86  
DATE

REVIEWED FOR HOWARD SOIL CONSERVATION DISTRICT AND MEETS TECHNICAL REQUIREMENTS  
U.S. SOIL CONSERVATION SERVICE  
DATE: 8-18-86  
APPROVED: *John L. Fulen*  
DISTRICT: HOWARD SOIL CONSERVATION DISTRICT  
DATE: 8-18-86

APPROVED: OFFICE OF PLANNING AND ZONING  
PLANNING DIRECTOR: *John L. Fulen*  
DATE: 8-18-86  
CHIEF, DIVISION OF LAND DEVELOPMENT AND ZONING ADMINISTRATION  
APPROVED: HOWARD COUNTY HEALTH DEPARTMENT FOR PUBLIC WATER AND SEWERAGE SYSTEMS  
HEALTH OFFICER: *John L. Fulen*  
DATE: 8-15-86

APPROVED: DEPARTMENT OF PUBLIC WORKS, FOR PUBLIC WATER & SEWER AND STORM DRAINAGE SYSTEMS AND ROADS.  
DIRECTOR, PUBLIC WORKS: *John L. Fulen*  
DATE: 8-13-86  
CHIEF, BUREAU OF ENGINEERING: *John L. Fulen*  
DATE: 8-13-86  
SUBDIVISION: COLUMBIA GATEWAY - DRYER BUILDING  
SECTION/AREA: 'L'  
PARCEL: 'L'  
PLAT NOB: 0012/0013  
BLOCK NO: 04/07  
ZONE: M-1  
TAX/ZONE: 42.443  
ELEC. DIST.: 6th  
CENSUS TR.: 000000  
WATER CODE: 0-00  
SEWER CODE: 0000000

SITE DEVELOPMENT PLAN  
COLUMBIA GATEWAY  
PARCEL 'L'  
DRYER BUILDING  
TAX MAPS NO. 42443  
SIXTH ELECTION DISTRICT  
HOWARD COUNTY, MARYLAND  
SCALE: 1"=50'  
MAY 27, 1986  
SHEET 2 OF 8  
REVISED: JULY 7, 1986  
S.D.P. 80-280

NO.	BY	REVISION	DATE
1	D.A.N.	CHANGE STORM DRAINS	4-2-87
2	D.A.N.	ADD WATER CONTRACT NOTES	4-2-87
3	D.A.N.	ADD WATER VALVE	4-2-87
4	D.A.N.	ADD WATER VAULTS	4-2-87

- PAVING LEGEND**
- NEW PAVING
  - PAVING RESURFACE COURSE (AS REQUIRED BY SITE CONDITIONS)
  - NEW CONCRETE
  - EXISTING PAVING TO BE REMOVED

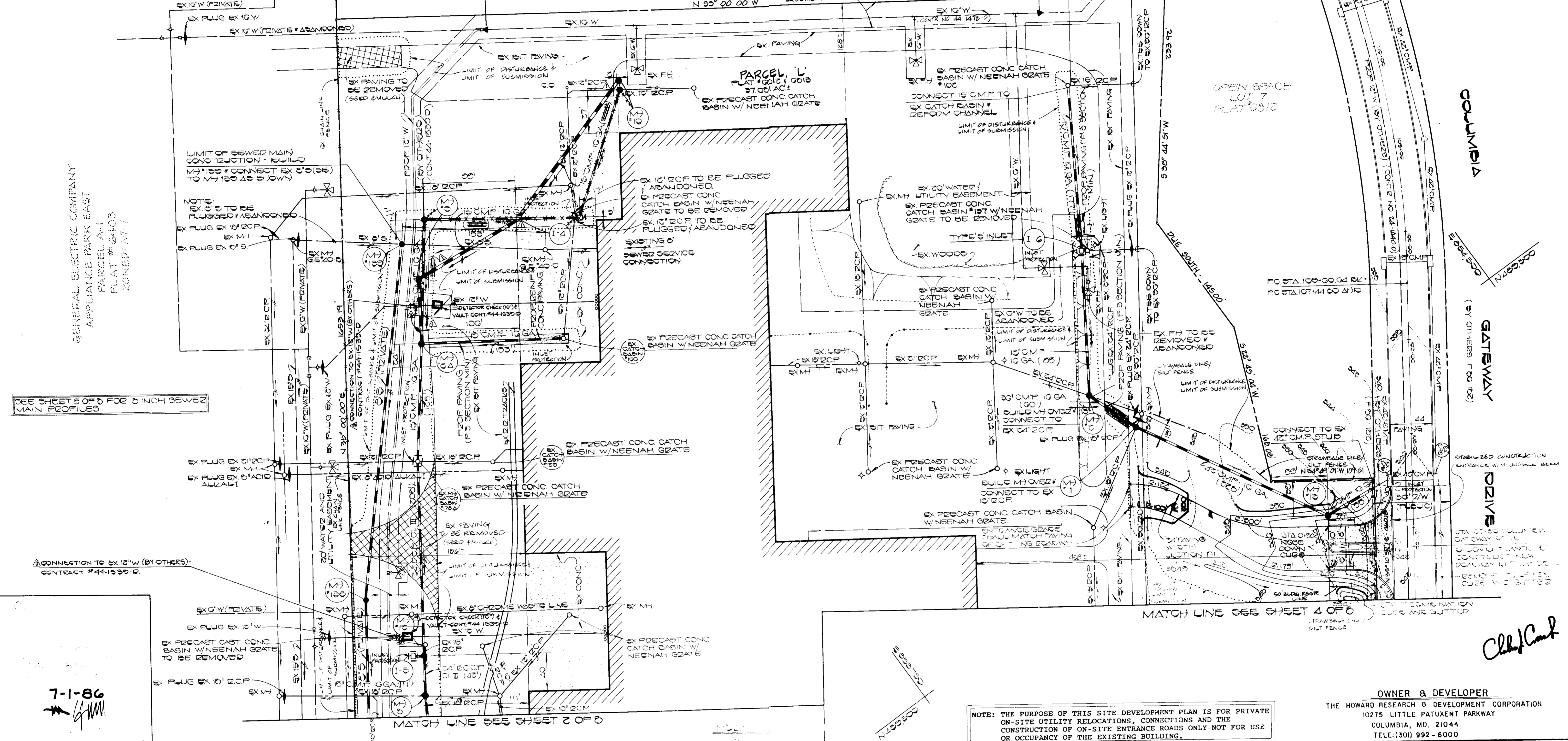

SEE SHEET 5 OF 8 FOR 8 INCH SEWER MAIN PROFILES

7-1-86  
[Signature]

NOTE: THE PURPOSE OF THIS SITE DEVELOPMENT PLAN IS FOR PRIVATE ON-SITE UTILITY RELOCATIONS, CONNECTIONS AND THE CONSTRUCTION OF ON-SITE ENTRANCE ROADS ONLY-NOT FOR USE OR OCCUPANCY OF THE EXISTING BUILDING.

**OWNER & DEVELOPER**  
THE HOWARD RESEARCH & DEVELOPMENT CORPORATION  
10275 LITTLE PATUXENT PARKWAY  
COLUMBIA, MD. 21044  
TELE: (301) 992-6000

**FISHER, COLLINS & CARTER, INC.**  
CIVIL ENGINEERS & LAND SURVEYORS  
8388 COURT AVENUE  
ELLICOTT CITY, MARYLAND 21043  
(301) 461-2855

**ENGINEER'S CERTIFICATE**  
I HEREBY CERTIFY THAT THIS PLAN FOR EROSION AND SEDIMENT CONTROL REPRESENTS A PRACTICAL AND WORKABLE PLAN BASED ON MY PERSONAL KNOWLEDGE OF THE SITE CONDITIONS AND THAT IT WAS PREPARED IN ACCORDANCE WITH THE REQUIREMENTS OF THE HOWARD SOIL CONSERVATION DISTRICT.

[Signature] 7/25/86  
SIGNATURE OF ENGINEER DATE

**DEVELOPER'S CERTIFICATE**  
"I/WE CERTIFY THAT ALL DEVELOPMENT AND CONSTRUCTION WILL BE DONE ACCORDING TO THIS PLAN OF DEVELOPMENT AND PLAN FOR EROSION AND SEDIMENT CONTROL AND THAT ALL RESPONSIBLE PERSONNEL INVOLVED IN THE CONSTRUCTION PROJECT WILL HAVE A CERTIFICATE OF ATTENDANCE AT A DEPARTMENT OF NATURAL RESOURCES APPROVED TRAINING PROGRAM FOR THE CONTROL OF SEDIMENT AND EROSION BEFORE BEGINNING THE PROJECT. I ALSO AUTHORIZE PERIODIC ON-SITE INSPECTION BY THE HOWARD SOIL CONSERVATION DISTRICT OR THEIR AUTHORIZED AGENTS, AS ARE DEEMED NECESSARY."

[Signature] 7-25-86  
SIGNATURE OF DEVELOPER DATE

REVIEWED FOR HOWARD SOIL CONSERVATION DISTRICT AND MEETS TECHNICAL REQUIREMENTS

U.S. SOIL CONSERVATION SERVICE DATE

THIS DEVELOPMENT IS APPROVED FOR EROSION AND SEDIMENT CONTROL BY THE HOWARD SOIL CONSERVATION DISTRICT

APPROVED: DATE

DISTRICT HOWARD SOIL CONSERVATION DISTRICT DATE

APPROVED: OFFICE OF PLANNING AND ZONING

PLANNING DIRECTOR DATE

[Signature] 8-18-86  
CHIEF, DIVISION OF LAND DEVELOPMENT AND ZONING ADMINISTRATION DATE

APPROVED: HOWARD COUNTY HEALTH DEPARTMENT FOR PUBLIC WATER AND SEWERAGE SYSTEMS

[Signature] 8-11-86  
HEALTH OFFICER DATE

APPROVED: DEPARTMENT OF PUBLIC WORKS FOR PUBLIC WATER & SEWER AND STORM DRAINAGE SYSTEMS AND ROADS.

DIRECTOR, PUBLIC WORKS DATE



[Signature] 8-11-86  
CHIEF, BUREAU OF ENGINEERING DATE

SUBDIVISION	SECTION/AREA	PARCEL
COLUMBIA GATEWAY - DRYER BUILDING		L
PLAT NOS	BLOCK NO	TAX / ZONE
6212 / 6213	412 / 17	M-1 42143
WATER CODE	ELEC DIST	CENSUS TR
6-00	614	0005 00
SEWER CODE	4900000	

**SITE DEVELOPMENT PLAN**  
**COLUMBIA GATEWAY**  
PARCEL 'L'  
**DRYER BUILDING**  
TAX MAPS NO. 42 & 43  
SIXTH ELECTION DISTRICT  
HOWARD COUNTY, MARYLAND  
SCALE: 1"=50' MAY 27, 1986  
SHEET 3 OF 8  
REVISED JULY 7, 1986  
SDP 86-230

[Signature]

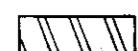
PAVING LEGEND

-  - NEW PAVING
-  PAVING RESURFACE COURSE (AS REQUIRED BY SITE CONDITIONS)
-  - EXISTING PAVING TO BE REMOVED

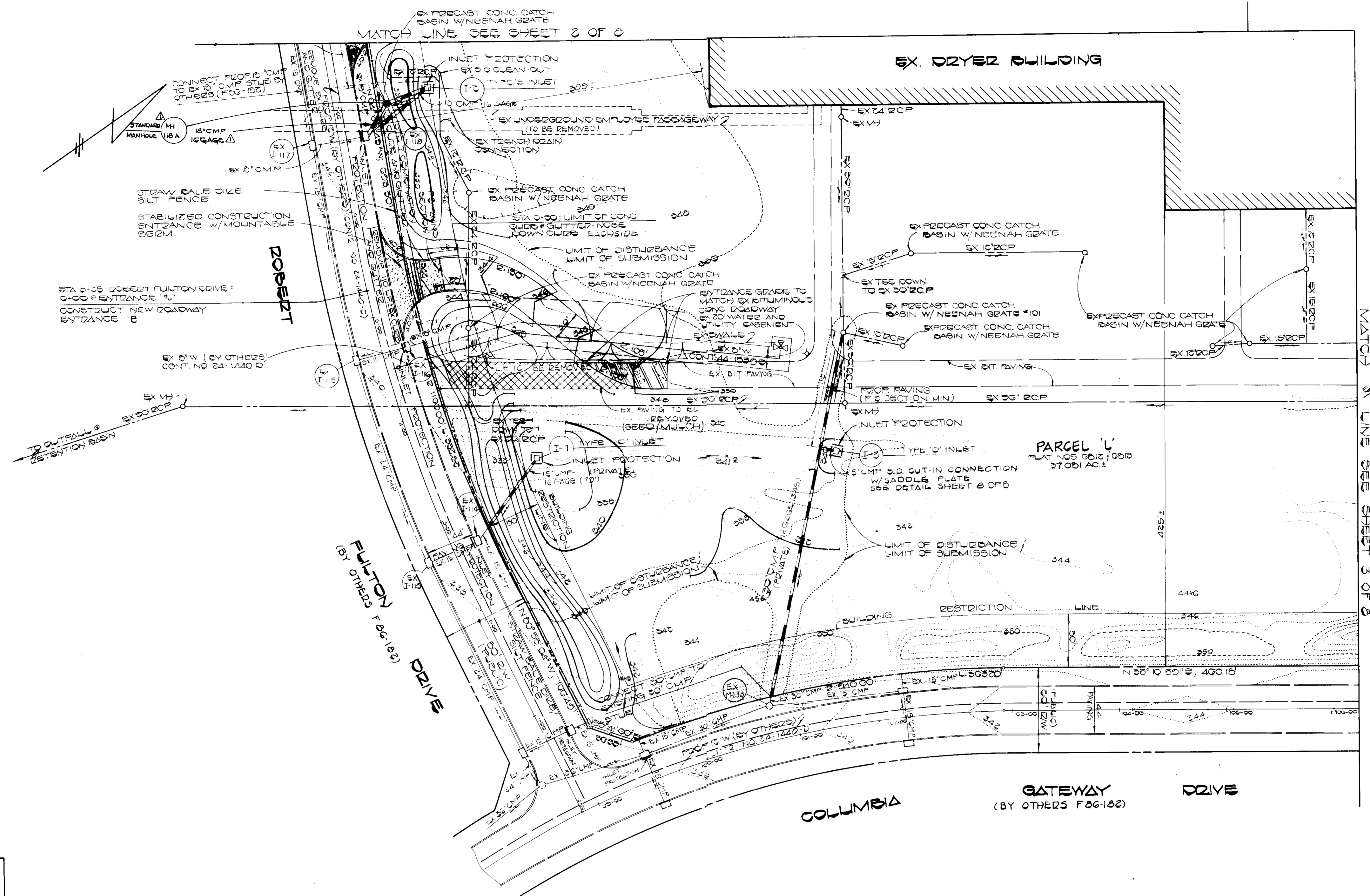

NO.	BY	CHANGE	DATE
1	DAN	CHANGE STORM DRAINS	4-2-87
2	BY	REVISION	

NOTE: THE PURPOSE OF THIS SITE DEVELOPMENT PLAN IS FOR PRIVATE ON-SITE UTILITY RELOCATIONS, CONNECTIONS AND THE CONSTRUCTION OF ON-SITE ENTRANCE ROADS ONLY NOT FOR USE OR OCCUPANCY OF THE EXISTING BUILDING.

**OWNER & DEVELOPER**  
 THE HOWARD RESEARCH & DEVELOPMENT CORPORATION  
 10275 LITTLE PATUXENT PARKWAY  
 COLUMBIA, MD. 21044  
 TELE: (301) 992-6000

**FISHER, COLLINS & CARTER, INC.**  
 CIVIL ENGINEERS & LAND SURVEYORS  
 8388 COURT AVENUE  
 ELLICOTT CITY, MARYLAND 21043  
 (301) 461-2855

**ENGINEER'S CERTIFICATE**  
 I HEREBY CERTIFY THAT THIS PLAN FOR EROSION AND SEDIMENT CONTROL REPRESENTS A PRACTICAL AND WORKABLE PLAN BASED ON MY PERSONAL KNOWLEDGE OF THE SITE CONDITIONS AND THAT IT WAS PREPARED IN ACCORDANCE WITH THE REQUIREMENTS OF THE HOWARD SOIL CONSERVATION DISTRICT.

*Charles C. Conner*  
 SIGNATURE OF ENGINEER  
 7/25/86  
 DATE

**DEVELOPER'S CERTIFICATE**  
 "I/WE CERTIFY THAT ALL DEVELOPMENT AND CONSTRUCTION WILL BE DONE ACCORDING TO THIS PLAN OF DEVELOPMENT AND PLAN FOR EROSION AND SEDIMENT CONTROL AND THAT ALL RESPONSIBLE PERSONNEL INVOLVED IN THE CONSTRUCTION PROJECT WILL HAVE A CERTIFICATE OF ATTENDANCE AT A DEPARTMENT OF NATURAL RESOURCES APPROVED TRAINING PROGRAM FOR THE CONTROL OF SEDIMENT AND EROSION BEFORE BEGINNING THE PROJECT. I ALSO AUTHORIZE PERIODIC ON-SITE INSPECTION BY THE HOWARD SOIL CONSERVATION DISTRICT OR THEIR AUTHORIZED AGENTS, AS ARE DEEMED NECESSARY."

*John N. N. N.*  
 SIGNATURE OF DEVELOPER  
 7-25-86  
 DATE

REVIEWED FOR HOWARD SOIL CONSERVATION DISTRICT AND MEETS TECHNICAL REQUIREMENTS

U.S. SOIL CONSERVATION SERVICE \_\_\_\_\_ DATE \_\_\_\_\_

THIS DEVELOPMENT IS APPROVED FOR EROSION AND SEDIMENT CONTROL BY THE HOWARD SOIL CONSERVATION DISTRICT.

APPROVED: \_\_\_\_\_ DATE \_\_\_\_\_

DISTRICT \_\_\_\_\_ DATE \_\_\_\_\_

HOWARD SOIL CONSERVATION DISTRICT

APPROVED: OFFICE OF PLANNING AND ZONING

PLANNING DIRECTOR \_\_\_\_\_ DATE \_\_\_\_\_

*John W. ...*  
 CHIEF, DIVISION OF LAND DEVELOPMENT AND ZONING ADMINISTRATION  
 DATE \_\_\_\_\_

APPROVED: HOWARD COUNTY HEALTH DEPARTMENT FOR PUBLIC WATER AND SEWERAGE SYSTEMS

HEALTH OFFICE \_\_\_\_\_ DATE \_\_\_\_\_

APPROVED: DEPARTMENT OF PUBLIC WORKS FOR PUBLIC WATER & SEWER AND STORM DRAINAGE SYSTEMS AND ROADS.

DIRECTOR, PUBLIC WORKS \_\_\_\_\_ DATE \_\_\_\_\_

CHIEF, BUREAU OF ENGINEERING \_\_\_\_\_ DATE \_\_\_\_\_

SUBDIVISION	SECTION/AREA	PARCEL
COLUMBIA GATEWAY - DRYER BUILDING		'L'

PLAT NOS	BLOCK NO	ZONE	TAX / ZONE	ELEC. DIST.	CENSUS TR.
6012 / 6013	1612 / 117	M-1	42143	6th	600002

WATER CODE \_\_\_\_\_ SEWER CODE 4000000

**SITE DEVELOPMENT PLAN**  
**COLUMBIA GATEWAY**  
 PARCEL 'L'  
**DRYER BUILDING**  
 TAX MAPS NO. 42143  
 SIXTH ELECTION DISTRICT  
 HOWARD COUNTY, MARYLAND  
 SCALE: 1"=50' MAY 27, 1986  
 SHEET 4 OF 8  
 REVISED JULY 7, 1986  
 S.O.P. 86-088



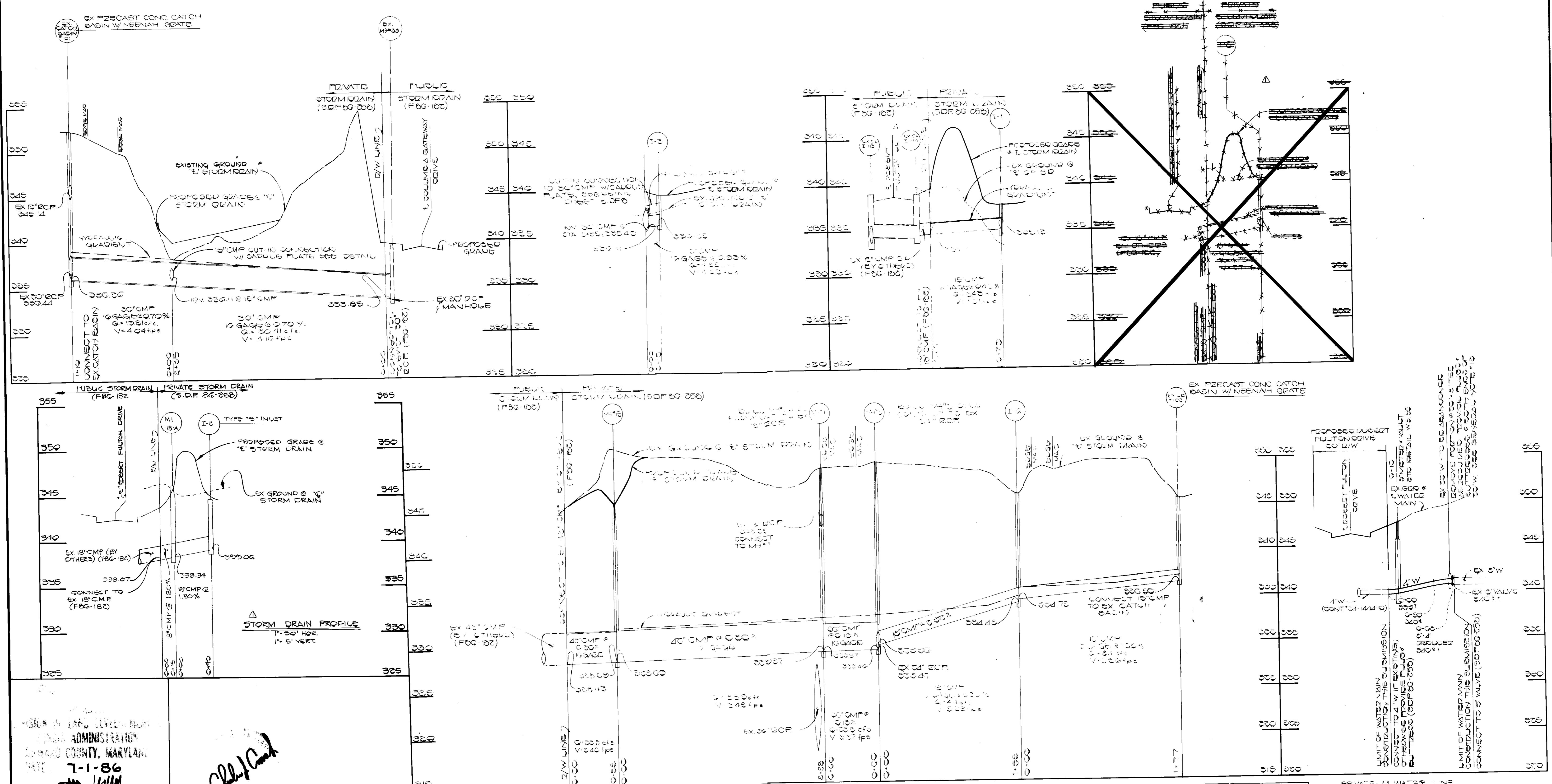

HOWARD COUNTY ADMINISTRATION  
 7-1-86  
*[Signature]*

*[Signature]*

PRIVATE STORM DRAIN PROFILES  
 SCALE: HORIZ. 1"=50'  
 VERT. 1"=5'

NOTE: THE PURPOSE OF THIS SITE DEVELOPMENT PLAN IS FOR PRIVATE ON-SITE UTILITY RELOCATIONS, CONNECTIONS AND THE CONSTRUCTION OF ON-SITE ENTRANCE ROADS ONLY-NOT FOR USE OR OCCUPANCY OF THE EXISTING BUILDING.

PRIVATE 4" WATER MAIN  
 SCALE: HORIZ. 1"=50'  
 VERT. 1"=5'

NO.	DATE	REVISION
1	4-2-87	VOID PROFILE & ADD NEW STORM DRAIN PROFILES.

**FISHER, COLLINS & CARTER, INC.**  
 CIVIL ENGINEERS & LAND SURVEYORS  
 8388 COURT AVENUE  
 ELLICOTT CITY, MARYLAND 21043  
 (301) 461-2855

**ENGINEER'S CERTIFICATE**  
 I HEREBY CERTIFY THAT THIS PLAN FOR EROSION AND SEDIMENT CONTROL REPRESENTS A PRACTICAL AND WORKABLE PLAN BASED ON MY PERSONAL KNOWLEDGE OF THE SITE CONDITIONS AND THAT IT WAS PREPARED IN ACCORDANCE WITH THE REQUIREMENTS OF THE HOWARD SOIL CONSERVATION DISTRICT.

*[Signature]*  
 SIGNATURE OF ENGINEER  
 7/25/86  
 DATE

**DEVELOPER'S CERTIFICATE**  
 I/WE CERTIFY THAT ALL DEVELOPMENT AND CONSTRUCTION WILL BE DONE ACCORDING TO THIS PLAN OF DEVELOPMENT AND PLAN FOR EROSION AND SEDIMENT CONTROL AND THAT ALL RESPONSIBLE PERSONNEL INVOLVED IN THE CONSTRUCTION PROJECT WILL HAVE A CERTIFICATE OF ATTENDANCE AT A DEPARTMENT OF NATURAL RESOURCES APPROVED TRAINING PROGRAM FOR THE CONTROL OF SEDIMENT AND EROSION BEFORE BEGINNING THE PROJECT. I ALSO AUTHORIZE PERIODIC ON-SITE INSPECTION BY THE HOWARD SOIL CONSERVATION DISTRICT OR THEIR AUTHORIZED AGENTS, AS ARE DEEMED NECESSARY.

*[Signature]*  
 SIGNATURE OF DEVELOPER  
 7-25-86  
 DATE

REVIEWED FOR HOWARD SOIL CONSERVATION DISTRICT AND MEETS TECHNICAL REQUIREMENTS

*[Signature]*  
 U.S. SOIL CONSERVATION SERVICE  
 DATE

THIS DEVELOPMENT IS APPROVED FOR EROSION AND SEDIMENT CONTROL BY THE HOWARD SOIL CONSERVATION DISTRICT.

APPROVED:  
 DATE

DISTRICT HEALTH OFFICER  
 DATE

APPROVED: OFFICE OF PLANNING AND ZONING

*[Signature]*  
 PLANNING DIRECTOR  
 DATE

*[Signature]*  
 CHIEF, DIVISION OF LAND DEVELOPMENT AND ZONING ADMINISTRATION  
 DATE

APPROVED: HOWARD COUNTY HEALTH DEPARTMENT FOR PUBLIC WATER AND SEWERAGE SYSTEMS

*[Signature]*  
 HEALTH OFFICER  
 DATE

APPROVED: DEPARTMENT OF PUBLIC WORKS FOR PUBLIC WATER & SEWER AND STORM DRAINAGE SYSTEMS AND ROADS.

*[Signature]*  
 DIRECTOR, PUBLIC WORKS  
 DATE

*[Signature]*  
 CHIEF, BUREAU OF ENGINEERING  
 DATE

SUBDIVISION	SECTION/AREA	PARCEL
COLUMBIA GATEWAY - DRYER BUILDING		'L'
PLAT NOS.	BLOCK NO.	ZONE
2012, 2013	2/12/17	M-1
TAX/ZONE	ELEC. DIST.	CENSUS TR.
424.43	6th	000000
WATER CODE	SEWER CODE	
4-00	4000000	

PROFILES - PRIVATE STORM DRAINS  
 PRIVATE 4" WATER MAIN  
**COLUMBIA GATEWAY**  
 PARCEL 'L'  
**DRYER BUILDING**  
 TAX MAPS NO. 42443  
 SIXTH ELECTION DISTRICT  
 HOWARD COUNTY, MARYLAND  
 SCALE: AS SHOWN MAY 27, 1986  
 SHEET 6 OF 8  
 REVISED JULY 7, 1986  
 30 P 80-250

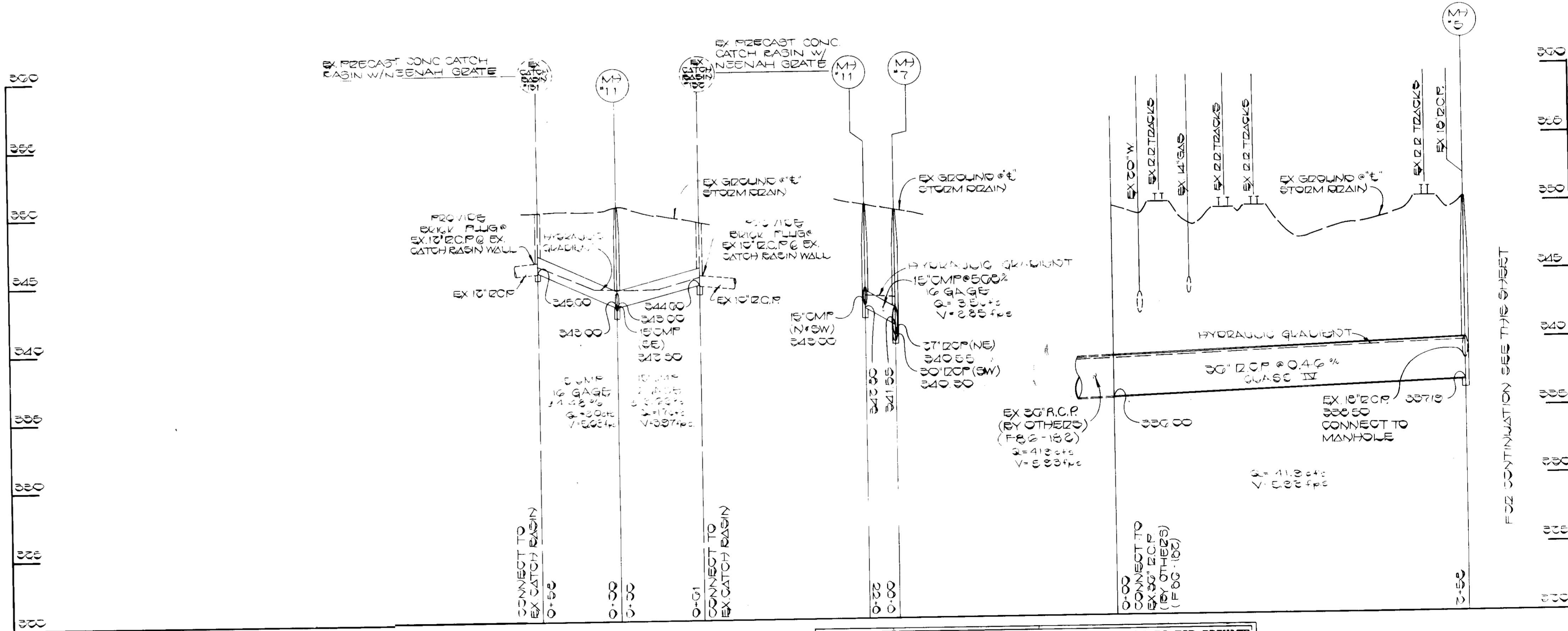
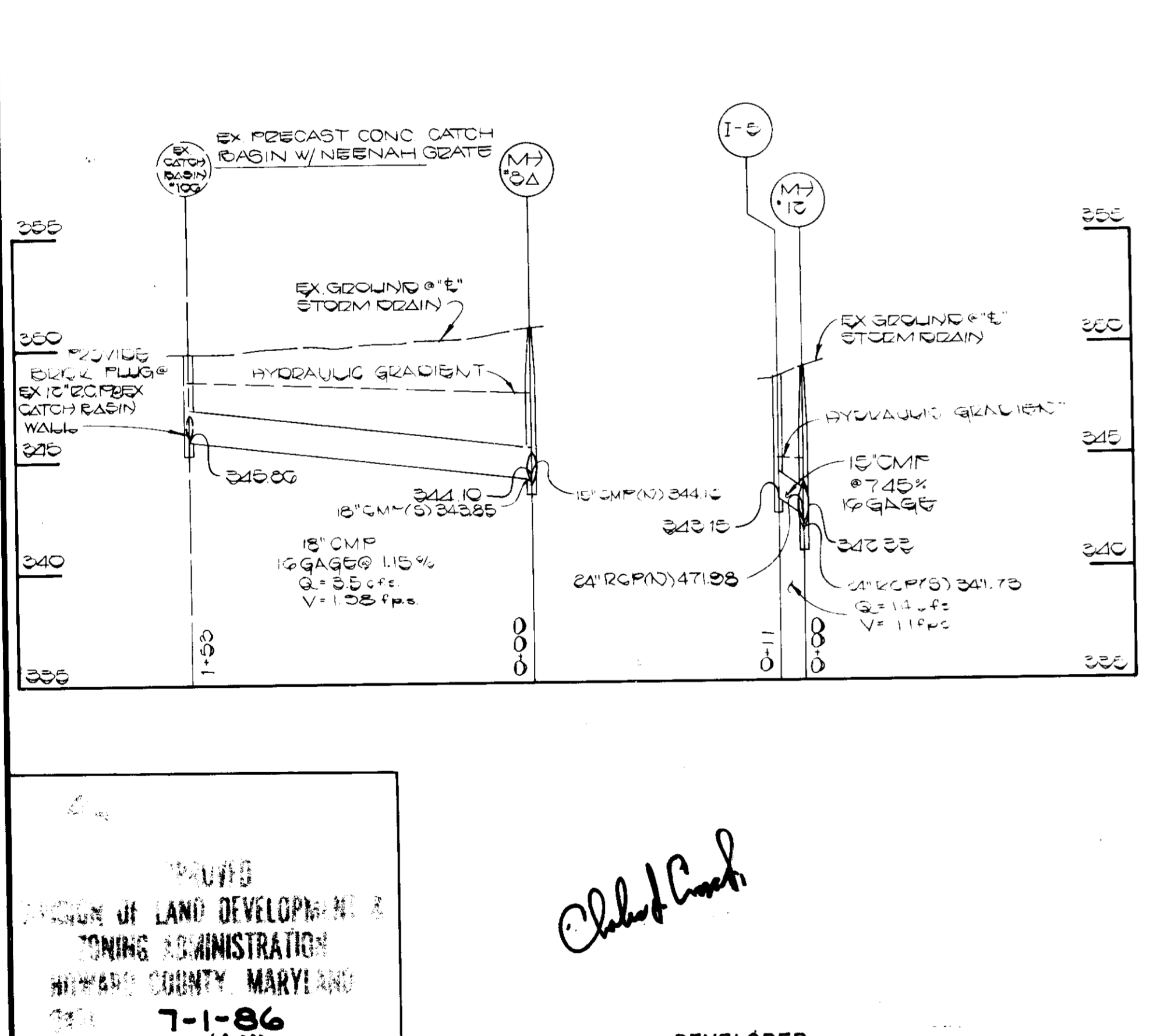
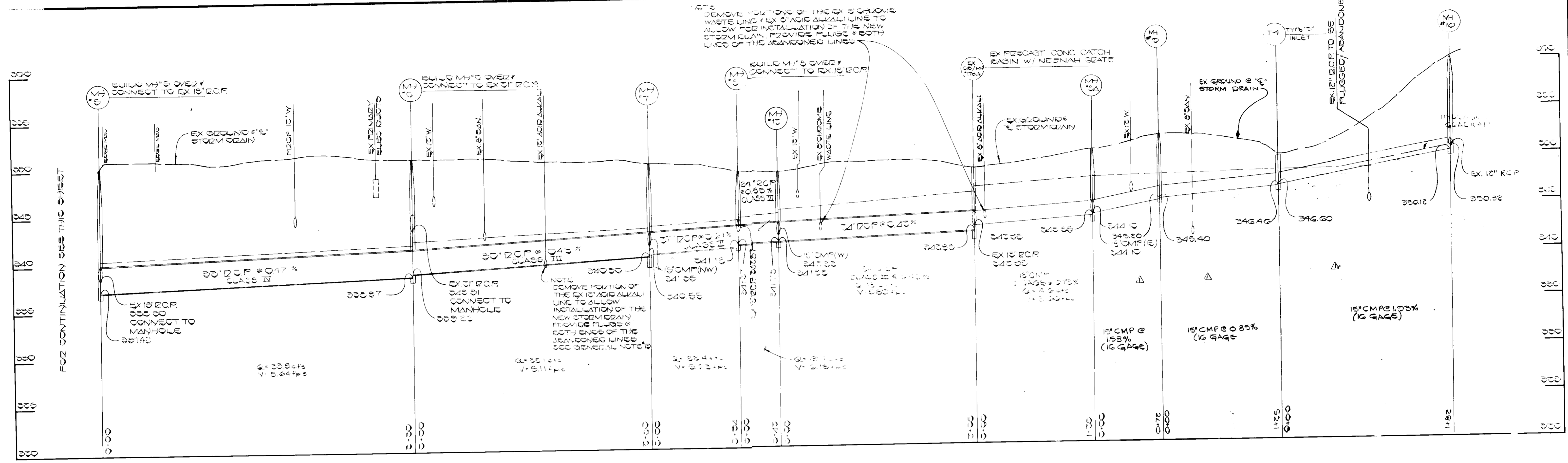

PLANNING  
DIVISION OF LAND DEVELOPMENT &  
ZONING ADMINISTRATION  
HOWARD COUNTY, MARYLAND  
7-1-86

**OWNER & DEVELOPER**  
THE HOWARD RESEARCH & DEVELOPMENT CORPORATION  
10275 LITTLE PATUXENT PARKWAY  
COLUMBIA MD. 21044  
TELE: (201) 992-6000

NO.	DATE	REVISION
1	4-2-87	REVISE STORM DRAIN PROFILE

**PRIVATE STORM DRAIN PROFILES**  
SCALE: HORIZ. 1"=50'  
VERT. 1"=5'

NOTE: THE PURPOSE OF THIS SITE DEVELOPMENT PLAN IS FOR PRIVATE ON-SITE UTILITY RELOCATIONS, CONNECTIONS AND THE CONSTRUCTION OF ON-SITE ENTRANCE ROADS ONLY-NOT FOR USE OR OCCUPANCY OF THE EXISTING BUILDING.

**FISHER, COLLINS & CARTER, INC.**  
CIVIL ENGINEERS & LAND SURVEYORS  
8388 COURT AVENUE  
ELLCOTT CITY, MARYLAND 21043  
(301) 461-2855

**ENGINEER'S CERTIFICATE**  
I HEREBY CERTIFY THAT THIS PLAN FOR EROSION AND SEDIMENT CONTROL REPRESENTS A PRACTICAL AND WORKABLE PLAN BASED ON MY PERSONAL KNOWLEDGE OF THE SITE CONDITIONS AND THAT IT WAS PREPARED IN ACCORDANCE WITH THE REQUIREMENTS OF THE HOWARD SOIL CONSERVATION DISTRICT.

Signature: *Chad C. Cook*  
Date: 7-25-86

**DEVELOPER'S CERTIFICATE**  
"I" WE CERTIFY THAT ALL DEVELOPMENT AND CONSTRUCTION WILL BE DONE ACCORDING TO THIS PLAN OF DEVELOPMENT AND PLAN FOR EROSION AND SEDIMENT CONTROL AND THAT ALL RESPONSIBLE PERSONNEL INVOLVED IN THE CONSTRUCTION PROJECT WILL HAVE A CERTIFICATE OF ATTENDANCE AT A DEPARTMENT OF NATURAL RESOURCES APPROVED TRAINING PROGRAM FOR THE CONTROL OF SEDIMENT AND EROSION BEFORE BEGINNING THE PROJECT. I ALSO AUTHORIZE PERIODIC ONSITE INSPECTION BY THE HOWARD SOIL CONSERVATION DISTRICT OR THEIR AUTHORIZED AGENTS, AS ARE DEEMED NECESSARY.

Signature: *John H. Stoltz*  
Date: 7-25-86

REVIEWED FOR HOWARD SOIL CONSERVATION DISTRICT AND MEETS TECHNICAL REQUIREMENTS

U.S. SOIL CONSERVATION SERVICE DATE: 8-2-86

THIS DEVELOPMENT IS APPROVED FOR EROSION AND SEDIMENT CONTROL BY THE HOWARD SOIL CONSERVATION DISTRICT.

DISTRICT: HOWARD SOIL CONSERVATION DISTRICT

APPROVED: OFFICE OF PLANNING AND ZONING

PLANNING DIRECTOR: *Ann M. ...* DATE: 8-11-86

CHIEF, DIVISION OF LAND DEVELOPMENT AND ZONING ADMINISTRATION

APPROVED: HOWARD COUNTY HEALTH DEPARTMENT FOR PUBLIC WATER AND SEWERAGE SYSTEMS

HEALTH OFFICER: *James ...* DATE: 8-11-86

APPROVED: DEPARTMENT OF PUBLIC WORKS FOR PUBLIC WATER & SEWER AND STORM DRAINAGE SYSTEMS AND ROADS.

DIRECTOR, PUBLIC WORKS: *...* DATE: 8-13-86

CHIEF, BUREAU OF ENGINEERING

SUBDIVISION: COLUMBIA GATEWAY - DRYER BUILDING

SECTION/AREA: PARCEL 'L'

PLAT NOS: 0512 / 0513	BLOCK NO: 6212/177	ZONE: M-1	TAX / ZONE: 42 & 43	ELEC. DIST. 5th	CENSUS TR. 502502
WATER CODE: 5-00	SEWER CODE: 4000000				

**PROFILES - PRIVATE STORM DRAINS**  
**COLUMBIA GATEWAY**  
PARCEL 'L'  
**DRYER BUILDING**  
TAX MAPS NO. 42 & 43  
SIXTH ELECTION DISTRICT  
HOWARD COUNTY, MARYLAND  
SCALE: AS SHOWN MAY 27, 1986  
SHEET 7 OF 8  
REVISED JULY 7, 1989  
SOP: 80-258

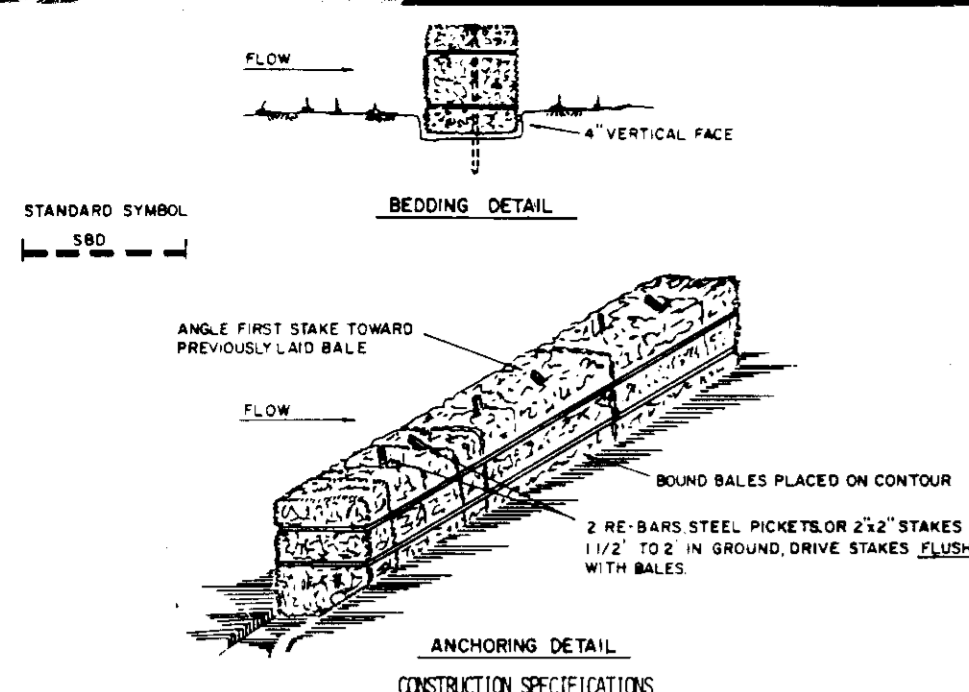

- Bales shall be placed at the toe of a slope or on the contour and in a row with ends tightly abutting the adjacent bales.
- Each bale shall be bedded in the soil a minimum of (4) inches, and placed so the bunnings are horizontal.
- Bales shall be securely anchored in place by either two stakes or re-bars driven through the bale. The first stake in each bale shall be driven toward the previously laid bale at an angle to force the bales together. Stakes shall be driven flush with the bale.
- Inspection shall be frequent and repair replacement shall be made promptly as needed.
- Bales shall be removed when they have served their usefulness so as not to block or impede storm flow or drainage.

**STRAW BALE DIKE**  
NOT TO SCALE

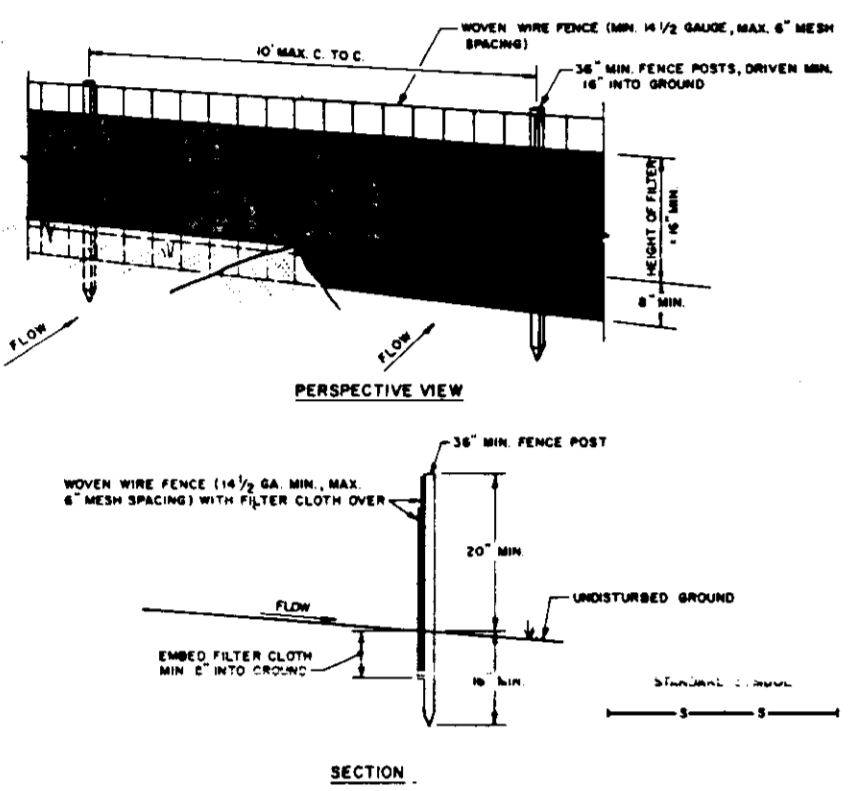

- When wire fence is to be fastened securely to fence posts with wire ties or staples.
- Filter cloth to be fastened securely to when wire fence with ties spaced every 24" at top and mid section.
- When two sections of filter cloth abut each other they shall be overlapped by six inches and folded.
- Maintenance shall be performed as needed and material removed when bales develop in the silt fence.

**SILT FENCE**  
NOT TO SCALE

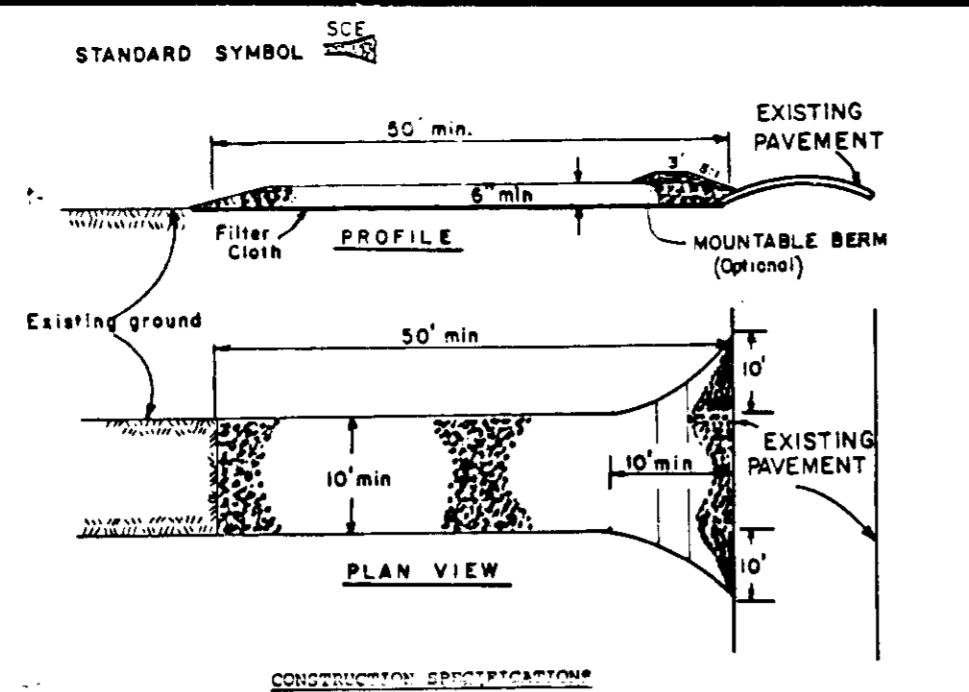

- Stone Size - Use 2" stone, or reclaimed or recycled concrete equivalent.
- Length - As required, but not less than 50 feet (except on a single residential lot where a 30 foot minimum length would apply).
- Thickness - Not less than six (6) inches.
- Width - Ten (10) foot minimum, but not less than the full width at points where ingress or egress occurs.
- Filter Cloth - Will be placed over the entire area prior to placing of stone. Filter will not be required on a single family residence driveway.
- Surface Water - All surface water flowing or diverted toward construction entrances shall be piped across the entrance. If piping is impractical, a mountable berm with 3:1 slopes will be provided.
- Maintenance - The entrance shall be maintained in a condition which will prevent tracking or flowing of sediment onto public rights-of-way. This may require periodic top dressing with additional stone as conditions demand and repair and/or cleanout of any measures used to trap sediment. All sediment spilled, dropped, washed or tracked onto public rights-of-way must be removed immediately.
- Washing - Wheels shall be cleaned to remove sediment prior to entrance onto public rights-of-way. When washing is required, it shall be done on area stabilized with stone and which drains into an approved sediment trapping device.
- Periodic inspection and needed maintenance shall be provided after each rain.

**STABILIZED CONSTRUCTION ENTRANCE**  
NOT TO SCALE

- APPLY TO GRADED OR CLEARED AREA NOT SUBJECT TO IMMEDIATE FURTHER DISTURBANCE WHERE A PERMANENT LONG-LIVED VEGETATIVE COVER IS REQUIRED.
- SEEDING PREPARATION: LOOSEN UPPER THREE-INCHES OF SOIL BY RAKING, DISCING OR OTHER ACCEPTABLE MEANS BEFORE SEEDING.
- SOIL AMENDMENTS: IN LIEU OF SOIL TEST RECOMMENDATIONS, USE ONE OF THE FOLLOWING SCHEDULE:
- PREFERRED - APPLY 2 TONS PER ACRE DOLOMITIC LIMESTONE (92 LBS/1000 SQ. FT.) AND 800 LBS PER ACRE 10-10-10 FERTILIZER (14 LBS/1000 SQ. FT.) BEFORE SEEDING. HARROW OR DISC INTO UPPER THREE-INCHES OF SOIL. AT TIME OF SEEDING, APPLY 400 LBS. PER ACRE 30-0-0 UREA-FORM FERTILIZER (9 LBS/1000 SQ. FT.).
  - ACCEPTABLE - APPLY 2 TONS PER ACRE DOLOMITIC LIMESTONE (92 LBS/1000 SQ. FT.) AND 1000 LBS PER ACRE 10-10-10 FERTILIZER (22 LBS/1000 SQ. FT.) BEFORE SEEDING. HARROW OR DISC INTO UPPER THREE-INCHES OF SOIL.
- SEEDING: FOR THE PERIODS MARCH 1 THRU APRIL 30, AND AUGUST 1 THRU OCTOBER 15, SEED WITH 60 LBS PER ACRE (1.4 LBS/1000 SQ. FT.) OF KENTUCKY 31 TALL FESCUE. FOR THE PERIOD MAY 1 THRU JULY 31, SEED WITH 60 LBS KENTUCKY 31 TALL FESCUE PER ACRE AND 2 LBS PER ACRE (.05 LBS/1000 SQ. FT.) OF WEeping LOVEGRASS. DURING THE PERIOD OF OCTOBER 16 THRU FEBRUARY 28, PROTECT SITE BY: OPTION (1) 2 TONS PER ACRE OF WELL ANCHORED STRAW MULCH AND SEED AS SOON AS POSSIBLE IN THE SPRING. OPTION (2) USE SOO. OPTION (3) SEED WITH 60 LBS/ACRE KENTUCKY 31 TALL FESCUE AND MULCH WITH 2 TONS/ACRE WELL ANCHORED STRAW. MULCHING: APPLY 1 1/2 TO 2 TONS PER ACRE (70 TO 90 LBS/1000 SQ. FT.) OF UNROTTED SMALL GRASS STRAW IMMEDIATELY AFTER SEEDING. ANCHOR MULCH IMMEDIATELY AFTER APPLICATION USING MULCH ANCHORING TOOL OR 218 GALLONS PER ACRE (5 GAL/1000 SQ. FT.) OF EMULSIFIED ASPHALT ON FLAT AREAS. ON SLOPES 8 FEET OR HIGHER, USE 348 GALLONS PER ACRE (8 GAL/1000 SQ. FT.) FOR ANCHORING.
- MAINTENANCE: INSPECT ALL SEEDING AREAS AND MAKE NEEDED REPAIRS, REPLACEMENTS AND RESEEDINGS.
- TEMPORARY SEEDING NOTES:
- APPLY TO GRADED OR CLEARED AREAS LIKELY TO BE REDISTURBED WHERE A SHORT-TERM VEGETATIVE COVER IS NEEDED.
- SEEDING PREPARATION: LOOSEN UPPER THREE-INCHES OF SOIL BY RAKING, DISCING OR OTHER ACCEPTABLE MEANS BEFORE SEEDING.
- SOIL AMENDMENTS: APPLY 600 LBS PER ACRE 10-10-10 FERTILIZER (14 LBS/1000 SQ. FT.).
- SEEDING: FOR PERIODS MARCH 1 THRU APRIL 30 AND FROM AUGUST 15 THRU NOVEMBER 15, SEED WITH 25 BUSHEL PER ACRE OF ANNUAL RYE (3.2 LBS/1000 SQ. FT.). FOR THE PERIOD MAY 1 THRU AUGUST 14, SEED WITH 3 LBS PER ACRE OF WEeping LOVEGRASS (.07 LBS/1000 SQ. FT.). FOR THE PERIOD NOVEMBER 16 THRU FEBRUARY 28, PROTECT SITE BY APPLYING 2 TONS PER ACRE OF WELL ANCHORED STRAW MULCH AND SEED AS SOON AS POSSIBLE IN THE SPRING, OR USE SOO.
- MULCHING: APPLY 1 1/2 TO 2 TONS PER ACRE (70 TO 90 LBS/1000 SQ. FT.) OF UNROTTED SMALL GRASS STRAW IMMEDIATELY AFTER SEEDING. ANCHOR MULCH IMMEDIATELY AFTER APPLICATION USING MULCH ANCHORING TOOL OR 218 GALLONS PER ACRE (5 GAL/1000 SQ. FT.) OF EMULSIFIED ASPHALT ON FLAT AREAS. ON SLOPES, 8 FT. OR HIGHER, USE 348 GAL PER ACRE (8 GAL/1000 SQ. FT.) FOR ANCHORING.
- REFER TO THE 1983 MARYLAND STANDARDS AND SPECIFICATIONS FOR SOIL EROSION AND SEDIMENT CONTROL FOR RATE AND METHODS NOT COVERED.

- When wire fence is to be fastened securely to fence posts with wire ties or staples.
- Filter cloth to be fastened securely to when wire fence with ties spaced every 24" at top and mid section.
- When two sections of filter cloth abut each other they shall be overlapped by six inches and folded.
- Maintenance shall be performed as needed and material removed when bales develop in the silt fence.

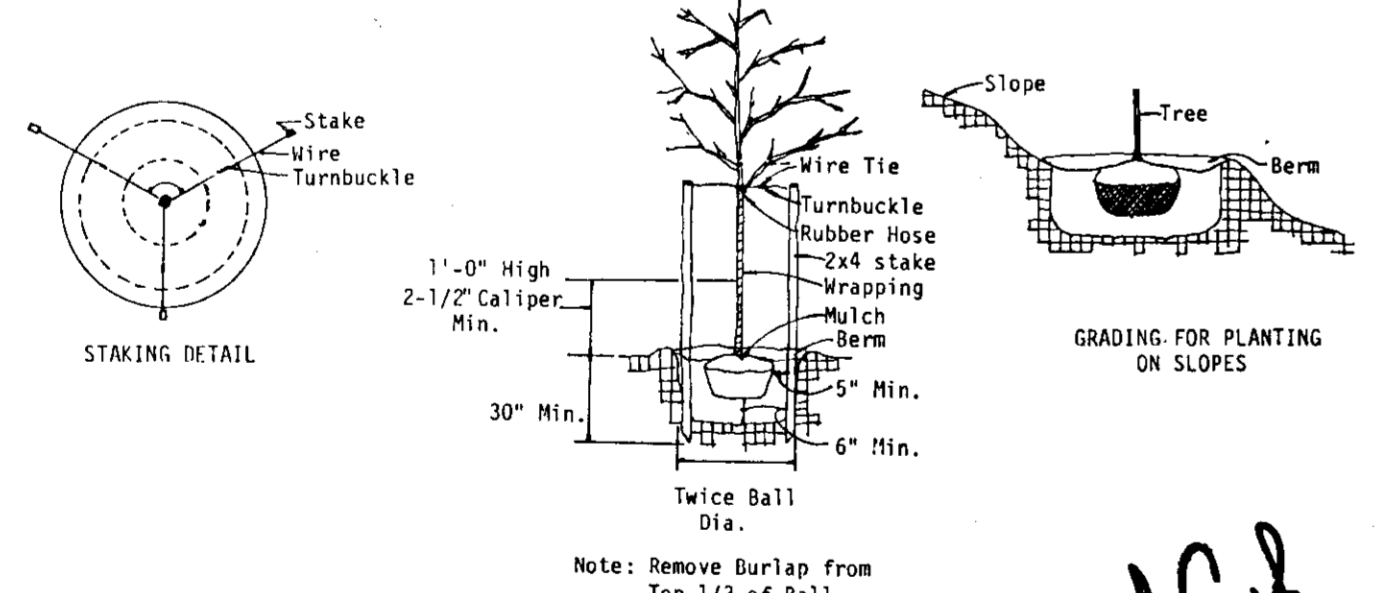

**TREE PLANTING**  
NOT TO SCALE

- SEDIMENT CONTROL NOTES:
- A MINIMUM OF 24 HOURS NOTICE MUST BE GIVEN TO THE HOWARD COUNTY OFFICE OF INSPECTIONS AND PERMITS PRIOR TO THE START OF ANY CONSTRUCTION (992-2437).
  - ALL VEGETATIVE AND STRUCTURAL PRACTICES ARE TO BE IN CONFORMANCE WITH THE PROVISIONS OF THIS PLAN AND ARE TO BE IN CONFORMANCE WITH THE 1983 MARYLAND STANDARDS AND SPECIFICATIONS FOR SOIL EROSION AND SEDIMENT CONTROL. FOLLOWING INITIAL SOIL DISTURBANCE OR REDISTURBANCE, PERMANENT OR TEMPORARY STABILIZATION SHALL BE COMPLETED WITHIN 7 CALENDAR DAYS FOR ALL PERIMETER SEDIMENT CONTROL STRUCTURES, DIKES, PERIMETER SLOPES AND ALL SLOPES GREATER THAN 3:1. b) 14 DAYS AS TO ALL OTHER DISTURBED OR GRADED AREAS ON THE PROJECT SITE.
  - ALL SEDIMENT TRAPS/BASINS SHOWN MUST BE FENCED AND WARNING SIGNS POSTED AROUND THEIR PERIMETER IN ACCORDANCE WITH VOL. 1, CHAPTER 12, OF THE HOWARD COUNTY DESIGN MANUAL - STORM DRAINAGE.
  - ALL DISTURBED AREAS MUST BE STABILIZED WITHIN THE TIME PERIOD SPECIFIED ABOVE IN ACCORDANCE WITH THE 1983 MARYLAND STANDARDS AND SPECIFICATIONS FOR SOIL EROSION AND SEDIMENT CONTROL FOR PERMANENT SEEDINGS (SEC. 51) SOO (SEC. 54) TEMPORARY SEEDING (SEC. 50) AND MULCHING (SEC. 52). TEMPORARY STABILIZATION WITH MULCH ALONE CAN ONLY BE DONE WHEN RECOMMENDED SEEDING DATES DO NOT ALLOW FOR PROPER GERMINATION AND ESTABLISHMENT OF GRASSES.
  - ALL SEDIMENT CONTROL STRUCTURES ARE TO REMAIN IN PLACE AND ARE TO BE MAINTAINED IN OPERATIVE CONDITION UNTIL PERMITS FOR THEIR REMOVAL HAS BEEN OBTAINED FROM THE HOWARD COUNTY SEDIMENT CONTROL INSPECTOR.
  - SITE ANALYSIS:
 

TOTAL AREA OF SITE	37.031 ACRES
AREA DISTURBED	7.350 ACRES
AREA TO BE ROOFED OR PAVED	0.250 ACRES
AREA TO BE VEGETATIVELY STABILIZED	6.750 ACRES
TOTAL CUT	6.750 CU.YDS.
TOTAL FILL	0.000 CU.YDS.
  - OFFSITE WASTE/BORROW AREA LOCATION
  - AN SEDIMENT CONTROL PRACTICE WHICH IS DISTURBED BY GRADING ACTIVITY FOR PLACEMENT OF UTILITIES MUST BE REPAIRED ON THE SAME DAY OF DISTURBANCE.
  - ADDITIONAL SEDIMENT CONTROLS MUST BE PROVIDED, IF DEEMED NECESSARY BY THE HOWARD COUNTY DOW SEDIMENT CONTROL INSPECTOR.

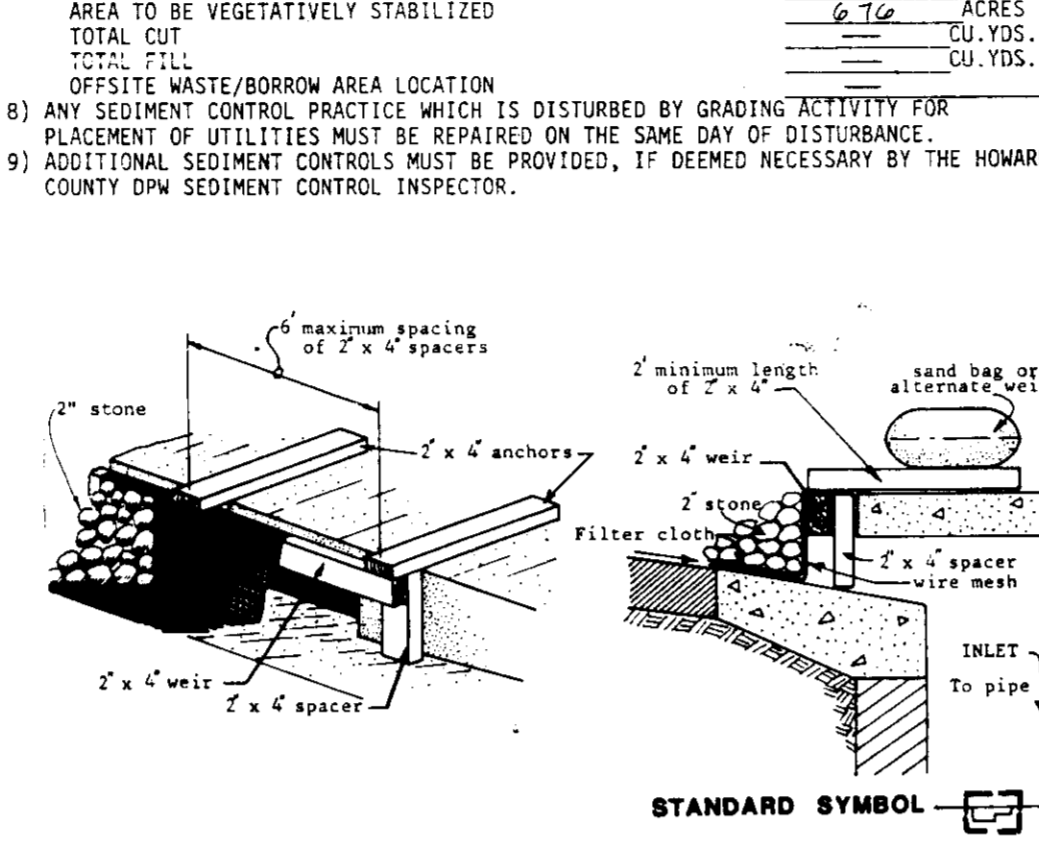

**STANDARD T COMBINATION CURB & GUTTER**  
NOT TO SCALE

- Materials
- Wooden frame is to be constructed of 2" x 4" construction grade lumber.
  - Wire mesh must be of sufficient strength to support filter fabric, and stone for curb inlets, with water fully impounded against it.
  - Filter cloth must be of a type approved for this purpose; resistant to sunlight with sieve size, 60S, 40-85, to allow sufficient passage of water and removal of sediment.
  - Stone is to be 2" in size and clean, since fines would clog the cloth.
- Procedure
- A swale, ditchline or yard inlet protection.
    - Excavate completely around inlet to a depth of 18" below notch elevation.
    - Drive 2 x 4 post 1' into ground at four corners of inlet. Place nail strips between posts on ends of inlet. Assemble top portion of 2 x 4 frame using overlap joint shown. Top of frame (weir) must be 6" below edge of roadway adjacent to inlet.
    - Stretch wire mesh tightly around frame and fasten securely. Ends must meet at post.
    - Stretch filter cloth tightly over wire mesh, the cloth must extend from top of frame to 18" below inlet notch elev. Fasten securely to frame. Ends must meet at post, be overlapped and folded, then fastened down.
    - Backfill around inlet in compacted 6" layers until layer of earth is even with notch elevation on ends and top elevation on sides.
    - If the inlet is not in a low point, construct a compacted earth dike in the ditchline below it. The top of this dike is to be at least 6" higher than the top of frame (weir).
    - This structure must be inspected frequently and the filter fabric replaced when clogged.
  - Curb Inlet Protection.
    - Attach a continuous piece of wire mesh (30" min. width by throat length plus 4") to the 2" x 4" weir (measuring throat length plus 2") as shown on the standard drawing.
    - Place a piece of approved filter cloth (40-85 sieve) of the same dimensions as the wire mesh over the wire mesh and securely attach to the 2" x 4" weir.
    - Securely nail the 2" x 4" weir to 9" long vertical spacers to be located between the weir and inlet face (max. 6" apart).
    - Place the assembly against the inlet throat and nail (minimum 2" lengths of 2" x 4" to the top of the weir at spacer locations. These 2" x 4" anchors shall extend across the inlet top and be held in place by sandbags or alternate weight.
    - The assembly shall be placed so that the end spacers are a minimum 1' beyond both ends of the throat opening.
    - Form the wire mesh and filter cloth to the concrete gutter and anchor the face of curb on both sides of the inlet. Place clean 2" stone over the wire mesh and filter fabric in such a manner as to prevent water from entering the inlet under or around the filter cloth.
    - This type of protection must be inspected frequently and the filter cloth and stone replaced when clogged with sediment.
    - Assure that storm flow does not bypass inlet by installing temporary earth or asphalt dikes directing flow into inlet.

**INLET PROTECTION**  
NOT TO SCALE

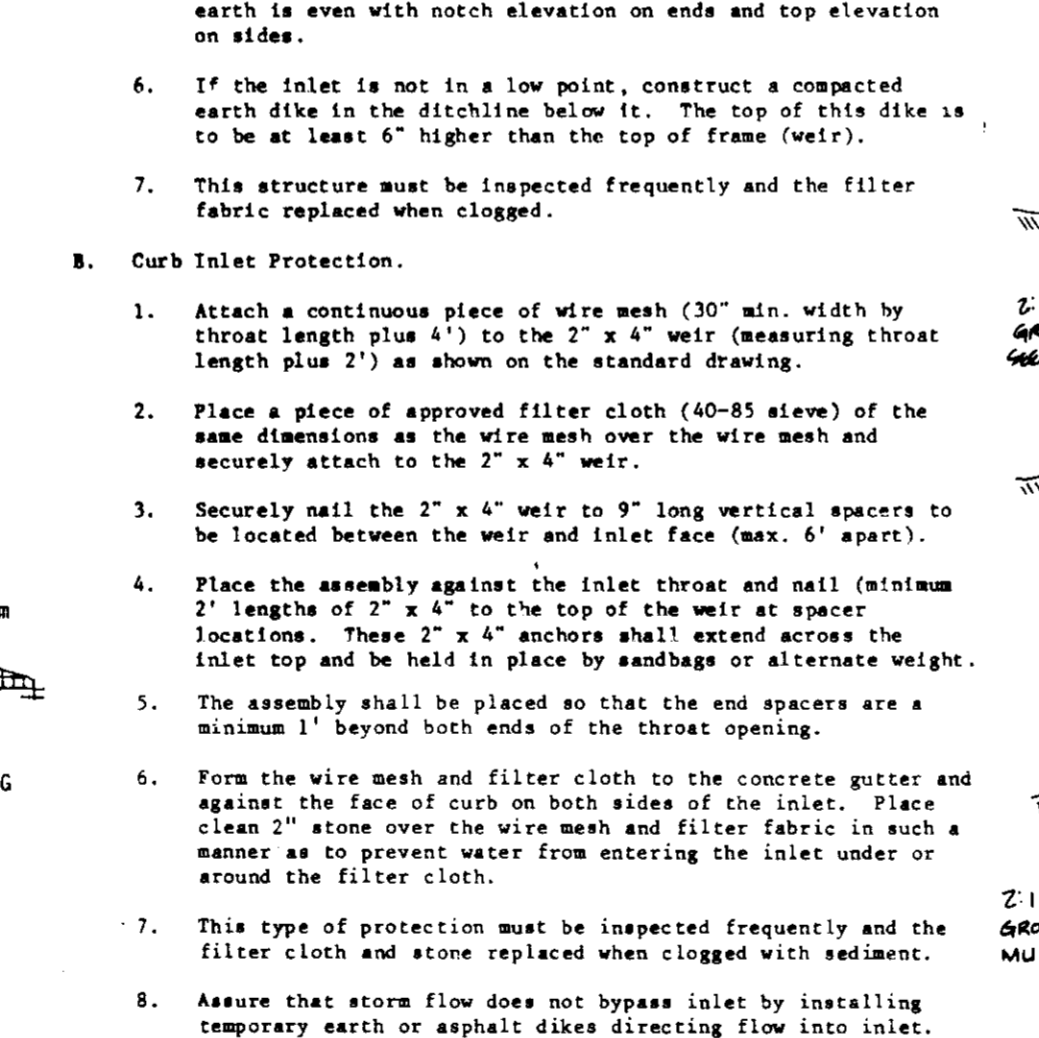

**INLET PROTECTION**  
NOT TO SCALE

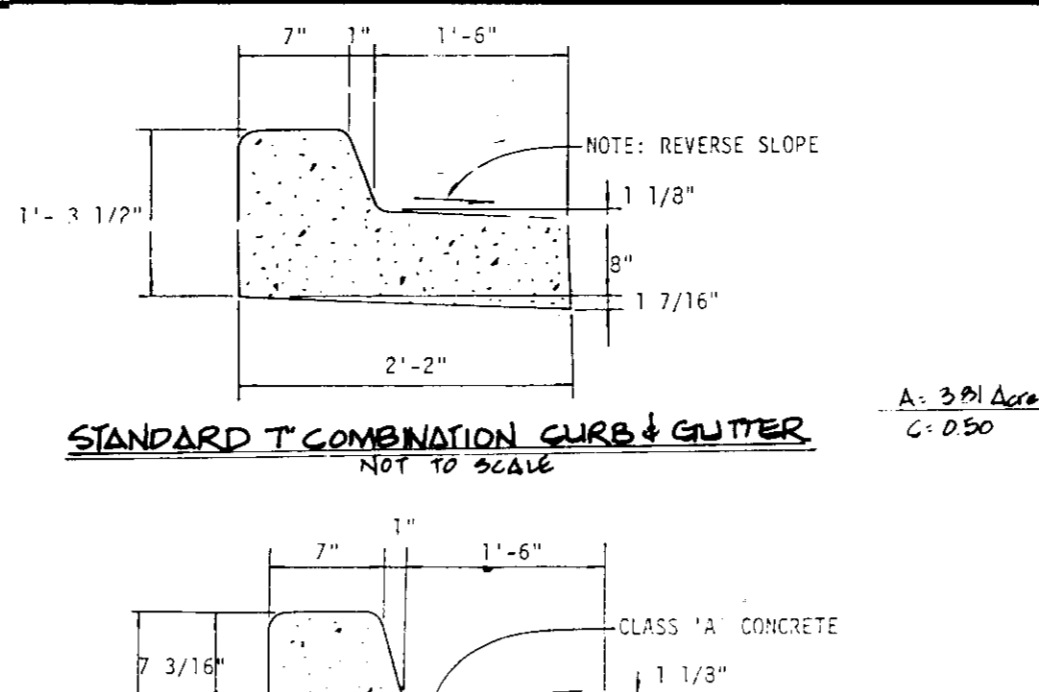

**STANDARD T COMBINATION CURB & GUTTER**  
NOT TO SCALE

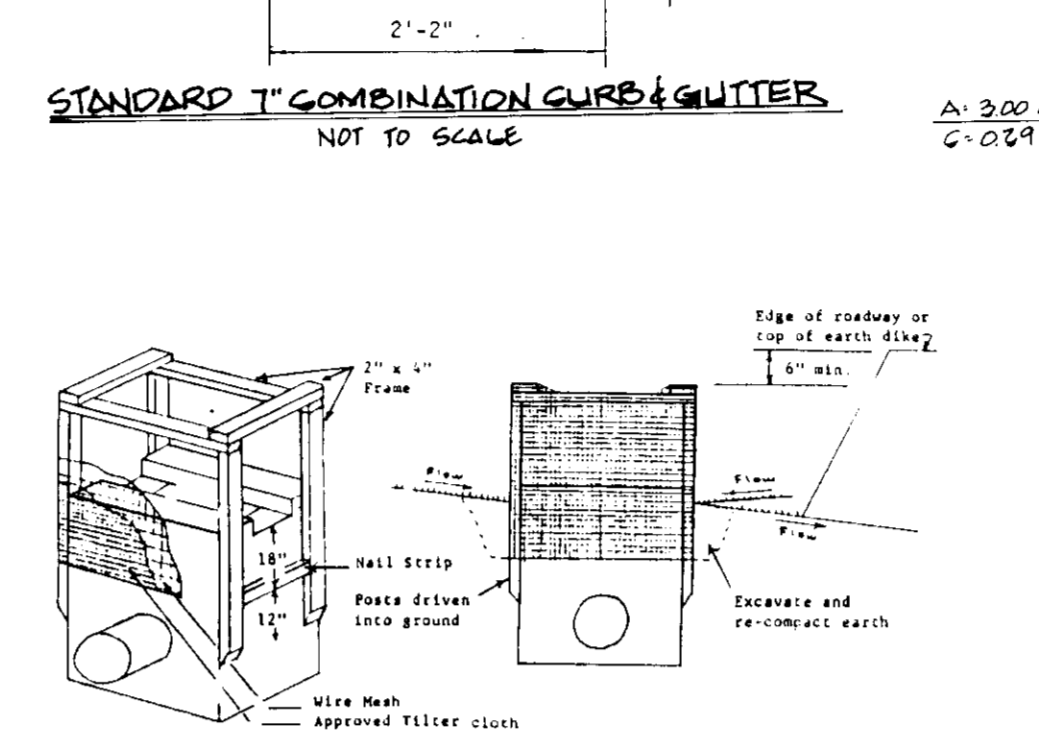

**STANDARD T COMBINATION CURB & GUTTER**  
NOT TO SCALE

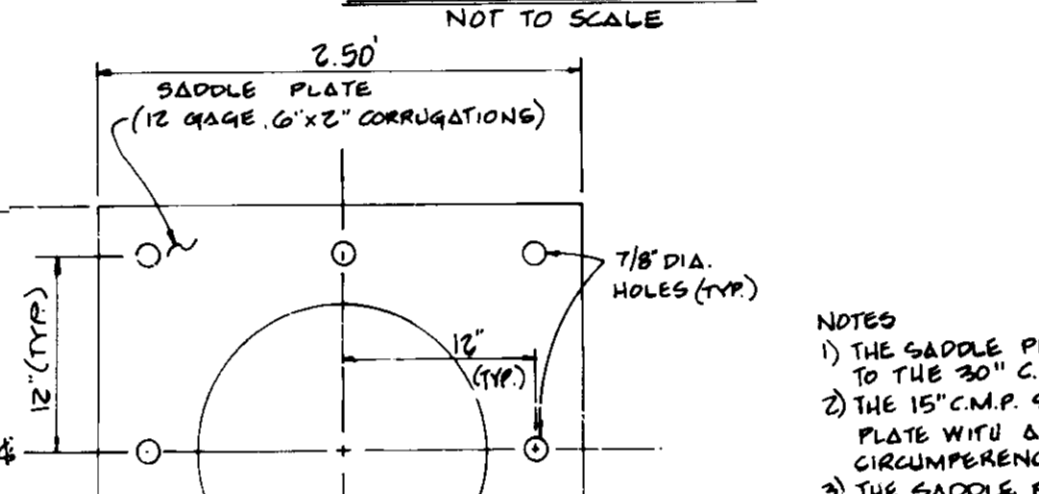

**SADDLE PLATE DETAIL**  
NOT TO SCALE

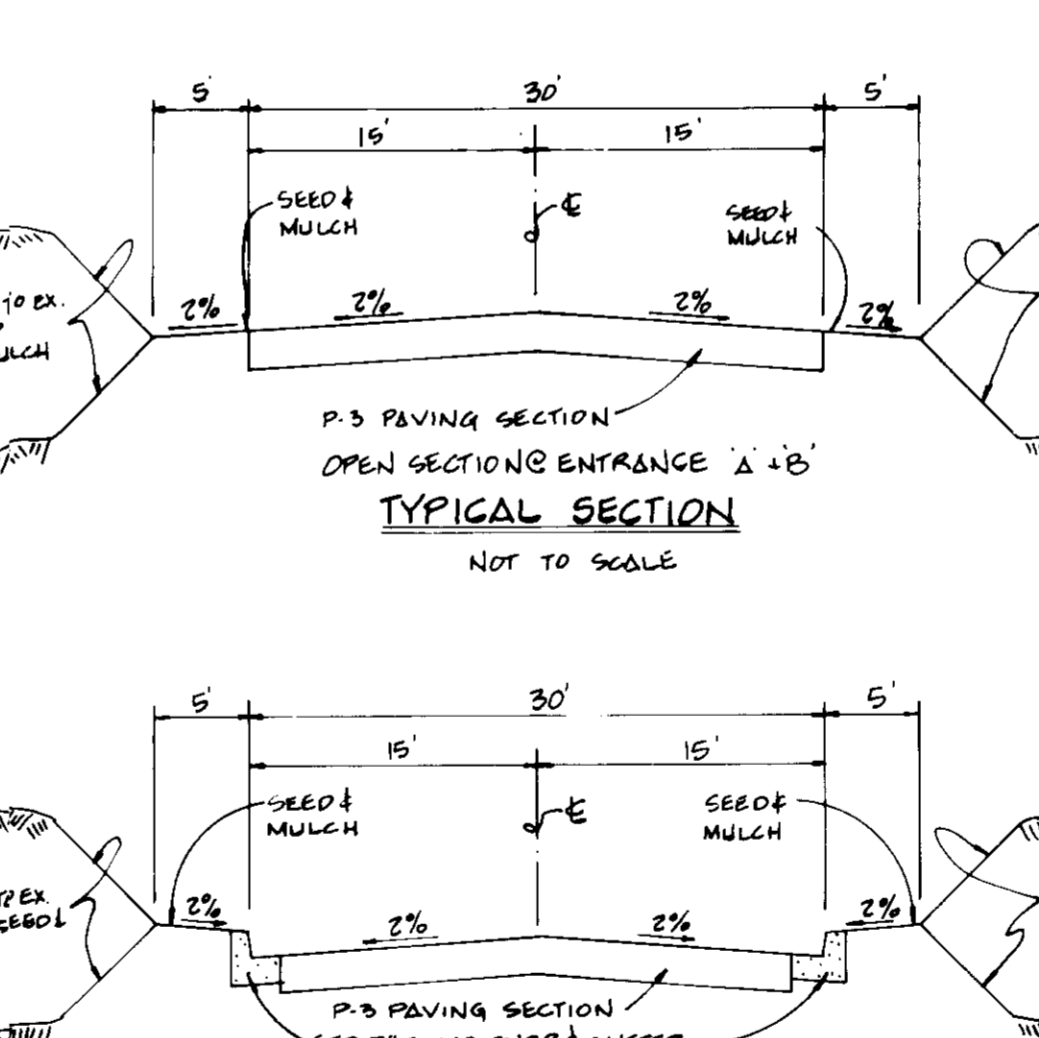

**INLET PROTECTION**  
NOT TO SCALE

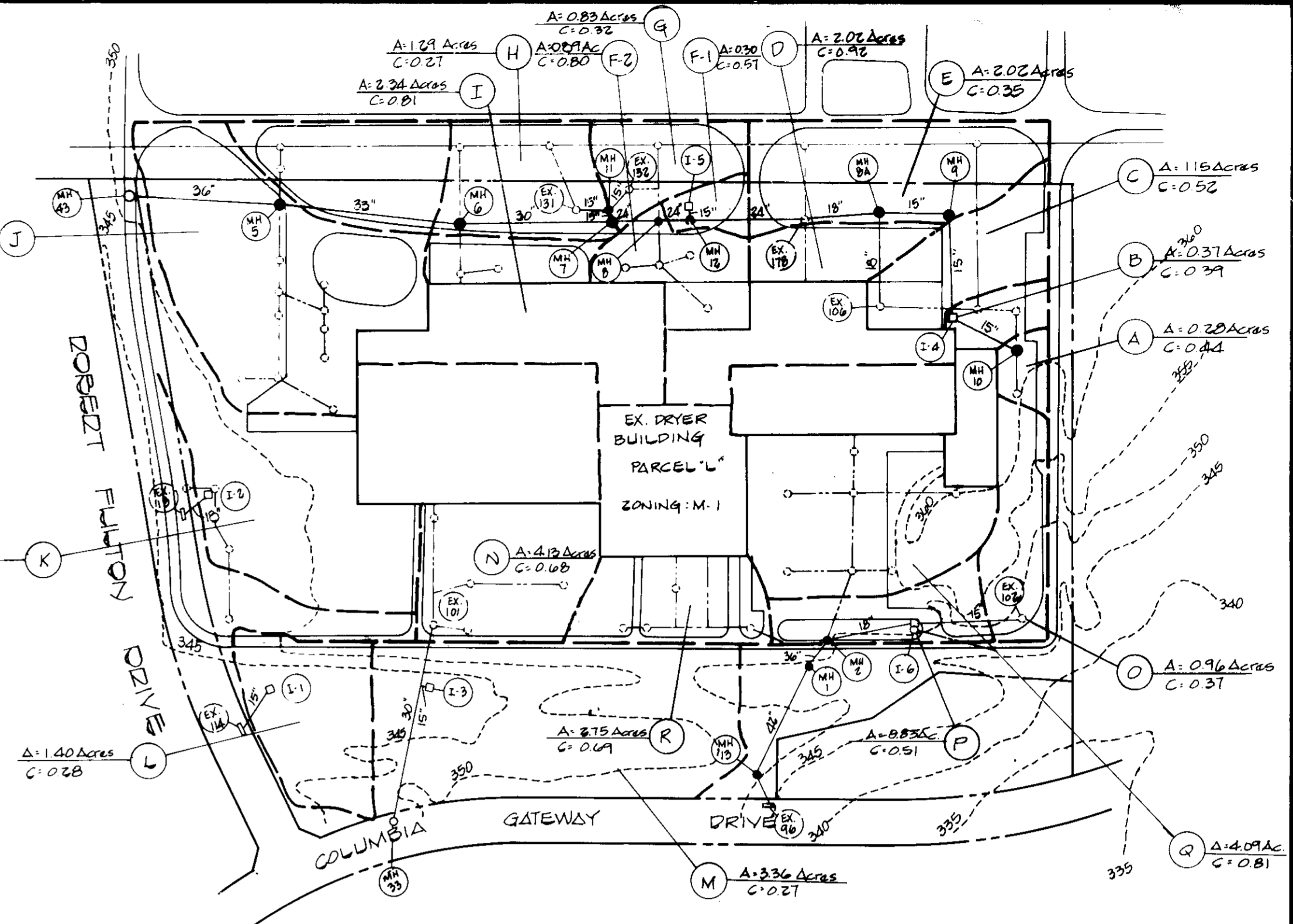

**DRAINAGE AREA MAP**  
SCALE 1"=200'

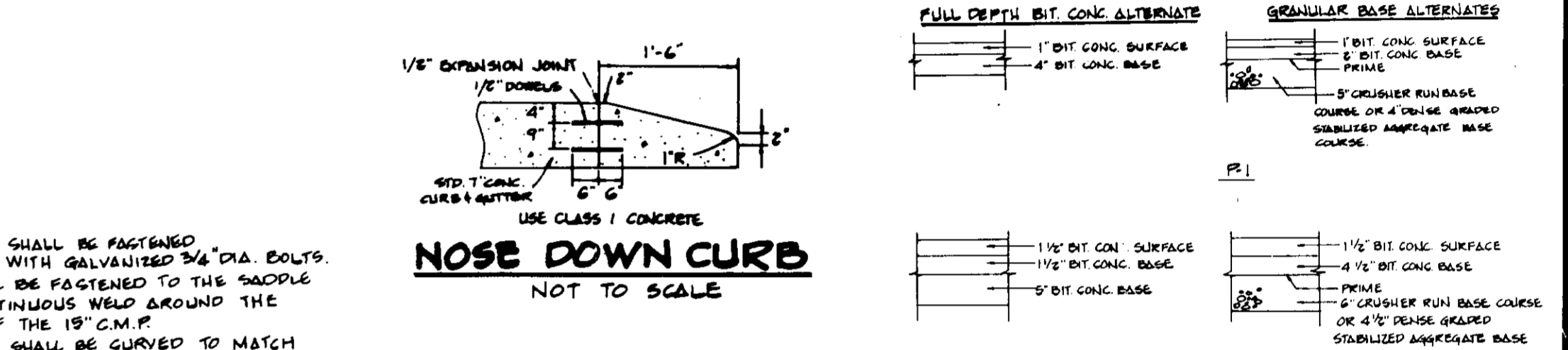

**NOSE DOWN CURB**  
NOT TO SCALE

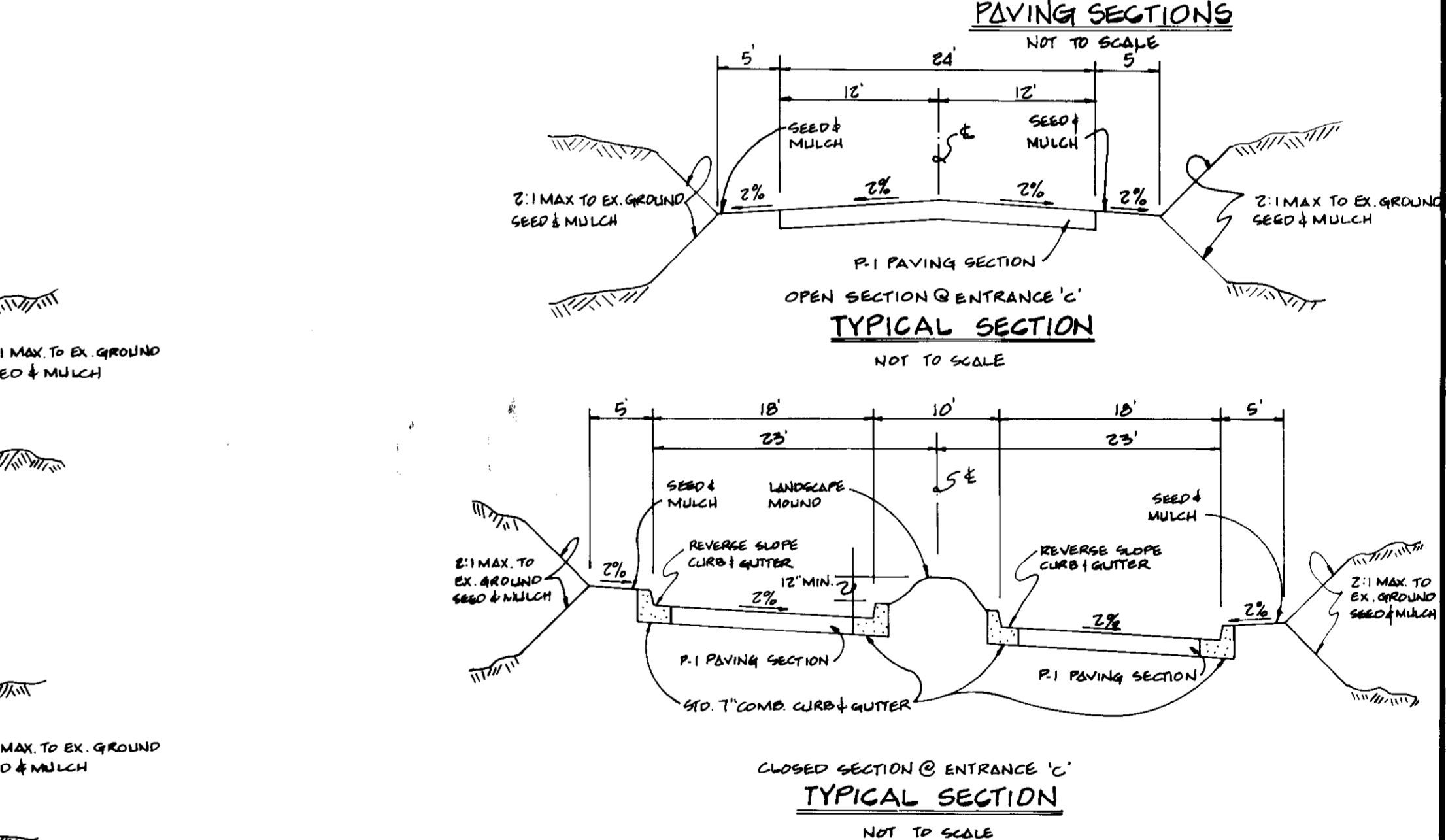

**PAVING SECTIONS**  
NOT TO SCALE

OWNER & DEVELOPER  
THE HOWARD RESEARCH & DEVELOPMENT CORPORATION  
10275 LITTLE PATUXENT PARKWAY  
COLUMBIA, MD. 21044  
TELE: (301) 992-6000

NOTES: THE PURPOSE OF THIS SITE DEVELOPMENT PLAN IS FOR PRIVATE ON-SITE UTILITY LOCATIONS, CONNECTIONS AND THE CONSTRUCTION OF ON-SITE ENTRANCE ROADS ONLY-NOT FOR USE OR OCCUPANCY OF THE EXISTING BUILDING.

**ENGINEER'S CERTIFICATE**  
I HEREBY CERTIFY THAT THIS PLAN FOR EROSION AND SEDIMENT CONTROL REPRESENTS A PRACTICAL AND WORKABLE PLAN BASED ON MY PERSONAL KNOWLEDGE OF THE SITE CONDITIONS AND THAT IT WAS PREPARED IN ACCORDANCE WITH THE REQUIREMENTS OF THE HOWARD SOIL CONSERVATION DISTRICT.

**FISHER, COLLINS & CARTER, INC.**  
CIVIL ENGINEERS & LAND SURVEYORS  
8388 COURT AVENUE  
ELLCOTT CITY, MARYLAND 21043  
(301) 461-2855

**DEVELOPER'S CERTIFICATE**  
I/WE CERTIFY THAT ALL DEVELOPMENT AND CONSTRUCTION WILL BE DONE ACCORDING TO THIS PLAN OF DEVELOPMENT AND PLAN FOR EROSION AND SEDIMENT CONTROL AND THAT ALL RESPONSIBLE PERSONNEL INVOLVED IN THE CONSTRUCTION PROJECT WILL HAVE A CERTIFICATE OF ATTENDANCE AT A DEPARTMENT OF NATURAL RESOURCES APPROVED TRAINING PROGRAM FOR THE CONTROL OF SEDIMENT AND EROSION BEFORE BEGINNING THE PROJECT. I ALSO AUTHORIZE PERIODIC ON-SITE INSPECTION BY THE HOWARD SOIL CONSERVATION DISTRICT OR THEIR AUTHORIZED AGENTS, AS ARE DEEMED NECESSARY.

**John H. Nally**  
7-25-86

REVIEWED FOR HOWARD SOIL CONSERVATION DISTRICT AND MEETS TECHNICAL REQUIREMENTS

**John H. Nally**  
U.S. SOIL CONSERVATION SERVICE  
DATE: 8-8-86

THIS DEVELOPMENT IS APPROVED FOR EROSION AND SEDIMENT CONTROL BY THE HOWARD SOIL CONSERVATION DISTRICT.

APPROVED: **John H. Nally**  
DATE: 7-25-86

APPROVED: OFFICE OF PLANNING AND ZONING

PLANNING DIRECTOR: **John H. Nally**  
DATE: 8-18-86

CHIEF, DIVISION OF LAND DEVELOPMENT AND ZONING ADMINISTRATION

APPROVED: HOWARD COUNTY HEALTH DEPARTMENT FOR PUBLIC WATER AND SEWERAGE SYSTEMS

HEALTH OFFICER: **John H. Nally**  
DATE: 8-18-86

APPROVED: DEPARTMENT OF PUBLIC WORKS FOR PUBLIC WATER & SEWER AND STORM DRAINAGE SYSTEMS AND ROADS.

DIRECTOR, PUBLIC WORKS: **John H. Nally**  
DATE: 8-18-86

SUBDIVISION: COLUMBIA GATEWAY - DRYER BUILDING  
SECTION/AREA: PARCEL 'L'

PLAT NO: 2012/0013  
BLOCK NO: 312/117  
TAX/ZONE: M-1  
ELEC. DIST: 42/43  
CENSUS TR: 6th  
SEWER CODE: 4900000

**NOTES AND DETAILS**  
**COLUMBIA GATEWAY**  
PARCEL 'L'  
**DRYER BUILDING**  
TAX MAPS NO. 42-43  
SIXTH ELECTION DISTRICT  
HOWARD COUNTY, MARYLAND  
SCALE: AS SHOWN MAY 27, 1986  
SHEET 8 OF 8  
REVISED JULY 7, 1986  
SOP 80-038