

ADDRESS CHART	
LOT NUMBER	STREET ADDRESS
PARCEL 'C-2'	9020 JUNCTION DRIVE

GARRISON INC.
499 / 331 ZONED M-2

A. B. HURD
573/45 ZONED M-2

7-1-86
M-9/11

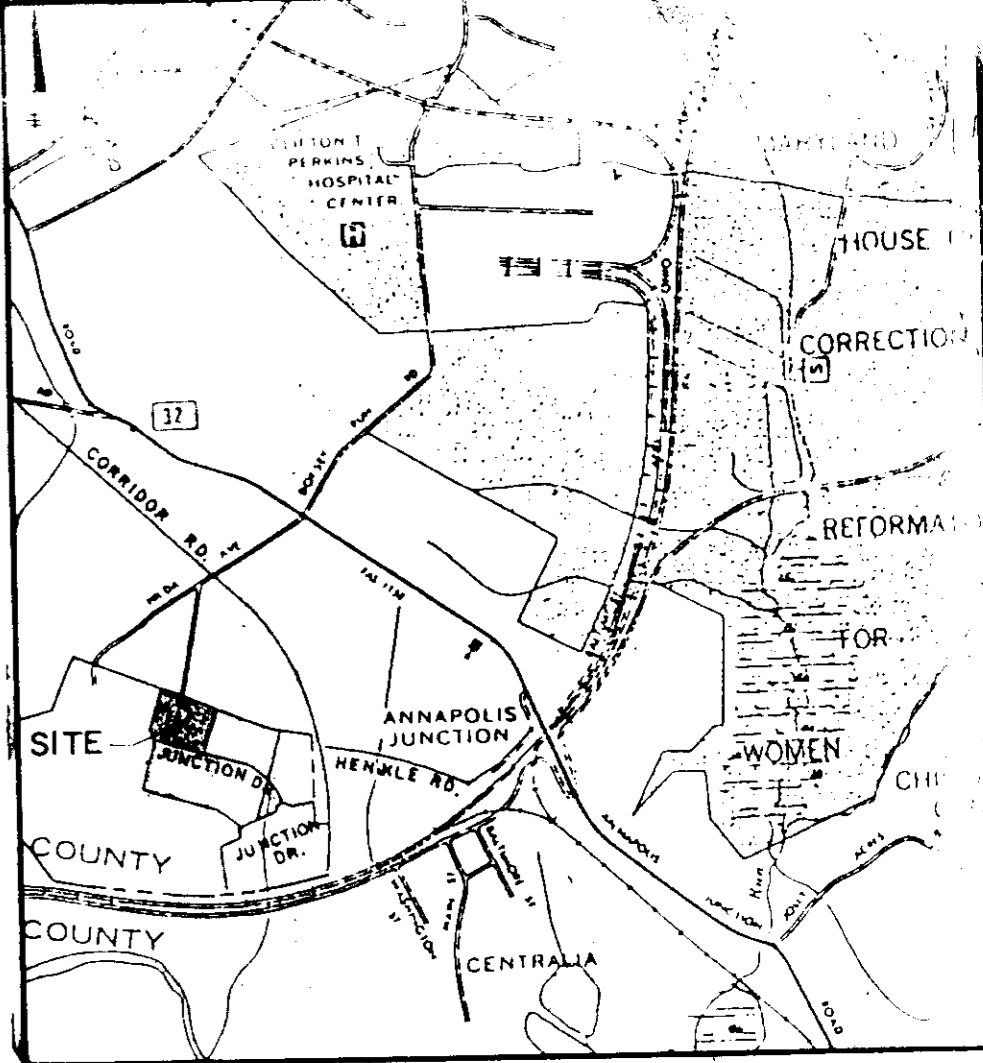
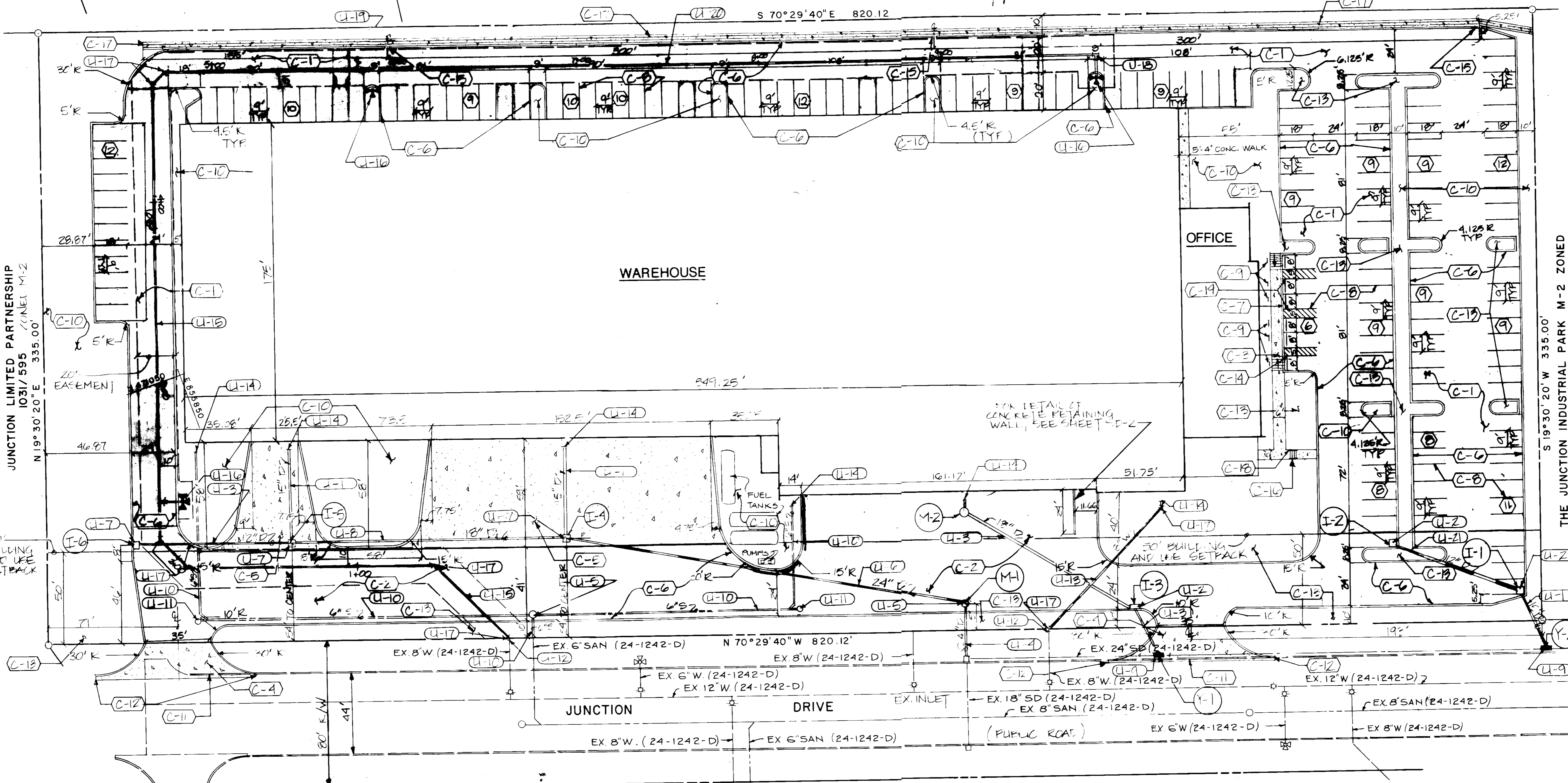

VICINITY MAP
SCALE: 1" = 2000'

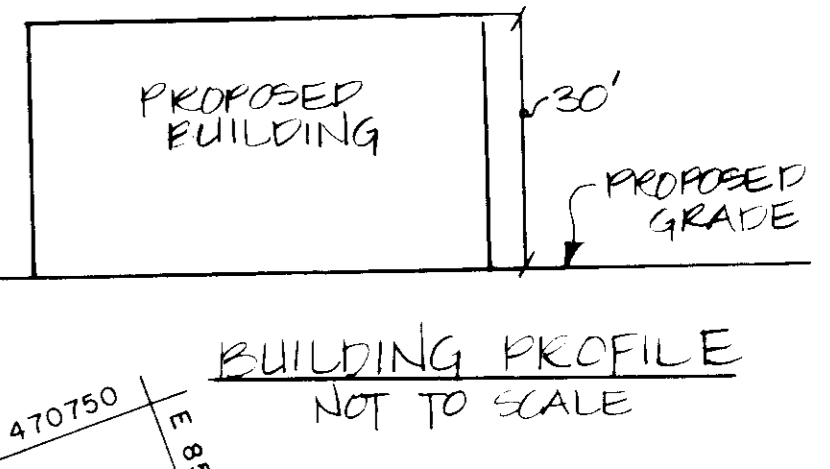

- GENERAL NOTES
- PRIOR TO THE START OF ANY CONSTRUCTION THE CONTRACTOR SHALL STAKE OUT ALL BASELINES, BUILDING LOCATION, AND CURVES, AND VERIFY OFFSETS AND SETBACKS.
 - THE CONTRACTOR SHALL NOTIFY "MISS UTILITY" AT TELEPHONE NO. (301) 589-0100 AT LEAST 72 HOURS PRIOR TO STARTING EXCAVATION TO VERIFY ALL LOCATIONS OF EXISTING UTILITIES.
 - ALL CONSTRUCTION SHALL BE ACCOMPLISHED IN ACCORDANCE WITH HOWARD COUNTY, DEPARTMENT OF PUBLIC WORKS STANDARDS, SPECIFICATIONS AND REQUIREMENTS.
 - THE INFORMATION SHOWN ON THESE PLANS IS FOR THE CONVENIENCE OF THOSE CONCERNED ONLY. THE CORRECTNESS OR COMPLETENESS OF THE INFORMATION SHOWN IS NOT WARRANTED OR GUARANTEED. THE CONTRACTOR SHALL VERIFY ALL INFORMATION TO HIS OWN SATISFACTION.
 - THE LOCATIONS OF EXISTING UNDERGROUND UTILITIES ARE SHOWN IN AN APPROXIMATE WAY ONLY. THE CONTRACTOR SHALL DETERMINE THE EXACT LOCATION OF ALL EXISTING UTILITIES BEFORE COMMENCING WORK. HE SHALL BE FULLY RESPONSIBLE FOR ANY AND ALL DAMAGES WHICH MIGHT BE OCCASIONED BY HIS FAILURE TO EXACTLY LOCATE AND PRESERVE ANY AND ALL UNDERGROUND UTILITIES.
 - ALL DISTURBED AREAS NOT STABILIZED WITH PAVING, BUILDING, LODGING OF MULCH IN PLANTING AREAS SHALL BE SEEDED AND MULCHED.
 - STORM WATER MANAGEMENT PROVIDED IN PARCEL R-1 UNDER FINAL PLANS 184-204.

- CONSTRUCTION NOTES
- C-1 NEW BITUMINOUS PAVING, LIGHT DUTY, SEE DETAIL 11, SHEET SD-5.
 - C-2 NEW BITUMINOUS PAVING, HEAVY DUTY, SEE DETAIL 11, SHEET SD-5.
 - C-3 NEW 3" CONCRETE SIDEWALK, SEE DETAIL 10, SHEET SD-5.
 - C-4 NEW CONCRETE DRIVEWAY ENTRANCE, REFER TO HOWARD COUNTY NO. STANDARD SPECIFICATIONS & DETAILS FOR CONSTRUCTION, STD. PLATE R-6.07.
 - C-5 NEW 8" CONCRETE PAVING, SEE DETAIL 6, SHEET SD-5.
 - C-6 NEW STANDARD 7" CURB & GUTTER COMBINATION, REFER TO HOWARD COUNTY NO. STANDARD SPECIFICATIONS & DETAILS FOR CONSTRUCTION, STD. PLATE R-4.01.
 - C-7 4" LINEAR FT. OF DEPRESSED CURB, SEE DETAIL 9, SHEET SD-5.
 - C-8 PAVEMENT MARKINGS TO BE DONE WITH YELLOW TRAFFIC PAINT, SEE DETAIL 7, SHEET SD-5.
 - C-9 NEW HANDICAP RESERVE PARKING SIGNS, SEE DETAIL 8, SHEET SD-5.
 - C-10 ALL DISTURBED AREAS WHICH ARE NOT PAVED OR PLANTED IN ACCORDANCE WITH THE PLANTING PLAN, SHEET SD-4, SHALL BE SEEDED & MULCHED, SEE SPECIFICATIONS.
 - C-11 REMOVE EXISTING CURB & GUTTER.
 - C-12 MEET EXISTING GRADE.
 - C-13 REFER TO PLANTING PLAN, SHEET SD-4.
 - C-14 HANDICAP PAVEMENT MARKINGS, SEE DETAIL 7, SHEET SD-5.
 - C-15 CURB OPENING, SEE DETAIL 10, SHEET SD-5.
 - C-16 CONCRETE STAIRS, REFER TO HOWARD COUNTY NO. STANDARD SPECIFICATIONS & DETAILS FOR CONSTRUCTION, STD. PLATE NO. 61.07.
 - C-17 CONCRETE CHANNEL, SEE DETAIL 12, SHEET SD-5.
 - C-18 NEW HANDICAP REFER TO HOWARD COUNTY NO. STANDARD SPECIFICATIONS & DETAILS FOR CONSTRUCTION, STD. PLATE NO. 47.02.

- UTILITY NOTES
- U-1 INSTALL NEW 12" RCCP GA 18.
 - U-2 INSTALL NEW DOUBLE 6" COME-THLET SEE SHEET 6 FOR INVERT & TOP ELEV.
 - U-3 INSTALL NEW 18" RCP CL IV.
 - U-4 INSTALL NEW 24" RCP CL IV FROM EX INLET TO MANHOLE M-1.
 - U-5 INSTALL NEW STANDARD MANHOLE SEE SHEET 6 FOR INVERT & TOP ELEVATION.
 - U-6 INSTALL NEW 24" RCP CL IV.
 - U-7 INSTALL NEW TYPE S INLET SEE SHEET 6 FOR INVERT & TOP ELEVATION.
 - U-8 INSTALL NEW 18" RCP CL IV.
 - U-9 INSTALL NEW SINGLE BRICK Y SEE SHEET 6 FOR INVERT.
 - U-10 INSTALL NEW 6" SANITARY SEWER.
 - U-11 INSTALL NEW CLEANOUTS PER HOWARD COUNTY STANDARD DETAIL S-2.22 SEE SHEET 6 FOR INVERT.
 - U-12 REMOVE EXISTING CAP & BUTTRUSS.
 - U-13 INSTALL NEW 6" WATER HOUSE CONNECTION.
 - U-14 SEE MECHANICAL DRAWING FOR CONTINUATION.
 - U-15 INSTALL NEW #1 FIRE LINE.
 - U-16 INSTALL NEW 6" FIRE HYDRANT TO INCLUDE TEE, VALVE, ROADWAY BOX AND 1" LEADER.
 - U-17 INSTALL 3/8" BEND.
 - U-18 INSTALL 1 1/2" BEND.
 - U-19 INSTALL NEW #1 X 6" REDUCER.
 - U-20 INSTALL NEW 12" CMP CO. 14.

THE JUNCTION INDUSTRIAL PARK M-2 ZONED PARCEL 'G-1'

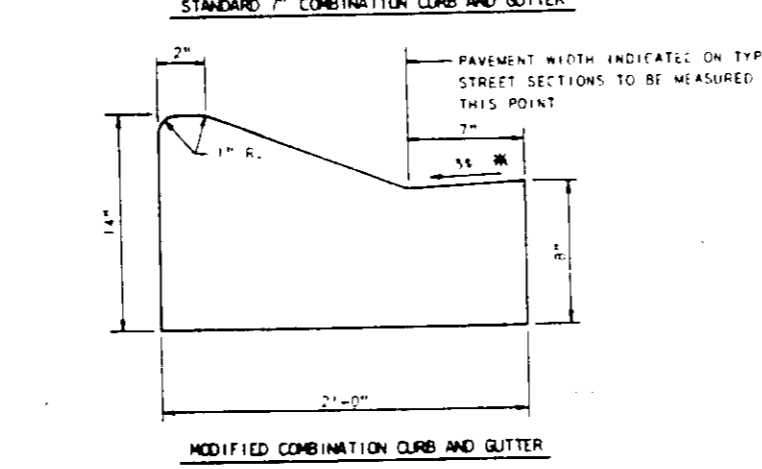
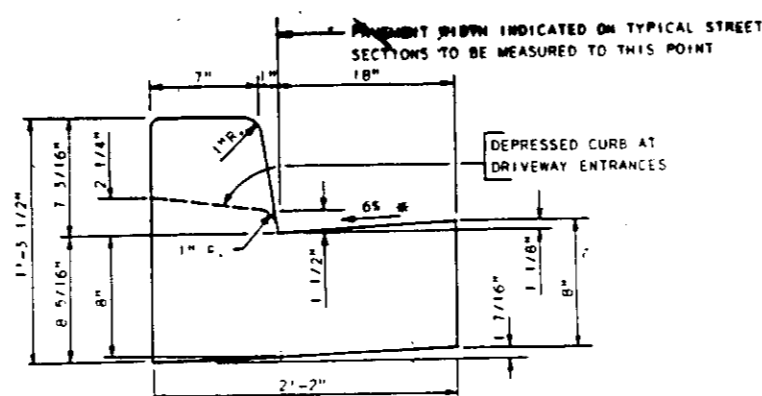

CURB & GUTTER

LEGEND

	EXISTING	NEW
BITUMINOUS CONCRETE PAVING (LIGHT DUTY)	[Symbol]	[Symbol]
BITUMINOUS CONCRETE PAVING (HEAVY DUTY)	[Symbol]	[Symbol]
CONCRETE PAVING	[Symbol]	[Symbol]
CURB AND GUTTER	[Symbol]	[Symbol]
STORM DRAIN	EX 24" SD	[Symbol]
SANITARY	EX 8" SAN	[Symbol]
WATER	EX 12" W	[Symbol]
PARKING SPACE AMOUNT	[Symbol]	[Symbol]

SUBDIVISION NAME THE JUNCTION INDUSTRIAL PARK		SECT./AREA 1/1	LOT/PARCEL # C-2
PLAT # 6379	BLOCK # 19	ZONE M-2	TAX/ZONE MAP 48
ELEC. DIST. 6		CENSUS TR. 606A	
WATER CODE CC4		SEWER CODE 4020000	
APPROVED: FOR PUBLIC WATER & PUBLIC SEWERAGE & FOR STORM DRAINAGE SYSTEMS AND ROADS. HOWARD COUNTY DEPARTMENT OF PUBLIC WORKS Director: [Signature] DATE: 8-12-86			
APPROVED: FOR WATER AND PUBLIC SEWERAGE SYSTEMS HOWARD COUNTY HEALTH DEPARTMENT County Health Officer: [Signature] DATE: 8-13-86			
APPROVED: HOWARD COUNTY OFFICE OF PLANNING AND ZONING Planning Director: [Signature] DATE: 8-14-86			

DATE	NO	REVISION
PROJECT: THE JUNCTION INDUSTRIAL PARK		
6th ELECTION DISTRICT HOWARD CO., MARYLAND SECTION I AREA I PARCEL 'C-2'		
TITLE: SD-1 LAYOUT AND UTILITY PLAN		
OWNER: LUCAS MANAGEMENT SERVICES CO 7700 PORT CAPITAL DRIVE BALTIMORE MD 21227		
ENGINEERS: WHITNEY, BAILEY, COX & MAGNANI CONSULTING ENGINEERS 1850 YORK ROAD TIMONUM, MARYLAND 21093 301-252-6080		
DATE:	DESIGNED: RZF	
	DRAWN: RZF	
	CHECKED: PD	
	PROJECT NO: E600	
	DATE: 3/31/86	
	SCALE: 1" = 30'	
PROFESSIONAL ENGR NO.	DRAWING NO.	

SDP-86-219

VISION OF LAND DEVELOPMENT
 ZONING ADMINISTRATION
 HOWARD COUNTY, MARYLAND
 7-1-86

GARRISON INC.
 499 / 331

A B HURD
 573 / 45

S 70°29'40"E 820.12

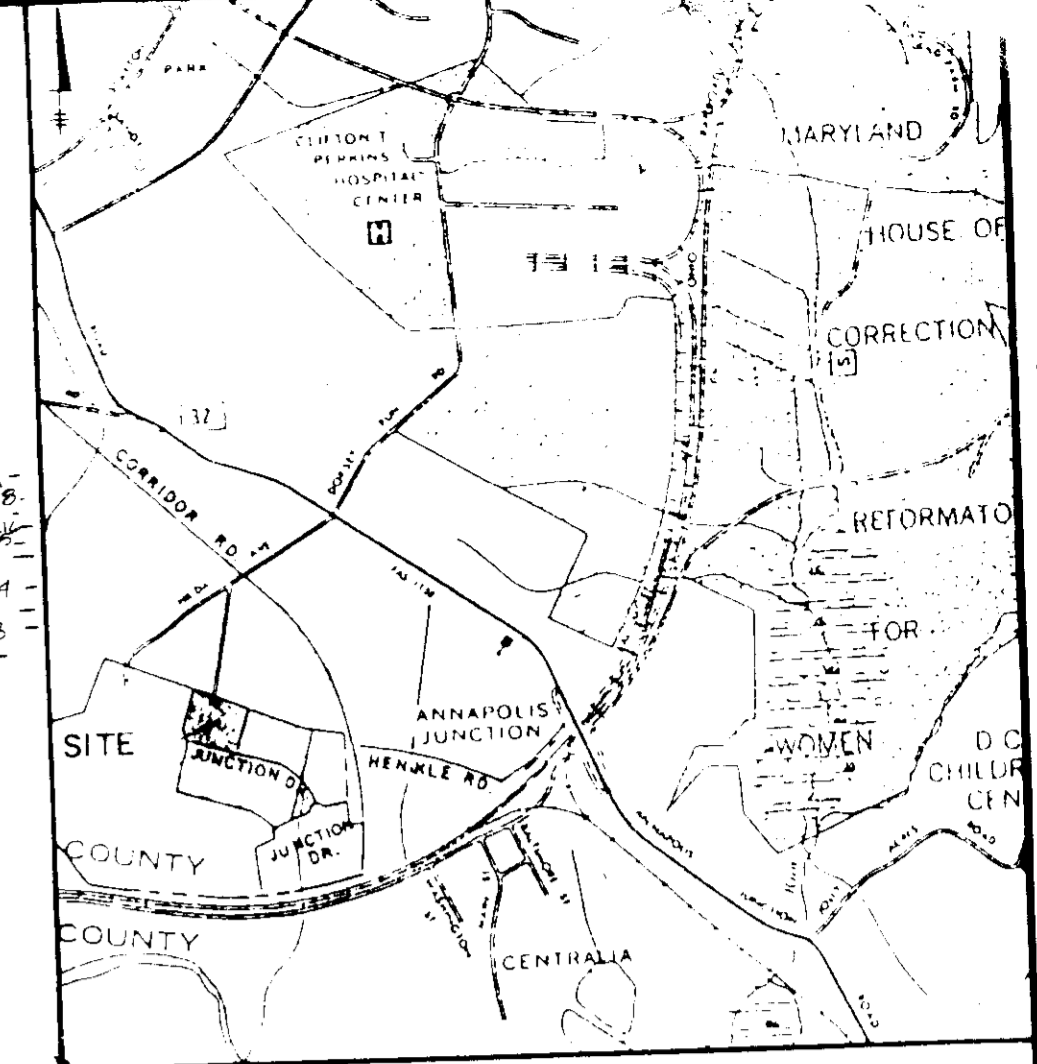

VICINITY MAP
 SCALE 1" = 2000'

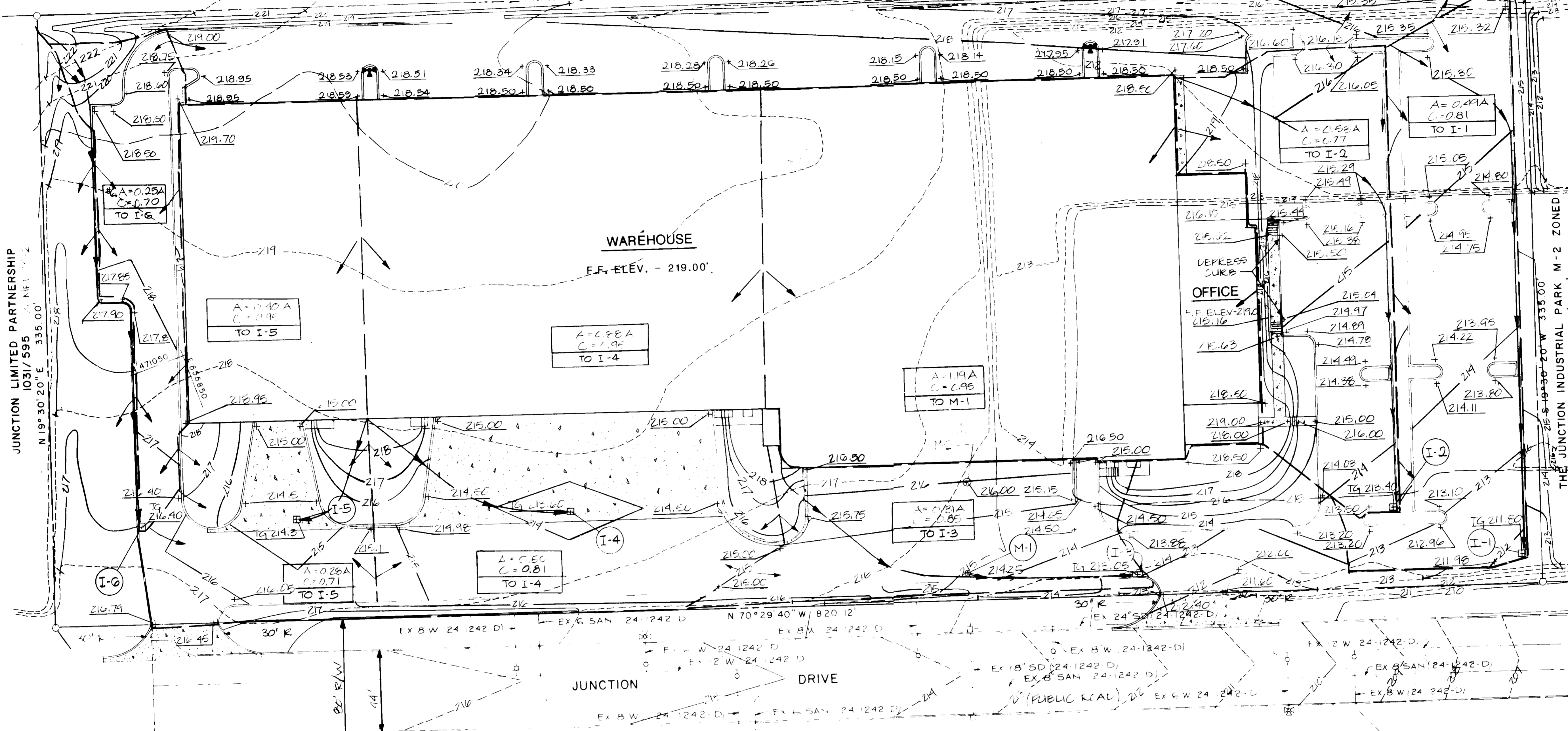

JUNCTION LIMITED PARTNERSHIP
 1031 / 595
 N 19°30'20"E 335.00'

THE JUNCTION INDUSTRIAL PARK M-2 ZONED
 PARCEL 'B-2'

THE JUNCTION INDUSTRIAL PARK M-2 ZONED
 PARCEL 'G-1'

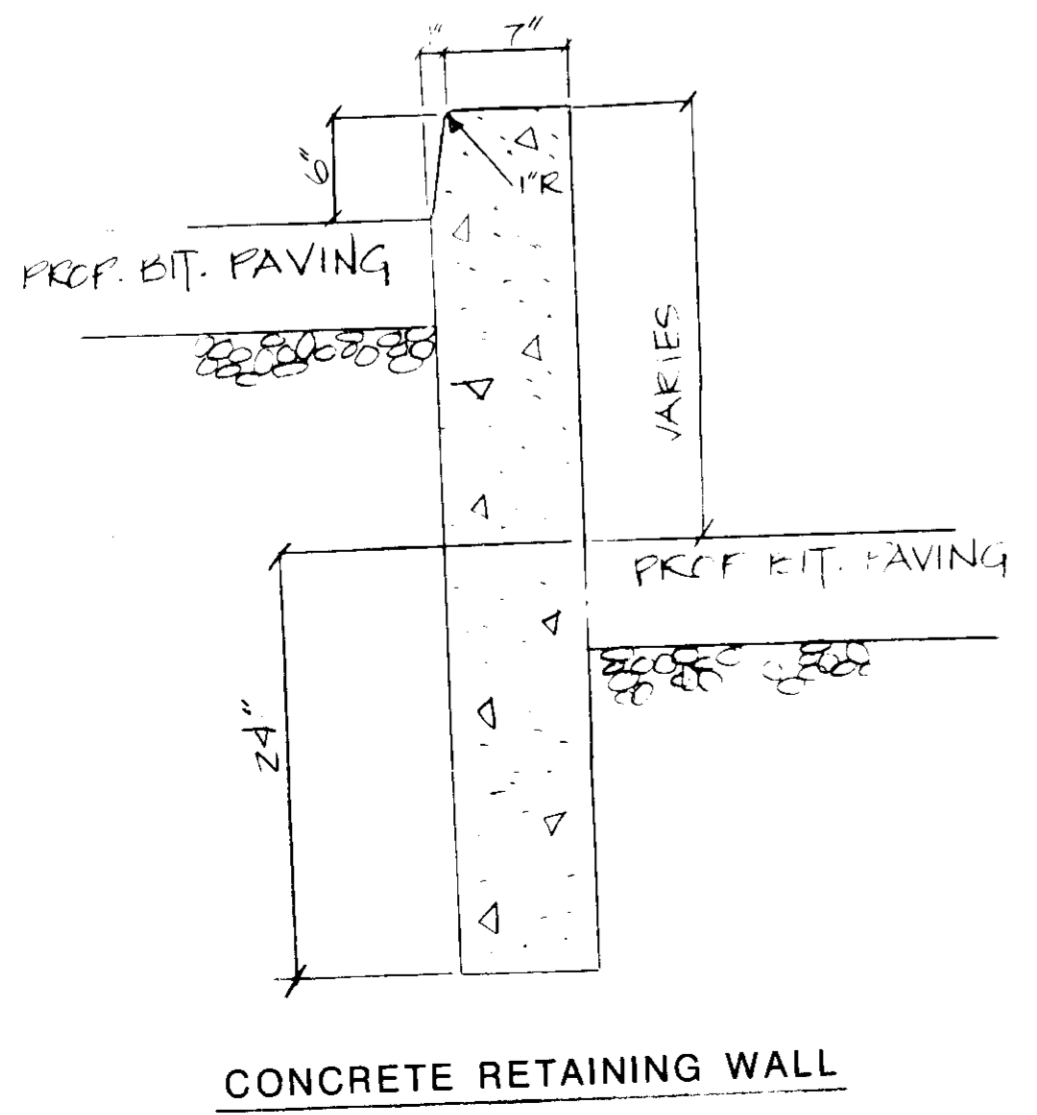

LEGEND		EXISTING	NEW
FINISHED GRADE		---	---
FINISHED SPOT ELEVATION			+
CONCRETE PAVING			+
CURB AND GUTTER			+
STORM DRAIN		EX 24" SD	
SANITARY		EX 8" SAN	
WATER		EX 12" W	
PARKING SPACE AMOUNT			(9)
DRAINAGE DELINEATION AREA			←

PROJECT NO.	11	REVISION	C-2
DATE	8-14-86	DATE	8-14-86
OWNER	LUCAS MANAGEMENT SERVICES CO.	OWNER	LUCAS MANAGEMENT SERVICES CO.
ENGINEERS	WHITNEY, BAILEY, COX & MAGNAN	ENGINEERS	WHITNEY, BAILEY, COX & MAGNAN
DESIGNED	RZE	DESIGNED	RZE
DRAWN	RZE	DRAWN	RZE
CHECKED	PD	CHECKED	PD
PROJECT NO.	86000	PROJECT NO.	86000
DATE	3/31/86	DATE	3/31/86
SCALE	1" = 30'	SCALE	1" = 30'

PROJECT	THE JUNCTION INDUSTRIAL PARK
SECTION	SECTION I AREA I PARCEL 'C-2'
TITLE	SD-2 GRADING PLAN / DRAINAGE AREA MAP
OWNER	LUCAS MANAGEMENT SERVICES CO. 7700 PORT CAPITAL DRIVE BALTIMORE MD 21227
ENGINEERS	WHITNEY, BAILEY, COX & MAGNAN CONSULTING ENGINEERS 1850 YORK ROAD TIMONIUM, MARYLAND 21093 301-252-6060
DATE	8-14-86
DESIGNED	RZE
DRAWN	RZE
CHECKED	PD
PROJECT NO.	86000
DATE	3/31/86
SCALE	1" = 30'

SDP-86-219

GARRISON INC.
499 / 331 ZONED M-2

7-1-86

A.B. HURD
573/45 ZONED M-2

S 70°29'40" E 820.12

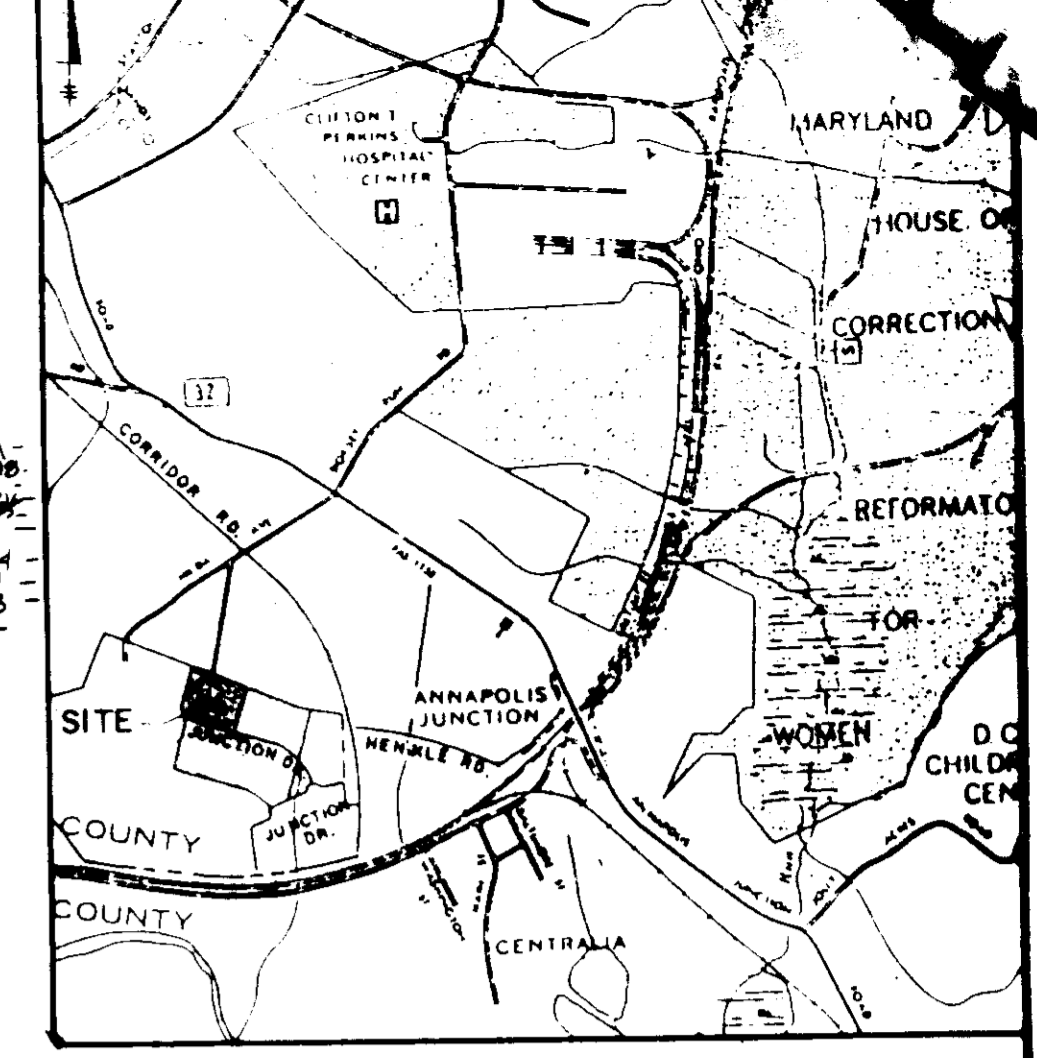
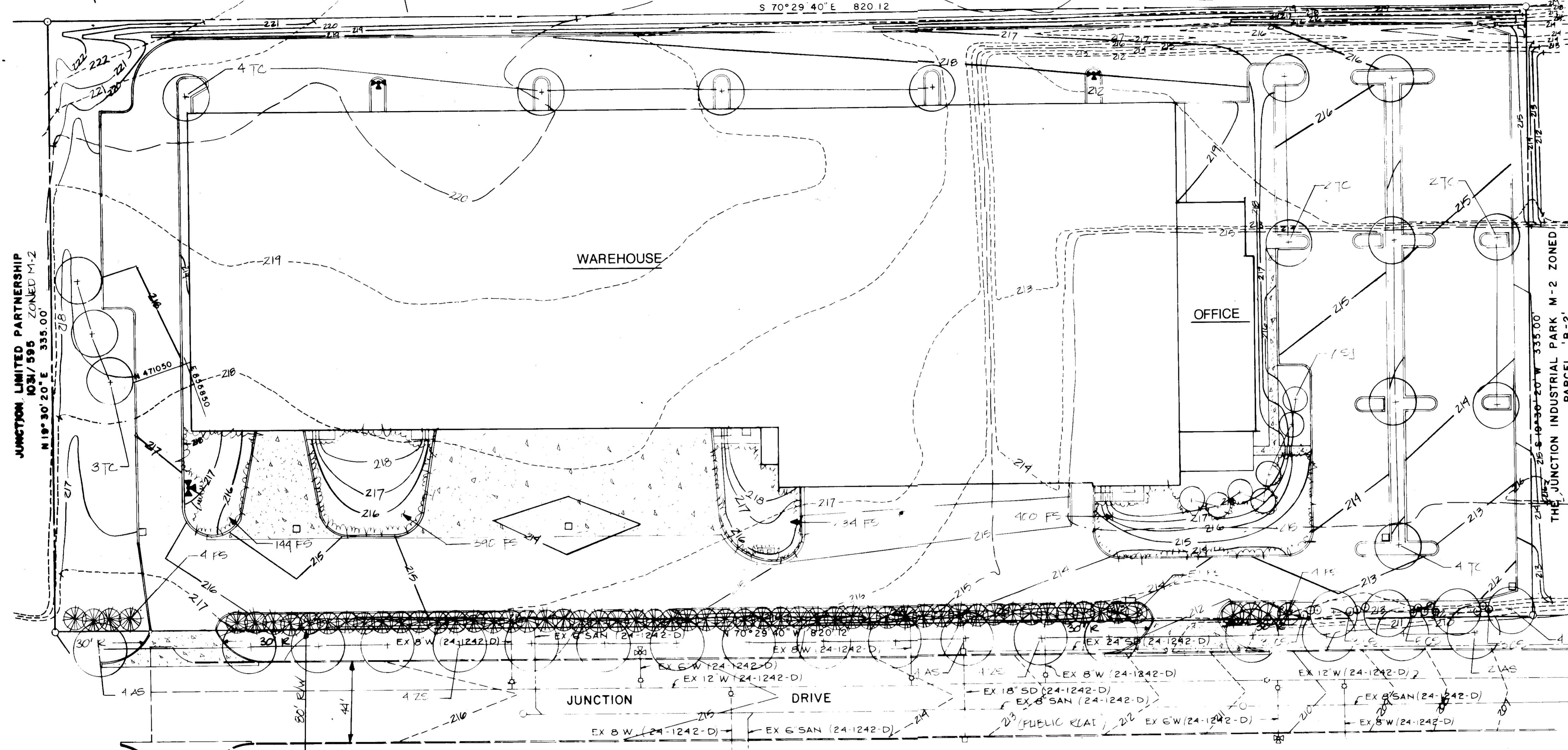

VICINITY MAP
SCALE 1" = 2000'

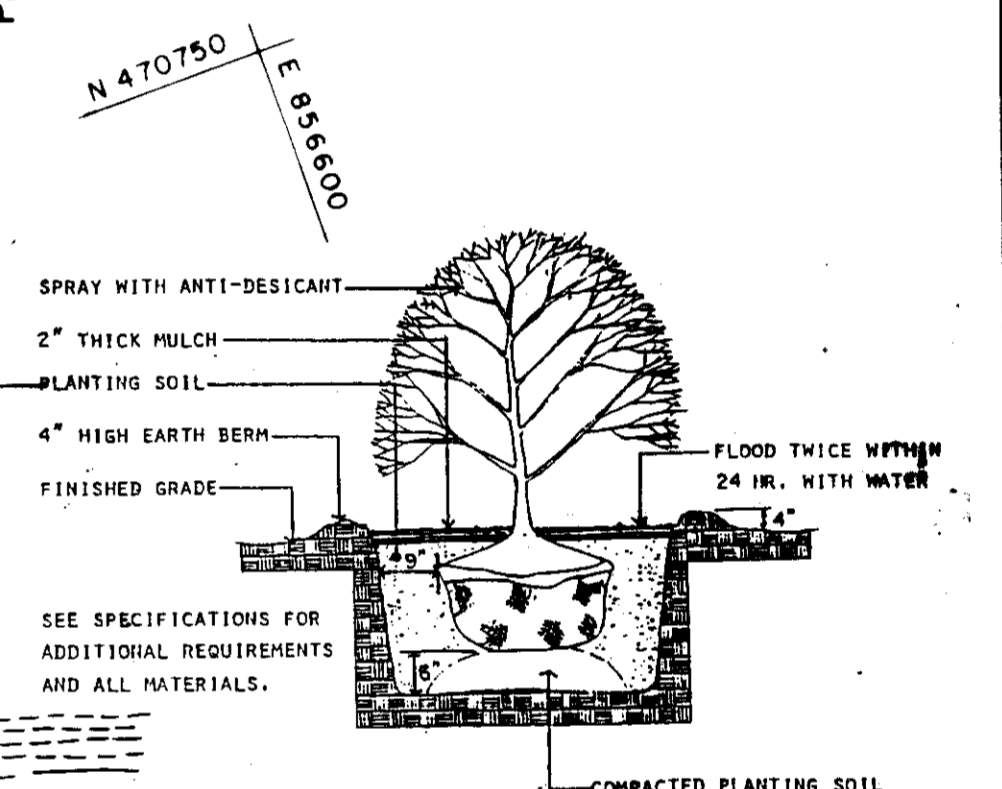
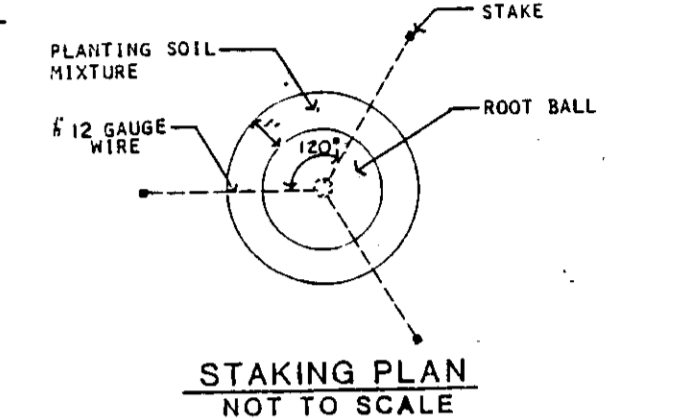

SHRUB PLANTING DETAIL

PLANT LIST

KEY	QUAN.	BOTANICAL NAME / COMMON NAME	SIZE	ROOT	REMARKS
AS	10	ACER SACCHARUM / GREEN MOUNTAIN SUGAR MAPLE	2-2 1/2" CAL	B&B	PLANT 40' O.C.
FS	59	PINUS STROBILUS / WHITE PINE	8-10' HT	B&B	PLANT 10' O.C. 2 1/2" CAL. MIN.
TC	19	TILIA CORDATA / GREENSPIKE / GREENSPIKE LITTLE LEAF LINDEN	2 1/2-3" CAL	B&B	
SJ	7	STYRAX JAPONICUS / JAPANESE SNOWBELL	6-8' HT	B&B	
FS	1168	FORSYTHIA SLEPENSIS / WEeping FORSYTHIA	2-3' HT	B&B	PLANT 4' O.C. STACKERED
CS	14	CORNUS SERICEA / KEOOSIER DOGWOOD	3-4' HT	B&B	
ZE	8	ZELKOVA SERKATA / VILLAGE GREEN / VILLAGE GREEN ZELKVA	2-2 1/2" CAL	B&B	PLANT 40' O.C.

- QUALITY AND SIZE OF PLANTS, SPREAD OF ROOTS, AND SIZE OF BALLS SHALL BE IN ACCORDANCE WITH THE STANDARDS OF THE AMERICAN ASSOCIATION OF NURSERYMEN, "AMERICAN STANDARDS FOR NURSERY STOCK".
- CONTRACTOR SHALL BE REQUIRED TO GUARANTEE ALL PLANTS MATERIALS FOR A PERIOD OF ONE YEAR AFTER INSTALLATION IS COMPLETE AND APPROVED. AT THE END OF ONE YEAR ALL PLANT MATERIAL WHICH IS DEAD OR DYING SHALL BE REPLACED AT THE CONTRACTOR'S EXPENSE WITH PLANT MATERIAL OF IDENTICAL TYPE, SIZE AND CONDITION AS ORIGINALLY SPECIFIED.
- CONTRACTOR SHALL BE RESPONSIBLE FOR ANY DAMAGE TO UTILITIES AND MAY MAKE MINOR ADJUSTMENTS IN SPACING AND/OR LOCATION OF PLANT MATERIALS TO AVOID CONFLICTS WITH UTILITIES. COORDINATE WITH UTILITY CONTRACTOR TO VERIFY 'AS BUILT' LOCATION OF ALL UTILITIES.
- EVERGREEN TREES SHALL HAVE A FULL, WELL-BRANCHED, CONICAL FORM TYPICAL OF THE SPECIES

THE JUNCTION INDUSTRIAL PARK M-2 ZONED PARCEL 'G-1'

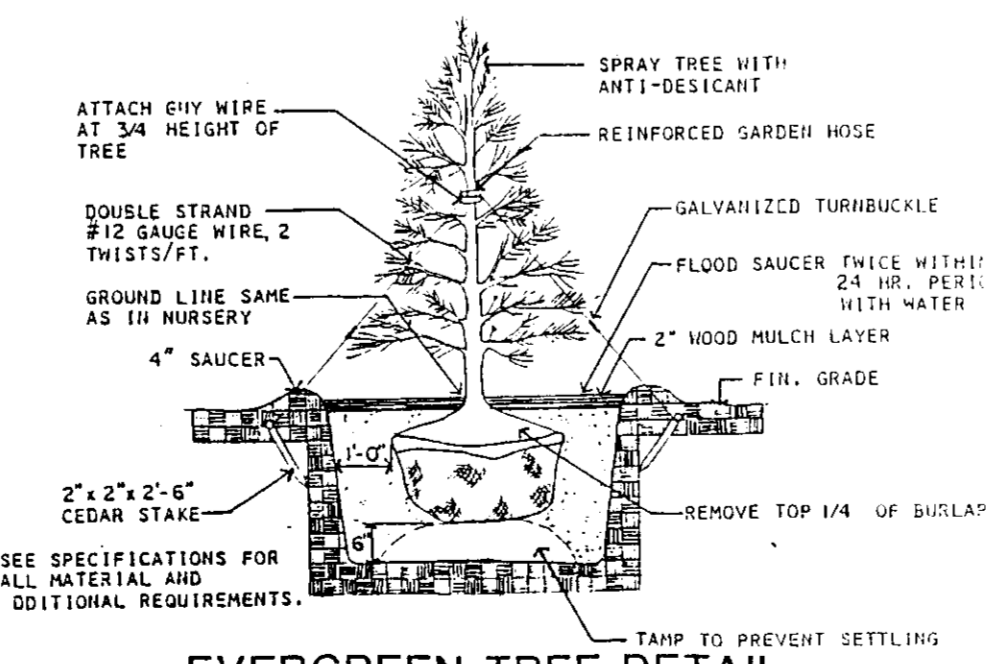

EVERGREEN TREE DETAIL

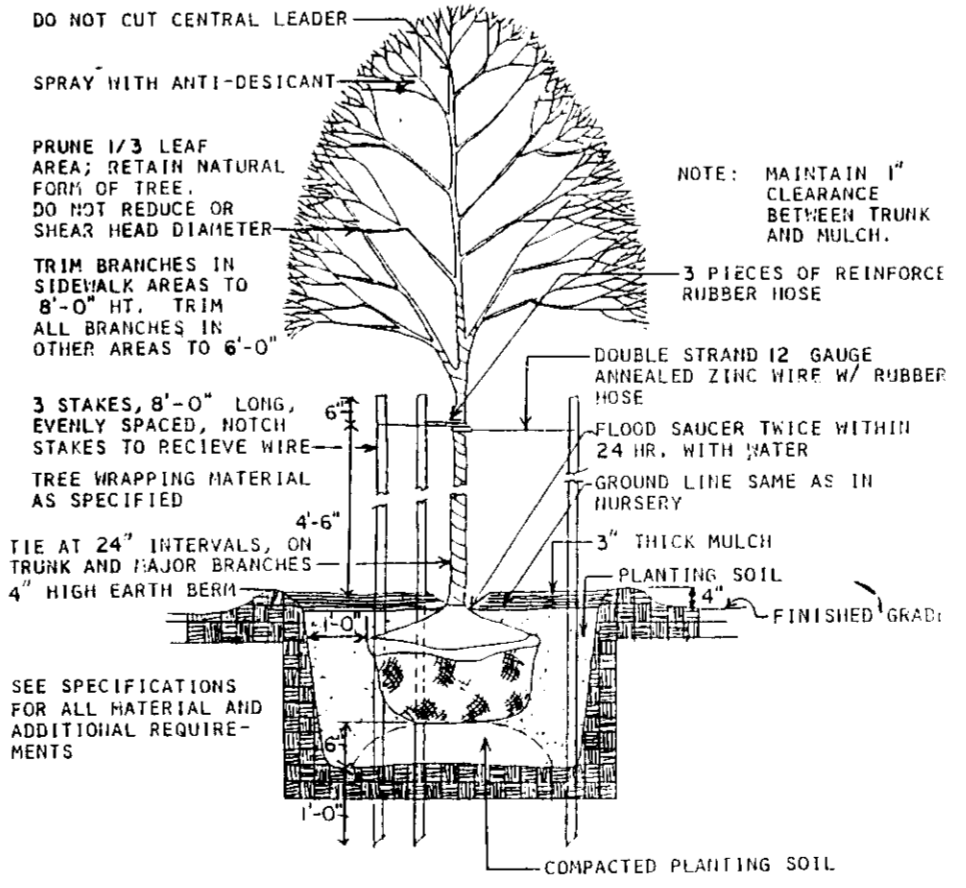

TREE PLANTING DETAIL

SUBDIVISION NAME THE JUNCTION INDUSTRIAL PARK		SECT./AREA 1/1	LOT/PARCEL # C-2
PLAT # 6379	BLOCK # 19	ZONE M-2	TAX/ZONE MAP 48
ELEC. DIST. 6		CENSUS TR. 6064	
WATER CODE C04		SEWER CODE 4020000	
FOR PUBLIC WATER & PUBLIC SEWERAGE & APPROVED FOR STORM DRAINAGE SYSTEMS AND ROADS. HOWARD COUNTY DEPARTMENT OF PUBLIC WORKS			
DATE 8-11-86		DATE 8-11-86	
DATE 8-13-86		DATE 8-14-86	
DATE 8-14-86		DATE 8-14-86	

DATE	NO.	REVISION
PROJECT: THE JUNCTION INDUSTRIAL PARK		
6th ELECTION DISTRICT HOWARD CO., MARYLAND SECTION I AREA I PARCEL 'C-2'		
TITLE SD-4 PLANTING PLAN		
OWNER: LUCAS MANAGEMENT SERVICES CO. 7700 PORT CAPITAL DRIVE BALTIMORE MD 21227		
ENGINEERS: WHITNEY, BAILEY, COX & MAGNANI CONSULTING ENGINEERS 1830 YORK ROAD TIMONIUM, MARYLAND 21093 301-282-8880		
DATE:	DESIGNED: RZB	
	DRAWN: RZB	
	CHECKED: PD	
	PROJECT NO: 06004	
	DATE: 3/31/86	
	SCALE: 1" = 30'	
PROFESSIONAL ENGR. NO.	DRAWING NO: 4 of 6	

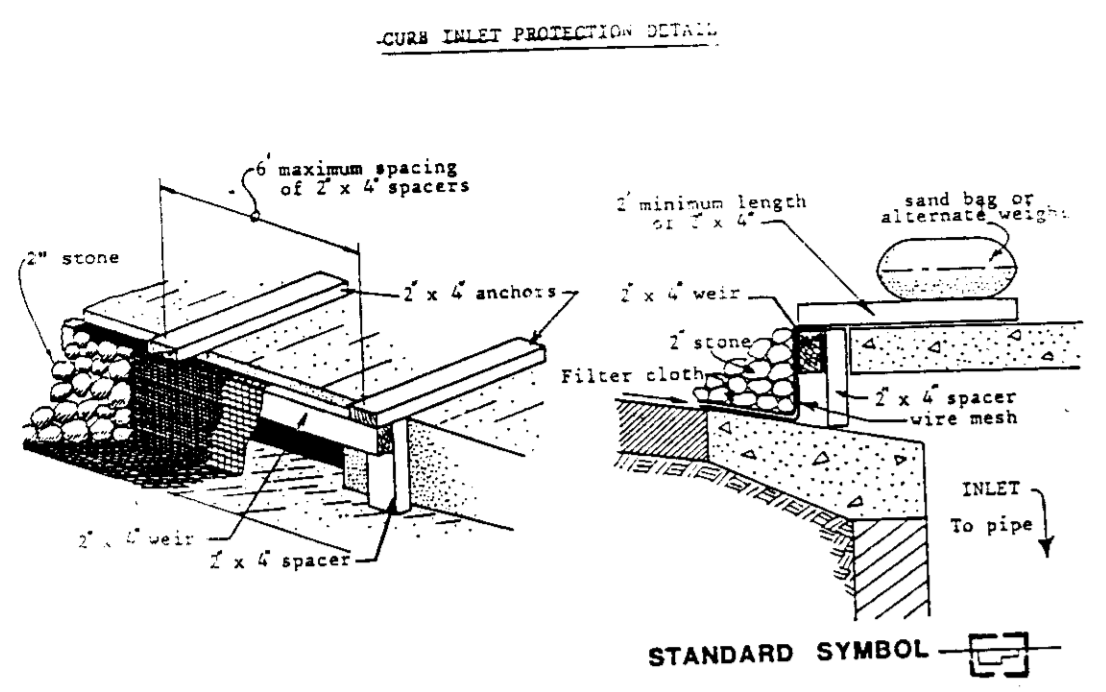

- Curb Inlet Protection.**
1. Attach a continuous piece of wire mesh (30" min. width by throat length plus 4") to the 2" x 4" weir (measuring throat length plus 4") as shown on the standard drawing.
 2. Place a piece of approved filter cloth (40-85 sieve) of the same dimensions as the wire mesh over the weir mesh and securely attach to the 2" x 4" weir.
 3. Securely nail the 2" x 4" weir to 9" long vertical spacers to be located between the weir and inlet face (max. 6' apart).
 4. Place the assembly against the inlet throat and nail (minimum 2" lengths of 2" x 4" to the top of the weir at spacer locations. These 2" x 4" anchors shall extend across the inlet top and be held in place by sandbags or alternate weight.
 5. The assembly shall be placed so that the end spacers are a minimum 1' beyond both ends of the throat opening.
 6. Form the wire mesh and filter cloth to the concrete gutter and against the face of curb on both sides of the inlet. Place clean 2" stone over the wire mesh and filter fabric in such a manner as to prevent water from entering the inlet under or around the filter cloth.
 7. This type of protection must be inspected frequently and the filter cloth and stone replaced when clogged with sediment.
 8. Assume that storm flow does not bypass inlet by installing temporary earth or asphalt dikes directing flow into inlet.

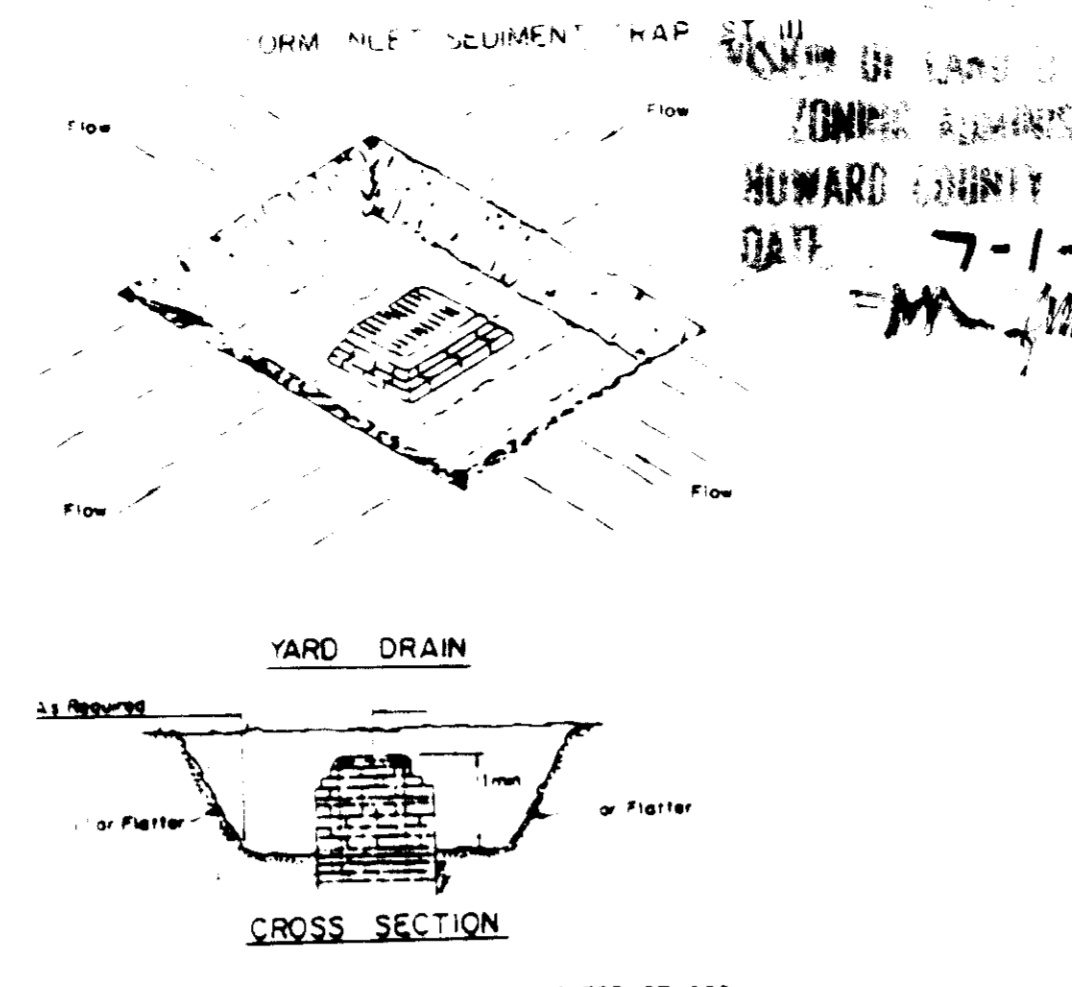

- CONSTRUCTION SPECIFICATION FOR ST-111**
1. Sediment shall be removed and the trap restored to its original dimensions when the sediment has accumulated to 1/2 the design depth of the trap. Removed sediment shall be deposited in a suitable area and in such a manner that it will not erode.
 2. The volume of sediment storage shall be 1800 cubic feet per acre of contributory drainage.
 3. The structure shall be inspected after each rain and repairs made as needed.
 4. Construction operations shall be carried out in such a manner that erosion and water pollution shall be minimized.
 5. The sediment trap shall be removed and the area stabilized when the constructed drainage area has been properly stabilized.
 6. All cut slopes shall be 1:1 or flatter.

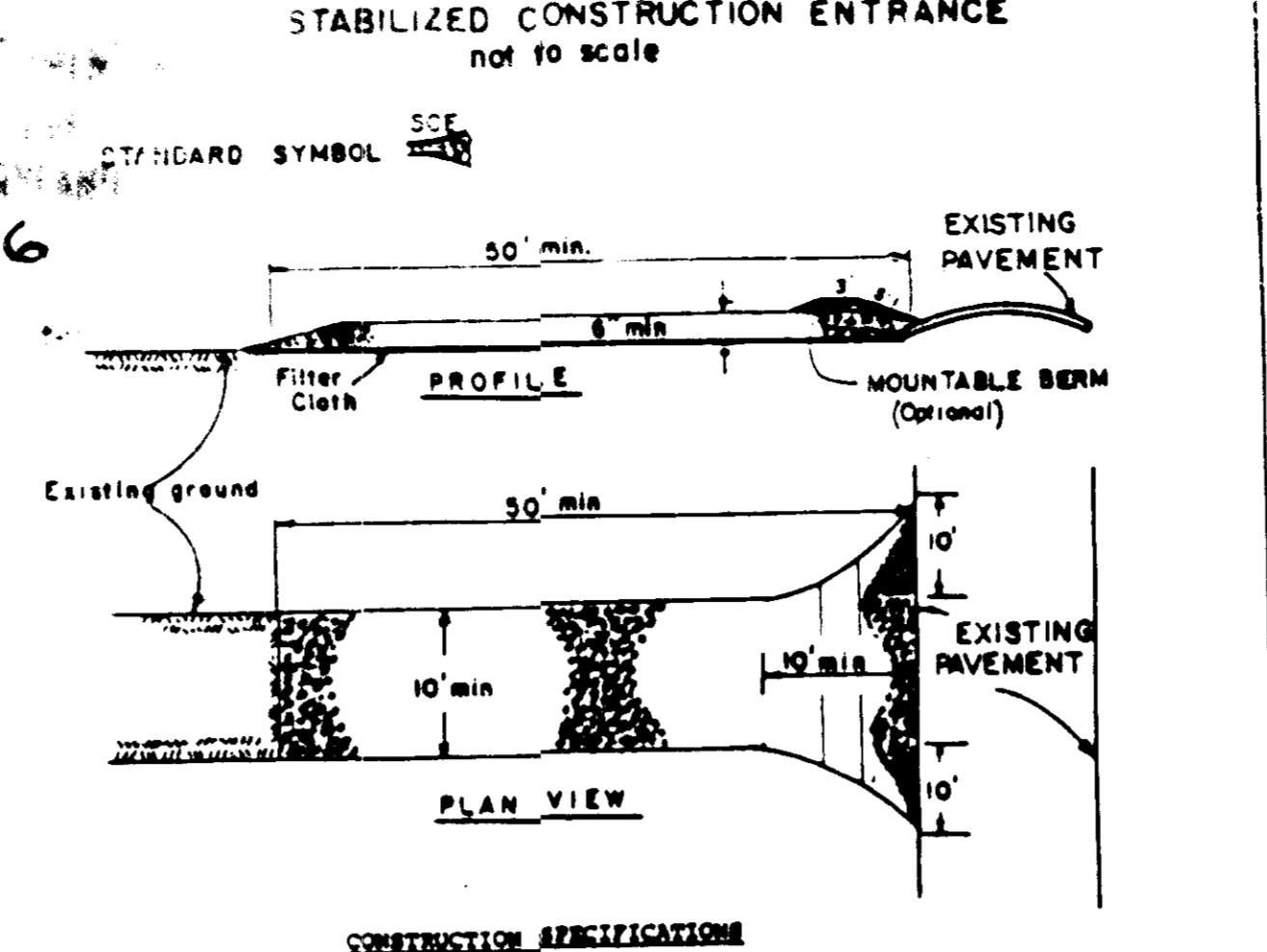

- CONSTRUCTION SPECIFICATIONS**
1. Stone Size - Use 1" stone, or recycled or recycled concrete equivalent.
 2. Length - As required, but not less than 50 feet (except on a single residence lot where a 30 foot minimum length would apply).
 3. Thickness - Not less than six (6) inches.
 4. Width - Ten (10) foot minimum, but not less than the full width at entrance where ingress or egress occurs.
 5. Filter Cloth - Will be placed over the entire area prior to placing of stone. Filter will not be required on a single family residence lot.
 6. Surface Water - All surface water flowing or diverted toward construction entrance shall be piped across the entrance. If piping is impractical, construction entrance shall be stabilized.
 7. Maintenance - The entrance shall be maintained in a condition which will prevent tracking or flowing of sediment onto public rights-of-way. This may require periodic top dressing with additional stone as conditions demand.
 8. Washing - Trucks shall be cleaned to remove sediment prior to entrance onto public rights-of-way. When washing is required, it shall be done on an area stabilized with stone and which drains into an approved sediment trapping device.
 9. Periodic inspection and needed maintenance shall be provided after each rain.

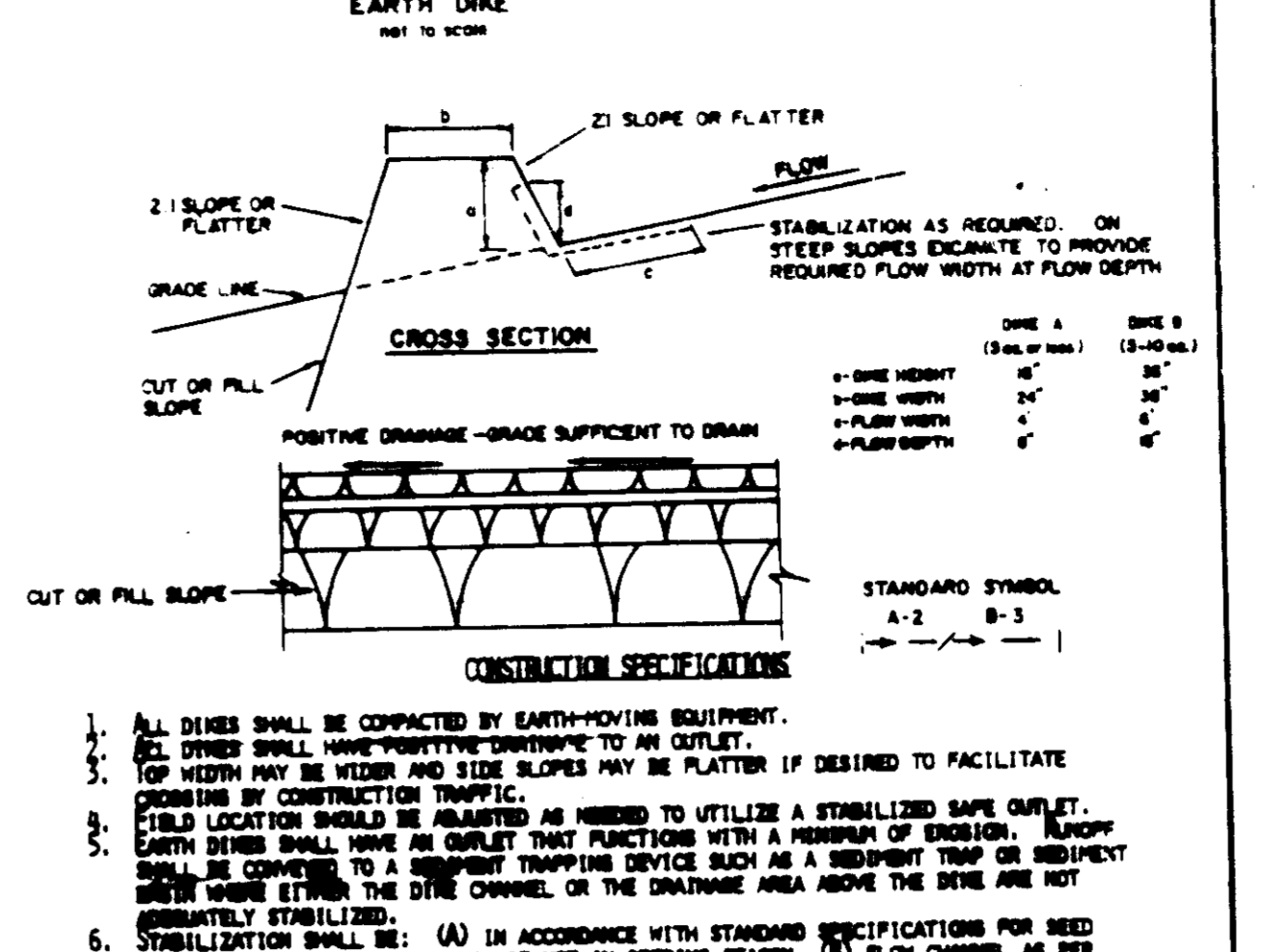

- CONSTRUCTION SPECIFICATIONS**
1. All dikes shall be compacted by earth-moving equipment.
 2. All dikes shall have positive drainage to an outlet.
 3. Top width may be wider and side slopes may be flatter if desired to facilitate crossing by construction traffic.
 4. Field location should be adjusted as needed to utilize a stabilized safe outlet. Earth dikes shall have an outlet that functions with a minimum of erosion. Runoff shall be conveyed to a sediment trapping device such as a sediment trap or sediment trap with a 100 mesh screen.
 5. Stabilization shall be: (A) in accordance with standard specifications for seed and straw mulch or straw mulch if not in seeding season, (B) plain channel as per the chart below.
- | TYPE OF TREATMENT | CHANNEL | DIKE A | DIKE B |
|-------------------|---------|--------------------------------------|---|
| 1 | 5-5-0 | SEED AND STRAW MULCH | SEED AND STRAW MULCH |
| 2 | 3-1-5-0 | SEED AND STRAW MULCH | SEED WITH LIME, OR SOIL EXCERCIATION; SO2; 2" STONE |
| 3 | 5-1-0-0 | SEED WITH LIME, OR SOIL EXCERCIATION | LINED RIP-RAP 4-8" |
| 4 | 8-1-0-0 | LINED RIP-RAP 4-8" | ENGINEERING DESIGN |
- A. STONE TO BE 2 INCH STONE, OR RECYCLED CONCRETE BRICK/PAVING, IN A LAYER AT LEAST 3 INCHES THICK. STONE SHALL BE PLACED IN A LAYER AT LEAST 8 INCHES THICK AND PRESSED INTO THE SOIL.
- C. APPROVED STABILIZATION CAN BE SUBSTITUTED FOR ANY OF THE ABOVE METHODS.
7. PERIODIC INSPECTION AND NEEDED MAINTENANCE MUST BE PROVIDED AFTER EACH RAIN EVENT.

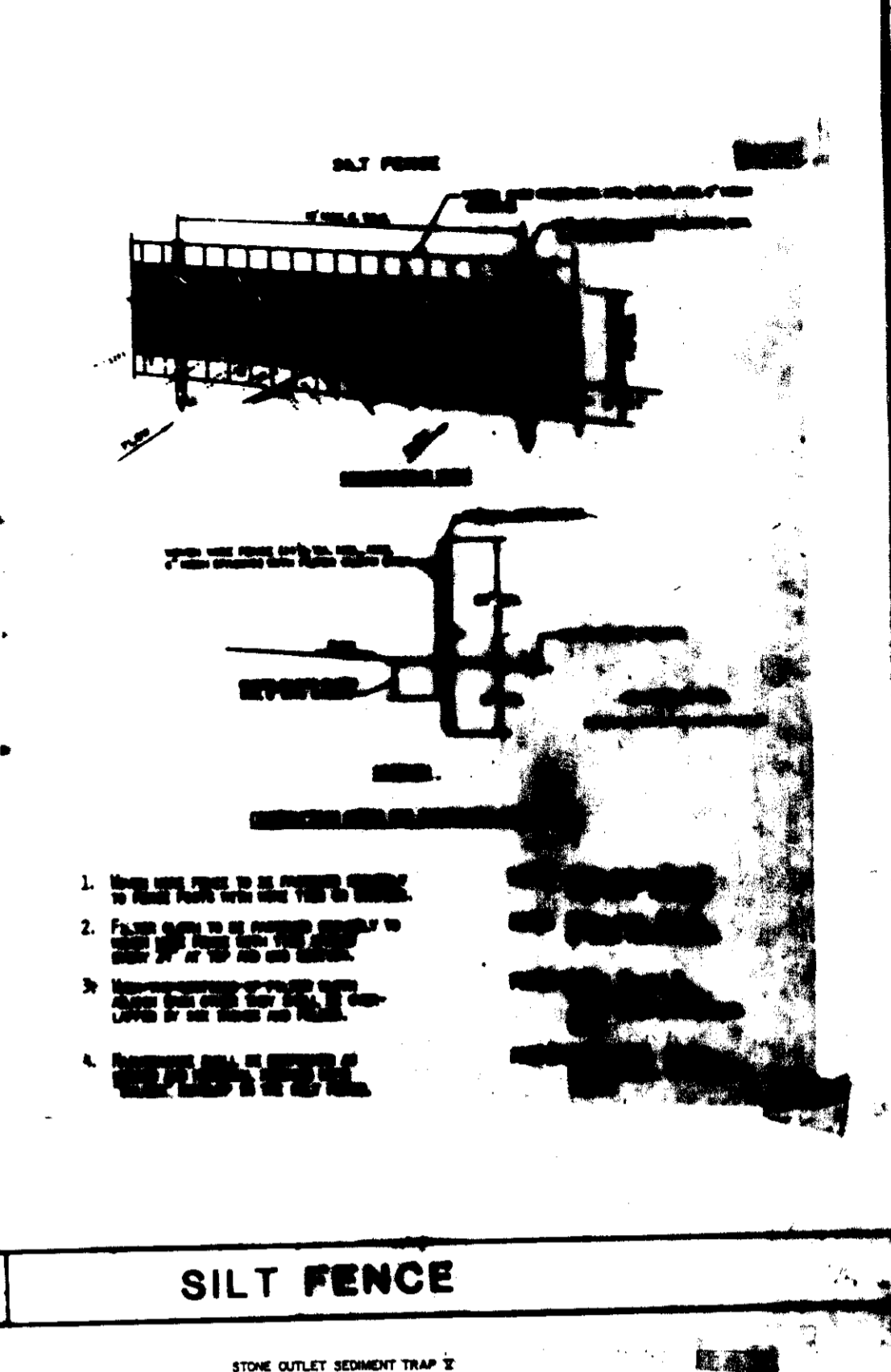

- CONSTRUCTION SPECIFICATIONS FOR S-111**
1. A one foot layer of 1/2" stone shall be placed on the upstream side of the silt fence in place of the sediment filter cloth.
 2. The silt fence shall be inspected after each rain and repairs made as needed.
 3. The structure shall be inspected after each rain and repairs made as needed.
 4. Construction operations shall be carried out in such a manner that erosion and water pollution shall be minimized.
 5. The structure shall be removed and the area stabilized when the drainage area has been properly stabilized.
- Minimum Drainage Area: 5 Acres

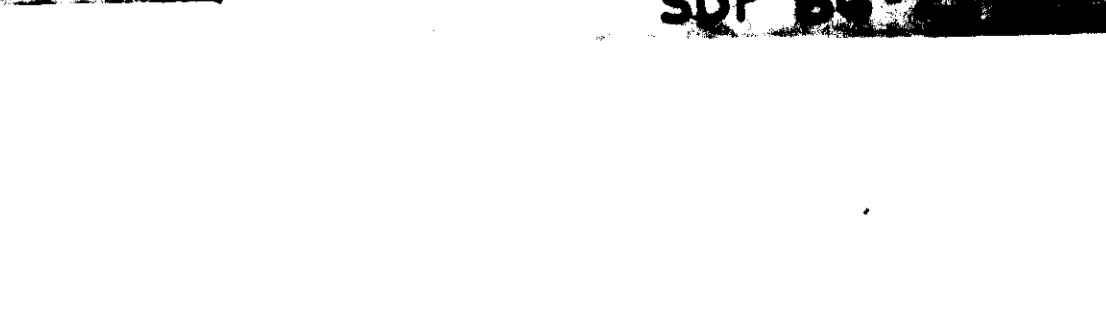
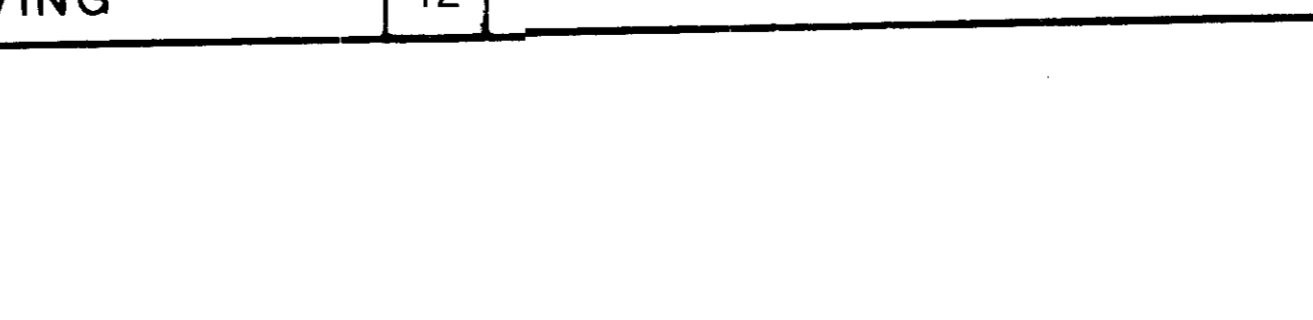
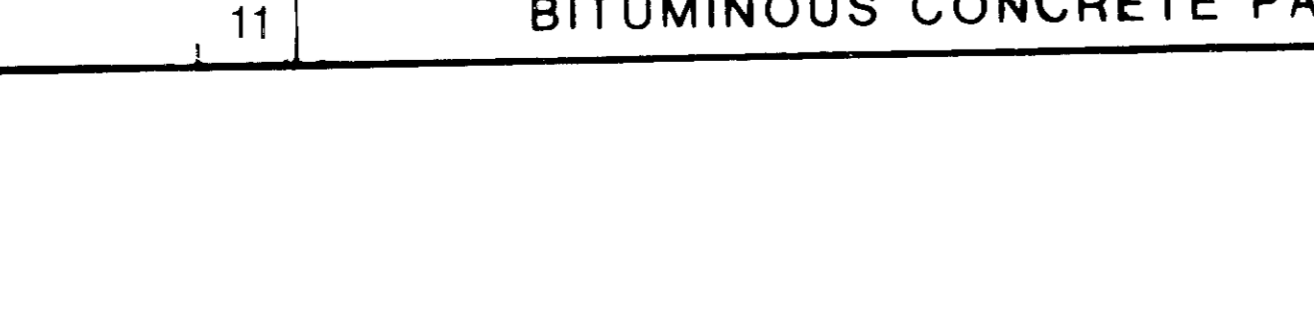
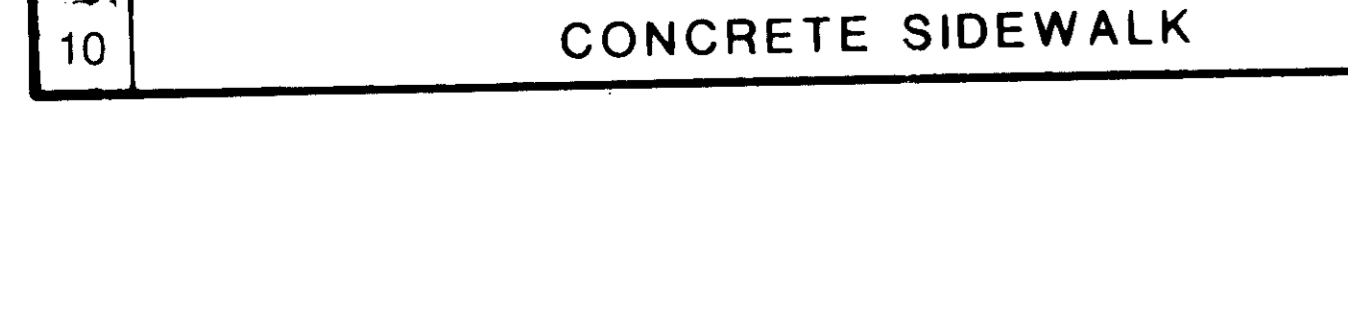
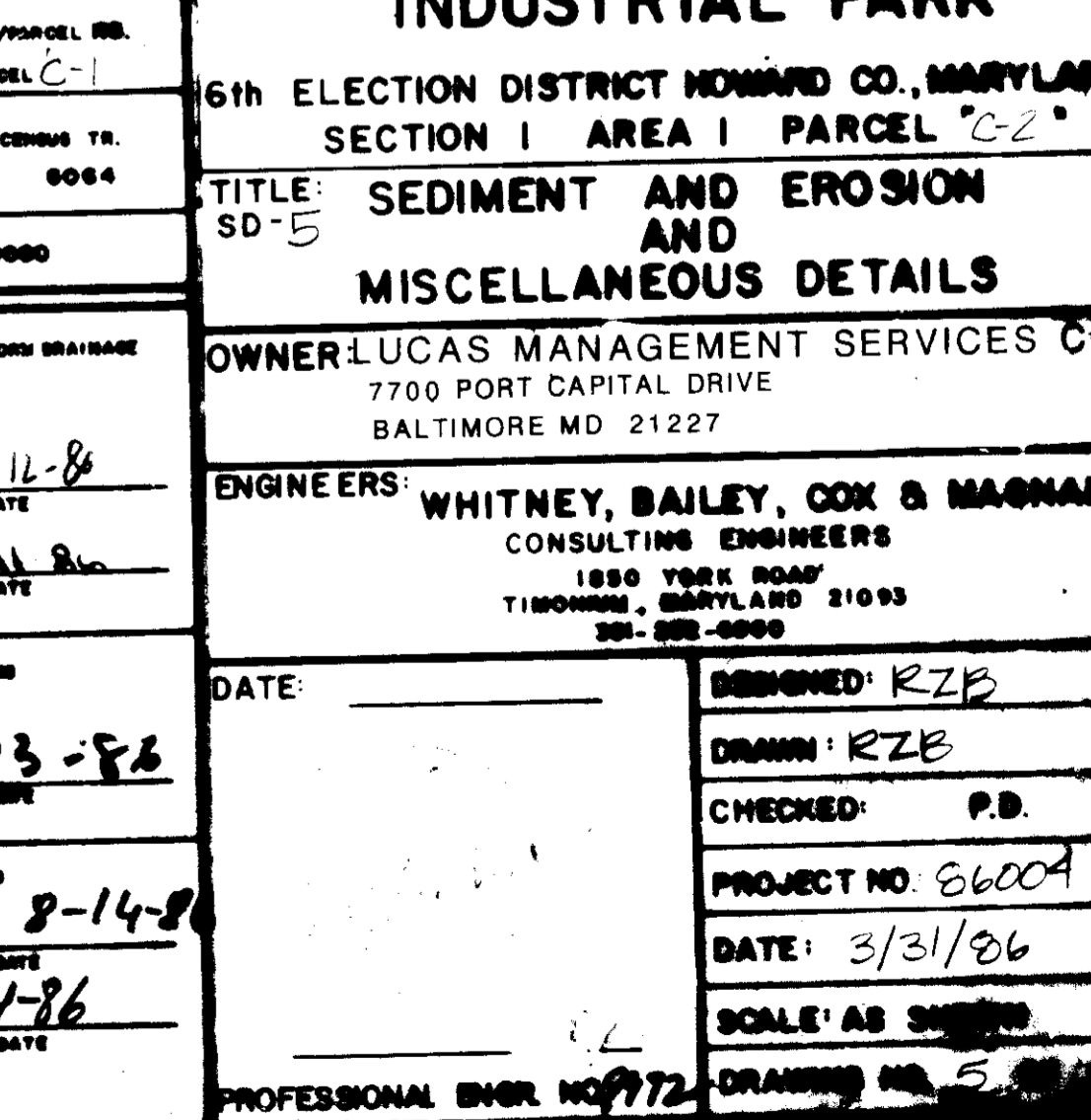
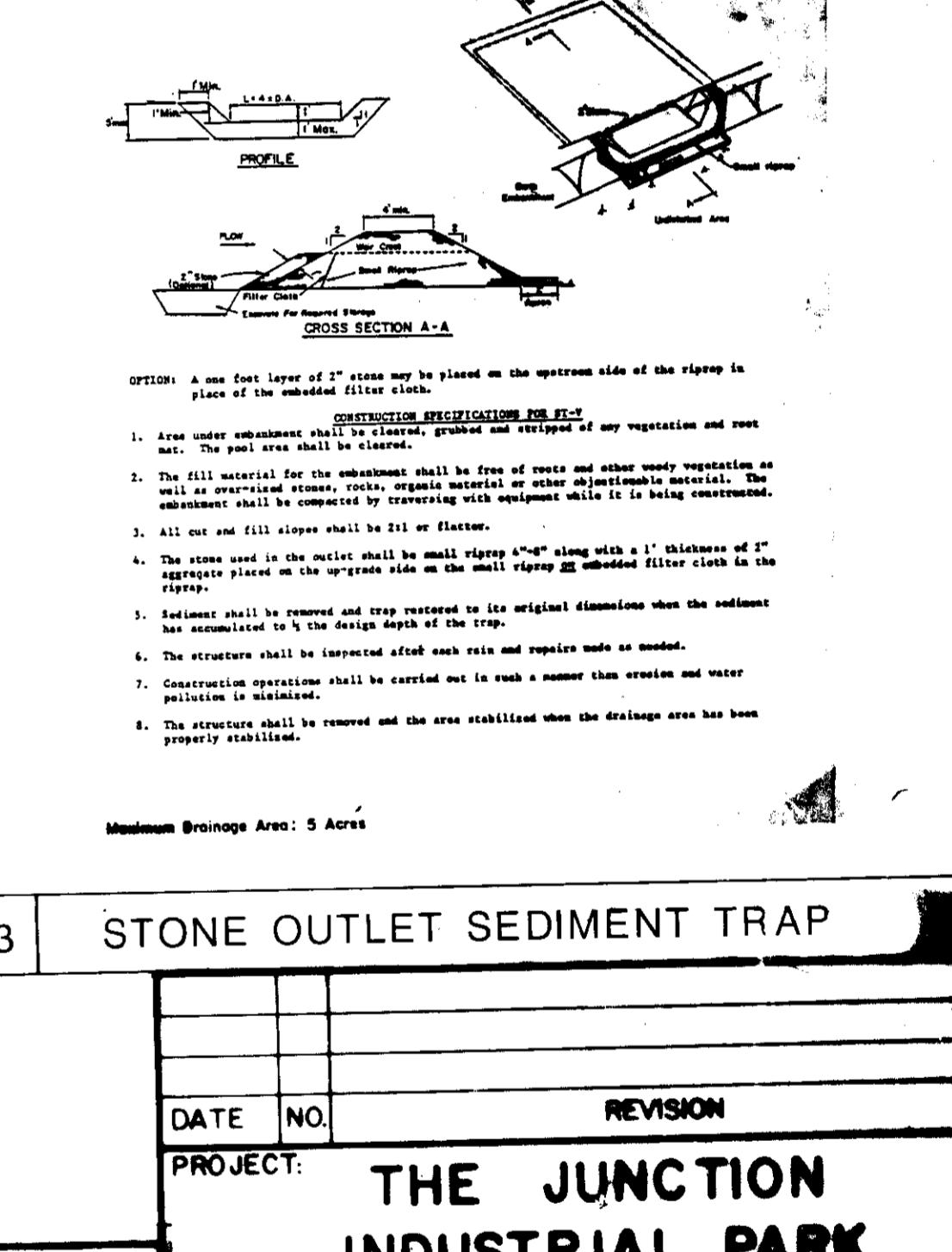
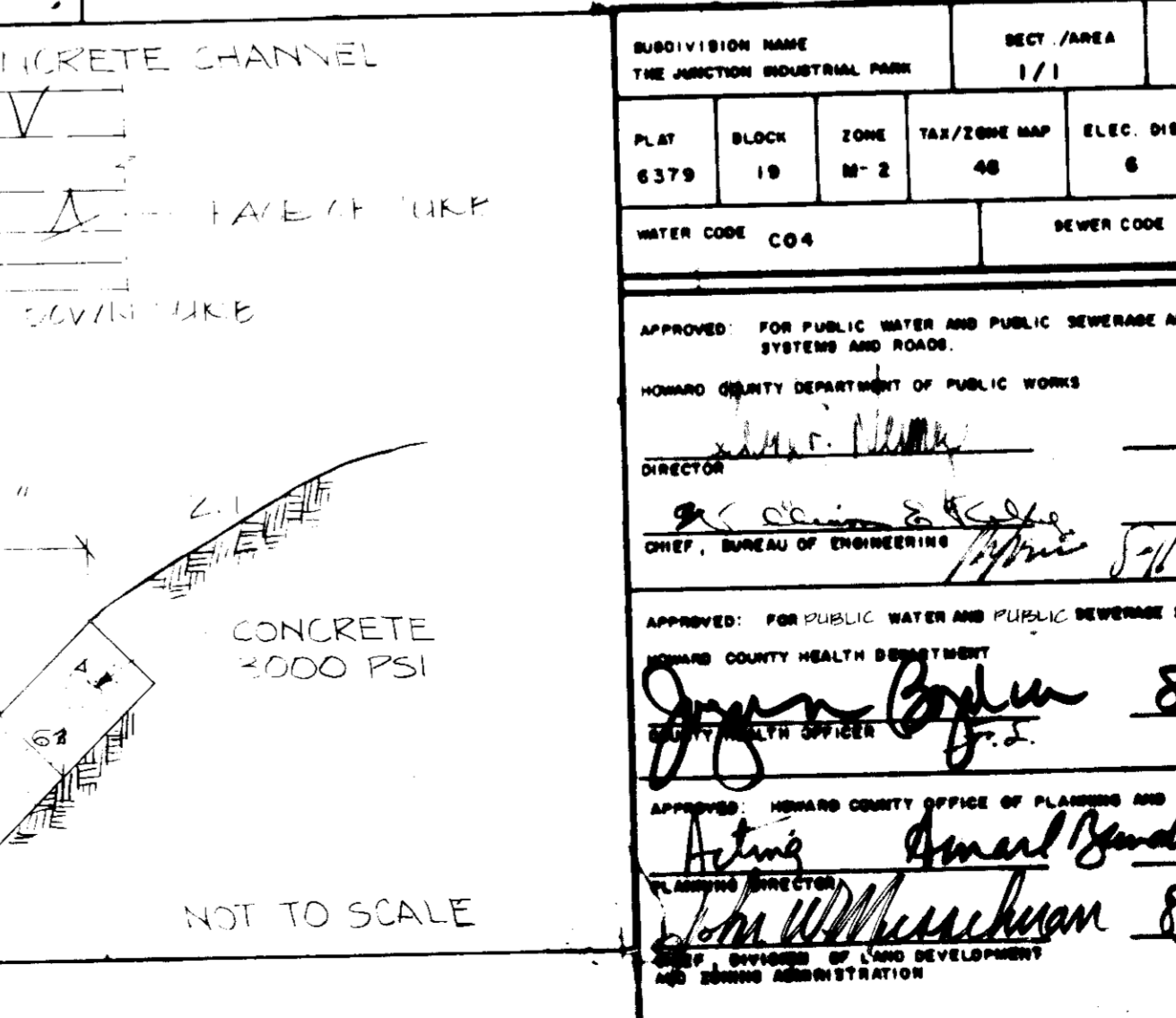
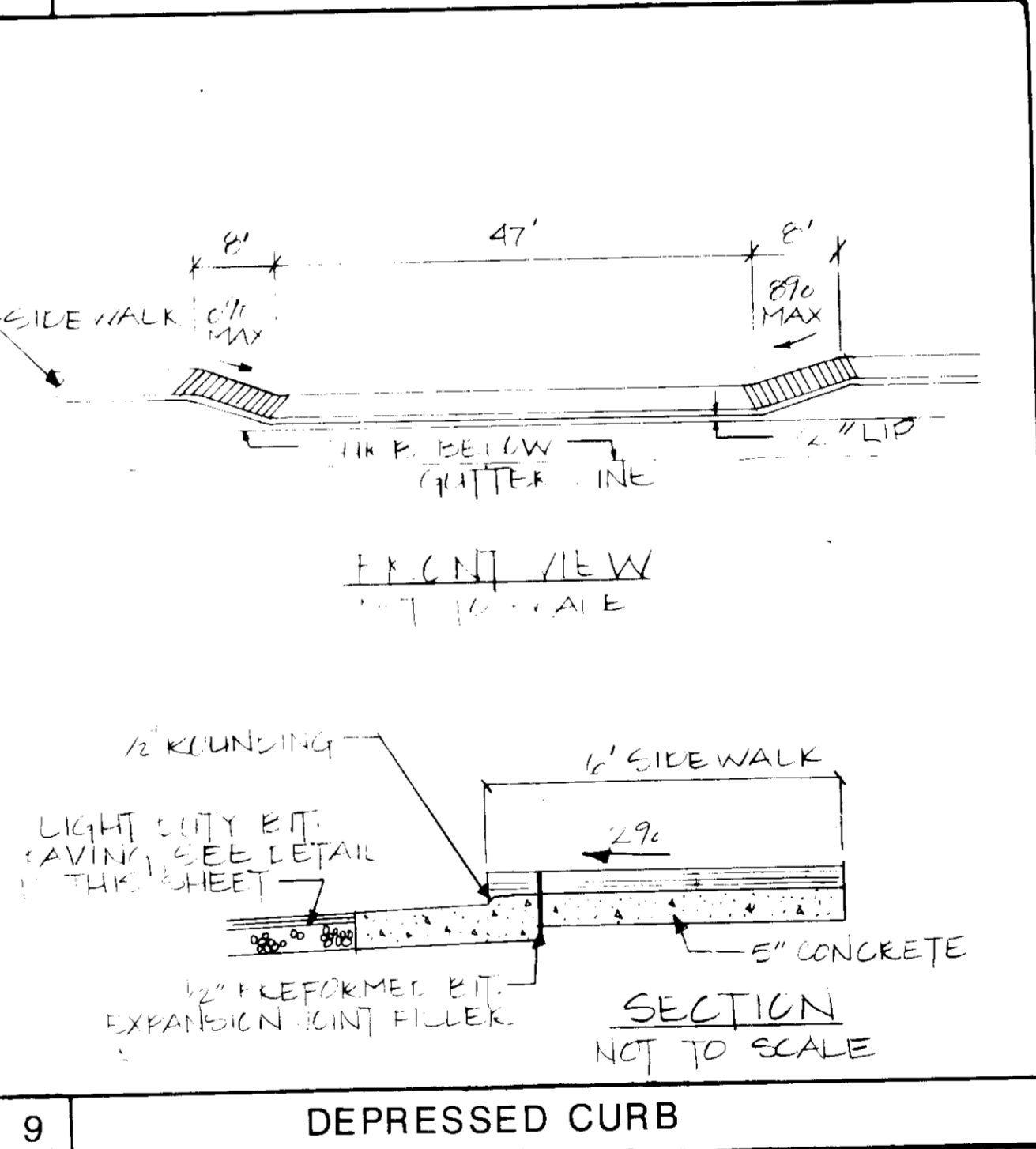
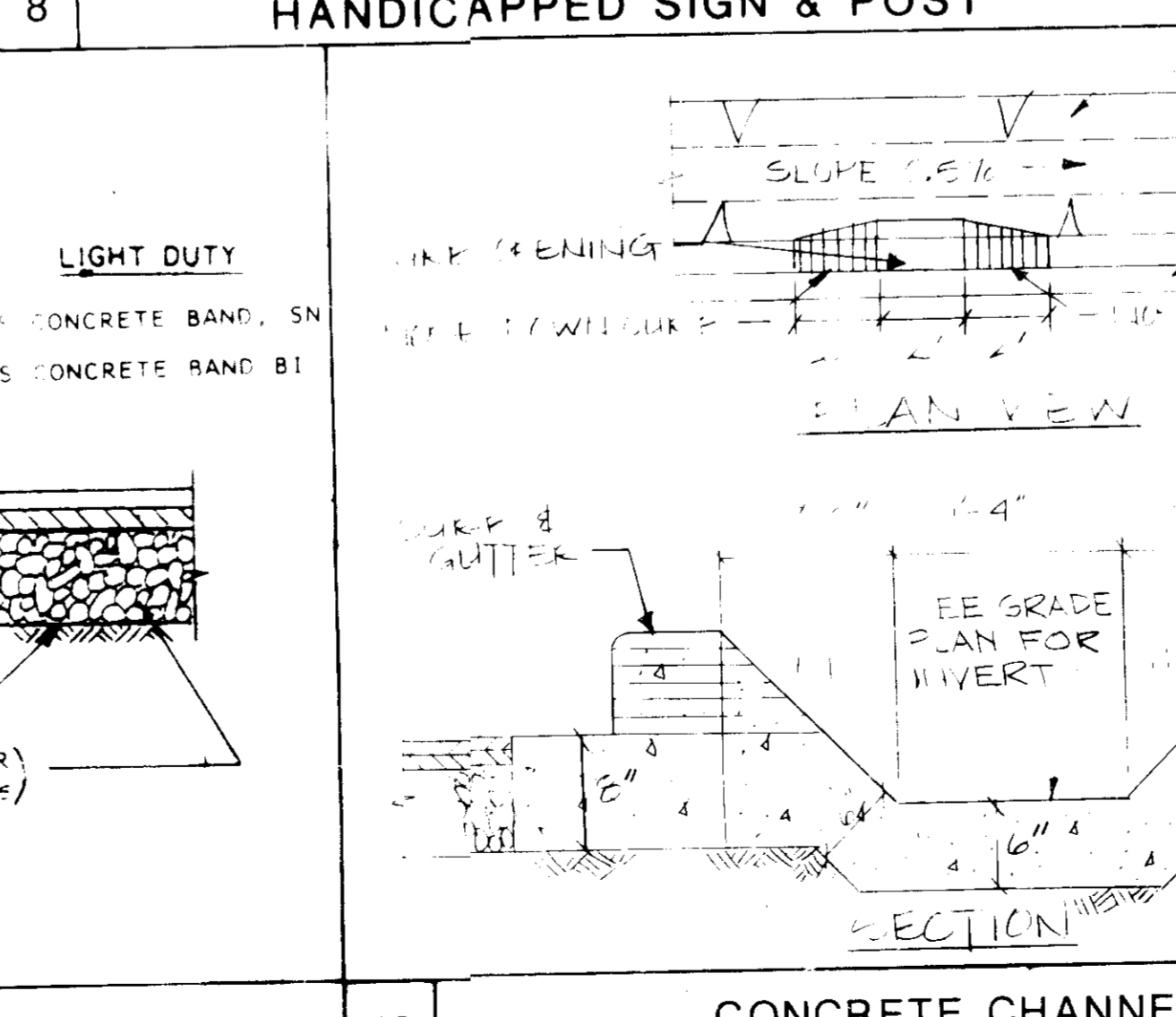
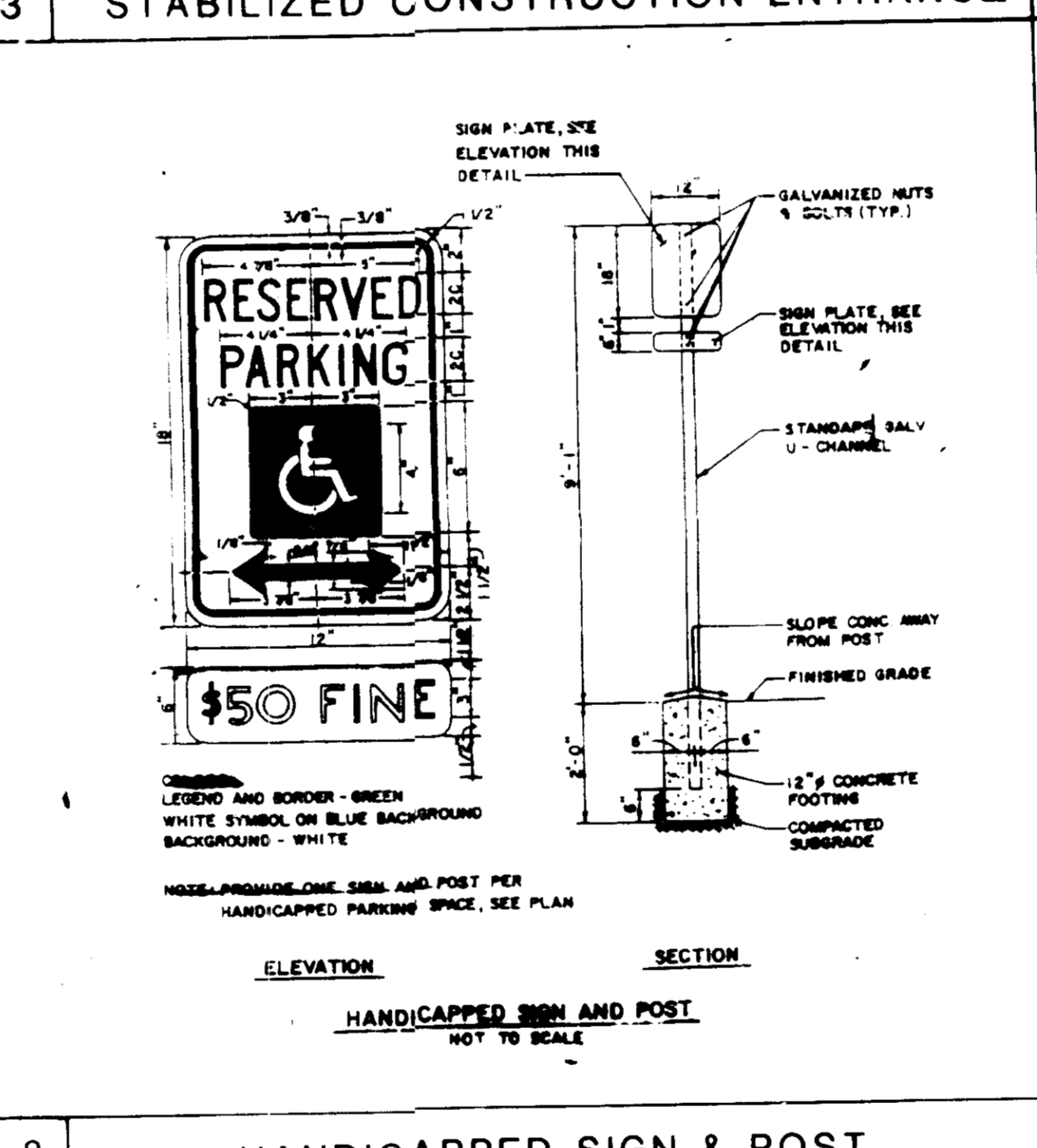
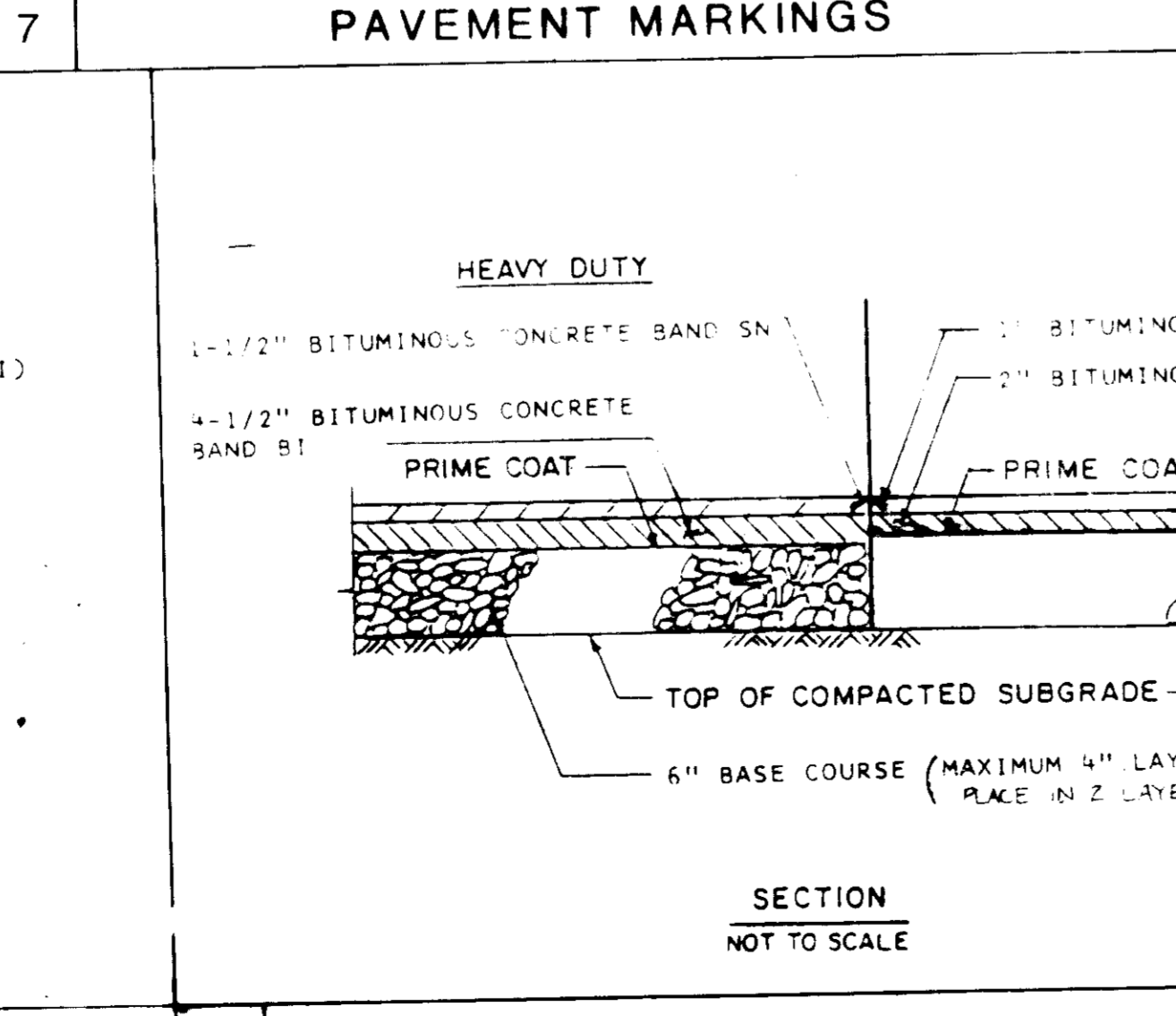
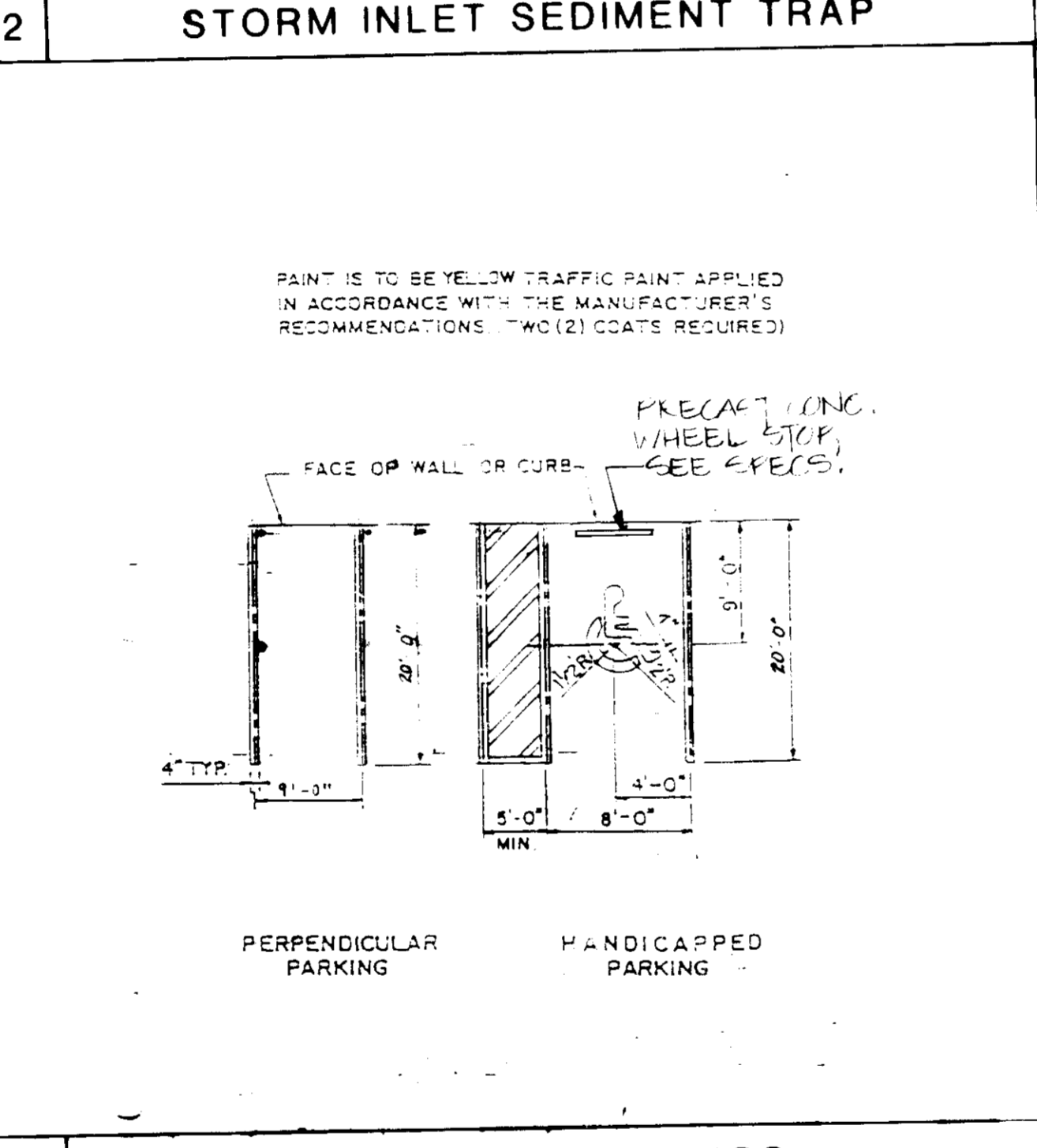
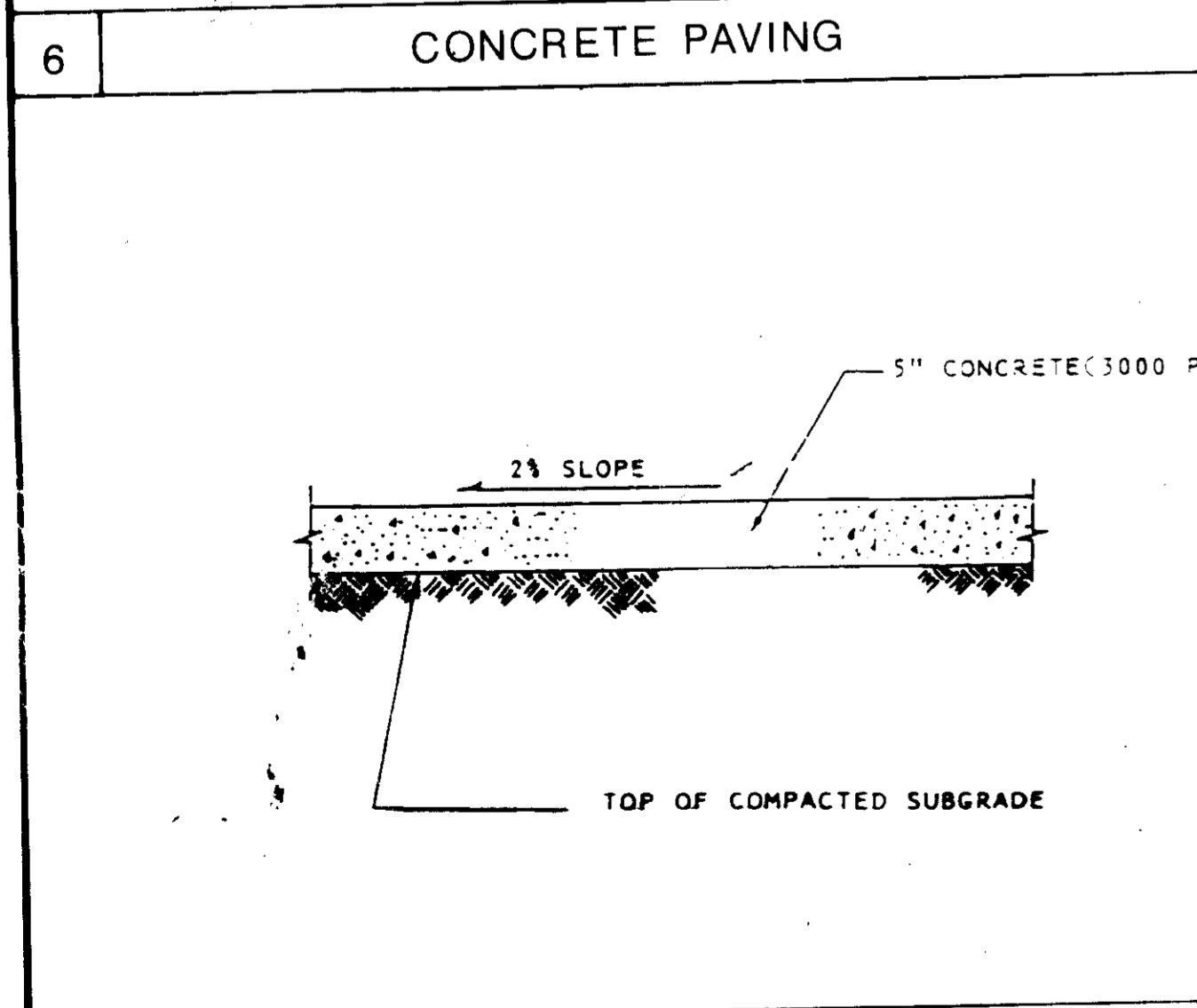
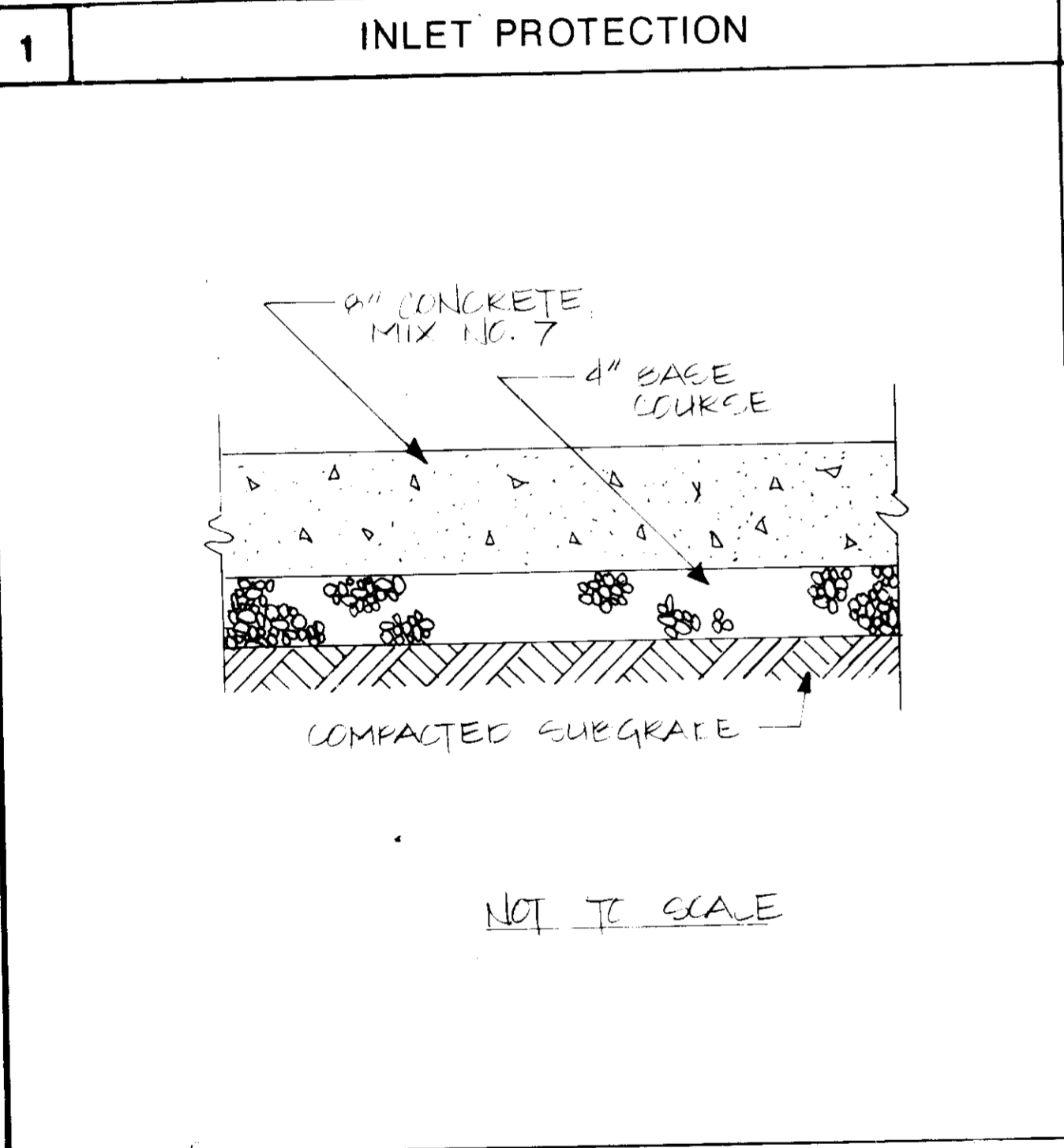

SUBDIVISION NAME		SECT./AREA	LOT/PORCEL. NO.
THE JUNCTION INDUSTRIAL PARK		1/1	PARCEL C-1
PLAT	BLOCK	ZONE	TAX/ZONE MAP
6379	19	M-2	48
ELEC. DIST.		CORRUS. TR.	
6		8004	
WATER CODE		SEWER CODE	
C04		4020000	
APPROVED FOR PUBLIC WATER AND PUBLIC SEWERAGE AND STORM DRAINAGE SYSTEMS AND ROADS.			
HOWARD COUNTY DEPARTMENT OF PUBLIC WORKS			
DIRECTOR		DATE	
James E. [Signature]		8-11-86	
APPROVED FOR PUBLIC WATER AND PUBLIC SEWERAGE SYSTEMS			
HOWARD COUNTY HEALTH DEPARTMENT			
HEALTH OFFICER		DATE	
James E. [Signature]		8-13-86	
APPROVED HOWARD COUNTY OFFICE OF PLANNING AND DESIGN			
PLANNING DIRECTOR		DATE	
John W. [Signature]		8-14-86	
PROFESSIONAL ENGR. NO. 972			

PROJECT:		REVISION	
THE JUNCTION INDUSTRIAL PARK			
6th ELECTION DISTRICT HOWARD CO., MARYLAND			
SECTION I AREA I PARCEL C-2			
TITLE: SEDIMENT AND EROSION AND MISCELLANEOUS DETAILS			
OWNER: LUCAS MANAGEMENT SERVICES CO.			
7700 PORT CAPITAL DRIVE			
BALTIMORE MD 21227			
ENGINEERS: WHITNEY, BAILEY, COX & MAGNAN			
CONSULTING ENGINEERS			
1800 YORK ROAD			
TIMMONS, MARYLAND 21093			
301-582-0000			
DATE:		DRAWN: RZB	
		CHECKED: P.B.	
		PROJECT NO: 66004	
		DATE: 3/31/86	
		SCALE: AS SHOWN	
		DRAWING NO. 5	

HOWARD COUNTY
7-1-86

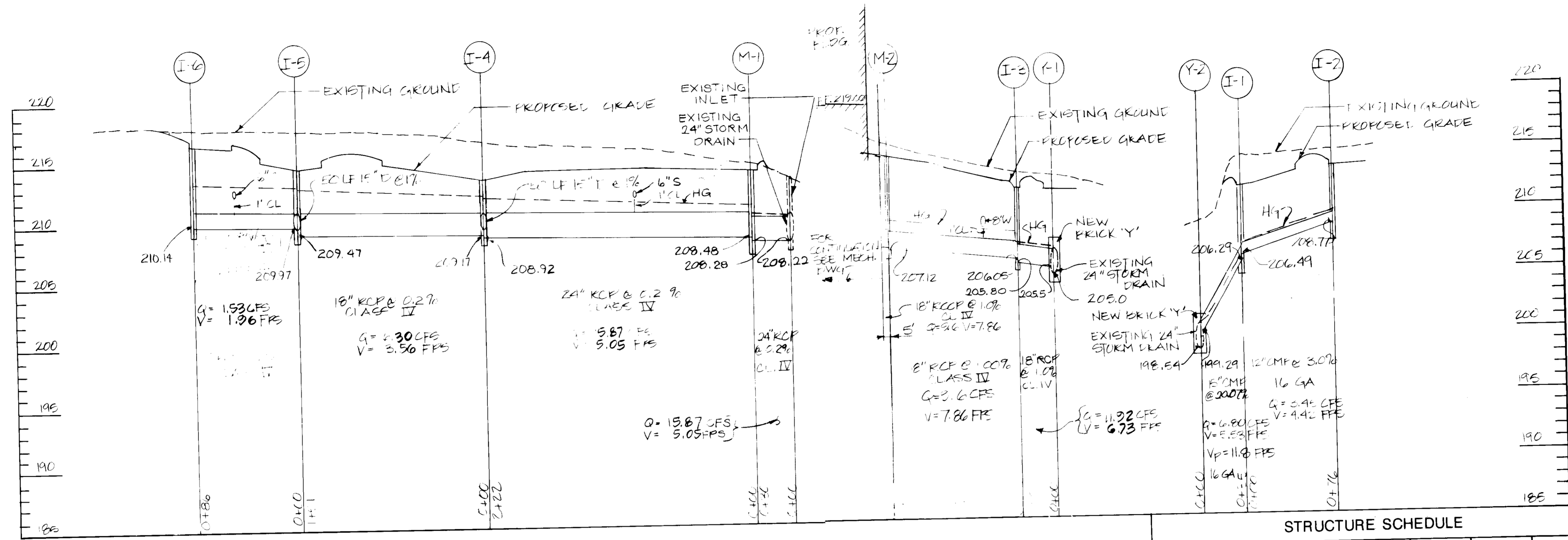

STORM DRAIN PROFILES

VERTICAL SCALE 1"=5'
HORIZONTAL SCALE 1"=50'

NO.	TYPE	INVERT IN	INVERT OUT	TOP ELEV (GRATE)
I-6	DOUBLE TYPE S COMB. INLET HOWARD CO. SD-4.34	-	210.14	216.40
I-5	TYPE S INLET HOWARD CO. SD-4.22	209.72(N) 209.97(W)	209.47	214.30
I-4	TYPE S INLET HOWARD CO. SD-4.22	209.42(N) 209.17(W)	208.92	213.60
I-3	DOUBLE TYPE S COMB. INLET HOWARD CO. SD 4.34	-	205.80	213.05
I-2	DOUBLE TYPE S COMB. INLET HOWARD CO. SD 4.34	-	208.77	213.40
I-1	DOUBLE TYPE S COMB. INLET HOWARD CO. SD 4.34	206.49	206.29	211.80
M-1	STANDARD SHALLOW PRE CAST MANHOLE - HOWARD CO GS.12	208.48(W)	208.28	214.25
I-2	SINGLE BRICK Y HOWARD CO. SD 1.11	199.29	198.54	
I-1	SINGLE BRICK Y HOWARD CO. SD 1.11	205.5	205.0	

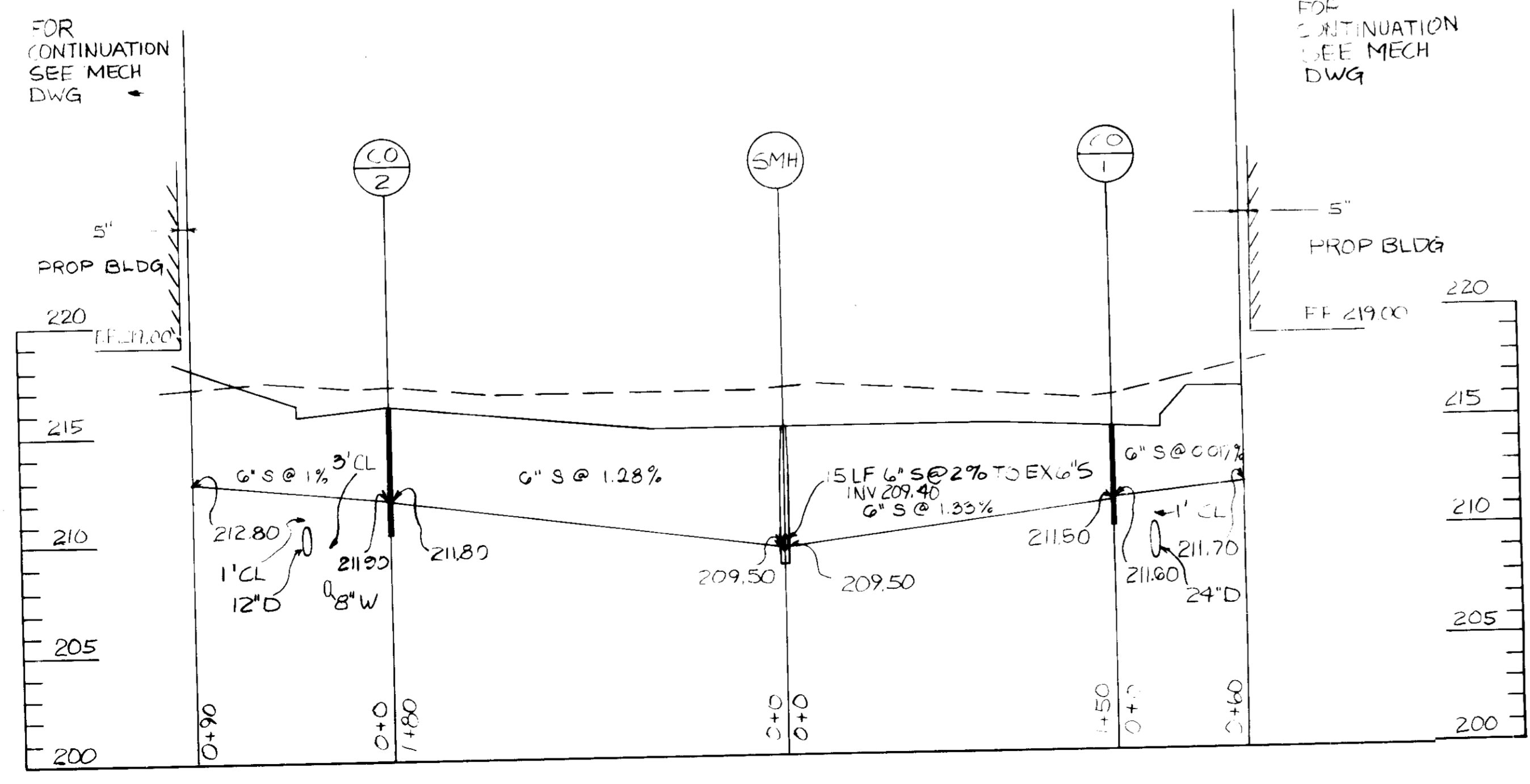

SANITARY SEWER PROFILE

VERTICAL SCALE 1"=5'
HORIZONTAL SCALE 1"=50'

STRUCTURE SCHEDULE

SUBDIVISION NAME THE JUNCTION INDUSTRIAL PARK		SECT./AREA V1	LOT/PARCEL # C-2
PLAT # 6279	BLOCK # 19	ZONE M-2	TAX/ZONE MAP 48
ELEC. DIST. 6	CENSUS TR. 6064	WATER CODE COA	
SEWER CODE 4020000		APPROVED: FOR PUBLIC WATER & PUBLIC SEWERAGE SYSTEMS AND ROADS. HOWARD COUNTY DEPARTMENT OF PUBLIC WORKS DIRECTOR: [Signature] DATE: 8-12-86	
APPROVED: FOR PUBLIC WATER AND PUBLIC SEWERAGE SYSTEMS HOWARD COUNTY HEALTH DEPARTMENT COUNTY HEALTH OFFICER: [Signature] DATE: 8-13-86		APPROVED: HOWARD COUNTY OFFICE OF PLANNING AND ZONING PLANNING DIRECTOR: [Signature] DATE: 8-14-86	
APPROVED: HOWARD COUNTY OFFICE OF PLANNING AND ZONING DEPUTY DIRECTOR: [Signature] DATE: 8-14-86		PROFESSIONAL ENGR. NO.	

DATE	NO.	REVISION
PROJECT: THE JUNCTION INDUSTRIAL PARK 6th ELECTION DISTRICT HOWARD CO., MARYLAND SECTION 1 AREA 1 PARCEL 'C-2'		
TITLE: SD-6 SANITARY SEWER AND STORM DRAIN PROFILES		
OWNER: LUCAS MANAGEMENT SERVICES CO 7700 PORT CAPITAL DRIVE BALTIMORE MD 21227		
ENGINEERS: WHITNEY, BAILEY, COX & MAGNANI CONSULTING ENGINEERS 1850 YORK ROAD TIMONUM, MARYLAND 21003 301-252-6060		
DATE:	DESIGNED: RZB	
	DRAWN: RZB	
	CHECKED: PD	
	PROJECT NO: 86004	
	DATE: 3/31/86	
	SCALE: AS SHOWN	
	DRAWING NO: 16 OF 22	