

DRIVEWAY ABUTTING MOD. COMB. CURB & GUTTER\*

ALTERNATE #1  
1 1/2" Conc. Surface  
4" Bit. Conc. Base  
3" Gravel

ALTERNATE #2  
1 1/2" Conc. Surface  
3" Bit. Conc. Base  
3" Gravel

\* See Ho. Ct. Ord. R. 3.01  
For Spec. 7" Comb. Curb & Gutter  
Necessary on Lots

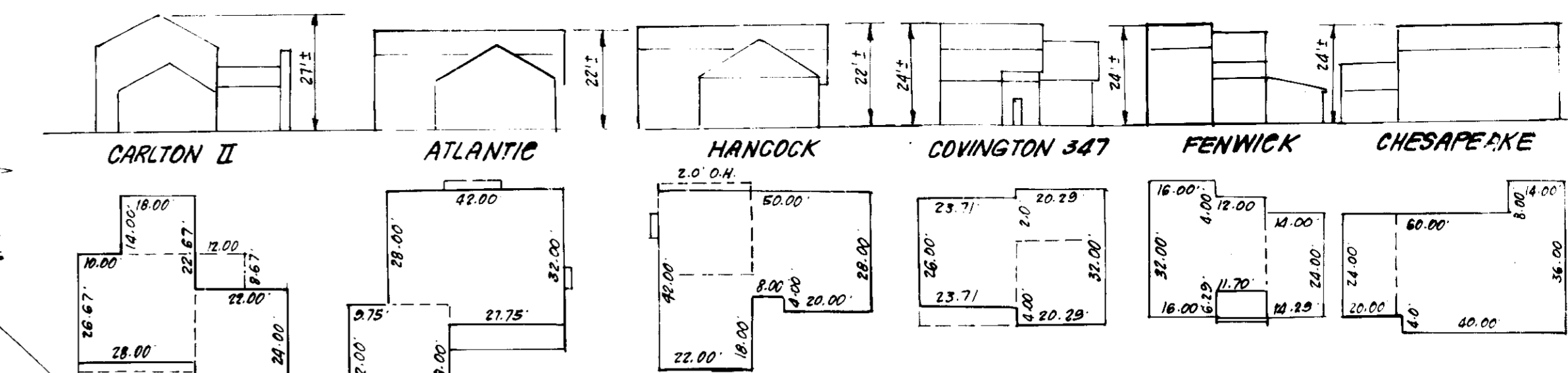

TYPICAL HOUSES  
NO SCALE

**GENERAL NOTES:**

1. The land included is zoned R-5C.
2. Horizontal Control Based on Howard County Monuments 224 0005 R & 224 0003 R.
3. All roads are Public & Existing.
4. Any damage to county owned rights of way shall be corrected at the developer's expense.
5. The total area included is 6.274 Acres.
6. The total number of lots is 28.

**LEGEND:**

1. Contour Interval
2. Existing Contour
3. Proposed Contour
4. Spot Elevation
5. Direction of Drainage
6. Existing Trees to be Saved

Sediment & Erosion Control for this project is provided by the Road Construction Plans - F-85-103.

Brantly Development Corp. hereby authorizes Diversified Holdings to utilize the existing sediment control measures shown on Plan F-85-103 for sediment control for this project. If Brantly Development Corp. removes the existing sediment & erosion control measures prior to completion of the site Development Plan, a revised Sediment & Erosion Control Plan will be required.

**ADDRESS TABLE**

LOT NO.	STREET ADDRESS
54	7101 Brandywine Way
55	7103 Forest Green Court
56	7107 " "
57	7111 " "
58	7114 " "
59	7110 " "
60	7106 " "
61	7102 " "
62	7117 " "
63	7121 Brandywine Way
64	7125 " "
65	7124 " "
66	7120 " "
67	7116 " "
68	7112 " "
69	7108 " "
70	7104 " "
71	7100 " "
72	7103 Starhill Court
73	7107 " "
74	7111 " "
75	7115 " "
76	7114 " "
77	7110 " "
78	7106 " "
79	7102 " "

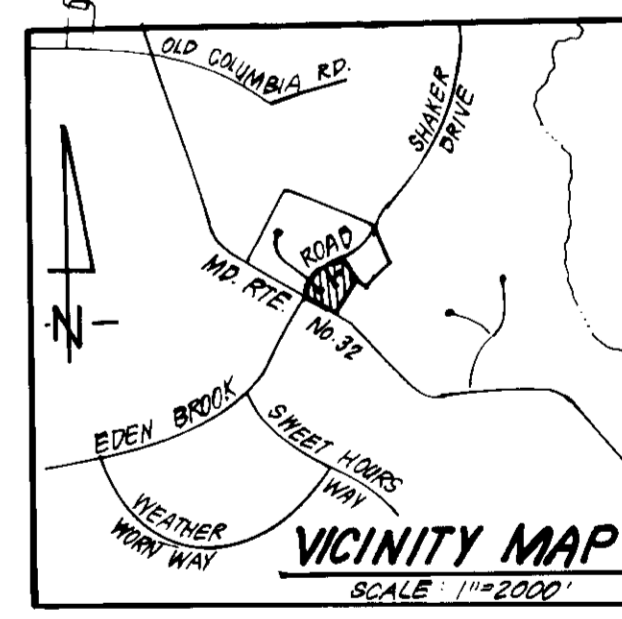

Subdivision Name: KINGS MEADE	SECT./AREA: 42, P. 804	LOTS: 54-79
Developer: Brantly Development Corp. 5501 Twin Knolls Road, Columbia, Maryland 21045	PLAT #: 0305	BLOCK #: 7
	WATER CODE: E-16	SEWER CODE: 520000

Reviewed for SCD  
not meet Technical Requirements  
James M. Hammett 3/24/86

APPROVED  
DATE: 3-27-86

APPROVED FOR PUBLIC WATER AND PUBLIC SEWERAGE SYSTEMS.  
HOWARD COUNTY HEALTH DEPARTMENT  
COUNTY HEALTH OFFICER: [Signature] DATE: 3-27-86

APPROVED: HOWARD COUNTY OFFICE OF PLANNING & ZONING  
PLANNING DIRECTOR: [Signature] DATE: 3-31-86

APPROVED: FOR PUBLIC WATER AND PUBLIC SEWERAGE, STORM DRAINAGE SYSTEMS AND PUBLIC ROADS  
HOWARD COUNTY DEPARTMENT OF PUBLIC WORKS  
DIRECTOR: [Signature] DATE: 3-6-86

MD. RTE. 32

OWNER/DEVELOPER  
B. Paul Montgomery  
DATE: 3-13-86

Professional Engineer Seal for G. Nelson Clark, No. 7150, State of Maryland, dated 3-14-86.

**CLARK · FINEFROCK & SACKETT**  
ENGINEERS · PLANNERS · SURVEYORS  
11315 LOCKWOOD DRIVE SILVER SPRING, MARYLAND 20904 (301) 593-3400

DESIGNED: GLE BAF  
DRAWN: KIN  
CHECKED: JME BAF  
DATE: 1-29-86

**SITE DEVELOPMENT PLAN & SEDIMENT & EROSION CONTROL PLAN**  
LOTS 54 THRU 79  
**KINGS MEADE**  
SECTION ONE  
6TH ELECTION DISTRICT  
HOWARD COUNTY, MARYLAND  
FOR: Diversified Homes Corporation of Silver Spring, 10015 Old Columbia Pk, Columbia, Md. 21046  
SD.P. 86-157

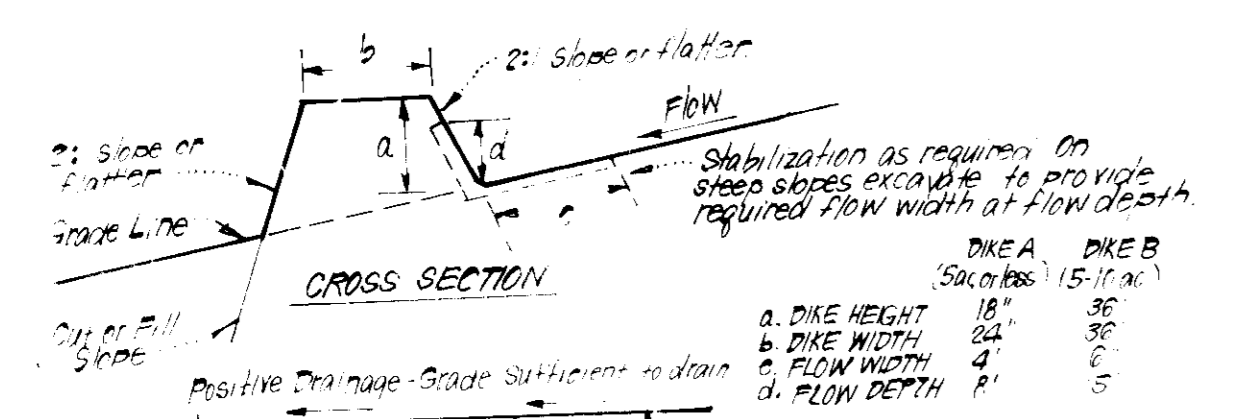

- CONSTRUCTION SPECIFICATIONS:**
1. All dikes shall be compacted by earth-moving equipment.
  2. All dikes shall have positive drainage to an outlet.
  3. Top width may be wider and side slopes may be flatter if desired, to facilitate crossing by construction traffic.
  4. Field location should be adjusted as needed to utilize a stabilized safe outlet.
  5. Earth dikes shall have an outlet that functions with a minimum of erosion. Runoff shall be conveyed to a sediment trapping device such as a sediment trap or sediment basin where either the dike channel or the drainage area above the dike are not adequately stabilized.
  6. Stabilization shall be: (A) in accordance with standard specifications for seed and straw mulch or straw mulch if not in seeding season, (B) flow channel as per chart below.

**FLOW CHANNEL STABILIZATION**

TYPE OF TREATMENT	SLOPE	DIKE A	DIKE B
1	0.5 - 3.0%	Seed & Straw Mulch	Seed or Straw Mulch
2	3.1 - 5.0%	Seed & Straw Mulch	Seed, Mulch, or Excelsior; Sod, 2" Stone
3	5.1 - 8.0%	Seed, Mulch or Sod; 2" Stone	Lined Rip Rap 4"-8" Stone
4	8.1 - 20.0%	Lined Rip Rap 4"-8" Stone	Engineering Design

A. Stone to be 2" Stone, or recycled concrete equivalent, in a layer at least 3" thick and be pressed into soil with construction equipment.  
 B. Rip Rap to be 4" in a layer at least 8" thick, pressed into soil.  
 C. Rip Rap to be 4" in a layer at least 8" thick, pressed into soil.  
 D. Rip Rap to be 4" in a layer at least 8" thick, pressed into soil.  
 E. Rip Rap to be 4" in a layer at least 8" thick, pressed into soil.

**EARTH DIKE DETAIL (E.D.)**  
NO SCALE

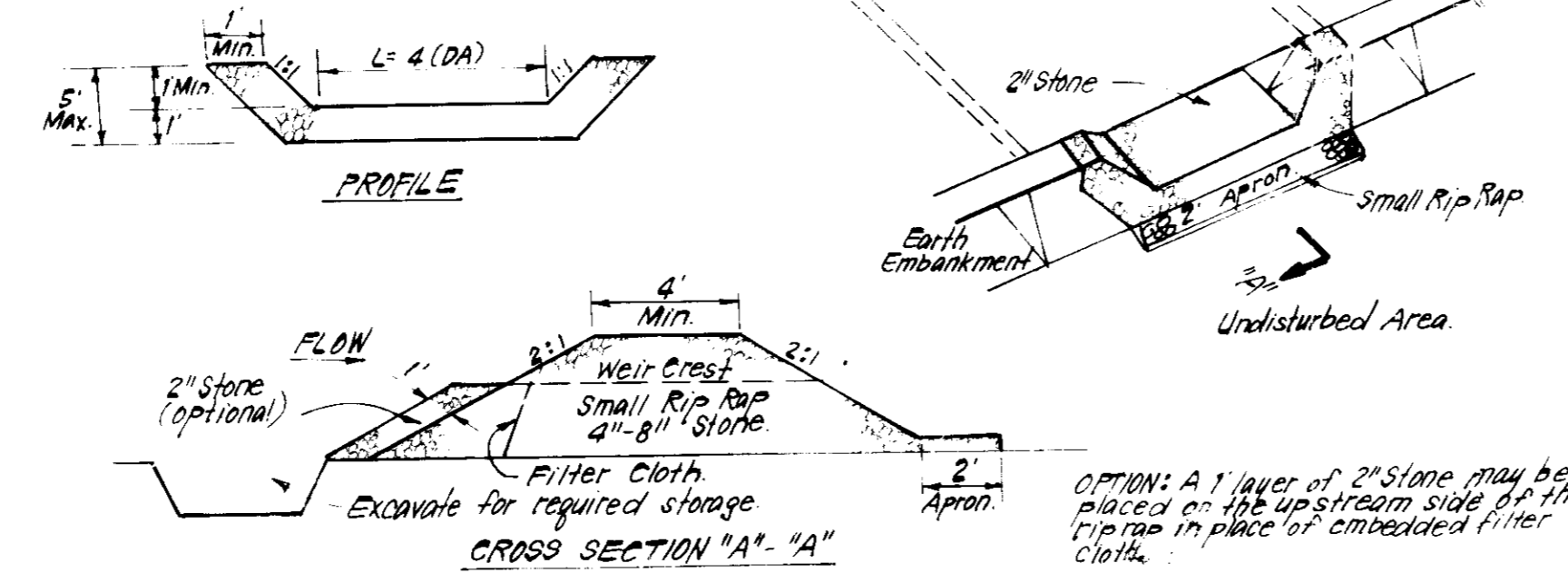

- CONSTRUCTION SPECIFICATIONS:**
1. Area under embankment shall be cleared, grubbed and stripped of any vegetation and root mat. The pool area shall be cleared.
  2. The fill material for the embankment shall be free of roots and other woody vegetation as well as oversized stones, rocks, organic material or other objectionable material. The embankment shall be compacted by traversing with equipment while it is being constructed.
  3. All cut and fill slopes shall be 2:1 or flatter.
  4. The stone used in the outlet shall be small rip rap 4"-8" along with 1" thickness of 2" aggregate placed on the up-grade side on the small rip rap or embedded filter cloth in the rip rap.
  5. Sediment shall be removed and trap restored to its original dimensions when the sediment has accumulated to 1/2 the design depth of the trap.
  6. The structure shall be inspected after each rain and repairs made as needed.
  7. Construction operations shall be carried out in such a manner that erosion and water pollution is minimized.
  8. The structure shall be removed and the area stabilized when the drainage area has been properly stabilized.

**STONE OUTLET SEDIMENT TRAP (SOST) STV**  
1/2 SCALE

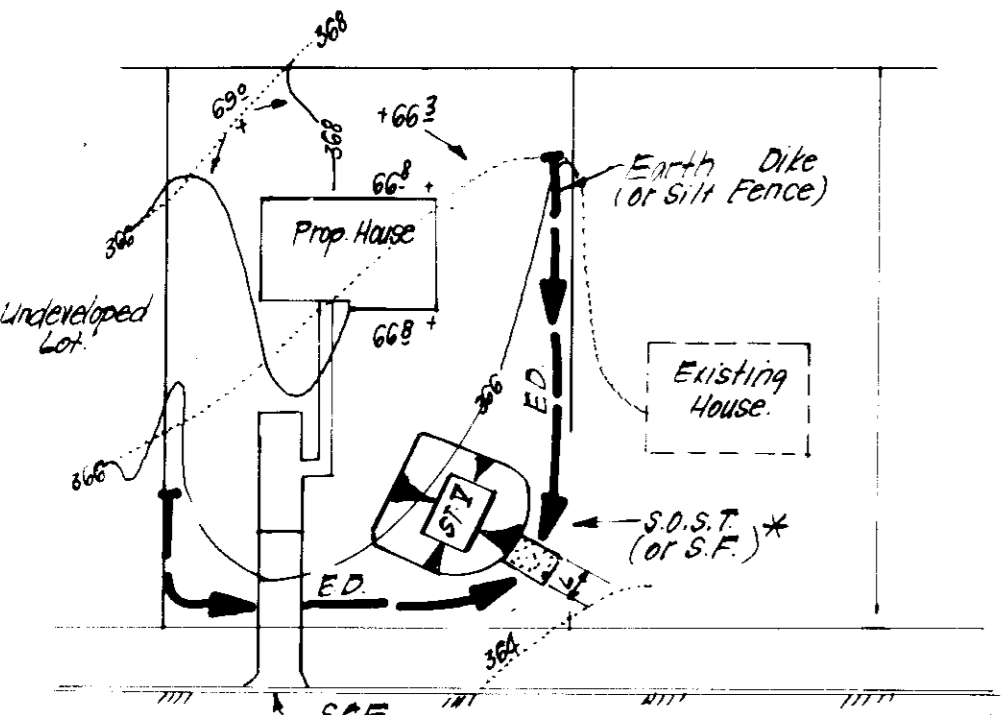

**S.O.S.T. (S.F.V) Pg. 16, 17**

LOT SIZE	VAR	VAR	VAR	TAC
2	2	2	2	2
Depth	11	26	26	26
Bot. Width	11	11	26	26
Bot. Area	121	276	676	676

+ NOTE: Single lot detail can not be utilized if any two lots sharing common property lines are to be disturbed at the same time or on any lots showing a sediment trap.  
 + Can be adjusted in field, but bottom area must be as given or greater.

**SINGLE LOT SEDIMENT CONTROL PLAN**  
NO SCALE

**PERMANENT SEEDING NOTES**

Apply to graded or cleared areas not subject to immediate further disturbance where permanent long-lived vegetative cover is needed.

**Seeding Preparation:** Loosen upper three inches of soil by raking, disking or other acceptable means before seeding.

**Soil Amendments:** In lieu of soil test recommendations, use one of the following schedule:

- 1) Preferred - Apply 2 tons per acre dolomitic limestone (92 lbs/1000 sq ft) and 900 lbs per acre 10-10-10 fertilizer (14 lbs/1000 sq ft) before seeding. Harrow or disc into upper three inches of soil. At time of seeding, apply 400 lbs per acre 30-0-0 ureaform fertilizer (9 lbs/1000 sq ft).
- 2) Acceptable - Apply 2 tons per acre dolomitic limestone (92 lbs/1000 sq ft) and 1000 lbs per acre 10-10-10 fertilizer (23 lbs/1000 sq ft) before seeding. Harrow or disc into upper three inches of soil.

**Seeding:** For the periods March 1 thru April 30, and August 1 thru October 15, seed with 60 lbs per acre (1.4 lbs/1000 sq ft) of Kentucky 31 Tall Fescue. For the period May 1 thru July 31, seed with 60 lbs Kentucky 31 Tall Fescue per acre and 2 lbs per acre (.03 lbs/1000 sq ft) of weeping lovegrass. During the period of October 16 thru February 28, protect site by: Option (1) 2 tons per acre of well anchored straw mulch and seed as soon as possible in the spring. Option (2) Use sod. Option (3) Seed with 60 lbs/acre Kentucky 31 tall Fescue and mulch with 2 tons/acre well anchored straw.

**Mulching:** Apply 1 1/2 to 2 tons per acre (70 to 90 lbs/1000 sq ft) of unrotted small grain straw immediately after seeding. Anchor mulch immediately after application using mulch anchoring tool or 218 gallons per acre (5 gal/1000 sq ft) of emulsified asphalt on flat areas. On slopes 8 feet or higher, use 348 gallons per acre (8 gal/1000 sq ft) for anchoring.

**TEMPORARY SEEDING NOTES**

Apply to graded or cleared areas likely to be redisturbed where a short-term vegetative cover is needed.

**Seeding Preparation:** Loosen upper three inches of soil by raking, disking or other acceptable means before seeding.

**Soil Amendments:** Apply 600 lbs per acre 10-10-10 fertilizer (14 lbs/1000 sq ft).

**Seeding:** For periods March 1 thru April 30 and from August 15 thru November 15, seed with 25 bushel per acre of annual ryegrass (3.2 lbs/1000 sq ft). For the period May 1 thru August 14, seed with 3 lbs per acre of weeping lovegrass (.07 lbs/1000 sq ft). For the period November 16 thru February 28, protect site by applying 2 tons per acre of well anchored straw mulch and seed as soon as possible in the spring, or use sod.

**Mulching:** Apply 1 1/2 to 2 tons per acre (70 to 90 lbs/1000 sq ft) of unrotted small grain straw immediately after seeding. Anchor mulch immediately after application using mulch anchoring tool or 218 gal per acre (5 gal/1000 sq ft) of emulsified asphalt on flat areas. On slopes 8 ft or higher, use 348 gal per acre (8 gal/1000 sq ft) for anchoring.

Refer to the 1983 MARYLAND STANDARDS AND SPECIFICATIONS FOR SOIL EROSION AND SEDIMENT CONTROL for rates and methods not covered.

**SEDIMENT CONTROL NOTES**

- 1) A minimum of 24 hours notice must be given to the Howard County Office of Inspection and Permits prior to the start of any construction. (992-2437)
- 2) All work shall be done in accordance with the 1983 MARYLAND STANDARDS AND SPECIFICATIONS FOR SOIL EROSION AND SEDIMENT CONTROL.
- 3) Following initial soil disturbance or redisturbance, permanent or temporary stabilization shall be completed within 7 calendar days for all perimeter sediment control structures, dikes, perimeter slopes and all slopes greater than 3:1. 14 days as to all other disturbed or graded areas on the project site.
- 4) All sediment traps having shown must be fenced and warning signs posted around their perimeter in accordance with Vol. 1, Chapter 12, of the HOWARD COUNTY DESIGN MANUAL, Storm Drainage.
- 5) All disturbed areas must be stabilized within the time period specified above in accordance with the 1983 MARYLAND STANDARDS AND SPECIFICATIONS FOR SOIL EROSION AND SEDIMENT CONTROL for permanent seedings (Sec. 51) sod (Sec. 54), temporary seeding (Sec. 50) and mulching (Sec. 52). Temporary stabilization with mulch alone can only be done when recommended seeding dates do not allow for proper germination and establishment of grasses.
- 6) All sediment control structures are to remain in place and are to be maintained in operative condition until permission for their removal has been obtained from the Howard County Sediment Control Inspector.
- 7) Site Analysis:
 

Total Area of Site	6,274 Acres
Area to be seeded	6,274 Acres
Area to be seeded or paved	1,472 Acres
Area to be vegetatively stabilized	4,802 Acres
Total Cut	Cu. yds
Total Fill	Cu. yds
Offsite waste/borrow area location	N/A

- 8) Any sediment control practice which is disturbed by grading activity for placement of utilities must be repaired on the same day of disturbance.
- 9) Additional sediment control must be provided, if deemed necessary by the Howard County DPW sediment control inspector.
- 10) On all sites with disturbed areas in excess of 2 acres, approval of the inspection agency shall be requested upon completion of installation of perimeter erosion and sediment controls, but before proceeding with any other earth disturbance or grading. Other building or grading inspection approvals may not be authorized until this initial approval by the inspection agency is made.
- 11) If houses are to be constructed on an "As-Built" basis, at random, single lot sediment control as shown below shall be implemented.
- 12) All pipes to be blocked at the end of each day (see detail below). N/A
- 13) The total amount of straw bale dikes/silt fence equals N/A T.P.

**CONSTRUCTION SEQUENCE:**

CONSTRUCTION SEQUENCE	No. OF DAYS
A. Obtain Grading Permit and Install Sediment and Erosion Control Devices and Stabilize.	2
B. Excavate for Foundations and Rough Grade & Temporary Stabilize	30
C. Construct Structures, Sidewalks and Driveways.	350
D. Final Grade and stabilize in accordance with Specs. & Specs.	15
E. Upon approval of the sediment control inspector remove sediment and erosion controls and stabilize.	0

APPROVED FOR PUBLIC WATER AND PUBLIC SEWERAGE SYSTEMS, HOWARD COUNTY HEALTH DEPARTMENT  
 3-27-86  
 APPROVED HOWARD COUNTY OFFICE OF PLANNING & ZONING  
 3-27-86  
 APPROVED FOR PUBLIC WATER AND PUBLIC SEWERAGE, STORM DRAINAGE SYSTEMS AND PUBLIC ROADS, HOWARD COUNTY DEPARTMENT OF PUBLIC WORKS  
 3-31-86  
 DIRECTOR DATE  
 CHIEF BUREAU OF ENGINEERING DATE

**DEVELOPER'S/BUILDER'S CERTIFICATE**

I certify that all development and construction will be done in accordance with the plan of development and plan for erosion and sediment control and that all responsible personnel involved in the construction of this project have received a Certificate of Attendance at a Dept. of Natural Resources Training Program for the Control of Sediment and Erosion. I also authorize periodic inspection by the Howard Soil Conservation District if their inspection is deemed necessary.

Signature of Developer/Builder: B. Paul Montgomery  
 Date: 1-29-86

Reviewed for Howard, SCD  
 Name: James M. McHenry  
 Signature: [Signature]  
 Title: S. Soil Conservation Service

Signature of Engineer: [Signature]  
 Date: 1-29-86

**ENGINEER'S CERTIFICATE**

I certify that this plan for Erosion and Sediment Control represents a practice which, with the exercise of personal knowledge and skill, and that it was prepared in accordance with the requirements of the Howard County Department of Public Works.

Signature of Engineer: [Signature]  
 Date: 1-29-86

**CLARK • FINEFROCK & SACKETT**  
 ENGINEERS • PLANNERS • SURVEYORS

11315 LOCKWOOD DRIVE SILVER SPRING, MARYLAND 20904 (301) 593-3400

DESIGNED: GLB/BAF  
 DRAWN: K/W  
 CHECKED: JBF  
 DATE: 1-29-86

**SITE DEVELOPMENT PLAN & SEDIMENT & EROSION CONTROL PLAN**  
 LOTS 54 THRU 79  
**KINGS MEADE**  
 SECTION ONE  
 6TH ELECTION DISTRICT  
 HOWARD COUNTY, MARYLAND  
 FOR DIVERSIFIED HOMES CORPORATION OF SHAKER  
 10015 Old Columbia Pike  
 Columbia, MD 21046

SCALE: 1"=30'  
 DRAWING: 2 OF 2  
 JOB NO: 86-004  
 FILE NO: 86-004-5E

SDP-86-157