

ADDRESS CHART	
LOT NUMBER	STREET ADDRESS
PARCEL 'G-1'	9015 JUNCTION DRIVE

JUNCTION INDUSTRIAL PARK M-2 ZONED
PARCEL 'C-2'

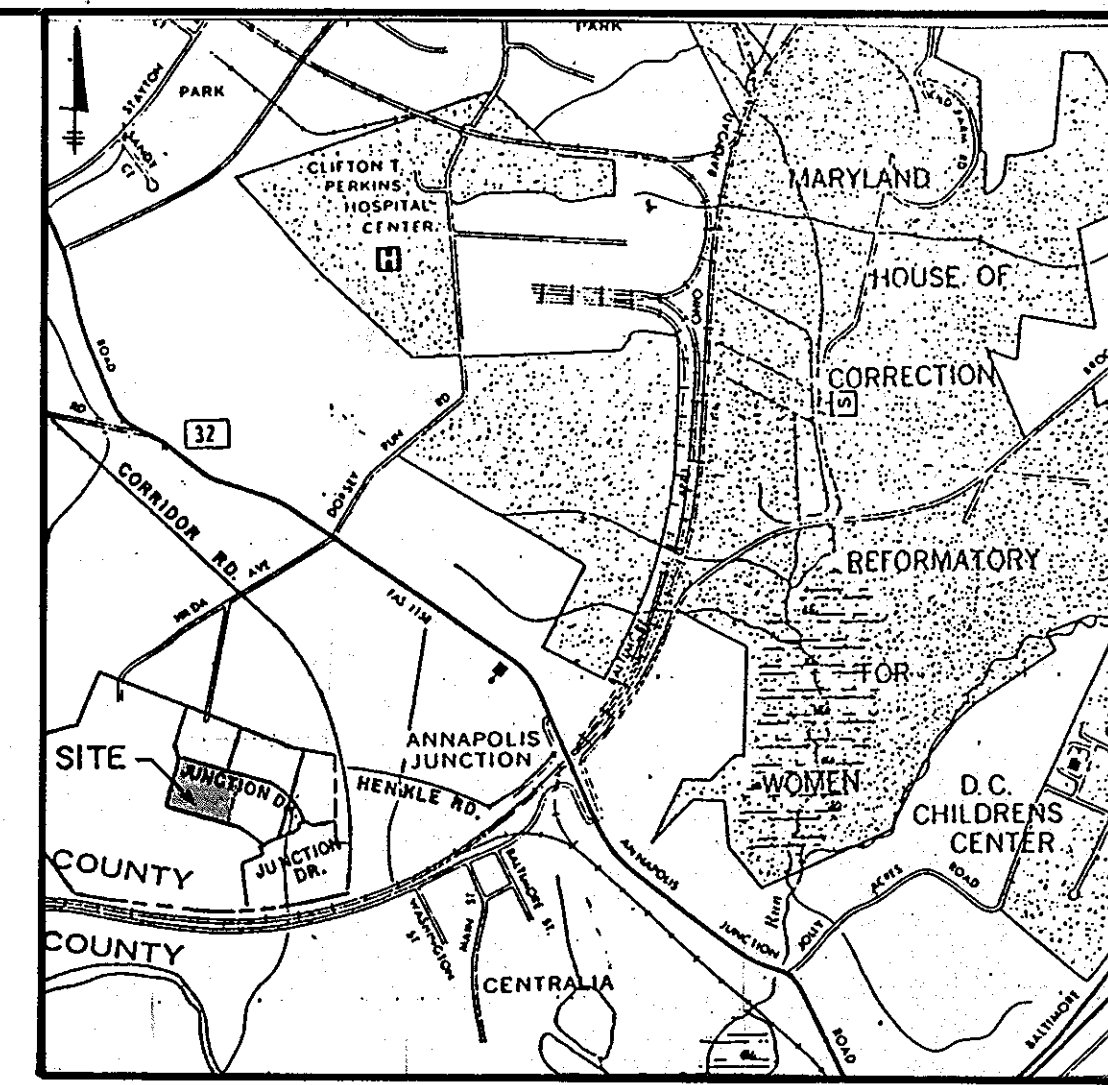

VICINITY MAP
SCALE: 1" = 2000'

GENERAL NOTES

- PRIOR TO THE START OF ANY CONSTRUCTION THE CONTRACTOR SHALL STAKE OUT ALL BASELINES, BUILDING LOCATION, AND CURBS; AND VERIFY OFFSETS AND SETBACKS.
- THE CONTRACTOR SHALL NOTIFY "MISS UTILITY" AT TELEPHONE NO. (301) 599-0100 PRIOR TO STARTING EXCAVATION TO VERIFY ALL LOCATIONS OF EXISTING UTILITIES.
- ALL CONSTRUCTION SHALL BE ACCOMPLISHED IN ACCORDANCE WITH HOWARD COUNTY, DEPARTMENT OF PUBLIC WORK STANDARDS, SPECIFICATIONS AND REQUIREMENTS.
- THE INFORMATION SHOWN ON THESE PLANS IS FOR THE CONVENIENCE OF THOSE CONCERNED ONLY. THE CORRECTNESS OR COMPLETENESS OF THE INFORMATION SHOWN IS NOT WARRANTED OR GUARANTEED. THE CONTRACTOR SHALL VERIFY ALL INFORMATION TO HIS OWN SATISFACTION.
- THE LOCATIONS OF EXISTING UNDERGROUND UTILITIES ARE SHOWN IN AN APPROXIMATE WAY ONLY. THE CONTRACTOR SHALL DETERMINE THE EXACT LOCATION OF ALL EXISTING UTILITIES BEFORE COMMENCING WORK. HE AGREES TO BE FULLY RESPONSIBLE FOR ANY AND ALL DAMAGES WHICH MIGHT BE OCCASIONED BY HIS FAILURE TO EXACTLY LOCATE AND PRESERVE ANY AND ALL UNDERGROUND UTILITIES.
- ALL DISTURBED AREAS NOT STABILIZED WITH PAVING, BUILDING, SODDING OF MULCH IN PLANTING AREAS SHALL BE SEEDED AND MULCHED.
- STORM WATER MANAGEMENT PROVIDED IN PARCEL R-1 UNDER FINAL PLANS P-84-204.

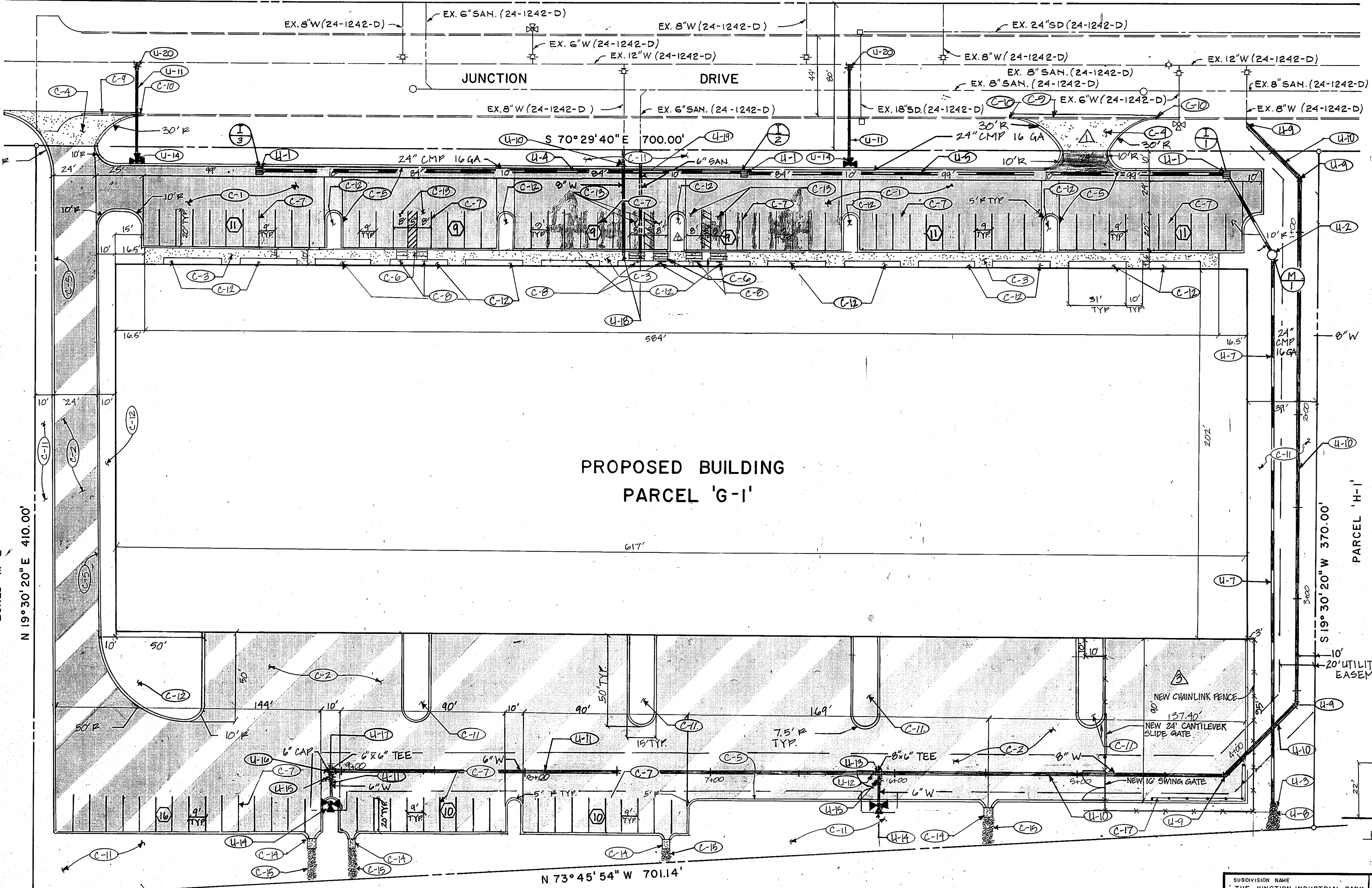

PROPOSED BUILDING
PARCEL 'G-1'

JUNCTION INDUSTRIAL PARK M-2 ZONED
PARCEL 'H-1'

APPROVED
DIVISION OF LAND DEVELOPMENT &
ZONING ADMINISTRATION
HOWARD COUNTY, MARYLAND
DATE 3-12-86

6/17/11	REVISION	REVISION
7/1/86	ADDITION OF EASTERN ENTRANCE	
11/20/86	REVISE HANDICAP RAMPS, PARKING	
6/11/74	CHAIN LINK FENCE ADDED, RET. WALL REMOVED	
DATE	NO.	REVISION

PROJECT: THE JUNCTION INDUSTRIAL PARK
6th ELECTION DISTRICT HOWARD CO., MARYLAND.
SECTION I AREA I PARCEL "G-1"

TITLE: SD-1
LAYOUT AND UTILITY PLAN
OWNER: EHM G LIMITED PARTNERSHIP
P.O. BOX 125
GLEN ARM, MARYLAND 21057
ENGINEERS: WHITNEY, BAILEY, COX & MAGNANI
CONSULTING ENGINEERS
1850 YORK ROAD
TIMONIUM, MARYLAND 21093
301 282-6060

DATE:	DESIGNED: R.B.
	DRAWN: G.G.
	CHECKED: P.D.
	PROJECT NO: 85232
	DATE: 12/12/85
	SCALE: 1" = 30'
PROFESSIONAL ENGR. NO. 9472	DRAWING NO. 1 OF 6

JUNCTION LIMITED PARTNERSHIP
1031/595
ZONED M-2

JUNCTION LIMITED PARTNERSHIP 1031/595 ZONED M-2

- UTILITY NOTES
- U-1 INSTALL NEW DOUBLE 'S' COMBINATION INLET SEE SHEET SD-6 FOR SCHEDULE.
 - U-2 INSTALL NEW PRECAST MANHOLE SEE SHEET SD-6 FOR SCHEDULE.
 - U-3 INSTALL NEW METAL END SECTION SEE SHEET SD-6 FOR SCHEDULE.
 - U-4 INSTALL 265 LF OF 21" CMP GA 16 @ 1.0%.
 - U-5 INSTALL 265 LF OF 24" CMP GA 16 @ 1.0%.
 - U-6 INSTALL 50 LF OF 24" CMP GA 16 @ 1.0%.
 - U-7 INSTALL 300 LF OF 24" CMP GA 16 @ 1.0%.
 - U-8 INSTALL 25 LF OF GABION OVER FILTER CLOTH SEE SHEET SD-4, SEE DETAIL 11.
 - U-9 INSTALL 1/8" BEND AND BUTTRESS.
 - U-10 INSTALL NEW 8" D.I.P. CL. 52.
 - U-11 INSTALL NEW 6" D.I.P. CL. 52.
 - U-12 INSTALL NEW 8"x6" REDUCER.
 - U-13 INSTALL NEW 8"x6" TEE.
 - U-14 INSTALL NEW 6" FIRE HYDRANT.
 - U-15 INSTALL NEW 6" VALVE WITH ROADWAY BOX.
 - U-16 INSTALL NEW 6" CAP AND BUTTRESS.
 - U-17 INSTALL NEW 6"x6" TEE.
 - U-18 SEE MECHANICAL PLAN FOR CONTINUATION.
 - U-19 INSTALL NEW 6" SEWER CONNECTION AT 2.01.
 - U-20 INSTALL NEW 12" x 6" TAPPING SLEEVE AND VALVE.

- CONSTRUCTION NOTES
- C-1 NEW BITUMINOUS CONCRETE PAVING, LIGHT DUTY, SEE DETAIL 10, SHEET SD-4.
 - C-2 NEW BITUMINOUS CONCRETE PAVING, HEAVY DUTY, SEE DETAIL 10, SHEET SD-4.
 - C-3 NEW 4" CONCRETE SIDEWALK, SEE DETAIL 9, SHEET SD-4.
 - C-4 NEW 7" CONCRETE DRIVEWAY ENTRANCE, REFER TO HOWARD COUNTY HD. STANDARD SPECIFICATIONS & DETAILS FOR CONSTRUCTION, STD. PLATE R-6-07.
 - C-5 NEW STANDARD 7" CURB & GUTTER COMBINATION, REFER TO HOWARD COUNTY, MD. STANDARD SPECIFICATIONS & DETAILS FOR CONSTRUCTION, STD. PLATE R-3-01.
 - C-6 NEW PEDESTRIAN RAMP, SEE DETAIL 5, SHEET SD-4.
 - C-7 PAVEMENT MARKINGS TO BE DONE W/YELLOW TRAFFIC PAINT, SEE DETAIL 6, SHEET SD-4.
 - C-8 NEW HANDICAP RESERVED PARKING SIGNS, SEE DETAIL 7, SHEET SD-4.
 - C-9 REMOVE EXISTING CURB & GUTTER.
 - C-10 MEET EXISTING GRADE.
 - C-11 ALL DISTURBED AREAS WHICH ARE NOT PAVED OR PLANTED IN ACCORDANCE WITH THE PLANTING PLAN, SHEET SD-5, SHALL BE SEEDED & MULCHED, SEE SPECIFICATIONS.
 - C-12 REFER TO PLANTING PLAN, SHEET SD-5.
 - C-13 HANDICAP PAVEMENT MARKINGS, SEE DETAIL 6, SHEET SD-4.
 - C-14 CURB OPENING, STATE OF MARYLAND, DEPARTMENT OF TRANSPORTATION, STATE HIGHWAY ADMINISTRATION STANDARDS FOR HIGHWAYS & INCIDENTAL STRUCTURES, STD. PLATE NO. MD-640-01.
 - C-15 GABION CHANNEL, SEE DETAIL 11 SHEET SD-4.
 - C-16 RAILROAD TIE RETAINING WALL, SEE DETAIL 12, SHEET SD-4.
 - C-17 INSTALL 70 L.F. OF GUARD RAIL, SEE HOWARD COUNTY STD PLATE R-7-01.

SITE DATA

AREA 6,2672
ZONING M-2
ELECTION DISTRICT 6TH

OPEN SPACE DATA

TOTAL AREA 272,999 S.F.
BUILDING 124,534 S.F.
PAVING 92,250 S.F.
OPEN SPACE 56,215 S.F.

56,515 : 272,999 = 20%

PARKING DATA

16% OFFICE = 19,715 S.F.
63% WAREHOUSE = 78,993 S.F.
21% VEHICLE SERVICE = 25,926 S.F. (8 BAYS)

REQUIRED:

75 OFFICE EMPLOYEES X .70 (7 SP. / 10 EMP.) = 53 SPACES
38 WAREHOUSE EMPLOYEES X .50 (1 SP. / 2 EMP.) = 19 SPACES
8 VEHICLE SERVICE BAYS = 3 SP. + (3 SP. / BAY) = 27 SPACES
TOTAL REQUIRED 99 SPACES

PROVIDED:

STANDARD 93 SPACES
HANDICAPPED 6 SPACES
TOTAL PROVIDED 99 SPACES

PAVED AREA = 93,750 S.F.
REQUIRED LANDSCAPE ISLAND AREA = 55 X 93,750 = 4687.5 S.F.
PROPOSED LANDSCAPE ISLAND AREA = 6220 S.F. = 6.64

LEGEND

EXISTING	NEW
BITUMINOUS CONCRETE PAVING (LIGHT DUTY)	[Symbol]
BITUMINOUS CONCRETE PAVING (HEAVY DUTY)	[Symbol]
CONCRETE PAVING	[Symbol]
CURB AND GUTTER	[Symbol]
STORM DRAIN	EX. 24" SD
SANITARY	EX. 8" SAN.
WATER	EX. 12" W.
PARKING SPACE AMOUNT	[Symbol]
GUARD RAIL	[Symbol]

SUBDIVISION NAME THE JUNCTION INDUSTRIAL PARK	SECT./AREA 1/1	LOT/PARCEL NO. G PARCEL G-1
PLAT 6379	BLOCK 19	ZONE M-2
TAX/ZONE MAP 48	ELEC. DIST. 6	CENSUS TR. 6064
WATER CODE CO4	SEWER CODE 4020000	
APPROVED FOR PUBLIC WATER AND PUBLIC SEWERAGE AND STORM DRAINAGE SYSTEMS AND ROADS HOWARD COUNTY DEPARTMENT OF PUBLIC WORKS		
DIRECTOR <i>W. F. Nemes</i>		DATE 4-22-86
CHIEF OF BUREAU OF ENGINEERING <i>W. J. ...</i>		DATE 2-21-86
APPROVED FOR PUBLIC WATER AND PUBLIC SEWERAGE SYSTEMS HOWARD COUNTY HEALTH DEPARTMENT		
COUNTY HEALTH OFFICER <i>Joseph Boyle</i>		DATE 4-24-86
APPROVED - HOWARD COUNTY OFFICE OF PLANNING AND ZONING		
PLANNING DIRECTOR <i>Thomas Hammons</i>		DATE 4-24-86
CHIEF DIVISION OF LAND DEVELOPMENT AND ZONING ADMINISTRATION <i>John W. ...</i>		DATE 4-24-86



SDP-86-135

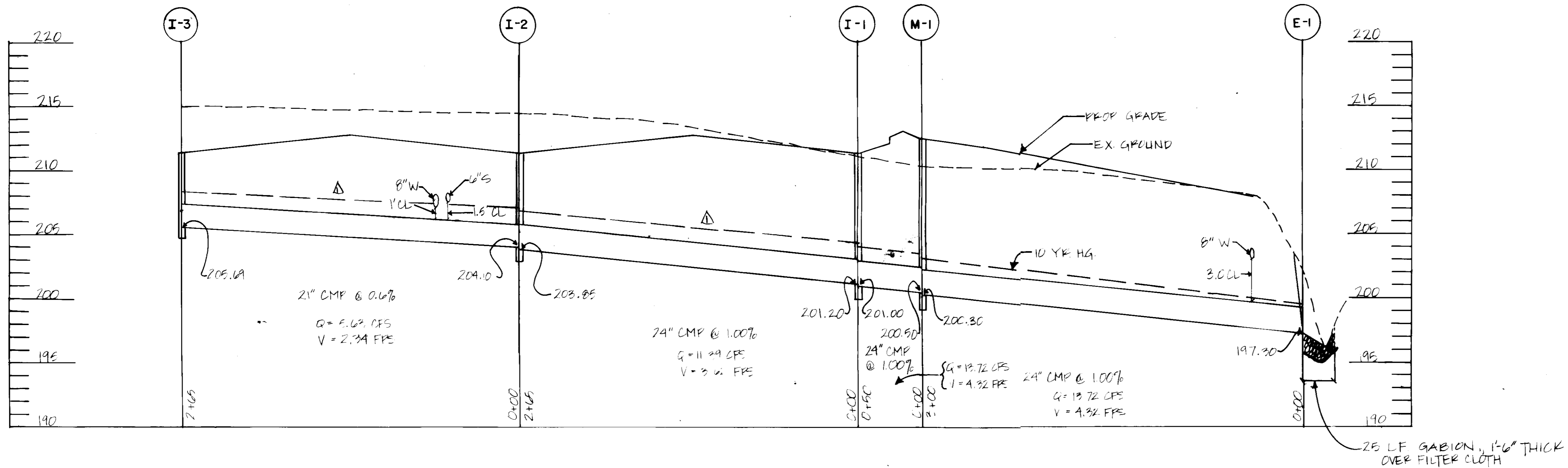

PROFILE
 HORIZ 1" = 50'
 VERT 1" = 5'

STRUCTURE SCHEDULE				
NO.	TYPE	INVERT IN	INVERT OUT	TOP ELEV
I-1	DOUBLE S-COMB INLET HOWARD CO. SD-4.34	201.20	201.00	211.39*
I-2	DOUBLE S-COMB INLET HOWARD CO. SD-4.34	204.10	203.85	211.39*
I-3	DOUBLE S-COMB INLET HOWARD CO. SD-4.34	—	205.14	211.39*
M-1	STANDARD PRECAST MANHOLE HOWARD CO. HS-12	200.50	200.30	213.00
E-1	METAL END SECTION HOWARD CO. SE-5.61	—	197.30	—

* TOP OF GRATE

APPROVED
 DIVISION OF LAND DEVELOPMENT &
 ZONING ADMINISTRATION
 HOWARD COUNTY, MARYLAND
 DATE 3-12-86

SUBDIVISION NAME THE JUNCTION INDUSTRIAL PARK		SECT./AREA 1/1	LOT/PARCEL NO. G PARCEL G-1
PLAT 6379	BLOCK 19	ZONE M-2	TAX/ZONE MAP 48
ELEC. DIST. 6		CENSUS TR. 6064	
WATER CODE C04		SEWER CODE 4020000	

APPROVED: FOR PUBLIC WATER AND PUBLIC SEWERAGE AND STORM DRAINAGE SYSTEMS AND ROADS.
 HOWARD COUNTY DEPARTMENT OF PUBLIC WORKS
 DIRECTOR: *[Signature]* DATE: 4-22-86

APPROVED: FOR PUBLIC WATER AND PUBLIC SEWERAGE SYSTEMS
 HOWARD COUNTY HEALTH DEPARTMENT
 COUNTY HEALTH OFFICER: *[Signature]* DATE: 4-24-86

APPROVED: HOWARD COUNTY OFFICE OF PLANNING AND ZONING
 PLANNING DIRECTOR: *[Signature]* DATE: 4-24-86

DATE: 4-24-86

7/1/86	REVISE HYDRAULIC GRADIENT
DATE	NO.
REVISION	

PROJECT: **THE JUNCTION INDUSTRIAL PARK**
 6th ELECTION DISTRICT HOWARD CO., MARYLAND
 SECTION I AREA I PARCEL "G-1"
 TITLE: SD-6
 UTILITY PROFILE

OWNER: EHM G LIMITED PARTNERSHIP
 P.O. BOX 125
 GLEN ARM, MARYLAND 21057

ENGINEERS: WHITNEY, BAILEY, COX & MAGNANI
 CONSULTING ENGINEERS
 1850 YORK ROAD
 TIMONIUM, MARYLAND 21093
 301-252-6060

DATE: 12/17/85

DESIGNED: R. B.
 DRAWN: G. G.
 CHECKED: P. D.
 PROJECT NO.: 85232
 DATE: 12/12/85
 SCALE: 1" = 30'
 DRAWING NO.: 6 OF 6

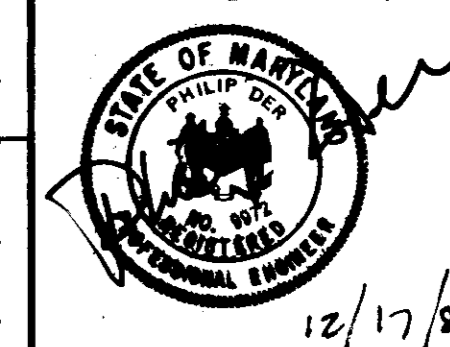

ADDRESS CHART	
LOT NUMBER	STREET ADDRESS
PARCEL 'G-1'	9015 JUNCTION DRIVE

JUNCTION INDUSTRIAL PARK M-2 ZONED
PARCEL 'C-2'

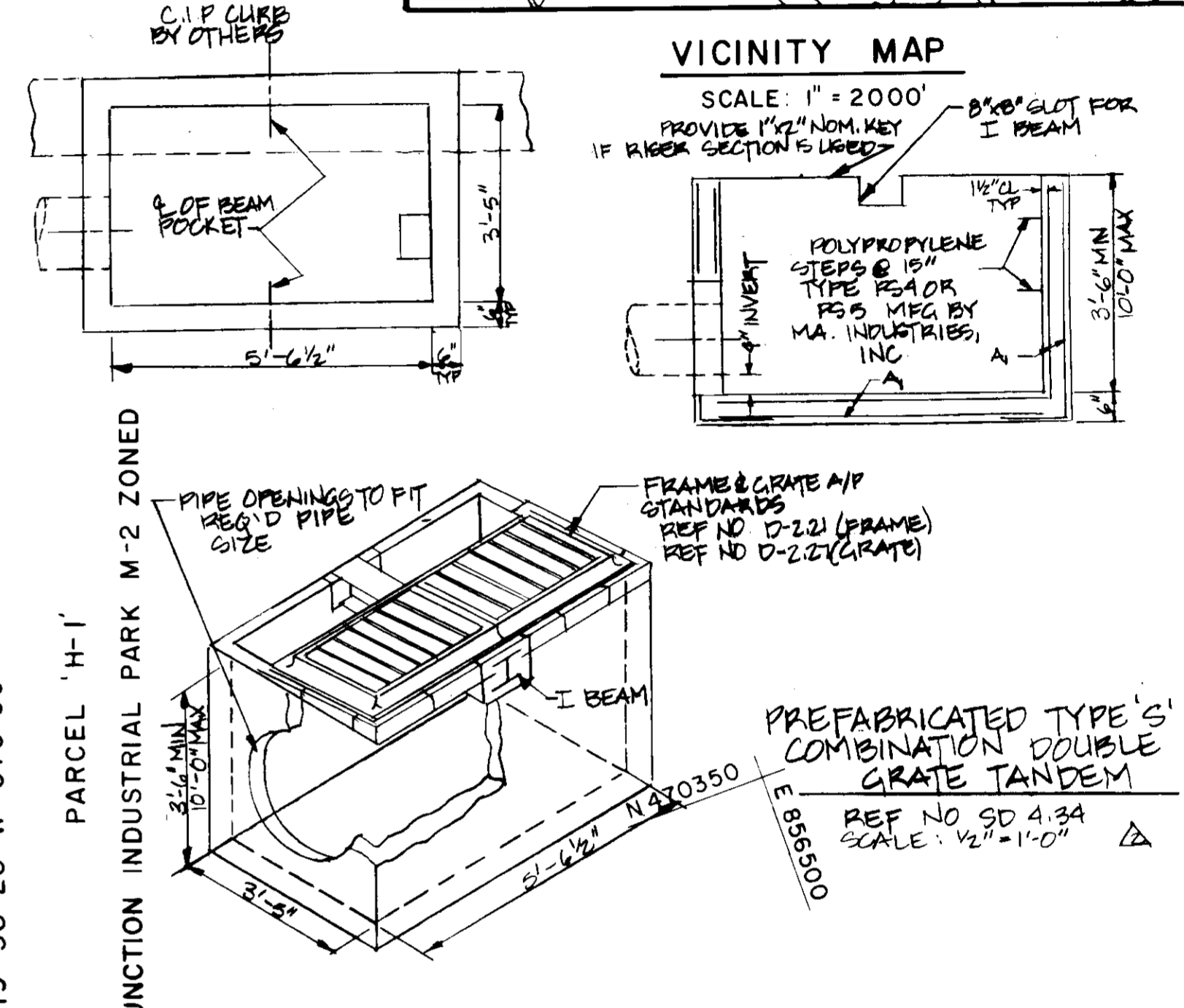
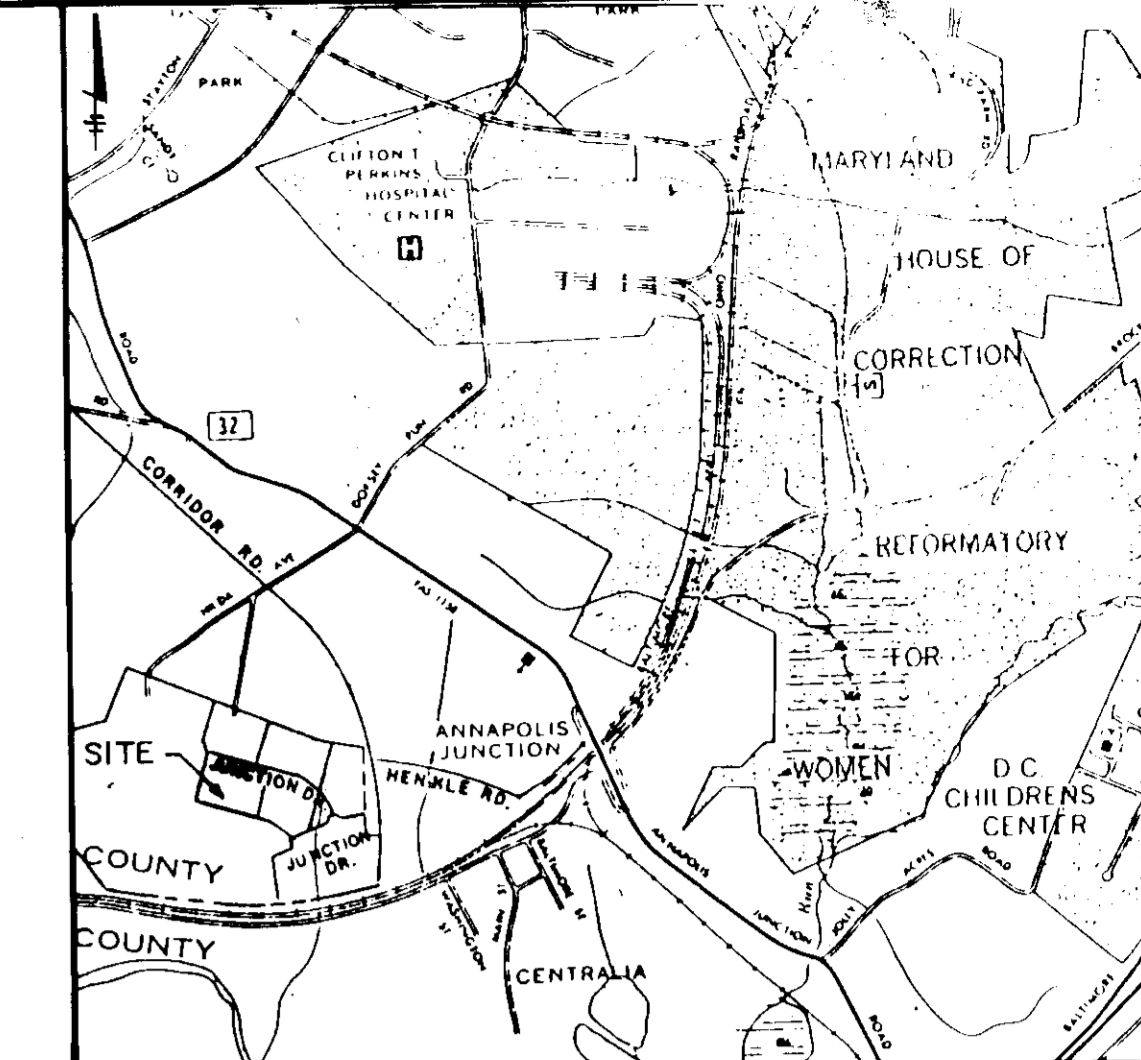
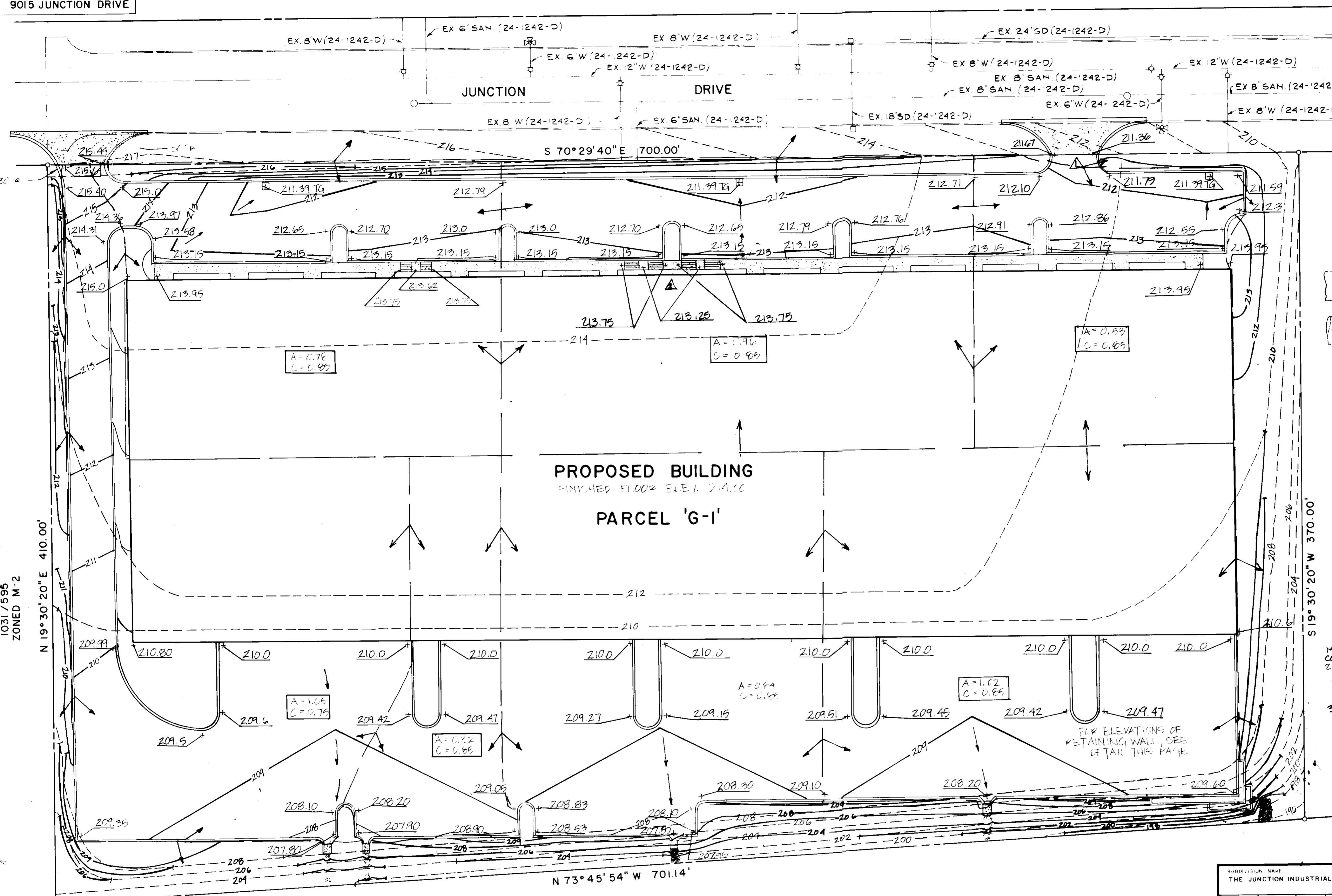

NOTES

- MANUAL IN HOWARD COUNTY STD DETAILS FOR CONSTRUCTION
- CONCRETE SHALL CONFORM TO THE MD DOT SHA STANDARD SPECIFICATION FOR CONSTRUCTION & MATERIALS 1002, MIX NO. 6 EXCEPT THAT TYPE II CEMENT & PENALTY DOT #13 COARSE AGGREGATE (4000 PSI)
- WELDED WIRE FABRIC SHALL CONFORM TO ASTM A 185. LAP SPICES SHALL BE A MINIMUM LENGTH OF 1/2 TRANSVERSE WIRE SPACES. W.W.F. CAGE SHALL BE TACK WELDED TO MAKE A RIGID UNIT
- CONTRACTOR TO PROVIDE BRICK INVERT AS PER DWG NO. SD 434
- BRICK REG'D TO BRING GRATE TO GRADE & ELEVATION

REINFORCING SCHEDULE
A1-WWF 4x4 W4, W4

APPROVED
DIVISION OF LAND DEVELOPMENT &
ZONING ADMINISTRATION
HOWARD COUNTY, MARYLAND
DATE 3-12-86

JUNCTION LIMITED PARTNERSHIP
1031/595
ZONED M-2

JUNCTION LIMITED PARTNERSHIP 1031/595 ZONED M-2

LEGEND

	EXISTING	NEW
FINISHED GRADE	--- 210 ---	--- 210 ---
FINISHED SPOT ELEVATION		▲ 209.45
CONCRETE PAVING		▨
CURB AND GUTTER		▬
STORM DRAIN	EX. 24" SD	▬
SANITARY	EX. 8" SAN.	▬
WATER	EX. 12" W.	▬
PARKING SPACE AMOUNT		⬡
DRAINAGE DELINEATION AREA		⬠

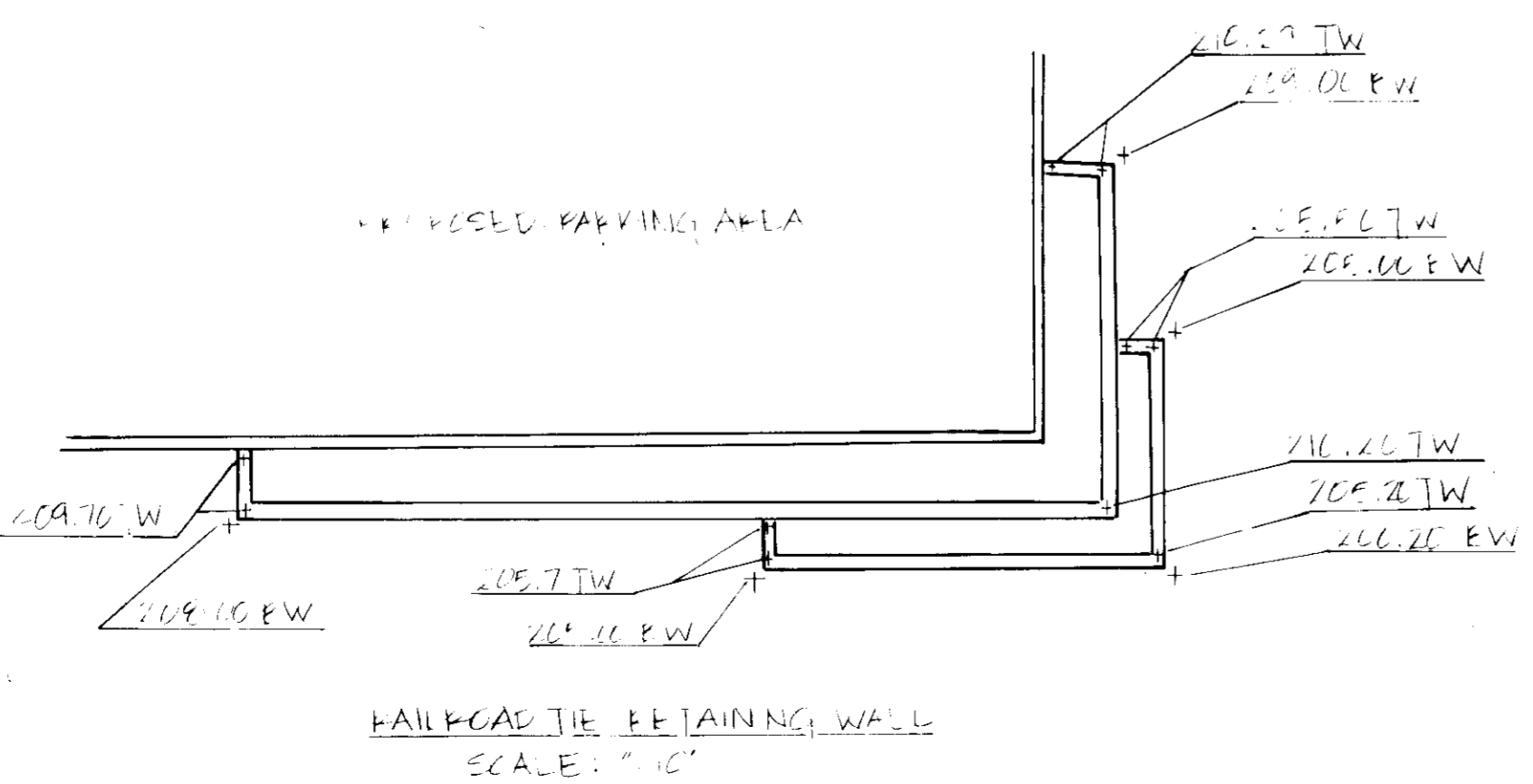

SUBMISSION NAME THE JUNCTION INDUSTRIAL PARK	SHEET AREA 1/1	LL/PARCEL NO. G PARCEL G-1
FILE 6379	DATE 19	ZONE M-2
WATER DATE CO4	SEWER DATE 4020000	ELC. DIST 6
CENSUS TR 6064		
APPROVED FOR PUBLIC WATER AND PUBLIC SEWERAGE AND STORM DRAINAGE SYSTEMS AND ROADS DATE 4-22-86		
APPROVED FOR PUBLIC WATER AND PUBLIC SEWERAGE SYSTEMS DATE 4-24-86		
APPROVED FOR PUBLIC WATER AND PUBLIC SEWERAGE AND STORM DRAINAGE SYSTEMS AND ROADS DATE 4-24-86		
APPROVED FOR PUBLIC WATER AND PUBLIC SEWERAGE AND STORM DRAINAGE SYSTEMS AND ROADS DATE 4-24-86		

7/1/86	ADDITION OF EASTERN ENTRANCE
11/20/86	RELOCATE HANDICAP RAMP, ADD INLET DETAIL
DATE NO.	REVISION
PROJECT:	THE JUNCTION INDUSTRIAL PARK
	6th ELECTION DISTRICT HOWARD CO, MARYLAND SECTION I AREA I PARCEL "G-1"
TITLE:	SD-2 DRAINAGE AREA/GRADING PLAN
OWNER:	EHM G LIMITED PARTNERSHIP P.O. BOX 125 GLEN ARM, MARYLAND 21057
ENGINEERS:	WHITNEY, BAILEY, COX & MAGNANI CONSULTING ENGINEERS 1850 YORK ROAD TIMONIUM, MARYLAND 21093 301 252-6060
DATE:	DESIGNED: R.B.
	DRAWN: G.G.
	CHECKED: P.D.
	PROJECT NO: 85232
	DATE: 12/12/85
	SCALE: 1" = 30'
PROFESSIONAL ENGR. NO. 71,123	DRAWING NO. 2 OF 6

ADDRESS CHART
 LOT NUMBER
 STREET ADDRESS
 PARCEL 'G-1' 9015 JUNCTION DRIVE

JUNCTION INDUSTRIAL PARK M-2 ZONED
 PARCEL 'C-2'

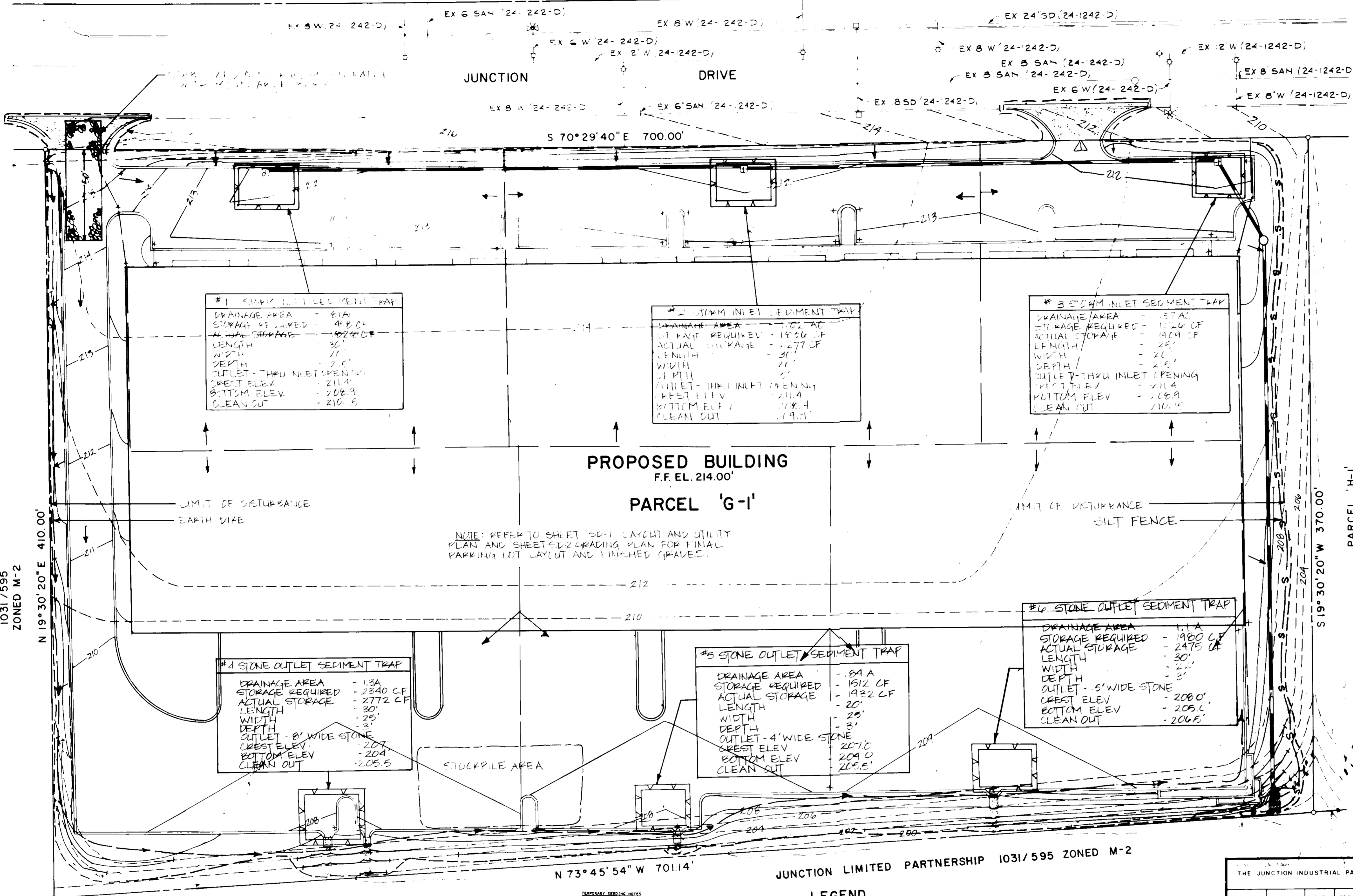

#1 STONE INLET SEDIMENT TRAP
 DRAINAGE AREA - 81A
 STORAGE REQUIRED - 89.03 CF
 ACTUAL STORAGE - 107.0 CF
 LENGTH - 30'
 WIDTH - 11'
 DEPTH - 2.5'
 OUTLET - 8" WIDE STONE
 CREST ELEV. - 211.4
 BOTTOM ELEV. - 208.9
 CLEAN OUT - 210.5'

#2 STONE INLET SEDIMENT TRAP
 DRAINAGE AREA - 102.2 AC
 STORAGE REQUIRED - 112.26 CF
 ACTUAL STORAGE - 127.7 CF
 LENGTH - 30'
 WIDTH - 11'
 DEPTH - 2.5'
 OUTLET - 8" WIDE STONE
 CREST ELEV. - 211.4
 BOTTOM ELEV. - 208.9
 CLEAN OUT - 210.5'

#3 STONE INLET SEDIMENT TRAP
 DRAINAGE AREA - 87.2 AC
 STORAGE REQUIRED - 102.0 CF
 ACTUAL STORAGE - 118.9 CF
 LENGTH - 30'
 WIDTH - 11'
 DEPTH - 2.5'
 OUTLET - 8" WIDE STONE
 CREST ELEV. - 211.4
 BOTTOM ELEV. - 208.9
 CLEAN OUT - 210.5'

#4 STONE OUTLET SEDIMENT TRAP
 DRAINAGE AREA - 13A
 STORAGE REQUIRED - 2340 CF
 ACTUAL STORAGE - 2772 CF
 LENGTH - 30'
 WIDTH - 25'
 DEPTH - 3'
 OUTLET - 8" WIDE STONE
 CREST ELEV. - 207
 BOTTOM ELEV. - 204
 CLEAN OUT - 205.5'

#5 STONE OUTLET SEDIMENT TRAP
 DRAINAGE AREA - .84 A
 STORAGE REQUIRED - 1512 CF
 ACTUAL STORAGE - 1932 CF
 LENGTH - 20'
 WIDTH - 20'
 DEPTH - 3'
 OUTLET - 4" WIDE STONE
 CREST ELEV. - 207.0
 BOTTOM ELEV. - 204.0
 CLEAN OUT - 205.5'

#6 STONE OUTLET SEDIMENT TRAP
 DRAINAGE AREA - 1.1 A
 STORAGE REQUIRED - 1980 CF
 ACTUAL STORAGE - 2475 CF
 LENGTH - 30'
 WIDTH - 25'
 DEPTH - 3'
 OUTLET - 8" WIDE STONE
 CREST ELEV. - 208.0
 BOTTOM ELEV. - 205.0
 CLEAN OUT - 206.5'

PROPOSED BUILDING
 F.F. EL. 214.00'
 PARCEL 'G-1'

NOTE: REFER TO SHEET SD-1 LAYOUT AND UTILITY PLAN AND SHEET SD-2 GRADING PLAN FOR FINAL PARKING LOT LAYOUT AND FINISHED GRADES.

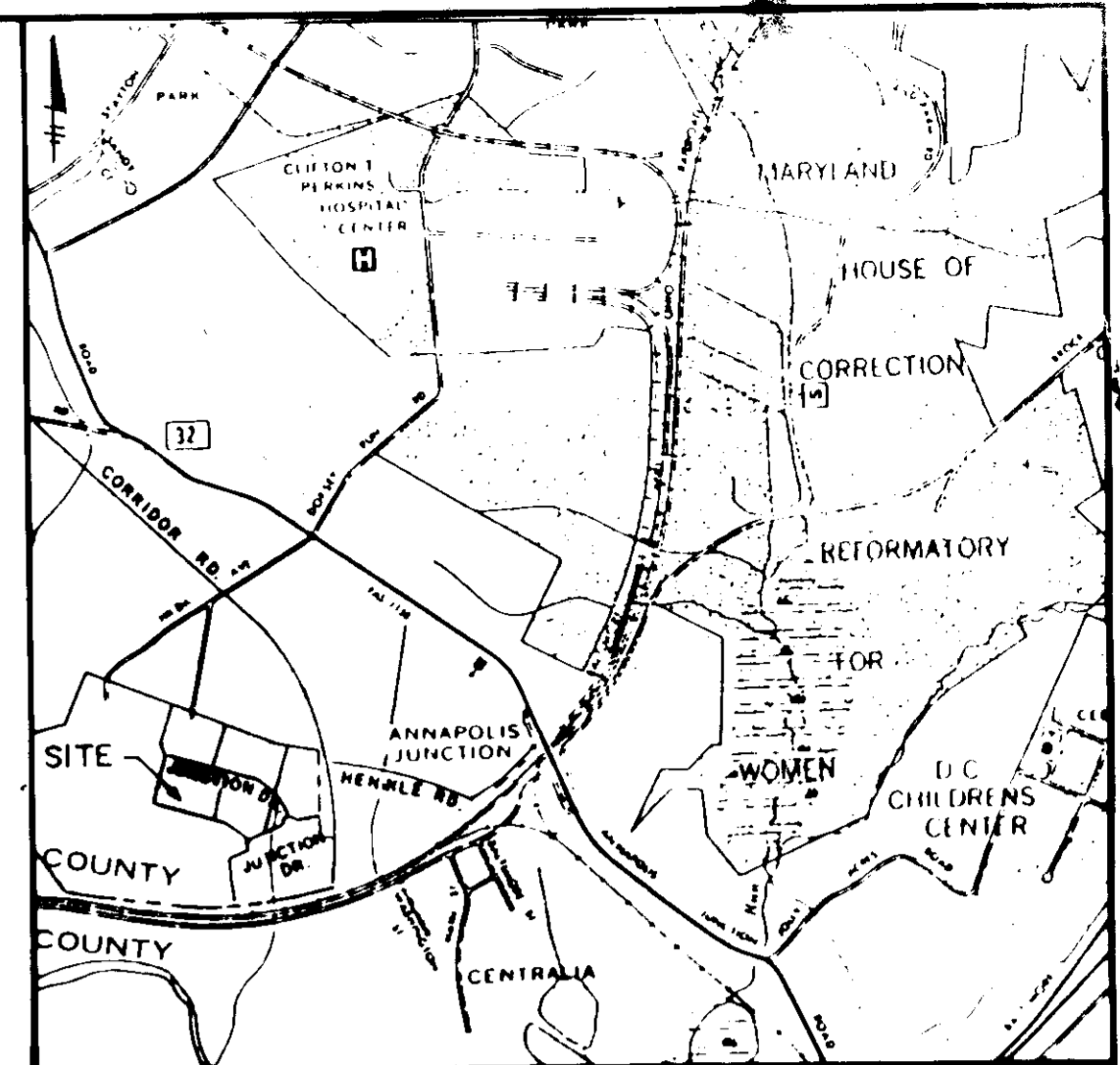

VICINITY MAP
 SCALE 1" = 2000'

APPROVED
 DIVISION OF LAND DEVELOPMENT &
 ZONING ADMINISTRATION
 HOWARD COUNTY, MARYLAND
 DATE 3-12-86

SEDIMENT CONTROL

PROVIDE THE FOLLOWING CERTIFICATION BLOCKS ON SEDIMENT CONTROL PLANS:
 BY THE DEVELOPER:
 "I/WE CERTIFY THAT ALL DEVELOPMENT AND CONSTRUCTION WILL BE DONE ACCORDING TO THIS PLAN, AND THAT ANY RESPONSIBLE PERSONNEL INVOLVED IN THE CONSTRUCTION PROJECT WILL HAVE A CERTIFICATE OF ATTENDANCE AT A DEPARTMENT OF NATURAL RESOURCES APPROVED TRAINING PROGRAM FOR THE CONTROL OF SEDIMENT AND EROSION BEFORE BEGINNING THE PROJECT."

Michael E. News
 SIGNATURE OF DEVELOPER 3/24/86
 DATE

BY THE ENGINEER:
 "I CERTIFY THAT THIS PLAN FOR EROSION AND SEDIMENT CONTROL REPRESENTS A PRACTICAL AND WORKABLE PLAN BASED ON MY PERSONAL KNOWLEDGE OF THE SITE CONDITIONS AND THAT IT WAS PREPARED IN ACCORDANCE WITH THE REQUIREMENTS OF THE HOWARD COUNTY SOIL CONSERVATION DISTRICT."

Philip A. ...
 SIGNATURE OF ENGINEER 12/17/85
 DATE

REVIEWED FOR HOWARD COUNTY, MARYLAND
 NAME S.C.D. AND MEETS TECHNICAL REQUIREMENTS.

James M. ...
 U.S. SOIL CONSERVATION SERVICE 4-16-86
 DATE

THIS DEVELOPMENT PLAN IS APPROVED FOR SOIL EROSION AND SEDIMENT CONTROL BY THE HOWARD COUNTY SOIL CONSERVATION DISTRICT.

William L. ...
 HOWARD S.C.D. 4/15/86
 DATE

JUNCTION LIMITED PARTNERSHIP
 1031/595
 ZONED M-2

PARCEL 'H-1'
 JUNCTION INDUSTRIAL PARK M-2 ZONED

JUNCTION LIMITED PARTNERSHIP 1031/595 ZONED M-2

LEGEND

- EXISTING GRADE - - - 210 - - -
- PROPOSED GRADE - - - 210 - - -
- SEDIMENT TRAP [Symbol]
- LIMIT OF DISTURBANCE [Symbol]
- EARTH DIKE [Symbol]
- DRAINAGE AREA DELINEATION [Symbol]
- STABILIZED CONSTRUCTION [Symbol]
- ENTRANCE [Symbol]
- SILT FENCE [Symbol]

NOTE: ALL EARTHWORK QUANTITIES SHOWN HEREON ARE FOR THE ENTIRE DISTRICT OF HOWARD COUNTY. THE CONTRACTOR SHALL OBTAIN SEPARATE EARTHWORK QUANTITIES FROM THE COUNTY ENGINEER'S OFFICE FOR EACH PLOT SURFACE.

- SEQUENCE OF OPERATIONS
1. NOTIFY THE HOWARD COUNTY OFFICE OF INSPECTION AND PERMITS (892-2437) A MINIMUM OF 24 HOURS PRIOR TO THE START OF ANY WORK.
 2. INSTALL STABILIZED CONSTRUCTION ENTRANCE.
 3. MINOR CLEANING AND GRADING OPERATIONS FOR CONSTRUCTION OF SEDIMENT CONTROL MEASURES.
 4. STABILIZE SLOPE ALONG SOUTHERN BOUNDARY WHICH WILL BE OUTSIDE OF EARTH DIKE.
 5. INSTALL EARTH DIKE, AND SEDIMENT TRAPS NO. 1, 2, 3 & 4 (AFTER SEDIMENT CONTROL MEASURES HAVE BEEN INSTALLED AND STABILIZED, THE CONTRACTOR SHALL INSPECT AND MAINTAIN ALL MEASURES ON A DAILY BASIS).
 6. INSTALL STORM DRAIN SYSTEM.
 7. CONSTRUCT SEDIMENT TRAP NO. 1, 2, 3 AT NEW INLETS. (SEDIMENT TRAPS SHALL BE INSPECTED AND MAINTAINED ON A DAILY BASIS).
 8. CLEAR AND ROUGH GRADE REMAINING SITE WORK.
 9. BUILDING CONSTRUCTION AND REMAINING SITE WORK.
 10. SEED AND MULCH ALL DISTURBED AREAS OUTSIDE OF THE BUILDING AND PAVED AREAS, UNLESS DIRECTED OTHERWISE ON THE PLANS.
 11. WITH PERMISSION OF THE SEDIMENT CONTROL INSPECTOR, REMOVE SEDIMENT CONTROL MEASURES AND STABILIZE REMAINING AREAS.

- SEDIMENT CONTROL NOTES
- 1) A MINIMUM OF 24 HOURS NOTICE MUST BE GIVEN TO THE HOWARD COUNTY OFFICE OF INSPECTIONS AND PERMITS PRIOR TO THE START OF ANY CONSTRUCTION (892-2437).
 - 2) ALL VEGETATIVE AND STRUCTURAL PRACTICES ARE TO BE INSTALLED ACCORDING TO THE PROVISIONS OF THIS PLAN AND ARE TO BE IN CONFORMANCE WITH THE 1983 MARYLAND STANDARDS AND SPECIFICATIONS FOR SOIL EROSION AND SEDIMENT CONTROL.
 - 3) FOLLOWING INITIAL SOIL DISTURBANCE OR REDISTURBANCE, PERMANENT OR TEMPORARY STABILIZATION SHALL BE COMPLETED WITHIN: A) 7 CALENDAR DAYS FOR ALL PERIMETER SEDIMENT CONTROL STRUCTURES, DIKES, PERIMETER SLOPES AND ALL SLOPES GREATER THAN 3:1; B) 14 DAYS AS TO ALL OTHER DISTURBED OR GRADED AREAS ON THE PROJECT SITE.
 - 4) ALL SEDIMENT TRAPS/BASINS SHOWN MUST BE FENCED AND WARNING SIGNS POSTED AROUND THEIR PERIMETER IN ACCORDANCE WITH VOL. 11, CHAPTER 12, OF THE HOWARD COUNTY DESIGN MANUAL, STORM DRAINAGE.
 - 5) ALL DISTURBED AREAS MUST BE STABILIZED WITHIN THE TIME PERIOD SPECIFIED ABOVE IN ACCORDANCE WITH THE 1983 MARYLAND STANDARDS AND SPECIFICATIONS FOR SOIL EROSION AND SEDIMENT CONTROL FOR PERMANENT SEEDINGS (SEC. 513) AND TEMPORARY SEEDINGS (SEC. 503) AND MULCHING (SEC. 523).
 - 6) ALL SEDIMENT CONTROL STRUCTURES ARE TO REMAIN IN PLACE AND ARE TO BE MAINTAINED IN OPERATIVE CONDITION UNTIL PERMISSION FOR THEIR REMOVAL HAS BEEN OBTAINED FROM THE HOWARD COUNTY SEDIMENT CONTROL INSPECTOR.
 - 7) SITE ANALYSIS:

TOTAL AREA OF SITE	103.12	ACRES
AREA DISTURBED	103.12	ACRES
AREA TO BE ROOFED OR PAVED	103.12	ACRES
AREA TO BE VEGETATIVELY STABILIZED	103.12	ACRES
TOTAL CUT	103.12	CU.YD
TOTAL FILL	103.12	CU.YD
OFFSITE WASTE/BORROW AREA LOCATION		
 - 8) ANY SEDIMENT CONTROL PRACTICE WHICH IS DISTURBED BY GRADING ACTIVITY FOR PLACEMENT OF UTILITIES MUST BE REPAIRED ON THE SAME DAY OF DISTURBANCE.
 - 9) ADDITIONAL SEDIMENT CONTROL MUST BE PROVIDED, IF DEEMED NECESSARY, BY THE HOWARD COUNTY DPM SEDIMENT CONTROL INSPECTOR.

- TEMPORARY SEEDING NOTES
- APPLY TO GRADES OR CLEARED AREAS LIKELY TO BE DISTURBED WHERE A PERMANENT VEGETATIVE COVER IS NEEDED.
- SEEDING PREPARATION: LOOSEN UPPER THREE INCHES OF SOIL BY RAKING, DISCING OR OTHER ACCEPTABLE MEANS BEFORE SEEDING.
- SOIL ACCEPTABLE: APPLY 600 LBS PER ACRE 10-10-10 FERTILIZER (10% N/10% P/10% K).
- SEEDING: FOR PERIODS MARCH 1 THRU APRIL 15, AND AUGUST 1 THRU OCTOBER 15, SEED WITH 20 LB/AC BUREAU PER ACRE OF BUREAU MIX (2:1 GRASS/1:1 LEGUME) AT TIME OF SEEDING. APPLY 40 LBS PER ACRE 10-10-10 FERTILIZER (10% N/10% P/10% K) IMMEDIATELY AFTER SEEDING. FOR PERIODS APRIL 16 THRU MAY 15, SEED WITH 15 LBS PER ACRE BUREAU MIX (2:1 GRASS/1:1 LEGUME) AT TIME OF SEEDING. APPLY 40 LBS PER ACRE 10-10-10 FERTILIZER (10% N/10% P/10% K) IMMEDIATELY AFTER SEEDING. FOR PERIODS MAY 16 THRU AUGUST 31, SEED WITH 15 LBS PER ACRE BUREAU MIX (2:1 GRASS/1:1 LEGUME) AT TIME OF SEEDING. APPLY 40 LBS PER ACRE 10-10-10 FERTILIZER (10% N/10% P/10% K) IMMEDIATELY AFTER SEEDING.
- SEEDING PREPARATION: LOOSEN UPPER THREE INCHES OF SOIL BY RAKING, DISCING OR OTHER ACCEPTABLE MEANS BEFORE SEEDING.
- SOIL ACCEPTABLE: IN LIEU OF SOIL TEST RECOMMENDATIONS, USE ONE OF THE FOLLOWING SCHEDULES:
- 1) PREPARED - APPLY 1 TON PER ACRE DOLOMITIC LIMESTONE (82 LBS/TON) AND 200 LBS PER ACRE 10-10-10 FERTILIZER (10% N/10% P/10% K) IMMEDIATELY AFTER SEEDING.
 - 2) ACCEPTABLE - APPLY 1 TON PER ACRE DOLOMITIC LIMESTONE (82 LBS/TON) AND 200 LBS PER ACRE 10-10-10 FERTILIZER (10% N/10% P/10% K) IMMEDIATELY AFTER SEEDING.
 - 3) SEEDING - FOR THE PERIODS MARCH 1 THRU APRIL 15, AND AUGUST 1 THRU OCTOBER 15, SEED WITH 15 LBS PER ACRE BUREAU MIX (2:1 GRASS/1:1 LEGUME) AT TIME OF SEEDING. APPLY 40 LBS PER ACRE 10-10-10 FERTILIZER (10% N/10% P/10% K) IMMEDIATELY AFTER SEEDING. FOR PERIODS APRIL 16 THRU MAY 15, SEED WITH 15 LBS PER ACRE BUREAU MIX (2:1 GRASS/1:1 LEGUME) AT TIME OF SEEDING. APPLY 40 LBS PER ACRE 10-10-10 FERTILIZER (10% N/10% P/10% K) IMMEDIATELY AFTER SEEDING. FOR PERIODS MAY 16 THRU AUGUST 31, SEED WITH 15 LBS PER ACRE BUREAU MIX (2:1 GRASS/1:1 LEGUME) AT TIME OF SEEDING. APPLY 40 LBS PER ACRE 10-10-10 FERTILIZER (10% N/10% P/10% K) IMMEDIATELY AFTER SEEDING.

THE JUNCTION INDUSTRIAL PARK		SECT./AREA	1/1	LOT/PARCEL NO. G	PARCEL G-1
PLAT	BLOCK	ZONE	TAX/ZONE MAP	ELEC. DIST.	CENSUS TR.
637D	19	M-2	48	6	6064
WATER CODE		SEWER CODE			
CO 4		4020000			
APPROVED FOR PUBLIC WATER AND PUBLIC SEWERAGE AND STORM DRAINAGE SYSTEMS AND ROADS					
HOWARD COUNTY DEPARTMENT OF PUBLIC WORKS					
DIRECTOR				DATE	
[Signature]				4-22-86	
APPROVED FOR PUBLIC WATER AND PUBLIC SEWERAGE SYSTEMS					
HOWARD COUNTY HEALTH DEPARTMENT					
COUNTY HEALTH OFFICER				DATE	
[Signature]				4-24-86	
APPROVED HOWARD COUNTY OFFICE OF PLANNING AND ZONING					
PLANNING DIRECTOR				DATE	
[Signature]				4-24-86	
[Signature]				4-24-86	

7/1/86 ADDITION OF EASTERN ENTRANCE		
DATE	NO.	REVISION
PROJECT		
THE JUNCTION INDUSTRIAL PARK		
6th ELECTION DISTRICT HOWARD CO., MARYLAND		
SECTION 1 AREA 1 PARCEL "G-1"		
TITLE SD-3		
SEDIMENT AND EROSION CONTROL PLAN		
OWNER: EHM G LIMITED PARTNERSHIP		
P.O. BOX 125		
GLEN ARM, MARYLAND 21057		
ENGINEERS: WHITNEY, BAILEY, COX & MAGNANI		
CONSULTING ENGINEERS		
850 YORK ROAD		
TIMONUM, MARYLAND 21093		
301 252-6060		
DATE:	DESIGNED	R B
	DRAWN	G G
	CHECKED	P D
	PROJECT NO:	85232
	DATE:	12/12/85
	SCALE:	1" = 30'
	PROFESSIONAL ENGR. NO. 112	DRAWING NO. 3 OF 6
		SDP-86-135

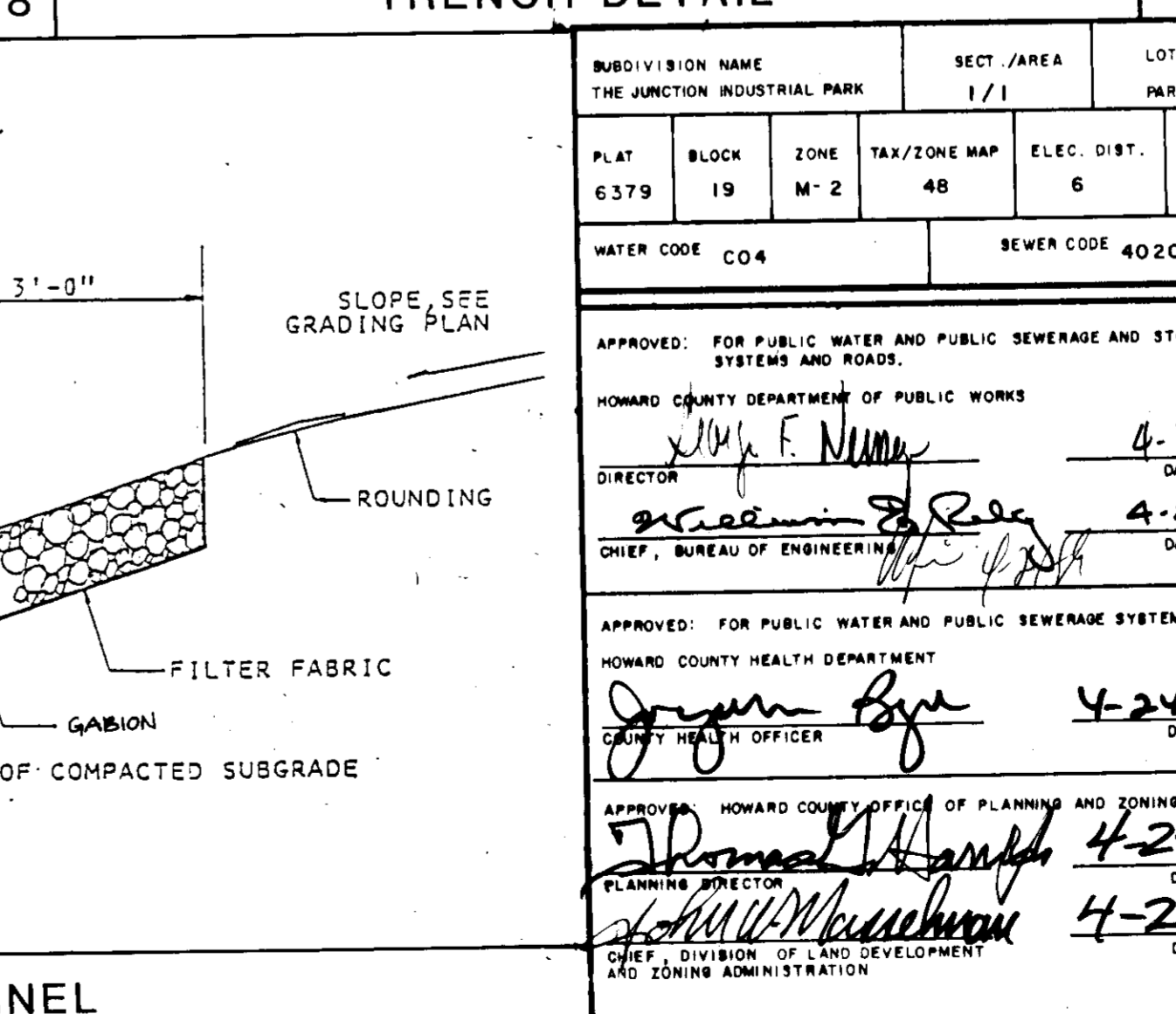
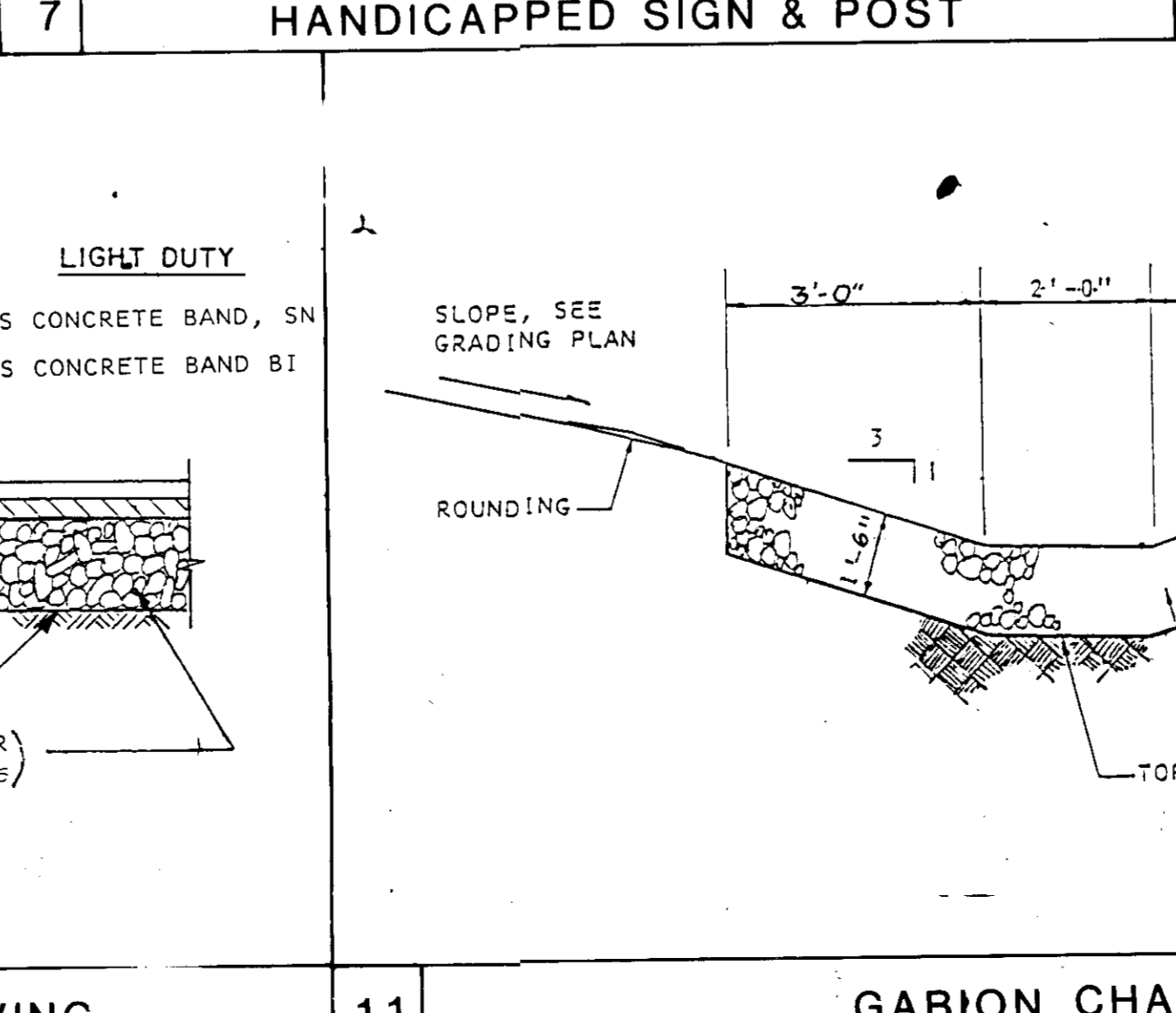
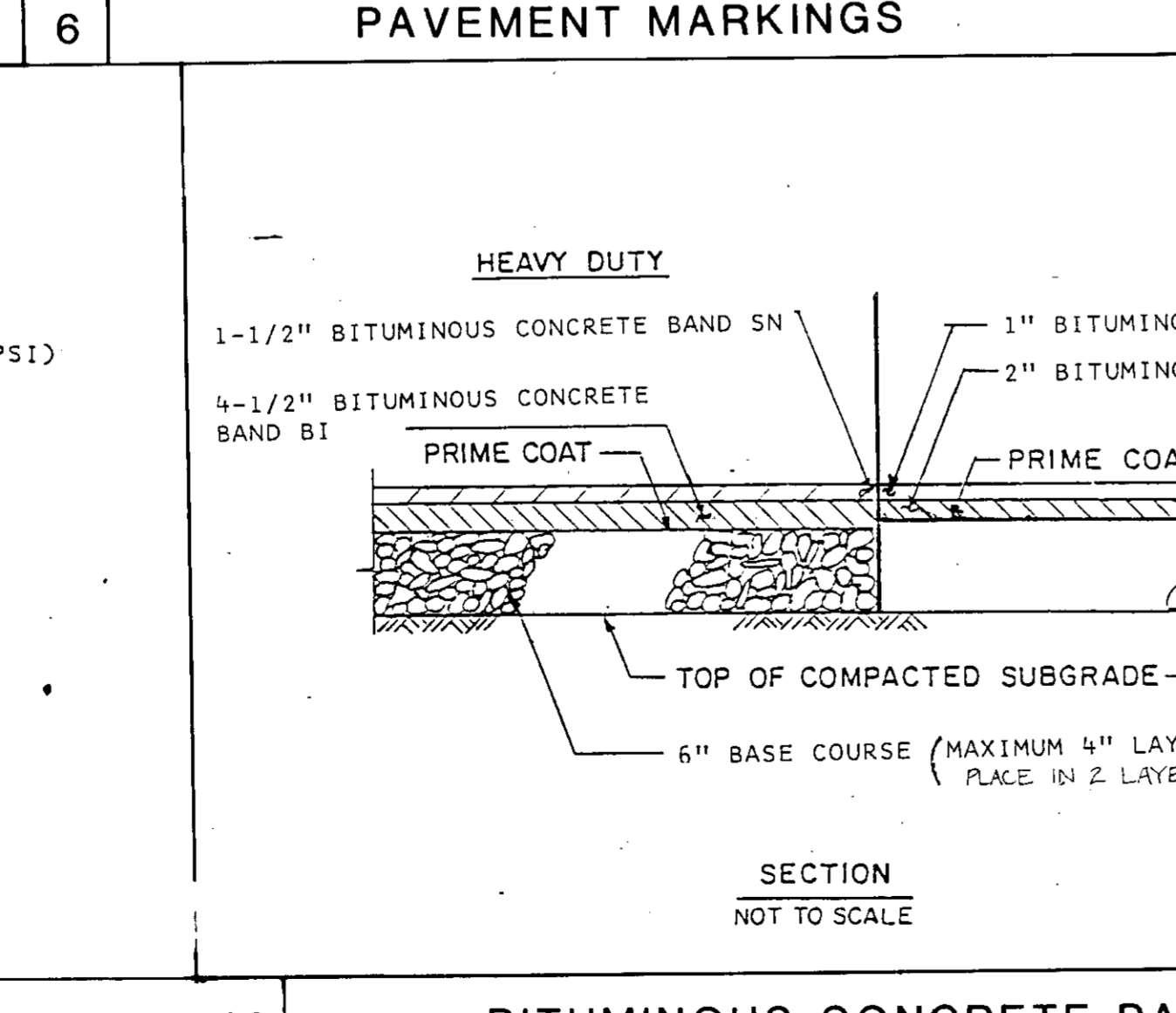
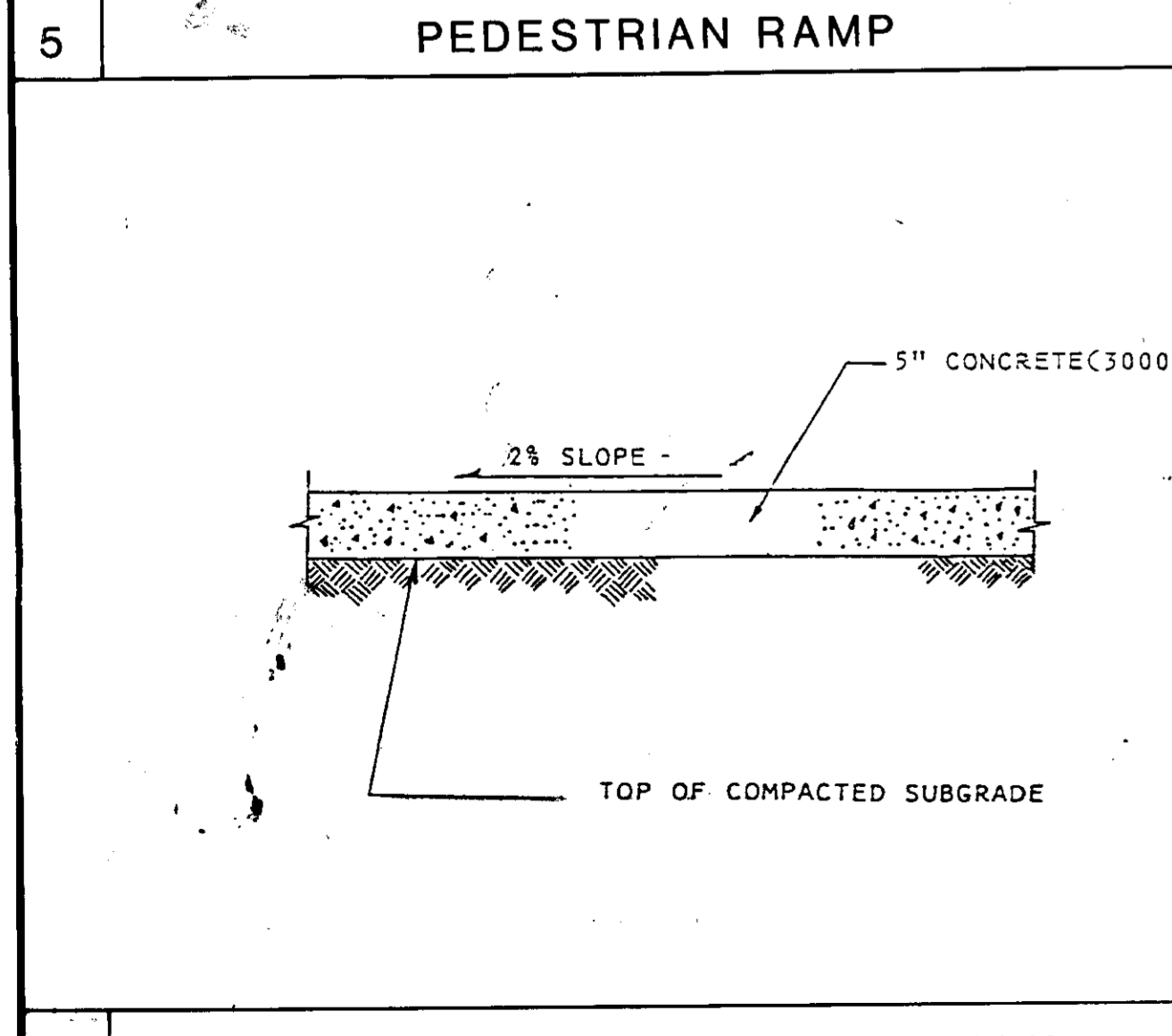
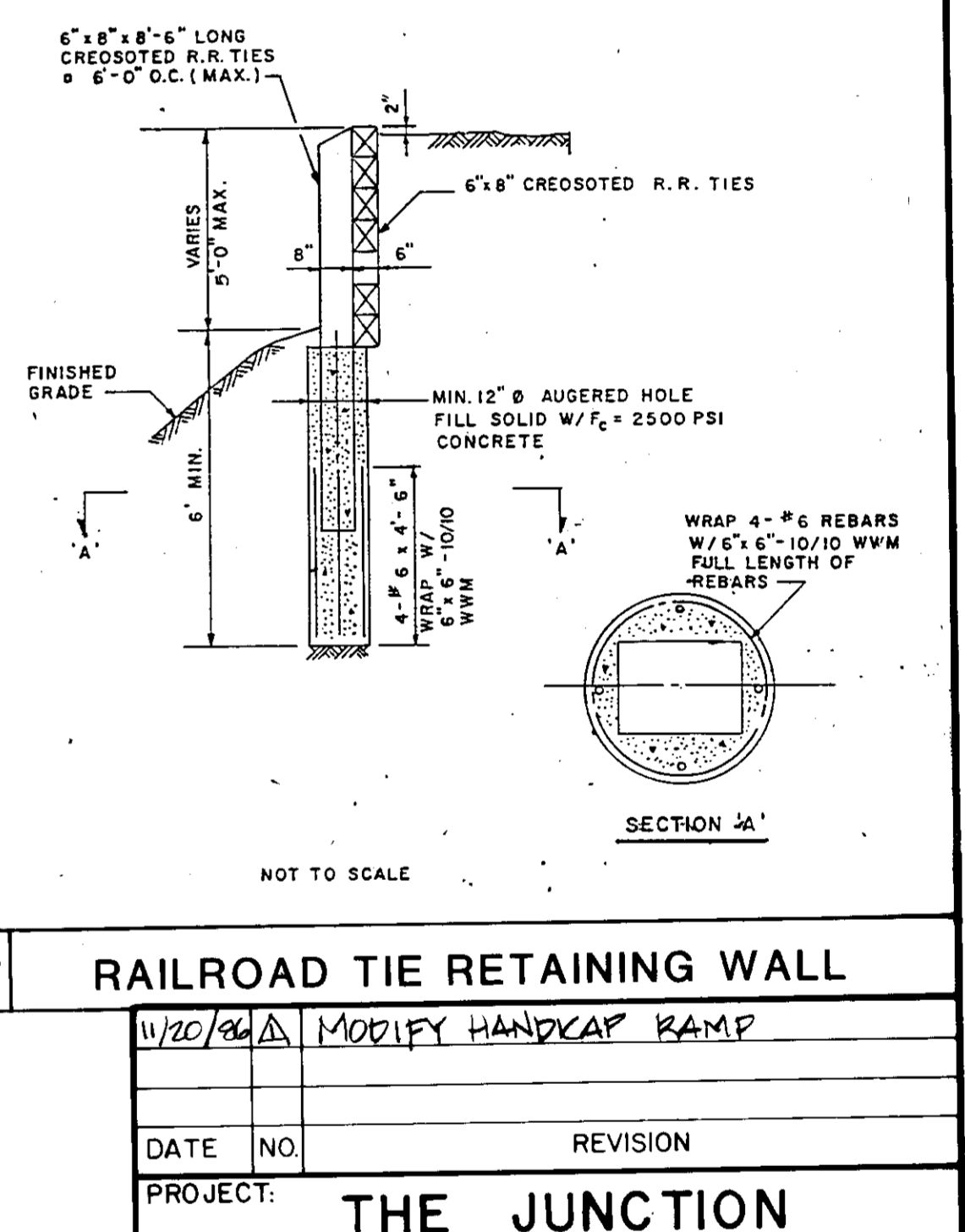
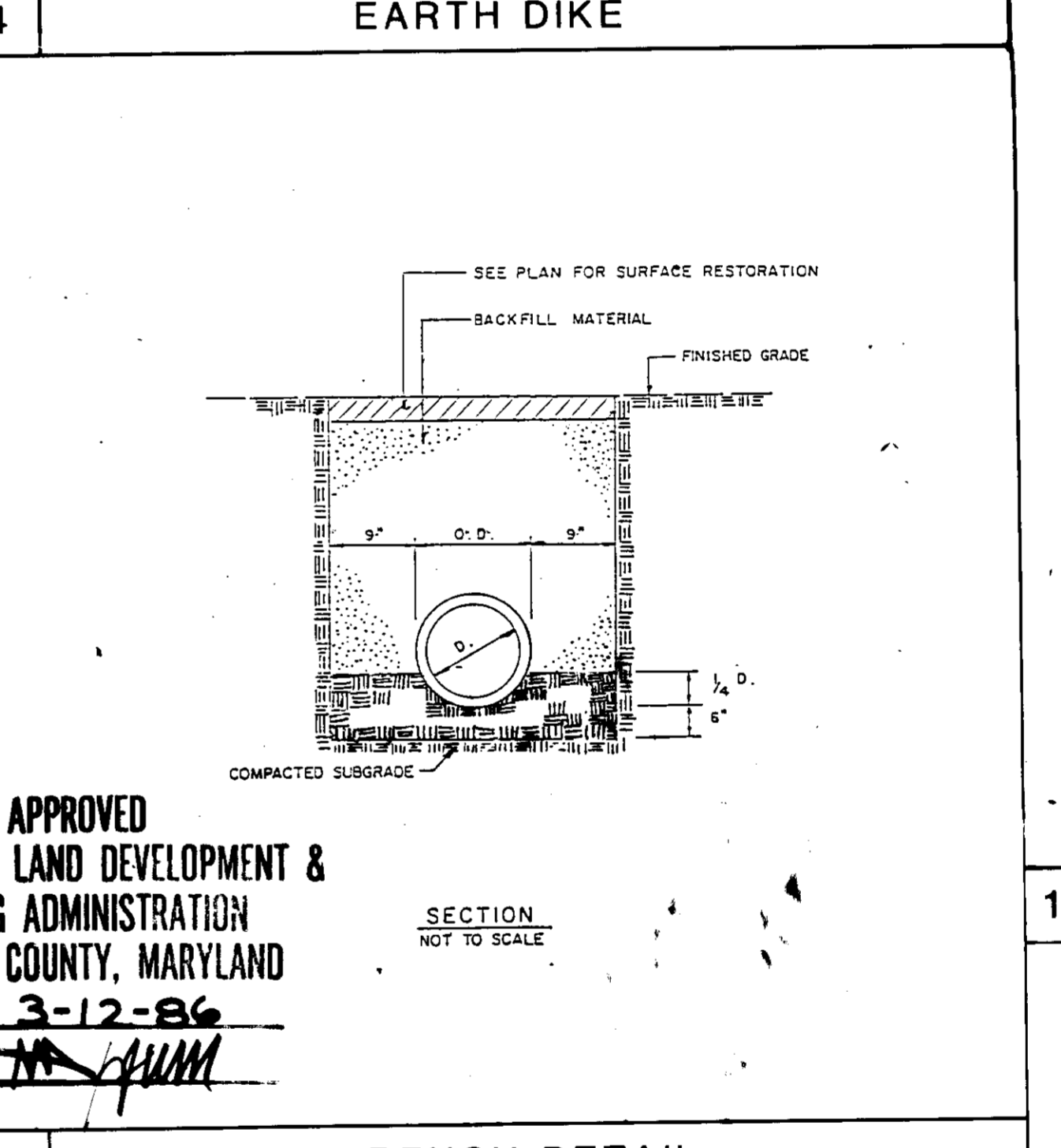
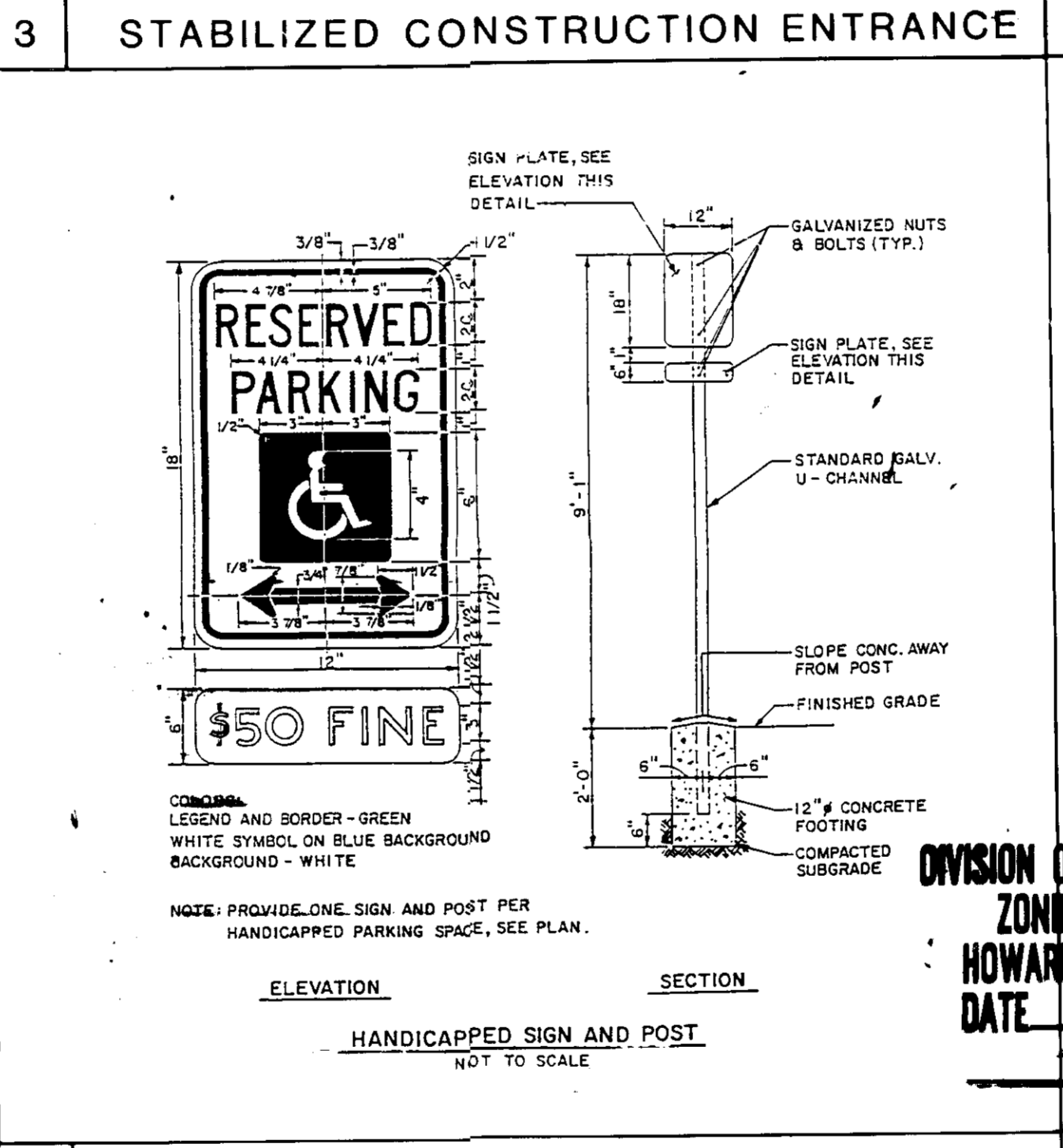
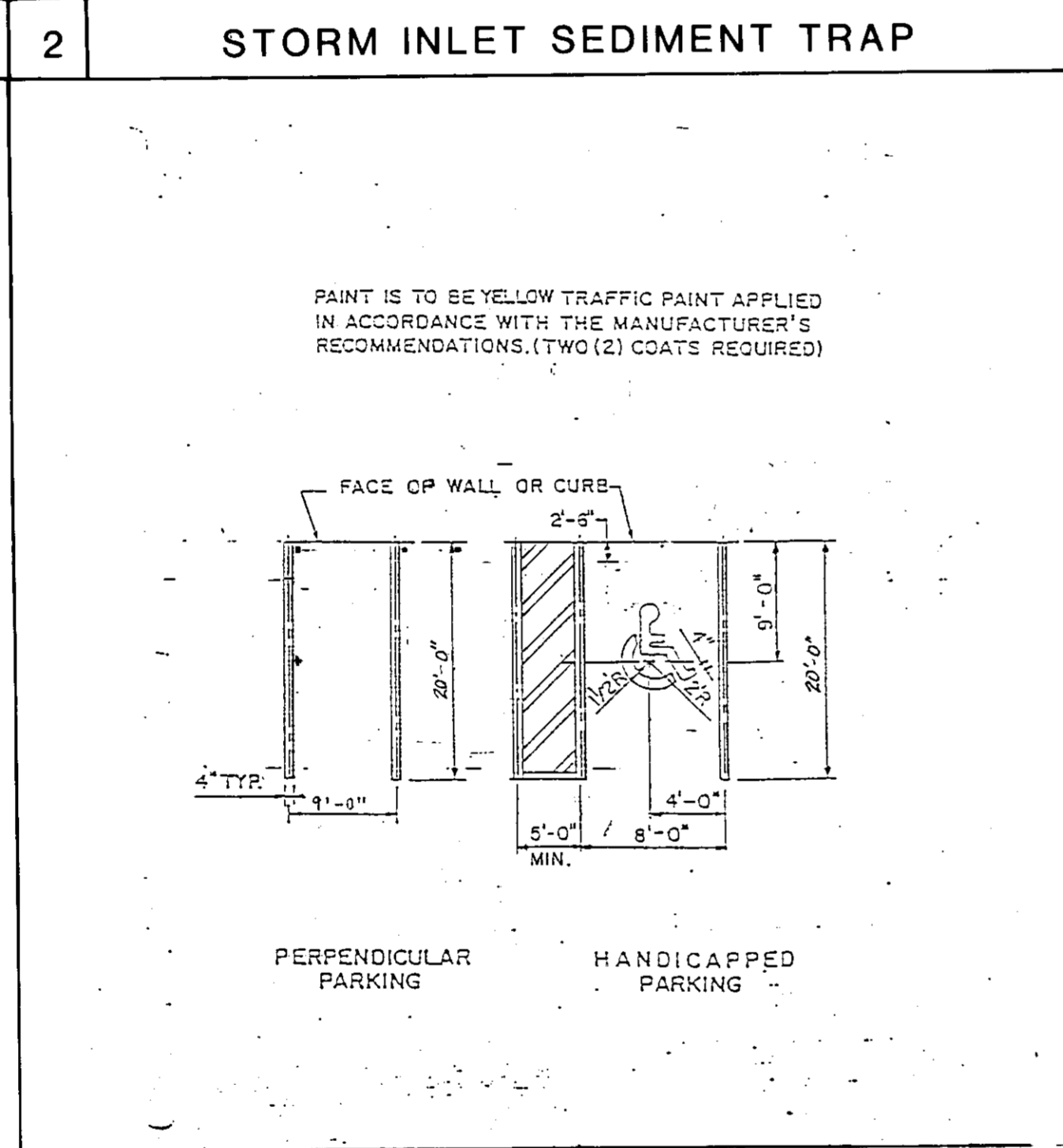
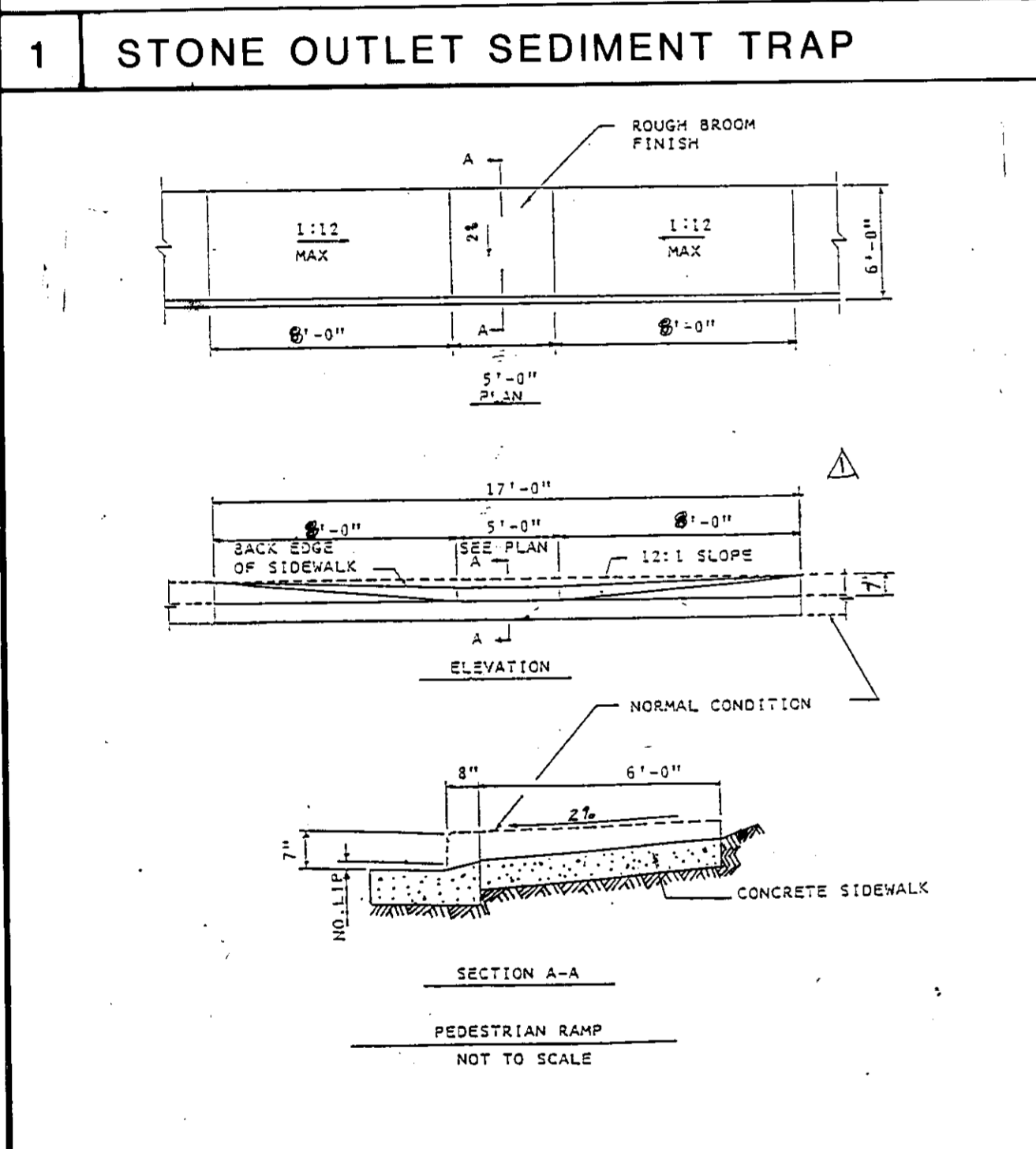
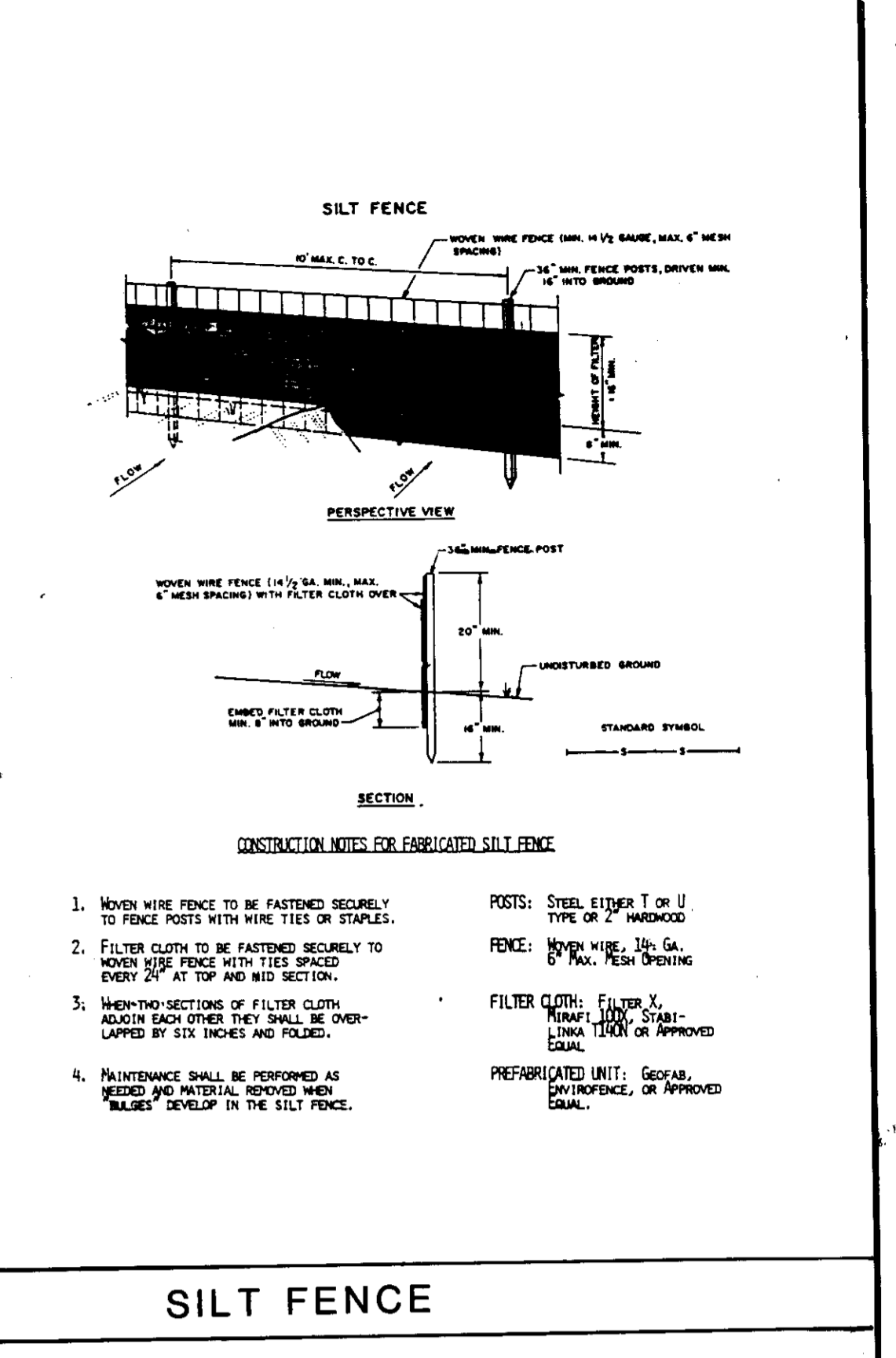
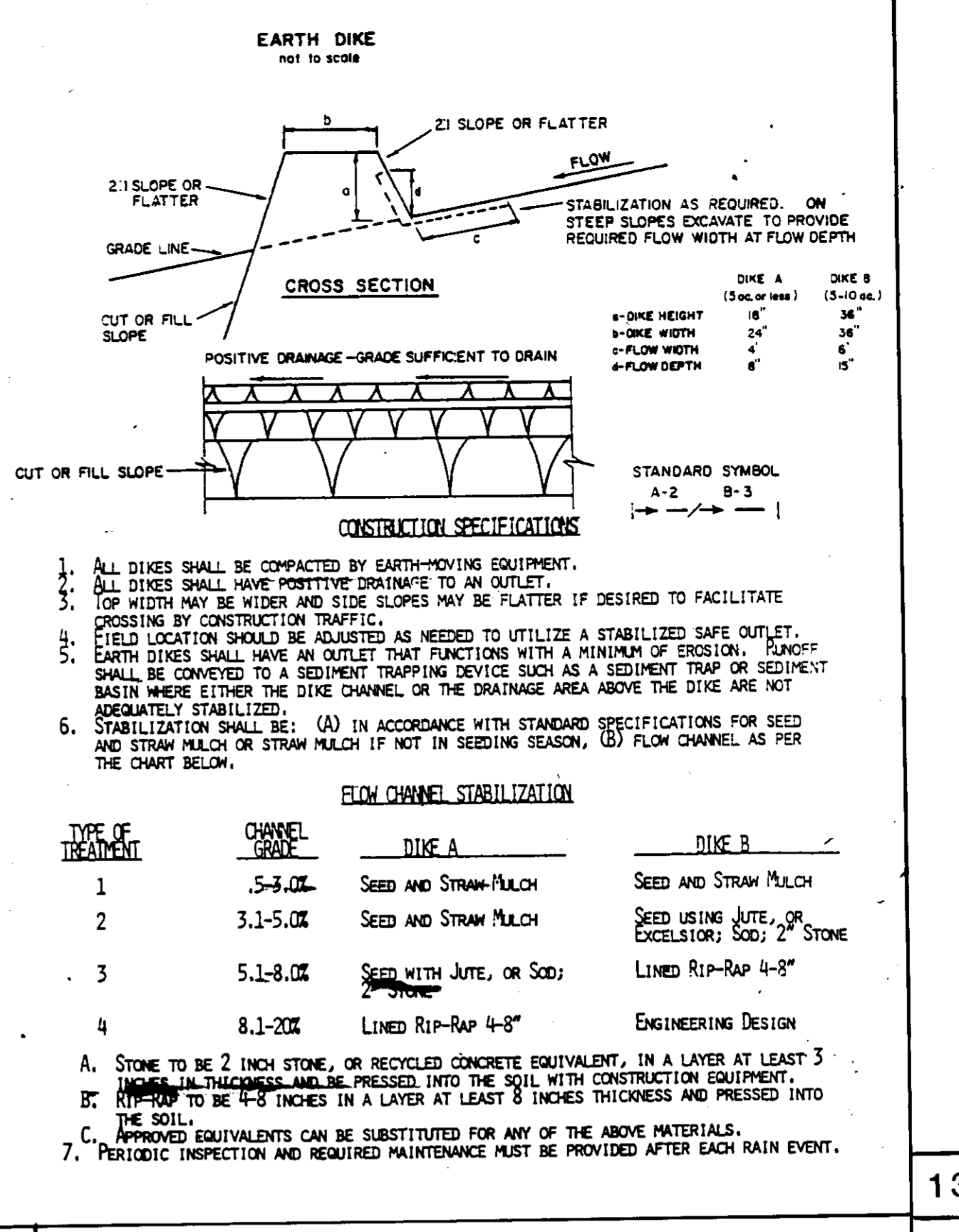
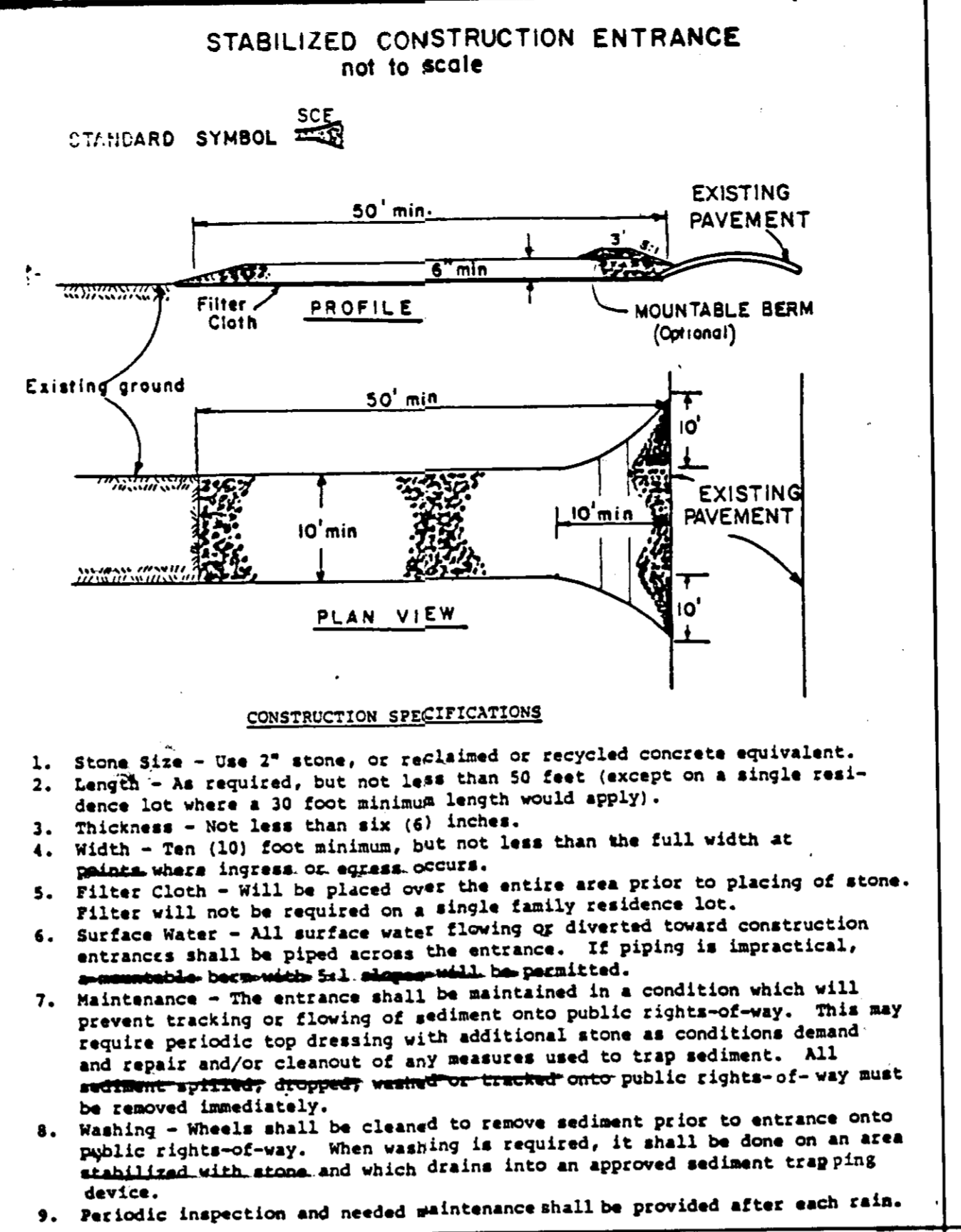
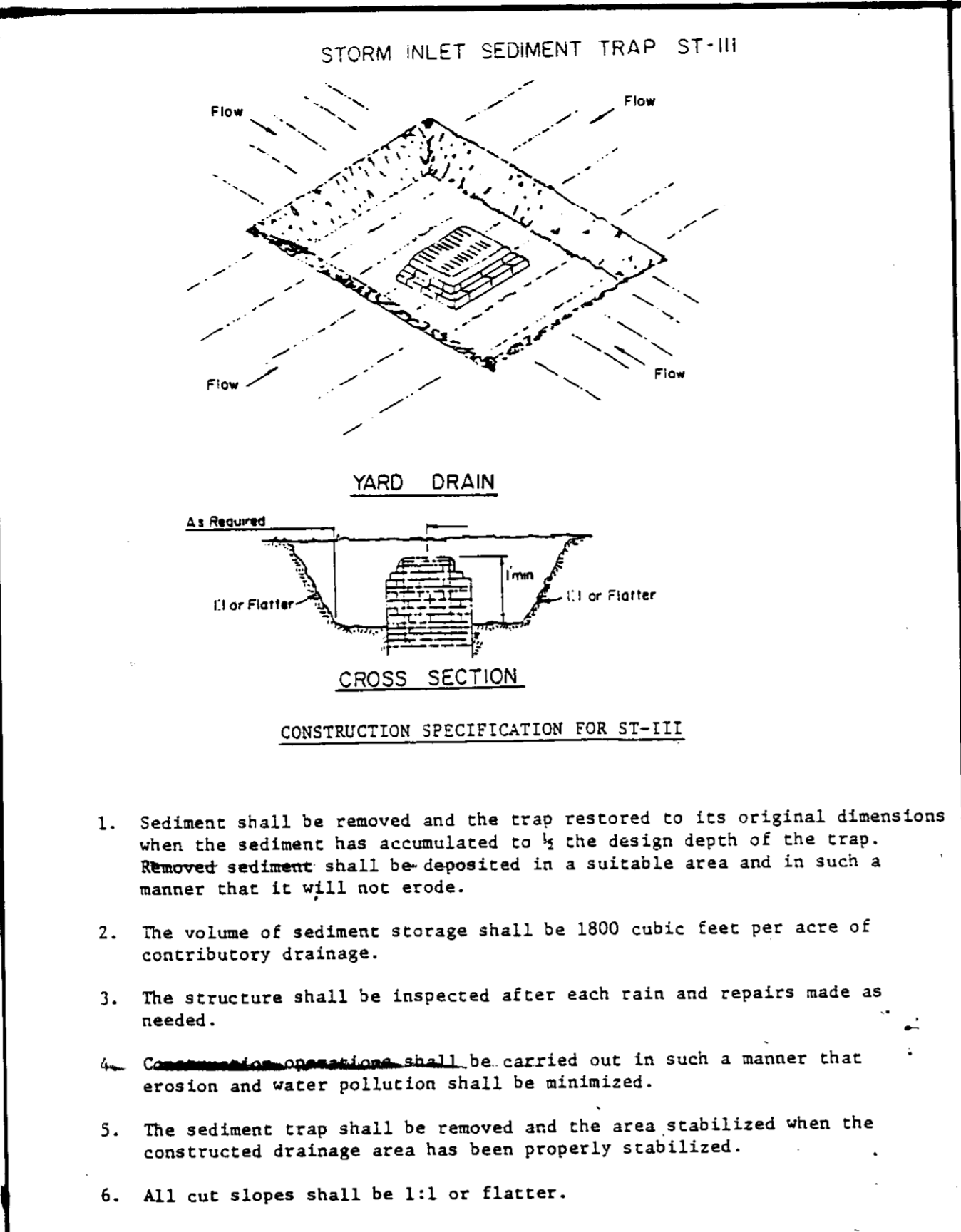
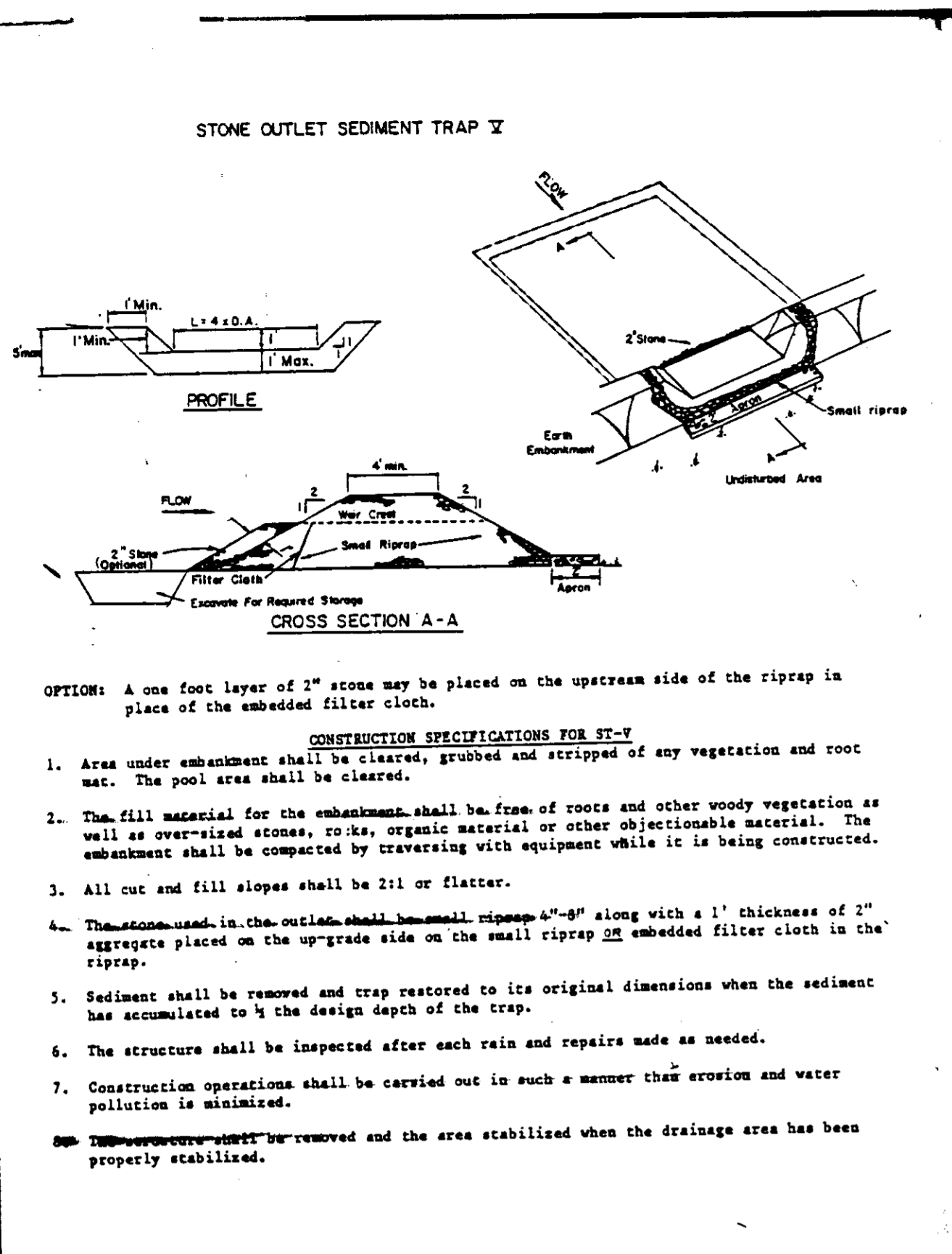

12 RAILROAD TIE RETAINING WALL

11/20/86 MODIFY HANDICAP RAMP

DATE NO. REVISION

PROJECT: **THE JUNCTION INDUSTRIAL PARK**

6th ELECTION DISTRICT HOWARD CO, MARYLAND SECTION 1 AREA 1 PARCEL "G-1"

TITLE: **SEDIMENT AND EROSION AND MISCELLANEOUS DETAILS**

OWNER: **EHM G LIMITED PARTNERSHIP**
P.O. BOX 125
GLEN ARM, MARYLAND 21057

ENGINEERS: **WHITNEY, BAILEY, COX & MAGNANI**
CONSULTING ENGINEERS
1850 YORK ROAD
TIMONIUM, MARYLAND 21093
301-252-6060

DATE: _____

DESIGNED: R. B.

DRAWN: G. G.

CHECKED: P. D.

PROJECT NO: **85232**

DATE: 12/12/85

SCALE: AS SHOWN

PROFESSIONAL ENGR. NO. 9772

SDP-86-135

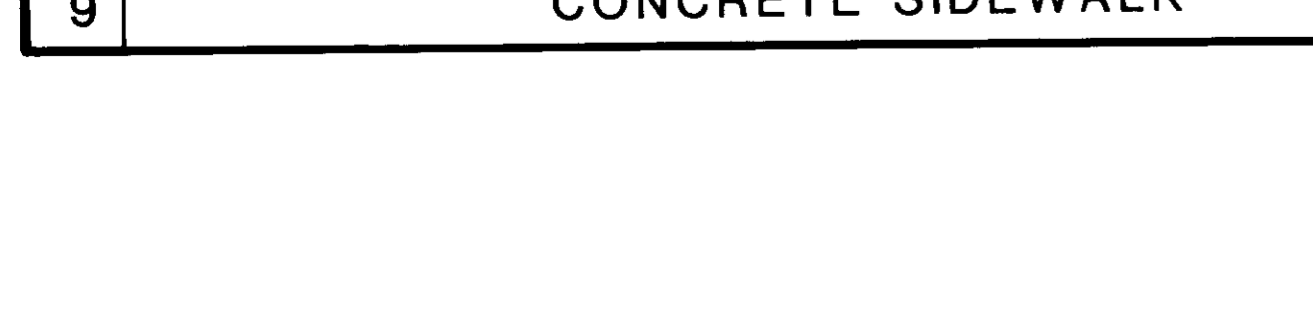

8 TRENCH DETAIL

SUBDIVISION NAME: THE JUNCTION INDUSTRIAL PARK

SECT./AREA: 1/1

LOT/PARCEL NO.: G-1

PLAT: 6379

BLOCK: 19

ZONE: M-2

TAX/ZONE MAP: 48

ELEC. DIST.: 6

CENSUS TR.: 6064

WATER CODE: CO4

SEWER CODE: 4020000

APPROVED: FOR PUBLIC WATER AND PUBLIC SEWERAGE AND STORM DRAINAGE SYSTEMS AND ROADS

HOWARD COUNTY DEPARTMENT OF PUBLIC WORKS

DIRECTOR: *John F. Numa* DATE: 4-22-86

CHIEF, BUREAU OF ENGINEERING: *William J. Rice* DATE: 4-22-86

APPROVED: FOR PUBLIC WATER AND PUBLIC SEWERAGE SYSTEMS

HOWARD COUNTY HEALTH DEPARTMENT

CHEATHEALTH OFFICER: *John F. Numa* DATE: 4-24-86

APPROVED: HOWARD COUNTY OFFICE OF PLANNING AND ZONING

PLANNING DIRECTOR: *Thomas W. Hays* DATE: 4-24-86

CHIEF, DIVISION OF LAND DEVELOPMENT AND ZONING ADMINISTRATION: *William J. Rice* DATE: 4-24-86

ADDRESS CHART	
LOT NUMBER	STREET ADDRESS
PARCEL 'G-1'	9015 JUNCTION DRIVE

JUNCTION INDUSTRIAL PARK M-2 ZONED
PARCEL 'C-2'

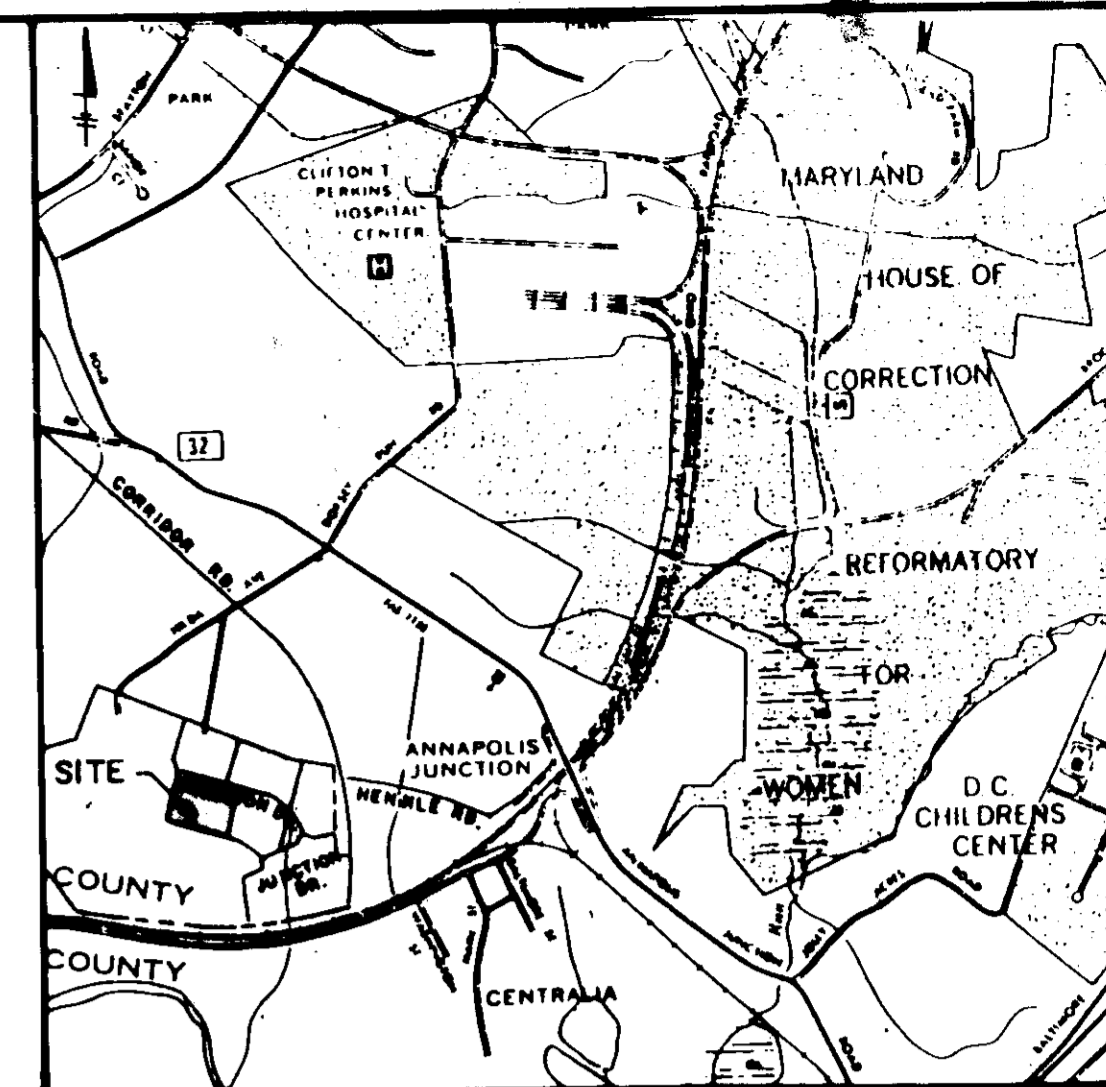

VICINITY MAP
SCALE: 1" = 2000'

NOTES

- CONTRACTOR SHALL BE RESPONSIBLE FOR ANY DAMAGE TO UTILITIES. CONTRACTOR SHALL MAKE MINOR ADJUSTMENTS IN SPACING AND/OR LOCATION OF PLANT MATERIAL TO AVOID CONFLICTS WITH UTILITIES. SEE SHEET SD-1 FOR COMPLETE UTILITY INFORMATION.
- REFER TO SPECIFICATIONS FOR ADDITIONAL INFORMATION ON PLANT MATERIALS AND PLANTING METHODS.

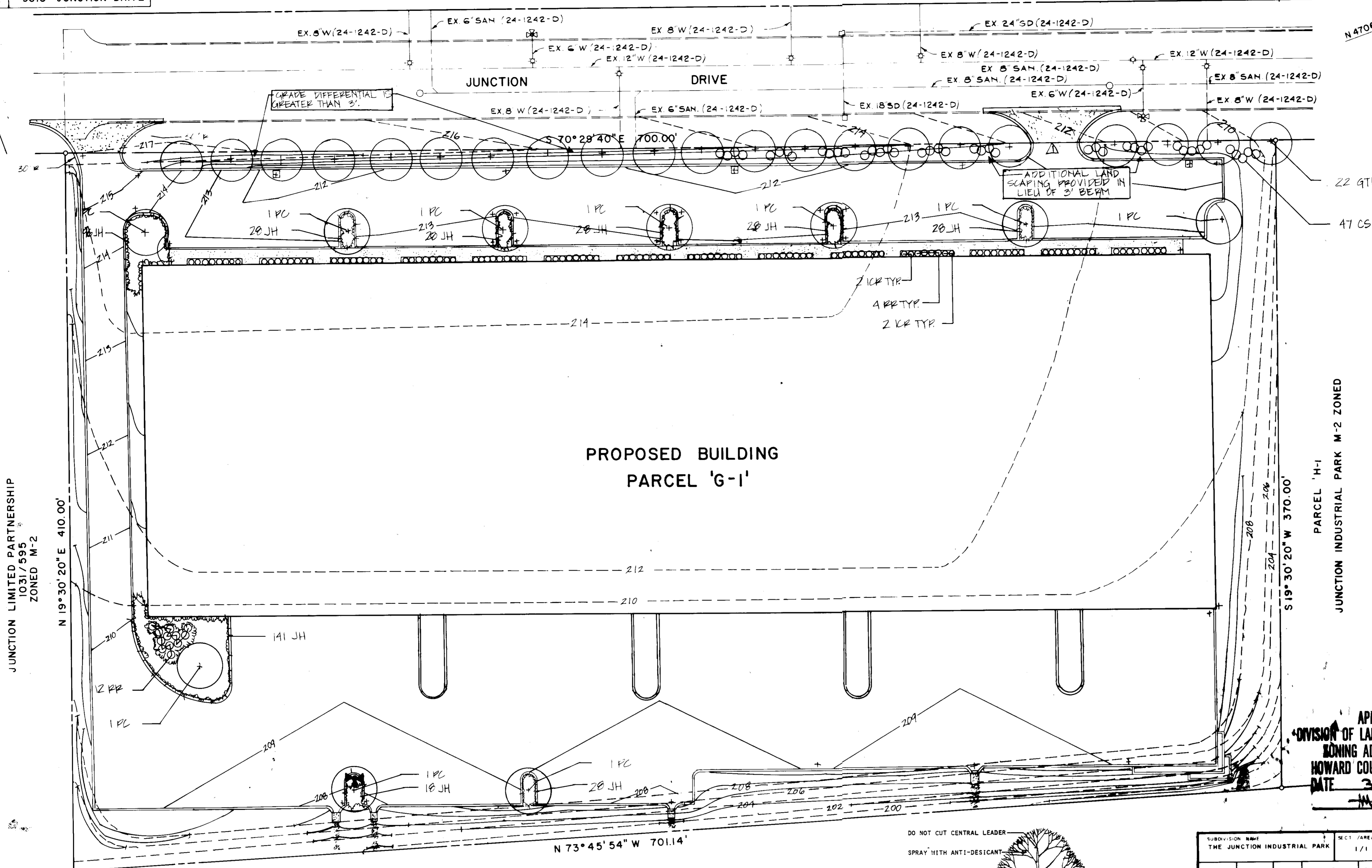

PROPOSED BUILDING
PARCEL 'G-1'

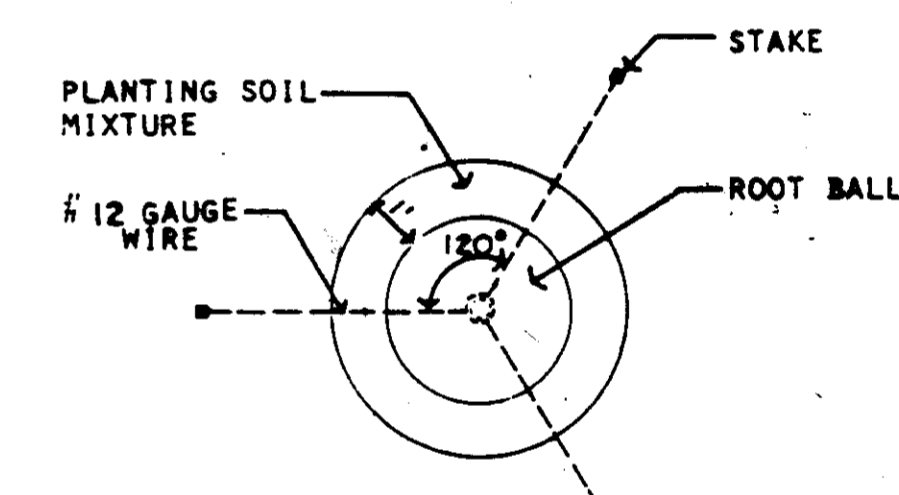

STAKING PLAN
NOT TO SCALE

APPROVED
DIVISION OF LAND DEVELOPMENT &
ZONING ADMINISTRATION
HOWARD COUNTY, MARYLAND
DATE 3-12-86

7/1/86 ADDITION OF EASTERN ENTRANCE

DATE	NO.	REVISION

PROJECT: THE JUNCTION INDUSTRIAL PARK
6th ELECTION DISTRICT HOWARD CO., MARYLAND
SECTION I AREA I PARCEL "G-1"
TITLE: SD-5

PLANTING PLAN

OWNER: EHM G LIMITED PARTNERSHIP
P.O. BOX 125
GLEN ARM, MARYLAND 21057
ENGINEERS: WHITNEY, BAILEY, COX & MAGNANI
CONSULTING ENGINEERS
1850 YORK ROAD
TIMONUM, MARYLAND 21093
301 252-6080

DATE: DESIGNED: R.B.
DRAWN: G.G.
CHECKED: F.D.
PROJECT NO: 85232
DATE: 12/12/85
SCALE: 1" = 30'
PROFESSIONAL ENGR. NO. 9711 DRAWING NO. 5 OF 6



PLANT SCHEDULE

KEY	QUAN.	BOTANICAL NAME COMMON NAME	SIZE	FOOT	REMARKS
PL	10	PYRUS CALLERYANA 'BRADFORD' BRADFORD PEAR	2-2 1/2' CAL	B&B	HIGH BRANCHED FORM
GT	21	GLEBITISIA TRIACANTHOS var. INERMIS THORNLESS HONEYLOCUST	2 1/2-3" CAL	B&B	
RR	60	ROSA RUGOSA RED RUGOSA ROSE	2 1/2-3' HT	CONT.	
CS	42	CORNUS SEPTICEA PEDDISIER DOGWOOD	3-4' HT	B&B	
JH	123	JUNIPERUS HORIZONTALIS 'WILTONI' BLUE BUG JUNIPER	12-15" HT	CONT.	PLANT 3' O.C.
ICR	50	ILEX CRENATA 'REPANDENS' JAPANESE HOLLY	2-2 1/2' HT	B&B	

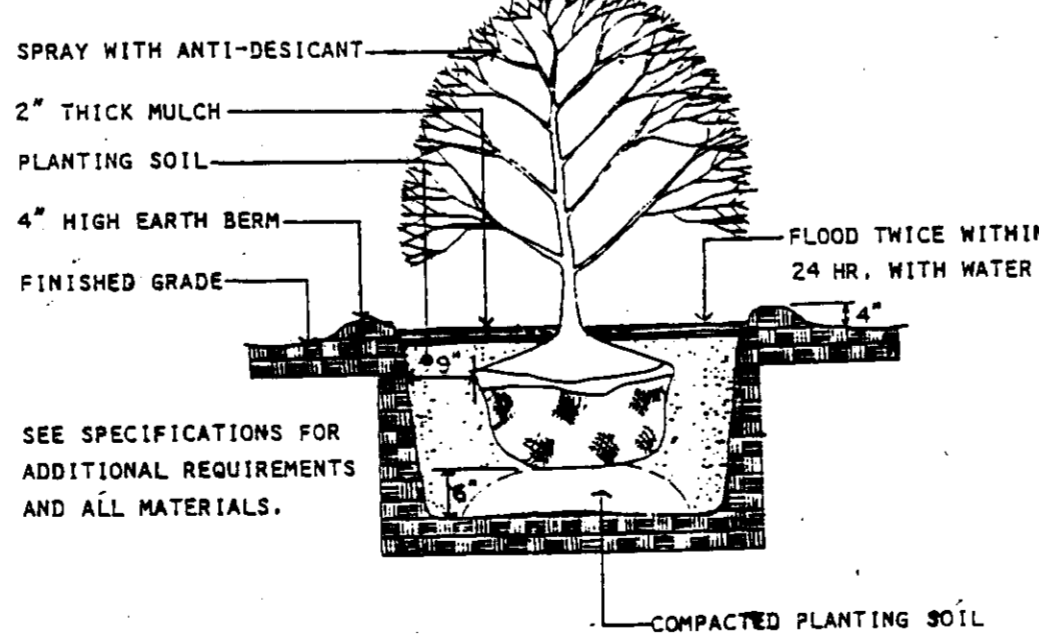

SHRUB PLANTING DETAIL
NOT TO SCALE

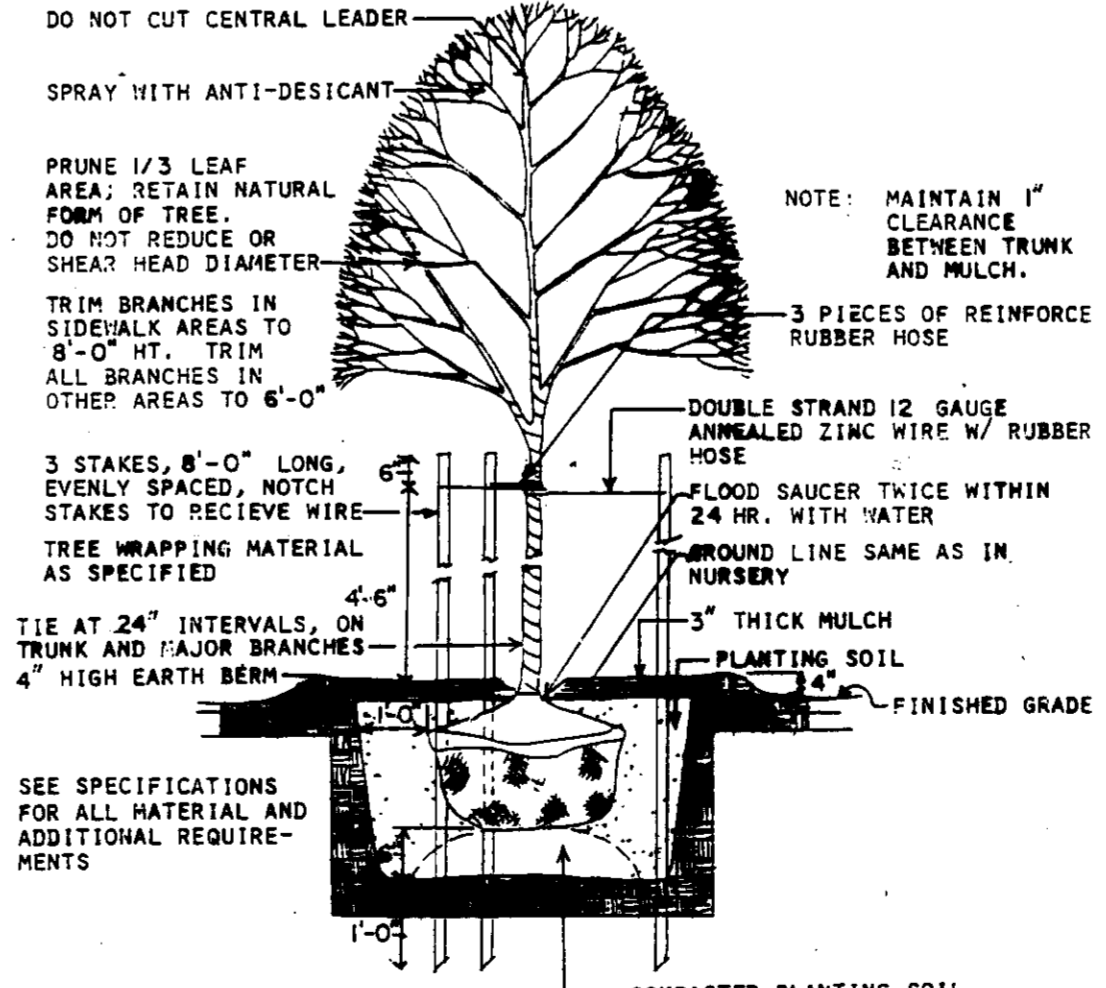

TREE PLANTING DETAIL
NOT TO SCALE

SUBDIVISION NAME THE JUNCTION INDUSTRIAL PARK		SECT./AREA 1/1	LOT/PARCEL NO. PARCEL G-1
PLAT 6379	BLOCK 19	ZONE M-2	TAX/ZONE MAP 48
ELEC. DIST. 6		CENSUS TR. 6064	
WATER CODE CO 4		SEWER CODE 4020000	
APPROVED FOR PUBLIC WATER AND PUBLIC SEWERAGE AND STORM DRAINAGE SYSTEMS AND ROADS HOWARD COUNTY DEPARTMENT OF PUBLIC WORKS DIRECTOR: [Signature] DATE: 6-22-86			
APPROVED FOR PUBLIC WATER AND PUBLIC SEWERAGE SYSTEMS HOWARD COUNTY HEALTH DEPARTMENT COUNTY HEALTH OFFICER: [Signature] DATE: 4-24-86			
APPROVED HOWARD COUNTY OFFICE OF PLANNING AND ZONING PLANNING DIRECTOR: [Signature] DATE: 4-24-86			
APPROVED DIVISION OF LAND DEVELOPMENT AND ZONING ADMINISTRATION DATE: 4-24-86			